

OCT. 7 - 1911

4-683.

MINERAL SURVEY No. 2890

NOV. 6 - 1911

LOT No.

Arizona Land District.

FIELD NOTES

OF THE SURVEY OF THE MINING CLAIM OF

Lincoln Consolidated Mining Company,

KNOWN AS THE

AGUINALDO, KING DAVID, QUEEN ANN, DAISY, ADMIRAL DEWEY,

PAPAGO Mining District,

PIMA County, Arizona,

Section 26, 35, 36, Township T7 South, Range 10 East

Surveyed under instructions dated February 11, 1911,

by Paul E. Fernald,
U. S. Mineral Surveyor.

Claim located (See Location Notices), 19

Survey commenced March 14, 1911.

Survey completed March 22, 1911.

6-822
Address:

Chas. E. Gill, Vice-President,
Lincoln Consolidated Mining Co.,
Redlands, California.

July 1st. 1910.

SURVEY NO. 2890.

KING DAVID

Beginning at Cor.No.1

Identical with Cor.No.1, Daisy lode, this survey.

" " Cor.No.2, Admiral Dewey lode, this survey

" " Cor.No.2, Aguinaldo lode, this survey,

A pine post, 4½ ft.long, 4 in.sq.,set 1½ ft.in ground,
with mound of stone, scribed 2890, 1-KING DAVID,
2890, 1-DAISY,
2890, 2-ADML.DEWEEY,
2890, 2-AGUINALDO,

Whence:-a Quartzite Rock, scribed (X) B.R. on face,
bears N 66°50'W, 31.18 ft.

the S.¼ Cor.of Sec.26, T 17 S, R 10 E, G & S.R.M.
bears S 40° 14'W, 1383.11 ft.

the S.E.Cor.of Sec.26, T 17 S, R 10 E, G & S.R.M.
bears S 55° 33'E, 1935.31 ft.

thence N 29°59'W

140.00 Center road, running N.E. and S.W.

193.00 Center gulch, running S 55° W.

1500.00 To Cor.No.2,

Identical with Cor.No.2,Daisy Lode, this Survey,

A pine post, 4½ ft.long, 4 in.sq.,set 1½ ft.in ground,
with mound of stones, Scribed 2890, 2-KING DAVID,
2890, 2-DAISY.

thence N 60° 01'E,

300.00 N.W.End Center, monument of stone, 3.ft.high.

460.00 Small Gulch from S.E.

600.00 To Cor.No.3, on E.bank of gulch from S.E.

A pine post, 4½ ft.long, 4 in.sq.,set 1½ ft.in ground,
with mound of stones, Scribed 2890, 3-KING DAVID.

thence S 29°59'E

1410.00 Center Gulch from East.

1500.00 To Cor.No.4,

Identical with Cor.No.3, Aguinaldo lode, this survey,

A pine post, 4½ ft.long, 4 in.sq.,set 1½ ft.in ground,
with mound of stones, Scribed 2890, 4-KING DAVID.
2890, 3-AGUINALDO.

(2).

SURVEY NO. 2890, (Continued)

KING DAVID LODE, (Continued).

Whence Quartzite rock, scribed (X) B.R., bears N 18° 30' E,
13.23 ft.

thence S 60° 01' W.

198.00 Center Gulch from S.E.
287.00 Center mouth of Cut,
300.00 S.E. End center. monument of stone 3.ft. high.
600.00 To Cor.No. I, the place of beginning.

DAISY

Beginning at Cor.No. I, identical with Cor.No. I, King David
lode, this survey, previously described.

Whence:- the S $\frac{1}{4}$ Cor. of Sec. 26, T 17 S, R 10 E, G & S.R.M.
bears S 40° 14' W, 1383.11 ft.

the S.E. Cor. of Sec. 26, T 17 S, R 10 E, G & S.R.M.
bears S 55° 33' E, 1935.31 ft.

140.00 Center road running NE & SW. thence N 29° 59' W
193.00 Center gulch running S55° W.
1500.00 To Cor.No. 2, identical with Cor.No. 2, King David Lode,
this survey, heretofore described.

thence S 60° 01' W

17.00 Center Gulch from South.
300.00 N.W. End Center. monument of stone 3.ft. high.
600.00 To Cor.No. 3,

A pine post, 4 $\frac{1}{2}$ ft. long, 4 in. sq., set 1 $\frac{1}{2}$ ft. in ground,
with mound of stones, scribed 2890, 3-DAISY, whence Cor. No. 3,
Kentucky¹⁹⁰¹ lode, Sur. No. 2891 A, brs. N. 89° 09' W, 1890.88 ft.

thence S 29° 59' E,

1278.50 Center gulch from East.
1369.00 Road running E. & W.
1500.00 To Cor.No. 4,
Identical with Cor.No. 3, Admiral Dewey Lode, this survey.
Identical with Cor.No. 2, (N.E. Cor.), Hillside No. I Lode,
unsurveyed.

SURVEY NO. 2890, (Continued)

DAISY LODE, (Continued).

A pine post, $4\frac{1}{2}$ ft. long, 4 in. sq., set $1\frac{1}{2}$ ft. in ground,
with mound of stones, scribed 2890, 4-DAISY.

2890, 3-ADMIRAL DEWEY.

2-HILLSIDE.

Whence the N.W. Cor. (Cor. No. 3) Hillside No. 1 Lode,

bears S $60^{\circ}01'W$, 600.00 ft.

Thence N $60^{\circ}01'E$

300.00 S.E. End Center monument of stone 3 ft. high.

310.00 Junction road east of bend, and small gulch from S.E.

402.00 Road west of bend.

600.00 To Cor. No. 1, the place of beginning.

AGUINALDO

Beginning at Cor. No. 1,

Identical with Cor. No. 1, Admiral Dewey Lode, this survey.

" " Cor. No. 1, Queen Ann Lode, this survey.

" " Cor. No. 1, (N.E. Cor.) Sunset Lode, unsurveyed.

A pine post, $4\frac{1}{2}$ ft. long, 4 in. sq., set $1\frac{1}{2}$ ft. in ground,

with mound of stones, scribed 2890, I-AGUINALDO,
2890, I-ADML. DEWEY,
2890, I-QUEEN ANN,
I-SUNSET.

Whence: - the S.E. Cor. of Sec. 26, T 17 S, R 10 E, G & S.R.M.

bears N $76^{\circ}25'E$, 870.65 ft.

the S.E. Cor. Sec. 35, T 17 S, R 10 E, G & S.R.M.,

bears S $9^{\circ}14'E$, 5208.30 ft.

the S $\frac{1}{4}$ Cor. of Sec. 26, T 17 S, R 10 E, G & S.R.M.

bears N $81^{\circ}35'W$, 1661.12 ft.

thence N $29^{\circ}59'W$

253.71 Intersects the S. boundary of Sec. 26, T 17 S, R 10 E, G &

S.R.M., N $89^{\circ}06'W$ - 972.74 ft. from the S.E. Corner, and

S $89^{\circ}06'E$ - 1516.61 ft. from the S $\frac{1}{4}$ Cor. of said Section.

1500.00 To Cor. No. 2,

Identical with Cor. No. 1, King David Lode, this survey,

heretofore described

(4).

Survey No. 2890, (Continued).

AGUINALDO LODE, (Continued).

thence N 60°01'E

300.00 N.W. End Center. monument of stone 3.ft.high.
 402.00 Center gulch from S.E.
 600.00 To Cor.No.3.

Identical with Cor.No.4, King David Lode, this survey,
 previously described.

thence S 29°59'E

1500.00 To Cor.No.4,

Identical with Cor.No.4, Queen Ann Lode, this survey.

A pine post, $4\frac{1}{2}$ ft.long, 4 in.sq., set $1\frac{1}{2}$ ft.in ground,

with mound of stones, scribed 2890, 4-Aguinaldo.

Whence:- the S.E.Cor.of Sec.26, T 17 S, R 10 E, G & S.R.M.
 2890, 4-Queen Ann

bears S 73°42'E, 339.80 ft.

Cor.No.2, Black Dike No.41 Lode, and Cor.No.3,

Black Dike No.42 Lode, both unsurveyed, bears N 53°15'E,
 457.90 ft.

thence S 60°01'W

175.80 Intersects the S boundary of Sec.26, T 17 S, R 10 E, G &
 S.R.M., N 89°06'W, 478.47 ft.from the S.E.Cor., and S 89°06'E
 2010.88 ft. from the S $\frac{1}{4}$ Cor. of said section.

300.00 S.E. End Center, monument of stone 3.ft.high.

600.00 To Cor.No.1, the place of beginning.

ADMIRAL DEWEY

Beginning at Cor.No.1,

Identical with Cor.No.1, Aguinaldo Lode, this survey,
 heretofore described.

Whence :- the S.E.Cor. of Sec.26, T 17 S, R 10 E, G &
 S.R.M., bears N 76°25'E, 870.65 ft.

the S.E.Cor. of Sec.35, T 17 S, R 10 E, G &
 S.R.M., bears S 9°14'E, 5208.30 ft.

the S $\frac{1}{4}$ Cor. of Sec.26, T 17 S, R 10 E, G &
 S.R.M., bears N 81°35'W, 1661.12 ft.

SURVEY NO. 2890. (Continued).

ADMIRAL DEWEY LODGE, (Continued).

thence N 29°59'W

253.71 Intersects S boundary of Sec.26, T 17 S, R 10 E, G & S.R.M. N 89°06'W, 972.74 ft. from the S.E.Cor.; and S 89°06'E, 1516.61 ft. from the S 1/4 Cor. of said section.

1500.00 To Cor.No.2,
Identical with Cor.No.1, King David lode, this survey, previously described.

198.00 *Intersect road.* thence S 60°01'W
290.00 *Junction road east of bend, and small gulch from S.E.*
300.00 N.W.End Center. monument of stone 3.ft.high.

600.00 To Cor.No.3,
Identical with Cor.No.4, Daisy Lode, this survey, heretofore described.

thence S 29°59'E

887.44 Intersects the S.boundary of Sec.26, T 17 S, R 10 E, G & S.R.M., N 89°06'W, 1671.87 ft. from the S.E.Cor., and S 89°06'E, 817.48 ft. from the S 1/4 Cor.of said section.

1500.00 To Cor.No.4,
(S.E. Cor)
Identical with Cor.No.1, Hillside No.1 Lode, unsurveyed.
" " Cor.No.1, Hillside No.2 Lode, unsurveyed.
(N.E. Cor.)
" " Cor.No.4, Sunset Lode, unsurveyed.
(W.W. Cor.)

A pine post, 4 1/2 ft. long, 4 in. sq., set 1 1/2 ft. in ground, with mound of stones, scribed 2890, 4-AD.DY.
I-HILLSIDE-1.
I-HILLSIDE-2.
4-SUNSET.

thence N 60°01'E

300.00 S.E.End Center. monument of stone 3.ft.high.

571.00 Small gulch, running S - S.E.

600.00 To Cor.No.1, the place of beginning.

QUEEN ANN

Beginning at Cor.No.1,
Identical with Cor.No.1, Aguinaldo Lode, this survey, heretofore described,

(6).

Survey No. 2890, (Continued).

QUEEN ANN LODE, (Continued).

Whence:- the S.E. Cor. of Sec. 26, T 17 S, R 10 E, G & S.R.M.
bears N 76° 25' E, 870.65 ft.

the S.E. Cor. of Sec. 35, T 17 S, R 10 E, G & S.R.M.
bears S 9° 14' E, 5208.30 ft.

the S $\frac{1}{4}$ Cor. of Sec. 26, T 17 S, R 10 E, G & S.R.M.
bears N 81° 35' W, 1661.12 ft.

thence S 29° 59' E

- 290.00 Small gulch from N.W.
- 766.00 Small gulch from N.- N.W.
- 978.00 N. bank big wash running W.
- 1107.00 S. bank " " " " .
- 1500.00 To Cor. No. 2,
Identical with Cor. No. 2, Sunset Lode, unsurveyed.
A pine post, 4 $\frac{1}{2}$ ft. long, 4 in. sq., set 1 $\frac{1}{2}$ ft. in ground
with mound of stones, scribed 2890, 2-QUEEN ANN.
2-SUNSET.
Whence:- Cor. No. 3, Sunset Lode, unsurveyed, bears S 60° 01' W
600.00 ft.
Cor. No. 2, Rescue No. 1 Lode, unsurveyed, bears
S 7° 50 $\frac{1}{2}$ ' W, 2872.47 ft.
-
- thence N 60° 01' E
- 108.16 Intersects the E. boundary of Sec. 35, T 17 S, R 10 E, G &
S.R.M., S 0° 06' W, 1449.69 ft. from the N.E. Corner, and
N 0° 06' E, 3895.63 ft. from the southeast corner.
- 300.00 S.E. End Center. monument of stone 3 ft. high.
- 469.00 West bank wash from S.E.
- 593.00 Witness Cor. to true Cor. No. 3,
A pine post, 4 $\frac{1}{2}$ ft. long, 4 in. sq., set 1 $\frac{1}{2}$ ft. in ground
with mound of stones, scribed 2890, W.C.-3-QUEEN ANN.
- 600.00 To true Cor. No. 3, not set, as it falls in channel of wash
and could not be permanent,
Whence:- W.C., heretofore described, bears S 60° 01' W, 7 ft.
a Mesquite Tree, marked B.T., bears N 11° 28' W, 93.24 ft
50.00 ft.

SURVEY NO. 2890, (Continued).

QUEEN ANN LODE, (Continued).

Cor.No.3, Black Dike No.4I Lode, unsurveyed, bears
N 7°25'E, 135.00 ft.

thence $N 29^{\circ} 59' W$

- III.50 E.bank big wash.
480.00 Middle of N.E.branch of wash.
849.03 Intersects the E.boundary of Sec.35, T 17 S, R 10 E, G &
S.R.M.; S 0°06'W, 468.49 ft.from the N.E.Cor. and N 0°06'E
4876.83 ft.from the Southeast corner of said section.
I394.86 Intersects the S.boundary of Sec.26, T 17 S, R 10 E, G &
S.R.M.; N 89°06'W, 273.63 ft. from the S.E.Cor., and
S 89°06'E, 2215.72 ft. from the S $\frac{1}{4}$ Cor.of said section.
I500.00 To Cor.No.4,
Identical with Cor.No.4, Aguinaldo Lode, this survey,
heretofore described.
- thence S 60°01'W
- I75.80 Intersects the S boundary of Sec.26, T 17 S, R 10 E, G &
S.R.M.; N 89°06'W, 478.47 ft.from the S.E.Cor., and S 89°
06'E, 2010.88 ft.from the S $\frac{1}{4}$ Cor. of said section.
300.00 N.W.End Center. monument of stone 3.ft.high.
600.00 To Cor.No.I, the place of beginning.

No natural bearing objects available, except where spec-
ifically noted in connection with the respective corners.
Variation at all corners - 14° East.

LODE LINES.

As near as can be determined from present developments,
the veins of the several locations embraced in this claim
extend as follows from their respective discovery points:-
King David Lode, 1494.00 ft, N 29°59'W, and 6.00 ft, S 29°59'E.
Daisy Lode, 1200.00 ft., N 29°59'W, and 300.00 ft., S 29°59'E.
Aguinaldo Lode, 6.00 ft., N 29°59'W and 1494.00 ft., S 29°59'E.
Admiral Dewey Lode, 165.00 ft., N 29°59'W and 1335.00 ft.
S 29°59'E.

(8).

SURVEY NO. 2890, (Continued).

Queen Ann Lode, 530.00 ft., N 29°59'W and 970.00 ft., S 29°59'E.

AREA.

King David Lode	20.661 Acres.
Daisy Lode	20.661 " .
Aguinaldo Lode	20.661 " .
Admiral Dewey Lode	20.661 " .
Queen Ann Lode	20.661 " .

The survey of each lode of this location is identical with the respective amended location as staked upon the ground.

LOCATION.

This survey is located in Section 26, the N.E. $\frac{1}{4}$ of Sec. 35, and the N.W. $\frac{1}{4}$ of Sec. 36, T 17 S, R 10 E, G & S.R.M. in the Papago Mining District, Pima County, Arizona.

EXPENDITURE OF FIVE HUNDRED DOLLARS.

I certify that the value of the labor and improvements made upon, and for the benefit of, each of the locations embraced in said mining claim by the claimant or its grantors, is not less than five hundred dollars, and that said improvements consist of:-

KING DAVID

No. 1, The discovery cut, the N. side of mouth of which bears S 61° 13' W, 287. ft. from Cor. No. 4, is 6 ft. wide, 50. ft. long, with 19. ft. face, running in S 60° 01' W.

Value - - - - - \$700.00

No. 2, A shaft, which bears N 79° 50' W, 285. ft. from Cor. No. 4, is 184. ft. deep, 7x9 to 100. ft. depth, thence 5x7 ft. to bottom, together with 50. ft. of drift, 4x6, running W by S.W. Shaft is partially timbered, and equipped with gallows frame, Total value \$4500.00.

An undivided 1/5 interest is assigned to this claim.

Value - - - - - \$900.00

SURVEY NO. 2890, (Continued).

Note:-

This shaft, being centrally located, is a practical and feasible main working shaft for the group, as, by drifting and crosscutting therefrom, in different directions towards and under the several claims of this group, the entire group may be advantageously developed and ore extracted therefrom. This improvement is therefore a common improvement for the benefit of each claim of this group, and a 1/5 undivided interest in the total value of this improvement is properly accredited to each lode claim of the group. This shaft, being located at a low point, the bottom thereof is below the surface of each claim of this group, making it possible to extend crosscuts and drifts from this shaft, and intersect the ore-bodies lying under each claim.

No.3, A cut, the S.W.Cor. of which bears N 78°08'W, 243. ft. from Cor.No.4, is 52.ft.wide, 26½ ft.long, 15 ft face, running N 45° E.

Value - - - - - \$2500.00

DAISY

No.1, the discovery cut, on center line, 300.ft.from center of line 4 - I, is 4 ft.wide, 15 ft.long, 8½ ft.face.

Value - - - - - \$60.00

No.2, a shaft, bears N 22°38'W, 456.ft.from Cor.No.4, is 75.ft.deep, inclining to E., 4x6, with 28.ft.of 4x6 drift running N.from 37.ft.level.

Value - - - - - \$1200.00

No.3, a cut and tunnel, mouth of cut bears N 2°05'E, 75.ft.from Cor.No.4, cut is 18.ft.long, thence tunnel from face 41.ft.long, 4x6, running S.

Value - - - - - \$300.00

An undivided 1/5 interest in shaft No.2, King David Lode, heretofore described,

Value - - - - - \$900.00

AGUINALDO

No.1, The discovery cut,, the S side of mouth of which bears S 58°49'W, 287.ft.from Cor.No.3, is 6.ft.wide, 50.ft.

(10).

SURVEY NO. 2890, (Continued).

ft. long, with 19.ft. face, running in S 60° 01' W.

Value - - - - - \$700.00

No. 2, A shaft, bearing S 61° 04' W, 389.ft. from point 400. on line 3-4, is 10.ft. deep, 4x6 ft.

Value - - - - - \$50.00

No. 3, A shaft, bearing S 50° 57' W, 327.50 ft. from point 400.00 on line 3-4, is 17.ft. deep, 4x6 ft.

Value - - - - - \$150.00

No. 4, A tunnel, the mouth of which bears S 54° 30' W, 263.ft. from point 400.00 on line 3-4, is 35.ft. long, 5x7 ft. running S 60° W.

Value - - - - - \$300.00

No. 5, A cut, the mouth of which bears S 81° 54' W, 271. ft. from point 999.40 on line 3-4, is 12.ft. long, 4 ft. wide, 12 ft. face.

Value - - - - - \$70.00

No. 6, A shaft, bearing S 69° 26' W, 234.ft. from point 999.40 on line 3-4, is 8.ft. deep, 4x6 ft.

Value - - - - - \$40.00

No. 7, A shaft, bearing S 52° 25' W, 210.ft. from point 999.40 On line 3-4, is 10.ft. deep, 4x6 ft.

Value - - - - - \$50.00

An undivided 1/5 interest in shaft No. 2, King David Lode, heretofore described,

Value - - - - - \$900.00

ADMIRAL DEWEY LODE.

No. I, Discovery cut, on center line 165.ft. from point 300.00 on line 2-3, is 12.ft. long, 4.ft. wide, 10.ft. face.

Value - - - - - \$50.00

An undivided 1/5 interest in shaft No. 2. King David Lode, heretofore described.

Value - - - - - \$900.00

QUEEN ANN LODE.

No. I, the discovery point, showing ledge, is on center

SURVEY NO.2890.(Continued).

line, 530.00 ft.from point 300.00 on line 4-I.

No.2, Discovery shaft, bearing N 60°01'E, 61.ft.from the discovery point, heretofore described, is 23.ft.deep, 4x6 $\frac{1}{2}$.

Value - - - - - \$230.00

An undivided 1/5 interest in shaft No.2, King David Lode, heretofore described,

Value - - - - - \$900.00

OTHER IMPROVEMENTS.

A forge, bearing N 69°0'W, 300.00 ft. from Cor.No.4, King David Lode.

An engine house, the S.E.Cor.of which bears S 80°10'W, 392.ft.from Cor.No.4, King David Lode, is 20.ft.long, 12 $\frac{1}{2}$ ft.wide, of frame and Iron. Contains one 2 cyl. 20.H.P. Marinette Gas Engine; Rand Imperial Compressor, belt driven; direct geared hoist, with cable to Shaft No.2, King David Lode.

INSTRUMENT

This survey was made with Buff & Buff Transit No.6672. The courses were deflected from the true meridian as determined by direct solar observations. Distances were measured with 100.ft. and 300.ft. steel tapes.

REPORT.

The lines of locations embraced in this claim were run directly upon the ground, as indicated in field notes. All tie lines were run either directly upon the ground, or by traverses run upon the ground and submitted in a separate report herewith.

I marked the exact corner points on monuments by small nails driven in the tops of posts, at exact point.

The S.E.Cor.of Sec.26, T 17 S, R 10 E, G & S.R.M., is a square porphyry rock 1 ft.above ground, scribed (I) on S.face and (I) on E.face. No mound of stones near, nor any bearing rocks nor trees to be found.

SURVEY NO. 2890, (Continued).

The S $\frac{1}{4}$ Cor. of Sec. 26, T 17 S, R 10 E, G & S.R.M., is a stone 1 ft. above ground, marked ($\frac{1}{4}$) on N. face.

The S.E. Cor. of Sec. 35, T 17 S, R 10 E, G & S.R.M., is a flat lime rock set on end N & S. Inscriptions indistinct from age. Large mound of stones 2 ft. north.

The E $\frac{1}{4}$ Cor. of Sec. 35, T 17 S, R 10 E, G & S.R.M., could not be found, therefore theoretical $\frac{1}{4}$ Cor. point was taken at exact middle point of E. boundary of said section, S $0^{\circ}06'W$, 2672.66 ft. from the N.E. Cor., and N $0^{\circ}06'E$, 2672.66 ft. from the S.E. Cor. of section.

Hillside No. 1, Hillside No. 2, and Sunset Lodes, unsurveyed, Lincoln Consolidated Mining Company, Claimant:—all corners are monuments of stone, 3 ft. high, with 4x4" pine posts in centers.

Black Dike Nos. 41, 42, and 43 Lodes, unsurveyed, Tucson Consolidated Copper Company, Claimant. Corner monuments are small posts, 2 ft. above ground, scribed with corner numbers.

Cor. No. 2, Rescue No. 1 Lode, unsurveyed, Olympia Mining & Milling Company, Claimant, is a redwood post, 4 ft. above ground, 4x4", scribed 2-RESCUE-1.

Note. The Discovery shaft of the Queen Ann Lode lies N $60^{\circ}01'E$, 61 ft. from discovery point on center line. The vein is divided in places through this claim by limestone inclusions, the discovery point being on the regular course of the ledge, while discovery shaft goes down on outcrop to the east. Location notice fails to mention this fact.

Adjoining Claims.

This survey is joined on the SW. by the Hillside No. 1, Hillside No. 2, and Sunset Lodes, unsurveyed, Lincoln Consolidated Mining Company, Claimant.

Paul E. Fernald.

U.S. Mineral Surveyor.

FINAL OATHS FOR SURVEYS.

LIST OF NAMES.

A list of the names of the individuals employed by Paul E. Fernald,

United States Mineral Surveyor, to assist in running, measuring, and marking the lines, corners, and boundaries described in the foregoing field notes of the survey of the mining claim of _____

Lincoln Consolidated Mining Company

known as the Aguinaldo, King David, Queen Anne, Daisy, Admiral Dewey,
and showing the respective capacities in which they acted.

William M. Dahncke, *Chainman.*

_____, *Chainman.*

_____, *Arman.*

_____, *Flagman.*

FINAL OATHS OF ASSISTANTS.

We, William M. Dahncke,

and _____, do solemnly swear that we assisted Paul E. Fernald

_____, United States Mineral Surveyor, in marking the corners and surveying

the boundaries of the mining claim of Lincoln Consolidated Mining Company

known as the Aguinaldo, King David, Queen Anne, Daisy, Admiral Dewey,

represented in the foregoing field notes as having been surveyed by said mineral surveyor and under his

direction; and that said survey has been in all respects, to the best of our knowledge and belief, faithfully

and correctly executed, and the corner and boundary monuments established according to law and the instruc-

tions furnished by the United States Surveyor-General for Arizona

William M. Dahncke, *Chainman.*

_____, *Chainman.*

_____, *Arman.*

_____, *Flagman.*

Subscribed and sworn to by the above-named persons before me this 24th

day of April, _____, 19 11.

My commission expires
Sept. 6, 1911.

H. B. Bulver.

Notary Public.

FINAL OATH OF U. S. MINERAL SURVEYOR.

I, Paul E. Fernald, U. S. Mineral Surveyor, do solemnly swear that, in pursuance of instructions received from the United States Surveyor General for Arizona, dated February 11, 1911, I have, in strict conformity to the laws of the United States, the official regulations and instructions thereunder, and the instructions of said Surveyor General, faithfully and correctly executed the survey of the Mining Claim of Lincoln Consolidated Mining Company, known as the Aguinaldo, King David, Queen Ann, Daisy, Admiral Dewey, situate in Papago Mining District, Pima County, Arizona, in Section 24, 35, 36, Township No. 17 S., Range No. 10 E., and designated as Survey No. 2890, as represented in the foregoing field notes, which accurately show the boundaries of said mining claim as distinctly marked by monuments on the ground, and described in the attached copy of the location certificate, which was received by me from the Surveyor General with said instructions, and that all the corners of said survey have been established and perpetuated in strict accordance with the law, official regulations and instructions thereunder; and I do further solemnly swear that the foregoing are the true and original field notes of said survey and my report therein, and that the labor expended and improvements made upon said mining claim by claimant or its grantors are as therein fully stated, and that the character, extent, location, and itemized value thereof are specified therein with particularity and full detail, and that no portion of said labor or improvements so credited to this claim has been included in the estimate of expenditures upon any other claim.

Paul E. Fernald.

U. S. Mineral Surveyor.

Subscribed and sworn to by the said Paul E. Fernald,
 U. S. Mineral Surveyor, before me K. B. Culver,
 this 1st
 day of May, 1911.

My commission expires
 Sept. 6, 1911.

K. B. Culver

Notary Public.

A M E N D E D
Notice of Mining Location
LODE CLAIM

JUL 23 1910

To All Whom it May Concern :

This Mining Claim, the name of which is the Aguinaldo
Mining Claim, situate on lands belonging to the United States of America, and in which there are valuable mineral deposits, was entered upon and located for the purposes of exploration and purchase by
The Lincoln Consolidated Mining Co., a corporation
chartered under the laws of Arizona
(Locator must insert either "a citizen of the United States," or "who has declared his intention to become a citizen of the United States")
the undersigned, on the 1st day of July 1910

The length of this claim is 1500 feet,
and we claim 6 feet
in a Northerly direction and
1494 feet in a Southerly direction from
the center of the discovery shaft, at which this notice is posted, lengthwise of the claim, together with
300 feet in width of the surface grounds, on each side of the center of said
claim. The general course of the lode deposit and premises is from the South
to the North

The claim is situated and located in the Papago Mining District, in
Pima County, in the Territory of Arizona, about 4800 Feet
in a Northerly direction from Stavan's Ranch House
(^{to} and discovery shaft) in the North West Corner of the Sierrita
Mts. and joins the Admiral Dewey on the West and Kind David on
North

The surface boundaries of the claim are marked upon the ground as follows: Beginning at
a monument of stone
at a point in a Northerly direction 6 feet from
the discovery shaft (at which this notice is posted) being in the center of the North
end line of said claim; thence S. 60° 1' W. 300 feet to a monument
of stone being the North West corner of said claim; thence
S. 29° 59' E. 1500 feet to a Monument of stone being at the
South West corner of said claim; thence N. 60° 1' E. 300 feet
to a monument of stone at the center of the South end of said claim
thence N. 60° 1' E. 300 feet to a Monument of stone being at the
South East corner of said claim; thence N. 29° 59' W.
1500 feet to a monument of stone at the
North East corner of said claim; thence S. 60° 1' W. 300
feet to the place of beginning.

All done under the provisions of Chapter Six; of Title XXXII, of the Revised Statutes of the United States, and of an Act of the General Assembly of Arizona, entitled "An Act to Revise and Codify the Laws of the Territory of Arizona," approved March 16, 1901.

This is an amended Location Notice of the Garcia No. 30
Mining Claim, located by The Lincoln Consolidated Mining Co.
on the day of January 13th
1905, and recorded in Book K. K. of Records of Mines, at
page 102, in the office of the County Recorder of the aforesaid county of Pima
to which reference is hereby made, and this Amended Location notice is made and posted to correct errors in
the description in the said original Location Notice.

Dated and posted on the ground this 1st day of July 1910

THE LINCOLN CONSOLIDATED MINING CO
By Chas E. Gill Vice Pres

An Act to Codify and Revise the Laws of the Territory of Arizona

SECTIONS I-II.-INC. LOCATION OF CLAIMS

Be it enacted by the Legislative Assembly of the Territory of Arizona:

SECTION 1. On the discovery of mineral in places on the public domain of the United States, the same may be located as a mineral claim by the discoverer for himself, for himself and others, or for others.
SECTION 2. Such location shall be made by erecting at or contiguous to the point of discovery, a conspicuous monument of stones not less than three (3) feet in height, or an upright post securely fixed, projecting at least four (4) feet above the ground, in which monument of stones or on which post, there shall be posted a location notice, which shall be signed by the name or names of the locator or locators.
SECTION 3. Until each and all of the above specified things shall have been done no right thereto shall be acquired.
SECTION 4. From the time of the location of a mining claim as above specified, the locator shall be allowed ninety (90) days within which to do or cause to be done, the following things: First, to cause to be recorded in the office of the County Recorder of the county in which the claim is situated, a copy of the location notice; second, to sink a discovery shaft in the claim to the depth of at least ten (10) feet from the lowest part of the rim of the shaft at the surface, and deeper if necessary until there is discovered in said shaft mineral in place; third, to monument the claim on the ground so that its boundaries can be readily traced.
SECTION 5. The failure to do all the things enumerated in this section in the time and space specified shall be construed into an abandoning of the the claim, and all right thereto of the discoverer and locator shall be forfeited.
SECTION 6. Such surface boundaries shall be marked by six (6) substantial posts projecting at least four (4) feet above the surface of the ground, or by substantial stone monuments at least three (3) feet high, to-wit: One at each corner of said claim, and one at the center of each end line thereof.
SECTION 7. Any open-cut, adit or tunnel which shall be made as above provided for as a part of the location of a lode mineral claim, and which shall be equal in amount of work to a shaft ten (10) feet deep and four (4) feet wide by six (6) feet long, and which shall cut the lode or mineral in place at a depth of ten (10) feet from the surface, shall be equivalent as a discovery work to a shaft sunk from the surface.
SECTION 8. Location notice may be amended at any time, and the monument changed to correspond with the amended location; provided, that no change shall be made that will interfere with the rights of others.
SECTION 9. The amount of assessment or representation work or improvements to be done or made during each year, after the completion of the location as heretofore provided, and the time for doing the same shall be as provided by the laws of the United States.
SECTION 10. Within three (3) months after the expiration of the period of the time fixed for the performance of annual labor, or the making of such improvements upon any mining claim, the person on whose behalf such work or improvements was made, or some person for him knowing the facts, may make a record in the office of the County Recorder of the county wherein such claim is situated, an affidavit in substance as follows:

TERRITORY OF ARIZONA,

ss.

being duly sworn deposes and says that he is a citizen of the United States and more than twenty-one years of age, resides at... County, Arizona, Territory, and is personally acquainted with the mining claim known as... Mining District, Arizona, Territory, the location notice of which is recorded in the office of the County Recorder of said County, in book... of Records of Mines, at page... That between the... day of... A. D. and the... day of... A. D. at least... dollars worth of work and improvements were done and performed upon said claim, not including the location work of said claim. Such work and improvements were made by and at the expense of... owners of said claim, for the purpose of complying with the laws of the United States, pertaining to assessments of annual work, and (here name the owners of men who worked upon the claim in doing the work) were the men employed by said owner, and who labored upon said claim, did said work and improvements, the same being as follows, to-wit: (Here describe the work done).

(Signature)

Subscribed and sworn to before me, this... day of... A. D.

My commission as Notary Public expires on the... day of... A. D.

Notary Seal)

Notary Public.

SECTION 11. Such affidavit, when so recorded, shall be prima facie evidence of the performance of such labor or the making of such improvements, and said original affidavit, after it has been recorded, or a certified copy of record of same, or the record of same, shall be received as evidence accordingly by the courts of the Territory. The relocation of forfeited or abandoned lode claims shall only be made by sinking a new discovery shaft and fixing the boundary in the same manner and to the same extent as is required in making an original location; or the locator may sink the original discovery shaft ten (10) feet deeper than it was at the commencement of such location, and shall erect new, or make the old monuments the same as originally required. In either case a new location monument shall be erected, and the location notice shall state if the whole or any part of the new location is located as abandoned property, else it shall be void.

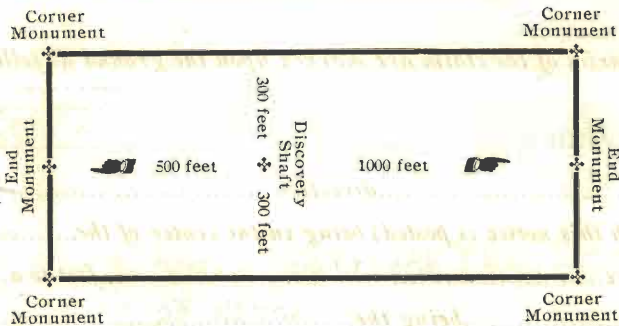

The above diagram is to give the locator a general idea of the plan of location under new law. Your discovery shaft may be in the center of claim, or any distance from either end you desire. In the diagram we have placed it 500 feet from one end and 1000 feet from the other. In description, be careful to state locality of claim with reference to some natural object, or permanent monument, so as to identify the claim.

TERRITORY OF ARIZONA,

ss.

County of... County Recorder in and for the County and Territory aforesaid; do hereby certify that the within instrument was filed for record at... o'clock... M. on this... day of... 190..., and duly recorded in Book No. ... of... Records of... County, Arizona, at pages... WITNESS my hand and official seal the day and year first above written.

County Recorder.

AMENDED LODGE CLAIM Notice of Forfeiture. Dated... 190... and Received at request of... July 22 A. D. 190... at 4:30 P. M. Book... Pages 237. By... Deputy Recorder.

2890

2

JUL 22 1910

AMENDED
Notice of Mining Location
LODE CLAIM

To All Whom it May Concern :

This Mining Claim, the name of which is the.....King David.....
Mining Claim, situate on lands belonging to the United States of America, and in which there are valuable
mineral deposits, was entered upon and located for the purposes of exploration and purchase by
.....The Lincoln Consolidated Mining Company, a corporation chartered
.....under the laws of Arizona.....
(Locator must insert either "a citizen of the United States," or "who has declared his intention to become a citizen of the United States")
the undersigned, on the.....First..... day of.....July..... 1910.....

The length of this claim is.....1500..... feet,
and.....we..... claim.....1494..... feet
in aNortherly..... direction and.....
.....6..... feet in a..... Southerly..... direction from
the center of the discovery shaft, at which this notice is posted, lengthwise of the claim, together with...
.....300..... feet in width of the surface grounds, on each side of the center of said
claim. The general course of the lode deposit and premises is from the.....North.....
to the.....South.....

The claim is situated and located in the.....Papago..... Mining District, in
.....Pima..... County, in the Territory of Arizona, about.....4300 feet.....
in a.....Northerly..... direction from.....Steven's Ranch.....
House (~~the~~ discovery shaft) in the North West Corner of the
Sierrita Mts.

The surface boundaries of the claim are marked upon the ground as follows: Beginning at
.....a monument of stone.....

at a point in a.....Southerly..... direction.....6..... feet from
the discovery shaft (at which this notice is posted) being in the center of the.....South.....
end line of said claim; thence..... N. 60° 1' E., 300..... feet to a..... Monument
..... of stone..... being the..... S. E..... corner of said claim; thence
..... N. 29° 59' W., 1500..... feet to a..... Monument of stone..... being at the
..... N. E..... corner of said claim; thence..... S. 60° 1' W., 300..... feet
to a..... monument of stone..... at the center of the..... North..... end of said claim
thence..... S. 60° 1' W., 300..... feet to a..... Monument of stone..... being at the
..... N. W..... corner of said claim; thence..... S. 29° 59' E.....
..... 1500..... feet to a..... monument of stone..... at the
..... S. W..... corner of said claim; thence..... N. 60° 1' E., 300.....
feet to the place of beginning.

All done under the provisions of Chapter Six; of Title XXXII, of the Revised Statutes of the United
States, and of an Act of the General Assembly of Arizona, entitled "An Act to Revise and Codify the Laws of
the Territory of Arizona," approved March 16, 1901.

This is an amended Location Notice of the..... Lincoln No. 1.....
Mining Claim, located by..... Fred W. Fickett.....
..... on the 1st.,..... on the day of..... January.....
..... 1906....., and recorded in Book..... K. K..... of Records of Mines, at
page 408, in the office of the County Recorder of the aforesaid county of..... Pima.....
to which reference is hereby made, and this Amended Location notice is made and posted to correct errors in
the description in the said original Location Notice.

Dated and posted on the ground this..... 1st.,..... day of..... July..... 1910.....

.....
The Lincoln Consolidated Min. Co.
By Chas E. Gill, Vice Pres.

SECTIONS I-II.-INC. LOCATION OF CLAIMS

Be it enacted by the Legislative Assembly of the Territory of Arizona:

SECTION 1. On the discovery of mineral in places on the public domain of the United States, the same may be located as a mineral claim by the discoverer for himself, for himself and others, or for others.

SECTION 2. Such location shall be made by erecting at or contiguous to the point of discovery, a conspicuous monument of stones not less than three (3) feet in height, or an upright post securely fixed, projecting at least four (4) feet above the ground, in which monument of stones or on which post, there shall be posted a location notice, which shall be signed by the name or names of the locator or locators. The location notice must contain: First, the name of the claim located; second, the name or names of the locators; third, the date of the location; fourth, the length and width of the claim in feet and the distance in feet from the point of discovery to each end of the claim; fifth, the general course of the claim; sixth, the locality of the claim with reference to some natural object or permanent monument whereby the claim can be identified.

SECTION 3. Until each and all of the above specified things shall have been done no right thereto shall be acquired.

SECTION 4. From the time of the location of a mining claim as above specified, the locator shall be allowed ninety (90) days within which to do or cause to be done, the following things: First, to cause to be recorded in the office of the County Recorder of the county in which the claim is situated, a copy of the location notice; second, to sink a discovery shaft in the claim to the depth of at least ten (10) feet from the lowest part of the rim of the shaft at the surface, and deeper if necessary until there is discovered in said shaft mineral in place; third, to monument the claim on the ground so that its boundaries can be readily traced.

SECTION 5. The failure to do all the things enumerated in this section in the time and space specified shall be construed into an abandoning of the claim, and all right thereto of the discoverer and locator shall be forfeited.

SECTION 6. Such surface boundaries shall be marked by six (6) substantial posts projecting at least four (4) feet above the surface of the ground, or by substantial stone monuments at least three (3) feet high, to-wit: One at each corner of said claim, and one at the center of each end line thereof.

SECTION 7. Any open-cut, adit or tunnel which shall be made as above provided for as a part of the location of a lode mineral claim, and which shall be equal in amount of work to a shaft ten (10) feet deep and four (4) feet wide by six (6) feet long, and which shall cut the lode or mineral in place at a depth of ten (10) feet from the surface, shall be equivalent as a discovery work to a shaft sunk from the surface.

SECTION 8. Location notice may be amended at any time, and the monument changed to correspond with the amended location; provided, that no change shall be made that will interfere with the rights of others.

SECTION 9. The amount of assessment or representation work or improvements to be done or made during each year, after the completion of the location as heretofore provided, and the time for doing the same shall be as provided by the laws of the United States.

SECTION 10. Within three (3) months after the expiration of the period of the time fixed for the performance of annual labor, or the making of such improvements upon any mining claim, the person on whose behalf such work or improvements was made, or some person for him knowing the facts, may make a record in the office of the County Recorder of the county wherein such claim is situated, an affidavit in substance as follows:

TERRITORY OF ARIZONA, } ss.

... being duly sworn deposes and says that he is a citizen of the United States and more than twenty-one years of age, resides at ... County, Arizona, Territory, and is personally acquainted with the mining claim known as ... Mining District, Arizona, Territory, the location notice of which is recorded in the office of the County Recorder of said County, in book ... of Records of Mines, at page ... That between the ... day of ... A. D. ... and the ... day of ... A. D. ... at least ... dollars worth of work and improvements were done and performed upon said claim, not including the location work of said claim. Such work and improvements were made by and at the expense of ... owners of said claim, for the purpose of complying with the laws of the United States, pertaining to assessments of annual work, and (here name the owners of men who worked upon the claim in doing the work) were the men employed by said owner, and who labored upon said claim, did said work and improvements, the same being as follows, to-wit: (Here describe the work done).

Subscribed and sworn to before me, this ... day of ... A. D. ...

My commission as Notary Public expires on the ... day of ... A. D. ... Notary Public.

SECTION 11. Such affidavit, when so recorded, shall be prima facie evidence of the performance of such labor or the making of such improvements, and said original affidavit, after it has been recorded, or a certified copy of record of same, or the record of same, shall be received as evidence accordingly by the courts of the Territory. The relocation of forfeited or abandoned lode claims shall only be made by sinking a new discovery shaft and fixing the boundary in the same manner and to the same extent as is required in making an original location; or the locator may sink the original discovery shaft ten (10) feet deeper than it was at the commencement of such location, and shall erect new, or make the old monuments the same as originally required. In either case a new location monument shall be erected, and the location notice shall state if the whole or any part of the new location is located as abandoned property, else it shall be void.

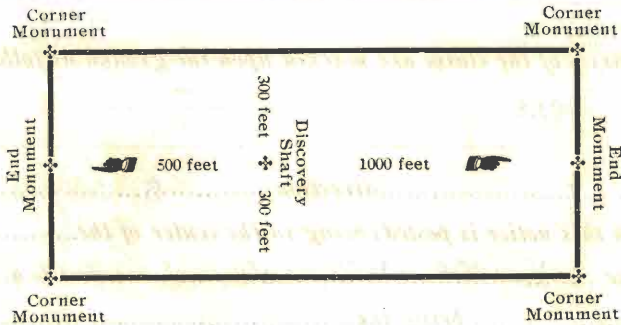

The above diagram is to give the locator a general idea of the plan of location under new law. Your discovery shaft may be in the center of claim, or any distance from either end you desire. In the diagram we have placed it 500 feet from one end and 1000 feet from the other. In description, be careful to state locality of claim with reference to some natural object, or permanent monument, so as to identify the claim.

TERRITORY OF ARIZONA, } ss.
County of

... County Recorder in and for the County and Territory aforesaid; do hereby certify that the within instrument was filed for record at ... o'clock ... M. on this ... day of ... 190..., and duly recorded in Book No. ... of ... Records of ... County, Arizona, at pages ... WITNESS my hand and official seal the day and year first above written.

County Recorder.

AMENDED
Notice of Forfeiture.
LODE CLAIM

Dated ... 190...

Filed and Recorded at request of

Handwritten signature

July 22 A. D. 1900.

at 4:30 P. M.

Book ...
Handwritten signature

Pages 234

Handwritten signature
County Recorder.

By ...
Deputy Recorder.

A M E N D E D
Notice of Mining Location
LODE CLAIM

JUL 22 1910

To All Whom it May Concern :

This Mining Claim, the name of which is the Queen Ann Mining Claim, situate on lands belonging to the United States of America, and in which there are valuable mineral deposits, was entered upon and located for the purposes of exploration and purchase by The Lincoln Consolidated Mining Co., a corporation chartered under the laws of Arizona. (Locator must insert either "a citizen of the United States," or "who has declared his intention to become a citizen of the United States") the undersigned, on the 1st day of July 1910.

The length of this claim is 1500 feet, and we claim 530 feet in a Northerly direction and 970 feet in a Southerly direction from the center of the discovery shaft, at which this notice is posted, lengthwise of the claim, together with 300 feet in width of the surface grounds, on each side of the center of said claim. The general course of the lode deposit and premises is from the South to the North.

The claim is situated and located in the Papago Mining District, in Pima County, in the Territory of Arizona, about 3750 in a North Easterly direction from Steven's Ranch House, in the North West Corner of the Sierrita Mts. and joins the Aguinaldo claim on the North.

The surface boundaries of the claim are marked upon the ground as follows: Beginning at

a monument of stone at a point in a Northerly direction 530 feet from the discovery shaft (at which this notice is posted) being in the center of the North end line of said claim; thence S. 60° 1' W. 300 feet to a monument of stone being the North West corner of said claim; thence S. 29° 59' E. 1500 feet to a monument of stone being at the South West corner of said claim; thence N. 60° 1' E. 300 feet to a monument of stone at the center of the South end of said claim thence N. 60° 1' E. 300 feet to a monument of stone being at the South East corner of said claim; thence N. 29° 59' W. 1500 feet to a monument of stone at the North East corner of said claim; thence S. 60° 1' W. 300 feet to the place of beginning.

All done under the provisions of Chapter Six; of Title XXXII, of the Revised Statutes of the United States, and of an Act of the General Assembly of Arizona, entitled "An Act to Revise and Codify the Laws of the Territory of Arizona," approved March 16, 1901.

This is an amended Location Notice of the Lincoln No. 2 Mining Claim, located by Fred W. Fickett on the 1st day of January 1906, and recorded in Book K. K. of Records of Mines, at page 409, in the office of the County Recorder of the aforesaid county of to which reference is hereby made, and this Amended Location notice is made and posted to correct errors in the description in the said original Location Notice.

Dated and posted on the ground this 1st day of July 1910.

LINCOLN CONSOLIDATED MINING CO.

By Chas. E. Gill Vice Pres.

An Act to Codify and Revise the Laws of the Territory of Arizona

SECTIONS I-II.-INC. LOCATION OF CLAIMS

Be it enacted by the Legislative Assembly of the Territory of Arizona:

SECTION 1. On the discovery of mineral in places on the public domain of the United States, the same may be located as a mineral claim by the discoverer for himself, for himself and others, or for others.
SECTION 2. Such location shall be made by erecting at or contiguous to the point of discovery, a conspicuous monument of stones not less than three (3) feet in height, or an upright post securely fixed, projecting at least four (4) feet above the ground, in which monument of stones or on which post, there shall be posted a location notice, which shall be signed by the name or names of the locator or locators.
SECTION 3. Until each and all of the above specified things shall have been done no right thereto shall be acquired.
SECTION 4. From the time of the location of a mining claim as above specified, the locator shall be allowed ninety (90) days within which to do or cause to be done, the following things: First, to cause to be recorded in the office of the County Recorder of the county in which the claim is situated, a copy of the location notice; second, to sink a discovery shaft in the claim to the depth of at least ten (10) feet from the lowest part of the rim of the shaft at the surface, and deeper if necessary until there is discovered in said shaft mineral in place; third, to monument the claim on the ground so that its boundaries can be readily traced.
SECTION 5. The failure to do all the things enumerated in this section in the time and space specified shall be construed into an abandoning of the claim, and all right thereto of the discoverer and locator shall be forfeited.
SECTION 6. Such surface boundaries shall be marked by six (6) substantial posts projecting at least four (4) feet above the surface of the ground, or by substantial stone monuments at least three (3) feet high, to-wit: One at each corner of said claim, and one at the center of each end line thereof.
SECTION 7. Any open-cut, adit or tunnel which shall be made as above provided for as a part of the location of a lode mineral claim, and which shall be equal in amount of work to a shaft ten (10) feet deep and four (4) feet wide by six (6) feet long, and which shall cut the lode or mineral in place at a depth of ten (10) feet from the surface, shall be equivalent as a discovery work to a shaft sunk from the surface.
SECTION 8. Location notice may be amended at any time, and the monument changed to correspond with the amended location; provided, that no change shall be made that will interfere with the rights of others.
SECTION 9. The amount of assessment or representation work or improvements to be done or made during each year, after the completion of the location as heretofore provided, and the time for doing the same shall be as provided by the laws of the United States.
SECTION 10. Within three (3) months after the expiration of the period of the time fixed for the performance of annual labor, or the making of such improvements upon any mining claim, the person on whose behalf such work or improvements was made, or some person for him knowing the facts, may make a record in the office of the County Recorder of the county wherein such claim is situated, an affidavit in substance as follows:

TERRITORY OF ARIZONA,

ss.

being duly sworn deposes and says that he is a citizen of the United States and more than twenty-one years of age, resides at... County, Arizona, Territory, and is personally acquainted with the mining claim known as... Mining District, Arizona, Territory, the location notice of which is recorded in the office of the County Recorder of said County, in book... of Records of Mines, at page... That between the... day of... A. D. and the... day of... A. D. at least... dollars worth of work and improvements were done and performed upon said claim, not including the location work of said claim. Such work and improvements were made by and at the expense of... owners of said claim, for the purpose of complying with the laws of the United States, pertaining to assessments of annual work, and (here name the owners of men who worked upon the claim in doing the work) were the men employed by said owner, and who labored upon said claim, did said work and improvements, the same being as follows, to-wit: (Here describe the work done).

(Signature)

Subscribed and sworn to before me, this... day of... A. D.

My commission as Notary Public expires on the... day of... A. D.

Notary Seal

Notary Public.

SECTION 11. Such affidavit, when so recorded, shall be prima facie evidence of the performance of such labor or the making of such improvements, and said original affidavit, after it has been recorded, or a certified copy of record of same, or the record of same, shall be received as evidence accordingly by the courts of the Territory. The relocation of forfeited or abandoned lode claims shall only be made by sinking a new discovery shaft and fixing the boundary in the same manner and to the same extent as is required in making an original location; or the locator may sink the original discovery shaft ten (10) feet deeper than it was at the commencement of such location, and shall erect new, or make the old monuments the same as originally required. In either case a new location monument shall be erected, and the location notice shall state if the whole or any part of the new location is located as abandoned property, else it shall be void.

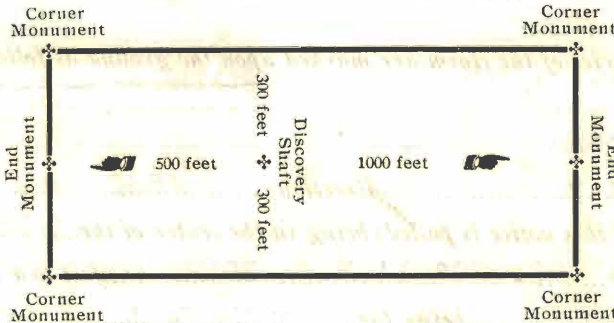

The above diagram is to give the locator a general idea of the plan of location under new law. Your discovery shaft may be in the center of claim, or any distance from either end you desire. In the diagram we have placed it 500 feet from one end and 1000 feet from the other. In description, be careful to state locality of claim with reference to some natural object, or permanent monument, so as to identify the claim.

TERRITORY OF ARIZONA, }
County of... } ss

County Recorder in and for the County and Territory aforesaid; do hereby certify that the within instrument was filed for record at... o'clock... M. on this... day of... 190..., and duly recorded in Book No. ... of... Records of... County, Arizona, at pages... WITNESS my hand and official seal the day and year first above written.

County Recorder.

AMENDED
Notice of Forfeiture.
LODE CLAIM

Dated July 22 A. D. 1900
at 4:30 P. M.
Book 232
Pages 232
By Deputy Recorder.
County Recorder.

JUL 22 1910

A M E N D E D Notice of Mining Location LODE CLAIM

To All Whom it May Concern :

This Mining Claim, the name of which is the.....Daisy.....
Mining Claim, situate on lands belonging to the United States of America, and in which there are valuable mineral deposits, was entered upon and located for the purposes of exploration and purchase by
.....The Lincoln Consolidated Mining Co., a corporation.....
.....chartered under the laws of Arizona.....
(Locator must insert either "a citizen of the United States," or "who has declared his intention to become a citizen of the United States")
the undersigned, on the.....1st..... day of.....July..... 1910.....

The length of this claim is.....1500..... feet,
and.....300..... claim.....300..... feet
in a.....Southerly..... direction and.....
.....1200..... feet in a.....Northerly..... direction from
the center of the discovery shaft, at which this notice is posted, lengthwise of the claim, together with.....
.....300..... feet in width of the surface grounds, on each side of the center of said
claim. The general course of the lode deposit and premises is from the.....South.....
to the.....North.....

The claim is situated and located in the.....Papago..... Mining District, in
.....Pima..... County, in the Territory of Arizona, about.....4550 feet.....
in a.....Northerly..... direction from.....Steven's Ranch.....
house, in the North West Corner of the Sierrita Mts......

The surface boundaries of the claim are marked upon the ground as follows: Beginning at

.....a Monument of stone.....

.....at a point in a.....Southerly..... direction.....300..... feet from
the discovery shaft (at which this notice is posted) being in the center of the.....South.....
end line of said claim; thence.....N. 60° 1' E., 300..... feet to a.....monument.....
.....of stone..... being the.....South East..... corner of said claim; thence
.....N. 29° 59' W., 1500..... feet to a.....Monument of stone..... being at the
.....North East..... corner of said claim; thence.....S. 60° 1' W., 300..... feet
to a.....monument of stone..... at the center of the.....North..... end of said claim
thence.....S. 60° 1' W., 300..... feet to a.....Monument of stone..... being at the
.....North West..... corner of said claim; thence.....S. 29° 59' E.,.....
.....1500..... feet to a.....monument of stone..... at the
.....South West..... corner of said claim; thence.....N. 60° 1' E., 300.....
feet to the place of beginning.

All done under the provisions of Chapter Six; of Title XXXII, of the Revised Statutes of the United States, and of an Act of the General Assembly of Arizona, entitled "An Act to Revise and Codify the Laws of the Territory of Arizona," approved March 16, 1901.

This is an amended Location Notice of the.....Garcia No. 29.....
Mining Claim, located by.....D. J. Pogue and V. M. Cole.....
.....on the day of.....March 24th.....
.....1904....., and recorded in Book.....J. J...... of Records of Mines, at
page.....376....., in the office of the County Recorder of the aforesaid county of.....Pima.....
to which reference is hereby made, and this Amended Location notice is made and posted to correct errors in
the description in the said original Location Notice.

Dated and posted on the ground this.....1st..... day of.....July..... 1910.....

.....LINCOLN CONSOLIDATED MINING CO......

.....by.....Chas. E. Gill..... Vice Pres.....

An Act to Codify and Revise the Laws of the Territory of Arizona

SECTIONS I-II.-INC. LOCATION OF CLAIMS

Be it enacted by the Legislative Assembly of the Territory of Arizona:

SECTION 1. On the discovery of mineral in places on the public domain of the United States, the same may be located as a mineral claim by the discoverer for himself, for himself and others, or for others.

SECTION 2. Such location shall be made by erecting at or contiguous to the point of discovery, a conspicuous monument of stones not less than three (3) feet in height, or an upright post securely fixed, projecting at least four (4) feet above the ground, in which monument of stones or on which post, there shall be posted a location notice, which shall be signed by the name or names of the locator or locators. The location notice must contain: First, the name of the claim located; second, the name or names of the locators; third, the date of the location; fourth, the length and width of the claim in feet and the distance in feet from the point of discovery to each end of the claim; fifth, the general course of the claim; sixth, the locality of the claim with reference to some natural object or permanent monument whereby the claim can be identified.

SECTION 3. Until each and all of the above specified things shall have been done no right thereto shall be acquired.

SECTION 4. From the time of the location of a mining claim as above specified, the locator shall be allowed ninety (90) days within which to do or cause to be done, the following things: First, to cause to be recorded in the office of the County Recorder of the county in which the claim is situated, a copy of the location notice; second, to sink a discovery shaft in the claim to the depth of at least ten (10) feet from the lowest part of the rim of the shaft at the surface, and deeper if necessary until there is discovered in said shaft mineral in place; third, to monument the claim on the ground so that its boundaries can be readily traced.

SECTION 5. The failure to do all the things enumerated in this section in the time and space specified shall be construed into an abandoning of the claim, and all right thereto of the discoverer and locator shall be forfeited.

SECTION 6. Such surface boundaries shall be marked by six (6) substantial posts projecting at least four (4) feet above the surface of the ground, or by substantial stone monuments at least three (3) feet high, to-wit: One at each corner of said claim, and one at the center of each end line thereof.

SECTION 7. Any open-cut, adit or tunnel which shall be made as above provided for as a part of the location of a lode mineral claim, and which shall be equal in amount of work to a shaft ten (10) feet deep and four (4) feet wide by six (6) feet long, and which shall cut the lode or mineral in place at a depth of ten (10) feet from the surface, shall be equivalent as a discovery work to a shaft sunk from the surface.

SECTION 8. Location notice may be amended at any time, and the monument changed to correspond with the amended location; provided, that no change shall be made that will interfere with the rights of others.

SECTION 9. The amount of assessment or representation work or improvements to be done or made during each year, after the completion of the location as heretofore provided, and the time for doing the same shall be as provided by the laws of the United States.

SECTION 10. Within three (3) months after the expiration of the period of the time fixed for the performance of annual labor, or the making of such improvements upon any mining claim, the person on whose behalf such work or improvements was made, or some person for him knowing the facts, may make a record in the office of the County Recorder of the county wherein such claim is situated, an affidavit in substance as follows:

TERRITORY OF ARIZONA, } ss.
being duly sworn deposes and says that he is a citizen of the United States and more than twenty-one years of age, resides at... County, Arizona, Territory, and is personally acquainted with the mining claim known as... Mining District, Arizona, Territory, the location notice of which is recorded in the office of the County Recorder of said County, in book... of Records of Mines, at page... That between the... day of... A. D. and the... day of... A. D. at least... dollars worth of work and improvements were done and performed upon said claim, not including the location work of said claim. Such work and improvements were made by and at the expense of... owners of said claim, for the purpose of complying with the laws of the United States, pertaining to assessments of annual labor, and the making of such improvements upon any mining claim; the owners of men who worked upon the claim in doing the work were the men employed by said owner, and who labored upon said claim, did said work and improvements, the same being as follows, to-wit: (Here describe the work done).

Subscribed and sworn to before me, this... day of... A. D. (Signature)

My commission as Notary Public expires on the... day of... A. D. Notary Seal

SECTION 11. Such affidavit, when so recorded, shall be prima facie evidence of the performance of such labor or the making of such improvements, and said original affidavit, after it has been recorded, or a certified copy of record of same, or the record of same, shall be received as evidence accordingly by the courts of the Territory. The relocation of forfeited or abandoned lode claims shall only be made by sinking a new discovery shaft and fixing the boundary in the same manner and to the same extent as is required in making an original location; or the locator may sink the original discovery shaft ten (10) feet deeper than it was at the commencement of such location, and shall erect new, or make the old monuments the same as originally required. In either case a new location monument shall be erected, and the location notice shall state if the whole or any part of the new location is located as abandoned property, else it shall be void.

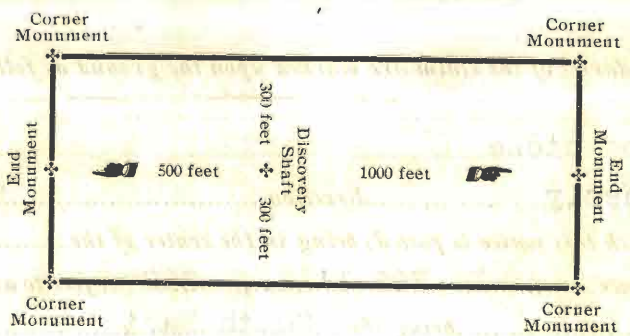

The above diagram is to give the locator a general idea of the plan of location under new law. Your discovery shaft may be in the center of claim, or any distance from either end you desire. In the diagram we have placed it 500 feet from one end and 1000 feet from the other. In description, be careful to state locality of claim with reference to some natural object, or permanent monument, so as to identify the claim.

TERRITORY OF ARIZONA, } ss
County of...
County Recorder in and for the County and Territory aforesaid; do hereby certify that the within instrument was filed for record at... o'clock... M. on this... day of... 190..., and duly recorded in Book No. ... of... Records of... County, Arizona, at pages... WITNESS my hand and official seal the day and year first above written.

County Recorder.

AMENDED
Notice of Forfeiture.
LODE CLAIM
Filed and Recorded at request of
Hank Cole
July 22 A. D. 1900.
at 1:30 P. M.
Book...
Pages 233
By... Deputy Recorder.

A M E N D E D
Notice of Mining Location

LODE CLAIM

24
JUL 22 1910

To All Whom it May Concern :

This Mining Claim, the name of which is the Admiral Dewey Mining Claim, situate on lands belonging to the United States of America, and in which there are valuable mineral deposits, was entered upon and located for the purposes of exploration and purchase by

The Lincoln Consolidated Mining Co., a corporation,
chartered under the laws of Arizona,

(Locator must insert either "a citizen of the United States," or "who has declared his intention to become a citizen of the United States")
the undersigned, on the 1st, day of July, 1910.

The length of this claim is 1500 feet,
and we claim 165 feet
in a Northerly direction and
1335 feet in a Southerly direction from
the center of the discovery shaft, at which this notice is posted, lengthwise of the claim, together with
300 feet in width of the surface grounds, on each side of the center of said
claim. The general course of the lode deposit and premises is from the South
to the North.

The claim is situated and located in the Papago Mining District, in
Pima County, in the Territory of Arizona, about 4200 feet
in a Northerly direction from Steven's Ranch
House., in the North West Corner of the Sierrita Mta., and
joins the Aguinaldo on the East and Daisy on the North

The surface boundaries of the claim are marked upon the ground as follows: Beginning at

a monument of stone
at a point in a Northerly direction 165 feet from
the discovery shaft (at which this notice is posted) being in the center of the North
end line of said claim; thence S. 60° 1' W. 300 feet to a monument of
stone being the North West corner of said claim; thence
S. 29° 59' E. 1500 feet to a monument of stone being at the
South West corner of said claim; thence N. 60° 1' E. 300 feet
to a monument of stone at the center of the South end of said claim
thence N. 60° 1' E. 300 feet to a monument of stone being at the
South East corner of said claim; thence N. 29° 59' W.
1500 feet to a monument of stone at the
North East corner of said claim; thence S. 60° 1' W. 300
feet to the place of beginning.

All done under the provisions of Chapter Six; of Title XXXII, of the Revised Statutes of the United States, and of an Act of the General Assembly of Arizona, entitled "An Act to Revise and Codify the Laws of the Territory of Arizona," approved March 16, 1901.

This is an amended Location Notice of the Garcia No. 28
Mining Claim, located by D. J. Pague and V. M. Cole
on the day of March 24th.
1904, and recorded in Book J. J. of Records of Mines, at
page 375., in the office of the County Recorder of the aforesaid county of Pima
to which reference is hereby made, and this Amended Location notice is made and posted to correct errors in
the description in the said original Location Notice.

Dated and posted on the ground this 1st, day of July, 1910.

L I N C O L N C O N S O L I D A T E D M I N I N G C O .

By Chas. E. Gill Vice Pres.

An Act to Codify and Revise the Laws of the Territory of Arizona

SECTIONS I-II.-INC. LOCATION OF CLAIMS

Be it enacted by the Legislative Assembly of the Territory of Arizona:

SECTION 1. On the discovery of mineral in places on the public domain of the United States, the same may be located as a mineral claim by the discoverer for himself, for himself and others, or for others.
SECTION 2. Such location shall be made by erecting at or contiguous to the point of discovery, a conspicuous monument of stones not less than three (3) feet in height, or an upright post securely fixed, projecting at least four (4) feet above the ground, in which monument of stones or on which post, there shall be posted a location notice, which shall be signed by the name or names of the locator or locators.
SECTION 3. Until each and all of the above specified things shall have been done no right thereto shall be acquired.
SECTION 4. From the time of the location of a mining claim as above specified, the locator shall be allowed ninety (90) days within which to do or cause to be done, the following things: First, to cause to be recorded in the office of the County Recorder of the county in which the claim is situated, a copy of the location notice; second, to sink a discovery shaft in the claim to the depth of at least ten (10) feet from the lowest part of the rim of the shaft at the surface, and deeper if necessary until there is discovered in said shaft mineral in place; third, to monument the claim on the ground so that its boundaries can be readily traced.
SECTION 5. The failure to do all the things enumerated in this section in the time and space specified shall be construed into an abandoning of the claim, and all right thereto of the discoverer and locator shall be forfeited.
SECTION 6. Such surface boundaries shall be marked by six (6) substantial posts projecting at least four (4) feet above the surface of the ground, or by substantial stone monuments at least three (3) feet high, to-wit: One at each corner of said claim, and one at the center of each end line thereof.
SECTION 7. Any open-cut, adit or tunnel which shall be made as above provided for as a part of the location of a lode mineral claim, and which shall be equal in amount of work to a shaft ten (10) feet deep and four (4) feet wide by six (6) feet long, and which shall cut the lode or mineral in place at a depth of ten (10) feet from the surface, shall be equivalent as a discovery work to a shaft sunk from the surface.
SECTION 8. Location notice may be amended at any time, and the monument changed to correspond with the amended location; provided, that no change shall be made that will interfere with the rights of others.
SECTION 9. The amount of assessment or representation work or improvements to be done or made during each year, after the completion of the location as heretofore provided, and the time for doing the same shall be as provided by the laws of the United States.
SECTION 10. Within three (3) months after the expiration of the period of the time fixed for the performance of annual labor, or the making of such improvements upon any mining claim, the person on whose behalf such work or improvements was made, or some person for him knowing the facts, may make a record in the office of the County Recorder of the county wherein such claim is situated, an affidavit in substance as follows:

TERRITORY OF ARIZONA,

ss.

being duly sworn deposes and says that he is a citizen of the United States and more than twenty-one years of age, resides at... County, Arizona, Territory, and is personally acquainted with the mining claim known as... Mining District, Arizona, Territory, the location notice of which is recorded in the office of the County Recorder of said County, in book... of Records of Mines, at page... That between the... day of... and the... day of... A. D. at least... dollars worth of work and improvements were done and performed upon said claim, not including the location work of said claim. Such work and improvements were made by and at the expense of... owners of said claim, for the purpose of complying with the laws of the United States, pertaining to assessments of annual work, and (here name the owners of men who worked upon the claim in doing the work) were the men employed by said owner, and who labored upon said claim, did said work and improvements, the same being as follows, to-wit: (Here describe the work done).

(Signature)

Subscribed and sworn to before me, this... day of... A. D.

My commission as Notary Public expires on the... day of... A. D.

Notary Seal) Notary Public.

SECTION 11. Such affidavit, when so recorded, shall be prima facie evidence of the performance of such labor or the making of such improvements, and said original affidavit, after it has been recorded, or a certified copy of record of same, or the record of same, shall be received as evidence accordingly by the courts of the Territory. The relocation of forfeited or abandoned lode claims shall only be made by sinking a new discovery shaft and fixing the boundary in the same manner and to the same extent as is required in making an original location; or the locator may sink the original discovery shaft ten (10) feet deeper than it was at the commencement of such location, and shall erect new, or make the old monuments the same as originally required. In either case a new location monument shall be erected, and the location notice shall state if the whole or any part of the new location is located as abandoned property, else it shall be void.

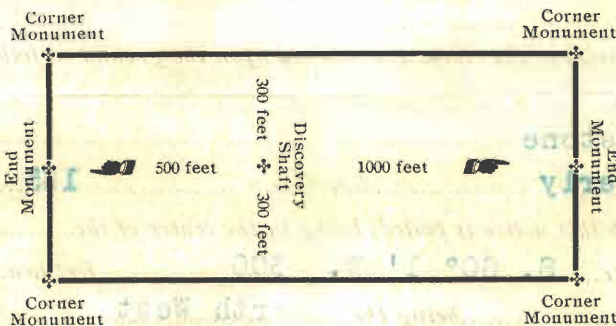

The above diagram is to give the locator a general idea of the plan of location under new law. Your discovery shaft may be in the center of claim, or any distance from either end you desire. In the diagram we have placed it 500 feet from one end and 1000 feet from the other. In description, be careful to state locality of claim with reference to some natural object, or permanent monument, so as to identify the claim.

TERRITORY OF ARIZONA,

ss.

County of... County Recorder in and for the County and Territory aforesaid; do hereby certify that the within instrument was filed for record at... o'clock... M. on this... day of... 190..., and duly recorded in Book No. ... of... Records of... County, Arizona, at pages... WITNESS my hand and official seal the day and year first above written.

County Recorder.

AMENDED Notice of Juratation. LODGE CLAIM

Dated July 1901 Filed and Recorded at request of Charles Hill July 22 A. D. 1901 at 4:30 P. M. Book 236 Pages 236 By Deputy Recorder. County Recorder.

U. S. SURVEYOR GENERAL'S FINAL CERTIFICATE ON
FIELD NOTES.

DEPARTMENT OF THE INTERIOR,
OFFICE OF U. S. SURVEYOR GENERAL,

Phoenix, Arizona,

December 29, 1911.

I, U. S. Surveyor General for Arizona,
do hereby certify that the foregoing transcript of the Field Notes, return and approval
of the Survey of the mining claim of
Lincoln Consolidated Mining Company,
, known as the AGUINALDO, KING DAVID, QUEEN ANN, DAISY,
ADMIRAL DEWEY, situate in PAPAGO
Mining District, Pima County,
Arizona, in Sections 26, 35, 36, Township No. 17 S.,
Range No. 10 E., and designated as Survey
No. 2890, has been correctly copied from the originals on
file in this office; that said Field Notes furnish such an accurate description of said
mining claim as will, if incorporated into a patent, serve fully to identify the premises,
and that such reference is made therein to natural objects or permanent monuments as
will perpetuate and fix the *locus* thereof.

And I further certify that five hundred dollars' worth of labor has been expended
or improvements made ^{or for each of} upon said mining claim^s by claimant or its grantors, and
that said improvements consist of 7 cuts, 7 shafts, 2 drifts and 2
tunnels, total value \$10900. Improvement No. 2 on the King
David lode is centrally located and is a practical and feasible
main working shaft for this group, therefore an undivided 1/5
interest therein, value \$900, is properly credited to each
of the lodes in this survey.

and that no portion of said labor or improvements has been included in the estimate of
expenditures upon any other claim.

I further certify that the plat thereof, filed in the U. S. Land Office at Phoenix,
Arizona, is correct and in conformity with the foregoing Field Notes.

Frank S. Ingalls,

United States Surveyor General for Arizona.

4-687.

SURVEYOR-GENERAL'S CERTIFICATE OF APPROVAL OF FIELD
NOTES AND SURVEY OF MINING CLAIM.

Department of the Interior.

Office of U. S. Surveyor-General,

Phoenix, Arizona,

December 29,, 1911.

I, U. S. Surveyor-General for Arizona,

do hereby certify that the foregoing and hereto attached Field Notes and Return of the Survey of the
Mining Claim of

Lincoln Consolidated Mining Company,

....., known as the
AGUINALDO, KING DAVID, QUEEN ANN, DAISY, ADMIRAL DEWEY,

situate in Papago mining district,

..... Pima County, Arizona,

in Section s 26, 35 & 36, Township No. 17 S., Range No. 10 E.,

....., designated as Survey No. 2890,

executed by Paul E. Fernald, U. S. Deputy Mineral

Surveyor, March 14 - 22, 1911, under my instructions dated

February 11, 1911, have been critically examined and the necessary cor-

rections and explanations made, and the said Field Notes and Return, and the Survey they describe,

are hereby approved. A true copy of the copy of the location certificate filed by the applicant for

survey is included in the field notes.

Frank S. Sigall

U. S. Surveyor-General for Arizona,

UNITED STATES DEPARTMENT OF THE INTERIOR
BUREAU OF LAND MANAGEMENT
ARIZONA STATE OFFICE

9605 (942)
M.S. 2890

NOTICE OF CANCELLATION OF MINERAL SURVEY

The Queen Ann, King David, Daisy, Aguinaldo and Admiral Dewey lodes, Mineral Survey No. 2890, located in sections 26, 35 and 36, Township 17 South, Range 10 East, Gila and Salt River Meridian, Arizona, are hereby canceled.

These claims have not been filed with the Arizona State Office, Bureau of Land Management, in accordance with Section 314, 90 STAT. 2769, (43 U.S.C. 1744).

This cancellation was necessitated to clear the record.

The Mineral Survey Plat should be noted as follows:

"Queen Ann, King David, Daisy, Aguinaldo and Admiral Dewey lodes, M.S. 2890 were canceled May 8, 1992, by memo 9605 (942) M.S. 2890, which is now a part of the original field notes."

May 8, 1992
Date

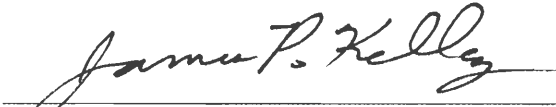

Chief Cadastral Surveyor of Arizona

May 5, 1992

To: Tom Reitmeyer
From: Dean Mac Donald
Subject: Verification of Recording of Mining Claim
in T.17 S., R.10 E.

Mineral Survey 2890, Queen Ann, King David, Daisy, Aguinaldo and Admiral Dewey, lodes in section 26 & 35.

Mineral Survey 2891A and 2891B, Blue Bird, Kentucky Nos. 1 and 2 lodes and Kentucky mill site, in sections 26 & 35.

Mineral Survey 2892 Hobson Nos. 1 and 2, Red Cross, Lawrence, Koo Koo, Saragossa No. 1, Enterprise and Providence in sections 27 & 34.

These lodes and mill sites lie within areas being computed by GCDB and will simplify their computations if the surveys can be canceled. Please verify whether they were recorded as required in FLPMA or that the annual assessment work has\has not been kept up, so that we can determine if they can be canceled or not.

Dean Mac Donald

May 7, 1992

The mining claim microfiche do not indicate that the above-listed mining claims and mill site, within the legal descriptions cited, were filed with BLM under Section 314 of FLPMA. We have no objection to cancelation of the Mineral Surveys involved.

Thomas E. Reitmeyer

Thomas E. Reitmeyer

UNITED STATES DEPARTMENT OF THE INTERIOR
BUREAU OF LAND MANAGEMENT
ARIZONA STATE OFFICE

9605 (942)
M.S. 2891 A&B

NOTICE OF CANCELLATION OF MINERAL SURVEY

The Blue Bird, Kentucky No. 1, Kentucky No. 2 lodes and Kentucky Mill-Site, Mineral Survey No. 2891 A&B, located in sections 26, 27 and 35, Township 17 South, Range 10 East, Gila and Salt River Meridian, Arizona, are hereby canceled.

These claims have not been filed with the Arizona State Office, Bureau of Land Management, in accordance with Section 314, 90 STAT. 2769, (43 U.S.C. 1744).

This cancellation was necessitated to clear the record.

The Mineral Survey Plat should be noted as follows:

"Blue Bird, Kentucky No. 1, Kentucky No. 2 lodes and Kentucky Mill-Site, M.S. 2891 A&B were canceled May 8, 1992, by memo 9605 (942) M.S. 2891, which is now a part of the original field notes."

May 8, 1992
Date

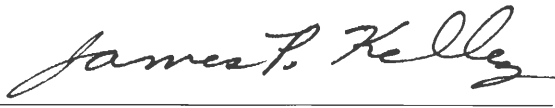

Chief Cadastral Surveyor of Arizona

UNITED STATES DEPARTMENT OF THE INTERIOR
BUREAU OF LAND MANAGEMENT
ARIZONA STATE OFFICE

9605 (942)
M.S. 2892

NOTICE OF CANCELLATION OF MINERAL SURVEY

The Hobson No. 1, Hobson No. 2, Red Cross, Lawrence, Koo Koo, Saragossa No. 1, Enterprise and Providence lodes, Mineral Survey No. 2892, located in sections 27 and 34, Township 17 South, Range 10 East, Gila and Salt River Meridian, Arizona, are hereby canceled.

These claims have not been filed with the Arizona State Office, Bureau of Land Management, in accordance with Section 314, 90 STAT. 2769, (43 U.S.C. 1744).

This cancellation was necessitated to clear the record.

The Mineral Survey Plat should be noted as follows:

"Hobson No. 1, Hobson No. 2, Red Cross, Lawrence, Koo Koo, Saragossa No. 1, Enterprise and Providence lodes, M.S. 2892 were canceled May 8, 1992, by memo 9605 (942) M.S. 2892, which is now a part of the original field notes."

May 8, 1992
Date



Chief Cadastral Surveyor of Arizona

State:

OK

Volume:

M 2760

Reviewer:

26.1

Xerox:

From	To	ACTION			XEROX ONLY			TRANSCRIBING NEEDED					
		Xerox	W.O. Notes		Light-Faded	Stain	Other	Binding	Bearing	Distance	Smear	Illegible	Other
	OK												