

JUL 5-1911

4-683.

MINERAL SURVEY No. 2939

LOT No.

Arizona Land District.

FIELD NOTES

OF THE SURVEY OF THE MINING CLAIM OF

The Arizona Copper Company,

KNOWN AS THE

Nelson, Comstock,

Copper Mountain Mining District,

Greenlee County, Arizona,

Sections 9 and 16 uns., Township 4 S., Range 29 E.

Surveyed under instructions dated June 30, 1911

by Lamar Cobb
U. S. Mineral Surveyor.

Claim located see location certificates, 19

Survey commenced July 2, 1911

Survey completed July 3, 1911

6-822 Address;

J. R. Hampton, Attorney for claimant,
Clifton,
Arizona.

feet

Survey^{No} 2939

Nelson

Beginning at Cor. No. 1

Identical with Cors. Nos. 2, 6, and 2 Lot No. 72 Dora lode, Lot No. 42 Clay lode, and Sur. No. 576 First North Extension Clay lode, respectively.

A pine post, in place, 4 x 6 ins., 3 ft. high, with mound of stone, scribed N-1-2939, whence

A cross (X) and B R-1-2939 chiseled on quartz porphyry bed rock 5 x 5 ft. facing north, bears S. 56°43' E. 9.2 ft.

U.S.L.M.No. 1654 bears S. 33°33' E 1042.7 ft.

Thence N. 9°32' W.

333.4 Southwest end center of the location and lode.

390. Cross gulch, course from southwest to northeast.

666.8 To Cor. No. 2.

On line 2-3 Sur. No. 576 First North Extension, Clay lode.

A pine post, in place, 4x 6 ins., 3 ft. high, with mound of stone, scribed N-2-2939, whence

A cross (X) and B R-2-2939 chiseled on quartz porphyry bed rock 3 x 3 ft. facing east, bears S. 49°28' W. 23.7 ft.

Thence N. 54°36' E.

799.58 Intersect line 2-3 Sur. No. 1792 A. Copper King lode, at N. 70°46' W. 579.66 ft. from Cor. No. 2.

1270. Cross gulch, course from northwest to southeast.

1422.3 To Cor. No. 3.

A cross (X) at Cor. point and N-3-2939 chiseled on quartz porphyry boulder exposed 5 x 10 ft., with a 4 x 4 in. pine post, 3 ft. high, with mound of stone, alongside.

Thence S. 9°32' E.

220. Cross gulch, course from northwest to southeast.

- feet
333.4 Northeast end center of the location and lode.
455. Intersect lines 1-2, and 4-1, Sur. No. 1792 A. Copper King and Copper King No. 2 lodes, respectively, at N. 19° 06' E. 108.96 ft. from Cors. Nos. 2, and 4, respectively.
- 578.31 Cor. No. 2 Comstock lode, of this survey, and
Intersect line 3-4 Sur. No. 1792 A Copper King No. 2 lode, at S. 71°36' E. 59.09 ft. from Cor. No. 4.
- 666.8 To Cor. No. 4.
Identical with Cor. No. 3 Lot No. 72 Dora lode, and
On line 1-2 Comstock lode, of this survey.
A pine post, in place, 4 x 6 ins., 3 ft. high, with mound of stone, scribed N-4-2939, whence
A cross (X) and B R-4-2939 chiseled on quartz porphyry bed rock, 3 x 4 ft., facing south, bears N. 7° E. 12.9 ft.

Thence S. 54°36' W.
250. Cross gulch, course from west to east.
- 1422.3 To Cor. No. 1, the place of beginning.

Comstock lode
Beginning at Cor. No. 1
Identical with the northwest Cor. of the California lode, unsurveyed.
A pine post, in place, 4 x 4 ins., 3 ft. high, with mound of stone, scribed C-1-2939, whence
A cross (X) and B R-1-2939 chiseled on quartz porphyry boulder, exposed 4 x 5 ft., 5 ft. high, bears S. 58°27' E. 6.5 ft.
U.S.L.M. No. 1654 bears S. 39°12' W. 1138.1 ft.

Thence N. 9°32' W.
- 343.84 Intersect line 2-3 Napoleon lode, Sur. No. 1654 A., at S. 51°03' W. 38.51 ft. from Cor. No. 3 and at N. 51°03' E.

feet
74.56 ft. from Cor. No. 5 Lot No. 72 Dora lode.
730.00 Gulch, course from west to east.
822.25 Cors. Nos. 3,4, Lot No. 72 Dora lode, and Nelson lode, of
this survey, respectively.

910.72 To Cor. No. 2.
On line 3-4 Nelson lode, of this survey, and
On line 3-4 Sur. No. 1792 A. Copper King No. 2 lode,
at S. 71°36' E. 59.09 ft. from Cor. No. 4.
A pine post, in place, 4 x 6 ins., 3 ft. high, with
mound of stone, scribed C-2-2939, whence
A cross (X) and B R-2-2939 chiseled on quartz porphy-
ry bluff 8 ft. high, facing east, bears N. 53°06' W. 10 ft.

Thence N. 80°28' E.

180. Cross gulch, course from northwest to southeast.
300. Northwest end center of the location, and lode.
600. To Cor. No. 3.
A pine post, in place, 4 x 6 ins., 3 ft. high, with
mound of stone scribed C-3-2939, whence
A cross (X) and B R-3-2939 chiseled on quartz porphy-
ry bed rock 3 x 6 ft. facing south, bears S 84°36' E.
13.4 ft.
U.S.L.M. No. 1654 bears S. 31°42' W.

Thence S. 9°32' E.

318.13 Intersect line 3-4 Sur. No. 1792 A Copper King No. 2
lode, at S. 71°36' E. 738.21 ft. From Cor. No. 4.
557.78 Intersect the northwest side line of the California
lode, unsurveyed, at N. 50° E. 696.12 ft. from the north-
west Cor, and 664.93 ft. from its intersection with line 3-4,
Napoleon lode, Sur. No. 1654 A.
910.74 To Cor. No. 4.
A pine post, in place, 4 x 6 ins., 3ft. high, with
mound of stone, scribed C-4-2939, whence
A cross (X) and B R-4-2939 chiseled on quartz porphy-
ry bed rock, 1 x 3 ft., facing southeast, bears N. 79°24'
W. 11.5 ft.

feet

Thence S. 80° 28' W.

180. Cross gulch, course from northwest to southeast.

300. Southeast end center of the location and lode.

573.42 Intersect line 3-4, Napoleon lode, Sur. No. 1654 A, at S. 8° 26' E.

600. To Cor. No. 1, the place of beginning, 362.82 ft. from Cor. No. 3, and 15.82 ft. from its intersection with the N. side line of the California lode, unsur.

Variation at all corners 13° 30' E.

Lode Lines

As near as can be determined from present developments the veins of the several locations embraced in this claim, extend as follows from their respective ^{dis} points to the end centers of their respective lodes:

Nelson lode, 520 ft. S. 54° 36' W., and 902.3 ft. N. 54° 36' E.

Comstock lode, 200 ft. N. 9° 32' W., and 710.74 ft. S. 9° 32' E.

	Area	Acres	Acres
Total area Nelson lode			19.591
Area in conflict with-			
Sur. No. 1792 A. Copper King lode		3.651	
Sur. No. 1792 A. Copper King No. 2 lode		0.074	
Total area Comstock lode			12.545
Area in conflict with-			
Sur. No. 1792 A. Copper King No. 2 lode		2.191	
Sur. No. 1654 A. Napoleon lode		0.243	
California lode, unsurveyed		2.431	
Common conflict,			
California lode, unsurveyed, with Sur. No. 1654 A. Napoleon lode			0.005

The survey of each lode of this location is identical with the respective location as staked on the ground.

Adjoining Claims

This claim is bounded as follows:

On the north by the Mohawk and Iroquois^{lodes,} unsurveyed, Detroit Copper Mining Co. claimant, and Sur. No. 1792 A. Copper King and Copper King No. 2 lodes, claimant herein; on the east by Sur. No. 1792 A. Copper King No. 2 lode, claimant herein, and the Bunker Hill and California lodes, unsurveyed, Detroit Copper Mining Co. claimant; on the south by the California lode, unsurveyed, Detroit Copper Co. claimant, Sur. No. 1654A Napoleon lode, and Lot No. 72 Dora lode, claimant herein; and on the west by Sur. No. 1654 A Napoleon lode, Lot No. 72 Dora lode, Sur. No. 576 First N^{orth} Ext^{ension} Clay lode, claimant herein, and the Bunker Hill lode, unsurveyed, Detroit Copper Mining Co. claimant.

L o c a t i o n

This survey is located in unsurveyed Sections 9 and 16, Township 4 S., Range 29, E. in the Copper Mountain Mining District, Greenlee (formerly Graham) County, Arizona.

Expenditure of five hundred dollars

I certify that the value of the labor and improvements made upon each location embraced in this mining claim by the claimant or its grantors is not less than five hundred dollars, and that said improvements consist of:

Nelson lode

No. 1 The discovery cut and tunnel, the mouth of which bears from a point on line 4-1, 466 ft. from Cor. No. 1, N. 1° 49' E. 310 ft., thence N. 26° W. 38 ft. in open cut 4 ft. wide, and 30 ft. in tunnel, 4 x 6 ft.

Value \$ 400.00

No. 2 A tunnel the mouth of which bears from Cor. No. 3, S. 30° 45' W. 299.3 ft. running S. 38° 35' W. 1450 ft. 8 x 8 ft., total value \$ 21,300.

Value last 1225 ft. \$18,375.00

Note: The first 225 ft. of this tunnel is on Sur. No. 1792 A. Copper King lode.

Comstock lode

No. 1 The discovery, showing mineral in place in the outcrop, which is on the lode line 200 ft. from the northwest end center.

No. 2 A tunnel the mouth of which bears from Cor. No. 3, S. 51°47' W. 491.0 ft. running S. 41³/₄' W. 57 ft.; thence S. 38° 45' W. 63 ft., 4 x 6 ft.

Value \$ 1200.00

Instrument

This survey was made with a Buff & Buff light mountain transit.

The courses were deflected from the true meridian as determined by Polaris observations and measured with 500 ft. and 5 ft. steel tapes.

R e p o r t

Sur. No 576, Lot No. 73 First North Extension, Clay lode:

Cors. Nos. 2 and 3 are pine posts properly set and scribed with the number of the Lot and corner.

Lot No. 42 Clay lode:

Cor. No. 6 is a pine post properly set and scribed with the number of the lot and corner.

Lot No. 72 Dora Lode:

Cors. Nos. 2, 3, and 5 are pine posts properly set and scribed with the number of the lot and corner. Cor. No. 4 has been obliterated.

Sur. No. 1654 A. Napoleon lode:

Cors. Nos. 2, 3, and 4 are pine posts properly set and scribed with the number of the survey and corner.

Sur. No. 1792 A. Copper King and Copper King No. 2 lodes:

Cors. Nos. 2 and 3, and Cors. No. 3 and 4, respectively, are pine posts properly set and scribed with the number of the survey and corner. Cors. Nos. 1 and 1, respectively, have been obliterated.

California lode, unsurveyed,

All corners are pine posts properly set and scribed.

The differences between these field notes and the returns of prior surveys are due to errors in the latter.

All end center monuments of this survey are monuments of stone.

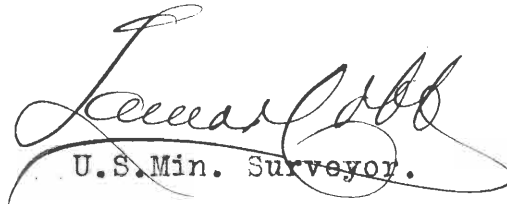
U.S. Min. Surveyor.

FINAL OATHS FOR SURVEYS.

LIST OF NAMES.

A list of the names of the individuals employed by Lamar Cobb
 United States Mineral Surveyor, to assist in running, measuring, and marking the lines, corners, and
 boundaries described in the foregoing field notes of the survey of the mining claim of
The Arizona Copper Company,
 known as the Nelson, Comstock,
 and showing the respective capacities in which they acted.

J. L. Awalt. _____, *Chainman.*
 & Axman _____, *Chainman.*
 _____, *Axman.*
 _____, *Flagman.*

FINAL OATHS OF ASSISTANTS.

We, I, J. L. Awalt
 and _____, do solemnly swear that we assisted
Lamar Cobb, United States Mineral Surveyor, in marking the corners and surveying
 the boundaries of the mining claim of The Arizona Copper Company,
 known as the Nelson, Comstock,
 represented in the foregoing field notes as having been surveyed by said mineral surveyor and under his
 direction; and that said survey has been in all respects, to the best of ^{my} ~~our~~ knowledge and belief, faithfully
 and correctly executed, and the corner and boundary monuments established according to law and the instruc-
 tions furnished by the United States Surveyor-General for Arizona

J. L. Awalt _____, *Chainman.*
 & Axman _____, *Chainman.*
 _____, *Axman.*
 _____, *Flagman.*

Subscribed and sworn to by the above-named persons before me this 3rd
 day of July, 1911

Mad. Hampton

 Notary Public.

My commission expires December 22, 1913.

4-686.

FINAL OATH OF U. S. MINERAL SURVEYOR.

I, Lamar Cobb, U. S. Mineral Surveyor, do solemnly swear that, in pursuance of instructions received from the United States Surveyor General for Arizona, dated June 30 5h., 1911, I have, in strict conformity to the laws of the United States, the official regulations and instructions thereunder, and the instructions of said Surveyor General, faithfully and correctly executed the survey of the Mining Claim of The Arizona Copper Company, known as the Nelson, Comstock, situate in Copper Mountain Mining District, Greenlee County, Arizona, in Sections 9 & 16 uns., Township No. 4 S., Range No. 29 E., and designated as Survey No. 2939, as represented in the foregoing field notes, which accurately show the boundaries of said mining claim as distinctly marked by monuments on the ground, and described in the attached copy of the location certificate, which was received by me from the Surveyor General with said instructions, and that all the corners of said survey have been established and perpetuated in strict accordance with the law, official regulations and instructions thereunder; and I do further solemnly swear that the foregoing are the true and original field notes of said survey and my report therein, and that the labor expended and improvements made upon said mining claim by claimant or its grantors are as therein fully stated, and that the character, extent, location, and itemized value thereof are specified therein with particularity and full detail, and that no portion of said labor or improvements so credited to this claim has been included in the estimate of expenditures upon any other claim.

Lamar Cobb
U. S. Mineral Surveyor.

Subscribed and sworn to by the said Lamar Cobb
U. S. Mineral Surveyor, before me Wade Hampton
this 3rd
day of July, 190- 1911.

Wade Hampton
Notary Public.

6-1044

My commission expires December 22, 1913,

AMENDED NOTICE OF LOCATION—Lode Claim

To all Whom it may Concern:

This mining claim, the name of which is the Nelson Mining Claim, situate on lands belonging to the United States of America, and in which there are valuable mineral deposits, was entered upon and amended for the purpose of exploration and purchase by The Arizona Copper Co.,

by A. T. Thomson

the undersigned on the 27 th. day of June 1911. 190

The length of the claim is 1422.3 feet, and It claim s 520 feet in a S.54°36'W. direction, and 902.3 feet in a N.54°36'E. direction from the center of the discovery --- at which this notice is posted, lengthwise of the claim together with 300 feet in width of the surface grounds, on each side of the center of said claim. The general course of the lode deposit and premises is from the Northeast to the Southwest

The claim is situated and located in the Copper Mountain Mining District, in Greenlee County, Territory of Arizona, ~~about~~ ----- direction from: From the Southwest Corner of this claim U.S.M.M. No. 1654 bears S.33°33' E. 1042.7 ft.

The surface boundaries of the claim are marked upon the ground as follows: beginning at a monument of stone

at a point in a S.54°36'W. direction 520 feet from the discovery --- (at which this notice is posted), being in the center of the Southwest end line of said claim; thence N.9°32'W. 333.4 feet to a pine post, being the Northwest corner of said claim; thence N.54°36'E. 1422.3 feet to a pine post, being at the Northeast corner of said claim; thence S.9°32'E. 333.4 feet to a monument of stone being the center of the Northeasterly end of said claim; thence S.9°32'E. 333.4 feet to a pine post being at the Southeast corner of said claim; thence S.54°36'W. 1422.3 feet to a pine post at the Southwest corner of said claim; thence N.9°32'W. 333. feet to the place of beginning.

All done under the provisions of Chapter SIX, of Title XXXII, of the revised Statues of the United States, and of an act of the General Assembly of the Territory of Arizona, entitled "An Act to Codify and Revise the Laws of the Territory of Arizona," approved March 16th, 1901.

This is an Amended Location Notice of the Nelson mining Claim, located by The Arizona Copper Co.

on the 1 st. day of January 1897 ~~190~~, and recorded in Book 9 of Records of Mines at page 131-2, in the office of the County Recorder of the ~~aforsaid~~ County of Graham to which reference is hereby made, --- This location was amended on June 8, 1911, and recorded in book /, at pages 295-296 in the office of the County Recorder of Greenlee County.

Dated and posted on the ground this 27 th., day of June 1911 ~~190~~

The Arizona Copper Co.,
by *A. T. Thomson*

11A

AMENDED NOTICE OF LOCATION—Lode Claim

TERRITORY OF ARIZONA,
County of Graham } ss.

I, _____ County Recorder in and for the County and Territory aforesaid, do hereby certify that the within instrument was filed for record at _____ o'clock _____ M, on this _____ day of _____ 190_____, and duly recorded in Book No _____ of _____ Records of Graham County Arizona, at pages _____.

Witness my hand and seal the day and year first above written,

County Recorder

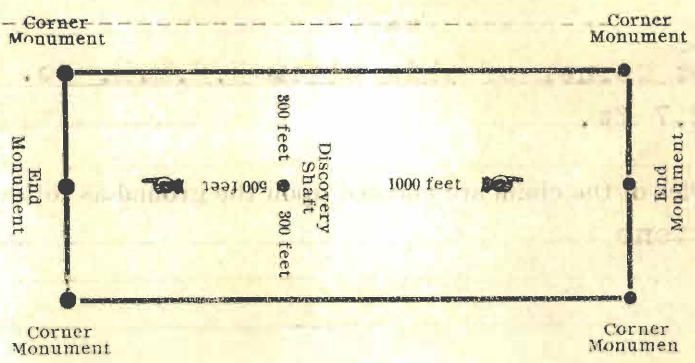

The above diagram is to give the locator a general idea of the plan of location under the new law. Your discovery shaft may be in the center of claim, or any distance from either end you desire. In the diagram we have placed it 500 feet from one end and 1000 feet from the other. In description be careful to state locality of claim with reference to some natural object, or permanent monument, so as to identify the claim.

JUN 30, 1911

916

Amended
Notice of Location
LODE CLAIM

Wesson

Dated *June 13 1911* 1911

Filed and recorded at request of
J. G. Wesson

June 13 1911 A. D. 1901
at *1:30 O'clock P.M.*
Book # *1 Mining Location*
Pages *311-312*
J. G. Wesson
County Recorder.

By _____ Deputy Recorder.

2939

AMENDED NOTICE OF LOCATION—Lode Claim

To all Whom it may Concern:

This mining claim, the name of which is the Comstock
Mining Claim, situate on lands belonging to the United States of America, and in which there are
valuable mineral deposits, was entered upon and amended for the purpose of exploration and purchase by
The Arizona Copper Co.,

by A.T. Thomson

the undersigned on the 27 th. day of June 1911
The length of the claim is 910.74 feet, and It claim 200
feet in a N.9°32'W. direction, and 710.74 feet in a S.9°32'E.
direction from the center of the discovery -- at which this notice is posted, lengthwise of the claim
together with 300. feet in width of the surface grounds, on each side of the
center of said claim. The general course of the lode deposit and premises is from the Northwest
to the Southeast

The claim is situated and located in the Copper Mountain
Mining District, in Greenlee County, Territory of Arizona, about
----- direction from
From the Southwest Corner of this claim U.S.M.M. No. 1654 bears
S.39°12'W. 1138.1 ft.

The surface boundaries of the claim are marked upon the ground as follows: beginning at
a monument of stone

at a point in a N.9°32'W. direction 200 feet from
the discovery --- (at which this notice is posted), being in the center of the Norwesterly
end line of said claim; thence N.80°28'E. 300 feet to a
pine post, being the Northeast
corner of said claim; thence S. 9°32'E. 910.74 feet to a
pine post, being at the Southeast
corner of said claim; thence S.80°28'W. 300 feet to a
monument of stone being the center of the Southeasterly
end of said claim; thence S.80°28'W. 300 feet to a
pine post being at the Southwest
corner of said claim; thence N. 9°32'W. 910.74 feet to a
pine post at the Northwest
corner of said claim; thence N.80°28'E. 300 feet to
the place of beginning.

All done under the provisions of Chapter SIX, of Title XXXII, of the revised Statues of the United States, and of
an act of the General Assembly of the Territory of Arizona, entitled "An Act to Codify and Revise the Laws of the
Territory of Arizona," approved March 16th, 1901.

This is an Amended Location Notice of the Comstock
mining Claim, located by The Arizona Copper Co.

on the 12 th.
day of June 1901 ~~-190-~~, and recorded in Book 14 of Records of Mines at
page 336, in the office of the County Recorder of the ~~aforsaid~~ County of Graham
to which reference is hereby made, -- This location was amended on June 8, 1911
and recorded in Book / , at pages 181, 188, in the office of the
County Recorder of Greenlee County.

Dated and posted on the ground this 27 th. day of June 1911 ~~190-~~

The Arizona Copper Co.,

by

A.T. Thomson

12A

TERRITORY OF ARIZONA,
County of Graham } ss.

I, _____ County Recorder in and for the County and Territory aforesaid, do hereby certify that the within instrument was filed for record at _____ o'clock _____ M, on this _____ day of _____ 190_____, and duly recorded in Book No _____ of _____ Records of Graham County Arizona, at pages _____

Witness my hand and seal the day and year first above written,

County Recorder

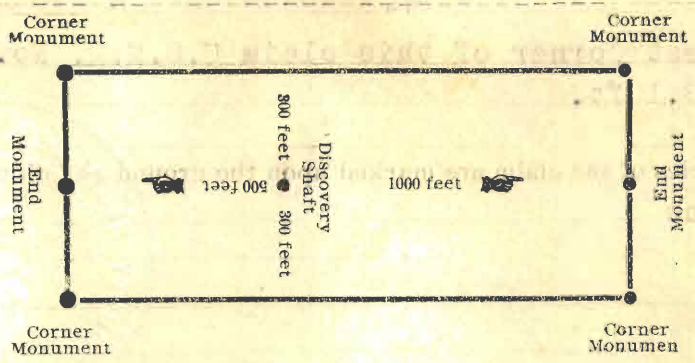

The above diagram is to give the locator a general idea of the plan of location under the new law. Your discovery shaft may be in the center of claim, or any distance from either end you desire. In the diagram we have placed it 500 feet from one end and 1000 feet from the other. In description be careful to state locality of claim with reference to some natural object, or permanent monument, so as to identify the claim.

JUN 30 1911

#915

Amended Notice of Location

LODE CLAIM

"Cambeast"

Dated June 27th 1911

Filed and recorded at request of

J. G. Cooper

A. D. 1911

June 27th at 1:30 P.M.

Book #1 Mining Location

Pages 309 to 310

J. G. Cooper
County Recorder

By _____ Deputy Recorder

U. S. SURVEYOR GENERAL'S FINAL CERTIFICATE ON
FIELD NOTES.

DEPARTMENT OF THE INTERIOR,
OFFICE OF U. S. SURVEYOR GENERAL,

Phoenix, Arizona,

August 12, 1911.

I, U. S. Surveyor General for Arizona,
do hereby certify that the foregoing transcript of the Field Notes, return and approval
of the Survey of the mining claim of

The Arizona Copper Company,

, known as the NELSON, COMSTOCK,

, situate in Copper Mountain

Mining District, Greenlee County,

Arizona, in Sections 9 & 16 uns., Township No. 4 S.,

Range No. 29 E., and designated as Survey

No. 2939, has been correctly copied from the originals on
file in this office; that said Field Notes furnish such an accurate description of said
mining claim as will, if incorporated into a patent, serve fully to identify the premises,
and that such reference is made therein to natural objects or permanent monuments as
will perpetuate and fix the locus thereof.

And I further certify that five hundred dollars' worth of labor has been expended
or improvements made upon said mining claim by claimant or its grantors, and
that said improvements consist of 1 cut and 3 tunnels, total value
\$19,975.00

and that no portion of said labor or improvements has been included in the estimate of
expenditures upon any other claim.

I further certify that the plat thereof, filed in the U. S. Land Office at Phoenix,
Arizona, is correct and in conformity with the foregoing Field Notes.

Frank S. Ingalls,

United States Surveyor General for Arizona.

4-687.

SURVEYOR-GENERAL'S CERTIFICATE OF APPROVAL OF FIELD NOTES AND SURVEY OF MINING CLAIM.

Department of the Interior,

Office of U. S. Surveyor-General,

Phoenix, Arizona,

August 12, 1911.

I, U. S. Surveyor-General for Arizona,

do hereby certify that the foregoing and hereto attached Field Notes and Return of the Survey of the Mining Claim of

The Arizona Copper Company,

known as the

NELSON, COMSTOCK,

situate in Copper Mountain Mining District,

Greenlee County, Arizona,

in Sections 9 and 16 un~~s~~. Township No. 4 S., Range No. 29 E.

designated as Survey No. 2939.

executed by Lamar Cobb, U.S. Deputy Mineral

Surveyor, July 2 - 3, 1911, under my instructions dated

June 30, 1911, have been critically examined and the necessary cor-

rections and explanations made, and the said Field Notes and Return, and the Survey they describe,

are hereby approved. A true copy of the copy of the location certificate filed by the applicant for

survey is included in the field notes.

Frank S. Ingalls

U. S. Surveyor-General for Arizona.