

Platted

Copied Oct. 21, 1913.

JUN 3- 1913

A.L.H.

AUG. 18. 1913

(4-683.)

Mineral Survey No. 5058

Lot No.

ARIZONA Land District.

FIELD NOTES

OF THE SURVEY OF THE MINING CLAIM OF

The Detroit Copper Mining Company of Arizona

KNOWN AS THE

Maine, Olivette, Maine Fraction, Tony, Fraction, Hidden View, Missing Link, Copper Chief, Alice Winifred, Tom H, Cambridge, North Star, Golden

Gate Greenlee Gold Mountain Mining District,

Greenlee County, Arizona

Section 1 surveyed, Secs. 2 and 11 unsurveyed, T. 4 S., R. 29 E. and Section 36, Township 3 S., Range 29 E. unsurveyed, G. and S.R.P.M.

Surveyed under instructions dated March 20, 1913,

by E. T. Morton, U. S. Deputy Mineral Surveyor.

Claim located see location notices, 1

Survey commenced March 25, 1913

Survey completed April 10, 1913

Address of attorneys:

Ellinwood & Ross,

Bisbee, Arizona.

SURVEY NO. 3058

Feet

Maine

Beginning at Cor. No. 1.

A pine post in place, 4 ins. square, 3.0 ft. high with mound of stone, scribed M-1-3058, whence.

The S. E. Cor. Sec. 1 T. 4 S., R. 29 E., G. & S. R. B. & M. bears S. 87° 20' E. 8849.7 ft.

U. S. L. M. No. 1576 bears N. 46° 43' E. 1801.5 ft.

Thence S. 61° 56' W.

20 Intersects gulch, course Southeast.

770.5 Cor. No. 2, Tony lode of this survey.

1395.5 To Cor. No. 2.

A pine post in place 4 ins. square, 3 ft. high, with mound of stone, scribed M-2-3058, whence

A cross (X) and B. R.-2-3058 chiseled on granite bedrock 2 x 4 ft. facing Southeast, bears N. 84° W. 7.1 ft.

Thence N. 38° 50' W.

305.24 Southwest end center of location and lode.

610.48 To Cor. No. 3.

A pine post in place 4 ins. square, 3 ft. high, with mound of stone, scribed M-3-3058.

No bearings available.

Thence N. 61° 56' E.

816.32 Intersect line 2-3 Olivette lode of this survey, at N. 38° 21' W. 26.85 ft. from Cor. No. 2.

1395.5 To Cor. No. 4.

Identical with Cor. No. 3 Maine Fraction lode and on line 1-2 Olivette lode of this survey, N. 59° 18' E. 575 ft. from Cor. No. 2.

A pine post, in place, 4 ins. square, 3.5 ft. high, with

Feet	mound of stone, scribed M-4-M F-3-3058. No bearings available. Thence S. 38° 50' E.
162.52	Intersect line 3-4 Monte Carlo lode Sur. No. 1584 at N. 3° 53' W. 78.08 ft. from Cor. No. 3.
257.07	Intersect lines 2-3 and 3-4 Monte Carlo lode Sur. No. 1584 and Tony lode of this survey at N. 85° 30' E. 54.17 ft. and 505.17 ft. from Cor's No's 3 and 3 respectively.
305.24	Northeast end center of the location and lode
460	Intersect gulch course Southeast.
606.1	Cor. No. 2, Maine Fraction lode of this survey.
610.48	To Cor. No. 1, the place of beginning. Olivette. Beginning at Cor. No. 1. Identical with Cor. No. 4 Maine Fraction lode of this survey. A pine post, in place, 4 ins. square, 3.5 ft. high with mound of stone, scribed M F-4-0-1-3058, whence, A cross (X) and B R chiseled on granite porphyry bluff 6 x 20 ft. facing Southeast bears N. 45° 55' W. 25.4 ft. The S. E. Cor. Sec. 1, T. 4 S., R. 29 E. G & S. R. B. & M. bears S. 80° 50' E. 8536.6 ft. U. S. L. M. No. 1576, bears N. 72° 16' E. 943.6 ft. Thence S. 59° 18' W.
99.6	Intersect line 6-1 Monte Carlo lode Sur. No. 1584 at N. 85° 35' E. 34.09 ft. from Cor. No. 6. From Cor. No. 6, Cor. No. 5, said Monte Carlo lode bears S. 58° 24' W. 606.8 ft., thence S. 86° 14' W. 72.3 ft. to Cor. No. 4.
820.68	Intersect line 3-4 Monte Carlo lode Sur. No. 1584 at

Feet N. 3° 53' W. 258.35 ft, from Cor. No. 3 and S. 3° 53' E.
42.95 ft. from Cor. No. 4.

845 Intersect gulch course Southeast.

925 Cor's No's 3 and 4 Maine Fraction and Maine lodes of
this survey, respectively.

1500 To Cor. No. 2.
A pine post in place, 4 ins. square, 3.5 ft. high, with
mound of stone scribed, O-2-3058, whence,
A cross (X) and B R 2-3058 chiseled on granite porphyry
bedrock 3 x 3 ft., facing South bears S. 46° W. 8.6 ft.

Thence N. 38° 21' W.

26.85 Intersect line 3-4 Maine lode at N. 61° 56' E. 816.32
ft. from Cor. No. 3 and S. 61° 56' W. 579.18 ft. from
Cor. No. 4.

302.45 Southwest end center of the location and lode.

604.9 To Cor. No. 3.
A pine post in place, 4 ins. square, 3.5 ft. high, with
mound of stone, scribed O-3-3058, whence,
No bearings available.

Thence N. 59° 18' E.

825 Intersect gulch, course Southeast.

1500 To Cor. No. 4.
Identical with Cor. No. 3 Copper Bullion lode, Sur. No.
1576.
A pine post, in place, 4 ins. square, 3.5 ft. high, with
a mound of stone, scribed, O-4-3058, whence
Cor. No. 2 Copper Bullion lode bears S. 35° 45' E. 600 ft.
A cross (X) and B R-4-3058 chiseled on granite bedrock
2 x 2 ft. facing Southeast bears N. 41° 20' E. 9.2 ft.

Thence S. 38° 21' E.

302.45 Northeast end center of the location and lode.

599.74 Intersect line 3-4 Fraction lode of this survey at N.

Feet	52° 30' E. .04 ft. from Cor. No. 3 and line 2-1 Copper Bullion lode Sur. No. 1576, N. 52° 30' E. 27.20 ft. from Cor. No. 2.
604.9	To Cor. No. 1, the place of beginning.
	Maine Fraction.
	Beginning at Cor. No. 1.
	Identical with Cor. No. 2 Fraction lode of this survey.
	A pine post, in place, 4 ins. square, 3.5 ft. high, with mound of stone scribed F-2- M F ^{-/-} 3058 whence,
	The S. E. Cor. Sec. 1, T. 4 S., R. 29 E., G. & S. R. B. & M., bears S. 83° 39' E. 8104.2 ft.
	U. S. L. M. No. 1576 bears N. 35° E. 916.6 ft.
	Thence S. 58° 37' W.
233.93	Intersect lines 1-2 and 3-4 Monte Carlo and Copper Verde lodes, Sur. No. 1584 at N. 4° 20' W. 23.48 ft from
	Cor's No's 2 and 3 respectively, and S. 4° 20' E. 552.82 ft. from Cors. 4-1.
285.86	Intersect lines 2-3 and 4-3 Monte Carlo lode Sur. No. 1584 and Tony lode of this survey at S. 85° 30' W. 46.25 ft.
	from Cor's No's 2 and 4 respectively.
923.5	To Cor. No. 2.
	A pine post in place, 4 ins. square 3.5 ft. high, with mound of stone, scribed M F -2-3058, whence Cor. No. 1
	Maine lode of this survey bears S. 38° 50' E. 4.38 ft.
	Thence N. 38° 50' W.
146.1	Intersect gulch course Southeast.
303.05	Southwest end center of the location and lode.
349.03	Intersect line 2-3 and 4-3 Monte Carlo lode Sur. No. 1584 and Tony lode of this survey at N. 85° 30' E. 54.17
	ft. and 505.17 ft. from Cor's No's 3 and 3, and S. 85°
	30' W. 811.83 ft. from Cor's No's 2 and 4 respectively.
443.58	Intersect line 3-4 Monte Carlo lode, Sur. No. 1584 at N. 3° 53' W. 78.08 ft. from Cor. No. 3.

Feet

606.1

To Cor. No. 3.

Identical with Cor. No. 4 Main lode of this survey heretofore described.

Thence N. 59° 18' E.

80

Intersect gulch, course Southeast.

104.32

Intersect line 3-4 Monte Carlo lode Sur. No. 1584 at N. 3° 53' W. 258.35 ft. from Cor. No. 3.

825.4

Intersect line 6-1 Monte Carlo lode Sur. No. 1584 at N. 85° 35' E. 34.09 ft. from Cor. No. 6.

925

To Cor. No. 4.

Identical with Cor. No. 1 Olivette lode of this survey heretofore described.

Thence S. 38° 50' E.

53.46

Intersect line 6-1 Monte Carlo lode Sur. No. 1584 at N. 85° 35' E. 153.6 ft. from Cor. No. 6.

227.18

Intersect line 1-2 and 3-4 Monte Carlo and Copper Verde lodes Sur. No. 1584, at S. 4° 20' E. 143.31 ft. from Cor's No's 1 and 4 respectively.

303.05

Northeast end center of the location and lode.

595

To Cor. No. 1, the place of beginning.

Tony.

Beginning at Cor. No. 1.

A pine post in place, 4 ins. square, 3.5 ft. high, with mound of stone, scribed T-1-3058, whence,

The S. E. Cor., Sec. 1, T. 4 S., R. 29 E., G. & S. R.

B&M., bears S. 88° 56' E. 8208.5 ft.

Thence S. 85° 30' W.

350

Intersect gulch, course Southeast.

1317

To Cor. No. 2.

On line 1-2 Maine lode of this survey at S. 61° 56' W.

Feet	770.5 ft. from Cor. No. 1. A pine post, in place, 4 ins. square, 3.5 ft. high, with mound of stone, scribed T-2-3058, whence, A cross (X) and B R -2-3058 chiseled on quartz porphyry bedrock, 2 x 2 ft., bears N. 3° E. 6 ft. Thence N. 4° 20' W;
300	West end center of the location and lode.
600	To Cor. No. 3. A pine post, in place, 4 ins. square, 3.5 ft. high, with mound of stone, scribed T-3-3058, whence, A cross (X) and B R-3-3058 chiseled on quartz porphyry bedrock 3 x 6 ft. facing Southeast bears N. 50° W. 3 ft. Thence N. 85° 30' E.
451	Cor. No. 3 Monte Carlo lode Sur. No. 1584.
505.17	Intersect line 4-1 and 2-3 Maine and Maine Fraction lodes of this survey at N. 38° 50' W. 353.41 ft. and 349.03 ft. from Cor's No's 1 and 2 respectively.
540	Intersect gulch, course Southeast.
1270.75	Intersect line 1-2 Maine Fraction lode of this survey at N. 58° 37' E. 637.64. ft. from Cor. No. 2.
1317	To Cor. No. 4. Identical with Cor's No's 2 and 3, Monte Carlo and Copper Verde lodes, Sur. No. 1584, respectively. A pine post, in place, 4 ins. square, 3.5 ft. high, with mound of stone, scribed T-4-3058, whence, U. S. L. M. No. 1576 bears N. 38° 53' E 1151.8 ft. A cross (X) and B R-4-3058 chiseled on quartz porphyry bedrock 2 x 3 ft., facing Southeast, bears N. 5° W. 23.2 ft. Thence S. 4° 20' E.
300	East end center of the location and lode.
600	To Cor. No. 1, the place of beginning.

Feet

Fraction.

Beginning at Cor. No. 1, identical with Cor. No. 2
Hidden View lode of this survey.

A pine post in place, 4 ins. square, 3.5 ft. high, with
mound of stone scribed H V-2-F-1-3058, whence

The S. E. Cor. Sec. 1, T. 4 S., R. 29 E., G. & S. R.
B.&M., bears S. 75° 32' E. 7128.4 ft.

U. S. L. M. No. 1576 bears S. 78° W. 640.3 ft.

A cross (X) and B R-2-1-3058, chiseled on granite bed-
rock 2.5 x 3 ft., facing South bears N. 38° 50' W. 6.4 ft.

Thence S. 52° 30' W.

628.3 Intersect line 4-1 Copper Verde lode, Sur. No. 1584 at
N. 85° 24' E. 897.83 ft. from Cor. No. 4.

1452 To Cor. No. 2.

Identical with Cor. No. 1 Maine Fraction lode of this
survey, heretofore described.

Thence N. 38° 50' W.

300.08 Southwest end center of the location and lode.

367.82 Intersect line 1-2 and 3-4 Monte Carlo and Copper Verde
lodes, Sur. No. 1584, at S. 4° 20' E. 143.31 ft. from
Cor's No's 1 and 4 respectively.

541.54 Intersect line 6-1 Monte Carlo lode, Sur. No. 1584, at
S. 85° 35' W. 98.4 ft. from Cor. No. 1.

595 Cor's No's 1 and 4 Olivette and Maine Fraction lodes of
this survey.

600.16 To Cor. No. 3.

On line 1-2 Copper Bullion lode Sur. No. 1576 at N.
52° 30' E. 27.16 ft. from Cor. No. 2.

A pine post in place 4 ins. square, 3. 5. ft. high, with
mound of stone, scribed F-3-3058, whence,

A cross (X) and B R 3-3058 chiseled on quartz porphyry
bluff 6x20 ft. facing the Southeast bears N. 47° 27' W.
20. 2 ft.

	Thence N. 52° 30' E.
.04	Intersect line 4-1 Olivette lode of this survey at N. 38° 21' W. 5.16 ft. from Cor. No. 1.
1448	Cor's No's 1 and 1 Copper Bullion and Solid Copper lodes Sur. No. 1576.
1452	To Cor. No. 4. Identical with Cor. No. 3, Hidden View lode of this survey. On line No. 1-4 Solid Copper lode, Sur. No. 1576. A pine post in place, 4 ins. square, 3 ft. high, with mound of stone, scribed H.V-3-F-4-3058, whence a cross (X) and B R-3-4-3058, chiseled on quartz porphyry 4. x 4 ft., facing East bears S. 52° 30' W. 44.2 ft.
	Thence S. 38° 50' E.
300.08	Northeast end center of the location and lode.
600.16	To Cor. No. 1, the place of beginning.
	Hidden View
	Beginning at Cor. No. 1. On line 2-3, Copper Chief lode of this survey, at N. 38° 50' E. 11.34 ft. from Cor. No. 2. A pine post, in place, 4 ins. square, 4 ft. high, with mound of stone, scribed H V-1-3058, whence, A cross (X) and B R-1-3058, chiseled on granite bedrock 5x6 ft., facing South bears S. 38° 50' E. 9.5 ft. The S. E. Cor. Sec. 1, T. 4 S., R. 29 E., G & S. R. B. & M., bears S. 66° 02' E 6390.5 ft.
	Thence S. 52° 30' W.
1340	To Cor. No. 2. Identical with Cor. No. 1, Fraction lode, of this survey heretofore described.
	Thence N. 38° 50' W.

Feet The S. E. Cor. Sec. 1, T. 4 S., R. 29 E, G. & S. R. B&M.
bears S.52°30 ' E 6136 ft. from true corner point.

Thence S.40°01'W' from true Cor.point.

1499.5 To Cor. No. 2.
A pine post, in place, 4 ins. square, 4 ft. high, with mound of stone , scribed C C-2-3058, whence,
A cross (X) and B R-2-3058 chiseled on granite bedrock 4 x 6 ft. facing East, bears N. 38° 50' W. 1.84 ft.

Thence N. 38° 50' W.

11.34 Cor. No. 1 Hidden View lode of this survey.
305.75 Southwest end center of the location and lode.
611.5 To Cor. No. 3.
Identical with Cor. No. 4 Hidden view lode of this survey, heretofore described.

Thence N. 40° 01' E.

1218.7 Cor's No's 1 and 1 Missing Link and Alice Winifred lodes of this survey.
1228.88 Intersect line 1-2 Golden Gate lode of this survey at N. 80° 20' W. 772.53 ft. from Cor. No. 1.
1499.5 To Cor. No. 4.
A pine post, in place, 4 ins. square 3.5 ft. high, with mound of stone scribed C C-4-3058, whence ,
A cross (X) and B R-4-3058, chiseled on granite bedrock 3 x 6 ft., facing East, bears N. 38° 50' W. 4.2 ft.

Thence S. 38° 50' E.

113.21 Cor. No. 2 Tom H. lode of this survey.
On line 4-1 Alice Winifred lode of this survey at N. 42° 41' E. 278.55 ft. from Cor. No. 1.
305.75 Northeast end center of the location and lode.
352.44 Intersect line 1-2 Golden Gate lode of this survey at

Feet

300.08 Southwest end center of the location and lode.

600.16 To Cor. No. 3.

Identical with Cor. No. 4 Fraction lode of this survey, heretofore described.

Thence N. 52° 30' E.

1333.33 Cor. No. 4 Solid Copper lode, Sur. No. 1576 on line 2-3 Missing Link lode of this survey, at N. 38° 50' W. 1.47 ft. from Cor. No. 2.

1340 To Cor. No. 4.

Identical with Cor. No. 3, Copper Chief lode of this survey.

On line 1-2 Missing Link lode of this survey, at N. 40° 01' E. 6.8 ft. from Cor. No. 2.

A pine post, in place, 4 ins. square, 3.5 ft. high, with mound of stone, scribed C C-3-H V-4-3058, whence,

A cross (X) and B R 3-4-3058, chiseled on granite 4 x 6 ft., facing East, bears S. 89° 10' W. 14.6 ft.

U. S. L. M. No. 1576, bears S. 42° 50' W. 1931.4 ft.

Thence S. 38° 50' E.

300.08 Northeast end center of the location and lode.

600.16 To Cor. No. 1, the place of beginning.

Copper Chief

Beginning at Cor. No. 1, which is on the side of an inaccessible granite bluff, 60 ft. high. on line 1-2

Tom H. lode of this survey, at N. 38° 50' W. 8.41 ft. from Cor. No. 1.

Witness corner bears N. 38° 50' W. 17.0 ft., identical with witness corner for Cor. No. 1 Tom H. lode of this survey.

A cross (X) W C T H-1- W C C C-1-3058 chiseled on granite shelf on side of high bluff.

Feet N. 80° 20' W. 371.84 ft., from Cor. No. 1.
 594.50 To witness Cor. for Cor. No. 1, heretofore described.
 611.5 To Cor. No. 1, the place of beginning.

Missing Link.

Beginning at Cor. No. 1.

Identical with Cor. No. 1, Alice Winifred lode of this survey.

A pine post, in place, 4 ins. square, 3.5 ft. high, with mound of stone scribed A. W-1- M L-1-3058, whence

A cross (X) and B R -1-1-3058 chiseled on granite bluff 12 ft. high bears N. 56° E. 7 ft.

The S. E. Cor. Sec. 1, T. 4 S., R. 29 E., bears S. 53° 39' E. 6744 ft.

Thence S. 40° 01' W.

1218.7 Cor's No's 3 and 4 Copper Chief and Hidden View lodes of this survey, respectively.

1225.5 To Cor. No. 2.

A pine post, in place, 4 ins. square, 3.5 ft. high, with mound of stone, scribed M L-2-3058, whence,

A cross (X) and B R-2-3058 chiseled on granite bedrock 4 x 6 ft. facing East, bears N. 64° 25' W. 11.3 ft.

U. S. L. M. No. 1576 bears S. 42° 51' W. 1924.6 ft.

Thence N. 38° 50' W.

1.47 Cor. No. 4, Solid Copper lode, Sur. No. 1576 and intersect line 3-4 Hidden View lode of this survey at S. 52° 30' W. 6.67 ft. from Cor. No. 4. Cor. 3 said solid Copper lode bears N. 37° 22' W. 592.5 ft.

305.35 Southwest end center of the location and lode.

594.13 Intersect line 2-3 Solid Copper lode Sur. No. 1576, at S. 52° 30' W. 15.17 ft. from Cor. No. 3.

610.7 To Cor. No. 3.

A pine post in place, 4 ins. square, 3.5 ft. high, with

Feet	mound of stone scribed M. L. -3-3058, whence, Cor. No. 3 Solid Copper lode Sur. No. 1576 bears S. 80° 43' E. 22.7 ft.
	Thence N. 40° 01' E.
766.75	Intersect line 1-2 Golden Gate lode of this survey at S. 80° 20' E. 33.14 ft. from Cor. No. 2.
1225.5	To Cor. No. 4. A pine post, in place, 4 ins. square, 3.5 ft. high, with mound of stone, scribed M L-4-3058, whence, A cross (X) and B R-4-3058 chiseled on granite rock 4 x 5 ft. facing South bears N. 55° 10' E. 9.1 ft.
	Thence S. 38° 50' E.
6.1	Cor. No. 2 Alice Winifred lode of this survey.
305.35	Northeast end center of the location and lode.
597.44	Intersect line 1-2 Golden Gate lode of this survey, at S. 80° 20' E. 712.4 ft. from Cor. No. 2.
610.7	To Cor. No. 1, the place of beginning.
	Alice Winifred
	Beginning at Cor. No. 1. Identical with Cor. No. 1, Missing Link lode of this survey, heretofore described. On line 3-4 Copper Chief lode of this survey at S. 40° 01' W. 280.80 ft. from Cor. No. 4. U. S. L. M. 1576 bears S. 41° 45' W. 3149.1 ft. The S. E. Cor. Sec. 1. T. 4. S., R. 29; E. G. & S. R. B. & M. bears S. 53° 39' E. 6744 ft.
	Thence N. 38° 50' W.
13.26	Intersect line 1-2 Golden Gate lode of this survey at N. 80° 20' W 787.6 ft. from Cor. No. 1.
302.5	Southwest end center of the location and lode.
604.6	To Cor. No. 2. A pine post, in place 4 ins. square, 3.5 ft. high, with

Feet mound of stone scribed A. W.-2-3058, whence,
 A cross (X) and B R-2-3058 chiseled on granite 4 x 5 ft.
 facing South bears N. 19° 24' E. 10.7 ft.

Thence N. 42° 41' E.

75.00 Intersect gulch course Southeast.

248.24 Intersect line 3-4 Golden Gate lode of this survey at
 S. 80° 20' E. 403.37 ft. from Cor. No. 3.

1500.00 To Cor. No. 3.

A cross (X) A W-3-3058 chiseled on granite bedrock 40 x
 50 ft. facing East with a pine post 4 ins. square 4 ft.
 in height along side.
 No bearings available.

Thence S. 38° 50' E.

276.37 Intersect North side line Philadelphia lode unsurveyed
 at S. 84° 31' E. 262.81 ft. from N. W. Cor. S. W. Cor.
 bears S. 5° 29' W. 600 ft. from N. W. Cor..

302.3 Northeast end center of the location and lode.

604.6 To Cor. No. 4.

On line 2-3 Tom H. lode of this survey at S. 42° 41' W.
 86.55 ft. from Cor. No. 3.

A pine post, in place, 4 ins. square, 3.5 ft. high, with
 mound of stone, scribed A W-4-3058 whence,
 No bearings available.

Thence S. 42° 41' W.

458.42 Intersect South side line Philadelphia lode unsurveyed,
 at S. 84° 31' E. 214.95 ft. from S. W. Cor.

773.96 Intersect line 3-4 Golden Gate lode at N. 80° 20' W.
 385.47 ft. from Cor. No. 4. and S. 80° 20' E. 1116.53 ft.
 from Cor. No. 3.

1071.45 Intersect gulch course Southeast.

1221.45 Cor. No. 2 Tom H. lode of this survey and intersect line
 4-1 Copper Chief lode of this survey at S. 38° 50' E.
 13.21 ft. from Cor. No. 4.

1489.52 Intersect line 1-2, Golden Gate lode of this survey, N. 80°
 20' W. 771.96 ft. from Cor. No. 1.

1500.00 To Cor. No. 1, the place of beginning.

Feet

Tom H.

Beginning at Cor. No. 1.

This corner is on a granite point about 60 ft. high, which identical with W.C. for Cor. No. 1, Copper Chief lode of this sur. is inaccessible. W. C. heretofore described bears N.

38° 50' W. 25.41 ft.

U. S. L. M. No. 1576 bears S. 52° 01' W. 5382.4 ft. from true corner point.

The S. E. Cor. Sec. 1, T. 4 S., R. 29 E. G. & S. R. B. & M bears S. 52° 31' E. 6128.1 ft. from true corner point.

Thence N. 38° 50' W.

8.41 Cor. No. 1, Copper Chief lode of this survey.

225.41 To witness corner for Cor. No. 1, heretofore described.

2267.47 Intersect line 1-2 Golden Gate lode of this survey at N. 80° 20' W. 371.84 ft. from Cor. No. 1

303.35 Southwest end center of the location and lode.

606.7 To Cor. No. 2.

On-line 4-1 and 4-1 Alice Winifred and Copper Chief lodes of this survey at S. 42° 41' W. 1221.45 ft. and S. 38° 50' E. 13.21 ft. from Cor's No's 4 and 4 respectively.

A pine post in place, 4 ins. square, 3 ft. high, with mound of stone scribed T H-2-3058.

No bearings available.

Thence N. 42° 41' E.

150 Intersect gulch course Southeast.

447.49 Intersect line 3-4 Golden Gate lode of this survey at N. 80° 20' W. 383.47 ft. from Cor. No. 4 and 321.68 ft.

from intersection of line 3-4 Golden Gate lode with West side line Quaker City, lode, unsurveyed.

763.03 Intersect South side line Philadelphia lode at E. 84°

31' E. 214.95 ft. from S. W. Cor. and N. 84° 21' W 1285.05 ft. from S. E. Cor.

1221.45 Cor. No. 4 Alice Winifred lode of this survey.

Feet	
1308	<p>To Cor. No. 5.</p> <p>A pine post in place, 4 ins. square, 3.5 ft. high, with mound of stone scribed, T H-3-3058.</p> <p>No bearings available.</p> <p style="text-align: center;">Thence S. 38° 50' E.</p>
303.35	Northeast end center of the location and lode.
606.7	<p>To Cor. No. 4.</p> <p>Identical with Cor. No. 3, Cambridge lode of this survey. On South side line Philadelphia lode unsurveyed at N. 84° 31' W. 531.7 ft. from S. E. Cor.</p> <p>A pine post in place 4 ins. square, 3.5 ft. high, with mound of stone, scribed C-3-T H-4-3058, whence,</p> <p>A cross (X) and B R-3-4-3058 chiseled on granite rock 3 x 4 ft. facing South bears N. 21° 50' E. 9.0 ft.</p> <p style="text-align: center;">Thence S. 42° 41' W.</p>
92.36	<p>Intersect East side line Quaker City lode, unsurveyed at S. 7° 26' E. 55.04 ft. from N. E. Cor. N. W. Cor. said Quaker City lode bears S. 82° 34' W. 600 ft. from the N.E. Cor.</p>
281.19	Cor. No. 2, Cambridge lode, of this survey.
581.91	Intersect wagon road, course Northwest to Southeast.
750	Intersect gulch, course Southeast.
874.27	<p>Intersect West side line Quaker City lode, unsurveyed at N. 7° 26' W. 879.57 ft. from S. W. Cor. and S. 7° 26' E. 556.43 ft. from N. W. Cor.</p>
992.85	<p>Intersect line 4-1 Golden Gate lode of this survey at S. 9° 48' W. 512.97 ft. from Cor. No. 4 and 313.62 ft. from the intersection of line 4-1 Golden Gate lode, with West side line, Quaker City lode, unsurveyed.</p>
1096.64	<p>Intersect line 1-2 Golden Gate Lode of this survey at N. 80° 20' W. 56.55 ft. from Cor. No. 1.</p>
1308	To Cor. No. 1, the place of beginning.

Cambridge

Beginning at Cor. No. 1.

On line 2-3 North Star lode of this survey and East side line Quaker City lode, unsurveyed, at N. 39° 45' E. 556.58 ft. and S. 7° 26' E. 209.35 ft. from Cor. No. 2 and the N. E. Cor., respectively.

A pine post, in place, 4 ins. square, 3.5 ft. high, with mound of stone, scribed C-1-3058, whence,

The S. E. Cor. Sec. 1, T. 4 S., R. 29 E., G. & S. R. B&M., bears S. 41° 58' E. 6010.6 ft.

Thence N. 84° 31' W.

111.66 Southwest end center of the location and lode

148.66 To Cor. No. 2.

On line 4-1 Tom H lode of this survey.

A pine post, in place, 4 ins. square, 3.5 ft. high, with mound of stone, scribed C-2-3058, whence,

A cross (X) and B R-2-3058 chiseled on granite rock 3 x 4 ft. facing South bears N. 20° 30' W. 2.9 ft.

U. S. L. M. No. 1576 bears S. 49° 51' W. 4399 ft.

Thence N. 42° 41' E.

188.83 Intersect east side line Quaker City lode, unsurveyed, at S. 7° 26' E. 55.04 ft. from the N. E. Cor.

281.19 To Cor. No. 3.

Identical with Cor. No. 4 Tom H lode of this survey, heretofore described.

On South side line Philadelphia lode, unsurveyed.

Thence S. 84° 31' E.

37 Northeast end center of the location and lode.

131.03 To Cor. No. 4.

On South side line Philadelphia lode unsurveyed, at

Feet	<p>N84°31' W. 400.67 ft. from the S. E. Cor. On line 2-3 North Star lode of this survey at N. 39° 43' E. 827.49 ft. from Cor. No. 2. A pine post, in place, 4 ins. square, 3.5 ft. high, with mound of stone, scribed C-4-3058. No bearings available</p>
270.91	<p style="text-align: center;">Thence S. 39° 43' W.</p> <p>To Cor. No. 1, the place of beginning.</p> <p style="text-align: center;">North Star.</p>
300	<p>Beginning at Cor. No. 1. On East side line Quaker City lode unsurveyed, at S. 7° 26' E. 1027.76 ft. from the N. E. Cor. A pine post, in place, 4 ins. square, 3.5 ft. high, with mound of stone, scribed N. S.-1-3058, whence S.E. Cor. Sec. 1, T. 4 S., R. 29 E., G. & S. R. B. & M., bears S. 46° 56' E. 5356.5 ft.</p>
600	<p style="text-align: center;">Thence N. 50° 17' W.</p> <p>Southwest end center of the location and lode. To Cor. No. 2. A pine post, in place, 4 ins. square, 3.5 ft. high, with mound of stone, scribed N S-2-3058, whence, A cross (X) and B R-2-3058 chiseled on granite rock 3 x 4 ft. facing Northeast bears S. 34° 05' W. 5.7 ft. U. S. L. M. No. 1576, bears S. 52° 48' W. 3960.6 ft.</p>
75	<p style="text-align: center;">Thence N. 39° 43' E.</p>
325	<p>Intersect gulch, course Southeast.</p>
556.58	<p>Wagon road course southwest to northeast. Cor. No. 1, Cambridge lode of this survey, and intersect East side line Quaker City lode unsurveyed at S. 7° 26' E.</p>

Feet 209.35 ft. from N. E. Cor.

827.49 Cor. No. 4 Cambridge lode of this survey and intersect South side line Philadelphia lode unsurveyed at N. 84° 31' W 400.67 ft. from S. E. Cor.

1500 To Cor. No. 3.
A pine post in place, 4 ins. square, 3.5 ft. high, with mound of stone, scribed N S-3-3058.
No bearings available.

Thence S. 50° 17' E.

27.01 Intersect East end line Philadelphia lode unsurveyed at S. 5° 29' W. 59.19 ft. from the N. E. Cor. and N. 5° 29' E. 540.81 ft. from the S. E. Cor.

300 Northeast end center of the location and lode.

600 To Cor. No. 4.
A pine post, in place, 4 ins. square, 3.5 ft. high, with mound of stone, scribed N S-4-3058, whence,
A cross (X) and B R-4-3058 chiseled on quartz porphyry bedrock 2 x 3 ft. facing East bears S. 66° W. 12.5 ft.

Thence S. 39° 43' W.

398 Wagon road, course Northwest to Southeast.

610 Wagon road, course Southwest to Northeast.

840 Intersect gulch, course Southeast.

1500 To Cor. No. 1, the place of beginning.

Golden Gate

Beginning at Cor. No. 1.
A pine post, in place, 4 ins. square, 3.5 ft. high, with mound of stone, scribed G G-1-3058, whence,
A cross (X) and B R-1-3058 chiseled on granite 2 x 6 ft. facing West bears S. 53° 10' W. 11 ft.
The S.E. Cor. Sec. 1, T. 4 S., R. 29 E., G. & S. R. B & M., bears S. 50° 17' E. 6063.6 ft.

Thence N. 80° 20' W.

56.35 Intersect line 4-1 Tom H lode of this survey at N. 42°

Feet 41' E. 211.36 ft. from Cor. No. 1.

371.84 Intersect line 1-2 and 4-1 Tom H and Copper Chief lodes of this survey at S. 38° 50' E. 339.23 ft. and 352.44 ft. from Cor's No's 2 and 4 respectively.

750 South side center of the location.

771.96 Intersect line 4-1 Alice Winifred lode of this survey at N. 42° 41' E. 10.48 ft. from Cor. No.1.

772.55 Intersect line 3-4 Copper Chief lode of this survey at S. 40° 01' W. 270.62 ft. from Cor. No. 4.

787.6 Intersect line 1-2 and 4-1 Alice Winifred and Missing Link lodes of this survey at S. 38° 50' E 591.34 ft. and 597.44 ft. from Cor's No's 2 and 4, respectively.

1466.86 Intersect line 3-4 Missing Link lode of this survey at S. 40° 01' W. 458.75 ft. from Cor. No. 4.

1500 To Cor. No. 2.

A pine post, in place, 4 ins. square, 3.5 ft. high, with mound of stone, scribed G G-2-3058, whence,

A cross (X) and B R-2-3058, chiseled on granite face 15 x 20 ft., facing North bears S. 13° 10' E. 4.1 ft.

U. S. L. M. No. 1576 bears S. 29° 12' W. 2840.7 ft.

Thence N. 9° 48' E.

300 West end center of the location and lode.

315 Intersect gulch, course Southeast.

600 To Cor. No. 3.

A pine post in place, 4 ins. square, 4 ft. high, set with iron pin in bedrock, scribed G G-3-3058, whence,

A cross (X) and B R-3-3058 chiseled on granite 4 x 5 ft. facing Southeast bears N. 43° W. 1.6 ft.

Thence S. 80° 20' E.

403.37 Intersect line 2-3 Alice Winifred lode of this survey at N. 42° 41' E. 248.24 ft. from Cor. No. 2.

750 North side center of the location.

Feet	
1116.53	Intersect line 4-1 and 2-3, Alice Winifred and Tom H lodes of this survey at N. 42° 41' E. 726.04 ft. and 447.49 ft. from Cor's No's 1 and 2 respectively.
1438.21	Intersect West side line Quaker City lode, unsurveyed at S. 7° 26' E. 124.14 ft. from N. W. Cor.
1500	To Cor. No. 4. A pine post, in place, 4 ins. square 3 ft. high, with mound of stone scribed G G-4-3058 No bearings available.
	Thence S. 9° 48' W.
199.35	Intersect West side line Quaker City lode, unsurveyed, at N. 7° 26' W. 1103.3 ft. from the S. W. Cor. and S. 7° 26' E. 332.7 ft. from the N. W. Cor.
250	Intersect wagon road, course Southwest to northeast.
300	East end center of the location and lode.
350	Intersect gulch, course Southeast.
512.97	Intersect line 4-1 Tom H lode of this survey at N. 42° 41' E. 315.15 ft. from Cor. No. 1.
600	To Cor. No. 1, the place of beginning.

Variation at all corners 13°30'E.

LODE LINES

As near as can be determined by present developments the veins of the several locations embraced in this claim extend as follows from their respective discovery points.

Maine lode 47 ft. N. 61° 56' E. and 1348.5 ft. S. 61° 56' W.

Olivette lode 56.5 ft. N. 59° 18' E. and 1443.5 ft. S. 59° 18' W.

Maine Fraction lode, 925 ft. N. 59° 18' E.

Tony lode, 13 ft. N. 85° 30' E. and 1304 ft. S. 85° 30' W.

F

Fraction lode, 616 ft. N. 52° 30' E. and 836 ft. S. 52° 30' W.

Hidden View lode, 550 ft. N. 52° 30' E. and 790 ft. S. 52° 30' W.

Copper Chief lode, 400 ft. N. 40° 01' E. and 1099.5 ft. S. 40° 01' W.

Missing Link lode, 1225.5 ft. S. 40° 01' W.

Alice Winifred lode, 2 ft. S. 42° 41' W. and 1498 ft. N. 42° 41' E.

Tom H lode, 380 ft. N. 42° 41' E and 928 ft. S. 42° 41' W.

Cambridge lode, 10 ft. N. 42° 41' E. and 271.19 ft. S. 42° 41' W.

North Star lode, 800 ft. N. 39° 43' E. and 700 ft. S. 39° 43' W.

Golden Gate lode, 150 ft. N. 80° 20' W. and 1350 ft. S. 80° 20' E.

A R E A S.

Acres

Total area Maine lode 19.213

Area in conflict with-

Olivette lode of this survey--0.176

Tony lode of this survey-----6.550.

Monte Carlo lode Sur.No.1584--0.049

Total area Olivette lode 20.644

Area in conflict with-

Monte Carlo lode Sur. No. 1584-----0.190

Copper Bullion lode Sur.No. 1576---0.187

Fraction lode of this survey-----0.000+

Total area Maine Fraction lode 12.625

Area in conflict with-

Monte Carlo lode Sur. No. 1584----8.859

Copper Verde lode Sur. No. 1584---0.979

Tony lode of this survey-----2.533

	Acres
Total area Tony lode-----	18.140
Total area Fraction lode-----	20.000
Area in conflict with-	
Monte Carlo lode Survey No. 1584-----	0.162
Copper Verde lode Sur. No. 1584-----	4.954
Total area Hidden View lode-----	18.457
Area in conflict with-	
Missing Link lode of this survey-----	0.000 ⁺
x Total area Copper Chief lode	20.653
Area in conflict with-	
Golden Gate lode of this survey-----	1.074
Golden Gate lode of this survey (.042 acs) (exclusive of its conflict with	
Alice Winifred lode of this survey)---	1.032
Alice Winifred lode of this survey---	0.042
x Total area Missing Link lode-----	16.857
Area in conflict with-	
Golden Gate lode of this survey-----	3.087
Solid Copper lode Sur. No. 1576-----	0.103
x Total area Alice Winifred lode -----	20.592
Area in conflict with-	
Golden Gate lode of this survey-----	6.686
Philadelphia lode unsurveyed-----	4.999
Golden Gate lode of this survey (.042) (exclusive of its conflict with	
Copper Chief lode of this survey)---	6.644
x Total area Tom H lode	18.018
Area in conflict with-	
Golden Gate lode of this survey-----	6.869
Golden Gate lode of this survey (.171 acs) (exclusive of its conflict with	
Quaker City lode, unsurveyed)-----	6.728

	Acres
Quaker City lode unsurveyed-----	4.211
Philadelphia lode unsurveyed-----	3.754
Total area Cambridge lode-----	0.719
Area in conflict with-	
Quaker City lode, unsurveyed -----	0.257
Total area North Star lode -----	20.661
Area in conflict with-	
Quaker City lode, unsurveyed-----	3.833
Philadelphia lode, unsurveyed-----	2.696
Total area Golden Gate lode -----	20.661
Area in conflict with-	
Quaker City lode, unsurveyed-----	0.141

L O C A T I O N .

This survey is located in Sec. 1, surveyed, Secs. 2 and 11 unsurveyed, T. 4 S., R. 29 E. and Sec. 36, T. 3 S., R. 29 E., Unsurveyed, G. & S. R. B. & M., Greenlee Gold Mountain Mining District, Greenlee County, Arizona.

A D J O I N I N G L O D E S .

The adjoining lodes, to this claim, are on the North the Nevada, Euclaire, Consolidate No. 1, lodes, unsurveyed, Copper Bullion, Solid Copper lodes, Sur. No. 1576, Consolidate No. 2 and Summit No. 1 lodes unsurveyed, claimant herein, on the East the Philadelphia lode, unsurveyed Geo. Williams claimant, on the South, Keystone and Quaker City lodes unsurveyed, Geo. Williams claimant, Fire Fly lode unsurveyed, claimant unknown, Copper Verde, Monte Carlo lodes Sur. No. 1584, Boston No. 1, Boston No. 3 and Triangulate No. 2 lodes unsur., claimant herein, on the West the New Jersey lode unsurveyed, claimant herein

EXPENDITURE OF FIVE HUNDRED DOLLARS.

I hereby certify that the value of the labor and improvements made upon and for the benefit of each of the lodes embraced in said mining claims by the claimant or its grantors is not less than Five Hundred Dollars, and that said improvements consist of:

Maine

No. 1. The discovery of the Maine lode showing mineral in place, is on the lode line 47 ft. from line 4-1.

No. 2. A tunnel, the mouth of which bears from the Northeast end center,

S 52° 10' W. 216 ft. 6 x 7 ft. running S. 49° W. 54 ft.

Value \$540.00

Note: An undivided 1/42 interest in the No. 2 tunnel on the Golden Gate lode is accredited to this lode.

Value 1/42 interest \$1710.00

Note: An undivided 1/42 interest in this working is accredited to each of the forty-two lodes that comprise the Copper King group as hereinafter explained.

Olivette

No. 1. The discovery shaft of the Olivette lode showing mineral in place is on the lode line 56.5 ft. from line 4-1, 4 x 6 ft., 185. ft. deep.

Value \$1850.00

Note: An undivided 1/42 interest in the No. 2 tunnel on the Golden Gate lode is accredited to this lode.

Value 1/42 interest \$1710.00

Maine Fraction

No. 1. The discovery of the Maine Fraction lode showing mineral in place is at the Southwest end center of the lode.

No. 2. A shaft, the center of which bears from Cor. No. 3 S. 44° E. 118 ft., 4 x 6 ft. 25 ft. deep.

Value \$250

No. 3. A tunnel the mouth of which bears from Cor. No 2, N. 26° 45' E. 313 ft., 5 x 7 ft., running N. 30° E 20 ft.

Value \$200.00

Note: The last 10 ft. of the No 2 tunnel of the Tony lode is on this lode and is hereto accredited.

Value of the last 10 ft. \$200.00

Note: An undivided 1/42 interest in the No.2 tunnel on the Golden Gate lode is accredited to this lode.

Value 1/42 interest \$1710.00

Tony

No. 1. The discovery of the Tony lode showing mineral in place is on the lode line 13 ft. from line 4-1.

No. 2. A tunnel the mouth of which bears from Cor. No. 1, N. 60° 35' W. 558 ft., 7x7 ft. running N. 11° E. 100 ft.

Value of first 90 ft. \$1800.00

Note: The last 10 ft. of this tunnel is on the Maine Fraction lode and is accredited thereto.

Note and undivided 1/42 interest in the No. 2 tunnel on the Golden Gate lode is accredited to this lode.

Value 1/42 interest \$1710.00

Fraction

No. 1. The discovery, of the Fraction lode, showing mineral in place is on the lode line 616 ft. from line 4-1.

No. 2. A tunnel, the mouth of which bears from Cor. No. 4, S. 6° E. 148 ft. 4 x 6 ft. running N. 40° E. 13 ft. thence N. 72° E. 37 ft., thence N. 89° E. 45 ft.

Value \$950.00

Note: An undivided 1/42 interest in the No. 2 tunnel on the Golden Gate lode is accredited to this lode.

Value 1/42 interest \$1710.00

Hidden View.

No. 1. The discovery showing mineral in place is on the lode line 550 ft. from line 4-1

No. 2. A tunnel the mouth of the open cut approach to, bears from Cor. No.3, N. 55° E. 878 ft., 12 ft. open cut 4 x 10 ft. and 4 x 6' tunnel running N.45° E. 16 ft.

Value \$280.00

Note: An undivided 1/42 interest in the No. 2 tunnel on the Golden Gate lode is accredited to this lode.

Value 1/42 interest \$1710.00

Copper Chief.

No. 1. The discovery showing mineral in place is on the lode line 400 ft. from line 4-1

No. 2. A shaft, the center of which bears from the S. W. end center N. 9° 30' E. 205 ft. 4x6 ft. 8 ft. deep.

Value \$80.00

Note: An undivided 1/42 interest in the No. 2 tunnel on the Golden Gate lode is accredited to this lode.

Value 1/42 interest \$1710.00

Missing Link.

No. 1. The discovery showing mineral in place is on the lode line 1225.5 ft. from line 2-3.

No. 2. A tunnel the mouth of which bears from Cor. No. 2, N. 18° 40' E. 440 ft., 4 x 6 ft. running N. 24° W. 24 ft., thence N. 71° W. 13 ft.

Value \$370.00

Note: An undivided 1/42 interest in the No. 2 tunnel on the Golden Gate lode is accredited to this lode.

Value 1/42 interest \$1710.00

Alice Winifred.

No. 1. The discovery showing mineral in place is on the lode line 2 ft. from line 1-2

No. 2. A tunnel the mouth of which bears from Cor. No. 2, S. 84° 25' E. 505 ft., 4 x 6 ft., running N. 15° E. 46 ft., thence N. 34° E. 31 ft., thence N. 14° E. 19 ft.

Value \$960.00

Note: An undivided 1/42 interest in the No 2 tunnel on the Golden Gate lode is accredited to this lode.

Value 1/42 interest \$1710.00

Tom H.

No. 1. The discovery showing mineral in place is on the lode line 386 ft. from line 3-4.

No. 2. An open cut the mouth of which bears from Cor. No. 4. N. 89° 20' W. 780 ft., 6 x 14 ft. running N. 12° W. 25 ft.

Value \$200.00

Note: An undivided 1/42 interest in the No. 2 tunnel on the Golden Gate lode is accredited to this lode.

Value 1/42 interest \$1710.00

Cambridge.

No. 1. The discovery shaft, the center of which is on the lode line 10 ft. from line 3-4, 4x6 ft., 55 ft. deep.

Value \$550.00

North Star.

No. 1. The discovery showing mineral in place is on the lode line 700 ft. from line 1-2.

No. 2. A tunnel the mouth of which bears from Cor. No. 1 N. 6° 10' E. 630 ft. 4 x 6 ft. running N. 69° W. 46 ft.

Value \$460.00

No. 3. A tunnel the mouth of which bears from Cor. No. 1, N. 28° 50' E. 728 ft. 4 x 6 running N. 10° W. 61. ft.

Value \$610.00

Golden Gate.

No. 1. The discovery showing mineral in place is on the

lode line 150 ft. from line 2-3.

No. 2. A tunnel the mouth of which bears from Cor. No. 1, N. 53° 12' W. 295 ft. 7 x 8 ft., running N. 70° 18' W. 600 ft., thence S. 52° 13' W. 835 ft., thence S. 42° 36' W. 100 ft., thence S. 17° 34' W. 91 ft., thence S. 6° 36' W. 266 ft. Beginning at a point in the above tunnel 1435 ft. from the mouth, a 5x6^{ft.} tunnel running S. 73° 08' W. 102.5 ft., thence S. 52° 40' W. 458 ft., thence S. 25° 30' W. 145 ft., thence S. 68° 20' W. 66.5 ft., thence S. 58° 55' W. 163.3 ft., thence S. 62° 48' W. 210.6 ft., thence S. 65° 28' W. 225 ft., thence S. 50° 42' W. 177.4 ft. thence S. 55° 17' W. 95 ft.; value \$71820.00

Value 1/42 interest \$1710.00

Note: An undivided 1/42 interest in this working is accredited to forty-two lodes as hereinafter explained.

This claim lies on the Southeastern slope of the Copper King Mountain, about a mile and one half from San Francisco River. It is a part of the Copper King Group, claimant herein, which comprises 44 lodes, viz: North Star, Cambridge, Tom H, Alice Winifred, Golden Gate, Copper Chief, Missing Link, Summit No. 1, Summit No. 2, Summit No. 3, Mt. Vernon No. 1, Consolidate No. 3, Consolidate No. 2, Solid Copper, Hidden View, Fraction, Copper Bullion, Consolidate No. 1, Consolidate No. 4, Mt. Vernon No. 2, Mt. Vernon No. 3, Virginia, Euclaire, Olivette, Monte Carlo, Maine Fraction, Copper Verde, Tony, Boston No. 1, Boston No. 2, Boston No. 3, Boston No. 4, Boston No. 5, Boston No. 6, Boston No. 7, Boston No. 8, Boston No. 9, Triangulate No. 2, Maine, New Jersey, Nevada, High View, Green Tree, and Eclipse. The accompanying map marked contour map Sur. No. 3058, (contours were taken from the U. S. G. S. topographic sheet), which is a part of these field notes, shows that all of the lodes are higher than the No. 2 Tunnel on the Golden Gate lode, except the Cambridge and North Star lodes, so 42 of these lodes can be worked advantageously from said tunnel as they can be

cut at depths from it, and the means of egress from this group is via the wagon road, shown on plat, to the San Francisco River, thence to Clifton, via the San Francisco R. R. which has a 20 inch gauge, and was constructed to transport the ore from this group. This tunnel is conveniently located for a main working tunnel to develop the 42 lodes to which I have credited it.

O T H E R I M P R O V E M E N T S.

A frame boarding house, the Southeast corner of which bears from Cor. No. 2 Maine Fraction lode N. $1^{\circ} 10'$ W. 135 ft., 32 x 36 ft., course of long sides N. 32° W.

A corrugated iron house, the Northeast corner of which bears from Cor. No. 4 Golden Gate lode S. $34^{\circ} 50'$ W. 350 ft. Beginning at said corner and going clockwise its dimensions are 61, 20, 47, 4, 14, and 16 ft. Course of the long sides N. $42^{\circ} 30'$ E.

A frame house, the Northeast corner of which bears from Cor. No. 4 Golden Gate lode, S. $25^{\circ} 15'$ W. 318 ft. 12 x 44 ft. Course of long sides N. 81° E.

A frame boarding house, the Northeast corner of which bears from Cor. No. 4 Golden Gate lode, S. $20^{\circ} 30'$ W. 510 ft. 15 x 44 ft. Course of long sides S. 7° E.

A corrugated iron boiler house, the Northeast corner of which bears from Cor. No. 4 Golden Gate lode S. $17^{\circ} 05'$ W. 415 ft. Beginning at said corner and going clockwise, its dimensions are 13, 66, 25, 51, 12 and 15 ft. Course of long side N. 68° W.

A frame house the Northwest corner of which bears from Cor. No. 4 Golden Gate lode S. $12^{\circ} 35'$ W. 440 ft. 12 x 12 ft. Course of long side S. 49° E.

A corrugated iron house, the Northwest Corner of which bears from Cor. No. 4 Golden Gate lode S. $50^{\circ} 4'$ W. 427 ft. 16 x 16 ft. Course of long side N. 80° E.

A corrugated iron house, the Northwest corner of which bears from Cor. No. 4 Golden Gate lode S. $31^{\circ} 50'$ W. 470 ft., 12 x 14 ft. course of long sides S. 44° E.

A frame house, the Southeast corner of which bears from Cor. No. 1 North Star lode N.31°40'E. 656 ft. Beginning at said corner and going clockwise its dimensions are 14,20,10,67,24 and 87 ft. Course of long side N.39°E.

I N S T R U M E N T.

This survey was made with a Buff and Berger light mountain mining transit. The courses were deflected from the true meridian as determined by Polaris' observations. The distances were measured with 500 ft. 50 ft. and 5 ft. steel tapes.

R E P O R T.

The S. E. Cor. Sec. 1, T. 4. S, R. 29E. G & S. R. B. & M., is a pine post 4 ins. square properly set and scribed.

U. S. L. M. No. 1576 is a pine post about 7 ft. high properly set and scribed.

All corners of Sur. No. 1576, Solid Copper and Copper Bullion lodes are pine posts, 4 ins. square, properly set and scribed.

All corners Sur. No. 1584 Monte Carlo and Copper Verde lodes are pine posts 4 ins. square, properly set and scribed, except Cor. No. 6 Monte Carlo lode, which is a stone properly set and scribed.

All end center monuments are mounds of stone.

The side center monuments of the Golden Gate lode are mounds of stone.

The ^{re are no} side centers of the Copper Chief lode on the ground.

The differences between the field notes and the location certificates are due to errors in the latter.

The differences between these field notes and the returns of Sur. No. 1576 Solid Copper and Copper Bullion are due to errors in the latter.

The differences between these field notes and the returns on Sur. No. 1584, Monte Carlo and Copper Verde lodes are due to errors in the latter.

These field notes are identical with the respective locations as staked on the ground.

The nearest corner of the public survey to this claim is the S. E. Cor. Sec. 1, which is the only standing corner of said section.

E. T. Morrow
U. S. M. & S. R. B. & M.

FINAL OATHS FOR SURVEYS.

LIST OF NAMES.

JUN. 9- 1913

A list of the names of the individuals employed by E. T. Morton

United States Mineral Surveyor, to assist in running, measuring, and marking the lines, corners, and boundaries described in the foregoing field notes of the survey of the mining claim of

The Detroit Copper Mining Company of Arizona

known as the Maine, Olivette, Maine Fraction, Tony, Fraction, Hidden View, Missing Link, Copper Chief, Alice Winifred, Tom H, Cambridge, North Star, Golden Gate and showing the respective capacities in which they acted.

J. L. Awalt, *Chainman.*

Chainman.

Arman.

Flagman.

FINAL OATHS OF ASSISTANTS.

We, I, J. L. Awalt

-and-

do solemnly swear that ^I~~we~~ assisted

E. T. Morton

United States Mineral Surveyor, in marking the corners and surveying

the boundaries of the mining claim of The Detroit Copper Mining Company of Arizona

known as the Maine, Olivette, Maine Fraction, Tony, Fraction, Hidden View, Missing Link, Copper Chief, Alice Winifred, Tom H, Cambridge, North Star, Golden Gate represented in the foregoing field notes as having been surveyed by said mineral surveyor and under his

direction; and that said survey has been in all respects, to the best of ^{my}~~our~~ knowledge and belief, faithfully

and correctly executed, and the corner and boundary monuments established according to law and the instruc-

tions furnished by the United States Surveyor-General for Arizona

J L Awalt, *Chainman.*

Chainman.

Arman.

Flagman.

Subscribed and sworn to by the above-named persons before me this 7th

day of June, 1913

My commission expires

June 3, 1916.

[Signature]
Notary Public

FINAL OATH OF U. S. DEPUTY MINERAL SURVEYOR

I, E. T. Morton, U. S. Deputy Mineral Surveyor, do solemnly swear that, in pursuance of instructions received from the United States Surveyor General for Arizona, dated March 20, 1913, I have, in strict conformity to the laws of the United States, the official regulations and instructions thereunder, and the instructions of said Surveyor General, faithfully and correctly executed the survey of the Mining Claim of The Detroit Copper Mining Company of Arizona known as the Maine, Olivette, Maine Fraction, Tony, Fraction, Hidden View, Missing Link, Copper Chief, Alice Winifred, Tom H. Cambridge, North Star, Golden Gate situate in Greenlee Gold Mountain Mining District, Greenlee County, Arizona, in ~~Section~~ Section 1, surveyed, Secs. 2 and 11 unsurveyed, T. 4 S., R. 29 E., and Section 36, Township No. 3 S., Range No. 29 E. unsurveyed, G. & S. R. B & M. and designated as Survey No. 3058, as represented in the foregoing field notes, which accurately show the boundaries of said mining claim as distinctly marked by monuments on the ground, and described in the attached copy of the location certificate, which was received by me from the Surveyor General with said instructions, and that all the corners of said survey have been established and perpetuated in strict accordance with the law, official regulations and instructions thereunder; and I do further solemnly swear that the foregoing are the true and original field notes of said survey and my report therein, and that the labor expended and improvements made upon said mining claim by claimant or its grantors are as therein fully stated, and that the character, extent, location and itemized value thereof are specified therein with particularity and full detail, and that no portion of said labor or improvements so credited to this claim has been included in the estimate of expenditures upon any other claim.

E. T. Morton
U. S. Deputy Mineral Surveyor.

Subscribed and sworn to by the said E. T. Morton
U. S. Deputy Mineral Surveyor, before me 29th
H. S. Bradford, Notary Public this 29th
day of May, 1913

H. S. Bradford
Notary Public

My commission expires Feb 19-1916

MAR 20 1913

Amended Location Notice

NOTICE IS HEREBY GIVEN THAT THE UNDERSIGNED

The Detroit Copper Mining Company of Arizona

a corporation, the assignee of Leopold Balback

who on the 1st day of April 1892, ~~19~~, located the Maines

mining claim situated in the ^{Greenlee Gold Mountain} Mining District, ^{Greenlee} Graham County, Arizona, ^{NOW GREENLEE Co.} the location notice of which claim is of record in the office of the Recorder of said ^{GREENLEE} County in Book 4 TRANSCRIBED, Record of Mines, page 71

, has on this 3rd day of March, 1913, made an amended location of said claim, by virtue of which

and of said original location, it claims as a mining claim the following described lead, lode or vein of mineral bearing earth, rock or quartz and premises situated in the Greenlee Gold Mountain Mining District, in the County of Greenlee Arizona, to-wit:

The name of said claim is the MAINE Mining Claim. The name of the locator is The Detroit Copper Mining Company of Arizona

The length of the claim along said vein or lode is 1395.5 feet; the width of said claim is 300 feet on each side of the middle of said lead, lode or vein. The general course of said lode and claim is Northeast to Southwest. The distance from the Point of Discovery to the Northeast end center monument of said claim is 47 feet. The distance from said Point of Discovery to the Southwest end center monument is 1348.5 feet.

This Location Notice is posted in the monument of stones erected at said Point of Discovery upon said claim, which monument is hereinafter referred to as the Location Monument.

Said claim is bounded and described as follows, to-wit: Beginning at the monument of stones placed at the center of the Northeast end of the claim, which monument is 47 feet Northeasterly from said Location Monument; thence S. 38° 50' E. 305.24 feet to a pine post, being the Southeast corner of the claim, thence S. 61° 56' W. 1395.5 feet to a pine post, being the Southwest corner of the claim; thence N. 38° 50' W. 305.24 feet, to a monument of stones, being the center of the S.W. end of the claim; thence again N. 38° 50' W. 305.24 feet to a pine post, being the Northwest corner of the claim; thence N. 61° 56' E. 1395.5 feet to a pine post, being the Northeast corner of the claim; thence S. 38° 50' E. 305.24 feet to the place of beginning.

To more fully identify the claim its general location is described as follows:

From the Southeast corner of this claim U.S. Mineral Monument No. 1584 bears N. 46° 43' E. 1801.5 Feet.

amended and posted on the ground this 3rd day of

The Detroit Copper Mining Co. of Arizona.

Witness
March 1913
Frank B. Rathbun

M. J. Houston
General Manager

I, _____, County Recorder in and for the County and Territory aforesaid, do hereby certify that the within instrument was filed for record at _____ o'clock, _____ M., on this _____ day of _____ 19____, and duly recorded in Book No. _____ of _____ Records of _____ County, Arizona, at pages _____

WITNESS my hand and official seal the day and year first above written.

County Recorder

160 B MAR 20 1913
"Maine"

Amended Location
Notice

The Detroit Copper Mining
Co. of Arizona

Dated March 8 1913

Filed and recorded at request of

R. J. M. R.

Mar. 14th A. D. 1913

at Prescott P. M.

Book # McSpanton Notes

Pages # 670

R. E. Steen

County Recorder

By R. A. Cady
Deputy Recorder

Amended Location Notice

MAR. 20. 1913

NOTICE IS HEREBY GIVEN THAT THE UNDERSIGNED
The Detroit Copper Mining Company of Arizona

a corporation, the assignee of *Charles F. Whiteher*

who on the *6th* day of *April*, 1901, located the *Olivette*

mining claim situated in the *Greenlee Gold Mountain* Mining District, *Graham*
Now Greenlee Co. County, Arizona, the location notice of which claim is of record in the office of the Recorder of said
County in Book *5* Transcribed, Record of Mines, page *87*, has on this *3rd* day of

March, 1913, made an amended location of said claim, by virtue of which
and of said original location, it claims as a mining claim the following described lead, lode or vein of
mineral bearing earth, rock or quartz and premises situated in the *Greenlee Gold Mountain*
Mining District, in the County of *Greenlee* Arizona, to-wit:

The name of said claim is the *OLIVETTE* Mining Claim. The name of
the locator is *The Detroit Copper Mining Company of*
Arizona

The length of the claim along said vein or lode is *1500* feet; the width of said claim is *300*
feet on each side of the middle of said lead, lode or vein. The general course of said lode and claim
is *Northeast* to *Southwest*. The distance from the Point of Discovery to
the *Northeast* end center monument of said claim is *56.5* feet. The distance from said
Point of Discovery to the *Southwest* end center monument is *1443.5* feet.

This Location Notice is posted in the monument of stones erected at said Point of Discovery upon
said claim, which monument is hereinafter referred to as the Location Monument.

Said claim is bounded and described as follows, to-wit: Beginning at the monument of stones
placed at the center of the *Northeast* end of the claim, which monument is *56.5* feet
Northeasterly from said Location Monument; thence *S. 38° 20' E* *302.45*
feet to a *pine post*, being the *Southeast* corner of the claim, thence *S. 59° 19' W*
1500 feet to a *pine post*, being the *Southwest* corner of the claim; thence
N. 38° 20' W *302.45* feet, to a monument of stones, being the center of the *S.W.* end of the
claim; thence again *N. 38° 20' W* *302.45* feet to a *pine post*, being
the *Northwest* corner of the claim; thence *N. 59° 19' E* *1500*
feet to a *pine post*, being the *Northeast* corner of the claim; thence *S. 38° 20' E*
302.45 feet to the place of beginning.

To more fully identify the claim its general location is described as follows: — From
The Southeast corner of this claim U.S. Mineral
monument No. 1584 bears N. 72° 16' E. 943.6 feet.

amended and posted on the ground

this *3rd* day of

March 1913

The Detroit Copper Mining Co. of Arizona.

M. J. Thomson
General Manager

Witness
Frank D. Rathbun

I, -----, County Recorder in and for the County and Territory aforesaid, do hereby certify that the within instrument was filed for record at ----- o'clock, ----- M., on this ----- day of ----- 19-----, and duly recorded in Book No. ----- of ----- Records of ----- County, Arizona, at pages -----

WITNESS my hand and official seal the day and year first above written.

County Recorder

1601 MAR. 20. 1913

Clivette

Amended Location
Notice

The Detroit-Copper Mining

Co. of Arizona

Dated March 3 1913

Filed and recorded at request of

H. O. M. Co.

March 4th A. D. 1913

at Prescott P.M.

Book #1102

Pages 4668

J. E. Kelly

County Recorder.

By H. A. Ramsey
Deputy Recorder.

MAR 20 1913

Amended Location Notice

NOTICE IS HEREBY GIVEN THAT THE UNDERSIGNED

The Detroit Copper Mining Company of Arizona

a corporation, the assignee of *The Mariken Copper Co.*

who on the *8th* day of *February*, 1899, located the *Maine Fractional*

mining claim situated in the *Greenlee Gold Mountain* Mining District, *Graham* County, Arizona, the location notice of which claim is of record in the office of the Recorder of said County in Book 4 *TRANSCRIBED*, Record of Mines, page *141*, has on this *3rd* day of

March, 1913, made an amended location of said claim, by virtue of which and of said original location, it claims as a mining claim the following described lead, lode or vein of mineral bearing earth, rock or quartz and premises situated in the *Greenlee Gold Mountain* Mining District, in the County of *Greenlee* Arizona, to-wit:

The name of said claim is the *MAINE FRACTION* Mining Claim. The name of the locator is *The Detroit Copper Mining Company of Arizona*

The length of the claim along said vein or lode is *925* feet; the width of said claim is *300* feet on each side of the middle of said lead, lode or vein. The general course of said lode and claim is *Northeast* to *Southwest*. The distance from the Point of Discovery to the *SW* end center monument of said claim is *0* feet. The distance from said Point of Discovery to the *NE* end center monument is *925* feet.

This Location Notice is posted in the monument of stones erected at said Point of Discovery upon said claim, which monument is hereinafter referred to as the Location Monument.

Said claim is bounded and described as follows, to-wit: Beginning at the monument of stones placed at the center of the *Southwest* end of the claim, which monument is *at* feet from said Location Monument; thence *N. 38° 50' W.* *303.07* feet to a *pine post*, being the *Northwest* corner of the claim, thence *N. 59° 19' E.* *925* feet to a *pine post*, being the *Northeast* corner of the claim; thence *S. 38° 50' E.* *303.07* feet, to a monument of stones, being the center of the *NE* end of the claim; thence again *S. 38° 50' E.* *297.09* feet to a *pine post*, being the *Southeast* corner of the claim; thence *S. 58° 37' W.* *923.5* feet to a *pine post*, being the *Southwest* corner of the claim; thence *N. 38° 50' W.* *303.07* feet to the place of beginning.

To more fully identify the claim its general location is described as follows:

From the Southeast corner of this claim U.S. Mineral Monument No. 1584 bears N. 35° E. 916.6 feet.

amended and posted on the ground this *3rd* day of *March* 1913

The Detroit Copper Mining Co. of Arizona.

W. J. Morrison
General Manager

Witness
Frank D. Rathbun

I, _____, County Recorder in and for the County and Territory aforesaid, do hereby certify that the within instrument was filed for record at _____ o'clock, _____ M., on this _____ day of _____ 19____, and duly recorded in Book No. _____ of _____ Records of _____ County, Arizona, at pages _____

WITNESS my hand and official seal the day and year first above written.

County Recorder

1607
MAR 20 1913

Maine Fraction

**Amended Location
Notice**

The Detroit Copper

Ming Co. of Arizona

Dated March 3 1913

Filed and recorded at request of

A. E. M. Co.

March 14 A. D. 1913

at Prescott P. M.

Book # 9 Section 11

Pages # 669

H. E. Kelly
County Recorder.

By H. A. Kelly
Deputy Recorder.

Amended Location Notice

MAR 20 1913

37

NOTICE IS HEREBY GIVEN THAT THE UNDERSIGNED
The Detroit Copper Mining Company of Arizona

a corporation, the assignee of *E. Fry and H. G. Rice*

who on the *9th* day of *April 1898*, ~~is~~, located the *Tony*

mining claim situated in the *Greenlee Gold Mountain* Mining District, *Graham*
~~now Greenlee Co~~ County, *Arizona*, the location notice of which claim is of record in the office of the Recorder of said
County in Book *4 Transcribed*, Record of Mines, page *70*, has on this *3rd* day of

March, 191*3*, made an amended location of said claim, by virtue of which
and of said original location, it claims as a mining claim the following described lead, lode or vein of
mineral bearing earth, rock or quartz and premises situated in the *Greenlee Gold Mountain*
Mining District, in the County of *Greenlee* Arizona, to-wit:

The name of said claim is the *TONY* Mining Claim. The name of
the locator is *The Detroit Copper Mining Company*
of Arizona

The length of the claim along said vein or lode is *1316.3* feet; the width of said claim is *300*
feet on each side of the middle of said lead, lode or vein. The general course of said lode and claim
is *Easterly* to *Westerly*. The distance from the Point of Discovery to
the *East* end center monument of said claim is *17* feet. The distance from said
Point of Discovery to the *West* end center monument is *1303.3* feet.

This Location Notice is posted in the monument of stones erected at said Point of Discovery upon
said claim, which monument is hereinafter referred to as the Location Monument.

Said claim is bounded and described as follows, to-wit: Beginning at the monument of stones
placed at the center of the *East* end of the claim, which monument is *17* feet
Easterly from said Location Monument; thence *S. 4° 19' E* *300*
feet to a *pine post*, being the *Southeast* corner of the claim, thence *S. 85° 31' W*
1316.3 feet to a *pine post*, being the *Southwest* corner of the claim; thence
N. 4° 19' W *300* feet, to a monument of stones, being the center of the *West* end of the
claim; thence again *N. 4° 19' W* *300* feet to a *pine post*, being
the *Northwest* corner of the claim; thence *N. 85° 31' E* *1316.3*
feet to a *pine post*, being the *Northeast* corner of the claim; thence *S. 4° 19' E*
300 feet to the place of beginning.

To more fully identify the claim its general location is described as follows:

From the Northeast corner of this claim U. S.
Mineral Monument No. 1584 bears N. 38° 55' E, 1151.8 feet.

amended and posted on the ground

this *3rd* day of

March 191*3*

Witness
Frank D. Rattigan

The Detroit Copper Mining Co. of Arizona

N. J. Johnson
General Manager

I,, County Recorder in and for the County and Territory aforesaid, do hereby certify that the within instrument was filed for record at o'clock, M., on this day of 19....., and duly recorded in Book No. of Records of County, Arizona, at pages

WITNESS my hand and official seal the day and year first above written.

..... County Recorder

#1600
"Gony"

MAR 20 1913

Amended Location
Notice

The Detroit Copper Mining
Co. of Arizona

Dated March 3 1913

Filed and recorded at request of

A. C. M. Co.
Miner
at Prescott P. M.

Book # 2 Mountain View

Pages # 667 & 668

W. E. Kelley
County Recorder.

By A. P. Hayden
Deputy Recorder.

MAR. 20. 1913

STATE OF ARIZONA,)
(SS.
COUNTY OF GRAHAM.)

I, D. H. Claridge County Recorder in and for the County of Graham, State of Arizona, do hereby certify that the within and following, is a true, full, and complete copy of the within mentioned Location Notice of the "FRACTION", Mine as the same appears of record in my office, in Book 15, of Record of Mines, at page 516.

IN WITNESS WHEREOF, I have hereunto set my hand and seal of office, this

27th day of July A. D. ~~1912~~ 1912

D. H. Claridge
County Recorder.



AMENDED NOTICE OF MINING LOCATION.

LODE CLAIM.

--0--

TO ALL WHOM IT MAY CONCERN: This mining claim, the name of which is the Fraction Mining Claim, situated on lands belonging to the United States of America, and in which there are valuable mineral deposits, was entered upon and located for the purpose of exploration and purchase by Nicholas Cole of Clifton, Arizona, a citizen of the United States, on the 4th day of December, 1897.

The length of this claim is 1451.47 feet, and we claim 616.15 feet in a north easterly direction, and 835.32 feet in a South Easterly direction from the center of the discovery cut at which this notice is posted, lengthwise of the claim, together with 300 feet in width of the surface grounds, on each side of the center of said claim. The general course of the lode deposit and premises is from the North east to the South weste

The claim is situated and located in the Greenlee Gold Mountain Mining District, in Graham County, in the Territory of Arizona, U. S. L. M. No. 1576 bears from the North west corner S. 22° 36' W. 649.9 ft. The discovery cut where this notice is posted bears from the North west, corner S. 45° 36' W. 618.9 ft.

The surface boundaries of the claim are marked upon the ground as follows: Beginning at a Monument of stone being in the center of the North east end line of said claim; thence N. 35° 50' W. 300.08 feet to a 3" x 3" Pine Post being the North west corner of said claim; thence S. 52° 30' W. 1451.47 feet to a 4" x 4" Pine Post being at the South west corner of said claim; thence S. 38° 50' E. 300.08 feet to a Monument of stone being the center of the South west end of said claim; thence S. 38° 50' E. 300.08 feet to a 4" x 4" Pine Post, being at the Southeast corner of said claim; thence N. 52° 30' E. 1451.47 feet to a 4" x 3" Pine Post at the North east corner of said claim; thence N. 38° 50' W. 300.08 feet to the place of beginning.

All done under the provisions of Chapter Six, of Title XXXII, of the Revised Statutes of the United States, and of an Act of the General Assembly of Arizona, entitled "An Act to Revise and Codify the Laws of the Territory of Arizona," approved March 16th, 1901.

This is an amended Location Notice of the Fraction Mining Claim, located by Nicholas Cole of Clifton, Arizona, a citizen of the United States on the 4th day of December, 1897 and recorded in Book 9 of Record of Mines at page 475 in the office of the County Recorder of the aforesaid County of Graham, to which reference is hereby made.

Dated and posted on the ground this 28th day of March, 1903.

L. A. Dunham)
) (Trustees.
Richard Hecksher)

Filed and recorded at request of Jno R. Hampton, April 4, 1903, at 1 P. M.

Mit Simms,
County Recorder.

MAR. 20. 1913

THE STATE OF ARIZONA,)
) (SS.
COUNTY OF GRAHAM.)

I, D. H. Claridge, County Recorder in and for the County of Graham, State of Arizona, do hereby certify that the within and following, is a true, full, and complete copy of the within mentioned Location Notice of the "HIDDEN VIEW", as the same appears of record in my office, in Book 15 of Record of Mines, at page 515.

IN WITNESS WHEREOF, I have hereunto set my hand and seal of office, this 27th day of July A^d D. 1912.
D. H. Claridge
County Recorder.

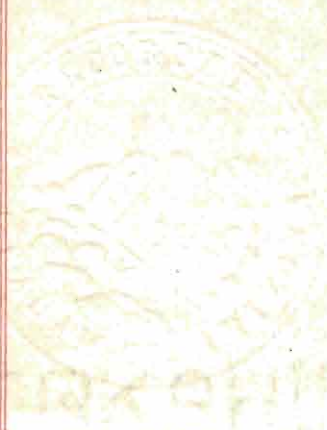

AMENDED NOTICE OF MINING LOCATION.

LODE CLAIM .

TO ALL WHOM IT MAY CONCERN: That this mining claim, the name of which is the Hidden View Mining Claim, situate on land belonging to the United States of America, and in which there are valuable mineral deposits, was entered upon and located for the purpose of exploration and purchase by H. G. Rice and E. E. Frye of Clifton, Arizona, citizens of the United States on the 28th day of March, 1890.

The length of this claim is 1338.85 feet and we claim 550.08 feet in a North easterly direction, and 788.8 feet in a South westerly direction from the center of the discovery shaft, at which this notice is posted, lengthwise of the claim, together with 300 feet in width of the surface grounds, on each side of the center of said claim. The general course of the lode deposit and premises is from the North east to the South west.

The claim is situated and located in the Greenlee Gold Mountain Mining District, in Graham County, in the Territory of Arizona, U. S. L. M. No. 1576. bears from the South west corner *The discovery shaft where this notice is posted* S. 22° 36' W. 649.9 ft bears from the south west corner N. 56° 25' E. 791.9 ft.

The surface boundaries of the claim are marked upon the ground as follows; Beginning at monument of stone in the center of the North east end line of said claim; thence N. 38° 50' W. 300.08 feet to a 4" X 4" Pine Post being the North West corner of said claim; thence S. 52° 30' W. 1338.85 feet to a 4" x4" Pine post, being at the South west corner of said claim; thence S. 38° 50' E. 300.08 feet to a monument of stone being the center of the South west end of said claim; thence S. 38° 50' E. 300.08 feet to a 4"x 4" Pine Post, being at the South east corner of said claim; thence N. 52° 30' E. 1338.85 feet to a 4 x 4 Pine post at the North east corner of said

claim; thence N. 38° 50' W. 300.08 feet to the place of, beginning.

All done under the provisions of Chapter Six, of Title XXXII, of the Revised Statutes of the United States, and of an Act of the General Assembly of Arizona, entitled "An Act to Revise and Codify the Laws of the Territory of Arizona," approved March 16th, 1901.

This is an amended Location of the Hidden View Mining Claim, located by H. S. Rice and E. E. Frye of Clifton, Arizona, citizens of the United States on the 28th day of March, 1898 and recorded in Book 10, of records of Mines at page 94, in the office of the County Recorder of Graham County to which reference is hereby made.

Dated and posted on the ground this 28th day of March, 1903.

L. A. Dunham)
 (Trustees.
Richard Hecksher)

Filed and recorded at request of Jno. R. Hampton, April 4th, 1903, at 1 P. M.

Mit Sinms,

County Recorder.

AMENDED NOTICE OF LOCATION—Lode Claim

MAR. 20. 1913 44

To all Whom it may Concern:

This mining claim, the name of which is the Missing Link Mining Claim, situate on lands belonging to the United States of America, and in which there are valuable mineral deposits, was entered upon and amended for the purpose of exploration and purchase by Detroit Copper Co. of Arizona

the undersigned on the 30th, day of December 1912. 190

The length of the claim is 1225.5 feet, and we claim 1225.5 feet in a S40°01'W direction, and 300 feet in a 300 direction from the center of the discovery pt. at which this notice is posted, lengthwise of the claim together with 300 feet in width of the surface grounds, on each side of the center of said claim. The general course of the lode deposit and premises is from the N.E. to the S.W.

The claim is situated and located in the Greenlee Gold Mountain Mining District, in Greenlee State County, Territory of Arizona, about

direction from
From the N.E. Cor. of this claim U.S.L.M. No. 1584 bears S.41°38'W. 3150.2 ft.

The surface boundaries of the claim are marked upon the ground as follows: beginning at a monument of stone

at a point in a N. 38°50' E. direction 305.35 feet from the discovery pt. (at which this notice is posted), being in the center of the N.E. end line of said claim; thence S.38°50'E. 305.35 feet to a pine post, being the N.E. corner of said claim; thence S.40°01'W. 1225.5 feet to a pine post, being at the S.E. corner of said claim; thence N.38°50'W. 305.35 feet to a monument of stone being the center of the S.W. end of said claim; thence N.38°50'W. 305.35 feet to a pine post being at the S.W. corner of said claim; thence N.40°01'E. 1225.5 feet to a pine post at the N.W. corner of said claim; thence S.38°50'E. 305.35 feet to the place of beginning.

~~All done under the provisions of Chapter Six, of Title XXXII, of the revised Statutes of the United States, and of an act of the General Assembly of the Territory of Arizona, entitled "An Act to Codify and Revise the Laws of the Territory of Arizona," approved March 16th, 1901.~~

This is an Amended Location Notice of the Missing Link mining Claim, located by J.F. Smart

on the 27th, Transcribed day of Jan. 1887, and recorded in Book 2 of Records of Mines at page 130, in the office of the County Recorder of the aforesaid County of Greenlee

to which reference is hereby made, Amended by J.F. Smart Apr. 6th, 1895, recorded in Book 3 of Transcribed Records of Mines at page 405 of Greenlee County.

Dated and posted on the ground this 30th, day of December 1912 190

Witness:

Frank D. Rathbun

Detroit Copper Mining Co. of Arizona
By A. J. Thomson Agt.

TERRITORY OF ARIZONA,

County of Graham

ss.

I, _____ County Recorder in and for the County and Territory aforesaid, do hereby certify that the within instrument was filed for record at _____ o'clock _____ M, on this _____ day of _____ 190_____, and duly recorded in Book No _____ of _____ Records of Graham County Arizona, at pages _____

Witness my hand and seal the day and year first above written,

County Recorder

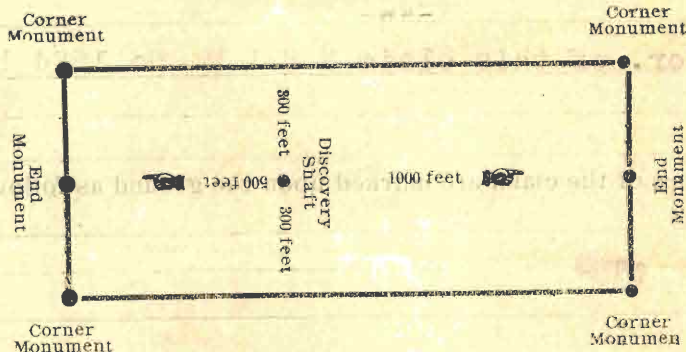

The above diagram is to give the locator a general idea of the plan of location under the new law. Your discovery shaft may be in the center of claim, or any distance from either end you desire. In the diagram we have placed it 500 feet from one end and 1000 feet from the other. In description be careful to state locality of claim with reference to some natural object, or permanent monument, so as to identify the claim.

MAR. 20. 1913

No. 1614

Amended

Notice of Location

LODE CLAIM

The Detroit Copper Mining Co. of Arizona.

MISSING LINK

Dated Dec 30 1902

Filed and recorded at request of

S. C. M. Co.

March 6th A. D. 1903

at Phoenix A. M.

Book Phoenix Arizona

Pages 1671

W. E. Steen

County Recorder.

By W. D. Ramsey
Deputy Recorder.

I, W. E. KELLY, County Recorder in and for the County of Greenlee, State of Arizona, do hereby certify that the within and following is a true, full and complete copy of the within mentioned "AMENDED NOTICE OF LOCATION" OF COPPER CHIEF MINING CLAIM.

as the same appears of record in my office, in book 5 of Transcribed Location Notices, at page 94-95.

IN WITNESS WHEREOF, I have hereunto set my hand and seal of office, this 6th day of March A. D. 1913.

(SEAL)

W. E. Kelly
County Recorder

AMENDED NOTICE OF MINING LOCATION.

MAR 20 1913

LODE CLAIM.

To all whom it may concern:

This mining claim, the name of which is the COPPER CHIEF Mining claim, situate on lands belonging to the United States of America, and in which there are valuable mineral deposits, was entered upon and located for the purpose of exploration and purchase by J. F. Smart the undersigned, on the 16th day of November, 1899.

The length of this claim is 1500 feet, and I claim about 400 feet in a South westerly direction and 1100 feet in a North Easterly direction from the center of the discovery shaft at which this notice is posted, lengthwise of the claim, together with 300 feet in width of the surface grounds, on each side of the center of said claim. The general course of the lode deposit and premises is from the South west to the North east.

The claim is situated and located in the Greenlee Gold Mountain Mining District, in Graham County, in the Territory of Arizona, about 700 feet in a North westerly direction from Spring under tall cottonwood tree in Hickory Jackson Canyon, where Canyon is crossed by a porphyry Dyke.

The surface boundaries of the claim are marked upon the ground as follows: Beginning at a monument of stones erected at the South Westerly end center of claim, at a point in a South westerly direction about 400 feet from the discovery shaft (at which this notice is posted, being in the center of the South westerly end line of said claim; thence 300 feet to a monument of stones, being the South east corner of said claim; thence 750 to a monument of stones at the center of the South Easterly side line of said claim; thence 750 feet to a monument of stones, being at the North Easterly corner of said claim; thence 300 feet to a monument of stones at the center of the North Easterly end of said claim; thence 300 feet to a monument of stones, being at the North westerly corner of said claim; thence 750 feet to a monument of stones, being at the center of the North westerly side line of said claim; thence 750 feet to a monument of stones, at the South Westerly corner of said claim; thence 300 feet to the place of beginning.

13
47

All done under the provisions of Chapter Six, of Title XXXII of the Revised Statutes of the United States, and of an Act of the General Assembly of Arizona, ebtitled "An Act Concerning Mines", approved March 20th, 1895, and amended March 2d, 1899.

This is an Amended Location Notice of the Copper Chief Mining Claim, located by J. F. Smart on the 16th day of November, 1899, and recorded in Book twelve (12) of Records of Mines, at page 220, in the office of the County Recorder of the aforesaid County of Graham, to which reference is hereby made, and this amended location notice is made and posted to correct errors, in the description in the said original location Notice.

Dated and posted on the ground this 10th day of April 1901.

J. F. Smart.

Filed and recorded at request of C. F. Whitcher this 15th day of April, 1901 at 9 O'clock A M.

Thomas Smith, County Recorder.

AMENDED NOTICE OF LOCATION—Lode Claim

To all Whom it may Concern:

This mining claim, the name of which is the ALICE WINIFFRED Mining Claim, situate on lands belonging to the United States of America, and in which there are valuable mineral deposits, was entered upon and amended for the purpose of exploration and purchase by Detroit Copper Mining Co. of Arizona

the undersigned on the 30th, day of December 1912. -190-

The length of the claim is 1500 feet, and 2 claims 2 feet in a S42°41'W direction, and 1498 feet in a N42°41'E direction from the center of the discovery pt. at which this notice is posted, lengthwise of the claim together with 300 feet in width of the surface grounds, on each side of the center of said claim. The general course of the lode deposit and premises is from the N.E. to the S.W.

The claim is situated and located in the Greenlee Gold Mountain Mining District, in Greenlee County, State of Arizona, about

direction from
From the S.E. Cor. of this claim U.S.L.M. No. 1584 bears S.41°38'W. 3150.2 ft.

The surface boundaries of the claim are marked upon the ground as follows: beginning at a monument of stone

at a point in a S.42°41'W. direction 2 feet from the discovery pt. (at which this notice is posted), being in the center of the S.W. end line of said claim; thence N.38°50'W.302.3 feet to a pine post, being the S.W. corner of said claim; thence N.42°41'E. 1500 feet to a pine post, being at the N.W. corner of said claim; thence S.38°50'E. 302.3 feet to a monument of stone being the center of the N.E. end of said claim; thence S.38°50'E. 302.3 feet to a pine post being at the N.E. corner of said claim; thence S.42°41'W. 1500 feet to a pine post at the S.E. corner of said claim; thence N.38°50'W 302.2 feet to the place of beginning.

~~All done under the provisions of Chapter Six, of Title XXXH, of the revised Statutes of the United States, and of an act of the General Assembly of the Territory of Arizona, entitled "An Act to Codify and Revise the Laws of the Territory of Arizona," approved March 16th, 1901.~~

This is an Amended Location Notice of the Alice Winiffred mining Claim, located by J.F. Smart

on the 8th, day of April 1895, and recorded in Book 3 Transcribed of Records of Mines at page 406, in the office of the County Recorder of the aforesaid County of Greenlee to which reference is hereby made,

Dated and posted on the ground this 30th, day of Dec. 1912. -190-

Witness: Frank D Rathbun Detroit Copper Mining Co. of Arizona
By N.S. Thomson Agt.

TERRITORY OF ARIZONA,

County of Graham

ss.

I, _____ County Recorder in and for the County and Territory aforesaid, do hereby certify that the within instrument was filed for record at _____

o'clock _____ M, on this _____ day of _____ 190____, and

duly recorded in Book No _____ of _____ Records of Graham County

Arizona, at pages _____

Witness my hand and seal the day and year first above written,

County Recorder

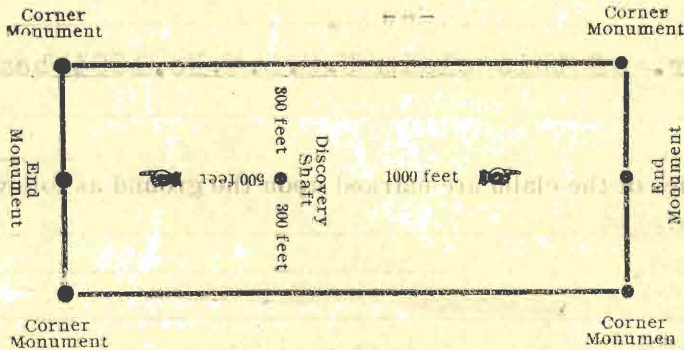

The above diagram is to give the locator a general idea of the plan of location under the new law. Your discovery shaft may be in the center of claim, or any distance from either end you desire. In the diagram we have placed it 500 feet from one end and 1000 feet from the other. In description be careful to state locality of claim with reference to some natural object, or permanent monument, so as to identify the claim.

MAR. 20. 1913

No. 1615

Amended

Notice of Location

LODE CLAIM

The Detroit Copper Mining Co. of Arizona,

ALICE WINIFRED

Dated Dec 30 1902

Filed and recorded at request of

Alice Winifred

Mrs. A. D. 1903

at 9:00 o'clock P.M.

Book #1741

Pages # 671 & 672

W. E. Steeg

County Recorder.

By *W. E. Steeg*

Deputy Recorder.

MAR. 20. 1913

THE STATE OF ARIZONA,)
) (SS.
COUNTY OF GRAHAM.)

I, D. H. Dlaridge, County Recorder in and for the County of Graham, Territory of Arizona, do hereby certify that the within and following, is a true & full, and complete copy of the within mentioned Location Notice of the "TOM H." as the same appears of record in my office, in book 15 Record of Mines, at page 519.

IN WITNESS WHEREOF? I have hereunto set my hand and sel of office, this
27" day of July A. D. 1913.
D. H. Dlaridge
County Recorder.

BERKSHIRE LINEN CO

NOTICE OF MINING LOCATION.

LODE CLAIM.

--0--

TO ALL WHOM IT MAY CONCERN: This mining claim, the name of which is the Tom H. Mining Claim, situate on lands belonging to the United States of America, and in which there are valuable mineral deposits was entered upon and located for the purpose of exploration and purchase by Louis A Dunham a citizen of the United States the undersigned, on the 9th day of Jan. 1903.

The length of this claim is 1500 feet, and I claim 600 feet in a Northeasterly direction, and 900 feet in a Southwesterly direction from the center of the discovery shaft, at which this notice is posted, lengthwise of the claim, together with 300 feet in width of the surface grounds, on each side of the center of said claim. The general course of the lode deposit and premises is from the North east to the South west.

The claim is situated and located in the Greenlee Gold Mountain Mining District, in Graham County, in the Territory of Arizona, it is the North east extension of the Copper Cleff claim of the Clifton Consolidated Copper Mines, The Mouth of No. 3 Tunnel of the said Company lies near the center line of this claim & about 300 feet from its South west end line.

The surface boundaries of the claim are marked upon the ground as follows; Beginning at ----- at a point in a Northeasterly direction 600 feet from the discovery shaft (at which this notice is posted), being in the center of the North East end line of said claim; thence Southeasterly 300 feet to a monument of stones, being the Northeast corner of said claim; thence South easterly 1500 feet to a Monument of stone, being at the South east corner of said claim; thence North wasterly 300 feet to a monument of stone being the center of the south west end of said claim; thence Northwesterly 300 feet to a monument of stone, being at the Southwest corner of said claim; thence

Northeasterly 1500 feet to a Monument of stone at the North west corner of said claim; thence Southeasterly 300 feet to the place of beginning.

All done under the provisions of Chapter Six, of Title XXXII, of the Revised Statutes of the United States, and of an Act of the General Assembly of Arizona, entitled "An Act to Revise and Codify the Laws of the Territory of Arizona," approved March 16th, 1901.

Dated and posted on the ground this 9th day of Jan, 1903.

Louis a Dunham

By Lamar Cobb, Jr.

Filed and recorded at request of Jno. R. Hampton, April 9th 1903, at 9 A. M.

Mit Simms,

County Recorder.

Notice of Mining Location

LODE CLAIM

MAR 20 1913

To All Whom it May Concern:

This Mining Claim, the name of which is the Cambridge Mining Claim, situate on lands belonging to the United States of America, and in which there are valuable mineral deposits, was entered upon and located for the purpose of exploration and purchase by The Detroit Copper Mining Company of Arizona

(Locator must insert either "a citizen of the United States," or "who has declared his intention to become a citizen of the United States.")

the undersigned, on the 30th, day of December 1912. -19-

The length of this claim is 281.19 feet and it claims 10 feet, in a N.42°41'E. direction and 271.19 feet in a S.42°41'W. direction from the center of the discovery shaft, at which this notice is posted, lengthwise of the claim, together with 300 feet in width of the surface grounds, on each side of the center of said claim. The general course of the lode deposit and premises is from the N.E. to the S.W.

The claim is situated and located in the Greenlee Gold Mountain Mining District, in Greenlee State County, in the Territory of Arizona, about -in a- direction from

From the S.W. Cor. of this claim, U.S.L.M. No. 1584 bears S49°51'W 4399 ft.

The surface boundaries of the claim are marked upon the ground as follows: Beginning at a monument of stones at a point in a N.42°41'E. direction _____ feet from the discovery shaft (at which this notice is posted), being in the center of the N.E. end line of said claim; thence S.84°31'E. 94.03 feet to a pine post, being the N.E. corner of said claim; thence S.39°43'W 270.91 feet to a pine post, being at the S.E. corner of said claim; thence N.84°31'W 111.66 feet to a monument of stones at the center of the S.W. end of said claim; thence N.84°31'W 37 feet to a pine post, being at the S.W. corner of said claim; thence N.42°41'E. 281.19 feet to a pine post at the N.W. corner of said claim; thence S.84°31'E. 37 feet to the place of beginning.

~~All done under the provisions of Chapter Six, of the Title XXXII, of the Revised Statutes of the United States, and of an Act of the General Assembly of Arizona, entitled, "An Act to Revise and Codify the Laws of the Territory of Arizona," approved March 16, 1901.~~

Dated and posted on the ground this 30th, day of December 1912. -19-

Witness:
Frank D. Rathbun

Detroit Copper Mining Co. of Arizona
By V. J. Thousay Agent.

TERRITORY OF ARIZONA

COUNTY OF

SS.

I, County Recorder in and for the County and Territory aforesaid, do hereby certify that the within instrument was filed for record at o'clock, M, on this day of 19....., and duly recorded in Book No of Records of County, Arizona, at pages

WITNESS my hand and official seal the day and year first above written.

COUNTY RECORDER

Mar 20 1912

CAMBRIDGE

1605

Notice of Location

LODE CLAIM

The Detroit Copper Mining Company of Arizona

Dated Dec 30th 1912

Filed and recorded at request of

J. E. M. O.

Much at Noon A. D. 1912

Book # 74

Pages # 74

J. E. M. O. County Recorder.

By J. E. M. O. Deputy Recorder.

The above diagram is to give the locator a general idea of the plan of location under the new law. Your discovery shaft may be in the center of claim, or any distance from either end you desire. In the diagram we have placed it 500 feet from one end and 1000 feet from the other. Commence description of claim at a center end monument, giving its distance and direction from center of Discovery Shaft; thence bound the claim in either direction. In description be careful to state locality of claim with reference to some natural object, or permanent monument, so as to identify the claim.

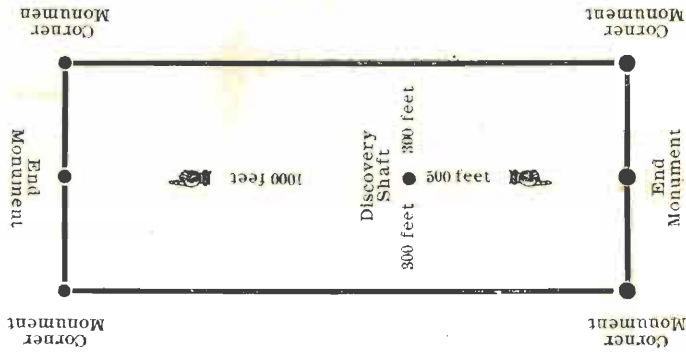

MAR 20 1913

THE STATE OF ARIZONA)
) (SS.
COUNTY OF GRAHAM.)

I, D. H. Claridge, County Recorder in and for the County of Graham, State of Arizona, do hereby certify that the within and following, is a true, full, and complete copy of the within mentioned Location Notice of the "NORTH STAR" Mine as the same appears of record in my office, in book 18 Record of Mines at page 16.

In WITNESS WHEREOF, I have hereunto set my hand and seal of office, this 27th day of July A. D. 1912.
D. H. Claridge
County Recorder.

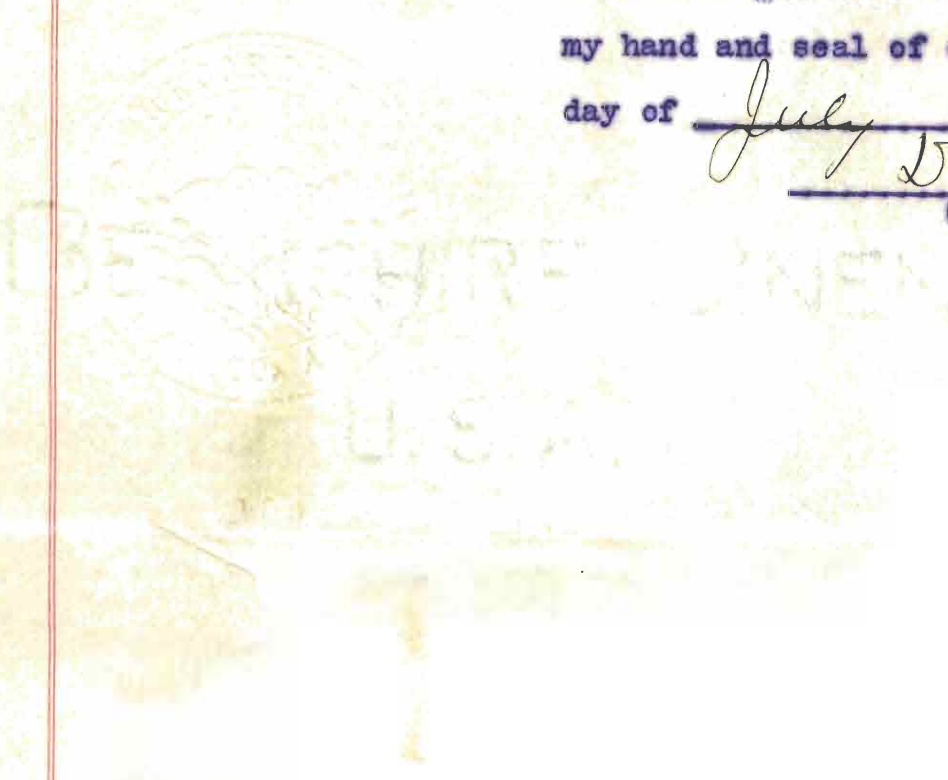

A M E N D E D
 NOTICE OF MINING LOCATION
 LODE CLAIM.
 --0--

TO ALL WHOM IT MAY CONCERN: This Mining Claim, the name of which is the North Star Mining Claim, situate on lands belonging to the United States of America, and in which there are valuable mineral deposits, was entered upon and located for the purposes of exploration and purchase by J. F. Smart, a citizen of the United States the undersigned, on the 1st day of April, 1901.

The length of this claim is 1500 feet and we claim 800 feet, in a N. E. Direction and 700 feet in a S. W. direction from the center of the discovery shaft, at which this notice is posted lengthwise of the claim, together with 300 feet in width of the surface grounds, on each side of the center of said claim. The general course of the lode deposit and premises is from the N. E. to the S. W.

The claim is situated and located in the Greenlee Gold Mountain Mining District, in Graham County, in the Territory of Arizona, about 2500 feet in a Westerly direction from N. W. Cor. Sec 6, Tp. 4 S. R. 30 E. G. & S. R. B & M. and lies parallel to & adjoins the Keystone on the N. W.

The surface boundaries of the claim are marked upon the ground as follows: Beginning at a pine post set in a monument of stones, at a point in a N. E. direction 800 feet from the Discovery shaft (at which this notice is posted), being in the center of the N. E. end line of said claim; thence N° 50° 13' W. 300 feet to a pine Post in a monument of stones being the N. W. corner of said claim; thence S. 39° 47' W. 1500 feet to a Pine Post set in a monument of stones, being at the S. W. corner of said claim; thence S. 50° 13' E. 300 feet to a Pine Post set in a Monument of stones at the center of the S. W. end of said claim; thence S° 50° 13' 300 feet to a Pine Post set in

a Monument of stones, being at the S. E. corner of said claim; thence N. 39° 48' E. 1500 feet to a Pine post set in Monument of Stones at the N. E. corner of said claim; thence N. 50° 13' W. 300 feet to the place of beginning.

All done under the provisions of Chapter Six, of Title XXXII of the Revised Statutes of the United States, and of an Act of the General Assembly of Arizona, entitled "An Act to Revise and Codify the Laws of the Territory of Arizona," approved March 16, 1901.

This is an Amended Location Notice of the North Star Mining Claim, located by J. F. Smart, on the 1st day of April, 1901, and recorded in Book 14 of Record of Mines, at page 253, in the office of the County Recorder of the aforesaid County of Graham, to which reference is here y made, and this amended Location Notice is made and posted to correct errors in the description in the said original Location Notice.

Dated and posted on the ground this 24th day of August, 1904.

New England & Clifton Copper Company
of Arizona.

By A. P. Ayling, Mgr.

Filed and recorded at request of John F. Robertson, Aug
29, 1904, at 9 A. M.

Mit Simms,

county Recorder.

By L. Simms, Deputy.

MAR. 20. 1913

THE STATE OF ARIZONA,)
) (SS.
COUNTY OF GRAHAM.)

I, D. H. Claridge, County Recorder in and for the County of Graham, State of Arizona, do hereby certify that the within and following, is a true, full, and complete copy of the within mentioned Location Notice of the "GOLDEN GATE", as the same appears of record in my office, in book 9 of Record of Mines, at page 99.

IN WITNESS WHEREOF, I have hereunto set my hand and seal of office, this 27 day of July A. D. 1913.
D. H. Claridge
County Recorder.

NOTICE OF MINING LOCATION.

QUARTZ CLAIM.

---0---

TO ALL WHOM IT MAY CONCERN: This Mining claim the name of which is the Golden Gate Mining Claim, Situate upon lands belonging to the United States of America, and in which there are valuable mineral deposits, was entered upon and located for the purpose of exploration and purchase by J. F. Smart, the undersigned on the 21st day of June, 1896.

The length of the claim is 1500 ft. with 300 ft in width on each side of the middle of the lode or vein, and about 950 ft South Ely from Discovery shaft and 550 ft North West lengthwise of the claim.

The general course of the lode deposit & premises is from the So. East to the No. West. The claim is situated and located in the Greenlee Gold Mountain Mining District, in Graham County Territory of Arizona,

Beginning at a point about 700 ft from Spring in Hickory Jackson Canyon marked by a tall cotton wood tree & running up the canyon in North Westerly direction.

Beginning at the upper side lines of the Firefly and Quaker City Lodes or claim and running No Westerly up the canyon across the A. M. Missing Link and Alice ~~Winfred~~ lodes lodes or claims. The surface boundaries of the claim are marked as follows:

Beginning at this monument of stones erected of the center South Ely end of claim, at a point about 950 ft in a So Ely direction from the Discovery Shaft at which this notice is posted, and which is the So Ely end center of claim and running 300 ft in a No Ely direction to a monument of stones, being the No Ely corner monument, thence 750 ft in a No Wly direction to a monument of stones, being the center of the No Ely side line, thence 750 ft in a No Wly direction to a monument of stones,

being the centre of the No Ely side line, Thence 750 ft in a No Wly direction to a monument of stones, being the No Wly corner monument, thence 300 ft in a So Wly direction to a monument of stones being the North Westerly End centre of claim, thence 300 ft in a So Wly direction to a monument of stones, being the So Wly corner monument, thence 750 ft in a So Ely direction to a monument of stones, being the centre of the So Wly side line, thence 750 ft in a So Ely direction to a monument of stones, being the So Ely corner monument, thence 300 ft in a No Ely direction to a monument of stones, being the place of beginning.

All done under the provisions of chapter Six of Title XXXII of the Revised Statutes of the United States and of an act of the General Assembly of Arizona, entitled "An Act of the General Assembly of Arizona, entitled "An Act concerning Mines"" approved March 20th, 1895.

Dated and posted on the ground this 21st day of Jan, 1896.

Witness

J. F. Smart,

Geo. W. Williams.

Locator.

Note: As Lode or vein lies in the Gulch discovery shaft was sunk on a cron vein near the intersection of a crossing to avoid danger from flood water & give room for dump.

J. F. Smart,
Locator.

Recorded at the request of J. F. Smart, September, 18th 1896, at 10 o'clock, A. M.

M. Leon,

Co. Recorder.

U. S. SURVEYOR GENERAL'S FINAL CERTIFICATE ON
FIELD NOTES.

DEPARTMENT OF THE INTERIOR,

OFFICE OF U. S. SURVEYOR GENERAL,

Phoenix, Arizona.

November 7, 1913.

I, U. S. Surveyor General for District of Arizona,
do hereby certify that the foregoing transcript of the Field Notes, return and approval
of the Survey of the mining claim of

THE DETROIT COPPER MINING COMPANY OF ARIZONA,
MAINE, OLIVETTE, MAINE FRACTION, TONY, FRACTION,
known as the HIDDEN VIEW, MISSING LINK, COPPER CHIEF, ALICE
WINIFRED, TOM H, CAMBRIDGE, NORTH STAR, GOLDEN GATE.
situate in GREENLEE GOLD MOUNTAIN

Greenlee Mining District, GREENLEE County,
ARIZONA Section 1 surveyed, Secs. 2 and 11 unsur.
in Section 36, Township No. 3 S.,
T. 4 S., R. 29 E. and
Range No. 29 E., unsurveyed.

and designated as Survey
No. 3058, has been correctly copied from the originals on
file in this office; that said Field Notes furnish such an accurate description of said
mining claim as will, if incorporated into a patent, serve fully to identify the premises,
and that such reference is made therein to natural objects or permanent monuments as
will perpetuate and fix the *locus* thereof.

And I further certify that five hundred dollars' worth of labor has been expended
or for each of
or improvements made upon said mining claim^s by claimant or its grantors, and
that said improvements consist of 10 tunnels, 4 shafts and 2 cuts, total
value \$81,120, of which \$53010 is reserved for other claims.
Tunnel No. 2 on the Golden Gate lode being a common improvement
for the benefit and development of all of the claims in this survey,
with the exception of the North Star and Cambridge lodes, and 31
other claims, viz., Summit No. 1, Summit No. 2, Summit No. 3, Mt. Vernon
No. 1, Mt. Vernon No. 2, Mt. Vernon No. 3, Consolidate No. 1, Consolidate No. 2,
Consolidate No. 3, Consolidate No. 4, Virginia, Euclaire, Eclipse, Green
Tree, High View, Nevada, New Jersey, Triangulate No. 2, Boston No. 1, Boston
No. 2, Boston No. 3, Boston No. 4, Boston No. 5, Boston No. 6, Boston No. 7,
Boston No. 8, Boston No. 9 lodes, unsurveyed, and Monte Carlo and Copper
Verde lodes, Sur. No. 1584, also Copper Bullion and Solid Copper lodes,
Sur. No. 1576, as set forth in the foregoing field notes, an undivided
1/42 interest therein, value \$1710, is properly credited to each of
said 42 claims.

and that no portion of said labor or improvements has been included in the estimate of
expenditures upon any other claim.

I further certify that the plat thereof, filed in the U. S. Land Office at Phoenix,
Arizona is correct and in conformity with the foregoing Field Notes.

Frank S. Ingalls,

United States Surveyor General for Arizona.

4-687.

SURVEYOR-GENERAL'S CERTIFICATE OF APPROVAL OF FIELD NOTES AND SURVEY OF MINING CLAIM.

Department of the Interior.

Office of U. S. Surveyor-General,

Phoenix, Arizona,

November 7, 1913.

I, U. S. Surveyor-General for District of Arizona

do hereby certify that the foregoing and hereto attached Field Notes and Return of the Survey of the Mining Claim of

THE DETROIT COPPER MINING COMPANY OF ARIZONA

known as the MAINE, OLIVETTE, MAINE FRACTION, TONY, FRACTION, HIDDEN VIEW, MISSING LINK, COPPER CHIEF, ALICE WINIFRED, TOM H, CAMBRIDGE, NORTH STAR, GOLDEN GATE.

situate in GREENLEE GOLD MOUNTAIN mining district,

GREENLEE County, ARIZONA

Section 1 surveyed, Secs. 2 and 11 unsurveyed, T. 4 S., R. 29 E. and in Section 36, Township No. 3 S., Range No. 29 E., Unsur.

designated as Survey No. 3058

executed by E. T. Morton, U. S. Deputy Mineral

Surveyor, March 25-April 10, 1913, 190, under my instructions dated

March 20, 1913, 190, have been critically examined and the necessary cor-

rections and explanations made, and the said Field Notes and Return, and the Survey they describe,

are hereby approved. A true copy of the copy of the location certificate filed by the applicant for

survey is included in the field notes.

Frank S. Sigall

U. S. Surveyor-General for Arizona.