

NOV 29 1915

4-683.

MINERAL SURVEY No. 3245

LOT No.

ARIZONA Land District.

FIELD NOTES

OF THE SURVEY OF THE MINING CLAIM OF

UNITED VERDE COPPER COMPANY

KNOWN AS THE

BALTIMORE NO.1 BALTIMORE NO.2

VERDE Mining District,

YAVAPAI County, ARIZONA

Section 2, Township 15 N., Range 2 E. Unsur.

Surveyed under instructions dated OCTOBER 2, 1915

by J. WILLIAM WAARA U. S. Deputy Mineral Surveyor.

Claim located see location notices, 19

Survey commenced Nov. 5, 1915, 19

Survey completed Nov. 9, 1915, 19

6-822

Address

H. H. LINNEY, Atty. for claimant, Prescott, Arizona.

MINERAL SURVEY NO. 3245

BALTIMORE NO.1

Beginning at Cor. No.1, identical with Corner No.1 Expectation Lode Sur. No. 1541, a limestone 10 x 12 x 20 inches exposed with a substantial mound of stone alongside; chiseled B No.1-1-3245 on southwest face and E-1-1541 on northeast face with cross on top for exact corner point, from which point,

A sandstone rock in place 4 x 3 x 2 ft. exposed and chiseled BxR B 1-1-3245, brs. N.55°-47'W. 21.0 ft.

A sandstone rock in place 6 x 2 x 4 feet exposed and chiseled BxR E No.1-1541-B 1-1-3245, brs. N.31°-51'E. 20.7 feet.

The east 1/4 cor. Sec.36, T.16 N.R.2 E. of the Gila and Salt River base and Meridian, brs. N.48°-13'-50"E. 7331.0 ft.

Thence N.44°-23'W.

- 85.0 Cross pipe line brs. northeast to southwest.
 268.0 Cross Gulch, flows northeasterly.
 494.0 Cross Pipe line, brs. southwest to northeast.
 737.0 Cross trail, brs. southwest to northeast.
 943.8 Cor.No.2 Expectation Lode, identical with corner No.1 Hope Lode, both Sur.No. 1541.
 1500.0 TO COR. NO.2, a limestone 4 x 12 x 27 inches long set fourteen inches in the ground with a substantial mound of stone alongside; chiseled B 1-2-3245 with cross on top for exact corner point, from which point,
 A limestone bluff fifteen feet high and chiseled BxR B No.1-2-3245 brs. N.68°-53'W. 25.3 feet.
 No other bearings available.
 Thence S.78°-37'W.
 21.5 Intersect line 1-2 Hope Lode Sur. No. 1541, at N.46°-12'W. 568.2 feet from Cor. No.1 and S.46°-12'E. 135.8 feet from Cor. No.2.
 333.3 Intersect the east side line of the Iron Joint Lode, unsurveyed at N.15°-52'E. 454.2 feet from the S.E. Corner, and

- 367.9 feet from its intersection with line 3-4 of this lode, identical with line 1-2 Baltimore No.2 lode of this survey, and S.15°-52'W. 722.9 feet from the N.E.Cor.
- 357.2 POINT FOR NORTH CENTER END, where it was impracticable to build monument due to point falling on side of bluff, so I established a witness point, being a substantial mound of stone S.78°-37'W. 6.6 feet.
- 363.8 Witness point for north center end, heretofore described.
- 714.0 TO POINT FOR COR. NO.3, identical with Cor.No.2 Baltimore No.2 lode of this survey, where it was impracticable to set stone for corner, ^{due to bed rock being too close to the surface,} so I established a witness corner S.44°-22'E. 0.8 feet, a limestone rock in place 6 x 4 x 3 feet exposed and chiseled W C-B 1-3, B 2-2-3245 with cross for exact corner point, from which point,
- A rock in place being limestone reef eight feet high and chiseled BxR B 1-3-3245 brs. N.82°-39'W. 15.4 ft.
- A rock in place being limestone reef one foot exposed and chiseled BxR B No.1-3, B No.2 -2-3245 brs. N.44°-22'W. 5.3 feet.
- Thence S.44°-22'E. from true corner point, W.C. for Cor. No.3, heretofore described.
- .8
389.9 Intersect the east side line of the Iron Joint Lode unsurveyed at N.15°-52'E. 86.3 feet from the S.E.Cor., and S.15°-52'W. 1090.8 feet from N.E.corner, 367.9 feet from its intersection ^{with} line 2-3 of this lode.
- 1440.0 Cross gulch , flows northeasterly.
- 1499.8 TO COR. NO.4, identical with Cor. No.1 Baltimore No.2 lode of this survey, a sandstone 3 x 9 x 24 inches long set twelve inches in the ground with a substantial mound of stone alongside; chiseled B 2-1, B 1-4-3245 with cross on top for exact corner point, from which point,
- A sandstone 3 x 6 x 0.4 feet exposed and chiseled BxR B No.2-1, B No.1-4-3245, brs. S.21°-12'W. 13.8 feet.
- A sandstone 3 x 2 x 0.5 feet exposed and chiseled BxR B No.1-4, B No.2-4-3245, brs. S.46°-40'E. 11.8 feet.
- Thence N.78°-37'E.
- 357.2 SOUTH CENTER END, a mound of stone.
- 714.4 TO THE PLACE OF BEGINNING. All corners are identical with

their respective locations. Variation at all corners N. 14°-50'E.

BALTIMORE NO.2

Beginning at Cor. No.1, identical with Cor No.4, Baltimore No.1 lode of this survey, previously described, from which point,

The east 1/4 cor.Sec. 36,T.16 N.R.2 E of the Gila and Salt River Base and Meridian,brs.N.50°-50'E. 7955.4 ft.

Thence N.44°-22'W.

59.8 Cross gulch flows northeasterly.

1109.9 Intersect the east side line of the Iron Joint Lode,unsurveyed at N.15°-52'E. 86.3 feet from S.E.Corner, and S.15°-52'W. 1090.8 feet from the N.E.Cor. 367.9 feet from its intersection with line 2-3 Baltimore No.1 lode of this survey. The S.W.Cor. brs. S.80°-42'W. 617.6 feet from S.E.Cor.

1499.0 Witness Corner to Cor. No.2,identical with W.C.for Cor.No.3,Baltimore No.1 lode of this survey,heretofore described.

1499.8 TO THE POINT FOR COR.NO.2, identical with ^{point for} Cor. No.3 Baltimore No.1 lode, previously described.

Thence S.78°-37'W.

264.7 Intersect the west side line of the Iron Joint Lode,unsurveyed at N.13°-51'E. 421.6 feet from the S.W.Corner and S.13°-51'W. 737.1 feet from the N.W.Corner from which point the N.E.Corner brs. N.80°-42'E. 662.8 feet.

357.2 NORTH CENTER END, a mound of stone.

714.0 TO COR. NO.3, a limestone 10 x 12 x 20 inches long, set twelve inches in the ground with a substantial mound of stone alongside; chiseled B No.2-3-3245 with cross on top for exact corner point, from which point,

A sandstone 2 x 2 x 3 ft exposed and chiseled BxR B 2-3-3245, brs.. S.64°-01'W. 23.5 feet.

A rock in place 4 x 3 x 1 ft. exposed and chiseled BxR B-2-3-3245 brs. S.44°-23'E. 8.5 feet.

Thence S.44°-21'E.

1499.6 TO COR. NO.4, a limestone 6 x 12 x 18 inches long set twelve inches in the ground with a substantial mound of

stone alongside; chiseled B No.2-4-3245 with cross on top for exact corner point, from which point,

A rock in place 3 x 2 x 0.4 feet exposed and chiseled BxR B No.2-4-3245 brs. S.65°-48'W. 6.9 feet.

A rock in place being limestone reef one foot exposed and 20 feet long chiseled BxR B No.2-4-3245, brs. N.70°-20'W. 20.6 feet.

Thence N.78°-37'E.

357.2 SOUTH CENTER END, A MOUND OF STONE.

714.4 TO THE PLACE OF BEGINNING. ALL CORNERS ARE IDENTICAL WITH their respective locations. Variation at all corners N. 14°-50'E.

LODE LINES.

As near as can be determined from the present developments, the veins on the respective lodes extend as follows from their discoveries:

Baltimore No.1 lode.

N.44°-23'W. 1440 feet and S.44°-23'E. 60 feet.

Baltimore No.2 lode

N.44°-22'W. 1365 feet and S.44°-22'E. 134.8 feet.

AREAS

BALTIMORE NO.1	Acres	Acres
Total area		20.626 ✓
Area in conflict with		
Hope lode Sur.No.1541	0.117 ✓	
Iron Joint Lode,unsurveyed	1.469 ✓	
BALTIMORE NO.2		20.626 ✓
Total area		
Area in conflict with		
Iron Joint Lode,unsurveyed	4.310	

LOCATION

This survey is located upon unsurveyed land in ~~approximately~~ section 2, T.15. N.R.2 E. of the Gila and Salt River Base and Meridian, in the Prescott national Forest, Verde Mining District, Yavapai County, State of Arizona.

EXPENDITURE OF FIVE HUNDRED DOLLARS

I hereby certify that the value of the labor and

improvements made upon, or for the benefit of each location embraced in said mining claim, by the claimant or its grantors is not less than five hundred dollars, and that said improvements consists of:

BALTIMORE NO.1

No.1 Discovery cut, the center of which brs. N.44°-23'W. 60.0 feet from the south center end, 4 x 12 x 11 foot face

Value \$100.00

To be credited to this claim is an equal undivided one half interest in workings of improvement No.2 Baltimore No.2 Lode, as set forth under heading "Common Improvements"

Value \$3638.50

BALTIMORE NO.2

No.1 Discovery cut, the center of which brs, N.44°-22'W. 134.8 feet from the South center end, 4 x 21 x 11 foot face.

Value \$150.00

No.2 Tunnel, the mouth of which brs. N.2°-40'W. 182 feet from the south center end, 4 x 6^{ft} running N.0°-29'E. 52.3 ft. to sta.1; thence N.20°-34'W. 97.4 ft. to sta. 2; thence N.12°-26'W. 64.8 ft. to sta. 3; thence N.13°-52'E. 46.5 ft. to sta. 4; thence N.12°-57'W. 65.9 ft. to sta.5; thence N.42°-16'W. 35.7 ft. to sta. 6; thence N.26°-01'W. 159.3 ft. to sta. 7; thence N.28°-23'W. 805.8 ft. to face, having a total length of 727.7 ft.

Value \$7277.00

Of the above improvement No.2, is to be credited to this claim an equal undivided one half interest as set forth under heading "Common Improvements".

Value \$3638.50

COMMON IMPROVEMENTS

Tunnel No.2 on the Baltimore No.2 lode runs diagonally across the Baltimore No.2 lode and into the Baltimore No.1 lode about midway between the mouth and face of said tunnel. Either lode can be developed from this tunnel, and as about one half of the total length is within the boundaries of

the respective lodes, I consider the workings, a common improvement, and of such character as to redound to the benefit of the two lodes, Baltimore No.1 and Baltimore No. 2.

727.7 feet of tunnel, total value - - - - \$7277.00
One half equal undivided interest - - - - \$3638.50

OTHER IMPROVEMENTS

BALTIMORE No.2 Lode.

A corrugated iron cabin 11.5 x 13 ft. the S.E. Corner of which bears N.7°-15'W. 155 feet from the south center end.

BALTIMORE No.1 Lode.

The United Verde Copper Company's pipe line from Allan Springs to Jerome, Arizona, traverses the southeast corner of this claim.

INSTRUMENT

This survey was made with a Lietz Light Mountain transit-theodolite, No. 13-5929. The courses were deflected from the true meridian, as determined by observation by the use of the Saegmuller Solar Attachment. The distances were measured with a 500 foot steel tape.

*(insert * next page)*

REPORT

Survey No.1541.

Hope and Expectation Lodes. The corners of these lodes adjoining this survey are stones properly set and marked as described in the field notes of Sur.No. 1541. I do not agree with the courses and distances of the respective lodes.

The corners of the Iron Joint lode are mounds of stone, three foot base and two feet high.

The 1/4 section corner on the east boundary of Section 36, T.16 N.R.2 E. to which connection was made is an iron post as described in the field notes for said section. It has been erroneously marked and instead of the letters and figures "1/4 S 36", appears the markings "1/4 S

11". I have checked the position of the corner with respect to the Amazon Lode Sur. No. 1469, and determined the identity as above reported. This is the nearest corner of the Public Survey that could be found and identity established.

(See explanation in letter dated Dec. 20, 1915)

The discrepancies found existing between the claims as marked by the location monuments and as described in the location notices are due to errors in the location notices.

The discrepancies between the lines of this survey and of other prior approved surveys are due to errors in the latter.

William L. ...

U.S. MINERAL SURVEYOR

* ADJOINING CLAIMS

BALTIMORE NO. 1

On the east by the Hope and Expectation lodes Sur.No. 1541, G.W.Hull, claimant, on the north by the Iron Joint lode unsurveyed, G.Brookshire, claimant, and on the south by Public Domain.

BALTIMORE NO. 2

On the south by Public Domain, on the west and north west by Public Domain, and on the north by the Iron Joint Lode unsurveyed, G.Brookshire, claimant.

FINAL OATHS FOR SURVEYS.

LIST OF NAMES.

A list of the names of the individuals employed by J. WILLIAM WAARA

United States ~~Deputy~~ Mineral Surveyor, to assist in running, measuring, and marking the lines, corners, and boundaries described in the foregoing field notes of the survey of the mining claim of

UNITED VERDE COPPER COMPANY

known as the BALTIMORE No. 1 BALTIMORE No. 2

and showing the respective capacities in which they acted.

JAMES M. SULLIVAN , Chainman.
 , Chainman.
 , Axman.
 , Flagman.

FINAL OATHS OF ASSISTANTS.

We, I, JAMES M. SULLIVAN

and do solemnly swear ~~that I~~ ^{that I} ~~was~~ assisted J. WILLIAM

WAARA , United States ~~Deputy~~ Mineral Surveyor, in marking the corners and surveying the boundaries of the mining claim of UNITED VERDE COPPER COMPANY

known as the BALTIMORE No. 1 , BALTIMORE No. 2

represented in the foregoing field notes as having been surveyed by said ~~deputy~~ mineral surveyor and under his direction; and that said survey has been in all respects, to the best of ~~our~~ ^{my} knowledge and belief, faithfully and correctly executed, and the corner and boundary monuments established according to law and the instructions furnished by the United States Surveyor-General for ARIZONA

James M. Sullivan , Chainman.
 , Chainman.
 , Axman.
 , Flagman.

Subscribed and sworn to by the above-named persons before me this 22nd

day of November, 1905

[Signature]
Notary Public

FINAL OATH OF U. S. ~~DEPUTY~~ MINERAL SURVEYOR

I, J. WILLIAM WAARA, U. S. ~~Deputy~~ Mineral Surveyor, do solemnly swear that, in pursuance of instructions received from the United States Surveyor General for ARIZONA, dated October 2, 1915., I have, in strict conformity to the laws of the United States, the official regulations and instructions thereunder, and the instructions of said Surveyor General, faithfully and correctly executed the survey of the Mining Claim of THE UNITED VERDE COPPER COMPANY, known as the BALTIMORE NO. 1 BALTIMORE NO. 2, situate in VERDE Mining District, YAVAPAI County, ARIZONA, in Section 2, Township No. 15 N., Range No. 2 E. unsurveyed and designated as Survey No. 3245, as represented in the foregoing field notes, which accurately show the boundaries of said mining claim as distinctly marked by monuments on the ground, and described in the attached copy of the location certificate, which was received by me from the Surveyor General with said instructions, and that all the corners of said survey have been established and perpetuated in strict accordance with the law, official regulations and instructions thereunder; and I do further solemnly swear that the foregoing are the true and original field notes of said survey and my report therein, and that the labor expended and improvements made upon said mining claim by claimant or its grantors are as therein fully stated, and that the character, extent, location and itemized value thereof are specified therein with particularity and full detail, and that no portion of said labor or improvements so credited to this claim has been included in the estimate of expenditures upon any other claim.

William Waara
U. S. ~~Deputy~~ Mineral Surveyor.

Subscribed and sworn to by the said J. WILLIAM WAARA

U. S. ~~Deputy~~ Mineral Surveyor, before me

this 24 th.

day of Nov. 1915.

W. Brown
Notary Public

6 3-154

My commission expires Feb. 19. 1916.

AMENDED

11

Notice of Mining Location

LODE CLAIM

JUL 2 1915

TO ALL WHOM IT MAY CONCERN:

This Mining Claim, the name of which is the BALTIMORE NO., 1,- Mining Claim, situate on lands belonging to the United States of America, and in which there are valuable mineral deposits, was entered upon and located for the purposes of exploration and purchase by

Charles W. Clark,

a citizen of the United States,

Locator must insert either "a citizen of the United States," or "who has declared his intention to become a citizen of the United States."

the undersigned, on the day of 191.....

The length of this claim is Fifteen Hundred (1500) feet, and claim Fourteen Hundred and Fifty (1450) feet, in a Northwesterly direction and Fifty (50)

feet in a Southeasterly direction from the center of the discovery shaft, at which this notice is posted, lengthwise of the claim, together with Three Hundred (300) feet in width of the surface grounds, on each side of the center of said claim. The general course of the lode deposit and premises is from the Northwest to the Southeast

The claim is situated and located in the Verde Mining District, in Yavapai County, in the State of Arizona, about 1500 feet, in a Northwesterly direction from United States Mineral Monument No., 2, V.D., and adjoins the Expectation Lode, Mineral Survey, No., 1541, on the West side.

The surface boundaries of the claim are marked upon the ground as follows: Beginning at a monument of stones,

at a point in a Southeasterly direction Fifty feet from the discovery shaft (at which this notice is posted,) being in the center of the South end line of said claim; thence S 77° 35' W-357 feet to a monument of stones, being the Southwest corner of said claim; thence N 45° 25' W-1500 feet to a monument of stones, being at the Northwest corner of said claim; thence N 77° 35' E-357 feet to a monument of stones at the center of the North end of said claim; thence N 77° 35' E-357 feet to a monument of stones, being at the Northeast corner of said claim; thence S 45° 25' E-1500 feet to a monument of stones at the Southeast corner of said claim; thence S 77° 35' W-357 feet to the place of the beginning.

All done under the provisions of Chapter Six, of Title XXXII, of the Revised Statutes of the United States, and of an Act of the General Assembly of Arizona, entitled "An Act to Revise and Codify the Laws of the Territory of Arizona," approved March 16, 1901.

This is an Amended Location Notice of the BALTIMORE, Mining Claim, located by Charles W. Clark,

..... on the Fifteenth day of June, 1910, and recorded in Book 88 of Records of Mines, at page 673, in the office of the County Recorder of the aforesaid County of Yavapai, to which reference is hereby made, and this Amended Location Notice is made and posted to correct errors in the description in the said Original Location Notice.

Dated and posted on the ground this 16th., day of June, 1915.

Chas. W. Clark,

By-C C.V. Hopkins,

Agent.

County of

I, County Recorder in and for the County and State aforesaid, do hereby certify that the within instrument was filed for record ato'clock.....M., on this day of, 191....., and duly recorded in Book No..... of Records of County, Arizona, at pages.....

Witness my hand and official seal the day and year first above written.

..... County Recorder.

AMENDED
Notice of Location
LODE CLAIM

Dated 191.....
Filed and Recorded at request of

Le Roy Anderson,

July 8th., A. D. 1918.

at **2:45- O'clock, P. M.**

Book **86 of Mines.**

Page **477; Records of Yavapai County, Arizona.**

(SEAL) **L. B. Colwell,**
County Recorder.

By **James W. Coyne,**
Deputy Recorder.

Printed and for sale by the Prescott Courier

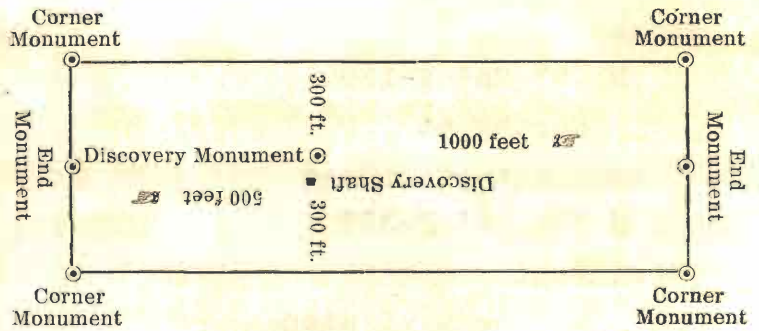

This diagram is to give locator a general idea of plan of location under the new law. The Discovery Shaft can be in the center of claim or any distance from either end desired. In the diagram it is placed 500 feet from one end and 1000 feet from the other. Commence description of claim at a center end monument, giving its distance and direction from center of Discovery Shaft; thence bound the claim in either direction. In description be careful to state locality of claim with reference to some natural object, or permanent monument, as will identify the claim.

#####

#####

#####

#####

#####

#####

#####

#####

#####

#####

STATE OF ARIZONA, }
COUNTY OF YAVAPAI. } ss.

I, L. S. Colwell, County Recorder in and for the County of Yavapai, State of Arizona, and custodian of the records of such office, do hereby certify that I have compared the foregoing copy with, and that the same is a full, true and correct copy of **"BALTIMORE NO. 1," AMENDED NOTICE OF MINING LOCATION, - LODGE CLAIM. - SAME BEING LOCATED BY CHARLES W. CLARK, BY - C.V. HOPKINS, as his AGENT; - AND**

filed for record on July 8th., A.D. 1915; at 2:45-0'clock ^{P.M.} and as the same appears of record in my office in Book 86, of MINES; at page 477 and of the whole thereof.



IN WITNESS WHEREOF, I have hereunto set my hand and affixed my Official Seal this 30th., day of September, A. D. 1915.

L. S. Colwell
County Recorder.

AMENDED
Notice of Mining Location
LODE CLAIM

14

501.2-1915

TO ALL WHOM IT MAY CONCERN:

This Mining Claim, the name of which is the BALTIMORE NO., 2,
Mining Claim, situate on lands belonging to the United States of America, and in which there are valuable
mineral deposits, was entered upon and located for the purposes of exploration and purchase by
Charles W. Clark,

a citizen of the United States,

Locator must insert either "a citizen of the United States," or "who has declared his intention to become a citizen of the United States."

the undersigned, on the 16th., day of June, 1915.

The length of this claim is Fifteen Hundred (1500) feet,
and claim Thirteen Hundred Seventy-Five (1375) feet,
in a Northwesterly direction and One Hundred Twenty
Five (125) feet in a Southeasterly direction from
the center of the discovery shaft, at which this notice is posted, lengthwise of the claim, together with
Three Hundred (300) feet in width of the surface grounds, on each
side of the center of said claim. The general course of the lode deposit and premises is from the
Northwest to the Southeast

The claim is situated and located in the Verde Mining District, in
Yavapai County, in the State of Arizona, about 1700 feet
in a Northwesterly direction from United States Mineral Monument,
No., 2, V.D., and adjoins the Baltimore No. 1, on the West Side.

The surface boundaries of the claim are marked upon the ground as follows: Beginning at
a monument of stones,

at a point in a Southeasterly direction One Hundred Twenty-Five feet from
the discovery shaft (at which this notice is posted,) being in the center of the South
end line of said claim; thence S. 77° 35' W-357 feet to a monument of
stones, being the Southwest corner of said claim;
thence N. 45° 25' W-1500 feet to a monument of stones, being at the
Northwest corner of said claim; thence N. 77° 35' E-357 feet
to a monument of stones at the center of the North end of said claim;
thence N. 77° 35' E-357 feet to a monument of stones, being at the
Northeast corner of said claim; thence S. 45° 25' E- 1500
feet to a monument of stones at the Southeast corner of said claim;
thence S. 77° 35' W.-357 feet to the place of the beginning.

All done under the provisions of Chapter Six, of Title XXXII, of the Revised Statutes of the United
States, and of an Act of the General Assembly of Arizona, entitled "An Act to Revise and Codify the Laws
of the Territory of Arizona," approved March 16, 1901.

This is an Amended Location Notice of the Baltimore No., 2,
Mining Claim, located by Charles W. Clark,
on the Fifteenth day of
June, 1915., and recorded in Book 91, of Records of Mines, at
page 49, in the office of the County Recorder of the aforesaid County of Yavapai,
to which reference is hereby made, and this Amended Location Notice is made and posted to correct errors
in the description in the said Original Location Notice.

Dated and posted on the ground this 16th., day of June, 1915.

Chas. W. Clark,

By, - C. V. Hopkins,

Agent.

15 County of

ss.

I,, County Recorder in and for the County and State aforesaid, do hereby certify that the within instrument was filed for record ato'clock.....M., on this day of, 191....., and duly recorded in Book No..... of Records oft. County, Arizona, at pages.....

Witness my hand and official seal the day and year first above written.

County Recorder.

Notice of Location

AMENDED

LODE CLAIM

Filed and Recorded at request of
Lo Roy Anderson,
Dated..... 191.....
at **2:45- 0'clock.** P. M.
Book **86 of Mines.**
Page **478; Records of Yavapai County, Arizona.**

(SEAL.) **L.S. Colwell,**
County Recorder.

By **James W. Coyne,**
Deputy Recorder.

Printed and for sale by the Prescott Courier

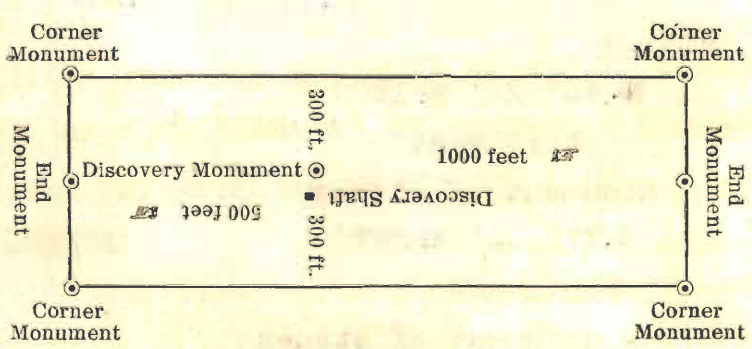

This diagram is to give locator a general idea of plan of location under the new law. The Discovery Shaft can be in the center of claim or any distance from either end desired. In the diagram it is placed 500 feet from one end and 1000 feet from the other. Commence description of claim at a center end monument, giving its distance and direction from center of Discovery Shaft; thence bound the claim in either direction. In description be careful to state locality of claim with reference to some natural object, or permanent monument, as will identify the claim.

#####

#####

#####

#####

#####

#####

#####

#####

#####

#####

STATE OF ARIZONA, }
COUNTY OF YAVAPAI. } ss.

I, L. S. Colwell, County Recorder in and for the County of Yavapai, State of Arizona, and custodian of the records of such office, do hereby certify that I have compared the foregoing copy with, and that the same is a full, true and correct copy of **BALTIMORE NO. 2, AMENDED NOTICE OF MINING LOCATION, - LODE CLAIM. SAME BEING LOCATED BY CHARLES W. CLARK, - BY C. V. HOPKINS, - as his AGENT; - AND** filed for record on **July 8th., A.D., 1915; at 2:45 O'clock P.M.** and as the same appears of record in my office in Book **86** of **MINES; -** at page **478,** and of the whole thereof.



IN WITNESS WHEREOF, I have hereunto set my hand and affixed my Official Seal this **30th.,** day of **September,** A. D. 191**5.**

L. S. Colwell
County Recorder.

4-688.

U. S. SURVEYOR-GENERAL'S FINAL CERTIFICATE ON FIELD NOTES.

Department of the Interior,

OFFICE OF U. S. SURVEYOR-GENERAL,

Phoenix, Arizona,

January 22, 1916.

I, U. S. Surveyor-General for District of Arizona

do hereby certify that the foregoing transcript of the Field Notes, return and approval of the survey of the mining claim of

United Verde Copper Company

known as the Baltimore No. 1, Baltimore No. 2.

situate in Verde

Mining District, Yavapai County, Arizona.

in Section 2, Township No. 15 N., Range No. 2 E., unsur., and

designated as Survey No. 3245, has been correctly copied from the originals on file in this office; that said Field Notes furnish such an accurate description of said mining claim as will, if incorporated into a patent, serve fully to identify the premises, and that such reference is made therein to natural objects or permanent monuments as will perpetuate and fix the *locus* thereof.

And I further certify that five hundred dollars' worth of labor has been expended or improvements or for each of made upon said mining claim^s by claimant or its grantors, and that said improvements consist of 2 cuts and 1 tunnel, total value \$8527. Tunnel No. 2 on the Baltimore No. 2 lode being a common improvement for the benefit and development of both of the lodes in this survey, an undivided one-half interest therein, value \$3638.50, is properly credited to each of said lodes.

and that no portion of said labor or improvements has been included in the estimate of expenditures upon any other claim.

I further certify that the plat thereof, filed in the U. S. Land Office at Phoenix,

Arizona, is correct and in conformity with the foregoing Field Notes.

Frank S. Ingalls,

United States Surveyor-General for Arizona.

4-687.

SURVEYOR-GENERAL'S CERTIFICATE OF APPROVAL OF FIELD NOTES AND SURVEY OF MINING CLAIM.

Department of the Interior,

Office of U. S. Surveyor-General,

Phoenix, Arizona,

January 22, 1916.

I, U. S. Surveyor-General for District of Arizona

do hereby certify that the foregoing and hereto attached Field Notes and Return of the Survey of the Mining Claim of

United Verde Copper Company

, known as the

Baltimore No. 1, Baltimore No. 2.

situate in Verde Mining District,

Yavapai County, Arizona.

in Section 2, Township No. 15 N., Range No. 2 E., un sur.

, designated as Survey No. 3245

executed by J. William Waara, U. S. Deputy Mineral

Surveyor, November 5, -9, 1915, under my instructions dated

October 2, 1915, have been critically examined and the necessary cor-

rections and explanations made, and the said Field Notes and Return, and the Survey they describe,

are hereby approved. A true copy of the copy of the location certificate filed by the applicant for

survey is included in the field notes.

Frank Ingalls

U. S. Surveyor-General for Arizona.