



United States Department of the Interior

BUREAU OF LAND MANAGEMENT

ARIZONA STATE OFFICE
2400 VALLEY BANK CENTER
PHOENIX, ARIZONA 85073

IN REPLY REFER TO

9632 (942)
M.S. # 3329

March 8, 1982

Memorandum

To: Chief, Branch of Lands and Minerals Operations
From: Chief, Branch of Cadastral Survey
Subject: Cancellation of Mineral Survey No. 3329

This memorandum cancels the survey of the Gold Cone, Bunker Hill, Mint and May Fraction lode claims of Mineral Survey No. 3329.

The following notation should be made on the plat of Mineral Survey No. 3329:

"Survey of Gold Cone, Bunker Hill, Mint and May Fraction lode claims cancelled by Chief, Branch of Cadastral Survey, memorandum dated March 8, 1982, File 9632 (942)."

A notation of this cancellation should also be made on the Mineral Mining District Sheet. This memorandum should be made a part of the original field notes. The plat and field notes should remain in the files.

These claims have not been recorded with the BLM in accordance with Section 314 of the Federal Land Policy and Management Act of 1976, and are considered to be invalid as noted in a memorandum from the Chief, Branch of Lands and Minerals Operations, dated March 5, 1982.

James P. Kelley

Platted

NOV 10 1916

MAR 7 - 1917

4-683.

Mineral Survey No. 3329

Lot No.

Arizona Land District.

FIELD NOTES

OF THE SURVEY OF THE MINING CLAIM OF

Liberty Bell Gold Mines Company.

KNOWN AS THE

Bunker Hill, Mint, Gold Cone, May fraction lodes.

San Francisco Mining District,

Mohave County, Arizona.

Sections 21, 22, 27, 28, Township 19 N., Range 20 W. unapproved G. & S.R.B. & M.

Surveyed under instructions dated July 17-1916, 1

by Alfred B. Colwell,

U. S. Deputy Mineral Surveyor

Claim located See location notices, 1

Survey commenced September 1-1916, 1

Survey completed September 30-1916, 1

Address of Claimant.

Care of J. P. Greeley,
643-644 Title Ins. Bldg.
Los Angeles, Cal.

1141a

TRANSCRIBED COPY OF ORIGINAL FIELD NOTES

MAY 7-1917 2

Survey No. 3329

1

BUNKER HILL LODE

Beginning at Cor. No. 1.

At the intersection of line 3-4, Sur. No. 1639, 35th Parallel lode, claimant unknown, and line 1-2, Gold Cone lode of this Survey, N. 13° 23' E. 411.18 ft. from Cor. No. 2 said Gold Cone lode.

A redwood post 4 x 4 ins. 4 ft. long, set 18 ins. in the ground, with mound of earth and rock, nail at corner point, scribed B-H-1-3329; Whence,

U. S. L.M. No. 1602 bears N. 0° 02' 10" E. 4925.40 ft.

Thence S. 81° 34' W.

195.35 Cor. No. 3, Sur. No. 1639, 35th Parallel lode.

301.40 North End Center.

A redwood post 4 x 4 ins. 4 ft. long, set 18 ins. in the ground, with mound of earth and rock, nail at center point, scribed N. E. C. B. H.-3329.

483.37 Intersect East End line Princess lode, unsurveyed, claimant unknown, at N. 10° 31' E.-380 ft. from S. E. Corner.

602.80 To Cor. No. 2.

A redwood post 4 x 4 ins. 4 ft. long, set 18 ins. in the ground, with mound of earth and rock, nail at corner point, scribed B. H. 2-3329; Whence,

S. E. Corner Princess lode, unsurveyed bears S. 7° 48' E.- 359.43 ft.

Thence S. 2° 19' E.

349.96 Intersect south side line Princess lode, unsurveyed, at N. 79° 29' W.-35.22 ft. from S. E. Corner.

1500.00 To Corner No. 3.

A redwood post 4 x 4 ins. 4 ft. long, set 18 ins. in the ground, with mound of earth and rock, nail at corner point, scribed B. H. 3-3329; Whence,

No bearing objects available.

Thence N. 81° 34' E.

.52 Cor. No. 2 Mint lode of this survey.

301.40 South End Center.

Survey No. 3329

1

BUNKER HILL LODE

Beginning at Cor. No. 1.

At the intersection of line 3-4, Sur. No. 1639, 35th Parallel lode, claimant unknown, and line 1-2, Gold Cone lode of this Survey, N. 13° 23' E. 411.18 ft. from Cor. No. 2 said Gold Cone lode.

A redwood post 4 x 4 ins. 4 ft. long, set 18 ins. in the ground, with mound of earth and rock, nail at corner point, scribed B-H-1-3329; Whence,

U. S. L.M. No. 1602 bears N. 0° 02' 10" E. 4925.40 ft.

Thence S. 81° 34' W.

195.35 Cor. No. 3, Sur. No. 1639, 35th Parallel lode.

301.40 North End Center.

A redwood post 4 x 4 ins. 4 ft. long, set 18 ins. in the ground, with mound of earth and rock, nail at center point, scribed N. E. C. B. H.-3329.

483.37 Intersect East End line Princess lode, unsurveyed, claimant unknown, at N. 10° 31' E.-380 ft. from S. E. Corner.

602.80 To Cor. No. 2.

A redwood post 4 x 4 ins. 4 ft. long, set 18 ins. in the ground, with mound of earth and rock, nail at corner point, scribed B. H. 2-3329: Whence,

S. E. Corner Princess lode, unsurveyed bears S. 7° 48' E.- 359.43 ft.

Thence S. 2° 19' E.

349.96 Intersect south side line Princess lode, unsurveyed, at N. 79° 29' W.-35.22 ft. from S. E. Corner.

1500.00 To Corner No. 3.

A redwood post 4 x 4 ins. 4 ft. long, set 18 ins. in the ground, with mound of earth and rock, nail at corner point, scribed B. H. 3-3329: Whence,

No bearing objects available.

Thence N. 81° 34' E.

.52 Cor. No. 2 Mint lode of this survey.

301.40 South End Center.

Identical with North End Center Mint lode of this survey.

A redwood post 4 x 4 ins. 4 ft. long, set 18 ins. in the ground, with mound of earth and rock, nail at center point, scribed B. H. S. E. C., M-N. E.C.-3329.

602.28 Cor. No. 1, Mint lode of this survey.

602.80 To Cor. No. 4.

A redwood post 4 x 4 ins. 4 ft. long, set 18 ins. in the ground, with mound of earth and rock, nail at corner point, scribed, B. H.4-3329: Whence, between Secs.

The 1/4 Cor./27 and 28 T. 19 N., R. 20 W., unapproved, G. S. R. B. & M., bears S. 55° 12' E. 578.58 ft.

Thence N. 2°19' W.

1076.94 Intersect line 2-3 Gold Cone lode of this survey, S. 78° 34' E. 114.35 ft. from Cor. No. 2.

1500.00 To Cor.No. 1, the place of beginning.

MINT LODGE

Beginning at Cor. No. 1.

On line 3-4 Bunker Hill lode of this survey, S. 81° 34' W.0.52 ft. from Cor. No. 4.

A redwood post 4 x 4 ins. 4 ft. long, set 18 ins. in the ground, with mound of earth and rock, nail at corner point, scribed M-1-3329: Whence,

U. S.L.M. No. 1602 bears N. 0°30'30" W. 6424.50 ft.

The 1/4 Cor. between Secs. 27 and 28, T. 19 N., R. 20 W., unapproved, G. & S. R. B. & M., bears S. 55° 14' E. 578.97 ft.

Thence S. 81° 34' W.

300.88 North End Center.

Identical with South End Center Bunker Hill lode of this survey, previously described.

601.76 To Cor. No. 2

A redwood post 4 x 4 ins. 4 ft. long, set 18 ins. in the ground, with mound of earth and rock, nail at corner point, scribed M-2-3329.

Thence S. 12° 49' E.

380.00

1189.73

Wagon road, course southwesterly and northeasterly. Intersect north side line Mulligan Queen lode, unsurveyed

ed, claimant unknown, at N.79°49'W.-783.87 ft. from N.E. corner.

1398.42 To Corner No. 3.

A redwood post 4 x 4 ins., 4 ft. long, set 18 ins. in the ground, with mound of earth and rock, nail at corner point, scribed M-3-3329: Whence,

No bearing objects available.

Thence N.81°34'E.

90.00 Wagon road, course southwest and northeast.

300.88 South End Center.

A redwood post 4 x 4 ins., 4 ft. long, set 18 ins. in the ground, with mound of earth and rock, scribed M.-S.E.C.-3329.

601.76 To Cor. No. 4.

On north side line Mulligan Queen lode, unsurveyed, at N.79°49'W.-132.06 ft. from the N.E.Cor.

A redwood post 4 x 4 ins., 4 ft. long, set 18 ins. in the ground, with mound of earth and rock, nail at corner point, scribed M-4-3329: Whence,

N.E.Cor. Mulligan Queen lode, unsurveyed, bears S.79°49'E.-132.06 ft.

Thence N.12°49'W.

110.00 Wagon road, course northeast and southwest.

1190.00 Wagon road, course northeast and southwest.

1398.42 To Cor. No. 1, the place of beginning.

GOLD CONE-LODE

Beginning at Cor. No. 1.

On southerly side line Golden Gate lode, unsurveyed, claimant unknown, at N.61°15'W.-655.67 ft. from the S.E.Cor.

A redwood post 4 x 4 ins., 4 ft. long, set 18 ins. in the ground, with mound of earth and rock, nail at corner point, scribed G.C.-1-3329: Whence,

SURVEY No. 3329.

U.S.L.M. No. 1602 bears N.3°41'W.-3874.17 ft.
 Cor. No. 4, Sur. No. 1639, 35th Parallel lode, claim-
 ant unknown, bears S.8°26'E.-1010.84 ft.
 Thence S.13°23'W.
 1.52 Intersect line 4-1 Sur. No. 1639, 35th Parallel lode
 at N.8°28'W.-1009.42 ft. from Cor. No.4.
 1088.82 Cor. No. 1 Bunker Hill lode of this survey, also intersect
 line 3-4 35th Parallel lode, Survey No. 1639, at S.81°
 34'W.-404.57 ft. from Cor. No. 4.
 1500.00 To Cor. No. 2.
 A redwood post 4 x 4 ins., 4 ft. long, set 18 ins. in
 the ground, with mound of earth and rock, nail at corner
 point, scribed G.C.2-3329: Whence,
 No bearing objects available.
 Thence S.78°34'E.
 114.35 Intersect line 4-1, Bunker Hill lode of this survey, S.2°19'E.
 423.06 ft. from Cor. No. 1.
 235.00 South End Center.
 A redwood post 4 x 4 ins., 4 ft. long, set 18 ins. in
 the ground, with mound of earth and rock, nail at center
 point, scribed S.E.C., G.C.-3329.
 535.00 To Cor. No. 3.
 Identical with Cor. No. 5, May Fraction lode of this
 survey.
 A redwood post 4 x 4 ins., 4 ft. long, set 18 ins. in
 the ground, with mound of earth and rock, nail at corner
 point, scribed G.C.3-M.F.5-3329.
 No bearing objects available.
 Thence N.13°23'E.
 1100.00 Wagon road, course N.22°W. and S.22°E.
 1334.85 Cor. No. 1, May Fraction lode of this survey, and in-
 tersect southerly side line Golden Gate lode, unsurveyed,
 at N.61°15'W.-101.16 ft. from the S.E.Cor.
 1500.00 To Cor. No. 4.
 A redwood post 4 x 4 ins., 4 ft. long, set 18 ins. in
 the ground, with mound of earth and rock, nail at corner

point, scribed G. C.1-3329: Whence,

The Cor. of Secs. 21, 22, 27 and 28, T. 19 N., R. 20 W., unapproved, G. & S. R. B. & M., bears S. 58° 50' W.-288.90 ft.

Thence N. 78° 34' W.

300.00 North End Center.

A redwood post, 4 x 4 ins., 4 ft. long, set 18 ins. in the ground, with mound of earth and rock, nail at center point, scribed N. E. C.-G. C. -3329.

335.00 Wagon road, course north and south.

535.00 To Cor. No. 1, the place of beginning.

MAY FRACTION LODE

Beginning at Cor.No. 1.

At the intersection of line 3-4 Gold Cone lode of this survey with the southerly side line of the Golden Gate lode, unsurveyed, at N. 61°15' W.-101.16 ft. from the southeast corner of the latter.

A redwood post 4 x 4 ins., 4 ft. long, set 18 ins. in the ground, with mound of earth and rock, with nail at corner point scribed M. F. 1-3329: Whence, U. S. L. M. No. 1602 bears N. ^{10° 05'}~~7° 31' 30"~~ W. 4197.71 ft.

The Cor. of Secs. 21, 22, 27 and 28 T. 19 N., R. 20 W., unapproved, G. & S. R. B. & M. bears N. 86° 56' W. -209.29 ft.

Thence S. 78° 34' E.

50.00 North End Center.

A redwood post 4 x 4 ins., 4 ft. long, set 18 ins. in the ground, with mound of earth and rock, nail at center point, scribed N. E. C.-M. F.-3329.

91.40 To Cor. No. 2.

On west side line Yellow Aster No. 1 lode, unsurveyed, claimant unknown, at N. 1°41' E. 402.9⁵ ft. from the west angle corner, and S. 1°41' W. 101.03 ft. from the N. W. Cor.

A redwood post 4 x 4 ins., 4 ft. long, set 18 ins. in the ground, with mound of earth and rock, nail at

A redwood post 4 x 4 ins., 4 ft. long, set 18 ins. in the ground, with mound of earth and rock, nail at corner point, scribed M.F. 2-3329.

Thence S. 1° 41' W.

30.55 S. E. Cor. Golden Gate lode, unsurveyed.

402.95 To Cor. No. 3

Identical with the west angle corner Yellow Aster No. 1 lode, unsurveyed.

A redwood post 4 x 4 ins., 4 ft. long, set 18 ins. in the ground, with mound of earth and rock, nail at corner point, scribed M. F.-3-3329.

Thence S. 18° 28' W.

150.00 Wagon road, course S. 13° E. and N. 13° W.

944.04 To Cor. No. 4

On west side line Yellow Aster No. 1 lode, unsurveyed, at N. 18° 28' E. -36.89 ft. from the S. W. Cor.

A redwood post 4 x 4 ins., 4 ft. long, set 18 ins. in the ground, with mound of earth and rock, nail at corner point, scribed M. F. 4-3329.

Thence N. 78° 34' W.

39.47 South End Center.

A redwood post 4 x 4 ins., 4 ft. long, set 18 ins. in the ground, with mound of earth and rock, nail at center point, scribed S. E. C. -M. F. 3329.

89.47 To Cor. No. 5.

Identical with Cor. No. 3 Gold Cone lode of this survey, previously described.

Thence N. 13° 23' E.

1100.00 Wagon road, course N. 22° W. and S. 22° E.

1334.85 To Cor. No. 1, the place of beginning.

Variation at all corners 14° 30' E.

LODE LINES

As near as may be determined from present developments, the veins of the locations embraced in this claim, extend from their respective discovery points, as follows:

Bunker Hill lode S. 2° 19' E. 115 ft. and N. 2° 19' W. 1385.0 ft. Mint lode, S. 12° 49' E. 175 ft. and N. 12° 49' W. 1223.42 ft.

Gold Cone lode, S. 13° 23' W. 970 ft. and N. 13° 23' E.
530 ft.

May Fraction lode, S. 13° 23' W. 1154.85 ft. and N. 13°
23' E. 180 ft.

A R E A S.

	ACRES
Total area Bunker Hill lode	20.638
Area in conflict with Princess lode, unsurveyed,	.631 A.
Total area Mint lode,	19.262
Area in conflict with: Mulligan Queen lode, unsurveyed,	1.437 A.
Total area Gold Cone lode,	18.412
Less area in conflict with: Sur. No. 1639-35th Parallel,	4.689 A.
Golden Gate lode, unsurveyed	1.013 A.
Bunker Hill lode of this survey,	.540 A.
Total area May Fraction lode,	4.030 ✓
Less area in conflict with: Golden Gate lode unsurveyed	.031 A.

The survey of this claim is identical with the amended location of the Bunker Hill, Mint and Gold Cone lodes, and with the original location of the May Fraction lode, as staked upon the ground.

LOCATION

This survey is located in the S. E. 1/4 Sec. 21, the S. W. 1/4 Sec. 22, the N.W. 1/4 Sec. 27 and the East 1/2 Sec. 28, T. 19 N., R. 20 W., unapproved, G. & S. R. B. & M.

ADJOINING CLAIMS

On the North:

Sur. No. 1639- 35th Parallel lode, Golden Gate lode, unsurveyed, claimants unknown.

On the East:

Yellow Aster No. 1 lode, unsurveyed, claimant unknown.

On the South:

Mulligan Queen lode, unsurveyed, claimant unknown.

On the West:

Sur. No. 1639-35th Parallel lode.
Princess lode, unsurveyed, claimant unknown.

EXPENDITURE OF FIVE HUNDRED DOLLARS.

I certify that the value of the labor and improvements made upon or for the benefit of each of the locations embraced in said mining claim by the claimant or its grantors is less than Five Hundred Dollars. and that said improvements consist of --

On the Bunker Hill lode:

No. 1 The discovery shaft, on the lode line, at N. 2° 19' W. 115 ft. from the South end Center, 4 x 6-1/2 ft. by 8 ft. deep. In rock.

Value, - - - - - \$60.00

No. 2 A shaft which bears from Cor. No. 3, N. 44°30'E. 350 ft. 3 1/2 x 6 ft., 96 ft. deep, the first 18 ft. being vertical, thence on a 75° dip to the west, to its bottom. In quartz and vein rock.

Value - - - - - \$1,152.00

No. 3 A shaft, which bears from Cor. No. 3, N. 31°20'E. -487 ft. 5 x 5 ft. 6 ft. deep, in rock.

Value, - - - - - \$35.00

No. 4 A shaft, which bears from Cor. No. 3, N. 29°50'E. 505 ft., 6 x 8 ft. deep, in rock.

Value - - - - - \$60.00

No. 5 A shaft on the lode line at N. 2°19'W. 655 ft. from the South End Center, 4 1/2 x 6 1/2 ft., 11 ft. deep, in vein rock,

Value, - - - - - \$100.00

No. 6 A shaft on the lode line at N. 2°19'W. -695 ft. from the South End Center, 4 x 6 1/2 ft. 10 ft. deep, in vein rock,

Value, - - - - - \$ 85.00

No. 7 A shaft on the lode line, at N. 2°19'W. -735 ft. from the South End center, 5 x 8 ft. 46 ft. deep, timbered. In vein rock,

Value, - - - - - \$920.00

On the Mint Lode

No. 1 The discovery shaft, on the lode line, at N.12°49' W.-
175 ft. from the South End Center. 4 x 6 ft. 9 ft. deep.
In altered andesite.

Value, - - - - - \$60.00

No. 2 A shaft, which bears from the North End Center, S.45°E.-
10 ft., 4 x 6 ft. 9 ft. deep, in mineralized andesite.

Value, - - - - - \$50.00

No. 3 A shaft, which bears from the North End Center, S. 80°E.-
55 ft., 4 x 6 ft. 8 ft. deep, in mineralized andesite.

Value, - - - - - \$50.00

No. 4 A shaft, which bears from the North End Center, S.84°E.-
25 ft., 4 x 6 ft. 8 ft. deep.

Value, - - - - - \$50.00

On the Gold Cone lode:

No. 1 The discovery cut, the face of which is on the lode line
at S. 13°23' W.-530 ft. from the North End Center, thence
south 10 ft. to mouth, 4 ft. wide, 8 ft. face,

Value, - - - - - \$50.00

No. 2 A shaft, which bears from Cor. No. 1, S.59°E.-106.5 ft.
4 x 7 ft. 30 ft. deep, in rock,

Value, - - - - - \$350.00

No. 3 A cut, the mouth of which bears from Cor. No. 1, S. 22°
10' E.-255 ft., running thence S.15°W.-16 ft. to face, 11
ft. high, 6 ft. wide, in rock,

Value, - - - - - \$75.00

On the May Fraction lode:

No. 1 The discovery shaft on the lode line, S.13°23' W.-180 ft.
from the North End Center, 4 x 6 ft., 10 ft. deep.

Value, - - - - - \$ 50.00

OTHER IMPROVEMENTS.

Corrugated iron building, the N.W. Cor. of which
bears from Cor.No. 2, Bunker Hill lode, S.18°30'E. 745 ft.
16 x 36 ft. Course of long side E. & W. Contains
hoisting plant and air compressor, belonging to claimant
herein.

INSTRUMENT.

This survey was made with a C. L. Berger & Son's transit. The courses were deflected from the true meridian, as determined by direct solar observations. The distances were measured with a steel tape.

REPORT

The lines of this claim and connections to adjoining and conflicting claims, were run direct upon the ground. U.S.L.M. No. 1602 is a basalt stone 8 x 15 x 14 ins. above the ground, chiseled with a cross (X) and U.S.L.M. 1602.

The common corner to Secs. 21-22-27-28, T. 19N., R. 20 W., unapproved, G. & S.R. B. & M., is a 2 in. iron pipe, properly set and marked.

The 1/4 Corner between Secs. 27 and 28, township and range aforesaid, is a 1 in. iron pipe, properly set and marked.

Sur. No. 1639 - 35th Parallel lode, corners Nos. 1 3 and 4, are 4 x 4 in. posts, properly set and marked.

Line 4-1 is N. 8°28' W. -1498.90 ft. instead of N. 8°20' W. 1500 ft.

Line 3-4 is N. 81°34' E. 599.92 ft. instead of N. 81°40' E. 600 ft.

Cor. No. 1 to U.S.L.M. No. 1602 is N. 2°59'20" W 3388.10 ft. instead of N. 3°08' 23"W. -3360.98 ft. as approved Golden Gate lode:

All corners are posts 4 x 4 ins. properly set and marked.

The southerly side line is N. 61°15' W. 916 ft. Princess lode:

All corners are 4 x 4 in. posts, properly set and marked.

The East End line is N. 10°31' E. 958 ft.

The South side line is N. 79°29' W. 1500 ft.

Mulligan Queen lode: Unsurveyed.

All corners are monuments of stone.

The northerly side line is N.79°49'W.-1500 ft.

Yellow Aster No. 1 lode:

All corners are 4 x 4 in. posts, properly set and marked.

The westerly side line runs S.1°41'W.-503.98^{ft} to angle corner, thence S.18°28'W.-980.93 ft.

NOTE

The discrepancies between these field notes and the location certificates upon which the order for survey is issued, are due to errors in the latter.

NOV. 10. 1916

NOV 1 - 1917

FINAL OATHS FOR SURVEYS.

LIST OF NAMES.

A list of the names of the individuals employed by Alfred B. Colwell

United States ~~Deputy~~ Mineral Surveyor, to assist in running, measuring, and marking the lines, corners, and boundaries described in the foregoing field notes of the survey of the mining claim of

Liberty Bell Gold Mines Company

known as the Bunker Hill, Mint, Gold Cone and May Fraction lodes.

and showing the respective capacities in which they acted.

J.S. Osborn, Chainman.

Chainman.

Arman.

Flagman.

FINAL OATHS OF ASSISTANTS.

~~XX~~ I J.S. Osborn

and _____, do solemnly swear that ~~We~~ assisted _____

Alfred B. Colwell, United States ~~Deputy~~ Mineral Surveyor, in marking the corners and surveying

the boundaries of the mining claim of Liberty Bell Gold Mines Company

known as the Bunker Hill, Mint, Gold Cone and May Fraction lodes.

represented in the foregoing field notes as having been surveyed by said ~~deputy~~ mineral surveyor and under his direction; and that said survey has been in all respects, to the best of our knowledge and belief, faithfully and correctly executed, and the corner and boundary monuments established according to law and the instructions furnished by the United States Surveyor-General for Arizona

J. S. Osborn, Chainman.

Chainman.

Arman.

Flagman.

6th.

Subscribed and sworn to by the above-named persons before me this _____

day of November 1916, ~~XXX~~

Joy May Bartz
Notary Public

My commission expires March 4, 1920.

NOV 10 1916
MAR 7 - 1917

(4-686.)

FINAL OATH OF U. S. ~~DEPUTY~~ MINERAL SURVEYOR

I, Alfred B. Colwell, U. S. ~~Deputy~~ Mineral Surveyor, do solemnly swear that, in pursuance of instructions received from the United States Surveyor General for Arizona, dated July 17-1916, I have, in strict conformity to the laws of the United States, the official regulations and instructions thereunder, and the instructions of said Surveyor General, faithfully and correctly executed the survey of the Mining Claim of Liberty Bell Gold Mines Company, known as the Bunker Hill, Mint. Gold Cone and May Fraction lodes, situate in San Francisco Mining District, Mohave County, Arizona, in Sections 21, 22, 27, 28 Township No. 19 N., Range No. 20 W. unapproved G. & S. R. B. & M. and designated as Survey No. 3329, as represented in the foregoing field notes, which accurately show the boundaries of said mining claim as distinctly marked by monuments on the ground, and described in the attached copy of the location certificate, which was received by me from the Surveyor General with said instructions, and that all the corners of said survey have been established and perpetuated in strict accordance with the law, official regulations and instructions thereunder; and I do further solemnly swear that the foregoing are the true and original field notes of said survey and my report therein, and that the labor expended and improvements made upon said mining claim by claimant or its grantors are as therein fully stated, and that the character, extent, location and itemized value thereof are specified therein with particularity and full detail, and that no portion of said labor or improvements so credited to this claim has been included in the estimate of expenditures upon any other claim.

Alfred B. Colwell
U. S. ~~Deputy~~ Mineral Surveyor.

Subscribed and sworn to by the said Alfred B. Colwell,
U. S. ~~Deputy~~ Mineral Surveyor, before me a Notary Public in and for
Mohave County, Arizona. this 6th.
day of November 1916.

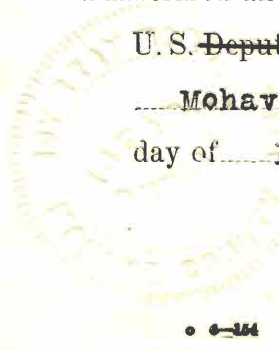

Wm. Gray Bartz
Notary Public
My Commission expires March 4, 1920

Amended Location Certificate

JUL 15 1916

KNOW ALL MEN BY THESE PRESENTS: That Liberty Bell Gold Mines Company by C. C.

Spicer

the undersigned citizen... of the United States, over the age of twenty-one years, having complied with all the requirements of the laws of the United States and the State of Arizona, relating to mining claims, and with the local laws, customs, rules and regulations of San Francisco Mining District, hereby make and file this --- amended location of the Bunker Hill Lode, claiming by right of discovery, location, primal appropriation and possession 1500 feet, linear and horizontal measurement, on this vein or lode of quartz, or other rock in place, bearing gold, silver and other valuable minerals, with all dips, variations and angles, the same being 115 feet along the ledge in a southerly direction from the shaft discovery ~~xxx~~ and 1385 feet along the ledge in a northerly direction therefrom, together with 300 feet in width on each side of the middle of said ledge, and all veins, lodes, ledges, mineral deposits, mineral and surface ground within the lines of said claim.

Situate in San Francisco Mining District, County of Mohave, State of Arizona, in --- and more particularly described as follows, to-wit:

Beginning at the Southeast corner, whence the 1/4 corner between sections 27 and 28 T. 19 N. R. 20 W. bears S. 55° 03' 30" E.-578.58 ft. Thence S. 81° 43' W.-301.40 ft. to the southerly end center Thence S. 81° 43' W.-301.40 ft. to the Southwest corner Thence N. 2° 10' W.-1500 ft. to the Northwest corner Thence N. 81° 43' E.-301.40 ft. to the Northerly end center Thence N. 81° 43' E.-301.40 ft. the Northeast corner Thence S. 2° 10' E.-1500 ft. to the place of beginning. All corners and end centers are marked by 4 x 4 in. posts.

by Casper Heck

THIS AMENDED LOCATION is made in conformity with the original location, made Jany. 1st., 1. 915 recorded March 11th, 1. 915, in Book J. J., Page 645, of Quartz Locations, in the office of the Recorder of said county, and it is made for the purpose of appropriating all ground within the boundaries hereinbefore described, and of more definitely describing the situation and boundaries of said lode, correcting any irregularities, informalities or errors, supplying omissions and correcting any defects which may have existed in the original location, or the record thereof, hereby waiving no rights acquired under and by virtue of said original location. And if the original location or the certificate thereof is void, then this location shall be an original location and this certificate an original certificate.

Date of Original Discovery Jany. 1st., 1915, A. D. 1.....

Date of Amended Location March 10-1916, A. D. 19.....

Attest: Liberty Bell Gold Mines Company
By C. C. Spicer

Recorded at the request of C. C. Spicer, at 9 o'clock A. M., March 13th, 1916, in Book I. I. of Mining Claims, Page 755., Records of Mohave County, Arizona.

J. W. Morgan
County Recorder.

Amended Location Certificate

KNOW ALL MEN BY THESE PRESENTS: That Liberty Bell Gold Mining Company.....
 ..by A. B. Rousselle.....
 the undersigned citizen... of the United States, over the age of twenty-one years, having complied with all the requirements of
 the laws of the United States and the State of Arizona, relating to mining claims, and with the local laws, customs, rules and regu-
 lations of San Francisco..... Mining District, hereby make and file this second..... amended
 location of the Mint..... Lode, claiming by right of discovery, location, primal appropriation
 and possession 1398.42..... feet, linear and horizontal measurement, on this vein or lode of quartz, or other rock
 in place, bearing gold, silver..... and other valuable minerals, with all dips, variations and angles, the same
 being 162..... feet along the ledge in a S. 12° 40' E...... direction from the dis-
 covery stake and 1236.42..... feet along the ledge in a N. 12° 40' W...... direction therefrom,
 together with 300..... feet in width on each side of the middle of said ledge, and all veins, lodes, ledges,
 mineral deposits, mineral and surface ground within the lines of said claim.

Situate in San Francisco..... Mining District, County of Mohave, State of Arizona, in
 and more particularly described as follows, to-wit:
Beginning at the northeast corner, whence the East 1/4 Cor. Sec.
28 T. 19 N. R. 20 W. G. & S. R. B. & M. bears S. 55° 03' E.-578.58 ft.
Thence S. 12° 40' E.-1398.42 ft. to the southeast corner
Thence S. 81° 43' W.-301.40 ft. to the south end center
Thence S. 81° 43' W.-301.40 ft. to the southwest corner
Thence N. 12° 40' W.-1398.42 ft. to the northwest corner
Thence N. 81° 43' E.-301.40 ft. to the north end center
Thence N. 81° 43' E.-301.40 ft. to the place of beginning.
All corners and end centers are marked by 4 x 4 in. posts.

..... by Casper Heck.....
 THIS AMENDED LOCATION is made in conformity with the original location, made January 1st., 1915,
 recorded March 11-1915....., in Book J. J......, Page 647....., of Quartz Locations, in the office of the
 Recorder of said county, and it is made for the purpose of appropriating all ground within the boundaries hereinbefore described,
 and of more definitely describing the situation and boundaries of said lode, correcting any irregularities, informalities or errors, sup-
 plying omissions and correcting any defects which may have existed in the original location, or the record thereof, hereby waiving
 no rights acquired under and by virtue of said original location. And if the original location or the certificate thereof is void, then
 this location shall be an original location and this certificate an original certificate.

Date of Original Discovery January 1-1915....., A. D. 1.....
 Date of Amended Location June 19-1916....., A. D. 19.....

Attest: Liberty Bell Gold Mining Co.....
 ..By A. B. Rousselle.....

Recorded at the request of A. B. Rousselle....., at XXXXXXXX 9 o'clock A. M.,
June 26th, 1916,
 in Book P. P. of Mining Claims, Pages 549-550 Records of Mohave County, Arizona.

..... J. W. Morgan.....
 County Recorder.
 By J. T. Morgan, Deputy.

Amended Location Certificate

KNOW ALL MEN BY THESE PRESENTS: That Liberty Bell Gold Mines Company by

C. C. Spicer

the undersigned citizen... of the United States, over the age of twenty-one years, having complied with all the requirements of the laws of the United States and the State of Arizona, relating to mining claims, and with the local laws, customs, rules and regulations of San Francisco Mining District, hereby make and file this ~~---~~ amended location of the Gold Cone Lode, claiming by right of discovery, location, primal appropriation and possession 1500 feet, linear and horizontal measurement, on this vein or lode of quartz, or other rock in place, bearing gold, silver and other valuable minerals, with all dips, variations and angles, the same being 970 feet along the ledge in a southwest direction from the discovery ~~site~~ ^{cut} and 530 feet along the ledge in a Northeast direction therefrom, together with 300 feet in width on each side of the middle of said ledge, and all veins, lodes, ledges, mineral deposits, mineral and surface ground within the lines of said claim.

Situate in San Francisco Mining District, County of Mohave, State of Arizona, in ~~---~~ and more particularly described as follows, to-wit:

Beginning at the Northeast corner, whence the Northwest corner
Section 27 T. 19 N. R. 20 W. bears S. 58° 59' 20" W.-288.9 ft.
Thence S. 13° 32' W.-1500 ft. to the southeast corner
Thence N. 78° 25' W.-300 ft. to the southwest end center.
Thence N. 78° 25' W.-235 ft. to the Southwest corner
Thence N. 13° 32' E.-1500 ft. to the Northwest corner
Thence S. 78° 25' E.-235 ft. to the Northeast end center
Thence N. 78° 25' E.-300 ft. to the place of beginning.
All corners and end centers are marked by 4 x 4 in. posts.

by Casper Heck

THIS AMENDED LOCATION is made in conformity with the original location, made [^] Jany. 1st., 1915., recorded March 11th, 1915, in Book J.J., Page 646, of Quartz Locations, in the office of the Recorder of said county, and it is made for the purpose of appropriating all ground within the boundaries hereinbefore described, and of more definitely describing the situation and boundaries of said lode, correcting any irregularities, informalities or errors, supplying omissions and correcting any defects which may have existed in the original location, or the record thereof, hereby waiving no rights acquired under and by virtue of said original location. And if the original location or the certificate thereof is void, then this location shall be an original location and this certificate an original certificate.

Date of Original Discovery Jany. 1st. 1915, A. D. 1.....

Date of Amended Location March 10-1916, A. D. 19.....

Attest: Liberty Bell Gold Mines Company
By C. C. Spicer

Recorded at the request of C. C. Spicer, at ~~XXXXXX~~ 9 o'clock A.M., March 13th, 1916, in Book I.I. of Mining Claims, Page 755-756 records of Mohave County, Arizona.

J. W. Morgan
County Recorder.

Notice of Mining Location

LODE CLAIM

TO ALL WHOM IT MAY CONCERN:

This Mining Claim, the name of which is the May Fraction Mining Claim, situate on lands belonging to the United States of America, and in which there are valuable mineral deposits, was entered upon and located for the purposes of exploration and purchase by H. C. Taber

A Citizen of the United States

(Locator must insert either "a citizen of the United States," or "who has declared his intention to become a citizen of the United States.")

the undersigned, on the 8th day of January, 1916.

The length of this claim is 1334.85 feet,

and I claim 180 feet,

in a Northeasterly direction and 1154.85

feet in a Southwesterly direction from

the center of the discovery shaft, at which this notice is posted, lengthwise of the claim, together

with 300 or less feet in width of the surface grounds, on each side

of the center of said claim. The general course of the lode deposit and premises is from the

South West to the North East

The claim is situated and located in the San Francisco Mining District, in

Mohave County in the State of Arizona, about ---

in a --- direction from ---

From the N. W. Cor. the N. W. Cor. Sec 27 T. 19 N. R. 20 W.

Bears N. 86° 47' 20" W. 209.29 ft.

The surface boundaries of the claim are marked upon the ground as follows: Beginning at

A 4 x 4 in. Post

at a point in a S. 13° 32' W. direction --- feet from

the discovery shaft (at which this notice is posted), being in the center of the North east

end line of said claim; thence S. 78° 25' E. 41.40 feet to a 4 x 4 in. post

being the North east corner of said claim; thence

S. 1° 50' W.-402.97 ft. to the East Angle Corner a 4 x 4 in. post

thence S. 18° 37' W.-944.04 feet to a 4 x 4 in. post, being at the

South East corner of said claim; thence N. 78° 25' W.-39.47 feet

to a 4 x 4 in. post at the center of the South West end of said claim;

thence N. 78° 25' W-50 feet to a 4 x 4 in. post being at the

Southwest corner of said claim; thence N. 13° 32' E.-1334.85 feet

to a 4 x 4 in. Post at the North West corner of said claim;

thence S. 78° 25' E.-50 feet to the place of beginning.

Dated and posted on the ground this 8th day of January, 1916.

H. C. Taber

Filed and recorded at request of E. G. Bettis April 5th A. D. 1916 at one o'clock P. M., in Book O.O. at Page 784.

J. W. Morgan
County Recorder.

County of

I,, County Recorded in and for the County and State aforesaid, do hereby certify that the within instrument was filed for record at o'clock M., on this day of, 19, and duly recorded in Book No. of Record of County, Arizona, at pages

WITNESS my hand and official seal the day and year first above written.

County Recorder,

Notice of Location

LODE CLAIM

Dated, 19

Filed and Recorded at request of

....., A. D. 19

at M.,

Book

Pages

County Recorder.

By Deputy Recorder.

Oatman Printing Co.

Excerpts from the Mining Laws of the State of Arizona Title XLVII of the Revised Statutes of 1901, and Amendments thereto.

Sec. 2. Such location shall be made by erecting at or contiguous to the point of discovery a conspicuous monument of stones not less than three feet in height, or an upright post, securely fixed, projecting at least four feet above the ground, in which post there shall be posted a location notice which shall be signed by the name or names of the locator or locators.

Sec. 4. From the time of the location of a mining claim, as above specified, the locator shall be allowed ninety days within which to do or cause to be done the following things:

2. To sink a discovery shaft in the claim to a depth of at least eight feet from the lowest part of the rim of the shaft at the surface, and deeper, if necessary, until there is disclosed in said shaft mineral in place.

Sec. 6. Such surface boundaries shall be marked by six substantial posts projecting at least four feet above the surface of the ground, or by substantial stone monuments at least three feet high, to-wit: One at each corner of said claim and one at the center of each end-line thereof.

Sec. 8. Location notices may be amended at any time and the monuments changed to correspond with the amended location; Provided, That no change shall be made that will interfere with the rights of others.

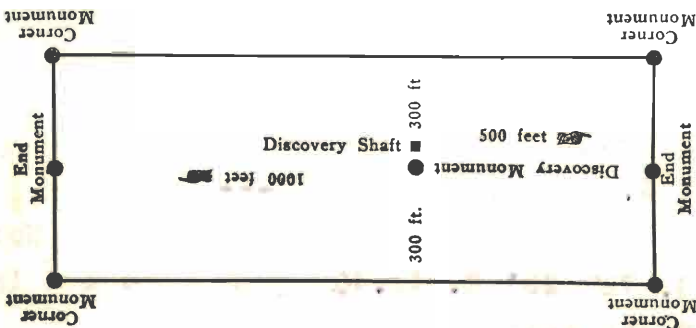

This diagram is to give locator a general idea of plan of location under the new law. The Discovery Shaft can be in the center of claim or any distance from either end desired. In the diagram it is placed 500 feet from one end and 1000 feet from the other. Commence description of claim at a center end monument, giving its distance and direction from center of Discovery Shaft; thence bound the claim in either direction. In description be careful to state locality of claim with reference to some natural object, or permanent monument, as will identify the claim.

RECORDER'S CERTIFICATE.

STATE OF ARIZONA,)
)-SS.
 County of Mohave.)

I, J. W. Morgan, Recorder of Mohave County, State of Arizona, do hereby certify that I have compared the foregoing copies of amended location certificates of the BUNKER HILL, GOLD CONE and MINT lode mining claims, and of notice of location of the MAY FRACTION lode mining claim, all of said lode mining claims located and situated in the San Francisco mining district, County of Mohave, State of Arizona, and of the endorsements thereon with the original records thereof on file in this office, and that the same are correct transcripts therefrom and of the whole of said original records.

WITNESS my hand and official seal this 7th day of JULY, A.D.
 1916.



J. W. MORGAN,

Recorder of Mohave County,
 State of Arizona.

By J. T. Morgan
 Deputy.



U. S. SURVEYOR-GENERAL'S FINAL CERTIFICATE ON FIELD NOTES.

Department of the Interior,

OFFICE OF U. S. SURVEYOR-GENERAL,

Phoenix, Arizona,

July 5, 1917.

I, U. S. Surveyor-General for District of Arizona

do hereby certify that the foregoing transcript of the Field Notes, return and approval of the survey of the mining claim of

LIBERTY BELL GOLD MINES COMPANY

known as the BUNKER HILL, MINT, GOLD CONE, MAY FRACTION LODES.

situate in SAN FRANCISCO

Mining District, MOHAVE County, ARIZONA.

in Sections 21, 22, 27, Township No. 19 N., Range No. 20 W., unapp'd.

designated as Survey No. 3329, has been correctly copied from the originals on file in

this office; that said Field Notes furnish such an accurate description of said mining claim as will, if incorporated into a patent, serve fully to identify the premises, and that such reference is made therein to natural objects or permanent monuments as will perpetuate and fix the locus thereof.

And I further certify that five hundred dollars' worth of labor has been expended or improvements made upon said ^{Mint} mining claim by claimant or its grantors, and that said improvements consist of and that less than five hundred dollars' worth of labor has been expended or improvements made upon each of the following claims, Bunker Hill, Gold Cone and May Fraction lodes, and that said improvements consist of 13 shafts and 2 cuts, total value \$3147.

and that no portion of said labor or improvements has been included in the estimate of expenditures upon any other claim.

I further certify that the plat thereof, filed in the U. S. Land Office at Phoenix,

Arizona, is correct and in conformity with the foregoing Field Notes.

Frank P. Trott,

United States Surveyor-General for Arizona.

SURVEYOR-GENERAL'S CERTIFICATE OF APPROVAL OF FIELD NOTES AND SURVEY OF MINING CLAIM.

Department of the Interior,

OFFICE OF U. S. SURVEYOR-GENERAL,

Phoenix, Arizona

July 5, 1917

I, U. S. Surveyor-General for District of Arizona

do hereby certify that the foregoing and hereto attached Field Notes and Return of the Survey of the

Mining Claim of

LIBERTY BELL GOLD MINES COMPANY

, known as the

BUNKER HILL, MINT, GOLD CONE, MAY FRACTION LODES

situate in SAN FRANCISCO mining district,

MOHAVE County, ARIZONA.

in Sections 21, 22, 27, 28, Township No. 19 N., Range No. 20 W., unapp'd.

, designated as Survey No. 3329

executed by Alfred B. Colwell, U. S. Deputy Mineral

Surveyor, September 1-30, 1916, under my instructions dated

July 17, 1916, have been critically examined and the necessary cor-

rections and explanations made, and the said Field Notes and Return, and the Survey they describe,

are hereby approved. A true copy of the copy of the location certificate filed by the applicant for

survey is included in the field notes.

[Handwritten signature]

U. S. Surveyor-General for Arizona.