

May 1917  
JUL 16 1917

Platted

4-683

MINERAL SURVEY No. 3388

LOT No.

ARIZONA Land District.

FIELD NOTES

OF THE SURVEY OF THE MINING CLAIM OF

BISBEE WARREN COPPER CO.

KNOWN AS THE

WILDFLOWER lode

WARREN Mining District,

COCHISE County, ARIZONA

Section 18, Township 23 South, Range 25 East

Surveyed under instructions dated April 24th, 1917

by Ralph L. Motz  
U. S. Mineral Surveyor.

Claim located See location notice, 19 17

Survey commenced April 28th, 19 17.

Survey completed April 28th, 19 17.

Address of claimant Bisbee, Arizona, Box 1129

~~Address of claimant's attorney, Fred Sutter, Attorney,~~

~~DATES OF AMENDED LOCATIONS. Bisbee, Arizona.~~

## WILDFLOWER lode.

Beginning at Cor No 1, identical with Cor No 2 Sur No 3390 Golconda lode, and situated on line 1-4 Sur No 2425 Delta lode at N 88° 55' W 443.5 ft from Cor No 4 and S 88° 55' E 1056.5 ft from Cor No 1, a pine post 4 ft long 4 ins sq set 18 ins in the ground in a mound of stones and scribed 1-3388 W, whence the original location for the N W Cor, being a mound of stones 3 ft high with a 3 ft base, brs N 2° 24' E 221.2 ft. No bearing rocks available. The W 1/4 Cor of Sec 18 T 23 S., R 25 E., G & S R B & M brs N 88° 15' W 1651.0 ft.

thence S 88° 55' E

443.5 along line 1-4 Sur No 2425 Delta lode to Cor No 2, identical with Cor No 4 Sur No 2425 Delta lode, a pine post 4 ft long 4 ins sq set 18 ins in the ground in a mound of stones and scribed 2-3388 W. No bearing rocks available.

thence N 2° 24' E

102.3 along line 4-3 Sur No 2425 Delta lode to Cor No 3, identical with Cor No 4 Sur No 2062 Golden Era No 1 lode, a pine post 4 ft long 4 ins sq set 18 ins in the ground in a mound of stones and scribed 3-3388 W, whence Cor No 3 Sur No 2425 Delta lode brs N 2° 24' E 497.7 ft., and the original location for the N W Cor brs N 73° 49' W 456.5 ft.

thence S 73° 49' E

1000.0 along line 4-3 Sur No 2062 Golden Era No 1 lode to Cor No 4, the N E Cor, identical with location and with Cor No 3 Sur No 2062 Little Era lode, and situated on line 3-4 Sur No 2062 Golden Era No 1 lode at N 73° 49' W 500.0 ft from Cor No 3, a pine post 4 ft long 4 ins sq set 18 ins in the ground in a mound of stones and scribed 4-3388 W, whence a sandstone ledge with 22 x 11 x 15 ins high exposure and chiseled BR x 4-3388 brs S 39° 13' E 25.8 ft,

thence S 2° 24' W

300.0 along line 3-2 Sur No 2062 Little Era lode, to original location for east end center, being a mound of stones 3 ft high with a 3 ft base,

500.0 to Cor No 2 and the northwest corner of Sur No 2062 Little Era lode and American lode unsurveyed, respectively,

600.0 to Cor No 5, the S. E Cor, identical with location and with the northeast corner of Anvil lode unsurveyed, a pine post 4 ft long 4 ins sq set 18 ins in the ground in a mound of stones and scribed 5-3388 W, whence a sandstone ledge with 17 x 18 x 4 ins high exposure and chiseled BR x 5-3388 brs S 20° 07' E 53.2 ft., and a second sandstone ledge with 17 x 13 x 4 ins high exposure with like chiseling brs S 44° 39' W 60.1 ft.

thence N 73° 49' W

1456.5 to Cor No 6, the S W Cor, identical with location and with the N W Cor of Anvil lode unsurveyed, and situated on line 2-3 Sur No 3390 Golconda lode, a pine post 4 ft long 4 ins sq set 18 ins in the ground in a mound of stones and scribed 6-3388 W, whence a sandstone rock in place 14 x 11 x 4 ins above ground chiseled BR x 6-3388 brs N 81° 20' E 6.2 ft, and a second sandstone rock in place 18 x 12 x 18 ins above ground with like chiseling brs S 36° 31' W 49.0 ft.

thence N 2° 24' E

300.0 to original location for west end center, being a mound of stones 3 ft high with a 3 ft base,

378.8 to Cor No 1, the place of the beginning.

LEDGE.

The presumed course of the vein on this claim is from the west end center S 73° 49' E 1456.5 ft.

AREA.

Total area Wildflower lode - - - - - 17.839 A.

IMPROVEMENTS.

I certify that the value of the labor and improvements made upon said mining claim by the claimant or its grantors is not less than five hundred dollars, and that said improvements consist of:-

No.1.	Discovery shaft 4 x 6 x 8nft deep brs from west end center on lode line 200 feet.	Value	\$ 50.00
No.2.	Open cut 4 x 8 x 15 ft long with tunnel in face 3.5 x 6 x 45 ft long, both brg S 85° W, the mouth of open cut brs from east end center N 24° 26' W 66.0 ft.	Value	\$500.00
	Total		\$550.00

## OTHER IMPROVEMENTS.

Open cut 5 x 8, x 17 ft long brg N 66° W, the mouth of  
which brs from east end center S 84° 53' W 26.5 ft.

Open cut 7 x 6 x 17 ft long brg N 80° W, the mouth of  
which brs from east end center S 88° 12' W 170.1 ft.

## ADJOINING CLAIMS.

North. Sur No 2425 Delta lode, Sur No 2062 Golden Era No 1 lode.

East. Sur No 2062 Little Era lode, American lode, unsurveyed,  
owned by John FitzPatrick.

South. Anvil lode, unsurveyed, owned by John FitzPatrick.

West. Golconda<sup>Lode</sup>, Sur No 3390.

## LOCATION.

This survey is located in Sec 18 T 23 S., R 25 E., G. & S R  
B & M.

## INSTRUMENT.

This survey was made with a Gurley Light Mountain transit.  
The courses were deflected from the true meridian as  
determined by a direct solar observation. The distances  
were measured with a 300 foot steel tape. Magnetic variation  
12° 30' East at all corners.

## REPORT.

The W 1/4 Cor of Sec 18, T 23 S., R 25 E, is an iron pipe  
1" in diameter set in the ground, with a 2" brass cap  
marked 1/4 S 18.

*Ralph L. Moad*  
U.S. Mineral Surveyor.

Dated at Bisbee, Arizona.

May 22nd, 1917.

JUL 16 1917

# FINAL OATHS FOR SURVEYS.

## LIST OF NAMES.

A list of the names of the individuals employed by Ralph L. Motz  
 United States ~~Deputy~~ Mineral Surveyor, to assist in running, measuring, and marking the lines, corners, and  
 boundaries described in the foregoing field notes of the survey of the mining claim of  
Bisbee Warren Copper Co.,  
 known as the WILDFLOWER lode  
 and showing the respective capacities in which they acted.

J. H. Duncan, Chainman.  
 \_\_\_\_\_, Chainman.  
 \_\_\_\_\_, Axman.  
 \_\_\_\_\_, Flagman.

## FINAL OATHS OF ASSISTANTS.

~~We~~, I J. H. DUNCAN  
 and \_\_\_\_\_, do solemnly swear that we assisted  
Ralph L. Motz, United States ~~Deputy~~ Mineral Surveyor, in marking the corners and surveying  
 the boundaries of the mining claim of Bisbee Warren Copper Co.,  
 known as the WILDFLOWER lode  
 represented in the foregoing field notes as having been surveyed by said ~~deputy~~ mineral surveyor and under his  
 direction; and that said survey has been in all respects, to the best of our knowledge and belief, faithfully and  
 correctly executed, and the corner and boundary monuments established according to law and the instructions  
 furnished by the United States Surveyor-General for Arizona.

J. H. Duncan, Chainman.  
 \_\_\_\_\_, Chainman.  
 \_\_\_\_\_, Axman.  
 \_\_\_\_\_, Flagman.

Subscribed and sworn to by the above-named persons before me this 22 nd

day of May, 19 17.

J. W. Ross

Notary Public in and for the County  
 of Cochise, State of Arizona.

## FINAL OATH OF U. S. MINERAL SURVEYOR.

I, Ralph L. Motz, U. S. Mineral Surveyor, do solemnly swear that, in pursuance of instructions received from the United States Surveyor General for Arizona, dated April 24, 1917, I have, in strict conformity to the laws of the United States, the official regulations and instructions thereunder, and the instructions of said Surveyor General, faithfully and correctly executed the survey of the Mining Claim of

Bisbee Warren Copper Co

known as the WILDFLOWER lode

Situate in the Warren Mining District, Cochise County, Arizona, in Section 18, T.<sup>N</sup> 23 S, R.<sup>N</sup> 25 E, G & S R B & M and designated as Survey No. 3388

as represented in the foregoing field notes, which accurately show the boundaries of said mining claim as distinctly marked by monuments on the ground, and described in the attached copy of the location certificate, which was received by me from the Surveyor General with said instructions, and that all the corners of said survey have been established and perpetuated in strict accordance with the law, official regulations and instructions thereunder: and I do further solemnly swear that the foregoing are the true and original field notes of said survey and my report therein, and that the labor expended and improvements made upon said mining claim by claimant or its grantors are as therein fully stated, and that the character, extent, location and itemized value thereof are specified therein with particularity and full detail, and that no portion of said labor or improvements so credited to this claim has been included in the estimate of expenditures upon any other claim.

Ralph L. Motz

U. S. Mineral Surveyor

Subscribed and sworn to by the said Ralph L. Motz,  
U. S. Mineral Surveyor, before me J. W. Ross  
Notary Public, this 22 nd day of May 1917.

J W Ross

Notary Public in and for the  
County of Cochise, State of  
Arizona.

My Commission expires Feb'y 21, 1920.

APR 24 1917

# Notice of Mining Location

## LODE CLAIM

TO ALL WHOM IT MAY CONCERN:

This Mining Claim, the name of which is the Wildflower  
Mining Claim, situate on lands belonging to the United States of America, and in which there are  
valuable mineral deposits, was entered upon and located for the purpose of exploration and purchase  
by A. H. Livingston,

a citizen of the United States  
(Locator must insert either "a citizen of the United States," or "who has declared his intention to become a citizen of the United States.")

the undersigned, on the 21st day of March, 1917

The length of this claim is 1500 feet,  
and I claim 200 feet,  
in a westerly direction and 1300  
feet in a easterly direction from

the center of the discovery shaft, at which this notice is posted, lengthwise of the claim, together with  
300 feet in width of the surface grounds, on each side  
of the center of said claim. The general course of the lode deposit and premises is from the  
west to the east

~~located in the~~ this claim is located in the Warren Mining District, in  
Cochise County in the State of Arizona, about 2 miles

in an easterly direction from the American Saginaw Shaft, it is  
bounded on the west by the Golconda claim, on the north by Mineral  
Survey No 2425 Delta lode, and the Golden Era No 1 lode Mineral Survey  
No 2062, and on the east by the Little Era lode Mineral Survey No  
2062.

The surface boundaries of the claim are marked upon the ground as follows: Beginning at

a monument of stones

at a point in a westerly direction 200 feet from  
the discovery shaft (at which this notice is posted), being in the center of the west  
end line of said claim; thence northerly 300 feet to a post and  
monument, being the northwest corner of said claim; thence  
easterly 1500 feet to a post and monument, being at the  
northeast corner of said claim; thence southerly 300 feet  
to a monument of stones at the center of the east end of said claim;  
thence southerly 300 feet to a post and monument being at the  
southeast corner of said claim; thence westerly 1500 feet  
to a post and monument at the southwest corner of said claim;  
thence northerly 300 feet to the place of beginning.

Dated and posted on the grounds this 21st day of March, 1917.

A. H. Livingston

STATE OF ARIZONA,

County of COCHISE ss.

I, [Signature] County Recorder in and for the County and State aforesaid, do hereby certify that the within instrument was filed for record at [Signature] o'clock P. M., on this MAR 23 1917 day of 19, and duly recorded in Book No. 57 of Records of COCHISE County, Arizona, at pages 431.

WITNESS my hand and official seal the day and year first above written.

By H L Hutchinson [Signature]

County Recorder.

2758

Notice of Location  
LODE CLAIM

FILED TO BE RECORDED

[Blank lines for location details]

Dated [Signature], 19

Filed and Recorded at request of

[Signature]

MAR 23 1917, A. D. 19

at [Signature] M.,

Book 57

Pages 431

[Signature] County Recorder.

[Signature] Deputy Recorder.

[Signature]

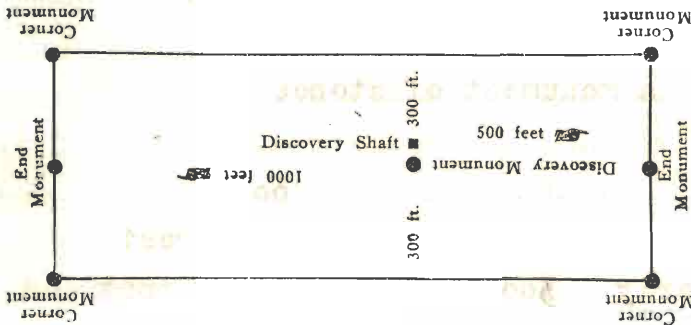

This diagram is to give locator a general idea of plan of location under the new law. The Discovery Shaft can be in the center of claim or any distance from either end desired. In the diagram it is placed 500 feet from one end and 1000 feet from the other. Commence description of claim at a center end monument, giving its distance and direction from center of Discovery Shaft; thence bound the claim in either direction. In description be careful to state locality of claim with reference to some natural object, or permanent monument, as will identify the claim.

Excerpts from the Mining Laws of the State of Arizona.

Title XLVII of the Revised Statutes of 1901, and Amendments thereto.

Sec. 2. Such location shall be made by erecting at or contiguous to the point of discovery a conspicuous monument of stones not less than three feet in height, or an upright post, securely fixed, projecting at least four feet above the ground, in which monument of stones or on which post there shall be posted a location notice which shall be signed by the name or names of the locator or locators.

Sec. 4. From the time of the location of a mining claim, as above specified, the locator shall be allowed ninety days within which to do or cause to be done the following things:

2. To sink a discovery shaft in the claim to a depth of at least eight feet from the lowest part of the rim of the shaft at the surface, and deeper, if necessary, until there is disclosed in said shaft mineral in place.

Sec. 6. Such surface boundaries shall be marked by six substantial posts projecting at least four feet above the surface of the ground, or by substantial stone monuments at least three feet high, to-wit: One at each corner of said claim and one at the center of each end-line thereof.

Sec. 8. Location notices may be amended at any time and the monuments changed to correspond with the amended location; Provided, That no change shall be made that will interfere with the rights of others.



U. S. SURVEYOR-GENERAL'S FINAL CERTIFICATE ON FIELD NOTES.

Department of the Interior,

OFFICE OF U. S. SURVEYOR-GENERAL,

Phoenix, Arizona.

October 2, 1917.

I, U. S. Surveyor-General for District of Arizona

do hereby certify that the foregoing transcript of the Field Notes, return and approval of the survey of the mining claim of

Bisbee Warren Copper Co.,

known as the WILDFLOWER Lode

situate in Warren

Mining District, Cochise County, Arizona

in Section 18, Township No. 23 S, Range No. 25 E., and

designated as Survey No. 3388, has been correctly copied from the originals on file in this office; that said Field Notes furnish such an accurate description of said mining claim as will, if incorporated into a patent, serve fully to identify the premises, and that such reference is made therein to natural objects or permanent monuments as will perpetuate and fix the locus thereof.

And I further certify that five hundred dollars' worth of labor has been expended or improvements made upon said mining claim by claimant or its grantors, and that said improvements consist of 1 shaft, 1 cut & tunnel, total value \$550.

and that no portion of said labor or improvements has been included in the estimate of expenditures upon any other claim.

I further certify that the plat thereof, filed in the U. S. Land Office at Phoenix,

Arizona, is correct and in conformity with the foregoing Field Notes.

Frank P. Trott,

United States Surveyor-General for Arizona.

SURVEYOR-GENERAL'S CERTIFICATE OF APPROVAL OF FIELD  
NOTES AND SURVEY OF MINING CLAIM.

Department of the Interior,

OFFICE OF U. S. SURVEYOR-GENERAL,

Phoenix, Arizona.

October 2, 1917.

I, U. S. Surveyor-General for District of Arizona,

do hereby certify that the foregoing and hereto attached Field Notes and Return of the Survey of the  
Mining Claim of

Bisbee Warren Copper Co.,

, known as the

WILDFLOWER Lode

situate in Warren mining district,

Cochise County, Arizona

in Section 18, Township No. 23 S, Range No. 25 E.

, designated as Survey No. 3388

executed by Ralph L. Motz, United States Mineral

Surveyor, April 28, 1917, under my instructions dated

April 28, 1917, have been critically examined and the necessary cor-

rections and explanations made, and the said Field Notes and Return, and the Survey they describe,

are hereby approved. A true copy of the copy of the location certificate filed by the applicant for

survey is included in the field notes.

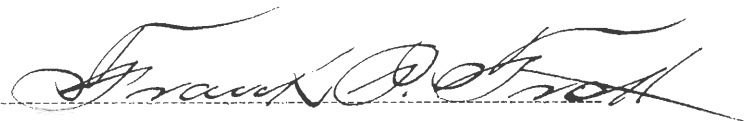

U. S. Surveyor-General for Arizona.