

Copied 5-17-1918 ARC

4-683

8 hrs

P. Lattal

AUG 7-1917

OCT 2-1917

NOV 10 1918

MINERAL SURVEY No. 3397

LOT No. ....

Arizona Land District.

### FIELD NOTES

OF THE SURVEY OF THE MINING CLAIM OF

Tejon Mining Co.

KNOWN AS THE

Olimar, Gladys, Gladys No. 2, Gladys No. 3, Gladys No. 4, Gertrude, El Capitain, Mary S., Elliott and El General.

Turquoise Mining District,

Cochise County, Arizona

Sections 5 and 6, Township 20S, Range 25E.

Surveyed under instructions dated May 8, 1917

by John A. Rockfellow  
U. S. Mineral Surveyor.

Claim located See Notices, 19

Survey commenced May 20, 1917

Survey completed June 22, 19 17

Address of claimant L. E. Thiers, Supt., Tucson Ariz.

DATES OF AMENDED LOCATIONS.

.....  
.....  
.....

OLEMA LODE.

Beginning at Cor. No. 1. Set an iron pipe 2 ins. diam. 3 ft. long 14 ins. in the ground to hardpan in a base of concrete: the pipe chiseled 1-3397-0 and base graven NWC-0.

Whence: The closing corner between secs. 5-6 Tp 20 S. R. 25 E. on N. boundary of township bears N. 86° 50' W. 188.7 ft.

U.S. Mineral Monument No. 1 of Tourquoise District bears N. 14° 26' W. 7128.0 ft.

Corner of location a mound of earth and stone bears N. 19° 42' W. 38 ft.

Thence N. 57° 40' E. Va. 13° 20' E.

9.75 N. Center End raise a mound of stone 3 ft. base 3 ft.

high whence N. Center End location a monument of earth and stone bears N. 26° 50' W. 38 ft.

19.5 To Cor. No. 2. Set an iron pipe 2 ins. diam 3 ft. long

18 ins. in ground in a base of concrete, the pipe chiseled 2-3397-0, the base graven NEC-0

Whence the closing corner between sec. 5-6 Tp 20 S. R. 25 E. bears West 204.9 ft.

Corner of location, a mound of earth and stone bears N. 37° 28' W. 38 ft.

Thence S. 37° 28' E. Va. 13° 20' E.

571.2 To Cor. No. 3, identical with location and with Cor. No.

1 Gladys lode of this survey a pine post in a mound of stone scribed NWC-G.

In its place set an iron pipe 2 ins. diam. 3 ft. long

12 ins. in the ground to hardpan in a base of concrete:

the pipe chiseled 3-1-3397-0-G, the base graven  $\Delta$  0 and NWC-G.

No rock or tree bearings available.

Thence S. 28° 50' E. Va. 13° 30' E.

126 Center of road bears N. Westerly and S. Easterly.

392.6 To Cor. No. 4 identical with location a monument of stone

Set an iron pipe 2 ins. diam. 3 ft. long 10 ins. in the ground to hardpan, in a base of concrete, the pipe

chiseled 4-3397-0 and base graven SEC-0. XBR 4-3397  
 chiseled on a porphyry rock 9x7 ins. 6 ins. high bears  
 S.46°19'E. 12.65 ft.

No other rock or tree bearing available.

Thence S.57°40'W. Va. 13°20'E.

129.5 Whence: The closing corner between sec 5-6 Tp 20 S. R.  
 262. To Cor. No. 5 identical with location and with Cor. No.

2 Tom Thumb lode Survey No. 2635, a mound of stone with  
 decayed stub of post, upper portion gone. Set an iron pipe

2 ins. diam. 3 ft. long 14 ins. in ground to hardpan, in  
 a base of concrete; the pipe chiseled 5-3397-0 and Tom

T. the base graven SWC-0.

No rock or tree bearing available

Thence N.19°42'W. Va. 13°20'E.

618.3 Center of road bears N.Westerly and S.Easterly.

984.6 To Cor. No. I the place of beginning. This line is also  
 the side 2-I of Tom Thumb lode: Cor. No. I originally  
 near edge of sand wash has disappeared

GLADYS LODE

Beginning at Cor. No. I identical with location and Cor.  
*No. 2 Olemalode of this survey*  
 previously described

Whence: The Closing Corner between sec 5-6 Tp 20 S. R.  
 25 E. on N. boundary of Township bears N. 50°37' W. 714.6

ft. U.S.M ineral Monument No. I ~~Tur~~quoise District bears  
 N.16°15'W. 7651.5 ft.

Thence N.59°24'E. Va. 13°30'E.

300. N. Center End identical with location a pine post 4 ins.  
 sq. 3 ft. above ground in a mound of stone scribed NCE-G  
 add 3397.

A sand wash has widened and destroyed original N.E. Cor.  
 which has been replaced by a fence post; as not suitable  
 for permanent corner, at

556.2 Establish witness corner. Set an iron pipe 2 ins. diam.  
 3 ft. long 10 ins. in ground to hardpan in a base of con-  
 crete: the pipe chiseled 2-3397 G-WC, the base graven  
 NEC-G-WC.

- 575. Enter sand wash course S. Easterly
- 600. Set stake at point for true Corner. No. 2.8  
Whence: Corner of location a fence post bears N. 22° E.  
0.8 ft. XBR. 2-3397 chiseled on a blue limestone 8x8  
ins. one inch above ground bears S. 11° 59' E. 29.6 ft.  
No other rock or tree bearing available.
- Thence S. 28° 50' E. Va. 13° 25' E. - Along a barbed wire  
fence.
- 32. Leave sand wash.
- 604.7 Post in a mound of stone scribed WCS-L for W. Center Side  
Lawrence lode, unsurveyed.
- 750. E. Center Side Gladys lode, this survey, a mound of stone.
- 980. Fence corner post.
- 1035. Center of road bears N. Westerly and S. Easterly.
- 1104. Center of road bears N. Westerly and S. Easterly.
- 1210.4 Post in a mound of stone scribed SWC-L and NWCO<sup>for</sup> the S.W.  
Cor. of Lawrence lode unsurveyed and N.W. Cor. of Orange  
lode Survey No. 3394.
- 1499.6 To Cor. No. 3 identical with location and with Cor. No. 3  
Gladys No. 2 lode of this survey. A monument of stone  
with post rotted off and on ground, scribed SEC-G and  
NEC-G2.  
Set an iron pipe 2 ins. diam. 3 ft. long 8 ins. in the  
ground to hardpan in a base of concrete: the pipe chisel-  
ed 3-2-3397-G-G2 the base graven SEC. G: NEC. G2.  
Whence XBR 3-2-3397 chiseled on a porphyry rock 7x8 ins.  
one inch above ground bears N. 15° 47' E. 27.15 ft.  
XBR. (not space for more) chiseled on a porphyry rock  
6x6x2 ins. bears N. 42° 14' W. 53.6 ft.  
Thence S. 59° 24' W. Va. 13° 25' E.
- 300. South Center End identical with location and with N. Center  
End of Gladys No. 2 lode of this survey, a post 4 ins. sq.  
3 ft. high in a mound of stone scribed SCE-G and NCE-G2  
add 3397
- 600. To Cor. No. 4 identical with location and with Cor. No. 1

Gladys No. 3 lode of this survey, a post in a mound of stone scribed SWC-G. and NWC-G2. The post is not secure. Set in its place an iron pipe 3 ins. diam. 3 ft. long 8 ins. in the ground to hardpan in a base of concrete, the pipe chiseled 4-1-3397-G-G2 the base graven SWC-G and NWC-G2.

Whence: XBR 4-3397 chiseled on a porphyry rock 16x14 ins. 6 ins. high bears N.44°00'W. 81.15 ft. No other nearby bearings available.

Thence N.28°50'W. Va. 13°30'E.  
 468.6 Cor. No.2 Gertrude lode of this survey.  
 505.6 Monument of stone N.E. Cor. of location Gertrude lode of

this survey and S.E. Cor. Ridgway lode unsurveyed.  
 749.6 West Center Side, a monument of stone.

805.6 Monument, East Center End Ridgway lode unsurveyed.

1015.0 Center of road bears N.Westerly and S.Easterly.

1107.0 Cor. No. 4 Olema lode of this survey previously described also N.E. Cor. Ridgway lode unsurveyed.

1373.6 Center of road bears N.Westerly and S.Westerly.

1499.6 To Cor. No. 1 the place of beginning.

GLADYS No. 3 LODE.

Beginning at Cor. No. 1 identical with location and with Cor. No. 4 Gladys lode of this survey and previously described.

Whence: The  $\frac{1}{4}$  Cor. between secs. 5-6 Tp 20 S. R. 25 E. bears S.52°28'30"W. 1610.7 ft.

U.S. Mineral Monument No. 1 Tourquoise District bears N.18°18'W. 9121.1 ft.

Thence N.59°24'E. Va. 13°30'E.

300. N.Center End identical with location and with S.Center End Gladys lode of this survey and previously described.

600. To Cor. No. 2 identical with location and with Cor. No. 3 Gladys lode of this survey and previously described.

Thence S.28°50'E. Va. 13°25'E.

1209.9 Post in a mound of stone the SW. Cor. <sup>No. 4</sup> of Orange lode survey No. 3394 and N.W. Cor. <sup>No. 1</sup> Gladys <sup>No. 4</sup> lode of this survey

I499.I To Cor. No.3 identical with location and with Cor. No.2 Gladys No.3 lode of this survey, a mound of stone and post down scribed SEC-G2 and NEC-G3.

Set an iron pipe 2 ins. in diam. 3 ft. long 7 ins. in the ground to hardpan in a base of concrete, the pipe chiseled 3-2-3397-G2-G3, the base graven SEC-G2 and NEC-G3.

Whence: XBR 3-2-3397 chiseled on conglomerate bed rock bears N.43°10'W. 88.1 ft. No other rock or tree bearing available.

Thence S.59°24'W. Va. 13-25'E.

300. S.Center End identical with location and with N.Center End Gladys No.3 lode of this survey. A mound of stone

600. To Cor. No. 4 identical with location and with Cor. No.1 Gladys No. 3 lode of this survey, a mound of stone and a post down scribed SWC-G2 and NWC-G3 .

Set an iron pipe 2 ins diam. 3 ft. long 10 ins. in the ground to hardpan in a base of concrete, the pipe chiseled 4-1-3397-G2-G3 and the base graven SWC-G2 and NWC-G3.

Whence: XBR 4-1-3397 chiseled on an iron-quartz rock 24x24x12 ins. in a reef bears S.29°33'E. 103.0 ft.

XBR (not room for more) chiseled on a porphyry rock 10x10x2 ins. bears S.50°26'W. 115.7 ft.

Thence N.28°50'W. Va. 13°20'E.

167.7 E.Center End Elliott lode of this survey.

467.7 N.E. Cor. <sup>No.2</sup> Elliott lode and S.E. Cor. <sup>No.3</sup> Gertrude lode both of this survey.

I499.I To Cor. No.1 the place of beginning.

Gladys No.3 Lode.

Beginning at Cor.No.1 identical with location and with Cor. No.4 Gladys No.2 lode of this survey and previously described

Whence: The  $\frac{1}{4}$  Cor. between secs. 5-6 Tp 20 S. R. 25 E. bears N.80°34'W. 2027.8 ft.

U.S.Mineral Monument No.1 Turquoise District bears N. 19°47'W. 10598.5 ft.

Thence N.59°24'E. Va.13°20'E.

300. N.Center End identical with location and with S.Center End Gladys No.2 lode of this survey and previously described.
600. -To Cor. No.2 identical with location and with Cor No.3 Gladys No.2 lode of this survey and previously described  
Thence S.28°50'E. Va. 13°25'E.
- 691.6 S.W.Cor. Gladys No.4 lode of this survey.
1360. Center of gulch 10 ft. wide course S.Easterly.
1500. To Cor. No.3, Set an iron pipe 2 ins. diam. 3 ft. long 7 ins. in the ground to hardpan in a base of concrete, the pipe chiseled 3-3397 G3, the base graven SEC-G3.  
Whence: Cor. of location a post in a mound of stone scribed SEC-G3 bears S.28°50'E. 1.3 ft. No rock or tree bearings available.  
Thence S.59°24'W. Va. 13°20'E.
300. Raise a monument of stone 3 ft. base 3 ft. high for S.Center End.  
Whence: Monument of location bears S.28°50'E. 1.3 ft.
600. To Cor. No.4. Set an iron pipe 2 ins. diam 3 ft. long 9 ins. in the ground to hardpan in a base of concrete the pipe chiseled 4-3397 G3 the base graven SWC-G3.  
Whence: XBR 4-3397 chiseled on a tufa rock 26x18x14 ins. bears S.13°31'E. 75.8 Corner of location a post in a mound of stone scribed SWC-G3 bears S.28°50'E. 1.3 ft. No other nearby bearings available.  
Thence N.28°50'W. Va. 13°20'E.
- 767.7 S.E.Cor. El General lode of this survey.
- 1047.7 Center gulch 10 ft. wide course S.Easterly.
- 1067.7 E.Center End El General lode of this survey.
- 1367.7 N.E.Cor. <sup>No.2</sup> of El General lode and S.E.Cor. <sup>No.3</sup> Elliott lode both of this survey..
1500. To Cor. No. 1 the place of beginning.  
GERTRUDE LODE.  
Beginning at Cor. No. 1 which is also Cor. No.2 of El Capitan lode of this survey, Set an iron pipe 2 ins. diam. 3 ft. long 12 ins. in the ground to hardpan in a base of

concrete, the pipe chiseled 1-2-3397-G-ELC the base graven NWC-G and NEC-ELC.

Whence: The corner of location a stone monument bears N. 28°50'W. 37 ft.

The 1/4 cor. between secs. 5-6 Tp.20 S.R.25E bears S.27° 01'W. 1200.5 ft. No rock or tree bearings available. Thence N.57°32'E. Va. 13°20'E.

300. N.Center End. Raise a monument of stone 3 ft. base 3 ft. high.

Whence: N.Center End of location a stone monument bears N.28°50'W. 37. ft.

600. To Cor. No.2 on line 4-I Gladys lode of this survey.

Set an iron pipe 2 ins. diam. 3 ft. long 12 ins. in the ground to hardpan in a base of concrete the pipe chiseled 2-3397 G. the base graven NEC-G.

Whence: Corner of location a stone monument bears N.28° 50'W. 37. ft.

U.S.Mineral Monument No.1 Turquoise District bears N. 17°44'W. 8660.8 ft.

Cor. No.4 Gladys lode bears S.28°50'E. 468.6 ft.

XBR 2-3397 chiseled on a quartzite rock 12x8x3 ins. bears S.42°01'E. 29.0 ft.

Thence S.28°50'E. Va. 13°20'E.

468.6 Cor.4 Gladys lode and Cor.1 Gladys No.2 lode of this survey.

1500. To Cor No.3 identical with location and with Cor.2

Elliott lode of this survey, a monument of stone. Set an iron pipe 2 ins. diam. 3 ft. long 5 ins. in ground to hardpan in a base of concrete, the pipe chiseled 3-2-

3397-G-E. the base graven SEC-G and NEC-E.

Whence: Cor.4 Gladys No.2 and Cor.1 Gladys No.3 lodes of this survey bears S.28°50'W. 467.7 ft.

No rock or tree bearings available.

Thence S.57°32'W. Va.13°20'E.

800. S.Center End, identical with location a monument of stone

600. To Cor. No.4 identical with location and with Cor. No. 3



El Capitan lode of this survey a monument of stone. Set an iron pipe 2 ins. diam. 3 ft. long 6 ins. in the ground to hardpan in a base of concrete the pipe chiseled 4-3-3397 G-ELC the base graven SWC-G and SEC-ELC. Whence: XBR 4-3-3397 chiseled on a porphyry rock 14x4x3 ins. bears S.6°20'E. 10.65 ft. No other rock or tree bearing available. Thence N.28°50'W. Va. 13°20'E.

I500. To Cor. No.1 the place of beginning.

EL CAPITAN LODE.

Beginning at Cor. No.1 identical with Cor. No.2 Mary S. lode of this survey. Set an iron pipe 2 ins diam. 3 ft. long 6 ins. in the ground to hardpan in a base of concrete the pipe chiseled 1-2-3397-ELC-MS, the base graven NWC-ELC and NEC-MS.

Whence: Cor. of location a monument of stone bears N. 28°50'W. 37 ft. The 1/4 corner between secs. 5-6 Tp.20 S.R. 25E. bears S. 3°14'W. 750.8 ft. Thence N.57°32'E. Va. 13°20'E.

300. N.Center End. Raise a monument of stone 3 ft. base 3 ft. high. Whence N.Center End of location a stone monument bears N.28°50'W. 37 ft.

596. To Cor. No.2 identical with Cor. No.1 Gertrude lode of this survey and previously described. Whence: U.S.Mineral Monument No.1 Turquoise District bears N.13°58'W. 8832.4 ft. Thence S.28°50' E. Va. 13°20'E.

I500. To Cor. No.3 identical with location and with Cor. No.4 Gertrude lode of this survey previously described. Thence S.57°32'W. Va. 13°20'E.

296. S.Center End identical with location, a monument of stone

596. To Cor. No.4 identical with location and with Cor. No. 3 Mary S. lode of this survey, a monument of stone. Set an iron pipe 2 ins. diam. 3ft. long 7 ins. in the ground to hardpan in a base of concrete the pipe chiseled 4-3-3397-ELC-MS.

and the base graven SWC-ELC and SEC-MS.

Whence: XBR 4-3-3397 chiseled on a porphyry rock 36 ins. long 0 to 12 ins. wide 10 ins. high bears S.30°30'E.

66.6 ft. XBR (not space for more) chiseled on a porphyry rock 8x3x6 ins. bears N.81°17'E. 21.3 ft.

A post in a mound of stone bears N.57°32'E. 3.7 ft. post marked NCE-RH.

Thence N.28°50'W. Va.13°20'E.

300.9 Point whence S.61°10'W. 24.5 ft. stone monument.

342.I Point whence S.61°10'W. 30.0ft. post in a mound of stone marked NEC-R.

1500. To Cor. No.1 the place of beginning.

MARY S. LODE

Beginning at Cor. No. 1 Set an iron pipe 2 ins. diam.

3 ft. long 8 ins in the ground to hardpan in a base of

concrete the pipe chiseled I-3397 MS. the base graven

NWC-MS.

Whence: The Corner of location a post in a mound of stone

scribed NWC-MS bears N.43°10'W 34.8 ft.

The  $\frac{1}{4}$  Cor. between secs. 5-6 Tp. 20 S.R.25E. bears S.

47°20'E. 63 0.8 ft.

XBR. I-3397 chiseled on a porphyry rock 12x8x2 ins. bears

N.41°40'E. 48.8 ft.

Thence N.57°32'E. Va. 13°15'E.

300. Center End. Raise a monument of stone 3 ft. base 3 ft.

high whence N.Center End of location a monument of stone

bears N.28°50'W. 37 ft.

550.5 Intersect line between secs 5-6 Tp.20 S.R.25 E. at N.

0°03'E. 723.05 ft. from  $\frac{1}{4}$  Cor. and S.0°03'W. 202735 ft

from closing corner.

600. To Cor. No.2 identical with Cor. No.1 El Capitan lode

of this survey previously described.

Whence U.S.Mineral Monument No.1 Turquoise District bears

N.10°23'W. 9039.15 ft. No rock or tree bearings avail-

able.

Thence S.28°50' E, Va.13°20'E.

6.00  
 5.96  
 2.95  
 14.91  
 14.86  
 14.91

- I500. To Cor. No.3 identical with location and Cor. No.4 El Capitan lode of this survey and previously described  
Thence S.57°32' W. Va.13°20' E.
- I30. Center of wash in gulch 10 ft. wide course S.Easterly.
- 295. Stone monument N.W. Cor. of Elliott lode of this survey.
- 300. South Center End, a stone monument identical with location
- 599.I To Cor. No.4 identical with location, a post in a mound of stone scribed SWC-MS. Set an iron pipe 2 ins. diam. 3 ft. long 10 ins. in the ground to hardpan in a base of concrete the pipe chiseled 4-3397 M the base graven SWC-MS.  
Whence: a stone monument bears N.42°10' E. 70.0 ft.  
A post in a mound of stone marked I K bears N.22°18' W. 378.7 ft.  
A post in md. of stone bears N.40°04' W. 302.5 ft.  
~~325.7 ft.~~ No rock or tree bearing available.  
Thence N.28°52' W. Va. 13°15' E.
- 538.5 Intersect line between secs 5-6 Tp.20 S. R 25 E. at S. 0°03' E. 414.55 ft. from  $\frac{1}{4}$  Cor. and N.0°03' W. 232.65 ft. from Cor. of secs 5-6-7-8.
- I500. To Cor. No.1 the place of beginning.  
ELLIOTT LODE.  
Beginning at Cor. No. 1 on line 3-4 Mary S. lode of this survey. Set an iron pipe 2 ins. diam 3 ft. long 8 ins. in the ground to hardpan in a base of concrete the pipe chiseled 1-3397 E. the base graven NWC-E.  
Whence: Cor. of location a stone monument bears S.57°32' W 4.3 ft. The  $\frac{1}{4}$  Cor. between secs. 5-6 Tp.20 S. R. 25 E. bears N.35°51' W. 888.8 ft.  
Thence N.57°32' E. Va. 13°20' E.
- I60.7 Center of wash in gulch 10 ft. wide course S.Easterly.
- 290.7 Cor. No.3 Mary S. lode and Cor. No.4 El Capitan lode of this survey.
- 590.7 S.Center End El Capitan lode of this survey.
- 886.7 Cor. No.3 El Capitan lode and Cor. No.4 Gertrude lode of this survey.
- I186.7 South Center End Gertrude lode of this survey.
- I486.7 To Cor. No.2 identical with location and with Cor. No.3

Gertrude lode of this survey and previously described.  
 Whence: U.S. Mineral Monument No. I Turquoise District  
 bears N. 19° 22' W. 10136.8 ft.  
 Thence S. 28° 50' E. Va. 13° 20' E.

300. E. Center End identical with location a stone monument.

467.7 Cor. No. 4 Gladys No. 2 lode and Cor No. I Gladys No. 3  
 lode of this survey.

600.0 To Cor. No. 3 identical with location and with Cor. No. 2  
 El General lode of this survey, a stone monument. Set  
 an iron pipe 2 ins. diam 3 ft. long 10 ins. in the  
 ground to hardpan in a base of concrete the pipe chiseled  
 3-2-3397-E-ELG the base graven SEC-E and NEC-ELG.  
 Whence: XBR 3-2-3397 chiseled on an iron-quartz rock  
 24x24x12 ins. bears N. 26° 57' W. 34.7 ft.  
 No other rock or tree bearings available.  
 Thence S. 57° 33' W. Va. 13° 25' E.

178.7 Center of wash 14 ft. wide course S. westerly.

1178.7 Enter broad sand wash course E.S.E.

1338.7 Leave sand wash enter island.

1486.7 To Cor. No. 4 identical with location and with Cor. No. I  
 El General lode of this survey. A post in a mound of  
 stone scribed SWC-E and NWC-ELG. Set an iron pipe 2 ins  
 diam. 3 ft. long 14 ins. in ground in a base of concrete  
 the pipe chiseled 4-1-3397-E-ELG the base graven SWC-E  
 and NWC-ELG.  
 Whence: XBR 4-1-3397 chiseled on face of porphyry bluff  
 bears S. 6° 27' E. 54.85 ft.  
 XBR 4-1-3397 chiseled on horizontal portion of a por-  
 phry bluff bears S. 69° 28' E. 57.1 ft.  
 Thence N. 28° 50' W. Va. 13° 30' E.

17. Leave island, enter wash.

58. Leave wash.

300. W. Center End. Raise a monument of stone 3 ft. base 3 ft.  
 high.  
 Whence: W. Center End of location a stone monument bears  
 S. 57° 32' W. 2 ft.

600. To Cor. No.1 the place of beginning.

EL GENERAL LODE.

Beginning at Cor. No.1 identical with location and with Cor. No.4 Elliott lode of this survey, and previously described.

Whence: the  $\frac{1}{4}$  Cor. between secs. 5-6 Tp.20 S. R.25 E.

bears N.33°01'W. 1486.2 ft.

Thence N.57°32'E. Va. 13°20'E.

148. Leave high ground and enter sand wash course E.S.E.

308. Leave wash.

1308. Center of wash 14 ft. wide course S.Easterly.

1486.7 To Cor. No.2 identical with location and with Cor. No.3

Elliott lode of this survey and previously described.

Whence U.S.Mineral Monument No.1 Turquoise District bears

N.19°54'W. 10729.2 ft.

Thence S. 28° 50' E. Va. 13° 25' E.

300. E.Center End identical with location a stone monument

320. Center of wash 10 ft. wide course S.Easterly

600. To Cor. No.3 identical with location a monument of stone.

Set an iron pipe 2 ins. diam. 3 ft. long 8 ins. in the

ground to hardpan in a base of concrete, the pipe chiseled

ed 3-3397 ELG the base graven SEC-ELG.

Whence: XBR 3-3397 chiseled on a tufa rock 14x12x5 ins.

bears N.42°21'W. 14.75 ft. No other rock or tree bearing

ing available.

Thence S.57°32'W. Va.13°20'E.

590. Center of sand wash 50 ft. wide course S.Easterly.

1486.7 To Cor. No.4 Set an iron pipe 2 ins. diam. 3 ft. long 5

ins. in ground to hard pan in a base of concrete the pipe

chiseled 4-3397 ELG, the base graven SWC-ELG.

Whence: XBR 4-3397 chiseled on a porphyry rock exposing

12x5 ins. bears S.36°51'W. 12.05 ft.

XBR 4-3397 chiseled on a porphyry rock 14x6x4 ins. bears

S.70°16'E. 17.7 ft. Cor. of location a stone monument

bears S.28°50'E. 15 ft.

Thence N.28°50'W. Va.13° 25' E.

300. W.Center End identical with location, a monument of stone  
 557.0 Enter wash course E.S.E.  
 564.0 Leave wash enter high ground an island in wash.  
 600.0 To Cor. No.1 the place of beginning.

GLADYS NO.4 LODE.

Beginning at Cor. No.1 the N.W. Cor. of location  
 identical with S.W. Cor.(No.4) of Orange lode Survey No.  
 3394, a post in a mound of stone scribed SWC-0 and NWC-G4,  
 on line 2-3 Gladys No.2 lode of this survey. Set an iron  
 pipe 2 ins. diam. 3 ft. long 7 ins. in the ground to  
 hardpan in a base of concrete the pipe chiseled I-3397 -  
 G4 and 4-3394-0 the base graven NWC-G4 and SWC-0.  
 Whence: the  $\frac{1}{4}$  Cor. between secs 5-6 Tp.20 S. R.25 E.  
 bears S.84°53'15"W. 2388.15 ft.  
 U.S.Mineral Monument No.1 Turquoise District bears N.  
 22°50'W. 10274.5 ft.  
 XBR I-3397 chiseled on conglomerate rock 24x18x8 ins.  
 bears N.69°25'E. 132.5 ft.  
 Thence N.58°31'E. Va. 13°20'E.

300.2 N.Center End identical with location. A stone monument  
 534.43 Intersect line 3-4 Kohinoor lode Survey No.3394 at N.  
 565.03 I2°52'E. 37.95 ft. from Cor. No.3.  
 600.4 To Cor. No.2 identical with location also with Cor. No.3  
 188.03 Orange lode and Cor. No.4 International lode both of  
 059.03 Survey No.3394, a stone monument. Set an iron pipe 2 ins  
 384.03 diam. 3 ft. long 6 ins. in the ground to hardpan in a  
 409.03 base of concrete, the pipe chiseled 2-3397-G4; also  
 724.03 3-3394-0 and 4-3394-I, the base graven NEC-G4 also  
 734.03 SEC-0 and SWC-I.  
 838.3 Whence: Cor. No.3 Kohinoor lode Survey No.3394 bears S.  
 42°10'W. 96.4 ft. No rock or tree bearings available.  
 180. Thence S.1°30'W. Va. 13°20'E.

55.78 Intersect line 3-2 Kohinoor lode Survey No.3394 at N.  
 76°04'E. 65.17 ft. from Cor. No.3.  
 1149.0 Post marked SWC-K for S.W. Cor. Keystone lode unsurveyed.  
 1168.0 To Cor. No.3. Set an iron pipe 2 ins. diam. 3 ft. long

7 ins. in the ground to hardpan in a base of concrete the pipe chiseled 3-3397 G4, the base graven SEC-G4. Whence: Cor. of location a stone monument bears S.1°30'W. 19.5 ft. No rock or tree bearings available.

Thence S.58°31'W. Va. 13°25'E.

4.95 S.Center End, raise a stone monument 3 ft. base 3 ft. high

Whence: S.Center End location a stone monument bears S. 12°19'E. 18. ft.

9.9 To Cor. No.4 on line 2-3 Gladys No.3 lode of this survey.

Set an iron pipe 3 ins. diam. 3 ft. long 3 ins. in the ground to hardpan in a base of concrete, the pipe chiseled 4-3397 G4 the base graven SWC-G4.

Whence: Corner of location a stone monument bears S. 28°50'E. 16.5 ft. No rock or tree bearings available.

Thence N.28°50'W. Va. 13°25'E.

691.6 Cor. No.2 Gladys No.3 lode and Cor. No.3 Gladys No.2 lode of this survey.

980.8 To Cor. No.1 the place of beginning.

AREA

	Acres.
Olona lode	6.669 6.669
Gladys lode	20.656 20.646 ✓
Gladys No.2 lode	20.639 20.639 ✓
Gladys No.3 lode	20.651 20.651 ✓
Gertrude lode	20.620 ✓
El Capitan lode	20.483 ✓
Mary lode	20.604 ✓
Elliott lode	20.437 ✓
El General lode	20.437 ✓
Gladys No.4	6.863 ✓
Area in Conflict Gladys No.4 lode and Kohinoor lode Survey No.3394	.061 ✓

LOCATION.

This claim is located in secs. 5 and 6 Tp.20 S. R.25 E.

G. & S.R. B. and M., in Turquoise Mining District Cochise

County Arizona.

Lode Lines.

The presumed courses of the veins are:

On the Olema N.26°50'W. 965.2 ft. from SCE to NCE.

On the Gladys N.28°50'W. 1499.6 ft. from SCE to NCE.

On the Gladys No.2 N.28°50'W. 1499.1 ft. from SCE to NCE.

On the Gladys No.3 N.28°50'W. 1800.0 ft. from SCE to NCE.

On the Gertrude N.28°50'W. 1500.0 ft. from SCE to NCE.

On the El Capitan N.28°50'W. 1500. ft. from SCE to NCE.

On the Mary S. N.28°50'W. 1500. ft. from SCE to NCE.

On the Elliott N.57°32'E. 1486.7 ft. from WCE to ECE.

On the El General N.57°32'E. 1486.7 ft. from WCE to ECE.

On the Gladys No.4 N.12°19'W. 1037.3 ft. from SCE to NCE.

ADJOINING CLAIMS.

On the North:

Imperial lode unsurveyed, John Gleeson Claimant.

Ridgway lode unsurveyed, Claimant unknown.

On the East:

Lawrence lode unsurveyed, John Gleeson Claimant.

Orange lode Survey No.3394, Tejon Mining Co. & John Gleeson Claimants.

Keystone lode unsurveyed, Patrick Brannon Claimant.

On the South and West:

Unknown lodes, <sup>unsurveyed</sup> Claimants unknown.

EXPENDITURE OF \$500.

I certify that the value of labor and improvements made upon or for the benefit of each of the locations is as follows:

On the Olema lode-

No. 1) Discovery shaft the center of which bears N.26°50'W. 34 ft. from S.Center End. Shaft 7x5 ft. 4 ft. deep, caved, once much deeper.

value \$20.

No. 2) A shaft the center of which bears N.51°53'E. 56 ft. from a point on line 5-1 at N.19°42'W. 695.3 ft. from Cor, No.5 Shaft 6x4 ft. 52 ft. deep below collar, 2 sets of timbers with lagging. First few feet cement



thence rock in place.

Value 52<sup>ft</sup> at average \$9.50 per foot \$494.

On the Gladys lode:

From S. Center End

No. 1) Discovery shaft the center of which bears N. 28°50'W. 335. ft. Shaft 6x4 ft. 4 ft. deep in rock to debris in bottom.

Value \$20.

No. 2) A shaft the center of which bears N. 28°50'W. 24 ft. Shaft 8x6 ft. 8 ft. deep, caved in cement and rock.

Value \$35.

From a point on lode line at N. 28°50'W. 421.5 ft.

No. 3) A shaft which bears N. 61°10'E. 50 ft. Shaft 6x4 ft. 47 ft. deep from collar timbered 9 ft.

Value at \$9. per foot \$423

No. 4) A shaft the center of which bears S. 45°50'W. 138.5 ft. Shaft 6x4 ft. 9 ft. deep caved.

Value \$50.

No. 5) A shaft the center of which bears S. 82°45'W. 150.5 ft. Shaft 7x5 ft. now 5 ft. deep, caved once deeper.

Value \$30.

From a point on line 2-3 at S. 28°50'E. 604.7 ft. from

Cor. No. 2

No. 6) A shaft the center of which bears S. 58°45'W. 64 ft.

Shaft 6x4 ft. 33 ft. deep from collar. Shaft timbered 30 ft.

Value at \$10. per foot \$330.

On the Gladys No. 2 lode-

From N. Center End

No. 1) Discovery shaft, a point 2 ft. in shaft from West side bears S. 28°50'E. 826. ft. Shaft 7x5 ft. 18 ft. deep in rock.

Value at \$10. per foot \$180.

From S. Center End.

No. 2) A shaft the center of which bears N. 57°30'W. 70 ft.

Shaft 6x5 ft. 6 ft. deep caved mainly in earth and cement

Value \$20.

From a point on line 4-1 at N. 28° 50' W. 707.5 ft. from Cor. No. 4

No. 3) A shaft, the center of which bears N. 75° 15' E. 305.5 ft. Shaft 6 X 4 ft., depth from collar 80.5 ft. From a point at 55 ft. drifts extend easterly and westerly. Easterly drift 6½ x 4½ ft. 58 ft. Westerly drift 6½ x 4½ ft. 43 ft.

Value of shaft and drifts at \$10 per ft. \$1815.

This shaft has been sunk and drifts run for the purpose of developing Gladys No. 2, Gladys No. 3, Gladys No. 4, Gertude, El Capitan and Elliott lodes.

This is practical as approximately the same or increased depth can be obtained by cross-cutting easterly or westerly. Westerly the limit would be the El Capitan lode, as a north and south ridge extends through the center of the claim. West of this the ground slopes away rapidly, so that the gain in depth would not compensate for the cross cut tunnel necessary to reach the Mary S lode. The same applies to the El General lode, as the ground slopes rapidly away from the N. E. corner toward the S. W. The Gladys lode is practically on the same level, but is being developed separately at Improvement No.3. The Olema lode is too far distant to be benefitted by either working.

\$1815 ÷ 6 (locations) = \$ 302.50

This sum assigned to each of the six lodes mentioned.

On the Gladys No. 3 lode:

From N. Center End

No. 1) Discovery shaft, the center of east end of which bears S. 28° 50' E. 278 ft. Shaft 6 x 4 ft., 8 ft. deep to debris in bottom.

Value \$50.

No. 2) A shaft, the center of which bears S. 18° 20' E. 85 ft. Shaft 8 x 5 ft., 5 ft. deep, caved in earth and cement.

Value \$20.

No.3) A shaft, the center of which bears S. 27° 30' W. 239 ft. Shaft 6 x 4 ft., 15 ft. deep in rock.

Value at \$10. per ft. \$150.

No. 4) A shaft, the center of which bears S. 35° 15' W. 282 ft. Shaft 6 x 4 ft., 15 ft. deep in rock.

Value at \$10. per ft. \$150.

Assigned one-sixth from common work on Gladys No. 2 lode \$302.50

On the Gertrude lode -

No. 1) Discovery shaft, the center of which bears S. 28° 50' E. 678 ft. from N. Center End. Shaft 7 x 5 ft., 5 ft. deep to debris, once deeper, in rock.

Value \$30.

From point on lode line at S 28° 50' E. 518.7 ft. from N C E.

No. 2) A cut and shaft, the mouth of which bears S. 9° 39' W. 312.5 ft. Cut extends southerly 23 ft. to a shaft from

bottom of cut, face of cut  $4\frac{1}{2}$  ft. wide, 6 ft. high,  
shaft 6 x 4 ft., 13 ft. deep.

Value of cut \$50.

Value of shaft at \$10. per ft. \$130.

From a point on lode line at S.  $28^{\circ} 50'$  E. 680.5 ft.

No. 3) A shaft, the center of which bears N.  $61^{\circ} 10'$  E.  
20.5 ft. Shaft 6 x 5 ft., 22 ft. deep, once deeper.

Value at \$8. per ft. \$176.

Assigned one-sixth of common work on Gladys No. 2 lode

\$302.50

On El Capitan lode -

From S. Center End -

No. 1) Discovery shaft, the center of the west side of  
which bears N.  $28^{\circ} 50'$  W. 9 ft., shaft 6 x 4 ft.; depth  
from collar 50.5 ft. Two sets of timber and lagging.

Value at \$10. per ft. \$505.

Assigned one-sixth of common work on Gladys No. 2

lode

\$302.50

On Mary S lode -

From S. Center End:

No. 1) Discovery shaft, the center of which bears N.  $28^{\circ}$   
 $50'$  W. 66 ft. Shaft 5 x 4 ft., 7 ft. deep to debris.

Value \$35.

No. 2) A shaft, the center of which bears from Cor. No. 4  
N.  $33^{\circ} 16'$  E. 158 ft. Shaft 6 x 4 ft.; depth from collar  
53 ft. 2 sets of timber and lagging.

Value at \$9.50 per ft. \$497.50

From point on line 2-3 at S.  $28^{\circ} 50'$  E. 613 ft. from  
Cor. No. 2.

No. 3) A shaft, the center of which bears S.  $61^{\circ} 10'$  W.  
25 ft. Shaft 10 x 8 ft., now 5 ft. deep, once deeper.

Value \$20.

No. 4) A shaft, the center of which bears S.  $61^{\circ} 10'$  W.  
47 ft.

Shaft 6x4 ft. 10 ft. deep all in rock.  
Value \$100.

On the Elliott lode-  
From East Center End

No. 1) Discovery shaft the center of which bears S.57°32'W.  
550 ft. Shaft 6x4 ft. 4 ft. deep to debris in bottom.  
Value \$25.

No. 2) A shaft the center of which bears S.57°32'W. 42 ft.  
Shaft 6x5 ft. caved, now 5 ft. deep, once deeper, in earth  
and cement.  
Value \$20.

From a point on line I-2 at N.57°32'E. 747.7/ from Cor.

No. I.

No. 3) A shaft the center of which bears S.32°28'E. 36 ft.  
Shaft 6x4 ft. 15 ft. deep. Thence drift northerly 5 ft.  
all in rock.  
Value at \$10. per ft. \$200.

From Cor. No. 3

No. 4) A shaft the center of which bears S.72°15'W. 317 ft.  
Shaft 6x4 ft. 20 ft. deep from collar. 2 sets of timbers  
and lagging.  
Value at \$10. per ft. \$200.

From Cor. No. 4

No. 5) A shaft the center of which bears N.6°33'W. 339 ft.  
Shaft 7x5 ft caved, now 4 ft. deep once deeper.  
Value \$20.

Assigned one-sixth of common work Gladys No. 2  
lode \$302.50

On the El general lode-

From East Center End

No. 1) Discovery shaft the center of which bears S.57°32'W.  
400ft. Shaft 6x4 ft. 4 ft. deep to debris in bottom.  
Value \$25.

No. 2) A shaft the center of which bears S.70°34'W. 391.5 ft.  
Shaft 6x4 ft. caved now 4 ft. deep in rock.  
Value \$20.

From Cor. No. 2

No. 3) A shaft the center of which bears S. 29° 29' W. 287.5 ft.  
 Shaft 6x4 ft. 29 ft. deep from collar to bottom. 2 sets  
 timbers and lagging.

Value at \$10. per ft. \$290.

No. 4) A shaft the center of which bears S. 2° 08' E. 165 ft.  
 Shaft 6x4 ft. 29 ft. deep, 2 ft. in earth thence rock.

Value at \$9 per ft. \$261.

From Cor. No. 3.

No. 5) A shaft the center of which bears N. 72° 27' W. 196.5 ft.

Shaft 6x4 ft. 32 ft. from collar to bottom, 5 ft to bed  
 rock. Timber and lagging 6 ft.

Value at \$9.50 per ft. \$304.

On the Gladys No. 4 lode  
 From N. Center End

No. 1) Discovery shaft the center of which bears S. 14° 30' E.

252 ft. Shaft 6x4 ft. caved now 5 ft. deep once deeper.  
 Value \$20.

No. 2) A shaft the center of which bears S. 78° 30' E. 54 ft.

Shaft 6x4 ft. 49 ft. from collar to bottom. First 20 ft.  
 cement thence bedrock.

Value at \$8 per ft. \$392

Assignment one-sixth common work on Gladys No. 2  
 lode \$302.50

INSTRUMENT.

This survey was made with a Young & Sons Mountain transit  
 (No. 6855) provided with a Smith Solar attachment. The  
 courses were deflected from true meridian as determined by  
 direct solar observations. The distances were measured  
 with 50 ft. and 500 ft. steel tapes.

REPORT

U.S. Mineral Monument No. I of Turquoise District is a post  
 8 ft. high, in a conical mound of stone scribed U.S.M.M.  
 No. I.

The closing corner between secs 5-6 on the N. boundary of  
 Tp. 20 S. R. 25 E. is a limestone firmly set exposing  
 7x6x6 ins. Chiseled 5 notches on the east one notch on

the west and C C on the south. The course and distance from said closing corner to U.S.M.M. No. I N.  $12^{\circ}59'W.$  7073.3 ft.

The  $\frac{1}{4}$  Cor. section between secs. 5-6 Tp. 20 S. R. 25 E. is an iron pipe with brass cap marked in the usual manner.

Tombstone Arizona

July 24, 1917.

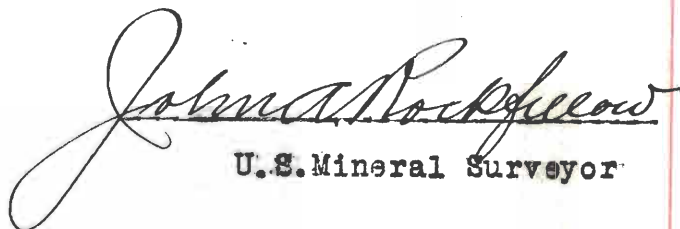
  
U.S. Mineral Surveyor

FINAL OATHS FOR SURVEYS.

806.7-1917

LIST OF NAMES.

A list of the names of the individuals employed by Johna Rockfellow  
United States ~~Deputy~~ Mineral Surveyor, to assist in running, measuring, and marking the lines, corners, and  
boundaries described in the foregoing field notes of the survey of the mining claim of \_\_\_\_\_

Tejon Mining Co.  
known as the Oliver, Gladys, Gladys No. 2, Gladys No. 3, Gladys No. 4, Gladys No. 5, Gladys No. 6, Gladys No. 7, Gladys No. 8, Gladys No. 9, Gladys No. 10, Gladys No. 11, Gladys No. 12, Gladys No. 13, Gladys No. 14, Gladys No. 15, Gladys No. 16, Gladys No. 17, Gladys No. 18, Gladys No. 19, Gladys No. 20, Gladys No. 21, Gladys No. 22, Gladys No. 23, Gladys No. 24, Gladys No. 25, Gladys No. 26, Gladys No. 27, Gladys No. 28, Gladys No. 29, Gladys No. 30, Gladys No. 31, Gladys No. 32, Gladys No. 33, Gladys No. 34, Gladys No. 35, Gladys No. 36, Gladys No. 37, Gladys No. 38, Gladys No. 39, Gladys No. 40, Gladys No. 41, Gladys No. 42, Gladys No. 43, Gladys No. 44, Gladys No. 45, Gladys No. 46, Gladys No. 47, Gladys No. 48, Gladys No. 49, Gladys No. 50, Gladys No. 51, Gladys No. 52, Gladys No. 53, Gladys No. 54, Gladys No. 55, Gladys No. 56, Gladys No. 57, Gladys No. 58, Gladys No. 59, Gladys No. 60, Gladys No. 61, Gladys No. 62, Gladys No. 63, Gladys No. 64, Gladys No. 65, Gladys No. 66, Gladys No. 67, Gladys No. 68, Gladys No. 69, Gladys No. 70, Gladys No. 71, Gladys No. 72, Gladys No. 73, Gladys No. 74, Gladys No. 75, Gladys No. 76, Gladys No. 77, Gladys No. 78, Gladys No. 79, Gladys No. 80, Gladys No. 81, Gladys No. 82, Gladys No. 83, Gladys No. 84, Gladys No. 85, Gladys No. 86, Gladys No. 87, Gladys No. 88, Gladys No. 89, Gladys No. 90, Gladys No. 91, Gladys No. 92, Gladys No. 93, Gladys No. 94, Gladys No. 95, Gladys No. 96, Gladys No. 97, Gladys No. 98, Gladys No. 99, Gladys No. 100  
and showing the respective capacities in which they acted.

- M.H. O'Connor, Chairman.
- A.G. Waite, Chairman.
- \_\_\_\_\_, Assman.
- \_\_\_\_\_, Flagman.

FINAL OATHS OF ASSISTANTS.

We, M.H. O'Connor  
and A.G. Waite, do solemnly swear that we assisted Johna Rockfellow  
Rockfellow, United States ~~Deputy~~ Mineral Surveyor, in marking the corners and surveying  
the boundaries of the mining claim of Tejon Mining Co.

known as the Oliver, Gladys, Gladys No. 2, Gladys No. 3, Gladys No. 4, Gladys No. 5, Gladys No. 6, Gladys No. 7, Gladys No. 8, Gladys No. 9, Gladys No. 10, Gladys No. 11, Gladys No. 12, Gladys No. 13, Gladys No. 14, Gladys No. 15, Gladys No. 16, Gladys No. 17, Gladys No. 18, Gladys No. 19, Gladys No. 20, Gladys No. 21, Gladys No. 22, Gladys No. 23, Gladys No. 24, Gladys No. 25, Gladys No. 26, Gladys No. 27, Gladys No. 28, Gladys No. 29, Gladys No. 30, Gladys No. 31, Gladys No. 32, Gladys No. 33, Gladys No. 34, Gladys No. 35, Gladys No. 36, Gladys No. 37, Gladys No. 38, Gladys No. 39, Gladys No. 40, Gladys No. 41, Gladys No. 42, Gladys No. 43, Gladys No. 44, Gladys No. 45, Gladys No. 46, Gladys No. 47, Gladys No. 48, Gladys No. 49, Gladys No. 50, Gladys No. 51, Gladys No. 52, Gladys No. 53, Gladys No. 54, Gladys No. 55, Gladys No. 56, Gladys No. 57, Gladys No. 58, Gladys No. 59, Gladys No. 60, Gladys No. 61, Gladys No. 62, Gladys No. 63, Gladys No. 64, Gladys No. 65, Gladys No. 66, Gladys No. 67, Gladys No. 68, Gladys No. 69, Gladys No. 70, Gladys No. 71, Gladys No. 72, Gladys No. 73, Gladys No. 74, Gladys No. 75, Gladys No. 76, Gladys No. 77, Gladys No. 78, Gladys No. 79, Gladys No. 80, Gladys No. 81, Gladys No. 82, Gladys No. 83, Gladys No. 84, Gladys No. 85, Gladys No. 86, Gladys No. 87, Gladys No. 88, Gladys No. 89, Gladys No. 90, Gladys No. 91, Gladys No. 92, Gladys No. 93, Gladys No. 94, Gladys No. 95, Gladys No. 96, Gladys No. 97, Gladys No. 98, Gladys No. 99, Gladys No. 100  
represented in the foregoing field notes as having been surveyed by said ~~deputy~~ mineral surveyor and under his  
direction; and that said survey has been in all respects, to the best of our knowledge and belief, faithfully and  
correctly executed, and the corner and boundary monuments established according to law and the instructions  
furnished by the United States Surveyor-General for Arizona

- M.H. O'Connor, Chairman.
- A.G. Waite, Chairman.
- \_\_\_\_\_, Assman.
- \_\_\_\_\_, Flagman.

Subscribed and sworn to by the above-named persons before me this 22<sup>nd</sup>

day of June, 1917.

M.O. Phears

My commission expires Jan 29<sup>th</sup> 1921

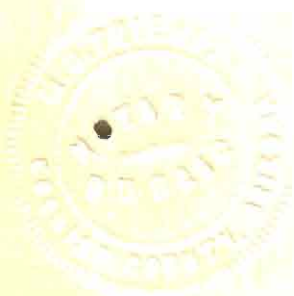

(4-686.)

FINAL OATH OF U. S. ~~DEPUTY~~ MINERAL SURVEYOR

I, John A. Rockefeller, U. S. ~~Deputy~~ Mineral Surveyor, do solemnly swear that, in pursuance of instructions received from the United States Surveyor General for Arizona, dated May 8 1917, I have, in strict conformity to the laws of the United States, the official regulations and instructions thereunder, and the instructions of said Surveyor General, faithfully and correctly executed the survey of the Mining Claim of Tejon Mining Co.

Oliver, Gladys, George, Gladys, No 3 Gladys No 4, Bertrudi, El Capitain, Mary S, Clifton and El General, known as the lodes situate in Turquoise Mining District, Cochise County, Arizona, in Section 5 and 6, Township No. 20 S, Range No. 25 E, and designated as Survey No. 3397

as represented in the foregoing field notes, which accurately show the boundaries of said mining claim as distinctly marked by monuments on the ground, and described in the attached copy of the location certificate, which was received by me from the Surveyor General with said instructions, and that all the corners of said survey have been established and perpetuated in strict accordance with the law, official regulations and instructions thereunder; and I do further solemnly swear that the foregoing are the true and original field notes of said survey and my report therein, and that the labor expended and improvements made upon said mining claim by claimant or its grantors are as therein fully stated, and that the character, extent, location and itemized value thereof are specified therein with particularity and full detail, and that no portion of said labor or improvements so credited to this claim has been included in the estimate of expenditures upon any other claim.

John A. Rockefeller  
U. S. ~~Deputy~~ Mineral Surveyor.

Subscribed and sworn to by the said John A. Rockefeller, U. S. ~~Deputy~~ Mineral Surveyor, before me Wm H. Monmonier, Notary Public, of Cochise County, Arizona this 4<sup>th</sup> day of August, 1917.

My commission expires Wm H. Monmonier Notary Public  
February 26, 1920



# Notice of Mining Location

*Tractional*  
LODE CLAIM

To All Whom It May Concern:

This Mining Claim, the name of which is the Olema  
Mining Claim, situate on lands belonging to the United States of America, and in which there  
are valuable mineral deposits, was entered upon and located for the purposes of exploration and  
purchase by Lee J. Thiers and W. H. McKittrick

Citizens of the United States  
(Locator must insert either "a citizen of the United States," or, "who has declared his intention to become a citizen of the United States.")

the undersigned, on the 10<sup>th</sup> day of March 1905

The length of this claim is 1000 feet,  
and NE claim ~~XX~~ 10 feet,  
in a Southeasterly direction and 990  
feet in a North westerly direction from

the center of the discovery shaft, at which this notice is posted, lengthwise of the claim, together  
with 132 1/2 feet in width of the surface grounds, on each  
side of the center of said claim. The general course of the lode deposit and premises is from the  
South East to the North West

The claim is situated and located in the Surquoise Mining District, in  
Cochise County, in the Territory of Arizona, about 1 mile  
in a Southerly direction from U.S. M. Monument No 1

and is bounded on the East by the Gladipe mining  
claim. On the NE, by the Independence M.C. on the  
North <sup>and</sup> West by the Low Shunt <sup>and</sup> on the S. by the Ridgway

The surface boundaries of the claim are marked upon the ground as follows: Beginning at  
Monument of Stone

at a point in a S. Easterly direction 10 feet from  
the discovery shaft (at which this notice is posted), being in the center of the South east  
end line of said claim; thence 132 1/2 feet to a monument  
being the S. East corner of said claim; thence  
N 41° W, 375' + N 85° W 60' feet to a Post, being at the  
North corner of said claim; thence S 45° W 2 feet  
to a monument Post at the center of the N. W. end of said claim;  
thence 2 feet to a Post, being at the  
West corner of said claim; thence 1000  
feet to a Monument at the South corner of said claim;  
thence 132 1/2 feet to the place of beginning.

All done under the provisions of Chapter Six, of Title XXXII, of the Revised Statutes of  
the United States, and of an Act of the General Assembly of Arizona, entitled "An Act to  
Revise and Codify the Laws of the Territory of Arizona," approved March 16, 1901.

Dated and posted on the ground this 10<sup>th</sup> day of March 1905

Witness  
M. C. Thiers

Lee J. Thiers  
W. H. McKittrick  
by L. J. Thiers

TERRITORY OF ARIZONA,  
County of COCHISE } ss.

I, Frank Shaw, County Recorder in and for the County and Territory aforesaid, do hereby certify that the within instrument was filed for record at 9 o'clock, 9 M., on this JUN 3 1905 day of 1905, and duly recorded in Book No. 34 of MINING Records of COCHISE County, Arizona, at pages 172.

WITNESS my hand and official seal the day and year first above written.

Frank Shaw  
County Recorder.

COPIED

No. 3316

### Notice of Location

LODE CLAIM

Oleua

Dated 1905

Filed and Recorded at request of  
Doc J. Shiers

JUN 3 1905 A. D. 190

at 11 A M.

Book 34 Record of Mines

Pages 172

Frank Shaw  
County Recorder.

By [Signature]  
Deputy Recorder.

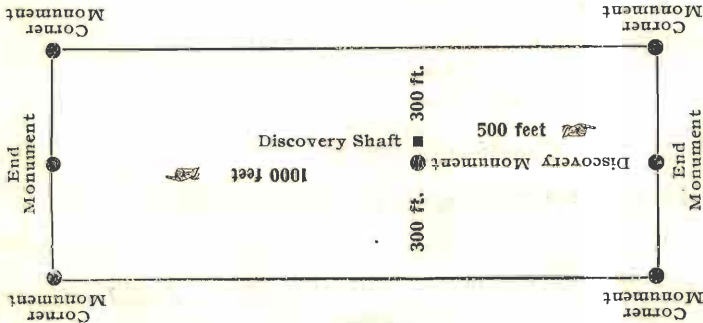

This diagram is to give locator a general idea of plan of location under the new law. The Discovery Shaft can be in the center of claim or any distance from either end desired. In the diagram it is placed 500 feet from the end and 1000 feet from the other. Commence description of claim at a center end monument, giving its distance and direction from center of Discovery Shaft; thence bound the claim in either direction. In description be careful to state locality of claim with reference to some natural object, or permanent monument, as will identify the claim.

Notice of Mining Location

To whom it may Concern;

This mining claim, the name of which is the Gladys Mining claim situate on lands belonging to the United States of America, and in which there are valuable mineral deposits, was entered upon and located for the purpose of exploration and purchase by Frank R. O'Brien (Citizen of the United States), the undersigned on the second day of January, 1901.

The description of the claim is as follows:

Runs No. 28 degrees 50 min. W. 1165 ft. and S. 28 deg. 50 min. E. 335 ft. from initial monument at discovery shaft.

Beginning at the North center end of claim a post in a mound of stone N. 28 deg. 50 min. W. 1165 ft. from initial monument, whence the main shaft of the Independence mine bears N. 40 deg. 40 min. E. 794 feet, No. 1 shaft Gleeson mine bears N. 8 deg. 42 min W. The smoke stack of hoist at Charleston mine bears N. 21 deg. 10 min W; thence running S. 59 deg. 23 min. W along side line of Independence mine 300 ft. to a post in mound of stone being at the N. W. corner of claim; thence S. 28 deg. 50 min E. 750 ft. to a post in mound of stone being at the center of of West side of claim; thence in same direction 750 ft. to a post in a mound of stone being at the S. W. cor. of claim; thence N. 59 deg. 23 min. E. 300 ft. to a post in mound of stone being at the south center end of claim; thence in same direction 300 ft. to post in mound of stone being at the S.E. corner of claim; thence N. 28 deg. 50 min. W. 750 ft. to a post in mound of stone being at the center of east side of claim; thence in the same direction 750 ft. to post in bed of wash which is true N. E. corner of claim but which is indicated by a witness corner, a post in a mound of stone, N. 59 deg. 23 min. E. 10 ft. from true corner, said true corner and witness corner being identical with N. W. true corner and witness corner of the Lizzie mine; thence ( from true corner) S. 59 deg. 23 min. W. 300 ft. to

place of beginning.

All done under the provisions of Chapter Six of Title XXXII, of the Revised Statutes of the United States, and of an act of the General Assembly of Arizona, entitled "An Act Concerning Mines" approved March 20th, 1895 , and amended March 2, 1899.

Dated and posted on the ground this second day of January, 1901.

Frank R. O'Brien

Filed and recorded at request of Frank R. O'Brien, January 30th, A.D. 1901, at 9: AM., Book 15 Record of Mines, pages 219-220.

NOTICE OF MINING LOCATION  
Lode Claim

TO ALL WHOM IT MAY CONCERN:

This Mining Claim, the name of which is the **Gladys No.2** Mining Claim, situate on lands belonging to the United States of America, and in which there are valuable mineral deposits, was entered upon and located for the purpose of exploration and purchase by The Tejon Mining Co. Incorporated under laws of Arizona, the undersigned, on the 6th day of January, 1908.

The length of this claim is 1500 feet and we claim 825 feet in a North Westerly direction, and 675 feet in a South Easterly direction from the center of the discovery shaft, at which this notice is posted, lengthwise of the claim, together with 300 feet in width of the surface grounds, on each side of the center of said claim. The general course of the lode deposit and premises is from the N. 41° 16' W.

The claim is situated and located in the Turquoise Mining District, in Cochise County, in the Territory of Arizona, College Peak bearing S. 64° 44' E. and the stack of the Tejon Mining Co's No. 3 Hoist bearing N. 30° 50' W. from the North center end monument, and being a relocation of abandoned Rattlesnake M.C.

The surface boundaries of the claim are marked upon the ground as follows: Beginning at a post in a mound of stone, scribed N.C.E.G.No.2 ( all courses magnetic) at a point N. 41° 16' W. direction 825 feet from the discovery shaft ( at which this notice is posted ), being in the center of the North end line of said claim; thence S. 46° 44' W. 300 feet to a post & M. of stone scribed N.W.C.-G- No. 2 , being the North west corner of said claim; thence S. 41° 16' E. 1500 feet to a post & M. of stone scribed S.W.C.-G- No. 2, being at the South West corner of said claim; thence N. 46° 44' E. 300 feet to a P.& M. of stone, scribed S.C.E.G No. 2 at the center of the South end of said claim; thence same course 300 feet to a p & m of stone scribed S.E.C.-G- No.2, being at the South east corner of

said claim; thence N. 41° 16' W. 1500 feet to a p & m of stone scribed N.E.C.-G- No. 2 at the North East corner of said claim; thence S. 46° 44' W. 300 feet to the place of beginning.

All done under the provisions of Chapter Six, of Title XXXII of the Revised Statutes of the United States, and an Act of the General Assembly of Arizona, entitled "An Act to Revise and Codify the laws of the Territory of Arizona," approved March 16, 1901.

Dated and posted on the ground this 6th day of January 1908.

Tejon Mining Co.

By L. I. Thiers,  
Supt.

Filed and recorded at request of L. I. Thiers, Apr 6, 1908, at 1:P.M., Book 41 Record of Mines, page 501.

## NOTICE OF MINING LOCATION

## Lode Claim

TO ALL WHOM IT MAY CONCERN:

This Mining Claim, the name of which is the **Gladys No.3** Mining Claim, situate on lands belonging to the United States of America, and in which there are valuable mineral deposits, was entered upon and located for the purpose of exploration and purchase by The Tejons Mining Co. Incorporated under laws of Arizona, the undersigned, on the 6th day of January, 1908

The length of this claim is 1500 feet and we claim 280 feet in a Northwesterly direction, and 1220 feet in a south easterly direction from the center of the discovery shaft, at which this notice is posted, lengthwise of the claim, together with 300 feet in width of the surface grounds, on each side of the center of said claim. The general course of the lode deposit and premises is N. 41° 6' W. to the -----

The claim is situated and located in the Turquoise Mining District, in Cochise County in the Territory of Arizona, College Peak bearing S. 65° 15' E. and a monument on apex of Sugar loaf Mt bearing S. 16° 32' E. from the North Center End Monument, and being a relocation of abandoned South End mining claim.

The surface boundaries of the claim are marked upon the ground as follows: Beginning at a post in mound of stones, scribed N.C.E.-G No.3 ( all courses magnetic). at a point N. 41° 16' W. direction 280 feet from the discovery shaft ( at which this notice is posted); being in the center of the North end line of said claim; thence S. 46° 44' W. 300 feet to a p & m of stone scribed N.W.C.-G No. 3, being at the North west corner of said claim; thence S. 41° 16' E. 1500 feet to a p & m of stone scribed S.W.C.-G.No.3 , being at the South west corner of said claim; thence N. 46° 44' E. 300 feet to a post & m of stones scribed S.C.E.G.No.3 at the center of the South end of said claim; thence same course 300 feet to a p & m of stone scribed S.E.C.-G No.3, being at the South east corner of said claim;

thence N. 41° 16' W. 1500 feet to a p & m of stone scribed N.E.C. -G No. 3 at the North east corner of said claim; thence S. 46° 44' W. 300 feet to the place of beginning.

All done under the provisions of Chapter Six of Title XXX II of the Revised Statutes of the United States, and an Act of the General Assembly of Arizona, entitled "An Act to Revise and Codify the Laws of the Territory of Arizona," approved March 16, 1901.

Dated and posted on the ground at this 6th day, of 9 January, 1908.

Tejon Mining Co.

By L. I. Thiers  
Supt.

Filed and recorded at request of L. I. Thiers, Apr. 6, 1908 at 1:P.M. Book 41 Record of Mines, page 502.



NOTICE OF MINING LOCATION  
Fraction. Lode Claim.

TO ALL WHOM IT MAY CONCERN:

This Mining Claim, the name of which is the Gladys No. 4 Mining Claim, situate on lands belonging to the United States of America, and in which there are valuable mineral deposits, was entered upon and located for the purpose of exploration and purchase by The Tejon Mining Co., a corporation, incorporated under laws of Arizona, the undersigned, on the 27th day of March, 1909.

The length of this claim is 1050 feet and we claim 250 feet in a northerly direction and 800 feet in a southerly direction from the center of the discovery shaft, at which this notice is posted, lengthwise of the claim, together with 300 feet in width of the surface grounds, on each side of the center of said claim. The General course of the lode deposit and premises is from the northerly (N.  $154^{\circ} 15'$  - E to the southerly.

The claim is situated and located in the Turquoise Mining District, in Cochise County, in the Territory of Arizona, about 1 mile in a southerly direction from Copper Belle Mine, the north end line coincides with the south end line of the Orange Mining Claim. The west sideline coincides with the Gladys 2 & 3 and east side line with Empire Mine.

The surface boundaries of the claim are marked upon the ground as follows: Beginning at a post & mound of stone scribed N.C.E - G 4 and S C E - O at a point in a N  $25^{\circ} 45'$  W direction 250 feet from the discovery shaft (at which this notice is posted), being in the center of the North end line of said claim; thence N  $134^{\circ} 02'$  W 300 feet to a post in mound of stone, being the northwest corner of said claim; thence N.  $138^{\circ} 25'$  E 1050 feet to a post in mound of stone being at the southwest corner of said claim; thence N  $45^{\circ} 58'$  E 1 foot to a post in mound of stone at the center of the south end of said claim; thence same course 1 foot to a post in mound of stone, being at the southeast corner of said claim; thence N  $11^{\circ}$  W 1230 feet

to a post & mound of stone at the northeast corner of said claim.  
thence N 1134° 02' W 300 feet to the place of beginning.

All done under the provisions of Chapter Six, of Title XXXII  
of the Revised Statutes of the United States, and an Act of the General  
Assembly of Arizona, entitled "An Act to Revise and Codify the Laws of  
the Territory of Arizona", approved March 16, 1901.

Dated and posted on the ground this 27th day of March, 1909.

Tejon Mining Co.  
By L. I. Thiers,  
Supt.

Filed and recorded at request of L. I. Thiers Apr. 12, 1909,  
at 9 AM in Book 44 Record of Mines at page 160.

*For recorder's certificate see Sur. No. 3394  
(covering Gladys, G.2, G.3, G4)*

Jan 8-1917

# Notice of Mining Location

## LODE CLAIM

To All Whom It May Concern:

This Mining Claim, the name of which is the Gertrude Mining Claim, situate on lands belonging to the United States of America, and in which there are valuable mineral deposits, was entered upon and located for the purposes of exploration and purchase by L. J. Thiers, W. C. Brown and Mrs. Fannie Burress, Citizens of U.S.

(Locator must insert either "a citizen of the United States," or, "who has declared his intention to become a citizen of the United States.")

the undersigned, on the 1st day of January 1905

The length of this claim is One thousand five hundred feet, and we claim Seven hundred and fifty feet, in a Northerly direction and Seven hundred and fifty feet in a Southerly direction from the center of the discovery shaft, at which this notice is posted, lengthwise of the claim, together with Three hundred feet in width of the surface grounds, on each side of the center of said claim. The general course of the lode deposit and premises is from the Northerly to the Southerly

The claim is situated and located in the Turquoise Mining District, in Cochise County, in the Territory of Arizona, about One mile in a Southerly direction from The Copper Belle Mine shaft and is joined on the E. by the Glady's mining claim and on the S. by the Elliott mining claim

The surface boundaries of the claim are marked upon the ground as follows: Beginning at a monument of Stone marked N.C.E.-G

at a point in a Northerly direction 750 feet from the discovery shaft (at which this notice is posted), being in the center of the North end line of said claim; thence 300 feet to a monument of stone marked N.E.C.-G being the North East corner of said claim; thence 7500 feet to a monument of stone, being at the South East corner of said claim; thence 300 feet to a monument of stone at the center of the South end of said claim; thence 300 feet to a monument of stone, being at the South west corner of said claim; thence 1500 feet to a monument of stone at the North west corner of said claim; thence 300 feet to the place of beginning.

All done under the provisions of Chapter Six, of Title XXXII, of the Revised Statutes of the United States, and of an Act of the General Assembly of Arizona, entitled "An Act to Revise and Codify the Laws of the Territory of Arizona," approved March 16, 1901.

Dated and posted on the ground this 1st day of January 1905

By Power of Atty. given } L. J. Thiers  
to L. J. Thiers } W. C. Brown  
                                  } Mrs. Fannie Burress

TERRITORY OF ARIZONA,  
County of Cochise ss.

I, Frank Star, County Recorder in and for the County and

Territory aforesaid, do hereby certify that the within instrument was filed for record at 10 o'clock, 2 M.,

on this MAR 1 day of 1905, and duly recorded in Book No. 33

of Minna Cochise Records of Cochise County, Arizona, at pages 37

WITNESS my hand and official seal the day and year first above written.

Frank Star  
County Recorder.

Notice of Location

LODE CLAIM

Subdiv  
Yuma Dist  
Cochise Co  
Arizona

Dated Jan 1st 1905

Filed and Recorded at request of

Lee J. Thiess

MAR 1 1905 A. D. 190

at 10:02 M.

Book 33 Record of Mines

Pages 37

Frank Star

County Recorder.

By FD  
Deputy Recorder.

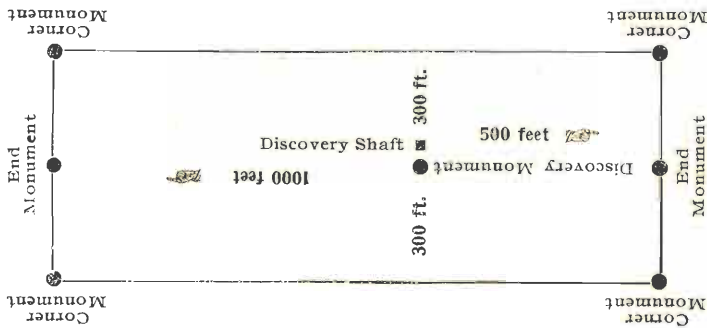

This diagram is to give locator a general idea of plan of location under the new law. The Discovery Shaft can be in the center of claim or any distance from either end desired. In the diagram it is placed 500 feet from one end and 1000 feet from the other. Commence description of claim at a center end monument, giving its distance and direction from center of Discovery Shaft; thence bound the claim in either direction. In description be careful to state locality of claim with reference to some natural object, or permanent monument, as will identify the claim.

# Notice of Mining Location

## QUARTZ CLAIM

TO ALL WHOM IT MAY CONCERN:

This mining claim, the name of which is the El Capitan

Mining Claim, situate on lands belonging to the United States of America, and in which there are valuable mineral deposits, was entered upon and located for the purpose of exploration and purchase by

Lee J. Thiers and W. H. McKittrick  
Citizens of the United States

by the undersigned, on the 10<sup>th</sup> day of March 1905

The length of this claim is 1500 feet and W<sup>1</sup>/<sub>2</sub> claim 1490

feet in a Northerly direction and 10 feet in a Southerly direction from

the center of the discovery shaft, at which this notice is posted, lengthwise of the claim, together with 300 feet in width of the surface grounds, on each side of the center of said claim

The general course of the lode deposit and premises is from the South east to the North west

The claim is situated and located in the Lurquise Mining District, in Cochise County, in the Territory of Arizona, about 1 1/2 miles

in a Southerly direction from U.S. M. Monument N<sup>o</sup> 1 and about 1/2 mile N.W. of Sugar Loaf Mountain

The surface boundaries of the claim are marked upon the ground as follows: Beginning at a monument of stone

at a point in a S. E. direction 10 feet from the discovery shaft (at which this notice is posted), being in the center of the South

end line of said claim; thence 300 feet to a monument of stone being the S. E. corner of said claim; thence 1500

feet to a monument being at the North East corner of said claim; thence 300 feet to a monument

being the center of the North end of said claim; thence 300 feet to a monument, being at the North West

corner of said claim; thence 1500 feet to a monument at the South West corner of said claim; thence 300

feet to the place of beginning.

All done under the provisions of Chapter Six of Title XXXII, of the Revised Statutes of the United States, and of an act of the General Assembly of Arizona, entitled "An Act to Codify and Revise the Laws of the Territory of Arizona," approved March 16th, 1901.

Dated and posted on the ground this 10<sup>th</sup> day of March 1905

Lee J. Thiers  
W. H. McKittrick

Witness  
M. O. Thiers.

by L. J. Thiers

# An Act to Codify and Revise the Laws of the Territory of Arizona

## SECTIONS 1-11.—INC. LOCATION OF CLAIMS

Be it enacted by the Legislative Assembly of the Territory of Arizona:

SECTION 1. On the discovery of mineral in places on the public domain of the United States, the same may be located as a mineral claim by the discoverer for himself, for himself and others, or for others.

SECTION 2. Such location shall be made by erecting at or contiguous to the point of discovery, a conspicuous monument of stones not less than three (3) feet in height, or an upright post securely fixed, projecting at least four (4) feet above the ground, in which monument of stones or on which post, there shall be posted a location notice, which shall be signed by the name or names of the locator or locators. The location notice must contain: First, the name of the claim located; second, the name or names of the locators; third, the date of the location; fourth, the length and width of the claim in feet and the distance in feet from the point of discovery to each end of the claim; fifth, the general course of the claim; sixth, the locality of the claim with reference to some natural object or permanent monument whereby the claim can be identified.

SECTION 3. Until each and all of the above specified things shall have been done no right thereto shall be acquired.

SECTION 4. From the time of the location of a mining claim as above specified, the locator shall be allowed ninety (90) days within which to do or cause to be done, the following things: First, to cause to be recorded in the office of the County Recorder of the county in which the claim is situated, a copy of the location notice; second, to sink a discovery shaft in the claim to the depth of at least ten (10) feet from the lowest part of the rim of the shaft at the surface, and deeper if necessary, until there is discovered in said shaft mineral in place; third, to monument the claim on the ground so that its boundaries can be readily traced.

SECTION 5. The failure to do all the things enumerated in this section in the time and place specified shall be construed into an abandoning of the claim, and all right thereto of the discoverer and locator shall be forfeited.

SECTION 6. Such surface boundaries shall be marked by six (6) substantial posts, projecting at least four (4) feet above the surface of the ground, or by substantial stone monuments at least three (3) feet high, to-wit: One at each corner of said claim, and one at the center of each end line thereof.

SECTION 7. Any open-cut, adit or tunnel which shall be made as above provided for as a part of the location of a lode mineral claim, and which shall be equal in amount of work to a shaft ten (10) feet deep and four (4) feet wide by six (6) feet long, and which shall cut the lode or mineral in place at a depth of ten (10) feet from the surface, shall be equivalent as a discovery work to a shaft sunk from the surface.

SECTION 8. Location notice may be amended at any time, and the monument changed to correspond with the amended location; provided, that no change shall be made that will interfere with the rights of others.

SECTION 9. The amount of assessment or representation work or improvements to be done or made during each year, after the completion of the location as heretofore provided, and the time for doing the same shall be as provided by the laws of the United States.

SECTION 10. Within three (3) months after the expiration of the period of the time fixed for the performance of annual labor, or the making of such improvements upon any mining claim, the person on whose behalf such work or improvement was made, or some person for him knowing the facts, may make a record in the office of the County Recorder of the county wherein such claim is situated, an affidavit in substance as follows:

TERRITORY OF ARIZONA, }  
 ..... } ss.  
 ..... being duly sworn, deposes and says that he is a citizen of the United States and more than twenty-one years of age, resides at ..... in ..... County, Arizona, Territory, and is personally acquainted with the mining claim known as ..... Mining District, Arizona, Territory, the location notice of which is recorded in the office of the County Recorder of said County, in book ..... of Records of Mines, at page ..... That between the ..... day of ..... A. D. and the ..... day of ..... A. D. at least ..... dollars worth of work and improvements were done and performed upon said claim, not including the location work of said claim. Such work and improvements were made by and at the expense of ..... owners of said claim, for the purpose of complying with the laws of the United States, pertaining to assessments of annual work, and (here name the owners or men who worked upon the claim in doing the work) were the men employed by said owner, and who labored upon said claim, did said work and improvements, the same being as follows, to-wit: (Here describe the work done).  
 ..... (Signature).  
 Subscribed and sworn to before me, this ..... day of ..... A. D. ....  
 My commission as Notary Public expires on the ..... day of ..... A. D. ....  
 (Notary Seal).  
 ..... Notary Public.

SECTION 11. Such affidavit, when so recorded, shall be prima facie evidence of the performance of such labor or the making of such improvements, and said original affidavit, after it has been recorded, or a certified copy of record of same, or the record of same, shall be received as evidence accordingly by the Courts of the Territory. The relocation of forfeited or abandoned lode claims shall only be made by sinking a new discovery shaft and fixing the boundary in the same manner and to the same extent as is required in making an original location; or the relocater may sink the original discovery shaft ten (10) feet deeper that it was at the date of the commencement of such location, and shall erect new, or make the old monuments the same as originally required. In either case a new location monument shall be erected, and the location notice shall state if the whole or any part of the new location is located as abandoned property, else it shall be void.

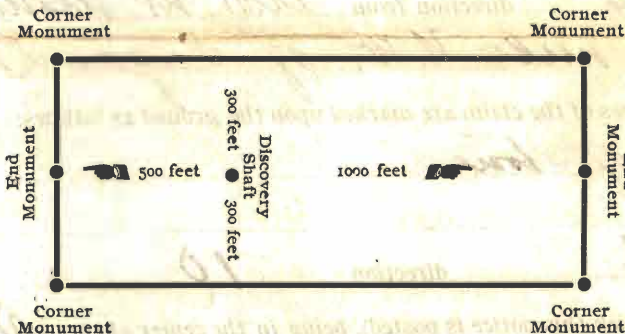

The above diagram is to give the locator a general idea of the plan of location under the new law. Your discovery shaft may be in the center of claim, or any distance from either end you desire. In the diagram we have placed it 500 feet from one end and 1000 feet from the other. In description, be careful to state locality of claim with reference to some natural object, or permanent monument, so as to identify the claim.

TERRITORY OF ARIZONA, }  
 ..... } ss.  
 County of Coconino  
 Territory aforesaid, do hereby certify that the within instrument was filed for record at ..... o'clock ..... M. on this ..... day of JUN 3 1905, 190..., and duly recorded in Book No. 34 of MINING Records of COCONINO County, Arizona, at pages 177.  
 WITNESS my hand and official seal the day and year first above written.  
 .....  
 County Recorder.

Notice of Location  
 QUARTZ CLAIM  
 Filed and recorded at request of  
Ed J. Thomas  
 Dated Mar 10 1905  
 JUN 3 1905 A. D. 1905  
 at 11 A. M.  
 Book 34 Record of Mines  
 Page 177  
 .....  
 County Recorder.  
 Deputy Recorder.  
 H. P. CORRETT, STATIONER AND PRINTER  
 TUCSON, ARIZONA

COMPAR  
No. 3515

11-8-1917

# Notice of Mining Location

## LODE CLAIM

To All Whom It May Concern:

This Mining Claim, the name of which is the Mary S.  
Mining Claim, situate on lands belonging to the United States of America, and in which there  
are valuable mineral deposits, was entered upon and located for the purposes of exploration and  
purchase by Lee J. Thiers & H. H. McKittrick  
Citizens of the United States  
(Locator must insert either "a citizen of the United States," or, "who has declared his intention to become a citizen of the United States.")

the undersigned, on the 16 day of January 1907

The length of this claim is Fifty Five Hundred (1500) feet,  
and W. 2 claim Sixty five (65) feet,  
in a South easterly direction and One thousand four  
hundred & thirty five (1435) feet in a North westerly direction from  
the center of the discovery shaft, at which this notice is posted, lengthwise of the claim, together  
with Three Hundred (300) feet in width of the surface grounds, on each  
side of the center of said claim. The general course of the lode deposit and premises is ~~from the~~  
North 29° 17' West and South to the Variation 12° 17' E

The claim is situated and located in the Marquise Mining District, in  
Cochise County, in the Territory of Arizona, about 7500 feet from  
~~in a The U.S. Mineral Monument~~ direction from which bears N 11° 37' W, the  
College Peak bearing South 53° 10' E from the South  
Center End monument

The surface boundaries of the claim are marked upon the ground as follows: Beginning at  
A monument of stone

at a point in a S 29° 17' E direction 65 feet from  
the discovery shaft (at which this notice is posted), being in the center of the South  
end line of said claim; thence N 57° 25' E 302 feet to a Monument of  
Stone, being the S. E. corner of said claim; thence  
N 29° 17' W 1500 feet to a Monument of Stone, being at the  
N. E. corner of said claim; thence S 57° 25' W (302) feet  
to a Stone monument at the center of the North end of said claim;  
thence S 57° 25' W 302 feet to a Stone Monument, being at the  
N. W. corner of said claim; thence South 29° 17' E, 1500  
feet to a Stone monument at the South West corner of said claim;  
thence N 57° 25' E, 302 feet to the place of beginning.

All done under the provisions of Chapter Six, of Title XXXII, of the Revised Statutes of  
the United States, and of an Act of the General Assembly of Arizona, entitled "An Act to  
Revise and Codify the Laws of the Territory of Arizona," approved March 16, 1901.

Dated and posted on the ground this 16<sup>th</sup> day of January 1907

Witnesses,  
M. H. O'Connor  
Jas Crawford

Lee J. Thiers  
H. H. McKittrick

TERRITORY OF ARIZONA,  
County of Cochise } ss.

I, C. A. McDonald, County Recorder in and for the County and Territory aforesaid, do hereby certify that the within instrument was filed for record at 2:30 o'clock, P, on this 5 day of Feb, 1907, and duly recorded in Book No. 38 of Mining Records of Cochise County, Arizona, at pages 88.

WITNESS my hand and official seal the day and year first above written.

C. A. McDonald  
County Recorder.

No 903

Notice of Location

LODE CLAIM

Mary S

Dated Jan 16<sup>th</sup> 1907

Filed and Recorded at request of

L. S. Thiers

Feb 5 A. D. 1907

at 2:30 P M.

Book 38 Record of Mines

Pages 88

C. A. McDonald  
County Recorder.

By rd  
Deputy Recorder.

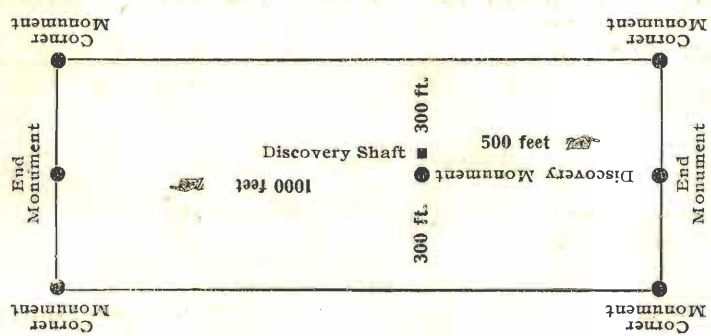

This diagram is to give locator a general idea of plan of location under the new law. The Discovery Shaft can be in the center of claim or any distance from either end desired. In the diagram it is placed 500 feet from one end and 1000 feet from the other. Commence description of claim at a center end monument, giving its distance and direction from center of Discovery Shaft; thence bound the claim in either direction. In description be careful to state locality of claim with reference to some natural object, or permanent monument, as will identify the claim.



8-1917

# Notice of Mining Location

## LODE CLAIM

To All Whom It May Concern:

This Mining Claim, the name of which is the Elliott Mining Claim, situate on lands belonging to the United States of America, and in which there are valuable mineral deposits, was entered upon and located for the purposes of exploration and purchase by Lee J. Thiers, H. C. Brown and Mrs. Jamie Burress Citizens of the United States

(Locator must insert either "a citizen of the United States," or, "who has declared his intention to become a citizen of the United States.") the undersigned, on the 1<sup>st</sup> day of January 1905

The length of this claim is One Thousand five hundred feet, and NE claim Three Hundred and fifty feet, in a Easterly direction and nine hundred and fifty feet in a Westerly direction from the center of the discovery shaft, at which this notice is posted, lengthwise of the claim, together with Three Hundred feet in width of the surface grounds, on each side of the center of said claim. The general course of the lode deposit and premises is from the Easterly to the Westerly

The claim is situated and located in the Turquoise Mining District, in Cochise County, in the Territory of Arizona, about one mile in a Southerly direction from The Copper Bell mine shaft and is joined on the North by the "Gertrude" mining claim and on the East by the "Aut" mining claim

The surface boundaries of the claim are marked upon the ground as follows: Beginning at a monument of Stone marked E.C.E. - E

at a point in a Easterly direction 550 feet from the discovery shaft (at which this notice is posted), being in the center of the East end line of said claim; thence 300 feet to a monument of stone being concurrent with the S.E. corner Gertrude, being the North East corner of said claim; thence 1500 feet to a monument of stone, being at the North West corner of said claim; thence 300 feet to a monument of Stone at the center of the West end of said claim; thence 300 feet to a monument of Stone, being at the South West corner of said claim; thence 1500 feet to a monument of Stone at the South East corner of said claim; thence 300 feet to the place of beginning.

All done under the provisions of Chapter Six, of Title XXXII, of the Revised Statutes of the United States, and of an Act of the General Assembly of Arizona, entitled "An Act to Revise and Codify the Laws of the Territory of Arizona," approved March 16, 1901.

Dated and posted on the ground this 1<sup>st</sup> day of January 1905

By Power of Atty. given to L. J. Thiers { Lee J. Thiers  
H. C. Brown  
Mrs. Jamie Burress

TERRITORY OF ARIZONA,  
County of Cochise } ss.

I, Frank Star, County Recorder in and for the County and Territory aforesaid, do hereby certify that the within instrument was filed for record at 10 o'clock, a M., on this 1 day of MAR 1 - 1905, 1905, and duly recorded in Book No. 33 of Mining Records of Cochise County, Arizona, at pages 36.

WITNESS my hand and official seal the day and year first above written.

Frank Star  
County Recorder.

Notice of Location

LODE CLAIM

Elliott  
Imperial Dist.  
Cochise Co  
Arizona

Dated Jan. 1st 1905-

Filed and Recorded at request of

Lee J. Thiers

MAR 1 - 1905 A. D. 1905

at 10 o'clock a M.

Book 33 Records of Mining

Pages 36  
Frank Star  
County Recorder.

By pd  
Deputy Recorder.

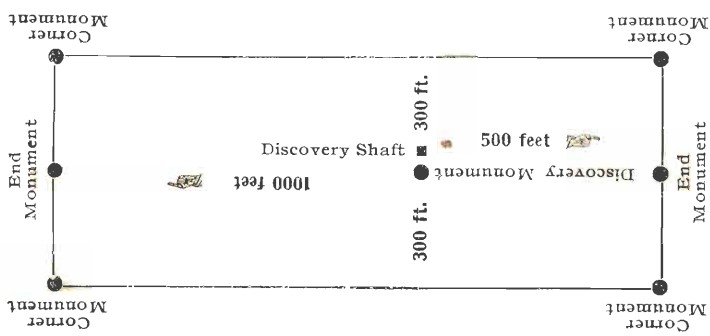

This diagram is to give locator a general idea of plan of location under the new law. The Discovery Shaft can be in the center of claim or any distance from either end desired. In the diagram it is placed 500 feet from one end and 1000 feet from the other. Commence description of claim at a center end monument, giving its distance and direction from center of Discovery Shaft; thence bound the claim in either direction. In description be careful to state locality of claim with reference to some natural object, or permanent monument, as will identify the claim.

March 8-1917

# Notice of Mining Location

## QUARTZ CLAIM

TO ALL WHOM IT MAY CONCERN:

This mining claim, the name of which is the El General

Mining Claim, situate on lands belonging to the United States of America, and in which there are valuable mineral deposits, was entered upon and located for the purpose of exploration and purchase by

Lee J. Thiers and W. H. M. Pittsick  
Citizens of the United States

by the undersigned, on the 10<sup>th</sup> day of March 1905

The length of this claim is 1500 feet and WE claim 400

feet in a North Easterly direction and 1100 feet in a South Westerly direction from

the center of the discovery shaft, at which this notice is posted, lengthwise of the claim, together with 300 feet in width of the surface grounds, on each side of the center of said claim

The general course of the lode deposit and premises is from the North East to the South West

The claim is situated and located in the Turquoise Mining District, in Cochise County, in the Territory of Arizona, about 1 3/4 miles in a Southerly direction from U.S. Mineral Monument No 1 and 1/3 mile N.W. Sugar Loaf mountain

The surface boundaries of the claim are marked upon the ground as follows: Beginning at A monument of stone

at a point in a N.E. direction 400 feet from the discovery shaft (at which this notice is posted), being in the center of the East

end line of said claim; thence 300 feet to a monument being the N.E. corner of said claim; thence 1500

feet to a monument being at the North West corner of said claim; thence 300 feet to a monument

being the center of the West end of said claim; thence 300 feet to a monument, being at the South West

corner of said claim; thence 1500 feet to a monument at the S. East corner of said claim; thence 300

feet to the place of beginning.  
All done under the provisions of Chapter Six of Title XXXII, of the Revised Statutes of the United States, and of an act of the General Assembly of Arizona, entitled "An Act to Codify and Revise the Laws of the Territory of Arizona," approved March 16th, 1901.

Dated and posted on the ground this 10<sup>th</sup> day of March 1905

Lee J. Thiers  
W. H. M. Pittsick  
by L. J. Thiers

Witness  
M. O. Thiers.

# An Act to Codify and Revise the Laws of the Territory of Arizona

## SECTIONS 1-11.—INC. LOCATION OF CLAIMS

Be it enacted by the Legislative Assembly of the Territory of Arizona:

- SECTION 1. On the discovery of mineral in places on the public domain of the United States, the same may be located as a mineral claim by the discoverer for himself, for himself and others, or for others.
- SECTION 2. Such location shall be made by erecting at or contiguous to the point of discovery, a conspicuous monument of stones not less than three (3) feet in height, or an upright post securely fixed, projecting at least four (4) feet above the ground, in which monument of stones or on which post, there shall be posted a location notice, which shall be signed by the name or names of the locator or locators. The location notice must contain: First, the name of the claim located; second, the name or names of the locators; third, the date of the location; fourth, the length and width of the claim in feet and the distance in feet from the point of discovery to each end of the claim; fifth, the general course of the claim; sixth, the locality of the claim with reference to some natural object or permanent monument whereby the claim can be identified.
- SECTION 3. Until each and all of the above specified things shall have been done no right thereto shall be acquired.
- SECTION 4. From the time of the location of a mining claim as above specified, the locator shall be allowed ninety (90) days within which to do or cause to be done, the following things: First, to cause to be recorded in the office of the County Recorder of the county in which the claim is situated, a copy of the location notice; second, to sink a discovery shaft in the claim to the depth of at least ten (10) feet from the lowest part of the rim of the shaft at the surface, and deeper if necessary, until there is discovered in said shaft mineral in place; third, to monument the claim on the ground so that its boundaries can be readily traced.
- SECTION 5. The failure to do all the things enumerated in this section in the time and place specified shall be construed into an abandoning of the claim, and all right thereto of the discoverer and locator shall be forfeited.
- SECTION 6. Such surface boundaries shall be marked by six (6) substantial posts, projecting at least four (4) feet above the surface of the ground, or by substantial stone monuments at least three (3) feet high, to-wit: One at each corner of said claim, and one at the center of each end line thereof.
- SECTION 7. Any open-cut, adit or tunnel which shall be made as above provided for as a part of the location of a lode mineral claim, and which shall be equal in amount of work to a shaft ten (10) feet deep and four (4) feet wide by six (6) feet long, and which shall cut the lode or mineral in place at a depth of ten (10) feet from the surface, shall be equivalent as a discovery work to a shaft sunk from the surface.
- SECTION 8. Location notice may be amended at any time, and the monument changed to correspond with the amended location; provided, that no change shall be made that will interfere with the rights of others.
- SECTION 9. The amount of assessment or representation work or improvements to be done or made during each year, after the completion of the location as heretofore provided, and the time for doing the same shall be as provided by the laws of the United States.
- SECTION 10. Within three (3) months after the expiration of the period of the time fixed for the performance of annual labor, or the making of such improvements upon any mining claim, the person on whose behalf such work or improvement was made, or some person for him knowing the facts, may make a record in the office of the County Recorder of the county wherein such claim is situated, an affidavit in substance as follows:

TERRITORY OF ARIZONA, } ss.  
 ..... being duly sworn, deposes and says that he is a citizen of the United States and more than twenty-one years of age, resides at ..... County, Arizona, Territory, and is personally acquainted with the mining claim known as ..... Mining District, Arizona, Territory, the location notice of which is recorded in the office of the County Recorder of said County, in book ..... of Records of Mines, at page ..... That between the ..... day of ..... A. D. and the ..... day of ..... A. D. at least ..... dollars worth of work and improvements were done and performed upon said claim, not including the location work of said claim. Such work and improvements were made by and at the expense of ..... owners of said claim, for the purpose of complying with the laws of the United States, pertaining to assessments of annual work, and (here name the owners or men who worked upon the claim in doing the work) were the men employed by said owner, and who labored upon said claim, did said work and improvements, the same being as follows, to-wit: (Here describe the work done).  
 ..... (Signature)  
 Subscribed and sworn to before me, this ..... day of ..... A. D. ....  
 My commission as Notary Public expires on the ..... day of ..... A. D. ....  
 (Notary Seal).  
 ..... Notary Public.

SECTION 11. Such affidavit, when so recorded, shall be prima facie evidence of the performance of such labor or the making of such improvements, and said original affidavit, after it has been recorded, or a certified copy of record of same, or the record of same, shall be received as evidence accordingly by the Courts of the Territory. The relocation of forfeited or abandoned lode claims shall only be made by sinking a new discovery shaft and fixing the boundary in the same manner and to the same extent as is required in making an original location; or the relocater may sink the original discovery shaft ten (10) feet deeper that it was at the date of the commencement of such location, and shall erect new, or make the old monuments the same as originally required. In either case a new location monument shall be erected, and the location notice shall state if the whole or any part of the new location is located as abandoned property, else it shall be void.

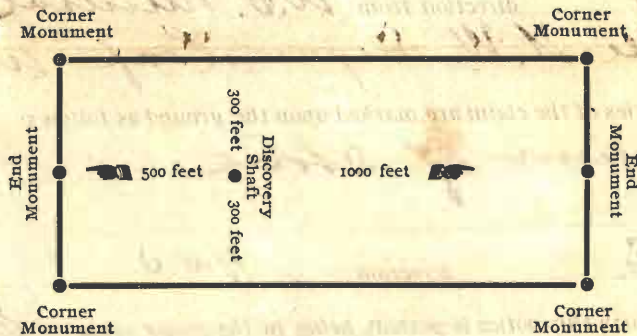

The above diagram is to give the locator a general idea of the plan of location under the new law. Your discovery shaft may be in the center of claim, or any distance from either end you desire. In the diagram we have placed it 500 feet from one end and 1000 feet from the other. In description, be careful to state locality of claim with reference to some natural object, or permanent monument, so as to identify the claim.

TERRITORY OF ARIZONA, } ss.  
 County of COCHISE  
 ..... County Recorder in and for the County and Territory aforesaid; do hereby certify that the within instrument was filed for record at ..... o'clock ..... M. on this ..... day of JUN 3, 1905, 190..., and duly recorded in Book No. 34 of MINING Records of COCHISE County, Arizona, at pages 170.  
 WITNESS my hand and official Seal the day and year first above written.  
 ..... County Recorder.

COMPARED.

No. 3314

**Notice of Location**  
QUARTZ CLAIM

E. L. Leonard  
Superintendent  
C. W. King

Dated Mar. 10th 1905

Filed and recorded at request of  
Ed. J. Brown

JUN 3 1905 A. D. 1905

at 11A M.

Book 34 Records of Mines

Pages 170

Ed. J. Brown  
County Recorder.

By H. D. Corbett  
Deputy Recorder.  
H. D. CORBETT, STATIONER AND PRINTER  
TUCSON, ARIZONA

U. S. SURVEYOR-GENERAL'S FINAL CERTIFICATE ON FIELD NOTES.

Department of the Interior,

OFFICE OF U. S. SURVEYOR-GENERAL,

Phoenix, Arizona.

May 28, 1918.

I, U. S. Surveyor-General for District of Arizona,

do hereby certify that the foregoing transcript of the Field Notes, return and approval of the survey of the mining claim of

TEJON MINING CO.,

known as the OLEMA, GLADYS, GLADYS NO. 2, GLADYS NO. 3, GLADYS NO. 4, GERTRUDE, EL CAPITAN, MARY S., ELLIOTT and EL GENERAL Lodes, situate in

TURQUOISE

Mining District, COCHISE County, ARIZONA

in Sections 5 and 6, Township No. 20 S., Range No. 25 E., and

designated as Survey No. 3397, has been correctly copied from the originals on file in

this office; that said Field Notes furnish such an accurate description of said mining claim as will, if incorporated into a patent, serve fully to identify the premises, and that such reference is made therein to natural objects or permanent monuments as will perpetuate and fix the locus thereof.

And I further certify that five hundred dollars' worth of labor has been expended or improvements made upon said mining claims by claimant or its grantors, and that said improvements consist of 28 shafts, 3 drifts and 1 cut, total value \$7117.50

As shaft No. 3 on the Gladys No. 2 lode is a common improvement for the benefit and development of the Gladys No. 2, Gladys No. 3, Gladys No. 4, Gertrude, El Capitan and Elliott lodes of this survey, and only those lodes, an undivided one-sixth interest in said improvement, value \$302.50, is properly credited to each of the six claims above named.

and that no portion of said labor or improvements has been included in the estimate of expenditures upon any other claim.

I further certify that the plat thereof, filed in the U. S. Land Office at Phoenix, Arizona, is correct and in conformity with the foregoing Field Notes.

Frank P. Trott

United States Surveyor-General for Arizona.

SURVEYOR-GENERAL'S CERTIFICATE OF APPROVAL OF FIELD  
NOTES AND SURVEY OF MINING CLAIM.

Department of the Interior,

OFFICE OF U. S. SURVEYOR-GENERAL,

-----Phoenix, Arizona,-----

-----May 28-----, 1918.

I, U. S. Surveyor-General for-----District of Arizona-----

do hereby certify that the foregoing and hereto attached Field Notes and Return of the Survey of the  
Mining Claim of-----

-----TEJON MINING CO.,-----

-----, known as the  
OLEMA, GLADYS, GLADYS NO. 2, GLADYS NO. 3, GLADYS NO. 4, GERTRUDE,  
EL CAPITAN, MARY S., ELLIOTT and EL GENERAL Lodes,

situate in-----TURQUOISE----- mining district,

COCHISE----- County,----- ARIZONA,

in Section s. 5 and 6-----, Township No. 20 S.,-----, Range No. 25 E.,-----

-----, designated as Survey No.----- 3397-----

executed by-----John A. Rockfellow-----, United States Mineral

Surveyor,-----May 23 - June 22,-----, 1917, under my instructions dated

May 8,-----, 1917, have been critically examined and the necessary cor-

rections and explanations made, and the said Field Notes and Return, and the Survey they describe,

are hereby approved. A true copy of the copy of the location certificate filed by the applicant for

survey is included in the field notes.



U. S. Surveyor-General for-----Arizona.-----