

4-683

Plotted

1917 29 18:7

MINERAL SURVEY No. 3426

LOT No.

ARIZONA Land District.

FIELD NOTES

OF THE SURVEY OF THE MINING CLAIM OF

Sunnyside Gold Mines Company

KNOWN AS THE

SUNNY SIDE, SUNNY SIDE EXTENSION, SUNNY SIDE EXTENSION NO. 1 lodes.

San Francisco Mining District,

Mohave County, Arizona.

Section 25, Township 19 North, Range 20 West,

Surveyed under instructions dated August 25, 1917.

by Herman C. Zulch
U. S. Mineral Surveyor.

Claim located See location notices, 19

Survey commenced September 5, 1917.

Survey completed September 25, 1917.

Address of claimant's agent, C. R. McCollom,
Oatman, Arizona.

DATES OF AMENDED LOCATIONS.

January 1, 1917.

Handwritten notes and stamps in the bottom right corner, including a rectangular stamp with the number 3426 and other illegible text.

-1-

JUL 29 1917

Feet.

SUNNY SIDE LODE

Beginning at Cor. No.1, identical with Cor. No.4 Sunny Side Extension lode of this survey, A redwood post 4 ft. long, 4 ins. square, with nail at exact Cor., set 18 ins. in the ground, in mound of earth and stone, scribed SS 1-3426 for this claim.

The S.W. Cor. of Sec.30; T.19 N; R.19 W. bears S43°-18'E 3863.77 ft.

No bearing objects available.

Thence S51°-02'W

310.46 To E. End Center, Identical with the W. End Center Sunny Side Extension lode of this survey, A redwood post, 4 ft. long, 4 ins. square, with nail at exact point, set 18 ins. in the ground in mound of earth and stone, scribed 3426 for this claim.

584.36 Witness post for Cor. No.2, identical with witness post for Cor. No.3 Sunny Side Extension lode, A redwood post 4 ft. long, 4 ins. square, with nail at exact point, set 18 ins. in the ground, in mound of earth and stone, scribed WC SS 2-3426 for this claim.

No bearing objects available.

587.36 To Cor. No.2, Identical with Cor. No.3 Sunny Side Extension lode of this survey. A non permanent place for a corner as it falls on the edge of the road, W. C., heretofore brs. N. 51°02' E. 3 ft.

Thence N66°-16'-30" W

7.50 Wagon road, course Northwesterly and Southeasterly.

345.91 To Cor. No.3, A redwood post, 4 ft. long, 4 ins. square, with nail at exact Cor., set 18 ins. in the ground, in mound of earth and stone, scribed SS 3-3426.

No bearing objects available.

855.00 Center of wash, draining Westerly.

Thence N29° 00' W

1042.00 Wagon road, course Easterly and Westerly.

1163.22 To Cor. No.4, A redwood post, 4 ft. long, 4 ins. square, with nail at exact Cor., set 18 ins. in the ground, in mound of earth and stone, scribed SS 4-3426.

Feet. The West $\frac{1}{4}$ Cor. of Sec.25; T.19 N; R.20 W., unapproved
bears S55°-44'W 1408.87 ft.

No. other bearing objects available.

Thence N51°-02'E

300.00 To W. End Center, A redwood post, 4 ft. long, 4 ins.
square, with nail at exact point, set 18 ins. in the
ground, in mound of earth and stone, scribed 3426.

336.34 Intersect South end line Lodestone lode, unsurveyed, at
S57°-22'W 447.05 ft. from the S.E. Cor.

586.95 To Cor. No.5, A redwood post, 4 ft. long, 4 ins. square,
with nail at exact Cor., set 18 ins. in the ground, in
mound of earth and stone, scribed SS 5-3426.

S.E. Cor. Lodestone lode unsurveyed, bears N65°-19'E 199.88
ft.

No. other bearing objects available.

Thence S38°-56'-30"E

27.81 Intersect South end line Lodestone lode, uns. at S57°-22'W
194.90 ft. from the S.E. Cor.

595.00 Center of Wash, draining Westerly.

1161.50 To Cor. No.6, A redwood post, 4 ft. long, 4 ins. square,
with nail at exact Cor., set 18 ins. in the ground, in
mound of earth and stone, scribed SS 6-3426.

Boundary Cone, a land mark, bears S65°-22'-30"W.

Thence S66°-22'-30"E

348.18 To Cor. No.1, the place of beginning.

SUNNY SIDE EXTENSION LODE.

Beginning at Cor. No.1, Identical with Cor. No.4
Sunny Side Extension No.1 lode of this survey, A redwood
post, 4 ft. long, 4 ins. square, with nail at exact Cor.,
set 18 ins. in the ground, in mound of earth and stone,
scribed SSE 1-3426 for this claim.

The S.W. Cor. of Sec.30; T.19 N; R.19 W., bears S37°-07'E
2403.87 ft.

Boundary Cone bears S70°-06'W.

White Elephant, a land mark, bears N29°-29'W.

Feet.

Thence S51°-02'W

235.00 Gulch, draining Northerly.

298.81 To E. End Center, Identical with the W. End Center Sunny Side Extension No.1 lode of this survey, A redwood post, 4 ft. long, 4 ins. square, with nail at exact point, set 18 ins. in the ground, in mound of earth and stone, scribed 3426 for this claim.

577.01 To Cor. No.2, Identical with Cor. No.5 Sunny Side Extension No.1 lode of this survey, A redwood post, 4 ft. long 4 ins. square, with nail at exact Cor., set 18 ins. in the ground, in mound of earth and stone, scribed SSE 2-3426 for this claim.

No bearing objects available.

Thence N53°-38'W

1195.00 Wagon road, course Northeasterly and Westerly also gulch draining Westerly.

1498.27 To ^{Pt. for} Cor. No.3, Identical with Cor. No.2 Sunny Side lode of this survey, A non permanent position for a corner, previously described, W.C., previously described bts. N. 51° 02' E. 3 ft.

Thence N51°-02'E

3.00 Witness post for Cor. No.3, Identical with witness post for Cor. No.2 Sunny Side lode of this survey, A redwood post, previously described, to which I add WC SSE 3-3426

276.90 To W. End Center, Identical with the E. End Center Sunny Side lode of this survey, A redwood post previously described to which I add 3426.

587.36 To Cor. No.4, Identical with Cor. No.1 Sunny Side lode of this survey, A redwood post, previously described to which I add SSE 4-3426.

Thence S50°-20'E

330.09 To Cor. No.5, A redwood post, 4 ft. long, 4 ins. square with nail at exact Cor., set 18 ins. in the ground, in mound of earth and stone, scribed SSE 5-3426.

No bearing objects available.

	Feet.	Thence S54°-04'-30"E
	185.00	Gulch, draining Southwesterly.
	1166.16	To Cor. No.1, the place of beginning.
		<u>SUNNY SIDE EXTENSION NO. 1 LODE.</u>
		Beginning at Cor. No.1, A redwood post, 4 ft. long 4 ins. square, with nail at exact Cor., set 18 ins. in the ground, in mound of earth and stone, scribed SSE NO 1 1- 3426.
		The S.W. Cor. of Sec.30; T.19 N; R.19 W. bears S31°-21'E 1114.51 ft.
		No other bearing objects available.
		Thence N51°-02'E
	276.99	To E. End Center, A redwood post, 4 ft. long, 4 ins. square, with nail at exact point, set 18 ins. in the ground, in mound of earth and stone, scribed 3426.
	357.21	Intersect Westerly side line Bullion lode uns. at N35°-38'W 389 ft. from the S.W. Cor.
	600.50	To Cor. No.2, A redwood post, 4 ft. long, 4 ins. square with nail at exact Cor., set 18 ins. in the ground, in mound of earth and stone, scribed SSE NO 1 2-3426. S.W. Cor. Bullion lode, uns. bears S4°-34'E 470.65 ft.
		No other bearing objects available.
		Thence N73°-38'-30"W
	394.42	Intersect Westerly side line Bullion lode uns. at N35° 38'W 713.92 ft. from the S.W. Cor.
	900.00	Top of divide, course of summit Northeasterly and South- westerly.
	1287.71	To Cor. No.3, A redwood post, 4 ft. long, 4 ins. square, with nail at exact Cor., set 18 ins. in the ground, in mound of earth and stone, scribed SSE NO 1 3-3426.
		No bearing objects available.
		Thence N24°-27'W
	246.90	To Cor. No.4, Identical with Cor. No.1 Sunny Side Exten- sion lode of this survey, A redwood post, previously described, to which I add SSE NO 1 4-3426.

Feet. Thence S51°-02'W

235.00 Gulch draining Northerly.

298.81 To W. End Center, Identical with the E. End Center Sunny Side Extension lode of this survey, A redwood post, previously described to which I add 3426.

577.01 To Cor. No.5, Identical with Cor. No.2 Sunny Side Extension lode of this survey, A redwood post, previously described to which I add SSE NO 1 5-3426.

Thence S24°-57'E

96.65 To Cor. No.6, A redwood post, 4 ft. long, 4 ins. square with nail at exact Cor., set 18 ins. in the ground, in mound of earth and stone, scribed SSE NO 1 6-3426.

No bearing objects available.

Thence S68°-05'E

735.00 Top of divide, course of summit Northeasterly and Southwesterly.

1378.35 To Cor. No.1, the place of beginning.

Variation at all corners 15° East.

LODE LINES.

As near as can be determined from present developments the veins of the several locations embraced in this claim extend as follows from their respective discovery points,

Sunny Side- 1167.17 ft. N38°-55'W and 332.83 ft. S63°-19'E along outcrop of vein.

Sunny Side Extension- 445.94 ft. N53°-53'W and 1052.61 ft. S53°-36'E.

Sunny Side Extension No.1- 169.00 ft. N22°-59'W and 1330.04 ft. S70°-21'E.

On both legs of the lode line of the Sunny Side Extension No.1 lode, mineral bearing crevices of calcite and spar are exposed, conforming with the course of the lode line. The irregularity of the lode lines in this survey may demand explanation: These claims were amongst

Feet. the first locations in this end of the district and the locator anxious to comply with the exact meaning of the mining law, made the locations conform with the outcrop of the veins, This irregularity is due to the outcropping of a vein(dipping 50 to 70 degrees) on a steep mountain side which is in turn cut by a rugged gulch on the Sunny Side Extension No.1 lode.

<u>AREA.</u>	Acres.
Total area, Sunny Side lode -----	19.800
Area in conflict with:	
Lodestone lode uns.-----	.080
Total area, Sunny Side Extension lode-----	19.084
Total area, Sunny Side Extension No.1 lode--	15.826
Area in conflict with:	
Bullion lode uns.-----	.906

The survey of each lode of this location is identical with the respective amended location as staked upon the ground.

LOCATION.

This survey is located in ~~unapproved surveyed land~~ in Sec. 25; T.19 N; R.20 W; G.& S.R. B.& M. San Francisco Mining District, Mohave County, Arizona.

ADJOINING AND CONFLICTING CLAIMS.

On the North and West- Lodestone lode uns., Telluride M. M. & D. Co. claimant.

On the North- Golden Queen, Green and Gold, uns. lodes claimant unknown. Telluride No.3 uns. Telluride M. M. & D. Co. claimant.

On the North and East- Bullion lode uns., Monarch M. & M. Co. claimant.

On the South- R.A.M. lode uns. claimant unknown. U No.39 lode uns. Oatman Imperial M. Co. claimant. Sunny Side Annex No.1, Cash Combination and Sunny Side Annex uns. lodes, Oatman Nugget M. Co. claimant.

EXPENDITURE OF FIVE HUNDRED DOLLARS.

I certify that the value of the labor and improvements made upon, or for the benefit of each of the locations embraced in this survey, by the claimant or its grantors is not less than five hundred dollars and that said improvements consist of:-

Sunny Side.

No.1- The discovery shaft of the Sunny Side lode and the Main working shaft of this group, the center of the shaft is on the lode line 332.83 ft. from the E. End Center, 4 1/2 x 7 ft. in the clear, timbered; From center of shaft N45° E, on a dip of 81 degrees, 250 ft. to point A and 400 ft. to point 1 and 435 ft. to bottom of shaft. From point A an adit 5x6 1/2 ft. runs N45° E 13 ft. to point B; Thence N65° W 36 ft. to brst and S55° E 80 ft. to brst and N45° E 70 ft. to point C; Thence S50° E 44 ft. to Easterly brst and N50° W 18 ft. to Westerly brst. and N45° E 64 ft. to Northerly brst. From point 1 an adit 5x6 1/2 ft. runs S45° W 8 ft. to point 2; Thence S45° W 90 ft. to brst and N21°-47'W 20.5 to point 3; Thence N42°-20'E 86.3 ft. to point 4; Thence N37°-44'W 18.7 ft. to point 5; Thence S69°-33'W 28.9 ft. to point 6; Thence N75°-15'W 69.6 ft. to point 7; Thence N59°-30'W 45.7 ft. to point 8; Thence S85°-13'W 44.6 ft. to brst and N32°-42'W 14.5 ft. to point 9; Thence N66°-44'W 70.7 ft. to point 10; Thence N32°-43'W 97.9 ft. to point 11; Thence N51°-20'E 21.6 ft. to brst. and N33°-45'W 19.2 ft. to point 12; Thence N54°-28'W 61.5 ft. to point 13; Thence N44°-22'W 19.9 ft. to brst.

Total value of shaft and adits-----\$20841.00

Improvement No.1, above described (hereinafter known as Common Improvement) was started by the claimant company as the basis of a system of development work, for the development of the three claims in this group; At the present depth it is well over 400 ft. below the surface of the other two claims in this group; The claimant company proposes by drifting and crosscutting on the 400 ft. level toward and under the other claims in this group to

435 ft of shaft.
13 -2.5
36 -2.5
70
40 -2.5
18 -2.5
64
32.5
-1.0
31.5 Total on 250 level.
30.5
36.3
18.7
38.9
29.6
45.7
44.6 -2.5
14.5
70.7
47.9
21.6 -2.5
19.2
41.5
19.9
186.6 Total
-5.0
181.6 Total on 400

develop and mine them; This plan of using one advantageously located shaft for the development of a group of claims is one generally adopted by the larger companies and in this case being a feasible one, consistent with good mining the value of the improvement is equally divided among the three claims in this group, 1/3 or \$6947.00 being distributed to each.

No.2- Shaft, the center bears N79°-22'W 423.4 ft. from Cor. No. 6, 4x7½ ft. in the clear, From center of shaft N67°-40'E on a dip of 76 degrees, 150 ft. to point A and 176 ft. to point B; From point A an adit 4½x6 ft. runs N33°-20'W 54.2 ft. to brst; From point B an adit 4½x6 ft. runs N59°-35'E 48.6 ft. to brst.

Value of shaft and adits-----\$5373.00

No.3- Shaft, 4x6ft. 10 ft. deep, the center bears N63°-50'W 550 ft. from Cor. No.6. Value-----\$100.00

No.4- Cut, 4 ft. wide, The center of mouth bears S7°-25'E 320 ft. from Cor. No.5 running N68° E 80 ft. to 10 ft. face. Value-----\$320.00

1/3 interest in common improvement, heretofore described-----\$6947.00

Sunny Side Extension.

No.1- The discovery shaft of the Sunny Side Extension lode, the center is on the lode line 445.94 ft. from the W. End Center, 4x6 ft. From center of shaft N50°-13'E, on a dip of 60 degrees, 97 ft. to bottom, From bottom of shaft an adit 4x6 ft. runs S58°-10'W 60 ft. to brst.

Value of shaft and adit-----\$3005.00

No.2- Shaft 4x6 ft. 10 ft. deep, the center is on the lode line 981 ft. from the E. End Center. Value-\$100.00

No.3- Cut and Tunnel, The center of mouth of cut, 5 ft. wide, bears S51°-55'E 520 ft. from the W. End Center, running S53°-15'E 31 ft. to 10 ft. face, thence a tunnel 5x6 ft. runs S53°-15'E 31 ft. to point; thence S12°-55'E

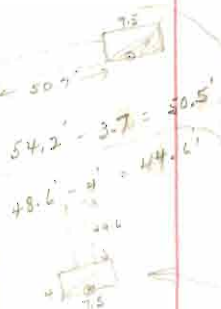

17 ft. to brst. Value of Cut and Tunnel-----\$557.00

No.4- The center of cut, 5 ft. wide is intersected by the lode line 301 ft. from the W. End Center, running N42° E 12 ft. to 8 ft. face and S42° W 12 ft. to mouth.

Value \$ 6000 0

1/3 interest in Common Improvement, heretofore described-----\$6947.00

Sunny Side Extension No.1

No.1- The discovery cut of the Sunny Side Extension No.1 lode, 4 ft. wide, the center of cut is on the lode line 169 ft. from the W. End Center, running S58° W 9ft. to 10 ft. face and N58° E 9 ft. to mouth. Value----\$36.00

No.2- Cut, the center of face 8 ft. wide, 15 ft. high, bears S66°-45'E 181 ft. from the W. End Center, running S67° W 15 ft. to mouth. Value----\$60.00

No.3- Cut and Tunnel, The center of mouth of cut, 7 ft. wide, bears S62°-05'E 254.8 ft. from the W. End Center, running N50° E 15 ft. to 10 ft. face, thence a tunnel 5x6 ft. running N50° E 5 ft. to face. Value----\$102.00

No. 4- Cut. The center of face 5 ft. wide and 10 ft. high, is on the lode line, 1215 ft. from the E. End Center running N22° W 16 ft. to mouth. Value----\$40.00

1/3 interest in Common Improvement, heretofore described-----\$6947.00

OTHER IMPROVEMENTS.

Tent Cabin, 14x24 ft., course of long side N4° W, The S.E. Cor. bears N55°-50'W 290 ft. from Cor. No.6 Sunny Side lode. Claimant herein.

Tent Cabin, 12x16 ft., course of long side N15° W, The S.E. Cor. bears N83°-05'W 212 ft. from Cor. No.6 Sunny Side lode. Claimant herein.

Tent cabin, boarding house, 14x36 ft., course of long

side N13° W., The S.W. Cor. is on the lode line 152 ft. from the discovery point of the Sunny Side lode.

Claimant herein.

INSTRUMENT AND DETERMINATION OF MERIDIAN

This survey was made with an Ainsworth Engineers transit.

The courses were deflected from the true meridian as determined by direct solar observations.

The distances were measured with 100 and 500 ft. steel tapes.

REPORT.

The side and end lines of the claims in this survey and all tie lines were run direct upon the ground.

The S.W. Cor. of Secs^{25 31&36} 30; T.19 N; R^{&20} 19 W., to which tie is given consists of a lava rock, 7x7 ins. 12 ins. above the ground, 5 notches chiseled on the Northerly side and indications of one notch on the Southerly side.

The West $\frac{1}{2}$ Cor. of Secs^{&26} 25; T.19 N; R.20 W., ~~unap-~~proved, to which tie is given consists of a one inch black iron pipe, stamped $\frac{1}{2}$ S26 S25.

All corners of the Lodestone lode uns. consist of 4x4 ins. redwood posts properly set and marked.

All corners of the Bullion lode uns. consist of 4x4 ins. pine posts, properly set and marked.

On my connected sheet the S.W. Cor. of Sec.30, platted from this survey, does not agree with the reported position of same. By rechecking my work I find the latter in error.

The disagreement between these notes and the notices of amended location is due to error in the latter.

Oatman, Arizona.

October 25, 1917.

Herman C. Zuleli
U. S. Mineral Surveyor.

FINAL OATHS FOR SURVEYS.

10/29/17

LIST OF NAMES.

A list of the names of the individuals employed by Herman C. Zulch
 United States ~~Deputy~~ Mineral Surveyor, to assist in running, measuring, and marking the lines, corners, and
 boundaries described in the foregoing field notes of the survey of the mining claim of
Sunnyside Gold Mines Company,
 known as the SUNNY SIDE, SUNNY SIDE EXTENSION, SUNNY SIDE EXTENSION NO. 1
lodes,
 and showing the respective capacities in which they acted.

A. F. Carper, Chainman.
 _____, Chainman.
 _____, Axman.
 _____, Flagman.

FINAL OATHS OF ASSISTANTS.

~~We~~ I, A. F. Carper
 and _____, do solemnly swear that ^I ~~we~~ assisted Herman C. Zulch
 _____, United States ~~Deputy~~ Mineral Surveyor, in marking the corners and surveying
 the boundaries of the mining claim of _____
Sunnyside Gold Mines Company,
 known as the Sunny Side, Sunny Side Extension, Sunny Side Extension No. 1
lodes,
 represented in the foregoing field notes as having been surveyed by said ~~deputy~~ mineral surveyor and under his
 my
 direction; and that said survey has been in all respects, to the best of ~~our~~ knowledge and belief, faithfully and
 correctly executed, and the corner and boundary monuments established according to law and the instructions
 furnished by the United States Surveyor-General for Arizona.

A. F. Carper, Chainman.
 _____, Chainman.
 _____, Axman.
 _____, Flagman.

Subscribed and sworn to by the above-named person ~~s~~ before me this 16th

day of October, 1917.

J. A. Francis
 Notary Public
 Nevada

FINAL OATH OF U. S. ~~DEPUTY~~ MINERAL SURVEYOR

I, Herman C. Zulch, U. S. ~~Deputy~~ Mineral Surveyor, do solemnly swear that, in pursuance of instructions received from the United States Surveyor General for Arizona, dated August 25, 1917, I have, in strict conformity to the laws of the United States, the official regulations and instructions thereunder, and the instructions of said Surveyor General, faithfully and correctly executed the survey of the Mining Claim of Sunnyside Gold Mines Company, known as the SUNNY SIDE, SUNNY SIDE EXTENSION, SUNNY SIDE EXTENSION NO. 1 lodes, situate in San Francisco Mining District, Mohave County, Arizona, in Section 25, Township No. 19 N., Range No. 20 W. Unapproved, and designated as Survey No. 3426, as represented in the foregoing field notes, which accurately show the boundaries of said mining claim as distinctly marked by monuments on the ground, and described in the attached copy of the location certificate, which was received by me from the Surveyor General with said instructions, and that all the corners of said survey have been established and perpetuated in strict accordance with the law, official regulations and instructions thereunder; and I do further solemnly swear that the foregoing are the true and original field notes of said survey and my report therein, and that the labor expended and improvements made upon said mining claim by claimant or its grantors are as therein fully stated, and that the character, extent, location and itemized value thereof are specified therein with particularity and full detail, and that no portion of said labor or improvements so credited to this claim has been included in the estimate of expenditures upon any other claim.

Herman C. Zulch
U. S. ~~Deputy~~ Mineral Surveyor.

Subscribed and sworn to by the said Herman C. Zulch,
U. S. ~~Deputy~~ Mineral Surveyor, before me Jacob Sheffield
A Notary Public this 25th
day of October, 1917.

Jacob Sheffield
Notary Public

(My Commission expires)
June 29th 1919

AMENDED LOCATION CERTIFICATE.

AUG 20 1917

KNOW ALL MEN BY THESE PRESENTS, that Sunnyside Gold Mines Co., C. R. McCollom, Agent, the undersigned citizen of the United States, over the age of twenty-one years, having complied with all the requirements of the laws of the United States and the State of Arizona, relating to mining claims, and with the local laws, customs, rules and regulations of San Francisco Mining District, hereby make and file this amended location of the Sunny Side Lode, claiming by right of discovery, location, primal appropriation and possession, 1500 feet linear and horizontal measurement, on this vein, or lode of quartz, or other rock in place, bearing gold and other valuable minerals, with all dips, variations and angles, the same being 1167.17 feet along the ledge in a N. 38° 56' W direction from the discovery shaft, and 332.83 feet along the ledge in a S. 63° 20' E direction therefrom, together with 300 feet in width on each side of the middle of said ledge and all veins, lodes, ledges, mineral deposits, mineral and surface ground within the lines of said claim.

Situate in San Francisco Mining District, County of Mohave, State of Arizona, in Sec. 25; T 19 N. R. 20 W. and more particularly described as follows, to-wit:

Beginning at Cor. No. 1 Identical with Cor. No. 4 Sunny Side Extension lode of this group.

Thence S. 51° 01' W 310.46 ft to E. End Center;
587.36 ft to S. E. Cor. No. 2,

Thence N. 66° 17½' W 345.91 ft to S. Angle Cor. No. 3;

Thence N. 39° 01' W 1163.22 ft to S. W. Cor. No. 4;

Thence N. 51° 01' E 300.00 ft to W. End Center,
586.95 ft to N. W. Cor. No. 5;

Thence S 38° 32' E 1167.65 ft to N. Angle Cor. No. 6;

Thence S 69° 11' E 346.80ft to Cor. No. 1, place of beginning.

All corners and end centers consist of 4 x 4 ins redwood posts properly set and marked.

THIS AMENDED LOCATION is made in conformity with the original location, made November 16, 1908, recorded February 11, 1909, in Book Z Page 735, of Quartz Locations in the office of the recorder of said County, and it is made for the purpose of appropriating all ground within the

-2-

boundaries hereinbefore described, and of more definitely describing the situation and boundaries of said lode, correcting any irregularities, informalities or errors, supplying omissions and correcting any defects, which may have existed in the original location, or the record thereof, hereby waiving no rights acquired under and by virtue of said original location. And if the original location or the certificate thereof is void, then this location shall be an original location and this certificate an original certificate.

Date of Original Discovery, November, 16, A. D. 1908.

Date of Amended Location January 1, A. D. 1917.

(ATTEST:)

C. H. Sampson.

Sunnyside Gold Mines Company,
R. C. McCollom,
Agent.

Recorded at the request of Sunnyside Gold Mines Co., at 9 o'clock A. M. January 31st, A. D. 1917, in Book S.S. of Mining Claims, page 49-50, Records of Mohave County, Arizona.

H. L. Underwood,
County Recorder.

AMENDED LOCATION CERTIFICATE

JUN 20 1917

KNOW ALL MEN BY THESE PRESENTS, that Sunnyside Gold Mines Co., C. R. McCollom, the undersigned citizen of the United States, over the age of twenty-one years, having complied with all the requirements of the laws of the United States and the STATE of Arizona, relating to mining claims, and with the local laws, customs, rules and regulations of San Francisco Mining District, hereby make and file this amended location of the Sunny Side Extension lode, claiming by right of discovery, location, primal appropriation and possession 1500. feet linear and horizontal measurement, on this vein or lode of quartz, or other rock in place, bearing gold and other valuable minerals, with all dips, variations and angles, the same being 1054.24 feet along the ledge in a S. 53° 38' E direction from the Disc. Shaft, and 445.94 feet along the ledge in a N. 53° 54' W. direction therefrom, together with 300 feet in width on each side of the middle of said ledge, and all veins, lodes, ledges, mineral deposits, mineral and surface ground within the lines of said claim.

Situate in San Francisco Mining District, County of Mohave, State of Arizona, in Sec. 25; T. 19 N. R. 20 W. and more particularly described as follows, to-wit:

Beginning at Cor. No. 1 Identical with Cor. No. 4 Sunny Side Extension No. 1 Lode, of this group.

Thence S. 51° 01' W. 298.81 ft. to E. End Center,
577.01 ft. to S. E. Cor. No. 2;

Thence N. 53° 39' W. 1498.27 ft. to S. W. Cor. No. 3;

Thence N. 51° 01' E 276.90 ft. to W. End Center,
587.36 ft. to N. W. Cor. No. 4;

Thence S. 50° 21' E. 330.09 ft. to N. Angle Cor. No. 5;

Thence S. 54° 05' E. 1166.16 ft. to Cor. No. 1, the place of beginning.

All corners and end centers consist of 4 x 4 ins. redwood posts, properly set and marked.

THIS AMENDED LOCATION is made in conformity, with the original location made November 16, 1908, recorded February 11, 1909, in Book Z page 735, of Quartz Locations, in the office of the Recorder of said County, and it is made for the purpose of appropriating all ground within the boundaries hereinbefore described, and of more definitely des-

cribing the situation and boundaries of said lode, correcting any irregularities, informalities or errors, supplying omissions, and correcting any defects which may have existed in the original location or the record thereof, hereby waiving no rights acquired under and by virtue of said original location. And if the Original Location or the certificate thereof is void, then this location shall be an original location and this certificate an original certificate.
 Date of Original Discovery, November 16, A. D. 1908.

Date of Amended Location January 1, A. D. 1917

ATTEST: Sunnyside Gold Mines Company,
C. R. McCollom,
Agent
 C. H. Sampson.

Recorded at the request of Sunnyside Gold Mines Co., at 9 o'clock A. M. January 31st, 1917, in Book S.S. of Mining Claims, page 50-51 Records of Mohave County, Arizona.

H. L. Underwood,
County Recorder.

JUL 20 1917

AMENDED LOCATION CERTIFICATE.

KNOW ALL MEN BY THESE PRESENTS, that Sunmyside Gold Mines Co., C. R. McCollom, Agent, the undersigned citizen of the United States, over the age of twenty-one years, having complied with all the requirements of the laws of the United States, and the State of Arizona, relating to mining claims, and with the local laws, customs, rules and regulations of San Francisco Mining District, hereby make and file this amended location of the Sunny Side Extension No. 1 lode, claiming by right of discovery, location, primal appropriation and possession, 1498.48 feet, linear and horizontal measurement, on this vein or lode of Quartz, or other rock in place, bearing gold and other valuable minerals, with all dips, variations and angles, the same being 1329.48 feet along the ledge in a S 70° 20' E direction from the discovery cut, and 169 feet along the ledge in a N. 23° W direction therefrom, together with 300 feet in width on each side of the middle of said ledge, and all veins, lodes, ledges, mineral deposits, mineral and surface ground within the lines of said claim.

Situate in San Francisco Mining District, County of Mohave, State of Arizona, in Sec. 25: T 19 N. R. 20 W. and more particularly described as follows, to-wit:

Beginning at Cor. No. 1, whence: The S. E. Cor. of Sec. 25; T. 19 N. R. 20 W. G. & S. R. B. & M. bears S. 31° 21' E. 1114.51 ft.

Thence N. 51° 01' E 276.99 ft. to E. End Center,
600.50 ft. to N. E. Cor. No. 2;
Thence N. 73° 39½' W 1287.71 ft. to N. Angle Cor. No. 3;
Thence N. 24° 28' W 246.90 ft. to N. W. Cor. No. 4;
Thence S. 51° 01' W 298.81 ft. to W. End Center,
577.01 ft to S. W. Cor. No. 5,
Thence S. 24° 58' E. 96.65 ft to S. Angle Cor. No. 6;
Thence S. 68° 06' E. 1378.35 ft to Cor. No. 1, the place of

beginning.

All corners and end centers consist of 4 x 4 ins. redwood posts, properly set and scribed.

THIS AMENDED LOCATION is made in conformity with the original location, made November 16, 1908, recorded February 11, 1909, in Book Z Page 736 of Quartz Locations in the office of the recorder of said County,

and it is made for the purpose of appropriating all ground within the boundaries hereinbefore described, and of more definitely describing the situation and boundaries of said lode, correcting any irregularities, informalities or errors, supplying omissions and correcting any defects which may have existed in the original location, or the record thereof, hereby waiving no rights acquired under and by virtue of said original location. And if the original location or the certificate thereof is void, then this location shall be an original location and this certificate an original certificate.

Date of Original Discovery, November 16, A.D. 1908.

Date of Amended Location, January 1, A. D. 1917.

Attest
 C. H. Sampson.
 Sunnyside Gold Mines Company,
 C. R. McCollom,
 Agent.

Recorded at the request of Sunnyside Gold Mines Co., at 9 o'clock A.M. January 31st, 1917, in Book S.S. of Mining Claims, page 51-52, Records of Mohave County, Arizona.

STATE OF ARIZONA }
 County of Mohave } ss.

I, H. L. Underwood, Recorder of Mohave County, State of Arizona,

do hereby certify that I have compared the foregoing copies of amended location certificates of Sunny Side Lode, Sunny Side Extension and Sunny Side Extension No. 1, dated January 1, 1917, and of the endorsement thereon with the original records of the same on file in this office, and that the same are correct transcripts therefrom and of the whole of said original records.

WITNESS my hand and the seal of said office this 16th

day of August 1917.

..... *H. L. Underwood*
 Recorder of Mohave County, Arizona.



U. S. SURVEYOR-GENERAL'S FINAL CERTIFICATE ON FIELD NOTES.

Department of the Interior,

OFFICE OF U. S. SURVEYOR-GENERAL,

Phoenix, Arizona.

April 6, 1918

I, U. S. Surveyor-General for District of Arizona

do hereby certify that the foregoing transcript of the Field Notes, return and approval of the survey of the mining claim of

SUNNYSIDE GOLD MINES COMPANY

known as the SUNNY SIDE, SUNNY SIDE EXTENSION, SUNNY SIDE EXTENSION NO. 1 LODES.

situate in SAN FRANCISCO

Mining District, MOHAVE County, ARIZONA.

in Section 25, Township No. 19 N., Range No. 20 W., and

designated as Survey No. 3426, has been correctly copied from the originals on file in

this office; that said Field Notes furnish such an accurate description of said mining claim as will, if incorporated into a patent, serve fully to identify the premises, and that such reference is made therein to natural objects or permanent monuments as will perpetuate and fix the locus thereof.

And I further certify that five hundred dollars' worth of labor has been expended or improvements made upon said mining claim by claimant or its grantors, and that said improvements consist of 5 shafts, 7 cuts, 5 adits and 2 tunnels, total value, \$30,594. As improvement No. 1 on the Sunny Side lode is a common improvement for the benefit and development of the three claims in this survey, an undivided one-third interest therein, value \$6947, is properly credited to each of the claims in the group.

and that no portion of said labor or improvements has been included in the estimate of expenditures upon any other claim.

I further certify that the plat thereof, filed in the U. S. Land Office at Phoenix, Arizona, is correct and in conformity with the foregoing Field Notes.

Frank P. Trott,

United States Surveyor-General for Arizona.

SURVEYOR-GENERAL'S CERTIFICATE OF APPROVAL OF FIELD
NOTES AND SURVEY OF MINING CLAIM.

Department of the Interior,

OFFICE OF U. S. SURVEYOR-GENERAL,

Phoenix, Arizona,

April 6, 1918

I, U. S. Surveyor-General for District of Arizona

do hereby certify that the foregoing and hereto attached Field Notes and Return of the Survey of the
Mining Claim of

SUNNYSIDE GOLD MINES COMPANY

known as the
SUNNY SIDE, SUNNY SIDE EXTENSION, SUNNY SIDE EXTENSION NO. 1 LODES.

situate in SAN FRANCISCO mining district,

MOHAVE County, ARIZONA.

in Section 25, Township No. 19 N., Range No. 20 W.

designated as Survey No. 3426

executed by Herman C. Zulch, United States Mineral

Surveyor, September 5-25, 1917; under my instructions dated

August 25, 1917, have been critically examined and the necessary cor-

rections and explanations made, and the said Field Notes and Return, and the Survey they describe,

are hereby approved. A true copy of the copy of the location certificate filed by the applicant for

survey is included in the field notes.

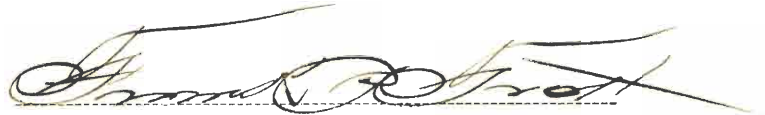

U. S. Surveyor-General for Arizona.