

JUN 29 1918

SEP 27 1918

11-6-1918 Copied - ARC

*Platted*

(4-683.)

Mineral Survey No. 3501

Lot No. \_\_\_\_\_

Arizona Land District.

### FIELD NOTES

OF THE SURVEY OF THE MINING CLAIM OF

~~Daily Arizona Consolidated Copper Company~~

KNOWN AS THE

~~HOLY TERROR, PRECIOUS METALS, QUINCY Lodes~~

Old Hat Mining District,

Pima County, Arizona

Unsurveyed  
Section 15-16, Township 11 S., Range 16 E.

Surveyed under instructions dated April 12, 1918,

by T.N. Stevens,  
U. S. Deputy Mineral Surveyor.

Claim located See location notice, 1916

Survey commenced April 21, 1918

Survey completed April 24, 1918

o 6-180

Address of Claimant:

G.S.Hancock, Attorney in Fact,

Tucson, Arizona.

Min. Sur. No 3501.

Holy Terror Lode.

Beginning at Cor. No. 1. A limestone 5X18X5 ins. 12 ins. in the ground, chiseled with a cross (X), HT -1-3501 with md. of stone alongside, whence the 1/4 Sec Cor. bet. Secs 15-16, T. 11 S., R. 16 E. G & S.R.M. bears S. 68°-12' E., 1220.1 ft.

An oak 16 ins. diam. brs. S. 7°-00' W., 27.2 ft. dist.

Blazed and scribed B.T. 1-3501.

Thence N. 75°-29' W.

Va. 13°-30' E.

Feet

326.0 To North End Center, an oak post 4 ft. long by 4 ins. square, set 18 ins. in the ground and surrounded with a mound of stone, scribed N. Cr. H.T. on S face.

652.0 To Cor. No. 2 a granite rock 6X6X5 ins. set 12 ins. in the ground with mound of stone alongside chiseled with cross (X) HT-2-3501. An oak 16 ins. diam. bears S 50°-00' W., 9.4 ft. dist.

Blazed and scribed B.T. 2-3501.

Thence S. 8°-58' E.,

Va. 13°-30' E.

1500.0 To Cor. No 3, set a limestone 8X10X6 ins. 12 ins in the ground, chiseled with a cross (X) HT, 3-3501 on N.E. face. with md of stone alongside, 3 1/2 ft. base by 3 ft. high.

An oak tree 20 ins in diameter bears N. 20°-00' E., 71.9 ft. dist.

blazed and scribed B.T. 3-3501.

Thence S. 75°-29' E.

Va. 13°-30' E.

326.0 To South End Center, an oak post 4 ins square by 4 ft. long set 18 ins in the ground and surrounded by a monument of stone 3 1/2 ft base by 3 ft high, scribed S Cr. H.T.

476.0 Center old road course N. 40°-00' E.

652.0 To Cor. No 4, Identical with Cor. No 3 Precious Metals lode of this Sur. a limestone 6 X 20 X 2 ins. 12 ins. in the ground chiseled with a cross (X) HT- 4-3501, 3-3501 with post 4 ins Sq. by 4 ft high, set 18 ins in the ground, surrounded by a mound of stone, and scribed S.E. H.T and S.W.P.M., alongside.

No bearings are available.

Sur. No. 3501 Continued

Holy Terror Lode-continued.

	Thence N.8°-58'W
	Va. 13-30' E.
Feet	
475.0	Old road, course N. 45.00' E.
606.0	To Cor No. 4 Precious Metals Lode and Cor No 3 Quincy Lodes of this survey
656.0	Center road to Daily Camp bears East.
1212.0	To Cor No 4 Quincy Lode of this survey.
1500.00	To Cor.. No 1 the place of beginning.

Sur. No. 3501- Continued.

Precious Metals lode.

Beginning at Cor. No.1, identical with Cor. NO.2 Quincy lode of this survey. A quartzite 6 x 12 x 5 ins., set 12 ins. in the ground and chiseled with cross (X) EM-1,Q-2-3501,with md of stone 3 1/2 ft base by 3 ft high alongside, whence the W.1/4 Cor. said Sec. 15 brs N.47-47 W.,607.43 ft.

An oak 12 ins. diam. Brs. N. 20-00'W., 23.2 ft. Blazed and scribed B.T. 1-2-3501.

Feet

Thence S.8°-58' E.

Va. 13°-30'E.

303.0 To East end center, an oak post 4 ins. Sq by 4 ft. long set 18 ins. in the ground and surrounded with a mound of stone 3 1/2 ft. base by 3 ft. high, scribed E. Cr. P. M.

606.0 To Cor. No. 2, A limestone 8 x 10 x 5 ins. set 12 ins. in the ground and chiseled with a cross (X) EM 2-3501 with md of stone 3 1/2 ft base by 3 ft high alongside

An oak 24 ins. Diam. Brs. N.70-00'E., 52.2 ft. Blazed and scribed B.T. EM-2-3501.

Thence S. 89°-08' W.

Va. 13°-30' E.

544/31 Intersect W. boundary of Sec. 15, at S. 1014.96 ft. from W. 1/4 Cor. said Sec, and N. 1625 ft from S.W. Cor.

1443.54 To Cor. No.3, identical with Cor. No 4 Holy Terror lode of this survey, heretofore described.

Thence N.8°-58' W.

Va.13°-30' E.

303.0 To W. End center. An oak post 4 ins Sq. by 4 ft long set 18 ins. in the <sup>ground</sup> and surrounded with a monument of stone 3 1/2 ft base by 3 ft high, blazed and scribed W Cr.P M

606.0 To Cor. No 4, identical with Cor. No. 3 Quincy lode of this survey. On line 4-1 Holy Terror lode of this survey. A quartzite 6 X 8 X 5 ins. set 12 ins. in the ground and chiseled with cross (X) EM 4,Q 3-3501 with md of stone 3 1/2ft base by 3 ft high alongside.

No bearings are available.

Thence N. 89°-08' E.

Va. 13°-30'E.

110.0 To center road, brs. N. 40 E.

993.64 Intersect W. boundary of Sec. 15 Uns. at S. 415.0 ft. from w. 1/4 Cor. said Sec. and N. <sup>2224.96</sup> ~~2639.96~~ ft from S.W. Cor.

Survey No. 3501- continued.

Precious Metals Lode-continued.

Feet	
1443.54	To Cor. No. 1, the place of beginning.
	Quincy Lode.
	Beginning at Cor. No.1
	A porphyry rock 6 x 10 x 8 ins. set 12 ins. in the ground with mound of stone alongside, chiseled with cross (X) <sup>Q</sup> and 1-3501.
	Whence the W. 1/4 Cor. Sec. 15, Brs. S. 61-49' W., 403.2. ft
	An oak 24 ins. Diam. Brs. N.79-30' W., 47.0 ft.
	An oak 24 ins. diam. brs. S. 42-00' E., 27.7 ft.
	Both blazed and scribed B.T. 1-3501
	Thence S. 8-58' E.
	Va. 13-30' E.
303.0	To East End Center, a pine post 4 ins. sq by 4 ft long set 18 ins. in the ground and surrounded with a md of stone 3 1/2 ft high, scribed E Cr. <sup>Q</sup>
606.0	To Cor. No. 2, identical with Cor. No.1 Precious Metals lode of this survey, heretofore described
	Thence S. 89-08' W.
	Va. 13-30' E.
449.9	Intersect W. boundary Sec. 15 at S. 415.0 from W. 1/4 Cor. said Sec, and N/ 2224.96 ft. from S.W. Cor.
1443.54	To Cor. No.3, identical with Cor. No.4 Precious Metals lode and on line 4-1 Holy Terror lode of this survey, heretofore described.
	Thence N.8-58' W.
	Va. 13-30' E.
303.0	To W. End Center, an oak post 4 ins sq by 4 ft long set 18 ins in the ground, surrounded with md of stone 3 1/2 ft high, scribed W Cr. <sup>Q</sup>
606.0	To Cor. No.4, a porphyry rock 6 x 6 x 6 ins. set 12 ins. in the ground with Md. of stone alongside, chiseled with cross (X) <sup>Q</sup> and 4-3501
	An oak 18 ins. Diam. Brs. N. 70-00' W., 12.9 ft.
	Blazed and scribed B.T. 4-3501.
	Thence N. 89-08' E.
	Va. 13-30' E.
1088.1	Intersect W. boundary Sec. 15 at N. 185.0 ft. from W. 1/4 Cor. said Sec. and S. 2455 ft. from N.W. Cor.
1443.54	To Cor. No. 1, the place of beginning.

Survey No. 3501- Continued.

Lode Lines.

As near as can be determined from the present developments the veins of the several locations embraced in this claim extend as follows from their respective discovery points:

Holy Terror Lode, 350 Ft. S. 8°-58'E., and 1150 Ft. N.8°-58'W.

Precious Metals Lode, 10 Ft.N.89°-08'E.,and 1433.54 Ft.S.89°-08'W.

Quincy Lode, 20 Ft. N.89°-08' E., and 1423.54 Ft. S.89°-08' W.

Areas

Total area, Holy Terror Lode-----	20.592
Total area, Precious Metals Lode-----	19.882
Total area, Quincy lode-----	19.882

The survey of each lode of this location is identical with the respective amended location as staked upon the ground.

Location.

This survey is located in the S.W 1/4 of N.W. 1/4 and the N.W.1/4 of S.W.1/4 Sec. 15, Uns. and S.1/2 of N.E.1/4 and the N.1/2 of S.E.1/4 Sec. 16, Unsr., T. 11 S., R. 16 E., of G. & S. R., B M., in the Coronado Nat'l Forest.

EXPENDITURE OF FIVE HUNDRED DOLLARS.

I certify that the value of the labor and the improvements made upon, or for the benefit of each of the locations embraced in said mining claim by the claimant or its grantors is not less than five hundred dollars, and that said improvements consist of:

Holy Terror

No.1. The discovery cut Holy Terror lode, the face of which being the discovery point, is on the lode line 350 ft. from a point on line 3-4, 326 ft. from Cor. No.3, 6 ft. wide, 10 ft. face running S. 8°-58'E., 20 ft.

Value \$125.0

An undivided 1/3 interest in tunnel No.8 on the Precious Metals lode credited to, this lode.

\$430.0

Precious Metals.

No. 1. The discovery cut of the Precious Metals lode, the face of which being the discovery point, is on the lode line, 10 ft. from center of line 1-2, 5 ft wide, 10 ft. face, running N. 89°-08'E., 10 ft.

Value \$100.0

No.2. An open cut the face of which brs. from Cor. No.1 S.41°-30'E., 280 ft., running S. 3-00'W. to mouth. From face is a tunnel 4 X 6 ft. running N..3-00'E., 19 ft. From same face is another tunnel 4 X 6 ft. running N. 66-00' W., 45 ft.

Value of cut and tunnel \$690.0

No.3 A cut the mouth of which brs. from Cor. No.1 S. 67-45'W/, 382 ft., 4 ft wide by 12 ft. face, running N. 26 ft. to face.

Value \$150.0

No. 4 A shaft the center of which brs. from Cor. No.1 S. 70-05' W., 495 ft. 4 X 6 ft. 8 ft. deep.

Value \$80.0

No.5. A shaft, the center of which brs from Cor. No.1, S, 72-15'W., 520 ft. 4 X 6 ft., 8 ft deep.

Value \$80.0

No.6 A shaft, the center of which brs. from Cor. No.1 S. 69-00' W., 530 ft. 5 X 5 ft., 5 ft. deep

Value \$ 50.0

No.7 A shaft, the center of which brs. from Cor. No.1 S. 69-50'W., 555 ft. 4 X 6 ft., 10 ft. deep.

Value \$100.0

No. 8 A tunnel , the mouth of which brs. from Cor. No.2 N. 9-45'W., 225 ft., thence;/ from mouth S. 54-00'W., 10 ft. to face. from mouth N. 56-54'W., 10.7 ft. to point. Thence S. 54-21'W., 7.2 ft to face.

From point N. 3-06' E., 33.5 ft. to face. From same point N. 56-54' W., 11.9 ft. to point 2. From point 2 S. 61-26' W., 35 ft to face. From point 2 N.71-54'W., 21.7 ft. Value \$1290.0

An undivided 1/3 interest credited to this claim----\$430.0

This tunnel is in the course of construction for the development of this claim and the contiguous claims, Holy Terror and Quincy lodes, claimants herein. An undivided 1/3 interest in this tunnel, value \$430.0, has been credited to each of the last two mentioned lodes. No other portion or interest in this tunnel has been credited to any other claim.

The surface embraced in this claim ascends rapidly from the mouth of the tunnel to Cors. No.2-3 Quincy lode, The discovery cuts of the two mentioned lodes are from 300 to 500 ft. higher than the mouth of the tunnel. The tunnel described and included in the estimate of expenditures, continued in its present course, will cut the veins of the several locations at great depth, whereby, by one system of workings and one plant of machinery, the entire claim can be most advantageously and economically developed.

Quincy

No. 1 The discovery point of the Quincy lode, on the center line 20 ft. from the center of line 1-2, A monument of stone 3 1/3 ft. base by 3 ft. high

No. value.

No. 2 ~~The cut of the Quincy lode~~, the face of which brs. from Cor. No.2 N.19-00'W., 180 ft. 4 ft. wide, 10 ft. face, running E. 10 ft. to mouth. Value \$100.0

An undivided 1/3 interest in tunnel No.8 on the Precious Metals lode, credited to this lode.----- \$430.0

Other Improvements.

A cut the mouth of which brs. from Cor. No. 1 Quincy lode, S.8-30'E., 22 ft. 4 ft. wide, 10 ft. face, running N. 42 W., 23 ft. From face is a tunnel 4 X 6 ft. running N. 42 W., 22 ft.

Instrument.

This survey was made with a Gurley mountain transit, the courses were deflected from the true meridian as determined by direct solar observations. The distances were measured with a 500 ft. steel tape.



Sur. No. 3501.  
REPORT.

The lode line of each location of this claim was run directly upon the ground, and the corners were established by running around the claim. All ties were run directly upon the ground.

The W. 1/4 Cor. Sec. 15, T. 11 S., R. 16 E., G. & S. R. B. M. is a limestone boulder 8 X 10 X 6 ins. above ground, chiseled with 1/4 on W. face.

Near it are two witness trees, blazed but the scribing cannot be distinguished as the blazes have grown over. This is the nearest corner of the public survey.

The N.W. Cor. Sec. 15 is a granite rock 6 X 14 X 18 ins. above ground chiseled with 3 notches on the E face, and 4 notches on the S. face.

Near it are three oak trees about 12 ins. in diam. Blazed and scribed, S.-9-BT., S.-16-BT., and S.-15-BT. respectively.

The S.W. Cor. Sec. 15, <sup>or the Cor. Secs. 15, 16, 21 & 22</sup> is a granite rock 8 X 12 X 12 ins. above ground, chiseled with 3 notches on E. face, and 3 notches on the S. face, and T. 11 S., R. 16 E. chiseled on the S.E. face, near it are two oak trees about 5 ins. diam. blazed and scribed. The only scribing that can be distinguished is BT ↗

There are no adjoining or conflicting claims known, except Nicholas <sup>unsur, on the south,</sup> No. 4, whose corners I am unable to identify, claimant Chas. Udall.

Note.- The amended location certificates of the Precious Metals and Quincy lodes fail to furnish the true courses of their side lines and the same are properly given in these field notes.

All corners are identical with the location monuments as staked upon the ground.

-----oOo-----

*do not copy*

Direct Solar observation taken Apr. 23, 1918 at 7.56 A.M. Solar time, Sun bisected. Lat. 32°-28' - Lon. 110-42'

Apparent Dec'l Apr. 23- 12°-21'-01"

Dif. in time - 3.33 hr.  $\frac{2'-47''}{12°-18'-14''}$

$$\text{Sin. } 1/2 A = \frac{\text{Sin } (S-L) \text{ (S-H)}}{\text{Cos. L. Cos. H}}$$

$$P = 90 - 12° 18' = 77° 42'$$

Sur. No. 3501  
 REPORT Cont'd

L = 52-28'  
 H = 31-23' Ver. Ang. diminished by Ref.  
 P = 77-42'  
 z | 141-33'  
 S = 70-46'  
 S-L = 36-18'  
 S-H = 39-23'

9.7922369  
 9.8024355  
 0.0738091  
 0.0686935  
19.7371750  
 19.8685875 = 47-38' 1/2 A  
 95-16' A

180°  
 95-16'  
 S. 84-44' E. Course of Sun.  
 75-46'  
 S. 8-58' E. Course of line 1-2 Quincy lode.

Set up at Cor. No.1 Quincy lode, BS at Cor. No.2

# FINAL OATHS FOR SURVEYS.

## LIST OF NAMES.

A list of the names of the individuals employed by T.N. Stevens

United States Mineral Surveyor, to assist in running, measuring, and marking the lines, corners, and boundaries described in the foregoing field notes of the survey of the mining claim of \_\_\_\_\_

~~Daily Arizona Consolidated Copper Company~~

known as the Holy Terror, Precious Metals and Quincy Lodes

and showing the respective capacities in which they acted.

W.H. Coplen \_\_\_\_\_, *Chainman.*

\_\_\_\_\_, *Chainman.*

\_\_\_\_\_, *Arman.*

\_\_\_\_\_, *Flagman.*

## FINAL OATHS OF ASSISTANTS.

We, I, W.H. Coplen

and \_\_\_\_\_, do solemnly swear that <sup>I</sup>~~we~~ assisted \_\_\_\_\_

T.N. Stevens, United States Mineral Surveyor, in marking the corners and surveying the boundaries of the mining claim of Daily Arizona Consolidated Copper Company

known as the Holy Terror, Precious Metals and Quincy Lodes

represented in the foregoing field notes as having been surveyed by said mineral surveyor and under his

direction; and that said survey has been in all respects, to the best of our knowledge and belief, faithfully

and correctly executed, and the corner and boundary monuments established according to law and the instruc-

tions furnished by the United States Surveyor-General for Arizona

W.H. Coplen \_\_\_\_\_, *Chainman.*

\_\_\_\_\_, *Chainman.*

\_\_\_\_\_, *Arman.*

\_\_\_\_\_, *Flagman*

Subscribed and sworn to by the above-named persons before me this 21<sup>st</sup>

day of May, 1918

*My Commission Expires February 19, 1920*

Geo. P. Myers  
*Notary Public*

# FINAL OATH OF U. S. MINERAL SURVEYOR.

I, T.N. Stevens, U. S. Mineral Surveyor, do solemnly swear that, in pursuance of instructions received from the United States Surveyor General for Arizona, dated April 12, 1918, I have, in strict conformity to the laws of the United States, the official regulations and instructions thereunder, and the instructions of said Surveyor General, faithfully and correctly executed the survey of the Mining Claim of Daily-Arizona Consolidated Copper Company, known as the Holy Terror, Precious Metals, Quincy Lodes, situate in Old Hat Mining District, Pima County, Arizona, in Sections 15-16 Uns, Township No. 11S., Range No. 16 E., G.&S.R. M., and designated as Survey No. 3501, as represented in the foregoing field notes, which accurately show the boundaries of said mining claim as distinctly marked by monuments on the ground, and described in the attached copy of the location certificate, which was received by me from the Surveyor General with said instructions, and that all the corners of said survey have been established and perpetuated in strict accordance with the law, official regulations and instructions thereunder; and I do further solemnly swear that the foregoing are the true and original field notes of said survey and my report therein, and that the labor expended and improvements made upon said mining claim by claimant or ~~their~~ <sup>to</sup> grantors are as therein fully stated, and that the character, extent, location, and itemized value thereof are specified therein with particularity and full detail, and that no portion of said labor or improvements so credited to this claim has been included in the estimate of expenditures upon any other claim.

T.N. Stevens  
U. S. Mineral Surveyor.

Subscribed and sworn to by the said T.N. Stevens  
U. S. Mineral Surveyor, before me Geo. P. Myers, a Notary Public in Pima County Arizona this 24<sup>th</sup>  
day of May, 1918

Geo. P. Myers  
Notary Public

My Commission Expires }  
February 19, 1920

STATE OF ARIZONA, }  
COUNTY OF PIMA. } ss.

I, R. B. Vinson, County Recorder in and for the  
County of Pima, State of Arizona, do hereby certify that the above and foregoing is a full, true and correct copy  
of Amended Location Notice of the Holy Terror Mining Claim situated  
in the Old Hot Mining District, and now owned by the Daily-Arizona  
Consolidated Copper Company, dated Nov. 22nd, 1917.  
as appears of record now in my office in Book B. B. B. Record of Mines Pages 382

IN WITNESS WHEREOF, I have hereunto set my hand

and affixed my official seal, at my office in Tucson,

this Eighth day of

January, A. D. 1917

R. B. Vinson  
County Recorder of Pima County, Arizona.



15

14

AMENDED

# Notice of Mining Location

## LODE CLAIM

TO ALL WHOM IT MAY CONCERN:

This Mining Claim, the name of which is the HOLY TERROR Mining Claim, situate on lands belonging to the United States of America, and in which there are valuable mineral deposits, was entered upon and located for the purpose of exploration and purchase by S. E. HALL, grantor of

(Locator must insert either "a citizen of the United States." or "who has declared his intention to become a citizen of the United States.")

the undersigned, on the 1st day of January, 1892.

The length of the claim is 1500 feet, and we claim 350 feet, in a S 8° 58' E direction and 1150 feet in a N 8° 58' W direction from

the center of the discovery shaft, at which this notice was posted, lengthwise of the claim, together with 300 feet in width of surface grounds, on each side of the center of said claim. The general course of the lode deposit and premises is from the S 8° 58' E to the N 8° 58' W.

The Claim is situated and located in the OLD HAT Mining District, in Pima County in the State of Arizona, ~~about~~ in a ~~direction~~ from S. W. Cor. Claim.

The N W Cor Sec 21, T 11 S., R 16 E. bears S 63° 56' W 4136.4 ft.

The surface boundaries of the claim are marked upon the ground as follows: Beginning at A Monument of Stone

at a point in a S 8° 58' E direction 350 feet from the discovery shaft (at which this notice is posted), being in the center of the South end line of said claim; thence S 75° 29' E 326 feet to a Monument, being the S. E. corner of said claim; thence N 8° 58' W 1500 feet to a Monument, being at the N. E. corner of said claim; thence N 75° 29' W 326 feet to a Monument at the center of the North end of said claim; thence N 75° 29' W 326 feet to a Monument being at the N. W. corner of said claim; thence S 8° 58' E 1500 feet to a Monument at the S W corner of said claim; thence S 75° 29' E 326.0 feet to the place of beginning.

All done under the provisions of Chapter Six, of Title XXXII, of the Revised Statutes of the United States, and of an Act of the General Assembly of Arizona, entitled "An Act to Revise and Codify the Laws of the Territory of Arizona," approved March 16, 1901.

This is an Amended Location Notice of the HOLY TERROR Mining Claim, located by S. E. HALL, grantor of the undersigned owner, on the 1st day of January, 1892, and recorded in Book C. C. of Records of Mines, at page 389, in the office of the County Recorder of the aforesaid County of ----- to which reference is hereby made, and this amended Location Notice is made and posted to correct errors in the description in the said original Location Notice.

Dated and posted on the ground this 22nd day of Nov, 1917

DAILY-ARIZONA CONSOLIDATED COPPER COMPANY,  
(present owner)

By J. M. Jacobs  
Its Attorney in Fact.

STATE OF ARIZONA,

County of \_\_\_\_\_ } ss.

I \_\_\_\_\_, County Recorder in and for the County and State aforesaid, do hereby certify that the within instrument was filed for record at \_\_\_\_\_ o'clock \_\_\_\_\_ M., on this \_\_\_\_\_ day of \_\_\_\_\_ 19\_\_\_\_\_, and duly recorded in book No. \_\_\_\_\_ of \_\_\_\_\_ Records of \_\_\_\_\_ County, Arizona, at pages \_\_\_\_\_.

WITNESS my hand and official seal the year first above written.

Country Recorder.

**AMENDED  
Notice of Location  
LODE CLAIM**

Dated \_\_\_\_\_, 19\_\_\_\_,

Filed and Recorded at request of

*P. W. Langworthy*

*Dec 1st A. D. 1917*

at \_\_\_\_\_ M.,

Book *P. P. Record of mines*

Pages *282*

County Recorder.

By *P. P. Hanson*  
*A. M. Shubell*  
Deputy Recorder.

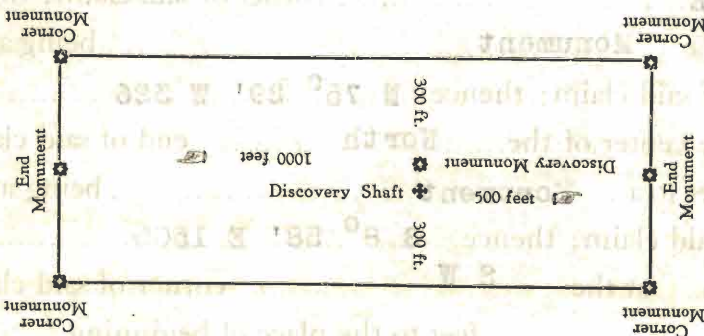

This Diagram is to give locator a general idea of plan of location under the new law. The Discovery Shaft can be in the center of the claim or any distance from either end desired. In the diagram it is placed 500 feet from one end and 1000 ft. from the other. Commence description of claim at a center end monument, giving its distance and direction from center of Discovery Shaft; thence bound the claim in either direction. In description be careful to state locality of claim with reference to some natural object, or permanent monument, as will identify the claim.

STATE OF ARIZONA, }  
COUNTY OF PIMA. } ss.

I, R. B. Vinson....., County Recorder in and for the  
County of Pima, State of Arizona, do hereby certify that the above and foregoing is a full, true and correct copy  
of Amended Location Notice of the Precious Metals Mining Claim  
situated in the Old Hat Mining District, and now owned by Daily-  
Arizona Consolidated Copper Company, dated Nov. 22nd, 1917  
as appears of record now in my office in Book B. B. B. Record of Mines pages 383

IN WITNESS WHEREOF, I have hereunto set my hand

and affixed my official seal, at my office in Tucson,

this Eighth..... day of

January....., A. D. 1917

R. B. Vinson  
County Recorder of Pima County, Arizona.



16

17

AMENDED

# Notice of Mining Location

## LODE CLAIM

TO ALL WHOM IT MAY CONCERN:

This Mining Claim, the name of which is the PRECIOUS METALS Mining Claim, situate on lands belonging to the United States of America, and in which there are valuable mineral deposits, was entered upon and located for the purpose of exploration and purchase by S. E. HALL, grantor of

(Locator must insert either "a citizen of the United States." or "who has declared his intention to become a citizen of the United States.")

the undersigned, on the 1st day of January, 1892.

The length of the claim is 1443.54 feet, and we claim 10 feet,

in a N 72° 56' E direction and 1433.54 feet in a S 72° 56' W direction from

the center of the discovery shaft, at which this notice was posted, lengthwise of the claim, together with 300 feet in width of surface grounds, on each side

of the center of said claim. The general course of the lode deposit and premises is from the N 72° 56' E to the S 72° 56' W

The Claim is situated and located in the OLD HAT Mining District, in Pima County in the State of Arizona, ~~about~~

in a ~~direction~~ from N. W. Cor. Claim

The N. W. Cor. Sec. 21, T. 11 S., R. 16 E., bears S. 62° 05' W. 4812.2

The surface boundaries of the claim are marked upon the ground as follows: Beginning at a Monument

at a point in a N 72° 56' E direction 10 feet from

the discovery shaft (at which this notice is posted), being in the center of the East end line of said claim; thence N 8° 58' W 303 feet to a Monument,

being the N. E. corner of said claim; thence S 72° 56' W 1443.54 feet to a Monument, being at the

N. W. corner of said claim; thence S 8° 58' E 303 feet

to a Monument at the center of the West end of said claim;

thence S 8° 58' E 303 feet to a Monument being at the

S. W. corner of said claim; thence N 72° 56' E 1443.54 feet

to a Monument at the S. E. corner of said claim;

thence N 8° 58' W 303 feet to the place of beginning.

All done under the provisions of Chapter Six, of Title XXXII, of the Revised Statutes of the United States, and of an Act of the General Assembly of Arizona, entitled "An Act to Revise and Codify the Laws of the Territory of Arizona," approved March 16, 1901.

This is an Amended Location Notice of the Precious Metal Mining Claim, located by S. E. HALL, grantor of the undersigned owner

on the 1st day of January, 1892, and recorded in Book C. C. of Records of Mines, at page 387,

in the office of the County Recorder of the aforesaid County of \_\_\_\_\_ to which reference is hereby made, and this amended Location Notice is made and posted to

correct errors in the description in the said original Location Notice.

Dated and posted on the ground this 22nd day of Nov, 1917

DAILY-ARIZONA CONSOLIDATED COPPER COMPANY?  
(Present Owner)

By J. Hancock  
its Attorney in Fact.

STATE OF ARIZONA,

County of \_\_\_\_\_

ss.

I \_\_\_\_\_, County Recorder in and for the County and State aforesaid, do hereby certify that the within instrument was filed for record at \_\_\_\_\_ o'clock \_\_\_\_\_ M., on this \_\_\_\_\_ day of \_\_\_\_\_ 19\_\_\_\_, and duly recorded in book No. \_\_\_\_\_ of \_\_\_\_\_ Records of \_\_\_\_\_ County, Arizona, at pages \_\_\_\_\_.

WITNESS my hand and official seal the year first above written.

Country Recorder.

AMENDED

Notice of Location  
LODE CLAIM

Dated \_\_\_\_\_, 19\_\_\_\_

Filed and Recorded at request of

*R. W. Langworthy*

*Dec. 17* A. D. 19*17*

at *11:30* a. M.,

Book *R. B. B. Road of Mines*

Pages *383*

County Recorder.

By *R. M. R. [Signature]*  
Deputy Recorder.

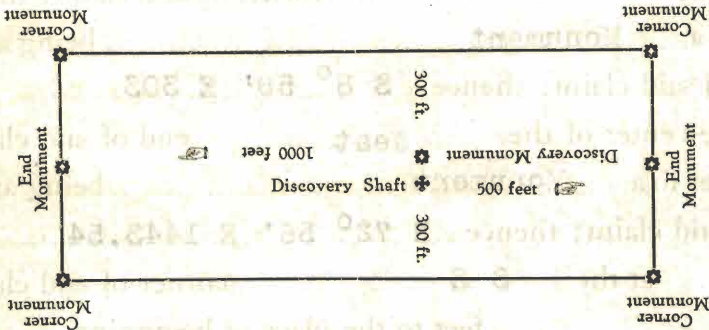

This Diagram is to give locator a general idea of plan of location under the new law. The Discovery Shaft can be in the center of the claim or any distance from either end desired. In the diagram it is placed 500 feet from one end and 1000 ft. from the other. Commence description of claim at a center end monument, giving its distance and direction from center of Discovery Shaft; thence bound the claim in either direction. In description be careful to state locality of claim with reference to some natural object, or permanent monument, as will identify the claim.

STATE OF ARIZONA, }  
COUNTY OF PIMA. } ss.

I, R. B. Vinson, County Recorder in and for the  
County of Pima, State of Arizona, do hereby certify that the above and foregoing is a full, true and correct copy  
of Amended Location Notice of the Quincy Mining Claim, situated in  
the Old Hat Mining District, and now owned by Daily-Arizona Consol-  
idated Copper Company, dated Nov. 22nd, 1917,  
as appears of record now in my office in Book B. B. B. Record of Mines pages 384

IN WITNESS WHEREOF, I have hereunto set my hand  
and affixed my official seal, at my office in Tucson,  
this Eighth day of  
January, A. D. 1917  
R. B. Vinson  
County Recorder of Pima County, Arizona.

AMENDED

Notice of Mining Location

LODE CLAIM

TO ALL WHOM IT MAY CONCERN:

This Mining Claim, the name of which is the QUINCY Mining Claim, situate on lands belonging to the United States of America, and in which there are valuable mineral deposits, was entered upon and located for the purpose of exploration and purchase by F. GEESAMAN, a citizen of the United States, grantor

(Locator must insert either "a citizen of the United States." or "who has declared his intention to become a citizen of the United States.")

the undersigned, on the 31st day of July, 1916.

The length of the claim is 1443.54 feet, and we claim 20 feet,

in a N 72° 56' E direction and 1423.54 feet in a S 72° 56' W direction from the center of the discovery shaft, at which this notice was posted, lengthwise of the claim, together with 300 feet in width of surface grounds, on each side of the center of said claim. The general course of the lode deposit and premises is from the

N 72° 56' E to the S 72° 56' W.

The Claim is situated and located in the OLD HAT Mining District, in Pima County in the State of Arizona,

direction from S. W. cor. Claim

The N. W. Cor. Sec 21, T. 11 S., R. 16 E. bears S 62° 05' W 4812.2

The surface boundaries of the claim are marked upon the ground as follows: Beginning at Monument of Stone

at a point in a N 72° 56' E direction 20 feet from the discovery shaft (at which this notice is posted), being in the center of the East end line of said claim; thence N 8° 58' W 303 feet to a Monument, being the N. E. corner of said claim; thence S 72° 56' W 1443.54 feet to a Monument, being at the N. W. corner of said claim; thence S 8° 58' E 303 feet to a Monument at the center of the West end of said claim; thence S 8° 58' E 303 feet to a Monument being at the S. W. corner of said claim; thence N 72° 56' E 1443.54 feet to a Monument at the S. E. corner of said claim; thence N 8° 58' W 303 feet to the place of beginning.

All done under the provisions of Chapter Six, of Title XXXII, of the Revised Statutes of the United States, and of an Act of the General Assembly of Arizona, entitled "An Act to Revise and Codify the Laws of the Territory of Arizona," approved March 16, 1901.

This is an Amended Location Notice of the QUINCY Mining Claim, located by F. Geesaman, grantor of the undersigned owner on the 31st day of July, 1916, and recorded in Book Y. Y. of Records of Mines, at page 611, in the office of the County Recorder of the aforesaid County of to which reference is hereby made, and this amended Location Notice is made and posted to correct errors in the description in the said original Location Notice.

Dated and posted on the ground this 22nd day of July, 1916

DAILY-ARIZONA CONSOLIDATED COPPER COMPANY (Present Owner)

By J. Hancock Its Attorney in Fact

STATE OF ARIZONA,

County of \_\_\_\_\_

ss.

I \_\_\_\_\_, County Recorder in and for the County and State aforesaid, do hereby certify that the within instrument was filed for record at \_\_\_\_\_ o'clock \_\_\_\_\_ M., on this \_\_\_\_\_ day of \_\_\_\_\_, 19\_\_\_\_, and duly recorded in book No. \_\_\_\_\_ of \_\_\_\_\_ Records of \_\_\_\_\_ County, Arizona, at pages \_\_\_\_\_.

WITNESS my hand and official seal the year first above written.

Country Recorder.

Dec 12 1915

*R. W. Langworthy*  
AMENDED  
Notice of Location  
LODE CLAIM

Dated \_\_\_\_\_, 19\_\_\_\_

Filed and Recorded at request of

*R. W. Langworthy*

*Dec. 11* A. D. 1915

at \_\_\_\_\_ M.,

Book *P. B. B., Record of Mines*

Pages *38 H*

County Recorder.

By *A. M. Alibell*  
Deputy Recorder.

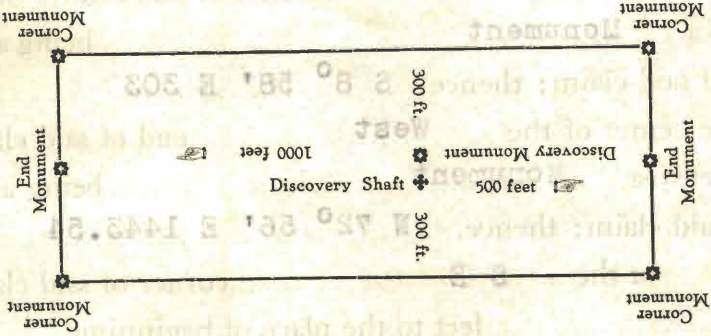

This Diagram is to give locator a general idea of plan of location under the new law. The Discovery Shaft can be in the center of the claim or any distance from either end desired. In the diagram it is placed 500 feet from one end and 1000 ft. from the other. Commence description of claim at a center end monument, giving its distance and direction from center of Discovery Shaft; thence bound the claim in either direction. In description be careful to state locality of claim with reference to some natural object, or permanent monument, as will identify the claim.

## U. S. SURVEYOR-GENERAL'S FINAL CERTIFICATE ON FIELD NOTES.

**Department of the Interior,**

OFFICE OF U. S. SURVEYOR-GENERAL,

Phoenix, Arizona,

February 26, 1919

I, U. S. Surveyor-General for District of Arizona

do hereby certify that the foregoing transcript of the Field Notes, return and approval of the survey of the mining claim of

DAILY-ARIZONA CONSOLIDATED COPPER COMPANY,known as the HOLY TERROR, PRECIOUS METALS, QUINCY Lodes,situate in OLD HATMining District, PIMA County, ARIZONA,in Sections 15 & 16 <sup>Un<sup>s</sup>.</sup>, Township No. 11 S., Range No. 16 E., anddesignated as Survey No. 3501, has been correctly copied from the originals on file in this office; that said Field Notes furnish such an accurate description of said mining claim as will, if incorporated into a patent, serve fully to identify the premises, and that such reference is made therein to natural objects or permanent monuments as will perpetuate and fix the *locus* thereof.

And I further certify that five hundred dollars' worth of labor has been expended or improvements made <sup>or for each of</sup> upon said mining claim <sup>by claimant or</sup> its grantors, and that said improvements consist of 4 shafts, 5 cuts and 3 tunnels, total value \$2765. As tunnel No. 8 on the Precious Metals lode is a common improvement for the benefit and development of all three of the claims in this survey, an undivided one-third interest therein, value \$430, is properly credited to each of the claims in this survey.

and that no portion of said labor or improvements has been included in the estimate of expenditures upon any other claim.

I further certify that the plat thereof, filed in the U. S. Land Office at Phoenix, Arizona, is correct and in conformity with the foregoing Field Notes.

Frank P. Trott,United States Surveyor-General for Arizona.

4-687

SURVEYOR GENERAL'S CERTIFICATE OF APPROVAL OF FIELD NOTES  
AND SURVEY OF MINING CLAIM

DEPARTMENT OF THE INTERIOR  
OFFICE OF U. S. SURVEYOR GENERAL

Phoenix, Arizona,

February 26, 1919

I, U. S. Surveyor General for District of Arizona.

do hereby certify that the foregoing and hereto attached Field Notes and Return of the Survey of the Mining Claim of

DAILY-ARIZONA CONSOLIDATED COPPER COMPANY,

, known as the

HOLY TERROR, PRECIOUS METALS, QUINCY Lodes,

situate in OLD HAT mining district,

PIMA County, ARIZONA,

in Sections s 15 & 16 Uns., Township No. 11 S., Range No. 16 E.,

designated as Survey No. 3501

executed by T. N. Stevens, U. S. Mineral

Surveyor, April 21-24, 1918, under my instructions dated

April 12, 1918, 191  , have been critically examined and the necessary cor-

rections and explanations made, and the said Field Notes and Return, and the Survey they describe,

are hereby approved. The certified copy of the location certificate filed by the applicant for survey is

on file in this office and a true copy of said certified copy of said location certificate is included and made

a part of the transcript of the field notes.

  
U. S. Surveyor General for Arizona.