

Platted

Copied 12-11-1918.

A L H

AS 121 1918

1

4-683

MINERAL SURVEY No. 3517

LOT No.

ARIZONA Land District.

FIELD NOTES

OF THE SURVEY OF THE MINING CLAIM OF

Arizona Binghamton Copper Company.

KNOWN AS THE

Russia and Belgium lodes.

Agua Fria Mining District,

Yavapai County, Arizona

Section 6 Unsur, Township 12 N., Range 2 E.G. & S.R.B. & M

Surveyed under instructions dated May 14-1918, 19

by Alfred B. Colwell U. S. Mineral Surveyor.

Claims located See location notices, 19

Survey commenced June 15-1918, 19

Survey completed June 25-1918, 19

Address of claimants Attorneys. Anderson & Ellis Prescott, Ariz.

DATES OF AMENDED LOCATIONS.

Empty lines for amended locations.

130 N. 6 7

Survey No.3517.

Feet

Russia lode.

Beginning at Cor.No.1

On line 1-2 Belgium lode of this survey.

A schist rock.3x.8 x 2.3 ft.set 1.5 ft.in the ground,  
chiseléd + at exact corner point and R-1-3517 with mound  
of rock alongside. Whence

Witness Corner to the W.  $\frac{1}{4}$  Cor.Sec.6 T.12 N.R.2 E.G.& S.R.  
B.& M. bears N.89°50'45"W-1351.70 ft.

Thence S.74°24'E.

290.73 South End Center, Belgium lode of this survey.

310.00 North End Center, a mound of rock.

597.33 To Cor.No.2

Identical with Cor.No.1 Sur.No.3421 Binghamton Fraction  
lode and Cor.No.5 Sur.No.3421 Illinous lode, claimants  
herein

A + on ledge of schist 5 ft.high, 20 ft.long, chiseled R-2  
B.2-3517, B.F.1, I.5-3421 with mound of rock alongside.

Whence

Sur.No.2543  
Cor.No.1 The Honey Moon lode, claimant unknown, bears  
S.18°16'E.-644.20 ft.

Thence S.0°45'W.

543.74 Intersect line 4-1 Sur.No.2543 The Honey Moon lode at  
S.71°58'E 380.17 ft.from Cor.No.4 and N.71°58'W.-219.83ft.  
from Cor.No.1

553.39 To Cor.No.3

On line 5-1 Sur.No.3421 Binghamton Fraction lode

A schist rock .4 .7 x 1.7 ft.set .8 ft.in ground to solid  
rock, chiseled + at exact corner point and R-3-3517 Mound  
of rock alongside. Whence

Cor.No.4 Sur.No.2543 The Honey moon lode bears N.70°34'  
20"  $\frac{383.15}{50}$ W.383.08 ft.

Thence N.74°24'W.

288.56 South end center, a mound of rock.

383.38 Intersect line 3-4 Sur.No.2543 The Honey Moon lode at  
S.18°02'W.-25.49 ft.from Cor.No.4

598.56 To Cor.No.4

Feet	<p>A schist rock .3 x .8 x 2.5 ft. set 1.5 ft. in the ground, chiseled + at exact corner point and 4-R.3517 Mound of rock alongside Whence</p> <p>No bearings are available.</p> <p>Thence N.0°53'E.</p> <p>553.05 To Cor.No.1, the place of beginning.</p>
	<p>Belgium lode.</p> <p>Beginning at Cor.No.1</p> <p>A schist rock .3 x 1.3 x 1.7 ft. set 1 ft. in the ground chiseled + at exact corner point and B.1-3517 with mound of rock alongside. Whence</p> <p>Witness Corner to the W.¼ Cor.Sec.6 T.12 N.R.2 E.G.&amp; S.R. B.&amp; M. bears S.89°31'W. -1299.45 ft.</p> <p>Thence S.74°24'E.</p>
	<p>54.30 Cor.No.1 Russia lode of this survey.</p>
	<p>345.03 South end center, a mound of rock.</p>
	<p>364.30 North end center Russia lode of this survey</p>
	<p>651.63 To Cor.No.2</p> <p>Identical with Cor.No.2 Russia lode of this survey, and here to fore described,</p> <p>with Cor.No.1 Sur.No.3421 Binghamton fraction lode and</p> <p>Cor.No.5 Sur.No.3421 Illinois lode</p> <p>Thence N.18°48'W</p>
	<p>1500.00 To Cor.No.3</p> <p>Identical with Cor.No.6 and Cor.No.4 Sur.No.3421 Illinois and Tennessee lodes respectively and S.E. Cor. France lode, unsurveyed, claimant herein.</p>
	<p>A schist rock .4 x 1 ft. showing .8 ft. above the ground, chiseled + at exact corner point and B 3-3517, I-6, T-4-3421 with mound of rock alongside. Whence</p> <p>Thence N.74°24'W</p>
	<p>306.60 North end center, a mound of rock.</p>
	<p>591.65 To Cor.No.4</p> <p>Identical with S.W. Cor. France lode unsurveyed.</p> <p>A schist rock .3 x 1.6 x 2.4 ft. set 1.6 ft. in the ground chiseled + at exact corner point and B 4-3517 mound of rock alongside.</p>

Feet

Thence S.16°52'E

1466.95 To Cor.No.1, The place of beginning.

Variation at all corners 14°30'E.

Lode lines.

As near as may be determined from present developments the lode lines run as follows from their respective discovery points:

Russia lode:- N.0°53'E.-14ft.to the North end center and S.0°53'W. 539.05 ft.to the south end center.

Belgium lode:-N.18°48'W.-14 ft.to the North end Center and S.18°48'E.1486 ft.to the South end center.

Area

Total area Russia lode .....7.342 Acres

Area in conflict with

Sur.No.2543 The Honey Moon lode .152 Acres

Total area Belgium lode ..... 17.663 Acres

The survey of this claim is identical with the respective locations.

Location

This survey is situated in the W.1/2 Sec.6, T.12 N.R.2 E.

Gila and Salt River Base and Meridian

Adjoining Claims.

On the North:-France lode,unsurveyed,claimant herein.

On the East:-Sur.No.3421 Illinois and Binghamton Fraction lodes, claimant herein

On the South:- Sur.No.2543 The Honey Moon lode,claimant unknown.

On the West,- Unknown.

Improvements.

I certify that the value of the labor and improvements upon this claim,placed thereon.by the claimant or its grantors is less than Five Hundred Dollars for each of the locations embraced therein and that said improvements consist of

On the Russia lode.

No.1 The discovery shaft, on the lode line at S0°53'W-14 ft.

Survey No. 3517

from the North end center, 4 x 6 ft. 10 ft. deep in rock.

Value \$50.00

On the Belgium lode

No. 1 The discovery shaft, on the lode line at S. 18° 48' E 14 ft. from the north end center. 4 x 6 ft. 10 ft. deep in rock.

Value \$50.00

Other Improvements

A cut and tunnel, the mouth of cut bears from Cor. No. 4 Belgium lode S. 43° 30' E. - 550 ft. Running thence N. 76° E. 30 ft. to mouth of tunnel running N. 76° E. 158 ft. to face. 4 x 7 ft. in rock, claimant herein.

An open cut the mouth of which bears from Cor. No. 4 Belgium lode, S. 38° 40' E. 712 ft. Running thence N. 80° E. 34 ft. to 10 ft. face 4 ft. wide, claimant herein.

An open cut the mouth of which bears from Cor. No. 4 Belgium lode S. 36° 30' E. - 720 ft. Running thence East 21 ft to 10 ft. face 4 ft. wide, claimant herein.

An open cut the mouth of which bears from Cor. No. 4 Belgium lode S. 25° E. - 950 ft. Running thence S. 4° E. 14 ft. to mouth of tunnel running same course 23 ft. 4 x 7 ft. Claimant herein.

A shaft which bears from Cor. No. 2 Russia lode N. 80° W. - 40 ft. 4 x 6 ft. 10 ft. deep, claimant herein.

Instrument.

This survey was made with a C.L. Berger & Sons transit, The courses were deflected from the true meridian as determined by direct solar observations. The distances were measured with steel tapes.

Report.

The lines of this survey were run upon the ground as were also connections to the public survey and adjoining claims except as follows.

The connection from Cor. No. 1 Russia lode to the W.C. 1/4 Cor. was calculated through the tie from Cor. No. 1 Belgium lode as per enclosed traverse.

The connection from Cor. No. 3 Russia lode to Cor. No. 4 Sur. No. 2543 The Honey Moon lode was calculated by traverse

## Survey No. 3517

enclosed.

The Witness Corner to W  $\frac{1}{4}$  Cor. Sec. 6 T. 12 N. R. 2 E. G. & S. R. B. & M. is a schist rock chiseled W. C.  $\frac{1}{4}$  The true  $\frac{1}{4}$  Cor. apparently falls in mouth of small gulch and could not be identified. W. C. is North 125.4 ft. from the true corner point, according to the record.

All corners of Sur. No. 2543 The Honey Moon lode are of stone properly set and marked.

The corners of France lode, unsurveyed are unmarked monuments of rock.

Note

The discrepancies between these notes and the location certificates are due to errors in the latter.

# FINAL OATHS FOR SURVEYS.

## LIST OF NAMES.

A list of the names of the individuals employed by Alfred B. Colwell  
 United States Mineral Surveyor, to assist in running, measuring, and marking the lines, corners, and  
 boundaries described in the foregoing field notes of the survey of the mining claim of \_\_\_\_\_  
 \_\_\_\_\_ Arizona Binghamton Copper Company \_\_\_\_\_  
 known as the Russia and Belgium lodes \_\_\_\_\_  
 and showing the respective capacities in which they acted.

\_\_\_\_\_  
H.A. Stanton \_\_\_\_\_, *Chainman.*  
 \_\_\_\_\_, *Chainman.*  
 \_\_\_\_\_, *Axman.*  
 \_\_\_\_\_, *Flagman.*

## FINAL OATHS OF ASSISTANTS.

**We, I** H.A. Stanton \_\_\_\_\_  
 and \_\_\_\_\_, do solemnly swear that **I** assisted \_\_\_\_\_  
Alfred B. Colwell \_\_\_\_\_, United States Mineral Surveyor, in marking the corners and surveying  
 the boundaries of the mining claim of Arizona Binghamton Copper Company \_\_\_\_\_  
 \_\_\_\_\_  
 known as the Russia and Belgium lodes \_\_\_\_\_  
 represented in the foregoing field notes as having been surveyed by said mineral surveyor and under his  
 direction; and that said survey has been in all respects, to the best of our knowledge and belief, faithfully  
 and correctly executed, and the corner and boundary monuments established according to law and the instruc-  
 tions furnished by the United States Surveyor-General for Arizona \_\_\_\_\_

\_\_\_\_\_  
H.A. Stanton \_\_\_\_\_, *Chainman.*  
 \_\_\_\_\_, *Chainman.*  
 \_\_\_\_\_, *Axman.*  
 \_\_\_\_\_, *Flagman*

Subscribed and sworn to by the above-named persons before me this 26<sup>th</sup>

day of June, 1918

R. Warren  
Notary Public

FINAL OATH OF U. S. MINERAL SURVEYOR.

I, Alfred B. Colwell, U. S. Mineral Surveyor, do solemnly swear that, in pursuance of instructions received from the United States Surveyor General for Arizona, dated May 14, 1918, I have, in strict conformity to the laws of the United States, the official regulations and instructions thereunder, and the instructions of said Surveyor General, faithfully and correctly executed the survey of the Mining Claim of Arizona Binghamton Copper Company, known as the Russia and Belgium lodes, situate in Agua Fria Mining District, Yavapai County, Arizona, in Section 6 Unsur, Township No. 12 N., Range No. 2 E. G. & S. R. B. & M., and designated as Survey No. 3 5 1 7, as represented in the foregoing field notes, which accurately show the boundaries of said mining claim as distinctly marked by monuments on the ground, and described in the attached copy of the location certificate, which was received by me from the Surveyor General with said instructions, and that all the corners of said survey have been established and perpetuated in strict accordance with the law, official regulations and instructions thereunder; and I do further solemnly swear that the foregoing are the true and original field notes of said survey and my report therein, and that the labor expended and improvements made upon said mining claim by claimant or its grantors are as therein fully stated, and that the character, extent, location, and itemized value thereof are specified therein with particularity and full detail, and that no portion of said labor or improvements so credited to this claim has been included in the estimate of expenditures upon any other claim.

Alfred B. Colwell, U. S. Mineral Surveyor.

Subscribed and sworn to by the said Alfred B. Colwell U. S. Mineral Surveyor, before me a Notary Public, in and for Yavapai County, State of Arizona. this 6th day of August, 1918

[Signature] Notary Public

My Commission Expires May 4, 1921



9

Notice of Mining Location  
LODE CLAIM

Nov. 11, 1918

TO ALL WHOM IT MAY CONCERN:

This Mining Claim, the name of which is the Russia Mining Claim, situate on lands belonging to the United States of America, and in which there are valuable mineral deposits, was entered upon and located for the purpose of exploration and purchase by Samuel E. Chaney a citizen of the United States, the undersigned, on the 12th day of November, 1917

The length of this claim is 650 feet and I claim 650 feet, in a Southerly direction from the center of the discovery shaft, at which this notice is posted, lengthwise of the claim, together with 300 feet in width of the surface grounds, on each side of the center of said claim. The general course of the lode deposit and premises is from the North to the South.

The claim is situated and located in the Agua Fria Mining District, in Yavapai County, in the State of Arizona, about 3000 feet in a South westerly direction from the old indian fort on Copper Ruin Claim.

The surface boundaries of the claim are marked upon the ground as follows: Beginning at a stone monument being the North End Center and identical with the location monument of this claim and the South end center of Belgium claim \_\_\_\_\_ feet from the discovery shaft (at which this notice is posted)", being in the center of the North end line of said claim; thence West 300 feet to a stone monument, being the S. W. Cor Belgium and N. W. corner of said claim; thence South 650 feet to a stone monument, being at the N. W. Cor Honeymoon and S. W. corner of said claim; thence East 300 feet to a stone monument at the center of the South end of said claim; thence East 300 feet to a stone monument being at the N. E. Cor. Honeymoon and S. E. corner of said claim; thence North 650 feet to a stone monument at the S. W. Cor Illinois and N. E. corner of said claim; thence West 300 feet to the place of beginning.

Dated and posted on the grounds this 12th day of November, 1917.

Samuel E. Chaney

Witness

"

Geo. W. Johnson  
G. E. Abernathy

Filed and Recorded at request of Anderson, Coleman & Nilsson, Nov. 14th., A. D. 1917, at 2:10 O'clock P. M., Book 109 of Mines, Page 54, Records of Yavapai County, Arizona.

E. A. McSWIGGIN  
(SEAL) County Recorder

By Lula McIntosh  
Deputy Recorder

STATE OF ARIZONA, )  
 : SS  
 COUNTY OF YAVAPAI.)

I, E. A. McSWIGGIN, County Recorder in and for the County of Yavapai, State of Arizona, and custodian of the records of such office, DO HEREBY CERTIFY that I have compared the foregoing copy with, and that the same is a full, true and correct copy of Location Notice of the RUSSIA Lode Mining Claim, filed for record November 14th., 1917, and as the same appears of record in my office in Book 109 of Mines, page 54, and of the whole thereof.

IN WITNESS WHEREOF, I have hereunto set my hand and affixed my Official Seal, at my Office in the City of Prescott, State of Arizona, this 10th day of May, 1918.



*E. A. McSwiggin*  
 COUNTY RECORDER OF YAVAPAI COUNTY,  
 ARIZONA

Notice of Mining Location  
LODE CLAIM

MAR 11 1918

TO ALL WHOM IT MAY CONCERN:

This Mining Claim, the name of which is the Belgium Mining Claim, situate on lands belonging to the United States of America, and in which there are valuable mineral deposits, was entered upon and located for the purpose of exploration and purchase by Samuel E. Chaney a citizen of the United States, the undersigned, on the 12th day of November, 1917.

The length of this claim is 1500 feet, and I claim 1500 feet in a Southerly in a direction from the center of the discovery shaft, at which this notice is posted, lengthwise of the claim, together with 300 feet in width of the surface grounds, on each side of the center of said claim, The general course of the lode deposit and premises is from the North to the South

The claim is situated and located in the Agua Fria Mining District, in Yavapai County in the State of Arizona, about 1800 feet in a Southwesterly direction from the old indian fort on Copper Ruin Claim.

The surface boundaries of the claim are marked upon the ground as follows: Beginning at a stone monument being the location monument and identical with the North End center of this claim and South End Center England Claim from the discovery shaft (at which this notice is posted), being in the center of the North end line of said claim; thence West 300 feet to a stone monument, being the S. W. Cor England and N. W. corner of said claim; thence South 1500 feet to a stone monument, being at the N. W. Cor Russia and S. W. corner of said claim; thence East 300 feet to a stone monument at the center of the South end of said claim; thence East 300 feet to a stone monument being at the S. W. Cor Illinois and S. E. corner of said claim; thence North 1500 feet to a stone monument at the N. W. Cor Illinois and N. E. corner of said claim; thence West 300 feet to the place of beginning.

Dated and posted on the grounds this 12th day of November, 1917.

Samuel E. Chaney.

Witness

G. E. Abernathy

Filed and Recorded at request of Anderson, Coleman & Nilsson, Nov., 14th., A. D. 1917, at 2:10 O'clock P. M., Book 109 of Mines, Page 53, Records of Yavapai County, Arizona.

(SEAL) E. A. McSWIGGIN  
County Recorder

By Lula McIntosh  
Deputy Recorder

STATE OF ARIZONA, )  
 : SS  
 COUNTY OF YAVAPAI.)

I, E. A. McSWIGGIN, County Recorder in and for the County of Yavapai, State of Arizona, and custodian of the records of such Office, DO HEREBY CERTIFY that I have compared the foregoing copy with, and that the same is a full, true and correct Copy of Location Notice of the BELGIUM Lode Mining Claim, filed for record on November 14th., 1917, and as the same appears of record in my office in Book 109 of Mines, at page 53, and of the whole thereof.

IN WITNESS WHEREOF, I have hereunto set my hand and affixed my Official Seal, at my Office in the City of Prescott, State of Arizona, this 10th day of May, 1918.



*E. A. McSwiggin*  
 COUNTY RECORDER OF YAVAPAI COUNTY,  
 ARIZONA.

U. S. SURVEYOR-GENERAL'S FINAL CERTIFICATE ON FIELD NOTES.

Department of the Interior,

OFFICE OF U. S. SURVEYOR-GENERAL,

Phoenix, Arizona,

December 26, 1918

I, U. S. Surveyor-General for District of Arizona

do hereby certify that the foregoing transcript of the Field Notes, return and approval of the survey of the mining claim of

ARIZONA BINGHAMTON COPPER COMPANY

known as the RUSSIA AND BELGIUM LODES

situate in AGUA FRIA

Mining District, YAVAPAI County, ARIZONA.

in Section 6 unsubs., Township No. 12 N., Range No. 2 E., and

designated as Survey No. 3517, has been correctly copied from the originals on file in

this office; that said Field Notes furnish such an accurate description of said mining claim as will, if incorporated into a patent, serve fully to identify the premises, and that such reference is made therein to natural objects or permanent monuments as will perpetuate and fix the locus thereof.

less than

And I further certify that, five hundred dollars' worth of labor has been expended or improvements made upon said mining claim by claimant or its grantors, and that said improvements consist of, at time of survey, 2 shafts, value \$100.

and that no portion of said labor or improvements has been included in the estimate of expenditures upon any other claim.

I further certify that the plat thereof, filed in the U. S. Land Office at Phoenix,

Arizona, is correct and in conformity with the foregoing Field Notes.

Frank P. Trott,

United States Surveyor-General for Arizona.

4-687

SURVEYOR GENERAL'S CERTIFICATE OF APPROVAL OF FIELD NOTES  
AND SURVEY OF MINING CLAIM

DEPARTMENT OF THE INTERIOR  
OFFICE OF U. S. SURVEYOR GENERAL

Phoenix, Arizona.

December 26, 1918

I, U. S. Surveyor General for District of Arizona

do hereby certify that the foregoing and hereto attached Field Notes and Return of the Survey of the Mining Claim of

ARIZONA BINGHAMTON COPPER COMPANY

, known as the

RUSSIA AND BELGIUM LODES

situate in AGUA FRIA mining district,

YAVAPAI

County,

ARIZONA

in Section 6 unsur., Township No. 12 N., Range No. 2 E.

, designated as Survey No. 3517

executed by Alfred B. Colwell, U. S. Mineral

Surveyor, June 15-25, 1918, under my instructions dated

May 14, 1918, have been critically examined and the necessary cor-

rections and explanations made, and the said Field Notes and Return, and the Survey they describe,

are hereby approved. The certified copy of the location certificate filed by the applicant for survey is

on file in this office and a true copy of said certified copy of said location certificate is included and made

a part of the transcript of the field notes.



U. S. Surveyor General for Arizona.

(4-691.)

# Certificate of U. S. Surveyor General

AS TO

EXPENDITURES REPORTED AFTER RETURN OF SURVEY OF MINING CLAIM.

I, U. S. Surveyor General for District of Arizona,  
do hereby certify that Five Hundred Dollars' worth of labor has been expended or  
improvements made by claimant or its grantors, upon or for each of the mining claims of

Arizona Binghamton Copper Company  
known as the RUSSIA and BELGIUM Lodes,  
situate in Agua Fria mining district,  
Yavapai County, Arizona,  
in Section 6, Unsur., Township No. 12 N, Range No. 2 E.;  
that said improvements consist of 3 shafts, 4 cuts and 2 tunnels, total  
value \$2360.

As improvement No. 2 on the Belgium lode constitutes  
a substantial development of the lode or mineralized zone which  
extends through both of these locations, an undivided one-half  
interest therein, value \$850, is credited to each location.

, and that no portion of said labor or improvements has been  
included in the estimate of expenditures upon any other claim. A copy of the report of  
Alfred B. Colwell, U. S. ~~Deputy~~ Mineral Surveyor, dated  
August 11, 1919, is hereto attached.



U. S. Surveyor General for Arizona.

Office of U. S. Surveyor General,

Phoenix, Arizona,

August 14, 1919

## Mineral Survey No. 3517

Russia and Belgium lodes. Tunnel to S. on the Belgium lode  
Expenditure of Five Hundred Dollars.

I certify that the value of the labor and improvements made upon, or for the benefit of each of the locations embraced in said mining claim by the claimant or its grantors is not less than five hundred dollars, and that said improvements consist of:

On the Russia lode.

No. 1 The discovery shaft, on the lode line at S.  $0^{\circ}53'W.$  -14 ft. from the north end center, 4 x 6 ft. 10 ft. deep in rock.

Value \$50

No. 2 A shaft which bears from Cor. No. 2 N.  $80^{\circ}W.$  40 ft. 4 x 6 ft. 10 ft. deep in rock.

Value \$80.

A one-half interest in improvement No. 2 on the Belgium lode credited to this lode.

Value, \$850.

On the Belgium lode.

No. 1 The discovery shaft, on the lode line at S.  $18^{\circ}48'E.$  -14 ft. from the north end center 4 x 6 ft. 10 ft. deep in earth and rock.

Value \$50

No. 2 A cut and tunnel, the mouth of cut bears from Cor. No. 4 S.  $43^{\circ}30'E.$  -550 ft. Running thence N.  $76^{\circ}E.$  30 ft. to mouth of tunnel running N.  $76^{\circ}E.$  -158 ft. to face, 4 x 7 ft. in rock.

Value of Cut and Tunnel \$1700

No. 3 An open cut, the mouth of which bears from Cor. No. 4 S.  $38^{\circ}40'E.$  -712 ft. Running thence N.  $80^{\circ}E.$  -34 ft. to 10 ft. face 4 ft. wide. in earth and rock.

Value \$100

No. 4 An open cut, the mouth of which bears from Cor. No. 4 S.  $36^{\circ}30'E.$  -720 ft. Running thence East 21 ft. to 10 ft. face, 4 ft. wide.

Value \$80

No. 5A A cut and tunnel, the mouth of cut bears from Cor. No. 4 S.  $25^{\circ}E.$  -950 ft. Running thence S.  $4^{\circ}E.$  -14 ft. to mouth of tunnel running same course a distance of 23 ft. to face thereof. 4 x 7 ft. in rock.

Value of Cut and Tunnel \$300

No. 6

Inasmuch as the locations embraced in this claim are contiguous, end to end, each covering a portion of the same lode or mineralized zone, it is claimed for the Cut and



Tunnel designated as Improvement No.2 on the Belgium lode, that it being of sufficient length and depth to constitute a substantial development of said lode or mineralized zone and that therefore one half of its value may properly be credited to each of the locations thereon.

Total Value of said Improvement \$1700  
 Credited to Russia lode \$850  
 Credited to Belgium lode \$850

The improvements indicated in this report are, with the exception of the discoveries, the ones given in the original survey under the head of "Other Improvements." Inquiry made at the time of my survey showed that they were made prior to the location of the Russia and Belgium claims and were claimed by the Arizona Binghamton Copper Co. only by right of possession. I therefore placed them under "Other Improvements." In Jan. 1919 the above company purchased these improvements among others and also the ground in controversy, paying a sum considerably in excess of the value which I have placed upon them.

No. 1. The discovery shaft on the lode line at S. 0° 33' W. - 14 ft. deep. Value of cut and tunnel \$1700

No. 2. An open cut, the mouth of which bears from Cor. No. 4 S. 38° 40' E. - 712 ft. Running thence N. 80° E. - 34 ft. to 10 ft. face 4 ft. wide. in earth and rock. Value \$100

No. 3. An open cut, the mouth of which bears from Cor. No. 4 S. 38° 30' E. - 720 ft. Running thence East 21 ft. to 13 ft. face. 4 ft. wide. Value \$50

No. 4. An open cut and tunnel, the mouth of cut bears from Cor. No. 4 S. 38° 15' E. - 950 ft. Running thence S. 4° E. - 14 ft. to mouth of tunnel running same course a distance of 23 ft. to face of shaft. 4 x 7 ft. in rock. Value of cut and tunnel \$300

Inasmuch as the locations embraced in this claim are contiguous, and to each, each covering a portion of the same lode or mineralized zone, it is claimed for the cut and

(4-690.)

# Report of Expenditures upon Mining Claim, filed by U. S. ~~Deputy~~ Mineral Surveyor after return of Survey.

I, Alfred B. Colwell, U. S. ~~Deputy~~ Mineral Surveyor, do solemnly swear that in pursuance of instructions received from the United States Surveyor General for Arizona, dated \_\_\_\_\_, 1 \_\_\_\_\_,

I have made a personal and thorough examination upon the premises, to ascertain the value of the labor expended and improvements made by claimant or its grantors upon the mining claim of Arizona Binghamton Copper Company

\_\_\_\_\_, known as the Russia and Belgium lodes

\_\_\_\_\_, situate in \_\_\_\_\_

Agua Fria mining district, Yavapai

County, Arizona, in Section 6 Unsur., Township No.

12 N., Range No. 2 E.G. and S.R.B. and M., surveyed by me

June 15-25, 1918, 18\_\_\_\_, and designated as Survey No. 3517;

that the value of the labor so expended and improvements so made are as fully stated in my report of said examination, hereto attached; that the character, extent, location and itemized value of said improvements are specified therein with particularity and full detail, and that no portion of said labor or improvements, so credited to this claim has been included in the estimate of expenditures upon any other claim.

Alfred B. Colwell  
U. S. ~~Deputy~~ Mineral Surveyor.

Subscribed and sworn to by the said Alfred B. Colwell

\_\_\_\_\_, U. S. ~~Deputy~~ Mineral Surveyor, before me

this 11<sup>th</sup> day of Aug, 1919

S. F. Deverson  
Notary Public

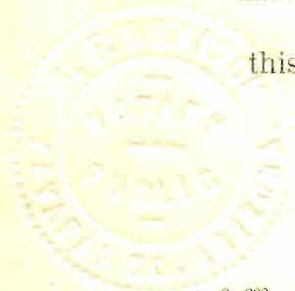

My Commission Expires Mar. 22, 1922

W. 1/2 SEC. 6  
T. 12 N., R. 2 E.

MINERAL SURVEY NO. 3517  
AGUA FRIA MINING DISTRICT  
YAVAPAI COUNTY, ARIZONA.  
SURVEYED JUNE 15-25, 1918  
BY Alfred B. Colwell.  
U.S. MIN. SUR.

Scale 1 in. = 300 Ft.

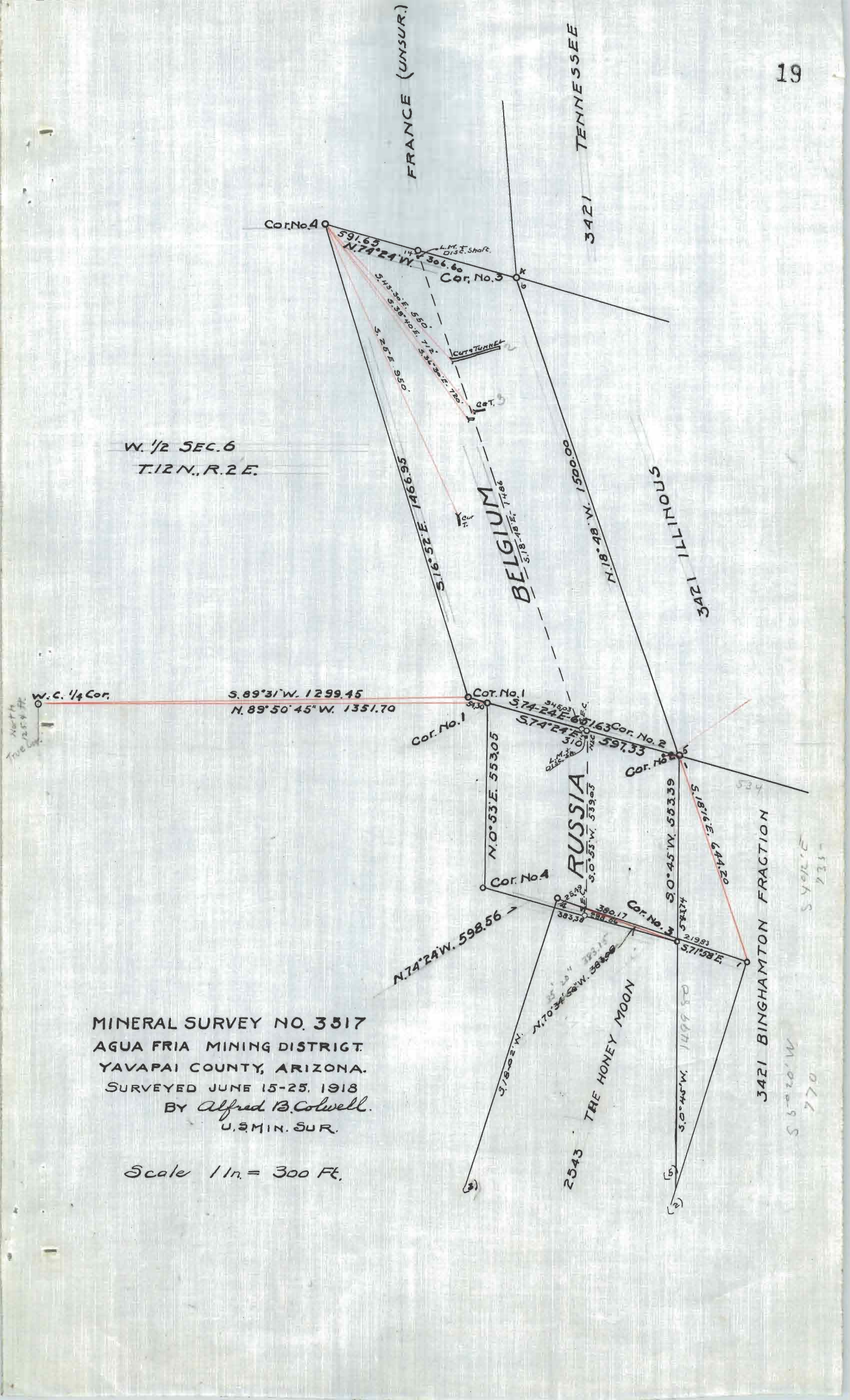

(SOUTH) 3000 FT

15451 15451

15451 15451

W 1/2 SEC 8  
T12N R5E

MULLEN

3000 FT

N 89° 20' 45" W 1321.70  
S 89° 17' W 1539.42

W 1/2 Cor

Corner 1

ALBERTA

3000 FT

6680 W 22° 03'

2120 W 22° 03'

Corner 4

N 22° 20' W 228.25

15451 15451

2120 W 22° 03'

Corner 3

3000 FT THE HOTEL ROOM

MINERAL SURVEY NO 3217  
AGUA FRIA MINING DISTRICT  
YAVAPAI COUNTY ARIZONA  
SURVEYED JUNE 13-25 1918  
By Alfred B. Coburn  
U.S. MIN. SUR.

Scale 1" = 300 FT

