

SEP 25 1918

4-683

Platted

MINERAL SURVEY No. 3534

LOT No.

Arizona Land District.

FIELD NOTES

OF THE SURVEY OF THE MINING CLAIM OF

T.M. Smith

KNOWN AS THE

STANDARD and TREASURE Lodes

Mammoth or Old Hat Mining District,

Pinal County, Arizona

Sections 34-35, Township 8 S., Range 16 E.

Surveyed under instructions dated Aug. 5, 1918, 19

by T.N. Stevens U. S. Mineral Surveyor.

Claim located See location notices, 19

Survey commenced Aug 13, 1918, 19

Survey completed Aug. 21, 1918, 19

Address of claimant Tucson, Arizona

DATES OF AMENDED LOCATIONS.

.....
.....
.....

UNITED STATES DEPARTMENT OF THE INTERIOR
BUREAU OF LAND MANAGEMENT
ARIZONA STATE OFFICE

9632.27 (942)
M.S. 3534

NOTICE OF CANCELLATION OF MINERAL SURVEY

The Treasure and Standard Lodes, M.S. 3534, in sections 34 and 35, T. 8 S., R. 16 E., Gila and Salt River Meridian, Arizona, are hereby cancelled.

These claims have not been filed with the Arizona State Office, Bureau of Land Management, in accordance with Section 314 of 43 U.S.C. 1744.

This cancellation was requested by the Chief, Branch of Lands and Minerals Operations, to facilitate a land exchange.

January 15, 1986
Date

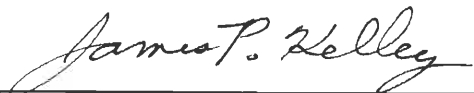
Chief Cadastral Surveyor of Arizona

Survey No. 3534.

Feet

Standard Lode.

Beginning at Cor. No 1, identical with Cor No 2,

Treasure Lode of this survey, a granite rock 6 X 8 X 6 ins.,

set 12 ins. in the ground, chiseled with cross (X), S-1,

T-2 3534, with mound of stone 3 1/2 ft. base by 3 ft.

high alongside, whence the 1/4 Cor. between Secs. 26-27,

T 8 S, R 16 E,G and S.R.B&M. brs. N. 0°-26'-41" W.

4358.5 ft. Original Loc. Mon. brs. N. 74°-27' W., 1.0 ft.

No other bearings are available.

Thence S. 30°-52' W

Va. 13°-30' E.

300 To W. end center, a pine post 3 X 4 ins. by 4 ft long,

set firmly in the ground and surrounded with a mound of

stone, 3 1/2 ft. base by 3 ft. high, scribed W. Cr.

Standard.

600 To Cor. No 2. a porphyry rock 8 X 10 X 4 ins., set

12 ins. in the ground, with mound of stone 3 1/2 ft.

base by 3 ft. high alongside, chiseled with a cross (X),

S-2-3534 on N. E. face. Original Loc. Mon. brs. S 30°-52' W., 81.12 ft.

No bearings are available.

Thence S. 74°-27' E

Va. 13°-30' E

1482.7 To Cor No 3, a porphyry rock 10 X 10 X 5 ins., set

12 ins. in the ground, chiseled with a cross (X)

S-3-3534, with mound of stone 3 1/2 ft. base by 3 ft.

high alongside. Original Loc. Mon. brs. S. 30°-52' W., 19.34 ft.

No bearings are available.

Thence N. 30°-52' E.

Va. 13°-30' E

300 East end center, a pine post 3 X 4 ins. by 4 ft. long,

set firmly in the ground and surrounded with mound of

stone 3 1/2 ft. base by 3 ft. high, scribed E Cr.

Standard.

600 To Cor No 4, identical with Cor No 3, Treasure Lode

Sur. 3534.
Standard Lode - continued.

of this survey, a porphyry rock 10 X 10 X 2 ins., set
12 ins. in the ground, chiseled with a cross (X)
S-4, T-3-3534, with mound of stone 3 1/2 base by 3 ft.
high alongside.

No bearings are available.

Thence N.74°-27'W.

Va.13°-30'E.

1482.7 To Cor No 1, the place of beginning

Treasure Lode.

Beginning at Cor No 1 - Identical with Original Loc. Mon.

A granite boulder in place, 2 X 3 ft. X 2 ins. high,
chiseled with a cross (X) T-1, 3534, with mound of stone
3 1/2 ft. base by 3 ft. high alongside, whence the
1/4 Cor bet. Secs. 26-27, T 8 S, R 16 E brs. N.5°-04'-50"W
3858.36 ft.

No other bearings are available.

Thence S.30°-52'W.

Va.13°-30'E.

300 To W end center, a pine post 3 X 4 ins. by 4 ft. long,
set firmly in the ground and surrounded with a mound of
stone, 3 1/2 ft. base by 3 ft. high, scribed W. Cr.,
Treas. on E. face.

600 To Cor No 2, identical with Cor No 1, Standard Lode of
this survey, heretofore described.

Thence S.74°-27'E

Va.13°-30'E

1482.7 To Cor No 3, identical with Cor No 4, Standard Lode of
this survey, heretofore described.

Thence N.30°-52'E.

Va.13°-30'E

300 To east end center, a pine post 3 X 4 ins. by 4 ft.
long, set firmly in the ground and surrounded with a
mound of stone 3 1/2 ft base by 3 ft. high, scribed
E. Cr. Treas.

Sur. 3534.
Treasure Lode - continued.

600

To Cor No 4.

A porphyry rock 8 X 12 X 3 ins., set 12 ins. in the ground and chiseled with a cross (X) T-4, 3534, on N.W. face, with mound of stone 3 1/2 ft. base by 3 ft. high alongside. Original Loc. Mon. brs. N.58°-30'E., 53.3

No bearings are available.

Thence N.74°-27'W.
Va.13°-30' E.

1482.7

To Cor No 1, the place of beginning.

LODE Lines.

As near as can be determined from the present developments the veins of the several locations embraced in this claim, extend as follows from their respective discovery points.

Standard lode, 638.67 ft. S.74°-27'E., and 844.03 ft. N.74°-27'W.

Treasure lode, 430.38 ft. N.74°-27'W., and 1052.32 ft. S.74°-27'E.

AREAS

Total area Standard lode-----	Acres 19.697
Total area Treasure lode-----	19.697

LOCATION.

This survey is located in the N.W. 1/4 Sec. 35 and S.E.1/4 of N.E. 1/4 Sec. 34, T. 8 S., R. 16 E., of G & S.R. B. & M.

EXPENDITURE OF FIVE HUNDRED DOLLARS.

I certify that the value of the labor and the improvements made upon, or for the benefit of, each of the locations embraced in said mining claim by the claimant or his grantors is not less than five hundred dollars, and that said improvements consist of:

Sur. No. 3534.

EXPENDITURE OF FIVE HUNDRED DOLLARS.

Standard Lode.

No.1 The discovery cut of the Standard lode, the mouth of which being the discovery point is on the center line 638.67 ft. from the center of line 3-4, 5 ft. wide, 10 ft. face, running N. 31°-48'E., 12 ft.

Value-\$100.00

No.2 A shaft, the center of which brs. from Cor. No.1, Standard lode S. 35°-10'E., 540 ft. 4 X 6 ft. 10 ft. deep.

Value-\$100.00

No.3 A cut, the face of which brs. from Cor. No.3 Standard lode N.59°-30'W., 655 ft., 5 ft. wide, 10 ft. face, running S. 34° W. 20 ft.

Value-\$150.00

No.4 A shaft the center of which brs. from Cor. No.4 Standard lode N. 84°-30' W., 730 ft. 4 X 6 ft., 10 ft deep.

Value-\$100.00

No.5 A cut the mouth of which brs. from Cor. No.4 Standard lode, S.83°-30'W., 590 ft., 5 ft. wide, 10 ft. face, running N. 74° W., 15 ft.

Value-\$125.00

No.6 A cut, the mouth of which brs. from Cor. No.4 Standard lode S. 86°-57'W., 222.5 ft., 5 ft. wide, 10 ft. face running N.62°-W., 20 ft.

Value-\$150.00

TREASURE Lode.

No.1 The discovery cut of the Treasure lode, the face of which is on the center line, 430.38 ft. from the center of line 1-2, 5 ft. wide, 10 ft. face, running N. 74°-27'W., 20 ft.

Value-\$150.00

No.2 A cut, the face of which brs. from Cor. No.1 Treasure lode, S. 16°-30'E., 330 ft., 5 ft. wide, 10 ft. face, running N. 16° W., 20 ft.

Value-\$150.00

No.3 A shaft, the center of which brs. from Cor. No.4 Treasure lode N.77°-30'W., 350 ft., 4 X 6 ft. 10 ft. deep.

Value-\$150.00

No.4 A shaft, the center of which brs. from Cor. No.4, Treasure lode S. 48° W., 210 ft. 4 X 6 ft. 10 ft. deep.

Value-100.00

5
18-5-18^d

Sur. No. 3534.
OTHER IMPROVEMENTS.

A shaft, the center of which hrs. from Cor. No. 3 Treasure lode,
N. 75°-18' W., 237 ft., 7 x 12 ft., 10 ft. deep.

A cut, the face of which hrs. from Cor. No. 2, Treasure lode,
S. 88°-30' E., 270 ft., 5 ft. wide, 3 ft. face, running S. 88° E., 10 ft.

INSTRUMENT.

This survey was made with a Gurley mountain transit, the courses were deflected from the true meridian as determined by direct Solar observations, The distances were measured with a 500 ft. steel tape.

REPORT.

The lode line of each location of this claim was run directly upon the ground, and the corners were established by running around the claims. All tie lines were run directly upon the ground.

The 1/4 Cor. bet. Secs. 26 and 27, T. 8 S., R. 16 E., G. & S.R.B.M. is a mesquite post 4 ins. sq. by 4 1/2 ft. long, surrounded with a md. of stone 4 ft. base by 2 1/2 ft. high, Scribed 1/4 on W. face, T.VIII-S-R-XVI E. on the N. face, and S-XXVII on N. face.

This is the nearest standing corner of the public survey that can be found and identified. A diligent search was made for the Cor. Secs. 26, 27, 34 and 35, Secs. 25, 26, 35 and 36. Secs. 2, 3, 34 and 35, and the 1/4 Cors. bet. Secs. 26 and 35, bet. Secs. 35 and 36, bet. Secs. 2 and 35, bet. Secs. 34 and 35 and bet. Secs. 27 and 34, T. 8 S., R. 16 E. and after exhausting all resources I fail to find any evidence of same. The location corners to which bearings are given all consist of monuments of stone 2 1/2 ft. base by 2 ft. high.

ADJOINING CLAIMS.

On the North, Victoria lode, Unsurveyed, claimant herein.

On the East, El Dinero, American Girl and Cruz D'Oro lodes, unsurveyed J. Torres, claimant.

On the South, Iron Chief lode, unsurveyed, J. Torres, claimant.

On the West, Ellen and Alexandria lodes, unsurveyed, claimant herein.

Sur. No. 3554.
REPORT Cont'd

need not copy
Direct Solar observation taken Thurs. Aug. 15, 1918.
At 8h.37m A.M. Solar time. Sun bisected-Lat. 32-42'-Lon. 110-41'
Difference in time 4h-0m

Apparent declination-14-14'-1.8"
3' 6" ✓
Dec'l = 14-10'55.8" ✓

P = 90-Dec'l = 90°
14-11'
75-49' = P ✓

Sin 1/2 A = $\sqrt{\frac{\text{Sin } (S-L) (S-H)}{\text{Cos. L Cos H}}}$

L = 32-42'
H = 39-49' Ver Ang. diminished by refraction
P = 75-49'
2) 148-20'
S = 74-10'

S-L = 41-28' 9.8209788 ✓
S-H = 34-21' 9.7514691 ✓
0.6749403 ✓
0.1145838 ✓
2) 19.7619720 ✓
9.8809860 ✓ 49-29'25" 1/2 A.
98-58'50" A.

180-00'-00"
98-58'50"
S-81° 01' 10 E ✓ Course of sun

111-53' Ang. from sun to Cor. No.2 Standard
81° 01'
S 30° 52' W. Course of line 1-2 Standard lode

~~Set up at Cor. No.1 Standard lode - F.S. Cor. No.2 Standard lode.~~

Sur. No. 3534.
OTHER IMPROVEMENTS

A shaft, the center of which hrs. from Cor. No.3 Treasure lode, N.73-18'W., 237 ft., 7 X 12 ft. 10 ft. deep.

A cut, the face of which hrs. from Cor. No.2, Treasure lode, S.88-30'E., 270 ft. 5 ft. wide, 3 ft. face, running S. 88 E., 10 ft.

INSTRUMENT.

This survey was made with a Gurley mountain transit, the courses were deflected from the true meridian as determined by direct Solar observations, The distances were measured with a 500 ft. steel tape.

REPORT.

The lode line of each location of this claim was run directly upon the ground, and the corners were established by running around the claims. All tie lines were run directly upon the ground.

The ^{bet.} W 1/4 Cor. Sect 26, T. 8 S., R. 16 E., G & S.R. B.M. is a mesquite post 4 ins. Sq. by 4 1/2 ft. long, surrounded with a md. of stone 4 ft. base by 2 1/2 ft. high, Scribed 1/4 on W. face, X V 111-S-R-XVI E. on the N. face, and S-XXVII on N. face.

This is the nearest standing corner of the public survey that can be found and identified. A diligent search was made for the N.W. Cor. Sec. 35, the W. 1/4 Cor. and the S.W. Cor. said Sec. and I fail to find any evidence of same.

ADJOINING CLAIMS.

The Corners of the Ellen, Alexandria and Victoria lodes, claimant herein, shown on plat. All corners consist of monuments of stone.

The Corners of ELDinero, American Girl, Cruz D'Oro and Iron Chief lodes, J. Torres, Claimant as shown on plat, consist of pine posts set in the ground and surrounded with mds. of stone.

FINAL OATHS FOR SURVEYS.

LIST OF NAMES.

A list of the names of the individuals employed by T.N. Stevens
 United States Mineral Surveyor, to assist in running, measuring, and marking the lines, corners, and
 boundaries described in the foregoing field notes of the survey of the mining claim of
T.M. Smith
 known as the STANDARD and TREASURE Lodes
 and showing the respective capacities in which they acted.

B. Snyder, Chairman.
 _____, Chairman.
 _____, Axman.
 _____, Flagman.

FINAL OATHS OF ASSISTANTS.

~~XXX~~ I, B.N. Snyder
~~we~~, do solemnly swear that we assisted
T.N. Stevens, United States Mineral Surveyor, in marking the corners and surveying
 the boundaries of the mining claim of T.M. Smith
 known as the Standard and Treasure Lodes
 represented in the foregoing field notes as having been surveyed by said mineral surveyor and under his
 direction; and that said survey has been in all respects, to the best of ~~our~~ ^{my} knowledge and belief, faithfully
 and correctly executed, and the corner and boundary monuments established according to law and the instruc-
 tions furnished by the United States Surveyor-General for Arizona

B. Snyder, Chairman.
 _____, Chairman.
 _____, Axman.
 _____, Flagman

Subscribed and sworn to by the above-named persons before me this 16th
 day of August, 1918

My Commission Expires February 22nd 1920
Natany Public

FINAL OATH OF U. S. MINERAL SURVEYOR.

I, T.N. Stevens, U. S. Mineral Surveyor, do solemnly swear that, in pursuance of instructions received from the United States Surveyor General for Arizona, dated Aug. 5, 1918, I have, in strict conformity to the laws of the United States, the official regulations and instructions thereunder, and the instructions of said Surveyor General, faithfully and correctly executed the survey of the Mining Claim of T.M. Smith, known as the STANDARD and TREASURE Lodes, situate in Mammoth or Old Hat Mining District, Pinal County, Arizona, in Section s 34-35, Township No. 8 S., Range No. 16 E. G. & S.R. P.M., and designated as Survey No. 3534, as represented in the foregoing field notes, which accurately show the boundaries of said mining claim as distinctly marked by monuments on the ground, and described in the attached copy of the location certificate, which was received by me from the Surveyor General with said instructions, and that all the corners of said survey have been established and perpetuated in strict accordance with the law, official regulations and instructions thereunder; and I do further solemnly swear that the foregoing are the true and original field notes of said survey and my report therein, and that the labor expended and improvements made upon said mining claim by claimant or his grantors are as therein fully stated, and that the character, extent, location, and itemized value thereof are specified therein with particularity and full detail, and that no portion of said labor or improvements so credited to this claim has been included in the estimate of expenditures upon any other claim.

T.N. Stevens

U. S. Mineral Surveyor.

Subscribed and sworn to by the said

U. S. Mineral Surveyor, before me,

Geo. P. Myers, a Notary Public in & for Pinal County, Arizona

this 21st

day of September, 1918

Geo. P. Myers, Notary Public

My Commission Expires February 19, 1920

AUG 5 - 1918

LOCATION NOTICE.

Quartz Claim.

To All Whom it May Concern:

J. N. Smith Claim for mining purposes, 600 feet wide and 1500 feet long in the form of a parallelogram. Monuments of stones at each corner, at the center of each end and center of each side

line. This notice is placed in a monument at the discovery shaft *Seven hundred and fifty* (750) feet from the *North West*

end of claim. General direction *North West and South East*

Situated in *Mammoth* Mining District,

Pinal County, Arizona, about *one half mile* Southward from the Mammoth and Mohawk mines and the town of Shultz

Commencing at a monument of stones at the North Westerly center end which is about *Seven hundred and fifty (750)* feet North West of the discovery shaft, thence North Easterly *Three hundred (300)* feet to a monument of stones which is the North Easterly corner of claim, thence South Easterly *Seven hundred and fifty (750)* feet to a monument of stones which is the North Easterly center side monument, thence South Easterly *Seven hundred and fifty (750)* feet to a monument of stones which is the South Easterly corner of claim, thence South Westerly *Three hundred (300)* feet to a monument of stones which is the South Easterly center end monument, thence South Westerly *Three hundred (300)* feet to a monument of stones which is the South Westerly corner of claim, thence North Westerly *Seven hundred and fifty (750)* feet to a monument of stones which is the South Westerly center side monument, thence North Westerly *Seven hundred and fifty (750)* feet to a monument of stones which is the North Westerly corner of claim, thence North Easterly *Three hundred (300)* feet to the place of beginning

This claim is the South Easterly extension of the Elin claim

and shall be known as the *Standard* mine

Located *February 4th* 189*7*

Witness

J. B. Lawrence
E. J. Whalley

J. N. Smith

An Act Concerning Mines.

Be it Enacted by the Legislative Assembly of the Territory of Arizona:

SECTION 1. Every notice of location of a mining claim shall contain: First, the name of the claim located; second, the name of the locator; third, the date of location; fourth, the number of feet claimed on each side of the center of the discovery shaft, lengthwise of the claim; fifth, the general course of the lode deposit or premises located; sixth, the locality of the claim with reference to some natural object, or permanent monument, as will identify the claim.

SECTION 2. All mining locations hereafter located, the certificate of location of which shall not contain: First, the name of the lode or premises; second, the name of the locator or locators; third, the date of location; fourth, the number of feet in length of said claim and the number of feet claimed on each side of the center of the lode or premises; as near as may be; sixth, the locality of the claim with reference to some natural object, or permanent monument, as will identify the claim.

SECTION 3. Before filing such location certificate with the County Recorder of the proper County, the discoverer shall locate his claim by: First, sinking a discovery shaft upon the premises so claimed, to a depth of at least ten feet from the lowest part of the rim of such shaft at the surface and deeper if necessary, until there is shown by such work a lode deposit or mineral in place; second, by posting at the point of discovery, a plain sign or notice substantially conforming to the location certificate; third, by marking such claim or premises on the ground so that its boundaries can be readily traced.

SECTION 4. Such surface boundaries shall be marked by Eight Feet High Posts projecting at least Three Feet Above the Surface of the Ground, or by substantial Stone Monuments at least Three Feet High, to-wit: One at each corner of said claim, and one at the center of each end and side line thereof.

SECTION 5. Any open-cut, cross cut, adit or tunnel which shall be made as above provided for, as a part of the location of a mining claim, and which shall be equal in amount of work, to a shaft ten feet deep and four feet wide by six feet long, and which shall cut a lode or mineral in place at the depth of ten feet from the surface, shall be equivalent, as a discovery work, to a shaft sunk from the surface.

SECTION 6. The discoverer shall have ninety days from the date of discovering the lode and the posting of the notice thereon, to perform said discovery work thereon.

SECTION 7. If at any time the locator of any mining claim hereafter located, or his assigns, shall learn that the original certificate was defective, or that the requirements of the law had not been complied with before filing, or shall be desirous of changing his surface boundaries, or of taking in any additional ground which is subject to location, or in case the original certificate was made prior to the passage of this law, and he shall be desirous of securing the benefits of this Act, such locator or his assigns, may file an amended certificate of location subject to the provisions of this Act, regarding the making of new locations.

SECTION 8. The amount of assessment, or representation, work or improvements, to be done or made during each year, after the completion of the location as herebefore provided, and the time for doing the same, shall be as provided by the laws of the United States.

SECTION 9. Within three months after the expiration of the period of time fixed for the performance of annual labor or the making of improvements upon any mining claims or premises, the person on whose behalf such work or improvement was made, or some person for him, knowing the facts, may make and record in the office of the County Recorder of the county wherein such claim is situated an affidavit in substance as follows:

TERRITORY OF ARIZONA, ss
County, ss

being duly sworn deposes and says, that he is a citizen of the United States, and more than 21 years of age, and resides at _____ in _____ County, Arizona Territory, and is personally acquainted with the mining claim and premises located and known as _____ in _____ Mining District, County of _____, Arizona Territory, the office of the County Recorder of said county, in Book _____ of Records of Mines, at _____ page _____, that between the _____ day of _____ A. D. 189 _____ at least _____ dollars worth of work and improvements were done and performed upon said premises or lode, not including the location work of said claim. Such work and improvements were made by and at the expense of _____ owners of said premises for the purpose of complying with the law of the United States pertaining to assessments or annual work, and [here name the miners or men who worked upon the claim in doing the work] were the men employed by said owner and who labored upon said premises and who did said work and improvements, and said work so done upon said premises is described as follows, to-wit: (Here describe the work done.) _____ day of _____ 189 _____

Subscribed and sworn to before me _____ day of _____ 189 _____

(Signature) _____

Notary Public.

SECTION 10. Such affidavit when so recorded shall be prima facie evidence of the performance of such labor or the making of such improvements, and said original affidavit after it has been recorded, or a certified copy of same, shall be received as evidence accordingly by all the Courts in this Territory.

SECTION 11. The relocation of forfeited or abandoned lode claims shall only be made by sinking a new discovery shaft and fixing new boundaries in the same manner and to same extent as is required in making a new location; or the relocater may sink the original discovery shaft ten feet deeper than it was at date of commencement of such relocation, and shall erect new or make the old monuments the same as originally required. In either case a new location monument shall be erected, and the location certificate shall state if the whole or any part of the new location is located as abandoned property.

SECTION 12. This Act shall take effect and be in force from and after July 1st, 1895.

SECTION 13. All Acts and parts of Acts in conflict with this Act are hereby repealed.

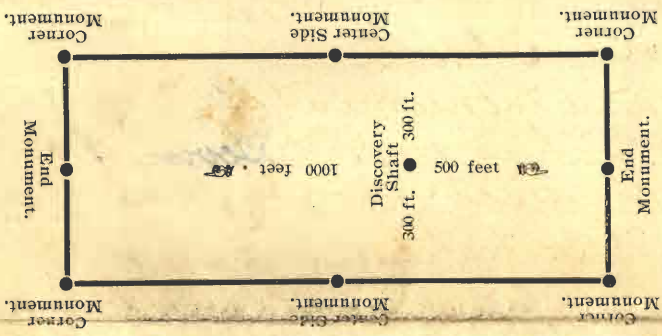

The above diagram is to give the locator a general idea of plan of location under the new law. Your discovery shaft can be in the center of claim or any distance from either end and you desire. In the diagram we have placed it 500 feet from one end and 1000 feet from the other. In description be careful to state locality of claim with reference to some natural object, or permanent monument, as will identify the claim.

Stankard

Dr. J. M. Smith
Recorder
OK

Stankard

Territory of Arizona,
County of Pinal,
ss.

J. A. Chamberlain Recorder,
in and for the County of Pinal, Territory
aforesaid, do hereby certify that the
aforesaid instrument was filed and
recorded at request of

J. M. Smith
on the 17 day of *April*
A. D., 189 *9*, at _____ minutes past
9 o'clock, A. M., in book No. *15*

of *Mines* Page *537*
WITNESS my hand and official

Seal, this *17* day of *April*, 189 *9*
J. A. Chamberlain

Stankard Recorder,
Deputy.

Stankard

LOCATION NOTICE.

Quartz Claim.

To All Whom it May Concern:

J. J. M. Smith Claim for mining purposes, 600 feet wide and 1500 feet long in the form

of a parallelogram. Monuments of stones at each corner, at the center of each end and center of each side line. This notice is placed in a monument at the discovery shaft. Four hundred and

fifty (450) feet from the North West

end of claim. General direction North West and South East

Situated in Mammoth Mining District,

Pinal County, Arizona, about one third mile

southern from the Mammoth and Mohawk mines and the town of Shultz

Commencing at a monument of stones at the North West side center end which is about four hundred and fifty (450) feet North West of the discovery shaft. Thence North Easterly three hundred (300) feet to a monument of stones which is the North Easterly corner of claim. Thence South Easterly seven hundred and fifty (750) feet to a monument of stones which is the North Easterly center side monument. Thence South Easterly seven hundred and fifty (750) feet to a monument of stones which is the South Easterly corner of claim. Thence South West side three hundred (300) feet to a monument of stones which is the South Easterly center end monument. Thence South West side three hundred (300) feet to a monument of stones which is the South West side corner of claim. Thence North West side seven hundred and fifty (750) feet to a monument of stones which is the South West side center side monument. Thence North West side seven hundred and fifty (750) feet to a monument of stones which is the North West side corner of claim. Thence North Easterly three hundred (300) feet to the place of beginning.

This claim is the South Easterly extension of the Alvandia claim

and shall be known as the Treasure mine

Located February 4th 1899

J. M. Smith

Witness
J. R. Roney
E. J. Whately

An Act Concerning Mines.

Be it Enacted by the Legislative Assembly of the Territory of Arizona:

- Section 1. Every notice of location of a mining claim shall contain: First, the name of the lode or third, the date of location; fourth, the number of feet in length of the lode deposit; fifth, the locality of the center of the discovery shaft, lengthwise of the claim; fifth, the general course of the lode deposit; sixth, the name of the lode or premises; second, the name of the locator or locators; third, the date of location; fourth, the number of feet in length of the lode or premises; second, the name of the locator or locators; third, the locality of the claim; fifth, the general course of the lode or premises; as will identify the claim; shall be void.
- Section 3. Before filing such location certificate with the County Recorder of the proper County, the discoverer shall locate his claim by: first, sinking a discovery shaft upon the premises so claimed, to a depth of at least ten feet from the west part of the rim of such shaft at the surface and deeper if necessary, until there is shown by such work a lode deposit of mineral in place; second, by posting at the point of discovery, on the surface and deeper if necessary, a plain sign or notice substantially conforming to the location certificate; third, by marking such claim or premises on the ground so that its boundaries can be readily traced.
- Section 4. Such surface boundaries shall be marked by Eight substantial Posts projecting at least Three Feet Above the Surface of the Ground, or by substantial Stone Monuments at least Three Feet High, to-wit: One at each corner of said claim, and one at the center of each end and side line thereof.
- Section 5. Any open-cut cross cut, adit or tunnel which shall be made as above provided for, as a part of the location of a mining claim, and which shall be equal in amount of work, to a shaft ten feet deep and four feet wide by six feet long, and which shall cut a lode or mineral in place at the depth of ten feet from the surface, shall be equivalent, as a discovery work, to a shaft sunk from the surface.
- Section 6. The discoverer shall have ninety days from the date of discovering the lode and the posting of the notice thereon, to perform said discovery work thereon.
- Section 7. If at any time the locator of any mining claim, heretofore or hereafter located, or his assigns, shall learn that his original certificate was defective or that the requirements of the law had not been complied with before filing, or shall be desirous of changing his surface boundaries, or of taking in any additional ground which is subject to location, or in case the original certificate was made prior to the passage of this law, and he shall be desirous of securing the benefits of this Act, such locator or his assigns, may file an amended certificate of location subject to the provisions of this Act, regarding the making of new locations.
- Section 8. The amount of assessment, or representation, work or improvements, to be done or made during each year, after the completion of the location as heretofore provided, and the time for doing the same, shall be as provided by the laws of the United States, knowing the facts, may make and record in the office of the County Recorder of the county wherein such claim is situated an affidavit in substance as follows:
- TERRITORY OF ARIZONA, ss
 and more than 21 years of age, and resides at _____ being duly sworn deposes and says, that he is a citizen of the United States, and really acquainted with the mining claim and premises located and known as _____ County, Arizona Territory, and is per-
 in _____ Mining District, County of _____ Arizona Territory, the notice of
 location of which premises is recorded in the office of the County Recorder of said county, in Book _____ of Records of Mines, at
 page _____; that between the _____ day of _____ A. D. 189____ at least _____ day of _____
 done and performed upon said premises or lode, not including the location work of said claim. Such work and improvements were made by and
 at the expense of _____ owners of said premises for the
 purpose of complying with the law of the United States pertaining to assessments or annual work, and (here name the miners or men who
 and improvements, and said work so done upon said premises is described as follows, to-wit: (Here describe the work done.)
 Subscribed and sworn to before me _____ 189____
 (Signature) _____ day of _____

Section 10. Such affidavit when so recorded shall be prima facie evidence of the performance of such labor or the making of such improve-
 ments, and said original affidavit after it has been recorded, or a certified copy of record of same, shall be received as evidence accordingly by all
 Courts in this Territory.

Section 11. The relocation of forfeited or abandoned lode claims shall only be made by sinking a new discovery shaft and fixing new
 boundaries in the same manner and to same extent as is required in making a new location; or the locator may sink the original discovery
 shaft ten feet deeper than it was at date of commencement of such relocation, and shall erect new or make the old monuments the same as origi-
 nally required. In either case a new location monument shall be erected, and the location certificate shall state if the whole or any part of the
 new location is located as abandoned property.

Section 12. This Act shall take effect and be in force from and after July 1st, 1895.

Section 13. All Acts and parts of Acts in conflict with this Act are hereby repealed.

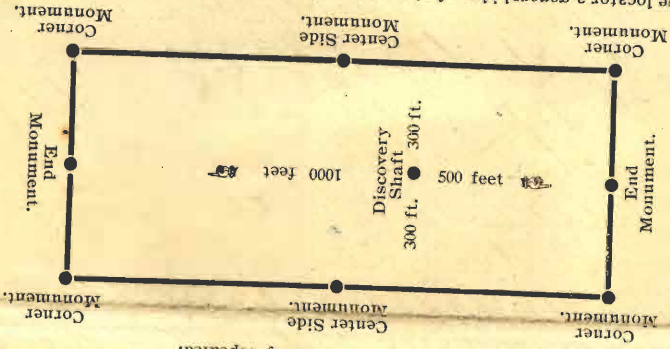

The above diagram is to give the locator a general idea of plan of location under the new law. Your discovery shaft can be in the center of
 claim or any distance from either end you desire. In the diagram we have placed it 500 feet from one end and 1000 feet from the other. In de-
 scription be careful to state locality of claim with reference to some natural object, or permanent monument, as will identify the claim.

3 Pa
 Territory of Arizona,
 County of Pinal, ss.
 I, I. O. Chamberlain Recorder,
 in and for the County of Pinal, Territory
 aforesaid, do hereby certify that the
 annexed instrument was filed and
 recorded at request of
J. M. Smith
 on the 14 day of April
 A. D., 1899, at _____ minutes past
9 o'clock, A. M. in book No. 15
 of Mines Page 540
 WITNESS my hand and official
 Seal, this 17 day of April 1899
I. O. Chamberlain
John L. Ogden
 Recorder.
 Deputy.

Resources

015

U. S. SURVEYOR-GENERAL'S FINAL CERTIFICATE ON FIELD NOTES.

Department of the Interior,

OFFICE OF U. S. SURVEYOR-GENERAL,

Phoenix, Arizona.

February 28, 1919

I, U. S. Surveyor-General for District of Arizona

do hereby certify that the foregoing transcript of the Field Notes, return and approval of the survey of the mining claim of

T. M. Smith

known as the STANDARD AND TREASURE LODES.

situate in MAMMOTH OR OLD HAT

Mining District, PINAL County, ARIZONA.

in Section s 34-35, Township No. 8 S., Range No. 16 E., and

designated as Survey No. 3534, has been correctly copied from the originals on file in this office; that said Field Notes furnish such an accurate description of said mining claim as will, if incorporated into a patent, serve fully to identify the premises, and that such reference is made therein to natural objects or permanent monuments as will perpetuate and fix the locus thereof.

And I further certify that five hundred dollars' worth of labor has been expended or improvements made upon said mining claim by claimant or his grantors, and that said improvements consist of 6 cuts and 4 shafts, total value \$1275.

and that no portion of said labor or improvements has been included in the estimate of expenditures upon any other claim.

I further certify that the plat thereof, filed in the U. S. Land Office at Phoenix, Arizona, is correct and in conformity with the foregoing Field Notes.

Frank P. Trott,

United States Surveyor-General for Arizona.

4-687

SURVEYOR GENERAL'S CERTIFICATE OF APPROVAL OF FIELD NOTES
AND SURVEY OF MINING CLAIM

DEPARTMENT OF THE INTERIOR
OFFICE OF U. S. SURVEYOR GENERAL

Phoenix, Arizona,

February 28, 1919

I, U. S. Surveyor General for District of Arizona

do hereby certify that the foregoing and hereto attached Field Notes and Return of the Survey of the Mining Claim of

T. M. Smith

, known as the

STANDARD AND TREASURE LODES.

situate in MAMMOTH OR OLD HAT mining district,

PINAL County, ARIZONA.

in Section^s 34-35, Township No. 8 S., Range No. 16 E.

, designated as Survey No. 3534

executed by T. N. Stevens, U. S. Mineral

Surveyor, Aug. 13-21, 1918, under my instructions dated

Aug. 5, 1918, have been critically examined and the necessary cor-

rections and explanations made, and the said Field Notes and Return, and the Survey they describe,

are hereby approved. The certified copy of the location certificate filed by the applicant for survey is

on file in this office and a true copy of said certified copy of said location certificate is included and made

a part of the transcript of the field notes.



U. S. Surveyor General for Arizona.