

APR 28 1919

MINERAL SURVEY No. 2542

LOT No.

ARIZONA Land District.

FIELD NOTES

OF THE SURVEY OF THE MINING CLAIM OF

ALCYONE MINING COMPANY

KNOWN AS THE

Pilot, Parrett, Contention and Contention No. 1

San Francisco Mining District,

Mohave County, Arizona

Sections 28, 32, 34, Township 19 North, Range 20 West

Surveyed under instructions dated August 24, 1918.

by Herman C. Gulch U. S. Mineral Surveyor.

Claim located See location notices, 19

Survey commenced November 3, 1918.

Survey completed November 29, 1918.

Address of claimant Chas. F. Pugh, Agent Oatman, Arizona.

DATES OF AMENDED LOCATIONS.

Parrett Lode.

- Feet.

-1-

Beginning at Cor. No.1, identical with Cor. No.2, Pilot lode of this survey, a redwood post 4 ft. long, 4 ins. square, with nail at exact Cor., set 18 ins. in the ground, in mound of earth and stone, scribed P 1-3542 for this claim.

The N.E. Cor. of Sec.33; T.19 N; R.20 W, bears N17°06'E 1024.68 ft.

No other bearing objects available.

Thence S10°28'E

300.00 To East End center monument, a redwood post, 4 ft. long 4 ins. square, with nail at exact point, set 18 ins. in the ground in mound of earth and stone scribed 3542.

600.00 To Cor. No.2, a redwood post, 4 ft. long, 4 ins. square with nail at exact Cor., set 18 ins. in the ground in mound of earth and stone, scribed P 2-3542.

No bearing objects available.

Thence S77°10'W

1410.00 Wagon road, course Northerly and southerly.

1500.00 To Cor. No.3, a redwood post, 4 ft. long, 4 ins. square, with nail at exact Cor., set 18 ins. in the ground in mound of earth and stone, scribed P 3-3542.

No bearing objects available.

Thence N10°28'W

300.00 To West end center monument, a redwood post, 4 ft. long 4 ins. square, with nail at exact point, set 18 ins. in the ground, in mound of earth and stone, scribed 3542.

600.00 To Cor. No.4, Identical with Cor. No.3, Pilot lode of this survey, a redwood post 4 ft. long, 4 ins. square, with nail at exact Cor., set 18 ins. in the ground in mound of earth and stone, scribed P 4-3542 for this claim.

Parrett lode-Cont.

-2-

Thence N77°-10'E

280.00 Wagon road, course Northerly and Southerly.

870.00 Wagon road, course Northeasterly and Southwesterly.

1500.00 To Cor. No.1, the place of beginning.

PILOT LODE.

Beginning at Cor. No.1, Identical with Cor. No.2
Contention No.1 lode of this survey and on line 1-2
Contention lode of this survey, a redwood post, 4 ft.
long, 4 ins. square, with nail at exact Cor., set 18 ins.
in the ground, in mound of earth and stone, scribed
Pilot 1-3542 for this claim.

The N.E. Cor. of Sec. 23; T.19 N; R.20 W., bears
N46°-29'-30"E 565.62 ft.

No other bearing objects available.

Thence S10-28'E

215.23 Cor. No.2 Contention lode of this survey.

285.00 Wagon road, course Easterly and westerly.

300.00 To East end center monument, a redwood post 4 ft. long,
4 ins. square, with nail at exact point, set 18 ins. in
the ground, in mound of earth and stone, scribed 7542.

600.00 To Cor. No.2, Identical with Cor. No.1, Parrett lode of
this survey, a redwood post previously described to
which I add Pilot 2-3542.

Thence S77-10'W

630.00 Wagon road, course Northeasterly and Southwesterly.

1220.00 Wagon road, course Northerly and Southerly.

1500.00 To Cor. No.3, Identical with Cor. No.4, Parrett lode of
this survey, a redwood post previously described to
which I add Pilot 3-3542.

Pilot lode-Cont.

Feet.

Thence N10°-28'W

300.00 To West end center monument, a redwood post, 4 ft. long 4 ins. square, with nail at exact point, set 18 ins. in the ground, in mound of earth and stone, scribed 3542.

509.96 Intersect West side line Gold Nob No.4 lode, unsurveyed, at N21°-52'W 107.93 ft. from the S.W.Cor.

600.00 To Cor. No.4, Identical with Cor. No.3 Contention No.1 lode of this survey, a redwood post 4 ft. long, 4 ins. square, with nail at exact Cor., set 18 ins. in the ground, in mound of earth and stone, scribed Pilot 4-3542, for this claim.

The S.W.Cor. Gold Nob No.4 lode, unsurveyed, bears S16°-41'E 197.02 ft.

No. other bearing objects available.

Thence N77°-10'E

576.03 Intersect Easterly side line Gold Nob No.4 lode, unsurveyed, at N21°-52'W 124.90 ft. from the S.E.Cor. The S.W. Cor. said Gold Nob No.4 lode, brs. S. 70° W. 587 ft. from the S.E.Cor. thereof.

1500.00 To Cor. No.1, the place of beginning.

CONTENTION NO.1 LODE.

Beginning at Cor. No.1, on a prominent, clean exposed ridge of Andesite rock in place, chiseled with a cross at the exact Cor. and C No 1 1-3542.

The N.E.Cor. of Sec.33; T.19 N; R.20 W., bears S68°-52'E 556.66 ft.

The S.E.Cor. Ella lode, unsurveyed, bears S61°-14'E 308.65 ft.

No other bearing objects available.

Thence S10°-28'E

39.07 Intersect Southerly end line Ella lode, unsurveyed, at N67°-19'W 285.55 ft. from the S.E.Cor.

Feet.	
145.27	Cor. No.1 Contention lode of this survey.
200.51	Intersect North boundary of Sec.33; T.19 N; R.20 W. at N89°-35'W 482.81 ft. from the N.E.Cor. and S89°-35'E 4808.75 ft. from the N.W.Cor.
300.00	To East end center monument, on line 1-2 Contention lode of this survey, A redwood post, 4 ft. long, 4 ins square with nail at exact point, set 18 ins. in the ground, in mound of earth and stone, scribed 3542.
480.25	West end center monument, Contention lode of this survey.
600.00	To Cor. No.2, Identical with Cor. No.1, Pilot lode of this survey, a redwood post, previously described, to which I add C NO 1 2-3542.
	Thence S77°-10'W
923.97	Intersect Easterly side line, Gold Nob No.4 lode, un- surveyed, at N21°-52'W 124.90 ft. from the S.E.Cor.
1500.00	To Cor. No.3, Identical with Cor. No.4 Pilot lode of this survey, a redwood post, previously described, to which I add, C NO 1 3-3542.
	Thence N10°-28'W
300.00	To West end center monument,, a redwood post, 4 ft. long 4 ins. square, with nail at exact point, set 18 ins. in the ground, in mound of earth and stone, scribed 7542.
600.00	To Cor. No.4, A redwood post, 4 ft. long, 4 ins. square with nail at exact Cor., set 18 ins. in the ground, in mound of earth and stone, scribed C NO 1 4-3542. No bearing objects available.
	Thence N77°-10'E
455.95	Intersect Easterly side line Gold Nob.No.4 lode, unsur- veyed, at N21°-52'W 751.91 ft. from the S.E.Cor.
640.85	Intersect North boundary of Sec.33; T.19 N; R.20 W., at N89°-35'W 1356.94 ft. from the N.E.Cor. and S89°-35'E 2934.62 ft. from the N.W.Cor. of said section.

Contention No.1 lode-Cont.

Feet.

-5-

1443.70' Intersect Southerly end line Ella lode, unsurveyed, at N67°-19'W 352.74 ft. from the S.E. Cor.

1500.00 To Cor. No.1, the place of beginning.

CONTENTION LODE.

Beginning at Cor. No.1, On line 1-2 Contention No.1 lode of this survey, A redwood post, 4 ft. long, 4 ins. square, with nail at exact Cor., set 18 ins. in the ground, in mound of earth and stone, scribed, C 1-3542.

The N.E. Cor. of Sec.33; T.19 N; R.20 W; bears S83°-18'-30"E 496.22 ft.

No other bearing objects available.

Thence S10°-28'E

55.26 Intersect North boundary of Sec.33; T.19 N; R.20 W. at N89°-35'W 482.81 ft. from the N.E. Cor. and S89°-35'E 4908.75 ft. from the N.W. Cor. of said section.

154.73 East end center monument, Contention No.1 lode of this survey.

334.98 To West end center monument, on line 1-2 Contention No.1 lode of this survey, A redwood post, 4 ft. long, 4 ins. square, with nail at exact point, set 18 ins. in the ground, in mound of earth and stone, scribed 3542.

454.73 Cor. No's 2-1 Contention No.1 and Pilot lodes of this survey.

669.96 To Cor. No.2, On line 1-2 Pilot lode of this survey, A redwood post, 4 ft. long, 4 ins. square, with nail at exact Cor., set 18 ins. in the ground, in mound of earth and stone scribed C 2-3542.

No bearing objects available.

Thence S74°-03'E

152.00 Wagon road, course Northeasterly and Southwesterly.

388.99 Intersect East boundary of Sec.33; T.19 N; R.20 W., at

Feet.

SO-14'E, 707.91 ft. from the N.E. Cor. and NO-14'W 1944.07 ft. from the East $\frac{1}{4}$ Cor. of said section. -

1109.36 To Cor. No.3, A redwood post, 4 ft. long, 4 ins. square, with nail at exact Cor., set 18 ins. in the ground, in mound of earth and stone, scribed C 3-3542.
No bearing objects available.

Thence N10-28'W

148.00 Wagon road, course Northwesterly and Southeasterly.

334.98 To East end center monument, A redwood post, 4 ft. long 4 ins. square, with nail at exact point, set 18 ins. in the ground, in mound of earth and stone, scribed 3542.

669.96 To Cor. No.4, Identical with the S.E. Cor. Helene No.3 lode, unsurveyed, a redwood post, 4 ft. long, 4 ins. square, with nail at exact Cor., set 18 ins. in the ground, in mound of earth and stone, scribed C 4-3542.
No bearing objects available.

Thence N74-03'W

195.00 Wagon road, course Northerly and Southerly.

340.00 South end center monument Helene No.3 lode, unsurveyed.

518.00 Wagon road, Course Northeasterly and Southwesterly.

596.43 Intersect East boundary of Sec.33; T.19 N; R.20 W; at SO-14'E 83.11 ft. from the N.E. Cor. and NO-14'W 2568.87 ft. from the East $\frac{1}{4}$ Cor. of said section.

680.00 S.W. Cor. Helene No.3 lode, unsurveyed.

906.82 Intersect North boundary of Sec.33; T.19 N; R.20 W., at N89-35'W 298.10 ft. from the N.E. Cor. and S89-35'E 4993.46 ft. from the N.W. Cor. of said section.

1109.36 To Cor. No.1, the place of beginning.

Variation at all corners 14° 30' E.

LODE LINES.

As near as can be determined from present developments, the veins of the several locations embraced in this claim, extend as follows from their respective discovery points;

Parrett- 808 ft. N77°-10'E and 692 ft. S77°-10'W.

Pilot- 770 ft. N77°-10'E and 730 ft. S77°-10'W.

Contention No.1- 250 ft. N77°-10'E and 1250 ft. S77°-10'W.

Contention- 212 ft. S74°-03'E and 897.36 ft. N74°-03'W.

AREA.

	Acres.
Total Area Parrett lode-----	20.643 ✓
Total Area Pilot Lode-----	20.643 ✓
Area in conflict with:	
Gold Nob No.4 lode, unsurveyed,-----	2.163 ✓
Total Area Contention No.1 lode-----	20.643 ✓
Area in conflict with:	
Gold Nob No.4 lode, unsurveyed,-----	7.101 ✓
Ella lode, unsurveyed,-----	.025 ✓
Total Area Contention lode-----	15.281 ✓

The survey of each lode of this location is identical with the respective location as staked upon the ground.

LOCATION.

This survey is located in Sections 28, 33 and 34 T.19 N; R.20 W; G.&&S.R., B. & M., San Francisco Mining District, Mohave County, Arizona.

ADJOINING AND CONFLICTING CLAIMS.

On the North, Gold Nob No.4, Ella, and Helene No.3, unsurveyed lodes, Claimants unknown.

On the East, Helene No.1, Helene No.4 and Pointer, unsurveyed lodes, Claimants unknown.

On the South, J.B. lode, unsurveyed, claimant unknown.

On the West J.B. No.2 and Gold Nob No.4, unsurveyed lodes, claimants unknown.

EXPENDITURE OF FIVE HUNDRED DOLLARS.

I certify that the value of the labor and improvements made upon, or for the benefit of each of the locations embraced in this survey, by the claimant or its grantors, is not less than five hundred dollars and that said improvements consist of :-

----- Parrett Lode.

No.1 The discovery monument of the Parrett lode, ^{on the outcrop of the vein,} consisting of a redwood post, 4ins. square, in mound of earth and rock, on the lode line 692 ft. from the West end center monument.

No.2 ~~The Discovery~~ cut, the center of a 10 ft. face is on the lode line, 600 ft. from the West end center monument, 4 ft. wide running N30° W 15 ft. to mouth.

Value \$60

No.3 The center of Main Shaft, 4x7 ft. in the clear, partly timbered, bears S58°-17'W 732 ft. from Cor.1. From center of collar, S8° E 50 ft. on a dip of 65 degrees to point A, 100 ft. to point B, 150 ft. to point C and 400 ft. to bottom of shaft. From point A N88° E 7.5 ft. to Sta.1, thence an adit 4½x7 ft. runs N70° E 20 ft. to face and an adit 4½x7 ft. runs S25° E 88 ft. to face. From point B an adit 4½x7 ft. runs N89°-30'E 54 ft. to face. From point C an adit 4½x7 ft. runs S8 E 40 ft. to face; A total of 200.5 ft. of adit and 400 ft. of shaft,

Value \$15000.00

Improvement No.3, above described, was started by the claimant company, as the working shaft to develop the Pilot and Parrett lodes; The Contention and Contention No.1 lodes were acquired by purchase; Subsequent to the purchase of these claims, the shaft was sunk from a depth of 165 ft. to 400 ft., at which depth it is at least 300 ft. below the surface of each of the claims in this group. The claimant company proposes by crosscutting and drifting, from this shaft, toward and under each of the claims, to develop and mine them, This plan of development is consistent with good mining.

The value of this improvement is therefore distributed equally to the four claims in this group, \$7750 being credited to each.

No.4 Shaft 4x7 ft. 35 ft. deep, The center of shaft bears S55°W 721 ft. from Cor. No.1. Value \$425.

Pilot Lode.

~~No.1 The discovery monument of the Pilot lode, consisting of a redwood post, 4 ins. square, in mound of earth and rock, on the lode line, 795 ft. from the East end center monument.~~

No.1 The discovery shaft, 4x6 ft. 8 ft. deep, The center of shaft is on the lode line 730 ft. from the West end center monument.

Value. \$80

$\frac{1}{4}$ interest in improvement No.3 Parrett lode, value \$3750.

Contention No.1 Lode.

No.1 The discovery shaft, 5x6 ft. 8 ft. deep, The center of shaft is on the lode line 250 ft. from the East end center monument,

Value \$80

No.2 Shaft, 4x8 ft., 8 ft. deep, The center of shaft bears N68°30'W 401 ft. from Cor. No.2. value \$80.

No.3 Shaft 4x6 ft. 8 ft. deep, The center of shaft bears
N67°-12'W 248 ft. from Cor. No.2.

Value \$80

No.4 Shaft, 3x5 ft., 7 ft. deep, The center of shaft
bears N64°-42'W 185 ft. from Cor. No.2

Value \$70

$\frac{1}{4}$ interest in improvement No.3 Parrett lode, Value, \$3750

Contention Lode.

No.1 The discovery shaft of the Contention lode, 4x6 ft.
8 ft. deep, The center of the shaft is on the lode line
212 ft. from the East end center monument.

Value \$80

$\frac{1}{4}$ interest in improvement No.3 Parrett lode, Value, \$3750

OTHER IMPROVEMENTS.

Shop, 12x14 ft., course of long side S82°W; The N.E. Cor.
bears S57°-47'W 775 ft. from Cor. No.1 Parrett lode.
Claimant herein.

Engine Room, 14x41 ft., course of long side S8°E., The
N.E. Cor. bears S63°-55'W 702 ft. from Cor. No.1 Parrett
lode. The N.E. Cor. is identical with the N.W. Cor. of the
Change Room, 8x12 ft., long side S8°E.

Claimant herein.

House, 14x26 ft., course of long side N20°E., The N.E.
Cor. bears S66°-10'W 758 ft. from Cor. No.1 Parrett lode.

Claimant herein.

Cut, 4 ft. wide, 6 ft. face, The center of face bears
N83°E 542 ft. from Cor. No.4 Contention No.1 lode,
running S5°E 12 ft. to mouth.

Claimant unknown.

This survey was made with an Ainsworth Engineers transit.

The courses were deflected from the true meridian as determined by direct solar observation.

The distances were measured with 100 ft. and 500 ft. steel tapes.

REPORT.

The side and end lines of the locations in this survey were run direct upon the ground; Tie lines were run either directly upon the ground or by traverses submitted in a separate report herewith.

The N.E. Cor. of Sec. 33; T. 19 N; R. 20 W. to which tie is given, consists of a two inch black iron pipe with brass cap, stamped: T 19 N R20W S27, S28, S33, S34.

The East 1/4 Cor. of Sec. 33; T. 19 N; R. 20 W. consists of a one inch black iron pipe, with brass cap, stamped: 1/4 Cor S33, S34.

The N.W. Cor. of Sec. 33; T. 19 N; R. 20 W., consists of a two inch black iron pipe, with brass cap stamped: T19N, R20W, S28, S29, S32, S33.

The North 1/4 Cor. of Sec. 33; T. 19 N; R. 20 W., has been washed out.

All corners of the Ella and Helene No. 3, unsurveyed lodes, consist of 4x4 ins. redwood posts, properly marked.

All corners of the Gold Nob No. 4 lode, unsurveyed, consist of rock monuments, 2 ft. high, diameter of base 2 ft.

The disagreement between these notes and the notices of location is due to error in the latter,

Catman, Arizona

Herman C. Gulch

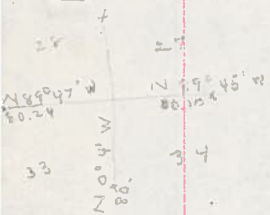

FINAL OATHS FOR SURVEYS.

LIST OF NAMES.

A list of the names of the individuals employed by Herman C. Zulch
 United States Mineral Surveyor, to assist in running, measuring, and marking the lines, corners, and
 boundaries described in the foregoing field notes of the survey of the mining claim of the
Alcyone Mining Company
 known as the Pilot, Parrett, Contention and Contention No. 1 lodes
 and showing the respective capacities in which they acted.

A. B. Crosby, Chainman.
 _____, Chainman.
 _____, Axman.
 _____, Flagman.

FINAL OATHS OF ASSISTANTS.

W^e, I, A. B. Crosby
 and _____, do solemnly swear that ^Iwe assisted
Herman C. Zulch, United States Mineral Surveyor, in marking the corners and surveying
 the boundaries of the mining claim of the Alcyone Mining Company
 known as the Pilot, Parrett, Contention and Contention No. 1 lodes
 represented in the foregoing field notes as having been surveyed by said mineral surveyor and under his
 direction; and that said survey has been in all respects, to the best of our knowledge and belief, faithfully
 and correctly executed, and the corner and boundary monuments established according to law and the instruc-
 tions furnished by the United States Surveyor-General for Arizona.

A. B. Crosby, Chainman.
 _____, Chainman.
 _____, Axman.
 _____, Flagman.

Subscribed and sworn to by the above-named persons before me this 6th
 day of July, 1919

Paulo Sheffield
 Notary Public

MY COMMISSION EXPIRES
 JUNE 28, 1919

FINAL OATH OF U. S. MINERAL SURVEYOR.

I, Herman C. Zulch, U. S. Mineral Surveyor, do solemnly swear that, in pursuance of instructions received from the United States Surveyor General for Arizona, dated August 24, 1918, I have, in strict conformity to the laws of the United States, the official regulations and instructions thereunder, and the instructions of said Surveyor General, faithfully and correctly executed the survey of the Mining Claim of the Alcyone Mining Company, known as the Pilot, Parrett, Contention and Contention No. 1 lodes, situate in San Francisco Mining District, Mohave County, Arizona, in Sections 28, 33, 34, Township No. 19 N., Range No. 20 West, and designated as Survey No. 3542, as represented in the foregoing field notes, which accurately show the boundaries of said mining claim as distinctly marked by monuments on the ground, and described in the attached copy of the location certificate, which was received by me from the Surveyor General with said instructions, and that all the corners of said survey have been established and perpetuated in strict accordance with the law, official regulations and instructions thereunder; and I do further solemnly swear that the foregoing are the true and original field notes of said survey and my report therein, and that the labor expended and improvements made upon said mining claim by claimant or its grantors are as therein fully stated, and that the character, extent, location, and itemized value thereof are specified therein with particularity and full detail, and that no portion of said labor or improvements so credited to this claim has been included in the estimate of expenditures upon any other claim.

Herman C. Zulch
U. S. Mineral Surveyor.

Subscribed and sworn to by the said Herman C. Zulch
U. S. Mineral Surveyor, before me Jacob Sheffield
Notary Public this 12th day of Feb, 1919

Jacob Sheffield
Notary Public.

U. S. SURVEYOR-GENERAL'S FINAL CERTIFICATE ON FIELD NOTES.

Department of the Interior,

OFFICE OF U. S. SURVEYOR-GENERAL,

Phoenix, Arizona.

July 26, 1919.

I, U. S. Surveyor-General for District of Arizona

do hereby certify that the foregoing transcript of the Field Notes, return and approval of the survey of the mining claim of

ALCYONE MINING COMPANY

known as the PILOT, PARRETT, CONTENTION and CONTENTION NO. 1 lodes

situate in SAN FRANCISCO

Mining District, MOHAVE County, ARIZONA

in Sections 28, 33, 34, Township No. 19 North, Range No. 20 West, and

designated as Survey No. 3542, has been correctly copied from the originals on file in

this office; that said Field Notes furnish such an accurate description of said mining claim as will, if incorporated into a patent, serve fully to identify the premises, and that such reference is made therein to natural objects or permanent monuments as will perpetuate and fix the locus thereof.

And I further certify that five hundred dollars' worth of labor has been expended or improved or for each of
ments made upon said mining claim by claimant or its grantors, and that said improvements consist of 1 cut, 8 shafts and 4 adits, total value \$15,955.

As improvement No. 3 on the Parrett lode is a common improvement for the benefit and development of this entire group of claims, an undivided one-fourth interest therein, value \$3750, is properly credited to each of the claims in this survey.

and that no portion of said labor or improvements has been included in the estimate of expenditures upon any other claim.

I further certify that the plat thereof, filed in the U. S. Land Office at Phoenix, Arizona is correct and in conformity with the foregoing Field Notes.

Frank P. Trott

United States Surveyor-General for Arizona.

SURVEYOR-GENERAL'S CERTIFICATE OF APPROVAL OF FIELD NOTES AND SURVEY OF MINING CLAIM.

Department of the Interior,

OFFICE OF U. S. SURVEYOR-GENERAL,

Phoenix, Arizona.

July 26, 1919

I, U. S. Surveyor-General for District of Arizona

do hereby certify that the foregoing and hereto attached Field Notes and Return of the Survey of the Mining Claim of

ALCYONE MINING COMPANY

, known as the

PILOT, PARRETT, CONTENTION and CONTENTION NO. 1 lodes

situate in SAN FRANCISCO mining district,

MOHAVE County, ARIZONA

in Sections 28, 33, 34, Township No. 19 North, Range No. 20 West

, designated as Survey No. 3542

executed by Herman C. Zulch, United States Mineral

Surveyor, November 3-29, 1918, 191, under my instructions dated

August 24, 1918, 191, have been critically examined and the necessary cor-

rections and explanations made, and the said Field Notes and Return, and the Survey they describe,

are hereby approved. A true copy of the copy of the location certificate filed by the applicant for

survey is included in the field notes.

[Handwritten signature]

U. S. Surveyor-General for Arizona

UNITED STATES DEPARTMENT OF THE INTERIOR 9605 (956)
BUREAU OF LAND MANAGEMENT M.S. 3542
ARIZONA STATE OFFICE

NOTICE OF CANCELLATION OF MINERAL SURVEY

The Pilot, Parrett, Contention, and Contention No. 1 lodes, Mineral Survey No. 3542, located in sections 28, 33 and 34, Township 19 North, Range 20 West, Gila and Salt River Meridian, Arizona, are hereby canceled.

These claims have not been filed with the Arizona State Office, Bureau of Land Management, in accordance with Section 314, 90 STAT. 2769, (43 U.S.C. 1744).

This cancellation was necessitated to clear the record.

The Mineral Survey Plat should be noted as follows:

"Pilot, Parrett, Contention, and Contention No. 1 lodes, M.S. 3542, were canceled February 7, 2007, by memo 9605 (956) M.S. 3542, which is now a part of the original field notes."

February 7, 2007
Date

Stephen K. Hansen
Chief Cadastral Surveyor of Arizona