

RECEIVED
BUREAU OF LAND MANAGEMENT

1953 AUG -3 AM 9:30
1-688

REGION V.
PHOENIX, ARIZONA

UNITED STATES
DEPARTMENT OF THE INTERIOR
BUREAU OF LAND MANAGEMENT



1

MINERAL SURVEY NO. 4374

Arizona Land District.

FIELD NOTES

Of The Survey Of The Mining Claim Of

Albert B. Capt and Ursula Capt

Known As The

PEGGIE lode mining claim

Hartford Mining District,

Cochise County, Arizona

Section 5, Township 24 S., Range 21 E., G&SRM

Surveyed under order dated March 4, 1953.

by Ralph L. Motz
Mineral Surveyor.

Claim located July 8, 1929

Survey commenced April 27, 1953

Survey completed April 28, 1953

Address of claimant's attorney, Gentry & Gentry,
P.O. Box - Drawer T,
Bisbee, Arizona.

DATES OF AMENDED LOCATIONS

January 14, 1953.

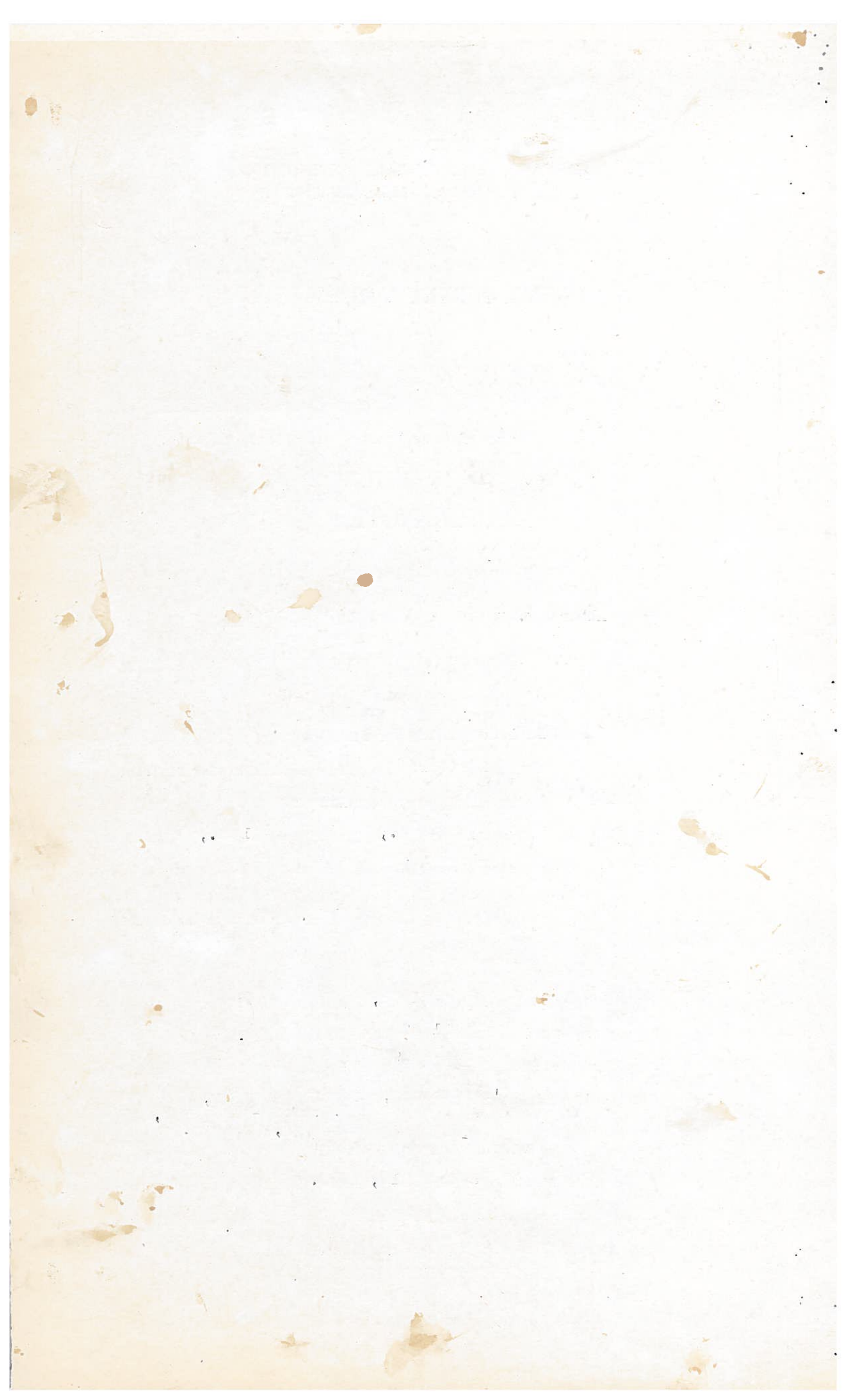

Survey No. 4374

This survey was made with a C. L. Berger & Sons Precise transit, with horizontal limb 6.25 ins. diam., having two double opposite verniers, and full vertical circle 5 ins. diam., having one double vernier; the verniers read to one minute of arc; the eye-piece is equipped with a colored glass slide in a prismatic eye-piece for making direct observations upon the sun. The instrument was in good condition at the time of the survey, and all adjustments were in good order.

All azimuths in this record were determined by the method of deflection angles referred to the meridian determined by the following observation:-

April 29, 1953, at Cor. No. 1 of the Peggie lode, in latitude $31^{\circ} 22' N.$, and longitude $110^{\circ} 14' W.$, I made a series of eight altitude observations upon the sun for azimuth at approximately equal time intervals, four each with the telescope in direct and reversed positions, observing opposite limbs of the sun, and reading the horizontal angle from Cor. No. 2 southwest to the sun.

Mean time of observation, 105th

meridian standard time - - - - - 8h., 45m., A.M.

Declination of the sun at mean
time of observation - - - - - $14^{\circ} 30' 37.9'' N.$

Mean observed vertical angle to
sun's center - - - - - $38^{\circ} 42'$

Mean horizontal angle from reference
point to sun's center - - - - - $121^{\circ} 16' S-E$

True bearing to reference point - - - S. $37^{\circ} 42' W.$

The lines were measured with a Keuffel & Esser steel tape, 100 ft. in length, graduated to feet, tenths and hundredths of feet for the entire length; a Keuffel & Esser steel tape, 300 feet in length, graduated to feet, tenths and hundredths of feet for the entire length. All tapes were compared with a Lufkin standard steel tape at the time of beginning the survey and found correct.

All lines and connections of this survey were run by direct methods.

The magnetic variation observed at each corner of the survey gave a uniform value of $12^{\circ} 45' E.$

PEGGIE LODGE

Beginning at Cor. No. 1 of the Peggie lode, identical with Cor. No. 3 of Survey No. 4297 Maggie lode,

An iron pipe, 2 ins. diam., 19 ins. above ground, with iron cap, mkd. P-1-4374; from which

The $1/4$ corner of Sections 2 and 5, T. 24 S., R. 21 E., G. & S. R. M. bears N. $72^{\circ} 27' E.$, 1573.0 ft. dist.; being an iron pipe with brass cap, firmly set and marked as described in the official record.

A sandstone tock in place, 9x30 ins., 15 ins. above ground, bears N. $22^{\circ} 01' W.$, 20.7 ft. dist., mkd. BR X P-1-4374

A quartzite rock in place, 18x25 ins., 8 ins. above ground, bears S. $25^{\circ} 05' W.$, 19.1 ft. dist., mkd. BR X P-1-4374

A monument of rocks, 3 ft. high, 3 ft. base, bears northeasterly 3 ft.

Feet	Thence S. 37° 42' W.,
300	Lode line, discovery point bears N. 52° 18' W., 1050 ft. dist.
600	Cor. No. 2 Set an iron pipe, 36 ins. long, 2 ins. diam., 18 ins. in the ground, in a mound of stone, with brass cap, mkd. P-2-4374; from which A quartzite rock in place, 17x30 ins., 12 ins. above ground bears S. 33° 53' E., 15.5 ft. dist., mkd. BR-x P-2-4374 A monument of rocks, 3 ft. high, 3 ft. diam., bears southeasterly 3 ft. Thence N. 52° 18' W.,
1500	Cor. No. 3 Set an iron pipe, 2 ins. diam., 36 ins. long, 18 ins. in the ground, in a mound of stones, with brass cap, mkd. P-3-4374; from which A monument of rocks, 3 ft. high, 3 ft. base, bears northeasterly 3 ft. Thence N. 37° 42' E.,
300	Lode line, discovery point bears S. 52° 18' E., 450 ft. dist.
600	Cor. No. 4 Set an iron pipe, 2 ins. diam., 36 ins. long, 18 ins. in the ground, in a mound of stones, with brass cap, mkd. P-4-4374; from which A monument of rocks, 3 ft. high, 3 ft. base, bears northwesterly 3 ft. Thence S. 52° 18' E.,
1500	Cor. No. 1 and place of beginning.

AREA acres

Total area, Peggie lode - - - - - 20.661

LOCATION

This survey is located in the NE 1/4, SE 1/4, NW 1/4 and SW 1/4 of Sec. 5, T. 24 S., R. 21 E., G. & S. R. M., Arizona.

The survey of the Peggie lode is identical with the location or amended location as marked upon the ground.

EXPENDITURES

The improvements and the value of the labor and improvements made upon this lode location by the claimants or their grantors are as follows:-

- No. 1 The discovery point of the Peggie lode, is on the lode line 450 ft. from a point on line 3-4, 300 ft. from Cor. No. 3, being an outcrop of copper ore.
- No. 2 An open cut, the mouth of which bears S. 23° 48' E., 485 ft. from Cor. No. 4 of the Peggie lode; 5 ft. wide 10 ft. face, runs S. 18° W., 13 ft. to face and portal of tunnel, 5 x 7 ft. in size, running S. 18° W., 19 ft. to breast
Value \$450
- No. 3 An open cut, the mouth of which bears S. 12° 39' E., 432 ft. from Cor. No. 4 of the Peggie lode; 4 ft. wide 8 ft. face, runs west 10 ft. to face
Value \$50
- No. 4 An open cut, the mouth of which bears S. 16° 10' E., 410 ft. from Cor. No. 4 of the Peggie lode; 4 ft. wide 8 ft. face, runs west 12 ft. to face and mouth of second open cut, 4 ft. wide, 6 ft. face, running west 10 ft. to face
Value \$100
- No. 5 An open cut, the mouth of which bears S. 28° 32' E., 318 ft. from Cor. No. 4 of the Peggie lode; 4 ft. wide, 10 ft. face, runs West 12 ft. to face
Value \$60
- No. 6 A shaft, the center of which bears S. 28° 22' E., 292 ft. from Cor. No. 4 of the Peggie lode; 4x6 ft. in size, 4 ft. deep
Value \$40

FIELD ASSISTANTS

J. I. Horton - - - - - chainman.

EXHIBIT

No. 1. The first of the items listed on the list is a...

No. 2. The second of the items listed on the list is a...

No. 3. The third of the items listed on the list is a...

No. 4. The fourth of the items listed on the list is a...

No. 5. The fifth of the items listed on the list is a...

EXHIBIT

UNITED STATES
DEPARTMENT OF THE INTERIOR
BUREAU OF LAND MANAGEMENT

CERTIFICATE OF SURVEYOR

I, Ralph L. Motz, Mineral Surveyor,
 hereby certify upon honor that in pursuance of an order received from the Division
of Cadastral Engineering, Region V, at Albuquerque, New Mexico,
 dated March 4, 1953, I have faithfully and correctly executed the survey
 of the mining claim of Albert B. Capt and Ursula Capt
 known as the Peggie lode mining claim
 (lode, placer, or millsite)
 situate in Hartford Mining District,
Cochise County, Arizona. Section 5 T. 24 S, R. 21 E.
Gila and Salt River Meridian, Arizona, and designated
 (State)
 as Survey No. 4374, which is represented in the fore-
 going field notes as having been executed by me and under my direction, and that said
 survey has been made in strict conformity with said order, the Manual of Instructions
 for the Survey of the Public Lands of the United States, and in the specific manner
 described in the foregoing field notes, and I do further certify that the labor ex-
 pended and improvements made upon or for the benefit of the lode
 (lode or placer)
 location—embraced in the said mining claim by claimant— or their grantors
 are fully stated in my report therein, and that the character, extent, location, and
 itemized value thereof are specified therein with particularity and full detail, and
 that no portion of, or interest in, said labor and improvements so credited to this
 claim has been included in the estimate of expenditures upon any other claim.

Bisbee, Arizona.
(Place)

Ralph L. Motz
(Mineral Surveyor)

April 30, 1953.
(Date)

UNITED STATES
DEPARTMENT OF THE INTERIOR
LAND MANAGEMENT
BUREAU OF LAND MANAGEMENT
STATEMENT OF WORK

1. The purpose of this statement of work is to define the scope, objectives, and deliverables of the project. The project is to be completed by the end of the fiscal year.

2. The project is to be completed by the end of the fiscal year. The project is to be completed by the end of the fiscal year.

3. The project is to be completed by the end of the fiscal year. The project is to be completed by the end of the fiscal year.

4. The project is to be completed by the end of the fiscal year. The project is to be completed by the end of the fiscal year.

5. The project is to be completed by the end of the fiscal year. The project is to be completed by the end of the fiscal year.

6. The project is to be completed by the end of the fiscal year. The project is to be completed by the end of the fiscal year.

7. The project is to be completed by the end of the fiscal year. The project is to be completed by the end of the fiscal year.

8. The project is to be completed by the end of the fiscal year. The project is to be completed by the end of the fiscal year.

9. The project is to be completed by the end of the fiscal year. The project is to be completed by the end of the fiscal year.

10. The project is to be completed by the end of the fiscal year. The project is to be completed by the end of the fiscal year.



**CERTIFICATE OF APPROVAL OF FIELD NOTES AND SURVEY OF
MINING CLAIM**

UNITED STATES
DEPARTMENT OF THE INTERIOR

~~GENERAL LAND OFFICE~~ BUREAU OF LAND MANAGEMENT
~~PUBLIC SURVEY OFFICE~~ Division of Cadastral Engineering

At Albuquerque, New Mexico

..... July 20, 1953

I, Office Cadastral Engineer at Albuquerque, New Mexico

do hereby certify that the foregoing and hereto attached Field Notes and Return of the Survey of the
Mining Claim of Albert B. Capt and Ursula Capt

....., known as the
Peggie lode mining claim

situate in Hartford mining district,

..... Cochise County, Arizona

in Section 5, Township No. 24 South, Range No. 21 East

G&SRM Ariz., designated as Survey No. 4374

executed by Ralph L. Motz, Mineral

Surveyor, April 27 and 28, 1953, 19, under my instructions dated

March 4, 1953, 19, have been critically examined and the necessary

corrections and explanations made, and the said Field Notes and Return, and the Survey they describe,

are hereby approved. The certified copy of the location certificate filed by the applicant for survey is

included and made a part of these field notes.

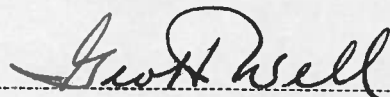

Geo. H. Well, Office Cadastral Engineer.

CENTRAL BUREAU OF FIELD WORK AND SURVEYS
MINING CLAIM

UNITED STATES

DEPARTMENT OF THE INTERIOR

GEOLOGICAL SURVEY

WASHINGTON, D. C.

[Faint, illegible text, likely bleed-through from the reverse side of the page]

[Handwritten signature]

AMENDED SURVEY NO. 4374

1

CHANGES

PEGGIE LODE

Expenditures

- No. 1 Discovery cut of the Peggie lode is on the lode line S. 52° 18' E., 450 ft. from the center of line 3-4; a cut, 5 ft. wide, runs south 20 ft. to 10-foot face.
Value, \$200.
- No. 2 An open cut and adit, the mouth of which bears S. 23° 48' E., 485 ft. from Cor. No. 4 of the Peggie lode, totals 40 ft. in length; cut runs S. 20° W., 20 ft. to 14-foot face (5 ft. wide); adit runs S. 10° W., 20 ft. to breast, 5 x 7 ft. in cross-section.
Value of open cut and adit, \$600.
- No. 3 An open cut, the mouth of which bears S. 12° 39' E., 432 ft. from Cor. No. 4 of the Peggie lode, 4 ft. wide; runs West 10 ft. to 7-foot face.
Value, \$75.
- No. 4 An open cut, the mouth of which bears S. 16° 10' E., 410 ft. from Cor. No. 4 of the Peggie lode; 5 ft. wide; runs West 20 ft. to 6-foot face in two steps.
Value, \$150.
- No. 5 An open cut, the mouth of which bears S. 28° 32' E., 318 ft. from Cor. No. 4 of the Peggie lode, 5 ft. wide; runs West 10 ft. to 8-foot face.
Value, \$100.
- No. 6 A shaft, the center of which bears S. 28° 22' E., 292 ft. from Cor. No. 4 of the Peggie lode, 4 x 6 ft. in size, 5 ft. deep.
Value, \$50.

Field Assistants
(None)

Robert Lenon
Mineral Surveyor

I, Lester S. Mann, Office Cadastral Engineer, Phoenix, Arizona, certify and approve the above amended field notes to Mineral Survey No. 4374, which have been made in accordance with the Amended Order for Mineral Survey dated February 1, 1960.

Lester S. Mann
Lester S. Mann
Office Cadastral Engineer

AMENDED SURVEY NO. 1271

Chains	PROSPECT LOGS	Comments
	<p>Extend surface</p> <p>No. 1. Discovery cut of the Peattie lode is on the face line S. 52° 15' E. 100 ft. from the center of line 3-11; a cut 5 ft. wide runs south 20 ft. to 10-foot level. Value, \$200.</p> <p>No. 2. An open cut and shaft, the mouth of which bears S. 33° 15' E. 100 ft. from the center of the Peattie lode, contains 10 ft. of lead ore. The shaft runs S. 10° W. 20 ft. to 10-foot face (5 ft. wide); shaft runs S. 10° W. 20 ft. to 10-foot face. In cross-section, 20 ft. by 7 ft. in cross-section. Value of cut and shaft, \$500.</p> <p>No. 3. An open cut, the mouth of which bears S. 15° 30' E. 100 ft. from the center of the Peattie lode, 4 ft. wide; runs west 10 ft. to 10-foot face. Value, \$75.</p> <p>No. 4. An open cut, the mouth of which bears S. 15° 10' E. 110 ft. from the center of the Peattie lode; 5 ft. wide; runs west 20 ft. to 10-foot face in two steps. Value, \$15.</p> <p>No. 5. An open cut, the mouth of which bears S. 24° 30' E. 318 ft. from the center of the Peattie lode, 5 ft. wide; runs west 10 ft. to 10-foot face. Value, \$100.</p> <p>No. 6. A shaft, the center of which bears S. 25° 30' E. 232 ft. from the center of the Peattie lode, 4 x 6 ft. in size, 17 ft. deep. Value, \$20.</p>	
	<p>Field Assistant (None)</p> <p>Robert Larson Principal Surveyor</p>	
	<p>Lester S. Mann Chief Cadastral Engineer</p>	
	<p>Lester S. Mann, Office Cadastral Engineer, Phoenix, Arizona, certifies and approves the above amended field notes to Mineral Survey No. 1271, which have been made in accordance with the amended order for Mineral Survey dated February 1, 1900.</p>	

UNITED STATES
DEPARTMENT OF THE INTERIOR
BUREAU OF LAND MANAGEMENT

REPORT OF EXPENDITURES UPON MINING CLAIM,
FILED BY MINERAL SURVEYOR
AFTER RETURN OF SURVEY

I, ROBERT LENON, Mineral Surveyor,
do certify that in pursuance of instructions received from Office Cadastral Engineer, Phoenix, Arizona,
dated February 1, 1960, I have made a personal and thorough examination upon the premises,
to ascertain the value of the labor expended and improvements made by claimants or their
grantors upon the mining claim of Albert B. & Ursula CAPT

known as the PEGGIE lode
situate in HARTFORD
mining district, COCHISE
County, ARIZONA, in Section 5, Township
No. 24 South, Range No. 21 East, surveyed by me
June, 1960, and designated as Survey No. 4374 Amended;

that the value of the labor so expended and improvements so made are as fully stated in my report of said exam-
ination, hereto attached; that the character, extent, location, and itemized value of said improvements are speci-
fied therein with particularity and full detail; and that no portion of said labor or improvements, so credited
to this claim has been included in the estimate of expenditures upon any other claim.

I certify that the statements made by me in this report are true, complete, and correct to the best of my
knowledge and belief, and are made in good faith.¹

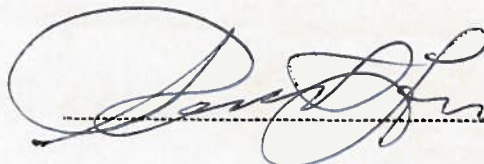
Mineral Surveyor.

¹ Title 18, U. S. C., sec. 1001, makes it a crime for any person knowingly and willfully to make to any department or agency of the
United States any false, fictitious or fraudulent statements or representations as to any matter within its jurisdiction.

UNITED STATES
DEPARTMENT OF THE INTERIOR
BUREAU OF LAND MANAGEMENT

REPORT OF EXPENDITURES UPON MINING CLAIM
FILED BY MINERAL SURVEYOR
AFTER RETURN OF SURVEY

MINERAL SURVEYOR
Name of Mineral Surveyor
Address of Mineral Surveyor
Date of Survey

NAME OF CLAIM
LOCATION OF CLAIM

County of _____ State of _____
The following is a list of the expenditures made by the mineral surveyor upon the mining claim during the survey, and the amount of each item:
1. _____
2. _____
3. _____
4. _____
5. _____
6. _____
7. _____
8. _____
9. _____
10. _____
Total _____

Witness my hand and seal at _____ this _____ day of _____ 19____.



UNITED STATES
DEPARTMENT OF THE INTERIOR
BUREAU OF LAND MANAGEMENT
SURVEY OFFICE

REPORT OF EXPENDITURES AFTER RETURN OF SURVEY OF MINING CLAIM

June 7, 1960

(Date)

I, Lester S. Mann Office
/Cadastral Engineer at Phoenix, Arizona

do hereby certify that five hundred dollars' (\$500) worth of labor has been expended or improvements made by claimant or their grantors upon the mining claim of Albert Basil Capt. and Ursula Capt

known as the Peggie lode

situate in Hartford mining district,

Cochise County, Arizona

in Section 5, Township No. 24 South, Range No. 21 East; that said

improvements consist of expanded work to the original cuts and shaft and corrects the drafting error for the location of the discovery cut.

and that no portion of said labor or improvements has been included in the estimate of expenditures upon any other claim. A copy of the report of Robert Lenon,
Mineral Surveyor, dated June 6, 1960, is hereto attached.

Lester S. Mann
Lester S. Mann Cadastral Engineer.

