

Form 4-683
(January 1963)

UNITED STATES
DEPARTMENT OF THE INTERIOR
BUREAU OF LAND MANAGEMENT

Mineral Survey number
4650

State
ARIZONA

Land District
ARIZONA

FIELD NOTES

Of the Survey of the Mining Claim of *(name and address of Claimant)*

ORVILLE MARION PENDERGRASS
209 N. ELDEN
FLAGSTAFF ARIZONA 86001

Known as the, *(name of group, if any)*

CONSISTING OF LOCATIONS NAMED AND LOCATED AS FOLLOWS

NAME OF LOCATION	DATE	
	LOCATED	AMENDED
COLLINS No.1	5/16/38	9/27/1966
COLLINS No.2	5/16/38	9/27/1966

Mining district WHITE MESA		County COCONINO	
Section 13 & 24	Township T.23 N.	Range R.7 E.	Meridian G. & S.R.
Survey commenced OCT.16, 1966		Survey completed NOV.5, 1966	
		Name of Mineral Surveyor J.WILLIAM WAARA	
		Survey under order dated Oct 3, 1966	

F E E T

This survey was made with a Lietz Light Mountain transit No. 9303, with horizontal limb five inches in diameter, having two double opposite verniers reading to thirty seconds of arc, and full vertical circle five inches in diameter, having two double opposite verniers reading to one minute of arc; the eyepiece is equipped to receive a prismatic eyepiece with colored shade for direct observations upon the sun. The instrument was in good condition at the time of the survey and all adjustments were in good order.

All azimuths in this record were determined by the method of deflection angles referred to the meridian established by direct observations on the sun.

November 5, 1966 at a point N.66°-46' E. 357.4 feet from cor. No.4 of the COLLINS No.2 placer of this survey, Latitude 35°-22'N., Longitude 111°-35'W.; turning from the reference northwest, clockwise to the sun in the southwest.

True bearing of the reference point is S.66°-46'W.

The lines were measured with a 1/8 in. steel tape 500 feet long, graduated every foot with both end feet in 1/10th. foot graduations. This tape was compared with a standard 100 foot steel tape at the time of beginning the survey, and found correct.

All lines and connections of this survey were run by direct methods.

The Magnetic declination observed at each corner of this survey gave a uniform value of 14°-30'E.

SURVEY NO. 4650

COLLINS No.1 PLACER

At Cor.No.1 of the COLLINS No.1 placer, identical with Cor. No.4 of the COLLINS No.2 placer of this survey.

On line 1-2 Sur.No.4652 KINCANON NO.1 placer.

Set an iron pipe 36 inches long, 1/2 in. diameter, 18 inches into the ground, surrounded by a substantial mound of stone, fitted with a three inch floor flange with copper plate bolted thereon, marked C 1-1, C 2-4 U S M S 4650 with its center for exact corner point; from which

The point for the northwest cor. of Sec. 19 T.23 N.R.8 E. of the Gila and Salt River Meridian bears N.87°-18'E. 1867.2 feet distant, reestablished from bearing trees.

FEET		
	<p>No other local bearing object or bearing trees available..</p> <p>Thence S.0°-56'E.</p>	
110.0	Cross mine road, bears northeast to southwest.	
1320.0	<p>Cor. No.2, identical with Cor. No.3 of the COLLINS No.2 placer of this survey.</p> <p>Set a 1/2 inch iron pipe 36 inches long, 18 inches into the ground, surrounded by a substantial mound of stone, fitted with a three inch floor flange with copper plate bolted thereon, marked C 1-2, C 2-3 U S M S 4650 with its center for exact corner point; from which</p> <p>No local bearing objects or bearing trees available.</p> <p>Thence S.66°-46'W.</p>	
713.3	<p>Cor. No.3</p> <p>Set a 1/2 inch iron pipe 36 inches long, 18 inches into the ground, surrounded by a substantial mound of stone, fitted with a three inch floor flange with copper plate bolted thereon, marked C 1-3-U S M S 4650 with its center for exact corner point; from which</p> <p>No local bearing objects or bearing trees available.</p> <p>Thence N.0° -56'W.</p>	
1120.0	Enter plantsite area of operations.	
1320.0	<p>Cor.No.4</p> <p>On line 1-2 Sur.No. 4652 KINCANON NO.1 placer.</p> <p>This corner falls within the plant site area of operations where a monument cannot be established.</p> <p>Thence N.66°-46'E.</p>	
8.7	<p>Point selected for witness Cor.No.4</p> <p>Set a 1/2 inch iron pipe 36 inches long, 18 inches into the ground, surrounded by a substantial mound of stone, fitted with a three inch floor flange with copper plate bolted thereon, marked W C C 1-4 U S M S 4650 with its center for exact corner point, from which</p> <p>The point for Cor. No. 2 Sur.No.4652 KINCANON NO.1 placer claim, bears S.66°-46'W. 258.0 feet distant.</p> <p>No other local bearing objects or trees available.</p>	

FEET 713.3	<p>Cor. No.1, and the place of beginning.</p> <hr/> <p style="text-align: center;">COLLINS No.2 PLACER</p> <p>At Cor. No.1 of the COLLINS No.2 placer.</p> <p>Set a 1/2 inch iron pipe 36 inches long, 18 inches into the ground, surrounded by a substantial mound of stone, fitted with a three inch floor flange with copper plate bolted thereon, marked C 2-1-U S M S 4650 with its center for exact corner point; from which</p> <p style="padding-left: 40px;">The northwest cor. of Section 19, T. 23 N.R.8 E., G. & S.R. meridian bears S.80°-57'E. 1235.2 feet distant; previously described.</p> <p style="padding-left: 40px;">No other local bearing objects or bearing trees available.</p> <p style="text-align: center;">Thence S. 0°-57'E.</p>
1319.9	<p>Cor. No. 2</p> <p>Set a 1/2 inch iron pipe 36 inches long, 18 inches into the ground, surrounded by a substantial mound of stone, fitted with a three inch floor flange with copper plate bolted thereon, marked C 2-2 U S M S 4650 with its center for exact corner point; from which</p> <p style="padding-left: 40px;">No local bearing objects or bearing trees available.</p> <p style="text-align: center;">Thence S.66°-46'W.</p>
713.3	<p>Cor. No. 3, identical with Cor. No.2 of the COLLINS No.1 placer of this survey.</p> <p style="text-align: center;">Thence N.0°-56'W.</p>
1210.0	<p>Cross mine road, bears northeast to southwest.</p>
1320.0	<p>Cor. No.4, identical Cor. No.1 of the COLLINS No.1 placer of this survey.</p> <p>On line 1-2 Sur. No. 4652 KINCANON NO.1 placer.</p> <p style="text-align: center;">Thence N.66°-46'E.</p>
257.4	<p>Cross mine road, bears northeast to southwest.</p>
357.4	<p>Cor. No.1 Sur.No. 4652 KINCANON NO.1. placer.</p>
713.1	<p>Cor. No.1, and the place of beginning.</p> <hr/> <p style="text-align: center;">SURVEY NO. 4650</p>

FEET	AREAS
	<p style="text-align: right;">Acres</p> <p>Total area, COLLINS No.1 placer - 19.999</p>
	<p>Total area, COLLINS No.2 placer 19.996</p>
	<p style="text-align: center;">LOCATION</p>
	<p>This survey is located in the S.W.1/4 of S.E.1/4 and in Lot 4 Sec. 13, and in the N.W.ofN.E. 1/4 and, in Lot 1 Sec.24 T. 23 N.R.7 E.G & S.R.Meridian, Arizona.</p>
	<p>The survey of the COLLINS No.1 and COLLINS No.2 placer claims is identical with the respective amended location as marked on the ground.</p>
	<p style="text-align: center;">EXPENDITURES</p>
	<p>The improvements and the value of the labor and improvements made upon or for the benefit of each of the placer locations embraced in said mining claims by the claimant or his grantors are as follows;</p>
No.1	<p>The discovery and development open pit of the COLLINS No.1 placer, the center of which is the discovery point. The boundaries of the pit are described as follows:</p> <p>Beginning at the southeast corner of the pit, thence N.89°-45'W. 190 ft.; thence N.74°-00'W. 70 ft.; thence N.38°-45'W. 310 ft.; thence N.53°-30'E. 170 ft.; thence S.76°-30'E. 235 ft.; thence N.71°-00'E. 100 ft.; thence S.14°-15'W. 100 ft.; thence S.4°-15'E. 245 ft. to the place of beginning; from which Cor. No.2 of the COLLINS No.1 placer bears S.7°-30'E. 616 feet distant.</p> <p>The area of this pit is approximately 110,000 sq.ft. and has an approximate average depth of 15 ft. or 71,000 cubic yards of excavation.</p> <p style="text-align: right;">Value \$35,500.00</p>
No.1	<p>The discovery and development open pit of the COLLINS No.2 placer, the center of which is the discovery. The boundaries of the pit are described as follows;</p> <p>Beginning at the northeast corner of the pit, thence S.15°-15'E. 185 ft.; thence S.43°-30'W. 45 ft.; thence S.1°E.; 80 ft.; thence S.36°-30'W. 85 ft.; thence S.58°W. 75 ft.; thence S.77°W. 80.0 ft.; thence N.59°-45'W. 55 ft.; thence N.17°-45'E. 75 ft.; thence N.18°-30'W. 150 ft.; thence N.42°-30'E. 85 ft.; thence N.59°-15'E. 220 ft. to the place of beginning, from which Cor. No.1 of the COLLINS No.2 placer bears N.37°-45'E. 615 feet.</p>

FEET

The area of this pit is approximately 100,000 square feet and has an approximate average depth of 15 ft. or 55,000 cu. yds. of excavation.

Value \$27,500.00

OTHER CORNER DESCRIPTIONS

Survey No. 4652; Corners of this survey are 1/2 inch iron pipe 36 inches long, set 18 inches into the ground, surrounded by a substantial mound of stone, fitted with a three inch floor flange with copper plate bolted thereon, and marked with name, number of corner and survey.

A tie could not be made to other than the known and properly identified Northwest Corner Section 19, T.23 N.R.8 E. being the nearest public survey corner. The stone is missing, however the four recorded bearings were; standing three trees, fallen one tree, scribed as of record. The point for South 1/4 cor. Sec. 13, as determined by projection of the calls in the official record, falls in the plant site area of operations and is obliterated.

REPORT OF MINERAL SURVEYOR
SPECIAL SURVEY DATA

This report covers the COLLINS No.1 placer and the COLLINS No.2 placer mining claims as observed in the field examination by me.

The claim is for residual volcanic deposit containing a pumice possessing unique chemical and physical properties different from the average pumice. It has been determined that this pumice, without calcining, is a true and effective pozzolanic material, and that its chemical and physical properties render it especially adaptable for use as a true and effective pozzolan, valuable for building, industrial and manufacturing purposes. This type of material was used in enormous quantities for mixing with concrete in the recent construction of the Glenn Canyon Dam by the U.S. Reclamation Service. The material is also used in lesser projects such as construction of the U.S. Arsenal at Belmont Arizona, presently on heavy concrete interchange and bridge construction on U.S. Military highway nearby. In addition it is used as sand for local consumption in the construction work, it being other than gold placer and still claimed under the PLACER MINING LAWS.

The valuable deposits consist principally of sand dune shaped bedding planes of fragmented material, consisting of a high percentage of sand and larger screen passing material. The presence of deeper bedding planes has not been explored, however the known plane is unlimited in extent.

FEET

There are no water holes, springs, or observable water courses; ground being extremely of pourous nature. The claim is in a cut-over timbered area, remaining trees being small size and larger seed type left over trees. The vegetation is sparce mountain grasses of 7500 foot elevation type. The claim is all placer ground, there being no known lodes. The claim is situated about one mile west of U.S.Highway No.89 and the adit road runs up a slightly rising plain, making the area extremely and advantageously accessible from the railroad, highways and cities. The construction of the proposed Marble Canyon Dam will open an immense market for this material.

J. William Waara
 J. William Waara
 U.S. Mineral Surveyor

Field assistants; Gene Garver
 E.G. Chapman

UNITED STATES
DEPARTMENT OF THE INTERIOR
BUREAU OF LAND MANAGEMENT

CERTIFICATE OF SURVEYOR

Name of Mineral Surveyor J. WILLIAM WAARA	Date NOV. 23, 1966
---	------------------------------

I HEREBY CERTIFY That in pursuance of an order received from the **BUREAU OF LAND MANAGEMENT** at **PHOENIX ARIZONA** dated **OCT. 3**, 19**66**, I have carefully executed the survey of the claim of **ORVILLE MARION PENDERGRASS** known as the (lode, placer, or mill site) **COLLINS No.1 and COLLINS No.2 placers**, situated in **Sections 13 and 24**, **Coconino National Forest**, Township **23 N.**, Range **7 E.**, **Gila and Salt River** Meridian, in the State of **ARIZONA**

This survey, designated as number **4650**, has been executed by me and under my direction and has been made in strict conformity with said order, the Manual of Instructions for the Survey of Public Lands of the United States, and in the specific manner described in the foregoing field notes.

I FURTHER CERTIFY That the labor expended and improvements made upon and for the benefit of the (lode or placer) **COLLINS No.1 and COLLINS No.2 placer** location(s) embraced in the said mining claim by claimant(s) or **his** grantors are fully stated in my report. The character, extent, location, and itemized value are specified in full detail. No portion of, or interest in, said labor and improvements so credited to this claim has been included in the estimate of expenditures upon any other claim.

Prescott Arizona (Location)	<i>J. William Waara</i> (Signature of Mineral Surveyor)
---------------------------------------	--

CERTIFICATE OF APPROVAL

Bureau of Land Management Office Arizona State Office Location Phoenix, Arizona Date February 28, 1968

The foregoing field notes of mineral survey number **4650**, in **Sections 13 and 24**, Township **23 N.**, Range **7 E.**, **Gila and Salt River** Meridian, in the State of **Arizona**, executed by **J. William Waara**, Mineral Surveyor, under order dated **October 3**, 19**66**, having been critically examined and the necessary corrections made prior to their certification by the surveyor, the field notes and the survey therein described are hereby approved.

<i>Fred J. Weiner</i> (Authorized Signature) Fred J. Weiner	State Director (Title)
--	----------------------------------

CERTIFICATE OF TRANSCRIPT

I CERTIFY That the foregoing transcript of field notes of the above described mineral survey number is a true copy of the original field notes.

(Authorized Signature)	(Title)
------------------------	---------

Title 18, U. S. C. section 1001, makes it a crime for any person knowingly and willfully to make to any department or agency of the United States any false, fictitious, or fraudulent statements or representations as to any matter within its jurisdiction.

Form 3400-9
(August 1967)
(formerly 4-688)

UNITED STATES
DEPARTMENT OF THE INTERIOR
BUREAU OF LAND MANAGEMENT

Land Office & Serial Number

84

CERTIFICATE OF EXPENDITURES, IMPROVEMENTS,
AND MINERAL SURVEY

Date

Name of Claimant

Mineral Survey Number

Orville Karlon Pendergrass

4650

I HEREBY CERTIFY That the record of the above-described mineral survey furnishes such an accurate description of all claims embraced within the survey that it will, if incorporated into a patent, serve fully to identify the premises and that references are made in the survey to natural objects or permanent monuments so that the location of the claims will be perpetuated and fixed.

I FURTHER CERTIFY That the record reveals not less than \$500 worth of labor has been expended for improvements upon or for the benefit of each of the lode claims embraced within the survey and that the improvements were made by the claimant or his grantors.

Date

Authorized Signature

March 7, 1968

DANIEL E. SAISBERY
Acting Chief, Division of Engineering

(See reverse)

AMENDED

9

Notice of Mining Location

**PLACER
MINE CLAIM**

TO ALL WHOM IT MAY CONCERN:

This Mining Claim, the name of which is the COLLINS No. 1 Mining Claim, situate on lands belonging to the United States of America, and in which there are valuable mineral deposits, was entered upon and located for the purpose of exploration and purchase by Orville Marion Pendergrass a citizen of the United States.

(Locator must insert either "a citizen of the United States" or "who has declared his intention of becoming a citizen of the United States.")

the undersigned, on the 27th day of Sept., 1966.
The length of this claim is 1320 feet,
and I claim 720 feet,
in a southerly direction and
600 feet in a northerly direction from
the center of the discovery ~~point~~ ^{mon.} at which this notice is posted, lengthwise of the claim, to-
gether with 660 feet in width of the surface grounds. ~~The course of the~~
~~boundaries of said claim.~~ The general course of the ~~boundaries of said~~ premises is from the
north to the south.

The claim is situated and located in the WHITE MESA Mining District, in
Cocconino County, in the State of Arizona, about one
~~mile~~ mile westerly from U.S. Highway No. 89 at Shultz Pass summit;
in section 13 and 24, ~~XXXXXX~~ T. 23 N.R. 7 E.

The surface boundaries of the claim are marked upon the ground as follows: Beginning
at on northerly boundary at a point in a

~~northerly~~ northerly direction 600 feet from
the discovery ~~point~~ ^{mon.} (at which this notice is posted), being in the ~~southerly~~
northerly end line of said claim; thence N.E. 74 feet to a mon.
being the N.E. corner of said claim; thence
southerly 1320 feet to a mon. being at the
S.E. corner of said claim; thence Southwesterly 713.5 feet
~~mon.~~ mon. to a mon. being at the
S.W. corner of said claim; thence northerly 1320 feet
to a mon. at the N.W. corner of said claim;
thence 639.5 (N.E.) feet to the place of beginning.

All done under the provisions of the laws of the United States, and the State of Arizona.

This is an amended Location Notice of the Earl Collins Placer Mining and Sand Claim

No. 1 ~~claim~~ located by Earl E. Collins
on the 11th day of
June, 1938, and recorded in Book 13 of Record of Mines, at
page 463, in the office of the County Recorder of the aforesaid County of Cocconino
to which reference is hereby made, and this amended Location Notice is made and posted to
correct errors in the description in the said original Location Notice

Dated and posted on the grounds this 27 day of Sept., 1966.

Witness

Robert W. Burns.

Orville Marion Pendergrass

BUCKET 261 PAGE 578

placer

STATE OF ARIZONA,
County of Coconino ss. **8119**

10

I, Edna Mae Thornton County Recorder in and for
the County and state aforesaid, do hereby certify that the within instrument was filed for
record at 3:00 o'clock P. M., on this 28th. day of September, 1966., and duly
recorded in Book No. 261 of Coconino County,
Arizona at pages 578-579 Request of Orville Marion Pendergrass

WITNESS my hand and official seal the day and year first above written.

Edna Mae Thornton
County Recorder.

Norothy J. Mortenson
Deputy

AMENDED
Notice of Location
LODE CLAIM

Dated , 19 ,
STATE OF ARIZONA
County of ss.
I hereby certify that the within in-
strument was filed and recorded at
request of
Book
In Docket
on page
Witness my hand and official seal
the day and year aforesaid.
County Recorder.
By Deputy Recorder.

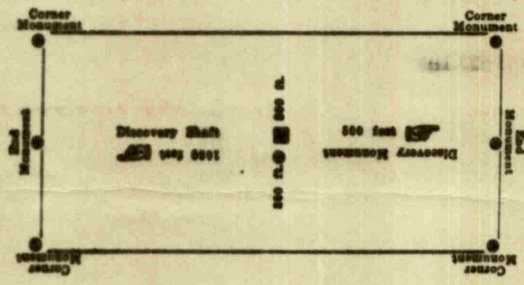

This diagram is to give locater a general idea of plan of location under the new law. The Discovery Shaft can be in the center of claim or any distance from either end desired. In the diagram it is placed 500 feet from one end, and 1000 feet from the other. Commence description of claim at a center end monument, giving its distance and direction from center of Discovery Shaft; thence bound the claim in either direction. In description be careful to state locality of object with reference to some natural object, or permanent monument, as will identify the claim.

AMENDED

Notice of Mining Location

11

PLACER
CLAIM

TO ALL WHOM IT MAY CONCERN:

This Mining Claim, the name of which is the COLLINS No. 2 Mining Claim, situate on lands belonging to the United States of America, and in which there are valuable mineral deposits, was entered upon and located for the purpose of exploration and purchase by Orville Marion Pendergrass, a citizen of the United States.

(Locator must insert either "a citizen of the United States" or "who has declared his intention of becoming a citizen of the United States.")

the undersigned, on the 27 day of Sept., 1966.

The length of this claim is 1320 feet, and 1 claim 880 feet,

in a southerly direction and 440 feet in a northerly direction from

the center of the discovery mon. at which this notice is posted, lengthwise of the claim, together with 660 feet in width of the surface grounds, ~~the general course of the~~

~~the general course of the~~ The general course of the ~~premises~~ premises is from the northerly to the southerly.

The claim is situated and located in the White Mesa Mining District, in Coconino County, in the State of Arizona, about one mile in a westerly direction from U.S. Highway No. 89 at Shultz Pass Summit, in Sec. 13 and 24 T. 23 N. R. 7 E.

The surface boundaries of the claim are marked upon the ground as follows: Beginning on northerly boundary at a point in a

~~northerly~~ northerly direction 440 feet from

the discovery mon. (at which this notice is posted), being in the ~~northerly~~ northerly

northerly end line of said claim; thence northeasterly 200 feet to a mon.

corner of said claim; thence N.E. being the southerly 1320

feet to a mon. corner of said claim; thence southwesterly 713.5 feet

~~to a~~ mon. being at the

S.W. corner of said claim; thence NORTHERLY 1320 feet

to a mon. at the N.W. corner of said claim;

thence 513.5 (N.E.) feet to the place of beginning.

All done under the provisions of the laws of the United States, and the State of Arizona.

This is an amended Location Notice of the Earl Collins Placer Mining and Sand Claim No. 2 ~~located by Earl E. Collins~~ located by Earl E. Collins

on the 11th day of

June, 1938, and recorded in Book 13 of Record of Mines, at

page 464, in the office of the County Recorder of the aforesaid County of Coconino

to which reference is hereby made, and this amended Location Notice is made and posted to

correct errors in the description in the said original Location Notice

Dated and posted on the grounds this 27 day of Sept., 1966.

Witness Robert W. Burns Orville Marion Pendergrass

FORM NO. 261 REV. 5-50

STATE OF ARIZONA,
County of Cocconino ss.

8120

I, Edna Mae Thornton County Recorder in and for
the County and state aforesaid, do hereby certify that the within instrument was filed for
record at 3:00 o'clock P. M., on this 28th day of September, 1966, and duly
recorded in ^{DKT} Book No. 261 of Cocconino County,
Arizona at pages 580-581 Request of Orville Marion Pendergrass

12

WITNESS my hand and official seal the day and year first above written.

Edna Mae Thornton County Recorder.

Dorothy J. Montanus
Deputy

AMENDED
Notice of Location
LODE CLAIM

Dated , 19 ,
STATE OF ARIZONA
County of ss.
I hereby certify that the within in-
strument was filed and recorded at
request of
Book
In Docket
on page
Witness my hand and official seal
the day and year aforesaid.
County Recorder.
By Deputy Recorder.

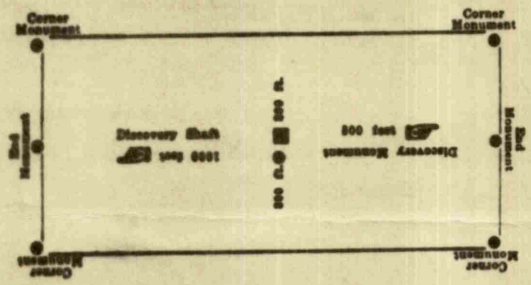

This diagram is to give locator a general idea of plan of location under the new law. The Discovery Shaft can be in the center of claim or any distance from either end desired. In the diagram it is placed 600 feet from one end, and 1000 feet from the other. Commence description of claim at a corner monument, giving of Discovery Shaft; thence bound the claim in either direction. In description be careful to state locality of claim with reference to some natural object, or permanent monument, as will identify the claim.

#911

NOTICE OF MINING LOCATION
PLACER CLAIM.

13
13

TO WHOM IT MAY CONCERN:

This Placer Mining Claim, the name of which is The Earl Collins Placer Mining/ and Sand Claim, No. 1, situate on lands belonging to the United States of America, and being a form of valuable mineral deposit other than in veins or lodes of quartz or other rock in place, was entered upon and located for the purposes of exploration and purchase by me E. E. Collins, a citizen of the United States and a resident of the State of Arizona, on the 16th., day of May, 1938.

I claim eighteen and sixty five one hundredths (18.65) acres thereof and have marked the same on the ground as follows:

Beginning at Corner No. 1, from which the quarter corner between sections 13 and 24, T. 23 N., R. 7 E., G. & S. R. B. & M. Arizona bears North 70 degrees East, 283 feet; thence South 64 degrees 44 minutes east, 1548.2 feet to corner No. 2; thence north 6 degrees 07 minutes west, 543.0 feet to corner No. 3; thence north 10 degrees 12 minutes west, 756.7 feet to corner No. 4; thence south 67 degrees 42 minutes west 1336.0 feet to corner No. 1, the place of beginning and containing 18.65 acres more or less.

All done under the provisions of the Revised Statutes of the United States and the laws of the State of Arizona.

Dated and posted on the grounds this 11 day of June, 1938.

Earl E. Collins

Recorded at the request of F. M. Gold
June 13th, A. D. 1938 at 4:00 o'clock P. M.
Marie Gregg, County Recorder

NOTICE OF MINING LOCATION
PLACER CLAIM.14
14

TO WHOM IT MAY CONCERN:

This Placer Mining Claim, the name of which is the Earl Collins Placer Mining and Sand Claim, No. 2, situate on lands belonging to the United States of America, and being a form of valuable mineral deposit other than in veins or lodes or quartz or other rock in place, was entered upon and located for the purposes of exploration and purchase by me E. E. Collins, a citizen of the United States and a resident of the State of Arizona, on the 16th., day of May, 1938.

I claim eighteen and sixty seven one hundredths, (18.67) acres thereof and have marked the same on the ground as follows:

Beginning at corner No. 1, from which the quarter corner between sections 13 and 24, T. 23 N., R. 7 E., G. & S. R. E. & M. Arizona, bears north 70 degrees east, 283 feet; thence south 10 degrees west, 450 feet to corner No. 2; thence south 50 degrees east, 490 feet to corner No. 3; thence south 56 degrees east, 500 feet to corner No. 4; thence north 60 degrees east, 800 feet to corner No. 5; thence north 64 degrees 44 minutes west, 1548.2 feet to corner No. 1, the place of beginning and containing 18.67 acres more or less.

All done under the provisions of the Revised Statutes of the United States and the laws of the State of Arizona.

Dated and posted on the ground this 11 day of June, 1938.

Earl E. Collins

Recorded at the request of F. M. Gold
June 13th, A. D. 1938 at 4:00 o'clock P. M.
Marie Gregg, County Recorder

UNITED STATES DEPARTMENT OF THE INTERIOR
BUREAU OF LAND MANAGEMENT
ARIZONA STATE OFFICE

NOTICE OF CANCELLATION OF MINERAL SURVEY

The COLLINS No. 1, and COLLINS No. 2 placers, Mineral Survey No. 4650, located in sections 13 and 24, Township 23 North, Range 7 East, Gila and Salt River Meridian, Arizona, are hereby cancelled.

These claims have not been filed with the Arizona State Office, Bureau of Land Management, in accordance with Section 314, 90 STAT. 2769 (43 U.S.C. 1744).

This cancellation was necessitated to clear the record.

The Mineral Survey Plat shall be noted as follows:

“COLLINS No. 1, and COLLINS No. 2 placers, M. S. 4650, were cancelled July 11, 2017, by memo 9605 (956), which is now a part of the original field notes.

July 11, 2017

Date

Chief Cadastral Surveyor of Arizona