

Platted 29th 1888

Approved by Commissioner

July 19th 1890

No - 11 -

Extensions & Subdivisions
of Fractional

~~4-671~~

FIELD NOTES

~~GENERAL LAND OFFICE.~~

T 3 N R 3 E.

Andrew Barry.

Contract No 9.

Dec. 1st 1888.

No - 11 -

11

Township No. 3 North 37th 100

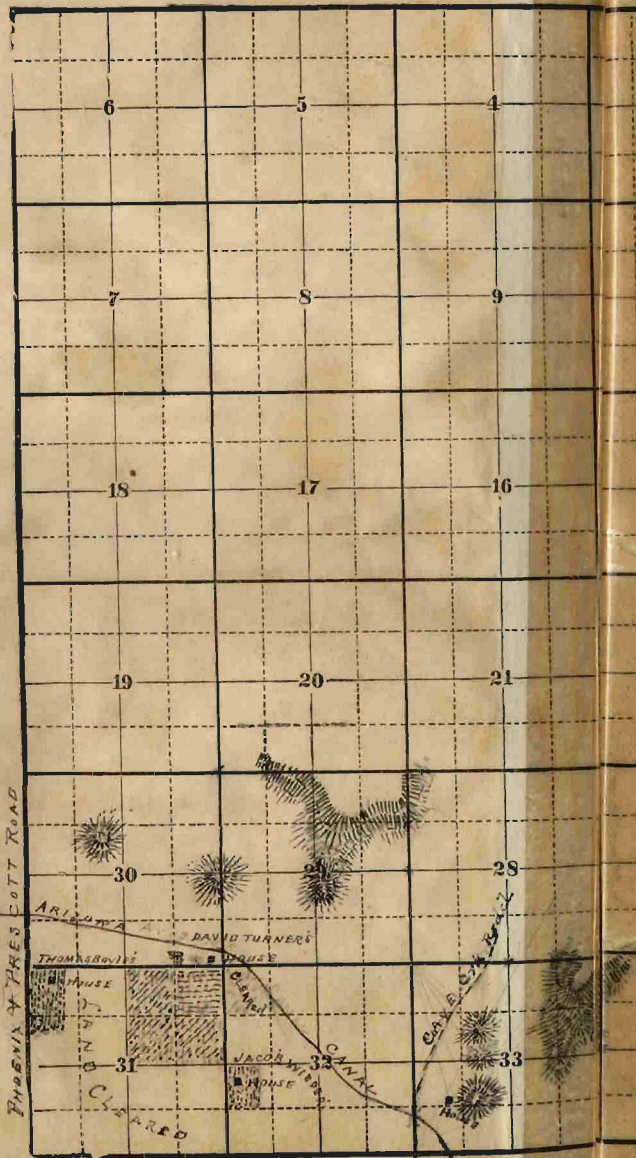

PHOENIX & FRES COTT ROAD

THOMAS BOWEN'S HOUSE
J. W. BOWEN'S HOUSE
CANNON

DAVID TURNER'S HOUSE
JACOB WILSON'S HOUSE

C.A. B. ST. ROAD

Range No. 36 G + S R B and Mer.

3	2	1
10	11	12
15	14	13
22	23	21
27	26	25
34	35	36

Tract Meridian

Scale 60 chains to an inch



1A

Preliminary Oaths of Assistants.

We George H Herold
 and Martin C Monry
 do solemnly swear that we will well and faithfully execute
 the duties of Chain Carriers; that we will level the chain over
 even and uneven ground, and plumb the tally pins, either by
 sticking or dropping the same; that we will report the true dis-
 tance to all notable objects, and the true length of all lines that
 we assist in measuring, to the best of our skill and ability and
 in accordance with instructions given us in the survey of the
portions of T. 3 N R 3 E and
T 2 N R 4 E

of the principal base and meridian in the Territory of Arizona.

George H. Herold Chairman.

Martin C Monry Chairman.

Subscribed and sworn before me, this 9

day of January 1889.

Frank Bexter

Notary Public.

We Meredith Abbridge

I do solemnly swear that we will well and truly perform the
the duties of Assessor

in the establishment of corners and other duties according to
instructions given us, and to the best of ^{my} our skill and ability,
in the survey of the portions of T 3 N R 3 E
and T 2 N R 4 E

of the principal base and meridian in the Territory of Arizona.

Meredith Abbridge
Assessor

Subscribed and sworn to before me this 9
day of January 1889

Frank Baxter
Notary Public.

Field Notes
of the
Retracing of a part of the
Exterior lines of
Township 3 North Range 3 East
of the
Gila and Salt River Base and
Meridian
of the
Territory of Arizona
as Surveyed by
Andrew Barry
U.S. Deputy Surveyor
under his Contract No. 9
dated December 1st 1888

Survey Commenced January 10th 1889
Survey Completed January 11th 1889

Names and duties of Assistants

George H. Herrold Chairman
 Martyn C. Mowry Chairman
 Meredith Aldridge Axeman

✓ Index

✓ T. 3N R3E. West boundary Page 11

" " " 5

" " " 6

T 3N R 3E South boundary Page 7

" " " 8

" " " 9

" " " 10

See also index opposite page 10

✓ Exteriors T3N R.3E.

Retracing Exterior boundaries
T3N R3E

Chain Survey commenced January 10th
1889 with Transit by Knox and
Shain N. 1303

I begin at the Southwest corner
of the Township, the stake of which
is lost and the mound and pits
obliterated by reason of the corner
being in the center of the Phoenix
and Prescott Road. The corner
is marked by a stone, marked with
6 notches on the N and W sides, which
was placed in the corner before it
was entirely destroyed.

I run North on the West bound-
ary of the Township,
or 13742' E.

that being the was reported on

Exteriors T3N R3E Continued

Chains previous survey, Six miles without finding any corners within 3 chains distance of the places where corners should be.

I then return to the Southwest corner of the Township and run East

va. $13^{\circ}47' E$

as the va. reported on previous survey 3 miles without finding any corners at or within 3 chains of their respective places -

I return to the Southwest cor. of the Township marked by stone marked 6 notches on the Wand W sides and run North on West boundary of Township

va. $13^{\circ}42' E$

40.00 finding no corner I set a Malpais

Exteriors T3N R3E Continued

Chain Stone 14x8x8 ins 9 ins in the ground for the 1/40. Cor. bet. Secs 31 and 36 marked 1/4 S. on the W. side.

dug no pits as the cor. is in the centre of the Phoenix and Prescott road which bears N and S

80.00 finding no corner I set a Malpais Stone 14x6x6 ins 9 ins in the ground for cor. to Secs 25 30 31 and 36 marked 1 notch on the S. and 5 notches on the ^N E. edges.

dug no pits as the stone is in the centre of the Phoenix and Prescott road which bears N. and S. Land level. Soil 1st class. No timber.

North on West boundary of Township betw Secs. 25 and 30.

bal 13° 42' E.

Exteriors T3N R3E Continued

- Chains
21.50 intersect the Centro line of the Arizona Canal bears N. 80° W.
- 40.00 finding no corner I set Malpais Stone 12 x 4 x 4 ins 8 ins in the ground for $\frac{1}{4}$ S. Cor. bet. Sec. 25 and 30 marked $\frac{1}{4}$ S on W. side dug no pits as the corner is in the Centro of the Phoenix and Prescott road which bears N and S
- 80.00 finding no cor. I set Malpais stone 14 x 6 x 4 ins 9 ins in the ground for cor. to Sec. 19 24 25 & 30 marked 2 notches on the S and 4 notches on the W. Edges; dug pits 18 x 18 x 12 ins in ea. Sec. 5 $\frac{1}{2}$ ft. dist. and raised a mound of earth 2 ft high and 4 $\frac{1}{2}$ ft. base alongside in Phoenix and Prescott road bears N and S
Land level, Soil 1st class, no timber.

Exteriors. T3N R3E Continued

Chains I return to the Southwest cor. of the Township marked by a stone marked 6 notches on the N and W sides and run East on S. boundary of Sec 31

on $13^{\circ}47'$

and at the dist. reported on previous survey

38.69 finding no cor. I set a Granite Stone $15 \times 5 \times 5$ ins 10 ins in the ground for $\frac{1}{4}$ S. Cor. bet. Sec. 6 and 31 marked $\frac{1}{4}$ S. on the North Side, dug pits $18 \times 18 \times 12$ ins $5\frac{1}{2}$ ft. dist E and W. and raised mound of earth $1\frac{1}{2}$ ft high $3\frac{1}{2}$ ft base alongside

78.69 the dist reported on previous survey finding no cor. I set Sandstone $20 \times 8 \times 3$ ins 14 ins in the ground for cor. to Sec. 5 6 31 and 32

Exteriors T3NR3E Continued

Chains

marked & notches on ^{W.} S. and 5 notches on the East. edges, dug pits 18x18x12 ins. in each Sec. 5 1/2 ft. dist and raised mound of earth 2 ft high 4 1/2 ft base alongside

Land level. Soil 1st class, no timber.

East on S. boundary of Sec 32
 bearing 13° 47' E

40.00 finding no corner I set sandstone 14x6x3 ins 9 ins in the ground for 1/4 S. Cor. bet. Secs 5 and 32 marked 1/4 S on N. face; dug pits 18x18x12 ins East and W. of stone 5 1/2 ft. dist and raised mound of earth 1 1/2 ft high 3 1/2 ft base alongside.

80.00 finding no cor. I set ^{Sand} stone 14x8x3 ins 9 ins in the ground for cor. to Sec. 4 5 32 and 33 marked & notches

Exteriors T3N R3E Continued

Chains

on the ^NS and 4 notches on the E. edges;
 dug pits ~~18 x 18 x 12~~ ins in each Sec
 5 1/2 ft. dist. and raised a mound
 of earth 2 ft high 4 1/2 ft. base alongside
 Land level, Soil 1st class, no timber.

East on South boundary of Sec 33
 by 13° 47' E.

15.60 intersect centro line of Arizona Canal
 bears N. W.

44.00 finding no cor. I set sandstone 12 x
 9 x 9 ins 8 ins in the ground for
 1/4 S. Cor. bet Sec. 4 and 33 and
 marked 1/4 S on N face, dug pits
 18 x 18 x 12 in E and W of stone 5 1/2 ft.
 dist and raised mound of earth
 1 1/2 ft high 3 1/2 ft. base alongside

80.00 I set sandstone 13 x 5 x 3 ins 8 ins
 in the ground for cor. to Sec. 3 4

Exteriors T3 NR3 E Continued

Chains 33 and 34 marked & notches on the
~~W.~~ ³ and 3 notches on the E edges,
 dug pits 18x18x12 ins in each Dec.
 5 1/2 ft. dist and raised mounds of
 earth 2 ft high 4 1/2 ft base alongside
 Land level, soil, & class, no timber.

Andrew Barry
 U.S. Deputy Surveyor.

(4-674.)

Township 3 North R. 3 East.

6	5	4	3	2	1
7	8	9	10	11	12
18	17	16	15	14	13
19	20	21	22	23	24
24					
5 30	23 29	18 28	27	26	25
29	20	17			
4 31	19 32	15 33	14 34	35	36

(11921-10 M.)

6-389

Field Notes
of the Survey of the
Subdivisions
of
Fractional
Township 3 North Range 3 East
of the
Gila and Salt River Base and
Meridian
of the
Territory of Arizona
as surveyed by
Andrew Barry
U.S. Deputy Surveyor
Under his Contract No 9
Dated December 1st 1888

Survey Commenced January 12th 1889
Survey Completed January 15th 1889

Names and duties of Assistants

George A. Herrold	Chairman
Martin C. Mowry	Chairman
Meredith Aldridge	Assessors

T. 3 N. R. 3 E.

Chains

On the night of January 10th, 1889
I take an observation of the star
Polaris in accordance with the
instructions contained in the
Manual of Surveys and drive
pickets on the line so established.

Before commencing this survey
I test my instrument on the
line established January 10th and
find it correct and the va. to be
13°42' E

My compass will therefore run the
same line as the exterior boundary
and the chaining practically
agrees, having just run the same.

Survey commenced January
12th with a Transit by Kiper and
chain No 1303

I begin at the corner to Sec 4

T3N R3E Continued

Chains 34 33 and 34 on the South boundary of the Township which is marked by a sandstone $13 \times 5 \times 3$ ins marked $\frac{3}{4}$ E. notches on the $\frac{N}{4}$ and 3 notches on the E. edges with a pit in each sec. $18 \times 18 \times 12$ ins $5\frac{1}{2}$ ft dist and a mound of earth 2 ft high and $1\frac{1}{2}$ ft. base alongside and run North on East boundary of Sec. 33

Pa. $13^{\circ}42'$ E.

40.00 I set sandstone $13 \times 5 \times 3$ ins 8 ins in the ground for $\frac{1}{4}$ Sec. bet Sec 33 and 34 marked $\frac{1}{4}$ S on N. face; dug pits $18 \times 18 \times 12$ ins N and S of stone $5\frac{1}{2}$ ft dist and raised mound of earth $1\frac{1}{2}$ ft high $3\frac{1}{2}$ ft. base alongside. Abrupt mountain. Land very broken Soil 4th Class.

T3NR3E Continued

NO Timber

From the Corner to Sec. 14, 5, 32 and
33 on the South boundary of the
Township which is a sandstone
14x8x8 ins marked 7 notches on
the ~~N~~^N and 4 notches on the ~~N~~^S edges
with a pit 18x18x12 ins in each S.
5 1/2 ft dist and mound of earth
2 ft high 1 1/2 ft base alongside.
From which I find

S. point of Mountain bears	N 61° 30' E	57	Chas dist
Butte 40 ft. high	" N 45° E	23	" "
" 70 ft. "	" N 40° E	44	" "
" 80 ft. "	" N 34° 20' E	54	" "
House	" N 38° 30' E	23	" "

I run North bet Sec. 32 and 33
va. 13° 42' E.

T3N R3E Continued

- Chains
 17.00 intersect center line of the Arizona Canal
 bears N. W.
- 40.00 Set sandstone $15 \times 4 \times 4$ ins 10 ins
 in the ground for $\frac{1}{4}$ S. Cor bet Sec
 32 and 33 marked $\frac{1}{4}$ S. on N. face;
 dug pits $18 \times 18 \times 12$ N & S of Stone $5\frac{1}{2}$ ft.
 dist and raised a mound of earth
 $1\frac{1}{2}$ ft. high $3\frac{1}{2}$ ft. base alongside.
- 80.00 Set sandstone $20 \times 6 \times 4$ ins 14 ins in
 the ground for cor to Sec. 28 29 32
 and 33 marked 1 notch on the S.
 and 4 notches on the E. edges, dug
 pits $18 \times 18 \times 12$ ins in each Sec. $5\frac{1}{2}$ ft.
 dist. and raised mound of earth
 2 ft. high $4\frac{1}{2}$ ft. base alongside.
- | | |
|-------------------|--|
| House | bears S 13° E 63.50 chns dist |
| Butte 40 ft. high | " S 14° E 66 " " |
| Butte 70 ft. " | " S $31^{\circ} 30'$ E. 54.50 " " |
| Butte 80 ft. " | " S $39^{\circ} 30'$ E. 47 " " |

T3N R3E Continued

Chain S. point of Mountain bears. S43°E. 75.50 Chus dist
 Land Level Soil 3rd Class
 No Timber.

East on line bet. Sec. 28 and 33
 on 13°42' E.

34.50 intersect Cave Creek road bears S28°W.
 4000 Set Sandstone 14 x 7 x 3 ins 9 ins
 in the ground for $\frac{1}{4}$ S. cor bet Secs
 28 and 33 marked $\frac{1}{4}$ S on N face;
 dug pits 18 x 18 x 12 ins E and W of Stone
 $5\frac{1}{2}$ ft dist and raised mound of
 earth $1\frac{1}{2}$ ft. high $3\frac{1}{2}$ ft base alongside
 finding that at 20 chus E. I en-
 counter a high steep mountain
 abandon the line

Land broken Soil 3rd Class
 Timber Ironwood and Palo Verde

TBN R.3E Continued

Chains I return to Cor. Sec. 28, 29 32 and
33 and run North on line bet. Sec:
28 and 29

Val. $13^{\circ}42' E$.

40.00 Set Sand Stone $12 \times 4 \times 3$ ins 9 ins
in the ground for the $\frac{1}{4}$ S. Cor. bet Sec
28 and 29 marked $\frac{1}{4}$ S. on the N-
face; dug pits $18 \times 18 \times 12$ ins N and S
of stone $5\frac{1}{2}$ ft. dist and raised
mound of earth $1\frac{1}{2}$ ft high $3\frac{1}{2}$ ft.
base alongside.

At 20 chns N of this $\frac{1}{4}$ S. Cor.
I came to the base of a precipitous
mountain and abandoned the
the line.

Land rolling Soil 1st Class
No Timber

T3NR3E Continued

Chains From the cor. to Sect 56 31 and 32 which is marked by a sandstone $20 \times 8 \times 8$ ins marked & notches on the Δ and 5 notches on the \square , edges with pits in each Sect $5\frac{1}{2}$ ft. dist and mound of earth along side. I run North on line bet. Sect 31 and 32

20.00 S.W. Cor. of Alfalfa field S.E. Cor. bears E. 15 Chns.
34.10 Jacob Haders House bears Due E.
6 chns - dist.

40.00 Set Sandstone $18 \times 6 \times 3$ ins 12 ins in the ground for the $\frac{1}{4}$ S. Cor. bet. Sect 31 and 32 marked $\frac{1}{4}$ S. on the W. face; dug pits $18 \times 18 \times 12$ ins N. and S. of Stone $5\frac{1}{2}$ ft dist and raised mound of earth $1\frac{1}{2}$ ft high $3\frac{1}{2}$ ft. base alongside. NW Cor. of Alfalfa field N.E. Cor. bears E. 15 Chains.

80.00 Set Sandstone $18 \times 6 \times 3$ ins 12 ins

T3NR3E, Continued

Chains in the ground for Cor. to Secs 29
 30 31 and 32 marked 1 notch on
 the S. and 5 notches on the East
 edges; dug pits 18x18x12 ins in each
 Sec. 5 1/2 ft dist and raised mound
 of earth 2 ft high 4 1/2 ft. base along
 side. N.E. Cor. of Orchard S.E. Cor. bear S. 40 ch.
 Land Level Soil 1st Class
 No Timber

East on random line bet. Sec.
 29 and 32

Var. 13° 42' E.

92.5 intersect center line of the Arizona
 Canal bear N. 71° W.

40.00 Sect. temporary 44 S. Cor.

80.00 intersect N and S line 58 links S
 of Cor. to Secs 28 29 32 and 33

T3N R3E Continued

Chain Thence down

S. $89^{\circ}37'$ W. on true line bet Sec 29
and 32 with same var.

40.00 Set Sandstone for the $\frac{1}{4}$ S. Cor.

16x8x5 ins 11 ins in the ground
marked $\frac{1}{4}$ S on N face and dug
pit 18x18x12 ins E and W of stone
and $5\frac{1}{2}$ ft. dirt and raised mound
of earth $1\frac{1}{2}$ ft high $3\frac{1}{2}$ ft. base along
sider

80.00 Cor. Sec. 29 30 31 32

Land Level Soil 1st Class
No Timber

West on random line bet. Sec.
30 and 31

Var. $13^{\circ}42'$ E

5.00 David Turner's House bears Due N. 75

T & N R 3 E Continued

Chains

links dist

40.00 Set temporary ^{1/4} Sec. Corner
 65.00 NE^{1/4} Cor. of Grainfield S.E. Cor. bears S 22 Chns.
 74.00 Thomas Boyles House bears due South

3 chns. dist

78.38 NW. Cor. of Grainfield SW Cor. bears S. 22 Chns.

78.88 intersect the West boundary of
 Township 40 links South of the
 Cor. to Sec. 25 30 31 and 36 which
 is marked by a Malpais Stone 14 x
 6 x 6 ins marked 1 notch on the
 S. and ⁵ notches on the ^{N.} E. edges
 Thence I run

S^{89°43'} E. on true line bet. sec.
 30 and 31 with same wa.

38.88 Set Sandstone 15 x 6 x 5 ins 10 ins
 in the grounds for 1/4 S. Cor. Marked
 1/4 S on the N. face, dug pits
 18 x 18 x 12 ins E & W of Stone 5 1/2 ft. dist
 and raised mound of earth 1 1/2 ft.
 high 3 1/2 ft. base alongside NW. cor. of
 Orchard S.W. Cor. bears S 40 Chains

T3NR3E Continued

Chains

78.88

Cor. to Secs 25 30 31 and 36

Land Level Soil 1st Class

No Timber

North bet. Secs 29 and 30

on 13°42' E.

3.36 intersect centro line of the Arizona
Canal bears N. 71° W.

29.00 Base of Butte 110ft. high

39.00 Top of " " "

40.00 Set Granite Stone 15x6x6 ins
10 ins in the ground for the $\frac{1}{4}$ S.
Cor. marked $\frac{1}{4}$ S. on the W face
and raised a mound of stone 2ft.
high 3ft. base alongside.
Pits impracticable.

45.00 Base of Butte

80.00 Set sandstone 30x8x8 ins 24

T3NR3E Continued

Chains

ins in the ground for Cor- to Sec.
 19 20 29 and 30 marked 2 notches
 on the South and 5 notches on the
 E. edges; dug pits 18x18x12 ins in
 each Sec. 5 1/2 ft. dist and raised
 mound of earth 2 ft. high 1 1/2 ft.
 base along side. High Mountain bears E. 20 Chns.
 Land broken Soil 4th Class
 No Timber

West on random line bet. Sec.
 19 and 30

on 13° 42' E.

40.00 Set temporary 1/4 S. Cor-
 78.75 intersect West boundary of the
 Township 43 links North of Cor-
 to ^{Secs} 19 24 25 and 30 which is mark-
 ed by a Malpais Stone 14 x 6 x 4

T3N R3E Continued

ins 9 ins in the ground marked
 2 notches on the S. and ⁴ 2 notches
 on the ^{North,} East edges with pit in
 each sec. and mound of earth
 alongside and from which
 Top of Butte S 58° 30' E 39.30 chs dist
 Thence Down

N 89° 41' E. on true line bet Sec.
 19 and 30 with same va.

38.75 Set Sandstone 16 x 8 x 6 ins 11 ins
 in the ground for the 1/4 D. Cor-
 marked 1/4 S. on the N. face
 dug pits 18 x 18 x 12 ^{ins} E and W from
 Stone 5 1/2 ft. dist. and raised a
 mound of earth 1 1/2 ft. high 3 1/2 ft.
 base alongside

Top of Butte bears S 18° N. 21.30 chs dist

78.75 Corners Sec. 19, 24 25 and 30

Land Broken Soil 2nd class No. Timber

T3N R3E Continued

General Description.

The Arizona ^{canal} was built for irrigating purposes and is 24 ft wide on bottom about 3 ft. depth of water

Jacob Wieder has a good substantial house on the S. W. $\frac{1}{4}$ of Sec 32 and 30 acres in alfalfa

David Turner has a house on the S. E. $\frac{1}{4}$ of Sec. 30

David Turner has set out the entire NE $\frac{1}{4}$ of Sec. 31 in orchard of various fruits.

Thomas Boyle has a house on the NW $\frac{1}{4}$ of Sec 31 and a growing crop of Grain on 33 acres.

There is a house on the SW $\frac{1}{4}$

T3NR3E Continued

of Sec. 33

Andrew Barry
U.S. Deputy Surveyor.

List of Names.

BOOK II



A List of the Names of Individuals employed by

Andrew Barry U. S. deputy

surveyor, to assist in running, measuring, or marking the lines

and corners described in the foregoing Field Notes of the surrey

of *fractional Township No 3 North*

Range No 3 East and the Extension of the

subdivision lines in Township No 2 North

Range No 4 East of the Gila and Salt

River Base and Meridian in the

Territory of Arizona

Showing the respective capacities in which they acted.

George A Herrold Chairman.

Martyn C. Morry Chairman.

Meredith Aldridge Axeman.

Flagg



Final Oath of Assistants.

BOOK 11

We hereby certify that we assisted Andrew

Darry

U. S. Deputy Surveyor, in surveying

all those parts or portions of Township N^o 3 North
Range No 3 E. and Township N^o 2 North
Range No 4 East of the Gila and Salt
River Base and Meridian in the
Territory of Arizona

as are represented in the foregoing field notes as having been surveyed by him and under his direction; and that said Survey has been in all respects, to the best of our knowledge and belief, well and faithfully surveyed and the corner monuments established according to the instructions furnished by the United States Surveyor-General for Arizona.

E. H. Herrold Chainman.

Martin C. Mowry Chainman.

Merrill H. Aldridge Axeman.

Flagman.

Sworn to and subscribed before me, this 28th day of

Jan, 1889

Frank Baxter

Notary Public

30

Final Oath of Deputy Surveyor.

BOOK 11

I, Andrew Barry

U. S. Deputy Surveyor, do solemnly swear that in pursuance
instructions received from John ~~Wasson~~^{Hess}, United States
Surveyor-General for Arizona, bearing date the 24th
day of December 1888, I have well, faithfully
and truly, in my own proper person, and in strict conformity
with the instructions furnished by the United States Surveyor
General for Arizona, the Surveying Manual, and the laws of the
United States, surveyed all those parts or portions of

Township No 3 North Range No
East and Township No 2 North
and Range No 4 East of the Gila
and Salt River Base and Meridian
of the Territory of Arizona

as are represented

in the foregoing Field Notes as having been surveyed by me and
under my direction; and I do further solemnly swear that all
the corners of said surveys have been established and perpetuated
in strict accordance with the Surveying Manual, printed instructions,
the special instructions of the United States Surveyor
General for Arizona, and in the specific manner described in the

old notes, and that the foregoing are the true Field Notch survey, and should any fraud be detected I will suffer penalty of perjury, under the provisions of an act of Congress approved August 8, 1846

Andrew Barr
U. S. Deputy Surveyor

Sworn to and subscribed before me this 28th day

January, 1889.

Frank Baxter
Notary Public

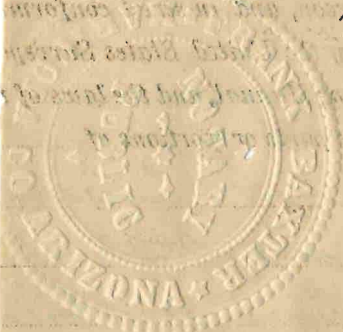

U. S. Surveyor-General's Office,

TUCSON, A. T., *Mar. 9* 1889

The foregoing Field Notes of the Surveys of
 Retracements of a portion
 of the exterior lines and
 subdivision lines of T. 3 N.
 R. 3 E. Gila and Salt River Meridian
 in *Arizona* executed by

U. S. Deputy Surveyor, under his contract dated

Andrew Barry.

having been critically examined, the necessary corrections and explanations made, the said Field Notes and the surveys they describe are hereby approved.

John Aise
 U. S. Surveyor-General
 for the Territory of Arizona.