

~~Book No. 11~~

mailed

*Attended by*  
*Superior*  
A. C. Shoemaker, Deputy Surveyor.  
T. South R. 30 East

Gila and Salt River Meridian.

No 56

*looked*

# FIELD NOTES

OF

THE SUBDIVISION LINES OF

Township *8 N*, Range *30 E*

Gila and Salt River Meridian

BY

A. C. Shoemaker, Deputy Surveyor.

Under his Contract of *Aug. 5, 1883*

Survey Commenced *Sept. 17, 1883*

Survey Completed *Sept. 24, 1883*

No 56

Platted,  
Copied for Washington,  
Copied for Register,

Edward Denny & Co., Stationers & Printers, S. F., Cal.  
Copyright Secured,

Entered according to Act of Congress, in the Clerk's Office of the Librarian of Congress at Washington, D. C., in the year 1880.

*Underscribed*



No-56

A. C. Shremaker, Deputy Surveyor.

T. 8 N. R. 30 East,

Gila and Salt River Meridian.

# FIELD NOTES

OF

THE SUBDIVISION LINES OF

Township 8 N, Range 30 E,

Gila and Salt River Meridian.

BY

A. C. Shremaker, Deputy Surveyor.

Under his Contract of Aug. 5, 1882,

Survey Commenced Sept. 17, 1883

Survey Completed Sept. 24, 1883.

Platted,  
Copied for Washington,  
Copied for Register,

No 56



1A

Township *8 North*, Range *30 East*,  
*Gila and Salt River* Meridian.

6	60	5	44	4	33	3	22	2	11	1
59		58		43		32		21		10
7	57	8	42	9	31	10	20	11	9	12
56		55		41		30		19		8
18	54	17	40	16	29	15	18	14	7	13
53		52		39		28		17		6
19	51	20	38	21	27	22	16	23	5	24
50		49		37		26		15		4
30	48	29	36	28	25	27	14	26	3	25
47		46		35		24		13		2
31	45	32	34	33	23	34	12	35	1	36

*O.K.*

Edward Denny & Co., Stationers & Printers, S. F., Cal.  
Copyright Secured,

Entered according to Act of Congress, in the Clerk's Office of the Librarian of Congress  
at Washington, D. C., in the year 1880.

Township.....Range.....

.....Meridian.

*For preliminary oaths and  
description of instrument, see  
Book No. 1.*

13 Township  
(See previous page.)

S N, Range 30 E,

BOOK 53

Gila and Salt River Meridian.

~~previously described.~~

Chains

From the corner to Sections 35, 36, 1 and 2 on the South boundary,  $\lambda$  run North, between Sections 35 and 36.

Variation 14° 18' East.

Over rolling land.

40.00

Set a Basalt stone 20 x 15 x 6 ins., 15 ins. in the ground, for  $\frac{1}{4}$  Sec. Cor., marked  $\frac{1}{4}$  on N, face, and raised a mound of stone alongside. Pits impracticable.

80.00

Set a Basalt stone 12 x 12 x 12 ins. 8 ins. in the ground for Cor. to Secs. 25-26-35-36 marked with / notch on S. and / notch on E. edges and raised a mound of stone alongside. Pits impracticable.

from which  
A Cedar 15 ins, diam, bears N. 10° E, 35 lks, dist, marked T. S. N., R. 30 E. S., 25 B. T.

No other trees within limits.

Land rolling.

Soil 2" 4 3" rate

Timber of Pine and cedar.

Vegetation. Grass.



Township

BOOK

8 N,

Range

30 E,

2

Gila and Salt River

Meridian.

Chains

East, on a random line between Sections 25 and 36.

Variation

14° 18'

East.

Over rolling land.

38.00 Descend.

40.00 Set temporary  $\frac{1}{4}$  Sec. Cor.79.84 Intersect C. B. of Twp. 20 N. S. of cor. to secs.  
previously described.

25-30-31-36 from which corner, I run

S. 89° 51' 17" a true line, between sections 25-36.

Variation

14° 21'

East.

34.92 Set a Basalt stone 15 x 12 x 6 ins., 10

ins. in the ground, for  $\frac{1}{4}$  Sec. Cor., marked  $\frac{1}{4}$  on N,

face, and raised a mound of stone alongside. Pits

impracticable.

79.84 The corner to sections 25-26-35-36.

Land rolling.

Soil 2" &amp; 3" rate

Timber of

Pine and cedar.

Vegetation.,

Grass.

Township

8 N,

Range

30 E,

BOOK 56

Gila and Salt River Meridian.

Chains

North, between Sections 25 and 26.

Variation

144° 18'

East.

Descend.

27.00

A Lake, bears west about 10 chs. dist.

40.00

A Pine 10 ins, diam. which I marked  $\frac{1}{4}$  S. on W face, for  $\frac{1}{4}$  sec. cor., dug pits, 18 x 18 x 12 ins. N and S of tree, 5  $\frac{1}{2}$  ft. dist. and raised a mound of earth around tree.

A Pine 15 ins, diam. bears N. 10° W, 5 lks. dist. marked  $\frac{1}{4}$  S. B. T. No other trees within limits.

45.00

Along edge of flat.

80.00

Set a post 4 ft. long, 1 ins. square, with marked stone 12 ins. in the ground, for Cor. to Secs, 23-24-25-26 marked T, 8 N, S, 24, on N, E, R, 30 E, S. 25 on S, E, S, 26 on S, W, and S, 23 on N, W, face with 2 notches on S, and 1 notch on E, edges, dug pits 18 x 18 x 12 ins, in each Sec., 5  $\frac{1}{2}$  ft. dist., and raised a mound of earth 2 ft, high, 4  $\frac{1}{2}$  ft, base around post.

rolling.

Soil 1" & 2" rate

Timber of Pine & Cedar.

Vegetation, Grass.



Township

8 N,

Range

31 E,

4

BOOK 56

Gila and Salt River

Meridian.

Chains

East, on a random line between Sections 24 and 25.

Variation

14° 18'

East.

Over rolling land.

40.00 Set temporary  $\frac{1}{2}$  Sec. Cor.

79.84 Intersect E. B. of Tp. 20 Ns. S. of cor. to secs.

14-24-25-30 from which corner, I run

S. 89° 57' W on a true line, between sections 24-25,

Variation 14° 21' East.

39.92

Set a Basalt stone 20 x 18 x 10 ins., 15 ins. in the ground, for  $\frac{1}{2}$  Sec. Cor., marked  $\frac{1}{2}$  on N, face, and raised a mound of stone alongside. Pits impracticable.

79.84 The corner to sections 23-24-25-26.

Land rolling.

Soil 1" 8 2" rate

Timber of Pine and Cedar.

Vegetation, Grass,

Township

8 N,

Range

30 E;

BOOK 56

Gila and Salt River Meridian.

Chains

North, between Sections 23 and 24.

Variation

14° 18'

East.

*Over rolling land.*

40.00 Set a Basalt stone 15 x 12 x 10 ins., 10 ins. in the ground, for  $\frac{1}{4}$  Sec. Cor., marked  $\frac{1}{4}$  on N, face, and raised a mound of stone alongside. Pits impracticable.

80.00 Set a Basalt stone 16 x 12 x 10 ins. 11 ins. in the ground for Cor. to Secs. 13-14-23-24 marked with 3 notches on S. and 1 notch on E. edges and raised a mound of stone alongside. Pits impracticable.

*Land rolling.*

Soil 2" 9 3' rate

Vegetation, Grass.

Township

8 N,

Range

30 E,

6

Gila and Salt River

Meridian.

BOOK 56

Chains

East, on a random line between Sections 13 and 24.

Variation

14° 18'

East.

Over rolling land.

40.00

Set temporary  $\frac{1}{2}$  Sec. Cor.

79.75

Intersect C. B. of Twp. 10 Ws. S. of cor. to secs.

13-18-19-20 from which corner, I run

S 89° 56' W on a true line, between sections 13-24,

Variation 14° 21' East.

39.88

Set a Basalt stone 10 x 10 x 8 ins.,  $\gamma$ ins. in the ground, for  $\frac{1}{2}$  Sec. Cor., marked  $\frac{1}{2}$  on N,

face, and raised a mound of stone alongside. Pits

impracticable.

79.75

The corner to sections 13-14-23-24,

Land rolling.

Soil 2" &amp; 3" rate

Vegetation, Grass.



Township

8 N,

Range

30 E,

BOOK 56

Gila and Salt River Meridian.

Chains

North, between Sections 13 and 14.

Variation

14° 18'

East.

Over rolling land.

40.00

Set a Basalt stone  $15 \times 12 \times 10$  ins., 10 ins. in the ground, for  $\frac{1}{4}$  Sec. Cor., marked  $\frac{1}{4}$  on N. face, and raised a mound of stone alongside. Pits impracticable.

70.00

Ascend.

80.00

Set a Basalt stone  $20 \times 8 \times 15$  ins. 5 ins. in the ground for Cor. to Secs. 11-12-13-14 marked with 4 notches on S. and 1 notch on E. edges and raised a mound of stone alongside. Pits impracticable.

Land rolling.

Soil 2" &amp; 3" rate

Timber of Pine & Cedar,  
Vegetation, Grass.

Township

8 N,

Range

30 E,

8

BOOK 56

Gila and Salt River

Meridian.

Chains

East, on a random line between Sections 12 and 13.

Variation

14° 18'

East.

Ascend.

30.00

Ascend.

abruptly.

40.00

Set temporary  $\frac{1}{2}$  Sec. Cor.

50.14

Intersect C. B. of Tp. 9 lks. N. of cor. to secs.

7-12-13-18<sup>previously described.</sup>  
from which corner, I run

N 89° 56' W on a true line, between sections 12-13.

Variation

14° 21'

East.

40.07

Set a

Basalt stone 30 x 20 x 15 ins., 22  
ins. in the ground, for  $\frac{1}{2}$  Sec. Cor., marked  $\frac{1}{2}$  on N.face, and raised a mound of stone alongside. Pits  
impracticable.

50.14

The corner to sections 11-12-13-14,

Land rolling.

Soil 2" &amp; 3" rate

Vegetation, Grass.

Township S N, Range 30 E,  
 BOOK 56 Gila and Salt River Meridian.

Chains

North, between Sections 11 and 12.

Variation

14° 18'

East.

Descend.

140.00

Set a post 3 ft. long, 3 ins. diam. with marked stone  
 12 ins. in the ground, for  $\frac{1}{2}$  Sec. Cor., marked  $\frac{1}{2}$  S. on  
 W. face, dug pits, 18 x 18 x 12 ins. N. and S. of  
 post  $5\frac{1}{2}$  ft. dist., and raised a mound of earth  $1\frac{1}{2}$  ft.  
 high,  $3\frac{1}{2}$  ft. base around post.

80.00

Set a Sand stone  $14 \times 10 \times 6$  ins. 9 ins. in  
 the ground for Cor. to Secs. 1-2-11-12 marked  
 with T notches on S. and 1 notch on E. edges and  
 raised a mound of stone alongside. Pits impracticable.

Land rolling.

Soil  $1^{st}$  rate

Timber of Pine &amp; Cedar.

Vegetation, Grass.

Sept. 17, 1883.



Township

S N,

Range

30 E,

10

BOOK 56

Gila and Salt River

Meridian.

Chains

East, on a random line between Sections 1 and 12.

Variation

14° 18'

East.

Descend.

40.00 Set temporary  $\frac{1}{2}$  Sec. Cor.79.87 Intersect C. B. of Tp. 22 lks. S. of cor. to secs.  
1-6-7-12 from which corner, I run  
previously described.

S. 89° 51' W on a true line, between sections 1-12,

Variation 14° 21' East.

39.94 Set a post 3 ft. long. 3 ins. diam. with marked stone

12 ins. in the ground, for  $\frac{1}{2}$  Sec. Cor., marked  $\frac{1}{2}$  S. on

N. face, dug pits, 18 x 18 x 12 ins., E. and W. of

post 5  $\frac{1}{2}$  ft. dist., and raised a mound of earth 1  $\frac{1}{2}$  ft.high, 3  $\frac{1}{2}$  ft. base around post.

from which

A Pine 10 ins. diam. bears N. 20° E, 11 lks. dist.

marked  $\frac{1}{2}$  S. B. T.

No other trees within limits.

79.87 The corner to sections 1-2-11-12,

Land mountainous

Soil

1<sup>st</sup>

rate

Timber of

Pine &amp; Cedar.

Vegetation.

Grass.

Township

8 N,

Range

30 E,

BOOK 56

Gila and Salt River Meridian.

Chains

true.  
North, on a ~~reference~~ line between Sections 1 and 2.

Variation

14° 18'

East.

Descend.

46.00

Set a post 3 ft. long, 3 ins. diam. with marked stone  
12 ins. in the ground, for  $\frac{1}{2}$  Sec. Cor., marked  $\frac{1}{2}$  S. on  
N. face, dug pits, 18 x 18 x 12 ins., N. and S. of  
post 5  $\frac{1}{2}$  ft. dist., and raised a mound of earth 1  $\frac{1}{2}$  ft.  
high, 3  $\frac{1}{2}$  ft. base around post.

from which

A Pine 12 ins. diam. bears N. 30 E, 22 lks. dist.  
marked  $\frac{1}{2}$  S. B. T. No other trees within limits.

74.00

Cross Road, bears, N. W. &amp; S. E.

81.42

Intersect the 2<sup>nd</sup> Standard Parallel N., at a  
point 14.12 chs. West of the Standard Cor. to on  
Secs. 1, 2, 3, 4 and Sec. 35 T. 9 N., R. 30 E.,  
which is a Sandstone,  
8 x 8 x 6 ins., set 5 ins. in the  
ground, marked  $\frac{1}{4}$  on N face  
and with mound of stone  
alongside,

Set a Sand stone 2  $\frac{1}{2}$  x 1  $\frac{1}{2}$  x 8 ins. 18 ins. in  
the ground for Closing Cor. to Secs. 1 and 2  
marked C. C. with 3 notches on N and 1 notch on  
E. edges and raised a mound of stone. alongside.

Pits in, racticable.

Land rolling.  
Soil "9 2" rats  
Vegetation, Grass.

Township

*T. N. 1*  
BOOK 56

Range

*30 E.*

Gila and Salt River Meridian.

~~From the corner to sections, 2, 3, 34 & 35 previously described.~~

Chains *run* North, between Sections 34 and 35.

Variation *14° 18'* East.

Over rolling land.

*40.00* Set a Basalt stone *15 x 10 x 8* ins., <sup>*10*</sup> ins. in the ground, for  $\frac{1}{4}$  Sec. Cor., marked  $\frac{1}{4}$  on *N.* face, and raised a mound of stone alongside. Pits impracticable.

*80.00* Set a Basalt stone *18 x 10 x 6* ins. <sup>*12*</sup> ins. in the ground for Cor. to Secs. *26-27-34-35* marked with *1* notch on S. and *2* notches on E. edges and raised a mound of stone alongside. Pits impracticable.

from which

A Cedar *25* ins, diam, bears *S. 10 E.*, *45* lbs, dist, marked *T. N. 1, R. 30 E. S., 35 B. T.*

No other trees within limits.

Land rolling.

Soil *2" & 3"* rate

Timber of *Pine & Cedar.*

Vegetation. , *Grass.*



Township

8 N,

Range

30 E,

BOOK 56

Gila and Salt River Meridian.

Chains

East, on a random line between Sections 26 and 35.

Variation

14° 18'

East.

Over rolling land.

40.00 Set temporary  $\frac{1}{4}$  Sec. Cor.

St. 14 Intersect N. &amp; S. line, 21 lks. N. of cor. to secs.

25-26-35-36 from which corner, I run

N. 89° 51' W. on a true line between sections 26-35,

Variation 14° 18' East

40.07 Set a Basalt stone 10 x 10 x 8 ins.,

7 ins. in the ground, for  $\frac{1}{4}$  Sec. Cor., marked  $\frac{1}{4}$  on N,

face, and raised a mound of stone alongside. Pits

impracticable.

St. 14 The corner to sections 26-27-34-35,

Land rolling.

Soil 2" 2 3" rate

Timber of Pine &amp; Cedar,

Vegetation, Grass.

Township

S N,

Range

30 E,

14

BOOK 56

Gila and Salt River Meridian.

Chains

North, between Sections 26 and 27. \*

Variation

14° 18'

East.

Over rolling land.

40.00

Set a Basalt stone  $24 \times 15 \times 3$  ins., 18 ins. in the ground, for  $\frac{1}{4}$  Sec. Cor., marked  $\frac{1}{4}$  on N. face, and raised a mound of stone alongside. Pits impracticable.

80.00

Set a Basalt stone  $15 \times 12 \times 6$  ins. 10 ins. in the ground for Cor. to Secs. 22-23-26-27 marked with 2 notches on S. and 2 notches on E. edges and raised a mound of stone alongside. Pits impracticable.

Land rolling.

Soil 2" &amp; 3" rate

Timber of Pine &amp; Cedar.

Vegetation. , Grass.

Township

S. N.

Range

30 E.

BOOK 56

Gila and Salt River Meridian.

Chains

East, on a random line between Sections 23 and 26.

Variation

14° 18'

East.

Over rolling land.

40.00 Set temporary  $\frac{1}{4}$  Sec. Cor.

79.90 Intersect N. &amp; S. line, 9 lks. N. of cor. to secs.

23-24-25-26 from which corner, I run

N89° 56' W. on a true line between sections 23-26.

Variation 14° 18' East

39.95 Set a Basalt stone 15 x 12 x 10 ins., 10

ins. in the ground, for  $\frac{1}{4}$  Sec. Cor., marked  $\frac{1}{4}$  on N,

face, and raised a mound of stone alongside. Pits

impracticable.

79.90 The corner to sections 22-23-26-27,

Land rolling.

Soil 2" 73' rate

Vegetation, Grass.



Township

8 N.

Range

30 E.

16

BOOK 56

Gila and Salt River Meridian.

Chains

North, between Sections 22 and 23.

Variation

114° 18'

East.

*Over rolling land.*

40.00

Set a Basalt stone 18 x 12 x 10 ins., 12 ins. in the ground, for  $\frac{1}{4}$  Sec. Cor., marked  $\frac{1}{4}$  on N. face, and raised a mound of stone alongside. Pits impracticable.

80.00

Set a Basalt stone 15 x 12 x 10 ins. in the ground for Cor. to Secs. 14-15-22-23 marked with 3 notches on S. and 2 notches on E. edges and raised a mound of stone alongside. Pits impracticable.

*Land rolling.*

Soil 2" &amp; 3" rate

Vegetation Grass

Township 8 N. Range 30 E.  
 BOOK 56 Gila and Salt River Meridian.

Chains East, on a random line between Sections 14 and 23.

Variation 14° 18' East.

Over rolling land.

40.00 Set temporary  $\frac{1}{4}$  Sec. Cor.

80.12 Intersect N. & S. line, 17 lks. N. of cor. to secs.

B-14-23-24 from which corner, I run

N.  $89^{\circ} 53' W.$  on a true line between sections 14-23,

Variation 14° 18' East

40.06 Set a Basalt stone 24 x 18 x 6 ins., 18

ins. in the ground, for  $\frac{1}{4}$  Sec. Cor., marked  $\frac{1}{4}$  on N

face, and raised a mound of stone alongside. Pits

impracticable.

80.12 The corner to sections 14-15-22-23.

Land rolling.

Soil 2" & 3" rate

Vegetation, Grass.

Township S N. Range 30 E.

BOOK 56 Gila and Salt River Meridian.

Chains North, between Sections 14 and 15.

Variation 14° 18' East.

Over rolling land.

40.00 Set a Basalt stone 10 x 10 x 10 ins. 7 ins. in the ground, for 1/4 Sec. Cor., marked 1/4 on W. face, and raised a mound of stone alongside. Pits impracticable.

80.00 Set a Basalt stone 15 x 12 x 4 ins. 10 ins. in the ground for Cor. to Secs. 10-11-14-15 marked with 4 notches on S. and 2 notches on E. edges and raised a mound of stone alongside. Pits impracticable.

Land rolling.

Soil 2" & 3" rate  
Vegetation, Grass.



Township *S N*, Range *30 E*,  
 Gila and Salt River Meridian.

BOOK 56

Chains

East, on a random line between Sections 11 and 14.

Variation

*114° 18'*

East.

Over rolling land.

*35.00* Ascend.

*40.00* Set temporary  $\frac{1}{4}$  Sec. Cor.

*S. 0.18* Intersect N. & S. line, *17* lks. *S.* of cor. to secs.

*10-11-14-15* from which corner, I run

*S. 89° 53' W.* on a true line between sections *11-14*,

Variation *114° 18'* East

*4009* Set a Basalt stone *20 x 18 x 16* ins., *15*  
 ins. in the ground, for  $\frac{1}{4}$  Sec. Cor., marked  $\frac{1}{4}$  on *N*,  
 face, and raised a mound of stone alongside. Pits  
 impracticable.

*S. 0.18* The corner to sections *10-11-14-15*,

Land rolling.

Soil *2" 3"* rate

Timber of *Pine & Cedar*.

Vegetation, *Grass*.

I carefully examined the adjustments of my solar  
 compass to-day, particularly the latitude and revers-  
 ing apparatus, and found them correct.

*Sept. 18, 1883.*

Township 8 N, Range 30 E,

**BOOK 56** Gila and Salt River Meridian.

Chains

North, between Sections 10 and 11.

Variation 14° 18' East.

Descend.

40.00 Set a Sand stone 14 x 12 x 8 ins., 9 ins. in the ground, for  $\frac{1}{4}$  Sec. Cor., marked  $\frac{1}{4}$  on N. face, and raised a mound of stone alongside. Pits impracticable.

80.00 Set a Sand stone 20 x 18 x 6 ins. 15 ins. in the ground for Cor. to Secs. 2-3-10-11 marked with 3 notches on S. and 2 notches on E. edges and raised a mound of stone alongside. Pits impracticable.

from which  
a Pine 15 ins, diam. bears S. 30 E, 68 lks. dist. marked T & N, R. 30 E. S., 11 B. T.

No other trees within limits.

Land rolling.

Soil 2" rate

Timber of Pine & Cedar.

Vegetation. Grass.

Township

8 N,

Range

30 E,

Gila and Salt River Meridian.

BOOK 56

Chains

East, on a random line between Sections 2 and 11.

Variation

14° 18'

East.

Descend.

40.00 Set temporary  $\frac{1}{4}$  Sec. Cor.

79.72 Intersect N. &amp; S. line, 57 lks. N. of cor. to secs.

1-2-11-12 from which corner, I run

N. 89° 38' W. on a true line between sections 2-11,

Variation 14° 18' East

39.86 Set a Sand stone 12 x 8 x 8 ins., 8  
 ins. in the ground, for  $\frac{1}{4}$  Sec. Cor., marked  $\frac{1}{4}$  on N,  
 face, and raised a mound of stone alongside. Pits  
 impracticable.

79.72 The corner to sections 2-3-10-11,

Land rolling.

Soil

2"

rate

Timber of

Pine and cedar.

Vegetation.,

Grass.



Township

S N,

Range

30 E,

22

BOOK 56

Gila and Salt River

Meridian.

Chains

North, on a <sup>true</sup> ~~measuring~~ line between Sections 2 and 3.

Variation

14° 18'

East.

Descend.

40.00

Set a post 3 ft. long, 3 ins. diam. with marked stone  
12 ins. in the ground, for  $\frac{1}{4}$  Sec. Cor., marked  $\frac{1}{4}$  S. on  
N. face, dug pits, 18 x 18 x 12 ins., N. and S. of  
post  $5\frac{1}{2}$  ft. dist., and raised a mound of earth  $1\frac{1}{2}$  ft.  
high,  $3\frac{1}{2}$  ft. base around post.

S 1. 16

Intersect the 2<sup>nd</sup> Standard Parallel <sup>with</sup> at a  
point 13.71 chs. West of the Standard Cor. to on  
Secs. S. 27 and Sec. 34 T. 9 N, R. 30 E,  
which is

A sandstone, 18 x 14 x 10  
inches, set 12 ins. in the  
ground, marked H on  
N. face, with mound of  
stone alongside,

Set a post, 4 ft. long, 4 ins. square, <sup>with marked stone</sup> 12 ins. in the  
ground, for ~~Chim~~ Cor. to Secs. 2 and 3 marked C.C.,  
T. 9 N. R. 30 E, on S. 2 on E, and S. 3 on  
W faces, with 2 notches on E and 4 notches  
on W faces, dug pits 18 x 18 x 12 ins. S. & N. of post,  
 $5\frac{1}{2}$  ft. dist. and raised a mound of earth 2 ft. high,  $4\frac{1}{2}$   
ft. base around post.

Land rolling.

Soil

2"

rate

Vegetation,

Grass.

Township S. N. Range 30 E.BOOK 56

Gila and Salt River Meridian.

~~From the corner to sections, 3, 4, 33 & 34 previously described.~~Chains <sup>9</sup> ~~from~~ North, between Sections 33 and 34.Variation 14° 18' East.

Over rolling land.

40.00 Set a Sand stone  $15 \times 12 \times 10$  ins., 10 ins. in the ground, for  $\frac{1}{4}$  Sec. Cor., marked  $\frac{1}{4}$  on N. face, and raised a mound of stone alongside. Pits impracticable.

80.00 Set a Sand stone  $15 \times 10 \times 6$  ins. 10 ins. in the ground for Cor. to Secs. 27-28-33-34 marked with 1 notch on S. and 3 notches on E. edges and raised a mound of stone alongside. Pits impracticable.

Land rolling.

Soil 2" & 3" rate  
Vegetation, Grass.

Township

8 N,

Range

30 E,

24

BOOK 56

Gila and Salt River

Meridian.

Chains

East, on a random line between Sections 27 and 34.

Variation

14° 18'

East.

Over rolling land.

40.00 Set temporary  $\frac{1}{4}$  Sec. Cor.

42.00 Top of Mesa bears N. 9 S.

50.00 Cross Wash, 14 lks. wide, Course N. 10° W.

79.91 Intersect N. &amp; S. line, 13 lks. S. of cor. to secs.

26-27-34 From which corner, I run

S. 89° 54' W. on a true line between sections 27-34,

Variation 4° 18'

East

39.96 Set a Sand stone 12 x 10 x 8 ins., 8

ins. in the ground, for  $\frac{1}{4}$  Sec. Cor., marked  $\frac{1}{4}$  on N,

face, and raised a mound of stone alongside. Pits

impracticable.

79.91 The corner to sections 27-28-33-34.

Land rolling.

Soil 2" &amp; 3" rate

Timber of Pine &amp; Cedar,

Vegetation, Grass.



Township

8N,

Range

30 E,

BOOK 56

Gila and Salt River Meridian.

Chains

North, between Sections 27 and 28.

Variation

14° 18'

East.

*Over rolling land.*

46.00 Set a Basalt stone  $12 \times 8 \times 8$  ins., 8 ins. in the ground, for  $\frac{1}{4}$  Sec. Cor., marked  $\frac{1}{4}$  on N, face, and raised a mound of stone alongside. Pits impracticable.

52.00 Descend.

80.00 Set a Basalt stone  $24 \times 12 \times 10$  ins. 8 ins. in the ground for Cor. to Secs. 21-22-27-28 marked with 2 notches on S. and 3 notches on E. edges and raised a mound of stone alongside. Pits impracticable.

*Land rolling.*

Soil 2" 3" rate

Timber of Pine &amp; Cedar,

Vegetation., Grass.

Township

S N,

Range

30. E,

26

BOOK 56

Gila and Salt River

Meridian.

Chains

East, on a random line between Sections 22 and 27.

Variation

114° 18'

East.

Over rolling land.

244.00 Cross Wash, 9 lks. wide, Course N.W.

40.00 Set temporary  $\frac{1}{4}$  Sec. Cor.

S0.18 Intersect N. &amp; S. line, 21 lks. S. of cor. to secs.

22-23-26-27 from which corner, I run

S. 89° 51' W. on a true line between sections 22-27,

Variation 114° 18' East

440.09 Set a Basalt stone 12 x 10 x 8 ins., 8  
ins. in the ground, for  $\frac{1}{4}$  Sec. Cor., marked  $\frac{1}{4}$  on N,  
face, and raised a mound of stone alongside. Pits  
impracticable.

S0.18 The corner to sections 21-22-27-28,

Land rolling.

Soil 2" 9 3" rate

Vegetation, Grass,

Township

S. N.

Range

30 E.

Gila and Salt River Meridian.

BOOK 156

Chains

North, between Sections 21 and 22.

Variation

14° 18'

East.

*Over rolling land.*

38.00 Cross Wash, 18 lks. wide, Course N. W.

40.00 Set a Sand stone 15 x 9 x 6 ins., 10  
 ins. in the ground, for  $\frac{1}{4}$  Sec. Cor., marked  $\frac{1}{4}$  on  
 face, and raised a mound of stone alongside. Pits  
 impracticable.

80.00 Set a Sand stone 20 x 10 x 4 ins. 10 ins. in  
 the ground for Cor. to Secs. 15-16-21-22 marked  
 with 3 notches on S. and 3 notches on E. edges and  
 raised a mound of stone alongside. Pits impracticable.

*Land rolling and mountainous.**Soil 2" & 3" rate**Vegetation, Grass.*



Township

8 N

Range

30 E

BOOK 56

Gila and Salt River Meridian.

Chains

East, on a random line between Sections 15 and 22.

Variation 14° 18' East.

Over rolling land.

40.00 Set temporary 1/2 Sec. Cor.

50.00 Descend.

80.34 Intersect N. & S. line. 45 fms. North of cor. to secs.

14-15-22-23 from which corner, I run

27.89° 41' W. on a true line between sections 15-22.

Variation 14° 18' East

40.17 Set a Basalt stone 15 x 10 x 6 ins., 10 ins. in the ground, for 1/2 Sec. Cor., marked 1/2 on N, face, and raised a mound of stone alongside. Pits impracticable.

80.34 The corner to sections 15-16-21-22,

Land rolling.

Soil 2" 9 3" rate

Vegetation, Grass.

Sept. 19, 1883.

Township

8 N,

Range

30 E,

Gila and Salt River Meridian.

BOOK 56

Chains

North, between Sections 15 and 16.

Variation

14° 18'

East.

Descend.

40.00 Set a Sand stone 18 x 10 x 7 ins., 12 ins. in the ground, for  $\frac{1}{2}$  Sec. Cor., marked  $\frac{1}{2}$  on N, face, and raised a mound of stone alongside. Pits impracticable.

80.00 Set a Sand stone 24 x 12 x 7 ins. 18 ins. in the ground for Cor. to Secs. 9-10-15-16 marked with 4 notches on S. and 3 notches on E. edges and raised a mound of stone alongside. Pits impracticable.

Land rolling.

Soil

2" rate

Vegetation, Grass.

BOOK 56

Gila and Salt River Meridian.

Chains

East, on a random line between Sections 10 and 15.

Variation

14°18'

East.

Over rolling land.

40.00 Set temporary  $\frac{1}{2}$  Sec. Cor.

P.O. 02 Intersect N. &amp; S. line. 14 lks. S. of cor. to secs.

10-11-14-15 from which corner, I run

S. 89°54' W. on a true line between sections 10-15,

Variation 14°18' East

40.01 Set a Sand stone 12 x 8 x 4 ins., P

ins. in the ground, for  $\frac{1}{2}$  Sec. Cor., marked  $\frac{1}{2}$  on N,  
face, and raised a mound of stone alongside. Pits

impracticable.

P.O. 02 The corner to sections 9-10-15-16.

Land rolling.

Soil 2" rate

Vegetation, Grass.



Township

S W,

Range

30 E,

BOOK

56

Gila and Salt River Meridian.

Chains

North, between Sections 9 and 10.

Variation

14° 18'

East.

Descend. gradually.

40.00 Set a Sand stone 10 x 6 x 4 ins., 7  
ins. in the ground, for  $\frac{1}{4}$  Sec. Cor., marked  $\frac{1}{4}$  on W,  
face, and raised a mound of stone alongside. Pits  
impracticable.

80.00 Set a Sand stone 18 x 18 x 10 ins. 2 ins. in  
the ground for Cor. to Secs. 3-4-9-10 marked  
with Notch  $\mathcal{C}$  on S. and Notch  $\mathcal{C}$  on E. edges and  
raised a mound of stone alongside. Pits impracticable.

Land rolling.

Soil

2"

rate

Vegetation,

Grass.

Chains

East, on a random line between Sections 3 and 10.

Variation

*114° 18'*

East.

*Descend.**40.00* Set temporary  $\frac{1}{4}$  Sec. Cor.*S. 16* Intersect N. & S. line, *19* lks. S. of cor. to secs.*2-3-10-11* from which corner, I run*S. 89° 52' W.* on a true line between sections *3-10*.Variation *114° 18'* East

*40.05* Set a *Sand* stone *12 x 10 x 6* ins., *8*  
 ins. in the ground, for  $\frac{1}{4}$  Sec. Cor., marked  $\frac{1}{4}$  on *N*,  
 face, and raised a mound of stone alongside. *Pits*  
*impracticable.*

*S. 16* The corner to sections *3-4-9-10*,Land *mountainous*Soil *2"* *rate*Timber of *Pine and cedar.*Vegetation., *Grass.*

Township

8 N.

Range

30 E.

BOOK 56

Gila and Salt River Meridian.

Chains

true.  
North, on a ~~run~~ line between Sections 3 and 4.

Variation

14° 18'

East.

Descend.

40.00

Set a

Sand stone 10 x 6 x 4 ins.  $\gamma$ ins. in the ground, for  $\frac{1}{4}$  Sec. Cor., marked  $\frac{1}{4}$  on W.

face, and raised a mound of stone alongside. Pits

impracticable.

80.94

Intersect the

2<sup>nd</sup> Standard Parallel

North at a

point 14.03 chs. West of the Standard Cor. to on

Secs. 33<sup>rd</sup> and Sec. 33<sup>rd</sup> T. 9 N., R. 30 E.,

which is

A Lava Stone, 18 x 14 x 12 ins.

set 12 ins. in the ground,

marked  $\frac{1}{4}$  on N. face and

with mound of stone

alongside,

Set a

Sand stone 11 x 9 x 4 ins. 10 ins. in

the ground for Closing Cor. to Secs. 3 and 4

marked C. C. with 3 notches on E. and 3 notches on

W. edges and raised a mound of stone. alongside.

Pits impracticable.

Land rolling.

Soil

2"

rate

Timber of

Pine &amp; Cedar.

Vegetation.,

Grass.

X



Township

8N,

Range

30E,

BOOK 56

Gila and Salt River Meridian.

~~From the corner to sections, 4, 5, 32 & 33 previously described.~~

Chains *run* North, between Sections 32 and 33.

Variation

114° 18'

East.

*Along Top of mesa.*

40.00 Set a Basalt stone 16 x 11 x 8 ins., 11 ins. in the ground, for  $\frac{1}{4}$  Sec. Cor., marked  $\frac{1}{4}$  on W. face, and raised a mound of stone alongside. Pits impracticable.

80.00 Set a Basalt stone 20 x 18 x 14 ins. 15 ins. in the ground for Cor. to Secs. 28-29-32-33 marked with 1 notch on S. and 4 notches on E. edges and raised a mound of stone alongside. Pits impracticable.

rolling.

Soil 1" 9 2" rate

Timber of Pine and cedar.

Vegetation, Grass,

I carefully examined the adjustments of my solar \* compass to-day, particularly the latitude and reversing apparatus, and found them correct.

Sept. 20, 1883.

Township *S N,* Range *30 E,*  
 BOOK *56* Gila and Salt River Meridian.

Chains

East, on a random line between Sections 28 and 33.

Variation

*14° 18'*

East.

Descend.

- 14.30* Cross Creek *10* fks. wide, Course *N. 10° W.* and ascend.
- 35.00* Edge of Mesa, bears *N. 20° W.* & *S. 20° E.*
- 40.00* Set temporary  $\frac{1}{4}$  Sec. Cor.
- 79.78* Intersect N. & S. line, *25* fks. N. of cor. to secs.  
*27-28-33-34* from which corner, I run  
*N. 89° 49' W.* on a true line between sections *28-33*,  
 Variation *14° 18'* East
- 39.89* Set a Basalt stone *16 x 11 x 9* ins., *11*  
 ins. in the ground, for  $\frac{1}{4}$  Sec. Cor., marked  $\frac{1}{4}$  on N,  
 face, and raised a mound of stone alongside. Pits  
 impracticable.
- 79.78* The corner to sections *28-29-32-33*  
 Land mountainous  
 Soil *2"* rate  
 Timber of *Pine & cedar.*  
 Vegetation., *Grass.*

Township

S N,

Range

30 E,

36

BOOK 56

Gila and Salt River Meridian.

Chains

North, between Sections 28 and 29.

Variation

14° 18'

East.

Descend.

35.00 Cross Creek 12 lks. wide, Course N. 20° W and ascend.

40.00 Set a Sand stone 11 x 9 x 8 ins.,  
 ins. in the ground, for  $\frac{1}{2}$  Sec. Cor., marked  $\frac{1}{2}$  on N.  
 face, and raised a mound of stone alongside. Pits  
 impracticable.

47.50 Top of mesa bears N. 20° W. &amp; S. 20° E.

80.00 Set a Basalt stone 20 x 18 x 12 ins. 15 ins. in  
 the ground for Cor. to Secs. 20-21-28-29 marked  
 with 2 notches on S. and 4 notches on E. edges and  
 raised a mound of stone alongside. Pits impracticable.

from which

A Cedar 25 ins. diam, bears N. 85° W, 25 lks. dist,  
 marked T S N, R. 30 E. S., 20 B. T.

No other trees within limits.

Land mountainous

Soil 1" &amp; 2" rate

Timber of Pine &amp; Cedar.

Vegetation., Grass



Township

8 N.

Range

30 E;

Gila and Salt River Meridian.

BOOK 56

Chains

East, on a random line between Sections 21 and 28.

Variation

14° 18'

East.

Along mesa,

40.00

Set temporary  $\frac{1}{4}$  Sec. Cor.

53.00 Descend.

79.92 Intersect N. &amp; S. line, 14 lks. S. of cor. to secs.

21-22-27-28 from which corner, I run

S 89° 54' W. on a true line between sections 21-28,

Variation 14° 18' East

39.96 Set a Basalt stone 15 x 10 x 10 ins., 10  
ins. in the ground, for  $\frac{1}{4}$  Sec. Cor., marked  $\frac{1}{4}$  on N,  
face, and raised a mound of stone alongside. Pits  
impracticable.

79.92 The corner to sections 20-21-28-29,

Land mountainous &amp; level.

Soil 2" &amp; 3" rate

Timber of Pine &amp; Cedar,

Vegetation, Grass.

Township

S. N.

Range

30 E.

BOOK 56

Gila and Salt River Meridian.

Chains

North, between Sections 20 and 21.

Variation

14° 18'

East.

Descend.

30.00

Descend.

abruptly.

40.00

Set a

Basalt

stone 10 x 10 x 8 ins.,

ins. in the ground, for 1/4 Sec. Cor., marked 1/2 on W.

face, and raised a mound of stone alongside.

Pits

impracticable.

80.00

Set a

Sand

stone 18 x 12 x 6 ins. 12 ins. in

the ground for Cor. to Secs. 16-17-20-21 marked

with 3 notches on S. and 4 notches on E. edges and

raised a mound of stone alongside.

Pits impracticable.

Land mountainous

Soil 2" & 3" rate

Timber of Pine & Cedar.

Vegetation, Grass.

Township 8 N, Range 30 E,  
BOOK 56 Gila and Salt River Meridian.

Chains East, on a random line between Sections 16 and 21.  
 Variation 14° 18' East.

Descend.

5.00 Cross Wash, 10 lks. wide, Course N. W., and ascend.

33.00 Top of Ridge, bears N 10° W. 9 S. 8 E. and descend.

40.00 Set temporary  $\frac{1}{4}$  Sec. Cor.

80.09 Intersect N. & S. line, 22 lks. S. of cor. to secs.

15-16-21-22 from which corner, I run

S. 89° 51' W. on a true line between sections 16-21,

Variation 14° 18' East

40.05 Set a Sand stone 18 x 12 x 4 ins., 12  
 ins. in the ground, for  $\frac{1}{4}$  Sec. Cor., marked  $\frac{1}{4}$  on N,  
 face, and raised a mound of stone alongside. Pits  
 impracticable.

80.09 The corner to sections 16-17-20-21,

Land mountainous

Soil 2" & 3" rate

Timber of Pine & cedar.

Vegetation. Grass.



Township *S N,* Range *30 E,*

BOOK *56* Gila and Salt River Meridian.

Chains North, between Sections 16 and 17.

Variation *14° 18'* East.

*Descend.*

*5.00* Cross Wash, *6* lks. wide, Course *N. W.* and ascend.

*40.00* Set a *Sand* stone *16 x 10 x 6* ins., *11* ins. in the ground, for  $\frac{1}{2}$  Sec. Cor., marked  $\frac{1}{2}$  on *W.*

*face, and raised a mound of stone alongside. Pits*

*impracticable.*

*80.00* Set a *Sand* stone *12 x 8 x 3* ins. *8* ins. in

*the ground for Cor. to Secs. *8-9-16-17* marked*

*with  $\frac{1}{4}$  notches on S. and  $\frac{1}{4}$  notches on E. edges and*

*raised a mound of stone alongside. Pits impracticable.*

*Land rolling.*

*Soil  $2''$  rate*

*Vegetation, Grass*

*Sept. 21, 1883.*

Township 8 N., Range 30 E.  
BOOK 56 Gila and Salt River Meridian.

Chains

East, on a random line between Sections 9 and 16.

Variation 14° 18' East.

Ascend.

40.00 Set temporary  $\frac{1}{2}$  Sec. Cor.

79.96 Intersect N. & S. line, 33 lks. N. of cor. to secs.

9-10-15-16 from which corner, I run

$N. 89^{\circ} 46' W.$  on a true line between sections 9-16.

Variation 14° 18' East

39.98 Set a Sand stone  $15 \times 12 \times 4$  ins., 10

ins. in the ground, for  $\frac{1}{2}$  Sec. Cor., marked  $\frac{1}{2}$  on N,

face, and raised a mound of stone alongside. Pits

unpracticable.

79.96 The corner to sections 8-9-16-17.

Land rolling.

Soil 2" rate

Vegetation, Grass.

Township S N, Range 30 E,

BOOK 56

Gila and Salt River Meridian.

Chains North, between Sections 8 and 9.

Variation 14° 18' East.

Descend.

140.00 Set a Sand stone 8 x 8 x 4 ins., 5 ins. in the ground, for  $\frac{1}{4}$  Sec. Cor., marked  $\frac{1}{4}$  on N. face, and raised a mound of stone alongside. Pits

impracticable,

80.00 Set a Sand stone 12 x 12 x 8 ins. 8 ins. in the ground for Cor. to Secs. 4-5-8-9. marked with 5 notches on S. and 4 notches on E. edges and raised a mound of stone alongside. Pits impracticable.

Land rolling.

Soil 2" & 3" rate  
Vegetation, Grass.



Township

8 N,

Range

30 E,

Gila and Salt River Meridian.

BOOK 56

Chains

East, on a random line between Sections 4 and 9.

Variation

14° 18'

East.

*Ascend.*40.00 Set temporary  $\frac{1}{2}$  Sec. Cor.

80.14 Intersect N. &amp; S. line, 26 lks. N. of cor. to secs.

3-4-9-10 from which corner, I run

N. 89° 49' W. on a true line between sections 4-9.

Variation 14° 18' East

40.07 Set a Sand stone 15 x 12 x 8 ins., 10

ins. in the ground, for  $\frac{1}{2}$  Sec. Cor., marked  $\frac{1}{2}$  on N.

face, and raised a mound of stone alongside. Pits

impracticable.

from which

A Pine 12 ins, diam. bears N. 50° W, 25 lks. dist.

marked  $\frac{1}{2}$  S. B. T.

No other trees within limits.

80.14 The corner to sections 4, 5, 8, 9

Land mountainous

Soil 2" &amp; 3" rate

Timber of Pine &amp; Cedar

Vegetation., Grass,

Township

8 N,

Range

30 E,

44

BOOK 56

Gila and Salt River Meridian.

Chains

North, on a <sup>1742</sup>random line between Sections 4 and 5.

Variation

14° 18'

East.

Descend.

40.00 Set a post 3 ft. long, 3 ins. diam. with marked stone  
12 ins. in the ground, for  $\frac{1}{2}$  Sec. Cor., marked  $\frac{1}{2}$  S. on  
W. face, dug pits, 18 x 18 x 12 ins. N. and S. of  
post  $5\frac{1}{2}$  ft. dist., and raised a mound of earth  $1\frac{1}{2}$  ft.  
high,  $3\frac{1}{2}$  ft. base around post.

81.10 Intersect the 2<sup>nd</sup> Standard Parallel North at a  
point 14.50 chs. West of the Standard <sup>1/2</sup> Sec. Cor. to on  
Secs. 1, 2 of and Sec. 32 T. 9 N., R. 30 E.,  
which is  
A Limp stone 14 x 10 <sup>ins</sup> marked  
 $\frac{1}{4}$  with a mound of stone  
along side

Set a post, 4 ft. long, 4 ins. square, <sup>with marked stone</sup> 12 ins. in the  
ground, for <sup>Chim</sup> Cor. to Secs. 4 and 5 marked C.C.,  
T. 8 N. R. 30 E. .. on S. 4 on East S. 5 on  
W. faces, with 4 notches on E. and 2 notches  
on W. faces, dug pits 18 x 18 x 12 ins. S. & W. of post,  
 $5\frac{1}{2}$  ft. dist. and raised a mound of earth 2 ft. high,  $4\frac{1}{2}$   
ft. base around post.

Land rolling.

Soil 2" @ 3' rate

Vegetation, Grass.

Township

8 N,

Range

30 E,

BOOK 56

Gila and Salt River Meridian.

~~From the corner to sections 5, 6, 31 & 32 previously described.~~Chains *run* North, between Sections 31 and 32.

Variation

14° 18'

East.

Over level land

140.00 Set a Basalt stone 11 x 9 x 8 ins., 7 ins. in the ground, for  $\frac{1}{4}$  Sec. Cor., marked  $\frac{1}{4}$  on W. face, and raised a mound of stone alongside.

Pits impracticable. - from this corner, a Ranch runs S. 75° W., 20 chs. dist.

80.00 Set a Basalt stone 14 x 11 x 9 ins. 9 ins. in the ground for Cor. to Secs. 29-30-31-32 marked with 1 notch on S. and 5 notches on E. edges and raised a mound of stone alongside. Pits impracticable.

Land level.

Soil 1" &amp; 2" rate

Timber of Pine &amp; Cedar.

Vegetation, Grass.



Township

8 N,

Range

30 E,

Gila and Salt River Meridian.

BOOK 156

Chains

East, on a random line between Sections 29 and 32.

Variation

14° 18'

East.

Over level land

4.00 Leave Flat bears N. &amp; S. and ascend.

20.00 Top of Ridge, bears N.E. &amp; S.W. and descend.

32.00 Cross Ravine, Course North and ascend

38.00 Edge of mesa, bears N. &amp; S.

40.00 Set temporary  $\frac{1}{4}$  Sec. Cor.

80.26 Intersect N. &amp; S. line, 43 lks. N. of cor. to secs.

28-29-32-33 from which corner, I run

N. 89° 42' W. on a true line between sections 29-32,

Variation 14° 18' East

40.13 Set a Basalt stone 16 x 8 x 8 ins., 11  
ins. in the ground, for  $\frac{1}{4}$  Sec. Cor., marked  $\frac{1}{4}$  on N.  
face, and raised a mound of stone alongside. Pits  
impracticable.

80.26 The corner to sections 29-30-31-32,

Land mountainous and level.

Soil 2" rate

Timber of Pmi &amp; Cedar,

Vegetation, Grass,

Township

8 N,

Range

30 E,

BOOK 56

Gila and Salt River Meridian.

Chains

West, on a random line between Sections 30 and 31.

Variation

14° 18'

East.

Descend.

2.00 Cross Creek 11 lks. wide, Course N. and ascend.

10.00 Top of mesa, bears N. &amp; S.

40.00 Set temporary  $\frac{1}{4}$  Sec. Cor.80.32 Intersect N.B. of Tp. 16 lks. S. of cor. to secs.  
previously described.

25-30-31-36 from which corner, I run

S. 84° 53' 0" on a true line, between sections 30 &amp; 31.

Variation 14° 18' East.

40.32 Set a Sand stone 11 x 11 x 10 ins.,

ins. in the ground, for  $\frac{1}{4}$  Sec. Cor., marked  $\frac{1}{4}$  on N  
face, and raised a mound of stone alongside. Pits  
impracticable.

80.32 The corner to sections 29-30-31-32-

Land mountainous

Soil 2" rate

Timber of Pine &amp; Cedar.

Vegetation, Grass.

Township

S. N.  
BOOK 156

Range

30 E.

48

Gila and Salt River Meridian.

Chains

North, between Sections 29 and 30.

Variation

14° 18'

East.

Ascend.

- 15.00 Top of Spur, bears E. & W., and descend.
- 25.00 Cross Creek 10 lks. wide, Course N. & E., and ascend.
- 31.00 Top of Spur, bears E. & W., and descend.
- 40.00 Set a Basalt stone 15 x 10 x 8 ins., 10 ins. in the ground, for  $\frac{1}{4}$  Sec. Cor., marked  $\frac{1}{4}$  on W. face, and raised a mound of stone alongside. Pits impracticable.
- 58.00 Cross Gulch, 7 lks. wide, Course East and ascend.
- 60.00 Edge of Mesa, bears E. & W.,
- 80.00 Set a Basalt stone 30 x 20 x 10 ins. 22 ins. in the ground for Cor. to Secs. 19-20-29-30 marked with 2 notches on S. and 1 notch on E. edges and raised a mound of stone alongside. Pits impracticable.

Land mountainous

Soil

2'

rate

Timber of

Pine &amp; Cedar.

Vegetation.,

Grass.



Township

S N.

Range

30 E.

BOOK 56

Gila and Salt River Meridian.

Chains

East, on a random line between Sections 20 and 29.

Variation

14°18'

East.

- 37.00 Ascend. Top of mesa.
- 40.00 Set temporary  $\frac{1}{4}$  Sec. Cor. and descend abruptly.
- 58.80 Cross Creek 14 lks. wide, Course N.W.
- 77.20 Ascend. abruptly.
- 80.42 Intersect N. & S. line, 28 lks.  $\frac{1}{4}$  N. of cor. to secs.  
20-21-28-29 from which corner, I run  
N. 89° 48' W. on a true line between sections 20-29,  
Variation 14°18' East
- 40.21 To a willow, ~~which~~ which I marked  $\frac{1}{4}$  S. on N.  
face, for  $\frac{1}{4}$  Sec. Cor.; from which  
A willow, 20 ins, diam. bears S. 5° W., 30 lks. dist.  
marked  $\frac{1}{4}$  S. B. T.  
A willow, 12 ins, diam. bears N. 85° E., 35 lks. dist.  
marked  $\frac{1}{4}$  S. B. T.
- 80.42 The corner to sections 19-20-29-30,  
Land mountainous  
Soil 2" & 3" rate  
Timber of Poplar, Cedar & Willow.  
Vegetation., Grass

Township 8 N. Range 30 E.

50

BOOK 56

Gila and Salt River Meridian.

Chains

West, on a random line between Sections 19 and 30.

Variation 14° 18' East,

Over rolling land.

2.00 Ascend.

40.00 Set temporary  $\frac{1}{4}$  Sec. Cor.

43.00 Cross Road, bears, N. W. & S. E.

80.69 Intersect N. B. of Tp. 10 W. of cor. to secs.  
previously described.

19-24-25-30 from which corner, I run

N. 84° 56' E. on a true line, between sections 19-30.

Variation 14° 18' East.

40.69 Set a Basalt stone 30 x 20 x 10 ins., 22  
ins. in the ground, for  $\frac{1}{4}$  Sec. Cor., marked  $\frac{1}{4}$  on N.  
face, and raised a mound of stone alongside. Pits  
unpracticable.

80.69 The corner to sections 19-20-29-30.

Land rolling.

Soil 2" & 3" rate

Vegetation, Grass.

I carefully examined the adjustments of my solar  
compass to-day, particularly the latitude and revers-  
ing apparatus, and found them correct.

Sept. 22, 1883.

Township

S N.

Range

30 E.

BOOK 56

Gila and Salt River Meridian.

Chains

North, between Sections 19 and 20.

Variation

124° 18'

East.

Along mesa.

40.00 Set a Basalt stone 12 x 10 x 6 ins. 8 ins. in the ground, for  $\frac{1}{4}$  Sec. Cor., marked  $\frac{1}{4}$  on N. face, and raised a mound of stone alongside. Pits impracticable.

80.00 Set a Sand stone 18 x 10 x 6 ins. 12 ins. in the ground for Cor. to Secs. 17-18-19-20 marked with 3 notches on S. and 5 notches on E. edges and raised a mound of stone alongside. Pits impracticable.

Land rolling.

Soil 2" rate  
Vegetation, Grass



Chains

East, on a random line between Sections 17 and 20.

Variation

14° 18'

East.

38.00 Along mesa,  
Descend: abruptly.

40.00 Set temporary  $\frac{1}{2}$  Sec. Cor.

58.00 Cross Creek 12 lks. wide, Course N, and ascend.

79.95 Intersect N. & S. line, 16 lks. S. of cor. to secs.

16-17-20-21 from which corner, I run

S. 89° 53' W. on a true line between sections 17-20.

Variation 14° 18' East

39.98 Set a Sand stone 12 x 10 x 6 ins. &  
ins. in the ground, for  $\frac{1}{2}$  Sec. Cor., marked  $\frac{1}{2}$  on N,  
face, and raised a mound of stone alongside. Pits  
impracticable.

79.95 The corner to sections 17-18-19-20.

Land mountainous

Soil 2" rate

Timber of Pine & Cedar,

Vegetation, Grass

Township

8 N,

Range

30 E,

BOOK 56

Gila and Salt River Meridian.

Chains

West, on a random line between Sections 18 and 19.

Variation

14° 18'

East.

Descend.

40.00. Set temporary  $\frac{1}{2}$  Sec. Cor.

57.10 Cross Road, bears, N. W. &amp; S. E.

81.43 Intersect N. B. of Twp. 31 N. S. of cor. to secs,  
13-18-19-20, <sup>previously described.</sup> from which corner, I run

S. 89° 47' E, on a true line, between sections 18-19.

Variation 14° 18' East.

41.43 Set a Sand stone 18 x 8 x 6 ins., 12  
ins. in the ground, for  $\frac{1}{2}$  Sec. Cor., marked  $\frac{1}{2}$  on N,  
face, and raised a mound of stone alongside. Pits  
impracticable.

81.43 The corner to sections 17-18-19-20.

Land mountainous

Soil 2" rate

Timber of Pine &amp; Cedar.

Vegetation., Grass.

Township 8 N, Range 30 E,

56 Gila and Salt River Meridian.

Chains North, between Sections 17 and 18.

Variation 14° 18' East.

Along mesa,

140.00 Set a Sand stone 20 x 12 x 4 ins., 15  
ins. in the ground, for 1/4 Sec. Cor., marked 1/4 on  
face, and raised a mound of stone alongside. Pits  
impracticable.

80.00 Set a Sand stone 18 x 14 x 7 ins. 12 ins. in  
the ground for Cor. to Secs. 7-8-17-18 marked  
with 4 notches on S. and 5 notches on E. edges and  
raised a mound of stone alongside. Pits impracticable.

Land mountainous

Soil 2" rate

Timber of Pine & Cedar.

Vegetation, Grass.



Township

8 N,

Range

30 E,

Gila and Salt River Meridian.

BOOK 56

Chains

East, on a random line between Sections 8 and 17.

Variation

14° 18'

East.

Along mesa.

36.00 Descend. abruptly.

40.00 Set temporary  $\frac{1}{4}$  Sec. Cor.

61.00 Cross Creek 10 lks. wide, Course N. 10 E and ascend.

79.78 Intersect N. &amp; S. line, 13 lks. S. of cor. to secs.

8-9-16-17 from which corner, I run

S. 89° 54' W. on a true line between sections 8-17.

Variation 14° 18' East

39.89 Set a Sand stone 24 x 20 x 4 ins., 18 ins. in the ground, for  $\frac{1}{4}$  Sec. Cor., marked  $\frac{1}{4}$  on N. face, and raised a mound of stone alongside. Pits impracticable.

79.78 The corner to sections 7-8-17-18.

Land rolling.

Soil 1" &amp; 2" rate

Vegetation, Grass.

Township S 21, Range 30 E,

**BOOK 156** Gila and Salt River Meridian.

Chains West, on a random line between Sections 7 and 18.  
Variation 14° 18' East.

Over rolling land.

40.00 Set temporary  $\frac{1}{2}$  Sec. Cor.

S 1.84 Intersect N. B. of Tp. 54 lks. S. of cor. to secs. previously described.

7-12-13-18 from which corner, I run

S. 89° 37' E on a true line, between sections 7-18,  
Variation 14° 18' East.

41.84 Set a Sand stone 14 x 8 x 6 ins., 9 ins. in the ground, for  $\frac{1}{2}$  Sec. Cor., marked  $\frac{1}{2}$  on N. face, and raised a mound of stone alongside. Pits impracticable.

S 1.84 The corner to sections 7-8-14-18,

Land rolling.

Soil 1" 9 2" rate

Vegetation, Grass.

Township *8 N,* Range *30 E,*BOOK *56* Gila and Salt River Meridian.

Chains North, between Sections 7 and 8.

Variation *14° 18'* East.*Along mesa.**30.00* Descend. *at a right angle.**40.00* Set a *Sand* stone *18 x 7 x 5* ins., *12**ins. in the ground, for  $\frac{1}{4}$  Sec. Cor., marked  $\frac{1}{4}$  on *N.***face, and raised a mound of stone alongside. Pits**impracticable.*

*80.00* Set a *Sand* stone *20 x 12 x 7* ins. *15* ins. in  
 the ground for Cor. to Secs. *5-6-7-8* marked  
 with *T* notches on S. and *T* notches on E. edges and  
 raised a mound of stone alongside. Pits *impracticable.*

*Land mountainous**Soil 2" 9 3" rate**Timber of Pine and Cedar.**Vegetation, Grass.*



Township

8 N.

Range

30 E.

BOOK 56

Gila and Salt River Meridian.

Chains

East, on a random line between Sections 5 and 8.

Variation

14° 18'

East.

Descend.

40.00 Set temporary 1/4 Sec. Cor.

67.00 Cross Creek 10 lks. wide, Course N., and ascend

74.55 Intersect N. & S. line. 21 lks. S. of cor. to secs.

11-5-8-9 from which corner, I run

589° 51' W. on a true line between sections 5-8.

Variation 14° 18' East

39.75 Set a Sand stone 18 x 10 x 7 ins., 12

ins. in the ground, for 1/4 Sec. Cor., marked 1/2 on N,

face, and raised a mound of stone alongside. Pits

impracticable.

79.55 The corner to sections 5-6-7-8,

Land mountainous

Soil 1" & 2" rate

Timber of Pine & Cedar,

Vegetation. Grass.

Township S 27, Range 30 E,  
 BOOK 56 Gila and Salt River Meridian.

Chains

West, on a random line between Sections 6 and 7.

Variation

114° 18'

East.

Over rolling land.

40.00 Set temporary  $\frac{1}{2}$  Sec. Cor.

84.17 Intersect N. B. of Tp. 15 Nks. S. of cor. to secs.  
 previously described.  
 1-6-7-12 from which corner, I run

S. 89° 54' E on a true line, between sections 6-7.

Variation 114° 18' East.

44.17 Set a Sand stone 15 x 8 x 4 ins., 10  
 ins. in the ground, for  $\frac{1}{2}$  Sec. Cor., marked  $\frac{1}{2}$  on N,  
 face, and raised a mound of stone alongside. Pits  
 impracticable.

84.17 The corner to sections 5-6-7-8,

Land rolling.

Soil 2" rate

Timber of Pine &amp; Cedar,

Vegetation., Grass.

Township

8 N,

Range

30 E,

K 56

Gila and Salt River Meridian.

Chains

North, on a ~~random~~<sup>true.</sup> line between Sections 5 and 6.

Variation 14° 18' East.

Ascend.

110.00 Set a Sand stone 19 x 14 x 7 ins., 12 ins. in the ground, for  $\frac{1}{4}$  Sec. Cor., marked  $\frac{1}{4}$  on N. face, and raised a mound of stone alongside. Pits impracticable.

81.63 Intersect the 2<sup>nd</sup> Standard Parallel with a point 13.92 chs West of the Standard Cor. on Sec. 31 9 N, R. 30 E,

Which is a Limestone 10 x 8 ins marked  $\frac{1}{4}$  with a mound of stone alongside

Set a Sand stone 15 x 9 x 4 ins. 10 ins. in the ground for Closing Cor. to Secs. 5 and 6 marked C. C. with 5 notches on E. and 1 notch on W. edges and raised a mound of stone. alongside.

Pits impracticable.

Land mountainous

Soil 2" rate

Timber of Pine & Cedar.

Vegetation. Grass

Sept. 24, 1883.



## GENERAL DESCRIPTION.

BOOK 56

The land in this Township consists mostly of high rolling prairie land with mesa in the south-western part. The soil is 1<sup>st</sup> and 2<sup>nd</sup> rate, being a rich dark loam, and very productive, especially along the valley of the Neutroso creek which crosses the western part of the Township.

It has a fair supply of Pine and Cedar timber, while grass is everywhere abundant affording excellent grazing facilities. Beside the above mentioned creek, the Township is well watered by numerous springs and spring branches.

For final notes, see Book 13,

U. S. Surveyor General's Office,

Tucson, Arizona, July 26, 1884

The foregoing Field Notes of the Survey of the

Subdivision Lines of  
Township 8 North  
Range 30 East

Of the Gila and Salt River Base and Meridian, Arizona, executed by A. E. Shoemaker

Deputy Surveyor, under his contract of the 6<sup>th</sup>  
day of August, 1882, having been

critically examined and the necessary corrections and explanations made, the said Field Notes and the surveys they describe

are hereby approved

Royce Johnson  
Surveyor General.

Township No. *8 N* Range No. *30* *East 1st P* Meridian

63

63

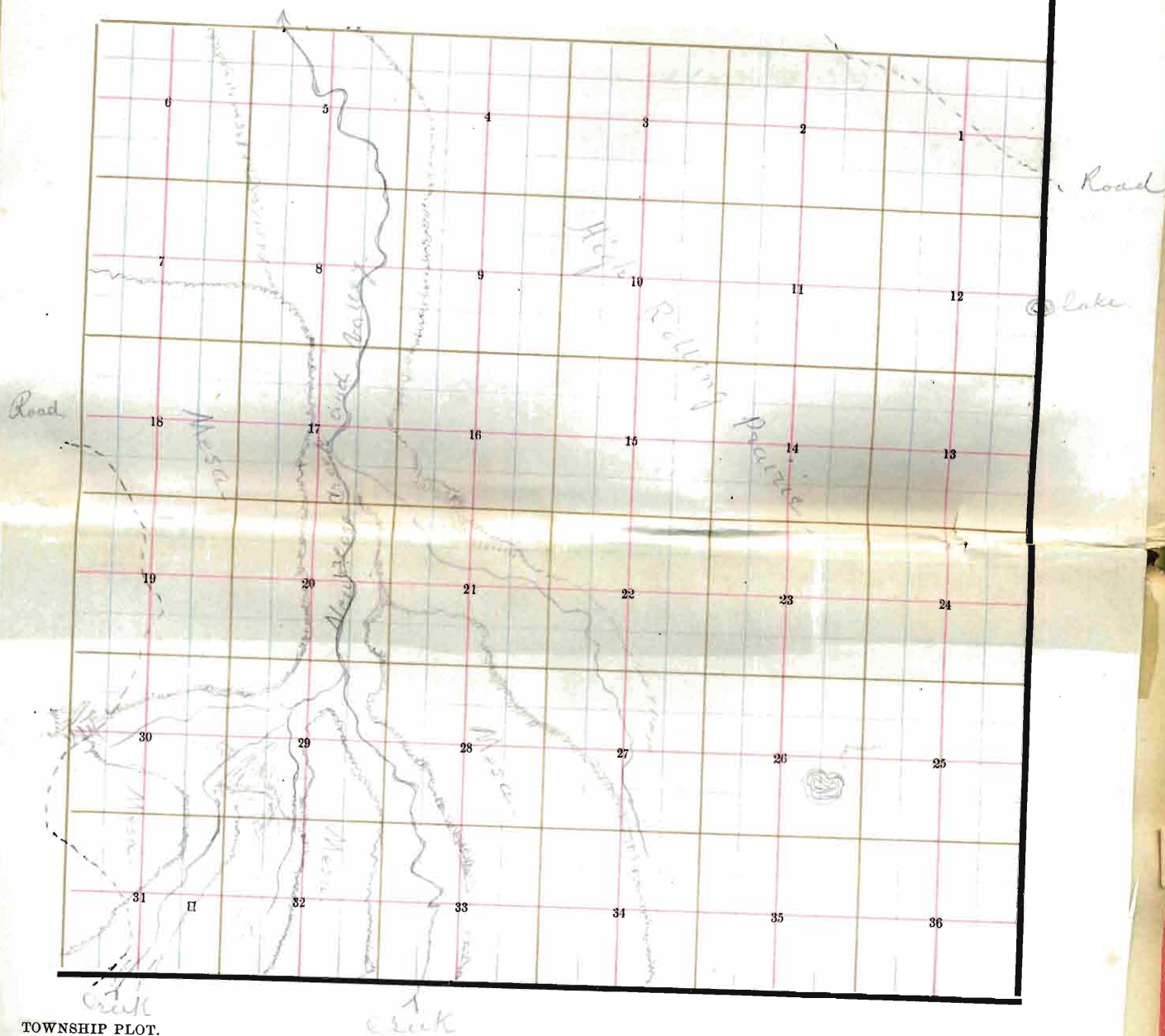

TOWNSHIP PLOT.

- Meridian Line,*
- Base Line,*
- Standard Line,*
- Township Lines,*
- Section Lines,*
- Meander Lines,*
- Office Work,*