

Book No. 13

Deputy Surveyor.

R.

Gila and Salt River Meridian.

No 107  
**FIELD NOTES**

OF

THE SUBDIVISION LINES OF

Township 12 N. Range 19 E

Gila and Salt River Meridian.

BY

H. A. Coe Deputy Surveyor.

Under his Contract of July 25<sup>th</sup> 1882

Survey Commenced April 17<sup>th</sup> 1883

Survey Completed April 23<sup>rd</sup> 1883

Platted,  
Copied for Washington,  
Copied for Register,

No-107

Edward Denny & Co., Stationers & Printers, S. F. Cal.

Copyright Secured.

Entered according to Act of Congress, in the Clerk's Office of the Librarian of Congress at Washington, D. C., in the year 1880.

107

Handwritten notes and scribbles on the left margin, including the word "Platted" written vertically.

Table showing the difference of latitude and departure in running 80 chains at any course from 1 to 60 minutes.

Minutes.	Lks.	Minutes.	Lks.	Minutes.	Lks.
1	2 $\frac{1}{2}$	21	49	41	95 $\frac{2}{3}$
2	4 $\frac{2}{3}$	22	51 $\frac{1}{3}$	42	98
3	7	23	53 $\frac{2}{3}$	43	100 $\frac{1}{3}$
4	9 $\frac{1}{3}$	24	56	44	102 $\frac{2}{3}$
5	11 $\frac{2}{3}$	25	58 $\frac{1}{3}$	45	105
6	14	26	60 $\frac{2}{3}$	46	107 $\frac{1}{3}$
7	16 $\frac{1}{3}$	27	63	47	109 $\frac{2}{3}$
8	18 $\frac{2}{3}$	28	65 $\frac{1}{3}$	48	112
9	21	29	67 $\frac{2}{3}$	49	114 $\frac{1}{3}$
10	23 $\frac{1}{3}$	30	70	50	116 $\frac{2}{3}$
11	25 $\frac{2}{3}$	31	72 $\frac{1}{3}$	51	119
12	28	32	74 $\frac{2}{3}$	52	121 $\frac{1}{3}$
13	30 $\frac{1}{3}$	33	77	53	123 $\frac{2}{3}$
14	32 $\frac{2}{3}$	34	79 $\frac{1}{3}$	54	126
15	35	35	81 $\frac{2}{3}$	55	128 $\frac{1}{3}$
16	37 $\frac{1}{3}$	36	84	56	130 $\frac{2}{3}$
17	39 $\frac{2}{3}$	37	86 $\frac{1}{3}$	57	133
18	42	38	88 $\frac{2}{3}$	58	135 $\frac{1}{3}$
19	44 $\frac{1}{3}$	39	91	59	137 $\frac{2}{3}$
20	46 $\frac{2}{3}$	40	93 $\frac{1}{3}$	60	140

PUBLISHED BY

**EDWARD DENNY & CO.**

DRAWING PAPER & MATERIAL, MATHEMATICAL INSTRUMENTS, ETC.,

STATIONERS AND PRINTERS,

SAN FRANCISCO, CAL.

Table for Running on Slopes.

In the following table the first column shows the angle, the second, the number of links to be added to a chain on the slopes, to make one chain. horizontal measurement.

Angle.	Cor. in links.	Angle.	Cor. in links.	Angle.	Cor. in links.	Angle.	Cor. in links.
°		°		°		°	
4	0-24	11	1-88	18	5-14	25	10-54
5	0-38	12	2-24	19	5-76	26	11-26
6	0-55	13	2-63	20	6-42	27	12-24
7	0-76	14	3-06	21	7-11	28	13-37
8	0-98	15	3-53	22	7-85	29	14-34
9	1-24	16	4-02	23	8-64	30	15-47
10	1-55	17	4-56	24	9-47	35	22-07



*H. A. Coe* Deputy Surveyor.

T. *12 N.* R. *19 W.*

Gila and Salt River Meridian.

*No-107*  
**FIELD NOTES**

OF

THE SUBDIVISION LINES OF

Township *12 N.* Range *19 W.*

Gila and Salt River Meridian.

BY

*H. A. Coe* Deputy Surveyor.

Under his Contract of *July 25* 188*2*

Survey Commenced *April 17* 1883

Survey Completed *April 23* 1883

*Platted,  
Copied for Washington,  
Copied for Register,*

1A

Township 12 North, Range 19 East,  
Gila and Salt River Basins Meridian.

6	60	5	44	4	33	3	22	2	11	1
59		58		43		32		21		10
7	57	8	42	9	31	10	20	11	9	13
53		55		41		30		19		8
18	54	17	40	16	29	15	18	14	7	13
53		52		39		28		17		6
19	51	20	38	21	27	22	16	23	5	24
50		49		37		26		15		4
30	48	29	36	28	25	27	14	26	3	25
47		46		35		24		13		2
31	45	32	34	33	23	34	12	35	10	36

*O.K.*

Edward Denny & Co., Stationers & Printers, S. F., Cal.

*Copyright Secured,*

Entered according to Act of Congress, in the Clerk's Office of the Librarian of Congress at Washington, D. C., in the year 1880.

Township

Range

BOOK

107

1B

Meridian.

No-107

For preliminary oaths  
and description of instrument  
used see book No. 1.

Survey made with Burt's Patent Improved Solar  
Compass nearly new, and in first rate order. Made  
by Otto Fennel of Cassel  
Germany in 1881

Before proceeding to subdivide this Tp., I made a  
change of 5 minutes in the latitude arc of my  
solar compass by subtracting same from  
the reading previously given, and at noon verified  
and corrected same by observation on the sun. I also  
further tested instrument by reversing.



10 BOOK 107

Township 12 N Range 19 E

(See previous page.)

Gila and Salt River Meridian.

Chains

From the corner to Sections 35, 36, 1 and 2 on the South boundary, <sup>1</sup> run, <sup>1</sup> previously set by me. *27*

Variation 13° 45' East.

Ascend.

27.70 Top of Ridge, bears E. 2 W. and descend.

40.00 Set a post 3 ft. long, 3 ins. diam 24 ins. in the ground, for 1/4 Sec. Cor., marked 1/4 S. on N. face; from which  
A Pine 8 ins, diam. bears S 87° E. 5 1/2 lks. dist. marked 1/4 S. B. T.

A Pine 6 ins, diam. bears S 10° W. 23 lks. dist. marked 1/4 S. B. T.

49.20 Cross Wash, 17 lks. wide, Course N 22° E and ascend.

80.00 Set a post 4 ft. long, 4 ins. square, with marked stone 12 ins. in the ground, for Cor. to Secs, 25, 26, 35, 36 marked T, R N. S. 25, on N, E, R, 19 E, S. 36 on S, E, S, 35 on S, W, and S, 26 on N, W, face with | notch on S, and | notch on E, edges, dug pits 18 x 18 x 12 ins, in each Sec., 5 1/2 ft, dist., and raised a mound of earth 2 ft, high, 4 1/2 ft, base around post. from which

A Pine 5 ins, diam. bears S 49° W. 8 1/2 lks. dist. marked T. R N. R. 19 E. S., 35 B. T.

A Juniper 9 ins. diam. bears S 41° E. 20 lks. dist. marked T. R N. R. 19 E. S., 36 B. T.

No other trees within limits.

Land mountainous.

Soil J. 2  
Vegetation Heavy timber of pine & juniper  
rate

Township 12 N Range 79 E

Gila and Salt River Meridian.

Chains

East, on a random line between Sections 25 and 36.

Variation 13° 37' East.*Descend.*7.85 Cross Wash, 10 lks. wide, Course N 30° E and ascend.25.00 Top of Spur, bears N. & S. and descend.40.00 Set temporary  $\frac{1}{2}$  Sec. Cor.57.20 Cross Wash, 10 lks. wide, Course N 25° W and ascend.80.37 Intersect O. B. of Tp. 10 lks. N. of cor. to secs.  
*previously set by me.*25.30. 3/4 Sec. from which corner, I runN. 89° 56' W on a true line, between sections 25 & 36Variation 14° 15' East.40.18 Set a post 3 ft. long, 3 ins. diam 24 ins. in the ground,  
for  $\frac{1}{2}$  Sec. Cor., marked  $\frac{1}{2}$  S. on N. face; from which  
A Pine 5 ins, diam. bears N 2° E 97 lks. dist.  
marked  $\frac{1}{2}$  S. B. T.A Juniper 8 ins. diam. bears S 51° E 106 lks. dist.  
marked  $\frac{1}{2}$  S. B. T.80.37 The corner to sections 25. 26. 35 & 36

Land mountainous

Soil 3<sup>rd</sup> rateTimber of pine & juniper.Vegetation. grass.

Township

12 N.

Range

19 E

Gila and Salt River Meridian.

Chains

North, between Sections 25 and 26.

Variation

13° 37' East.

Descend.

40.00

Set a post 3 ft. long, 3 ins. diam 24 ins. in the ground, for  $\frac{1}{4}$  Sec. Cor., marked  $\frac{1}{4}$  S. on W. face; from which  
A Juniper 4 ins. diam. bears N 40° E. 5 lks. dist. marked  $\frac{1}{4}$  S. B. T.

A Juniper 6 ins. diam. bears N. 80° W. 25 lks. dist. marked  $\frac{1}{4}$  S. B. T.

80.00

Set a sand stone 21 x 10 x 11 ins. 15 ins. in the ground for Cor. to Secs. 23. 24. 25 & 26 marked with 2 notches on S. and 1 notch on E. edges, dug pits 18 x 18 x 12 ins. in each Sec., 5  $\frac{1}{2}$  ft. dist. and raised a mound of earth 2 ft. high, 4  $\frac{1}{2}$  ft. base. alongside.

from which

A Juniper 16 ins. diam. bears S 71° E. 22 lks. dist. marked T. 12 N. R. 19 E. S., 25 B. T.

No other trees within limits.

Land rolling.

Soil 3<sup>rd</sup> rate

Vegetation

grass  
Heavy timber of juniper.



Township

12 N.

Range

19 E.

Gila and Salt River Meridian.

Chains

East, on a random line between Sections 24 and 25.

Variation

13° 45'

East.

*Over rolling land.*

40.00

Set temporary  $\frac{1}{4}$  Sec. Cor.

58.73

Cross Wash, 10 lks. wide, Course N. 6° W.

80.31

Intersect E. B. of Tp. 24 lks. S. of cor. to secs.  
previously set by me.

19, 24, 25 &amp; 30 from which corner, I run

S. 89° 50' W. on a true line, between sections 24 &amp; 25

Variation

14° 15'

East.

40.15

Set a post 3 ft. long. 3 ins. diam. with marked stone

12 ins. in the ground, for  $\frac{1}{4}$  Sec. Cor., marked  $\frac{1}{4}$  S. on

N. face, dug pits, 18 x 18 x 12 ins., Q and W. of

post  $5\frac{1}{2}$  ft. dist., and raised a mound of earth  $1\frac{1}{2}$  ft.high,  $3\frac{1}{2}$  ft. base around post.

80.31

The corner to sections 23, 24, 25 &amp; 26

Land rolling.

Soil

2<sup>nd</sup>

rate

Timber of

Juniper.

Vegetation.

Grass.

Chains

North, between Sections 23 and 24.

Variation 13° 45' East.

Descend.

2.75 Cross Wash, 10 lks. wide, Course N 50° E.

40.00 Set a post 3 ft. long, 3 ins. diam. with marked stone  
12 ins. in the ground, for  $\frac{1}{4}$  Sec. Cor., marked  $\frac{1}{4}$  S. on  
W. face, dug pits, 18 x 18 x 12 ins., N. and S. of  
post  $5\frac{1}{2}$  ft. dist., and raised a mound of earth  $1\frac{1}{2}$  ft.  
high,  $3\frac{1}{2}$  ft. base around post.

80.00 Set a post 4 ft. long, 4 ins. square, with marked stone  
12 ins. in the ground, for Cor. to Secs, 13, 14, 23 & 24  
marked T, 12 N. S, 13 E, on N, E, R, 19 E, S. 24  
on S, E, S, 23 on S, W, and S, 14 on N, W, face  
with 3 notches on S, and 1 notch on E, edges,  
dug pits 18 x 18 x 12 ins, in each Sec.,  $5\frac{1}{2}$  ft. dist.,  
and raised a mound of earth 2 ft, high,  $4\frac{1}{2}$  ft, base  
around post.

Land rolling.

Soil 2<sup>nd</sup> & 3<sup>rd</sup> rate

Vegetation grass.

Timber of Juniper.

Township

12 N

Range

19

Gila and Salt River Meridian.

Chains

East, on a random line between Sections 13 and 24.

Variation

13° 48'

East.

Descend.

40.00 Set temporary  $\frac{1}{4}$  Sec. Cor.

42.75 Cross Wash, 15 lks. wide, Course N. 23° E and ascend.

80.11 Intersect E. B. of Tp. 30 lks. N. of cor. to secs.  
previously set by me.

B. 18, 19 &amp; 24, from which corner, I run

N. 89° 47' W. on a true line, between sections 13 &amp; 24

Variation

14° 15'

East.

40.07

Set a Sand stone 24 x 14 x 0 ins., 18  
ins. in the ground, for  $\frac{1}{4}$  Sec. Cor., marked  $\frac{1}{4}$  on N  
face, and raised a mound of stone alongside. Pits

impracticable.

80.14

The corner to sections 13, 14, 23 &amp; 24

Land rolling.

Soil

3<sup>rd</sup>

rate

Vegetation

grass.

Timber of juniper.



Township 12 N. Range 19 E.

Gila and Salt River Meridian.

Chains North, between Sections 13 and 14.

Variation 13° 43' East.

Descend.

- 40.00 Set a post 3 ft. long, 3 ins. diam. with marked stone 12 ins. in the ground, for  $\frac{1}{2}$  Sec. Cor., marked  $\frac{1}{2}$  S. on W. face, dug pits, 18 x 18 x 12 ins., N. and S. of post  $5\frac{1}{2}$  ft. dist., and raised a mound of earth  $1\frac{1}{2}$  ft. high,  $3\frac{1}{2}$  ft. base around post. from which  
A Pine 6 ins. diam. bears N.  $53^{\circ}$  W. 49 lks. dist. marked  $\frac{1}{2}$  S. B. T. No other trees within limits.
- 61.00 Cross Wash, 19 lks. wide, Course N.  $40^{\circ}$  E. and ascend.
- 70.00 Top of Spur, bears N.  $39^{\circ}$  W. & S.  $39^{\circ}$  E. and descend.
- 80.00 Set a sand stone 20 x 10 x 8 ins.  $1\frac{1}{2}$  ins. in the ground for Cor. to Secs. 11, 12, 13 & 14 marked with 3 notches on S. and 1 notch on E. edges and raised a mound of stone alongside. Pits impracticable. from which  
A Juniper 10 ins. diam. bears S.  $73^{\circ}$  W. 91 lks. dist. marked T. 12 N. R. 19 E. S., 13 B. T.  
A Juniper 10 ins. diam. bears N.  $60^{\circ}$  E. 1.95 lks. dist. marked T. 12 N. R. 19 E. S., 12 B. T.  
No other trees within limits.
- Land rolling.
- Soil 3<sup>rd</sup> rate
- Timber of Juniper.
- Vegetation. grass.

Township 12 N. Range 19 E.

Gila and Salt River Meridian.

Chains

East, on a random line between Sections 12 and 13.

Variation  $13^{\circ} 30'$  East.*Descend.*9.40 Cross Wash, 20 lks. wide, Course *NW* and ascend.40.00 Set temporary  $\frac{1}{4}$  Sec. Cor.42.00 Top of Ridge, bears *N. 38° E. & S. 38° W.* and descend.79.75 Intersect *E. B. of Tp.* 17 lks. *N.* of cor. to secs.  
*previously set by me.*7. 12. 13. 18 <sup>^</sup> from which corner, I run*N. 89° 53' W.* on a true line, between sections 12 & 13Variation  $14^{\circ} 15'$  East.39.87 Set a *lime* stone 10 x 10 x 6 ins., 10  
ins. in the ground, for  $\frac{1}{4}$  Sec. Cor., marked  $\frac{1}{4}$  on *N.*  
face, and raised a mound of stone alongside. Pits  
impracticable. from whichA Juniper 9 ins. diam. bears *N. 67° W.* 40 lks. dist.  
marked  $\frac{1}{4}$  S. B. T.

No other trees within limits.

79.76 The corner to sections 11. 12. 13. &amp; 14

Land mountainous

Soil  $3^{\circ}$  rateTimber of *Juniper*Vegetation. *grass*



Township

12 N.

Range

19 E.

Gila and Salt River Meridian.

Chains

North, between Sections 11 and 12.

Variation 13° 30' East.

Ascend.

28.00 Top of Ridge, bears N. 41° E. 8.41' and descend.

40.00 Set a *lime* stone 14 x 12 x 10 ins., 10 ins. in the ground, for 1/4 Sec. Cor., marked 1/4 on *W.* face, and raised a mound of stone alongside. Pits impracticable.

43.50 <sup>snowflake</sup> Cross, Wash, 80 lks. wide, Course S. 60° E.

80.00 Set a *Granite* stone 16 x 9 x 3 ins. 10 ins. in the ground for Cor. to Secs. 1, 2, 11 & 12 marked with 5 notches on S. and 1 notch on E. edges and raised a mound of stone alongside. Pits impracticable.

A Pine 8 ins, diam. bears N. 74° E. <sup>from which</sup> 22 lks. dist. marked T. 12 N. R. 19 E. S., 1 B. T.

A Pine 12 ins, diam. bears S. 60° W. 1.3 lks. dist. marked T. 12 N. R. 19 E. S., 11 B. T.

A Pine 6 ins, diam. bears N. 70° W. 1.29 lks. dist. marked T. 12 N. R. 19 E. S., 2 B. T.

No other trees within limits.

Land mountainous.

Soil 3<sup>rd</sup> rate

Vegetation grass

Heavy timber of pine.



Township 13 N Range 19 E

Gila and Salt River Meridian.

Chains

East, on a random line between Sections 1 and 12.

Variation  $14^{\circ} 20'$  East.

Descend.

6.16 Cross Wash, 10 lks. wide, Course  $S. 25^{\circ} E$  and ascend.16.00 Top of Spur, bears  $S. 30^{\circ} E$   $N. 30^{\circ} W$  and descend.40.00 Set temporary  $\frac{1}{4}$  Sec. Cor.51.00 Cross Wash, 18 lks. wide, Course  $S. 30^{\circ} E$ .67.17 Cross Wash, 100 lks. wide, Course  $E$  and ascend.79.61 Intersect E. B. of Tp. 40 lks.  $S$  of cor. to secs.  
previously set by me.

1. 6. 7 &amp; 12 from which corner, I run

 $S. 89^{\circ} 43' W$  on a true line, between sections 1 & 12Variation  $14^{\circ} 17'$  East.39.81 Set a Sand stone  $14 \times 9 \times 4$  ins., 10  
ins. in the ground, for  $\frac{1}{4}$  Sec. Cor., marked  $\frac{1}{4}$  on  $N$ .  
face, and raised a mound of stone alongside. Pits  
impracticable.

79.61 The corner to sections 1. 2. 11. 12

Land mountainous.

Soil  $3^{\text{rd}}$  rate

Vegetation grass.

Township

13 N

Range

19 E

Gila and Salt River Meridian.

Chains

North, on a ~~line~~ <sup>true.</sup> line between Sections 1 and 2.

Variation 14° 20' East.

Ascend.

12.10

Cross Road, bears N. 75° E. 4 S. 78° W.

40.00

Set a post 3 ft. long, 3 ins. diam 24 ins. in the ground, for 1/2 Sec. Cor., marked 1/2 S. on W. face; from which

A Juniper 7 ins. diam. bears N. 5° E. 60ks. dist. marked 1/2 S. B. T.

A Pine 6 ins. diam. bears N. 70° W. 1.0ks. dist. marked 1/2 S. B. T.

46.75

Intersect the 3<sup>rd</sup> Standard Parallel North at a point 16.97 chs. E. of the Standard Cor. to Secs. 35 and 36 T. 12 N. R. 19 E. <sup>Previously described by me</sup> at which point I

Set a post, 4 ft. long, 4 ins. square, 12 ins. in the ground, for ~~the~~ Cor. to Secs. 1 and 2 marked 1/2 T. 12 N. R. 19 E., on S. 1 on S and S. 2 on W faces, with 1 notch on E and 5 notches on N faces, dug pits 18 x 18 x 12 ins. S.E. W of post, 5 1/2 ft. dist. and raised a mound of earth 2 ft. high, 4 1/2 ft. base around post.

Land rolling.

Soil 3<sup>rd</sup> rate

Vegetation grass

Timber of Juniper

April 17. 1883

Township R. C. N. Range 19

Gila and Salt River Meridian.

Chains *From the Cor. to Secs. 2, 3, 34 & 35 - previously set by me. on 8/20/97 J.P.*  
Run North, between Sections 34 and 35.Variation 13° 30' East.

Ascend.

40.00 Set a Sand stone 20 x 12 x 4 ins., 15 ins. in the ground, for  $\frac{1}{4}$  Sec. Cor., marked  $\frac{1}{2}$  on W. face, and raised a mound of stone alongside. Pits impracticable.

68.17 Top of Ridge, bears E. &amp; W. and descend.

80.00 Set a post 4 ft. long, 4 ins. square, with marked stone 12 ins. in the ground, for Cor. to Secs. 26, 27, 34 & 35 - marked T, 12 N. S., 26, on N, E, R, 19 E., S. 35 - on S, E, S, 34 on S, W, and S, 27 on N, W, face with 1 notch on S, and 2 notches on E, edges, dug pits 18 x 18 x 12 ins, in each Sec.,  $5\frac{1}{2}$  ft, dist., and raised a mound of earth 2 ft, high,  $4\frac{1}{2}$  ft, base around post.from which  
A Pine 10 ins, diam. bears S. 35° W. 72 lks. dist.  
marked T. 12 N. R. 19 E. S., 34 B. T.A Pine 6 ins, diam. bears N. 80° E. 43 lks. dist.  
marked T. 12 N. R. 19 E. S., 26 B. T.A Juniper 8 ins. diam. bears N. 60° W. 89 lks. dist.  
marked T. 12 N. R. 19 E. S., 27 B. T.

No other trees within limits.

Land mountainous.

Soil 3<sup>rd</sup> rate

Vegetation

grass.  
Heavy timber of juniper & pine



Township

12 N

Range

19 E

Gila and Salt River Meridian.

Chains

East, on a random line between Sections 26 and 35.

Variation 13° 31' East.

*Descend.*40.00 Set temporary  $\frac{1}{4}$  Sec. Cor.

50.70 Cross Wash, 16 lks. wide, Course N. 24° E and ascend.

67.00 Top of Spur, bears N. 20° E. &amp; S. 20° W and descend.

79.84 Intersect N. &amp; S. line, 48 lks. S. of cor. to secs.

26, 26, 36, 36 from which corner, I run

S. 89° 39' W on a true line between sections 26 &amp; 35

Variation 13° 31' East

39.92 Set a post 3 ft. long, 3 ins. diam 24 ins. in the ground,  
for  $\frac{1}{4}$  Sec. Cor., marked  $\frac{1}{4}$  S. on N. face; from which  
A Pine 6 ins, diam. bears N. 45° W. 37 lks. dist.  
marked  $\frac{1}{4}$  S. B. T.

A Pine 4 ins, diam. bears S. 40° E. 18 lks. dist.  
marked  $\frac{1}{4}$  S. B. T.

79.84 The corner to sections 26, 27, 34 &amp; 35

Land mountainous

Soil. 3<sup>rd</sup> rate

Timber of Pine

Vegetation. grass.

Township 12 N Range 19 E

Gila and Salt River Meridian.

Chains

North, between Sections 26 and 27.

Variation 13° 31' East.

Descend.

- 22.10 Cross head of wash 10 lks wide, <sup>N.E.</sup> Course and ascend
- 29.80 Top of Spur, bears N. 40° E. & S. 40° W. and descend.
- 40.00 Set a post 3 ft. long, 3 ins. diam 24 ins. in the ground, for 1/2 Sec. Cor., marked 1/2 S. on W. face; from which
- A Juniper 9 ins. diam. bears S. 60° E. 110 lks. dist. marked 1/2 S. B. T.
- A Juniper 16 ins. diam. bears S. 65° W. 49 lks. dist. marked 1/2 S. B. T.

- 53.13 Cross Wash, 10 lks. wide, Course N. 65° E. and ascend.
- 77.00 Top of Spur, bears N. 40° E. & S. 40° W. and descend.
- 80.00 Set a post 4 ft. long, 4 ins. square, with marked stone 12 ins. in the ground, for Cor. to Secs, 22, 23, 26 & 27 marked T, 12 N, S, 23, on N, E, R, 19 E, S. 26 on S, E, S, 27 on S, W, and S, 22 on N, W, face with 2 notches on S, and 2 notches on E, edges, dug pits 18 x 18 x 12 ins, in each Sec., 5 1/2 ft, dist., and raised a mound of earth 2 ft, high, 4 1/2 ft, base around post.

A Pine 8 ins, diam. bears S. 1° E. 49 lks. dist. from which marked T. 12 N. R. 19 E. S. 26 B. T.

A Juniper 6 ins. diam. bears N. 10° E. 80 lks. dist. marked T. 12 N. R. 19 E. S. 23 B. T.

No other trees within limits.  
Land mountainous

Soil 3<sup>rd</sup> rate

Timber of Yucca & juniper.  
Vegetation grass.

Township

12 N.

Range

19 E

Gila and Salt River Meridian.

Chains

East, on a random line between Sections 23 and 26.

Variation  $13^{\circ} 40'$  East.*Ascend.*20.00 Top of Spur, bears N.  $54^{\circ}$  E.  $\frac{1}{2}$  S.  $54^{\circ}$  W. and descend.40.00 Set temporary  $\frac{1}{2}$  Sec. Cor.78.13 Cross Wash, 16 lks. wide, Course N.  $71^{\circ}$  E.

80.19 Intersect N. &amp; S. line, 13 lks. S. of cor. to secs.

23, 24, 25 &amp; 26 from which corner, I run

A  $89^{\circ} 54'$  W. on a true line between sections 23 & 26Variation  $13^{\circ} 45'$  East40.09 Set a post 3 ft. long, 3 ins. diam 24 ins. in the ground,  
for  $\frac{1}{2}$  Sec. Cor., marked  $\frac{1}{2}$  S. on N. face; from whichA Juniper 6 ins. diam. bears S.  $50^{\circ}$  E. 34 lks. dist.  
marked  $\frac{1}{2}$  S. B. T.A Pine 4 ins. diam. bears N.  $5^{\circ}$  E. 43 lks. dist.  
marked  $\frac{1}{2}$  S. B. T.

80.19 The corner to sections 22, 23, 26 &amp; 27

Land mountainous

Soil 3<sup>rd</sup> rate

Timber of Juniper &amp; pine.

Vegetation. grass.



Township 12 N Range 19 E

Gila and Salt River Meridian.

Chains

North, between Sections 22 and 23.

Variation 13° 40' East.

Descend.

40.00

Set a Sand stone 30 x 14 x 3 ins., 23  
 ins. in the ground, for  $\frac{1}{4}$  Sec. Cor., marked  $\frac{1}{4}$  on W.  
 face, and raised a mound of stone alongside. Pits  
 impracticable. from which

1 Juniper 12 ins. diam. bears S. 71° W. 38 lks. dist.  
 marked  $\frac{1}{4}$  S. B. T.

2 Juniper 16 ins. diam. bears S. 55° E. 44 lks. dist.  
 marked  $\frac{1}{4}$  S. B. T.

80.00

A Juniper 6 ins. diam. <sup>14. 15. 22. 23</sup> for cor. to sec. which I marked  
T. 12 N. S. 14, on N. E. R. 19 E. S. 23 on  
S. E. S. 22, on S. W. and S. 15 on N. W. faces,  
 with 3 notches on S. and 2 notches on E. edges,  
 dug pits 18 x 18 x 12 ins. in each sec. 5 1/2 ft. dist. and  
 raised a mound of earth around tree, for cor. to sec.

from which  
 A Pine 10 ins. diam. bears N. 12° W. 48 lks. dist.  
 marked T. 12 N. R. 19 E. S., 15 B. T.

A Pine 7 ins. diam. bears N. 38° E. 69 lks. dist.  
 marked T. 12 N. R. 19 E. S., 14 B. T.

A Pine 6 ins. diam. bears S. 15° W. 67 lks. dist.  
 marked T. 12 N. R. 19 E. S., 22 B. T.

No other trees within limits.

Land rolling.

Soil 3° rate

Vegetation grass.

Heavy timber of juniper & pine.

Township

12 N

Range

19 E

Gila and Salt River Meridian.

Chains

East, on a random line between Sections 14 and 23.

Variation 13° 45' East.

*Descend.*40.00 Set temporary  $\frac{1}{2}$  Sec. Cor.

79.88 Intersect N. &amp; S. line, 9 lks. S. of cor. to secs.

13. 14. 22 &amp; 24 from which corner, I run

S 89° 56' W. on a true line between sections 14 &amp; 23

Variation 13° 43' East

39.94 Set a post 3 ft. long, 3 ins. diam. with marked stone  
12 ins. in the ground, for  $\frac{1}{2}$  Sec. Cor., marked  $\frac{1}{2}$  S. on  
N. face, dug pits, 18 x 18 x 12 ins., E. and W. of  
post  $5\frac{1}{2}$  ft. dist., and raised a mound of earth  $1\frac{1}{2}$  ft.  
high,  $3\frac{1}{2}$  ft. base around post.

79.88 The corner to sections 14. 15. 22 &amp; 23

Land rolling.

Soil 3<sup>rd</sup> rate

Vegetation grass.

Township 12 N Range 19 E

Gila and Salt River Meridian.

Chains

North, between Sections 14 and 15.

Variation  $13^{\circ} 45'$  East.*Descend.*

40.00 Set a post 3 ft. long. 3 ins. diam. with marked stone 12 ins. in the ground, for  $\frac{1}{4}$  Sec. Cor., marked  $\frac{1}{4}$  S. on W. face, dug pits, 18 x 18 x 12 ins., N. and S. of post  $5\frac{1}{2}$  ft. dist., and raised a mound of earth  $1\frac{1}{2}$  ft. high,  $3\frac{1}{2}$  ft. base around post.

75.40 Cross Wash, 90 lks. wide, Course N. 46° E and ascend.

80.00 Set a Sand stone 16 x 12 x 10 ins. 10 ins. in the ground for Cor. to Secs. 10, 11, 14 & 15 - marked with 4 notches on S. and 2 notches on E. edges and raised a mound of stone alongside. Pits impracticable.

*from which*

Balm of Gilead 8 ins, diam. bears  $184^{\circ} E$  2.74 lks. dist. marked T. 12 N. R. 19 E. S., 14 B. T.

No other trees within limits.

Land rolling.

Soil 3<sup>rd</sup> rate

Vegetation grass.

Timber of *Yucca* & *Juniper*.



Township

12 N

Range

19 E

Gila and Salt River Meridian.

Chains

East, on a random line between Sections 11 and 14.

Variation  $13^{\circ} 30'$  East.

Descend.

1.80 Cross Wash, 91 lks. wide, Course N.  $20^{\circ}$  E.

24.50 Cross Wash, 16 lks. wide, Course N.W. and ascend.

40.00 Set temporary  $\frac{1}{4}$  Sec. Cor.

61.12 Top of Ridge, bears N. &amp; S. and descend.

79.94 Intersect N. &amp; S. line, 25 lks. N. of cor. to secs.

11. 12. 13 &amp; 14 from which corner, I run

N.  $89^{\circ} 49'$  W. on a true line between sections 11 & 14Variation  $13^{\circ} 30'$  East39.97 Set a Granite stone  $14 \times 10 \times 5$  ins., 10 ins. in the ground, for  $\frac{1}{4}$  Sec. Cor., marked  $\frac{1}{4}$  on N. face, and raised a mound of stone alongside. Pits

impracticable. from which

A Pine 10 ins, diam. bears N.  $23^{\circ}$  W. 24 lks. dist. marked  $\frac{1}{4}$  S. B. T.A Pine 8 ins, diam. bears S.  $52^{\circ}$  E. 70 lks. dist. marked  $\frac{1}{4}$  S. B. T.

79.94 The corner to sections 10. 11. 14. 15

Land mountainous

Soil 3<sup>rd</sup> rate

Timber of pine.

Vegetation. grass.

Township 12 N Range 19 E

Gila and Salt River Meridian.

Chains North, between Sections 10 and 11. Variation 13° 30' East.

Ascend.

34.12 Top of Ridge, bears N 55° E. & S 55° W and descend.

40.00 Set a Sand stone 24 x 16 x 4 ins., 18 ins. in the ground, for 1/4 Sec. Cor., marked 1/4 on W face, and raised a mound of stone alongside. Pits impracticable. from which

A Pine 12 ins, diam. bears S 85° E. 30 lks. dist. marked 1/4 S. B. T.

No other trees within limits.

66.70 Cross Wash, 16 lks. wide, Course E. and ascend.

72.60 Cross Road, bears, N 85° E. & S 85° W.

80.00 Set a Sand stone 16 x 8 x 3 ins. 10 ins. in the ground for Cor. to Secs. 2. 3. 10. 11 marked with 5 notches on S. and 2 notches on E. edges, dug pits 18 x 18 x 12 ins. in each Sec., 5 1/2 ft. dist. and raised a mound of earth 2 ft. high, 4 1/2 ft. base. alongside. from which

A Pine 10 ins, diam. bears S 50° W. 58 lks. dist. marked T. 12 N. R. 19 E. S., 10 B. T.

A Juniper 6 ins. diam. bears S 37° E. 1.19 lks. dist. marked T. 12 N. R. 19 E. S., 11 B. T.

No other trees within limits.

Land mountainous

Soil 3<sup>rd</sup> rate

Timber of pine & juniper.

Vegetation. grass

Township

R. N.

Range

19 E

Gila and Salt River Meridian.

Chains

East, on a random line between Sections 2 and 11.

Variation  $13^{\circ} 30'$  East.

Descend.

22.10 Cross low Sag and ascend.

32.30 Cross Road, bears,  $N. 71^{\circ} E. \& S. 71^{\circ} W.$ 40.00 Set temporary  $\frac{1}{4}$  Sec. Cor.68.00 Top of Spur, bears  $N. \& S.$  and descend.

79.78 Intersect N. &amp; S. line, 18' lks. N. of cor. to secs.

1. 2. 11 &amp; 12 from which corner, I run

 $N. 89^{\circ} 32' W.$  on a true line between sections 2 & 11Variation  $14^{\circ} 20'$  East39.89 Set a post 3 ft. long, 3 ins. diam 24 ins. in the ground, for  $\frac{1}{4}$  Sec. Cor., marked  $\frac{1}{4}$  S. on N. face; from whichA Juniper 7 ins. diam. bears  $N. 88^{\circ} E. 1.0$  lks. dist. marked  $\frac{1}{4}$  S. B. T.A Pine 8 ins. diam. bears  $S. 39^{\circ} W. 5$  lks. dist. marked  $\frac{1}{4}$  S. B. T.

79.78 The corner to sections 2, 3, 10 &amp; 11

Land mountainous

Soil 3<sup>rd</sup> rate

Timber of pine &amp; juniper.

Vegetation. grass.



Township 12 N Range 19 E

Gila and Salt River Meridian.

Chains *true.* North, on a ~~ran~~ line between Sections 2 and 3.  
Variation 13° 30' East.

*Ascend.*

40.00 Set a post 3 ft. long, 3 ins. diam. with marked stone 12 ins. in the ground, for  $\frac{1}{4}$  Sec. Cor., marked  $\frac{1}{4}$  S. on W. face, dug pits, 18 x 18 x 12 ins., N. and S. of post  $5\frac{1}{2}$  ft. dist., and raised a mound of earth  $1\frac{1}{2}$  ft. high,  $3\frac{1}{2}$  ft. base around post.

45.00 Intersect the 3<sup>rd</sup> Standard Parallel North at a point 17.80 chs. East of the Standard Cor. to Secs. 34 and 35 T. 12 N. R. 19 E. *Previously described by me.* at which point I

Set a post, 4 ft. long, 4 ins. square, 12 ins. in the ground, for <sup>closing</sup> Cor. to Secs. 2 and 3 marked 66 T. 12 N. R. 19 E., on S. S. 2 on E. and S. 3 on W. faces, with 2 notch E. on and 4 notch on W. faces, dug pits 18 x 18 x 12 ins. SE & W. of post,  $5\frac{1}{2}$  ft. dist. and raised a mound of earth 2 ft. high,  $4\frac{1}{2}$  ft. base around post.

Land rolling.

Soil 3<sup>rd</sup> rate

Vegetation grass.

I carefully examined the adjustments of my solar compass to-day, particularly the latitude and reversing apparatus, and found them correct.

April 18. 1883

Township

R. N.

Range

19 E

Gila and Salt River Meridian.

Chains From the Cor. to Secs. 33 & 34 previously set by me. Now 8 1/2 by 5 1/2.

North, between Sections 33 and 34.

Variation

13° 45'

East.

Descend.

37.80 Cross Wash, 30 lks. wide, Course N. 38° W.

40.00 Set a Granite stone 12 x 10 x 7 ins., 8 ins. in the ground, for 1/4 Sec. Cor., marked 1/4 on face, and raised a mound of stone alongside. Pits impracticable.

80.00 Set a Sand stone 16 x 10 x 9 ins. 10 ins. in the ground for Cor. to Secs. 27, 28, 33 & 34 marked with 1 notch on S. and 3 notches on E. edges, dug pits 18 x 18 x 12 ins. in each Sec., 5 1/2 ft. dist. and raised a mound of earth 2 ft. high, 4 1/2 ft. base. alongside.

Land rolling.

Soil 3<sup>rd</sup> rate

Vegetation grass

Timber of juniper &amp; pine.

Township 12 N Range 19 E

Gila and Salt River Meridian.

Chains

East, on a random line between Sections 27 and 34.

Variation 13° 30' East.

*Ascend.*

27.30 Top of Ridge, bears N. 10° E. &amp; S. 10° W. and descend.

40.00 Set temporary  $\frac{1}{2}$  Sec. Cor.

43.13 Cross wash 2 lbs. wide, Course N. 50° E. and ascend

80.16 Intersect N. &amp; S. line, 31 lks. S. of cor. to secs.

26. 27. 34. 36 from which corner, I run

A 89° 47' W. on a true line between sections 27 &amp; 34

Variation 13° 31' East

40.07 Set a post 3 ft. long. 3 ins. diam. with marked stone

12 ins. in the ground, for  $\frac{1}{2}$  Sec. Cor., marked  $\frac{1}{2}$  S. on

N. face, dug pits, 18 x 18 x 12 ins., E. and W. of

post 5  $\frac{1}{2}$  ft. dist., and raised a mound of earth 1  $\frac{1}{2}$  ft.high, 3  $\frac{1}{2}$  ft. base around post.

80.16 The corner to sections 27. 28. 33 &amp; 34

Land mountainous.

Soil 3<sup>rd</sup> rate

Vegetation grass.



Township

12 N

Range

19 E

Gila and Salt River Meridian.

Chains

North, between Sections 27 and 28.

Variation 13° 30' East.

Descend.

36.15 Cross Wash, 90 lks. wide, Course N. 80° E.

40.00 Set a Sand stone 38 x 18 x 10 ins., 27  
ins. in the ground, for  $\frac{1}{4}$  Sec. Cor., marked  $\frac{1}{4}$  on W.  
face, and raised a mound of stone alongside. Pits  
impracticable.

48.20 Cross Wash, 85 lks. wide, Course N. 30° W.

56.24 Cross Wash, 85 lks. wide, Course N. 28° E and ascend.

80.00 Set a Granite stone 14 x 10 x 6 ins. 10 ins. in  
the ground for Cor. to Secs. 21. 22. 27. 28 marked  
with 2 notches on S. and 3 notches on E. edges and  
raised a mound of stone alongside. Pits impracticable.

from which

A Pine 10 ins. diam. bears S. 75° W. 75 lks. dist.  
marked T. 12 N. R. 19 E. S., 28 B. T.

A Juniper 10 ins. diam. bears N. 28° E. 10 lks. dist.  
marked T. 12 N. R. 19 E. S., 22 B. T.

No other trees within limits.

Land rolling.

Soil 3<sup>rd</sup> rate

Timber of pine &amp; juniper

Vegetation. grass.

Township

12 N.

Range

19 E

Gila and Salt River Meridian.

Chains

East, on a random line between Sections 22 and 27.

Variation 13° 30' East.

*Descend.*

13.00 Cross Wash, 180 lks. wide, Course N. 10° E and ascend.

37.00 Top of Ridge, bears N. &amp; S. and descend.

40.00 Set temporary  $\frac{1}{4}$  Sec. Cor.

79.80 Intersect N. &amp; S. line, 24 lks. S. of cor. to secs.

22, 23, 26 &amp; 27 from which corner, I run

S 89° 50' W. on a true line between sections 22 &amp; 27

Variation 13° 40' East

39.90 Set a Sand stone 15 x 8 x 3 ins., 10

ins. in the ground, for  $\frac{1}{4}$  Sec. Cor., marked  $\frac{1}{4}$  on N.

face, and raised a mound of stone alongside. Pits

impracticable. from which

A Pine 8 ins, diam. bears S. 55° W. 51 lks. dist.  
marked  $\frac{1}{4}$  S. B. T.A Pine 6 ins, diam. bears N. 65° W. 54 lks. dist.  
marked  $\frac{1}{4}$  S. B. T.

79.80 The corner to sections 21, 22, 27 &amp; 28

Land mountainous

Soil 3<sup>rd</sup> rate

Timber of Pine.

Vegetation. Grass.

Township

13 N.

Range

19 E.

Gila and Salt River Meridian.

Chains

North, between Sections 21 and 22.

Variation 13° 30' East.

*Descend.*

- 5.70 Cross Wash, 80 lks. wide, Course N. 30° W.
- 14.60 Cross Wash, 80 lks. wide, Course N. 60° E. and ascend.
- 27.17 Top of Spur, bears E. & W. and descend.
- 40.00 Set a *lime* stone 22 x 14 x 6 ins., 16 ins. in the ground, for  $\frac{1}{4}$  Sec. Cor., marked  $\frac{1}{4}$  on W. face, and raised a mound of stone alongside. Pits impracticable. from which
- 56.5 A Pine 8 ins, diam. bears N. 72° W. 190 lks. dist. marked  $\frac{1}{4}$  S. B. T.
- A Pine 9 ins, diam. bears S. 64° E. 39 lks. dist. marked  $\frac{1}{4}$  S. B. T.
- 56.51 Cross Wash, 22 lks. wide, Course E. and ascend.
- 77.10 Top of Spur, bears N. 87° E. & S. 87° W. and descend.
- 80.00 Set a post 4 ft. long, 4 ins. square, with marked stone 12 ins. in the ground, for Cor. to Secs, 15. 16. 21. 22 marked T, 12 N.S. 15, on N, E, R, 198, S. 22 on S, E, S, 21 on S, W, and S, 16 on N, W, face with 3 notches on S; and 3 notches on E, edges, dug pits 18 x 18 x 12 ins, in each Sec., 5 $\frac{1}{2}$  ft, dist., and raised a mound of earth 2 ft, high, 4  $\frac{1}{2}$  ft, base around post.
- Land mountainous.
- Soil 3<sup>rd</sup> rate
- Vegetation grass, Timber of pine.



Township 12 N. Range 19 E.

Gila and Salt River Meridian.

Chains East, on a random line between Sections 15 and 22.

Variation 13° 30' East.*Descend.*40.00 Set temporary  $\frac{1}{4}$  Sec. Cor.48.20 Cross Creek 115 lks. wide, Course *N.* and ascend.60.00 Top of Ridge, bears *N. & S.* and descend.79.63 Intersect N. & S. line, 115 lks. *N.* of cor. to secs.

14. 15. 22 23 from which corner, I run

*N. 59° 54' W.* on a true line between sections 15 & 22Variation 13° 45' East

39.81 Set a Sand stone 21 x 17 x 4 ins., 15  
 ins. in the ground, for  $\frac{1}{4}$  Sec. Cor., marked  $\frac{1}{4}$  on *N.*  
 face, and raised a mound of stone alongside. Pits  
 impracticable.

79.63 The corner to sections 15. 16. 21. 22

Land mountainous.

Soil 3<sup>rd</sup> rate

Vegetation Grass.

Timber of juniper.

Township 12 N Range 19 E

Gila and Salt River Meridian.

Chains

North, between Sections 15 and 16.

Variation 13° 30' East.*Ascend.*30.00 Top of Ridge, bears N. 42° E. & S. 42° W. and descend.40.00 Set a post 3 ft. long, 3 ins. diam. with marked stone 12 ins. in the ground, for  $\frac{1}{2}$  Sec. Cor., marked  $\frac{1}{2}$  S. on W. face, dug pits, 18 x 18 x 12 ins., N. and S. of post  $5\frac{1}{2}$  ft. dist., and raised a mound of earth  $1\frac{1}{2}$  ft. high,  $3\frac{1}{2}$  ft. base around post.80.00 Set a post 4 ft. long, 4 ins. square, with marked stone 12 ins. in the ground, for Cor. to Secs, 9, 10, 15, & 16 marked T, 12 N. S., 10, on N, E, R, 19 E., S, 15 on S, E, S, 16 on S, W, and S, 9 on N, W, face with 4 notches on S, and 3 notches on E, edges, dug pits 18 x 18 x 12 ins, in each Sec.,  $5\frac{1}{2}$  ft. dist., and raised a mound of earth 2 ft. high,  $4\frac{1}{2}$  ft. base around post.

from which

A Pine 8 ins, diam. bears S. 79° W. 34 lks. dist.

marked T. 12 N. R. 19 E. S., 16 B. T.

A Cedar 8 ins, diam, bears S. 79° E. 21 lks, dist,

marked T. 12 N. R. 19 E. S., 15 B. T.

No other trees within limits.

Land mountainous

Soil 3<sup>rd</sup> rateTimber of Juniper.Vegetation. grass.

Township 12 N Range 19 E

Gila and Salt River Meridian.

Chains East, on a random line between Sections 10 and 15.

Variation  $13^{\circ} 30'$  East.

Descend.

40.00 Set temporary  $\frac{1}{4}$  Sec. Cor.

80.06 Intersect N. &amp; S. line, 41 lks. S. of cor. to secs.

10. 11. 14. 15 from which corner, I run

S.  $89^{\circ} 42' W.$  on a true line between sections 10 & 15Variation  $13^{\circ} 30'$  East40.03 Set a post 3 ft. long. 3 ins. diam. with marked stone  
12 ins. in the ground, for  $\frac{1}{4}$  Sec. Cor., marked  $\frac{1}{4}$  S. onN. face, dug pits,  $18 \times 18 \times 12$  ins., E. and W. of  
post  $5\frac{1}{2}$  ft. dist., and raised a mound of earth  $1\frac{1}{2}$  ft.  
high,  $3\frac{1}{2}$  ft. base around post.

from which

A Juniper 8 ins. diam. bears  $S. 46^{\circ} W.$  67 lks. dist.  
marked  $\frac{1}{4}$  S. B. T.

No other trees within limits.

80.06 The corner to sections 9. 10. 15. 16

Land rolling.

Soil  $3^{\circ}$  rate

Timber of Juniper.

Vegetation. Grass.



Chains

North, between Sections 9 and 10.

Variation  $13^{\circ} 30'$  East.

Descend.

40.00

Set a Sand stone  $16 \times 10 \times 6$  ins., 10 ins. in the ground, for  $\frac{1}{4}$  Sec. Cor., marked  $\frac{1}{4}$  on W. face, dug pits  $18 \times 18 \times 12$  ins., N. and S. of stone  $5\frac{1}{2}$  ft. dist., and raised a mound of earth  $1\frac{1}{2}$  ft. high,  $3\frac{1}{2}$  ft. base alongside.

55.75

Cross Road, bears, N.  $35^{\circ}$  E. & S.  $35^{\circ}$  W.

57.00

Cross Wash, 20 lks. wide, Course N.  $30^{\circ}$  E. and ascend.

67.88

Cross Road, bears, E. &amp; W.

80.00

Set a post 4 ft. long, 4 ins. square, with marked stone 12 ins. in the ground, for Cor. to Secs. 3, 4, 9, 10 marked T. 12 N. S. 3, on N, E, R, 19 E, S. 10 on S, E, S, 9 on S, W, and S, 4 on N, W, face with 6 notches on S, and 3 notches on E, edges, dug pits  $18 \times 18 \times 12$  ins. in each Sec.,  $5\frac{1}{2}$  ft. dist., and raised a mound of earth 2 ft. high,  $4\frac{1}{2}$  ft. base around post.

from which

A Pine 8 ins. diam. bears S.  $82^{\circ}$  E. 83 lks. dist. marked T. 12 N. R. 19 E. S., 10 B. T.

A Juniper 8 ins. diam. bears N.  $27^{\circ}$  E. 1.20 lks. dist. marked T. 12 N. R. 19 E. S., 3 B. T.

No other trees within limits.

Land rolling.

Soil

3<sup>rd</sup>

rate

Vegetation grass

Timber of Juniper &amp; pine.

Township 12 N Range 19 O  
Gila and Salt River Meridian.

Chains

East, on a random line between Sections 3 and 10.

Variation  $13^{\circ} 30'$  East.*Ascend.*12.00 Top of Spur, bears  $S. 40^{\circ} E$  &  $N. 40^{\circ} W$  and descend.39.11 Cross Wash, 17 lks. wide, Course  $N. 44^{\circ} E$  and ascend.40.00 Set temporary  $\frac{1}{4}$  Sec. Cor.65.30 Cross Wash, 90 lks. wide, Course  $S. 60^{\circ} E$  and ascend.80.27 Intersect N. & S. line, 21 lks. S. of cor. to secs.  
3, 3, 10 & 11 from which corner, I run $S. 89^{\circ} 51' W$ . on a true line between sections 3 & 10Variation  $13^{\circ} 30'$  East

40.13 Set a post 3 ft. long, 3 ins. diam. with marked stone  
12 ins. in the ground, for  $\frac{1}{4}$  Sec. Cor., marked  $\frac{1}{4}$  S. on  
N. face, dug pits, 18 x 18 x 12 ins., E. and W. of  
post  $5\frac{1}{2}$  ft. dist., and raised a mound of earth  $1\frac{1}{2}$  ft.  
high,  $3\frac{1}{2}$  ft. base around post.

80.27 The corner to sections 3, 4, 9 & 10  
Land mountainous.

Soil 3<sup>rd</sup> rate

Vegetation grass.

Chains	<p style="text-align: center;"><i>true.</i></p> <p>North, on a <del>random</del> line between Sections 3 and 4.</p> <p style="text-align: right;">Variation 13° 30' East.</p>
<p>29.15</p> <p>40.00</p>	<p><i>Descend.</i></p> <p>Cross Wash, 90 lks. wide, Course S. 50° E and ascend.</p> <p>Set a post 3 ft. long. 3 ins. diam. with marked stone 12 ins. in the ground, for 1/4 Sec. Cor., marked 1/4 S. on W. face, dug pits, 18 x 18 x 12 ins. N. and S. of post 5 1/2 ft. dist., and raised a mound of earth 1 1/2 ft. high, 3 1/2 ft. base around post. <span style="float: right;">from which</span></p> <p>A Pine 10 ins. diam. bears S. 66° E. 29 lks. dist. marked 1/4 S. B. T. <span style="float: right;">No other trees within limits.</span></p>
<p>44.69</p>	<p>Intersect the 3<sup>rd</sup> Standard Parallel North at a point 78.65 chs. East of the Standard Cor. to Secs. 3 and 4 T. 12 N. R. 19 E. at which <span style="float: right;"><i>Previously described by me</i></span></p> <p><b>point I</b></p> <p>Set a post, 4 ft. long, 4 ins. square, 12 ins. in the ground, for <sup>closing</sup> Cor. to Secs. 3 and 4 marked 6.6 T. 12 N. R. 19 E., on S. S. 3 on E. and S. 4 on W. faces, with 3 notches on E. and 3 notches on W. faces, dug pits 18 x 18 x 12 ins. S. E. W. of post, 5 1/2 ft. dist. and raised a mound of earth 2 ft. high, 4 1/2 ft. base around post.</p> <p>Land rolling.</p> <p>Soil 3<sup>rd</sup> rate</p> <p>Timber of pine.</p> <p>Vegetation. grass. April 19. 1883</p>



Township 12 N Range 19 E

Gila and Salt River Meridian.

Chains *From the Cor. to Secs. 41, 5, 32 & 33 previously set by me. on S. 6. 9<sup>th</sup>*  
North, between Sections 32 and 33.Variation 13° 50' East.

Descend.

24.36 Cross Wash, 30 yds. wide, Course N. 70° E and ascend.40.00 Set a post 3 ft. long, 3 ins. diam. with marked stone 12 ins. in the ground, for  $\frac{1}{2}$  Sec. Cor., marked  $\frac{1}{2}$  S. on W. face, dug pits, 18 x 18 x 12 ins., N. and S. of post  $5\frac{1}{2}$  ft. dist., and raised a mound of earth  $1\frac{1}{2}$  ft. high,  $3\frac{1}{2}$  ft. base around post.63.50 Top of Spur, bears E. & W. and descend.80.00 Set a sand stone 17 x 13 x 10 ins. 12 ins. in the ground for Cor. to Secs. 28. 29. 32. 33 marked with 1 notch on S. and 4 notches on E. edges and raised a mound of stone alongside. Pits impracticable.*from which*  
A Juniper 12 ins. diam. bears S. 19° W. 1.69 yds. dist. marked T. 12 N. R. 19 E. S., 32 B. T.

No other trees within limits.

Land mountainous

Soil 3<sup>rd</sup> rate

Timber of Juniper

Vegetation. grass

Township 22 N.

Range 19 E

Gila and Salt River Meridian.

Chains

East, on a random line between Sections 28 and 33.

Variation  $14^{\circ} 15'$  East.

Descend.

40.00 Set temporary  $\frac{1}{4}$  Sec. Cor.

58.18 Cross Wash, 90 lks. wide, Course  $N. 5^{\circ} E$  and ascend.

80.60 Intersect N. & S. line, 25 lks. N. of cor. to secs.

27, 28, 32, 34 from which corner, I run

$N. 89^{\circ} 49' W.$  on a true line between sections 28 & 33

Variation  $13^{\circ} 30'$  East

40.80 Set a Sand stone  $14 \times 10 \times 7$  ins., 10

ins. in the ground, for  $\frac{1}{4}$  Sec. Cor., marked  $\frac{1}{4}$  on N.

face, and raised a mound of stone alongside. Pits

impracticable.

80.60 The corner to sections 28, 29, 32 & 33

Land rolling.

Soil  $3^{\text{rd}}$  rate

Vegetation Grass.

Township 12 N Range 19 E  
Gila and Salt River Meridian.

Chains

North, between Sections 28 and 29.

Variation 14° 15' East.

Descend.

29.15 Cross Wash, 20 lks. wide, Course N. 86° E and ascend.

40.00 Set a Flint stone 19 x 15 x 9 ins., 12 ins. in the ground, for  $\frac{1}{4}$  Sec. Cor., marked  $\frac{1}{4}$  on W. face, dug pits 18 x 18 x 12 ins., N. and S. of stone 5 $\frac{1}{2}$  ft. dist., and raised a mound of earth 1 $\frac{1}{2}$  ft. high, 3 $\frac{1}{2}$  ft. base alongside.

from which

A Pine 7 ins, diam. bears S. 5° W. 13 lks. dist. marked  $\frac{1}{4}$  S. B. T.

A Pine 5 ins, diam. bears N. 89° E. 44 lks. dist. marked  $\frac{1}{4}$  S. B. T.

57.83 Top of Spur, bears E. & W. and descend.

80.00 Set a Sand stone 23 x 17 x 9 ins. 18 ins. in the ground for Cor. to Secs. 20. 21. 28 & 29 marked with 2 notches on S. and 4 notches on E. edges and raised a mound of stone alongside. Pits impracticable.

from which

A Pine 12 ins, diam. bears S. 7° W. 1.25 lks. dist. marked T. 12 N. R. 19 E. S., 29 B. T.

A Pine 7 ins, diam. bears N. 54° E. 1.53 lks. dist. marked T. 12 N. R. 19 E. S., 21 B. T.

No other trees within limits.  
Land mountainous

Soil 3<sup>rd</sup> rateTimber of Yew.Vegetation. grass.



Township

12 A

Range

19 E

Gila and Salt River Meridian.

Chains

East, on a random line between Sections 21 and 28.

Variation  $14^{\circ} 15'$  East.*Descend.*36.40 Cross Wash, 16 lks. wide, Course  $N. 40^{\circ} E$  and ascend.40.00 Set temporary  $\frac{1}{4}$  Sec. Cor.50.27 Top of Spur, bears  $N. 40^{\circ} E$  &  $S. 40^{\circ} W$  and descend.

80.42 Intersect N. &amp; S. line, 43 lks. N. of cor. to secs.

21. 22. 27 &amp; 28 from which corner, I run

 $N. 89^{\circ} 42' W.$  on a true line between sections 21 & 28Variation  $13^{\circ} 30'$  East

40.21 Set a sand stone  $18 \times 10 \times 5$  ins., 12 ins. in the ground, for  $\frac{1}{4}$  Sec. Cor., marked  $\frac{1}{4}$  on N. face, and raised a mound of stone alongside. Pits impracticable.

80.42 The corner to sections 20. 21. 28. 29

Land mountainous

Soil 3<sup>rd</sup> rate

Timber of Juniper

Vegetation. grass.

Township

12 N.

Range

19 E.

Gila and Salt River Meridian.

Chains

North, between Sections 20 and 21.

Variation

14° 15'

East.

*Descend.*6.36<sup>-</sup> Cross Wash, 19 lks. wide, Course N. 73° E. and ascend.

40.00 Set a Granite stone 14 x 10 x 6 ins., 10 ins. in the ground, for  $\frac{1}{4}$  Sec. Cor., marked  $\frac{1}{4}$  on W. face, and raised a mound of stone alongside. Pits impracticable.

50.00 Top of Spur, bears N. 80° W. &amp; S. 80° E. and descend.

70.00 *Ascend.*

80.00 Set a post 4 ft. long, 4 ins. square, with marked stone 12 ins. in the ground, for Cor. to Secs, 16, 17, 20, 21 marked T, 12 N. S. 16, on N, E, R, 19 S., S. 21 on S, E, S, 20 on S, W, and S, 17 on N, W, face with 3 notches on S, and 4 notches on E, edges, dug pits 18 x 18 x 12 ins, in each Sec., 5½ ft. dist., and raised a mound of earth 2 ft. high, 4 ½ ft. base around post.

from which

A Juniper 12 ins. diam. bears N. 21° E. 1.7 lks. dist. marked T. 12 N. R. 19 E. S., 16 B. T.

A Pine 8 ins, diam. bears N. 67° W. 1.2 lks. dist. marked T. 12 N. R. 19 E. S., 17 B. T.

No other trees within limits.

Land mountainous

Soil 3<sup>rd</sup> rate

Timber of Juniper &amp; Yew.

Vegetation. grass.

Township

12 N

Range

19 E

Gila and Salt River Meridian.

Chains

East, on a random line between Sections 16 and 21.

Variation  $13^{\circ} 28'$  East.*Ascend.*40.00 Set temporary  $\frac{1}{4}$  Sec. Cor.55.50 Top of Spur, bears N.  $80^{\circ}$  W. & S.  $80^{\circ}$  E. and descend.

80.26 Intersect N. &amp; S. line, 14 lks. S. of cor. to secs.

15, 16, 17, 22 from which corner, I run

S.  $89^{\circ} 54'$  W. on a true line between sections 16 & 21Variation  $13^{\circ} 30'$  East

40.13 Set a post 3 ft. long, 3 ins. diam. with marked stone

12 ins. in the ground, for  $\frac{1}{4}$  Sec. Cor., marked  $\frac{1}{4}$  S. onN. face, dug pits, 18 x 18 x 12 ins., E. and W. of post  $5\frac{1}{2}$  ft. dist., and raised a mound of earth  $1\frac{1}{2}$  ft. high,  $3\frac{1}{2}$  ft. base around post.

80.20 The corner to sections 16, 17, 20, 21

Land mountainous

Soil 3<sup>rd</sup> rate

Timber of pine &amp; juniper

Vegetation. grass



Township *12 N.*

Range *19 E.*

Gila and Salt River Meridian.

Chains

North, between Sections 16 and 17.

Variation *13° 25'* East.

*Ascend.*

*4.00* Top of Ridge, bears *N. 86° E. & S. 86° W.* and descend.

*40.00* Set a post 3 ft. long, 3 ins. diam. with marked stone 12 ins. in the ground, for  $\frac{1}{2}$  Sec. Cor., marked  $\frac{1}{4}$  S. on *N.* face, dug pits, 18 x 18 x 12 ins., *N.* and *S.* of post  $5\frac{1}{2}$  ft. dist., and raised a mound of earth  $1\frac{1}{2}$  ft. high,  $3\frac{1}{2}$  ft. base around post.

*60.51* Cross Wash, 18 lks. wide, Course *N. 46° E.* and ascend.

*62.06* Cross Road, bears, *N. 60° E. & S. 60° W.*

*80.00* Set a post 4 ft. long, 4 ins. square, with marked stone 12 ins. in the ground, for Cor. to Secs, *8, 9, 16 & 17.* marked T, *12 N. S, 9*, on *N, E, R, 19 E. S. 10* on *S, E, S, 17* on *S, W, and S, 8* on *N, W, face* with *4 notches* on *S,* and *4 notches* on *E, edges,* dug pits 18 x 18 x 12 ins, in each Sec.,  $5\frac{1}{2}$  ft. dist., and raised a mound of earth 2 ft, high,  $4\frac{1}{2}$  ft, base around post.

*Land mountainous*

*Soil 9<sup>th</sup> rate*

*Timber of juniper & pine.*

*Vegetation. grass.*

Township

12 N

Range

19 E

Gila and Salt River Meridian.

Chains

East, on a random line between Sections 9 and 16.

Variation  $13^{\circ} 45'$  East.*Descend.*

22.00 Cross Road, bears,

N.  $6^{\circ}$  E. & S.  $84^{\circ}$  W.23.13 Cross Wash, 19 lks. wide, Course  $N. 40^{\circ} E$  and ascend.40.00 Set temporary  $\frac{1}{4}$  Sec. Cor.57.16 Top of Ridge, bears  $N. 43^{\circ} E$  &  $S. 43^{\circ} W$  and descend.

79.89 Intersect N. &amp; S. line, 10 lks. N. of cor. to secs.

9. 10. 16. 16 from which corner, I run

 $N. 89^{\circ} 56' W.$  on a true line between sections 9 & 10Variation  $13^{\circ} 30'$  East

39.94 Set a sand stone 16 x 10 x 6 ins., 10

ins. in the ground, for  $\frac{1}{4}$  Sec. Cor., marked  $\frac{1}{4}$  on N.

face, and raised a mound of stone alongside. Pits

impracticable.

from which

A Pine 4 ins. diam. bears  $S. 76^{\circ} E$  & 1 lks. dist.marked  $\frac{1}{4}$  S. B. T. No other trees within limits.

79.89 The corner to sections 8. 9. 16. 17

Land mountainous

Soil 3<sup>rd</sup> rate

Timber of pine.

Vegetation. grass.

Township

12 N

Range

19 E

Gila and Salt River

Meridian.

Chains

North, between Sections 8 and 9.

Variation

13° 45'

East.

Ascend.

40.00

Set a post 3 ft. long, 3 ins. diam. with marked stone  
12 ins. in the ground, for  $\frac{1}{2}$  Sec. Cor., marked  $\frac{1}{2}$  S. on  
W. face, dug pits, 18 x 18 x 12 ins., N and S. of  
post  $5\frac{1}{2}$  ft. dist., and raised a mound of earth  $1\frac{1}{2}$  ft.  
high,  $3\frac{1}{2}$  ft. base around post.

from which

A Pine 5 ins. diam. bears S. 35° E. 101 lks. dist.  
marked  $\frac{1}{2}$  S. P. T.

A Juniper 8 ins. diam. bears S. 60° W. 57 lks. dist.  
marked  $\frac{1}{2}$  S. B. T.

43.00

Top of Ridge, bears N. 50° E. & S. 50° W. and descend.

46.49

Cross Road, bears, N. 75° E. & S. 75° W.

80.00

Set a post 4 ft. long, 4 ins. square. 24 ins. in the ground,  
for Cor. to Secs. 4, 5, 8, 9 marked T. 12 N.  
S. 4 on N. E., R. 19 E., S. 9 on S. E., S. 8 on  
S. W., and S. 5 on N. W. faces, with 5 notches on  
S. and 4 notches on E. edges, from which

A Pine 6 ins. diam. bears N. 55° W. 80 lks. dist.  
marked T. 12 N. R. 19 E. S., 5 B. T.

A Pine 8 ins. diam. bears S. 62° W. 51 lks. dist.  
marked T. 12 N. R. 19 E. S., 8 B. T.

A Pine 10 ins. diam. bears S. 29° E. 50 lks. dist.  
marked T. 12 N. R. 19 E. S., 9 B. T.

A Pine 6 ins. diam. bears N. 38° E. 29 lks. dist.  
marked T. 12 N. R. 19 E. S., 4 B. T.  
Land mountainous.

Soil 2<sup>nd</sup> rate

Vegetation Grass.

Heavy timber of fern &amp; juniper.



Township 12 N Range 19 E

Gila and Salt River Meridian.

Chains

East, on a random line between Sections 4 and 9.

Variation  $14^{\circ} 15'$  East.*Descend.*40.00 Set temporary  $\frac{1}{4}$  Sec. Cor.

79.53 Intersect N. &amp; S. line, 16 lks. S. of cor. to secs.

3, 4, 9, &amp; 10 from which corner, I run

S. 89° 53' W. on a true line between sections 4 &amp; 9

Variation  $12^{\circ} 30'$  East

89.76 Set a post 3 ft. long, 3 ins. diam. with marked stone  
12 ins. in the ground, for  $\frac{1}{4}$  Sec. Cor., marked  $\frac{1}{4}$  S. on  
N. face, dug pits, 18 x 18 x 12 ins., E. and W. of  
post  $5\frac{1}{2}$  ft. dist., and raised a mound of earth  $1\frac{1}{2}$  ft.  
high,  $3\frac{1}{2}$  ft. base around post.

79.53 The corner to sections 4, 5, 8 &amp; 9

*Land rolling.**Soil 2<sup>nd</sup> & 3<sup>rd</sup> rate**Vegetation. grass.**Timber of pine.*

Township

R. N.

Range

19 0

Gila and Salt River

Meridian.

Chains

North, on a <sup>true</sup> random line between Sections 4 and 5.Variation  $14^{\circ} 15'$  East.

Descend.

39.90 Cross Wash, 21 lks. wide, Course  $N. 80^{\circ} E$  and ascend.40.00 Set a sand stone  $17 \times 9 \times 7$  ins., 12 ins. in the ground, for  $\frac{1}{4}$  Sec. Cor., marked  $\frac{1}{4}$  on W. face, and raised a mound of stone alongside. Pits impracticable.44.00 Intersect the  $3^{\circ}$  Standard Parallel ~~North~~ at a point 19.70 chs. East of the Standard Cor. to Secs. 32 and 33 T. 12 N. R. 19 E. at which point I

Set a post, 4 ft. long, 4 ins. square, 12 ins. in the ground, for <sup>approx</sup> Cor. to Secs. 4 and 5 - marked T. 12 N. R. 19 E., on S. S. 4 on E. and S. 5 on W. faces, with  $\frac{1}{4}$  notch on E. and  $\frac{1}{2}$  notch on W. faces, dug pits  $18 \times 18 \times 12$  ins. S. & E. of post,  $5\frac{1}{2}$  ft. dist. and raised a mound of earth 2 ft. high,  $4\frac{1}{2}$  ft. base around post.

Land rolling.

Soil  $3^{\circ}$  rate

Vegetation grass.

I carefully examined the adjustments of my solar compass to-day, particularly the latitude and reversing apparatus, and found them correct.

April 20. 1883

Township

12 N

Range

19 E

Gila and Salt River Meridian.

Chains *From the Co. to Secs. 5, 6, 31 & 32 previously set by me.*  
 North, between Sections 31 and 32 on S. Boundary

Variation *140° 00'* East.

Ascend.

*73.14* Top of Ridge, bears *N. 30° E. & S. W.* and descend.

*40.00* Set a sand stone *17 x 9 x 8 ins., 12*  
 ins. in the ground, for  $\frac{1}{4}$  Sec. Cor., marked  $\frac{1}{4}$  on *W.*  
 face, and raised a mound of stone alongside. Pits  
 impracticable.

*80.00* Marked a juniper *sin. dia. for ca. 10 sec. 30, 31, 32*  
 T. 12 N. S. 29, on N. E. R. 19 E. S. 32 on  
 S. E. S. 31, on S. W. and S. 30 on N. W. faces,  
 with 1 notch on S. and 5 notches on E. edges,  
 dug pits 18 x 18 x 12 ins. in each sec.  $5\frac{1}{2}$  ft. dist. and  
 raised a mound of earth around tree, for cor. to sec.

from which

A Pine 12 ins, diam. bears *S. 60° E.* 50 lks. dist.  
 marked T. 12 N. R. 19 E. S., 32 B. T.

A Juniper 8 ins. diam. bears *S. 53° W.* 40 lks. dist.  
 marked T. 12 N. R. 19 E. S., 31 B. T.

No other trees within limits.

Land mountainous

Soil *3<sup>rd</sup>* rate

Timber of *pine & juniper.*

Vegetation. *grass.*



Township 12 N. Range 19 E.  
 Gila and Salt River Meridian.

Chains East, on a random line between Sections 29 and 32.  
 Variation 14° 00' East.

*Ascend.*

7.82 Top of Ridge, bears N. 30° E. 30' W. and descend.  
 40.00 Set temporary  $\frac{1}{4}$  Sec. Cor.  
 79.57 Intersect N. & S. line, 16 lks. S. of cor. to secs.  
 28. 29. 32. 33 from which corner, I run  
 89. 53' W. on a true line between sections 29 & 32  
 Variation 14° 15' East

89.78 Set a post 3 ft. long, 3 ins. diam. with marked stone  
 12 ins. in the ground, for  $\frac{1}{4}$  Sec. Cor., marked  $\frac{1}{2}$  S. on  
 N. face, dug pits, 18 x 18 x 12 ins., E. and W. of  
 post  $5\frac{1}{2}$  ft. dist., and raised a mound of earth  $1\frac{1}{2}$  ft.  
 high,  $3\frac{1}{2}$  ft. base around post.

77.57 The corner to sections 29. 30. 31. 32

Land mountainous

Soil 3<sup>rd</sup> rate

Timber of Juniper

Vegetation. grass

Township 12 N. Range 19 E.  
 Gila and Salt River Meridian.

Chains West, on a random line between Sections 30 and 31.  
 Variation 14° 00' East.

Descend.

40.00 Set temporary  $\frac{1}{2}$  Sec. Cor.

78.81 Intersect W. B. of Tp. 39 lks. N. of cor. to secs. previously set by me.

25.30.31.30 from which corner, I run N. 89° 43' E. on a true line, between sections 30 & 31  
 Variation 14° 00' East.

38.81 Set a post 3 ft. long, 3 ins. diam. with marked stone 12 ins. in the ground, for  $\frac{1}{2}$  Sec. Cor., marked  $\frac{1}{2}$  S. on N. face, dug pits, 18 x 18 x 12 ins., E. and W. of post 5 $\frac{1}{2}$  ft. dist., and raised a mound of earth 1 $\frac{1}{2}$  ft. high, 3 $\frac{1}{2}$  ft. base around post.

78.81 The corner to sections 29.30.31.32

Land rolling.

Soil 3<sup>rd</sup> rate

Timber of pine & juniper.

Vegetation. grass.

Township 12 N. Range 19 E.

Gila and Salt River Meridian.

Chains

North, between Sections 29 and 30.

Variation 41° 00' East.

Descend.

35.50 Cross Wash, 19 lks. wide, Course N. 22° E. and ascend.40.00 Set a post 3 ft. long, 3 ins. diam. with marked stone 12 ins. in the ground, for  $\frac{1}{2}$  Sec. Cor., marked  $\frac{1}{2}$  S. on N. face, dug pits, 18 x 18 x 12 ins., N. and S. of post  $5\frac{1}{2}$  ft. dist., and raised a mound of earth  $1\frac{1}{2}$  ft. high,  $3\frac{1}{2}$  ft. base around post.80.00 Set a post 4 ft. long, 4 ins. square, with marked stone 12 ins. in the ground, for Cor. to Secs, 19. 20. 29. 30 marked T, 12 N. S. 20, on N, E, R, 19 E, S. 29 on S, E, S, 30 on S, W, and S, 19 on N, W, face with 2 notches on S, and 5 notches on E, edges, dug pits 18 x 18 x 12 ins, in each Sec.,  $5\frac{1}{2}$  ft. dist., and raised a mound of earth 2 ft. high,  $4\frac{1}{2}$  ft. base around post.

from which

A Pine 6 ins. diam. bears N. 46° W. 80 lks. dist. marked T. 12 N. R. 19 E. S., 19 B. T.A Juniper 10 ins. diam. bears N. 60° E. 15 lks. dist. marked T. 12 N. R. 19 E. S., 20 B. T.

No other trees within limits.

Land rolling.

Soil 3<sup>rd</sup> rateTimber of Yucca & juniper.Vegetation. grass.



Township

12 N. 7

Range

19 E

Gila and Salt River Meridian.

Chains

East, on a random line between Sections 20 and 29.

Variation

14° 15'

East.

Descend.

40.00

Set temporary  $\frac{1}{4}$  Sec. Cor.

44.10

Cross Wash, 50 lks. wide, Course N. 80° E and ascend.

79.73

Intersect N. &amp; S. line, 2' lks. N. of cor. to secs.

20. 21. 28. 29 from which corner, I run

N. 89° 51' W. on a true line between sections 20 &amp; 29

Variation

14° 15'

East

39.86

Set a Sand stone 16 x 11 x 7 ins., 10 ins. in the ground, for  $\frac{1}{4}$  Sec. Cor., marked  $\frac{1}{4}$  on N. face, dug pits 18 x 18 x 12 ins., E. and W. of stone 5 $\frac{1}{2}$  ft. dist., and raised a mound of earth 1 $\frac{1}{2}$  ft. high, 3 $\frac{1}{2}$  ft. base alongside.

79.73

The corner to sections 19. 20. 29. 30

Land rolling.

Soil

3<sup>rd</sup>

rate

Vegetation

grass.

Timber of

Yucca &amp; juniper.

Township R. N. Range 19

Gila and Salt River Meridian.

Chains

West, on a random line between Sections 19 and 30.

Variation 14° 15' East.*Ascend.*40.00 Set temporary  $\frac{1}{4}$  Sec. Cor.78.40 Intersect N. B. of Tp. 14 lks. N. of cor. to secs.  
previously set by me.19. 24. 25. 30 from which corner, I runN. 89° 54' on a true line, between sections 19 & 30Variation 13° 45' East.38.40 Set a post 3 ft. long. 3 ins. diam. with marked stone  
12 ins. in the ground, for  $\frac{1}{4}$  Sec. Cor., marked  $\frac{1}{4}$  S. on  
N. face, dug pits, 18 x 18 x 12 ins., E. and W. of  
post  $5\frac{1}{2}$  ft. dist., and raised a mound of earth  $1\frac{1}{2}$  ft.  
high,  $3\frac{1}{2}$  ft. base around post.

78.40 The corner to sections 19. 20. 29. 30

Land rolling.

Soil 3<sup>rd</sup> rateTimber of JuniperVegetation. grass

Township

12 North

Range

19 East

Gila and Salt River Meridian.

Chains

North, between Sections 19 and 20.

Variation

14° 16'

East.

*Ascend.*

16.00 Top of Ridge, bears N. 41° E. &amp; S. 41° W. and descend.

40.00 Set a Granite stone 17 x 9 x 4 ins., 12 ins. in the ground, for  $\frac{1}{4}$  Sec. Cor., marked  $\frac{1}{4}$  on W. face, and raised a mound of stone alongside. Pits impracticable.

54.30 Cross Wash, 24 lks. wide, Course N. 62° E. and ascend.

77.50 Cross Road, bears, N. 65° E. &amp; S. 65° W.

80.00 Set a post 4 ft. long, 4 ins. square, with marked stone 12 ins. in the ground, for Cor. to Secs, 17, 18, 19, 20 marked T, R, N, S, 17, on N, E, R, 19 E, S, 20 on S, E, S, 19 on S, W, and S, 18 on N, W, face with 3 notches on S, and 5 notches on E, edges, dug pits 18 x 18 x 12 ins, in each Sec., 5½ ft. dist., and raised a mound of earth 2 ft. high, 4½ ft. base around post.

Land mountainous

Soil 2<sup>nd</sup> rate

Timber of juniper &amp; pine.

Vegetation. Grass.



Township

12 N.

Range

19 E.

Gila and Salt River Meridian.

Chains

East, on a random line between Sections 17 and 20.

Variation

13° 30'

East.

*Descend.*

2.56 Cross Road, bears N. 10° E. &amp; S. 11° W.

19.30 Cross Wash, 21 lks. wide, Course N. 33° E. and ascend.

32.40 Top of Spur, bears N. 6° E. and descend.

37.00 Cross Wash, 17 lks. wide, Course N. and ascend.

40.00 Set temporary  $\frac{1}{4}$  Sec. Cor.

64.00 Top of Ridge, bears N. 3° E. &amp; S. 3° W. and descend.

80.09 Intersect N. &amp; S. line, 20 lks. S. of cor. to secs.

16. 17. 20. 21 from which corner, I run

S. 89° 49' W. on a true line between sections 17 &amp; 20

Variation

13° 28'

East

40.04 Set a post 3 ft. long. 3 ins. diam. with marked stone  
12 ins. in the ground, for  $\frac{1}{4}$  Sec. Cor., marked  $\frac{1}{4}$  S. on  
N. face, dug pits, 18 x 18 x 12 ins., E. and W. of  
post  $5\frac{1}{2}$  ft. dist., and raised a mound of earth  $1\frac{1}{2}$  ft.  
high,  $3\frac{1}{2}$  ft. base around post.

80.09 The corner to sections 17. 18. 19. 20

Land mountainous

Soil 3<sup>50</sup> rate

Timber of Juniper &amp; pine

Vegetation. grass

Township

12 N. 107

Range

19 E. 107

Gila and Salt River Meridian.

Chains

West, on a random line between Sections 18 and 19.

Variation

13° 30'

East.

*Ascend.*40.00 Set temporary  $\frac{1}{2}$  Sec. Cor.

65.30 Top of Ridge, bears N. 59° E. &amp; S. 59° W. and descend.

78.35 Intersect W. B. of Tp. 33 lks. S. of cor. to secs.

13. 18. 19. 24 <sup>previously set by me.</sup> from which corner, I runS. 89° 46' E. on a true line, between sections 18 & 19  
Variation 13° 45' East.

38.35 Set a post 3 ft. long. 3 ins. diam. with marked stone  
12 ins. in the ground, for  $\frac{1}{2}$  Sec. Cor., marked  $\frac{1}{2}$  S. on  
N. face, dug pits, 18 x 18 x 12 ins., E. and W. of  
post 5  $\frac{1}{2}$  ft. dist., and raised a mound of earth 1  $\frac{1}{2}$  ft.  
high, 3  $\frac{1}{2}$  ft. base around post.

78.35 The corner to sections 17. 18. 19. 20

Land mountainous

Soil <sup>2<sup>nd</sup></sup> rate

Timber of juniper.

Vegetation. grass.

Township 12 N. Range 19 E.

Gila and Salt River Meridian.

Chains

North, between Sections 17 and 18.

Variation 13° 30' East.*Ascend.*34.18 Top of Ridge, bears N. 71° E. & S. 71° W. and descend.40.00 Set a post 3 ft. long, 3 ins. diam. with marked stone 12 ins. in the ground, for  $\frac{1}{2}$  Sec. Cor., marked  $\frac{1}{2}$  S. on W. face, dug pits, 18 x 18 x 12 ins., N. and S. of post  $5\frac{1}{2}$  ft. dist., and raised a mound of earth  $1\frac{1}{2}$  ft. high,  $3\frac{1}{2}$  ft. base around post.80.00 Set a post 4 ft. long, 4 ins. square, with marked stone 12 ins. in the ground, for Cor. to Secs, 7. 8. 17. 18 marked T, R N. S. 8, on N, E, R, 19 E. S. 17 on S, E, S, 18 on S, W, and S, 7 on N, W, face with 5 notches on S, and 5 notches on E, edges, dug pits 18 x 18 x 12 ins, in each Sec.,  $5\frac{1}{2}$  ft, dist., and raised a mound of earth 2 ft, high,  $4\frac{1}{2}$  ft, base around post.

Land mountainous

Soil 2<sup>nd</sup> rateTimber of juniper.Vegetation. grass.

April 21. 1883



Township

12 N

Range

19 E

Gila and Salt River Meridian.

Chains

East, on a random line between Sections 8 and 17.

Variation 13° 30' East.

*Ascend.*40.00 Set temporary  $\frac{1}{4}$  Sec. Cor.

62.18 Top of Ridge, bears N. 43° E. S. 43° and descend.

80.80 Intersect N. &amp; S. line, 8 lks. S. of cor. to secs.

8. 9. 16. 17 from which corner, I run

S. 87° 57' W. on a true line between sections 8 &amp; 17

Variation 13° 45' East

40.15 Set a post 3 ft. long, 3 ins. diam. with marked stone  
12 ins. in the ground, for  $\frac{1}{4}$  Sec. Cor., marked  $\frac{1}{4}$  S. on  
N. face, dug pits, 18 x 18 x 12 ins., E. and W. of  
post 5  $\frac{1}{2}$  ft. dist., and raised a mound of earth 1  $\frac{1}{2}$  ft.  
high, 3  $\frac{1}{2}$  ft. base around post.

80.30 The corner to sections 7. 8. 17. 18

Land mountainous

Soil 3<sup>rd</sup> rate

Timber of Juniper.

Vegetation, grass.

Township 12 N Range 19 E

Gila and Salt River Meridian.

Chains

West, on a random line between Sections 7 and 18.

Variation 13° 30' East.*Descend.*

11.11 Cross Wash, 110 yds. wide, Course N. 11° W and ascend.

24.20 Cross Road, bears N. 67° E. &amp; S. 67° W.

38.13 Top of Spur, bears N. &amp; S. and descend.

40.00 Set temporary  $\frac{1}{2}$  Sec. Cor.

67.00 Enter Valley, bears N. 15° W.

78.48 Intersect W. B. of Tp. 19 yds. N. of cor. to secs.

*previously set by me,*  
7. 12. 13. 18 from which corner, I run

N. 89° 52' E on a true line, between sections 7 &amp; 18

Variation 13° 45' East.

38.48 Set a post 3 ft. long, 3 ins. diam. with marked stone  
12 ins. in the ground, for  $\frac{1}{2}$  Sec. Cor., marked  $\frac{1}{2}$  S. on  
N. face, dug pits, 18 x 18 x 12 ins., E. and W. of  
post  $5\frac{1}{2}$  ft. dist., and raised a mound of earth  $1\frac{1}{2}$  ft.  
high,  $3\frac{1}{2}$  ft. base around post.

78.48 The corner to sections 7, 8, 17, 18

Land mountainous level.

Soil 2<sup>nd</sup> rateTimber of JuniperVegetation. grass.

Township 12 N Range 19 E

Gila and Salt River Meridian.

Chains

North, between Sections 7 and 8.

Variation 13° 30' East.

Descend.

15.30 Cross-Road, bears, N. 70° E. & S. 70° W.

40.00 Set a post 3 ft. long. 3 ins. diam. with marked stone 12 ins. in the ground, for  $\frac{1}{4}$  Sec. Cor., marked  $\frac{1}{4}$  S. on W. face, dug pits, 18 x 18 x 12 ins., N. and S. of post  $5\frac{1}{2}$  ft. dist., and raised a mound of earth  $1\frac{1}{2}$  ft. high,  $3\frac{1}{2}$  ft. base around post.

76.10 Cross Wash, 19 lks. wide, Course N. 50° E.

80.00 Set a post 4 ft. long, 4 ins. square, with marked stone 12 ins. in the ground, for Cor. to Secs, 5, 6, 7, 8 marked T, 12 N. S. 5, on N, E, R, 19 E. S. 8 on S, E, S, 7 on S, W, and S, 6 on N, W, face with 5 notches on S, and 5 notches on E, edges, dug pits 18 x 18 x 12 ins, in each Sec.,  $5\frac{1}{2}$  ft, dist., and raised a mound of earth 2 ft, high,  $4\frac{1}{2}$  ft, base around post.

from which

A Pine 8 ins, diam. bears N. 34° E. 33 lks. dist. marked T. 12 N. R. 19 E. S. 5 B. T.

A Pine 10 ins, diam. bears N. 62° W. 1.39 lks. dist. marked T. 12 N. R. 19 E. S. 6 B. T.

A Juniper 12 ins. diam. bears N. 47° E. 1.92 lks. dist. marked T. 12 N. R. 19 E. S., 8 B. T.

No other trees within limits.

Soil 1<sup>st</sup> rate

Timber of pine & juniper

Vegetation. grass.

Land rolling.



Township

12 N.

Range

19 E.

Gila and Salt River Meridian.

Chains

East, on a random line between Sections 5 and 8.

Variation  $14^{\circ} 30'$  East.

Descend.

3.20 Cross Wash, 17 lks. wide, Course N. E.

40.00 Set temporary  $\frac{1}{4}$  Sec. Cor.

79.82 Intersect N. &amp; S. line, 34 lks. S. of cor. to secs.

4. 5. 8. 9 from which corner, I run

 $S. 89^{\circ} 45' W.$  on a true line between sections 5 & 8Variation  $14^{\circ} 15'$  East

39.91 Set a post 3 ft. long, 3 ins. diam 24 ins. in the ground,  
for  $\frac{1}{4}$  Sec. Cor., marked  $\frac{1}{4}$  S. on N. face; from which  
A Pine 10 ins, diam. bears  $S. 51^{\circ} E.$  57 lks. dist.  
marked  $\frac{1}{4}$  S. B. T.

A Pine 8 ins, diam. bears  $S. 71^{\circ} W.$  70 lks. dist.  
marked  $\frac{1}{4}$  S. B. T.

79.82 The corner to sections 5, 6, 7, 8

Land rolling.

Soil 2<sup>nd</sup> rate

Timber of pine

Vegetation. Grass.

Township

12 N.

Range

19 E.

Gila and Salt River Meridian.

Chains

West, on a random line between Sections 6 and 7.

Variation  $14^{\circ} 30'$  East.*Descend.*26.30 Cross Wash, 16 lks. wide, Course  $N. 50^{\circ} E$  and ascend.40.00 Set temporary  $\frac{1}{4}$  Sec. Cor.78.90 Intersect W.B. of Tp. 28 lks. S. of cor. to secs.  
previously set by me.

1. 6. 7. 12 from which corner, I run

S.  $89^{\circ} 48'$  on a true line, between sections 6 & 7Variation  $13^{\circ} 45'$  East.

38.90 Set a post 3 ft. long. 3 ins. diam. with marked stone  
12 ins. in the ground, for  $\frac{1}{4}$  Sec. Cor., marked  $\frac{1}{4}$  S. on  
N. face, dug pits, 18 x 18 x 12 ins., E. and W. of  
post  $5\frac{1}{2}$  ft. dist., and raised a mound of earth  $1\frac{1}{2}$  ft.  
high,  $3\frac{1}{2}$  ft. base around post.

78.90 The corner to sections 5. 6. 7. 8

Land rolling.

Soil 7<sup>th</sup> rate

Vegetation grass.

Township R N. Range 19 0  
Gila and Salt River Meridian.

Chains

North, on a <sup>true.</sup> ~~random~~ line between Sections 5 and 6.

Variation 14° 30' East.

Descend.

14.00 Cross Wash, 25 lks. wide, Course N. 60° E. and ascend.

42.00 A Pine 8 ins, diam. which I marked  $\frac{1}{2}$  S. on W. face, for  $\frac{1}{2}$  Sec. Cor.; from which

A Pine 10 ins, diam. bears S. 69° W. 47 lks. dist. marked  $\frac{1}{2}$  S. B. T.

A Pine 9 ins, diam. bears S. 52° E. 31 lks. dist. marked  $\frac{1}{2}$  S. B. T.

43.70 Intersect the 3<sup>rd</sup> Standard Parallel <sup>North</sup> at a point 19.55 chs. West of the Standard Cor.  <sup>$\frac{1}{2}$  Sec.</sup> on S. B. T. <sup>Previously described by one</sup> R. N. R. 19 E. at which point I.

Set a post, 4 ft. long, 4 ins. square, 12 ins. in the ground, for <sup>Corner</sup> Cor. to Secs. 5 and 6 marked 66. T. 2 N. R. 19 E., on S. S. 5 on E. and S. 6 on W. faces, with 5 notches on E. and 1 notch on W. faces, dug pits 18 x 18 x 12 ins. 1/2 E. W. of post,  $5\frac{1}{2}$  ft. dist. and raised a mound of earth 2 ft. high,  $4\frac{1}{2}$  ft. base around post.

Land rolling.

Soil 3<sup>rd</sup> rate

Timber of Pine.

Vegetation. Grass.

I carefully examined the adjustments of my solar compass to-day, particularly the latitude and reversing apparatus, and found them correct.

April 23. 1883



## GENERAL DESCRIPTION.

The surface of this Tp. is high and broken in the East and North East parts. From the center towards the West it is rolling, and on the West boundary it breaks off into a fine valley.

There is a deep canyon commencing on the South boundary about the center of sec. 33 and runs north east through the Tp. It is called snowflake wash.

There is some good timber in this Tp. mostly juniper and Pine.

This grows in thick bunches and can be found in all parts.

The grass is fine in most parts, especially in the west.

The soil is very rocky in the parts along the canyon. In other places it is sand and gravel mixed, except along the west boundary, here it is fine soil, and can be classed as 1<sup>st</sup> rate. In other parts it is from 2<sup>nd</sup> to 3<sup>rd</sup> rate.

For Trial notes  
see Book No 14

## U. S. Surveyor General's Office,

TUCSON, ARIZONA

July 31, 1883,

The foregoing Field Notes of the Survey of the

Subdivision Lines of  
Township 12 N. R. 19 East

Of the Gila and Salt River Base and Meridian, Arizona, execu-  
ted by A. R. Lee

Deputy Surveyor, under his contract of the

25<sup>th</sup>

day of

July

, 1882, having been

critically examined and the necessary corrections and explana-  
tions made, the said Field Notes and the surveys they describe  
are hereby approved.

*J. W. P. Smith*

Surveyor General.

Township No. 12 N Range No. 13 E 4th 9 Sec + 10 Meridian.

2045  
80  
1965  
7876

BOOK 107

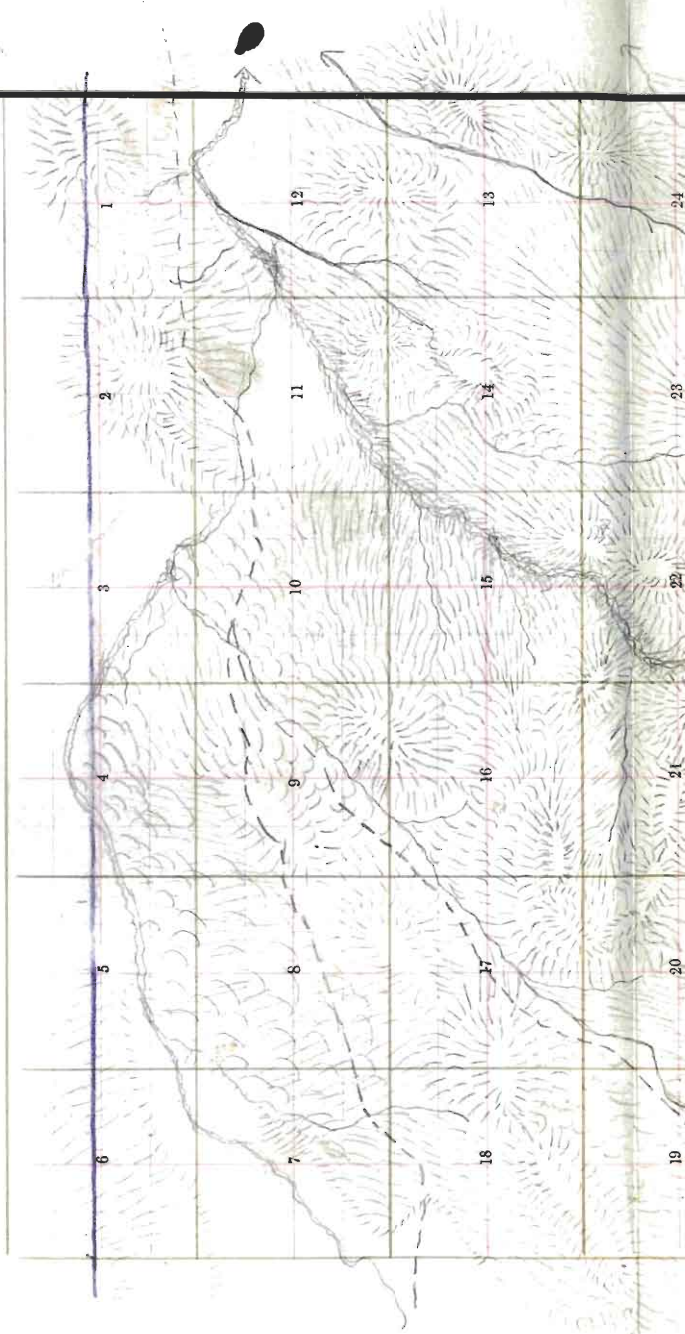

68



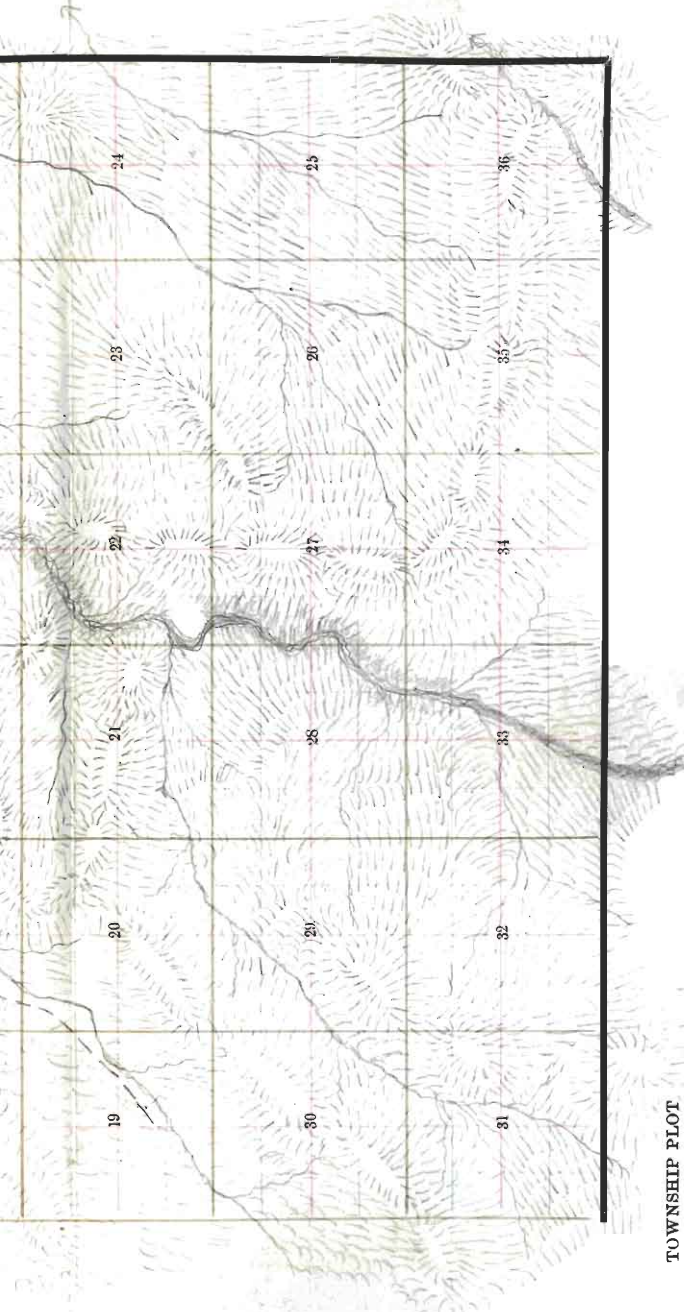

**TOWNSHIP PLOT**

*Meridian Line,*

*Base Line,*

*Standard Line,*

*Township Lines,*

*Section Lines,*

*Meander Lines,*

*Office Work.*