

~~Book No. 14~~

BOOK 162

Henry Meyrick Jr.
1883

Henry Meyrick Jr. Deputy Surveyor.
14 N. R. 18 E.

BOOK 162

Gila and Salt River Meridian.

No-162

FIELD NOTES

OF

THE SUBDIVISION LINES OF

Township *14 N.* Range *18 E.*

Gila and Salt River Meridian.

BY

Henry Meyrick Jr. Deputy Surveyor.

Under his Contract of *July 28th* 1882

Survey Commenced *June 1st* 1883

Survey Completed *June 5th* 1883

No-162

Platted,
Copied for Washington,
Copied for Register,

162

Edward Denny & Co., Stationers & Printers, S. F. Cal.

Copyright Secured.

Entered according to Act of Congress, in the Clerk's Office of the Librarian of Congress at Washington, D. C., in the year 1880.

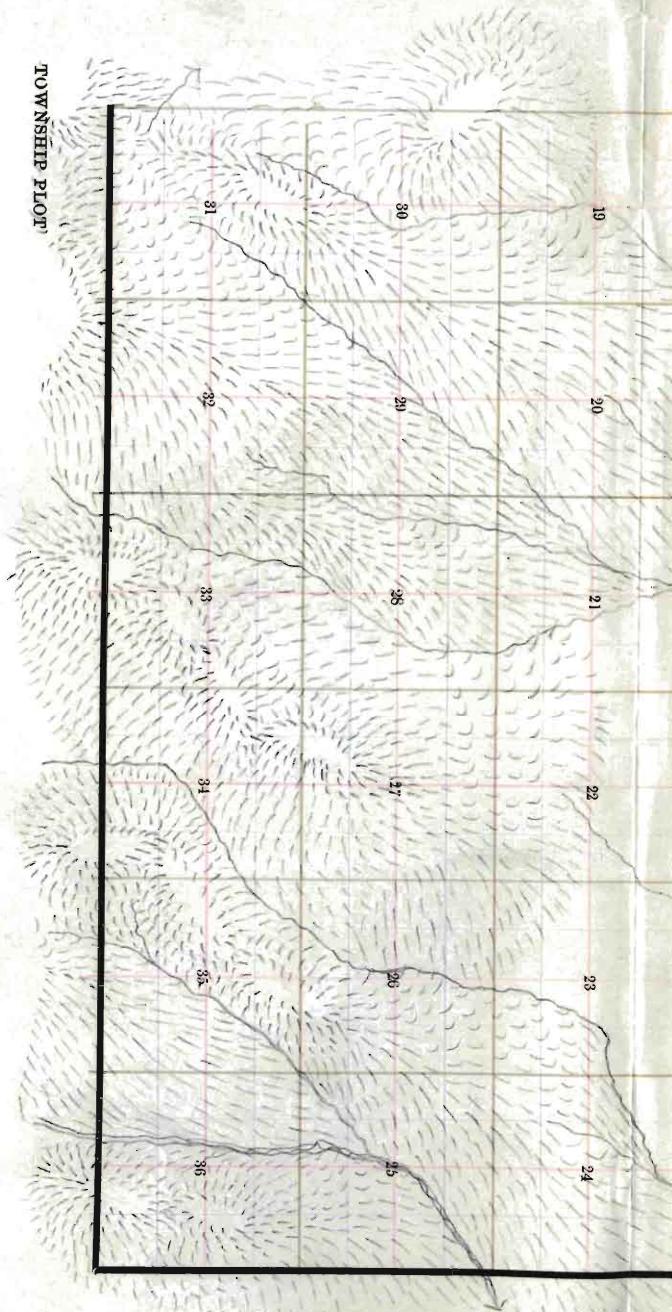

TOWNSHIP PLOT

- Meridian Line,**
- Base Line,**
- Standard Line,**
- Township Lines,**
- Section Lines,**
- Meander Lines,**
- Office Work.**

BOOK 162
BOOK 162

Township No. 14 N Range No. 16 E 3rd 6th Meridian.

Edward Denny & Co., Stationers and Printers, Drawing Material, No. 512 So. 1st St., S. F.

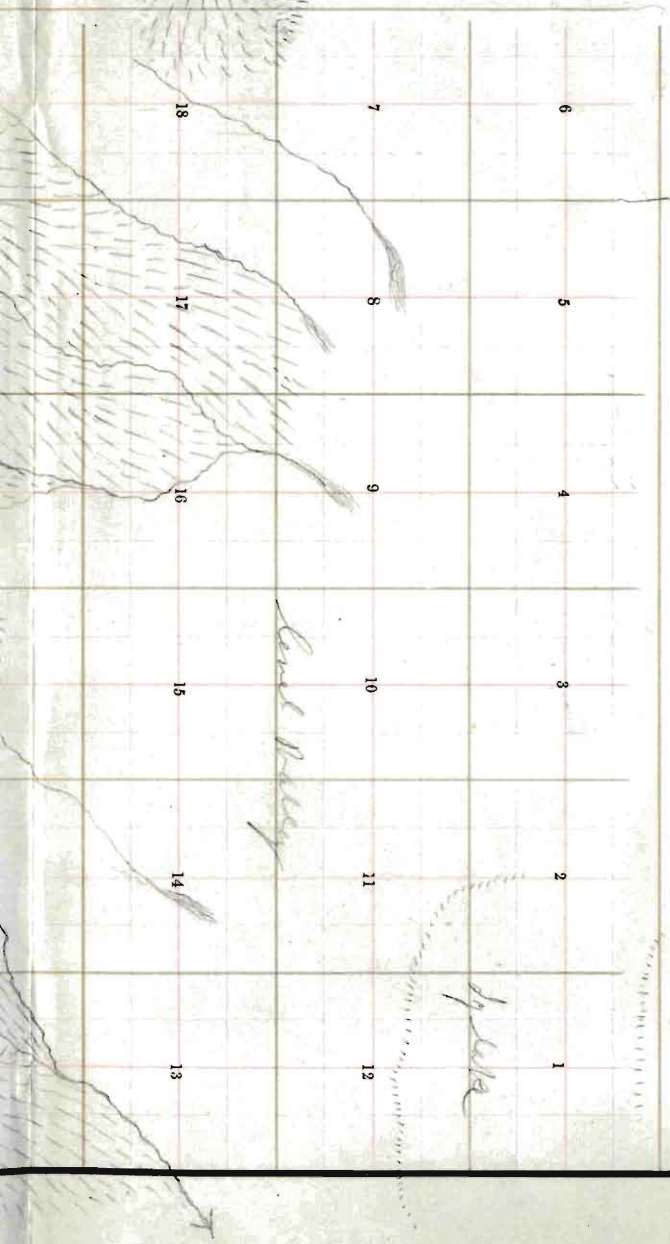

Table showing the difference of latitude and departure in running 80 chains at any course from 1 to 60 minutes.

Minutes.	Lks.	Minutes.	Lks.	Minutes.	Lks.
1	2½	21	49	41	95½
2	4½	22	51½	42	98
3	7	23	53½	43	100½
4	9½	24	56	44	102½
5	11½	25	58½	45	105
6	14	26	60½	46	107½
7	16½	27	63	47	109½
8	18½	28	65½	48	112
9	21	29	67½	49	114½
10	23½	30	70	50	116½
11	25½	31	72½	51	119
12	28	32	74½	52	121½
13	30½	33	77	53	123½
14	32½	34	79½	54	126
15	35	35	81½	55	128½
16	37½	36	84	56	130½
17	39½	37	86½	57	133
18	42	38	88½	58	135½
19	44½	39	91	59	137½
20	46½	40	93½	60	140

PUBLISHED BY

EDWARD DENNY & CO.

DRAWING PAPER & MATERIAL, MATHEMATICAL INSTRUMENTS, ETC.,
 STATIONERS AND PRINTERS,
 SAN FRANCISCO, CAL.

Table for Running on Slopes.

In the following table the first column shows the angle, the second, the number of links to be added to a chain on the slopes, to make one chain. horizontal measurement.

Angle.	Cor. in links.	Angle.	Cor. in links.	Angle.	Cor. in links.	Angle.	Cor. in links.
0		0		0		0	
4	0-24	11	1-88	18	5-14	25	10-54
5	0-38	12	2-24	19	5-76	26	11-26
6	0-55	13	2-63	20	6-42	27	12-24
7	0-76	14	3-06	21	7-11	28	13-37
8	0-98	15	3-53	22	7-85	29	14-34
9	1-24	16	4-02	23	8-64	30	15-47
10	1-55	17	4-56	24	9-47	35	22-07

Henry Meppick Jr. Deputy Surveyor.
T. 14 N. **R.** 18 E.

Gila and Salt River Meridian.

No-162
FIELD NOTES

OF

THE SUBDIVISION LINES OF

Township 14 N. Range 18 E.

Gila and Salt River Meridian.

BY

Henry Meppick Jr. Deputy Surveyor.
 Under his Contract of July 28th 1882
 Survey Commenced June 1st 1883
 Survey Completed June 5th 1883

*Platted,
 Copied for Washington,
 Copied for Register,*

Edward Denny & Co., Stationers & Printers, S. F. Cal.

Copyright Secured,

Entered according to Act of Congress, in the Clerk's Office of the Librarian of Congress
 at Washington, D. C., in the year 1880.

1B

Township 14 North, Range 18 East.

Gila and Salt River Basins Meridian.

6	60	5	44	4	33	3	22	2	11	1
59		58		43		32		21		10
7	57	8	42	9	31	10	20	11	9	12
53		55		41		30		19		8
18	54	17	40	16	29	15	18	14	7	13
53		52		39		28		17		6
19	51	20	38	21	27	22	16	23	5	24
50		49		37		26		15		4
30	48	29	36	28	25	27	14	26	3	25
47		46		35		24		13		2
31	45	32	34	33	23	34	12	35	1	36

D.K.

Edward Denny & Co., Stationers & Printers, S. F., Cal.

Copyright Secured,

Entered according to Act of Congress, in the Clerk's Office of the Librarian of Congress at Washington, D. C., in the year 1880.

Township.....

Range.....

BOOK 162

10

..... Meridian.

No-162

For Preliminary Data
and description of instrument
used see Book No. 1

Survey made with Burt's Patent Improved Solar
Compass,¹² nearly new, and in first rate order. Made
by Otto Gennel of Basel
Germany in 1881.

Before proceeding to subdivide this Tp., I made a
change of 0 minutes in the latitude arc of my
solar compass by subtracting same from
the reading previously given, and at noon verified
and corrected same by observation on the sun. I also
further tested instrument by reversing.

Chains From the corner to Sections 35, 36, 1 and 2 on the South boundary, $\frac{1}{2}$ p.

Which is a sand stone
 24 x 16 x 4 ins.; 18 ins. in
 the ground, marked
 with 1 notch on E. and
 5 notches on W. edge, and
 a mound of stone alongside.

From North between sections 35 & 36

Variation $14^{\circ} 00'$ East.

Descend.

40.00 Set a post 3 ft. long, 3 ins. diam. with marked stone
 12 ins. in the ground, for $\frac{1}{4}$ Sec. Cor., marked $\frac{1}{4}$ S. on
 W. face, dug pits, 18 x 18 x 12 ins., N. and S. of
 post $5\frac{1}{2}$ ft. dist., and raised a mound of earth $1\frac{1}{2}$ ft.
 high, $3\frac{1}{2}$ ft. base around post.

78.83 Cross Wash, 19 lks. wide, Course $N. 51^{\circ} E$ and ascend.

80.00 Set a Sand stone 18 x 12 x 6 ins. 12 ins.
 in the ground for Cor. to Secs. 25, 26, 35 & 36 marked
 with 1 notch on S. and 1 notch on E. edges,
 dug pits 18 x 18 x 12 ins. in each Sec., $5\frac{1}{2}$ ft. dist. and
 raised a mound of earth 2 ft. high, $4\frac{1}{2}$ ft. base. alongside.

Land hilly.

Soil 2nd rate

Undergrowth of juniper.

Chains East, on a random line between Sections 25 and 36.
 Variation 14° 00' East.

Descend.

- 290 **Gross Wash**, 20 lks. wide. Course N. 52° W.
- 3489 **Gross Creek** 43 lks. wide. Course N. 10° E. and ascend.
- 40.00 Set temporary $\frac{1}{2}$ Sec. Cor.
- 63.12 Top of Spur, bears N. & S. and descend.
- 80.11 Intersect E. B. of Tp. 51 lks. S. of cor. to secs.
- 25.30.31 & 30

Which is a post 4 ft. long, 4 ins. square, 12 ins. in the ground, marked T. 14 N., S. 30 on N. E., R. 14 E., S. 31 on S. E., R. 18 E., S. 30 on S. W. and S. 25 on N. W. face, with 1 notch on S. and 5 notches on N. edge with pits 18 x 18 x 12 ins. in each sec, 5 1/2 ft. dist; and a mound of earth 2 ft. high, 4 1/2 ft. base around post: from which

- A Cedar 6 ins. diam, bears S. 23° W. 50 lks, dist, marked T. 14 N. R. 18 E. S., 30 B. T.
- A Cedar 8 ins. diam, bears S. 89° E. 57 lks, dist, marked T. 14 N. R. 19 E. S., 31 B. T.
- A Cedar 8 ins. diam, bears N. 75° W. 4 lks, dist, marked T. 14 N. R. 18 E. S., 25 B. T.

from which corner, I run S. 89° 38' W. on a true line, between sections 25 & 30
 Variation 14° 00' East.

- 40.05 Set a post 3 ft. long, 3 ins. diam. with marked stone 12 ins. in the ground, for $\frac{1}{2}$ Sec. Cor., marked $\frac{1}{2}$ S. on N. face, dug pits, 18 x 18 x 12 ins., E. and W. of post 5 1/2 ft. dist., and raised a mound of earth 1 1/2 ft. high, 3 1/2 ft. base around post.
- The corner to sections 25, 26, 35 & 36.

Land rolling. 2000. Rate of undergrowth of soil

Township 14 N Range 18 E

Gila and Salt River Meridian.

BOOK 162

Chains

North, between Sections 25 and 26.

Variation 14° 00' East.*Ascend.*

40.00

Set a Sand stone $14 \times 11 \times 8$ ins., 10 ins. in the ground, for $\frac{1}{4}$ Sec. Cor., marked $\frac{1}{4}$ on W. face, dug pits $18 \times 18 \times 12$ ins., N. and S. of stone $5\frac{1}{2}$ ft. dist., and raised a mound of earth $1\frac{1}{2}$ ft. high, $3\frac{1}{2}$ ft. base alongside.

46.31

Top of Spur, bears $N. 35^\circ E.$ & $S. 35^\circ W.$ and descend.

80.00

Set a post 4 ft. long, 4 ins. square, with marked stone 12 ins. in the ground, for Cor. to Secs, 23, 24, 25 & 26 marked T, 14 N. S. 24, on N, E, R, 18 E., S. 20 on S, E, S, 26 on S, W, and S, 23 on N, W, face with 2 notches on S, and 1 notch on E, edges, dug pits $18 \times 18 \times 12$ ins, in each Sec., $5\frac{1}{2}$ ft, dist., and raised a mound of earth 2 ft, high, $4\frac{1}{2}$ ft, base around post.

*Land rolling.*Soil 3rd rateVegetation grass & sage.

Township

14 N.

Range

18 E.

BOOK 162

Gila and Salt River Meridian.

Chains

East, on a random line between Sections 24 and 25.

Variation $13^{\circ} 50'$ East.*Ascend.*20.33 Top of Spur, bears $N. 43^{\circ} E. 654.3$ and descend.40.00 Set temporary $\frac{1}{4}$ Sec. Cor.

80.42 Intersect E. B. of Tp. 14 lks. S. of cor. to secs.

19, 24, 25 & 30

Which is a post 4 ft. long, 4 ins. sq.
12 ins. in the ground, marked

S. 14 N. S. 19 on N. E. R. 19 E. S. 30 on

S. E. R. 18 E. S. 25 on S. W. and S. 24 on W. W. face,

with 2 notches on S. and 4 notches on N. edges,
with peds. $18 \times 18 \times 12$ ins. in each sec. $5\frac{1}{2}$ ft. dist.
and a mound of earth 2 ft. high $4\frac{1}{2}$ ft. base around

post.

from which corner, I run

S. $89^{\circ} 54' W.$ on a true line, between sections 24 & 25Variation $14^{\circ} 00'$ East.

40.21 Set a post 3 ft. long. 3 ins. diam. with marked stone

12 ins. in the ground, for $\frac{1}{4}$ Sec. Cor., marked $\frac{1}{4}$ S. onN. face, dug pits, $18 \times 18 \times 12$ ins., E. and W. ofpost $5\frac{1}{2}$ ft. dist., and raised a mound of earth $1\frac{1}{2}$ ft.high, $3\frac{1}{2}$ ft. base around post.

80.42 The corner to sections 23, 24, 25 & 26

Land hilly.

Soil 3rd rate

Undergrowth of Juniper.

5 Township 14 N. Range 18 E.

Gila and Salt River Meridian.

BOOK 162

Chains

North, between Sections 23 and 24.

Variation 14.00 East.

Descend gradually.

40.00

Set a post 3 ft. long, 3 ins. diam. with marked stone 12 ins. in the ground, for 1/2 Sec. Cor., marked 1/2 S. on W. face, dug pits, 18 x 18 x 12 ins., N. and S. of post 5 1/2 ft. dist., and raised a mound of earth 1 1/2 ft. high, 3 1/2 ft. base around post.

63.41

Cross Wash, 10 lks. wide, Course N. 68° E.

80.00

Set a post 4 ft. long, 4 ins. square, with marked stone 12 ins. in the ground, for Cor. to Secs, 13, 14, 23 & 24 marked T, 14 N. S, 13, on N, E, R, 18 E., S. 24 on S, E, S, 23 on S, W, and S, 14 on N, W, face with 3 notches on S, and 1 notch on E, edges, dug pits 18 x 18 x 12 ins, in each Sec., 5 1/2 ft, dist., and raised a mound of earth 2 ft, high, 4 1/2 ft, base around post.

Land rolling.

Soil 300 rate

Undergrowth of Juniper.

Henry Meyrick June 1. 1883

Township 14 N. Range 18 E.
 BOOK 162 Gila and Salt River Meridian.

Chains

East, on a random line between Sections 13 and 24.

Variation $14^{\circ} 00'$ East.

Descend.

40.00 Set temporary $\frac{1}{4}$ Sec. Cor.

45.08 Cross Wash. 30 lks. wide, Course N. E.

80.13 Intersect E. B. of Tp. 27 lks. S, of cor. to secs.

S. 18, 19 & 24

Which is a post 4 ft. long, 4 ins. sq. with 12 ins. in the ground, marked S. 14 N. S. 18 on N. E., R. 19 E., S. 19 on S. E., R. 18 E., S. 24 on S. W. and S. 13 on N. W. faces, with 3 notches on S. and 3 notches on N. edges, with pits 18 x 18 x 12 ins. in each Sec. $5\frac{1}{2}$ ft. dist., and a mound of earth 2 ft. high, $4\frac{1}{2}$ ft. base around ^{feet} from which corner, I run

S. 89.48 W. on a true line, between sections 13 & 24

Variation $14^{\circ} 00'$ East.

40.00 Set a sand store 10 x 13 x 5 ins., 10 ins. in the ground, for $\frac{1}{4}$ Sec. Cor., marked $\frac{1}{4}$ on N. face, dug pits 18 x 18 x 12 ins., E. and W. of stone $5\frac{1}{2}$ ft. dist., and raised a mound of earth $1\frac{1}{2}$ ft. high, $3\frac{1}{2}$ ft. base alongside.

80.13 The corner to sections 13, 14, 23 & 24

Land rolling.

Soil 1^{st} - 2^{nd} rate

Vegetation grass & sage.

Township 14 N. Range 18 E.

BOOK 162

Gila and Salt River Meridian.

Chains

North, between Sections 13 and 14.

Variation 11° 00' East.*Over rolling land.*

40.00

Set a post 3 ft. long, 3 ins. diam. with marked stone 12 ins. in the ground, for $\frac{1}{4}$ Sec. Cor., marked $\frac{1}{4}$ S. on W. face, dug pits, 18 x 18 x 12 ins., N. and S. of post $5\frac{1}{2}$ ft. dist., and raised a mound of earth $1\frac{1}{2}$ ft. high, $3\frac{1}{2}$ ft. base around post.

80.00

Set a post 4 ft. long, 4 ins. square, with marked stone 12 ins. in the ground, for Cor. to Secs, 11, 12, 13 & 14 marked T, 14 N. S. 12, on N, E, R, 18 E, S. 13 on S, E, S, 14 on S, W, and S, 11 on N, W, face with 4 notches on S, and 1 notch on E, edges, dug pits 18 x 18 x 12 ins, in each Sec., $5\frac{1}{2}$ ft. dist., and raised a mound of earth 2 ft, high, $4\frac{1}{2}$ ft, base around post.

*Land rolling.*Soil 3rd rateVegetation grass & sage.

Township 14 N. Range 18 E.
 BOOK 162 Gila and Salt River Meridian.

Chains

East, on a random line between Sections 12 and 13.

Variation 14° 00' East.*Over rolling land.*40.00 Set temporary $\frac{1}{4}$ Sec. Cor.

79.92 Intersect E. B. of Tp. 10 lks. S. of cor. to secs.

7. 12. 13. & 18

Which is a post 4 ft. long, 4 ins. sq.
 12 ins. in the ground, marked T. 14 N.
 S. 7 on N. E. R. 19 E. S. 18 on S. E. R. 18 E. S.
 3 on S. W. and S. 2 on N. W. face, with 4 notches
 on S. and 2 notches on N. edges, with
 pits 18 x 18 x 12 ins., in each sec. $5\frac{1}{2}$ ft. dist.
 and a mound of earth 2 ft. high, $4\frac{1}{2}$ ft. base
 around post. from which corner, I run

S. 89° 56' W. on a true line, between sections 12 & 13

Variation 14° 00' East.

39.90 Set a post 3 ft. long. 3 ins. diam. with marked stone
 12 ins. in the ground, for $\frac{1}{4}$ Sec. Cor., marked $\frac{1}{4}$ S. on
 N. face, dug pits, 18 x 18 x 12 ins., E. and W. of
 post $5\frac{1}{2}$ ft. dist., and raised a mound of earth $1\frac{1}{2}$ ft.
 high, $3\frac{1}{2}$ ft. base around post.

79.92 The corner to sections 11. 12. 13 & 14

Land rolling.

Soil 3rd rateVegetation grass & sage.

Township

14 N.

Range

18 E.

BOOK 162

Gila and Salt River Meridian.

Chains

North, between Sections 11 and 12.

Variation $14^{\circ} 00'$ East.

Descend. gradually.

-40.00

Set a post 3 ft. long, 3 ins. diam. with marked stone 12 ins. in the ground, for $\frac{1}{4}$ Sec. Cor., marked $\frac{1}{4}$ S. on W. face, dug pits, 18 x 18 x 12 ins., N. and S. of post $5\frac{1}{2}$ ft. dist., and raised a mound of earth $1\frac{1}{2}$ ft. high, $3\frac{1}{2}$ ft. base around post.

60.14

Edge of Dry Lake bears E. & W.

80.00

Set a Sand stone 18 x 12 x 7 ins. 12 ins. in the ground for Cor. to Secs. 1, 2, 11 & 12 marked with 5 notches on S. and 1 notch on E. edges, dug pits 18 x 18 x 12 ins. in each Sec., $5\frac{1}{2}$ ft. dist. and raised a mound of earth 2 ft. high, $4\frac{1}{2}$ ft. base. alongside.

Land rolling.

Soil 3rd rate

Vegetation Grass & sage.

Township 14 N Range 18 E

BOOK 152

Gila and Salt River Meridian.

Chains

East, on a random line between Sections 1 and 12.

Variation $14^{\circ} 00'$ East.*Over rolling land.*40.00 Set temporary $\frac{1}{4}$ Sec. Cor.

77.43 Cross low Sag. Course N. 30° W. & leave Lake bear N. & S.

79.80 Intersect E. B. of Tp. 37 lks. S. of cor. to secs.

1, 6, 7 & 12.

Which is a post 4 ft. long, 4 in. sq. 12 in. in the ground, marked T. 14 N., S. on N. E. R. 49 E., S. 7 on S. E. R. 18 E., S. 12 on S. W. and S. 1 on N. W. face, with 5 notches on S. and 1 notch on N. edge, with pits 18 x 18 x 12 ins. in each Sec., $5\frac{1}{2}$ ft. dist. and amount of earth 2 ft. high, $4\frac{1}{2}$ ft. base around post; from which corner, I run

S. 89° 44' W. on a true line, between sections 1 & 12

Variation $14^{\circ} 00'$ East.

39.90 Set a Sand store 36 x 30 x 7 ins., 27 ins. in the ground, for $\frac{1}{4}$ Sec. Cor., marked $\frac{1}{4}$ on N. face, dug pits 18 x 18 x 12 ins., E. and W. of stone $5\frac{1}{2}$ ft. dist., and raised a mound of earth $1\frac{1}{2}$ ft. high, $3\frac{1}{2}$ ft. base alongside.

79.80 The corner to sections 1, 2, 11 & 12

*Land rolling.*Soil 3rd rate

Vegetation grass & sage.

11

Township 14 N. Range 18 E.

Gila and Salt River Meridian.

BOOK 132

Chains

North, on a random line between Sections 1 and 2.

Variation $13^{\circ} 45'$ East.*Over rolling land.*40.00 Set temporary $\frac{1}{2}$ Sec. Cor.74.30 *Leave by stake bears N.W. and ascend*

80.45 Intersect N.B. of Tp. 40 lks. E. of cor. to secs.

previously set by me.
12.35 & 30' from which corner, I runS. 17° E. on a true line, between sections 1 & 2Variation $14^{\circ} 00'$ East.

40.45 Set a post 3 ft. long, 3 ins. diam. with marked stone
12 ins. in the ground, for $\frac{1}{2}$ Sec. Cor., marked $\frac{1}{2}$ S. on
W. face, dug pits, 18 x 18 x 12 ins., N. and S. of
post $5\frac{1}{2}$ ft. dist., and raised a mound of earth $1\frac{1}{2}$ ft.
high, $3\frac{1}{2}$ ft. base around post.

80.45 The corner to sections 1, 2, 11 & 12

*Land rolling.**Soil 3rd rate**Vegetation grass & sage.*

*I carefully examined the adjustments of my solar
compass to-day, particularly the latitude and revers-
ing apparatus, and found them correct.*

Henry Meppick June 2, 1883

Township 14 N. Range 18 E.

Gila and Salt River Meridian.

BOOK 162

Chains

From the corner to sections, 2, 3, 34 & 35 on S 34 ^{7/8}
 Which is a sand stone
 14 x 10 x 8 ins., 10 ins. in the
 ground, marked with 2 notches
 on E. and 4 notches on W. edge,
 with pits 18 x 18 x 12 ins. in each Sec.,
 5 1/2 ft. dist., and a mound of earth
 2 ft. high, 4 1/2 ft. base alongside. Iron
 North between sections 34 & 35

Variation 14° 00' East.

Ascend.

32.77

Top of Ridge, bears N. E. & S. W. and descend.

40.00

Set a lime stone 17 x 10 x 6 ins., 12 ins.
 in the ground, for 1/2 Sec. Cor., marked 1/2 on W. face,
 dug pits 18 x 18 x 12 ins., N. and S. of stone 5 1/2
 ft. dist., and raised a mound of earth 1 1/2 ft. high, 3 1/2
 ft. base alongside.

54.39

Cross Wash, 14 lks. wide, Course N. 47° E. and ascend.

80.00

Set a post 4 ft. long, 4 ins. square, with marked stone
 12 ins. in the ground, for Cor. to Secs. 20, 27, 34 & 35
 marked T, 14 N. S. 20, on N, E, R, 18 E., S. 35
 on S, E, S, 34 on S, W, and S, 27 on N, W, face
 with 1 notch on S, and 2 notches on E, edges,
 dug pits 18 x 18 x 12 ins. in each Sec., 5 1/2 ft. dist.,
 and raised a mound of earth 2 ft. high, 4 1/2 ft. base
 around post.

Land rolling.

Soil 3rd

rate

Undergrowth of juniper.

Township

14 N.

Range

18 E.

Gila and Salt River Meridian.

BOOK 162

Chains

East, on a random line between Sections 26 and 35.

Variation $13^{\circ} 31'$ East.*Descend gradually.*19.77 Cross Wash, 25 lks. wide, Course N. 17° E and ascend.40.00 Set temporary $\frac{1}{4}$ Sec. Cor.

41.66 Top of Ridge, bears N. E. & S. W. and descend.

80.07 Intersect N. & S. line, 19 lks. S. of cor. to sec.

25.26.35 & 36 from which corner, I run

 $S 89^{\circ} 52' W.$ on a true line between sections 20 & 35Variation $14^{\circ} 00'$ East

44.03 Set a post 3 ft. long. 3 ins. diam. with marked stone
12 ins. in the ground, for $\frac{1}{4}$ Sec. Cor., marked $\frac{1}{4}$ S. on
N. face, dug pits, 18 x 18 x 12 ins., E. and W. of
post $5\frac{1}{2}$ ft. dist., and raised a mound of earth $1\frac{1}{2}$ ft.
high, $3\frac{1}{2}$ ft. base around post.

80.07 The corner to sections 26. 27. 34 & 35

Land mountainous

Soil 3rd rate

Timber of Juniper,

Vegetation. Grass & Sage.

Township 14 N Range 18 E.

Gila and Salt River Meridian.

BOOK 162

Chains

North, between Sections 26 and 27.

Variation 18° 31' East.

Ascend. gradually,

40.00

Set a *lime* stone 27 x 19 x 6 ins., 2' ins. in the ground, for $\frac{1}{4}$ Sec. Cor., marked $\frac{1}{4}$ on W. face, and raised a mound of stone alongside. Pits impracticable.

Top of Spur, bears N. E. & S. W. an

45.00

Descend.

80.00

Set a *lime* stone 18 x 12 x 4 ins. 12 ins. in the ground for Cor. to Secs. 22, 23, 26, 27 marked with 2 notches on S. and 2 notches on E. edges, dug pits 18 x 18 x 12 ins. in each Sec., 5 $\frac{1}{2}$ ft. dist. and raised a mound of earth 2 ft. high, 4 $\frac{1}{2}$ ft. base. alongside.

Land rolling.

Soil 3rd rate

Vegetation Grass & Sage.

15

Township 14 N. Range 18 E.

BOOK 162

Gila and Salt River Meridian.

Chains

East, on a random line between Sections 23 and 26.

Variation $13^{\circ} 30'$ East.*Descend very gradually.*40.00 Set temporary $\frac{1}{2}$ Sec. Cor.43.15 Cross Wash, 20 yds. wide, Course N. 9° E and ascend.

79.78 Intersect N. & S. line, 30 yds. S. of cor. to secs.

23, 24, 25 & 26 from which corner, I run

 $S. 89^{\circ} 47' W.$ on a true line between sections 23 & 20Variation $13^{\circ} 50'$ East

3989 Set a Sand stone $20 \times 15 \times 9$ ins., 15 ins. in the ground, for $\frac{1}{2}$ Sec. Cor., marked $\frac{1}{2}$ on N. face, dug pits $18 \times 18 \times 12$ ins., E and W. of stone $5\frac{1}{2}$ ft. dist., and raised a mound of earth $1\frac{1}{2}$ ft. high, $3\frac{1}{2}$ ft. base alongside.

79.78 The corner to sections 22, 23, 26 & 27

Land rolling.

Soil 2nd rate

Vegetation grass & sage.

Township ~~14 N.~~ ^{14 N.} Range 18 E.~~BOOK 2~~

BOOK 162

Gila and Salt River Meridian.

Chains

North, between Sections 22 and 23.

Variation $13^{\circ} 30'$ East.

Descend gradually

40.00

Set a post 3 ft. long, 3 ins. diam. with marked stone

12 ins. in the ground, for $\frac{1}{2}$ Sec. Cor., marked $\frac{1}{2}$ S. on

W. face, dug pits, 18 x 18 x 12 ins., N. and S. of

post $5\frac{1}{2}$ ft. dist., and raised a mound of earth $1\frac{1}{2}$ ft.high, $3\frac{1}{2}$ ft. base around post.

57.62

Cross Wash, 17 lks. wide, Course N. 42° E. and ascend.

80.00

Set a post 4 ft. long, 4 ins. square, with marked stone

12 ins. in the ground, for Cor. to Secs, 14, 15, 22 & 23

marked T, 14 N. S. 14, on N, E, R, 18 E., S. 23

on S, E, S, 22 on S, W, and S, 15 on N, W, face

with 3 notches on S, and 2 notches on E, edges,

dug pits 18 x 18 x 12 ins, in each Sec., $5\frac{1}{2}$ ft. dist.,and raised a mound of earth 2 ft. high, $4\frac{1}{2}$ ft. base

around post

Land rolling.

Soil 3rd rate

Vegetation Grass & Sage.

G. W. Pearson, Compassman June 1. 1883

17 Township 14 N. Range 18 E.
 BOOK 162 Gila and Salt River Meridian.

Chains

East, on a random line between Sections 14 and 23.

Variation $13^{\circ} 30'$ East.*Descend gradually.*

10.00 Cross Wash, 25' lks. wide, Course N. E. and ascend.

40.00 Set temporary $\frac{1}{2}$ Sec. Cor.

80.24 Intersect N. & S. line, 11 lks. N. of cor. to secs.

13. 14. 23 & 24 from which corner, I run

N. $89^{\circ} 55' W.$ on a true line between sections 14 & 23Variation $14^{\circ} 00'$ East

40.12 Set a post 3 ft. long, 3 ins. diam. with marked stone

12 ins. in the ground, for $\frac{1}{2}$ Sec. Cor., marked $\frac{1}{4}$ S. on

N. face, dug pits, 18 x 18 x 12 ins., E. and W. of

post $5\frac{1}{2}$ ft. dist., and raised a mound of earth $1\frac{1}{2}$ ft.high, $3\frac{1}{2}$ ft. base around post.

80.24 The corner to sections 14, 15, 22 & 23

Land rolling.

Soil 3° rate

Vegetation grass & sage.

Township 14 N. Range 18 E.

Gila and Salt River Meridian.

BOOK 162

Chains

North, between Sections 14 and 15.

Variation 13° 30' East.*Descend gradually.*

40.00

Set a post 3 ft. long, 3 ins. diam. with marked stone 12 ins. in the ground, for $\frac{1}{4}$ Sec. Cor., marked $\frac{1}{4}$ S. on W. face, dug pits, 18 x 18 x 12 ins., N. and S. of post $5\frac{1}{2}$ ft. dist., and raised a mound of earth $1\frac{1}{2}$ ft. high, $3\frac{1}{2}$ ft. base around post.

80.00

Set a sand stone 21 x 10 x 3 ins. 16 ins. in the ground for Cor. to Secs. 10, 11, 14 & 15 marked with 4 notches on S. and 2 notches on E. edges, dug pits 18 x 18 x 12 ins. in each Sec., $5\frac{1}{2}$ ft. dist. and raised a mound of earth 2 ft. high, $4\frac{1}{2}$ ft. base. alongside.

Top of Spur, bears N. E. & S. W. and descend.

Land rolling.

Soil 3rd rate

Vegetation Grass & Sage.

Township

14² N.

Range

18 E.

BOOK

162

Gila and Salt River Meridian.

Chains

East, on a random line between Sections 11 and 14.

Variation 13° 30' East.

*Over level land*40.00 *Set temporary $\frac{1}{4}$ Sec. Cor.*79.87 *Intersect N. & S. line, 35 lks. N. of cor. to secs.**11, 12, 13 & 14 from which corner, I run**N. 89° 45' W. on a true line between sections 11 & 14**Variation 14° 00' East*

39.93 *Set a post 3 ft. long. 3 ins. diam. with marked stone
12 ins. in the ground, for $\frac{1}{4}$ Sec. Cor., marked $\frac{1}{4}$ S. on
N. face, dug pits, 18 x 18 x 12 ins., E. and W. of
post 5 $\frac{1}{2}$ ft. dist., and raised a mound of earth 1 $\frac{1}{2}$ ft.
high, 3 $\frac{1}{2}$ ft. base around post.*

79.87 *The corner to sections 10, 11, 14 & 15**Land level.**Soil 2nd rate**Vegetation grass & sage.*

Township

BOOK

162

14 N.

Range

18 E.

Gila and Salt River Meridian.

Chains

North, between Sections 10 and 11.

Variation $13^{\circ} 30'$ East.*Descend.*

40.00

Set a Sand stone $16 \times 8 \times 6$ ins., 10 ins. in the ground, for $\frac{1}{4}$ Sec. Cor., marked $\frac{1}{4}$ on W. face, dug pits $18 \times 18 \times 12$ ins., N. and S. of stone $5\frac{1}{2}$ ft. dist., and raised a mound of earth $1\frac{1}{2}$ ft. high, $3\frac{1}{2}$ ft. base alongside.

80.00

Set a post 4 ft. long. 4 ins. square, with marked stone 12 ins. in the ground, for Cor. to Secs, 2, 3, 10 & 11 marked T, 14 N. S, 2, on N, E, R, 18 E., S. 11 on S, E, S, 10 on S, W, and S, 3 on N, W, face with 5 notches on S, and 2 notches on E, edges, dug pits $18 \times 18 \times 12$ ins, in each Sec., $5\frac{1}{2}$ ft. dist., and raised a mound of earth 2 ft. high, $4\frac{1}{2}$ ft. base around post.

*Land rolling.*Soil 3rd rate

Vegetation grass & sage.

Township

14 N.

Range

18 E.

BOOK 162

Gila and Salt River Meridian.

Chains

East, on a random line between Sections 2 and 11.

Variation $13^{\circ} 30'$ East.*Over level land*40.00 Set temporary $\frac{1}{4}$ Sec. Cor.

79.63 Intersect N. & S. line, 14 lks. S. of cor. to secs.

1.2. 11 & 12 from which corner, I run

189° 54' W. on a true line between sections 2 & 11

Variation $14^{\circ} 00'$ East

39.81 Set a post 3 ft. long, 3 ins. diam. with marked stone
 12 ins. in the ground, for $\frac{1}{4}$ Sec. Cor., marked $\frac{1}{4}$ S. on
 N. face, dug pits, 18 x 18 x 12 ins., E. and W. of
 post $5\frac{1}{2}$ ft. dist., and raised a mound of earth $1\frac{1}{2}$ ft.
 high, $3\frac{1}{2}$ ft. base around post.

79.63 The corner to sections 2, 3, 10 & 11

*Land level.**Soil 2nd & 3rd rate**Vegetation grass & sage.*

Township

BOOK 162

Range

18 E.

Gila and Salt River Meridian.

Chains

North, on a random line between Sections 2 and 3.

Variation $13^{\circ} 45'$ East.

Over level land

40.00 Set temporary $\frac{1}{4}$ Sec. Cor.80.08 Intersect N. B. of Tp. 24 lks. E. of cor. to secs.
previously set by me.
2, 3, 34 & 35 from which corner, I run

S. 10' E. on a true line, between sections 2 & 3

Variation $13^{\circ} 30'$ East.40.08 Set a Sand stone $15 \times 7 \times 5$ ins., 10 ins.
in the ground, for $\frac{1}{4}$ Sec. Cor., marked $\frac{1}{4}$ on W. face,
dug pits $18 \times 18 \times 12$ ins., N. and S. of stone $5\frac{1}{2}$
ft. dist., and raised a mound of earth $1\frac{1}{2}$ ft. high, $3\frac{1}{2}$
ft. base alongside.

80.08 The corner to sections 2, 3, 10 & 11

Land level.

Soil 3° rate

Vegetation Grass & sage

I carefully examined the adjustments of my solar
compass to-day, particularly the latitude and revers-
ing apparatus, and found them correct.

G. W. Pearson, Compassman, June 2, 1883

Township 14 N. Range 18 E.

BOOK 162

Gila and Salt River Meridian.

Chains From the corner to sections 3, 4, 33 & 34 on S. 24, 25
 Which is a post 4 ft. long, 4 ins. sq.
 12 ins. in the ground, marked
 T. 14 N., S. 34 on N. E., R. 18 E., S. 3 on S. E.
 T. 13 N., S. 4 on S. W. and S. 33 on N. W. face,
 with 3 inches on E and 3 inches on
 W. edge, with pits 18 x 18 x 12 ins. in each
 Sec., 5 1/2 ft. dist., and a mound of
 earth 2 ft. high, 4 1/2 ft. base around post. *from*
 North between sections 33 & 34

Variation 13° 50' East.

Ascend.

40.00 Set a post 3 ft. long, 3 ins. diam. with marked stone
 12 ins. in the ground, for 1/2 Sec. Cor., marked 1/2 S. on
 W. face, dug pits, 18 x 18 x 12 ins., N. and S. of
 post 5 1/2 ft. dist., and raised a mound of earth 1 1/2 ft.
 high, 3 1/2 ft. base around post.

54.37 Top of Ridge, bears N. 48° E. & S. 48° W. and descend.

80.00 Set a post 4 ft. long, 4 ins. square, with marked stone
 12 ins. in the ground, for Cor. to Secs, 27, 28, 33 & 34
 marked T, 14 N. S., 27, on N, E, R, 18 E., S. 34
 on S, E, S, 33 on S, W, and S, 28 on N, W, face
 with 1 notch on S, and 3 notches on E, edges,
 dug pits 18 x 18 x 12 ins. in each Sec., 5 1/2 ft. dist.,
 and raised a mound of earth 2 ft. high, 4 1/2 ft. base
 around post.

and mountainous.
 Soil 3rd rate
 Undergrowth of juniper.

Township 14 N. Range 18 E.
 BOOK 162
 Gila and Salt River Meridian.

Chains

East, on a random line between Sections 27 and 34.

Variation $14^{\circ} 00'$ East.*Ascend gradually.*29.57 Top of Ridge, bears $N60^{\circ}E$ & $S60^{\circ}W$ and descend.40.00 Set temporary $\frac{1}{2}$ Sec. Cor.

79.94 Intersect N. & S. line, 10 lks. N. of cor. to secs.

26, 27, 34 & 35 from which corner, I run

 $N. 89^{\circ} 56' W.$ on a true line between sections 27 & 34Variation $13^{\circ} 31'$ East

39.97 Set a *lime* stone $17 \times 9 \times 8$ ins., 12 ins. in the ground, for $\frac{1}{2}$ Sec. Cor., marked $\frac{1}{2}$ on N. face, dug pits $18 \times 18 \times 12$ ins., E and W. of stone $5\frac{1}{2}$ ft. dist., and raised a mound of earth $1\frac{1}{2}$ ft. high, $3\frac{1}{2}$ ft. base alongside.

79.94 The corner to sections 27, 28, 33 & 34

Land mountainous.

Soil 3^{d} rate

Vegetation Grass & Sage.

Township 14 N Range 18 E

BOOK 162

Gila and Salt River Meridian.

Chains

North, between Sections 27 and 28.

Variation $13^{\circ} 30'$ East.

Descend gradually.

40.00

Set a post 3 ft. long. 3 ins. diam. with marked stone 12 ins. in the ground, for $\frac{1}{4}$ Sec. Cor., marked $\frac{1}{4}$ S. on W. face, dug pits, 18 x 18 x 12 ins., N. and S. of post $5\frac{1}{2}$ ft. dist., and raised a mound of earth $1\frac{1}{2}$ ft. high, $3\frac{1}{2}$ ft. base around post.

80.00

Set a *lime* stone 28 x 25 x 4 ins. 21 ins. in the ground for Cor. to Secs. 21, 22, 27 & 28 marked with 2 notches on S. and 3 notches on E. edges and raised a mound of stone alongside. Pits impracticable.

Land rolling.

Soil 2nd rate

Vegetation grass & sage.

Timber of juniper.

Township 14 N. Range 18 E.

BOOK 162

Gila and Salt River Meridian.

Chains

East, on a random line between Sections 22 and 27.

Variation 13° 30' East.*Over rolling land.*40.00 Set temporary $\frac{1}{4}$ Sec. Cor.

79.57 Intersect N. & S. line, 49 lks. N. of cor. to secs.

22.23.26 & 27 from which corner, I run

N. 89° 39' W. on a true line between sections 22 & 27

Variation 13° 30' East

39.78 Set a sand stone $27 \times 18 \times 6$ ins., 21 ins. in the ground, for $\frac{1}{4}$ Sec. Cor., marked $\frac{1}{4}$ on N. face, dug pits $18 \times 18 \times 12$ ins., E. and W. of stone $5\frac{1}{2}$ ft. dist., and raised a mound of earth $1\frac{1}{2}$ ft. high, $3\frac{1}{2}$ ft. base alongside.

79.57 The corner to sections 21. 22. 27 & 28

*Land rolling.*Soil 2nd rateTimber of juniper.Vegetation. grass & sage.

Township

14 N.

Range

18 E.

BOOK 162

Gila and Salt River Meridian.

Chains

North, between Sections 21 and 22.

Variation

13° 30'

East.

Descend gradually.

20.00

Foot of Spur bears N.W. & S. E.

40.00

Set a *lime* stone 20 x 15 x 6 ins., 15 ins. in the ground, for $\frac{1}{2}$ Sec. Cor., marked $\frac{1}{2}$ on W. face, and raised a mound of stone alongside. Pits impracticable.

80.00

Set a *lime* stone 16 x 11 x 7 ins. 10 ins. in the ground for Cor. to Secs. 15, 16, 21 & 22 marked with 3 notches on S. and 3 notches on E. edges, dug pits 18 x 18 x 12 ins. in each Sec., $5\frac{1}{2}$ ft. dist. and raised a mound of earth 2 ft. high, $4\frac{1}{2}$ ft. base. alongside.

Land rolling.

Soil 2nd rate

Vegetation grass & sage

Township 162 44 N. Range 18 E.

Gila and Salt River Meridian.

Chains

East, on a random line between Sections 15 and 22.

Variation $13^{\circ} 30'$ East.*Over level land*40.00 *Set temporary $\frac{1}{4}$ Sec. Cor.*79.40 *Intersect N. & S. line, 25 lks. N. of cor. to secs.
14. 15. 22 & 23 from which corner, I run**N. $89^{\circ} 49'$ W. on a true line between sections 15 & 22**Variation $13^{\circ} 30'$ East*

39.73

*Set a lime stone $10 \times 6 \times 6$ ins., 10 ins.
in the ground, for $\frac{1}{4}$ Sec. Cor., marked $\frac{1}{4}$ on N. face,
dug pits $18 \times 18 \times 12$ ins., E. and W. of stone $5\frac{1}{2}$
ft. dist., and raised a mound of earth $1\frac{1}{2}$ ft. high, $3\frac{1}{2}$
ft. base, alongside.*

79.40

*The corner to sections 15. 16. 21 & 22**Lana level.**Soil 2nd rate**Timber of juniper.**Vegetation. grass & Sage.*

Township 14 N. Range 18 E.

Gila and Salt River Meridian.

BOOK 162

Chains

North, between Sections 15 and 16.

Variation $13^{\circ} 30'$ East.

Over nearly level land.
Descend very gradually.

40.00

Set a post 3 ft. long, 3 ins. diam. with marked stone
12 ins. in the ground, for $\frac{1}{4}$ Sec. Cor., marked $\frac{1}{4}$ S. on
W. face, dug pits, 18 x 18 x 12 ins., N. and S. of
post $5\frac{1}{2}$ ft. dist., and raised a mound of earth $1\frac{1}{2}$ ft.
high, $3\frac{1}{2}$ ft. base around post.

80.00

Set a post 4 ft. long, 4 ins. square, with marked stone
12 ins. in the ground, for Cor. to Secs. 9, 10, 15 & 16
marked T, 14 N. S. 10, on N, E, R, 18 E, S. 15
on S, E, S, 16 on S, W, and S, 9 on N, W, face
with 5 notches on S, and 3 notches on E, edges,
dug pits 18 x 18 x 12 ins, in each Sec., $5\frac{1}{2}$ ft. dist.,
and raised a mound of earth 2 ft, high, $4\frac{1}{2}$ ft, base
around post.

Land rolling.

Soil good rate

Vegetation grass & sage.

Township 14 N. Range 18 E.

BOOK 162

Gila and Salt River Meridian.

Chains East, on a random line between Sections 10 and 15.

Variation 13° 31' East.

Over level land

40.00 Set temporary $\frac{1}{4}$ Sec. Cor.

79.98 Intersect N. & S. line, 13 lks. S. of cor. to secs.

10. 11. 14. 15 from which corner, I run

S. 89° 54' W. on a true line between sections 10 & 15

Variation 13° 30' East

39.99 Set a Sand stone 25 x 19 x 7 ins., 18

ins. in the ground, for $\frac{1}{4}$ Sec. Cor., marked $\frac{1}{4}$ on N. face, and raised a mound of stone alongside. Pits

impracticable.

79.98 The corner to sections 9. 10. 15 & 16

Land level.

Soil 2nd rate

Timber of Juniper.

Vegetation. grass & sage.

Township 14 N. Range 18 E.

Gila and Salt River Meridian.

BOOK 162

Chains

North, between Sections 9 and 10.

Variation 13° 31' East.*Descend gradually*

40.00

Set a post 3 ft. long, 3 ins. diam. with marked stone 12 ins. in the ground, for $\frac{1}{4}$ Sec. Cor., marked $\frac{1}{4}$ S. on W. face, dug pits, 18 x 18 x 12 ins., N and S. of post $5\frac{1}{2}$ ft. dist., and raised a mound of earth $1\frac{1}{2}$ ft. high, $3\frac{1}{2}$ ft. base around post.

80.00

Set a sand stone 20 x 10 x 7 ins. 15 ins. in the ground for Cor. to Secs. 3, 4, 9 & 10 marked with 5 notches on S. and 3 notches on E. edges, dug pits 18 x 18 x 12 ins. in each Sec., $5\frac{1}{2}$ ft. dist. and raised a mound of earth 2 ft. high, $4\frac{1}{2}$ ft. base. alongside.

Land rolling.

Soil 1st & 2nd rate

Vegetation grass & sage.

Township 14 N. Range 18 E.

BOOK 162

Gila and Salt River Meridian.

Chains

East, on a random line between Sections 3 and 10.

Variation $13^{\circ} 31'$ East.*Over level land*40.00 *Set temporary $\frac{1}{4}$ Sec. Cor.*80.34 *Intersect N. & S. line, 21 lks. N. of cor. to secs.**2.3. 10 & 11 from which corner, I run**N. sq. 51' W. on a true line between sections 3 & 10*Variation $13^{\circ} 30'$ East

40.17

*Set a post 3 ft. long, 3 ins. diam. with marked stone
12 ins. in the ground, for $\frac{1}{4}$ Sec. Cor., marked $\frac{1}{4}$ S. on
N. face, dug pits, 18 x 18 x 12 ins., E. and W. of
post $5\frac{1}{2}$ ft. dist., and raised a mound of earth $1\frac{1}{2}$ ft.
high; $3\frac{1}{2}$ ft. base around post.*

80.34

*The corner to sections 3, 4, 9 & 10**Land level.**Soil 3rd rate**Vegetation grass & sage.*

Township 14 N Range 18 E

BOOK 132 Gila and Salt River Meridian.

Chains

North, on a random line between Sections 3 and 4.

Variation $14^{\circ} 00'$ East.*Ascend.*40.00 Set temporary $\frac{1}{4}$ Sec. Cor.79.90 Intersect *N* B. of Tp. *lbs.* at cor. to secs.
previously set by me.

3. 4. 33 & 34 from which corner, I run

South on a ~~tree~~ *same* line, between sections 3 & 4Variation $13^{\circ} 31'$ East.39.90 Set a post 3 ft. long. 3 ins. diam. with marked stone
12 ins. in the ground, for $\frac{1}{4}$ Sec. Cor., marked $\frac{1}{4}$ S. on
W. face, dug pits, 18 x 18 x 12 ins., N. and S. of
post $5\frac{1}{2}$ ft. dist., and raised a mound of earth $1\frac{1}{2}$ ft.
high, $3\frac{1}{2}$ ft. base around post.

79.90 The corner to sections 3. 4. 9 & 10

Land rolling.

Soil 3^{rd} rate

Vegetation grass & sage.

Henry Meyrick June 4. 1883

Township 14 N. Range 18 E.

BOOK 162

Gila and Salt River Meridian,

Chains

From the corner to sections,

4. 5. 32 & 33

on, Sperry Township

Which is a lime stone
 24x10x10 ins., 18 ins. in the
 ground, marked with 4 notches
 on E. and 2 notches on W. edge,
 and a mound of stone
 alongside. Iron

North between sections 32 & 33

Variation $13^{\circ} 50'$ East.

Ascend.

40.00

Set a post 3 ft. long, 3 ins. diam. with marked stone
 12 ins. in the ground, for $\frac{1}{2}$ Sec. Cor., marked $\frac{1}{2}$ S. on
 W. face, dug pits, 18 x 18 x 12 ins., N. and S. of
 post $5\frac{1}{2}$ ft. dist., and raised a mound of earth $1\frac{1}{2}$ ft.
 high, $3\frac{1}{2}$ ft. base around post.

50.33

Top of Spur, bears $N. 11^{\circ} E.$ & $S. 11^{\circ} W.$ and descend.

80.00

Set a sand stone 23 x 14 x 7 ins. 18 ins. in
 the ground for Cor. to Secs. 28, 29, 32 & 33 marked
 with 1 notch on S. and 4 notches on E. edges and
 raised a mound of stone alongside. Pits impracticable.

Land rolling.

Soil 3° rate

Vegetation grass & sage.

Township 14 N. Range 18 E.

Gila and Salt River Meridian.

Chains

East, on a random line between Sections 28 and 33.

Variation 14° 00' East.*Ascend.*13.73 Top of Spur, bears N. 30° E. & S. 30° W. and descend.33.41 Cross Wash, 20⁻ lks. wide. Course N. 49° E. and ascend.40.00 Set temporary $\frac{1}{2}$ Sec. Cor.

79.71 Intersect N. & S. line, 32 lks. S. of cor. to secs.

27.28. 33 & 34 from which corner, I run

S. 89° 46' W. on a true line between sections 28 & 33Variation 14° 00' East39.86 Set a post 3 ft. long. 3 ins. diam. with marked stone
12 ins. in the ground, for $\frac{1}{2}$ Sec. Cor., marked $\frac{1}{4}$ S. onN. face, dug pits, 18 x 18 x 12 ins., E. and W. of
post $5\frac{1}{2}$ ft. dist., and raised a mound of earth $1\frac{1}{2}$ ft.
high, $3\frac{1}{2}$ ft. base around post.

79.71 The corner to sections 28. 29. 32 & 33

Land rolling.

Soil 2nd run.Timber of juniper.Vegetation. grass & sage.

Township

14 N.

Range

18 E.

Gila and Salt River Meridian.

Chains

North, between Sections 28 and 29.

Variation

44° 00'

East.

Descend.

17.00 Cross Wash, 10 lks. wide, Course N. 10° E

40.00 Set a *lime* stone 24 x 19 x 6 ins., 18 ins. in the ground, for $\frac{1}{4}$ Sec. Cor., marked $\frac{1}{4}$ on *W* face, and raised a mound of stone alongside. Pits impracticable.

80.00 Set a post 4 ft. long, 4 ins. square, with marked stone 12 ins. in the ground, for Cor. to Secs, 20, 21, 28 & 29 marked T, 14 N. S, 21, on N, E, R, 18 E, S, 28 on S, E, S, 29 on S, W, and S, 20 on N, W, face with 2 notches on S, and 4 notches on E, edges, dug pits 18 x 18 x 12 ins, in each Sec., 5 $\frac{1}{2}$ ft, dist., and raised a mound of earth 2 ft, high, 4 $\frac{1}{2}$ ft, base around post.

Land rolling.

Soil 1st & 2nd rate

Vegetation grass & sage.

Township

14 N

Range

18 E

Gila and Salt River Meridian.

BOOK 162

Chains

East, on a random line between Sections 21 and 28.

Variation $14^{\circ} 00'$ East.*Over rolling land.*13.50 Cross Wash, 20 lks. wide, Course N. 13° E.40.00 Set temporary $\frac{1}{4}$ Sec. Cor.63.74 Cross Wash, 21 lks. wide, Course N. 10° W.

80.03 Intersect N. & S. line, 51 lks. S, of cor. to secs.

21.22.27.28 from which corner, I run

S $89^{\circ} 38'$ W. on a true line between sections 21 & 28Variation $13^{\circ} 30'$ East

40.01 Set a *lime* stone $17 \times 12 \times 10$ ins., 12 ins. in the ground, for $\frac{1}{4}$ Sec. Cor., marked $\frac{1}{4}$ on N face, and raised a mound of stone alongside. Pits impracticable.

80.23 The corner to sections 20, 21, 28 & 29

Land rolling.

Soil 1st & 2nd rate

Vegetation grass & sage.

Township

14 N

Range

18 E

BOOK 162

Gila and Salt River Meridian.

Chains

North, between Sections 20 and 21.

Variation

4° 00'

East.

Descend gradually,

18.90

Cross Wash, 23 lks. wide, Course N. 46° E.

40.00

Set a Sand stone 23 x 13 x 7 ins., 18 ins. in the ground, for $\frac{1}{4}$ Sec. Cor., marked $\frac{1}{4}$ on W. face, dug pits 18 x 18 x 12 ins., N. and S. of stone $5\frac{1}{2}$ ft. dist., and raised a mound of earth $1\frac{1}{2}$ ft. high, $3\frac{1}{2}$ ft. base, alongside.

80.00

Set a post 4 ft. long, 4 ins. square, with marked ~~...~~ 12 ins. in the ground, for Cor. to Secs, 16, 17, 20 & 21 marked T, 14 N. S. 16, on N, E, R, 18 E., S. 21 on S, E, S, 20 on S, W, and S, 17 on N, W, face with 3 notches on S, and 4 notches on E, edges, dug pits 18 x 18 x 12 ins. in each Sec., $5\frac{1}{2}$ ft. dist., and raised a mound of earth 2 ft. high, $4\frac{1}{2}$ ft. base around post.

Land rolling.

Soil 2nd rate

Vegetation grass & sage.

Township

14 N.

Range

18 E.

BOOK 162

Gila and Salt River Meridian.

Chains

East, on a random line between Sections 16 and 21.

Variation $14^{\circ} 00'$ East.

Over rolling land.

37.50 Cross Wash, 17 lks. wide, Course N $14^{\circ} 0'$ E.40.00 Set temporary $\frac{1}{4}$ Sec. Cor.

79.88 Intersect N. & S. line, 40 lks. S. of cor. to secs.

15, 16, 21, 22 from which corner, I run

S. $89^{\circ} 43'$ W. on a true line between sections 16 & 21Variation $13^{\circ} 30'$ East

39.94 Set a Sand store $17 \times 11 \times 9$ ins., 12 ins. in the ground, for $\frac{1}{4}$ Sec. Cor., marked $\frac{1}{4}$ on N. face, dug pits $18 \times 18 \times 12$ ins., E and W. of stone $5\frac{1}{2}$ ft. dist., and raised a mound of earth $1\frac{1}{2}$ ft. high, $3\frac{1}{2}$ ft. base alongside.

79.88 The corner to sections 16, 17, 20 & 21

Land rolling.

Soil 3rd rate

Vegetation grass & sage

Township 14 N Range 18 E.

Gila and Salt River Meridian.

BOOK 162

Chains

North, between Sections 16 and 17.

Variation $14^{\circ} 00'$ East.

Descend gradually.

40.00

Set a sand stone $17 \times 12 \times 5$ ins., 12 ins. in the ground, for $\frac{1}{2}$ Sec. Cor., marked $\frac{1}{2}$ on W. face, dug pits $18 \times 18 \times 12$ ins., N. and S. of stone $5\frac{1}{2}$ ft. dist., and raised a mound of earth $1\frac{1}{2}$ ft. high, $3\frac{1}{2}$ ft. base alongside.

44.10

Cross Wash, 13 lks. wide, Course N. 44° E.

30.00

Set a post 4 ft. long, 4 ins. square, with marked stone 12 ins. in the ground, for Cor. to Secs. 8, 9, 16 & 17 marked T, 14 N. S. 9, on N, E, R, 18 E, S. 16 on S, E, S, 17 on S, W, and S, 8 on N, W, face with 4 notches on S, and 4 notches on E, edges, dug pits $18 \times 18 \times 12$ ins. in each Sec., $5\frac{1}{2}$ ft. dist., and raised a mound of earth 2 ft. high, $4\frac{1}{2}$ ft. base around post.

Land rolling.

Soil good rate

Vegetation grass & sage.

Township

BOOK 162

Range

18 E.

Gila and Salt River Meridian.

Chains

East, on a random line between Sections 9 and 16.

Variation

14° 00'

East.

Descend.

26.55 Cross Wash, 30 lks. wide, Course N 21° E.

40.00 Set temporary $\frac{1}{4}$ Sec. Cor.

80.20 Intersect N. & S. line, 16 lks. S. of cor. to secs.

9, 10, 15 & 16 from which corner, I run

S 89° 53' W. on a true line between sections 9 & 10

Variation 13° 31' East

40.10 Set a post 3 ft. long, 3 ins. diam. with marked stone
12 ins. in the ground, for $\frac{1}{4}$ Sec. Cor., marked $\frac{1}{4}$ S. on
N. face, dug pits, 18 x 18 x 12 ins., E. and W. of
post $5\frac{1}{2}$ ft. dist., and raised a mound of earth $1\frac{1}{2}$ ft.
high, $3\frac{1}{2}$ ft. base around post.

80.20 The corner to sections 8, 9, 10 & 17:

*Land rolling.*Soil 2nd rate

Vegetation grass & sage.

Township

14 N.

Range

18 E.

BOOK 162

Gila and Salt River Meridian.

Chains

North, between Sections 8 and 9.

Variation

14° 00'

East.

Descend gradually

40.00

Set a post 3 ft. long, 3 ins. diam. with marked stone 12 ins. in the ground, for $\frac{1}{4}$ Sec. Cor., marked $\frac{1}{4}$ S. on W. face, dug pits, 18 x 18 x 12 ins., N and S. of post $5\frac{1}{2}$ ft. dist., and raised a mound of earth $1\frac{1}{2}$ ft. high, $3\frac{1}{2}$ ft. base around post.

80.00

Set a post 4 ft. long, 4 ins. square, with marked stone 12 ins. in the ground, for Cor. to Secs, 14, 5, 8 & 9 marked T, 14 N.S, 4, on N, E, R, 18 E, S. 9 on S, E, S, 8 on S, W, and S, 5 on N, W, face with 5 notches on S, and 4 notches on E, edges, dug pits 18 x 18 x 12 ins, in each Sec., $5\frac{1}{2}$ ft. dist., and raised a mound of earth 2 ft. high, $4\frac{1}{2}$ ft. base around post.

Land rolling.

Soil 3rd rate

Vegetation grass & sage.

Township 14 N. Range 18 E.

BOOK 162 Gila and Salt River Meridian.

Chains

East, on a random line between Sections 4 and 9.

Variation 14° 00' East.

Descend gradually.

13.20 Enter level bottom.

40.00 Set temporary $\frac{1}{4}$ Sec. Cor.

80.09 Intersect N. & S. line, 9 lks. N. of cor. to secs.

3.4. 9 & 10 from which corner, I run

N. 89° 56' W. on a true line between sections 4 & 9

Variation 13° 31' East

40.04 Set a Sand stone 10 x 8 x 6 ins., 10 ins.
in the ground, for $\frac{1}{4}$ Sec. Cor., marked $\frac{1}{4}$ on N. face,
dug pits 18 x 18 x 12 ins., E. and W. of stone 5 $\frac{1}{2}$
ft. dist., and raised a mound of earth 1 $\frac{1}{2}$ ft. high, 3 $\frac{1}{2}$
ft. base alongside.

80.09 The corner to sections 4, 5, 8 & 9

Land rolling.

Soil good rate

Vegetation grass & sage.

Township 14 N Range 18 E
 BOOK 162 Gila and Salt River Meridian.

Chains

North, on a random line between Sections 4 and 5.

Variation 14° 10' East.*Ascend gradually.*40.00 Set temporary $\frac{1}{4}$ Sec. Cor.79.62 Intersect N. B. of Tp. 29 lks. W. of cor. to sec.
 previously set by me.

4. 5. 32 & 33 from which corner, I run

S. 12' W. on a true line, between sections 4 & 5-

Variation 14° 00' East.

39.62 Set a post 3 ft. long. 3 ins. diam. with marked stone
 12 ins. in the ground, for $\frac{1}{4}$ Sec. Cor., marked $\frac{1}{4}$ S. on
 W. face, dug pits, 18 x 18 x 12 ins., N. and S. of,
 post $5\frac{1}{2}$ ft. dist., and raised a mound of earth $1\frac{1}{2}$ ft.
 high, $3\frac{1}{2}$ ft. base around post.

79.62 The corner to sections 4. 5. 8 & 9

Land rolling.

Soil 3rd rate

Vegetation grass & sage.

- G. W. Pearson, Compademom June 4. 1883

45 Township 14 N.

Range 18 E.

Gila and Salt River Meridian.

BOOK 162

Chains

From the corner to sections, 5, 6, 31 & 32 on S. by S. ²⁰
 Which is a post 4 ft. long. Horiz. 29. 2 ins. in the ground marked T. 14 N., S. 32 on N. E., R. 18 E., S. 5 on S. E., T. 13 N., S. 30 on W., and S. 31 on N. W. face with 5 notches on E. and 1 notch on W. edge with pits 18 x 18 x 12 ins. in each Sec., 5 1/2 ft. dist. and a mound of earth 2 ft. high, 4 1/2 ft. base around post; from which

A Pine 6 ins. diam. bears S. 58° E. 1.06 lks. dist. marked T. 13 N. R. 18 E. S., 5 B. T.

A Pine 8 ins. diam. bears N. 36° W. 56 lks. dist. marked T. 14 N. R. 18 E. S., 31 B. T.

A Cedar 4 ins. diam. bears S. 60° W. 70 lks. dist. marked T. 13 N. R. 18 E. S., 6 B. T. ^{same}

North between sections 31 & 32

Variation - 13° 50' East.

Descend.

40.00

Set a lime stone 18 x 10 x 10 ins., 12 ins. in the ground, for 1/2 Sec. Cor., marked 1/2 on W. face, dug pits 18 x 18 x 12 ins., N. and S. of stone 5 1/2 ft. dist., and raised a mound of earth 1 1/2 ft. high, 3 1/2 ft. base alongside.

49.84

Cross Wash, 26 lks. wide, Course N. 41° E. and ascend.

80.00

Set a post 4 ft. long, 4 ins. square, with marked stone 12 ins. in the ground, for Cor. to Secs, 29, 30, 31 & 32 marked T, 14 N. S. 29, on N, E, R, 18 E., S. 32 on S, E, S, 31 on S, W, and S, 30 on N, W, face with 1 notch on S, and 5 notches on E, edges, dug pits 18 x 18 x 12 ins. in each Sec., 5 1/2 ft. dist., and raised a mound of earth 2 ft. high, 4 1/2 ft. base around post. low Sag and ascend.

Land hilly.

Soil 3rd

rate

Undergrowth of juniper.

Township 14 N. Range 18 E.

BOOK 162

Gila and Salt River Meridian.

Chains East, on a random line between Sections 29 and 32.
Variation 14° 00' East.

*Descend.*34 Cross Wash, 30 lks. wide, Course N. 45° E. and ascend.40.00 Set temporary $\frac{1}{4}$ Sec. Cor.41.00 Top of Spur, bears N. 32° E. & S. 32° W. and descend.73.60 Cross Wash, 27 lks. wide, Course N. 12° E. and ascend.80.32 Intersect N. & S. line, 43 lks. S. of cor. to secs.28.29.32 from which corner, I runS. 89° 42' W. on a true line between sections 29 & 32Variation 14° 00' East

40.10 Set a post 3 ft. long, 3 ins. diam. with marked stone
12 ins. in the ground, for $\frac{1}{4}$ Sec. Cor., marked $\frac{1}{4}$ S. on
N. face, dug pits, 18 x 18 x 12 ins. E. and W. of
post 5 $\frac{1}{2}$ ft. dist., and raised a mound of earth 1 $\frac{1}{2}$ ft.
high, 3 $\frac{1}{2}$ ft. base around post.

80.32 The corner to sections 29. 30. 31 & 32

Land rolling.

Soil 3rd rateUndergrowth of Juniper.Henry Meyrick June 5. 1883

Township 14 N. Range 18 E.

BOOK 162 Gila and Salt River Meridian.

Chains

West, on a random line between Sections 30 and 31.

Variation 14° 00' East.

Ascend.

37.63 Top of Hill bears N. 21° E. & S. 21° W. and descend.

40.00 Set temporary $\frac{1}{4}$ Sec. Cor.

54.46 Cross Wash, 15' lks. wide, Course N. 18° E. and ascend.

85.07 Intersect W. B. of Tp. 149 lks. N. of cor. to secs. 25, 30, 31 & 36 ^{previously set by me} from which corner, I run

N. 89° 40' E. on a true line, between sections 30 & 31

Variation 13° 30' East.

45.07 Set a lime stone 23 x 12 x 7 ins., 18 ins. in the ground, for $\frac{1}{4}$ Sec. Cor., marked $\frac{1}{4}$ on N. face, and raised a mound of stone alongside. Pits impracticable.

86.07 The corner to sections 29, 30, 31 & 32
Land hilly.

Soil 2nd rate

Vegetation grass & sage.

G. W. Pearson, Compassman June 5, 1883

Township 14 N Range 18 E

Gila and Salt River Meridian.

Chains

North, between Sections 29 and 30.

Variation

14° 00'

East.

Ascend gradually.

40.00

Set a post 3 ft. long, 3 ins. diam. with marked stone 12 ins. in the ground, for $\frac{1}{2}$ Sec. Cor., marked $\frac{1}{2}$ S. on W. face, dug pits, 18 x 18 x 12 ins., N. and S. of post $5\frac{1}{2}$ ft. dist., and raised a mound of earth $1\frac{1}{2}$ ft. high, $3\frac{1}{2}$ ft. base around post.

Top of Spur, bears N. 8. ⁴⁰ S. N. and descend.

80.00

Set a post 4 ft. long, 4 ins. square, with marked stone 12 ins. in the ground, for Cor. to Secs. 19, 20, 29 & 30 marked T, 44° N. S. 20° , on N, E, R, 18° E, S. 29 on S, E, S, 30 on S. W, and S, 19 on N, W, face with 2 notches on S, and 5 notches on E, edges, dug pits 18 x 18 x 12 ins, in each Sec., $5\frac{1}{2}$ ft. dist., and raised a mound of earth 2 ft. high, $4\frac{1}{2}$ ft. base around post.

Land rolling.

Soil 2^{nd} & 3^{rd} rate

Vegetation grass & sage.

Township 14 N. Range 18 E.

BOOK 162

Gila and Salt River Meridian.

Chains

East, on a random line between Sections 20 and 29.

Variation

13° 00'

East.

*Ascend gradually.*20.61 *Descend. gradually.*40.00 *Set temporary 1/4 Sec. Cor.*63.47 *Cross Wash, 17 lks. wide, Course N. E. and ascend.*79.87 *Intersect N. & S. line, 13 lks. S. of cor. to secs.*20, 21, 28 & 29 *from which corner, I run*S 89° 54' W. *on a true line between sections 20 & 29*

Variation

14° 00'

East

39.93 *Set a post 3 ft. long, 3 ins. diam. with marked stone**12 ins. in the ground, for 1/4 Sec. Cor., marked 1/4 S. on**N. face, dug pits, 18 x 18 x 12 ins., E. and W. of**post 5 1/2 ft. dist., and raised a mound of earth 1 1/2 ft.**high, 3 1/2 ft. base around post.*79.87 *The corner to sections 19, 20, 29 & 30**Land rolling.**Soil 2nd & 3rd rate**Vegetation grass & sage.**Henry Meyrick June 5, 1883*

Township 14 N. Range 18 E.
 BOOK 162 Gila and Salt River Meridian.

Chains West, on a random line between Sections 19 and 30.
 Variation $13^{\circ} 30'$ East.

Descend gradually.

39.00 Cross Wash, 10 lks. wide, Course $N 3^{\circ} E$ and ascend.

40.00 Set temporary $\frac{1}{4}$ Sec. Cor.

84.93 Intersect W. B. of Tp. 28 lks. N of cor. to secs

~~knownly set by me~~
 19. 24. 25 & 30 from which corner, I run

$N 89^{\circ} 49' E$, on a true line, between sections 19 & 30

Variation $13^{\circ} 30'$ East.

44.93 Set a Limestone stone $18 \times 10 \times 6$ ins., 12 ins.
 in the ground, for $\frac{1}{4}$ Sec. Cor., marked $\frac{1}{4}$ on N. face,
 dug pits $18 \times 18 \times 12$ ins., E and W. of stone $5\frac{1}{2}$
 ft. dist., and raised a mound of earth $1\frac{1}{2}$ ft. high, $3\frac{1}{2}$
 ft. base alongside.

84.93 The corner to sections 19. 20. 29. & 30

Land rolling.

Soil 3^{rd} rate

Vegetation grass & sage.

G. W. Pearson, Compassman June 5, 1883

Township 14 N. Range 18 E.

BOOK 162

Gila and Salt River Meridian.

Chains

North, between Sections 19 and 20.

Variation

13° 30'

East.

Descend.

40.00

Set a post 3 ft. long, 3 ins. diam. with marked stone 12 ins. in the ground, for $\frac{1}{4}$ Sec. Cor., marked $\frac{1}{4}$ S. on W. face, dug pits, 18 x 18 x 12 ins., N. and S. of post $5\frac{1}{2}$ ft. dist., and raised a mound of earth $1\frac{1}{2}$ ft. high, $3\frac{1}{2}$ ft. base around post.

80.00

Set a Sand stone 20 x 10 x 6 ins. 15 ins. in the ground for Cor. to Secs. 17, 18, 19 & 20 marked with 3 notches on S. and 5 notches on E. edges, dug pits 18 x 18 x 12 ins. in each Sec., $5\frac{1}{2}$ ft. dist. and raised a mound of earth 2 ft. high, $4\frac{1}{2}$ ft. base. alongside.

Land rolling.

Soil 2nd rate

Vegetation grass & sage.

Township 14 N Range 18 EBOOK 162 Gila and Salt River Meridian.

Chains

East, on a random line between Sections 17 and 20.

Variation 13° 30' East.*Over rolling land.*40.00 *Set temporary $\frac{1}{4}$ Sec. Cor.*66.11 *Cross Wash, 18 lks. wide, Course N.*79.96 *Intersect N. & S. line, 17 lks. N. of cor. to secs.**16.17.20 & 2 from which corner, I run**N. 89° 53' W. on a true line between sections 17 & 20**Variation 11° 00' East*

39.98 *Set a post 3 ft. long, 3 ins. diam. with marked stone
12 ins. in the ground, for $\frac{1}{4}$ Sec. Cor., marked $\frac{1}{4}$ S. on
N. face, dug pits, 18 x 18 x 12 ins., E. and W. of
post $5\frac{1}{2}$ ft. dist., and raised a mound of earth $1\frac{1}{2}$ ft.
high, $3\frac{1}{2}$ ft. base around post.*

79.96 *The corner to sections 17, 18, 19 & 20**Land rolling.**Soil 3rd rate**Vegetation grass & sage.**Henry Meyrick June 5, 1883*

Township

14 N.

Range

18 E.

BOOK 162

Gila and Salt River Meridian.

Chains

West, on a random line between Sections 18 and 19.

Variation

13° 30'

East.

Descend gradually.

5.51 Cross Wash, .08 lks. wide, Course N. E. and ascend.

40.00 Set temporary $\frac{1}{4}$ Sec. Cor.

85.25 Intersect W. B. of Tp. 14 lks. N. of cor. to secs.

previously set by me.
13, 18, 19 & 24 from which corner, I run

N. 89° 54' E. on a true line, between sections 18 & 19

Variation

13° 30'

East.

45.25 Set a post 3 ft. long, 3 ins. diam. with marked stone

12 ins. in the ground, for $\frac{1}{4}$ Sec. Cor.; marked $\frac{1}{4}$ S. on

N. face, dug pits, 18 x 18 x 12 ins. E. and W. of

post 5 $\frac{1}{2}$ ft. dist., and raised a mound of earth 1 $\frac{1}{2}$ ft.high, 3 $\frac{1}{2}$ ft. base around post.

86.25 The corner to sections 17, 18, 19 & 20

Land rolling.

Soil 2^m & 3^m rate

Timber of juniper

Vegetation. Grass & sage.

G. W. Pearson Compassman June 5, 1883

Township

14 N.

Range

18 E.

Gila and Salt River Meridian.

BOOK 162

Chains

North, between Sections 17 and 18.

Variation

13° 30'

East.

Descend gradually.

9.13 Cross Wash, .08 lks. wide, Course N. E. and ascend.

40.00 Set a post 3 ft. long, 3 ins. diam. with marked stone
12 ins. in the ground, for $\frac{1}{2}$ Sec. Cor., marked $\frac{1}{4}$ S. on
W. face, dug pits, 18 x 18 x 12 ins., N. and S. of
post $5\frac{1}{2}$ ft. dist., and raised a mound of earth $1\frac{1}{2}$ ft.
high, $3\frac{1}{2}$ ft. base around post.

80.00 Set a post 4 ft. long, 4 ins. square, with marked stone
12 ins. in the ground, for Cor. to Secs, 7, 8, 17 & 18
marked T, 14 N. S, 8, on N, E, R, 18 E., S. 17
on S, E, S, 18 on S, W, and S, 7 on N, W, face
with 4 notches on S, and 5 notches on E, edges,
dug pits 18 x 18 x 12 ins, in each Sec., $5\frac{1}{2}$ ft. dist.,
and raised a mound of earth 2 ft, high, $4\frac{1}{2}$ ft. base
around post.

Land rolling.

Soil 2nd & 3rd rate

Vegetation

grass & sage.

Township

14 N.

BOOK 162

Range

18 E.

Gila and Salt River Meridian.

Chains

East, on a random line between Sections 8 and 17.

Variation

13° 30'

East.

Over rolling land.

38.40

Cross Wash, 10 lks. wide, Course N. 25° E.

40.00

Set temporary $\frac{1}{4}$ Sec. Cor.

79.99

Intersect N. & S. line, 26 lks. S. of cor. to secs.

8, 9, 16 & 17 from which corner, I run

S. 89° 49' W. on a true line between sections 8 & 17

Variation 14° 00' East

39.99

Set a Sand stone 14 x 10 x 9 ins., 10 ins.
in the ground, for $\frac{1}{4}$ Sec. Cor., marked $\frac{1}{4}$ on N. face,
dug pits 18 x 18 x 12 ins., E. and W. of stone 5 $\frac{1}{2}$
ft. dist., and raised a mound of earth 1 $\frac{1}{2}$ ft. high, 3 $\frac{1}{2}$
ft. base alongside.

79.99

The corner to sections 7, 8, 17 & 18

Land rolling.

Soil 3rd rate

Vegetation grass & sage,

Henry Meyrick June 5. 1883

Township

14 N

Range

18 E

BOOK 162

Gila and Salt River Meridian.

Chains

West, on a random line between Sections 7 and 18.

Variation

13° 30'

East.

Descend gradually.

27.16 Cross Wash, 18 lks. wide, Course N. E. and ascend.

40.00 Set temporary $\frac{1}{4}$ Sec. Cor.,

84.78 Intersect W. B. of Tp. 150 lks. N. of cor. to secs.

7.12. 13 & 18 from which corner, I run

N. 89° 40' E on a true line, between sections 7 & 18

Variation

13° 30'

East.

144.78 Set a sand store 14 x 10 x 9 ins., 70 ins. in the ground, for $\frac{1}{4}$ Sec. Cor., marked $\frac{1}{4}$ on N. face, dug pits 18 x 18 x 12 ins., E. and W. of stone 5 $\frac{1}{2}$ ft. dist., and raised a mound of earth 1 $\frac{1}{2}$ ft. high, 3 $\frac{1}{2}$ ft. base alongside.

84.78 The corner to sections 7, 8, 17 & 18

Land rolling.

Soil 3rd rate

Vegetation grass & sage.

G. W. Pearson. Compass more June 5, 1883

Township

14 N.

Range

18 E.

Gila and Salt River Meridian.

BOOK 162

Chains

North, between Sections 7 and 8.

Variation

13° 30'

East.

Descend. *gradually.*

35.76

Cross Wash, 10 lks. wide, Course N. E. and ascend.

40.00

Set a post 3 ft. long, 3 ins. diam. with marked stone
12 ins. in the ground, for $\frac{1}{4}$ Sec. Cor., marked $\frac{1}{4}$ S. on
W. face, dug pits, 18 x 18 x 12 ins., N. and S. of
post $5\frac{1}{2}$ ft. dist., and raised a mound of earth $1\frac{1}{2}$ ft.
high, $3\frac{1}{2}$ ft. base around post.

80.00

Set a post 4 ft. long, 4 ins. square, with marked stone
12 ins. in the ground, for Cor. to Secs. 5, 6, 7 & 8
marked T, 14 N. S. 5, on N, E, R, 15 E, S. 8
on S, E, S, 7 on S, W, and S, 6 on N, W, face
with 5 notches on S, and 5 notches on E, edges,
dug pits 18 x 18 x 12 ins, in each Sec., $5\frac{1}{2}$ ft, dist.,
and raised a mound of earth 2 ft, high, $4\frac{1}{2}$ ft, base
around post.

Land rolling.

Soil 3rd rate

Vegetation grass & sage.

Township 14 N BOOK 162 Range 18 E
 BOOK 162 Gila and Salt River Meridian.

Chains

East, on a random line between Sections 5 and 8.

Variation $18^{\circ} 30'$ East.

Descend.

40.00 Set temporary $\frac{1}{2}$ Sec. Cor.

80.14 Intersect N. & S. line, 40 lks. S. of cor. to secs.

4, 5, 8 & 9 from which corner, I run

S. $89^{\circ} 43' W.$ on a true line between sections 5 & 8Variation $14^{\circ} 00'$ East

40.07 Set a post 3 ft. long, 3 ins. diam. with marked stone
 12 ins. in the ground, for $\frac{1}{2}$ Sec. Cor., marked $\frac{1}{2}$ S. on
 N. face, dug pits, 18 x 18 x 12 ins., E. and W. of
 post $5\frac{1}{2}$ ft. dist., and raised a mound of earth $1\frac{1}{2}$ ft.
 high, $3\frac{1}{2}$ ft. base around post.

80.14 The corner to sections 5, 6, 7 & 8

Land rolling.

Soil 3^{rd} rate

Vegetation grass & sage

I carefully examined the adjustments of my solar
 compass to-day, particularly the latitude and revers-
 ing apparatus, and found them correct.

Henry Meyrick June 5, 1883

Township 14 N. Range 18 E.

Gila and Salt River Meridian.

BOOK 162

Chains

West, on a random line between Sections 6 and 7.

Variation $13^{\circ} 30'$ East.

Ascend.

40.00 Set temporary $\frac{1}{4}$ Sec. Cor.84.61 Intersect W. B. of Tp. 33 1/2 W. of cor. to secs. ~~previously set on me~~
1.6. 7 & 12 from which corner, I run $N. 89^{\circ} 47'$ on a true line, between sections 6 & 7
Variation $13^{\circ} 30'$ East.44.61 Set a post 3 ft. long. 3 ins. diam. with marked stone
12 ins. in the ground, for $\frac{1}{4}$ Sec. Cor., marked $\frac{1}{4}$ S. on
N. face, dug pits, 18 x 18 x 12 ins., E. and W. of
post $5\frac{1}{2}$ ft. dist., and raised a mound of earth $1\frac{1}{2}$ ft.
high, $3\frac{1}{2}$ ft. base around post.

84.61 The corner to sections 5. 6. 7. 8.

Land rolling.

Soil 3rd rate

Vegetation grass & sage.

Township

14 N

Range

18 E

Gila and Salt River Meridian.

Chains

North, on a random line between Sections 5 and 6.

Variation $14^{\circ} 15'$ East.*Ascend.*40.00 Set temporary $\frac{1}{4}$ Sec. Cor.79.86 Intersect N. B. of Tp. 10 lks. E. of cor. to secs.
previously set by me.
S. 6. 31 & 32 from which corner, I runS. $7'$ E. on a true line, between sections 5 & 6Variation $13^{\circ} 30'$ East.39.86 Set a post 3 ft. long, 3 ins. diam. with marked stone
12 ins. in the ground, for $\frac{1}{4}$ Sec. Cor., marked $\frac{1}{4}$ S. on
W. face, dug pits, 18 x 18 x 12 ins. N. and S. of
post $5\frac{1}{2}$ ft. dist., and raised a mound of earth $1\frac{1}{2}$ ft.
high, $3\frac{1}{2}$ ft. base around post.

79.86 The corner to sections 5. 6. 7 & 8

Land rolling.

Soil 3rd rate

Timber of juniper

Vegetation. grass & sage.

I carefully examined the adjustments of my solar
compass to-day, particularly the latitude and revers-
ing apparatus, and found them correct.

G. W. Pearson Compassman June 5, 1883

GENERAL DESCRIPTION.
 BOOK 162

This Tp. is a vast grazing country, it is very gently rolling in the southern part; but almost level in the northern part.

There is a little timber of juniper in the S. E.

The Northern part is almost void of timber. It is a rich agricultural district.

The washes that rise & deposit their contents in this basin forming a very rich soil.

There is a cabin in the N. W. part of Sec. 2.

Soil varies from 2nd to 3rd rate.

For Trial Dates
 See Book No. 18.

U. S. Surveyor-General's Office.

.....188'

The foregoing Field Notes of the surveys of

.....*Meridian*

in.....*executed by*

.....*U. S. Deputy Surveyor, under his contract dated*

.....*having been critically examined, the necessary corrections and explanations made, the said Field Notes and the surveys they describe are hereby approved.*

.....*U. S. Surveyor-General for*

U. S. Surveyor General's Office,

Tucson, Arizona, July, 5, 1884

The foregoing Field Notes of the Survey of the

Subdivision Line of
Township 14 North
Range 18 East

Of the Gila and Salt River Base and Meridian, Arizona, execu-
ted by Henry Meyrick Jr.

Deputy Surveyor, under his contract of the 25th

day of July, 1882, having been

critically examined and the necessary corrections and explana-

tions made, the said Field Notes and the surveys they describe

are hereby approved

Royal Johnson
Surveyor General.