

Book No. 9.

No-163

# Field Notes

OF THE SURVEY OF THE

**SUBDIVISION LINES**

- OF -

Township 14 N Range 19 E

*Gila and Salt River Base and Meridian*

**ARIZONA.**

By M. N. Grant D. S.

under contract dated Aug 7<sup>th</sup> 1882.

Survey commenced June 7<sup>th</sup> 1883.

Survey completed June 9<sup>th</sup> 1883.

No-163

163

1A

BOOK 163

BOOK 163

INDEX DIAGRAM.

Township 14 N.

Range 19 E

6	60	5	44	4	33	3	22	2	11	1
59		58		43		32		21		10
7	57	8	42	9	31	10	20	11	9	12
56		55		41		30		19		8
18	54	17	40	16	29	15	18	14	7	13
53		52		39		28		17		6
19	51	20	38	21	27	22	16	23	5	24
50		49		37		26		15		4
30	48	29	36	28	25	27	14	26	3	25
47		46		35		24		13		2
31	45	32	34	33	23	34	12	35	1	36

Gila and Salt River, Arizona.

ARIZONA.

No-163

15

Township 14 North Range 19 East  
Gila + Salt River Meridian.

For preliminary oaths  
see Book 712 1.

Survey commenced June 7<sup>th</sup> 1883  
Survey completed June 9<sup>th</sup> 1883

Survey made with Bunts Improved  
Solar Compasses nearly new and in  
first rate order. Made by Otto  
Fennel of Cassel Germany in 1881.  
Before proceeding to subdivide this Twp.  
I made a change of 5 minutes in the  
latitude arc of my Solar Compass  
by adding same to the reading pre-  
viously given and at noon verified  
and corrected same by observation  
on the Sun and also further tested  
instruments by reversing.



10

BOOK 163

BOOK 163

Township 14 North Range 19 East  
 of Gila + Salt River Meridian.

From Cor. to Secs 35-36-1+2 on S. B.  
 previously set by me. From  
 North Int. Secs. 35+36.  
 va.  $13^{\circ}30' E$ .

Ascend gradually

40.00 Set a sand stone  $14 \times 6 \times 4$  ins. 9 ins.  
 in the ground for  $\frac{1}{4}$  Sec. Cor. Marked  
 $\frac{1}{4}$  on N. face, and raised a mound  
 of stone alongside. Pits impracticable.

80.00 Set a post 4 ft. long 4 ins. square, with marked  
 stone, 12 ins. in the ground for Cor. to Secs,  
 25-26-35+36 marked T. 14 N S. 25 on  
 N. E. R. 19 E. S. 36 on S. E. S. 35 on  
 S. W. and S. 26 on N. W. face, with 1 notch  
 on S, and 1 notch on E. edges, dug  
 pits  $18 \times 18 \times 12$  ins. in each Sec.,  $5\frac{1}{2}$  ft. dist.  
 and raised a mound of earth 2 ft, high.  $4\frac{1}{2}$  ft.  
 base. around post.

Surface rolling  
 Soil 2<sup>o</sup>. rate

Good grass.

Some Juniper Bush





Tp. 14 N. R. 19 E.

S. G. + S. R. M.

North lot. Secs. 25 + 26.

wa. 1330' E.

Descend gradually

36.00 Cross Wash 10 lks. Wide Co. N. 60° E. descend gradually.

40.00 Set a post 3 ft. long 3 ins. diam with marked stone, 12 ins, in the ground for  $\frac{1}{4}$  Sec, Cor, marked  $\frac{1}{4}$  S. on W. face, dug pits 18 x 18 x 12 ins. N. and S of post  $5\frac{1}{2}$  ft. dist. and raised a mound of earth  $1\frac{1}{2}$  ft, high.  $3\frac{1}{2}$  ft. base. around post.

80.00 Set a post 4 ft. long 4 ins. square, with marked stone, 12 ins, in the ground for Cor, to Secs, 23-24-25+26 marked T. 14 N, S. 24 on N. E. R. 19 E. S. 25 on S. E, S, 26 on S, W, and S, 23 on N, W, face, with 2 notches on S, and 1 notch - on E. edges, dug pits 18 x 18 x 12 ins. in each Sec.,  $5\frac{1}{2}$  ft. dist. and raised a mound of earth 2 ft, high.  $4\frac{1}{2}$  ft. base. around post.

Surface rolling + Slopes grad. to East  
Soil 2 into  
good grass.

Some Juniper Bush.

Tr. 14 N. R. 19 E.

Sec. 4. + S. R. M.

East, on a random line bet. Secs. 24 + 25,  
 Va.  $13^{\circ}30' E$ .

Descends gradually

40.00 Set temporary  $\frac{1}{4}$  Sec. Cor.

79.81 Intersect E. 1/3 of Tr. 19 lks. S of  
 Cor. to Secs. 19-24-25 + 30, previously  
 set by me. Hence I run  
 $S. 89^{\circ}52' N.$  on a true line bet. Secs. 24 + 25,  
 Va.  $13^{\circ}30' E$ .

39.90 Set a Sand Stone  $14 \times 10 \times 7$  ins. 9 ins.  
 in the ground for  $\frac{1}{4}$  Sec. Cor. Marked  
 $\frac{1}{4}$  on N. face, and raised a mound  
 of Stone alongside. Pitts impracticable

79.81 The Cor. to Secs. 23-24-25 + 26.

Surface rolling, slopes to East. grad.

Soil 2<sup>d</sup> rate

• Good grass.

Some Juniper Bush

Tr. 14 N. R. 19 E.

Ch.

G. + S. R. M.

North lot Secs. 73 + 24  
 Va. 13° 30' E.

Descend gradually

21.60

Enter Rolling Valley

40.00

Set a post 3 ft. long 3 ins. diam with marked stone, 12 ins. in the ground for  $\frac{1}{2}$  Sec. Cor, marked  $\frac{1}{2}$  S. on N. face, dug pits 18 x 18 x 12 ins. N. and S. of post 5  $\frac{1}{2}$  ft. dist. and raised a mound of earth 1  $\frac{1}{2}$  ft. high. 3  $\frac{1}{2}$  ft. base. around post.

80.00

Set a sand stone 14 x 9 x 5 ins, 9 ins. in the ground for Cor. to Secs, 13-14-23+24 marked with 3 notches on S. and 1 notch on E. edges, dug pits 18 x 18 x 12 ins. in each Sec., 5  $\frac{1}{2}$  ft. dist. and raised a mound of earth 2 ft. high. 4  $\frac{1}{2}$  ft. base. alongside.

Surface slopes gradually to East.  
 Soil 3<sup>d</sup> rate  
 Poor grass. Sec. 24 -



Tr 14 N. R. 19 E.  
 S. H. + S. R. M.

Earl. on a random line bet. Secs. 13 & 24

Va.  $13^{\circ}45' E.$

Descent gradually

40.00 Set temporary  $\frac{1}{4}$  Sec. Cor. and  
 ascent slightly

79.68 Interval S. B. of Tr. 44 lks. S. of

Cor. to Secs. 13-18-19 & 24 previously  
 set by me. Hence I run

S. 89.41 N. on a true line bet. Secs. 13-24

Va.  $13^{\circ}45' E.$

3984

**Set a post** 3 ft. long 3 ins. diam with marked  
 stone, 12 ins, in the ground for  $\frac{1}{4}$  Sec, Cor,  
 marked  $\frac{1}{4}$  S. on N. face, dug pits 18 x 18 x 12  
 ins. E. and W. of post  $5\frac{1}{2}$  ft. dist. and raised  
 a mound of earth  $1\frac{1}{2}$  ft, high.  $3\frac{1}{2}$  ft. base. around  
 post.

79.68 The Cor. to Secs. 13-14-23 & 24

Surface slopes gradually to East  
 Soil 3' rate  
 Good grass.

Tk. 14 N. R. 19 E.

Chs

G. + S. R. M.

North lot. Secs. 13 + 14

Va. 18° 30' E.

Descend gradually

40.00

Set a post 3 ft. long 3 ins. diam with marked stone, 12 ins, in the ground for  $\frac{1}{4}$  Sec. Cor, marked  $\frac{1}{4}$  S. on N. face, dug pits 18 x 18 x 12 ins. N and S of post 5  $\frac{1}{2}$  ft. dist. and raised a mound of earth 1  $\frac{1}{2}$  ft. high. 3  $\frac{1}{2}$  ft. base. around post.

80.00

Set a post 4 ft. long 4 ins. square, with marked stone, 12 ins, in the ground for Cor, to Secs, 11-12-13+14 marked T. 14 N. S. 12 on N. E. R. 19 E. S. 13 on S. E. S, 14 on S, W, and S, 11 on N, W, face, with  $\frac{1}{4}$  notch on S, and 1 notch - on E. edges, dug pits 18 x 18 x 12 ins. in each Sec., 5  $\frac{1}{2}$  ft. dist. and raised a mound of earth 2 ft. high. 4  $\frac{1}{2}$  ft. base. around post.

Surface rolling  
 Soil 3<sup>rd</sup> rate  
 Grass good

Th. 114 N. R. 19 E.  
Ch. G. & S. R. M.

East. on a random line bet. Secs. 12+13.  
va.  $13^{\circ}45' \Sigma$ .

Over level land.

40.00 Set temporary  $\frac{1}{4}$  Sec. Cor.

63.80 Foot of Hill bet N 57' W & ascent

50.07 Intersect  $\Sigma$ . B. of Twp. 63 E. S. of Cor.

to Secs. 7-12-13+18. previously set  
by me. Thence I run

S.  $89^{\circ}33' N$ . on a true line bet. Secs. 12+13.

va.  $13^{\circ}45' \Sigma$ .

40.04

Set a post 3 ft. long 3 ins. diam with marked  
stone, 12 ins, in the ground for  $\frac{1}{4}$  Sec. Cor,  
marked  $\frac{1}{4}$  S. on N. face, dug pits 18 x 18 x 12  
ins.  $\Sigma$ . and N. of post  $5\frac{1}{2}$  ft. dist. and raised  
a mound of earth  $1\frac{1}{2}$  ft. high.  $3\frac{1}{2}$  ft. base. around  
post.

50.07

The Cor. to Secs. 11-12-13+14

Sec 13 - Surface level

Soil 2<sup>d</sup> rate

low grass.



Th. 1st N. R. 19 E.

Chs. G. + S. R. M.

North. bet. Secs. 11 & 12.  
 Va. 134 S E.

Over level Mesa -

31.92 Foot of Hill bet. E. & W. corners

40.00 Set a Sand stone, 24 x 8 x 3 ins., 18 ins. in the ground for  $\frac{1}{4}$  Sec. Cor. marked  $\frac{1}{4}$  on W. face, dug pits 18 x 18 x 12 ins. N and S. of stone 5 $\frac{1}{2}$  ft. dist. and raised a mound of earth 1 $\frac{1}{2}$  ft. high. 3 $\frac{1}{2}$  ft. base. alongside.

62.00 Top of Bluff 130 ft. high on E. & W. and enter Tableland

80.00 Set a Sand stone 7 x 10 x 3 ins., 12 ins. in the ground for Cor. to Secs. 1-2-11 & 12 marked with 5 notches on S. and 1 notch on E. edges, dug pits 18 x 18 x 12 ins. in each Sec., 5 $\frac{1}{2}$  ft. dist. and raised a mound of earth 2 ft. high. 4 $\frac{1}{2}$  ft. base. alongside.

Surface rolling  
 Soil 3 $\frac{1}{2}$  rate  
 Grass good.

Tr. 14 N. R. 19 E.

Ch G. + S. R. M.

East, on a random line bet. Secs. 1 + 12.  
 Va.  $13^{\circ}45'E$ .

ascend gradually

40.00 Set temporary  $\frac{1}{4}$  Sec. Cor.

80.24 Interval E. B. of Tr. 40 lks. S. of Cor.  
 to Secs. 1-6-7+12 previously set  
 by me. Thence I run  
 $S. 89^{\circ}43' W.$  on a true line bet. Secs. 1 + 12.  
 Va.  $13^{\circ}45'E$ .

40.12 Set a Sand Stone  $26 \times 8 \times 4$  ins 18  
 ins in the ground for  $\frac{1}{4}$  Sec. Cor.  
 Marker  $\frac{1}{4}$  on N. face, and raise  
 a mound of stones alongside

80.24 <sup>Pits impracticable</sup>  
 low to Secs 1 2 11 + 12  
 Sec. 12. Surface slightly rolling  
 Soil 3<sup>rd</sup> rate & rocky  
 Grass fair  
 Some Juniper Bush

Sp 144 N. R. 19 E.

Chs: G. + S. R. M.

Wth. on a random line bet. Secs. 1 + 2.  
 Va. 1345' E.

Ascend gradually

14.00 Top of Bluff + descends gradually

110.00 Set temporary  $\frac{1}{4}$  Sec. Cor.

80.16 Intersect N. B. of 7 p. 8 k. E. of Cor.

to Secs. 1-2-35 + 36. previously

Set by one. James Iron

S. 3' E. on a true line bet. Secs. 1 + 2.

Va. 1345' E.

40.16 Set a post 3 ft. long 3 ins. diam with marked  
 stone, 12 ins, in the ground for  $\frac{1}{4}$  Sec, Cor,  
 marked  $\frac{1}{4}$  S. on N. face, dug pits 18 x 18 x 12  
 ins. N. and S. of post  $5\frac{1}{2}$  ft. dist. and raised  
 a mound of earth  $1\frac{1}{2}$  ft. high.  $3\frac{1}{2}$  ft. base. around  
 post.

80.16 The Cor. to Secs. 1-2-11-12.

Sec 1. Slightly rolling

Soil 3<sup>d</sup> rate + rocky

Grass fair

Some Juniper brush

M. N. Grant June 7. 1883.



BOOK

Tp. 14 N. R. 19 E.  
Ch. G. + S. R. M.

From the Cor. to Secs <sup>2.3</sup> 34 + 35, <sup>on S. B. T. p</sup> previously  
 set by me, I run  
 North cut Secs. 34 + 35  
 ascent gradually Va 1330' E.  
 37.00 Top of Spur 110 ft. high Cor. E. N. + descent.  
 40.00 **Set a post 3 ft. long 3 ins. diam with marked  
 stone, 12 ins, in the ground for 1/4 Sec, Cor,  
 marked 1/4 S. on N. face, dug pits 18 x 18 x 12  
 ins. N. and S. of post 5 1/2 ft. dist. and raised  
 a mound of earth 1 1/2 ft, high. 3 1/2 ft. base. around  
 post.**  
 80.00 **Set a post 4 ft. long 4 ins. square, with marked  
 stone, 12 ins, in the ground for Cor, to Secs,  
 26-27-34+35 marked T. 14 N. S. 26 on  
 N. E. R. 19. E, S. 35 on S. E, S, 34 on  
 S, W, and S, 27 on N, W, face, with 1 notch  
 on S, and 2 notch 20 on E. edges, dug  
 pits 18 x 18 x 12 ins. in each Sec., 5 1/2 ft. dist.  
 and raised a mound of earth 2 ft, high. 4 1/2 ft.  
 base. around post.**  
 Surface rolling  
 Soil 6: rate  
 Grass fair

Tr. 14 N. R. 19 E,  
Chs. G. & S. R. M.

Each on a random line bet. Secs. 26 & 35  
Va.  $13^{\circ}30' E$ .

Ascends gradually

40.00 Set temporary  $\frac{1}{4}$  Sec. Cor.

55.00 Top of Butte 60 ft. high. br. N. & S. + descend grad.

79.78 Interset N. & S. line 16 lks. N. of Cor.

to Secs. 25-26-35 & 36. Hence I run

N.  $89^{\circ}53' N$ . on a true line bet. Secs. 26 & 35

Va.  $13^{\circ}30' E$ .

79.89 Set a post 3 ft. long 3 ins. diam with marked  
stone, 12 ins, in the ground for  $\frac{1}{4}$  Sec, Cor.  
marked  $\frac{1}{4}$  S. on N. face, dug pits 18 x 18 x 12  
ins. E. and W. of post  $5\frac{1}{2}$  ft. dist. and raised  
a mound of earth  $1\frac{1}{2}$  ft. high.  $3\frac{1}{2}$  ft. base. around  
post.

79.78  $\frac{1}{4}$  Cor. to Secs. 26-27-34 & 35

Sec 35. is slightly rolling

Soil 3<sup>rd</sup> rate

Grass fair

Scattering Juniper Brush

T. 14 N. R. 19 E.

Ch. G. + S. R. M.

North, bet. Secs. 26 + 27  
Va.  $13^{\circ} 30' E$ ,

ascend

40.00 Set a post 3 ft. long 3 ins. diam with marked stone, 12 ins. in the ground for  $\frac{1}{4}$  Sec, Cor, marked  $\frac{1}{4}$  S. on N. face, dug pits 18 x 18 x 12 ins. N. and S. of post  $5\frac{1}{2}$  ft. dist. and raised a mound of earth  $1\frac{1}{2}$  ft. high.  $3\frac{1}{2}$  ft. base. around post.

40.38 Point of Hill bet N.W. + descend

80.00 Set a post 4 ft. long 4 ins. square, with marked stone, 12 ins. in the ground for Cor, to Secs, 22-23-26+27 marked T. 14 N. S. 25 on N. E. R. 19 E, S. 26 on S. E, S, 27 on S. W. and S, 22 on N, W, face, with 2 notch  $\infty$  on S, and 2 notch  $\infty$  on E. edges, dug pits 18 x 18 x 12 ins. in each Sec.,  $5\frac{1}{2}$  ft. dist. and raised a mound of earth 2 ft. high.  $4\frac{1}{2}$  ft. base. around post.

Surface rolling  
Soil 3<sup>d</sup> rate  
Grass fair.



Th. 14 N. R. 19 E.

Ch G. + S. R. M.

East, on a random line bet. Secs. 23 + 26.

va.  $13^{\circ}30'$  E.

Ascend gradually

40.00 Set temporary  $\frac{1}{4}$  Sec. Cor.

46.56 Top of Spur 60 ft high. brs. N. + descend.

79.69 Intersect N. + S. line 29 lks. N. of Cor.

to Secs. 23-24-25 + 26. Thence I run  
N.  $89^{\circ}48'$  N. on a true line bet. Secs 23 + 26.

va.  $13^{\circ}30'$  E.

39.84

Set a post 3 ft. long 3 ins. diam with marked  
stone. 12 ins, in the ground for  $\frac{1}{4}$  Sec, Cor,  
marked  $\frac{1}{4}$  S. on N. face, dug pits 18 x 18 x 12  
ins. E. and W. of post  $5\frac{1}{2}$  ft. dist. and raised  
a mound of earth  $1\frac{1}{2}$  ft. high.  $3\frac{1}{2}$  ft. base. around  
post.

79.69

Th. Cor. to Secs. 22-23-26 + 27  
Sec. 26. is rolling + rocky  
Soil 3<sup>d</sup>. rate  
Good grass.  
Scattering Juniper Bush

Tr. 14 N. R. 19 E.

Ch. G. & S. R. M.

North bet. Secs, 22 + 23,  
 Va, 3° 30' E.

Nearly level.

40.00 Set a post 3 ft. long 3 ins. diam with marked stone, 12 ins, in the ground for  $\frac{1}{4}$  Sec, Cor, marked  $\frac{1}{4}$  S. on N. face, dug pits 18 x 18 x 12 ins. N. and S. of post 5  $\frac{1}{2}$  ft. dist. and raised a mound of earth 1  $\frac{1}{2}$  ft. high. 3  $\frac{1}{2}$  ft. base. around post.

80.00 Set a post 4 ft. long 4 ins. square, with marked stone, 12 ins, in the ground for Cor, to Secs, 14-15-22 + 23 marked T. 14 N. S. 14 on N. E. R. 19 E. S. 23 on S. E, S. 22 on S. W. and S. 15 on N. W. face, with  $\frac{3}{4}$  notch on S. and 2 notch on E. edges, dug pits 18 x 18 x 12 ins. in each Sec., 5  $\frac{1}{2}$  ft. dist. and raised a mound of earth 2 ft. high. 4  $\frac{1}{2}$  ft. base. around post.

Surface rolling  
 Soil 3? rate  
 Grass fair.

Th. 14 N. R. 19 E.

Obs G. & S. R. M.

Cast on a random line bet. Secs. 14 + 23  
 Va. 3° 30' E.

descent gradually

40.00 Set temporary  $\frac{1}{4}$  Sec. Cor.

79.91 Intersect N. & S. line 42 Chs. S. of Cor.  
 to Secs. 13-14-23 + 24. Thence I run  
 S. 89° 42' W. on a true line bet. Secs. 14 + 23.  
 Va. 13° 30' E.

39.9 J- Set a post 3 ft. long 3 ins. diam with marked  
 stone, 12 ins, in the ground for  $\frac{1}{4}$  Sec, Cor,  
 marked  $\frac{1}{4}$  S. on N. face, dug pits 18 x 18 x 12  
 ins. E. and W of post 5  $\frac{1}{2}$  ft. dist. and raised  
 a mound of earth 1  $\frac{1}{2}$  ft. high. 3  $\frac{1}{2}$  ft. base. around  
 post

79.91 The Cor. to Secs. 14-15-22 + 23.  
 Sec. 23. is gently rolling  
 Soil 2° + 3° rate  
 poor grass.



T. 14 N. R. 19 E.

Ch. G. & S. R. M.

North cut. Secs. 14 + 15,  
va. 13° 30' E.

Descend gradually

40.00

Set a post 3 ft. long 3 ins. diam with marked stone, 12 ins. in the ground for  $\frac{1}{4}$  Sec, Cor, marked  $\frac{1}{4}$  S. on N. face, dug pits 18 x 18 x 12 ins. N and S, of post 5 $\frac{1}{2}$  ft. dist. and raised a mound of earth 1 $\frac{1}{2}$  ft. high. 3 $\frac{1}{2}$  ft. base. around post.

80.00

Set a post 4 ft. long 4 ins. square, with marked stone, 12 ins. in the ground for Cor, to Secs, 10-11-14 + 15 marked T. 14 N. S. 11 on N. E. R. 19 E. S. 14 on S. E. S, 15 on S, W, and S, 10 on N, W, face, with 4 notches on S, and 2 notches on E. edges, dug pits 18 x 18 x 12 ins. in each Sec., 5 $\frac{1}{2}$  ft. dist. and raised a mound of earth 2 ft. high. 4 $\frac{1}{2}$  ft. base. around post.

Surface rolling  
Grass fair  
Soil 3<sup>d</sup>. rate

Th. 14 N. R. 19 E.

Chs. G. + S. R. M.

Each on a random line bet. Secs 11 & 14  
 Va.  $13^{\circ}30' E$

Over rolling Valley

40.00 Set temporary  $\frac{1}{4}$  Sec. Cor.

80.18 Intersect N. + S. line 33 W. N. of  
 Cor. to Secs. 11-12-13 & 14. Then I run  
 N.  $89^{\circ}46' N$ . on a true line bet. Secs. 11-14  
 Va  $13^{\circ}30' E$ .

40.09 Set a post 3 ft. long 3 ins. diam with marked  
 stone, 12 ins, in the ground for  $\frac{1}{4}$  Sec, Cor,  
 marked  $\frac{1}{4}$  S. on N. face, dug pits 18 x 18 x 12  
 ins. E. and W. of post  $5\frac{1}{2}$  ft. dist. and raised  
 a mound of earth  $1\frac{1}{2}$  ft. high.  $3\frac{1}{2}$  ft. base. around  
 post.

80.18 The Cor. to Secs. 10-11-14 & 15  
 Sec. 14. is a Rolling Valley  
 Soil 3<sup>rd</sup> rate  
 Good grazing

Tr 14 N. R. 19 E.  
 Ch. G. + S. R. M.

North bet. Secs. 10 + 11.  
 Va. 13° 30' E.

Nearly level.

- 34.73 Foot of Hill bet. E + N. + ascend  
 40.00 Set a Sand stone, 16 x 10 x 9 ins., 11 ins.  
 in the ground for  $\frac{1}{4}$  Sec, Cor, marked  $\frac{1}{4}$ . on W.  
 face, dug pits 18 x 18 x 12 ins. N. and S.  
 of stone 5 ft. dist. and raised a mound of earth  
 1  $\frac{1}{2}$  ft. high 3  $\frac{1}{2}$  ft. base. along side.  
 78.00 Top of Bluff 120 ft. high bet. N. 50° W. + descend.  
 80.00 Set a Sand stone 19 x 12 x 4 ins., 12 ins. in  
 the ground for Cor, to Secs. 2-3-10 + 11 marked  
 with 5 notches on S. and 2 notches on E. edges,  
 dug pits 18 x 18 x 12 ins. in each Sec., 5  $\frac{1}{2}$  ft.  
 dist. and raised a mound of earth 2 ft. high  
 4  $\frac{1}{2}$  ft. base. alongside.

Surface rolling  
 Soil 3<sup>rd</sup> rate  
 Grass good



Th. 12 N. R. 19 E.

Ch. G. + S. R. M.

East, on a random line bet. Secs. 2 + 11.

va.  $13^{\circ}45' E$ .

descends gradually along side of Hill

40.00 Set temporary  $\frac{1}{4}$  Sec. Cor.

80.40 Intersect N. + S. line 26 Chs. S. of Cor  
to Secs. 1-2-11 + 12. Thence I run

S.  $89^{\circ}49' N$ . on a true line bet. Secs. 2 + 11.

va.  $13^{\circ}45' E$ .

40.70

Set a post 3 ft. long 3 ins. diam with marked  
stone, 12 ins, in the ground for  $\frac{1}{4}$  Sec, Cor,  
marked  $\frac{1}{4}$  S. on N. face, dug pits 18 x 18 x 12  
ins. E. and S. of post  $5\frac{1}{2}$  ft. dist. and raised  
a mound of earth  $1\frac{1}{2}$  ft, high.  $3\frac{1}{2}$  ft. base. around  
post.

80.40

Th. Cor. to Secs. 2-3-10 + 11,

Sec. 11. Slopes gradually to S. E.

Soil 3<sup>rd</sup> rate

good grass.

Some Juniper Bush.

Tr. 14 N. R. 19. E.

Ch. G. + S. R. M.

North on a random line bet. Secs. 2 + 3.

Va. 13<sup>0</sup> 45' E.

Ascend gradually

40.00 Set temporary  $\frac{1}{4}$  Sec. Cor.

80.20 Induced N. B. of Tr. 19 lks. N. of Cor.

to Secs. 2 - 3 - 34 + 35 previously  
set by me. Thence I run

S. 8' N. on a true line bet. Secs. 2 + 3.

Va. 13<sup>0</sup> 45' E.

40.20 Set a Sand stone, 17 x 8 x 4 ins., 12 ins.

in the ground for  $\frac{1}{4}$  Sec, Cor, marked  $\frac{1}{4}$ . on N.

face. dug pits 18 x 18 x 12 ins. N. and S.

of stone 5 $\frac{1}{2}$  ft. dist. and raised a mound of earth

1 $\frac{1}{2}$  ft. high. 3 $\frac{1}{2}$  ft. base. alongside.

80.20 The Cor. to Secs. 2 - 3 - 10 + 11.

Sec. 2. is smooth slope to the South.

Soil 2<sup>o</sup>. rate

Good grass.

Some Juniper Brush.

A. H. Arnold Comptroller

June 7. 1883.

BOOK 163

T<sub>h</sub>. 14 N. R. 19 E.O<sub>l</sub>'s G. + S. R. M.

304 on S. R. Sp.

From Cor. to Secs 33 + 34, previously set by me. I run North bet. Secs. 33. + 34  
Va. 1330' E.

*Descend over rolling ground*

40.00

**Set a post 3 ft. long 3 ins. diam with marked stone, 12 ins, in the ground for  $\frac{1}{4}$  Sec, Cor, marked  $\frac{1}{4}$  S. on N. face, dug pits 18 x 18 x 12 ins. N. and S. of post  $5\frac{1}{2}$  ft. dist. and raised a mound of earth  $1\frac{1}{2}$  ft, high.  $3\frac{1}{2}$  ft. base. around post.**

80.00

**Set a post 4 ft. long 4 ins. square, with marked stone, 12 ins, in the ground for Cor, to Secs, 27-28-33 + 34 marked T. 14 N. S. 27 on N. E. R. 19 E. S. 34 on S. E. S, 35 on S, W, and S, 28 on N. W. face, with 1 notch on S, and 3 notches on E. edges, dug pits 18 x 18 x 12 ins. in each Sec.,  $5\frac{1}{2}$  ft. dist. and raised a mound of earth 2 ft, high.  $4\frac{1}{2}$  ft. base. around post.**

*Surface rolling  
Soil 3" rate  
Grass land.*



Th. 14 N. R. 19 E.  
 Chs G. & S. R. M.

East, on a random line bet. Secs. 27 & 34  
 Va.  $13^{\circ}30' E.$

Acres slightly rolling

40.00 Set temporary  $\frac{1}{4}$  Sec. Cor.

79.63 Inters. N. & S. line 28 lks. S. of Cor. to  
 Secs. 26-27-34 & 35. Thence I run

S.  $89^{\circ}48' N.$  on a true line bet. Secs. 27 & 34  
 Va.  $13^{\circ}30' E.$

39.82

**Set a post 3 ft. long 3 ins. diam with marked  
 stone, 12 ins, in the ground for  $\frac{1}{4}$  Sec, Cor,  
 marked  $\frac{1}{4}$  S. on N. face, dug pits 18 x 18 x 12  
 ins. E. and W. of post  $5\frac{1}{2}$  ft. dist. and raised  
 a mound of earth  $1\frac{1}{2}$  ft. high.  $3\frac{1}{2}$  ft. base. around  
 post.**

79.63 The Cor. to Secs. 27-28-33 & 34

Sec. 34. is slightly rolling  
 Soil 3<sup>rd</sup> rate

Good grass.

Scrubby Juniper.

BOOK 163

Tl. 12 N. R. 19 E.

Ch. G. + S. R. M.

North cut. Secs. 27 + 28.

Va.  $13^{\circ}30'$  E.

Ascend gradually

40.00

Set a post 3 ft. long 3 ins. diam with marked stone, 12 ins, in the ground for  $\frac{1}{4}$  Sec, Cor, marked  $\frac{1}{4}$  S. on N. face, dug pits 18 x 18 x 12 ins. N. and S. of post  $5\frac{1}{2}$  ft. dist. and raised a mound of earth  $1\frac{1}{2}$  ft. high.  $3\frac{1}{2}$  ft. base. around post.

80.00

Set a post 4 ft. long 4 ins. square, with marked stone, 12 ins, in the ground for Cor, to Secs, 21-22-27+28 marked T. 14 N. S. 22 on N. E. R. 19 E, S. 27 on S. E, S, 28 on S, W, and S, 21 on N, W, face, with Z notch 20 on S, and 3 notch 20 on E. edges, dug pits 18 x 18 x 12 ins. in each Sec.  $5\frac{1}{2}$  ft. dist. and raised a mound of earth 2 ft, high.  $4\frac{1}{2}$  ft. base. around post.

Surface rolling  
Soil 3<sup>rd</sup> rate  
Grass grow.

Tr. 14 N. R. 19 E.  
Ch. G. & S. R. M.

East, on a random line bet. Secs. 22 & 27.  
Va.  $13^{\circ}30' E$ .

Marshy level

40.00 Set temporary  $\frac{1}{4}$  Sec. Cor.

79.94 Intersect N. & S. line 17 lbs. S. of Cor.  
to Secs. 22-23-26 & 27. Thence I run  
 $S. 89^{\circ}53' N.$  on a true line bet. Secs. 22 & 27  
Va.  $13^{\circ}30' E$ .

39.77

**Set a post 3 ft. long 3 ins. diam with marked  
stone, 12 ins, in the ground for  $\frac{1}{4}$  Sec, Cor,  
marked  $\frac{1}{4}$  S. on N. face, dug pits 18 x 18 x 12  
ins. E. and N. of post  $5\frac{1}{2}$  ft. dist. and raised  
a mound of earth  $1\frac{1}{2}$  ft. high.  $3\frac{1}{2}$  ft. base. around  
post.**

79.94 The Cor. to Secs. 21-22-27 & 28.

Sec. 27 - is rolling

Soil 2<sup>d</sup> rate

Good grass

Thick Juniper Brush



BOOK 163

T. 14 N. R. 19 E.

Ch

G. + S. R. M.

North bet Secs. 21 + 22.

va. 1330 E.

Descend gradually

40.00

Set a post 3 ft. long 3 ins. diam with marked stone, 12 ins, in the ground for 1/2 Sec, Cor, marked 1/2 S. on N. face, dug pits 18 x 18 x 12 ins. N. and S. of post 5 1/2 ft. dist. and raised a mound of earth 1 1/2 ft, high. 3 1/2 ft. base. around post.

80.00

Set a post 4 ft. long 4 ins. square, with marked stone, 12 ins, in the ground for Cor, to Secs, 15-16-21+22 marked T. 14 N. S. 15 on N. E. R. 19 E. S. 22 on S. E, S, 21 on S, W, and S, 16 on N, W, face, with 3 notch on S, and 3 notch on E. edges, dug pits 18 x 18 x 12 ins. in each Sec.. 5 1/2 ft dist. and raised a mound of earth 2 ft. high. 1 1/2 ft. base. around post.

Surface rolling  
Soil 3<sup>rd</sup> rate  
Grass fair

BOOK 163

Tp. 14 N. R. 19 E.  
Chs G. & S. R. M.

East, on a random line bet. Secs. 15 + 22.  
Va. 13° 30' E.

Ascend gradually from Cor.

40.00 Set temporary  $\frac{1}{4}$  Sec. Cor.

80.35 Intersect N + S. line 39 Chs. S. of Cor.  
to Secs. 14 - 15 - 22 + 23 Thence Iron  
S. 89° 43' W. on a true line bet. Secs. 15 + 22.  
Va. 13° 30' E.

40.18 Set a post 3 ft. long 3 ins. diam with marked  
stone, 12 ins, in the ground for  $\frac{1}{4}$  Sec. Cor.  
marked  $\frac{1}{4}$  S. on N. face, dug pits 18 x 18 x 12  
ins. E. and W. of post 5  $\frac{1}{2}$  ft. dist. and raised  
a mound of earth 1  $\frac{1}{2}$  ft, high. 3  $\frac{1}{2}$  ft. base. around  
post.

80.35 The Cor. to Secs. 15 - 16 - 21 + 22.  
Sec. 22. is slightly rolling  
Soil 2<sup>d</sup> rate  
Good grass.  
Scattering Juniper.

BOOK 183

Tr. 14 N. R. 19 E.

Chs

G. + S. R. M.

North bet. Secs. 15 + 16.

Pa.  $10^{\circ}30' E$ .

Descends gradually

40.00

Set a post 3 ft. long 3 ins. diam with marked stone, 12 ins, in the ground for  $\frac{1}{4}$  Sec, Cor, marked  $\frac{1}{4}$  S. on N. face, dug pits 18 x 18 x 12 ins. N. and S. of post  $5\frac{1}{2}$  ft. dist. and raised a mound of earth  $1\frac{1}{2}$  ft. high.  $3\frac{1}{2}$  ft. base. around post.

48.50

Enter Corral bet. N.W. + S.E.

77.00

Leave Corral bet. E. + N.

80.00

Set a post 4 ft. long 4 ins. square, with marked stone, 12 ins, in the ground for Cor, to Secs, 9-10-15+16 marked T. 14 N. S. 10 on N. E. R. 19 E, S. 15 on S. E, S, 16 on S, W, and S, 9 on N, W, face, with 4 notch es on S, and 3 notch es on E. edges, dug pits 18 x 18 x 12 ins. in each Sec.,  $5\frac{1}{2}$  ft. dist. and raised a mound of earth 2 ft, high.  $4\frac{1}{2}$  ft. base. around post.

Surface rolling

Soil 3. rate

↳ Grass fair



Sp. 14 N. R. 19 E.  
Ch G. + S. R. M.

East, on a random line bet. Secs. 10 + 15  
va.  $13^{\circ} 30' E$ ,

Slightly rolling

40.00 Set temporary  $\frac{1}{4}$  Sec. Cor.

80.03 Intusuect N. + S. line 10 Chs. S. of Cor.  
to Secs. 10-11-14 + 15. Thence Iron  
S.  $89^{\circ} 56' N$ . on a true line bet. Secs. 10 + 15.  
va.  $13^{\circ} 30' E$ .

40.01 **Set a post 3 ft. long 3 ins. diam with marked  
stone, 12 ins, in the ground for  $\frac{1}{4}$  Sec, Cor,  
marked  $\frac{1}{4}$  S. on N. face, dug pits 18 x 18 x 12  
ins. E. and N. of post  $5\frac{1}{2}$  ft. dist. and raised  
a mound of earth  $1\frac{1}{2}$  ft. high.  $3\frac{1}{2}$  ft. base. around  
post.**

80.03 In Cor. to Secs. 9-10-15 + 16.

Sec. 15. is rolling

Soil 2<sup>d</sup> rate

Good grass

Scattering Juniper Bush.

Sp. 14 N. R. 19 E.  
Chs B. + S. R. M.

North Cut Secs. 9 + 10.  
Va. 13° 30' E.

Ascend gradually

40.00 Set a Sand stone, 15 x 8 x 4 ins., 10 ins.  
in the ground for  $\frac{1}{4}$  Sec, Cor, marked  $\frac{1}{4}$ . on N.  
face, dug pits 18 x 18 x 12 ins. N. and S.  
of stone 5 $\frac{1}{2}$  ft. dist. and raised a mound of earth  
1 $\frac{1}{2}$  ft. high. 3 $\frac{1}{2}$  ft. base. alongside.

47.00 Foot of Bluff br N. 7° N.

50.00 Set a Sand Stone 43-12 x 4 ins  
30 ins. in the ground for Cor. to  
Secs. 3-4-9+10. Marked with  
5 Notches on S. and 3 Notches on  
E. edge, and raised a mound  
of Stone alongside - Pits impracticable  
Sec. 10 is slightly rolling in the  
S. half

Soil 2<sup>nd</sup> rate. Grazing good  
North  $\frac{1}{2}$  Broken + rocky  
Soil 3<sup>rd</sup> rate  
Grass poor  
Scattering Immature Brush.

Sp. 14. N. R. 19 E.  
Ch. G. + S. R. M.

Each on a random line bet. Secs. 3 + 10.

Va.  $13^{\circ}30' E$ .

Occurs along side of Hill.

40.00 Set temporary  $\frac{1}{4}$  Sec. Cor.

71.12 Top of Bluff 430 ft. high bet. N. 80° W. +  
descent gradually

7973 Intersub N. S. line 13 Chs. N. of Cor.  
to Secs. 2-3-10 + 11. Thence I run

N. 89° 54' W. on a true line bet. Secs. 3 + 10.

Va.  $13^{\circ}30' E$ .

39.86 Set a Sand Stone 18 x 13 x 12 ins.  
in the ground for  $\frac{1}{4}$  Sec. Cor. Marked  
 $\frac{1}{4}$  on N. face, and raised a  
Mound of this along side.

7973 ~~Cor. 10~~ Set 3, 4, 9 + 10  
Cts. impracticable.

Sec. 10 is Brook + rocky

Soil 3<sup>d</sup> rate

Grass fair

Some Juniper Bush.



Dr. 14 N. R. 19 E.

Ch. G. + S. R. M.

North on a random line bet. Secs. 3 & 4  
 Va. 1330' E.  
 ascent.

16.80 Head of Wash 10 Chs. wide Co S. 1/2 N. 1/2 corner

40.00 Set temporary 1/4 Sec. Cor.

61.00 Top of Bluff 215 ft. high. brs. E. & N. + center Tableland

79.89 Interval N. B. of Tr. 12 Chs. N. of Cor. to

Secs. 3-4-33-34 recently set by me

from S. 5' N. on a true line bet. Secs. 3 & 4.

(Var. 1335' E.)

39.89 Set a Sand Stone 18x14x4 ins. 12 ins.  
 in the ground for 1/4 Sec. Cor. Marked  
 1/4 on N. face and raised a mound

of Stone around it. Pits impracticable  
 49.89 See map to left  
 Soil 3' rate  
 Grass fair  
 Scattering Juniper Brush

I carefully examined the adjustments  
 of my Solar Compass today, par-  
 ticularly the latitude and reversing  
 apparatus and find them correct.  
 M. W. Grant June 8, 1883.

Tp. 14 N. R. 29. E,  
Chs. G. & S. R. M.

From Cor. to Secs. <sup>4.5</sup> 32 & 33. pre-  
viously set by me. From  
North lat. Secs. 32 & 33.  
Va. 1330' E,

Mainly level.

4000

**Set a post 3 ft. long 3 ins. diam with marked  
stone, 12 ins, in the ground for  $\frac{1}{4}$  Sec, Cor,  
marked  $\frac{1}{4}$  S. on N. face, dug pits 18 x 18 x 12  
ins. N. and S. of post  $5\frac{1}{2}$  ft. dist. and raised  
a mound of earth  $1\frac{1}{2}$  ft, high.  $3\frac{1}{2}$  ft. base. around  
post.**

80.00

**Set a post 4 ft. long 4 ins. square, with marked  
stone, 12 ins, in the ground for Cor, to Secs,  
25-27-32 & 33 marked T. 14 N. S. 28 on  
N. E. R. 19 E, S. 33 on S. E, S, 32 on  
S, W, and S, 39 on N, W, face, with / notch  
20 on S, and H notch 20 on E. edges, dug  
pits 18 x 18 x 12 ins. in each Sec.,  $5\frac{1}{2}$  ft. dist.  
and raised a mound of earth 2 ft, high.  $1\frac{1}{2}$  ft.  
base. around post.**

Surface well  
Soil 3' rate  
Grass good.

BOOK 163

Th. 14 N. R. 19 E.

Ch. G. + S. R. M.

East. on a random line bet. Secs. 21 + 28.  
Va. 133° 0' E.

Ascend gradually

40.00 Set temporary  $\frac{1}{4}$  Sec. Cor.80.28 Intersect N. + S. line 32 Chs. S. of Cor.  
to Secs. 21-22-27 + 28. Thence I run  
S. 89° 46' N. on a true line bet. Secs. 21 + 28  
Va. 133° 0' E

80.14

Set a post 3 ft. long 3 ins. diam with marked  
stone, 12 ins. in the ground for  $\frac{1}{4}$  Sec. Cor,  
marked  $\frac{1}{4}$  S. on N. face, dug pits 18 x 18 x 12  
ins. E. and W. of post 5  $\frac{1}{2}$  ft. dist. and raised  
a mound of earth 1  $\frac{1}{2}$  ft. high. 3  $\frac{1}{2}$  ft. base. around  
post.

80.28 The Cor. to Secs. 20-21-28 + 29

Sec. 28 - is rolling

Soil 2<sup>d</sup> rate

Good grass

Scattering Juniper Bush



T. 14 N. R. 19 E.

Ch. G. + S. R. M.

North Int. Secs. 20 + 21  
va 1336 E,

Descent gradually

40.00

Set a post 3 ft. long 3 ins. diam with marked stone, 12 ins, in the ground for  $\frac{1}{4}$  Sec, Cor. marked  $\frac{1}{4}$  S. on N. face, dug pits 18 x 18 x 12 ins. N. and S. of post 5  $\frac{1}{2}$  ft. dist. and raised a mound of earth 1  $\frac{1}{2}$  ft. high. 3  $\frac{1}{2}$  ft. base. around post.

80.00

Set a post 4 ft. long 4 ins. square, with marked stone, 12 ins, in the ground for Cor, to Secs, 16-17-20+21 marked T. 14 N. S. 16 on N. E. R. 19 E S. 21 on S. E, S, 20 on S, W, and S, 17 on N. W. face, with 3 notch 20 on S, and 4 notch 20 on E. edges, dug pits 18 x 18 x 12 ins. in each Sec.. 5  $\frac{1}{2}$  ft. dist. and raised a mound of earth 2 ft. high. 4  $\frac{1}{2}$  ft. base. around post.

Surface rolling  
Soil 3  $\frac{1}{2}$  rate  
Grass fair.

Tr. 14 N. R. 19 E.

Ch. G. + S. R. M.

East, on a random line bet. Sec. 16 + 21,  
va. 1330' E.

Over rolling hills

40.00 S. E. temporary  $\frac{1}{4}$  Sec. Cor.

80.18 Intersect N. + S. line 26 lks. N. of Cor.  
to Secs. 15-16-21 + 22. Thence I run  
N. 89° 49' W. on a true line bet. Secs. 16 + 21,  
va. 1330' E.

40.09

**Set a post 3 ft. long 3 ins. diam with marked  
stone, 12 ins, in the ground for  $\frac{1}{4}$  Sec. Cor,  
marked  $\frac{1}{4}$  S. on N. face, dug pits 18 x 18 x 12  
ins. E. and W. of post 5 $\frac{1}{2}$  ft. dist. and raised  
a mound of earth 1 $\frac{1}{2}$  ft, high. 3 $\frac{1}{2}$  ft. base. around  
post.**

80 18

Lead to Secs 16 17 20 + 21  
Sec. 21. is slightl, rolling  
Soil 2<sup>o</sup> rate  
Good grass  
Scattering Juniper Bush.

T. 14 N. R. 19 E,

chs G. + S. R. M.

North cut. Secs. 16 + 17  
Va. 13° 30' E.

over slightly rolling ground

4000

Set a post 3 ft. long 3 ins. diam with marked stone, 12 ins, in the ground for  $\frac{1}{4}$  Sec, Cor, marked  $\frac{1}{4}$  S. on N. face, dug pits 18 x 18 x 12 ins. N. and S. of post 5  $\frac{1}{2}$  ft. dist. and raised a mound of earth 1  $\frac{1}{2}$  ft, high. 3  $\frac{1}{2}$  ft. base. around post.

8000

Set a post 4 ft. long 4 ins. square, with marked stone, 12 ins, in the ground for Cor, to Secs, 8-9-16 + 17 marked T. 14 N. S. 9 on N. E. R. 19 E, S. 16 on S. E, S, 17 on S, W, and S, 8 on N, W, face, with 4 notch es on S, and 4 notch es on E. edges, dug pits 18 x 18 x 12 ins. in each Sec., 5  $\frac{1}{2}$  ft. dist. and raised a mound of earth 2 ft, high. 4  $\frac{1}{2}$  ft. base. around post.

Surface rolling  
Soil 3<sup>rd</sup> rate  
Grass fair.



N. 14 N. R. 19 E.

Chs G. S. R. M.

East on a random line bet. Secs. 9 + 16  
 Na.  $18^{\circ}30' E$ .

Nearly level.

40.00 Set temporary  $\frac{1}{4}$  Sec. Cor.

79.70 Intersub N. & S. line 16 lks. N. of Cor.  
 to Secs. 9-10-15 + 16. Thence I run  
 N  $89^{\circ}53' N$ . on a true line bet. Secs. 9 + 16  
 Na.  $18^{\circ}30' E$ .

39.85

**Set a post 3 ft. long 3 ins. diam with marked  
 stone, 12 ins, in the ground for  $\frac{1}{4}$  Sec, Cor,  
 marked  $\frac{1}{4}$  S. on N. face, dug pits 18 x 18 x 12  
 ins. E. and W. of post  $5\frac{1}{2}$  ft. dist. and raised  
 a mound of earth  $1\frac{1}{2}$  ft. high.  $3\frac{1}{2}$  ft. base. around  
 post.**

79.70

The Cor. to Secs. 8-9-16 + 17  
 Sec. 16. is slightly rolling  
 Soil 2<sup>d</sup> rate

Good grass

Scattering bunches Juniper Bush

T. 14 N. R. 19 E.

chs G. + S. R. M.

North cut. Sec. 8 + 9  
wa 1530 E.

Ascend gradually

4000

Set a post 3 ft. long 3 ins. diam with marked stone, 12 ins, in the ground for  $\frac{1}{4}$  Sec, Cor. marked  $\frac{1}{4}$  S. on N. face, dug pits 18 x 18 x 12 ins. N and S of post 5  $\frac{1}{2}$  ft. dist. and raised a mound of earth 1  $\frac{1}{2}$  ft. high. 3  $\frac{1}{2}$  ft. base. around post.

8000

Set a post 4 ft. long 4 ins. square, with marked stone, 12 ins, in the ground for Cor, to Secs, 4-5-8+9 marked T. 14 N. S. 4 on N. E. R. 19 E. S. 9 on S. E, S, 8 on S, W, and S, 5 on N, W, face, with 5 notch on S, and 4 notch on E. edges. dug pits 18 x 18 x 12 ins. in each Sec. 5  $\frac{1}{2}$  ft. dist. and raised a mound of earth 2 ft. high 4  $\frac{1}{2}$  ft. base. around post.

Surface rolling  
Soil 3<sup>d</sup> rate  
Grass grass.

St. 14 N. R. 19 E.  
Ch. G. & S. R. M.

East on a random line bet. Secs. 4 & 9.  
Va.  $13^{\circ}30' E$ .

Over rolling Hills.

36.10 Foot of Hill to N.  $44^{\circ} N$ , + ascend

40.00 Set temporary  $\frac{1}{4}$  Sec. Cor.

60.31 Top of Spur to N. & S. + descend.

76.50 Cross Wash 17 lbs. wide Co. S  $57^{\circ} N$  + east

79.88 Intended N. & S. line 7 lbs. N. of Cor. to  
Secs. 3-4-9+10. Hence I run  
N.  $89^{\circ}57' N$ . on a true line bet. Secs. 4 & 9.  
Va.  $13^{\circ}39' E$ .

39.94 Set a post 3 ft. long 3 ins. diam with marked  
stone, 12 ins, in the ground for  $\frac{1}{4}$  Sec, Cor,  
marked  $\frac{1}{4}$  S. on N. face, dug pits 18 x 18 x 12  
ins. E. and N. of post  $5\frac{1}{2}$  ft. dist. and raised  
a mound of earth  $1\frac{1}{2}$  ft. high.  $3\frac{1}{2}$  ft. base. around  
post.

79.88 The Cor. to Secs. 4-5-8 & 9  
Sec 9. is rolling in N. + level in S.  
soil 2<sup>d</sup> + 3<sup>d</sup> rate  
Good grass  
Scattering Juniper Bush in North



N. 14 N. R. 19 E.

Chs G. & S. R. M.

North on a random line bet. Secs. 4 & 5,  
ra.  $13^{\circ}30' E$ ,

Ascend gradually

35.00 Foot of Bluff bet. S & N.

40.00 Set temporary  $\frac{1}{4}$  Sec. Cor.

48.00 Top of Rocky Bluff 100 ft. high bet. E & W.

79.69 Intersect N. B. of Tp. 26 lks. E. of Cor. to  
Secs. 4-5-32 & 33. Previously set by me, Thos. Iron

S. 11 $^{\circ}$  E. on a true line bet. Secs. 4 & 5.  
ra.  $13^{\circ}30' E$ .

39.69 Set a Sand Stone  $14 \times 10 \times 6$  ins. 9 ins.

in the ground for  $\frac{1}{4}$  Sec. Cor. Marked  
 $\frac{1}{4}$  on W. face. and raised a mound of

stray alongside - Pits impracticable.

79.69 Sec. 5 is rolling & rocky  
soil 3 $^{\circ}$  rate

Grass fair

Thick bunches of Juniper

I carefully examined the adjustments of my  
Solar Compass today, particularly the  
latitude and leveling apparatus,  
and found them correct.

A. H. Arnold Compassman June 8. 1873.

Th. 14 N. R. 19 E.

G. S. R. M.

From Cor. to Secs <sup>S. 6.</sup> 31 & 32 re-  
cently established by me, I run  
North bet. Secs. 31 & 32.  
Va. 13° 30' E.

40.00

**Set a post 3 ft. long 3 ins. diam with marked stone, 12 ins, in the ground for  $\frac{1}{2}$  Sec, Cor, marked  $\frac{1}{2}$  S. on N. face, dug pits 18 x 18 x 12 ins. N. and S. of post 5 $\frac{1}{2}$  ft. dist. and raised a mound of earth 1 $\frac{1}{2}$  ft, high. 3 $\frac{1}{2}$  ft. base. around post.**

50.00

**Set a post 4 ft. long 4 ins. square, with marked stone, 12 ins, in the ground for Cor, to Secs, 29-30-31 & 32 marked T. 14 N. S. 29 on N. E. R. 19. E. S. 32 on S. E, S, 31 on S, W, and S, 30 on N, W, face, with  $\perp$  notch on S, and  $\nabla$  notch  $es$  on E. edges, dug pits 18 x 18 x 12 ins. in each Sec., 5 $\frac{1}{2}$  ft. dist. and raised a mound of earth 2 ft, high. 4 $\frac{1}{2}$  ft. base. around post.**

Surface rolling  
Soil 3. rate  
Drain good.

N. 14 N. R. 19 E.

G. & S. R. M.

East, on a random line bet. Secs. 29 & 32.  
Va. 13° 30' E.

40.00 Set temporary  $\frac{1}{4}$  Sec. Cor.

80.27 Interset N. & S. line 36 Chs. S. of Cor.  
to Secs. 28-29-32 & 33. Thence Iron  
S. 89° W. N. on a true line bet. Secs. 29 & 32.  
Va. 13° 30' E.

40.14 Set a post 3 ft. long 3 ins. diam with marked  
stone, 12 ins, in the ground for  $\frac{1}{4}$  Sec, Cor,  
marked  $\frac{1}{4}$  S. on N. face, dug pits 18 x 18 x 12  
ins. E. and W of post 5  $\frac{1}{2}$  ft. dist. and raised  
a mound of earth 1  $\frac{1}{2}$  ft, high. 3  $\frac{1}{2}$  ft. base. around  
post.

80.27 The Cor. to Secs. 29-30-31 & 32.

Sec. 32. is slightly rolling  
Soil 2<sup>d</sup> rate

Good grass.

Scattering Juniper Brush.

M. N. Grant June 9, 1883.



163

Tr. 14 N. R. 19 E.  
G. & S. R. M.

Section a random line bet. Secs. 30 + 31.  
Va. 13° 30' E.

Ascend gradually

40.00 Set temporary  $\frac{1}{4}$  Sec. Cor.

81.98 Intersect N. B. of Tr. 14 8 kts. N. of Cor.  
to Secs. 25-30-31 + 36, recently  
set by me. Thence I run  
N. 89° 39' E. on a true line bet. Secs. 30 + 31.  
Va. 13° 30' E.

41.98 **Set a post 3 ft. long 3 ins. diam with marked  
stone, 12 ins. in the ground for  $\frac{1}{4}$  Sec. Cor,  
marked  $\frac{1}{4}$  S. on N. face, dug pits 18 x 18 x 12  
ins. E. and W. of post 5  $\frac{1}{2}$  ft. dist. and raised  
a mound of earth 1  $\frac{1}{2}$  ft. high. 3  $\frac{1}{2}$  ft. base. around  
post.**

81.98 The Cor. to Secs. 29-30-31 + 32,  
Sec. 31. is slightly rolling  
Soil 1<sup>st</sup> rate  
Good grass  
Scattering Juniper.

A. H. Arnold Compassman June 9, 1883.

BOOK 163

T. 14 N. R. 19 E.  
G. & S. R. M.

North Int. Secs. 29 & 30  
Va. 13° 30' E.

Descend gradually

40.00

Set a post 3 ft. long 3 ins. diam with marked stone, 12 ins, in the ground for 1/4 Sec. Cor, marked 1/4 S. on N. face, dug pits 18 x 18 x 12 ins. N. and S. of post 5 1/2 ft. dist. and raised a mound of earth 1 1/2 ft, high. 3 1/2 ft. base. around post.

80.00

Set a post 4 ft. long 4 ins. square, with marked stone, 12 ins, in the ground for Cor, to Secs, 19 20 - 29 & 30 marked T. 14 N. S. 20 on N. E. R. 19 E. S. 29 on S. E, S, 30 on S, W, and S, 19 on N, W, face, with 2 notch es on S, and 5 notch es on E. edges, dug pits 18 x 18 x 12 ins. in each Sec., 5 1/2 ft. dist. and raised a mound of earth 2 ft, high. 4 1/2 ft. base. around post.

Surface rolling  
Soil 3<sup>rd</sup> rate  
Grass poor.

Tp. 14 N. R. 19 E.

Chs G. + S. R. M.

East on a random line bet. Secs. 20 + 29  
Va 133° E  
descent.

40.00 Set temporary  $\frac{1}{2}$  Sec. Cor.

80.07 Intersect N. + S. line 27 Chs. S. of Cor.  
to Secs. 20-21-28 + 29 Thence I run  
S. 89° 48' N. on a true line bet. Secs. 20 + 29  
Va. 133° E.

40.04 **Set a post 3 ft. long 3 ins. diam with marked  
stone, 12 ins. in the ground for  $\frac{1}{4}$  Sec. Cor,  
marked  $\frac{1}{4}$  S. on N. face, dug pits 18 x 18 x 12  
ins. E. and W. of post 5  $\frac{1}{2}$  ft. dist. and raised  
a mound of earth 1  $\frac{1}{4}$  ft. high. 3  $\frac{1}{4}$  ft. base. around  
post.**

80.07 ~~The~~ Cor. to Secs. 19-20-29 + 30  
Sec. 29. is rolling

Soil 2<sup>d</sup> vale  
Good grass  
Scattering Juniper  
M. N. Grauf

June 9. 1883.



BOOK 163

Twp. 14 N. R. 19 E.

Chs G. &amp; S. R. M.

Post, on a random line bet. Secs. 19 &amp; 30.

Va.  $13^{\circ}36' E$ ,

Ascent gradually

40.00 Set temporary  $\frac{1}{4}$  Sec. Cor. and  
descent70.42 Cross Wash 19 $\frac{1}{2}$  m. S. of C.  $N43^{\circ}E$ . + ascent.82.10 Intersect N. B. of Twp. 6 $\frac{1}{2}$  m. N. of Cor.  
to Secs. 19-24-25 + 30. N. nearly

set by me. Thence I run

 $N. 89^{\circ}57' E$ , on a true line bet. Secs. 19 & 30.Va.  $13^{\circ}36' E$ ,42.10 Set a post 3 ft. long 3 ins. diam with marked  
stone, 12 ins, in the ground for  $\frac{1}{4}$  Sec, Cor,  
marked  $\frac{1}{4}$  S. on N. face, dug pits 18 x 18 x 12  
ins. E. and W. of post  $5\frac{1}{2}$  ft. dist. and raised  
a mound of earth  $1\frac{1}{2}$  ft. high.  $3\frac{1}{2}$  ft. base. around  
post.82.10 Set bar to level 19 20 29 + 30  
Sec. 30. is level Mesa  
Soil 2 $\frac{1}{2}$  rate  
good grass  
no timber or brush

A. H. Arnold Comptroller June 9, 1883.

OK 1883

T<sub>h</sub>. 14 N. R. 19 E.

Chs

G. + S. R. M.

North bet. Secs. 19 + 20

va 1330 E.

Descend gradually

110.00

Set a post 3 ft. long 3 ins. diam with marked stone, 12 ins, in the ground for  $\frac{1}{4}$  Sec, Cor, marked  $\frac{1}{4}$  S. on N. face, dug pits 18 x 18 x 12 ins. N. and S. of post 5  $\frac{1}{2}$  ft. dist. and raised a mound of earth 1  $\frac{1}{2}$  ft, high. 3  $\frac{1}{2}$  ft. base. around post.

20.00

Set a post 4 ft. long 4 ins. square, with marked stone, 12 ins, in the ground for Cor, to Secs, 17-18-19+20 marked T. 14 N. S. 17 on N. E. R. 19 E. S. 20 on S. E, S, 19 on S, W, and S, 18 on N, W, face, with 3 notch 20 on S, and 5 notch 20 on E. edges, dug pits 18 x 18 x 12 ins. in each Sec. 5  $\frac{1}{2}$  ft. dist. and raised a mound of earth 2 ft, high. 4  $\frac{1}{2}$  ft. base. around post.

Surface rolling  
Soil 3? rate  
brown foot.



OK 163

✓ N. 14 N. R. 19 E.

chs G. & S. R. M.

East on a random line bet. Secs. 17 & 20.

va. 13°30' E.

Ascend gradually

40.00 Set temporary 1/4 Sec. Cor.

79.81 Intersub N. & S. line 34 lks. N. of Cor. to

Secs. 16-17-20 & 21. Thence I run

N. 89°45' N. on a true line bet. Secs. 17 & 20.

va. 13°30' E.

39.90

**Set a post 3 ft. long 3 ins. diam with marked stone, 12 ins, in the ground for 1/4 Sec, Cor, marked 1/4 S. on N. face, dug pits 18 x 18 x 12 ins. E. and W. of post 5 1/2 ft. dist. and raised a mound of earth 1 1/2 ft, high, 3 1/2 ft. base. around post.**

79.81

The Cor. to Secs. 17-18-19-20.

Sec. 20, is almost level on N. rolling on E. half

Soil 2<sup>d</sup> & 3<sup>d</sup> rate

Grass grows to fair

Scattering Juniper in E. half

M.N. Grant

June 9, 1883.



Tr. 14 N. R. 19 E.  
 Ch. G. & S. R. M.

Met. on a random line bet. Secs. 18 & 19  
 Va. 18° 30' E.

Descend.

9.70 Cross Wash 30 fks. wide C. N. 5° N. + ascent

40.00 Set temporary  $\frac{1}{4}$  Sec. Cor.

81.93 Intrench N. B. of Tr. 25 fks. N. of Cor.  
 to Secs. 13-18-19-24 result at 4 mi. from  
 N. 89° 49' East on a random line bet. Secs. 18 & 19.

Va. 18° 30' E.

41.93 Set a post 3 ft. long 3 ins. diam with marked  
 stone, 12 ins, in the ground for  $\frac{1}{4}$  Sec. Cor,  
 marked  $\frac{1}{4}$  S. on N. face, dug pits 18 x 18 x 12  
 ins. E. and W. of post  $5\frac{1}{2}$  ft. dist. and raised  
 a mound of earth  $1\frac{1}{2}$  ft. high.  $3\frac{1}{2}$  ft. base. around

post.

81.93 The Cor. to Secs 17-18-19 + 20

Sec. 19 is rolling

Soil 2<sup>o</sup> rate

Good grazing

Scattering Juniper Bush

A. A. Arnold Comptroller June 9, 1883.

BOOK 763

T. 14 N. R. 19 E.

Ch G + S. R. m.

North cut. Secs. 17 + 18

Na. 13° 30' E.

Ascend.

40.00

Set a post 3 ft. long 3 ins. diam with marked stone, 12 ins, in the ground for  $\frac{1}{4}$  Sec, Cor, marked  $\frac{1}{4}$  S. on N. face, dug pits 18 x 18 x 12 ins. N. and S. of post  $5\frac{1}{2}$  ft. dist. and raised a mound of earth  $1\frac{1}{2}$  ft, high.  $3\frac{1}{2}$  ft. base. around post.

80.00

Set a post 4 ft. long 4 ins. sqare, with marked stone, 12 ins, in the ground for Cor, to Secs, 7-8-17 + 18 marked T. 14 N. S. 8 on N. E. R. 19 E. S. 17 on S. E, S, 18 on S, W, and S, 7 on N, W, face. with 4 notch 20 on S, and 5 notch 20 on E. edges, dug pits 18 x 18 x 12 ins. in each Sec.,  $5\frac{1}{2}$  ft. dist. and raised a mound of earth 2 ft, high.  $4\frac{1}{2}$  ft. base. around post.

Surface rolling  
Soil 3<sup>rd</sup> rate  
Grass food.

Dr. 14 N. R. 19 E,  
 Chy G. & S. R. M.

East, on a random line bet. Secs. 8 & 17  
 Va.  $133^{\circ}0' E$ .

Level land.

410.00 Set temporary  $\frac{1}{4}$  Sec. Cor.

79.76 Intersect N. & S. line 2 1/2 kts. N. of  
 Cor. to Secs. 8-9-16-17. Thence I run  
 N. 89 1/2° W. on a true line bet. Secs. 8 & 17.  
 Va.  $133^{\circ}0' E$ .

39.88 Set a post 3 ft. long 3 ins. diam with marked  
 stone, 12 ins, in the ground for  $\frac{1}{4}$  Sec. Cor,  
 marked  $\frac{1}{4}$  S. on N. face, dug pits 18 x 18 x 12  
 ins. E. and W. of post 5 1/2 ft. dist. and raised  
 a mound of earth 1 1/2 ft. high. 3 1/2 ft. base. around  
 post.

79.76 The Cor. to Secs. 7-8-17 & 18

Sec. 17. is level

Soil 2. rate

Good grazing

Scattig Brush,

M. N. Grant

June 9: 1893.



Tr. 14 N. R. 19 E.  
Ch. G. & S. R. M.

Post, on a random line bet. Secs. 7 + 18.  
Va.  $13^{\circ}30' E$ ,

Descends gradually

26.40 Cross Wash 25 lks. wide Co. N.  $20^{\circ} N$ .

40.00 Set temporary  $\frac{1}{4}$  Sec. Cor.

81.74 Intersect N. B. of Tr. 33 lks N. of

Cor. to Secs. 7-12-13+18 nearly set by me then Iron

N.  $89^{\circ}46' E$ , on a true line bet. Secs. 7 + 18.

Va.  $13^{\circ}30' E$ ,

41.74 Set a post 3 ft. long 3 ins. diam with marked  
stone, 12 ins, in the ground for  $\frac{1}{4}$  Sec, Cor,  
marked  $\frac{1}{4}$  S. on N. face, dug pits 18 x 18 x 12  
ins. E. and W. of post  $5\frac{1}{2}$  ft. dist. and raised  
a mound of earth  $1\frac{1}{2}$  ft. high.  $3\frac{1}{2}$  ft. base. around  
post.

81.74 The Cor. to Secs. 7-8-17+18

Sec. 18 is rolling

Soil 2<sup>nd</sup> Rate

Fine grass

Scattering Juniper

A. H. Arnold Comptroller June 9, 1883.

Tr. 14 N. R. 19 E.  
 Chs G. & S. R. M.

North. lot Secs. 7 & 8.

Var. 1330' E.

Rolling Hills

4000

Set a post 3 ft. long 3 ins. diam with marked stone, 12 ins, in the ground for  $\frac{1}{4}$  Sec, Cor, marked  $\frac{1}{4}$  S. or N. face, dug pits 18 x 18 x 12 ins. N. and S. of post 5 $\frac{1}{2}$  ft. dist. and raised a mound of earth 1 $\frac{1}{2}$  ft, high. 3 $\frac{1}{2}$  ft. base. around post.

80.00

Set a post 4 ft. long 4 ins. square, with marked stone, 12 ins, in the ground for Cor, to Secs, 5-6-7 & 8 marked T. 14 N. S. 5 on N. E. R. 19 E, S. 8 on S. E, S, 7 on S, W, and S, 6 on N, W, face, with 5 notches on S, and 5 notches on E. edges, dug pits 18 x 18 x 12 ins. in each Sec., 5 $\frac{1}{2}$  ft. dist. and raised a mound of earth 2 ft, high. 4 $\frac{1}{2}$  ft. base. around post.

Surface rolling  
 Soil 3 $\frac{1}{2}$  rate  
 Grass poor.



Tp. 14 N. R. 19 E.  
Chs. G. & S. R. M.

Each on a random line bet. Secs. 5 & 8.  
Va.  $13^{\circ}30' E$ .

Over rolling Hills

40.00 Set temporary  $\frac{1}{4}$  Sec. Cor.

79.47 Interest N. & S. line 39 Chs. S. of Cor  
to Secs. 4-5-8-9. Thence Iron.

S.  $89^{\circ}43' N$ . on a true line bet. Secs. 5 & 8.  
Va.  $13^{\circ}30' E$ .

39.73

Set a post 3 ft. long 3 ins. diam with marked  
stone, 12 ins. in the ground for  $\frac{1}{4}$  Sec. Cor,  
marked  $\frac{1}{4}$  S. on N. face. dug pits 18 x 18 x 12  
ins. E. and N. of post  $5\frac{1}{2}$  ft. dist. and raised  
a mound of earth  $1\frac{1}{2}$  ft. high.  $3\frac{1}{2}$  ft. base. around

post

79.47 In Cor. to Secs. 5-6-7 & 8

Sec. 8. is rolling  
soil 3' rate  
good grass.

Some juniper Brush

I carefully examined the adjustments of my  
Solar Compass today; particularly the  
latitude and meridian apparatus, and  
found them correct.

M. N. Grant June 9, 1883.



Tr. 124 N. R. 19 E.

Chs G. + S. R. M.

Went on a random line bet. Secs. 6 + 7.

Ascend gradually Va.  $13^{\circ}30' E$ .

410.00 Set temporary  $\frac{1}{4}$  Sec. Cor. and  
descent

81.39 Intersect N.W. Q. of Tr. 21 Chs N. of Cor. to  
Secs. 1-6-7-12. Recently set by me  
Thence I run

N.  $89^{\circ}51' E$ . on a true line bet. Secs. 6 + 7.

Va  $13^{\circ}30' E$ .

41.39 Set a post 3 ft. long 3 ins. diam with marked  
stone, 12 ins. in the ground for  $\frac{1}{4}$  Sec. Cor,  
marked  $\frac{1}{4}$  S. on N. face, dug pits 18 x 18 x 12  
ins. E. and N. of post  $5\frac{1}{2}$  ft. dist. and raised  
a mound of earth  $1\frac{1}{2}$  ft. high.  $3\frac{1}{2}$  ft. base. around  
post.

81.39 The Cor. to Secs. 5-6-7 + 8.

Sec. 7. is rolling

Soil 2<sup>d</sup> date

Good grass.

Scattering Juniper.

BOOK 783

Twp. 14 N. R. 19 E.

Chs. G. + S. R. M.

- North on a random line bet. Secs. 5 + 6.  
 wa.  $13^{\circ}30' E.$   
 ascent gradually
- 1.73 Foot of Hill bet. N  $23^{\circ} E$  + N.W. + ascend
- 40.00 Set temporary  $\frac{1}{4}$  Sec. Cor.
- 55.06 Top of Bluff 135 ft. high bet. E. + W. + descend
- 80.09 Intrench N. B. of Twp. 49 lbs. E. of Cor.  
 to Secs. 5-6-31 + 32. recult by set by me. Thence I run  
 S  $21^{\circ} E.$  on a true line bet. Secs. 5 + 6.  
 wa  $13^{\circ}30' E.$
- 40.09 Set a Sand stone  $18 \times 10 \times 8$  ins. 12 ins. in  
 the ground for  $\frac{1}{4}$  Sec. Cor. Marked  $\frac{1}{4}$  on N.  
 face and raised a mound of stone  
 alongside. Pits impracticable.
- 80.09 In Cor. to Secs. 5-6-7 + 8.  
 Secs. 5 + 6 are level in S.  $\frac{1}{2}$  N.  $\frac{1}{2}$  rolling  
 Soil  $2^{\circ}$  to  $3^{\circ}$  rate  
 Grass good + fair.  
 Scattering Juniper brush on north
- I carefully examined the adjustments of my  
 Solar Compass today, particularly the  
 latitude and reversing apparatus, and  
 found them correct.
- A. N. Arnold Compassman June 9, 1883.



BOOK 163

Apr. 14 N. R. 19 E.

G. + S. R. M.

## General Description

The greater portion of this Tr. is a rolling Valley, there is a little rough and rock land in the north part.

The Soil is sand + gravel and from 2" to 4" rate and is covered with a fine growth of grass in all parts, except a small portion in the Northern part.

There is a thick growth of Juniper + Pinon Bush in the Northern part, but very little in other parts.

Found no water in Tr.

There is a Cabin and Corral in Sec. 16.



BOOK 163

BOOK 163

67

For final oaths see  
Book No 13.

BOOK 163

63

U. S. Surveyor General's Office,

Tucson, Arizona, July 17, 1884,

The foregoing Field Notes of the Survey of the

Subdivision Lines of  
Township 14 North  
Range 19 East

Of the Gila and Salt River Base and Meridian, Arizona, execu-  
ted by M. A. Grant

Deputy Surveyor, under his contract of the 30 months

day of August, 1882, having been

critically examined and the necessary corrections and explana-

tions made, the said Field Notes and the surveys they describe

are hereby approved

Royce Johnson  
Surveyor General.

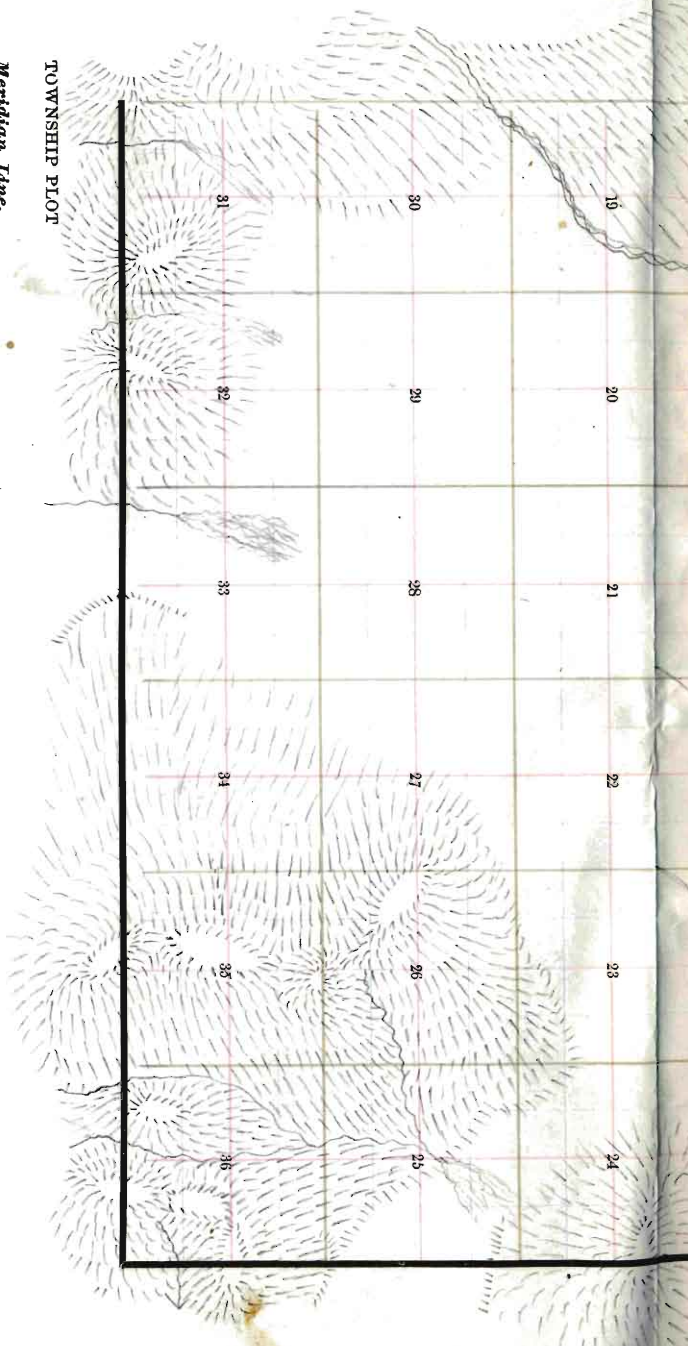

**TOWNSHIP PLOT**

*Meridian Line,*

*Base Line,*

*Standard Line,*

*Township Lines,*

*Section Lines,*

*Meander Lines,*

*Office Work.*



Township No. 14 N Range No. 13 E 5th 6th 7th 8th 9th 10th 11th 12th 13th 14th 15th 16th 17th 18th  
Ella & Salt River Meridian.

Edward Denny & Co., Stationers and Printers, Drawing Material, Box 512 Sec 10, St. S. F.

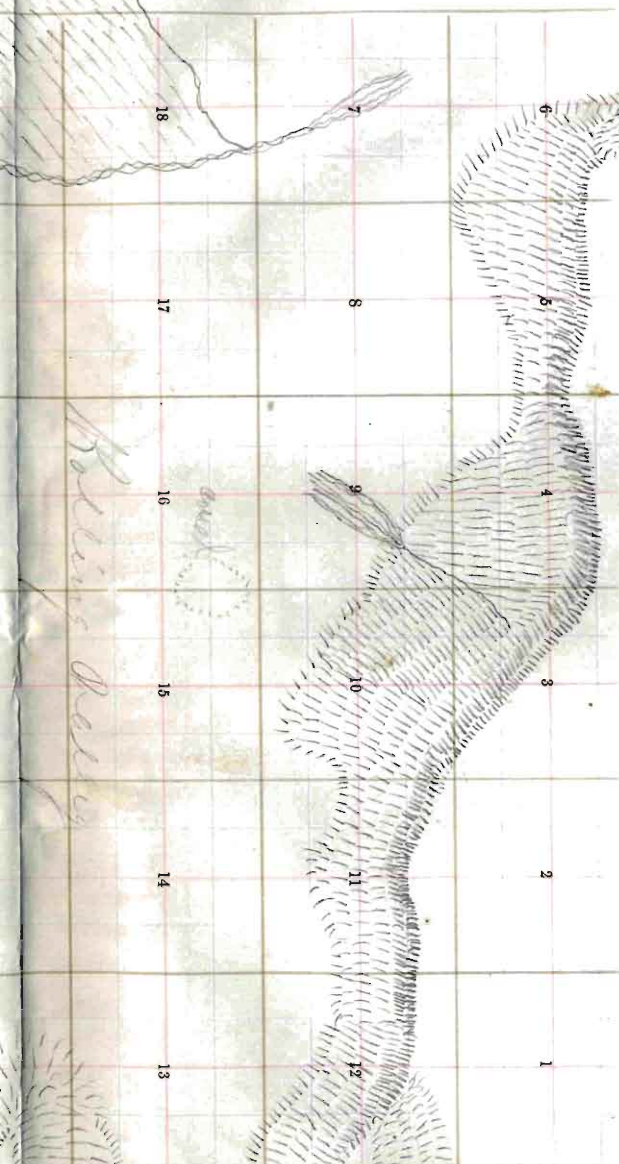

*Rollins Pass*