

Book No. 7

BOOK 207

H. A. Coe Deputy Surveyor.

T. 15 N. R. 24 E.

Gila and Salt River Meridian.

No-207 FIELD NOTES

OF

THE SUBDIVISION LINES OF

Township 15 N. Range 24 E.

Gila and Salt River Meridian.

BY

H. A. Coe Deputy Surveyor.

Under his Contract of July 25th 1882

Survey Commenced Feb 17th 1883

Survey Completed Feb 14th 1883

207

Platted,
Copied for Washington,
Copied for Register,

No-207

Edward Denny & Co., Stationers & Printers, S. F. Cal.

Copyright Secured,

Entered according to Act of Congress, in the Clerk's Office of the Librarian of Congress at Washington, D. C., in the year 1880.

1A

Township 15 North Range 24 East

Gibson and Salt River Baseland Meridian.

| | | | | | | | | | | |
|----|----|----|----|----|----|----|----|----|----|----|
| 6 | 60 | 5 | 44 | 4 | 33 | 3 | 22 | 2 | 11 | 1 |
| 59 | | 58 | | 43 | | 32 | | 21 | | 10 |
| 7 | 57 | 8 | 42 | 9 | 31 | 10 | 20 | 11 | 9 | 12 |
| 53 | | 55 | | 41 | | 30 | | 19 | | 8 |
| 18 | 54 | 17 | 40 | 16 | 29 | 15 | 18 | 14 | 7 | 13 |
| 53 | | 52 | | 39 | | 28 | | 17 | | 6 |
| 19 | 51 | 20 | 38 | 21 | 27 | 22 | 16 | 23 | 5 | 24 |
| 50 | | 49 | | 37 | | 26 | | 15 | | 4 |
| 30 | 48 | 29 | 36 | 28 | 25 | 27 | 14 | 26 | 3 | 25 |
| 47 | | 46 | | 35 | | 24 | | 13 | | 2 |
| 31 | 45 | 32 | 34 | 33 | 23 | 34 | 12 | 35 | 1 | 36 |

OK

Edward Denny & Co., Stationers & Printers, S. F., Cal.

Copyright Secured.

Entered according to Act of Congress, in the Clerk's Office of the Librarian of Congress at Washington, D. C., in the year 1880.

Township

Range

Meridian.

BOOK 207

Township *15 N* Range *24 East* M.

Only 9th - 11th Range meridian.

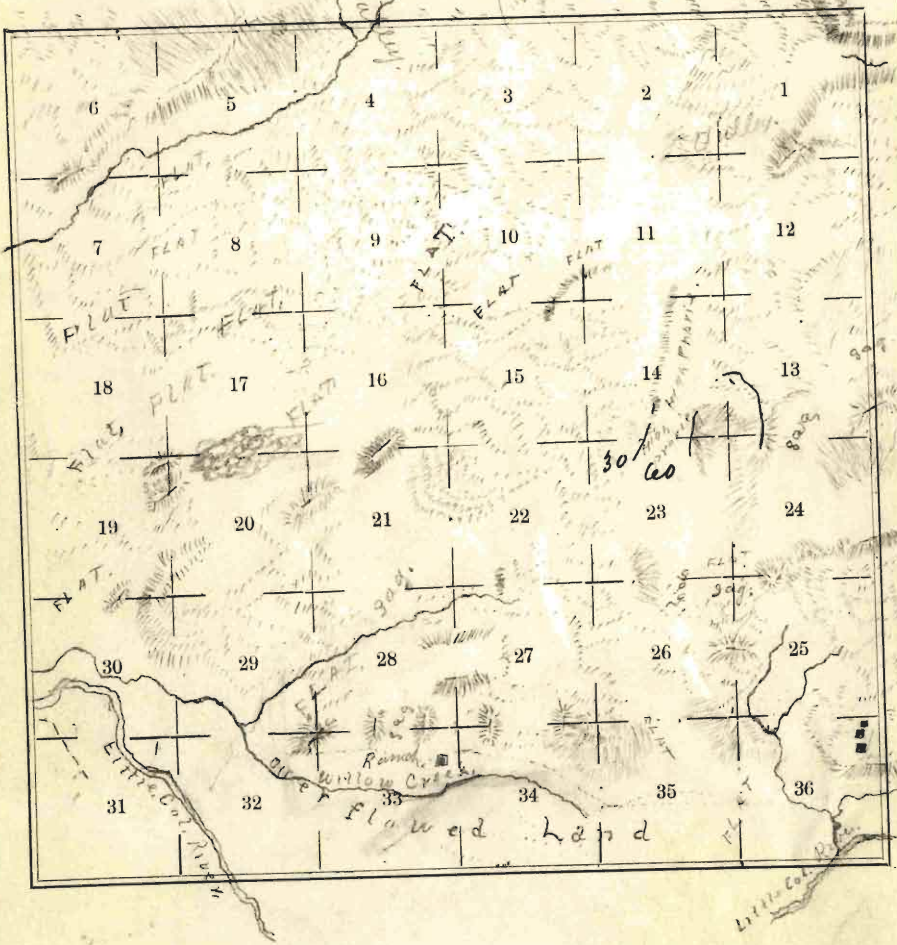

Township

Range

Meridian.

No-207

Survey made with Burt's Patent Improved Solar
Compass nearly new, and in first rate order. Made
by Otto Fennel of Cassel
Germany in 1881

1 Township 15 N. Range 24 E.
 (See previous page.) Gila and Salt River Meridian.

Chains

From the corner to Sections 35, 36, 1 and 2 on the South boundary, of S

Which is a post 4 ins. square set firmly in the ground, marked T. 15 N. S. 36 on N. E. R. 24 E. S. 1 on S. E. T. 14 N. S. 2 on S. W. and S. 35 on NW ^{base} north notch on E. and 5 notches on Wedges with top 18 x 18 x 12 in. on each Sec. 5 1/2 ft. dist. and a mound of earth 1 1/2 ft. high, 4 1/2 ft. base around post. Run North between sections 35 & 36

Variation 13° 45' East.

37.00

Leave over flared land bearing N.W. & S.E.

40.00

Set a post 3 ft. long, 3 ins. diam. with marked stone 12 ins. in the ground, for 1/4 Sec. Cor., marked 1/4 S. on W. face, dug pits, 18 x 18 x 12 ins., N. and S. of post 5 1/2 ft. dist., and raised a mound of earth 1 1/2 ft. high, 3 1/2 ft. base around post.

50.00
80.00

Leave Flat on bottom land and ascend. Set a post 4 ft. long, 4 ins. square, with marked stone 12 ins. in the ground, for Cor. to Secs, 25, 26, 35, 36 marked T, 15 N S, 26, on N, E, R, 24 E, S, 36 on S, E, S, 35 on S, W, and S, 26 on N, W, face with 1 notch on S, and 1 notch on E, edges, dug pits 18 x 18 x 12 ins, in each Sec., 5 1/2 ft, dist., and raised a mound of earth 2 ft, high, 4 1/2 ft, base around post.

Land rolling.
 Soil 1/2 in. 2 in. rate
 Vegetation Sparse.
 Timber of Gambel.

from which
 A Juniper 10 ins. diam. bears S. 19° W. 10 lks. dist.
 marked T. 15 N. R. 24 E. S. 35 B. T.
 A Juniper 10 ins. diam. bears N. 39° E. 53 lks. dist.
 marked T. 15 N. R. 24 E. S. 35 B. T.
 A Juniper 18 ins. diam. bears N. 69° W. 69 lks. dist.
 marked T. 15 N. R. 24 E. S. 36 B. T.
 No other trees within limits.

Township

15 N

Range

24 E

Gila and Salt River Meridian.

Chains 788⁰/₃₆ East, on a random line between Sections 25 and 36.

Variation 13° 45' East.

Ascend.

2.30 Cross Wash, 30 lks. wide, Course S.

20.65 Cross Wash, 15 lks. wide, Course S. W. and ascend.

40.00 Set temporary $\frac{1}{2}$ Sec. Cor.

80.14 Intersect E. B. of Tp. 26 lks. S. of cor. to secs.

20.30.31.36 from which corner, I run

S. 85° 45' W. on a true line, between sections 20.230

Variation 13° 45' East.

40.07 Set a post 3 ft. long. 3 ins. diam. with marked stone
12 ins. in the ground, for $\frac{1}{2}$ Sec. Cor., marked $\frac{1}{2}$ S. on
N. face, dug pits, 18 x 18 x 12 ins., E. and W. of
post 5 $\frac{1}{2}$ ft. dist., and raised a mound of earth 1 $\frac{1}{2}$ ft.
high, 3 $\frac{1}{2}$ ft. base around post.

80.14 The corner to sections 20. 26. 30. 36

Land rolling.

Soil 3rd rate

Vegetation Grass.

Timber of Juniper.

Township

15 N.

Range

24 E.

Gila and Salt River Meridian.

Chains

North, between Sections 25 and 26.

Variation

13° 45'

East.

Over rolling land.

30.00

Top of Spur, bears E. 2 W. and descend.

40.00

Set a post 3 ft. long, 3 ins. diam. with marked stone 12 ins. in the ground, for $\frac{1}{4}$ Sec. Cor., marked $\frac{1}{4}$ S. on W. face, dug pits, 18 x 18 x 12 ins., N and S of post $5\frac{1}{2}$ ft. dist., and raised a mound of earth $1\frac{1}{2}$ ft. high, $3\frac{1}{2}$ ft. base around post.

79.00

Cross low Sag and ascend.

80.00

Set a post 4 ft. long, 4 ins. square, with marked stone 12 ins. in the ground, for Cor. to Secs, 23, 24, 25, 26 marked T, 15 N. S, 24, on N, E, R, 24 E. S, 25 on S, E, S, 26 on S, W, and S, 23 on N, W, face with 2 notches on S, and 1 notch on E, edges, dug pits 18 x 18 x 12 ins, in each Sec., $5\frac{1}{2}$ ft, dist., and raised a mound of earth 2 ft, high, $4\frac{1}{2}$ ft, base around post.

*Land rolling.*Soil 3rd rate

Vegetation grass.

Township

15 N

Range

24 E

Gila and Salt River Meridian.

Chains

N. 85° 50'

East, on a random line between Sections 24 and 25.

Variation

13° 45'

East.

Ascend.

40.00

Set temporary $\frac{1}{4}$ Sec. Cor.

79.82

Intersect $\frac{1}{4}$ B. of Tp. 37 Nks. S. of cor. to secs.

previously marked by me

19.24. 25. 30 from which corner, I run

S. 85° 110' W. on a true line, between sections 24 & 25

Variation

13° 45'

East.

39.91

Set a post 3 ft. long. 3 ins. diam. with marked stone

12 ins. in the ground, for $\frac{1}{4}$ Sec. Cor., marked $\frac{1}{4}$ S. on

N. face, dug pits, 18 x 18 x 12 ins., E. and W. of

post 5 $\frac{1}{2}$ ft. dist., and raised a mound of earth 1 $\frac{1}{2}$ ft.high, 3 $\frac{1}{2}$ ft. base around post.

79.82

The corner to sections 23, 24, 25, 26

Land rolling.

Soil 2nd & 3rd rate

Vegetation grass.

Chains

North, between Sections 23 and 24.

Variation

13° 45'

East.

Over level land

23.00

Leave Flat bears *N 8° W S W*, and ascend.

40.00

Set a post 3 ft. long, 3 ins. diam. with marked stone 12 ins. in the ground, for $\frac{1}{4}$ Sec. Cor., marked $\frac{1}{4}$ S. on W. face, dug pits, 18 x 18 x 12 ins., N. and S. of post $5\frac{1}{2}$ ft. dist., and raised a mound of earth $1\frac{1}{2}$ ft. high, $3\frac{1}{2}$ ft. base around post.

80.00

Set a post 4 ft. long, 4 ins. square, with marked stone 12 ins. in the ground, for Cor. to Secs, 13, 14, 23, 24 marked T, $\frac{1}{5}$ N. S. 13, on N, E, R, 24 E, S. 24 on S, E, S, 23 on S, W, and S, 14 on N, W, face with 3 notches on S, and 1 notch on E, edges, dug pits 18 x 18 x 12 ins. in each Sec., $5\frac{1}{2}$ ft. dist., and raised a mound of earth 2 ft. high, $4\frac{1}{2}$ ft. base around post.

*Land rolling.*Soil *1st & 2nd rate*Vegetation *Grass.*

Township

15 N

Range

24 E

Gila and Salt River Meridian.

Chains N. 15.00 East, on a random line between Sections 13 and 24.

Variation 13° 45' East.

Ascend.

17.00 Top of Spur, bears N. & S. and descend.

39.00 Cross low Sag and ascend.

40.00 Set temporary $\frac{1}{4}$ Sec. Cor.

79.69 Intersect E. B. of Tp. 5 Wks. N. of cor. to secs.

13, 18, 19, 24 from which corner, I run

S. 89° 2' W on a true line, between sections 13 & 24

Variation 13° 45' East.

39.84 Set a post 3 ft. long, 3 ins. diam. with marked stone
12 ins. in the ground, for $\frac{1}{4}$ Sec. Cor., marked $\frac{1}{4}$ S. on
N. face, dug pits, 18 x 18 x 12 ins., E. and W. of
post 5 $\frac{1}{2}$ ft. dist., and raised a mound of earth 1 $\frac{1}{2}$ ft.
high, 3 $\frac{1}{2}$ ft. base around post.

79.69 The corner to sections 13, 14, 23, 24

Land mountainous.

Soil 3rd rate

Vegetation Grass.

Township 15 N. Range 24 E.
 Gila and Salt River Meridian.

Chains

North, between Sections 13 and 14.

Variation 13° 45' East.

Ascend.

19.00 Top of Spur, bears N. 55° W. 2.455 and descend.

40.00 Set a post 3 ft. long, 3 ins. diam. with marked stone
 12 ins. in the ground, for $\frac{1}{4}$ Sec. Cor., marked $\frac{1}{4}$ S. on
 W. face, dug pits, 18 x 18 x 12 ins., N. and S. of
 post $5\frac{1}{2}$ ft. dist., and raised a mound of earth $1\frac{1}{2}$ ft.
 high, $3\frac{1}{2}$ ft. base around post.

80.00 Set a post 4 ft. long, 4 ins. square, with marked stone
 12 ins. in the ground, for Cor. to Secs. 11. 12. 13. 14
 marked T, 15 N. S. 12, on N, E, R, 24 E. S. 13
 on S, E, S, 14 on S, W, and S, 11 on N, W, face
 with 4 notches on S, and 1 notch on E, edges,
 dug pits 18 x 18 x 12 ins, in each Sec., $5\frac{1}{2}$ ft. dist.,
 and raised a mound of earth 2 ft, high, $4\frac{1}{2}$ ft, base
 around post.

Land rolling.

Soil 3rd rate

Vegetation grass.

Township

15 N.

Range

24 E.

Gila and Salt River Meridian.

Chains N. 88° 38' E. East, on a random line between Sections 12 and 13.

Variation 13° 45' East.

Over rolling land.

40.00 Set temporary $\frac{1}{4}$ Sec. Cor.

80.07 Intersect E. B. of Tp. 41 lks. S. of cor. to secs.

previously located by me

7. 2. 13. 18, from which corner, I run

S. 88° 38' W. on a true line, between sections 12 & 13

Variation 13° 45' East.

40.03 Set a Sand stone 10 x 10 x 8 ins., 0 ins.
 in the ground, for $\frac{1}{4}$ Sec. Cor., marked $\frac{1}{4}$ on N. face,
 dug pits 18 x 18 x 12 ins., E. and W. of stone $5\frac{1}{2}$
 ft. dist., and raised a mound of earth $1\frac{1}{2}$ ft. high, $3\frac{1}{2}$
 ft. base alongside.

80.07 The corner to sections 11, 12, 13, 14

Land rolling.

Soil 3rd rate

Vegetation Grass.

Township

15 N.

Range

24 E.

Gila and Salt River Meridian.

Chains

North, between Sections 11 and 12.

Variation 13° 45' East.

Over rolling land.

40.00

Set a Sand stone 18 x 16 x 5 ins., 12 ins. in the ground, for $\frac{1}{4}$ Sec. Cor., marked $\frac{1}{4}$ on W. face, dug pits 18 x 18 x 12 ins., N. and S. of stone $5\frac{1}{2}$ ft. dist., and raised a mound of earth $1\frac{1}{2}$ ft. high, $3\frac{1}{2}$ ft. base. alongside.

80.00

Set a Sand stone 14 x 8 x 4 ins. 10 ins. in the ground for Cor. to Secs. 1. 2. 11. 12 marked with 5 notches on S. and 1 notch on E. edges, dug pits 18 x 18 x 12 ins. in each Sec., $5\frac{1}{2}$ ft. dist. and raised a mound of earth 2 ft. high, $4\frac{1}{2}$ ft. base. alongside.

*Land rolling.**Soil 3rd rate**Vegetation Grass.*

Township 15 N Range 24 E

Gila and Salt River Meridian.

Chains N. 88° 56' E, on a random line between Sections 1 and 12.Variation 13° 45' East.*Ascend.*40.00 Set temporary $\frac{1}{4}$ Sec. Cor.50.00 Top of Ridge, bears N. 82° W. and descend.80.33 Intersect E. B. of Tp. 75 lks. S. of cor. to secs.*Previously described by me*
1.6. 7. 12. A from which corner, I runS. 88° 24' W. on a true line, between sections 1 & 12Variation 13° 45' East.40.16 Set a Sand stone 18 x 14 x 4 ins., 12 ins.
in the ground, for $\frac{1}{4}$ Sec. Cor., marked $\frac{1}{4}$ on N. face,
dug pits 18 x 18 x 12 ins., E. and W. of stone 5 $\frac{1}{2}$
ft. dist., and raised a mound of earth 1 $\frac{1}{2}$ ft. high, 3 $\frac{1}{2}$
ft. base alongside.80.33 The corner to sections 1. 2. 11. 12Land mountainous.Soil 3rd rateVegetation Grass.

Township 15 N. Range 24 E.

Gila and Salt River Meridian.

Chains

North, on a random line between Sections 1 and 2.

Variation 13° 45' East.*Ascend.*40.00 Set temporary $\frac{1}{4}$ Sec. Cor.

80.59 Intersect N. B. of Tp. 14 Tks. W. of cor. to secs.

1. 2. 35. 36 T. 15 N. R. 24 E.

Which is a sand stone $18 \times 16 \times 3$ ins.
 Set 2 ins. in the ground, marked
 with 1 notch on E. and
 5 notches on W. edges with pits
 $18 \times 18 \times 12$ ins. in each Sec. $5\frac{1}{2}$ ft. dist.
 and earth mound 2 ft. high, $4\frac{1}{2}$ ft. base
 alongside.

from which corner, I run

S. 6' W. on a true line, between sections 1 & 2

Variation 13° 45' East.

40.59 Set a sand stone $15 \times 12 \times 4$ ins., 10 ins.
 in the ground, for $\frac{1}{4}$ Sec. Cor., marked $\frac{1}{4}$ on W. face,
 dug pits $18 \times 18 \times 12$ ins., N. and S. of stone $5\frac{1}{2}$
 ft. dist., and raised a mound of earth $1\frac{1}{2}$ ft. high, $3\frac{1}{2}$
 ft. base. alongside.

80.59 The corner to sections 1. 2. 11. 12

Land rolling.

Soil 1st & 2nd rateVegetation grass.

Feb. 7. 1883

Township 15 N

Range 24 E

Gila and Salt River Meridian.

2.3.

Chains

From the corner to sections, 34 & 35 on S. 13 & 14 T. 15 N.

Which is a post-4 in. square set firmly in the ground, marked T. 15 N. & 35 on N. E. R. 24 E. S. 2 on S. E. T. 14 N. S. 3 on S. W. and 4 on N. W. with 2 notches on E. and 5 notches on W. edge with pits 18 x 18 x 12 ins. in each Sec. 5 1/2 ft. dist. and mound of earth 2 ft. high, 4 1/2 ft. base around post. North between sections 34 & 35

Variation 13° 40' East.

Over level land

40.00

Set a post 3 ft. long, 3 ins. diam. with marked stone 12 ins. in the ground, for 1/4 Sec. Cor., marked 1/4 S. on W. face, dug pits, 18 x 18 x 12 ins., N. and S. of post 5 1/2 ft. dist., and raised a mound of earth 1 1/2 ft. high, 3 1/2 ft. base around post.

and ascend

70.00

Top of Ridge bears E. & W. and descend

80.00

Set a post 4 ft. long, 4 ins. square, with marked stone 12 ins. in the ground, for Cor. to Secs. 26, 27, 34, 35 marked T. 15 N. S. 26, on N, E, R. 24 E. S. 35 on S, E, S, 34 on S, W, and S, 27 on N, W, face with 1 notch on S, and 2 notches on E, edges, dug pits 18 x 18 x 12 ins, in each Sec., 5 1/2 ft, dist., and raised a mound of earth 2 ft, high, 4 1/2 ft, base around post.

from which

A Juniper 38 ins. diam. bears N. 12° E. 42 lbs. dist.
 marked T. 15 N. R. 24 E. S. 26 B. T.
 A Juniper 28 ins. diam. bears S. 86° W. 70 lbs. dist.
 marked T. 15 N. R. 24 E. S. 34 B. T.
 A Juniper 24 ins. diam. bears S. 67° E. 80 lbs. dist.
 marked T. 15 N. R. 24 E. S. 35 B. T.
 No other trees within limits.

Land level. rolling.

Soil 1 1/2 x 3.0 rate

Vegetation Grass
 Timber of Juniper

Township

15 N.

Range

21 E.

Gila and Salt River Meridian.

Chains ¹⁸⁸⁵ East, on a random line between Sections 26 and 35.

Variation 13° 45' East.

Over rolling land.

22.00 Leave Timber, bear N. & E.

26.00 Enter Flat bears N. 20° E. & S. 20° W.

40.00 Set temporary $\frac{1}{4}$ Sec. Cor.

45.00 Leave Flat and ascend gradually.

50.00 Enter Timber, bear N. & E.

80.08 Intersect N. & S. line, 30 lks. S. of cor. to secs.

26, 26, 30, 30 from which corner, I run

S. 88° 48' W. on a true line between sections 26 & 30

Variation 13° 45' East

40.04 Set a post 3 ft. long, 3 ins. diam. with marked stone
 12 ins. in the ground, for $\frac{1}{4}$ Sec. Cor., marked $\frac{1}{4}$ S. on
 N. face, dug pits, 18 x 18 x 12 ins., E. and W. of
 post 5 $\frac{1}{2}$ ft. dist., and raised a mound of earth 1 $\frac{1}{2}$ ft.
 high, 3 $\frac{1}{2}$ ft. base around post.

80.08 The corner to sections 26, 27, 34, 35

Land rolling.

Soil ^{2nd} & 3rd rate

Vegetation grass

Timber of juniper

Township

15 N.

Range

24 E.

Gila and Salt River Meridian.

Chains

North, between Sections 26 and 27.

Variation 13° 45' East.

Over rolling land.

40.00 Set a post 3 ft. long, 3 ins. diam 24 ins. in the ground, for $\frac{1}{4}$ Sec. Cor., marked $\frac{1}{4}$ S. on W. face; from which
 A Juniper 12 ins. diam. bears S. 20° W. 33 lks. dist.
 marked $\frac{1}{4}$ S. B. T.

A Juniper 6 ins. diam. bears N. 55° E. 37 lks. dist.
 marked $\frac{1}{4}$ S. B. T.

80.00 Set a post 4 ft. long, 4 ins. square, with marked stone
 12 ins. in the ground, for Cor. to Secs, 22 23 26 27
 marked T, 15 N. S, 23, on N, E, R, 24 E, S, 26
 on S, E, S, 27 on S, W, and S, 22 on N, W, face
 with 3 notches on S, and 2 notches on E, edges,
 dug pits 18 x 18 x 12 ins, in each Sec., 5 $\frac{1}{2}$ ft, dist.,
 and raised a mound of earth 2 ft, high, 4 $\frac{1}{2}$ ft, base
 around post.

from which

A Juniper 18 ins. diam. bears S. 82° W. 190 lks. dist.
 marked T. 15 N. R. 24 E. S., 27 B. T.

A Juniper 29 ins. diam. bears S. 62° E. 160 lks. dist.
 marked T. 15 N. R. 24 E. S., 26 B. T.

A Juniper 12 ins. diam. bears N. 65° W. 183 lks. dist.
 marked T. 15 N. R. 24 E. S., 22 B. T.

No other trees within limits.

Land rolling.

Soil 3rd rate Timber of juniper
 Vegetation Grass

Township 15 N. Range 21 E.

Gila and Salt River Meridian.

Chains/1886 East, on a random line between Sections 23 and 26.

Variation 13° 45' East.

Over rolling land.

18.00 Descend.

40.00 Set temporary $\frac{1}{4}$ Sec. Cor.

50.00 Leave Timber, leave N. & S.

60.00 Cross low Sag and ascend.

80.22 Intersect N. & S. line, 21 lks. N. of cor. to secs.

23, 24, 25, 26 from which corner, I run

S. 89° 45' W. on a true line between sections 23 & 26

Variation 13° 45' East

40.11 Set a post 3 ft. long, 3 ins. diam. with marked stone
 12 ins. in the ground, for $\frac{1}{4}$ Sec. Cor., marked $\frac{1}{2}$ S. on
 N. face, dug pits, 18 x 18 x 12 ins., E. and W. of
 post 5 $\frac{1}{2}$ ft. dist., and raised a mound of earth 1 $\frac{1}{2}$ ft.
 high, 3 $\frac{1}{2}$ ft. base around post.

80.22 The corner to sections 22, 23, 25, 27

Land rolling.

Soil 2nd & 3rd rate

Vegetation Grass.

Township 15 N Range 24 E

Gila and Salt River Meridian.

Chains

North, between Sections 22 and 23.

Variation 13° 40' East.*Over rolling land.*

- 40.00 Set a post 3 ft. long, 3 ins. diam. 24 ins. in the ground, for $\frac{1}{4}$ Sec. Cor., marked $\frac{1}{4}$ S. on W. face; from which
- A Juniper 12 ins. diam. bears S. 26° W. 164ks. dist. marked $\frac{1}{4}$ S. B. T.
- A Juniper 18 ins. diam. bears N. 67° E. 164ks. dist. marked $\frac{1}{4}$ S. B. T.

80.00

Set a post 4 ft. long, 4 ins. square, with marked stone 12 ins. in the ground, for Cor. to Secs, 14. 15. 22. 23 marked T, 15 N. S, 14, on N, E, R, 24 E, S, 23 on S, E, S, 22 on S, W, and S, 15 on N, W, face with 4 notches on S, and 2 notches on E, edges, dug pits 18 x 18 x 12 ins, in each Sec., 5 $\frac{1}{2}$ ft, dist., and raised a mound of earth 2 ft, high, 4 $\frac{1}{2}$ ft, base around post.

*Land rolling.*Soil 3rd rateVegetation grass.Timber of Juniper.

Township

15 N.

Range

24 E.

Gila and Salt River Meridian.

Chains $1/88^{\circ} 56'$ East, on a random line between Sections 14 and 23.

Variation $13^{\circ} 45'$ East.

Ascend.

30.00

See *misa*

40.00

Set temporary $\frac{1}{4}$ Sec. Cor.

60.00

Descend gradually.

80.39

Intersect N. & S. line, 37 lks. N. of cor. to secs.

13. 14. 23. 24 from which corner, I run

$S. 89^{\circ} 12' W.$ on a true line between sections 14 & 23

Variation $13^{\circ} 45'$ East

40.19

Set a post 3-ft. long. 3 ins. diam. with marked stone

12 ins. in the ground, for $\frac{1}{4}$ Sec. Cor., marked $\frac{1}{4}$ S. on

N. face, dug pits, 18 x 18 x 12 ins., E. and W. of

post $5\frac{1}{2}$ ft. dist., and raised a mound of earth $1\frac{1}{2}$ ft.

high, $3\frac{1}{2}$ ft. base around post.

80.39

The corner to sections 14. 15. 22. 23

Land rolling.

Soil 3rd rate

Vegetation Grass.

Township 15 N. Range 24 E

Gila and Salt River Meridian.

Chains

North, between Sections 14 and 15.

Variation $13^{\circ} 45'$ East.*Descend.*

40.00

Set a Sand stone $12 \times 12 \times 6$ ins., 8 ins. in the ground for $\frac{1}{4}$ Sec. Cor., marked $\frac{1}{4}$ on W. face, dug pits $18 \times 18 \times 12$ ins., N. and S. of stone $5\frac{1}{2}$ ft. dist., and raised a mound of earth $1\frac{1}{2}$ ft. high, $3\frac{1}{2}$ ft. base. alongside.

80.00

Set a Sand stone $18 \times 8 \times 8$ ins. 12 ins. in the ground for Cor. to Secs. 10. 11. 14. 15 marked with 4 notches on S. and 2 notches on E. edges, dug pits $18 \times 18 \times 12$ ins. in each Sec., $5\frac{1}{2}$ ft. dist. and raised a mound of earth 2 ft. high, $4\frac{1}{2}$ ft. base. alongside.

*Land rolling.*Soil 3rd rate

Vegetation grass.

Township 15 N. Range 24 E.

Gila and Salt River Meridian.

Chains 188° 54' East, on a random line between Sections 11 and 14.

Variation 13° 45' East.

Descend.

10.00 Ascend.

40.00 Set temporary $\frac{1}{4}$ Sec. Cor.

79.91 Intersect N. & S. line, 12 lks. S. of cor. to secs.

11, 12, 13, 14 from which corner, I run

S. 88° 51' W. on a true line between sections 11 & 14

Variation 13° 45' East

39.90 Set a Sand stone 18 x 17 x 4 ins., 12 ins.
in the ground, for $\frac{1}{4}$ Sec. Cor., marked $\frac{1}{4}$ on N. face,
dug pits 18 x 18 x 12 ins., E. and W. of stone 5 $\frac{1}{2}$
ft. dist., and raised a mound of earth 1 $\frac{1}{2}$ ft. high, 3 $\frac{1}{2}$
ft. base alongside.

79.91 The corner to sections 10, 11, 14, 15

Land rolling.

Soil 3rd rate

Vegetation Grass.

Township

15 N.

Range

24 E.

Gila and Salt River Meridian.

Chains

North, between Sections 10 and 11.

Variation $13^{\circ} 40'$ East.*Descend.*

15.00

Enter Valley, bears

N. E. & S. W.

40.00

Set a Sand stone $13 \times 12 \times 10$ ins., 8 ins. in the ground, for $\frac{1}{4}$ Sec. Cor., marked $\frac{1}{4}$ on W. face, dug pits $18 \times 18 \times 12$ ins., N and S. of stone $5\frac{1}{2}$ ft. dist., and raised a mound of earth $1\frac{1}{2}$ ft. high, $3\frac{1}{2}$ ft. base. alongside.

80.00

Set a Sand stone $24 \times 6 \times 5$ ins. 18 ins. in the ground for Cor. to Secs. 2. 3. 10. 11 marked with 5 notches on S. and 2 notches on E. edges, dug pits $18 \times 18 \times 12$ ins. in each Sec., $5\frac{1}{2}$ ft. dist. and raised a mound of earth 2 ft. high, $4\frac{1}{2}$ ft. base. alongside.

Land rolling. level.

Soil 3rd rate

Vegetation grass.

Township 15 N. Range 24 E.

Gila and Salt River Meridian.

Chains 188.66 East, on a random line between Sections 2 and 11.

Variation 13° 45' East.

Over flat in Valley.

40.00 Set temporary $\frac{1}{4}$ Sec. Cor.

60.00 Leave Valley, bears *N. E. & S. W.* and ascend.

74.73 Intersect N. & S. line, 60 lks. S. of cor. to secs.

1. 2. 11. 12 from which corner, I run

S. 88° 30' W. on a true line between sections 2 & 11

Variation 13° 45' East

39.86 Set a Sand stone $12 \times 10 \times 4$ ins., 8 ins. in the ground, for $\frac{1}{4}$ Sec. Cor., marked $\frac{1}{4}$ on *N.* face, dug pits $18 \times 18 \times 12$ ins., *E.* and *W.* of stone $5\frac{1}{2}$ ft. dist., and raised a mound of earth $1\frac{1}{2}$ ft. high, $3\frac{1}{2}$ ft. base alongside.

79.73 The corner to sections 2. 3. 10. 11

Land rolling. level.

Soil 3rd rate

Vegetation *grass.*

Township 15 N Range 24 E

Gila and Salt River Meridian.

Chains

North, on a random line between Sections 2 and 3.

Variation 13° 45' East.

Over level land

40.00 Set temporary $\frac{1}{4}$ Sec. Cor.80.22 Intersect N.B. of Tp. 36 1/2 S. E of cor. to secs.
2. 3. 34. 35 T. 15 N. R. 24 E.

Which is a sand stone 18 x 11 x 7 ins.,
set 12 ins. in the ground marked with
2 notches on E. and 5 notches on
W. wedges with site 18 x 18 x 12 ins.
in each Sec. 5 1/2 ft. dist., and
earth mound 2 ft. high, 4 1/2 ft.
base alongside.

from which corner, I run

S. 15' E on a true line, between sections 2 & 3

Variation 13° 45' East.

40.22 Set a sand stone 18 x 11 x 6 ins., 8 ins.
in the ground, for $\frac{1}{4}$ Sec. Cor., marked $\frac{1}{4}$ on W. face,
dug pits 18 x 18 x 12 ins., N. and S. of stone 5 1/2
ft. dist., and raised a mound of earth 1 1/2 ft. high, 3 1/2
ft. base.

80.22 The corner to sections 2, 3, 10, 11

Land level.

Soil 3rd rate

Vegetation grass.

Feb. 8, 1883

Township 15 N. Range 24 E.

Gila and Salt River Meridian.

Chains

3.4.
From the corner to sections, 33 & 34 in S.B. T^p
Which is a post = 4 ins. square set firmly
in the ground marked T. 15 N. S. 34 on N.E.
R. 24 E. S. 30 on S.E. T. 14 N. S. 4 on S.W. and
33 on N.W. ^{face} with 3 notches on E. and
3 notches on W. edges with pits
18 x 18 x 12 ins. in each Sec. 5 1/2 ft.
dist. and a mound of earth 2 ft. high,
4 1/2 ft. base around post. Iron.
North between sections 33 & 34

Variation 13° 40' East.

Over level land

40.00 Set a post 3 ft. long. 3 ins. diam. with marked stone
12 ins. in the ground, for 1/4 Sec. Cor., marked 1/2 S. on
W. face, dug pits, 18 x 18 x 12 ins., N. and S. of
post 5 1/2 ft. dist., and raised a mound of earth 1 1/2 ft.
high, 3 1/2 ft. base around post.

41.00 Cross tributary of Little Col. River 30 W. side Canon S.W.

63.00 Leave Flat bears N. 70° W. & S. 70° E. and ascend.

66.00 Due West of this point is Lopez House. Dist. 16.00

77.00 Enter Timber, E. & W.

80.00 Set a sand stone 19 x 14 x 3 ins. 12 ins.
in the ground for Cor. to Secs. 27. 28. 33. 34 marked
with 1 notch on S. and 3 notches on E. edges,
dug pits 18 x 18 x 12 ins. in each Sec., 5 1/2 ft. dist. and
raised a mound of earth 2 ft. high, 4 1/2 ft. base. alongside.

Land level.

Soil 1st & 3rd rate Timber of juniper.

Vegetation Grass

Township 15 N Range 24 E

Gila and Salt River Meridian.

Chains 1.88 50' East, on a random line between Sections 27 and 34.
 Variation 13° 45' East.

Ascend.

20.00 Top of Spur, bears N. 2 S. and descend.

40.00 Set temporary $\frac{1}{4}$ Sec. Cor.

79.69 Intersect N. & S. line, 17 lks. N. of cor. to secs.

26. 27. 34. 35 from which corner, I run

89° 3' W. on a true line between sections 27 & 34

Variation 13° 45' East

39.84 Set a post 3 ft. long, 3 ins. diam 24 ins. in the ground,
 for $\frac{1}{4}$ Sec. Cor., marked $\frac{1}{4}$ S. on N. face; from which

A Juniper 16 ins. diam. bears N. 56° E. 120 lks. dist.
 marked $\frac{1}{4}$ S. B. T.

A Juniper 9 ins. diam. bears S. 19° W. 50 lks. dist.
 marked $\frac{1}{4}$ S. B. T.

79.69 The corner to sections 27. 28. 33. 34

Land mountainous

Soil 3rd rate

Timber of Juniper.

Vegetation. grass.

Township 15 N. Range 24 E.

Gila and Salt River Meridian.

Chains

North, between Sections 27 and 28.

Variation $13^{\circ} 45'$ East.

20.00 Ascend.

32.00 Top of bluff bears E. & W. and descend

40.00 Set a post 3 ft. long, 3 ins. diam. with marked stone
12 ins. in the ground, for $\frac{1}{4}$ Sec. Cor., marked $\frac{1}{4}$ S. on
W. face, dug pits, 18 x 18 x 12 ins., N. and S. of
post $5\frac{1}{2}$ ft. dist., and raised a mound of earth $1\frac{1}{2}$ ft.
high, $3\frac{1}{2}$ ft. base around post.

48.00 Descend gradually.

72.00 Cross Wash, 15' lks. wide, Course S. 80° W.

80.00 Set a post 4 ft. long, 4 ins. square, with marked stone
12 ins. in the ground, for Cor. to Secs. 21, 22, 27, 28
marked T, 15 N.S. 22, on N, E, R, 24 E., S. 27
on S, E, S, 28 on S, W, and S, 21 on N, W, face
with 2 notches on S, and 3 notches on E, edges,
dug pits 18 x 18 x 12 ins, in each Sec., $5\frac{1}{2}$ ft, dist.,
and raised a mound of earth 2 ft, high, $4\frac{1}{2}$ ft, base
around post.

Land rolling.

Soil 2nd & 3rd rate

Vegetation grass.

Township 15 N Range 24 E

Gila and Salt River Meridian.

Chains $N 88^{\circ} 52'$ East, on a random line between Sections 22 and 27.Variation $18^{\circ} 40'$ East.*Ascend.*28.00 Top of bluff bears *N. E. S.* and descend40.00 Set temporary $\frac{1}{4}$ Sec. Cor.

59.73 Intersect N. & S. line, 10 lks. S. of cor. to secs.

22, 23, 26, 27 from which corner, I run

 $S. 88^{\circ} 52' W.$ on a true line between sections 22 & 27Variation $13^{\circ} 45'$ East

39.86 Set a post 3 ft. long, 3 ins. diam. with marked stone

12 ins. in the ground, for $\frac{1}{4}$ Sec. Cor., marked $\frac{1}{4}$ S. onN. face, dug pits, 18 x 18 x 12 ins., E. and W. of
post $5\frac{1}{2}$ ft. dist., and raised a mound of earth $1\frac{1}{2}$ ft.high, $3\frac{1}{2}$ ft. base around post. from whichA Juniper 18 ins. diam. bears $S. 69^{\circ} W.$ 1.07 lks. dist.
marked $\frac{1}{4}$ S. B. T.

No other trees within limits.

79.73 The corner to sections 21, 22, 27, 28

Land rolling.

Soil 3rd rate

Vegetation grass.

Timber of Juniper.

Township

15 N.

Range

24 E.

Gila and Salt River Meridian.

Chains

North, between Sections 21 and 22.

Variation

13° 45'

East.

36.00 Ascend.

40.00 Set a post 3 ft. long, 3 ins. diam. with marked stone
12 i.s. in the ground, for $\frac{1}{4}$ Sec. Cor., marked $\frac{1}{4}$ S. on
W. face, dug pits, 18 x 18 x 12 ins., N and S of
post $5\frac{1}{2}$ ft. dist., and raised a mound of earth $1\frac{1}{2}$ ft.
high, $3\frac{1}{2}$ ft. base around post.

80.00 Set a post 4 ft. long, 4 ins. square, with marked stone
12 ins. in the ground, for Cor. to Secs, 15, 16, 21, 22
marked T, 15 N. S, 16, on N, E, R, 24 E. S. 22
on S, E, S, 21 on S. W, and S, 16 on N, W, face
with 4 notches on S, and 3 notches on E, edges,
dug pits 18 x 18 x 12 ins, in each Sec., $5\frac{1}{2}$ ft, dist.,
and raised a mound of earth 2 ft, high, $4\frac{1}{2}$ ft, base
around post.

from which

A Juniper 14 ins. diam. bears N. 57° W. 1.00 lks. dist.
marked T. 15 N. R. 24 E. S., 16 B. T.

A Juniper 18 ins. diam. bears S. 63 $\frac{1}{2}$ ° E. 39 lks. dist.
marked T. 15 N. R. 24 E. S., 22 B. T.

A Juniper 12 ins. diam. bears S. 49 $\frac{1}{4}$ ° W. 118 lks. dist.
marked T. 15 N. R. 24 E. S., 21 B. T.

No other trees within limits.

Land rolling.

Soil 3rd rate

Vegetation

Grass

Timber of

Juniper.

Township 15 N Range 24 E

Gila and Salt River Meridian.

Chains 1.88° East, on a random line between Sections 15 and 22.

Variation 13° 45' East.

*Over rolling land.*3.00 Leave Timber, *see N. & S.*40.00 Set temporary $\frac{1}{4}$ Sec. Cor.80.15 Intersect N. & S. line, 18 lks. *S.* of cor. to *secs.**H. 15, 22, 23 from which corner, I run**S. 88° 45' W. on a true line between sections 15 & 22*

Variation 13° 45' East

40.07 Set a post 3 ft. long, 3 ins. diam. with marked stone
 12 ins. in the ground, for $\frac{1}{4}$ Sec. Cor., marked $\frac{1}{4}$ S. on
N. face, dug pits, 18 x 18 x 12 ins., *E.* and *W.* of
 post $5\frac{1}{2}$ ft. dist., and raised a mound of earth $1\frac{1}{2}$ ft.
 high, $3\frac{1}{2}$ ft. base around post.

80.15 The corner to sections 15, 16, 21, 22

Land rolling.

Soil 3rd rate

Vegetation Grass

Township 15 N Range 24 E

Gila and Salt River Meridian.

Chains

North, between Sections 15 and 16.

Variation 13° 45' East.*Over rolling land.*38.00 *Leave Timber,*

40.00 Set a *Sand* stone $10 \times 10 \times 8$ ins., 6 ins. in the ground, for $\frac{1}{4}$ Sec. Cor., marked $\frac{1}{4}$ on *W.* face, dug pits $18 \times 18 \times 12$ ins., *N.* and *S.* of stone $5\frac{1}{2}$ ft. dist., and raised a mound of earth $1\frac{1}{2}$ ft. high, $3\frac{1}{2}$ ft. base. alongside.

80.00

Set a *Sand* stone $16 \times 12 \times 4$ ins. 10 ins. in the ground for Cor. to Secs. 9, 10, 15, 16 marked with 4 notches on *S.* and 3 notches on *E.* edges, dug pits $18 \times 18 \times 12$ ins. in each Sec., $5\frac{1}{2}$ ft. dist. and raised a mound of earth 2 ft. high, $4\frac{1}{2}$ ft. base. alongside.

*Land rolling.*Soil 3rd rateVegetation grass.

Chains N. 88° 56' East, on a random line between Sections 10 and 15.

Variation 13° 45' East.

Over level land

40.00 Set temporary 1/4 Sec. Cor.

74.50 Leave Flat and ascend.

77.00 Top of bluff bears N. 20° E. & S. 20° W. and descend

79.82 Intersect N. & S. line, 28 lks. S. of cor. to sec.

10. 11. 14. 15 from which corner, I run

S. 88° 44' W. on a true line between sections 10 & 15

Variation 13° 45' East

39.91 Set a sand stone 12 x 12 x 5 ins., 8 ins. in the ground, for 1/4 Sec. Cor., marked 1/4 on N. face, dug pits 18 x 18 x 12 ins., E. and W. of stone 5 1/2 ft. dist., and raised a mound of earth 1 1/2 ft. high, 3 1/2 ft. base alongside.

79.82 The corner to sections 9. 10. 15. 16

Land level.

Soil 2° & 3° rate

Vegetation grass.

Township

15 N

Range

24

E

Gila and Salt River Meridian.

Chains

North, between Sections 9 and 10.

Variation

13° 45'

East.

Over level land

40.00

Set a *Sand* stone 16 x 13 x 14 ins., 10 ins. in the ground, for $\frac{1}{4}$ Sec. Cor., marked $\frac{1}{4}$ on W. face, dug pits 18 x 18 x 12 ins., N. and S. of stone $5\frac{1}{2}$ ft. dist., and raised a mound of earth $1\frac{1}{2}$ ft. high, $3\frac{1}{2}$ ft. base alongside.

80.00

Set a *Sand* stone 18 x 16 x 5 ins. 12 ins. in the ground for Cor. to Secs. 3. 4. 9. 10 marked with 5 notches on S. and 3 notches on E. edges, dug pits 18 x 18 x 12 ins. in each Sec., $5\frac{1}{2}$ ft. dist. and raised a mound of earth 2 ft. high, $4\frac{1}{2}$ ft. base alongside.

*Land level.**Soil 3rd rate**Vegetation grass*

Township

15 N

Range

21 E

Gila and Salt River Meridian.

Chains $N. 88^{\circ} 56'$ East, on a random line between Sections 3 and 10.Variation $13^{\circ} 45'$ East.

Over level land

40.00 Set temporary $\frac{1}{4}$ Sec. Cor.

79.90 Intersect N. & S. line, 44' lks. S. of cor. to secs.

2, 3, 10, 11 from which corner, I run

 $S. 88^{\circ} 37'$ W. on a true line between sections 3 & 10Variation $13^{\circ} 45'$ East

39.95 Set a sand stone $15 \times 10 \times 5$ ins., 10 ins. in the ground, for $\frac{1}{4}$ Sec. Cor., marked $\frac{1}{4}$ on N. face, dug pits $18 \times 18 \times 12$ ins., E. and W. of stone $5\frac{1}{2}$ ft. dist., and raised a mound of earth $1\frac{1}{2}$ ft. high, $3\frac{1}{2}$ ft. base alongside.

79.90 The corner to sections 3, 4, 9, 10

Land level.

Soil g° rate

Vegetation grass.

Township

15 N.

Range

24

E.

Gila and Salt River Meridian.

Chains

North, on a random line between Sections 3 and 4.

Variation $13^{\circ} 45'$ East.*Over level land*40.00 Set temporary $\frac{1}{4}$ Sec. Cor.

80.11 Intersect N. B. of Tp. 21 Nks. E. of cor. to secs.

3, 4, 33, 34 T. 15 N. R. 24 E.

Which is a sandstone $16 \times 16 \times 6$ ins. set 11 ins. in the ground, marked with 3 matches on E. and 3 matches on W. edges, with pits $18 \times 18 \times 12$ ins. in each Sec., $15\frac{1}{2}$ ft. dist. and earth mound 2 ft. high, $4\frac{1}{2}$ ft. base alongside.

from which corner, I run

S. 9. E. on a true line, between sections 3 & 4

Variation $13^{\circ} 45'$ East.

40.11 Set a sand stone $14 \times 7 \times 14$ ins., 10 ins. in the ground, for $\frac{1}{4}$ Sec. Cor., marked $\frac{1}{4}$ on W. face, dug pits $18 \times 18 \times 12$ ins., N. and S. of stone $5\frac{1}{2}$ ft. dist., and raised a mound of earth $1\frac{1}{2}$ ft. high, $3\frac{1}{2}$ ft. base alongside.

80.11 The corner to sections 3, 4, 9, 10

Land level.

Soil 3rd rate

Vegetation grass.

Feb. 9. 1883

Township 15 N Range 24 E

Gila and Salt River Meridian.

Chains

From the corner to sections ⁴⁵ 22 & 33 on S.R. 97 -
 Which is a post, 4 ins. square set firmly in the ground, marked
 T. 15 N. S. 33 on N. E. P. 24 E. S. 40 on S. E.
 T. 14 N. S. 5 on S. W. S. 22 on N. W. ^{face} with
 4 notches on E. and 2 notches on W. edges.
 with pits 18 x 18 x 12 ins. in each Sec.,
 5 1/2 ft. dist. and around of earth 2 ft.
 high, 4 1/2 ft. base around post. Run
 North between sections 22 & 33

Variation 13° 45' East.

Over rolling land.

40.00

Set a Sand stone 14 x 12 x 4 ins., 10 ins.
 in the ground, for 1/4 Sec. Cor., marked 1/4 on W. face,
 dug pits 18 x 18 x 12 ins., N. and S. of stone 5 1/2
 ft. dist., and raised a mound of earth 1 1/2 ft. high, 3 1/2
 ft. base alongside.

50.00

Cross Creek 1/4 lks. wide, Course N 20° W and ascend.

64.00

Leave Flat bears N. 60° E.

66.00

Enter Timber, N. 60° E.

79.10

Top of Spur, bears N. 15° E. and descend.

80.00

Set a Sand stone 16 x 12 x 3 ins. 10 ins.
 in the ground for Cor. to Secs. 28. 29. 32. 33 marked
 with 1 notch on S. and 4 notches on E. edges,
 dug pits 18 x 18 x 12 ins. in each Sec., 5 1/2 ft. dist. and
 raised a mound of earth 2 ft. high, 4 1/2 ft. base. alongside.

Land poleing
 Soil...
 Vegetation grass.

Township

15 N

Range

24 E

Gila and Salt River Meridian.

Chains $N. 88^{\circ} 30'$ East, on a random line between Sections 28 and 33.Variation $13^{\circ} 45'$ East.*Over rolling land. and ascend*36.00 Top of Spur, bears $N. \& S.$ and descend.

38.41 Cross low Sag and ascend.

40.00 Set temporary $\frac{1}{4}$ Sec. Cor.55.00 Top of Spur, bears $N. \& S.$ and descend.79.98 Intersect N. & S. line, 15 lks. $N.$ of cor. to sees.

27. 28. 33. 34 from which corner, I run

 $S. 59^{\circ} 2'$ W. on a true line between sections 28 & 33Variation $13^{\circ} 45'$ East

39.99 Set a post 3 ft. long, 3 ins. diam 24 ins. in the ground,
for $\frac{1}{4}$ Sec. Cor., marked $\frac{1}{4}$ S. on $N.$ face; from which
A Juniper 19 ins. diam. bears $N. 11^{\circ} E.$ 52 lks. dist.
marked $\frac{1}{4}$ S. B. T.

A Juniper 14 ins. diam. bears $S. 46^{\circ} W.$ 26 lks. dist.
marked $\frac{1}{4}$ S. B. T.

79.98 The corner to sections 28. 29. 32. 33

Land mountainous

Soil 3rd rate

Timber of Juniper.

Vegetation. Grass.

Township

15 N

Range

211 E

Gila and Salt River Meridian.

Chains

North, between Sections 28 and 29.

Variation $13^{\circ} 40'$ East.

Descend.

20

Cross Creek Corner S 87 W

7.00

Leave Timber, Enter Flat bears N. 115° W.

40.00

Set a Sand stone $18 \times 8 \times 8$ ins., 12 ins. in the ground, for $\frac{1}{4}$ Sec. Cor., marked $\frac{1}{4}$ on W. face, dug pits $18 \times 18 \times 12$ ins., N. and S. of stone $5\frac{1}{2}$ ft. dist., and raised a mound of earth $1\frac{1}{2}$ ft. high, $3\frac{1}{2}$ ft. base alongside.

65.00

Enter Timber, N. 50 E.

80.00

Set a Sand stone $17 \times 5 \times 4$ ins. 12 ins. in the ground for Cor. to Secs. 20, 21, 28, 29 marked with 2 notches on S. and 4 notches on E. edges, dug pits $18 \times 18 \times 12$ ins. in each Sec., $5\frac{1}{2}$ ft. dist. and raised a mound of earth 2 ft. high, $4\frac{1}{2}$ ft. base. alongside.

Land rolling.

Soil 1st & 3rd rate

Vegetation grass.

Timber of juniper.

Township 15 N. Range 24 E.

Gila and Salt River Meridian.

Chains N. 83° 56' East, on a random line between Sections 21 and 28.

Variation 13° 45' East.

*Over rolling land.*40.00 Set temporary $\frac{1}{4}$ Sec. Cor.

47.00 Cross low Sag and ascend.

80.06 Intersect N. & S. line, 16 lks. S. of cor. to secs.

21. 22. 27. 28 from which corner, I run

S. 88° 49' W. on a true line between sections 21 and 28

Variation 13° 45' East

40.03 Set a post 3 ft. long, 3 ins. diam. with marked stone
12 ins. in the ground, for $\frac{1}{4}$ Sec. Cor., marked $\frac{1}{4}$ S. on
N. face, dug pits, 18 x 18 x 12 ins., E. and W. of
post $5\frac{1}{2}$ ft. dist., and raised a mound of earth $1\frac{1}{2}$ ft.
high, $3\frac{1}{2}$ ft. base around post.

80.06 The corner to sections 20. 21. 28. 29

*Land rolling.**Soil 2nd & 3rd rate**Vegetation grass.**Timber of juniper.*

Township 15 N Range 24 E

Gila and Salt River Meridian.

Chains

North, between Sections 20 and 21.

Variation 13° 15' East.

Ascend.

40.00

Set a Sand stone $18 \times 14 \times 14$ ins., 12 ins. in the ground, for $\frac{1}{4}$ Sec. Cor., marked $\frac{1}{4}$ on W. face, dug pits $18 \times 18 \times 12$ ins., N. and S. of stone $5\frac{1}{2}$ ft. dist., and raised a mound of earth $1\frac{1}{2}$ ft. high, $3\frac{1}{2}$ ft. base alongside.

70.00

Top of Spur, bears N.E. & S.W. and descend.

80.00

Set a Sand stone $15 \times 12 \times 5$ ins. 10 ins. in the ground for Cor. to Secs. 16. 17. 20. 21 marked with 3 notches on S. and 4 notches on E. edges, dug pits $18 \times 18 \times 12$ ins. in each Sec., $5\frac{1}{2}$ ft. dist. and raised a mound of earth 2 ft. high, $4\frac{1}{2}$ ft. base. alongside.

Land rolling.

Soil 2nd rate

Vegetation Grass

Timber of Juniper

Township

15 N

Range

24

E

Gila and Salt River Meridian.

Chains $N. 88^{\circ} 45'$ East, on a random line between Sections 16 and 21.Variation $13^{\circ} 45'$ East.

Over rolling land.

8.00

Enter Timber, bears N. & S.

40.00

Set temporary $\frac{1}{4}$ Sec. Cor.

44.00

Top of Hill bears $N. 40^{\circ} E.$ & $S. 40^{\circ} W.$ and descend.

79.77

Intersect N. & S. line, 25 lks. S. of cor. to secs.

15. 16. 21. 22, from which corner, I run

 $S. 88^{\circ} 45' W.$ on a true line between sections 16 & 21Variation $13^{\circ} 45'$ East

39.88

Set a sand stone $10 \times 10 \times 6$ ins., 6 ins. in the ground, for $\frac{1}{4}$ Sec. Cor., marked $\frac{1}{4}$ on N. face, dug pits $18 \times 18 \times 12$ ins., E. and W. of stone $5\frac{1}{2}$ ft. dist., and raised a mound of earth $1\frac{1}{2}$ ft. high, $3\frac{1}{2}$ ft. base alongside.

79.77

The corner to sections 16. 17. 20. 21

Land rolling.

Soil 3rd rate

Vegetation Grass.

Timber of Juniper.

Township

15

Range

24

E

Gila and Salt River Meridian.

Chains

North, between Sections 16 and 17.

Variation

13° 40'

East.

Over rolling land.

2.00

Leave Timber, bears E. & W.

20.00

Enter Flat bears E. & W.

40.00

Set a Sand stone 18 x 6 x 6 ins., 12 ins. in the ground, for $\frac{1}{4}$ Sec. Cor., marked $\frac{1}{4}$ on W. face, dug pits 18 x 18 x 12 ins., N. and S. of stone $5\frac{1}{2}$ ft. dist., and raised a mound of earth $1\frac{1}{2}$ ft. high, $3\frac{1}{2}$ ft. base *along side*

80.00

Set a Sand stone 14 x 14 x 7 ins. 10 ins. in the ground for Cor. to Secs. 8. 9. 16. 17 marked with 4 notches on S. and 4 notches on E. edges, dug pits 18 x 18 x 12 ins. in each Sec., $5\frac{1}{2}$ ft. dist. and raised a mound of earth 2 ft. high, $4\frac{1}{2}$ ft. base *along side*

*Land rolling and level.*Soil 3rd rateVegetation *grass*

Township 15 N. Range 24 E.

Gila and Salt River Meridian.

Chains 7.88° East, on a random line between Sections 9 and 16.Variation $13^{\circ} 45'$ East.*Over level land*40.00 Set temporary $\frac{1}{4}$ Sec. Cor.79.65 Intersect N. & S. line, 34 lks. S. of cor. to secs.
9. 10. 15. 16 from which corner, I run $7.88^{\circ} 41' W.$ on a true line between sections 9 & 16Variation $13^{\circ} 45'$ East3782 Set a sand stone $12 \times 12 \times 9$ ins., 8 ins.
in the ground, for $\frac{1}{4}$ Sec. Cor., marked $\frac{1}{4}$ on N. face,
dug pits $18 \times 18 \times 12$ ins., E. and W. of stone $5\frac{1}{2}$
ft. dist., and raised a mound of earth $1\frac{1}{2}$ ft. high, $3\frac{1}{2}$
ft. base alongside.

79.65 The corner to sections 8. 9. 16. 17

Land level.

Soil 3rd rate

Vegetation grass.

I carefully examined the adjustments of my solar
compass to-day, particularly the latitude and revers-
ing apparatus, and found them correct.

Feb. 10. 1883

Township 15 N Range 24 E

Gila and Salt River Meridian.

Chains

North, between Sections 8 and 9.

Variation 13° 45' East.

Over rolling land.

40.00

Set a Sand stone 18 x 6 x 6 ins., 12 ins. in the ground, for $\frac{1}{4}$ Sec. Cor., marked $\frac{1}{4}$ on W. face, dug pits 18 x 18 x 12 ins., N and S. of stone $5\frac{1}{2}$ ft. dist., and raised a mound of earth $1\frac{1}{2}$ ft. high, $3\frac{1}{2}$ ft. base alongside.

80.00

Set a Sand stone 18 x 14 x 3 ins. 12 ins. in the ground for Cor. to Secs. 4. 5. 8. 9 marked with 5 notches on S. and 4 notches on E. edges, dug pits 18 x 18 x 12 ins. in each Sec., $5\frac{1}{2}$ ft. dist. and raised a mound of earth 2 ft. high, $4\frac{1}{2}$ ft. base. alongside.

*Land rolling.*Soil 3rd rate

Vegetation grass.

Township

15 N.

Range

24 E.

Gila and Salt River Meridian.

Chains $N 85^{\circ} 06'$ East, on a random line between Sections 4 and 9.Variation $13^{\circ} 14' 0''$ East.

Over level land

40.00 Set temporary $\frac{1}{4}$ Sec. Cor.

80.08 Intersect N. & S. line, 68 lks. S. of cor. to secs.

S. H. Q. 10 from which corner, I run

 $S 88^{\circ} 27' W.$ on a true line between sections 4 & 9Variation $13^{\circ} 14' 5''$ East

40.04 Set a Sand stone $15 \times 14 \times 4$ ins., 10 ins. in the ground, for $\frac{1}{4}$ Sec. Cor., marked $\frac{1}{2}$ on N. face, dug pits $18 \times 18 \times 12$ ins., E. and W. of stone $5\frac{1}{2}$ ft. dist., and raised a mound of earth $1\frac{1}{2}$ ft. high, $3\frac{1}{2}$ ft. base alongside.

80.08 The corner to sections 4, 5, 8, 9

Land level.

Soil 3° rate

Vegetation grass.

Township 15 N Range 24 E

Gila and Salt River Meridian.

Chains

North, on a random line between Sections 4 and 5.

Variation $13^{\circ} 45'$ East.

38.5

Over rolling land.

40.00

Cross wash corner SW
Set temporary $\frac{1}{4}$ Sec. Cor.

41.00

Leave Flat bears N.E. & S.W., and ascend.

42.00

ascend gradually.

79.66

Intersect N. B. of Tp. 8 lks. W. of cor. to secs.

T. 15 N. R. 24 E.

Which is a sandstone $14 \times 13 \times 2$ ins.
Set 9 ins. in the ground marked
with 4 molches on E. and
2 molches on W. edges, with pits
 $18 \times 18 \times 12$ ins. in each Sec. $5\frac{1}{2}$ ft.
dist. and earth mound 2 ft. high,
 $4\frac{1}{2}$ ft. base alongside.

from which corner, I run

S. 3' W. on a true line, between sections 4 & 5
Variation $18^{\circ} 45'$ East.

39.66

Set a Sand stone $16 \times 16 \times 4$ ins., 10 ins.
in the ground, for $\frac{1}{4}$ Sec. Cor., marked $\frac{1}{4}$ on W. face,
dug pits $18 \times 18 \times 12$ ins., N. and S. of stone $5\frac{1}{2}$
ft. dist., and raised a mound of earth $1\frac{1}{2}$ ft. high, $3\frac{1}{2}$
ft. base. alongside.

79.66

The corner to sections 4, 5, 8, 9

Land rolling.

Soil 2nd & 3rd rate

Vegetation grass.

Township

15 N

Range

24 E

Gila and Salt River Meridian.

Chains

5-6

From the corner to sections, 31 & 32

Which is a post-4 ms. square set firmly in the ground, marked T. 15 N. S. 32 on N. E. R. 24 E. S. 5 on S. E. T. 14 N. S. 6 on S. W. S. 31 on N. W. ^{face} with 5 notches on E. and 1 notch on W. edge with pits 18 x 18 x 12 ms. in each Sec. 15 1/2 ft. dist. and mound of earth 2 ft. high, 4 1/2 ft. base around post. I run North between sections 31 & 32

Variation 13° 45' East.

Over level land

40.00

Set a Sand stone 15 x 13 x 9 ins., 10 ins. in the ground, for 1/4 Sec. Cor., marked 1/4 on W. face, dug pits 18 x 18 x 12 ins., N. and S. of stone 5 1/2 ft. dist., and raised a mound of earth 1 1/2 ft. high, 3 1/2 ft. base alongside.

46.58

Cross little Col. River Course N. 15° W.

80.00

Set a post 4 ft. long, 4 ins. square, with marked stone 12 ins. in the ground, for Cor. to Secs, 29, 30, 31, 32 marked T. 15 N. S. 29, on N. E. R. 24 E., S. 32 on S. E. S. 31 on S. W. and S. 30 on N. W. face with 1 notch on S. and 5 notches on E. edges, dug pits 18 x 18 x 12 ins. in each Sec., 5 1/2 ft. dist., and raised a mound of earth 2 ft. high, 4 1/2 ft. base around post.

nd level.

Soil / rate

Vegetation / space

Township 15 N. Range 24 E.

Gila and Salt River Meridian.

Chains 1.58° East, on a random line between Sections 29 and 32.Variation $13^{\circ} 45'$ East.

Over level land

40.00 Set temporary $\frac{1}{4}$ Sec. Cor.47.00 Cross Creek 10⁺ lks. wide, Course N. 30° W.60.00 Leave Flat bears N. 45° W. and ascend.64.00 Enter Timber, bears N. 45° W.

80.29 Intersect N. & S. line, 40 lks. N. of cor. to secs.

28.29. 32. 33 from which corner, I run

S. 59° 2' W. on a true line between sections 29 & 32Variation $13^{\circ} 45'$ East

40.14 Set a Flint stone $17 \times 14 \times 11$ ins., 12 ins. in the ground, for $\frac{1}{4}$ Sec. Cor., marked $\frac{1}{4}$ on N. face, dug pits $18 \times 18 \times 12$ ins., E. and W. of stone $5\frac{1}{2}$ ft. dist., and raised a mound of earth $1\frac{1}{2}$ ft. high, $3\frac{1}{2}$ ft. base alongside.

80.29 The corner to sections 29. 30. 31. 32.

Land level. rolling.

Soil 1.52° rate

Vegetation Grass.

Township

15 N

Range

24 E

Gila and Salt River Meridian.

Chains 588.66 West, on a random line between Sections 30 and 31.

Variation 13° 45' East.

Over level land

32.83 Cross Colorado River. Course N.

70.00 Cross Road, bears, N. 45° W. & S. 45° E.

40.00 Set temporary 1/4 Sec. Cor.

86.56 Intersect W. B. of Tp. 39 lks. N. of cor. to secs.

29. 30. 31. 32 E. 15 N. R. 24 E.

Which is a post-4 ft. long, 4 ins. square, with marked stone, 12 ins. in the ground, marked E. 15 N. & 30 on N. E. R. 24 E. & 31 on S. E. R. 23 E. & 32 on S. W. and S. 25 on N. W. faces with 1 notch on S. and 5 notches on N. edges; with pits 18 x 18 x 12 ins. in each Sec. 5 1/2 ft. dist. and a mound of earth 2 ft. high, 4 1/2 ft. base around post. from which corner 1 run

N. 88° 39' E on a true line, between sections 30 & 31

Variation 13° 47' East.

46.56 Set a Sand stone 12 x 12 x 5 ins., 8 ins. in the ground, for 1/4 Sec. Cor., marked 1/4 on N. face, dug pits 18 x 18 x 12 ins., E. and W. of stone 5 1/2 ft. dist., and raised a mound of earth 1 1/2 ft. high, 3 1/2 ft. base alongside.

86.56 The corner to sections 29. 30. 31. 32 Land level.

Soil rate

Vegetation grass.

Township, 15 NRange 24 E

Gila and Salt River Meridian.

Chains

North, between Sections 29 and 30.

Variation 13° 45' East.*Over level land*

24.40

Cross Creek 10 *uks. wide. Course N. 40° W.*

40.00

Set a *Sand* stone $18 \times 6 \times 4$ ins., 12 ins. in the ground, for $\frac{1}{4}$ Sec. Cor., marked $\frac{1}{4}$ on *W.* face, dug pits $18 \times 18 \times 12$ ins., *N.* and *S.* of stone $5\frac{1}{2}$ ft. dist., and raised a mound of earth $1\frac{1}{2}$ ft. high, $3\frac{1}{2}$ ft. base alongside.

41.00

Leave Flat bears *E. & W.* and ascend.

62.00

Enter Timber, ^{bears} *S. 70° E. & N. 70° W.*

80.00

Set a *Sand* stone $14 \times 10 \times 4$ ins. 10 ins. in the ground for Cor. to Secs. 19. 20. 29. 30 marked with 2 notches on *S.* and 5 notches on *E.* edges, dug pits $18 \times 18 \times 12$ ins. in each Sec., $5\frac{1}{2}$ ft. dist. and raised a mound of earth 2 ft. high, $4\frac{1}{2}$ ft. base. alongside.

Land level. *rolling.*Soil *1st & 2nd rate*Vegetation *grass*Timber of *juniper*

Township 15 N Range 24 E

Gila and Salt River Meridian.

Chains ^{189.86} East, on a random line between Sections 20 and 29.Variation 13° 45' East.*Ascend.*14.00 Top of Spur, bears N. 45° E. S. 45° W. and descend.27.00 *Ascend. gradually.*40.00 Set temporary $\frac{1}{2}$ Sec. Cor.69.00 Top of Spur, bears N. & S. and descend.80.12 Intersect N. & S. line, 40 lks. N. of cor. to sess.

20. 21. 28. 29 from which corner, I run

189. 13' W. on a true line between sections 20 & 29Variation 13° 45' East

40.06 Set a Sand stone $16 \times 12 \times 4$ ins., 10 ins. in the ground, for $\frac{1}{2}$ Sec. Cor., marked $\frac{1}{2}$ on N face, dug pits $18 \times 18 \times 12$ ins., E and W. of stone $5\frac{1}{2}$ ft. dist., and raised a mound of earth $1\frac{1}{2}$ ft. high, $3\frac{1}{2}$ ft. base alongside.

80.12 The corner to sections 17. 20. 29. 30

Land mountainous

Soil 2nd & 3rd rateTimber of juniperVegetation. grass.

I carefully examined the adjustments of my solar compass to-day, particularly the latitude and reversing apparatus, and found them correct.

Feb. 12. 1883

Township 15 N Range 24 E

Gila and Salt River Meridian.

Chains 1.88 3/4 West, on a random line between Sections 19 and 30.

Variation 13° 45' East.

Ascend.

12.00 Top of Spur, bears N. 30° E. & S. 30° W. and descend.

14.00 Enter Timber.

17.00 Cross low Sag and ascend.

27.00 Top of Spur, bears N. 30° E. & S. 30° W. and descend.

40.00 Set temporary $\frac{1}{4}$ Sec. Cor.

50.00 Leave Timber, bears N. 30° E.

53.00 Enter Flat bears N. 30° E.

56.38 Intersect N. & S. line, 47 lks. N. of cor. to seas.

9. 24. 25. 30 T. 15 N. R. 24 E.

Which is a post 4 ft. long, 4 ins. square, with marked stone 2 ins. in the ground, marked T. 15 N. S. 19 on N.E. R. 24 E. S. 30 on S.E. R. 23 E. S. 25 on S.W. and S. 24 on W.W. face with 2 notches on S. and 4 notches on W. edge, with pits 18 x 18 x 2 ins. in each Sec. $5\frac{1}{2}$ ft. dist., and a mound of earth 2 ft. high, $4\frac{1}{2}$ ft. base around post. From which corner, I run

N. 88° 36' W. on a true line between sections 19 & 30

Variation 13° 47' East

Set a sound stone 27 x 15 x 2 ins., 21 ins.

in the ground, for $\frac{1}{4}$ Sec. Cor., marked $\frac{1}{4}$ on N. face,

dug pits 18 x 18 x 12 ins., S. and W. of stone 5 1/2

ft. dist., and raised a mound of earth 1 1/2 ft. high, 3 1/2

ft. base alongside.

The corner to sections 19. 20. 29. 30

Soil 15. 2. 8. 10
 Timber of Juniper
 Vegetation ...
 rate 46.38

Standard mountainous

Township

15 N.

Range

24 E.

Gila and Salt River Meridian.

Chains

North, between Sections 19 and 20.

Variation $13^{\circ} 45'$ East.*Ascend.*

6.00

Top of Spur, bears $N. 45^{\circ} E.$ $S. 45^{\circ} W.$ and descend.

20.00

Ascend. gradually.

40.00

Set a *Sand* stone $17 \times 24 \times 3$ ins., 12 ins. in the ground, for $\frac{1}{2}$ Sec. Cor., marked $\frac{1}{2}$ on W. face, dug pits $18 \times 18 \times 12$ ins., N. and S. of stone $5\frac{1}{2}$ ft. dist., and raised a mound of earth $1\frac{1}{2}$ ft. high, $3\frac{1}{2}$ ft. base alongside.

60.00

Top of Spur, bears $N. 45^{\circ} E.$ $S. 45^{\circ} W.$ and descend.

63.00

Cross low Sag and ascend.

70.00

Top of Spur, bears $N. 10^{\circ} W.$ $S. 10^{\circ} E.$ and descend.

80.00

Set a *Sand* stone $18 \times 12 \times 6$ ins. 12 ins. in the ground for Cor. to Secs. 17, 18, 19. 2 marked with 3 notches on S. and 5 notches on E. edges, dug pits $18 \times 18 \times 12$ ins. in each Sec., $5\frac{1}{2}$ ft. dist. and raised a mound of earth 2 ft. high, $4\frac{1}{2}$ ft. base. alongside.

*Land mountainous*Soil 2^{nd} rateTimber of *Juniper*.Vegetation. *grass*.

Township 15 N Range 24 E

Gila and Salt River Meridian.

Chains $N. 88^{\circ} 56'$ East, on a random line between Sections 17 and 20.Variation $13^{\circ} 45'$ East.

Ascend.

- 19.00 Through low range of hills bears $N. 70^{\circ} E. \text{ \& } S. 70^{\circ} W.$
- 40.00 Set temporary $\frac{1}{4}$ Sec. Cor.
- 68.50 Top of summit bears $N. E. \text{ \& } S. W.$ and descend
- 72.00 Enter Timber, $N. \text{ \& } S.$
- 76.00 Leave Timber, $N. \text{ \& } S.$
- 79.84 Intersect N. & S. line, 51 lks. $N.$ of cor. to secs.
16. 17. 20. 21 from which corner, I run
 $S. 89^{\circ} 15' W.$ on a true line between sections 17 & 20
Variation $13^{\circ} 45'$ East
- 399.2 Set a Sand stone $12 \times 12 \times 5$ ins., 8 ins.
in the ground, for $\frac{1}{4}$ Sec. Cor., marked $\frac{1}{4}$ on $N.$ face,
dug pits $18 \times 18 \times 12$ ins., $E.$ and $W.$ of stone $5\frac{1}{2}$
ft. dist., and raised a mound of earth $1\frac{1}{2}$ ft. high, $3\frac{1}{2}$
ft. base alongside.
- 79.84 The corner to sections 17, 18, 19, 20
- Land rolling.
- Soil 3rd rate
- Vegetation grass.

Township

15 N

Range

24 E

Gila and Salt River Meridian.

Chains) 88° 56' West, on a random line between Sections 18 and 19.

Variation 13° 45' East.

Descend.

29.50

Enter Flat bears

N.W. & S.E.

40.00

Set temporary $\frac{1}{4}$ Sec. Cor.

86.95

Intersect W. B. of Tp. 70 lks. N. of cor. to secs.

13. 18. 19. 24 E. 15 N. R. 24 E.

Which is a post - 4 ft. long, 4 ins. square with marked stone. 12 ins. in the ground, marked E. 15 N. S. 18 on N. E. R. 24 E. N. on S. E. R. 23 E. S. 24 on S. W. and S. 13 on W. W. faces with 3 notches on S. and 3 notches on N. edges; with pits 18 x 18 x 12 ins. in each Sec. $5\frac{1}{2}$ ft. dist. and a mound of earth 2 ft. high, $4\frac{1}{2}$ ft. base, ground post. from $\frac{1}{2}$ high corner, 1 run

N. 88° 26' E on a true line, between sections 18 & 19

Variation 13° 47' East.

45.95

Set a Flint stone 10 x 12 x 5 ins., 10 ins.

in the ground, for $\frac{1}{4}$ Sec. Cor., marked $\frac{1}{4}$ on N. face, dug pits 18 x 18 x 12 ins., E. and W. of stone $5\frac{1}{2}$ ft. dist., and raised a mound of earth $1\frac{1}{2}$ ft. high, $3\frac{1}{2}$ ft. base alongside.

85.95

The corner to sections 17. 18. 19. 20

Land level. rolling.

Soil 3rd rate

Vegetation grass.

Township

15 N

Range

24 E

Gila and Salt River Meridian.

Chains

North, between Sections 17 and 18.

Variation

13° 45'

East.

Descend.

12.00

Enter Flat bears E. & W.

40.00

Set a Sand stone $12 \times 12 \times 6$ ins., 8 ins. in the ground, for $\frac{1}{4}$ Sec. Cor., marked $\frac{1}{4}$ on W. face, dug pits $18 \times 18 \times 12$ ins., N and S. of stone $5\frac{1}{2}$ ft. dist., and raised a mound of earth $1\frac{1}{2}$ ft. high, $3\frac{1}{2}$ ft. base alongside.

80.00

Set a Sand stone $20 \times 10 \times 4$ ins. 10 ins. in the ground for Cor. to Secs. 7, 8, 17, 18 marked with $\frac{1}{4}$ notch on S. and $\frac{1}{4}$ notch on E. edges, dug pits $18 \times 18 \times 12$ ins. in each Sec., $5\frac{1}{2}$ ft. dist. and raised a mound of earth 2 ft. high, $4\frac{1}{2}$ ft. base. alongside.

Land level. and rolling.

Soil 1st & 2nd rate

Vegetation grass.

Township

15 N

Range

24 E

Gila and Salt River Meridian.

Chains 158²⁰ East, on a random line between Sections 8 and 17.

Variation 13° 45' East.

Over level land

40.00 Set temporary $\frac{1}{4}$ Sec. Cor.

80.21 Intersect N. & S. line, 19 lks. N. of cor. to secs.

8.9.46. 17 from which corner, I run

89° 4' W. on a true line between sections 8 & 17

Variation 13° 45' East

40.11 Set a Sand stone 15 x 8 x 8 ins., 10 ins. in the ground, for $\frac{1}{4}$ Sec. Cor., marked $\frac{1}{4}$ on N. face, dug pits 18 x 18 x 12 ins., E. and W. of stone 5 $\frac{1}{2}$ ft. dist., and raised a mound of earth 1 $\frac{1}{2}$ ft. high, 3 $\frac{1}{2}$ ft. base alongside.

80.21 The corner to sections 7. 8. 17. 18

Land level.

Soil 3rd rate

Vegetation Grass

Township 15 N. Range 21 E.

Gila and Salt River Meridian.

Chains $S. 88^{\circ} 30'$ West, on a random line between Sections 7 and 18.Variation $13^{\circ} 45'$ East.

Over level land

40.00 Set temporary $\frac{1}{4}$ Sec. Cor.85.61 Intersect W. B. of Twp. 77 N. of cor. to secs.7, 12, 13, 18 E. 15 N. R. 24 E.

Which is a mound of earth 2 ft. high, $4\frac{1}{2}$ ft. base, with pits $18 \times 18 \times 12$ ins. $5\frac{1}{2}$ ft. dist. in each sec. In S. E. pit was a stake 2 ins. square, 2 ft. long, 12 ins. in the ground, marked E. 15 N. S. 7 on N. E. R. 24 E. S. 18 on S. E. R. 23 E. S. 13 on S. W. and S. 12 on N. W. faces, with 4 notches on S. and 2 notches on W. edge from W. edge corner, I run

$N. 88^{\circ} 25'$ E on a true line, between sections 7 & 18
Variation $13^{\circ} 47'$ East.

45.61 Set a Sand stone $14 \times 11 \times 8$ ins., 10 ins. in the ground, for $\frac{1}{4}$ Sec. Cor., marked $\frac{1}{4}$ on N. face, dug pits $18 \times 18 \times 12$ ins., E. and W. of stone $5\frac{1}{2}$ ft. dist., and raised a mound of earth $1\frac{1}{2}$ ft. high, $3\frac{1}{2}$ ft. base alongside.

85.61 The corner to sections 7, 8, 17, 18

Land level.

Soil 1^{st} & 2^{nd} rateVegetation grass.

Township

13 N.

Range

24 E.

Gila and Salt River Meridian.

Chains

North, between Sections 7 and 8.

Variation

13° 45'

East.

Over level land

40.00

Set a *Sand* stone 10 x 10 x 8 ins., 6 ins. in the ground, for $\frac{1}{4}$ Sec. Cor., marked $\frac{1}{4}$ on *W.* face, dug pits 18 x 18 x 12 ins., *N.* and *S.* of stone $5\frac{1}{2}$ ft. dist., and raised a mound of earth $1\frac{1}{2}$ ft. high, $3\frac{1}{2}$ ft. base alongside.

80.00

Set a *Sand* stone 10 x 8 x 6 ins. 6 ins. in the ground for Cor. to Secs. 5, 6, 7, 8. marked with 5 notches on *S.* and 5 notches on *E.* edges, dug pits 18 x 18 x 12 ins. in each Sec., $5\frac{1}{2}$ ft. dist. and raised a mound of earth 2 ft. high, $4\frac{1}{2}$ ft. base. alongside.

*Land level.**Soil 2nd rate**Vegetation grass.*

Township

10 N

Range

21 E

Gila and Salt River Meridian.

Chains $N. 88^{\circ} 30'$ East, on a random line between Sections 5 and 8.Variation $13^{\circ} 45'$ East.*Over rolling land.*40.00 Set temporary $\frac{1}{4}$ Sec. Cor.

80.14 Intersect N. & S. line, 21 lks. S. of cor. to secs.

4. 5. 8. 9 from which corner, I run

 $S. 88^{\circ} 47'$ W. on a true line between sections 5 & 8Variation $13^{\circ} 45'$ East

40.07 Set a Sand stone $17 \times 14 \times 3$ ins., 12 ins. in the ground, for $\frac{1}{4}$ Sec. Cor., marked $\frac{1}{4}$ on N. face, dug pits $18 \times 18 \times 12$ ins., E. and W. of stone $5\frac{1}{2}$ ft. dist., and raised a mound of earth $1\frac{1}{2}$ ft. high, $3\frac{1}{2}$ ft. base alongside.

80.14 The corner to sections 5. 6. 7. 8

Land rolling.

Soil 2° & 3° rate

Vegetation Grass.

I carefully examined the adjustments of my solar compass to-day, particularly the latitude and reversing apparatus, and found them correct.

Feb. 13. 1883

Township 15 N Range 24 E

Gila and Salt River Meridian.

Chains 85° 50' West, on a random line between Sections 6 and 7.

Variation 13° 45' East.

Over rolling land.

16.00 Cross Wash, 125- lks. wide, Course S. W. and ascend.

40.00 Set temporary 1/4 Sec. Cor.

41.00 Top of Ridge, bears N. 70° E. S. 70° W. and descend.

85.11 Intersect W. B. of Tp. 90 lks. N. of cor. to secs.

1. 6. 7. 12 C. 15 N. R. 24 E.

Which is a mound of earth 2 ft. high, 4 1/2 ft. base, with pits 18 x 18 x 12 ins. 5 1/2 ft. dist. in each Sec. In S. E. pit was a stake 2 ins. square, 2 ft. long, 12 ins. in the ground, marked C. 15 N. S. 6 on N. E. R. 24 E. S. 7 on S. E. R. 23 E. S. 12 on S. W. and S. 1 on N. W. faces, with 5 notches on S. and 1 notch on N. edges. from which corner, I run

N. 85° 17' E on a true line, between sections 6 & 7

Variation 13° 44' East.

415.11 Set a Sand stone 10 x 8 x 6 ins., 6 ins.

in the ground, for 1/4 Sec. Cor., marked 1/4 on N. face, dug pits 18 x 18 x 12 ins., E. and W. of stone 5 1/2 ft. dist., and raised a mound of earth 1 1/2 ft. high, 3 1/2 ft. base. alongside.

86.11 The corner to sections 5, 6, 7, 8

Land mountainous.

Soil 2nd & 3rd rate

Vegetation grass.

Township 15 N

Range 21 E

Gila and Salt River Meridian.

Chains

North, on a random line between Sections 5 and 6.

Variation 13° 45' East.

Over rolling land.

8.00 Cross Wash, 125 lks. wide, Course S. W. and ascend.

38.00 Top of Ridge, bears N. 45° W. & S. 45° E and descend.

40.00 Set temporary 1/4 Sec. Cor.

79.50 Intersect N. B. of Tp. 29 lks. W. of cor. to secs.

S. 6. 31. 32 E. 15 N. R. 24 E.

Which is a sand stone 15 x 14 x 9 ins.
 set 10 ins. in the ground marked
 with 5 notches on E. and 1
 notch on W. edges, with pits 18 x 18 x 12 ins.
 in each Sec. 5 1/2 ft. dist. and earth
 mound 2 ft. high, 4 1/2 ft. base
 alongside.

from which corner, I run

S. 12° W. on a true line, between sections 5 & 6

Variation 13° 45' East.

39.50 Set a sand stone 12 x 8 x 4 ins., 8 ins.
 in the ground, for 1/4 Sec. Cor., marked 1/4 on W. face,
 dug pits 18 x 18 x 12 ins., N. and S. of stone 5 1/2
 ft. dist., and raised a mound of earth 1 1/2 ft. high, 3 1/2
 ft. base alongside.

79.50 The corner to sections 5. 6. 7. 8

Land mountainous.

Soil 1st & 2nd rate

Vegetation grass.

Feb. 14. 1883

GENERAL DESCRIPTION.

The sand in this Township is generally rolling, covered with a light growth of timber juniper.

Nutritious grasses cover the ground in abundance, making it a fine grazing country.

Most of the Township consists of 2nd rate soil. It is a sandy loam

U. S. Surveyor General's Office,

Tucson, Arizona, July 31, 1883

The foregoing Field Notes of the Survey of the

6th Meridian Lines of
Township 15 North,
Range 24 East

Of the Gila and Salt River Base and Meridian, Arizona, execu-
ted by W. A. Coe,

Deputy Surveyor, under his contract of the 25th

day of July, 1882, having been

critically examined and the necessary corrections and explana-
tions made, the said Field Notes and the surveys they describe
are hereby approved

J. W. Robinson
Surveyor General.

U. S. Surveyor-General's Office.

..... 188'

The foregoing Field Notes of the surveys of

..... *Meridian*

in..... *executed by*

.....
U. S. Deputy Surveyor, under his contract dated

.....
having been critically examined, the necessary corrections and explanations made, the said Field Notes and the surveys they describe are hereby approved.

.....
U. S. Surveyor-General for