

Book No. 78

*Copy  
made  
from  
this*

A. P. Johnson Deputy Surveyor.

T. 21 North R. 20 East

Meridian.

No-399

FIELD NOTES

BOOK 399

OF

THE SUBDIVISION LINES OF

Township 21 North Range 20 East

Meridian.

399

BY

A. P. Johnson Deputy Surveyor.

Under his Contract of Aug 5. 1882

Survey Commenced Mar. 26. 1883

Survey Completed Mar. 28. 1883

No-399

Platted,  
Copied for Washington,  
Copied for Register,

Edward Denny & Co., Stationers & Printers, S. F. Cal.

Copyright Secured,

Entered according to Act of Congress, in the Clerk's Office of the Librarian of Congress at Washington, D. C., in the year 1880.

Township No. 41 N Range No. 20 East 1st 1st Meridian.

BOOK 399

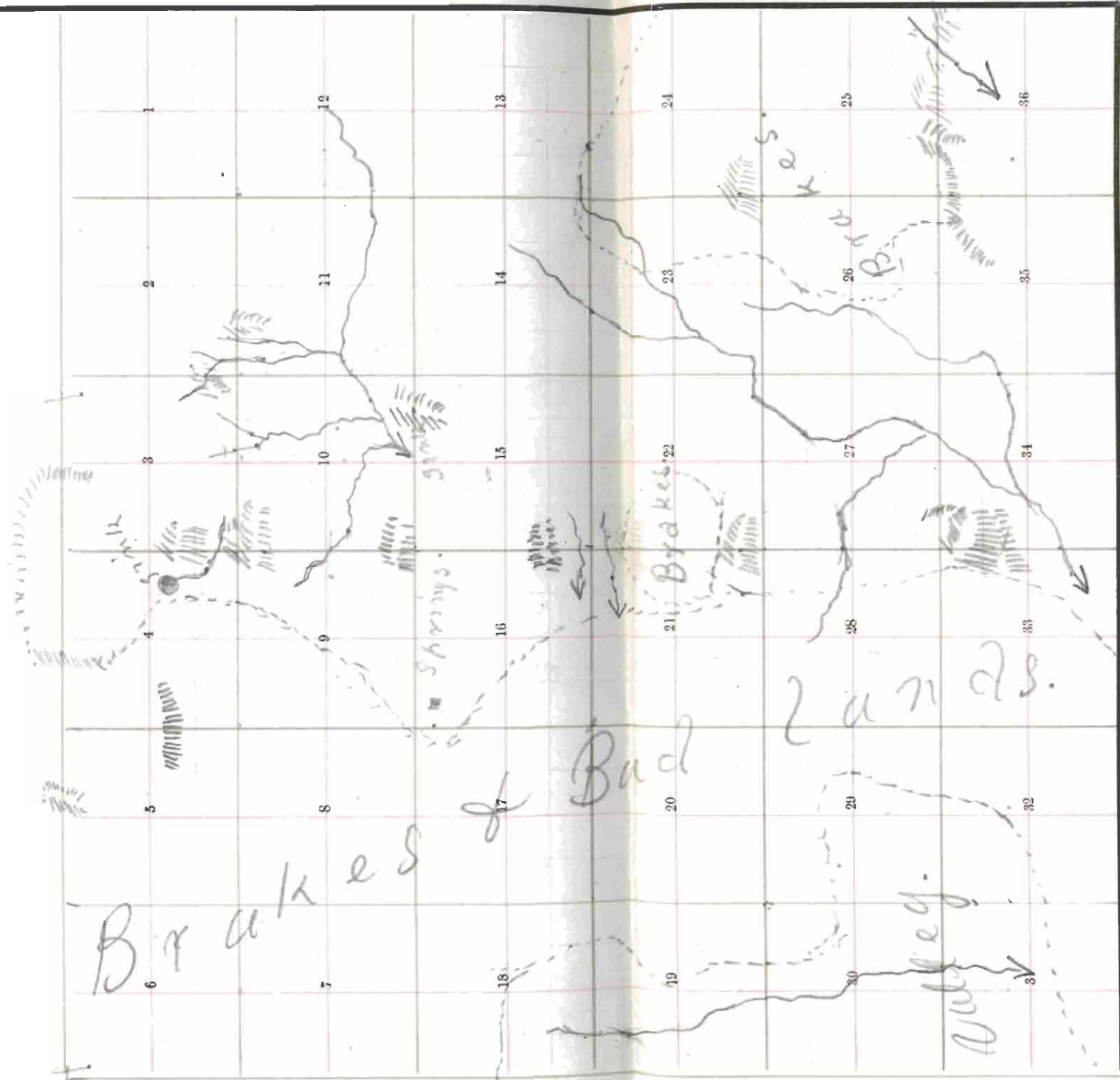

BOOK 399

TOWNSHIP PLOT

Meridian Line,

Base Line,

Standard Line,

Township Lines,

Section Lines,

Meander Lines,

Office Work.

1

*A. P. Johnson* Deputy Surveyor.  
T. *21 North* R. *20 East*  
Meridian.

*No-399*  
**FIELD NOTES**  
BOOK 399

OF  
THE SUBDIVISION LINES OF  
Township *21 North* Range *20 East*  
Meridian.

BY

*A. P. Johnson* Deputy Surveyor.  
Under his Contract of *Aug. 15* 188*2*  
Survey Commenced *Mar. 20* 188*3*  
Survey Completed *Mar. 28* 188*3*

---

*Platted,  
Copied for Washington,  
Copied for Register,*

Edward Denny & Co., Stationers & Printers, S. F. Cal.

*Copyright Secured,*

Entered according to Act of Congress, in the Clerk's Office of the Librarian of Congress  
at Washington, D. C., in the year 1880.

1A

BOOK 399

Township 21 North, Range 20 East,  
Sils and Salt River Baseline Meridian.

6	60	5	44	4	33	3	22	2	11	1
59		58		43		32		21		10
7	57	8	42	9	31	10	20	11	9	19
56		55		41		30		19		8
18	54	17	40	16	29	15	18	14	7	13
53		52		39		28		17		6
19	51	20	38	21	27	22	16	23	5	24
50		49		37		26		15		4
30	48	29	36	28	25	27	14	26	3	25
47		46		35		24		13		2
31	45	32	34	33	23	34	12	35	1	36

Edward Denny & Co., Stationers & Printers, S. F., Cal.

Copyright Secured,

Entered according to Act of Congress, in the Clerk's Office of the Librarian of Congress at Washington, D. C., in the year 1880.

Township.....Range.....

Meridian.

Township

Range

Meridian.

For Preliminary Data and  
description of instrument  
see Book No. 1.

Survey made with Burt's Patent Improved Solar  
Compass, nearly new, and in first rate order. Made  
by Otto Femmel of Cassel  
Germany in 1884

Township

21

Range

20

See previous page.)

Gila and Salt River Meridian.

Chains

Standard  
From the corner to Sections 35, 36, on the South boundary,

of Township  
which is a post, 4 ft. long, <sup>with marked stone</sup> 4 in. square, 12 in. in the ground marked S. C. T. 21 N. R. 20 E. on N. S. 30 on E. and S. 35 on W. faces, with 1 notch on E. and 5 notches on W. faces, with pits 15 x 15 x 12 ins. N. E. + W. of post, 5 1/2 ft. dist. and a mound of earth 2 ft. high 4 1/2 ft. base around post. I run North between sections 35 + 36

Variation 14° 18' East.

Over rolling land.

40.00 Set a sand stone 15 x 14 x 10 ins., 10 ins. in the ground, for 1/4 Sec. Cor., marked 1/4 on W. face, dug pits 18 x 18 x 12 ins., N. and S. of stone 5 1/2 ft. dist., and raised a mound of earth 1 1/2 ft. high, 3 1/2 ft. base alongside.

Leave Valley, bears E. + W.

78.00  
80.00 Set a sand stone 16 x 12 x 8 ins., 10 ins. in the ground for Cor. to Secs. 25, 26, 35 + 36 marked with / notch on S. and / notch on E. edges and raised a mound of stone alongside. Pits impracticable.

Land rolling.

Soil Ind. + Grate

Vegetation bunchgrass + sagebrush

Township 21 N. Range 20 E<sup>2</sup>

## Gila and Salt River Meridian.

Chains East, on a random line between Sections 25 and 36.  
Variation  $14^{\circ}57'$  East.

Ascend.

21.00 Top of Ridge, bears N. &amp; S. and descend.

40.00 Set temporary  $\frac{1}{4}$  Sec. Cor.

65.00 Cross Wash, 210 lks wide, Course S. 40° W and ascend.

79.91 Intersect C. B. of Tp. 11 lks South of cor. to secs.

previously set by me.  
25, 30, 31 & 36 from which corner, I run

S.  $59^{\circ}55'$  on a true line, between sections 25 & 36Variation  $14^{\circ}30'$  East.

89.96 Set a sand stone 16 x 14 x 16 ins.. 10

ins. in the ground, for  $\frac{1}{4}$  Sec. Cor., marked  $\frac{1}{4}$  on N.  
face and raised a mound of stone. alongside.

Pits impracticable.

79.91 The corner to sections 25, 26, 35 &amp; 36

Land mountainous.

Soil. Ind. &amp; S. &amp; S. &amp; S.

Vegetation bunchgrass &amp; sagebrush



Township 31 N. Range 20 8

Gila and Salt River Meridian.

Chains North, between Sections 25 and 26.

Variation 14° 57' East.*Ascend.*

40.00 Set a sand stone  $16 \times 12 \times 12$  ins. 10 ins. in the ground, for  $\frac{1}{4}$  Sec. Cor., marked  $\frac{1}{4}$  on W face and raised a mound of stone alongside. Pits impracticable.

80.00 Set a sand stone  $16 \times 12 \times 6$  ins. 10 ins. in the ground for Cor. to Secs. 23, 24, 25 & 26 marked with  $\angle$  notches on S. and 1 notch on E. edges and raised a mound of stone alongside. Pits impracticable.

*Land rolling.**Soil 2nd & 3rd rate**Vegetation bunchgrass & sagebush*

Township

21

N. Range

20

E. 4

Gila and Salt River Meridian.

Chains

East, on a random line between Sections 24 and 25.

Variation  $14^{\circ} 51'$  East.

Ascend.

40.00 Set temporary  $\frac{1}{4}$  Sec. Cor.87.22 Intersect *C. B.* of Tp. 11 *1/2* N. of cor. to secs.  
*previously set by me.*  
1924.25 & 30 from which corner, I runN 89 $^{\circ}$  36' W on a true line, between sections 24 & 25Variation  $14^{\circ} 30'$  East.44.11 Set a sand stone 15 x 12 x 8 ins.. 10  
ins. in the ground, for  $\frac{1}{4}$  Sec. Cor., marked  $\frac{1}{4}$  on *N.*  
face and raised a mound of stone. alongside.

Pits impracticable.

87.22 The corner to sections 23, 24, 25 &amp; 26

Land rolling.

Soil 2nd. &amp; 3rd. rate

Vegetation bunchgrass &amp; sagebrush

Township

21

Range

20

E

Gila and Salt River Meridian.

Chains

North, between Sections 23 and 24.

Variation 14° 57'

East.

*Ascend.*

10.00

Top of Ridge, bears E. &amp; W. and descend.

40.00

Set a sand stone 15 x 14 x 9 ins. 10 ins. to the ground, for  $\frac{1}{4}$  Sec. Cor., marked  $\frac{1}{4}$  on W. face and raised a mound of stone. alongside.*Pits impracticable.*

80.00

Set a sand stone 18 x 10 x 9 ins. 12 ins. in the ground for Cor. to Secs. 13, 14, 23 &amp; 24 marked with 3 notches on S. and 1 notch on E. edges and raised a mound of stone. alongside. Pits impracticable.

*Land mountainous.**Soil 2nd. & 3rd. rate**Vegetation bunchgrass & sagebrush*

Township

21

Range

20

6

Gila and Salt River Meridian.

Chains

East, on a random line between Sections 13 and 24.

Variation  $14^{\circ} 57'$  East.25.00 *Leaves brakes*40.00 *Set temporary  $\frac{1}{4}$  Sec. Cor.*50.39 *Intersect C. B. of Tp. 68 1/2 N. of cor. to secs.  
previously set by me.  
N. 18. 19 & 24, from which corner, I run**N 89° 44' W on a true line, between sections 13 & 24*Variation  $14^{\circ} 30'$  East.40.20 *Set a sand stone 16 x 10 x 8 ins. 10  
ins. in the ground, for  $\frac{1}{4}$  Sec. Cor., marked  $\frac{1}{4}$  on N  
face and raised a mound of stone. alongside.**Pits impracticable.*50.39 *The corner to sections N. 14. 23 & 24**Land rolling.**Soil Ind. & Indrate**Vegetation bunchgrass & sagebrush*

Township 21 N Range 20 S

Gila and Salt River Meridian.

Chains North, between Sections 13 and 14.

Variation 14° 51' East.

Descend.

- 44.50 Cross Wash, 245 lks. wide, Course West and ascend.
- 40.00 Set a sand stone 10 x 12 x 8 ins., 10 ins. in the ground, for  $\frac{1}{4}$  Sec. Cor., marked  $\frac{1}{4}$  on W. face, dug pits 18 x 18 x 12 ins., N. and S. of stone  $5\frac{1}{2}$  ft. dist., and raised a mound of earth  $1\frac{1}{2}$  ft. high,  $3\frac{1}{2}$  ft. base. alongside.
- 80.00 Set a sand stone 18 x 12 x 6 ins. 12 ins. in the ground for Cor. to Secs. 11, 12, 13 & 14 marked with 4 notches on S. and 1 notch on E. edges, dug pits 18 x 18 x 12 ins. in each Sec.,  $5\frac{1}{2}$  ft. dist. and raised a mound of earth 2 ft. high,  $4\frac{1}{2}$  ft. base. alongside.

Land rolling.

Soil 2nd & 3rd. rate

Vegetation bunchgrass & sagebrush

Township 21 N. Range 20 E. <sup>8</sup>

Gila and Salt River Meridian.

Chains East, on a random line between Sections 12 and 13.  
Variation  $14^{\circ} 57'$  East.

Over rolling land.

40.00 Set temporary  $\frac{1}{4}$  Sec. Cor.

79.88 Intersect  $\frac{1}{2}$  B. of Tp. 12 1/2 mls. North of cor. to secs.  
previously set by me.  
7, 12, 13 & 18 from which corner, I run

$148^{\circ} 55'$  Run a true line, between sections 12 & 13  
Variation  $14^{\circ} 30'$  East.

39.94 Set a sand stone  $14 \times 11 \times 9$  ins., 10 ins.  
in the ground, for  $\frac{1}{4}$  Sec. Cor., marked  $\frac{1}{4}$  on N. face,  
dug pits  $18 \times 18 \times 12$  ins., E. and W. of stone  $5\frac{1}{2}$   
ft. dist., and raised a mound of earth  $1\frac{1}{2}$  ft. high,  $3\frac{1}{2}$   
ft. base alongside.

79.88 The corner to sections 11, 12, 13 &amp; 14

Land rolling.

Soil 2nd &amp; 3rd rate

Vegetation bunchgrass &amp; sagebrush

Township

21

N. Range

20

6

Gila and Salt River Meridian.

Chains

North, between Sections 11 and 12.

Variation 14° 57'

East.

*Over rolling land.*

- 19.50 Cross Wash, 220 lks. wide, Course West and ascend.
- 40.00 Set a sand stone 18 x 10 x 7 ins., 12 ins. in the ground, for  $\frac{1}{4}$  Sec. Cor., marked  $\frac{1}{4}$  on W. face, dug pits 18 x 18 x 12 ins., N. and S. of stone  $5\frac{1}{2}$  ft. dist., and raised a mound of earth  $1\frac{1}{2}$  ft. high,  $3\frac{1}{2}$  ft. base. alongside.
- 80.00 Set a sand stone 16 x 12 x 9 ins. 10 ins. in the ground for Cor. to Secs. 1, 2, 11 & 12 marked with J notches on S. and 1 notch on E. edges, dug pits 18 x 18 x 12 ins. in each Sec.,  $5\frac{1}{2}$  ft. dist. and raised a mound of earth 2 ft. high,  $4\frac{1}{2}$  ft. base. alongside.

*Land rolling.**Soil ind. & ind. rate**Vegetation bunchgrass & sagebrush*

Township

21

Range

20

E

Gila and Salt River Meridian.

Chains

East, on a random line between Sections 1 and 12.

Variation

14° 57'

East.

Over level land

40.00 Set temporary  $\frac{1}{4}$  Sec. Cor.79.94 Intersect  $\frac{1}{4}$  B. of Tp. 21 1/2 m. North of cor. to secs.  
previously set by me.  
S. 6. 7 & 12 from which corner, I run

N 89° 57' W on a true line, between sections 1 &amp; 12

Variation

14° 30'

East.

39.97 Set a sand stone 14 x 10 x 10 ins. 10  
ins. in the ground, for  $\frac{1}{4}$  Sec. Cor., marked  $\frac{1}{4}$  on N.  
face and raised a mound of stone. alongside.

Pits impracticable.

79.94 The corner to sections 1, 2, 11 &amp; 12

Land level.

Soil 2nd. &amp; 3rd. rate

Vegetation bunchgrass &amp; sagebrush



Township

21

N. Range

20

E.

Gila and Salt River Meridian.

Chains

North, on a random line between Sections 1 and 2.

Variation

14° 51'

East.

*Over rolling land.*40.00 Set temporary  $\frac{1}{4}$  Sec. Cor.8007 Intersect N. B. of Tp. 29 *1/2* wks. East of cor. to secs.  
previously set by me.  
1.2.35 & 36 from which corner, I run

S. S. E. on a true line, between sections 1 &amp; 2

Variation

14° 51'

East.

440.07 Set a sand stone 18 x 12 x 6 ins., 12 ins.  
in the ground, for  $\frac{1}{4}$  Sec. Cor.; marked  $\frac{1}{4}$  on W face,  
dug pits 18 x 18 x 12 ins., N and S. of stone 5  $\frac{1}{2}$   
ft. dist., and raised a mound of earth 1  $\frac{1}{2}$  ft. high, 3  $\frac{1}{2}$   
ft. base, alongside.

80.07 The corner to sections 1.2.11 &amp; 12

*Land rolling.**Soil 2nd & 3rd. rate**Vegetation bunchgrass & sagebrush**I carefully examined the adjustments of my solar  
compass to-day, particularly the latitude and revers-  
ing apparatus, and found them correct.**A. P. Johnson**Mar. 26. 1883*

Township

21

N Range

20

S

Gila and Salt River Meridian.

Chains

Standard  
From the corner to sections, 34 & 35 on S. By of Sp  
which is a post 4 ft. long, 4 in. square, 12 ins. in the ground marked  
S. C. T. 21 N. R. 20 E. on N. 4. 35 on E and  
4. 34 on W. faces, with 2 notches on E  
and 4 notches on W. faces, with pits  
15 x 15 x 12 ins. N. E. and W. of post, 5 1/2  
ft. dist. and a mound of earth, 2 ft  
high, 4 1/2 ft. base around post Turn  
North between sections 34 & 35

Variation 14° 18' East.

Over rolling land. and descend

40.00 Set a sand stone 14 x 12 x 8 ins., 10 ins.  
in the ground, for 1/2 Sec. Cor., marked 1/2 on W. face,  
dug pits 18 x 18 x 12 ins., N. and S. of stone 5 1/2  
ft. dist., and raised a mound of earth 1 1/2 ft. high, 3 1/2  
ft. base.

57.00 Cross Wash, 180 yds. wide, Course S. 10° W. and ascend.

80.00 Set a sand stone 14 x 12 x 8 ins., 10 ins.  
in the ground for Cor. to Secs. 26. 27. 34 & marked  
with 1 notch on S. and 2 notches on E. edges,  
dug pits 18 x 18 x 12 ins. in each Sec., 5 1/2 ft. dist. and  
raised a mound of earth 2 ft. high, 4 1/2 ft. base. alongside.

Land rolling.

Soil 2nd &amp; 3rd rate

Vegetation bunchgrass &amp; sagebrush

Township

21

N Range

20

E

Gila and Salt River Meridian.

Chains

East, on a random line between Sections 26 and 35.

Variation

14° 51'

East.

*Ascend.*2.80 Cross Wash, 225 lks. wide, Course *S 1/2 W* and ascend.40.00 Set temporary  $\frac{1}{2}$  Sec. Cor.50.11 Intersect N. & S. line, *N* lks North of cor. to secs.*25, 26, 30 & 36* from which corner, I run*N 89° 34' W.* on a true line between sections 26 & 30

Variation

14° 51'

East

40.00 Set a sand stone  $10 \times 14 \times 9$  ins.,  $10$  ins. in the ground, for  $\frac{1}{2}$  Sec. Cor., marked  $\frac{1}{2}$  on *N* face, dug pits  $18 \times 18 \times 12$  ins., *E* and *W*. of stone  $5\frac{1}{2}$  ft. dist., and raised a mound of earth  $1\frac{1}{2}$  ft. high,  $3\frac{1}{2}$  ft. base alongside.

58.11 The corner to sections *26, 27, 34 & 35*

Land rolling.

Soil *Loam & Silt*Vegetation *bunchgrass & sagebrush*

Township 21 N Range 20 E

Gila and Salt River Meridian.

Chains North, between Sections 26 and 27.

Variation  $14^{\circ} 51'$  East.

*Ascend.*

40.00

Set a sand stone  $15 \times 12 \times 8$  ins., 10 ins. in the ground, for  $\frac{1}{4}$  Sec. Cor., marked  $\frac{1}{4}$  on W. face, dug pits  $18 \times 18 \times 12$  ins., N. and S. of stone  $5\frac{1}{2}$  ft. dist., and raised a mound of earth  $1\frac{1}{2}$  ft. high,  $3\frac{1}{2}$  ft. base. alongside.

80.00

Set a sand stone  $15 \times 12 \times 9$  ins. 10 ins. in the ground for Cor. to Secs. 22, 23, 26 & 27 marked with 2 notches on S. and 2 notches on E. edges, dug pits  $18 \times 18 \times 12$  ins. in each Sec.,  $5\frac{1}{2}$  ft. dist. and raised a mound of earth 2 ft. high,  $4\frac{1}{2}$  ft. base. alongside.

*Land rolling.*

*Soil 2nd. & 3rd. rate*

*Vegetation bunchgrass & sagebrush*

Township

21

Range

20

E

Gila and Salt River Meridian.

Chains

East, on a random line between Sections 23 and 26.

Variation

14° 57'

East.

Descend.

34.50 Cross Wash, 10 lks. wide, Course South and ascend.

40.00 Set temporary  $\frac{1}{4}$  Sec. Cor.

80.16 Intersect N. &amp; S. line, 30 lks. North of cor. to secs.

23, 24, 25 &amp; 26 from which corner, I run

N. 89° 47' W. on a true line between sections 23 &amp; 26

Variation

14° 57'

East

40.08 Set a sand stone  $N \times 12 \times 8$  ins., 10 ins. in the ground, for  $\frac{1}{4}$  Sec. Cor., marked  $\frac{1}{4}$  on N. face, dug pits  $18 \times 18 \times 12$  ins., E and W. of stone  $5\frac{1}{2}$  ft. dist., and raised a mound of earth  $1\frac{1}{2}$  ft. high,  $3\frac{1}{2}$  ft. base, alongside.

80.16 The corner to sections 22, 23, 26 &amp; 27

Land rolling.

Soil 2nd &amp; 3rd rate

Vegetation bunchgrass &amp; sagebrush

Township

21

Range

20

E

Gila and Salt River Meridian.

Chains

North, between Sections 22 and 23.

Variation

14° 51'

East.

Ascend.

- 1.00 Cross Wash, 50 lks. wide, Course S 60° W and ascend.
- 40.00 Set a sand stone 16 x 8 x 8 ins., 10 ins. in the ground, for  $\frac{1}{2}$  Sec. Cor., marked  $\frac{1}{2}$  on W. face, dug pits 18 x 18 x 12 ins., N. and S. of stone 5 $\frac{1}{2}$  ft. dist., and raised a mound of earth 1 $\frac{1}{2}$  ft. high, 3 $\frac{1}{2}$  ft. base. alongside.
- 80.00 Set a sand stone 16 x 14 x 9 ins. 10 ins. in the ground for Cor. to Secs. 14, 15, 22 & 23 marked with 1 notches on S. and 2 notches on E. edges, dug pits 18 x 18 x 12 ins. in each Sec., 5 $\frac{1}{2}$  ft. dist. and raised a mound of earth 2 ft. high, 4 $\frac{1}{2}$  ft. base. alongside.
- 2 Land rolling.
- Soil 2nd. & 3rd. rate
- Vegetation bunchgrass & sagebrush

Township

21

N. Range

20

E

Gila and Salt River Meridian.

Chains

East, on a random line between Sections 14 and 23.

Variation

14° 51'

East.

Descend.

26.00 Cross Wash, 400 lks. wide, Course S. W.

40.00 Set temporary  $\frac{1}{4}$  Sec. Cor.

77.00 Cross Wash, 170 lks. wide, Course S 10° W and ascend.

79.81 Intersect N. &amp; S. line, 9 lks South of cor. to secs.

N. 14, 23 &amp; 24 from which corner, I run

S. 89° 56' W. on a true line between sections 14 &amp; 23

Variation

14° 51'

East

39.91 Set a sand stone 16 x 12 x 8 ins., 10 ins. in the ground, for  $\frac{1}{4}$  Sec. Cor., marked  $\frac{1}{4}$  on N. face, dug pits 18 x 18 x 12 ins., E. and W. of stone 5  $\frac{1}{2}$  ft. dist., and raised a mound of earth 1  $\frac{1}{2}$  ft. high, 3  $\frac{1}{2}$  ft. base, alongside.

79.81 The corner to sections 14, 15, 22 &amp; 23

Land rolling.

Soil 2nd &amp; 3rd rate

Vegetation bunchgrass &amp; sagebrush

Township

21

N. Range

20

E<sup>18</sup>

## Gila and Salt River Meridian.

Chains

North, between Sections 14 and 15.

Variation  $14^{\circ}51'$  East.

Descend.

40.00 Set a sand stone  $16 \times 14 \times 8$  ins., 10 ins. in the ground, for  $\frac{1}{4}$  Sec. Cor., marked  $\frac{1}{4}$  on W. face, dug pits  $18 \times 18 \times 12$  ins., N. and S. of stone  $5\frac{1}{2}$  ft. dist., and raised a mound of earth  $1\frac{1}{2}$  ft. high,  $3\frac{1}{2}$  ft. base. alongside.

80.00 Set a sand stone  $16 \times 14 \times 8$  ins. 10 ins. in the ground for Cor. to Secs. 10, 11, 14 & 15 marked with 4 notches on S. and 2 notches on E. edges, dug pits  $18 \times 18 \times 12$  ins. in each Sec.,  $5\frac{1}{2}$  ft. dist. and raised a mound of earth 2 ft. high,  $4\frac{1}{2}$  ft. base. alongside.

Land rolling.

Soil Ind. &amp; Profile

Vegetation bunchgrass &amp; sagebrush



19 Township 21 N. Range 20 E

Gila and Salt River Meridian.

Chains East, on a random line between Sections 11 and 14.  
Variation  $14^{\circ}57'$  East.

Over rolling land.

40.00 Set temporary  $\frac{1}{4}$  Sec. Cor.

80.08 Intersect N. & S. line, SW  $\frac{1}{4}$  Sec. South of cor. to secs. 11, 12, 13 & 14 from which corner, I run

S  $89^{\circ}50'$  W. on a true line between sections 11 & 14  
Variation  $14^{\circ}57'$  East

40.04 Set a sand stone  $14 \times 12 \times 10$  ins.  $10$  ins. in the ground, for  $\frac{1}{4}$  Sec. Cor., marked  $\frac{1}{4}$  on N. face and raised a mound of stone. alongside.

Pits impracticable.

80.08 The corner to sections 10, 11, 14 & 15 -

Land rolling.

Soil 2nd. & 3rd. rate

Vegetation bunchgrass & sagebrush

Township

21

N. Range

20

E. 20

Gila and Salt River Meridian.

Chains

North, between Sections 10 and 11.

Variation

14° 57'

East.

Descend.

35.00 Cross Wash, 40 lks. wide, Course S 30° W and ascend.

40.00 Set a sand stone 6 x 10 x 8 ins., 10 ins. in the ground, for  $\frac{1}{4}$  Sec. Cor., marked  $\frac{1}{4}$  on W. face, dug pits 18 x 18 x 12 ins., N and S. of stone  $5\frac{1}{2}$  ft. dist., and raised a mound of earth  $1\frac{1}{2}$  ft. high,  $3\frac{1}{2}$  ft. base. alongside.

80.00 Set a sand stone 18 x 12 x 6 ins. 12 ins. in the ground for Cor. to Secs. 23, 10 & 11 marked with J notches on S. and L notches on E. edges, dug pits 18 x 18 x 12 ins. in each Sec.,  $5\frac{1}{2}$  ft. dist. and raised a mound of earth 2 ft. high,  $4\frac{1}{2}$  ft. base. alongside.

Land rolling.

Soil 2nd. &amp; 3rd. rate

Vegetation bunchgrass &amp; sagebrush

Township

21

N. Range

20

E

Gila and Salt River Meridian.

Chains

East, on a random line between Sections 2 and 11.

Variation  $14^{\circ}57'$  East.*Descend.*

- 1.20 Cross Wash, 20 fms. wide, Course South  
 15.00 Cross Wash, 250 fms. wide, Course South and ascend.  
 20.00 Top of Hill bears N.  $\vee$  S and descend.

40.00 Set temporary  $\frac{1}{4}$  Sec. Cor.

79.72 Intersect N. &amp; S. line, 12 fms. South of cor. to secs.

1.2.11  $\vee$  12 from which corner, I run $S. 89^{\circ}57' W.$  on a true line between sections 2  $\vee$  11Variation  $14^{\circ}57'$  East

- 39.86 Set a sand stone  $15 \times 12 \times 9$  ins., 10 ins.  
 in the ground, for  $\frac{1}{4}$  Sec. Cor., marked  $\frac{1}{4}$  on N. face,  
 dug pits  $18 \times 18 \times 12$  ins., E and W. of stone  $5\frac{1}{2}$   
 ft. dist., and raised a mound of earth  $1\frac{1}{2}$  ft. high,  $3\frac{1}{2}$   
 ft. base. alongside.

79.72 The corner to sections 2, 3, 10  $\vee$  11

Land hilly.

Soil 2nd.  $\vee$  3rd rateVegetation bunchgrass  $\vee$  sagebrush

Township

21

Range

20

Gila and Salt River Meridian.

Chains

North, on a random line between Sections 2 and 3.

Variation

14° 51'

East.

*Descend.*15.00 Cross Wash, 30 lks. wide, Course *S. E.* and ascend.40.00 Set temporary  $\frac{1}{4}$  Sec. Cor.79.98 Intersect *N. B.* of Tp. 12 lks. *East* of cor. to sec. previously set by me.2.3.34 *from which corner, I run**S. E.* on a true line, between sections 2 & 3

Variation

14° 51'

East.

39.98 Set a sand stone 16 x 12 x 6 ins., 10 ins. in the ground, for  $\frac{1}{4}$  Sec. Cor., marked  $\frac{1}{4}$  on *W.* face, dug pits 18 x 18 x 12 ins., *N.* and *S.* of stone  $5\frac{1}{2}$  ft. dist., and raised a mound of earth  $1\frac{1}{2}$  ft. high,  $3\frac{1}{2}$  ft. base alongside.

79.98 The corner to sections 2, 3, 10 &amp; 11

*Land rolling.**Soil 2nd. & 3rd. grade**Vegetation bunchgrass & sagebrush*

I carefully examined the adjustments of my solar compass to-day, particularly the latitude and reversing apparatus, and found them correct.

*G. M. Carson**Compassman**Mar. 26, 1883*

Township 21 N. Range 20 O

Gila and Salt River Meridian.

Standard  
 Chains From the corner to sections, 33 & 34 on S. By of Sp-  
 which is a post, 4 ft. long 4 in. square  
 12 in. in the ground, marked S. C  
 T. 21 N. R. 20 O. S. 34 on E. and S. 33 on W.  
 face with 3 notches on E. and 3 notches  
 on W. face, with pits 15 x 15 x 12 in.  
 N. E. and W. of post  $5\frac{1}{2}$  ft. dist. and  
 a mound of earth 2 ft. high,  $4\frac{1}{2}$  ft.  
 base around post & run

North between sections 33 &amp; 34

Variation  $14^{\circ}18'$  East.

Over rolling land.

26.00 Cross Wash, 30 lks. wide, Course  $S30^{\circ}W$  and ascend.

40.00 Set a sand stone 10 x 10 x 8 ins., 10  
 ins. in the ground, for  $\frac{1}{4}$  Sec. Cor., marked  $\frac{1}{4}$  on W.  
 face, and raised a mound of stone alongside. Pits  
 impracticable.

54.00 Leave Valley, bears  $N. 70^{\circ} E$  &  $S. 70^{\circ} W$  and ascend.

70.00 Top of Hill bears E. &amp; W. and descend.

80.00 Set a sand stone 10 x 12 x 8 ins. 10 ins.  
 in the ground for Cor. to Secs. 27 28 33 & 34 marked  
 with / notch on S. and 3 notches on E. edges,  
 dug pits 18 x 18 x 12 ins. in each Sec.,  $5\frac{1}{2}$  ft. dist. and  
 raised a mound of earth 2 ft. high,  $4\frac{1}{2}$  ft. base. alongside.

Land rolling.

Soil Ind &amp; 3rd rate

Vegetation bunchgrass &amp; sagebrush

Township

21

N. Range

20

S

Gila and Salt River Meridian.

Chains

East, on a random line between Sections 27 and 34.

Variation  $14^{\circ}57'$ 

East.

Descend.

12.00 Enter Valley, bears  $N. 21^{\circ} W.$  &  $S. 21^{\circ} E.$ 40.00 Set temporary  $\frac{1}{4}$  Sec. Cor.54.00 Cross Wash, 20 lks. wide, Course  $S W$  and ascend.

79.70 Intersect N. &amp; S. line, 26 lks. South of cor. to secs.

26.2734 from which corner, I run

 $S 89^{\circ} 49' W.$  on a true line between sections 27 & 34Variation  $14^{\circ}57'$ 

East

39.88 Set a sand stone  $16 \times 14 \times 8$  ins., 10. ins. in the ground, for  $\frac{1}{4}$  Sec. Cor., marked  $\frac{1}{4}$  on  $N.$  face, dug pits  $18 \times 18 \times 12$  ins.,  $E$  and  $W.$  of stone  $5\frac{1}{2}$  ft. dist., and raised a mound of earth  $1\frac{1}{2}$  ft. high,  $3\frac{1}{2}$  ft. base alongside.

79.70 The corner to sections 27, 28, 33 &amp; 34

Land rolling.

Soil 2nd &amp; 3rd rate

Vegetation bunchgrass &amp; sagebrush.

Township

21

N. Range

210

S.

Meridian.

Chains

North, between Sections 27 and 28.

Variation

14°51'

East.

Descend.

2.00

Enter Valley, bears E. &amp; W.

40.00

Set a sand stone 16 x 2 x 8 ins., 10 ins. in the ground, for  $\frac{1}{2}$  Sec. Cor., marked  $\frac{1}{2}$  on W. face, dug pits 18 x 18 x 12 ins., N. and S. of stone 5 $\frac{1}{2}$  ft. dist., and raised a mound of earth 1 $\frac{1}{2}$  ft. high, 3 $\frac{1}{2}$  ft. base. alongside.

42.00

Leave Valley, bears E. &amp; W.

87.00

Set a sand stone 16 x 2 x 10 ins. 10 ins. in the ground for Cor. to Secs. 21, 22, 27 & 28 marked with 2 notches on S. and 3 notches on E. edges and raised a mound of stone alongside. Pits impracticable.

Land level. &amp; rolling.

Soil 2nd &amp; 3rd rate

Vegetation bunchgrass &amp; sagebrush

Township

31

Range

20

E

Gila and Salt River Meridian.

Chains

East, on a random line between Sections 22 and 27.

Variation

14° 57'

East.

Descend.

40.00 Set temporary  $\frac{1}{4}$  Sec. Cor.

78.00 Cross Wash, 50 lks. wide, Course S 60° W and ascend.

79.87 Intersect N. &amp; S. line, 50 lks. South of cor. to secs.

22 23 26 &amp; 27 from which corner, I run

S 59° 39' W. on a true line between sections 22 &amp; 27

Variation

14° 57'

East

39.94 Set a sand stone 16 x 12 x 9 ins., 10 ins. in the ground, for  $\frac{1}{4}$  Sec. Cor., marked  $\frac{1}{4}$  on N. face, dug pits 18 x 18 x 12 ins., E. and W. of stone 5 $\frac{1}{2}$  ft. dist., and raised a mound of earth 1 $\frac{1}{2}$  ft. high, 3 $\frac{1}{2}$  ft. base alongside.

79.87 The corner to sections 21 22 27 &amp; 28

Land rolling.

Soil 2nd. &amp; 3rd. rate

Vegetation sagebrush &amp; bunchgrass



Township 21

Range 20

0

Gila and Salt River Meridian.

Chains

North, between Sections 21 and 22.

Variation

14° 51'

East.

Ascend.

7.00 Top of Ridge, bears *S* & *W* and descend.

46.00 Set a sand stone 6 x 12 x 5 ins., 10 ins. in the ground, for  $\frac{1}{4}$  Sec. Cor., marked  $\frac{1}{4}$  on *W.* face, dug pits 18 x 18 x 12 ins., *N.* and *S.* of stone 5  $\frac{1}{2}$  ft. dist., and raised a mound of earth 1  $\frac{1}{2}$  ft. high, 3  $\frac{1}{2}$  ft. base

68.00 Leave Brakes

73.00 Cross Wash, 100 lks. wide, Course West and ascend.

80.00 Set a sand stone 6 x 12 x 5 ins., 10 ins. in the ground for Cor. to Secs. 15, 16, 21 & 22 marked with *S* notches on *S.* and *U* notches on *E.* edges and raised a mound of stone. alongside. Pits impracticable.

Land mountainous.

Soil 2nd. & 3rd. rate

Vegetation sagebrush & bunchgrass

Township

21

Range

20

E

Gila and Salt River Meridian.

Chains

East, on a random line between Sections 15 and 22.

Variation

14° 57'

East.

*Over rolling land.*40.00 Set temporary  $\frac{1}{4}$  Sec. Cor.79.98 Intersect N. & S. line, 15 lks *South* of cor. to secs.141522 *and* from which corner, I run

S 89° 52' W. on a true line between sections 15 &amp; 22

Variation

14° 57'

East

39.99 Set a sand stone 16 x 12 x 4 ins., 10 ins.

in the ground, for  $\frac{1}{4}$  Sec. Cor., marked  $\frac{1}{4}$  on N. face,dug pits 18 x 18 x 12 ins., E. and W. of stone 5  $\frac{1}{2}$ ft. dist., and raised a mound of earth 1  $\frac{1}{2}$  ft. high, 3  $\frac{1}{2}$ 

ft. base alongside.

79.98 The corner to sections N. 16. 21 &amp; 22

*Land rolling.**Soil 2nd. & 3rd. rate**Vegetation bunchgrass & sagebrush*

Township

21

N Range

20

E

Gila and Salt River Meridian.

Chains

North, between Sections 15 and 16.

Variation

14° 57'

East.

*Descend.*

0.50 Cross Wash, 20 lks. wide, Course West and ascend.

18.60 Top of Hill bears E. &amp; W. and descend.

40.00 Set a sand stone  $16 \times 14 \times 8$  ins., 10 ins. in the ground, for  $\frac{1}{4}$  Sec. Cor., marked  $\frac{1}{4}$  on W. face, dug pits  $18 \times 18 \times 12$  ins., N. and S. of stone  $5\frac{1}{2}$  ft. dist., and raised a mound of earth  $1\frac{1}{2}$  ft. high,  $3\frac{1}{2}$  ft. base alongside.

80.00 Set a sand stone  $16 \times 12 \times 10$  ins. 10 ins. in the ground for Cor. to Secs. 9. 10. 15 & 16 marked with 4 notches on S. and 3 notches on E. edges and raised a mound of stone alongside. Pits impracticable.

Land hilly.

Soil 2nd ~~rate~~ rate

Vegetation sagebrush &amp; bunchgrass

Township 21 N. Range 20 East

## Gila and Salt River Meridian.

Chains East, on a random line between Sections 10 and 15.  
Variation  $14^{\circ}51'$  East.

Over rolling land.

40.00 Set temporary  $\frac{1}{4}$  Sec. Cor.

63.00 Top of Hill bears N. & S. and descend.

79.00 Cross low Sag and ascend.

80.16 Intersect N. & S. line, 15 lks. North of cor. to secs.

10.11.14 & 15 from which corner, I run

N.  $89^{\circ}24'W$ . on a true line between sections 10 & 15

Variation  $14^{\circ}51'$  East

40.05 Set a sand stone  $16 \times 13 \times 8$  ins., 10 ins.  
in the ground, for  $\frac{1}{4}$  Sec. Cor., marked  $\frac{1}{4}$  on N. face,  
dug pits  $18 \times 18 \times 12$  ins., E. and W. of stone  $5\frac{1}{2}$   
ft. dist., and raised a mound of earth  $1\frac{1}{2}$  ft. high,  $3\frac{1}{2}$   
ft. base alongside.

80.16 The corner to sections 9, 10, 15 & 16

Land rolling.

Soil Ind. & Ind. rats

Vegetation bunchgrass & sagebrush

Township 21 Range 20

Gila and Salt River Meridian.

Chains North, between Sections 9 and 10.

Variation  $14^{\circ} 51'$  East.

Ascend.

- 130 Top of Hill bears  $E \vee W$  and descend.
- 30.00 Enter Valley, bears  $E \vee W$ .
- 39.65 Cross Wash, 30 lks. wide, Course  $S 10^{\circ} E$  and ascend.
- 40.00 Set a sand stone  $15 \times 12 \times 9$  ins., 10 ins. in the ground, for  $\frac{1}{4}$  Sec. Cor., marked  $\frac{1}{4}$  on  $W$  face, dug pits  $18 \times 18 \times 12$  ins.,  $N$  and  $E$  of stone  $5\frac{1}{2}$  ft. dist., and raised a mound of earth  $1\frac{1}{2}$  ft. high,  $3\frac{1}{2}$  ft. base alongside.
- 68.50 Leave Valley, bears  $E \vee W$  and ascend.
- 77.00 Top of Ridge, bears  $E \vee W$  and descend.
- 80.00 Set a sand stone  $18 \times 12 \times 6$  ins. 12 ins. in the ground for Cor. to Secs. 3, 4, 9 & 10 marked with  $J$  notches on S. and  $S$  notches on E. edges and raised a mound of stone alongside. Pits impracticable.

Land hilly.

Soil  $2nd. \vee 3rd. rate$ 

Vegetation bunchgrass &amp; sagebrush

Township 21 Range 20 E

Gila and Salt River Meridian.

Chains

East, on a random line between Sections 3 and 10.

Variation  $14^{\circ} 37'$  East.

Descend.

3.75 Enter Valley, bears  $N. 17^{\circ} W.$  &  $S. 77^{\circ} E.$ 40.00 Set temporary  $\frac{1}{4}$  Sec. Cor.48.70 Cross Wash, 30 fms. wide, Course  $S. 40^{\circ} E.$ 53.40 Cross Wash, 40 fms. wide, Course  $S. W.$ 80.45 Intersect N. & S. line, 33 fms. North of cor. to secs.  
2. 3. 10 & 11 from which corner, I run $N. 89^{\circ} 46' W.$  on a true line between sections 3 & 10Variation  $14^{\circ} 37'$  East40.23 Set a sand stone  $16 \times 12 \times 7$  ins., 10 ins.  
in the ground, for  $\frac{1}{4}$  Sec. Cor., marked  $\frac{1}{4}$  on N. face,  
dug pits  $18 \times 18 \times 12$  ins., E. and W. of stone  $5\frac{1}{2}$   
ft. dist., and raised a mound of earth  $1\frac{1}{2}$  ft. high,  $3\frac{1}{2}$   
ft. base alongside.

80.45 The corner to sections 3, 4, 9 &amp; 10

Land rolling.

Soil 2nd. 3rd. rate

Vegetation bunchgrass &amp; sagebunch

Township

21

N. Range

20

Gila and Salt River Meridian.

Chains

North, on a random line between Sections 3 and 4.

Variation

14° 51'

East.

Descend.

- 2.40 Foot of Hill, bears E. & W.
- 5.10 Cross Wash, 20 fks. wide, Course N 63° W and ascend.
- 15.60 Foot of Bluff, bears E. & W.
- 21.30 Top of Ridge, bears E. & W. and descend.

40.00 Set temporary  $\frac{1}{4}$  Sec. Cor.

79.61 Intersect N. B. of Tp. 27, 1ks. West of cor. to secs.  
<sup>previously set by me.</sup>  
 3, 4, 33 & 34 from which corner, I run

S. 12° W. on a true line, between sections 3 &amp; 4

Variation

14° 51'

East.

39.61 Set a sand stone 16 x 10 x 9 ins., 10  
 ins. in the ground, for  $\frac{1}{4}$  Sec. Cor., marked  $\frac{1}{4}$  on W.  
 face and raised a mound of stone. alongside.

Pits impracticable.

79.61 The corner to sections 3, 4, 9 &amp; 10

Land mountainous.

Soil 2nd. &amp; 3rd. rate

Vegetation bunchgrass &amp; sagebrush

I carefully examined the adjustments of my solar  
 compass to-day, particularly the latitude and revers-  
 ing apparatus, and found them correct.

A. P. Johnson Mar 27. 1883

Township

21

N. Range

20

S 34

Meridian.

Chains

Standard  
From the corner to sections, 32 & 33 on S. By of Sp -  
which is a sand stone 20 x 10 x 5 ins.  
15 ins. in the ground, marked S. C. with  
4 notches on E and 2 notches on W  
faces with pits 18 x 18 x 12 ins. N. E.  
and W. of stone 5 1/2 ft. dist. and  
a mound of earth 2 ft. high  
4 1/2 ft. base alongside  
I run

North between sections 32 &amp; 33

Variation 14° 18' East.

Over level land

40.00

Set a sand stone 12 x 11 x 10 ins., 8 ins.  
in the ground, for 1/2 Sec. Cor., marked 1/2 on W. face,  
dug pits 18 x 18 x 12 ins., N. and S. of stone 5 1/2  
ft. dist., and raised a mound of earth 1 1/2 ft. high, 3 1/2  
ft. base alongside.

80.00

Set a sand stone 12 x 6 x 5 ins. 8 ins.  
in the ground for Cor. to Secs. 25, 29, 32 & 33 marked  
with 1 notch on S. and 4 notches on E. edges,  
dug pits 18 x 18 x 12 ins. in each Sec., 5 1/2 ft. dist. and  
raised a mound of earth 2 ft. high, 4 1/2 ft. base alongside.

Land level.

Soil 2nd. &amp; 2nd rate

Vegetation bunchgrass &amp; sagebrush



Township

21

N. Range

20

S

Gila and Salt River Meridian.

Chains

East, on a random line between Sections 28 and 33.

Variation  $14^{\circ} 0' 1''$  East.

Over rolling land.

40.00 Set temporary  $\frac{1}{2}$  Sec. Cor.

79.95 Intersect N. & S. line. 18 lks. South of cor. to secs.

27.28 & 36 from which corner, I run

S.  $89^{\circ} 52' W.$  on a true line between sections 28 & 33

Variation  $14^{\circ} 0' 1''$  East

39.98 Set a sand stone  $4 \times 2 \times 10$  ins., 10 ins. in the ground, for  $\frac{1}{2}$  Sec. Cor., marked  $\frac{1}{2}$  on N. face, dug pits  $18 \times 18 \times 12$  ins., E and W. of stone  $5\frac{1}{2}$  ft. dist., and raised a mound of earth  $1\frac{1}{2}$  ft. high,  $3\frac{1}{2}$  ft. base alongside.

79.95 The corner to sections 28. 29. 32 & 33

Land rolling.

Soil Ind. & 1/2 rats

Vegetation bunchgrass & sagebrush

Township 21 Range 20 36

Gila and Salt River Meridian.

Chains

North, between Sections 28 and 29.

Variation

14° 37'

East.

Ascend.

40.00 Set a sand stone 18 x 10 x 12 ins., 12 ins. in the ground, for  $\frac{1}{4}$  Sec. Cor., marked  $\frac{1}{4}$  on W. face, dug pits 18 x 18 x 12 ins., N. and S. of stone 5 $\frac{1}{2}$  ft. dist., and raised a mound of earth 1 $\frac{1}{2}$  ft. high, 3 $\frac{1}{2}$  ft. base. alongside.

80.00 Set a sand stone 14 x 10 x 5 ins. 10 ins. in the ground for Cor. to Secs. 20, 21, 25 & 29 marked with 2 notches on S. and 4 notches on E. edges, dug pits 18 x 18 x 12 ins. in each Sec., 5 $\frac{1}{2}$  ft. dist. and raised a mound of earth 2 ft. high, 4 $\frac{1}{2}$  ft. base. alongside.

Land rolling.

Soil 2nd &amp; 3rd rate

Vegetation bunchgrass &amp; sagebrush

Township 21 N. Range 20

Gila and Salt River Meridian.

Chains East, on a random line between Sections 21 and 28.  
 Variation  $14^{\circ} 51'$  East.

Ascend.

40.00 Set temporary  $\frac{1}{4}$  Sec. Cor.

79.82 Intersect N. & S. line, 32 lks North of cor. to secs.  
 21, 22, 23 & 24 from which corner, I run

N.  $89^{\circ} 40'$  W. on a true line between sections 21 & 28  
 Variation  $14^{\circ} 57'$  East

39.91 Set a sand stone  $14 \times 12 \times 8$  ins., 10 ins.  
 in the ground, for  $\frac{1}{4}$  Sec. Cor., marked  $\frac{1}{4}$  on N. face,  
 dug pits  $18 \times 18 \times 12$  ins., E and W. of stone  $5\frac{1}{2}$   
 ft. dist., and raised a mound of earth  $1\frac{1}{2}$  ft. high,  $3\frac{1}{2}$   
 ft. base. alongside.

79.82 The corner to sections 20, 21, 28 & 29

Land rolling.

Soil 2nd. & 3rd. rate

Vegetation bunchgrass & sagebrush

Township 21 N. Range 20 8 38

Gila and Salt River Meridian.

Chains North, between Sections 20 and 21.

Variation  $14^{\circ} 51'$  East.*Over bad lands*

40.00 Set a sand stone  $10 \times 9 \times 8$  ins., 6 ins. in the ground, for  $\frac{1}{4}$  Sec. Cor., marked  $\frac{1}{4}$  on W. face, dug pits  $18 \times 18 \times 12$  ins., N. and S. of stone  $5\frac{1}{2}$  ft. dist., and raised a mound of earth  $1\frac{1}{2}$  ft. high,  $3\frac{1}{2}$  ft. base alongside.

80.00 Set a sand stone  $16 \times 14 \times 8$  ins., 10 ins. in the ground for Cor. to Secs. 16, 17, 20 & 21 marked with  $\int$  notches on S. and  $\nabla$  notches on E. edges, dug pits  $18 \times 18 \times 12$  ins. in each Sec.,  $5\frac{1}{2}$  ft. dist. and raised a mound of earth 2 ft. high,  $4\frac{1}{2}$  ft. base alongside.

Land rolling.

Soil 2nd. &amp; 3rd. rate

Vegetation bunchgrass &amp; sagebrush

Township

21

Range

20

8

Gila and Salt River Meridian.

Chains

East, on a random line between Sections 16 and 21.

Variation  $14^{\circ}51'$  East.

Descend.

40.00 Set temporary  $\frac{1}{4}$  Sec. Cor.

5039 Intersect N. & S. line, 53 lks. North of cor. to secs.

N. 16, 21 & 22 from which corner, I run

N. 89 $^{\circ}$  37' W. on a true line between sections 16 & 21

Variation  $14^{\circ}51'$  East

40.20 Set a sand stone  $12 \times 10 \times 4$  ins., 8 ins. in the ground, for  $\frac{1}{4}$  Sec. Cor., marked  $\frac{1}{4}$  on N. face, dug pits  $18 \times 18 \times 12$  ins., E and W. of stone  $5\frac{1}{2}$  ft. dist., and raised a mound of earth  $1\frac{1}{2}$  ft. high,  $3\frac{1}{2}$  ft. base alongside.

5039 The corner to sections 16, 17, 20 & 21

Land rolling.

Soil Ind  $\Delta$  Indrate

Vegetation bunchgrass & sagebrush

Township 21 N. Range 20 E. <sup>40</sup>

Gila and Salt River Meridian.

Chains

North, between Sections 16 and 17.

Variation  $14^{\circ} 57'$  East.*Ascend.*

40.00 Set a sand stone  $14 \times 12 \times 6$  ins., 10 ins. in the ground, for  $\frac{1}{4}$  Sec. Cor., marked  $\frac{1}{4}$  on W. face, dug pits  $18 \times 18 \times 12$  ins., N. and S. of stone  $5\frac{1}{2}$  ft. dist., and raised a mound of earth  $1\frac{1}{2}$  ft. high,  $3\frac{1}{2}$  ft. base. alongside.

70.00 A Spring, bears East about 500 lks. dist.

80.00 Set a sand stone  $15 \times 10 \times 6$  ins. 12 ins. in the ground for Cor. to Secs. 8. 9. 16 & 17 marked with  $\#$  notches on S. and  $\#$  notches on E. edges, dug pits  $18 \times 18 \times 12$  ins. in each Sec.,  $5\frac{1}{2}$  ft. dist. and raised a mound of earth 2 ft. high,  $4\frac{1}{2}$  ft. base. alongside.

Land rolling.

Soil Ind.  $\frac{1}{2}$  3rd rate

Vegetation bunchgrass &amp; sagebrush

Township 21 N. Range 20 E

Gila and Salt River Meridian.

Chains

East, on a random line between Sections 9 and 16.

Variation 14° 51' East.

*Descend.*

40.00 Set temporary  $\frac{1}{4}$  Sec. Cor.

77.00 Cross low Sag and ascend.

79.92 Intersect N. & S. line, 13 lks North of cor. to secs.

9.10.15  $\frac{1}{4}$  from which corner, I run

N 89° 54' W. on a true line between sections 9 & 16

Variation 14° 51' East

89.96 Set a sand stone 12 x 12 x 10 ins. 8 ins. in the ground, for  $\frac{1}{4}$  Sec. Cor., marked  $\frac{1}{4}$  on N face and raised a mound of stone. alongside.

*Pits impracticable.*

99.92 The corner to sections 8. 9. 16 & 17

Land rolling.

Soil 2nd. & 3rd. rate

Vegetation bunchgrass & sagebrush

Township

21

Range

20

E 42

Gila and Salt River Meridian.

Chains

North, between Sections 8 and 9.

Variation

14° 51'

East.

*Descend.*

40.00 Set a sand stone  $16 \times 14 \times 8$  ins., 10 ins. in the ground, for  $\frac{1}{4}$  Sec. Cor., marked  $\frac{1}{4}$  on W. face, dug pits  $18 \times 18 \times 12$  ins., N and S. of stone  $5\frac{1}{2}$  ft. dist., and raised a mound of earth  $1\frac{1}{2}$  ft. high,  $8\frac{1}{2}$  ft. base, alongside.

47.00 Cross low Sag and ascend.

80.00 Set a sand stone  $15 \times 12 \times 10$  ins. 10 ins. in the ground for Cor. to Secs. 4, 5, 8 & 9 marked with J notches on S. and H notches on E. edges and raised a mound of stone, alongside. Pits impracticable.

Land rolling.

Soil 2nd &amp; 3rd rate

Vegetation bunchgrass &amp; sagebush



Township

21

N. Range

20

E

Gila and Salt River Meridian.

Chains

East, on a random line between Sections 4 and 9.

Variation

14° 51'

East.

*Over brakes*

40.00

Set temporary  $\frac{1}{4}$  Sec. Cor.

79.79

Intersect N. &amp; S. line, 6 lks North of cor. to secs.

3.4.9 &amp; 10 from which corner, I run

N. 89° 57' W. on a true line between sections 4 &amp; 9

Variation

14° 51'

East

39.90

Set a sand stone 16 x 11 x 10 ins. 15 ins. in the ground, for  $\frac{1}{4}$  Sec. Cor., marked  $\frac{1}{4}$  on N face and raised a mound of stone. alongside.

Pits impracticable.

79.79

The corner to sections 4, 5, 8 &amp; 9

Land rolling.

Soil 2nd &amp; 3rd rate

Vegetation bunchgrass &amp; sagebrush

Township 21 N Range 20 E

Gila and Salt River Meridian.

Chains North, on a random line between Sections 4 and 5.  
Variation 14° 51' East.

Ascend.

77.70 Top of bluff bears E & W and descend  
40.00 Set temporary 1/4 Sec. Cor.

79.93 Intersect N.B. of Tp. 40 1/2 kts. East of cor. to sec.  
previously set by me.  
4.5.3.3 from which corner, I run  
S. 17° E on a true line, between sections 4 & 5  
Variation 14° 51' East.

39.93 Set a sand stone 14 x 12 x 4 ins., 10  
ins. in the ground, for 1/4 Sec. Cor., marked 1/4 on W.  
face, and raised a mound of stone alongside. Pits  
impracticable.

79.93 The corner to sections 4.5.8 & 9

Land rolling.  
Soil 2nd. & 3rd rate  
Vegetation bunchgrass & sagebrush

I carefully examined the adjustments of my solar  
compass to-day, particularly the latitude and revers-  
ing apparatus, and found them correct.

G. M. Casson Comptroler  
Mar. 27. 1853

Township

21

N. Range

20

E

Gila and Salt River Meridian.

Chains

Standard

From the corner to sections 31 & 32 on S. By of Sp. which is a sand stone, 6 x 10 x 5 ins. 10 ins. in the ground marked S.C. with 5 notches on S. and 1 notch on W. edges, and a mound of stone alongside.  
I run

North between sections 31 &amp; 32

Variation  $14^{\circ} 15'$  East.

Over level land

37.00

Enter Valley, bears N. E. &amp; S. W.

40.00

Set a sand stone 12 x 11 x 10 ins., 8 ins. in the ground, for  $\frac{1}{4}$  Sec. Cor., marked  $\frac{1}{4}$  on W. face, dug pits 18 x 18 x 12 ins., N. and S. of stone  $5\frac{1}{2}$  ft. dist., and raised a mound of earth  $1\frac{1}{2}$  ft. high,  $3\frac{1}{2}$  ft. base alongside.

80.00

Set a sand stone 20 x 12 x 8 ins. 10 ins. in the ground for Cor. to Secs. 29, 30, 31 & 32 marked with / notch on S. and 5 notches on E. edges, dug pits 18 x 18 x 12 ins. in each Sec.,  $5\frac{1}{2}$  ft. dist. and raised a mound of earth 2 ft. high,  $4\frac{3}{8}$  ft. base. alongside.

Land level.

Soil 2nd &amp; 3rd. rate

Vegetation bunchgrass &amp; sagebrush

Township 21 N. Range 20 E 46

Gila and Salt River Meridian.

Chains East, on a random line between Sections 29 and 32.

Variation  $14^{\circ}57'$  East.

Over level land

30.00 Leave Valley, bears  $N. 20^{\circ} E. \vee S. 20^{\circ} W.$ 40.00 Set temporary  $\frac{1}{2}$  Sec. Cor.

50.25 Intersect N. &amp; S. line. 30 lks North of cor. to secs.

28. 29. 30. 31. 32. From which corner, I run

 $N 59^{\circ} 47' W.$  on a true line between sections 29 & 32Variation  $14^{\circ}57'$  East

40.75 Set a sand stone  $2 \times 10 \times 8$  ins., 8 ins. in the ground, for  $\frac{1}{2}$  Sec. Cor., marked  $\frac{1}{2}$  on N. face, dug pits  $18 \times 18 \times 12$  ins., E and W. of stone  $5\frac{1}{2}$  ft. dist., and raised a mound of earth  $1\frac{1}{2}$  ft. high,  $3\frac{1}{2}$  ft. base alongside.

50.25 The corner to sections 29. 30. 31 &amp; 32

Land level.

Soil 2nd. &amp; 3rd. rate

Vegetation bunchgrass &amp; sagebrush

A. P. Johnson

Mar. 28. 1883

Township

21

Range

20

8

Gila and Salt River Meridian.

Chains

West, on a random line between Sections 30 and 31.

Variation  $14^{\circ}51'$

East.

Over Valley land

32.00 Cross Wash, 150 lks. wide, Course South

40.00 Set temporary  $\frac{1}{4}$  Sec. Cor.

79.80 Intersect W. B. of Tp. 37 lks North of cor. to sec. previously set by me.

25.30.01/410 from which corner, I run

N 89° 44' E on a true line, between sections 30 & 31

Variation  $14^{\circ}$

East.

39.80 Set a sand stone  $2 \times 10 \times 10$  ins., 8 ins.

in the ground, for  $\frac{1}{4}$  Sec. Cor., marked  $\frac{1}{4}$  on N. face, dug pits  $18 \times 18 \times 12$  ins., E and W. of stone  $5\frac{1}{2}$  ft. dist., and raised a mound of earth  $1\frac{1}{2}$  ft. high,  $3\frac{1}{2}$  ft. base. alongside.

79.80 The corner to sections 29.30.01 & 32

Land rolling.

Soil 2nd & 3rd rate

Vegetation bunchgrass & sagebrush

J. M. Carson Compassman

Mar. 25. 1883

Township 21 N. Range 20 E

Gila and Salt River Meridian.

Chains

North, between Sections 29 and 30.

Variation 14° 51' East.*Over Valley land*

40.00 Set a sand stone  $12 \times 8 \times 6$  ins., 8 ins. in the ground, for  $\frac{1}{4}$  Sec. Cor., marked  $\frac{1}{4}$  on W. face, dug pits  $18 \times 18 \times 12$  ins., N. and S. of stone  $5\frac{1}{2}$  ft. dist., and raised a mound of earth  $1\frac{1}{2}$  ft. high,  $3\frac{1}{2}$  ft. base. alongside.

40.00 Leave Valley, bears E. & W.

80.00 Set a sand stone  $12 \times 10 \times 8$  ins., 8 ins. in the ground for Cor. to Secs. 19, 20, 29, 30 marked with 2 notches on S. and 1 notch on E. edges, dug pits  $18 \times 18 \times 12$  ins. in each Sec.,  $5\frac{1}{2}$  ft. dist. and raised a mound of earth 2 ft. high,  $4\frac{1}{2}$  ft. base. alongside.

Land level.

Soil Ind. &amp; Strata

Vegetation bunchgrass &amp; sagebrush

Township 21 N. Range 20 0

Gila and Salt River Meridian.

Chains East, on a random line between Sections 20 and 29.

Variation  $14^{\circ} 51'$  East.

*Over bad lands*

40.00 Set temporary  $\frac{1}{4}$  Sec. Cor.

80.10 Intersect N. & S. line,  $10^{-}$  lks South of cor. to secs.

20, 21, 28, 29 from which corner, I run

S.  $89^{\circ} 34' W.$  on a true line between sections 20 & 29

Variation  $14^{\circ} 51'$  East

40.05 Set a sand stone  $14 \times 10 \times 8$  ins., 10 ins. in the ground, for  $\frac{1}{4}$  Sec. Cor., marked  $\frac{1}{4}$  on N. face, dug pits  $18 \times 18 \times 12$  ins., E. and W. of stone  $5\frac{1}{2}$  ft. dist., and raised a mound of earth  $1\frac{1}{2}$  ft. high,  $3\frac{1}{2}$  ft. base

80.10 The corner to sections 19, 20, 29 & 30

Land rolling.

Soil 2nd. & 3rd. rate

Vegetation bunchgrass & sagebrush

*J. P. Johnson*

Mar. 25. 1883

Township 21 N. Range 20 E. 50.

Gila and Salt River Meridian.

Chains West, on a random line between Sections 19 and 30.  
Variation  $14^{\circ} 51'$  East.

*Over bad lands,*

28.00 *Leave bad lands and enter Valley*

40.00 Set temporary  $\frac{1}{4}$  Sec. Cor.

42.00 Cross Wash, 150 yds. wide, Course South

79.35 Intersect N. B. of Tp. 5 N. 1/2 Sec. North of cor. to sec. previously set by me.  
19.24.25 & 30 from which corner, I run

N. 89° 58' On a true line, between sections 19 & 30

Variation  $14^{\circ}$  East.

39.38 Set a sand stone  $10 \times 8 \times 6$  ins., 6 ins. in the ground, for  $\frac{1}{4}$  Sec. Cor., marked  $\frac{1}{4}$  on N. face, dug pits  $18 \times 18 \times 12$  ins., E and W. of stone  $5\frac{1}{2}$  ft. dist., and raised a mound of earth  $1\frac{1}{2}$  ft. high,  $3\frac{1}{2}$  ft. base alongside.

79.38 The corner to sections 19.20.21 & 30

Land rolling.

Soil Ind. & Ind. rate

Vegetation bunchgrass & sagebrush

G. W. Casson Compassman  
May 25. 1883



Township 21 N. Range 20 E.

Gila and Salt River Meridian.

Chains North, between Sections 19 and 20.

Variation 45' East.

*Over bad lands*

40.00 Set a sand stone  $16 \times 12 \times 10$  ins., 10 ins. in the ground, for  $\frac{1}{4}$  Sec. Cor., marked  $\frac{1}{4}$  on W. face, dug pits  $18 \times 18 \times 12$  ins., N and S. of stone  $5\frac{1}{2}$  ft. dist., and raised a mound of earth  $1\frac{1}{2}$  ft. high,  $3\frac{1}{2}$  ft. base. alongside.

80.00 Set a sand stone  $14 \times 12 \times 8$  ins. 10 ins. in the ground for Cor. to Secs. 17, 18, 19 & 20 marked with  $\{$  notches on S. and  $\}$  notches on E. edges, dug pits  $18 \times 18 \times 12$  ins. in each Sec.,  $5\frac{1}{2}$  ft. dist. and raised a mound of earth 2 ft. high,  $4\frac{1}{2}$  ft. base. alongside.

Land rolling.

Soil 2nd & 3rd rate

Vegetation bunchgrass & sagebrush

Township 21 N. Range 20 0

Gila and Salt River Meridian.

Chains East, on a random line between Sections 17 and 20.  
 Variation 14° 51' East.

*Over bad lands*

40.00 Set temporary  $\frac{1}{4}$  Sec. Cor.  
 79.89 Intersect N. & S. line, 23 lks. *South* of cor. to secs.  
 16.17, 20 & 21 from which corner, I run  
S. 89° 50' W. on a true line between sections 17 & 20

Variation 14° 51' East

39.95 Set a sand stone  $12 \times 8 \times 4$  ins., 8 ins.  
 in the ground, for  $\frac{1}{4}$  Sec. Cor., marked  $\frac{1}{4}$  on N. face,  
 dug pits  $18 \times 18 \times 12$  ins., E and W. of stone  $5\frac{1}{2}$   
 ft. dist., and raised a mound of earth  $1\frac{1}{2}$  ft. high,  $3\frac{1}{2}$   
 ft. base alongside.

79.89 The corner to sections 17, 18, 19 & 20  
 Land rolling.

Soil Ind. & Int. rate

Vegetation *bunchgrass & sagebrush*

A. P. Johnson  
 Mar. 28. 1883

Township

21

N Range

20

D

Gila and Salt River Meridian.

Chains

West, on a random line between Sections 18 and 19.

Variation

14° 51'

East.

5.00 Leave badland, Enter Valley, bears N. + S.

40.00 Set temporary  $\frac{1}{4}$  Sec. Cor.

60.00 Cross Wash, 150 yds. wide, Course South

79.00 Intersect W. B. of Tp. 40 yds. South of cor. to secs.  
previously set by me.  
13, 18, 19 + 24 from which corner, I run

S. 59° 40' On a true line, between sections 18 + 19

Variation

14°

East.

79.13 Set a sand stone  $12 \times 10 \times 8$  ins., 8 ins.  
in the ground, for  $\frac{1}{4}$  Sec. Cor., marked  $\frac{1}{4}$  on N. face,  
dug pits  $18 \times 18 \times 12$  ins., E. and W. of stone  $5\frac{1}{2}$   
ft. dist., and raised a mound of earth  $1\frac{1}{2}$  ft. high,  $3\frac{1}{2}$   
ft. base, alongside.

79.18 The corner to sections 17, 18, 19 + 20

Land rolling.

Soil Ind. + 3rd rate

Vegetation bunchgrass + sagebrush

G. M. Cannon Comptroller

Mar. 25. 1883

Township

21

N. Range

20

8

Gila and Salt River Meridian.

Chains

North, between Sections 17 and 18.

Variation

140'

East.

Ascend.

49.00

Set a sand stone 10 x 12 x 8 ins., 10 ins. in the ground, for 1/4 Sec. Cor., marked 1/4 on W face, dug pits 18 x 18 x 12 ins., N. and S. of stone 5 1/2 ft. dist., and raised a mound of earth 1 1/2 ft. high, 3 1/2 ft. base. alongside.

80.00

Set a sand stone 18 x 14 x 8 ins. 12 ins. in the ground for Cor. to Secs. 7, 8, 17 & 18 marked with 4 notches on S. and 5 notches on E. edges, dug pits 18 x 18 x 12 ins. in each Sec., 5 1/2 ft. dist, and raised a mound of earth 2 ft. high, 4 1/2 ft. base. alongside.

Land rolling.

Soil Ind. & 3d rate

Vegetation bunchgrass & sagebrush

Township

21

Range

20

8

Gila and Salt River Meridian.

Chains

East, on a random line between Sections 8 and 17.

Variation

14° 51'

East.

*Ascend.*

40.00

Set temporary  $\frac{1}{4}$  Sec. Cor.

79.82

Intersect N. & S. line.  $\cup$  1/2 S. South of cor. to sec.

8. 9. 16. 17 from which corner, I run

S. 89° 08' W. on a true line between sections 8 &amp; 17

Variation

14° 51'

East

39.91

Set a sand stone 18 x 10 x 11 ins.  $\frac{1}{2}$ ins. in the ground, for  $\frac{1}{4}$  Sec. Cor., marked  $\frac{1}{4}$  on N. face and raised a mound of stone. alongside.*Pits impracticable.*

79.82

The corner to sections 7. 8. 17 &amp; 18

*Land rolling.**Soil ind. & soil rate**Vegetation bunchgrass & sagebrush*

T. P. Johnson

Mar 28. 1883

Township 21 N. Range 20 E

Gila and Salt River Meridian.

Chains West, on a random line between Sections 7 and 18.  
Variation 14° 51' East.

Descend.

40.00 Set temporary  $\frac{1}{4}$  Sec. Cor.79.05 Intersect W.B. of Tp. 18 1/2 m. South of cor. to secs.  
previously set by me.  
1.12.13 & 18 from which corner, I runS 89° 52' On a true line, between sections 7 & 18Variation 14° East.39.05 Set a sand stone 22 x 16 x 11 ins., 18 ins.  
in the ground, for  $\frac{1}{4}$  Sec. Cor., marked  $\frac{1}{4}$  on N. face,  
dug pits 18 x 18 x 12 ins., E. and W. of stone 5  $\frac{1}{2}$   
ft. dist., and raised a mound of earth 1  $\frac{1}{2}$  ft. high, 3  $\frac{1}{2}$   
ft. base alongside.79.05 The corner to sections 7. 8. 17 & 18

Land rolling

Soil 2nd. & 3rd. rateVegetation timbergrass & sagebrush

G. M. Carson Comptroller

Mar. 28. 1883

Township

21

Range

20

0

Gila and Salt River Meridian.

Chains

North, between Sections 7 and 8.

Variation

14° 57'

East.

*Ascend.*

40.00 Set a sand stone 30 x 15 x 17 ins., 24 ins. in the ground, for  $\frac{1}{4}$  Sec. Cor., marked  $\frac{1}{4}$  on W. face, dug pits 18 x 18 x 12 ins., N. and S. of stone  $5\frac{1}{2}$  ft. dist., and raised a mound of earth  $1\frac{1}{2}$  ft. high,  $3\frac{1}{2}$  ft. base.

80.00 Set a sand stone 14 x 10 x 6 ins. 10 ins. in the ground for Cor. to Secs. 6, 7 & 8 marked with J notches on S. and J notches on E. edges, dug pits 18 x 18 x 12 ins. in each Sec.,  $5\frac{1}{2}$  ft. dist. and raised a mound of earth 2 ft. high,  $4\frac{1}{2}$  ft. base.

*Land rolling.**Soil 2nd. & 3rd rate**Vegetation bunchgrass & sagebrush*

Township 21 N Range 20 E

Gila and Salt River Meridian.

Chains East, on a random line between Sections 5 and 8.  
Variation  $14^{\circ}51'$  East.

Ascend.

40.00 Set temporary  $\frac{1}{4}$  Sec. Cor.

50.24 Intersect N. & S. line,  $15'$  *W. of* *the* *bull* *of* *cor.* *to* *secs.*  
45.849 from which corner, I run  
 $189^{\circ}54'W.$  on a true line between sections 5 & 8  
Variation  $14^{\circ}51'$  East

40.12 Set a sand stone  $15 \times 12 \times 6$  ins., 10 ins.  
in the ground, for  $\frac{1}{4}$  Sec. Cor., marked  $\frac{1}{4}$  on N. face,  
dug pits  $18 \times 18 \times 12$  ins., *E* and *W.* of stone  $5\frac{1}{2}$   
ft. dist., and raised a mound of earth  $1\frac{1}{2}$  ft. high,  $3\frac{1}{2}$   
ft. base, alongside.

50.24 The corner to sections 5, 6, 7 & 8

Land rolling.

Soil Ind. & *Lid. rate*

Vegetation bunchgrass & sagebrush

I carefully examined the adjustments of my solar  
compass to-day, particularly the latitude and revers-  
ing apparatus, and found them correct.

A. P. Johnson Mar. 28. 1883



Township 21 N. Range 20 8

Gila and Salt River Meridian.

Chains

West, on a random line between Sections 6 and 7.

Variation  $14^{\circ} 51'$  East.

Descend.

40.00 Set temporary  $\frac{1}{4}$  Sec. Cor.

79.18 Intersect W. B. of Tp. 44 1ks South of cor. to secs. previously set by me.  
 10. 7 & 12 from which corner, I run

S. 89 $^{\circ}$  41' on a true line, between sections 6 & 7  
 Variation  $14^{\circ}$  East.

39.18 Set a sand stone  $14 \times 10 \times 8$  ins., 10 ins. in the ground, for  $\frac{1}{4}$  Sec. Cor., marked  $\frac{1}{4}$  on N. face, dug pits  $18 \times 18 \times 12$  ins.,  $\odot$  and  $\omega$ . of stone  $5\frac{1}{2}$  ft. dist., and raised a mound of earth  $1\frac{1}{2}$  ft. high,  $3\frac{1}{2}$  ft. base, alongside.

79.18 The corner to sections 6, 7 & 8

Land rolling.

Soil 2nd & 3rd rate

Vegetation bunchgrass & sagebrush

Township 21 N Range 21 E

Gila and Salt River Meridian.

Chains North, on a random line between Sections 5 and 6.  
Variation 14° 51' East.

Over broken land.

20.00 Enter Timber, leave E & W.

40.00 Set temporary 1/4 Sec. Cor.

50.20 Intersect N.B. of Tp. 13 N.S. East of cor. to secs. 5, 6, 7 & 8 from which corner, I run

S. 6 C on a true line, between sections 5 & 6  
Variation 14° 51' East.

40.20 Set a sand stone 16 x 8 x 8 ins., 10 ins. in the ground, for 1/4 Sec. Cor., marked 1/4 on W. face, dug pits 18 x 18 x 12 ins., N and S. of stone 5 1/2 ft. dist., and raised a mound of earth 1 1/2 ft. high, 3 1/2 ft. base alongside.

50.20 The corner to sections 5, 6, 7 & 8

Land mountainous

Soil 2nd & 3rd rate

Timber of Juniper

Vegetation. bunchgrass & sagebrush

I carefully examined the adjustments of my solar compass to-day, particularly the latitude and reversing apparatus, and found them correct.

G. M. Cannon Compassman

## GENERAL DESCRIPTION.

The land in this Township is principally rolling some portions being mountainous.

The soil is 3rd. rate and covered with a good growth of bunchgrass and sagebrush.

There is also some scattering junipers.  
Deer spring is situated in the N. W. 1/4 of Sec. 10

For Trial Oaths  
see Book No 19.

BOOK 399

62

U. S. Surveyor General's Office,  
Tucson, Arizona, July 26, 1883,

The foregoing Field Notes of the survey of the

sub division lines of Townships  
21 North, Range 20 East,

of the Gila and Salt River Base and Meridian, Arizona,  
executed by A. P. Johnson,  
D. S., under his contract of the 5<sup>th</sup> day of  
August, 1882, having been critically ex-  
amined and the necessary corrections and explanations  
made, the said Field Notes and the surveys they de-  
scribe, are hereby approved.

J. M. Robinson

Surveyor General.