

Recd. Oct 24 89
Copied.
Compared.
Platted.

23

No. 531

Sent to bow. S. L. O. Feb 6th 1892

Approved March 18 1892

BOOK 531

Subdivisions T. 27 N R. 15 E

4-671

531

FIELD NOTES

GENERAL LAND OFFICE.

of the survey
of the

Subdivision Lines of
Township 27 N Range 15 E

Surveyed by John C. Smith
U. S. Dep. Sur

Under his contract No 16

Dated Nov. 1st 1890

Survey commenced June 5th

" completed " 1891

Index

Sp 27 N. R 15. E
 G. F. S. R. M.

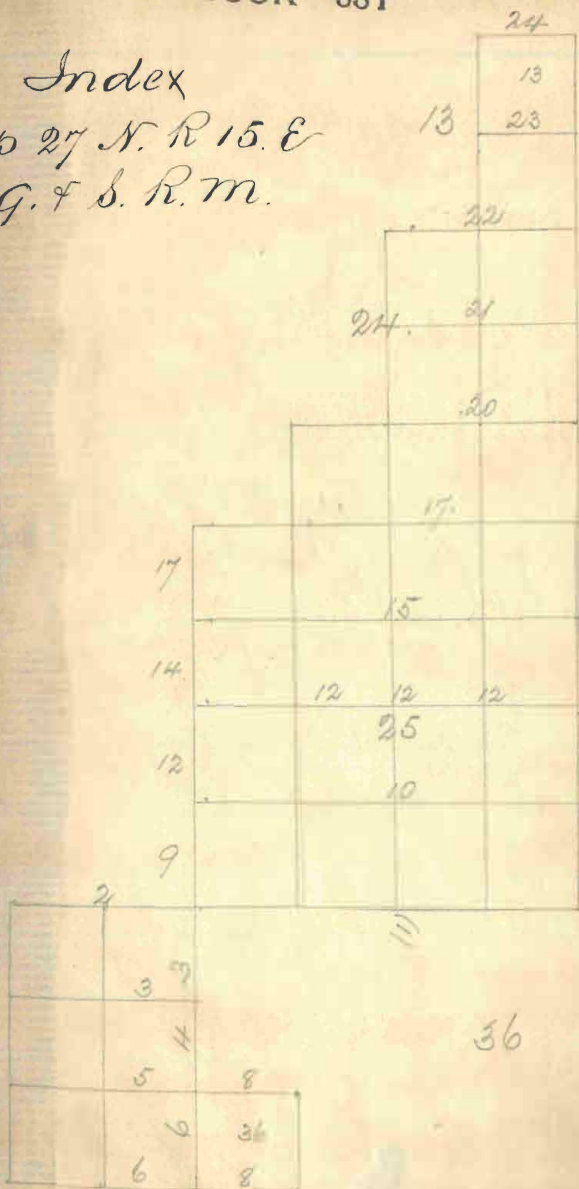

35

36

CHAINS Subdivisions T. 27 N R. 15 E 113

From the cor. to svs. 25, 30,
31 and 36, Sps. 27 71. Crs.
15 and 16 East, I run
West on a true line bet.
Svs. 25 and 36.

Ya. 13° E.

1714. mesa.

20.00

Set a ^{line} sandstone 14 X 12 X 3 ins., 9 ins.
in the ground, for 116 Sec. Cor., marked 116 on N...
face, dug pits 18x18x12 ins., E. and W. of stone
5 1-2 ft. dist., and raised a mound of earth 1 1-2 ft.
high, 3 1-2 ft. base, alongside,

29.00

Descend from mesa bears N.E.
and S.W.

40.00

Set a ^{line} sandstone 15 X 10 X 4 ins., 10 ins.
in the ground, for 114 Sec. Cor., marked 114 on N...
face, dug pits 18x18x12 ins., E. and W. of stone
5 1-2 ft. dist., and raised a mound of earth 1 1-2 ft.
high, 3 1-2 ft. base, alongside,

41.61

Trail bears N. E. and S. W. (near road to flagstaff)

45.80

Trail bears N. E. and S. W.

47.20

Trail bears N. E. and S. W.

48.00

Enter field bears N. E.

CHAINS. Subdivisions T. 27 N. R. 15 E.

60.00

Set a sandstone $16 \times 10 \times 8$ ins., 11 ins. in the ground, for $\frac{1}{16}$ Sec. Cor., marked $\frac{1}{16}$ on N. face, dug pits $18 \times 18 \times 12$ ins., E. and W. of stone 5 1-2 ft. dist., and raised a mound of earth 1 1-2 ft. high, 3 1-2 ft. base, alongside,

68.50

Trail bears 77.5 .

73.10

Leave cornfield bears 77.5 .

80.00

Set a sandstone $9 \times 8 \times 7$ ins., 6 ins. in the ground for Cor. to Secs. 25, 26, 35 and 36 marked with 1 notch on 3 and 1 notch on E. edges, dug pits $18 \times 18 \times 12$ ins. in each Sec. 5 1-2 ft. dist. and raised a mound of earth 2 ft. high, 4 1-2 ft. base, alongside.

Surface mesa and bottom land
Soil 10 ft. ⁱⁿ bottom
Some grass on mesa

West bet. S.W. 26 and 35.
 $70. 13^{\circ} E.$

In bottom

19.30

Enter field from new line st.

20.00

Set a sandstone $24 \times 24 \times 1$ ins., 18 ins. in the ground, for $\frac{1}{16}$ Sec. Cor., marked $\frac{1}{16}$ on N. face, dug pits $18 \times 18 \times 12$ ins., E. and W. of stone 5 1-2 ft. dist., and raised a mound of earth 1 1-2 ft. high, 3 1-2 ft. base, alongside,

CHAINS Subdivisions T. 27 N R. 15 E

40.00

Set a sandstone $18 \times 10 \times 4$ ins., 12 ins. in the ground, for $\frac{1}{4}$ Sec. Cor., marked $\frac{1}{4}$ on N. face, dug pits $18 \times 18 \times 12$ ins., E. and W. of stone 5 1-2 ft. dist., and raised a mound of earth 1 1-2 ft. high, 3 1-2 ft. base, alongside,

Foot of Bluffs -

Surface flat,

Soil 1st rate

Vegetation corn.

From the cor to sec 25.
26. 35 and 36. I run
S. 10° E. bet. sec 35. and 36
70. 13° E.

In bottom.

20.00

Set a sandstone $16 \times 12 \times 4$ ins., 11 ins. in the ground, for $\frac{1}{16}$ Sec. Cor., marked $\frac{1}{16}$ on W. face, dug pits $18 \times 18 \times 12$ ins., N. and S. of stone 5 1-2 ft. dist., and raised a mound of earth 1 1-2 ft. high, 3 1-2 ft. base, alongside,

Thence I run West on
a true line through
north $\frac{1}{2}$ sec. 35.

4V

BOOK 531

CHAINS Subdivisions T. 27

7a. 13° E.

In Bottom

20.00

Deposited a marked stone 12 ins. in the ground, for $\frac{1}{16}$ Sec. Cor., dug pits 18x18x12 ins. ...E. and ...W... of corner 5 1-2 ft. dist., and raised a mound of earth 1 1-2 ft. high, 3 1-2 ft. base over it.

In ...E... pit drove a stake 2 ft. long, 2 ins. square, 12 ins. in the ground, marked $\frac{1}{16}$ S, on ...N... face,

40.00

Set a sandstone $\frac{1}{32}$ X $\frac{1}{32}$ X ... ins., ... $\frac{2}{4}$ ins. in the ground, for $\frac{1}{16}$ Sec. Cor., marked $\frac{1}{16}$ on ...N... face, dug pits 18x18x12 ins., E. and ...W... of stone 5 1-2 ft. dist., and raised a mound of earth 1 1-2 ft. high, 3 1-2 ft. base, alongside,

Bluffs to the west.

Surface flat

Soil 1st. rate.

Some brush.

I continue S 20° 14' E.

bet. sec. 35 and 36 from $\frac{1}{16}$ Cor.

35.80

34.00

40.00

Mark 15 limits mid course R.T.
Trail and road bear N.E. & S.W.

Set a sandstone $\frac{1}{16}$ X $\frac{1}{12}$ X ... ins., ... $\frac{1}{11}$ ins. in the ground, for $\frac{1}{4}$ Sec. Cor., marked $\frac{1}{4}$ on ...W... face, dug pits 18x18x12 ins., N. and ...S... of stone 5 1-2 ft. dist., and raised a mound of earth 1 1-2 ft. high, 3 1-2 ft. base, alongside,

CHAINS. Subdivisions T. 27 N R. 15 E.

Shed I run West on a true
line through middle sec. 5-

7a. 130 E.

In follow.

1.00 Trail and road bears NE. and SW.

4.00 Flag 15 links with course SW.

2.00
20.00

Deposited a marked stone 12 ins. in the ground,
for ~~11~~ 6. Sec. Cor., dug pits 18X18X12 ins. E... and
W... of corner 5 1-2 ft. dist., and raised a mound of
earth 1 1-2 ft. high, 3 1-2 ft. base over it.

In E... pit drove a stake 2 ft. long, 2 ins. square,
12 ins. in the ground, marked ~~11~~ 6. S, on N... face,

40.00

Set a sandstone 9 X 8 X 7 ins., 6 ins.
in the ground, for ~~11~~ 4. Sec. Cor., marked ~~11~~ 4. on N...
face, dug pits 18x18x12 ins., E... and W... of stone
5 1-2 ft. dist., and raised a mound of earth 1 1-2 ft.
high, 3 1-2 ft. base, alongside,

Sand northless west.

Surface level

Soil 1st. rate

Grasswood brush

CHAINS Subdivisions T. 27 N. 13° E. R. 15 W.

20° NE bet. sec. 35 and 36,
from 1/4 sec. cor.
79. 13° E.

40.50 Trail bears N. E. and S. W.

47.40 Ascend mesa. bear. n.e., row.

49.00 about 100 ft. high
Trail bear. n.e. and s.w.

53.50 Top. of mesa.

60.00 Set a sandstone 9 X 8 X 7 ins. 6 ins.
in the ground, for 1/6 Sec. Cor., marked 1/6 on W.
face, dug pits 18x18x12 ins., N. and S. of stone
5 1-2 ft. dist., and raised a mound of earth 1 1-2 ft.
high, 3 1-2 ft. base, alongside,

Sand rough and broken to south

Surface flat and broken

Soil 1st and 3rd. note

Some brush.

Then I run West.
on a true line through
south 1/2 sec. 35.
79. 13° E.

CHAINS Subdivisions T. 27 N R. 10 E.

over mesa.

- 12.00 Stone house 2 rooms bears north of line 188 links.
- 13.00 Descend from mesa
- 15.00 South edge of spring, good water.
- 16.00 Foot of mesa, from N.E. and SW.
- 20.00 Set a sandstone $18 \times 10 \times 3$ ins., $1\frac{1}{2}$ ins. in the ground, for $\frac{1}{16}$ Sec. Cor., marked $\frac{1}{16}$ on N face, and raised a mound of stone 1 1-2 ft. high 2 ft. base, alongside. Pits impracticable.
- 23.00 Trail and road to Flystaff bears N.E. and SW.
- 23.50 Wash 30 links wide across S.W.
- 40.00 Set a sandstone $17 \times 10 \times 5$ ins., $1\frac{1}{2}$ ins. in the ground, for $\frac{1}{16}$ Sec. Cor., marked $\frac{1}{16}$ on N face, dug pits $18 \times 18 \times 12$ ins., E. and W. of stone 5 1-2 ft. dist., and raised a mound of earth 1 1-2 ft. high, 3 1-2 ft. base, alongside.
- Sand worthless now:-
 Surface flat and broken
 Oil 2nd and 4th rate
 Some brush.

8

BOOK 531

CHAINS. Subdivisions T. 27 N. R. 15 E.

East through south $\frac{1}{2}$
 sec. 36. from $\frac{1}{16}$ sec. cor.
 bet. sec. 35 and 36.

Ta. 13° E.

over mesa

8.90

Trail from North to Spring.

20.00

Set a sandstone $2 \frac{1}{2} \times 16 \times 2$ ins., 15 ins.
 in the ground, for $\frac{1}{16}$ Sec. Cor., marked $\frac{1}{16}$ on N...
 face, dug pits $18 \times 18 \times 12$ ins. E. and W. of stone
 5 1-2 ft. dist., and raised a mound of earth 1 1-2 ft.
 high, 3 1-2 ft. base, alongside,

Surface mountainous to the east
 Soil 3rd soil -
 Some Grass.

East through middle sec.
 36. from $\frac{1}{4}$ sec. cor.
 bet. sec. 35 and 36.

Ta. 10° E.

In flat.

.50

Trail bears N. E. and S. W.

CHAINS Subdivisions T. 27 N R. 10 E.

6.80 Trail bears N. W. and S. E.

7.70 Trail bears N. W. and S. E.

12.00 Ascend mesa -

20.00 Set a sandstone... 24 X 16 X 4... ins. 18...
 ins. in the ground, for 116... Sec. Cor., marked 116... on
 ...N... face, and raised a mound of stone 1 1-2 ft. high
 2 ft. base, alongside. Pits impracticable.

Surface level and bottom

Soil 3rd. rate

Some brush -

Spring in centre of
 N.W. 1/4 of SW. 1/4 of
 sec. 36.

From the cor. to sec.

25. 26. 35 and 36. I run

No. 1 N. bet. sec. 25 and 26

7a. 13° E.

In flat.

3.20 Enter cornfield from N.E. SW.

5.10 Leave " " " "

CHAINS Subdivisions T 27 N 15 E

20.00 Set a sandstone $2.2 \times 2.2 \times 1\frac{1}{2}$ ins., 2.2 ins. in the ground, for $\frac{1}{16}$ Sec. Cor., marked $\frac{1}{16}$ on $W.$ face, dug pits $18 \times 18 \times 12$ ins., $N.$ and $S.$ of stone 5 1-2 ft. dist., and raised a mound of earth 1-1.2 ft. high, 3 1-2 ft. base, alongside,

Then I run east on a random line through south $\frac{1}{2}$ sec., 25,

7a. 13° E.

20.00 Set temporary 1-16 Sec. Cor.

40.00 Set temporary 1-16 Sec. Cor.

60.00 Set temporary 1-16 Sec. Cor.

80.00 Intersect east boundary of Township 9 lines north of $\frac{1}{16}$ sec. cor. then I run $N. 89^{\circ} 56' 7''$ on a true line through south $\frac{1}{2}$ sec. 25.

7a. 13° E.

over mesa.

CHAINS. Subdivisions T. 27 N R. 15 E.

20.00

Set a sandstone $24 \times 8 \times 5$ ins., 18 ins. in the ground, for $\#6$ Sec. Cor., marked $\#6$ on N face, dug pits $18 \times 18 \times 12$ ins., E and W of stone 5 $1-2$ ft. dist., and raised a mound of earth 1 $1-2$ ft. high, 3 $1-2$ ft. base, alongside,

Descend from mesa -

3350 Foot. from $N.E.$ and $SW.$ about 60 ft. high. cross road and trail to Glaystaff from $N.E.$ and $SW.$

40.00

Deposited a marked stone 12 ins. in the ground, for $\#6$ Sec. Cor., dug pits $18 \times 18 \times 12$ ins. E and W of corner 5 $1-2$ ft. dist., and raised a mound of earth 1 $1-2$ ft. high, 3 $1-2$ ft. base over it.

In E pit drove a stake 2 ft. long, 2 ins. square, 12 ins. in the ground, marked $\#6$ S, on N face,

4365 Enter cornfield from $N. 10^\circ E$ and $S. 10^\circ W.$

60.00

Set a sandstone $16 \times 12 \times 3$ ins., 11 ins. in the ground, for $\#6$ Sec. Cor., marked $\#6$ on N face, dug pits $18 \times 18 \times 12$ ins., E and W of stone 5 $1-2$ ft. dist., and raised a mound of earth 1 $1-2$ ft. high, 3 $1-2$ ft. base, alongside,

6790 Trail bears $N.$ and $S.$ W.

7000 Leave cornfield from $N.E.$ and $SW.$

CHAINS Subdivisions T. 27 N. R. 15 E.

80.00

The 1/16 sec. cor.

Surface flat, and mesq
Soil 1st. and 4th rate,
No grass.

Then I continue 21.00176
bet. sec. 25 and 26

7a. 13° E.

40.00

Set a sandstone 24 X 12 X 2 1/2 ins. 18
ins. in the ground, for 1/4 Sec. Cor., marked 1/4 on
...W...face, and raised a mound of stone 1 1/2 ft. high
2 ft. base, alongside. Pits impracticable.

Then I run east on a
random line through
middle sec. 25.

7a. 13° E.

20.00

Set temporary 1-16 Sec. Cor.

40.00

.....Set temporary 1-4 Sec. Cor.

60.00

Set temporary 1-16 Sec. Cor.

79.90 Inhibit east. boundary

CHAINS Subdivisions T. 27 N R. 10 E.

of Township 12, units north
of 1/4 sec. cor. There, I
run N. 89° 55' W. on a
faint line through middle
Sec. 25.

7th. 13° E.

over mesa.

7:00 Descend from mesa

7:50 Foot. bear. N. 10° E. and S. 10° W.

Grass. trail and road. bear,
N. E. and SW.

1498 Set a sandstone $15 \times 10 \times 5$ ins., 10 ins.
in the ground, for 1/6 Sec. Cor., marked 1/6 on N.
face, dug pits $18 \times 18 \times 12$ ins., E. and W. of stone
5 1-2 ft. dist., and raised a mound of earth 1 1-2 ft.
high, 3 1-2 ft. base, alongside,

7:30 Enter cornfield bear, N.E. and SW.

3995 Set a sandstone $16 \times 14 \times 3$ ins., 11 ins.
in the ground, for 1/4 Sec. Cor., marked 1/4 on N.
face, dug pits $18 \times 18 \times 12$ ins., E. and W. of stone
5 1-2 ft. dist., and raised a mound of earth 1 1-2 ft.
high, 3 1-2 ft. base, alongside,

7:00 Leave cornfield bear. N.E. and SW.

CHAINS Subdivisions T. 27 N. 15 E.

59.93 ^{line} Set a sandstone 16 X 15 X 2 1/2 ins., 11 ins. in the ground, for 1/16 Sec. Cor., marked 1/16 on N. face, dug pits 18x18x12 ins. E. and W. of stone 5 1-2 ft. dist., and raised a mound of earth 1 1-2 ft. high, 8 1-2 ft. base, alongside,

64.82 Big trail bears N.E.S.

71.20 Trail bears N. E. and S. W.

76.30 Trail bears N. E. and S. W.

79.90 The 14 sec. cor.

Surface flat and mesa
Soil 1st. and 4th rate
Some brush

Thence I continue N. 0° 1' N.
bet. Secs. 25 and 26.

52.00 Ascend. leave flat bears
N.E. and S.W.

60.00 Set a sandstone 23 X 10 X 5 ins., 17 ins. in the ground, for 1/16 Sec. Cor., marked 1/16 on W. face, dug pits 18x18x12 ins. N. and S. of stone 5 1-2 ft. dist., and raised a mound of earth 1 1-2 ft. high, 8 1-2 ft. base, alongside,

CHAINS. Subdivisions T. 27 N R. 15 E.

Thence I run east on a
random line through north
 $\frac{1}{2}$ sec. 25.

Ya. 13° E.

20.00 Set temporary 1-16 Sec. Cor.

40.00 Set temporary 1-16 Sec. Cor.

60.00 Set temporary 1-16 Sec. Cor.

79.95 Inhibit east boundary of
township 6 links north
of $\frac{1}{16}$ sec. cor. Thence I
run N. $89^{\circ} 57' 11''$ on
a true line through north
 $\frac{1}{2}$ sec. 25.

Ya. 13° E.

3.00 Descend from mesa
19.99 Foot bear. N and S. and

Set a sandstone $18 \times 12 \times 2$ ins. 12 ins.
in the ground, for $\frac{1}{16}$ Sec. Cor., marked $\frac{1}{16}$ on N...
face, dug pits $18 \times 18 \times 12$ ins., E. and W. of stone
5 1-2 ft. dist., and raised a mound of earth 1 1-2 ft.
high, 3 1-2 ft. base, alongside,

CHAINS Subdivisions T. 27 N. R. 15 E.

33.85

Wash. 40 lks. wide course, SW

3998

Set a ^{matita} sandstone 18 X 14 X 13 ins., 12 ins.
 in the ground, for $\frac{1}{16}$ Sec. Cor., marked $\frac{1}{16}$ on N...
 face, dug pits 18x18x12 ins., E. and W. of stone
 5 1-2 ft. dist., and raised a mound of earth 1 1-2 ft.
 high, 3 1-2 ft. base, alongside,

5996

Set a ^{lime} sandstone 17 X 11 X 13 ins., 11 ins.
 in the ground, for $\frac{1}{16}$ Sec. Cor., marked $\frac{1}{16}$ on N...
 face, dug pits 18x18x12 ins., E. and W. of stone
 5 1-2 ft. dist., and raised a mound of earth 1 1-2 ft.
 high, 3 1-2 ft. base, alongside,

61.57

Trail bears N. E. and S. W.

70.00 Leave flat ascend mountain
 from N.E. and SW.

79.95

The $\frac{1}{16}$ sec. cor.

Surface flat and rough
 Soil 1st and 4th rate
 Some grass
 Dense greasewood 5-5 chs.
 in flats.

Subdivisions T. 27 N R. 15 E.

Then I continue N. 00° 11' W. 66 ft.
 Secs. 25 and 26.

30.00 Set a ^{lime} sandstone $24 \times 12 \times 2\frac{1}{2}$ ins. 18
 ins. in the ground for Cor. to Secs. 23, 24, 25 and 26
 marked with 2 notches on S. and 1 notch on E.
 edges, dug pits 18X18X12 in. in each Sec. 5 1-2 ft.
 dist. and raised a mound of earth 2 ft. high, 4 1-2 ft.
 base, alongside.

Surface 40 chs. level
 40 chs. rough and rolling
 Soil 1st and 3rd rate.
 Some socraton grass.

Then I run east. on
 a random line bet. secs.
 24 and 25.

Pa. 13° E.

20.00 Set temporary 1-16 Sec. Cor.

40.00.....Set temporary 1-4 Sec. Cor.

60.00 Set temporary 1-16 Sec. Cor.

80.00 Intersect east. Boundary

18

CHAINS. Subdivisions T 27 ~~at~~ 15

of Township at cor. to
secs. 19, 24, 25 and 30,
thence I run west on
a true line bet. secs.
24 and 25

7/8. 13° E.

Descending

+0.00 Leave mesa enter flat
beas. N.E. and S.W.

18.47 Trail beas. N.E.

20.00 Set a sandstone 18 X 12 X 3 ins. 12 ins.
in the ground, for 1/4 Sec. Cor., marked 1/6 on N.
face, dug pits 18x18x12 ins. E. and W. of stone
5 1-2 ft. dist., and raised a mound of earth 1 1-2 ft.
high, 3 1-2 ft. base, alongside,

26.00 Trail beas N. E. and S. W.

28.80 Wash... 6... lks. wide course, SW

40.00 Deposited a marked stone 12 ins. in the ground,
for 1/4 Sec. Cor., dug pits 18X18X12 ins. E. and
W. of corner 5 1-2 ft. dist., and raised a mound of
earth 1 1-2 ft. high, 3 1-2 ft. base over it.

In E. pit drove a stake 2 ft. long, 2 ins. square,
12 ins. in the ground, marked 1/4 S, on N. face,

CHAINS Subdivisions T. 27 N R. 15 E.

56.15 Trail bears N. E. and S. W.

60.00 Set a sandstone $12 \times 8 \times 6$ ins., 8 ins. in the ground, for $\frac{1}{6}$ Sec. Cor., marked $\frac{1}{6}$ on N... face, dug pits $18 \times 18 \times 12$ ins., E. and W. of stone 5 1-2 ft. dist., and raised a mound of earth 1 1-2 ft. high, 3 1-2 ft. base, alongside,

70.00 Same flat, accud

80.00 The cor. To sec 23, 24, 25 and 26

Surface flat 60 chs. mesa 20 chs.

Dense brush 60 chs. in flat.

Soil 1st and 2nd. rate

CHAINS Subdivisions T. 27 N. 13° E. R. 15 E.

Trail on a true line through
south $\frac{1}{2}$ sec. 24.
from $\frac{1}{16}$ sec. Cor. bet.
secs. 19 and 24.

$79, 13^{\circ} E.$

In dense brush.

18.32 Wash $\frac{1}{16}$ s. lks. wide course, SW.

20.00 Set a sandstone $18 \times 14 \times 2\frac{1}{2}$ ins., 12 ins.
in the ground, for $\frac{1}{16}$ Sec. Cor., marked $\frac{1}{16}$ on N...
face, dug pits $18 \times 18 \times 12$ ins., E. and W. of stone
5 1-2 ft. dist., and raised a mound of earth 1 1-2 ft.
high, 3 1-2 ft. base, alongside,

27.00 Trail bears N. E. and S. W.

29.54 Trail bears N. E. and S. W.

40.00 Deposited a marked stone 12 ins. in the ground,
for $\frac{1}{16}$ Sec. Cor., dug pits $18 \times 18 \times 12$ ins. E. and
W. of corner 5 1-2 ft. dist., and raised a mound of
earth 1 1-2 ft. high, 3 1-2 ft. base over it.

In E. pit drove a stake 2 ft. long, 2 ins. square,
12 ins. in the ground, marked $\frac{1}{16}$ S. on N. face,

50.80 Trail bears N. E. and S. W.

60.00 Set a sandstone $18 \times 13 \times 3$ ins., 12 ins.
in the ground, for $\frac{1}{16}$ Sec. Cor., marked $\frac{1}{16}$ on N...
face, dug pits $18 \times 18 \times 12$ ins. E. and W. of stone
5 1-2 ft. dist., and raised a mound of earth 1 1-2 ft.
high, 3 1-2 ft. base, alongside,

CHAIN Subdivisions T. 27 N R. 15 E

Land north lies to the west,
and mountainous -
Surface level.
Soil 1st. rate.
Dense brush.

West. through middle sec.
24. from 1/4 sec. cor.
T. 13° E.

In flat.

10.30 Wash.....lks. wide course, SW.

11.00 Trail bears N. E. and S. W.

20.00 Deposited a marked stone 12 ins. in the ground,
for 1/4 Sec. Cor., dug pits 18X18X12 ins. E....and
...W....of corner 5 1-2 ft. dist., and raised a mound of
earth 1 1-2 ft. high, 3 1-2 ft. base over it.

In ...E. pit drove a stake 2 ft. long, 2 ins. square,
12 ins. in the ground, marked 1/6 S, on ...N. face,

40.00 Deposited a marked stone 12 ins. in the ground,
for 1/4 Sec. Cor., dug pits 18X18X12 ins. E. and
W....of corner 5 1-2 ft. dist., and raised a mound of
earth 1 1-2 ft. high, 3 1-2 ft. base over it.

In ...E. pit drove a stake 2 ft. long, 2 ins. square,
12 ins. in the ground, marked 1/4 S, on ...N. face,

CHAINS, Subdivisions T. 27 N. 10 R. 25 E.

Bluffs a few chains west.
Surface flat.
Soil 1st. rate
Dense brush.

West, ^{through} north $\frac{1}{2}$ sec. 24
from $\frac{1}{16}$ sec. cor.
Ta. 13° E.

In flat.

20.00

Deposited a marked stone 12 ins. in the ground,
for $\frac{1}{16}$ Sec. Cor., dug pits $18 \times 18 \times 12$ ins. ... E. and
... W. of corner 5 1-2 ft. dist., and raised a mound of
earth 1 1-2 ft. high, 3 1-2 ft. base over it.

In E. pit drove a stake 2 ft. long, 2 ins. square,
12 ins. in the ground, marked $\frac{1}{16}$ S, on N. face,

3800

Trail bears N. E. and S. W.

40.00

Set a ^{lime} sandstone $18 \times 10 \times 6$ ins., 12 ins.
in the ground, for $\frac{1}{16}$ Sec. Cor., marked $\frac{1}{16}$ on N.
face, dug pits $18 \times 18 \times 12$ ins. E. and W. of stone
5 1-2 ft. dist., and raised a mound of earth 1 1-2 ft.
high, 3 1-2 ft. base, alongside,

Bluffs to the west.
Surface flat.

CHAINS Subdivisions T. 27 N. R. 15 E.

Soil pt. note

Dense brush

From the cor. To sec 13, 18,
19, and 24, on the east
boundary. I run West.
bet. Secs 13 and 24.

Va. 13° E.

20.00

Deposited a marked stone 12 ins. in the ground,
for $\frac{1}{16}$ Sec. Cor., dug pits 18X18X12 ins. ... E... and
... W... of corner 5 1-2 ft. dist., and raised a mound of
earth 1 1-2 ft. high, 3 1-2 ft. base over it.

In ... E... pit drove a stake 2 ft. long, 2 ins. square,
12 ins. in the ground, marked $\frac{1}{16}$ S, on ... N... face,

Bluffs west.

Surface flat.

Soil pt. note

Scattered brush

9

CHAINS. Subdivisions T. 27 N. R. 15 E.

West. south $\frac{1}{2}$ sec. 13T. 13^a E.

20.00

Set a sandstone $24 \times 13 \times 3$ ins., 18 ins.
 in the ground, for $\frac{1}{6}$ Sec. Cor., marked $\frac{1}{6}$ on N...
 face, dug pits $18 \times 18 \times 12$ ins., E... and W... of stone
 5 1-2 ft. dist., and raised a mound of earth 1 1-2 ft.
 high, 3 1-2 ft. base, alongside.

Bluffs on west.

Surface flat.

Soil 1st. rate

Some brush.

No Grass.

Several sheep hinders,
 stone huts N.W. of cor.
 against foot of bluffs.

CHAINS Subdivisions T. 27 N R. 15 E.

General description -

The foregoing field notes embrace all the agricultural land in this township - and is good land - It is farmed by the Shi-mop-ovi Indians.

Its close proximity to water makes it very valuable -

The remainder of the township is broken and mountainous.

John B. Smith
U.S.D.S.

June 5th 1891.

For final notes see Book 47

U. S. Surveyor-General's Office,

TUCSON, A. T., *Feb 6th* 1882

The foregoing Field Notes of the Surveys of
Subdivisions of T^h 27 N
R. 15. E. of the

Gila and Salt River Meridian
 in *Arizona* executed by

Columb Smith
 U. S. Deputy Surveyor, under his contract dated
November 2nd 1880

having been critically examined, the necessary corrections and explanations made, the said Field Notes and the surveys they describe are hereby approved.

Rapal & Johnson

U. S. Surveyor-General
 for the Territory of Arizona.