

BOOK 651

651

651

F I E L D N O T E S
OF THE SURVEY OF THE
SUBDIVISION LINES
OF
Township 6 North, Range 7 East.
Gila and Salt River Base and
Meridian,
ARIZONA.
By R. C. Powers, D. S., under
Contract dated July 20, 1883.
Survey commenced Dec. 29, 1887.
Survey completed Jan. 9, 1888.

Township No. 6 South Range No. 7 East, Gila & Salt River Meridian

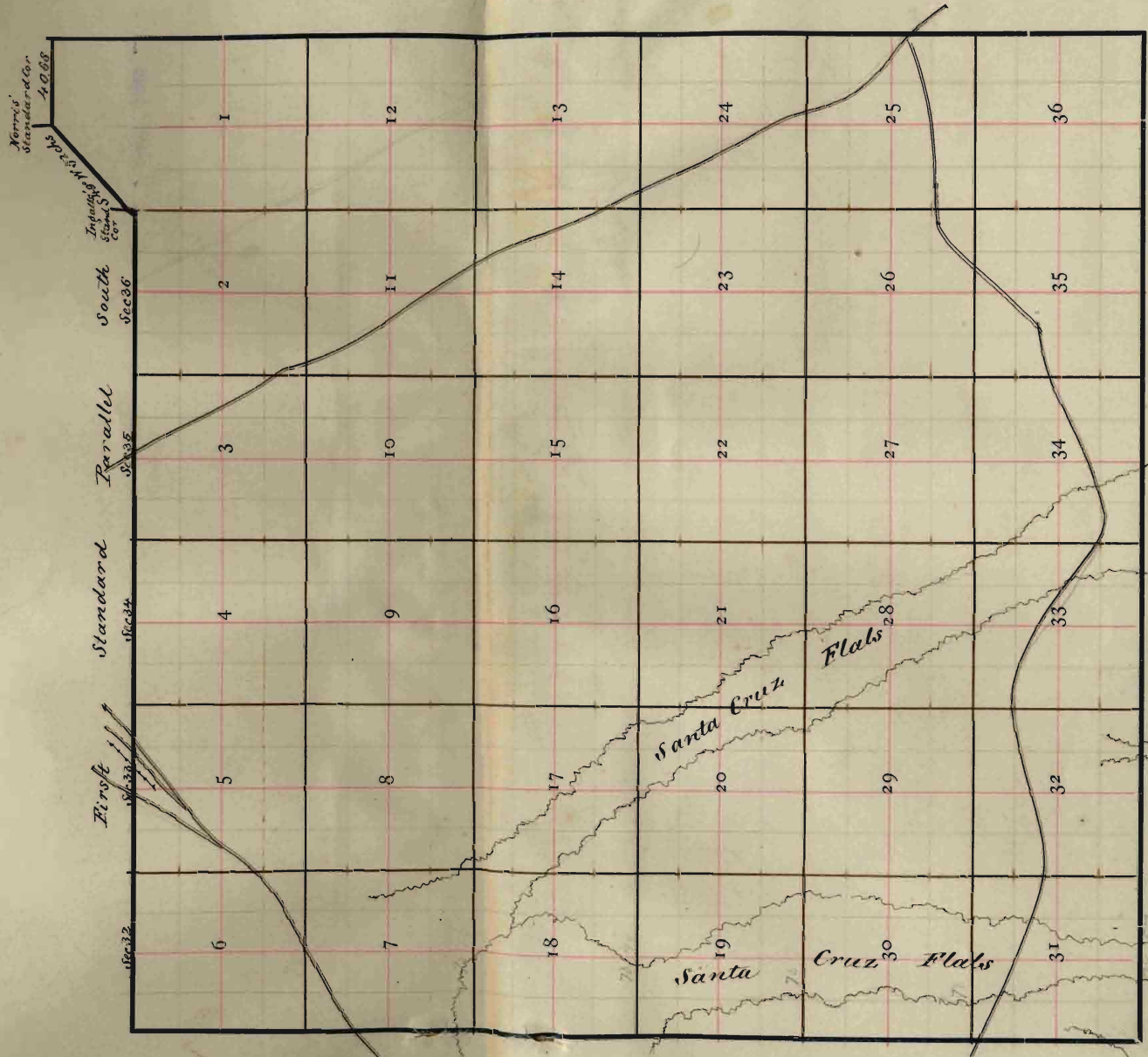

Township Plot.
Meridian Line,

1A

(4-674.)

Township *6 South* R. *7 East*

BOOK 651

6	81	5	65	4	49	3	33	2	18	1
86		85		64		48		32		17
7	84	8	62	9	47	10	31	11	15	12
82		81		61		45		30		14
18	80	17	60	16	44	15	28	14	12	13
78		77		58		42		27		11
19	75	20	57	21	41	22	26	23	9	24
74		73		55		40		24		8
30	71	29	54	28	38	27	23	26	6	25
70		69		53		37		22		5
31	67	32	51	33	35	34	20	35	4	36

2
BOOK 651

No. 651

Field Notes
of the Survey of the
Subdivision Lines
of
Township No 6 South, Range No 7 East
of the
Gila and Salt River Bas & Meridian
of
Arizona Territory
as surveyed by
R. C. Powers
U. S. Deputy Surveyor
Under his Contract No 41
Dated July 20th 1883

Survey commenced Dec 29th 1887
Survey completed Jan 9th 1888

Subdivisions T. 6 S. R. 4 E.

Chains

Preliminary to commencing this survey I ran North on a blank line on the East boundary of Sec 36 and at 40.01 chs found the $\frac{1}{4}$ sec cor. and at 80.03 chs found the sec cor. I also ran West on a blank line on the South boundary of Sec 36 and at 39.97 chs found the $\frac{1}{4}$ sec cor. and at 80 chs found the sec cor. My compass will therefore run the same line as the exterior boundaries, and the chaining practically agrees.

Survey commenced Dec 29th 1887. with a Buato improved solar compass with telescope attachment.

I commenced at the cor to Sec 36

Subdivisions T6.S.R7E. Continued
 chains

1. 2. 35 and 36 on the S. boundary
 of the Township previously established
 and described by me

Thence S 90°

North bet Secs 35 & 36

Var $12^{\circ}48'E$.

Over level ground

40.00 Set a mesquite post 3 ft long 3 ins
 square with marked stone 12 ins in
 the ground for $\frac{1}{4}$ sec cor. marked
 $\frac{1}{4}$ S on W. face, dug pits 18×18
 $\times 12$ ins N & S of post $5\frac{1}{2}$ ft dia
 and raised a mound of
 earth $1\frac{1}{2}$ ft high $3\frac{1}{2}$ ft base
 around post

80.00 Set a mesquite post 4 ft long
 4 ins square with marked stone
 12 ins in the ground for cor to
 Secs 25-26-35 & 36 marked

Subdivisions
Chain

T. 6 S. R. 7 E. Continued

T. 6 S. S. 25 on NE

R. 7 E. S. 36 on SE

S. 35 on SW end

S. 26 on NW. faces with

1 notch on S and E edges dug pits
18 x 18 x 12 ins in each sec 5 1/2 ft dia

and raised a mound of earth
2 ft high 4 1/2 ft base around foot
Land level

Soil yellow loam 1st rate

Dense greasewood, sage brush
and mesquite entire mile.

East on a random line bet Secs 25 & 36

Var 12° 48' E.

Over level ground

40.00 Set temporary 1/4 sec cor.

80.00 Intersect E boundary of Sp.

32 lbs S of the cor to sec 25

Subdivisions

Chaus

T6 S. R 7 E. Continued

30. 31 & 36 previously established
and described by me

Thence S. 89° 46' W. on a true line bet

secs 25 & 36 with same \overline{D} .

40.00 Set a mesquite post 3 ft long 3 in
square with marked stone 12 in
in the ground for $\frac{1}{4}$ sec cor. marked
 $\frac{1}{4}$ S on N. face, dug pits 18x18x12
in E & W. of post and raised
a mound of earth $1\frac{1}{2}$ ft high
 $3\frac{1}{2}$ ft base around post

80.00 The cor to secs 25. 26. 35 & 36

Land level

Soil yellow loam 1st rate

None greasewood entire mile

North bet Secs 25 & 26

\overline{D} 12° 48' E

Subdivisions T6 S. R7 E Continued

Over level ground

- 16.00 Cross ranch road bears E & W.
- 40.00 Set a mesquite post 3 ft long
3 ins square with marked stone
12 ins in the ground for $\frac{1}{4}$ Sec
cor. marked $\frac{1}{4}$ S on W. face
dry pits 18 x 18 x 12 ins. N & S.
of post 5 $\frac{1}{2}$ ft diam. and raised
a mound of earth 12 ft high
3 $\frac{1}{2}$ ft base around post
- 80.00 Set a mesquite post 4 ft long
4 ins square with marked
stone 12 ins in the ground for
cor to secs 23, 24, 25 and 26
marked
- T. 6 S. S. 24 on NE
R 7 E S. 25 on SE
S. 26 on SW and
S. 23 on NW. faces

Subdivisions T₆S. R 7E Continued

with 2 notches on S and 1 notch
on E edges, dug pits 18x18x12
ins in each sec 5½ ft dia
and raised a mound of earth
2 ft high 4½ ft base around
post

Land level

Soil yellow loam

Dense greasewood sage brush
and mesquite entire mile

East on a random line bet secs 24 & 25

Var. 12° 47' E

Over level ground

- 40.00 Set temporary ¼ sec cor.
52.85 Cross old road bears N 12° W & S 12° E.
79.85 Intersect E boundary of Tp 27 N
S of the cor to secs 19. 24. 25 & 30
previously established and

Subdivision T6 S R 7 E Continued
 Chain

described by me

Thence I run

S $89^{\circ}48'$ W. on a true line bet
 Secs 24 & 25 with same bar.

39.92 Set a mesquite post 3 ft long 3 ins
 square with marked atop 12 ins
 in the ground for $\frac{1}{4}$ Sec cor. marked
 $\frac{1}{4}$ S on N. face, dig pits 18 X 18 X 12
 ins E & W. of post $5\frac{1}{2}$ ft dist and
 raised a mound of earth $1\frac{1}{2}$ ft
 high $3\frac{1}{2}$ ft base around post

79.85 The cor to secs 23.24.25 & 26

Land level

Soil yellow loam 1st rate

Some brush entire mile.

North bet Secs 23 & 24

Var $12^{\circ}47'$ E.

Over level ground

Subdivision T6 S. R7 E Continued

Chairs

40.00

Set a mesquite post 3 ft long 3 ins square with marked stone 12 ins in the ground for $\frac{1}{4}$ sec cor marked $\frac{1}{4}$ S on W. face, dug pits 18x18x12 ins NW S of post $5\frac{1}{2}$ ft dist and raised a mound of earth $1\frac{1}{2}$ ft high $3\frac{1}{2}$ ft base around post

80.00

Set a mesquite post 4 ft long 4 ins square with marked stone 12 ins in the ground for cor to secs 13, 14, 23 and 24 marked T6 S. S. 13. on NE
R7 E S. 24 on SE
S. 23 on SW and
S. 14 on NW faces with 3 notches on S and 1 notch on E. edges, dug pits 18x18x12 ins in each sec $5\frac{1}{2}$ ft dist and raised a mound of earth 2 ft high

Subdivision T6. S. R. 4 E. Cont'd

Chambers

4½ ft base around part.

Land level

Soil yellow loam

Dense sage brush and mesquite
brush entire mile

East on a random line bet Secs

13 and 24

Var. $12^{\circ}48'E$

Over level ground

10.92 Cross old road bears NW & SE.

40.00 Set temporary ¼ sec cor.

79.92 Intersect E boundary of Township

32 lks S of the cor. to secs 13. 18. 19

and 24 previously established
and described by me

Thence I run

S $89^{\circ}46'W$ on a true line bet

Secs 13 & 24 with same Var

Subdivision T6 S. R7 E Continued
 Cham

39.96 Set a mesquite post 3 ft long 3 in square with marked stone 12 in in the ground for $\frac{1}{4}$ sec even marked $\frac{1}{4}$ S. on N. face, dug pits 18x18x12 in E & W of post 5 $\frac{1}{2}$ ft diam and raised a mound of earth $1\frac{1}{2}$ ft high 3 $\frac{1}{2}$ ft base around post.

79.92 The cor to secs 13, 14, 23 & 24.

Land level

Soil sedimentary 1st rate

Dense brush entire mile

North bet secs 13 & 14

Var $12^{\circ}48'E$

Over level ground

17.00 Cross old road bears $N20^{\circ}W$ and SE.

40.00 Set a mesquite post 3 ft long 3 in square with marked stone 12 in

Subdivisions T. 6 S. R. 7 E Continued

in the ground for $\frac{1}{4}$ sec cor marked
 $\frac{1}{4}$ S on W face, dug pits 18 X 18 X 12
 ins N & S of post $5\frac{1}{2}$ ft dist and
 raised a mound of earth $1\frac{1}{2}$ ft
 high $3\frac{1}{2}$ ft base around post.

80.00 Set a meaprite post 4 ft long 4 ins
 square with marked stone 12 ins
 in the ground for cor to secs 11, 12
 13 & 14 marked

T. 6 S. S. 12 on NE

R. 7 E S. 13 on SE

S. 14 on SW and

S. 11 on NW face with
 4 notches on S and 1 notch on
 E edges, dug pits 18 X 18 X 12 ins
 in each sec $5\frac{1}{2}$ ft dist and
 raised a mound of earth
 2 ft high $4\frac{1}{2}$ ft base around
 post.

Subdivision T6S. R7E Continued
 Chain

Land level

Soil yellow loam 1st rate

Dense sage and mesquite brush
 entire mile

Dec 29th 1887

East on a random line bet Secs 12 & 13

Var $12^{\circ}47'E$.

Over level ground

40.00 Set temporary $\frac{1}{4}$ Sec cor.

80.10 Intersect E boundary of Tp 42 N. S. of the cor to Secs 7. 12. 13 & 18 previously established and described by me.

Fence I run

S. $89^{\circ}42'W$ on a true line bet Secs 12 & 13 with same Var.

40.05 Set a mesquite post 3 ft long 3 ins square with marked atom 12 ins in the ground for $\frac{1}{4}$ Sec cor

Subdivisions F. C. R. 7 E Continued
 Chain

marked $\frac{1}{4}$ S on N. face dry pits 18
 x 18 x 12 ins E & W. of post 5 $\frac{1}{2}$ ft dist
 and raised a mound of earth
 1 $\frac{1}{2}$ ft high 3 $\frac{1}{2}$ ft here around post

80.10 The cor to secs 11, 12, 13 & 14

Land level

Soil yellow loam 1st rate.

Dense sage and mesquite
 brush entire mile.

North bet Secs 11 & 12

Var 12° 47' E.

Over level ground

70.10 Set a mesquite post 3 ft long
 3 ins square with the marked stem
 12 ins in the ground for $\frac{1}{4}$ Sec
 cor. marked $\frac{1}{4}$ S. on N. face
 dry pits 18 x 18 x 12 ins N & S of
 post 5 $\frac{1}{2}$ ft dist and raised

Subdivision T6 S. R. 7 E Continued

a mound of earth $1\frac{1}{2}$ ft high
 $3\frac{1}{2}$ ft base around post

80.00 Set a mesquite post 4 ft long x ins
 square with marked stone 12 ins in
 the ground for cor to secs 1, 2, 11, 12
 12 marked

T. 6 S. S. 1 on NE

R 7 E S. 12 on SE

S. 11 on SW and

S. 2 on NW faces, with
 5 matches on S and 1 match on
 E edges, dug pits 18 x 18 x 12 ins in
 each sec $5\frac{1}{2}$ ft dia and raised
 a mound of earth 2 ft high
 $4\frac{1}{2}$ ft base around post
 Land level

Soil yellow loam, 1st rate

Dense sage brush and scrub
 mesquite entire mile.

Subdivision T6 S. R 7 E Continued

East on a random line bet Secs 1 & 12.

Var. $12^{\circ}48'E$.

Over level ground

40.00 Set temporary $\frac{1}{4}$ Sec cor.

80.00 Intersect E boundary of Township
38 lks S of the cor. to secs 1, 6, 7 &
12. previously established and
described by me.

Thence I run

$S 89^{\circ}44'W$. on a true line bet
Secs 1 & 12. with same Var.

40.00 Set a mesquite post 3 ft long
3 ins square with marked stone
12 ins in the ground for $\frac{1}{4}$ Sec
cor. marked $\frac{1}{4}$ S on N. face
dry pits 18 X 18 X 12 ins E & W
of post $5\frac{1}{2}$ ft diam and raised
a mound of earth $1\frac{1}{2}$ ft high
 $3\frac{1}{2}$ ft base around post

Subdivisions T. 6 S. R. 7 E Cont.

Chain

80.00 Tie cor to Secs 1, 2, 11 & 12.

Land level

Soil yellow loam 1st rateDense sage and mesquite
brush entire mile.North on a true line bet Secs 1 & 2
Dir. $12^{\circ}48'E$.

Over level ground

40.00 Set a mesquite post 3 ft long
3 ins square with marked stem
12 ins in the ground for $\frac{1}{4}$ Sec
Cor marked $\frac{1}{4}$ S on W. face,
dug pits 18 X 18 X 12 ins N & S of
post and raised a mound
of earth $1\frac{1}{2}$ ft high $3\frac{1}{2}$ ft base
around post.80.22 Intersect first Standard Parallel
South 20 Ws E of the Standard

Subdivisions T6 S. R7 E. Contins^d

Chambers

Cor to Tps 5 and 6 S. R's 7 & 8
 E. previously established and
 described by me, at which point
 I set a mesquite post 4 ft long
 4 ins square with marked stone
 12 ins in the ground for Closing
 Corner to secs 1 & 2. marked
 C. C. T. 6 S. R 7 E on S
 S 1 on E and
 S 2 on W faces with 1 notch
 on E and 5 notches on W. edges
 dug pits 18 X 18 X 12 ins S. E & W.
 of post 5 1/2 ft dist and raised
 a mound of earth 2 ft high 4 1/2 ft
 base around post.

Land level

Soil yellow loam 1st rate

Dense sage brush and scrub
 mesquite entire mile

Dec 30^{*} 1887

Subdivisions
Chains

F. E. S. R & E. Weston

At 12 o'clock M. today I found latitude to be $32^{\circ}56'N.$ and my compass in good adjustment

From the cor to Secs 2, 3, 34 & 35 on the S. boundary of the Township previously established and described by me

I run

North bet Secs 34 & 35

Var. $12^{\circ}49'E.$

Over level ground

40.00 Set a mesquite post 3 ft long 3 ins square with marked stone 12 ins in the ground for $\frac{1}{4}$ sec. cor. marked $\frac{1}{4}$ sec. cor. marked $\frac{1}{4}$ S on W. face dug pits 18 x 18 x 12 ins N & S of post $5\frac{1}{2}$ ft dist and raised a mound of earth $1\frac{1}{2}$ ft high $3\frac{1}{2}$ ft base

Subdivision T6 S. R7 E Section 1 d

Chams

around post

45.00 Cross road bears E & W.

80.00 Set a mesquite post 4 ft long 4 ins square with marked stone 12 ins in the ground for cor to also 26.27 34 & 35 marked

T. 6 S. S. 26 on NE

R 7 E S. 35 on SE

S. 34 on SW and

S. 27 on NW face, with 1 notch on S and 2 notches on E edges, dry pits 18 x 18 x 12 ins in each sec 5 1/2 ft dist. and raised a mound of earth 2 ft high

4 1/2 ft base around post

Land level

Soil yellow loam 1st rate

Dense greasewood and scrub

Subdivision T6 S. R 7 E Continued
 Chain

mesquite entire mile.

East on a random line bet Secs 26 & 35
 Var $12^{\circ}47'E$.

Over level ground

- 40.00 Set temporary $\frac{1}{4}$ sec cor.
 58.00 Epos road head N & and S W.
 80.22 Intersect N & S line 30 lks S of the cor
 to secs 25. 26. 35 & 36

Thence S run

S $89^{\circ}47'W$. on a true line bet Secs
 26 & 35 with same Var.

- 40.11 Set a mesquite post 3 ft long 3 ins
 square with marked stone 12 ins in
 the ground for $\frac{1}{4}$ Sec cor. marked
 $\frac{1}{4}$ S on N. face, dug pits $18 \times 18 \times 12$ ins
 E & W. of post $5\frac{1}{2}$ ft dist and
 raised a mound of earth $1\frac{1}{2}$ ft
 high $3\frac{1}{2}$ ft base around post
 80.22 The cor to secs 26. 27. 34 & 35

Subdivisions T6 S. R 4 E Continued.

Chains

Land level

Soil yellow loam

Some greasewood and scrub mesquite entire mile.

North lot Secs 26 & 27.

Dir. 12° 47' E.

11.12

Over level ground

40.00 Set a mesquite post 3 ft long 3 in square with marked atow 12 in in the ground for $\frac{1}{4}$ sec cor.

marked $\frac{1}{4}$ S. on W. face, dug pits 18 x 18 x 12 in N & S of post 3 $\frac{1}{2}$ ft dist and raised a mound of earth $\frac{1}{2}$ ft high 3 $\frac{1}{2}$ ft base around post

80.00 Set a mesquite post 4 ft long 4 in square with marked atow 12 in in the ground for cor

Subdivisions T6 S. R7 E continued

to secs 22, 23, 26 & 27, marked

T6 S. of 23. on NE

R7 E S. 26 on SE

S. 27 on SW and

S. 22 on NW faces, with

2 notches on S and E edges, dug
pits 18 X 18 X 12 ins in each sec 5 1/2 ft
diam and raised a mound of
earth 2 ft high 4 1/2 ft base around
post.

Land level

Soil yellow loam 1st rate

Dense sage brush and mesquite
entire mile.

East on a random line bet secs 23 & 26.

Var 12° 47' E.

Over level ground

40.00 Set temporary 1/4 sec cor.

Subdivisions T6S. R7E Continued

80.05 Intersect N & S line 23 lks S. of the
cor to secs 23, 24, 25 & 26

Thence I run

S. $89^{\circ}50'$ W. on a true line bet secs
23 & 26 with same bar.

40.04 Set a mesquite post 3 ft long 3 ins
square with marked stone 12 ins
in the ground for $\frac{1}{4}$ sec cor marked
 $\frac{1}{4}$ S on N. face, dig pits 18 x 18 x 12
ins. E & W. of post $3\frac{1}{2}$ ft dist
and raised a mound of earth
 $1\frac{1}{2}$ ft high $3\frac{1}{2}$ ft here around post.

80.08 The cor to secs 22, 23, 26 & 27

Land level

Soil yellow loam 1st rate

Dense sage brush and mesquite
entire mile.

Subdivision 'T.C.S. R.7E Continued
 Chain

North bet secs 22 and 23.

Var $12^{\circ}47'E$.

Over level ground.

40.00 Set a mesquite post 3 ft long 3 in square with marked stone 12 in in the ground for $\frac{1}{4}$ sec cor marked $\frac{1}{4}$ S on W face, dug pits 18 x 18 x 12 in N & S of post $5\frac{1}{2}$ ft dist and raised a mound of earth $1\frac{1}{2}$ ft high $3\frac{1}{2}$ ft base around post.

80.00 Set a mesquite post 4 ft long 4 in square with marked stone 12 in in the ground for cor to secs 14, 15, 22 and 23 marked.

T.C.S. S. 14 on NE

R. 7E S. 23 on SE

S. 22 on SW and

S. 15 on NW faces, with 3 notches on S and 2 notches on E edges,

Subdivision T. 6 S. R. 7 E. Continued
 Thoms

dry pits 18 x 18 x 12 ins in each sec 5 1/2 ft
 dist and raised a mound of earth
 2 ft high 4 1/2 ft base around post
 Land level

Soil yellow loam 1st rate

Scarcely any brush and mesquite,
 entire mile

East on a random line bet Secs 14 & 23

Var. 12° 47' E.

Over level ground

70.00 Set temporary 1/4 Sec cor.

80.08 Intersect N & S line 19 Chs S. of the
 cor to secs 13, 14, 23 & 24

Thence I run

S 89° 52' W. on a true line bet
 Secs 14 & 23 with same var.

40.04 Set a mesquite post 3 ft long
 3 ins square with marked

Subdivisions T.P.S. R7E. continued

Chains

stone 12 ins in the ground for $\frac{1}{4}$ sec.
 cor. marked $\frac{1}{4}$ S on N. face, dug pits
 18 X 18 X 12 ins. E & W. of post 5 ft
 dist and raised a mound of
 earth $1\frac{1}{2}$ ft high $3\frac{1}{2}$ ft base around
 post

80-08 The cor to secs 14, 15, 22 & 23.

Land level

Soil yellow loam 1st rate

Dense sage brush, greasewood and
 scrub mesquite entire mile

Dec 31st 1887.

North bet Secs 14 & 15

Var. 12047 E.

Over level ground

40-00 Set a mesquite post 3 ft long 3 ins
 square with marked stone 12 ins in
 the ground for $\frac{1}{4}$ sec cor. marked
 $\frac{1}{4}$ S. on W. face, dug pits 18 X 18 X 12

Chams
 Subdivision T6 S. R7 E. continued

80.00 in N8 S of post 5 1/2 ft dist and
 raised a mound of earth 1 1/2 ft
 high 3 1/2 ft base around post
 Set a mesquite post 4 ft long 4
 in square with marked stone
 12 in in the ground for cor to sec
 10. 11. 14 and 15 marked

T6 S. S. 11 on NE

R7 E S. 14 on SE

S. 15 on SW and

S 10 on NW faces with 4
 notches on S and 2 notches on E
 edges, dug pits 18 x 15 x 12 in in
 each sec 5 1/2 ft dist and raised
 a mound of earth 2 ft high
 4 1/2 ft base around post
 Land level

Soil yellow loam 1st rate

Scuse sage, greasewood and

Subdivision T. S. R. & C. continued
 Chains
 mesquite brush entire mile

East on a random line bet Secs 11 & 14
 Var. $12^{\circ}47'E$.

Over level ground

40.00 Set temporary $\frac{1}{4}$ Sec cor.

57.90 Cross old road bears $N22^{\circ}W$.

79.90 Intersect N & S line at cor to secs 11.
 12, 13 & 14

Fence Line

West on a true line bet Secs 11 & 14
 with same Var.

39.95 Set a mesquite post 3 ft long 3 ins
 square with marked stone 12 ins
 in the ground for $\frac{1}{4}$ Sec cor marked
 $\frac{1}{4}$ S. on N. face, dug pits 18 x 18 x 12 ins
 E & W. of post 5 $\frac{1}{2}$ ft dia. and
 raised a mound of earth 1 $\frac{1}{2}$ ft
 high 3 $\frac{1}{2}$ ft base around post

Subdivisions T₆S. R7E Continued

79.90 The cor to secs 10. 11. 14 & 15.

Land level

Soil yellow loam 1st rate

Some brush entire mile.

North bet Secs 10 & 11

Var 12° 47' E

Over level ground

40.00 Set a mesquite post 3 ft long 3 ins square with marked stone 12 ins in the ground for $\frac{1}{4}$ Sec cor. marked $\frac{1}{4}$ S on. W face, dug pits 18 x 18 x 12 ins N & S of post 3 $\frac{1}{2}$ ft dist and raised a mound of earth 1 $\frac{1}{2}$ ft high 3 $\frac{1}{2}$ ft bare around post

80.00 Set a mesquite post 4 ft long 4 ins square with marked stone 12 ins in the ground for cor to secs 2. 3. 10 and 11 marked

Subdivisions T6 S. R7 E. Continued

Chains

T-6 S. S 2 on NE

R7 E S. 11 on SE

S 10 on SW and

S. 3 on NW faces, with 5 notches
on S and 2 notches on E edges, dug pits

18 x 18 x 12 ins in each sec 5 1/2 ft dia
and raised a mound of earth

2 ft high 4 1/2 ft base around post
Land level

Soil yellow loam 1st rate.

Dense sage brush mesquite and
greasewood entire mile

East on a random line bet Secs 2 & 11

Var. $12^{\circ}48' E$.

Over level ground

59.92 Cross old road bears $N25^{\circ} W$.

40.00 Set temporary 1/4 sec cor.

79.92 Intersect N & S line 14 lks S. of the

Subdivisions T6 S. R4 E. Continued

over to secs 1, 2, 11 & 12.

Thence I run

$S 89^{\circ} 54' W.$ on a true line bet Secs 2
& 11 with same Var.

99.96 Set a mesquite post 3 ft long 3 ins
square with marked stow 12 ins in
the ground for $\frac{1}{4}$ Sec cor. marked
 $\frac{1}{4}$ S on N. face, dig pits 18 x 18 x 12 ins
E & W of post 5 $\frac{1}{2}$ ft dist and raised
a mound of earth 1 $\frac{1}{2}$ ft high 3 $\frac{1}{2}$ ft
base around post

99.92 Thence over to Secs 2, 3, 10 & 11

Level level

Soil yellow loam 1st rate

Dense brush entire mile

North on a true line bet Secs 2 & 3

Var. $12^{\circ} 48' E.$

Over level ground

Subdivision T. 5. R. 7E. Continued

Chains

- 17.00 Cross old road bears $N 30^{\circ} W$ and $S 20^{\circ} E$.
- 40.00 Set a mesquite post 3 ft long 3 ins square with marked stone 12 ins in the ground for $\frac{1}{4}$ sec. cor. marked $\frac{1}{4}$ S on W face, dug pits $18 \times 18 \times 12$ ins N & S of post $5\frac{1}{2}$ ft dist and raised a mound of earth $1\frac{1}{2}$ ft high $3\frac{1}{2}$ ft base around post.
- 80.20 Intersect First Standard Parallel South 15 lks E of the Standard cor. to secs 35 & 36 T. 5. S. R. 7E. previously described by me
At this point I set a mesquite post 4 ft long 4 ins square with marked stone 12 ins in the ground for Closing Corner to secs 2 & 3 marked
C.C. T. 5. S. R. 7E on S
S 2 on E and

Subdivisions, T. S. R. & C. Continued

3 on W. face, with 2 notches on E
and 4 notches on W. edges dry pits
18x18x12 ins S. E and W. of post $5\frac{1}{2}$ ft
dist and raised a mound of earth
2 ft high $4\frac{1}{2}$ ft base around post
Land level

Soil yellow loam 1st rate

Some brush entire mile

Jan 2^d 1888

From the cor to Secs 3. 4. 33 & 34
on the S boundary of the Township
previously established and described
by me

I run

N. bet Secs 33 & 34

Var $12^{\circ}49'8$

In Santa Cruz Plats

20.00 Cross road bears E & W.

Subdivisions T. 6 S. R. 7 E. Continued

chains

- 40.00 Set a mesquite post 3 ft long 3 ins square with marked stone 12 ins in the ground for $\frac{1}{4}$ Sec cor marked $\frac{1}{4}$ S. on W face, dug pits 18 x 18 x 12 ins N & S of post $5\frac{1}{2}$ ft dist and raised a mound of earth $1\frac{1}{2}$ ft high $3\frac{1}{2}$ ft base around post.
- 60.00 Leave Santa Cruz river flats bearing $N 20^{\circ} W$.
- 80.00 Set a mesquite post 4 ft long 4 ins square with marked stone 12 ins in the ground for cor. to secs 27, 28, 33 & 34 marked
 T. 6 S. S. 27 on NE
 R. 7 E S. 34 on SE
 S. 33 on SW and
 S. 28 on NW face, with 1 notch on S and 3 notches on E. edges, dug pits 18 x 18 x 12 ins in

Subdivisions T.S. R7E. Continued

Chains

each also $5\frac{1}{2}$ ft dist and raised a mound of earth 2 ft high $4\frac{1}{2}$ ft base around post.

Land level

Soil yellow loam 1st rate.

Several sage and mesquite bush entire mile.

Cast on a random line bet Secs 27 & 34

Var. $12^{\circ}47'E$.

Over level ground

40.00 Set temporary $\frac{1}{4}$ Sec cor.

80.00 Intersect N & S line 34 lks S of the cor. to Secs 26, 27, 34 & 35

Thence I run

S. $89^{\circ}45'W$. on a true line bet Secs 27 & 34 with same Var.

40.00 Set a mesquite post 3 ft long 3 ins square with marked stone 12 ins

Subdivisions T6 S. R 7 E. continued

Chain

in the ground for $\frac{1}{4}$ Sec cor. marked
 $\frac{1}{4}$ S. on N. face, dug pits 18 x 18 x 12 ins
 E & W. of post $5\frac{1}{2}$ ft dist and
 raised a mound of earth $1\frac{1}{2}$ ft
 high $3\frac{1}{2}$ ft base around post.

80.00 The cor to secs 27. 28. 33 & 34.

Land level

Soil yellow loam 1st rate.

Dense sage and mesquite brush
 entire mile.

North bet Secs 27 and 28

Var $12^{\circ} 47' E$.

Over level ground

40.00 Set a mesquite post 3 ft long
 3 ins square with marked stone
 12 ins in the ground for $\frac{1}{4}$ Sec
 Cor. marked $\frac{1}{4}$ S on W face
 dug pits 18 x 18 x 12 ins N & S

Subdivision T6 S. R7 E. Continued

marks

of post $5\frac{1}{2}$ ft dist and raised a mound of earth $1\frac{1}{2}$ ft high $3\frac{1}{2}$ ft base around post.

80.00 Set a mesquite post 4 ft long 4 in square with marked atom 12 in in the ground for cor to Secs 21-22 27 & 28 marked

T. 6 S. S. 22 on NE

R7 E S 27 on SE

S. 28 on SW and

S. 21 on NW faces, with 2 marks on S and 3 notches on E edges, dug pits $18 \times 18 \times 12$ in in each sec $5\frac{1}{2}$ ft dist and raised a mound of earth 2 ft high $4\frac{1}{2}$ ft base around post.

Land level

Soil yellow loam

Sense break entire mile.

Subdivision T. S. R. & E. continued

Chain

✓ East on a random line bet Secs
22 & 27

Var $12^{\circ}48'E$.
Over level ground

40.00 Set temporary $\frac{1}{4}$ Sec cor.

80.10 Intersect N & S line 19 Chs S of
the cor to Secs 22, 23, 26 & 27

Thence I run

$S 89^{\circ}52'W$. on a true line bet
Secs 22 & 27. with same Var.

40.05 Set a mesquite post 3 ft long
3 ins square with marked stone
12 ins in the ground for $\frac{1}{4}$ Sec
cor. marked $\frac{1}{4}$ Sec on N. face
dry pits 18 x 18 x 12 ins E & W
of post $5\frac{1}{2}$ ft diam and raised
a mound of earth $1\frac{1}{2}$ ft high
 $3\frac{1}{2}$ ft base around post.

80.10 Th cor to Secs 21, 22, 27 and 28

Subdivisions T6 S. R7 E. Continued

Land level

Soil yellow loam 1st rate

Dense sage and mesquite brush
entire mile.

North bet Secs 21 & 22

Var. $12^{\circ} 48' E$

Over level ground

40.00 Set a mesquite post 3 ft long 3 ins
square with marked stone 12 ins
in the ground for $\frac{1}{4}$ Sec cor.

marked $\frac{1}{4}$ S. on W. face, dig pits
18 x 18 x 12 ins N & S of post $3\frac{1}{2}$ ft
dirt and raised a mound of
earth $1\frac{1}{2}$ ft high $3\frac{1}{2}$ ft base around
post

80.00 Set a mesquite post 4 ft long
4 ins square with marked stone
12 ins in the ground for cor to

Subdivisions T. 6 S. R. 7 E. Continued

Secs 15, 16, 21 & 22 marked

T. 6 S. S. 15 on NE

R 7 E S. 22 on SE

S. 21 on SW. and

S. 16 on NW. faces, with

3 notches on S and E edges, dug

pits 18 x 18 x 12 ins in each

sec 5 1/2 ft dist and raised a

mound of earth 2 ft high 4 1/2 ft

base around post.

Land level

Soil yellow loam 1st rate

Dense sage brush and mesquite
entire mile.

East on a random line bet Secs

15 & 22.

Var. 12° 47' E.

Over level ground

Subdivisions T6 S. R7 E Continued

- 40.00 ^{bars} Set temporary $\frac{1}{4}$ sec cor.
 9.90 Intersect N & S line 47ths S of
 the cor to Secs 14, 15, 22 & 23.

Then we run

- S. $89^{\circ}40'$ W. on a true line bet
 Secs 15 & 22. with same bar
 9.95 Set a mesquite post 3 ft long 3 ins
 square with marked stone 12 ins
 in the ground for $\frac{1}{4}$ sec cor. marked
 $\frac{1}{4}$ S. on N. face, dig pits 18 x 18 x
 12 ins. E & W. of post $5\frac{1}{2}$ ft dist
 and raised a mound of earth
 $1\frac{1}{2}$ ft high $3\frac{1}{2}$ ft base around post
 9.90 The cor. to Secs 15, 16, 21 & 22
 Land level
 Soil yellow loam 1st rate
 Dense brush entire mile

Subdivisions T6 S. R7 E. continued
 Charcos

North bet Secs 15 & 16

Var. $12^{\circ}47'E$.

Over level ground

40.00 Set a mesquite post 3 ft long 3 in square with marked stone 12 in in the ground for "4 Sec Cor." marked $\frac{1}{4}$ S on W. face, dig pits 18 x 18 x 12 in N & S of post $5\frac{1}{2}$ ft dist and raised a mound of earth $1\frac{1}{2}$ ft high $3\frac{1}{2}$ ft base around post.

80.00 Set a mesquite post 4 ft long 4 in square with marked stone 12 in in the ground for cor to Secs 9, 10, 15 & 16 marked
 T. 6 S. S. 10 on NE
 R7 E. S. 15 on SE
 S. 16 on SW and
 S. 9, 6 on NW faces, with

Subdivision T6 S. R7 E. Continued

4 notches on S and 3 notches on E
edges, dry pits $18 \times 18 \times 12$ ins in each
sec $5\frac{1}{2}$ ft dist and raised a
mound of earth 12 ft high $4\frac{1}{2}$ ft
base around post

Land level

Soil yellow loam 1st rate

Dense sedge brks and mesquite
entire mile.

Jan 3^d 1888

V East on a random line bet Secs 10 & 15

Dir. $12^{\circ} 47' E.$

Over level ground

10.00 Set temporary $\frac{1}{4}$ Sec cor.

9.95 Intersect N & S line 27 lks S of
the cor to secs 10. 11. 14 & 15

Thence S run

S $89^{\circ} 48' W.$ on a true line bet

Chinus
 Subdivision T.C. S. R. 7 E. Continued

Secs 10 & 15 with same var.

39.97 Set a mesquite post 3 ft long 3 in square with marked stone 12 in in the ground for $\frac{1}{4}$ sec cor. marked $\frac{1}{4}$ S on N. face, dug pits 18 x 18 x 12 in E & W. of post $5\frac{1}{2}$ ft dist and raised a mound of earth $1\frac{1}{2}$ ft high $3\frac{1}{2}$ ft base around post

79.95 The cor. to Secs 9, 10, 15 & 16.

Land level

Soil yellow loam 1st rate

Dense sage and mesquite brush entire mile.

North bet Secs 9 & 10

Var. $12^{\circ}47'E$.

Over level ground

40.00 Set a mesquite post 3 ft long 3 in square with marked stone

Subdivision T6 S. R7 E. Continued

12 ins in the ground for $\frac{1}{4}$ sec cor.
 marked $\frac{1}{4}$ S on W face, dry pits 18 x
 18 x 12 ins N & S of post $5\frac{1}{2}$ ft dist
 and raised a mound of earth
 $1\frac{1}{2}$ ft high $3\frac{1}{2}$ ft base around post.
 Set a mesquite post 4 ft long 4 in
 square with marked stone 12 ins
 in the ground for cor to Secs 3, 4
 9 and 10 marked

T. 6 S. S. 3 on N & E

R7 E. S. 10 on S & E

S. 9 on S W and

S. 4 on N W face, with
 5 notches on S and 3 notches
 on E edges, dry pits 18 x 18 x 12 ins
 in each sec $5\frac{1}{2}$ ft dist. and
 raised a mound of earth 2 ft
 high $4\frac{1}{2}$ ft base around post
 Land level

Chambers
 Subdivision T S R 7 E Continued

Soil yellow loam 1st rate
 Dense brush entire mile.

East on a random line bet Secs 3 & 10
 Var. $12^{\circ} 47' E$.

40.00 Set temporary $\frac{1}{4}$ Sec Cor.

80.00 Intersect N & S line 22 lbs S.
 of the cor to Secs 2, 3, 10 & 11

Thence I run

$S 89^{\circ} 54' W$. on a true line bet
 Secs 3 & 10 with same Var.

40.00 Set a mesquite post 3 ft long
 3 ins square with marked
 stone 12 ins in the ground for
 $\frac{1}{4}$ Sec cor. marked $\frac{1}{4}$ S. on N
 face, dug pits $18 \times 18 \times 12$ ins E
 and W. of post $5\frac{1}{2}$ ft dist
 and raised a mound
 of earth $1\frac{1}{2}$ ft high $3\frac{1}{2}$ ft diam

Subdivision T. S. R. & E. continued
 around post

50.00 Set a box to secos 2, 3, 10 and 11

Land level

Soil yellow loam 1st rate.

Dense brush entire mile.

North on a true line bet Secos 3 & 4.

Dir. $12^{\circ}47'$ E.

Over level ground

40.00 Set a mesquite post 3 ft long 3
 ins square with marked stone
 12 ins in the ground for $\frac{1}{4}$ Sec cor.
 marked $\frac{1}{4}$ S on W. face, dug pits
 18 x 18 x 12 ins N & S of stone $5\frac{1}{2}$
 ft dist and raised a mound
 of earth $1\frac{1}{2}$ ft high $3\frac{1}{2}$ ft base
 around post.

30.28 Intersect the First-Standard -
 Parallel-South, 16 lks W. of the

Subdivisions T6 S. R7 E Continued
chain

Standard corner to Secs 34 and 35. T6 S. R7 E previously established and described by me. At which point I set a mesquite post 4 ft long 4 ins square with marked at one 12 ins in the ground for closing corner to Sec 3 and 4 marked C.C.

T6 S. R7 E on S

S 3 on E and

S 4 on W. face, with 3 notches on E and W. faces, dug pits 18 x 18 x 12 ins S. E and W. of post 5½ ft diam and raised a mound of earth 2 ft high 4½ ft base around post.

Land level

Soil yellow loam 1st rate

Dense brush entire site

Jan 4th 1888

Subdivisions T. 1. R. 7. E. Continued

From the bar to Secs 4, 5, 32 & 33
on the S. boundary of the Township
previously established and
described by me.

I run

North bet Secs 32 & 33

Var. $12^{\circ}49'6''$.

Over level ground

40.00 Set a mesquite post 4 ft long
4 ins square with marked stone
12 ins in the ground for $\frac{1}{4}$ Sec cor.
marked $\frac{1}{4}$ S. on W. face, dug pits
18 x 18 x 12 ins N & S of post $5\frac{1}{2}$ ft
dist and raised a mound of
earth $1\frac{1}{2}$ ft high $3\frac{1}{2}$ ft base around
post.

6.00 Cross road bears S. 60° E and W.

0.00 Set a mesquite post 4 ft long
4 ins square with marked stone

Subdivisions F. G. S. R 7 E. continued
 then

12 ins in the ground for cor to
 secs 28, 29, 32 & 33. marked.

F. G. S. S. 28 on NW

R 7 E S. 33 on SE

S. 32 on SW and

S. 29 on NW faces with

1 notch on S and 4 notches on

E edges, dug pits 18 x 18 x 12 ins

in each sec 5 1/2 ft dist and

raised a mound of earth

2 ft high 4 1/2 ft base around

post.

Land level

Soil yellow loam 1st rate

Dense sage brush greasewood

and mesquite entire mile

East on a random line bet secs 28 & 33

Var 12° 49' E

Subdivisions T. 6 S. R. 7 E. continued

^{thru} Over level ground

36.86 Enter Santa Cruz river flats bearing
N 20° W.

40.00 Set temporary $\frac{1}{4}$ Sec cor.

5.86 Leave Santa Cruz Flats course N 25° W
and S 25° E

19.86 Intersect N & S line 15 lks S. of the
cor to Secs 27. 28. 33 & 34

Thence I run

S. 89° 54' W. on a true line bet Secs
28 & 33. with same bar.

39.93 Set a mesquite post 3 ft long 3 ins
square with marked stone 12 ins
in the ground for $\frac{1}{4}$ Sec cor. marked
 $\frac{1}{4}$ S. on N. face, dug pits 18 X 18 X 12
ins E & W. of post 5 $\frac{1}{2}$ ft dia and
raised a mound of earth 1 $\frac{1}{2}$ ft
high 3 $\frac{1}{2}$ ft base around post

79.86 The cor to secs 28. 29. 32 & 33

Subdivision T6 R7 E. continued
 chains

Land level

Soil yellow loam 1st rate

Dense brush and mesquite
 entire mile.

North bet Secs 28 & 29

Var. $12^{\circ}49' E$.

Over level ground.

- 40.00 Set a mesquite post 3 ft long
 3 ins square with marked atom
 12 ins in the ground for $\frac{1}{4}$ Sec
 cor. marked $\frac{1}{4}$ S on W. face
 dug pits 18 x 18 x 12 ins N & S of
 post $5\frac{1}{2}$ ft dist and raised
 a mound of earth $1\frac{1}{2}$ ft high
 $3\frac{1}{2}$ ft base around post.
- 68.00 Enter Santa Cruz river flats
 bearing $N20^{\circ}W$ and $S20^{\circ}E$.
- 80.00 In flats set a mesquite

Thomas
 Subdivisions T6 S. R7 E. continued

post 4 ft long 4 ins square with
 marked stone 12 ins in the ground
 for cor to Secs 20, 21, 28 & 29 marked

T. 6 S. 21 on NE

R7 E S. 28 on SE

S. 29 on SW and

S. 20 on NW faces, with

2 notches on S and 4 notches on
 E edges, dug pits 18 X 18 X 12 ins in
 each sec 5 1/2 ft dist and raised a
 mound of earth 2 ft high 4 1/2 ft
 base around post

Land level

Soil loam 1st rate

Sense say and mezzinte track
 entire mile.

East on a random line bet Secs 21 & 28

Dir. 120° 47' E

Subdivision T. S. R. 76 Continued
 thence

- Over level ground
- 35.84 Leave Santa Cruz river flats bearing
 N. 18° W.
- 40.00 Set temporary $\frac{1}{4}$ Sec cor.
- 79.84 Intersect N and S line 26 lks S.
 of the cor. to Secs 21, 22, 27 and 28
 Thence S run
 S. 89° 49' W. on a true line bet
 Secs 21 & 28 with same Var.
- 39.92. Set a mesquite post 3 ft long 3 ins
 square with marked stone 12 ins
 in the ground for $\frac{1}{4}$ Sec cor. marked
 $\frac{1}{4}$ S on N. face, dug pits 18 x 18
 x 12 ins E & W. of post $5\frac{1}{2}$ ft dia
 and raised a mound of earth
 $1\frac{1}{2}$ ft high $3\frac{1}{2}$ ft low around
 post.
- 79.84 The cor to Secs 20, 21, 28 & 29.
 Land level

Subdivisions T6S. R4E. Continued

Soil loam 1st rate

Dense sage and mesquite brush
entire mile.

North lot Secs 20 & 21

Var. $12^{\circ}47'E$.

Over level ground

40.00 Set a mesquite post 3ft long 3 ins
square with marked stone 12 ins
in the ground for $\frac{1}{4}$ Sec cor. marked
 $\frac{1}{4}$ Sec on W. face, dug pits 18x18x12
ins N & S of post $5\frac{1}{2}$ ft dist and
raised a mound of earth $1\frac{1}{2}$ ft
high $3\frac{1}{2}$ ft base around post

57.00 Leave Santa Cruz Flats bearing
N 120° W

80.00 Set a mesquite post 4ft long
4 ins square with the marked stone
12 ins in the ground for cor to

Subdivisions T. 6 S. R. 7 E. - Continued
 Chaus

Secs 16, 17, 20 & 21 marked

T. 6 S. S. 16 on NE

R. 7 E. S. 21 on SE

S. 20 on SW and

S. 17 on NW faces with

3 notches on S and 4 notches
 on E edges, dug pits 18 x 18 x 12 ins

in each sec 5 1/2 ft dist and

raised a mound of earth 2 ft
 high 4 1/2 ft base around post
 Land level

Soil yellow loam 1st rate

Dense sage brush and mesquite
 entire mile.

East on a random line bet Secs 16 & 21

Var 12° 47' E.

Over level ground

40.00 Set temporary 1/4 sec cor.

Subdivision T. 6 S. R. 7 E. Continued

79.88 Intersect N & S line 15 lbs. N. of the
cor to Secs 15. 16. 21 & 22.

Thence S run

N $89^{\circ} 34'$ W. on a true line bet Secs
16 & 21. with same Var.

39.94 Set a mesquite post 3 ft long 3 in
square with marked stone 12 in in
the ground for $\frac{1}{4}$ Sec cor. marked
 $\frac{1}{4}$ S on N. face, dug pits 18 x 18 x
12 in E & W. of post $5\frac{1}{2}$ ft dist
and raised a mound of earth
 $1\frac{1}{2}$ ft high $3\frac{1}{2}$ ft base around
post

79.88 The cor to Secs 16. 17. 20 & 21.

Land level

Soil loam 1st rate

Dense sage brush and mesquite
entire mile.

Subdivisions T. 6 S. R. 7 E. Continued

Chains

North bet Secs 16 & 17

Var. $12^{\circ} 47' 6''$.

Over level ground.

40.00 Set a mesquite post 3 ft long
3 ins square with marked stone
12 ins in the ground for $\frac{1}{4}$ sec
cor. marked $\frac{1}{4}$ S. on W. face
dig pits 18 x 18 x 12 ins N & S of
post $5\frac{1}{2}$ ft dist and raised
a mound of earth $1\frac{1}{2}$ ft high
 $3\frac{1}{2}$ ft base around post

80.00 Set a mesquite post 4 ft long
4 ins square with marked
stone 12 ins in the ground for
Cor. to Secs 8, 9, 16 & 17 marked
T. 6 S. S. 9 on NE
R. 7 E S. 16 on SE
S. 17 on SW and
S. 8 on NW faces with

Subdivision T6 S. R7 E. Continued
 chains

4 notches on S and E edges, dug
 pits 18 X 18 X 12 ins in each Sec 5 1/2
 ft dist and raised a mound
 of earth 2ft high 4 1/2 ft base around
 post.

Land level

Soil loam 1st rate

Dense sage brush and mesquite
 entire mile.

East on a random line bet Sec 9 & 16

Var 12° 47' 6"

Over level ground

40.00 Set temporary 1/4 Sec cor.

80.00 Intersect N and S line 21 lks N.
 of the cor to secs 9. 10. 15 & 16.

Thence I run

N. 89° 51' W. on a true line bet
 Secs 9 & 16 with same Var

Subdivisions T6 S. R7E. continued

chains

40.00

Set a mesquite post 3 ft long 3 ins square with marked stone 12 ins in the ground for $\frac{1}{4}$ Sec Cor. marked $\frac{1}{4}$ S. on N. face, dug pits 18 X 18 X 12 ins E & W. of post 5 $\frac{1}{2}$ ft dirt and raised a mound of earth 1 $\frac{1}{2}$ ft high 3 $\frac{1}{2}$ ft base around post.

80.00

The cor to Secs 8, 9, 16 & 17

Land level

Soil yellow loam 1st rate

Dense brush entire mile.

North bet Secs 8 & 9

Var 12° 47' E

Over level ground

40.00

Set a mesquite post 3 ft long 3 ins square with marked stone 12 ins in the ground for

Subdivisions T. 6 S. R. 7 E. Continued
 chains

$\frac{1}{4}$ Sec Cor. marked $\frac{1}{4}$ Sec on W. face
 dry pits 18 X 18 X 12 ins. N & S of
 post $5\frac{1}{2}$ ft dist and raised a
 mound of earth $1\frac{1}{2}$ ft high $3\frac{1}{2}$ ft
 base around post.

80.00 Set a mesquite post 4 ft long
 4 ins square with marked stone
 12 ins in the ground for cor to
 Secs 4, 5, 8 & 9, marked

T. 6 S. S. 4 on N 6

R 7 E S. 9 on S 6

S. 8 on SW and

S. 5 on NW face with
 5 notches on S and 4 notches
 on E edges, dry pits 18 X 18 X 12
 ins in each Sec $5\frac{1}{2}$ ft dist
 and raised a mound of
 earth 2 ft high $4\frac{1}{2}$ ft base
 around post.

Subdivision T6S. R7E Continued
 Chorus

Land level

Soil loan 1st rate

Denise sage brush and mesquite

✓ East on a random line bet Secs 4 & 9

Var. $12^{\circ} 48' E$.

40.00 Set temporary $\frac{1}{4}$ Sec cor.

79.80 Intersect N & S line at the Cor
 to Secs 3, 4, 9, & 10

Thence I run

W. on a true line bet Secs 4 & 9
 with same Var.

39.90 Set a mesquite post 3 ft long 3 ins
 square with marked stem 12 ins
 in the ground for $\frac{1}{4}$ Sec cor. on a true
 $\frac{1}{4}$ S. on N. face dig pits 18 X 18 X 12
 ins E & W. of post $5\frac{1}{2}$ ft dist
 and raised a mound of
 earth $1\frac{1}{2}$ ft high $3\frac{1}{2}$ ft base around

Subdivision P. C. S. R. & C. Continued

Chains

post

79.80 The cor to Secs 4, 5, 8 & 9.

Land level

Soil lower 1st rate

Some sage and mesquite brush.

North on a true line bet Secs 4 & 5

Var. $12^{\circ}48'6''$.

Over level ground

40.00 Set a mesquite post 3 ft long 3 in square with marked stone 12 in in the ground for $\frac{1}{4}$ Sec Cor. marked $\frac{1}{4}$ S. on W. face, dug pits 18 x 18 x 12 in N & S. of post $5\frac{1}{2}$ ft dist and raised a mound of earth $1\frac{1}{2}$ ft high $3\frac{1}{2}$ ft base around post.

80.37. Intersect 1st Standard Parallel South 25th W. of the Land Cor. to

Subdivision 76 S. R 7 E. Continued
 Chaus

Secs 33 & 34 Tp 5 S. R 7 E previously established and described by me.

At this point I set a mesquite post 4 ft long 4 in square with marked stone 12 in in the ground for closing corner to Secs 4 & 5 marked C.C.

Set P. to S. R 7 E on S.

S. 4 on E and

S 5 on W. faces, with 4 notches on E and 2 notches on W edges dug pits 18 x 18 x 12 in S. E and W of post 5 1/2 ft diam and raised a mound of earth 2 ft high 4 1/2 ft base around post.

Land level

Soil loam 1st rate

Some sage and mesquite brush

Jan 6th 1887

at 12 o'clock M to day I found the

Subdivision T6 S. R7 E Continued

hams

latitude to be $32^{\circ}56'N.$ and my
Compass in good adjustment

From the Cor. to Secs 5. 6. 31 & 32
on the S. boundary of the Township
previously established and de-
scribed by me

I run

North bet Secs 31 & 32

$N. 12^{\circ}50' E.$

Over level ground

40.00 Set a mesquite post 3 ft long
3 ins square with marked stone
12 ins in the ground for $\frac{1}{4}$ Sec
Cor. marked $\frac{1}{4}$ S. on W. face
dig pits $18 \times 18 \times 12$ ins N & S.
of post $5\frac{1}{2}$ ft dia and raised
a mound of earth $1\frac{1}{2}$ ft high
 $3\frac{1}{2}$ ft base around post

Subdivisions T6S. R7E. Continued
Chaus.

57.00 Cross road bears E & N.

80.00 Set a mesquite post 4 ft long 4 in.
square with marked atom 12 in.
in the ground for cor to Sec 29, 30

31 & 32 marked

T. 6 S. S. 29 on NE

R 7 E S. 32 on SE

S. 31 on SW and

S. 30 on NW. posts with
1 notch on S and 5 notches on
E edges, dug pits 18 x 18 x 12 in.
in each sec 5 1/2 ft dist and
raised a mound of earth 2 ft
high 4 1/2 ft dia around post.

Land level

Soil yellow loam. 1st rate

Sage brush, greasewood and
mesquite entire mile.

Subdivisions T. S. R. & C. continued

hours

East on a random line bet Secs 29 & 32

Var. $12^{\circ}48' E$.

Over level ground.

40.00 Set temporary $\frac{1}{4}$ Sec Cor.

80.00 Intersect N & S line at the Cor
to Secs 28. 29. 32 & 33

Thence I run

W. on a true line bet Secs 29 & 32

with same Var.

40.00 Set a mesquite post 3 ft long 3
ins square with marked atom
12 ins in the ground for $\frac{1}{4}$ Sec
Cor. marked $\frac{1}{4}$ S on N. face dug
pits 18 x 18 x 12 ins E & W. of post
 $5\frac{1}{2}$ ft dia and raised a mound
of earth $1\frac{1}{2}$ ft high $3\frac{1}{2}$ ft base
around post.

80.00 The Cor. to Secs 29. 30. 31. & 32.

Land level

Subdivisions T6S. R7E. Continued
 Chams

Soil yellow loam 1st rate
 Dense sage brush and mesquite

2. West on a true line bet secs 30 & 31
 Var. $12^{\circ}48'E$.

Over level ground.

20.26 Enter Santa Cruz river flats.

40.00 Set temporary $\frac{1}{4}$ sec cor.

61.26 Leave Santa Cruz river flats
 bearing N & S.

78.26 Intersect W. boundary of Tp. 23 N.
 N. of the cor. to secs 25. 30. 31 &
 36 previously established and
 described by me.

Thence I run

N $89^{\circ}50'E$ on a true line bet
 secs 30 & 31 with same Var.

38.26 Set a mesquite post 3 ft long
 3 in square with marked

Subdivisions T. 6 S. R. 7 E. Continued

Plains

stone 12 ins in the ground for $\frac{1}{4}$ sec. cor. marked $\frac{1}{4}$ S on N. face, dug pits 18 x 18 x 12 ins E & W of post 5 $\frac{1}{2}$ ft dirt and raised a mound of earth 1 $\frac{1}{2}$ ft high 3 $\frac{1}{2}$ ft bare around post.

78.26 The cor to Secs 29, 30, 31, & 32

Land level

Soil loan 1st rate

Some brush entire mile.

North bet Secs 29 & 30.

Var. 12° 48' E.

Over level ground

40.00 Set a mesquite post 3 ft long 3 ins square with marked stone 12 ins in the ground for $\frac{1}{4}$ sec cor. marked $\frac{1}{4}$ S. on W. face, dug pits 18 x 18 x 12

Subdivision T. 6 S. R. 7 E. Continued
Chains.

80.00 in N & S of post $5\frac{1}{2}$ ft dist and
 raised a mound of earth $1\frac{1}{2}$ ft
 high $3\frac{1}{2}$ ft base around post.
 Set a mesquite post 4 ft long
 4 in square with marked stone
 12 in in the ground for cor to
 Secs 19, 20, 29 & 30 marked
 T. 6 S. S. 20 on NE
 R. 7 E. S. 29 on SE
 S. 30 on SW and
 S. 19 on NW faces, with
 2 notches on S and 5 notches
 on E. edges, dug pits $18 \times 18 \times 12$ in
 in each sec $5\frac{1}{2}$ ft dist and
 raised a mound of earth 2 ft
 high $4\frac{1}{2}$ ft base around post
 Land level
 Soil yellow loam 1st rate
 Dense brush entire site

Subdivision T. 6 S. R. 7 E. continued

Chain

East on a random line bet Sec. 20 & 29
 Var. $12^{\circ}47'E$.

Over level ground

40.00 Set temporary $\frac{1}{4}$ Sec Cor.

68.12 Enter Santa Cruz river flats
 bearing $N. 10^{\circ}W$ & $S. 15^{\circ}E$.

80.12 Intersect N & S line 29 lks S. of the
 Cor to Secs 20. 21. 28 & 29

Thence I run

$S 89^{\circ}48'W$. on a true line bet Secs
 20 & 29 with same Obs.

70.06 Set a mesquite post 3 ft long 3 in
 square with marked stone 12 in
 in the ground for $\frac{1}{4}$ Sec cor. marked
 $\frac{1}{4} S$ on N. face, dry pits 18 x 18 x 12
 in E & W. of post $5\frac{1}{2}$ ft diam
 and raised a mound of earth
 $1\frac{1}{2}$ ft high $3\frac{1}{2}$ ft base around post

80.12 The cor to Secs 19. 20. 29 & 30

Subdivisions T.C. R. & E. continued

chains

Land level

Soil yellow loam 1st rate

Dense sage brush and mesquite

Went on a random line bet secs 19 & 30

Var. $12^{\circ}47'E$.

Over level ground

13.38 Enter Santa Cruz river flats
bearing N & S.

40.10 Set temporary $\frac{1}{4}$ sec cor.

48.38 Leave Santa Cruz river flats
bearing N & S.

78.38 Intersect W. boundary of T_p 32 lks
N. of the cor to secs 19, 24, 25 & 30
previously established and described
by me

Fence from

$S89^{\circ}46'E$ on a true line bet
secs 19 & 30 with same Var.

Subdivision T6 S. R 7 E. Continued

Chain

38.38 Set a mesquite post 3 ft long 3 in square with marked stone 12 in in the ground for $\frac{1}{4}$ Sec cor. marked $\frac{1}{4}$ S. on N. face, dug pits 18 x 18 x 12 in E & W. of post 5 $\frac{1}{2}$ ft dist and raised a mound of earth 1 $\frac{1}{2}$ ft high 3 $\frac{1}{2}$ ft base around post

78.38 The cor to Secs 19, 20, 29 & 30

Land level

Soil yellow loam 1st rate

Some sage and mesquite brush entire mile.

North bet Secs 19 & 20

N. $12^{\circ} 47' E.$

Over level ground

40.00 Set a mesquite post 3 ft long 3 in square with marked stone 12 in in the ground

Subdivision T. 6 S. R. 7 E. Continued
 Chain

- for $\frac{1}{4}$ sec cor marked $\frac{1}{4}$ S on W face, dug pits 18 X 18 X 12 ins N & S of stone $5\frac{1}{2}$ ft dia and raised a mound of earth $1\frac{1}{2}$ ft high $3\frac{1}{2}$ ft base around post.
- 80.00 Set a mesquite post 4 ft long 4 ins square with marked stone 12 ins in the ground for cor to Secs 17, 18, 19, & 20 marked T. 6 S. S. 17 on NE R. 7 E. S. 20 on SE S. 19 on SW and S. 18 on NW face with 3 notches on S and 5 notches on E edge, dug pits 18 X 18 X 12 ins in each sec $5\frac{1}{2}$ ft dia and raised a mound of earth 2 ft high $4\frac{1}{2}$ ft base around post.

Subdivision T. 6 S. R. 7 E. Continued

Chains

Land level

Soil yellow loam 1st rate.

Dense sage brush and mesquite

East on a random line bet Secs 17 & 20

Var. $12^{\circ} 47' E$.

Over level ground

37.00 Enter Santa Cruz river flats bearing
 $N 40^{\circ} W$ and $S 25^{\circ} E$.

40.00 Set temporary $\frac{1}{4}$ sec cor.

69.00 Leave Santa Cruz river flats
bearing $N. 12^{\circ} W$.

80.00 Intersect N & S. line 12 lks N. of the
cor to Secs 16, 17, 20 & 21

Thence I run

$N. 89^{\circ} 55' W$. on a true line bet
Secs 17 & 20 with same Var.

40.00 Set a mesquite post 2 ft long
3 ins square with marked stone

Subdivision T⁶. S. R⁷ E. Continued
 Chans.

12 ins in the ground for $\frac{1}{4}$ Sec cor.
 marked $\frac{1}{4}$ S on N face, dug pits
 18 x 18 x 12 ins E & W. of post $5\frac{1}{2}$ ft
 dist and raised a mound
 of earth $1\frac{1}{2}$ ft high $3\frac{1}{2}$ ft base
 around post.

80.00 The cor to Secs 17. 18. 19 & 20

Land level

Soil yellow loam

Dense sage brush and mesquite
 entire mile.

Jan 7th 1888.

West on a random line bet Secs 18 & 19
 Var. $12^{\circ} 47' E$.

Over level ground

40.10 Set temporary $\frac{1}{4}$ Sec cor.

41.40 Enter Santa Cruz river
 flats bearing N.W.

Subdivisions T.S. R 7 E. Continued

Chains

- 78.40 Intersect W boundary of Township
47 lks. N. of the cor to Secs 13. 18. 19 &
24 previously established and
described by me
Thence I run
N. $89^{\circ}40' E.$ on a true line bet
Secs 18 & 19 with same bearing.
- 38.40 Let a mesquite post 3 ft long 3 ins
square with marked stone 12 ins
in the ground for $\frac{1}{4}$ Sec cor. near
 $\frac{1}{4}$ S on N face, dig pits 18x18x
12 ins E & W of post $5\frac{1}{2}$ ft dist
and raised a mound of
earth $1\frac{1}{2}$ ft high $3\frac{1}{2}$ ft base around
post.
- 78.40 The cor to Secs 17. 18. 19 & 20
Land level
Soil yellow loam 1st rate
Dense sage brush and mesquite entire
mile

Subdivisions T6S. R7E. Continued

Chans.

North bet Secs 17 & 18

Var. $12^{\circ} 47' E$.

Over level ground

40.00 Set a mesquite post 3 ft long 3 ins square with marked stone 12 ins in the ground for $\frac{1}{4}$ Sec cor. marked $\frac{1}{4}$ S on W face, dug pits 18 X 18 X 12 ins N & S of post $5\frac{1}{2}$ ft dist and raised a mound of earth $1\frac{1}{2}$ ft high $3\frac{1}{2}$ ft high around post.

80.00 Set a mesquite post 4 ft long 4 ins square with marked stone 12 ins in the ground for Cor to Secs 7, 8, 17 & 18 marked

T6S. S. 8 on NE

R7E. S. 17 on SE

S. 18 on SW and

S. 7 on NW face, with

Subdivision T. C. S. R. 76. Continued
 chain

4 notches on S and 5 notches on E
 edges, dug pits 18 x 18 x 12 ins in
 each Sec. 5 1/2 ft dia and raised a
 mound of earth 2 ft high 4 1/2 ft
 base around post.

Land level

Soil yellow loam 1st rate.

Dense sage brush and mesquite
 entire mile.

Cast on a random line bet Secs 8 & 17

Dir. 12° 48' E.

Over level ground

5.75 Leave Santa Cruz river flats bearing
 N 78° SE

40.00 Set temporary 1/4 Sec Cor.

79.75 Intersect N & S line at the cor to
 Secs 8, 9, 16 and 17

Thence S run

Subdivision T.C.S. R7 E. Continued

Chaus

Went on a true line bet Secs 8 & 17
with same Var.

39.87 Set a mesquite post 3 ft long 3 ins
square with marked stone 12 ins in
the ground for $\frac{1}{4}$ Sec Cor. marked
 $\frac{1}{4}$ S. on N. face, dug pits 18 x 18 x 12
ins E & W of post and raised a
mound of earth $1\frac{1}{2}$ ft high $3\frac{1}{2}$ ft
base around post.

79.75 The Cor to Secs 7, 8, 17 and 18
Land level

Soil yellow loam 1st rate

Dense brush entire mile

Went on a random line bet Secs 7 & 18
Var. $12^{\circ}48' E$.

Over level ground

40.00 Set temporary $\frac{1}{4}$ Sec Cor.

41.46 Leave Santa Cruz river flats bearing

Subdivision T6 S. R7 E. Continued

Thence

N. 65° W.

78.46 Intersect W. boundary of Township
52 lks N. of the Cor. to Secs 7. 8. 12. 13 &
18 previously established and described
by me

Thence I run

N 89° 38' E on a true line bet Secs
7 & 18 with same Var.

38.46 Set a mesquite post 3 ft long 3 ins
square with marked stone 12 ins in
the ground for $\frac{1}{4}$ Sec Cor. marked
 $\frac{1}{4}$ S on N. face, dug pits 18 x 18 x 12
ins E & W. of post 5 $\frac{1}{2}$ ft dist and
raised a mound of earth $1\frac{1}{2}$ ft
high 3 $\frac{1}{2}$ ft base around post.

78.46 The Cor to Secs 7. 8. 17 and 18
Land level

Soil loam 1st rate

Dense brush entire mile.

Subdivision T. 6 S. R. 7 E. continued

Chain

North lot Secs 7 & 8

Var. $12^{\circ}48'E$.

Over level ground

8.00 Leave Santa Cruz river flats bearing
 $N50^{\circ}W$ and SE.

40.00 Set a mesquite post 3 ft long 3 in
 square with marked stone 12 in in
 the ground for $\frac{1}{4}$ sec cor. marked
 $\frac{1}{4}$ S on W face, dug pits 18 x 18 x 12
 in NE S of post $5\frac{1}{2}$ ft diam and
 raised a mound of earth $1\frac{1}{2}$ ft
 high $3\frac{1}{2}$ ft base around post

80.00 Set a mesquite post 4 ft long
 4 in. square with marked stone
 12 in in the ground for cor to Secs
 5, 6, 7 and 8 marked
 T. 6 S. S 5 on NE
 R 7 E. S 8 on SE
 S 7 on SW

Subdivision T. 6 S. R. 7 E. Continued

and S 6 on NW. face with 5 notches
 on S and E edges, dug pits 18 X 18 X 12
 ins in each sec $5\frac{1}{2}$ ft dist and
 raised a mound of earth 2 ft
 high $4\frac{1}{2}$ ft base around post.

Land level

Soil to run 1st rate.

Dense brush entire mile.

East on a random line bet Secs 5 & 8

Var. $12^{\circ}49' E$.

Over level ground

40.00 Set temporary $\frac{1}{4}$ Sec cor.

49.70 Intersect N & S line 21 lks S. of the
 cor. to Secs 4, 5, 8 & 9

Thence I run

S $89^{\circ}51' W$. on a true line bet
 Secs 5 & 8 with same Var.

59.85 Set a mesquite post 3 ft long 3 ins

Subdivision T. 6 S. R. 7 E. Continued
 Chains

square with marked stone 12 ins
 in the ground for $\frac{1}{4}$ sec cor.
 marked $\frac{1}{4}$ S. on N. face, dug pits
 18 x 18 x 12 ins E & W. of post $5\frac{1}{2}$ ft
 dist. and raised a mound
 of earth $1\frac{1}{2}$ ft high $3\frac{1}{2}$ ft base
 around post.

79.70 The Cor. to Secs 5. 6. 7 & 8

Land level

Soil loam 1st rate

Shrub brush entire mile

West on a random line bet Secs 6 & 7

Var. $12^{\circ}49'6''$

Over level ground

38.50 Cross road from Casa Grande to
 Florence bearing $N 50^{\circ} E$ & $S 50^{\circ} W$.

78.50 Intersect N. boundary of Township
 37 lks. N. of the cor. to Secs 1. 6. 7 & 8

Subdivisions T6 S. R7 E. continued

Trans

12 previously established and described by me

Thence I run

N $89^{\circ}44'E$ on a true line bet Secs 6 & 7 with same Var.

38.50

Set a mesquite post 3 ft long 3 ins square with marked atom 12 ins in the ground for $\frac{1}{4}$ Sec cor. marked $\frac{1}{4}$ S. on N face dug pits 18 X 18 X 12 ins E & W of post $3\frac{1}{2}$ ft dist and raised a mound of earth $1\frac{1}{2}$ ft high $3\frac{1}{2}$ ft base around post.

78.50

The cor to Secs 5, 6, 7 and 8
Land level

Soil loam 1st rate

Sage brush and scrub mesquite

North on a true line bet Secs 5 & 6
Var. $12^{\circ}49'E$.

Subdivisions T6 S. R 7 E. continued

Chains

- Over level ground
- 25.00 Cross Florence road bears N E & S W.
- 40.00 Set a mesquite post 3 ft long 3 in square with marked atom 12 in in the ground for $\frac{1}{4}$ Sec Cor. marked $\frac{1}{4}$ S. on W. face, dug pits 18 x 18 x 12 in N & S of post 5 $\frac{1}{2}$ ft dia and raised a mound of earth $\frac{1}{2}$ ft high 3 $\frac{1}{2}$ ft base around post.
- 80.65 Intersect First Standard Parallel South 38 lks W. of the cor to Secs 32 & 33 of Tp 5 S. R. 7 E. previously established and described by me. At this point I set a mesquite post 4 ft long 4 in square with marked atom 12 in in the ground for closing corner to Sec 5 & 6 marked
- C.C. T6 S. R 7 E on S

Subdivision T6 S. R4E. Continued

Thaus

S 5 on E and

S 6 on W. face, with 5 notches on E
and 1 notch on W. edge; dry pits
18 X 18 X 12 ins S. E and W. of post
5 1/2 ft dia and raised a mound
of earth 2 ft high 4 1/2 ft base around
post

Land level

Soil loan 1st rate

Sage brush entire mile

Jan 9th 1888.

General Description

This Township is level. The
soil is rich and the ground is
more or less densely covered
with sage brush, greasewood
and scrub mesquite. In
places the brush is almost

Subdivisions T. 6 S. R. 7 E. continued
Chano

impenetrable. There is but one habitation in the Township that of Señor Araglio in the SE $\frac{1}{4}$ of Sec 31. With the exception of the well on his ranch there is no developed water in the township. The Santa Cruz river passes through the Twp. underground. Only during the wet season water spreads over the surface of the State flowing north-westerly.

Ridgely C. Powers,
U.S. Deputy Surveyor

U. S. Surveyor-General's Office,

TUCSON, A. T., Feb 16 1889

The foregoing Field Notes of the Surveys of
subdivision lines,
Township 6 South
Range 7 East

Gila and Salt River Meridian
in Arizona, executed by
R. C. Powers

U. S. Deputy Surveyor, under his contract dated
July 20th 1883
having been critically examined, the necessary correc-
tions and explanations made, the said Field Notes and
the surveys they describe are hereby approved.

John A. Rice
U. S. Surveyor-General
for the Territory of Arizona.