

64

*Printed  
Indexed*  
X d

VOL. 2

No. 653

*Subdivisions*

BOOK 653

4-671

653

FIELD NOTES

GENERAL LAND OFFICE.

Sub. Vol. 2.

T. N.º 6 S. R. N.º 8 E.

Albert J. Cotton

Contract No. 11.

Approved by Com<sup>r</sup>  
G. L. O. - April 24, 1890

Chs.

BOOK 653 66

ground for  $\frac{1}{4}$  sec. Cor.  
Marked -  $\frac{1}{4}$  S. on N. Face  
Sug pits  $18 \times 18 \times 12$ . N.  $\frac{3}{4}$  S. of post  
 $5\frac{1}{2}$  ft. dist. raised mound  
of earth  $1\frac{1}{2}$  ft. high  $3\frac{1}{2}$  ft.  
base around post.

80.00 Set a charred mesquite  
post 4 ft. long 4 ins. eq.  
12 ins. in ground for Cor. to  
Secs. 29-30-31 & 32, Marked:-  
T. 6. S. S. 29 on N. E.  
R. 8. E. S. 32 on S. E.  
S. 31. on S. W. N. S. 30. on N. W. face  
5 notches on N. 1 notch on S.  
Edges. Sug pits  $18 \times 18 \times 12$ .  
Ins. in each sec.  $5\frac{1}{2}$  ft. dist.  
raised mound of earth  
3 ft. high  $4\frac{1}{2}$  ft. base  
around post. Soil 1<sup>st</sup> rate. (Aug 29)

1889

Wis.

E. on a random line bet. secs 29 & 32

Na.  $13^{\circ} 57' E$ ,

40.00 Set temp.  $\frac{1}{4}$  sec. cor.

80.00 Intersect N & S line 57 lks. S. of Cor  
to Secs. 28-29-30 & 33.

Thence Iron S.  $89^{\circ} 36' W$ . on a  
true line bet. secs. 29 & 32

Same Na.

440.00 Set a charred mesquite post  
3 ft. long 3 in. sq. 12 in. in  
ground for  $\frac{1}{4}$  sec. cor.

Marked  $\frac{1}{4}$  S. on N. face

Dug pits 18x18x12. E & W  
of post  $5\frac{1}{2}$  ft. dist. raised  
mound of earth  $1\frac{1}{2}$  ft. high  
 $3\frac{1}{2}$  ft. base around post

80.00 the Cor. to secs. 29-30-31 & 32

Soil 1st. Rate

Ohio,

N. on a random line bet.

Secs. 30 &amp; 31

Na.  $13^{\circ} 57' E$ ,

28.50 Cross road bears N &amp; S,

66.40 Cross old arland stage road  
bears N & S,

74.50 Florence Canal Course S. W.

87.70 Intersect N. boundary of tp.  
10 lks. S. of Cor. <sup>to</sup> Secs. 30-31-25-36which is a mesquite post  
4 ins. sq. marked: -

T. 6. S. 30. on N. E.

R. 8. E. 31. on S. E.

R. 7. E. 36. on S. W.

S. 25. on N. W. faces.

5 notches on N. 1 notch on S.  
edges, pits in each sec.5  $\frac{1}{2}$  ft. dist. 7 mound of earth  
a round post. Thence I run

Obs.

S.  $89^{\circ}57'$  E, on a true line  
Same No.

12.20 Set a charred mesquite post  
3 ft. long, 3 in. sq, 12 in. in  
ground for  $\frac{1}{4}$  sec. cor.

Marked: -  $\frac{1}{4}$  S. on N. face  
Lug pits  $18 \times 18 \times 12$ , E & W,  
of post.  $5\frac{1}{2}$  ft. dist. raised  
wand of earth  $1\frac{1}{2}$  ft. high  
 $3\frac{1}{2}$  ft. base  
around post

82.20 Cor. to secs. 29-30-31 & 32.  
Soil 1<sup>st</sup> Class.

N. bet. secs. 29 & 30,  
No.  $13^{\circ}57'$  E.

36.00 Cross Canal bears E & W.

10.00 Set a charred mesquite post  
3 ft. long, 3 in. sq, 12 in. in  
ground for  $\frac{1}{4}$  sec. cor.

Chis.

80.00

Marked  $\frac{1}{4}$  S. on W. face  
 dug pits  $18 \times 18 \times 12$ . N & S;  
 $5\frac{1}{2}$  ft. dist. Raised  
 mound of earth  $1\frac{1}{2}$  ft. high  
 $3\frac{1}{2}$  ft. base around post  
 Set charred mesquite post  
 4 ft. <sup>long</sup> ~~high~~ 4 in sq. 13 in.  
 in ground for Cor. to sec.  
 19-20-29 & 30. Marked  
 T. 6. S. S. 20 on N. E.  
 R. 8. E. S. 29 on S. E.  
 S. 30 on S. W.  
 S. 19 on N. W. faces,  
 with 2 notches on S.  $\frac{1}{4}$  S 5 notches  
 on the E. edges. Dug pits  
 $18 \times 18 \times 12$  in in each sec.  
 $5\frac{1}{2}$  ft. dist. Raised mound  
 of earth 2 ft. high  $4\frac{1}{2}$  ft  
 base around post.

Obs.

Soil 1<sup>st</sup> class.

mesquite &amp; Sage brush

E. on a random line bet. secs 20 &amp; 29

Va.  $13^{\circ} 57' E$ .+0.00 Set temp.  $\frac{1}{4}$  sec. Cor

+0.00 Intersect N &amp; S. line 20 lks

S. of Cor 40 secs. 20-21-28-29.

Hence I run S.  $89^{\circ} 51' W$ . on

a true line. Same Va.,

+0.00 Set a charred mesquite

post 3 ft. long 3 ins. sq. 12

ins. in ground for  $\frac{1}{4}$  sec cormarked  $\frac{1}{4}$  S. & N. face. Dig

pits 18X18X12 E &amp; W of post

 $5\frac{1}{2}$  ft. dist. raised moundof earth  $1\frac{1}{2}$  ft. high  $3\frac{1}{2}$  ft.

base around post. Sand

level Soil 1<sup>st</sup> class. Mesquite,

(transpire)

Ois.

80.00 Cor. to secs. 19-20-29 &amp; 30.

N. on a random line bet. secs. 19 &amp; 30

Na.  $13^{\circ}57' E.$ 3.50 Road bears S.  $10^{\circ} W.$  N.  $10^{\circ} E.$ 40.00 Set temp.  $\frac{1}{4}$  sec. Cor.81.78 Intersect N. boundary of tp.  
60 lks. S. of Cor to secs. 19-30-24 & 25  
Thence S.  $89^{\circ}34' E.$  on a  
true line

Same Na.

41.78 Set charred mesquite post  
3 ft. <sup>plong</sup> high 3 ins. sq. 12 ins. in  
ground for  $\frac{1}{4}$  sec cor.  
Marked  $\frac{1}{4}$  S. on N. face  
Dig pits 18x18x12 ins. E & W  
of post.  $5\frac{1}{2}$  ft. dist.  
Raised mound of earth  
 $1\frac{1}{2}$  ft. high  $3\frac{1}{2}$  ft. <sup>base</sup> around



Obs.

Base of post.

8178 Cor to Secs. 19-20-29 &amp; 30

Sand level. Soil 1<sup>st</sup> classMesquite  $\frac{1}{4}$  & Oags bush

Sec. 20 is the Desert Claim

of Wm. J. Hunsaker

North bet. secs. 19 &amp; 20

Na.  $13^{\circ} 57' E$ ,9.00 Cross road. Bears N.E.  $\frac{1}{4}$  S. W.

40.00 Set a charred mesquite post

3 ft. long, 3 ins. sq., 12 ins in

ground for  $\frac{1}{4}$  sec cor.Marked  $\frac{1}{4}$  S. on N. face

Dug pits 18x18x12 ins. N &amp; S,

of post  $5\frac{1}{2}$  ft. dist.Raised mound of earth  $1\frac{1}{2}$  ft.high  $3\frac{1}{2}$  ft base around

post.

Chis.

80.00 Set a charred mesquite post  
 4 ft. long 4 in. sq. 12 ins. in  
 ground. for cor. to secs.  
 17-18-19 & 20. marked:-  
 T. 6. S. S. 17 on N. E.  
 R. 8. E. S. 20 on S. E.  
 S. 19. on S. W.  
 S. 18. on N. W. face  
 with 3 notches on S. and 5  
 notches on E. edge. dug  
 pits 18 X 18 X 12 ins in each  
 sec. 5 1/2 ft dist. Raised  
 mound of earth 2 ft. high  
 4 1/2 ft. base around post.  
 Land level. Soil 1st Class

Run a random line bet. 17 & 20.  
 Na.  $13^{\circ} 57' E$ ,

35.00 Road bears N. and S.

Chis.

40.00 Set temp.  $\frac{1}{4}$  S. Cor.  
 50.00 over broken ground  
 80.00 Intersect N & S. line 3 oaks S.  
 of Cor. to Recs. 16-17-20<sup>th</sup> & 21  
 Thence S.  $89^{\circ}47'$  W. on a true  
 line Same Va.

40.00 Set a charred mesquite post  
 3 ft. long, 3 ins. sq. 12 ins in  
 ground for  $\frac{1}{4}$  sec. cor.  
 marked: -  $\frac{1}{4}$  S. on N. face  
 Dig pits 18 X 18 X 12 ins. E & W  
 of post  $5\frac{1}{2}$  ft. dist. raised  
 mound of earth  $1\frac{1}{2}$  ft. high  
 $3\frac{1}{2}$  ft. base around post

80.00 A charred mesquite  
 post 4 ft. long 4 ins. sq.  
 12 ins. in ground Corner  
 to Recs. 17-18-19<sup>th</sup> & 20.  
 Soil 1st Class

Chs.

N. on a random line bet Secs. 18 & 19

Na.  $13^{\circ} 57' E$ ,

40.00 Set temp.  $\frac{1}{4}$  sec Cor.

81.08 Intersect N. boundary of tp.

40 lks. S. of Cor. 4 Secs.:-

18-19-13 & 24, which is

a mesquite post 4 ins. eq.

Marked: T. 6. S. 5. 18 on N. E.

R. 8. E. S. 19, on S. E.

R. 7. E. S. 24, on S. W.

S. 13 on N. W. faces with

(3) three notches on N.  $\frac{3}{4}$  S. edges

pits in each sec.  $5\frac{1}{2}$  ft.

dist.  $\frac{1}{2}$  mound of earth around

post. Thence S.  $89^{\circ} 43' E$ ,

on a true line bet. secs. 18 & 19

Same Va.

41.08

Set a charred mesquite  
post 3 ft. long 3 in. eq. 12 ins.

Obs.

No. 653

in ground for  $\frac{1}{4}$  sec. cor.  
 Marked  $\frac{1}{4}$  S. on N. face  
 Dig pits 18x18x12 ins E & W,  
 of post 5 $\frac{1}{2}$  ft. dist. Raised  
 mound of earth 1 $\frac{1}{2}$  ft. high  
 3 $\frac{1}{2}$  ft. base around post.  
 41.08 The cor to secs. 17-18-19 & 20.  
 Soil 1st class.

North bet. Secs. 17 & 18,  
 Va. 13° 57' E,

40.00 Set a charred mesquite post  
 3 ft. long, 3 in. sq., 2 ins in  
 ground, for  $\frac{1}{4}$  sec. cor.  
 Marked  $\frac{1}{4}$  S. on N. face  
 Dig pits 18x18x12 ins N & S,  
 of post 5 $\frac{1}{2}$  ft. dist. Raised  
 mound of earth 1 $\frac{1}{2}$  ft. high  
 3 $\frac{1}{2}$  ft. base around post

Ohio

80.00

Set a charred mesquite  
post 4 ft. long 4 in. sq. 12 in.  
in ground. For cor. to Secs.  
7-8-17 & 18 marked:—

T. 6. S. 5. 8. on N. E.

R. 8. E. S. 17. on S. E.

S. 18 on S. W.

S. 7 on N. W. faces with  
5 notches on E. & 4 notches on

S. edge. Lay pits in each  
Sec. 18 X 18 X 12 in. 5 1/2 ft. dist

Raised mound of earth 3  
ft. high 4 1/2 ft. base  
around post. Soil 1 ct. deep

Mesquite and Sage brush

Sec. 17 is the Desert Claim of  
Sherman E. Vogt.

Sec. 18 is the Desert Claim of  
George Neale

his.

*E. marandani* bet. sec. 8 & 17  
 Va.  $13^{\circ}57' E$ ,

10.00 Set temp  $\frac{1}{4}$  sec. cor.

9.00 Cross road Bars N & S,

10.60 Intersect  $N^{\frac{2}{3}} S$  line 60 exs<sup>s</sup>,  
 of cor to sec. 8 & 16<sup>4</sup> 17.

Thence S.  $89^{\circ}34' N$ . on a  
 true line bet. 8 & 17.

Same Va.

11.30 Set a charred mesquite  
 post 3 ft. long 3 in. sq.

12 in. in ground for  $\frac{1}{4}$  sec.

Cor. marked  $\frac{1}{4}$  S. on N. face

Dug pits  $18 \times 18 \times 12$  in. E<sup>4</sup> & S

N. of post  $5\frac{1}{2}$  ft. dist.

raised mound of earth  $1\frac{1}{2}$

ft. high  $3\frac{1}{2}$  ft. base

around post.

10.60 The cor. to sec. 7-8-17<sup>4</sup> 18.

Chi.

## Soil let. class

N. on a random bet sec. 7<sup>th</sup> S 18

Na. 13° 57' E.

40.00 Set temp. 1/4 sec. cor.

79.80 Intersect N. boundary of tp.  
60 lks. S. of Corx. to sec. —7.18. 12<sup>th</sup> & 13. which is  
a charred mesquite post

4 ins. sq. Marked: —

T. 6. S. S. 7 on 77, E.

R. 8. E. S. 18 on S. E.

R. 7. E. S. 13 on S. W.

and S. 12, on N. W. faces with  
2 notches on N. & 4 notches  
on S. edges, with pits in  
each sec. 5 1/2 ft. dist.  
and mound of earth around  
post. Hence I run S.



Clis.

89°34' E. on true line'  
bet. sec. 7<sup>th</sup> & 18.

Same No.

39.90 Set a charred mesquite post  
3 ft. long 3 ins. sq. 15 ins. in ground  
for 1/4 sec. cor. marked 1/4 S.  
on N. face. Dig pits 18X18X12  
ins. E<sup>nd</sup> N of post 5 1/2 ft. dist.  
Raise mound of earth 1 1/2 ft.  
high 3 1/2 ft base around post.

79.80 The cor. to sec. 7-8-17<sup>th</sup> & 18.  
Soil 1<sup>st</sup> class.

N. between sec. 7<sup>th</sup> & 8.

No. 13°57' E.

40.00 Set a charred mesquite post  
3 ft. long 3 ins. sq. 12 ins. in  
ground for 1/4 sec. cor. marked  
1/4 S. on N. face. Dig pits

Chis.

18X18X12 ins  $7\frac{1}{2}$  S. of post  
 5 $\frac{1}{2}$  ft. dist. Raised mound  
 of earth 1 $\frac{1}{2}$  ft. high 3 $\frac{1}{2}$  ft.  
 base around post.

80.00 Set a charred mesquite post  
 4 ft. long 4 ins. sq. 13 in in  
 ground for cor. to sec.

5-6-7<sup>th</sup> 8. 4 marked:—

T. 6. S. S. 5 on N. E.

R. 8. E. S. 8 on S. E.

S. 7. on S. N. <sup>4th</sup>

S. 6 on 7. W. faces wood

5 notches on E.  $\frac{1}{2}$  5 notches on

S. edges. Aug pits 18X18X12

in each sec. 5 $\frac{1}{2}$  ft. dist.

Raised mound of earth  
 2 ft. high 4 $\frac{1}{2}$  ft. base around  
 post. Soil 1 $\frac{1}{2}$  rate

Sec. 8. is the Desert Claim

Chis.

of John M. Sestoge

E. on a random line bet. Secs. 5<sup>th</sup> & 8<sup>th</sup>  
 Va.  $13^{\circ} 57' E$ ,

40.00 Set temp.  $\frac{1}{4}$  sec. cor.

80.50 Intersect N<sup>th</sup> S. line & 12<sup>th</sup> E. S.  
 of Cor. to secs. 4-5-8<sup>th</sup> & 9

Thence Iron S.  $89^{\circ} 55' N$ .

on a true line bet secs, 5 & 8

Same Va.

40.25 Set a charred mesquite post

3 ft. long 3 in. sq. 12 in. in

ground for  $\frac{1}{4}$  sec. cor.

marked  $\frac{1}{4}$  S. in 7<sup>th</sup> face

Dug pits E<sup>th</sup> & N. of post

18 $\times$ 18 $\times$ 12 in.  $5\frac{1}{2}$  ft. dist

raised mound of earth  $1\frac{1}{2}$

ft. high  $3\frac{1}{2}$  ft. base

around post.

Chis.

80.50 The cor. to secs. 5-6-7 & 8.  
Soil 1st rate, mesquite  
& sage brush. (July 30<sup>th</sup> 1859)

N. on a random bet. secs. 6 & 7.  
Na.  $13^{\circ} 57' E$ .

40.00 Set. temp.  $\frac{1}{4}$  sec. cor.

79.00 Intersect. N. boundary of tp.

80 lks. S. of Cor. to Secs: -

6-7-1<sup>st</sup> & 2. which is a  
mesquite post 4 in eq.

marked: - T. 6. S. S. 6. on N.E.

R. 8. E. S. 7 on S. E.

R. 7. E. S. 12 on S. W

and S 1 on N. W. faces, with  
1 notch on N.  $\frac{1}{2}$  & 5 notches  
on S. edges. Pits in each  
sec.  $5\frac{1}{2}$  ft. dist. mound  
of earth around post.

Ois.

Hence S.  $89^{\circ} 26' E$ , on a  
true line bet. secs. 6 & 7.  
Same Va.

39.50 Set a charred mesquite post  
3 ft. long 3 ins. sq. 12 ins in  
ground for  $\frac{1}{4}$  sec. cor.  
marked  $\frac{1}{4}$  S. on N. face.  
Dig pits  $18 \times 18 \times 12$  ins E & W,  
of post  $5\frac{1}{2}$  ft dist. raised  
mound of earth  $1\frac{1}{2}$  ft.  
high  $3\frac{1}{2}$  ft. base around  
post.

79.00 Cor. to <sup>Sec.</sup> 5-6-7 & 8. Soil  
1st rate. Mesquite & Sage.  
Sec. 7 is the Desert Claim  
of Helen S. Meade.

North between Secs. 5 & 6,  
Va.  $13^{\circ} 57' E$ .

Chs.

40.00 Set a charred mesquite  
post 3 ft. long 3 in. eq. 12 ins.  
in ground for  $\frac{1}{4}$  sec. cor.  
Marked  $\frac{1}{4}$  S. on W. face.  
Dig pits 18 X 18 X 12. ins  $7\frac{9}{16}$   
S of post  $5\frac{1}{2}$  ft. dist.  
raised mound of earth  
 $1\frac{1}{2}$  ft. high  $3\frac{1}{2}$  ft. base  
around post.

116.48 Intersect the 1st. Standard  
S. 2 ch. E. of  $\frac{1}{4}$  cor of sec,  
32, T. 5. S. R. 8. E.,

Set a charred mesquite  
post 4 ft. long 4 in. eq.  
12 ins in the ground for C.  
Cor to sec. 5 $\frac{4}{16}$  S 6.  
Marked: - C. C. T. 6. S. R. 8. E. on  
S. - S. 5. on E. - S. 6. on W. face  
with 6 notches on S. and

Ch's.

5 notches on E. <sup>edges</sup> ~~faces~~  
 Aug. pile 18x18x2 ins. S. E  
 $\frac{1}{4}$  W. of post 5  $\frac{1}{2}$  ft. dist.  
 Raised mound of earth 3 ft.  
 high 4  $\frac{1}{2}$  ft. base around  
 post. Soil 1st. Class,  
 Sec. 5. is the Desert Claim  
 of Leonard Wood.

The E.  $\frac{1}{2}$  of Sec. 6. is the Desert  
 Claim of Charlott L. McAffee  
 The W.  $\frac{1}{2}$  of Sec. 6. is the Desert  
 Claim of Joel M. Scovell

Aug. 31<sup>st</sup> 1889

Camp  
 S. E.  
 2  $\frac{1}{2}$  ft.

Albert T. Colton  
 U. S. Dep. - Survey

U. S. Surveyor-General's Office,

TUCSON, A. T., Nov. 25<sup>th</sup> 1889

The foregoing Field Notes of the Surveys of  
The Subdivisions

A. No 6 S

R. No 8 E.

Gila and Salt River Meridian

in Arizona executed by

A. J. Colton

U. S. Deputy Surveyor, under his contract dated

June 8<sup>th</sup> 1889

having been critically examined, the necessary corrections and explanations made, the said Field Notes and the surveys they describe are hereby approved.

Popple Johnson

U. S. Surveyor-General  
for the Territory of Arizona



List of Names.

Surveyor.

BOOK 653

A List of the Names of Individuals employed

A. J. Cotton U. S. Surveyor, to assist in running, measuring, or marking the corners described in the foregoing Field Notes of the

Twp 6 S. R. 8. E. 22  
Gila and Salt Meridian in Arizona

showing the respective capacities in which they acted.

- Anthony Dean Cha
- Lewis G. Vinger Chas are represented
- M. M. Rice Aseveyed by me and
- Louis Kliese Fla and perpetuated



## Final Oath of Assistants.

I hereby certify that we assisted

*Albert J. Alton* U. S. Deputy Surveyor, in surveying  
 the parts or portions of *Top G. S. R. S. E.*  
*and Salt River*  
*Indian* - *Arizona*

represented in the foregoing field notes as having been  
 done by him and under his direction; and that said Survey  
 was in all respects, to the best of our knowledge and belief,  
 and faithfully surveyed and the corner monuments estab-  
 lished according to the instructions furnished by the United  
 States Surveyor-General for Arizona.

*Alvin Deau* Chainman.  
*Lewis G. Vugor* Chainman.  
*W. W. Rice* Axeman.  
*Lewis Klum* Flagman.

Sworn to and subscribed before me, this *5<sup>th</sup>* day of

*September*, 188*9*

*J. P. Meller*

## Final Oath of Deputy Surveyor.

I, A. T. Cotton

U. S. Deputy Surveyor, do solemnly swear, that in pursuance of instructions received from Royal A. Johnson, United States Surveyor-General for Arizona, bearing date the 22

day of July 1887, I have well, faithfully and truly, in my own proper person, and in strict conformity with the instructions furnished by the United States Surveyor-General for Arizona, the Surveying Manual, and the laws of the United States, surveyed all those parts or portions of

Twp. 6, S. R. 8 E.  
Gila and Salt River  
Meridian Arizona

as are represented

in the foregoing Field Notes as having been surveyed by me and under my direction; and I do further solemnly swear that all the corners of said surveys have been established and perpetuated in strict accordance with the Surveying Manual, printed instructions, the special instructions of the United States Surveyor-General for Arizona, and in the specific manner described in the

97

BOOK 653

field notes, and that the foregoing are the true Field Notes of such survey, and should any fraud be detected I will suffer the penalty of perjury, under the provisions of an act of Congress approved August 8, 1846

A. T. Colton

U. S. Deputy Surveyor.

Sworn to and subscribed before me this 5<sup>th</sup> day of

Sept

1889

J. P. Miller  
Notary Public



97

[4  
0.]

Township No. 6 S

Range No. 8 E Mer.

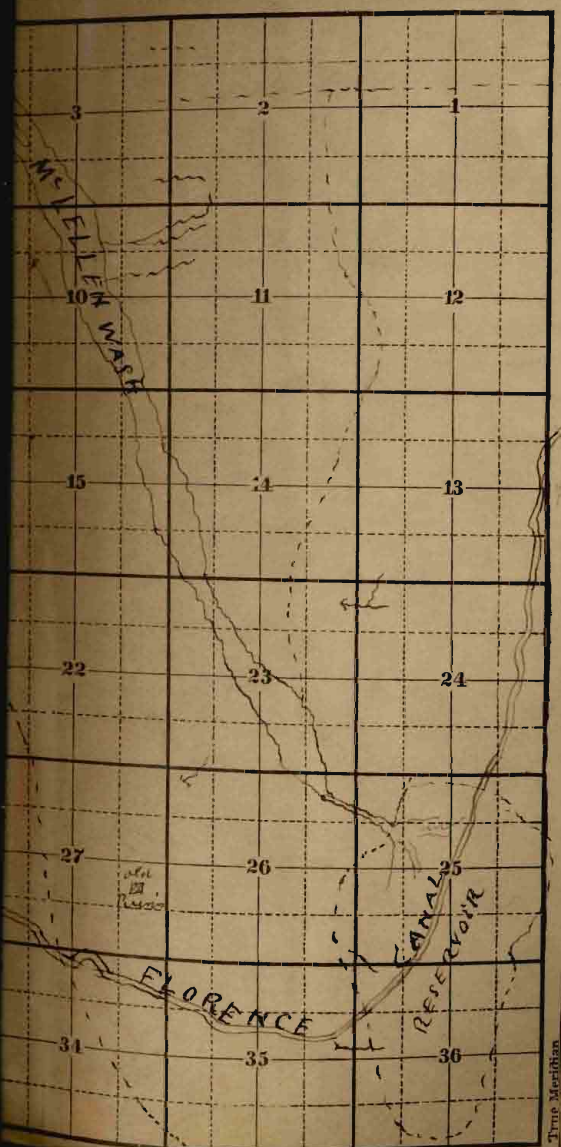
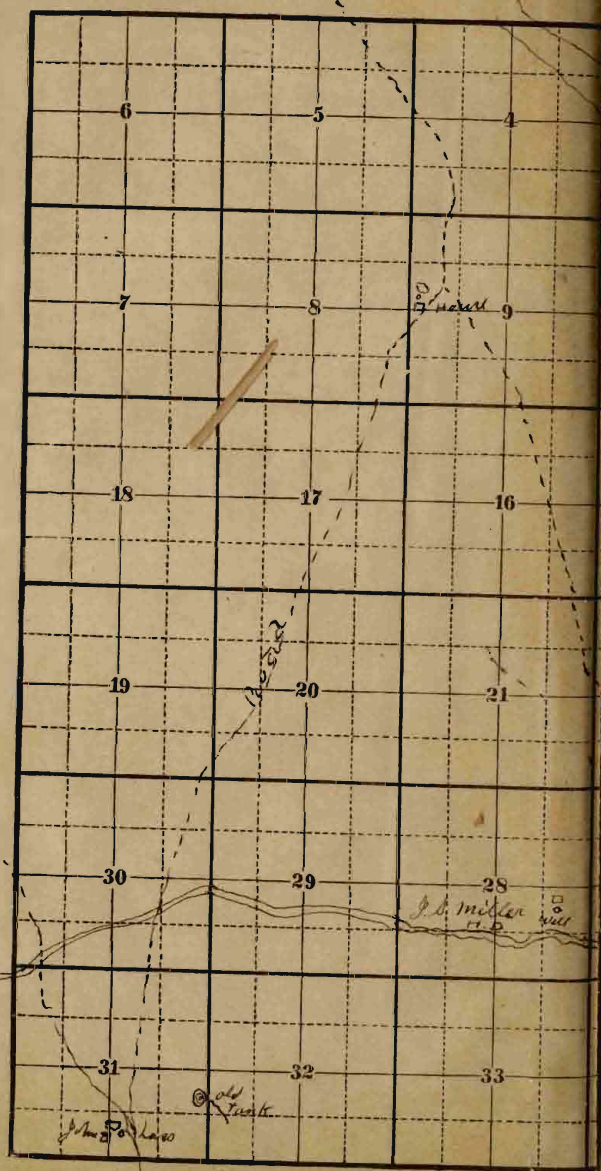

□ Quinn Ranch

Thos. Meridian