

latted
indexed

Collected

Compassed

No. 680

No 13

680

BOOK 680

Field Notes

OF THE SURVEY OF THE

SUDIVISION LINES

— OF —

Township 7 S Range 6 E

Gila and Salt River Base and Meridian

ARIZONA. No. 680

By R. C. Powers D. S.

under contract dated July 20, 1883.

Survey commenced Dec 8, 1883.

Survey completed Dec 13, 1883.

*Corrected
See Resurvey*

Resurveyed

*Approved - by Com^r G. L. C.
February 27. 1890.*

Township 7 S Range 6 E M.
21.48

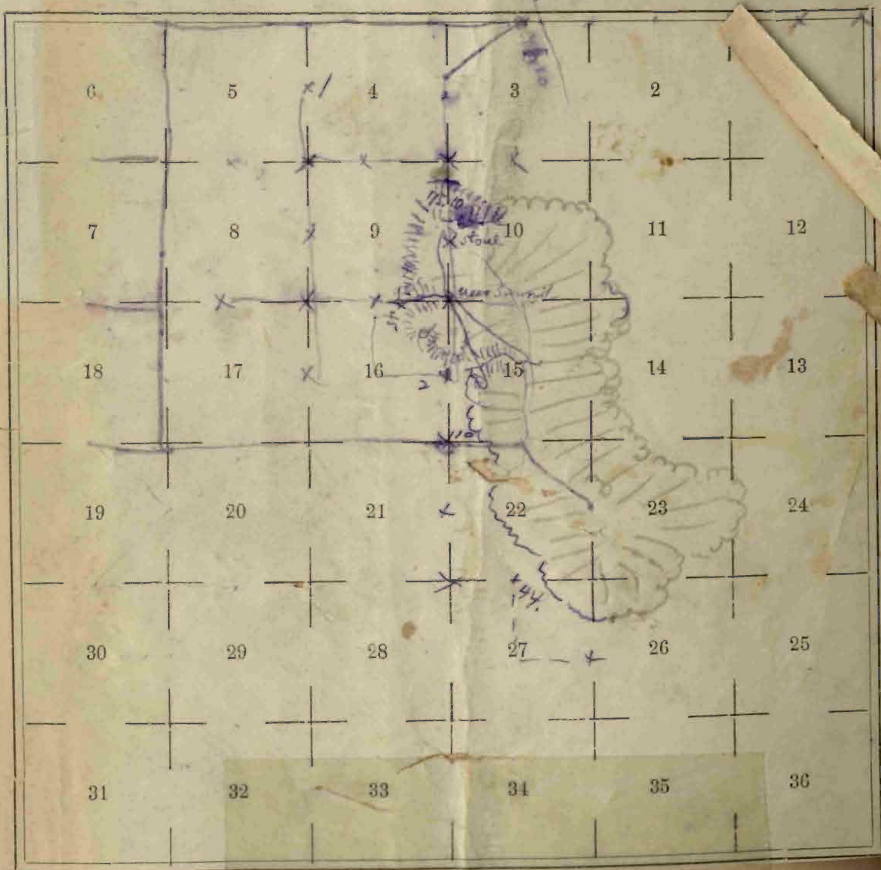

9
Book No 13
T. 7 S. R 6 E

BOOK 680 INDEX.

Township 7 S, Range 6 E,

Gila and Salt River Meridian.

6	60	5	44	4	33	3	22	2	11	1
19	58	58	43	43	32	32	21	21	10	10
7	57	8	42	9	31	10	20	11	9	12
56	55	55	41	41	30	30	19	19	8	8
18	54	17	40	16	29	15	18	14	17	14
53	52	52	39	39	28	28	17	17	6	6
19	51	20	38	21	27	22	16	23	30	24
50	49	49	37	37	26	26	15	15	5	5
30	48	29	36	28	25	27	14	26	3	25
47	46	46	35	35	24	24	13	25	2	20
31	45	32	34	31	23	34	12	35	1	36

Referring the lines to the pages of the field notes.

For preliminary on the one back 401

T 7 S. 6 E

BOOK 680

No. 680 1B

Subdivisions T 7 S. R 6 E.

Acre	From the corner to Secs. 1, 2, 35 & 36 on South boundary of Sp. just recently by me, I run North bet. Secs. 35 & 36 γ a $13^{\circ} 05' E$.
40.00	Set a post 3 ft. long 3 ins. diam with marked stone, 12 ins, in the ground for $\frac{1}{4}$ Sec. Cor. marked $\frac{1}{4}$ S. on W face, dug pits 18 x 18 x 12 ins. N and S of post $5\frac{1}{2}$ ft. dist. and raised a mound of earth $1\frac{1}{2}$ ft. high. $3\frac{1}{2}$ ft. base. around post. from vol. 2 $Mag.$ 14 $lms.$ dist. to 340° W . $9\frac{1}{2}$ ft. dist. marked $\frac{1}{4}$ S. R. E.
80.00	Set a post 4 ft. long 4 ins. square, with marked stone, 12 ins, in the ground for Cor. to Secs, 25, 26, 35 & 36 marked T 7 S. S. 25 on N. E. R. 6 E S. 36 on S. E. S. 05 on S. W. and S. 26 on N. W. face, with γ notch on S. and γ notch on E. edges, dug pits 18 x 18 x 12 ins. in each Sec., $5\frac{1}{2}$ ft. dist. and raised a mound of earth 2 ft. high. $4\frac{1}{2}$ ft. base. around post. Land level, Soil 2 d. at Dune bank the entire north side of road.

Subdivisions 175

Chains

East on a random line
bet. Secs. 25 & 36.

$\gamma = 130^{\circ} 06'$

40.00 Set temporary $\frac{1}{4}$ sec. cor.

80.26 Intersect the East Ry of
Tp. 10 lbs N of Cor. to Secs.
25. 30. 31 & 36. just recently
established by me

Thence I run N. $89^{\circ} 56'$ W. on
a true line bet. Secs. 25 & 36.,
with same γ .

40.13 Set a post 3 ft. long 3 ins. diam with marked
stone, 12 ins. in the ground for $\frac{1}{4}$ Sec, Cor,
marked $\frac{1}{4}$ S. on N face, dug pits 18 x 18 x 12
ins. E and W. of post $5\frac{1}{2}$ ft. dist. and raised
a mound of earth $1\frac{1}{2}$ ft. high $3\frac{1}{2}$ ft. base. around
post.

80.26 The cor. to Secs. 25. 26. 35 & 36.

Soil $\frac{1}{4}$ sec. land level
since burial the surface with
some grass

R 6 E. continued

chains

North bet. Secs. 25 & 26
Va 13° 09' E

40.00

Set a post 3 ft. long 3 ins. diam with marked stone, 12 ins, in the ground for 1/4 Sec, Cor, marked 1/4 S. on W face, dug pits 18 x 18 x 12 ins. N. and E. of post 5 1/2 ft. dist. and raised a mound of earth 1 1/2 ft, high. 3 1/2 ft. base. around post.

80.00

Set a post 4 ft. long 4 ins. square, with marked stone, 12 ins, in the ground for Cor, to Secs, 23, 24, 25 & 26 marked T. 98 S. 24 on N. E. R. 62 S. 25 on S. E, S, 26 on S, W. and S, 23 on N, W. face, with 2 notch on S, and 1 notch on E. edges, dug pits 18 x 18 x 12 ins. in each Sec., 5 1/2 ft. dist. and raised a mound of earth 2 ft, high. 4 1/2 ft. base. around post.

Land level, Soil 2d cat
Lense level the entire north
some grass.

Subdivisions N 7 S.

chains

East on a random line
bet. Secs. 24 & 25.

$N 13^{\circ} 06' E$.

40.00 Set temporary $\frac{1}{4}$ sec. cor.

79.96 Intersect E. Ry of Sp 20 Chs N.
of cor. to Secs. 19, 24, 25 & 30
just recently established
by me.

Place iron h. $89^{\circ} 57' W$.
on a line bet. Secs. 24 & 25
with same ea.

39.98 Set a post 3 ft. long 3 ins. diam with marked
stone, 12 ins. in the ground for $\frac{1}{4}$ Sec. Cor,
marked $\frac{1}{4}$ S. on N face, dug pits 18 x 18 x 12
ins. E and W of post $5\frac{1}{2}$ ft. dist. and raised
a mound of earth $1\frac{1}{2}$ ft. high $3\frac{1}{2}$ ft. base around
post.

79.96 The cor. to Secs. 23, 24, 25 & 26
land level, Soil 2^d rate
same but the timber with
some grass.

R. 6 East - continued

Claims

North bet. Secs. 23 & 24

19.50 ~~Commence~~ ^{Var. 13° 19' E} ~~at end of~~ ^{small mound} ~~at~~ ^{the} ~~end~~ ^{of} ~~the~~ ^{line}
29.56 ~~Commence~~ ^{at} ~~end~~ ^{of} ~~the~~ ^{line}

40.00 Set a post 3 ft. long 3 ins. diam with marked stone, 12 ins, in the ground for 1/2 Sec, Cor, marked 1/2 S. on face, dug pits 18 x 18 x 12 ins. and of post 5 1/2 ft. dist. and raised a mound of ^{stone} earth 1 1/2 ft. high, 3 1/2 ft. base. around post.

60.00 Foot of 1/2 Sec 2 center flat

80.00 Set a post 4 ft. long 4 ins. square, with marked stone, 12 ins, in the ground for Cor, to Secs, 13, 14, 23 & 24 marked T. 75 S. 13 on N. E. R. 6 E S. 24 on S. E. S. 23 on S. W. and S. 14 on N. W. face, with 2 notch 20 on S, and 1 notch on E. edges, dug pits 18 x 18 x 12 ins. in each Sec., 5 1/2 ft. dist. and raised a mound of earth 2 ft. high, 4 1/2 ft. base. around post.

~~Line of 20 ch. long~~ ~~at~~ ~~end~~ ~~of~~ ~~the~~ ~~line~~ ~~at~~ ~~end~~ ~~of~~ ~~the~~ ~~line~~
Line mark the entire north
some grass.

12 M. Latitude 32° 49' N. and in
in good adjustment

Subdivisions N 7 S.

Chains

East on a random line bet
Secs. ¹³ 24 + 25

72° 13' 00" E

40.00

Set temporary 1/4 sec. cor.

79.71

Intersect E. Ry of Sp. 19 lks

N of cor. to Secs. 13, 18, 14 + 24
just recently established
by Sec. Thence I runN. 89° 52' 77. on a true line
bet. Secs. 13 + 24, north-south

34.85

Set a post 3 ft. long 3 ins. diam with marked
stone, 12 ins. in the ground for 1/4 Sec, Cor,
marked 1/4 S. on N face, dug pits 18 x 18 x 12
ins. E and W of post 5 1/2 ft. dist. and raised
a mound of earth 1 1/2 ft. high, 3 1/2 ft. base, around
post.

79.71

In cor. to Secs. 13, 14, 23 + 24
land mounted on Soil 3rd + 4th
Several kinds the entire mole
some Ploverish trees.

R6 E. continued

chains

North bet. Secs. 13 & 14

T₂ 13° 10' E

40.00

Set a post 3 ft. long 3 ins. diam with marked stone, 12 ins. in the ground for $\frac{1}{2}$ Sec. Cor. marked $\frac{1}{2}$ S. on $\frac{1}{2}$ face, dug pits 18 x 18 x 12 ins. N and S of post 5 $\frac{1}{2}$ ft. dist. and raised a mound of earth 1 $\frac{1}{2}$ ft. high, 3 $\frac{1}{2}$ ft. base. around post.

50.00

Set a post 4 ft. long 4 ins. square, with marked stone, 12 ins. in the ground for Cor. to Secs, 11, 12, 13 & 14 marked T. 75 S. 12 on N. E. R. & 2 S. 13 on S. E. S. 14 on S. W. and S. 11 on N. W. face, with $\frac{1}{2}$ notch on S, and $\frac{1}{2}$ notch on E. edges, dug pits 18 x 18 x 12 ins. in each Sec., 5 $\frac{1}{2}$ ft. dist. and raised a mound of earth 2 ft. high, 4 $\frac{1}{2}$ ft. base. around post.

Land level. Soil set out
Some brush the entire width

Subdivisions of N.

Chain

East on a random line bet.
Secs. 12 & 13.

To $13^{\circ}09'2''$

70.00 Set temporary $\frac{1}{4}$ sec. cor.

74.76 Intersect E. Ry. of S. p. 17 lks N.
of cor. to Secs. 7, 12, 13 & 18.

Just recently established by
one Steve I am N $89^{\circ}53'14''$
on a true line bet. Secs.
12 & 13 with chain or.

34.88

Set a post 3 ft. long 3 ins. diam with marked
stone, 12 ins. in the ground for $\frac{1}{4}$ Sec. Cor,
marked $\frac{1}{8}$ S. on N face, dug pits 18 x 18 x 12
ins. E and W of post 5 $\frac{1}{2}$ ft. dist. and raised
a mound of earth 1 $\frac{1}{2}$ ft. high. 3 $\frac{1}{2}$ ft. base. around
post.

79.76

The cor. to Secs 11, 12, 13 & 14
land level, soil 2d rate
burn brush the cubic mile
good grass

R. C. E. continued

Chains

North bet. Secs. 11 & 12
Ya 13° 09' E

40.00 Set a post 3 ft. long 3 ins. diam. with marked stone, 12 ins. in the ground for 1st Sec. Cor. marked 1 S. on W face, dug pits 18 x 18 x 12 ins. N and S of post 5½ ft. dist. and raised a mound of earth 1½ ft. high. 3½ ft. base. around post.

65.04 S. P. R. R. Co S. 53° 58' E

75.00 Road to Mason Co S. E

80.00 Set a post 4 ft. long 4 ins. square, with marked stone, 12 ins. in the ground for Cor. to Secs. 1, 2, 11 & 12 marked T. 7 S S. 1 on N. E. R. 6 E S. 12 on S. E. S. 11 on S. W. and S. 12 on N. W. face, with 5 notches on S; and 2 notches on E. edges, dug pits 18 x 18 x 12 ins. in each Sec., 5½ ft. dist. and raised a mound of earth 2 ft. high. 4½ ft. base. around post.

Land level, Soil 2^d set

same bond the entire work
 done by me

Subdivisions 1 & 45.

chains

East on a random line bet
Secs. 1 & 12.Ta $10^{\circ} 06' E$ 40.00 Set temporary $\frac{1}{4}$ sec. cor.79.80 Intersect E. By of S. p. 14
Eko N of Cor. to Secs. 16. 7 & 12
Just recently establishedby me Hence I run
N $89^{\circ} 54' W$. on a true line
bet. Secs. 1 & 12. with a survey

39.90

~~75.00~~Set a post 3 ft. long 3 ins. diam with marked
stone, 12 ins. in the ground for $\frac{1}{4}$ Sec. Cor.
marked $\frac{1}{4}$ S. on N face, dug pits 18 x 18 x 12
ins. E and W of post $5\frac{1}{2}$ ft. dist. and raised
a mound of earth $1\frac{1}{2}$ ft. high, $3\frac{1}{2}$ ft. base, around
post.79.80 The Cor. to Secs. 12, 11 & 12
land level. Soil 2 ft set
burn brush the entire mile
some grass.

R6 E continued

chains

North on a random
line bet. Secs. 1 & 2.

$N 13^{\circ} 07' E$

4000 Set temporary $1/4$ sec. cor.

80.19 Intersect N. By of Sp. 10th

E. of cor. to Secs. 1, 2, 35 & 36

just recently established

by me thence I run $S 0^{\circ} 42'$

on a true line bet. Secs. 1 & 2

with same α .

40.19 Set a post 3 ft. long 3 ins. diam with marked

stone, 12 ins. in the ground for $1/4$ Sec, Cor,

marked $1/4$ S. on N face, dug pits 18 x 18 x 12

ins. N and S of post $5\frac{1}{2}$ ft. dist. and raised

a mound of earth $1\frac{1}{2}$ ft. high, $3\frac{1}{2}$ ft. base. around

post.

80.19 The cor. to Secs. 1, 2, 11 & 12

land level, Soil 2^d rate

Young brush the entire mile

some grass.

Subdivisions T 7 S

- Chains
- From the Cor. to Secs. 2, 3, 34 & 35
on S. By of Sp. just recently
established by me I run
North East. Dec. 57 & 58
To 13° 07' E
- 40.00 Set a post 3 ft. long 3 ins. diam with marked
stone, 12 ins, in the ground for $\frac{1}{4}$ Sec, Cor,
marked $\frac{1}{4}$ S. on W face, dug pits 18 x 18 x 12
ins. N and S. of post $5\frac{1}{2}$ ft. dist. and raised
a mound of earth $1\frac{1}{2}$ ft. high. $3\frac{1}{2}$ ft. base. around
post. from which a Meridian line
data to S 10° E. 75 lbs. dist. marked (see p. 1)
- 80.00 Set a post 4 ft. long 4 ins. square, with marked
stone, 12 ins, in the ground for Cor, to Secs,
26, 27, 34 & 35 marked T. 7 S S. 20 on
N. E. R. 6 E S. 35 on S. E. S. 34 on
S. W. and S. 27 on N. W. face, with 1 notch
on S. and 2 notch 20 on E. edges. dug
pits 18 x 18 x 12 ins. in each Sec., $5\frac{1}{2}$ ft. dist.
and raised a mound of earth 2 ft. high. $4\frac{1}{2}$ ft.
base. around post. from which a Meridian
line data to S 4° W. 45 lbs. dist. marked
S. 75. R. 6 E. S. 27 B. S.
Land level Soil 2^d rate
Dense brush the entire south
some grass.
- Dec. 8. 1883

R 6 E. continued

chains

East on a random line
bet. Secs. 26 & 35.

To 13° 10' E.

40.00 Set temporary 1/4 sec. cor.

80.24 Intersect R&S line 12 lks. E.
of cor. to Secs. 25, 26, 35 & 36

Thence I run

S. 89° 55' W. on a true line
bet. Secs. 26 & 35. with same
ca.

40.12

Set a post 3 ft. long 3 ins. diam with marked
stone, 12 ins. in the ground for 1/4 Sec, Cor,
marked 1/4 S. on N face, dug pits 18 x 18 x 12
ins. E and W of post 5 1/2 ft. dist. and raised
a mound of earth 1 1/2 ft. high, 3 1/2 ft. base. around
post.

80.24 The cor. to Secs. 26, 27, 34 & 35

land level, Soil 2d rate
Dense brush the entire mile
some grass.

Subdivisions N 7 S.

Chains

North bet. Secs. 26 & 27

$T = 13^{\circ} 57'$

4000

Set a post 3 ft. long 3 ins. diam. with marked stone, 12 ins, in the ground for $\frac{1}{4}$ Sec, Cor, marked $\frac{1}{4}$ S. on W face, dug pits 18 x 18 x 12 ins. N and S of post $5\frac{1}{2}$ ft. dist. and raised a mound of earth $1\frac{1}{2}$ ft. high $3\frac{1}{2}$ ft. base. around post.

51.12

Commence ~~acant~~ over slope ~~with~~

8000

Set a post 4 ft. long 4 ins. square, with marked stone, 12 ins, in the ground for Cor, to Secs, 22, 23, 26 & 27 marked T. 75 S. 25 on N. E. R. 62 S. 26 on S. E. S. 27 on S. W. and S. 22 on N. W. face, with 2 notches on S. and 2 notches on E. edges, dug pits 18 x 18 x 12 ins. in each Sec., $5\frac{1}{2}$ ft. dist. and raised a mound of ~~earth~~ ^{stone} 2 ft. high $4\frac{1}{2}$ ft. base, around post.

~~chain~~

Land ~~and~~ ^{and} ~~so~~ ^{so} ~~mountain~~ ^{mountain} ~~and~~ ^{and} ~~some~~ ^{some} ~~grass~~ ^{grass}.
 Soil. 2^d & 3^d ~~rel.~~ ^{rel.} same ~~but~~ ^{but} some grass.

R 6 E. continued.

Chains

East on a random line
bet. Secs. 23 + 26,Descending steeply $\text{D}^{\circ} 13^{\circ} 07' 18''$ 40.00 Set temporary $\frac{1}{4}$ sec. cor.

42.21 Enter flat ground.

79.87 Intersect NW line 12th
S of cor. to Secs. 23, 24, 25 & 26Thence I run $\text{S}^{\circ} 89^{\circ} 55' \text{W}$.on a true line bet. Secs. 23 & 26.
with same or.39.93 Set a post 3 ft. long 3 ins. diam with marked
stone, 12 ins, in the ground for $\frac{1}{4}$ Sec, Cor,
marked $\frac{1}{4}$ S. on N face, dug pits 18 x 18 x 12
ins. E and W of post $5\frac{1}{2}$ ft. dist and raised
a mound of ~~earth~~ ^{stone} $1\frac{1}{2}$ ft. high. $3\frac{1}{2}$ ft. base. around79.87 The corner to Secs. 22, 23, 26 & 27
Cand. level, Soil 2' ^{38' 10"} N of
mountainous Soil 5' N of
same level & N of

Subdivisions W 7 S.

chains

North bet. Secs. 22 & 23.

Va $13^{\circ} 07' E$
ascending along E. slope of high mts.

40.00

Set a post 3 ft. long 3 ins. diam with marked stone, 12 ins, in the ground for $\frac{1}{4}$ Sec. Cor, marked $\frac{1}{4}$ S. on face, dug pits 18 x 18 x 12 ins. and ^{stones} of post 5 $\frac{1}{4}$ ft. dist. and raised a mound of earth $1\frac{1}{2}$ ft. high $3\frac{1}{2}$ ft. base. around post.

45.00

Commence descend

50.00

Set a post 4 ft. long 4 ins. square, with marked stone, 12 ins, in the ground for Cor. to Secs, ~~14, 15, 22 & 23~~ marked T. 7 S. S. 14 on N. E. R. 62 S. 23 on S. E. S. 22 on S. W. and S. 15 on N. W. face, with 2 notches on S. and 2 notch ~~es~~ on E. edges, dug pits 18 x 18 x 12 ins. in each Sec., 5 $\frac{1}{4}$ ft. dist. and raised a mound of earth 2 ft. high $4\frac{1}{2}$ ft. base. around post.

Sand mountains, Soil 3' and rocky
Some small trees and shrubs.

R. 6 E. continued

chains

East on a random line
bet. Secs. 14 + 23.

7c 13.0912
Descending over rough Mts.
22.00 Foot of Mountains enters flat

4.000 Set temporary 1/4 sec. cor.

79.71 Intersect R & S. line 19 lks

N of cor. to Secs. 13, 14, 23 & 24
a line I run N 89° 52' W.

on a true line, bet. Secs. 14 & 23
with same co.

39.85 Set a post 3 ft. long 3 ins. diam with marked
stone, 12 ins. in the ground for 1/4 Sec. Cor,
marked 1/8 S. on N face, dug pits 18 x 18 x 12
ins. @ and N of post 5 1/2 ft. dist. and raised
a mound of earth 1 1/2 ft. high, 3 1/2 ft. base around
post.

79.71. The Cor. to Secs. 14, 15, 22 & 23.
Land 22 ch. containing 58 ch. level
Soil 2 d x 3 9 sets. dense brush
and some grass.

Subdivisions 1578

Chain

North bet. Secs. 14 & 15.

$72^{\circ} 13' 09'' E$

along slope of Mountain
descending.

Stone

46.00

Set a granite stone, $14 \times 8 \times 6$ ins., 10 ins. in the ground for $\frac{1}{2}$ Sec, Cor, marked $\frac{1}{2}$ on N face, dug pits $18 \times 18 \times 12$ ins. N and S of stone $5\frac{1}{2}$ ft. dist. and raised a mound of earth $12\frac{1}{2}$ ft. high, 24 ft. base, alongside.

Stone

30.00

Set a volcanic stone $17 \times 9 \times 5$ ins., 11 ins. in the ground for Cor. to Secs. 10, 11, 14, marked with 4 notches on S. and 2 notches on E. edges, dug pits $18 \times 18 \times 12$ ins. in each Sec., $5\frac{1}{2}$ ft. dist. and raised a mound of ^{stone} earth 2 ft. high, $4\frac{1}{2}$ ft. base, alongside.

Land monument survey

Soil 3^d rate & rocky
Some break the surface
congress.

R. 6 E. continued

Chain

East on a random line
bet. Secs. 11 & 14.

27.00 ^{To 13° 09' E} ascending over high vegetation
Enter level ground

40.00 Set temporary 1/4 sec. cor.

79.76 Intersect W. Line 17 Ch. N
if cor. to Secs. 11, 12, 13 & 14

Thence 1000 N 89° 53' W.
on a true line bet. Secs. 11 & 14
with same or.

59.88 Set a post 3 ft. long 3 ins. diam with marked
stone, 12 ins. in the ground for 1/4 Sec, Cor,
marked 1/4 S. on N face, dug pits 18 x 18 x 12
ins. E and W of post 5 1/2 ft. dist. and raised
a mound of earth 1 1/2 ft. high. 3 1/2 ft. base. around

79.76 ^{post,} The cor. to Secs. 10, 11, 14 & 15
~~land is~~ ~~irregular~~ ~~irregular~~
~~to~~ ~~level~~ ~~soil~~ ~~of~~ ~~a~~ ~~3~~ ~~of~~ ~~rate~~
~~some~~ ~~brush~~ ~~to~~ ~~entire~~ ~~with~~
~~some~~ ~~grass.~~

Subdivision T 7 S.

chain

North bet. Secs. 10 & 11
 Ta $13^{\circ} 09' E$
 along steep mountain

Tym
45.00

Set a volcanic stone, 10 x 7 x 5 ins., 7 ins.
 in the ground for $\frac{1}{2}$ Sec, Cor, marked $\frac{1}{2}$. on N
 face, dug pits 18 x 18 x 12 ins. $\frac{1}{2}$ and S
 of stone $5\frac{1}{2}$ ft. dist. and raised a mound of earth
 $1\frac{1}{2}$ ft. high, $3\frac{1}{2}$ ft. base. alongside.

60.00

Foot of mountain into bay

80.00

Set a post 4 ft. long 4 ins. square, with marked
 stone, 12 ins. in the ground for Cor, to Secs,
 2-3. 10 x 11 marked T. 7 S S. 2 on
 N. E. R. & E S. 11 on S. E. S, 10 on
 S, W, and S, 3 on N. W, face, with 5 notches
 on S, and 2 notch 60 on E. edges, dug
 pits 18 x 18 x 12 ins. in each Sec., $5\frac{1}{2}$ ft. dist.
 and raised a mound of earth 2 ft. high, $4\frac{1}{2}$ ft.
 base. around post.

Land each mountainous level
 Sept 2d a 3rd party
 came over the entire creek
 some grass.

P. 6 E. continued

chains

East on a random line
bet. Secs. 2 + 11.

To $13^{\circ} 09' E$.

40.00 Set temporary $\frac{1}{4}$ sec. cor.

58.30 S. P. R. R. to $S. 53^{\circ} 58' E$

75.10 Road to NW $S. E$.

79.09 Intersect W line 16 lbs W of cor.

to Secs. 12, 11 + 12. Hence I run
to $89^{\circ} 53' W$ on a true line bet. Secs
2 + 11. with same va .

39.96

Set a post 5 ft. long 3 ins. diam with marked
stone, 12 ins, in the ground for $\frac{1}{4}$ Sec, Cor,
marked $\frac{1}{4}$ S. on N face, dug pits 18 x 18 x 12
ins. E and W of post $5\frac{1}{2}$ ft. dist. and raised
a mound of earth $1\frac{1}{2}$ ft. high, $3\frac{1}{2}$ ft. base. around
post.

79.92 The Cor. W Secs. 2, 3, 10, + 11
Land level. Soil 2 ft. with
some hard $\frac{1}{2}$ in. cubes with
some grass

Subdivisions 175.

chains

North on a railroad line
bet. Secs. 2 & 3.Ta $13^{\circ} 10' E$ 40.00 Set temporary $\frac{1}{4}$ sec. cor.42.47 S $\frac{1}{2}$ R R to S. $53^{\circ} 58' E$

57.20 Road to Incarn to S. E.

80.17 Intersect N. Ry. of $\frac{1}{2}$ p. 16 lbs E
of cor. to Secs. 2, 3, 34 & 35.Just recent to established by
line E and $80^{\circ} 7' E$. on a true line
bet. Secs. 2 & 3. will same to.40.17 Set a post 3 ft. long 3 ins. diam with marked
stone, 12 ins, in the ground for $\frac{1}{4}$ Sec, 1°
marked $\frac{1}{2}$ S. on $\frac{1}{2}$ face, dug pits 18 x 18 x 7
ins. N and S of post $5\frac{1}{2}$ ft. dist. and rais
a mound of earth $1\frac{1}{2}$ ft. high $3\frac{1}{2}$ ft. base. around
post.80.17 The cor. to Secs. 2, 3, 10 & 11.
Land level Soil 2^d to
Dense wood the entire mile
Some grass.

R. 6 E. continued

- chains From the Cor. to Secs. 3, 4, 33 & 34
on S. P₂ of Sp. just recently est-
ablished by me from
North lat. Secs. 33 & 34
N. 13° 59' E
- 4000 Set a post 3 ft. long 3 ins. diam with marked
stone, 12 ins, in the ground for $\frac{1}{4}$ Sec, Cor,
marked $\frac{1}{4}$ S. on N face, dug pits 18 x 18 x 12
ins. N and S of post 5 $\frac{1}{2}$ ft. dist. and raised
a mound of earth 1 $\frac{1}{2}$ ft. high, 3 $\frac{1}{2}$ ft. base. around
post.
- 8000 Set a post 4 ft. long 4 ins. square, with marked
stone, 12 ins, in the ground for Cor, to Secs,
27, 28, 33 & 34 marked T, 7 S. 27' on
N. E. R. 6 E S. 34 on S. E, S. 33 on
S, W, and S, 28 on N, W, face, with \angle notch
on S, and γ notch ∞ on E. edges, dug
pits 18 x 18 x 12 ins. in each Sec., 5 $\frac{1}{2}$ ft. dist.
and raised a mound of earth 2 ft. high, 4 $\frac{1}{2}$ ft.
base. around post.
Laid level, soil & d. oak
Secure bond the entire work
some grass

Subdivisions 178

Chain

East on a random line
bet. Secs. 27 & 34 $\frac{1}{2}$ 13° 07' E40.00 Set temporary $\frac{1}{4}$ sec. cor.

79.97 Intersect N & S line 35 Ch.

S. of cor. to Secs. 26, 27, 34 & 35

Thence I run S. 89° 45' W.

on a true line bet. Secs.

27 & 34 with same ca.

39.98

Set a post 3 ft. long 3 ins. diam with marked
stone, 12 ins. in the ground for $\frac{1}{4}$ Sec. Cor.
marked $\frac{1}{4}$ S. on N. face, dug pits 18 x 18 x 12
ins. E and W of post 5 $\frac{1}{2}$ ft. dist. and raised
a mound of earth 1 $\frac{1}{2}$ ft. high, 3 $\frac{1}{2}$ ft. base, aroundpost, from which a meas. 70 ins. in cor.
S. 45° W. 70 Ch. dist. marked $\frac{1}{4}$ S. P. T.

79.97

The cor. to Secs. 27, 28, 33 & 34

Land level. Soil 2d rate

Dune toward the entire tract

Dec. 10. 1883.

R 6 E. continued

Chains

North bet. Secs. 27 & 28
 Ya $13^{\circ} 10' E$

4000

Set a post 3 ft. long 3 ins. diam with marked stone, 12 ins, in the ground for $\frac{1}{4}$ Sec, Cor, marked $\frac{1}{4}$ S. on W face, dug pits 18 x 18 x 12 ins. N and S. of post $5\frac{1}{2}$ ft. dist. and raised a mound of earth $1\frac{1}{2}$ ft. high $3\frac{1}{2}$ ft. base. around post.

5000

Set a post 4 ft. long 4 ins. square, with marked stone, 12 ins, in the ground for Cor, to Secs, 21, 22, 27 & 28 marked T. 2 S. 22 on N. E. R. 6 E. S. 27 on S. E. S. 28 on S, W, and S, 21 on N. W, face, with 2 notch es on S, and 3 notch es on E. edges, dug pits 18 x 18 x 12 ins. in each Sec., $5\frac{1}{2}$ ft. dist. and raised a mound of earth 2 ft. high $4\frac{1}{2}$ ft. base. around post.
 Sand level. Soil 2^d rate
 dense brush the entire mile
 some grass.

Subdivision N. 25

Chains

East on a random line
bet. Secs. 22 & 27.

 $\gamma = 130^{\circ} 07' 2$

40.00 Set temporary $\frac{1}{4}$ sec. cor.

44.00 Commence asc. of Monument

76.40 Summit of Mt. to N. 15° W. & descend

80.46 Intersect N & S. line 39 lbs N of
cor. to Secs. 22, 23, 26 & 27. Thence run
N 89° 45' W. on a true line bet.
Secs. 22 & 27, with same cor.

40.23

Set a post 3 ft. long 3 ins. diam. with marked
stone, 12 ins. in the ground for $\frac{1}{4}$ Sec. Cor.
marked $\frac{1}{4}$ S. on N. face, dug pits 18 x 18 x 12
ins. E and W of post 5 $\frac{1}{2}$ ft. dist. and raised
a mound of ^{stone} earth 1 $\frac{1}{2}$ ft. high. 3 $\frac{1}{2}$ ft. base. around
post.

80.46

The cor. to Secs. 21, 22, 27 & 28
land ~~to~~ subdivisions ~~is~~
level soil. 2' of E. 8' of W.
Some brush the ~~sub~~ ~~in~~
some grass.

R. to E. continued

claims

North bet. Secs 21 & 22
ascending North.

4000

Set a post 3 ft. long 3 ins. diam with marked stone, 12 ins, in the ground for $\frac{1}{4}$ Sec, Cor, marked $\frac{1}{4}$ S. on $\frac{2}{4}$ face, dug pits 18 x 18 x 12 ins. N and S of post $5\frac{1}{2}$ ft. dist. and raised a mound of earth $1\frac{1}{2}$ ft. high. $3\frac{1}{2}$ ft. base. around post.

8000

Set a post 4 ft. long 4 ins. square, with marked stone, 12 ins, in the ground for Cor, to Secs, 15, 16, 21 & 22 marked T. 7 $\frac{1}{2}$ S. 15 on N. E. R. 6 E S. 22 on S. E, S, 21 on S, W, and S, 16 on N, W, face, with \odot notch on S, and \ominus notch on E. edges, dug pits 18 x 18 x 12 ins. in each Sec., $5\frac{1}{2}$ ft. dist. and raised a mound of earth 2 ft. high. $4\frac{1}{2}$ ft. base. around post.
Land level. Soil 3 d rate
Dense brush the cut has
some grass.

17 m . Latitude of this point $32^{\circ} 49' 21''$
and inst. in adjustment.

Subdivisions N 7d

Chains

Cast on a random line
bet. Secs. 15 & 22

according to $13^{\circ} 09' E$

10.10 Commence ascend of steep Mt.

4000 Set temporary 1/4 sec. cor.

57.24 Summit to $29^{\circ} 50' W$ & descend

80.25 Intersect red line 52 lbs N.

of cor. to Secs. 14, 15, 22 & 23.

Thence I run $289^{\circ} 38' W$ on a
true line bet. Secs. 15 & 22 with same

40.12 Set a post 3 ft. long 3 ins. diam with marked

stone, 12 ins, in the ground for 1/4 Sec, Cor,

marked 1/4 S. on N face, dig pits 18 x 18 x 12

ins. E and W of post 5 1/2 ft. dist. and raised

a mound of ~~earth~~ ^{stone} 1 1/2 ft. high. 3 1/2 ft. base. around

post.

80.25 The cor. to Secs. 15, 16, 21 & 22.

Land mountainous. Soil 3^d rate

same brush the entire area.

some grass.

R. 6 E. continued

Leins

North bet. Secs. 15 & 16

Ya $13^{\circ} 10' E$

ascending over Monument

4500

Set a post 3 ft. long 3 ins. diam with marked stone, 12 ins. in the ground for $\frac{1}{4}$ Sec. Cor, marked $\frac{1}{4}$ S. on W face, dug pits 18 x 18 x 12 ins. N and S of post $5\frac{1}{2}$ ft. dist. and raised a mound of ~~earth~~ ^{stone} $1\frac{1}{2}$ ft. high, $3\frac{1}{2}$ ft. base. around post.

from which a Pilewood is on the top of the hill. It is marked with a Pilewood on the top of the hill. It is marked with a Pilewood on the top of the hill.

$\frac{1}{4}$ S. B. T. ascend very steeply.

52.10

Set a ~~volcanic~~ stone $4\frac{1}{2} \times 10 \times 8$ ins., 10 ins. in the ground for Cor. to Secs. 7, 10, 15, marked with 4 notches on S. and 3 notches on E. edges, dug pits 18 x 18 x 12 ins. in each Sec., $5\frac{1}{2}$ ft. dist. and raised a mound of ~~earth~~ ^{stone} 2 ft. high, $4\frac{1}{2}$ ft. base. alongside.

Land monument on.

For C 2^d rate.

Some brush the entire mile
Some grass.

Subdivisions 1775.

chains

East on a random line

let. Secs. 10 & 15

ascending. $72^{\circ} 13' 06'' E$ 10.21 Summit to $N 20^{\circ} W$ & descend
4000 Set temporary $\frac{1}{4}$ sec. cor.80.23 Intersect N&S line 62 Chs N
of cor. to Secs. 10, 11, 14 & 15.

Thence 9 mi

 $N. 89^{\circ} 33' W$ on a true linelet. Secs. 10 & 15, with same
va.40.12 Set a post 3 ft. long 3 ins. diam with marked
stone, 12 ins. in the ground for $\frac{1}{4}$ Sec. Cor,
marked $\frac{1}{4}$ S. on \swarrow face, dug pit 18 x 18 x 12
ins. E and \swarrow of post $5\frac{1}{2}$ ft. dist. and raised
a mound of ~~earth~~^{stone} $1\frac{1}{2}$ ft. high, $3\frac{1}{2}$ ft. base. around
post.80.23 The cor. to Secs. 4, 10, 15 & 16.
Land level. Soil 2 ft. at
base brush the entire mile
some grass.

R. 6 E. continued

chains

North bet. Secs. 9 & 10

Ya $15^{\circ} 10' E$

 Second along N. slope of Mtn

40.00

Set a post 3 ft. long 3 ins. diam with marked stone, 12 ins, in the ground for $\frac{1}{4}$ Sec. Cor, marked $\frac{1}{4}$ S. on W face, dug pits 18 x 18 x 12 ins. N and S of post $5\frac{1}{2}$ ft. dist. and raised a mound of earth $1\frac{1}{2}$ ft. high. $3\frac{1}{2}$ ft. base. around post.

75.12

Leave Mountain & enter flat

80.00

Set a post 4 ft. long 4 ins. square, with marked stone, 12 ins, in the ground for Cor. to Secs. 3, 4, 9 & 10 marked T. 7 S S. 3 on N. E. R. 6 E S. 10 on S. E. S, 9 on S, W, and S, 4 on N. W. face, with S notch on S, and S notch on E. edges, dug pits 18 x 18 x 12 ins. in each Sec., $5\frac{1}{2}$ ft. dist. and raised a mound of earth 2 ft. high. $4\frac{1}{2}$ ft. base. around post.

Land to the mountain to the
 soil 2^d & 3^d part.
 Leave land the entire north
 side.

Subdivisions 75.

Chains

East on a random line
bet. Secs. 9 & 10 $72^{\circ} 13' 09'' E$ 40.00 Set temporary $\frac{1}{4}$ sec. cor.80.08 Intersect N&S line 27 ch
N of cor. to Secs. 2 & 3. 10 & 11.Thence I run N. $84^{\circ} 49' W$
on a true line bet. Secs. 3 & 4
with same or.40.04 Set a post 3 ft. long 3 ins. diam with marked
stone, 12 ins. in the ground for $\frac{1}{4}$ Sec. Cor,
marked $\frac{1}{4}$ S. on N face, dug pits 18 x 18 x 12
ins. E and W of post 5 $\frac{1}{2}$ ft. dist. and raised
a mound of earth 1 $\frac{1}{2}$ ft. high. 3 $\frac{1}{2}$ ft. base. around
post.80.08 The cor. to Secs. 3, 4, 9 & 10.
Land level, Soil 2d cat
Dune bound the exterior with
some grass.

R. & E. continued

Lains

North on a random line
bet. Secs. 3 & 4N = $13^{\circ} 09' E$.

40.00 Sit temporary office cor.

79.86 Intersect N. By. of Sp. 50 lks. W.
of cor. to Secs. 3 & 4. 33 & 34.
Just recently established
by me, Thence Iron $S^{\circ} 21' W$. on a true line bet.
Secs. 3 & 4, with same cor.39.86 Set a post 3 ft. long 3 ins. diam with marked
stone, 12 ins. in the ground for $\frac{1}{4}$ Sec. Cor,
marked $\frac{1}{4}$ S. on W face, dug pits 18 x 18 x 12
ins. N and S of post 54 ft. dist. and raised
a mound of earth 1 1/2 ft. high 3 1/2 ft. base. around
post.79.86 The cor. to Secs. 3 & 4. 9 & 10.
Sand level. Soil 2^d rate
Secure means to limit the
subsoil from coming up.

Subdivisions W. 75

Chains from the corner to Secs. 75, 32 & 33 on S. Bay of Sp. just recently established by me & Mrs. North bet. Secs. 32 & 33.

7a 13° 07' 12"

7000 Set a post 3 ft. long 3 ins. diam with marked stone, 12 ins, in the ground for $\frac{1}{4}$ Sec. Cor, marked $\frac{1}{4}$ S. or W face, dug pits 18 x 18 x 12 ins. N and S. of post $5\frac{1}{2}$ ft. dist. and raised a mound of earth 1 ft. high $3\frac{1}{2}$ ft. base around post.

8000 Set a post 4 ft. long 4 ins. square, with marked stone, 12 ins, in the ground for Cor. to Secs, 28, 29, 32 & 33 marked T. 7 S S. 28 on N. E. R. 62 S. 33 on S. E. S. 32 on S, W, and S, 27 on N, W, face, with γ notch on S, and γ notch 90 on E. edges, dug pits 18 x 18 x 12 ins. in each Sec., $5\frac{1}{2}$ ft. dist. and raised a mound of earth 2 ft. high $4\frac{1}{2}$ ft. base. around post.
Sand level, Soil 2 of rat
Some brush the entire north
corner of 28.

R 6 E. continued

Lines

East on a random line
bet. Secs. 28 & 33.

To $13^{\circ}10' E$

4000 Set temporary 1/4 sec. cor.

79.91 Intersect N.S. line 22 lbs

W of cor. to Secs. 27, 28, 33 & 34

Thence S 90°

N $89^{\circ}51' W$ on a true line

bet. Secs. 28 & 33. with same

079.95 Set a post 3 ft. long 3 ins. diam with marked

stone, 12 ins. in the ground for 1/4 Sec. Cor.

marked 1/4 S. on N face, dug pits 10 x 10 x 12

ins. E and W of post 5 1/2 ft. dist. and raised

a mound of earth 1 1/2 ft. high, 3 1/2 ft. base. around

post.

79.91 The cor. to Secs. 28, 29, 32 & 33.

Land level. Soil 2 d. set

since found the other

Subdivisions N. 75

claims

North bet. Secs. 28 & 29.
To $13^{\circ} 10' E$

40.00

Set a post 3 ft. long 2 ins. diam. with marked stone, 12 ins. in the ground for $\frac{1}{4}$ Sec. Cor. marked $\frac{1}{4} S.$ on W face, dug pits $18 \times 18 \times 12$ ins. N and S of post $5\frac{1}{2}$ ft. dist. and raised a mound of earth $1\frac{1}{2}$ ft. high, $3\frac{1}{2}$ ft. base. around post.

80.00

Set a post 4 ft. long 4 ins. square, with marked stone, 12 ins. in the ground for Cor. to Secs. 20. 21. 28 & 29 marked T. 75 S. 21 on N. E. R. 6 E S. 28 on S. E. S. 29 on S. W. and S. 20 on N. W. face, with 2 notch ∞ on S. and 4 notch ∞ on E. edges, dug pits $18 \times 18 \times 12$ ins. in each Sec., $5\frac{1}{2}$ ft. dist. and raised a mound of earth 2 ft. high, $4\frac{1}{2}$ ft. base. around post.

Land local, Soil 2^d rate
Dense brush the entire north
side of road.

Dec. 11. 1883.

R 6 E. continued

chains

East on a random line
hit. Secs. 21 + 28.

To $13^{\circ} 09' E.$

4000 Set temporary $1/4$ sec. cor.

79.94 Intersect N + S line 2.3 ch
S of cor. to Secs. 21, 22, 27 + 28
thence S on

$S 89^{\circ} 50' W.$ on a true line
hit. Secs. 21 + 28. with
same \rightarrow .

39.97 Set a post 3 ft. long 3 ins. diam with marked
stone, 12 ins, in the ground for $1/4$ Sec, Cor,
marked $1/4 S.$ on N face, dug pits $18 \times 18 \times 12$
ins. E and W of post $5 1/2$ ft. dist. and raised
a mound of earth $1 1/2$ ft. high $3 1/2$ ft. base around
post.

79.94 The cor to Secs. 20, 21, 28 + 29
land levels. Soil 2 ft out
thence mark the intersection
with 200 ft. line.

Subdivisions N 7 S.

chains

North lat. Secs. 20 & 21

N 130 09 S

4000

Set a post 3 ft. long 3 ins. diam with marked stone, 12 ins, in the ground for $\frac{1}{4}$ Sec. Cor, marked $\frac{1}{4}$ S. on N face, dug pits 18 x 18 x 12 ins. N and S of post $5\frac{1}{2}$ ft. dist. and raised a mound of earth $1\frac{1}{2}$ ft. high $3\frac{1}{2}$ ft. base. around post.

8000

Set a post 4 ft. long 4 ins. square, with marked stone, 12 ins, in the ground for Cor, to Secs, 16, 17, 20 & 21 marked T. 7 S. S. 16 on N. E. R. & E. S. 21 on S. E. S. 20 on S. W. and S. 17 on N. W. face, with $\frac{1}{2}$ notch on S. and $\frac{1}{2}$ notch on E. edges, dug pits 18 x 18 x 12 ins. in each Sec., $5\frac{1}{2}$ ft. dist. and raised a mound of earth 2 ft. high $4\frac{1}{2}$ ft. base. around post.

Land level, Soil 2d. rat
 down toward the water side
 some grass

R 6' E. continued

Chains

East on a random line
bet. Secs. 16 & 21

$72^{\circ}13'09''$

4+00 Set temporary $\frac{1}{4}$ sec. cor.

79.91 Intersect N & S. line 11 kts

Not cor. to Secs. 15, 16, 21 & 22

Thence I run

$N 89^{\circ}53' W$. on a true line

bet. Secs. 16 & 21. with same
ra

39.95

Set a post 3 ft. long 1 1/2 ins. diam with marked
stone, 12 ins. in the ground for $\frac{1}{4}$ Sec. Cor,
marked $\frac{1}{4}$ S. on N face, dig pits 18 x 18 x 12
ins. E and W of post 5 1/2 ft. dist and raised
a mound of earth 1 1/2 ft. high, 3 1/2 ft. base, around

post

79.91

The cor. to Secs. 16, 17, 20 & 21

Land level, post. 2^d rate

since found the entire mile
same goes.

Subdivision A75

claims

North bet. Secs 16 & 17
Tc 13' on 'S

4000 Set a post 3 ft. long 3 ins. diam. with marked stone, 12 ins. in the ground for $\frac{1}{4}$ Sec. Cor. marked $\frac{1}{4}$ S. on W face, dug pits 18 x 18 x 12 ins. N and S of post $5\frac{1}{2}$ ft. dist. and raised a mound of earth $1\frac{1}{2}$ ft. high $3\frac{1}{2}$ ft. base. around post.

5000 Set a post 4 ft. long 4 ins. square, with marked stone, 12 ins. in the ground for Cor. to Secs. 8, 9, 16 & 17 marked T. 75 S. 7 on N. E. R. 6 E S. 16 on S. E. S. 17 on S. W. and S. 8 on N. W. face, with $\frac{1}{4}$ notch on S, and $\frac{1}{4}$ notch on E. edges, dug pits 18 x 18 x 12 ins. in each Sec., $5\frac{1}{2}$ ft. dist. and raised a mound of earth 2 ft. high $4\frac{1}{2}$ ft. base. around post.

Said level, Soil 2nd set
Dense brush the entire width
Some grass.

R 6 E continued

chains

East on a random line
bet. Secs. 9 & 16.

To 13° 10' E.

40.00 Set temporary $\frac{1}{4}$ sec. cor.

45.86 Ascend ~~to~~ steep *Mounted*

80.56 Intersect N + S. line 12th
profess. to Secs. 9, 10, 15 & 16

Thence from S 89° 55' W.
on a true line bet. Secs.
9 & 16 with same va.

70.28 Set a post 3 ft. long 3 ins. diam with marked
stone, 12 ins. in the ground for $\frac{1}{4}$ Sec. Cor.
marked $\frac{1}{4}$ S. on $\frac{1}{4}$ face, dug pits 16 x 18 x 12
ins. E and W of post 5 $\frac{1}{2}$ ft. dist. and raised
a mound of ~~stone~~ ^{stone} 1 $\frac{1}{2}$ ft. high, 3 $\frac{1}{2}$ ft. base, around
post.

80.56 The Cor. to Secs. 8, 9, 16 & 17
land level. ~~Set~~ ^{Set} ~~2~~ ² ~~rate~~
stone ~~brush~~ the entire ~~with~~
some grass.

Subdivision D. 75.

chains

North bet. Secs. 8 & 9.

T_a 130075

4000

Set a post 3 ft. long 3 ins. diam with marked stone, 12 ins. in the ground for 4 Sec, Cor, marked 15. on ^W face, dug pits 18 x 18 x 12 ins. N and S of post 5 1/2 ft. dist. and raised a mound of earth 1 1/2 ft. high. 3 1/2 ft. base. around post.

8000

Set a post 4 ft. long 4 ins. square, with marked stone, 12 ins. in the ground for Cor, to Secs, 4, 5, 8 & 9 marked 170 S. 4 on N. E. R. 72 S. 9 on S. E. S. 8 on S. W. and S. 5 on N. W. face with 5 notches on S. and 4 notches on E. edges, dug pits 18 x 18 x 12 ins. in each Sec., 5 1/2 ft. dist. and raised a mound of earth 2 ft. high. 4 1/2 ft. base. around post.

Land level, Soil 2d rate
 dense timber with the usual
 some grass.

P. 68. continued

Chains

East on a random line
bet. Secs. 4 & 9.

$\gamma = 13^{\circ} 09' E$

40.00 Set temporary 4 sec. cor.

80.12 Intersect red line 1+1/2
S. of cor. to sec. 34. 9 & 10.

Thence 3 mm S. $89^{\circ} 55' W$
on a true line bet. Secs.
4 & 9. with same va.

40.06 Set a post 3 ft. long 3 ins. diam with marked
stone, 12 ins. in the ground for 1/2 Sec. Cor.,
marked 1/5. on N face, dug pits 18 x 18 x 12
ins. E and W of post 5 1/2 ft. dist. and raised
a mound of earth 1 1/2 ft. high 3 1/2 ft. base. around
post.

80.12 The cor. to Secs. 4, 5, 8 & 9.
Land level Soil 2d rate
Thence bound the entire north
corner.

Sub divisions 075

chains

North on a random line
bet. Secs. 4 & 5.

T = 13' 06" 8

40.00 Set temporary 44 sec. cor.

80.17 Intersect N. Pt. of T. 16
200 ft. of cor. to Secs. 4, 5, 8 & 9just recently established by me
thence I run 8' 0" 7' N. on a
true line bet. Secs. 4 & 5,
with same va.40.17 Set a post 3 ft. long 3 ins. diam with marked
stone, 12 ins. in the ground for $\frac{1}{2}$ Sec. Cor.
marked $\frac{1}{2}$ S. on $\frac{1}{2}$ face, dug pits 18 x 18 x 12
ins. N and S of post 5 $\frac{1}{2}$ ft. dist. and raised
a mound of earth 1 $\frac{1}{2}$ ft. high, 3 $\frac{1}{2}$ ft. base, around
post, from which a Mercury 10 in. dia
was used to mark the other side of the80.17 The cor. to Secs. 4, 5, 8 & 9.
Land level Soil 2' 9" rate.
Some brush the entire mile
was grass.

R. 6 E. continued

- From the corner, to Secs. 5, 6, 31 & 32
on S. Ry. off Sp. post recently
established by my Son North
bet. Secs 31 & 32. $\gamma = 130^{\circ} 10' 2''$
- 40.00 Set a post 3 ft. long 3 ins. diam with marked
stone, 12 ins. in the ground for 1 Sec. Cor,
marked 1 S. on W. face, dug pits 18 x 18 x 12
ins. N and S of post $5\frac{1}{2}$ ft. dist. and raised
a mound of earth $1\frac{1}{2}$ ft. high. $3\frac{1}{2}$ ft. base. around
post.
- 25.00 Set a post 4 ft. long 4 ins. square, with marked
stone, 12 ins. in the ground for Cor, to Secs,
29, 30, 31 & 32 marked T. 7 S S. 29 on
N. E. H. 6 E S. 32 on S. E. S. 31 on
S. W. and S. 30 on N. W. face, with 1 notch
on 2 and 5 notch on 3 on E. edges, dug
pits 18 x 18 x 12 ins. in each Sec., $5\frac{1}{2}$ ft. dist.
and raised a mound of earth 2 ft. high. $4\frac{1}{2}$ ft.
base. around post.
Sand level, Soil 2d. set
same mark the entire with
some glass.

Subdivisions 475

Chain

East on a random line
bet. Secs. 29 & 32

$\gamma = 130^{\circ} 07' 12''$

40.00 Set temporary 1/4 sec. cor.

70.85 Intersect N. S. line 21 Chs. N.
of cor. to Secs. 28, 29, 32 & 33.

Thence S. 89° 51' W. on a true line

bet. Secs. 29 & 32 with same

74.92 Set a post 3 ft. long 3 ins. diam with marked
stone, 12 ins. in the ground for 1/4 Sec, Cor.
marked 1/4 S. on N. face, dug pits 18 x 18 x 12
ins. E and W of post 5 1/2 ft. dist. and raised
a mound of earth 1 1/2 ft. high 3 1/2 ft. base around
post.

74.85 The cor. to Secs. 29, 30, 31 & 32
land level, Soil 2^d rat
Once brush the entire area
same grass.

R. 6 E. continued

Lains

West on a random line
bet. Secs. 30 & 31.N $13^{\circ} 09' E$.

40.00

Set temporary 4 sec. cor.

78.10

Intersect N. Ry of Sp. 26
also N of Cor. to Secs. 29, 30, 31 & 32
just recently establishedby me, Hence I run
N $89^{\circ} 49' E$ on a true line
bet. Secs. 30 & 31. with same on.

38.10

Set a post 3 ft. long 3 ins. diam with marked
stone, 12 ins, in the ground for 1/2 Sec, Cor,
marked 1/2 S. on N face, dug pits 18 x 18 x 12
ins. E and W of post 5 1/2 ft. dist. and raised
a mound of earth 1 1/2 ft. high, 3 1/2 ft. base, around
post.

78.10

The Cor. to Secs. 29, 30, 31 & 32
land level, siled with
dense brush the entire work
some grass.

Subdivisions V 75.

chains

North bet. Secs. 29 & 30
 T₂ 130° 07' 12"

40.00

Set a post 3 ft. long 3 ins. diam with marked stone, 12 ins. in the ground for $\frac{1}{2}$ Sec, Cor marked $\frac{1}{2}$ S. on $\frac{W}{N}$ face, dug pits 18 x 18 x 12 ins. N and S of post 5 $\frac{1}{2}$ ft. dist. and raised a mound of earth 1 $\frac{1}{2}$ ft. high, 3 $\frac{1}{2}$ ft. base. around post.

80.00

Set a post 4 ft. long 4 ins. square, with marked stone, 12 ins. in the ground for Cor, to Secs, 19, 20, 29 & 30 marked T. 75 S. 20 on N. E. R. 6 E S. 29 on S. E. S, 30. on S, W. and N, 19 on N, W, face, with 2 notches on S. and 5 notch 40 on E. edges, dug pits 18 x 18 x 12 ins. in each Sec., 5 $\frac{1}{2}$ ft. dist. and raised a mound of earth 2 ft. high, 4 $\frac{1}{2}$ ft. base. around post.

Land level, Soil 2 ft. out
 on a bush the entire with
 some grass.

Dec 12. 1883.

R. 6 E. continued

chains

Cast on a random line
bet. Secs. 20 + 29.

$\gamma = 13^{\circ} 10' E$

40.00 Set temporary 1/4 sec. cor.

79.87 Intersect N + S line 13 ch. S.
of cor. to Secs. 20, 21, 28 + 29.

Thence I run

$S^{\circ} 89^{\circ} 54' W.$ on a true line
bet. Secs. 20 + 29, north corner
va

39.93

Set a post 3 ft. long 3 ins. diam with marked
stone, 12 ins. in the ground for $\frac{1}{4}$ Sec. Cor.,
marked $\frac{1}{4}$ S. on N face; dug pits 18 x 18 x 12
ins. E and W of post $5\frac{1}{2}$ ft. dist. and raised
a mound of earth $1\frac{1}{2}$ ft. high, $3\frac{1}{2}$ ft. base. around
post.

79.87

Set cor. to Secs. 19, 20, 29 + 30
Land level, set 2^d rail
thence travel the entire 40th ch.
north corner.

subdivisions of 45.

Chains

West on a random line
bet. Secs. 19 + 30

To 13° 07' 12"

40.00 Set temporary of sec. cor.

78.02 Intersect W. B. of Sp
16 lks S. of cor. to Secs. 19, 20, 29, 30
just recently established
by ed. Thence I run

S. 89° 53' 5" on a true line
bet. Secs. 19 + 30. with sens. va.

98.02 Set a post 3 ft. long 2 in. diam with marked
stone, 12 ins. in the ground for $\frac{1}{4}$ Sec. Cor.
marked $\frac{1}{4}$ S. on N. face, dug pits 18 x 18 x 12
ins. E and W of post $5\frac{1}{2}$ ft. dist. and raised
a mound of earth 1 $\frac{1}{2}$ ft. high, 3 $\frac{1}{2}$ ft. base, around
post.

78.02 The cor. to Secs. 19, 20, 29 + 30
Sand level. Soil 2 $\frac{1}{2}$ rate
Thence brush the entire east
corner grass.

R. C. E. continued

claim

North bet. Secs. 19 + 20
T. 13° 09' E

4-50

Set a post 3 ft. long 3 ins. diam. with marked stone, 12 ins. in the ground for $\frac{1}{4}$ Sec. Cor., marked $\frac{1}{4}$ S. on $\frac{1}{4}$ face, dug pits 18 x 18 x 12 ins. N. and S. of post $3\frac{1}{2}$ ft. dist. and raised a mound of earth $1\frac{1}{2}$ ft. high $3\frac{1}{2}$ ft. base. around post.

8-50

Set a post 4 ft. long 4 ins. square, with marked stone, 12 ins. in the ground for Cor. to Secs. 17, 18, 19 + 20 marked T. 78 S. 17 on N. E. R. 6 E S. 20 on S. E. S. 19 on S. W. and S. 18 on N. W. face, with 3 notches on S. and 1 notch 20 on E. edges, dug pits 18 x 18 x 12 ins. in each Sec., $5\frac{1}{2}$ ft. dist. and raised a mound of earth 2 ft. high $4\frac{1}{2}$ ft. base. around post.

Land level. Soil 2 d. rate
Be sure to mark the entire with
some grass

12 m. I find latitude to be 32° 49' N.
and just in adjustment -

Subdivisions of 75.

chains

East on a random line
bet. Secs. 17 & 20.

To 13° 09' 18"

4000 Set benchmark 1/4 sec. cor.

79.80 Intersect N. S. line 17 1/2 S.
of cor. to Secs. 16, 17, 20 & 21Distance 9 pm S. 89° 58' W.
on a true line bet. Secs. 17 & 20
with same ea.39.90 Set a post 3 ft. long 3 ins. diam with marked
stone, 12 ins. in the ground for 1/4 Sec. Cor.
marked 1/4 S. on N. face, dug pits 18 x 18 x 12
ins. E and W of post 51 ft. dist and raised
a mound of earth 1 1/2 ft. high 3 1/2 ft. from ground
post.

17, 18, 19, 20

79.80 The Cor. to Secs. 16, 17, 20 & 21
sand level, 3/4 sec. of east
Secs. brush the cut in north
some grass.

R. C. E. continued

- | | |
|--------|--|
| Chalco | West on a random line
bet. Secs. 18 & 19.
Va $13^{\circ} 09' 12''$ |
| 4.00 | Set temporary $\frac{1}{4}$ sec. cor. |
| 78.00 | Intersect N. By of Tp. 17
Ch. N. of cor. to Secs. 13, 18, 19 & 20
not recently established by me
since I run $N 89^{\circ} 53' E$.
on a true line bet. Secs.
18 & 19. with same va. |
| 38.00 | Set a post 3 ft. long 3 ins. diam with marked
stone, 12 ins. in the ground for $\frac{1}{4}$ Sec. Cor,
marked $\frac{1}{4}$ S. on N face, dug pits 18 x 18 x 12
ins. E and W of post 5 ft. dist. and raised
a mound of earth 12 ft. high 2 ft. base. around
post. |
| 78.00 | Set cor. to Secs. 17, 18, 19 & 20
Sand level. Post 2 ^d set
N. on line of the cut in with
some grass. |

Subdivisions A 75

chains

North bet. Secs. 17 & 18

T_a 13° 07' 12"

40.00

Set a post 3 ft. long 3 ins. diam with marked stone, 12 ins. in the ground for $\frac{1}{4}$ Sec. Cor. marked $\frac{1}{4}$ S. on W face, dug pits 18 x 18 x 12 ins. N and S of post $5\frac{1}{2}$ ft. dist. and raised a mound of earth $1\frac{1}{2}$ ft. high. $3\frac{1}{2}$ ft. base. around post.

80.00

Set a post 4 ft. long 4 ins. square, with marked stone, 12 ins. in the ground for Cor. to Secs. 7, 8, 17, 18 marked 1, 7, 8 S. 7 on N. E. R. 6 S. 17 on S. E. S. 18 on S. W. and S. 7 on N. W. face, with γ notch ϵ on S. and δ notch ϵ on E. edges, dug pits 18 x 18 x 12 ins. in each Sec., $5\frac{1}{2}$ ft. dist. and raised a mound of earth 2 ft. high. $4\frac{1}{2}$ ft. base. around post.

Land level. Soil 2 d. m. t.
shown below the entire m. t.

R. & S. continued

Chains

East on a random line
bet. Secs. 8 & 17.To $13^{\circ} 09' E$

4000 Set temporary 4 sec. cor.

79.75 Intersect N & S line 12th

N of cor. to Secs. 8, 9, 16 & 17

thence I run N $89^{\circ} 55' W$.

on a true line bet. Secs.

8 & 17. with same vo.

39.87

Set a post 3 ft. long 3 ins. diam with marked
stone, 12 ins. in the ground for $\frac{1}{4}$ Sec, Cor,
marked $\frac{1}{4}$ S. on N face, dug pits 18 x 18 x 12
ins. E and W of post 54 ft. dist. and raised
a mound of earth 14 ft. high by PL base around
post.

79.75

The Cor. to Secs. 7, 8, 17 & 18

find level. Set 2^d set
same mark with entire with
same pins.

BOOK 680

Subdivisions of 75.

chains

West on a random line
bet. Secs. 7+18 $T = 13^{\circ} 49' 12''$ 40.00 Set temporary $\frac{1}{4}$ sec. cor.78.10 Intersect W. B. of T. P. 16
Ch. N. of Cor. to Secs. 7, 12, 13 & 18
just recently established by me
Thence I run N $89^{\circ} 53' 2''$
on a true line bet. Secs. 7 & 18
with same $\frac{1}{4}$ sec. cor.58.10, Set a post 3 ft. long 3 ins. diam with marked
stone, 12 ins, in the ground for $\frac{1}{4}$ Sec. Cor.
marked $\frac{1}{4}$ S. on N face, dug pits 18 x 18 x 12
ins. E and W of post 5 $\frac{1}{2}$ ft. dist. and raised
a mound of earth 1 $\frac{1}{2}$ ft. high, 3 $\frac{1}{2}$ ft. base, around
post.78.10. In cor to Secs. 7, 8, 17+18,
land loc. Sect 2 & 10
line bet. the entire chain
same place.

R. 6 E. continued

chains

North bet. Secs. 7 & 8.
Ta $13^{\circ} 07' 2''$

7000

Set a post 3 ft. long 3 ins. diam with marked stone, 12 ins, in the ground for $\frac{1}{4}$ Sec, Cor, marked $\frac{1}{4}$ S. on W face, dug pits 18 x 18 x 12 ins. N and S of post $5\frac{1}{2}$ ft. dist. and raised a mound of earth $1\frac{1}{2}$ ft. high $2\frac{1}{2}$ ft. base. around post.

8000

Set a post 4 ft. long 4 ins. square, with marked stone, 12 ins, in the ground for Cor, to Secs, 6, 6, 7 & 8 marked T. 7 S. 5 on N. E. R. 6 E S. 8 on S. E. S. 7 on S. W. and S. 6 on N. W. face, with \mathcal{S} notch on S, and \mathcal{E} notch on E. edges, dug pits 18 x 18 x 12 ins. in each Sec., $5\frac{1}{2}$ ft. dist. and raised a mound of earth 2 ft. high $4\frac{1}{2}$ ft. base. around post.

Land level, Soil & etc.
Some brush the surface and
some grass.

Subdivisions: No. 75

Chains

East on a random line
bet. Secs. 5 & 8.

Va. $13^{\circ} 06' E$.

4000 Set temporary 4 sec. cor.

79.77 Intersect N.S. line 19th Sec.

S of cor. to Secs. 4, 5, 8 & 9

Thence I run

S. $89^{\circ} 52' W$. on a true
line bet. Secs. 5 & 8. with
same va.

39.88 Set a post 3 ft. long 3 ins. diam with ~~marked~~
stone, 12 ins, in the ground for $\frac{1}{4}$ Sec. Cor.
marked $\frac{1}{4}$ S. on N face, dug pits 18 x 18 x 12
ins. E and W of post 5 $\frac{1}{2}$ ft. dist. and raised
a mound of earth 1 $\frac{1}{2}$ ft. high, 3 $\frac{1}{2}$ ft. base around

post.

79.77 The cor. to Secs. 5, 6, 7 & 8.

land level, Soil 2 $\frac{1}{2}$ rats
thence bound the entire with
some grass.

R. & S. continued

chain

West on a random line
bet. Secs. 6 & 7.

To $13^{\circ} 09' E$.

40.00 Set benchmark $\frac{1}{4}$ sec cor.

77.95 Intersect N. Ry. of S. 16
lbs S. of Cor. to Secs. 1, 6, 7 & 12
Just recently established
by me, True. True $S^{\circ} 89^{\circ} 53' E$.
on a true line bet. Secs.
6 & 7, with cause va.

37.95 Set a post $3\frac{1}{2}$ ft. long 3 ins. diam with marked
stone, $1\frac{1}{2}$ ins. in the ground for $\frac{1}{4}$ Sec. Cor.
marked $\frac{1}{4}$ S. on N. face, dug pits $18 \times 18 \times 12$
ins. E and W of post $5\frac{1}{2}$ ft. dist. and raised
a mound of earth $1\frac{1}{2}$ ft. high, $3\frac{1}{2}$ ft. base. around
post.

77.95 The cor. to Secs. 5, 6, 7 & 8.
Sand level, Soil 2^d rate
dense brush the entire north
some grass.

Subdivision 4.7.5

Chains

North on a random
line betw Secs. 5 & 6.Ta $13^{\circ} 09' E$.

40.00 Set temporary, 4 sec. cor

80.10 Intersect N. By. & Sp. 16th
N. of the cor. to Secs. 5.6.31 & 32
first recently established
by one, & hence I run $50^{\circ} 44' N$ on a true line
betw Secs. 5 & 6. with same co.10
40.45Set a post 3 ft. long 3 in. diam with marked
stone, 12 in. in the ground for $\frac{1}{4}$ Sec, Cor.
marked $\frac{1}{4}$ S. on N. face, dog pits 18 x 18 x 12
ins. N. and S. of post $5\frac{1}{2}$ ft. dist. and raised
a mound of earth $1\frac{1}{2}$ ft. high $3\frac{1}{2}$ ft. base. around
post,

80.10

The Cor. to Secs. 5.6.7 & 8
land level, Soil 22 rat
Dense brush the entire line

Dec 13. 1883.

R. 6 E. continued.

General Description

This township is situated in the level valley of the Santa Cruz River, it is covered with a dense growth of brush and the soils mostly a 2° rate. Near the center of the township is a Mountain range extending north westerly & south easterly. Water may be had by sinking 40 to 50 feet below the surface.

There is some good grazing in the Township.

For final notes see book No. 18.

U. S. Surveyor General's Office,

Tucson, Arizona, *May 22* 188*4*/*5*

The foregoing Field Notes of the Survey of the

*Subdivision lines of
Township 7 South
Range 6 East*

Of the Gila and Salt River Base and Meridian, Arizona, execu-
ted by *R. L. Powers*

Deputy Surveyor, under his contract of the *20th*

day of *July*, 188*3*, having been

critically examined and the necessary corrections and explana-

tions made, the said Field Notes and the surveys they describe

are hereby approved

Royal Johnson
Surveyor General.