

Contract 41
F. W. No 2.
Corrections

BOOK 741

No. 741

Subdivisions

4-671

741

FIELD NOTES

GENERAL LAND OFFICE.

Survey of
Twp. 7 S. Range 7 E.
in land salt river Basin
Arizona.

By R. C. Powers, D.S.

Under Contract dated July 20, '83.

Survey commenced Nov. 28, '87.

Completed Dec. 7, '87.

approved - by Com^r G. L. O.
February. 27. 1890.

PAYOT, UPHAM & Co., Stationers and Printers, Drawing Materials, etc., 204 Sansome St., S.F.

Township No. 7 South Range No. 7 East, Gila & Salt River Meridian

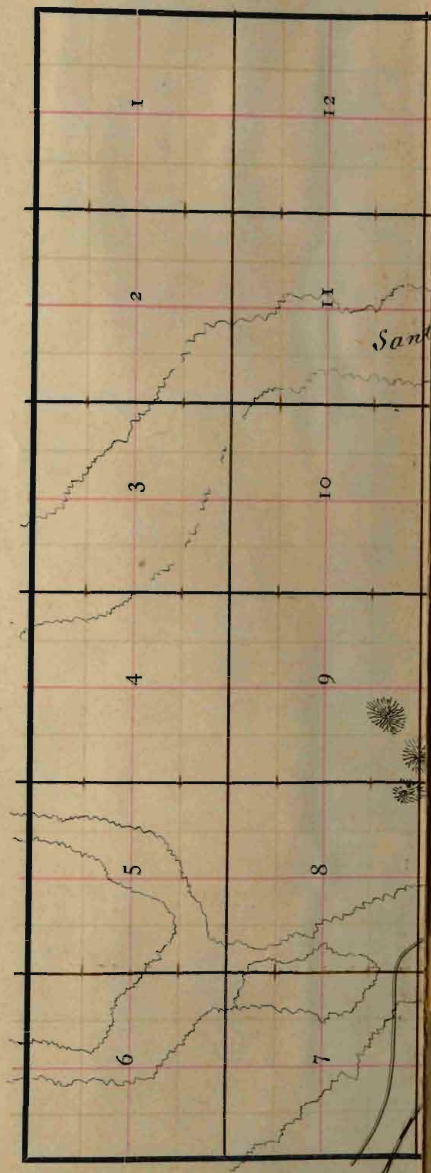

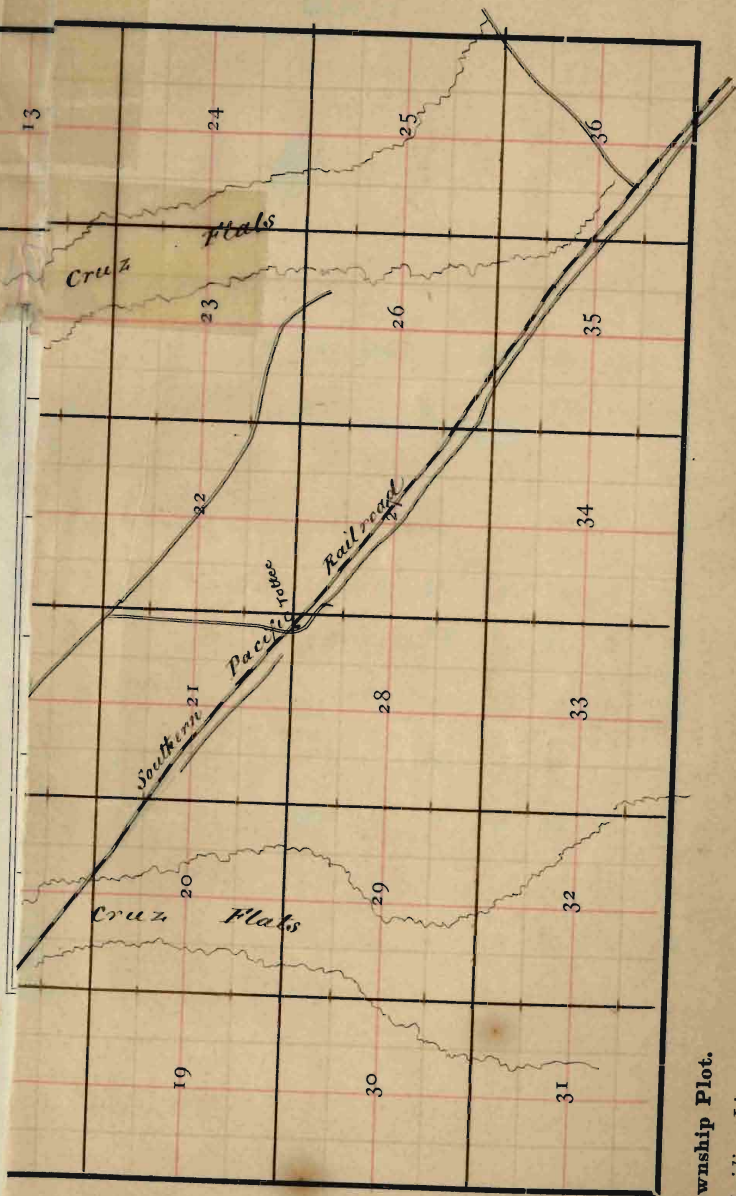

Township Plot.
Meridian Line,

BOOK 741

Index.

Township. *9. E* R. *7. E*

6	79	5	59	4	45	3	30	2	16	1
78		77		58		44		29		15
7	76	8	57	9	43	10	28	11	13	12
75		74		56		41		27		12
18	72	17	55	16	40	15	25	14	11	13
71		70		54		38		24		9
19	69	20	52	21	37	22	23	23	8	24
67		66		51		36		21		7
30	65	29	50	28	34	27	20	26	5	25
63		62		48		33		19		4
31	61	32	47	33	32	34	17	35	3	36

No Topography

Field Notes
of the Survey of the
Subdivision Lines
of
Township 9 South, Range 7 East
of
the Gila and Salt River
Meridian
of
Arizona Territory
as surveyed by
R. C. Powers
U. S. Dep. Sur-
Under his Contract No 41
Dated July 20th 1883

Survey commenced Nov 28th 1887
Survey completed Dec 7th 1887

Subdivisions T9 S R 7 E.

Preliminary to commencing this survey I ran
west on a black line on the south boundary
of Sec 36 and at 39.98 chs found the $\frac{1}{2}$ sec cor and
at 80.00 chs found the sec cor. I also ran S on
the E boundary of Sec 36 and at 40 chs found
the $\frac{1}{2}$ sec cor and at 80 chs found the sec cor.
My compass will therefore run the same line
as the exterior boundaries and the chaining
applies

Survey commenced Nov 28th 1887 with a Burt's
improved Solar Compass

~~For preliminary notes etc see book No. 740 Exterior
boundaries~~

At 12 o'clock this day I took latitude and found
it to be $32^{\circ}38'N$. I also carefully
examined my compass and found
it to be in good adjustment.

I commenced at the
cor. to Secs 1, 2, 35, & 36 on the

T. J. R. & Co. - Continued

Boundary of the Township previously established and described by me.

Thence I run
North bet Secs 35 & 36

Bear. $12^{\circ} 50' E$.

Over level ground

40.00 Set mesquite post 3 ft long 3 in. square with marked stone 12 in in the ground for $\frac{1}{4}$ Sec cor marked to S. on W. face, dug pits $18 \times 18 \times 12$ in N. & S of post $5\frac{1}{2}$ ft dist. and raised a mound of earth $1\frac{1}{2}$ ft high $3\frac{1}{2}$ ft base around post

80.00 Deposited a marked stone 12 in in the ground for cor to secs 25, 26, 35 & 36, dug pits $18 \times 18 \times 12$ in in each sec

chs

T 9 S. R 7 E

5½ ft-dia and raised a mound
of earth 2 ft-high 4½ ft-base
over it. In S.E. pit drove

a stake 2 ins sq x 2 ft long
12 ins in the ground marked

T 9 S. S 25 on NE

R 7 E S. 36 on S.E.

S 35 on SW and

S. 26 on N.W. faces with 1 notch
on S and E edges

Land level

Soil sedimentary 19th rate

Dense greasewood brush entire mile

E on a random line bet Sec 25 & 36

70.12° 50' E

40.00 Set temporary ¼ Sec Cor

80.12 Intersect E. boundary of the ¼

32 chs S. of the Cor to Secs 25, 30

cls

T9S. R7E

31 and 36 previously described
Thence I run

S 89° 46' N. on a true line bet Secs 25 & 36
with same va

Over level ground

40.06 Set mesquite post 3 ft long
3 ins sq with marked stone
12 ins in the ground for $\frac{1}{4}$ Sec
Cor marked $\frac{1}{4}$ S on N face, dug pits
18 + 18 + 12 ins E and W of post 5 ft
dist and raised a mound of earth
1 $\frac{1}{2}$ ft high 3 $\frac{1}{2}$ ft base around post

80.12 Cor to Secs 25, 26, 35 & 36

Land level

Soil sedimentary 1 $\frac{1}{2}$ rate
Dense greasewood brush entire mile

N. bet Secs 25 and 26

7a 12° 50' E

T 9 S. R 7 E

Over level ground

40.00 Set mesq. post 3 ft long 3 ins sq
with marked stone 12 ins in
the ground for $\frac{1}{4}$ Sec. Cor marked
 $\frac{1}{4}$ S. on W face dug pits 18+18
+12 ins N & S. of post 5 $\frac{1}{2}$ ft dist
and raised a mound of earth
1 $\frac{1}{2}$ ft high 3 $\frac{1}{2}$ ft base around post

80.00 Set mesq. post 4 ft long 4 ins sq
with marked stone 12 ins in the
ground for Cor. to Secs. 23. 24
25 and 26 marked

T 9 S. S 24 on N.E.

R 7 E. S 25 on S E

S 26 on S W and

S. 23 on N W faces with 2 notches
on S. and 1 notch on E. edges. dug
pits - 18+18+12 ins N & S of post
5 $\frac{1}{2}$ ft dist. and raised a mound

T₉ S. 10 7 E

of earth 2 ft high 4½ ft base around
 post Land level

Soil sedimentary 1st rate
 Dense greasewood bush entire mile

4 E. on a random line bet. Secs. 24 & 25

va 12° 50' E

40.00 Set temporary ¼ Sec Cor

79.65 Intersect E boundary of the township

42 cks S of the Cor to Secs 19, 24

25 and 30 previously described by me

Thence I run

8 S 89° 42' W. on a true line bet Secs 24 & 25

with same va

over level ground

39.82 Set merge post 3 ft long 3 ins sq

with marked stone 12 ins in the

ground for ¼ Sec Cor marked

¼ S on N face; dug pits 18 + 18 + 12

chs T 9 S. R. 7 E.

jus E & W. of post $5\frac{1}{2}$ ft - dist. and raised
a mound of earth $1\frac{1}{2}$ ft high $3\frac{1}{2}$ ft -
base around post -

7965 - Cor. to Secs 23, 24, 25 and 26

Land level

Soil sedimentary (or rate)
dense grass wood entire mile.

N. bet. Secs. 23 and 24

to $12^{\circ} 50'$ E.

Over level ground

40.00 Set mesq. post 3 ft long 3 ins
sq. with marked. drove 12 ins
in the ground for $\frac{1}{4}$ Sec. Cor marked
 $\frac{1}{4}$ Sec on W. face. dug pits 78 + 18 + 12
ins N & S of post $5\frac{1}{2}$ ft dist and
raised a mound of earth $1\frac{1}{2}$ ft -
high $3\frac{1}{2}$ ft - base around post -

80.00 Set mesq. post 4 ft long 4 ins sq

e. chs

Tg S. R 7 E

with marked stone 12 ins in the
ground for Cor to Secs 13, 14,
23 and 24 marked

Tg S. S 13 on NE

R 7 E. S 24 on SE

S 23 on SW and

S. 14 on NW faces with 3 notches
on S. and 1 notch on E edges. dug
pits 18 + 18 + 12 ins in each Sec
 $5\frac{1}{2}$ ft dist. and raised a mound
of earth 2 ft high $4\frac{1}{2}$ ft base
around post -

Land level

Soil sandy loam

Dense greasewood brush entire mile

Considerable Guyetta

E. on a random line bet Secs 13 + 24

Va $12^{\circ} 49' E$

chs

T. S. R. 7 E

40.00 Set temporary $\frac{1}{4}$ Sec cor79.80 Intersect E boundary of township
28 lks S. of the cor to Secs 13, 18, 19 & 24

Thence I run

S $89^{\circ}48'$ W. on a true line bet Secs 13 & 24

with same va

Over level ground

39.90 Set metal post 3 ft long 3 ins sq
with marked stone 12 ins in the
ground for $\frac{1}{4}$ Sec cor marked $\frac{1}{4}$
S. on N face; dig pits 18+18+12
ins E & W of post $5\frac{1}{2}$ ft dist and
raised a mound of earth $1\frac{1}{2}$ ft high
 $3\frac{1}{2}$ ft base around post -

79.80 Cor. to Secs 13, 14, 23 & 24

Level level

Soil sandy loam

Dense greasewood entire mile

chs T9 S. R 7 E.

N. bet Secs 13 and 14

7a 12° 49' E

Over level ground

40.00 Set post 3 ft long 3 ins sq
with marked stone 12 ins in
the ground for 1/4 Sec Cor marked
1/4 S on N. face dug pits 18+18+
12 ins N + S of post 5 1/2 ft dist
and raised a mound of earth
1 1/2 ft high 3 1/2 ft diam around post

80.00 Set mesq post 4 ft long 4 ins
sq with marked stone 12
ins in the ground for Cor to Secs
11, 12, 13 and 14 marked
T9 S. S 12 on N. E.

R 7 E S 13 on S E

S 14 on SW end

S. 11 on N W faces with 4 notches
on S. and 1 notch on E edges

chs

T. S. R. 7 E

Dug pits 18+18+12 ins in each
 the 5 1/2 ft dist. and raised a
 mound of earth 2 ft high 4 1/2 ft -
 base around post -

Sand level

Soil sedimentary 1st rate
 dense brush entire mile

E. on a random line but Secs 12+13
 on 12° 49' E

40.00 Set temporary 1/4 Sec Cor

80.20 Intersect E. boundary of township
 40 cks S. of the Cor to Secs 7, 12, 13+18

Thence I run

S 89° 04' 3/4 W. on a true line but Secs 12+13
 with same run

Over level ground

40.10 Set survey post 3 ft long 3 ins
 sq or with marked stone 12 ins

chs 19 S. R. 7 E

in the ground for $\frac{1}{4}$ Sec Cor
 Marked $\frac{1}{4}$ S on N face; dug pits
 18+18+12 ins E + W of post $3\frac{1}{2}$ ft
 dia and raised a mound of
 earth $1\frac{1}{2}$ ft high $3\frac{1}{2}$ ft base
 around post -

80.20 Cor. to Secs 11, 12, 13 + 14

Land level

Soil sedimentary 1st rate
 dense brush entire mile

N. bet - Secs 11 and 12

2a 12° $49'$ E

Over level ground

40.00 Set post 3 ft long 3 ins sq rivet
 marked stone 12 ins in the
 ground for $\frac{1}{4}$ Sec Cor marked
 $\frac{1}{4}$ S on N face; dug pits 18+18+
 12 ins N + S of post $3\frac{1}{2}$ ft dia -

cls

Tg S. R. 7 E

and raised a mound of earth
 $1\frac{1}{2}$ ft high $3\frac{1}{2}$ ft base around post
 80.00 Set mesq post 4 ft long 4 ins
 sqr with marked stone 12 ins
 in the ground for lots to sects

1, 2, 11 and 12 marked

Tg S. S. 1 on N.E.

R. 7. E. S. 12 on S.E.

S. 11 on SW and

S. 2 on NW faces with 5 notches
 on S. and 1 notch on E edges
 they put 15 + 18 + 12 ins in each
 sect $5\frac{1}{2}$ ft dist. and raised a
 mound of earth 2 ft high 4 ft
 base around post -
 Land level

Soil sedimentary 1st with
 dense grasswood brush and timber

Nov. 28th 1887

6 chs T 9 S R 7 E

Co. on a random line bet Secs 1 & 12

7a 12° 49' E

40.00 Set temporary 1/4 Sec Cor

80.30 Intersect E boundary of Township
60 chs S. of the Cor to Secs 1, 6, 7 & 12

Thence S 1/4 run

S 89° 34' W. on a true line bet Secs 1 & 12

with same ra

Over level ground

40.15 Deposited a marked stone 12 ins
in the ground for 1/4 Sec Cor

dug pits 15 + 15 + 12 ins E + W

3 1/2 ft - dist - and raised a mound

of earth 1 1/2 ft high 3 1/2 ft base

over it. In E pit drove a

slate 2 ft long 2 ins sq or 12

ins in the ground marked 1/4 S

on N face

80.30 Cor to Secs 1, 2, 11 and 12

cls

T of S R 7 E

Sand level

Soil sedimentary 18th rate
sense brush entire mile

Now a random line bet Secs 1 and 2

va 120 49' E

40.00 Set temporary 1/4 Sec Cor

80.45 Intersect N. boundary of township
at the Cor to Secs. 1, 2, 35 + 36

Thence I run

S on a true line bet Secs 1 and 2

with same va

Over level ground

40.45 Set mesq¹ post 3 ft long 3 ins eye

with marked stone 12 ins in

the ground for 1/4 Sec Cor marked

1/4 Sec on N face dug pits 18 + 15

+ 12 ins N + S of post - 5 1/2 ft dist

and raised a mound of earth 6 1/2

chs

T₉ S. R. 7 E

ft high $3\frac{1}{2}$ ft - bare around post
80.45 - Cor to Secs 1, 2, 11 and 12

Land level

Soil sedimentary 18⁺ rate
dense brush entire mile

At 12 o'clock M today I took
latitude and found it to be $32^{\circ} 40' N$
I also carefully examined my
Compass and found it to be in
good adjustment.

From the Cor to Secs 2, 3, 34 and 35
on the S boundary of the township
previously described by me.

I run
N. bet Secs 34 and 35 -

bc $12^{\circ} 50' E$

No. 741

18

BOOK 741

chs

T 9 S. R 7 E

Over level ground.

40.00 Set survey post 3 ft long 3 ins agr
with marked stone 12 ins in the
ground for $\frac{1}{4}$ Sec for marked $\frac{1}{4}$
S on W face, dug pits 18+18+12 ins
to S of post $5\frac{1}{2}$ ft dist, and raised
a mound of earth 1 $\frac{1}{2}$ ft high $3\frac{1}{2}$
ft base around post.

80.00 Set survey post 4 ft long 4 ins agr
with marked stone 16 ins in the
ground for Cor to Secs. 26, 27, 34 &
35 marked

T 9 S. S. 26 on N. E.

R 7 E S 35 on S. E.

S. 34 on SW and

S 27 on NW face with notch on
S. and 2 notches on E edges
Dug pits 18+18+12 ins in each
Sec. $5\frac{1}{2}$ ft dist and raised a

Tg S R 7 E

cl
mound of earth 2 ft high
4 1/2 ft base around post -
Sand level

Soil sedimentary 2nd rate
dense grasswood brush entire mile

4 E. on a random line bet Secs 26 & 35

ra 12° 49' E

40.00 Set temporary 1/4 Sec Cor

79.78 Submerged A+S line 21 lbs S of
Cor to Secs 25, 26, 35 and 36

Thence I run

8 S. 89° 51' W. as a true line bet Secs 26 & 35

with same ra

Over level ground
39.89 Deposited marked stone
12 ins in the ground ^{for 1/4 Sec Cor}; day pits
18 + 18 + 12 ins E + W. 5 1/2 ft
dist and raised a mound of
earth 1 1/2 ft high 3 1/2 ft base

chs

T. S. R. & E

one it. In S pit-drove a
slate 2 ft long 2 ins sqr 12
ins in the ground marked
1/4 S on N face.

79.78 Cor. to Secs 26, 27, 34 and 35
Land level

Soil sedimentary 1st rate
Scrub brush entire mile

Nov. 29th 1887

N. bet Secs 26 and 27
70 120 49' E

Over level ground

40.00 Set mery. post 3 ft long 3 ins sqr
with marked stone 12 ins in the
ground for 1/4 Sec. Cor marked 1/4
S. on N face. dug pits 18 + 18 + 12 ins
N. & S. of post 5 1/2 ft dist and
raised a mound of earth 1 1/2 ft
high 3 1/2 ft base around post

cho

T9 S R7 E

8000 Set magnet post 4 ft long 4 ins
 sq. with marked stone 12 ins
 in the ground for Cor to Secs
 22, 23, 26 and 27 marked
 T9 S S 23 on N.E.
 R7 E S 26 on S.E.
 S 27 on SW and
 S. 22 on NW faces with 2 notches
 on S. and E. edges dug pits
 18+18+12 ins in each Sec
 5½ ft-dia. and raised a mound
 of earth 3 ft high ½ ft base
 around post

Land level

Soil sedimentary 18th rate
 pens brush entire mile

E. on a random line bet Secs 23 & 26

Va 12° 49' E

chs

T. G. S. R. 7 E

40.00 Set temporary $\frac{1}{4}$ Sec. Cor.
 79.72 Intersect N & S line 25-cks S of the
 Cor to Secs. 23, 24, 25 and 26.

Thence I run

S $89^{\circ} 49' N$, on a true line bet - Secs 23 + 26

With some va

Over level ground

39.86 Set mesq. post 3 ft - long 3 ins agr
 with marked stone 12 ins in
 the ground for $\frac{1}{4}$ Sec. Cor marked
 $\frac{1}{4}$ S. on N face, dug pits 18 + 18 + 12
 ins E + W of post $5\frac{1}{2}$ ft dist and
 raised a mound of earth $1\frac{1}{2}$ ft
 high $3\frac{1}{2}$ ft - base around post -

79.72 Cor. to Secs. 27, 23, 26 + 27

Land level

Soil sandy loam
 dense greasewood brush entire
 mile. Guyetta grass.

clus Tg S. R 7 E

N. bet - Secs 22 and 23

va 120 49' E

Over level ground

40.00 Set mays post 3 ft long 3 ins
sq or with marked stone 12 ins
in the ground for $\frac{1}{4}$ Sec 22
marked $\frac{1}{4}$ S on N face, dry
pits 18 + 18 + 12 ins N & S of
post 3 $\frac{1}{2}$ ft dia. and raised
a mound of earth 1 $\frac{1}{2}$ ft high 3 $\frac{1}{2}$
ft base around post.

8
+ 80.00 Set mays post 4 ft long
4 ins sq or with marked stone
12 ins in the ground for Cor to
Secs. 14, 15, 22 and 23 marked
Tg S S 14 on N. E.
R 7 E S 23 on S. E.
S. 22 on SW and
S. 15 on NW faces with 3 mclus

cls

Tg S R 7 E

on S. and 2 notches on E edges
 dug pits 18+18+12 ins in each
 Sec. 5 1/2 ft dist and raised a mound
 of earth 2 ft high 4 ft base around post.

Land level

Soil loamy

Some grass and some brush
 entire mile

E. on a random line bet Secs 14 & 23
 Va 120 49' E

40.00 Set temporary 1/4 sec cor

80.00 Intersect N & S line 14 lks

S. of cor to Secs 13, 14, 23 + 24

Thence I run

S 89° 54' W on a true line bet Secs 14 & 23
 with some va

Over level ground

40.00 Set mesq post 3 ft long 3 in's age

chs

T₉ S R 7 E

with marked stone 12 ins in the
ground for $\frac{1}{4}$ Sec Cor marked $\frac{1}{4}$
S. on N face; dug pits 18+18+12 ins
E + W of post 5 $\frac{1}{2}$ ft dist and
raised a mound of earth 1 $\frac{1}{2}$ ft
high 3 $\frac{1}{2}$ ft base around post -
80.00 Cor to Secs 14, 15, 22 + 23

Land level

Soil heavy 1st rate
some Sage brush & greasewood ^{with} ~~with~~

N. bet. Secs. 14 and 15

7a 120 49' Ee

Over level ground

40.00 Set mesq^{it} post 3 ft long 3
ins sq with marked stone
12 ins in the ground for $\frac{1}{4}$
Sec Cor marked $\frac{1}{4}$ S on N face
dug pits 18+18+12 ins N + S

Chs

T₉ S. R₇ E.

of post $3\frac{1}{2}$ ft-dia and raised
a mound of earth $1\frac{1}{2}$ ft high $3\frac{1}{2}$ ft
base around post.

80.00 Set mark 1 post 4 ft long 4 ins
sq with marked stone 12 ins
in the ground for Cor to Secs 10, 11
14 and 15 marked

T₉ S. S. 11 on N.E.

R₇ E. S. 14 on S.E.

S. 15 on SW and

S. 10 on N.W. faces with 4 notches on
S. and 2 notches on E. edges
flag pits 18 + 18 + 12 ins in each
Sec. $5\frac{1}{2}$ ft dia. and raised a
mound of earth 2 ft high $4\frac{1}{2}$
ft base around post.

Land line

Soil sandy loam

Scuse brush entire mile
& quail grass.

Chs

T. S. R. 7 E

E. on a random line bet Secs 11 + 14

wa $12^{\circ} 49' E$ 40.00 Set temporary $\frac{1}{4}$ Sec Cor.

79.90 Intersect N + S line 21 els N. of

Cor to Secs 11, 12, 13 and 14.

Thence I run

N. $89^{\circ} 54' W$ on a true line bet Secs 11 + 14

with same wa

Over level ground

39.95 - Set mag. post 3 ft long 3 ins agr
with marked stone 12 ins in the
ground for $\frac{1}{4}$ Sec Cor marked
 $\frac{1}{4}$ Sec N. face, dug pits 18 + 18 + 12
ins E + W of post $5\frac{1}{2}$ ft dist and
raised a mound of earth 1 $\frac{1}{2}$ ft
high $3\frac{1}{2}$ ft base around post -

79.90 Cor to Secs 10, 11, 14 and 15 -

Land level

Soil sedimentary 15' thick -
dense brush entire mile.

Chs T. 9 S. R 7 E

N. bet - Secs 10 and 11

wa 120° 49' Ee

Over level ground

40.00 Set mngt post 3 ft long 3 ins sq x with
marked stone 12 ins in the ground
for $\frac{1}{4}$ Sec 10, marked $\frac{1}{4}$ Sec 11, face
due pits - 18 + 18 + 12 ins. N + S of
post $5\frac{1}{2}$ ft - dia., and raised a
mound of earth $1\frac{1}{2}$ ft - high
 $3\frac{1}{2}$ ft - base around post -

80.00 Set mngt post 4 ft long 4 ins sq x with
marked stone 12 ins in the ground for
to Secs. 2, 3, 10 & 11 marked

T. 9 S. S 2 on N. E.

R 7 E. S. 11 on S. E.

S 10 on SW and

S 3 on NW faces with 5 notches on
and 2 notches on E edges due
pits 18 + 18 + 12 ins in each Sec

cls

Tg S. R. y E

$5\frac{1}{2}$ ft-dia; deep raised a mound
of earth 2 ft high $4\frac{1}{2}$ ft base
around post

Land level

Soil loamy 1st route
bears brush entire mile

E. on a random line bet Secs 2 & 11

7a. $12^{\circ} 49' E$

40.00 Set temporary $\frac{1}{4}$ Sec Cor

79.84 Intersect N & S line 18 lks N
of Cor to Secs 1, 2, 11 and 12

Thence I run

N. $89^{\circ} 52' N.$ on a true line bet Secs 2 & 11

with same o.c.

Over level of ground

39.92 Set mesquite post 36 in long 3 ins

sq. with marked stone 12 ins
in the ground for $\frac{1}{4}$ Sec Cor

30

cls

T₉ S R₇ E

marked $\frac{1}{4}$ S on N face; dug pits
 18+18+12 ins E + W of post $3\frac{1}{2}$
 ft dia and raised a mound
 of earth $1\frac{1}{2}$ ft high $3\frac{1}{2}$ ft base
 around post.

79.84 Cor. to Secs 2, 3, 10 and 11

Land level

Soil sedimentary ¹⁰⁰ natl
 dense brush entire mile

N. on a random line bet Secs ²
 $7^{\circ} 12' 49''$ Ee

40.00 Set temporary $\frac{1}{4}$ sec cor

80.35 Entered N. boundary of the township
 21 cks E. of the cor to Secs 2, 3, 34+35

thence I run

S. $00^{\circ} 29'$ E. on a true line bet Secs 2+3

with same ra

Over level ground.

Chs

Tq S. R. 7 E

40.35 Set misc post 3 ft long 3 in
sq r with marked stone 12 in
in the ground for $\frac{1}{4}$ Sec, for marked
 $\frac{1}{4}$ S on W face, dug pits 78+18+12
ins N & S of post $5\frac{1}{2}$ ft dist.
and raised a mound of earth

4
80.35 $1\frac{1}{2}$ ft high $3\frac{1}{2}$ ft base mound post
The Cor to Secs. 2, 3, 10 and 11.
Sand level

Soil sedimentary 1st rate
burned greasewood & sage brush
entire mile.

Nov. 30th, 1887.

Chs

T₉ S. R. 7 E.

From the Cor to Secs 3 and 4, 33 & 34
on the S boundary of the Township
previously described by me.

I run

N. bet Secs 33 and 34

70° 12' 50" E

Over level ground

40.00 Set magnt post 3 ft long 3 ins
sq. with marked stone 12 ins
in the ground for $\frac{1}{4}$ Sec Cor
marked $\frac{1}{4}$ S on N. face dug
pits 18 + 18 + 12 ins N + S of
post 5 $\frac{1}{2}$ ft dist and raised
a mound of earth 1 $\frac{1}{2}$ ft high
3 $\frac{1}{2}$ ft base around post -

80.00 Set magnt post 4 ft long 4 ins
sq. with marked stone 12 ins
in the ground for Cor to Secs
27, 28, 33 and 34, marked

ch. ch. ch. Tg S. R. 7 E.

Tg S S 27 on N E

R 7 E S 34 on S. E.

S. 33 on SW and

S 28 on NW faces with 1 notch

on S. and 3 notches on E edges

4. dug pits 18 + 18 + 12 ins in. Each

Set. 5 1/2 ft dist and raised a mound of earth 2 ft high 4 1/2 ft base around post

Land level

Soil sedimentary 2nd rat.

Scrub brush entire mile

E. on a random line bet S 27 + 34

ra 12° 49' E

40.00 Set temporary 1/4 Sec Cor

80.00 Intersect to S line 15 chs S

of the Cor to S 26. 27. 34 + 35

Thence I run

T. & S. R. & E.

S. 89° 52' 11" on a true line bet Secs 27 & 34
with same run

Over level ground

40.00 Set mesq¹ post 3 ft long 3 ins
sq. with marked stone 12 ins
in the ground for $\frac{1}{4}$ Sec cor
marked $\frac{1}{4}$ S on N face dug
pits 18 + 18 + 12 ins E and N of
post - 5 $\frac{1}{2}$ ft. diam. and raised
a mound of earth 1 $\frac{1}{2}$ ft high
3 $\frac{1}{2}$ ft base around post

80.00 Cor. to Secs 27, 28, 33 and 34
Land level

Aril Sedimentary 2nd rate
Sense brush entire mile

N. bet Secs 27 and 28

70° 50' E

Over level ground

cls

Tg S. R 7 E

40.00 Sec 1 - mesq - post 3 ft long 3 in
sq r with marked stone 12 ins
in the ground for $\frac{1}{4}$ Sec Cor
marked $\frac{1}{4}$ S on W face, dry pits
18 + 18 + 12 ins N + S of post $3\frac{1}{2}$ ft
dist. and raised a mound of
Earth $1\frac{1}{2}$ ft high $3\frac{1}{2}$ ft bare around
post -

80.00 Sec 1 mesq post 4 ft long 4 in
sq r with marked stone 12 ins
in the ground for Cor to Secs 21, 22, 27
marked S. of S. S 22 on W E
R 7 E S. 27 on S E
S 28 on SW and
S 21 on NW faces with 2
notches on S and 3 notches on E
edges; dry pits 18 + 18 + 12 ins
in each Sec. $5\frac{1}{2}$ ft dist. and
raised a mound of earth 2 ft -

chs

T₉ S. R₇ E₆

high $4\frac{1}{2}$ ft - base ground post
 Land level

Soil sedimentary 1st rate
 dense brush entire mile.

E₆ on a random line bet Secs 22 & 27

va $12^{\circ} 49' E$

40.00 Set temporary $\frac{1}{4}$ sec cor

80.14 Intersect at S line 30 lks S. of cor
 to Secs 22, 23, 26 & 27

Thence I run

S $89^{\circ} 47'$ W on a true line bet Secs 22 & 27

with same cu

Over level ground

40.07 Deposit marked stone
 12 ins in the ground for $\frac{1}{4}$
 Sec cor. dig pits 18 + 18 + 12
 ins E and W. ^{of cor.} $\frac{1}{2}$ ft dist and
 raised a mound of earth $1\frac{1}{2}$ ft

chs

T₉S. R. 7 E

high $3\frac{1}{2}$ ft - base over it
 In E pit drove a stake 2
 ft - long 2 ins sq or 12 ins in
 the ground marked $\frac{1}{4}$ S on
 N face

4 80.14 Cor to Secs 21, 22, 27 and 28
 Land level

Soil sedimentary and rate
 dense brush entire mile

N. bet Secs 21 and 22

70. 12° 49' E

8 Over level ground

4000 Set mark post 3 ft - long 3 ins sq
 with marked stone 12 ins in the
 ground for $\frac{1}{4}$ Sec Cor marked
 $\frac{1}{4}$ S on N. face, dug pits 18+18+
 12 ins N + S. of post $5\frac{1}{2}$ ft - dist -
 and raised a mound of earth

chs

T. g. S. R. 7 E.

1½ ft high 3½ ft base around post
 80.00 Set metal post 4 ft long 4 ins sq
 with marked stone 12 ins in the
 ground for Cor to Secs 15, 16, 21 & 22
 Marked T. g. S. & 15 on N E
 R 7 E S 22 on S E
 S 21 on S. W. and

S 16 on N W faces with 3 notches on
 S. and E. edges; dug pits 18 + 18 +
 12 ins in each Sec. 5½ ft dia -
 and raised a mound of earth 2
 ft high 4½ ft base around post
 Sand level

Soil sedimentary 18th ^{mile} feet
 dense grasswood & sage brush ^{entire}

E. on a random line bet Secs 15 & 22

va. 12° 49' E

40.00 Set temporary ¼ Sec Cor

chs
 4
 8
 Tg S. R. 7 E

80.10 Intersect-A + S line 13 chs S
 of the cor to Secs 14, 15, 22 + 23

Thence I run

S $89^{\circ} 54'$ W, as a true line bet Secs 15 + 22
 with same 24

Over level ground

40.05 Set a post 1 foot 3 ft long 3 ins dia
 with marked stone 12 ins in the
 ground for $\frac{1}{4}$ Sec. cor, marked
 $\frac{1}{4}$ S. on N face, dug pits 18 + 18 + 12
 ins E + W. of post 5 $\frac{1}{2}$ ft dist and
 raised a mound of earth 1 $\frac{1}{2}$ ft
 high 3 $\frac{1}{2}$ ft base around post

80.10 Cor to Secs 15, 16, 21 and 22

Land level

Soil sedimentary 18th rate
 some sage brush entire mile,

Dec 1st 1887

chs Tq S. R 7 E

N. bet Secs. 15 and 16

7a 12° 49' Ee

Over level ground

40.00 Set mesq^t post 3 ft long 3 ins sq
with marked stone 12 ins in the
ground for $\frac{1}{4}$ Sec Cor marked $\frac{1}{4}$
S. on N. face, dug pits 78 + 18 + 12 ins
to S. of post 5 $\frac{1}{2}$ ft dist. and raised
a mound of earth 1 $\frac{1}{2}$ ft high 3 $\frac{1}{2}$ ft
base around post.

80.00 Set mesq^t post 4 ft long 4 ins
sq with marked stone 12 ins
in the ground for Cor. to Secs
9, 10, 15 and 16 marked
Tq S. S. 10 on N Ee
R 7 E. S 15 on S. Ee.
S. 16 on SW and
S. 9 on N.W. face with 4 notches
on S. and 3 notches on E edges

chs

T9 S. R7 E

dug pits 18+18+12 ins in each
 Sec. 5 $\frac{1}{2}$ ft. dist. and raised a
 mound of earth 2 ft high $4\frac{1}{2}$
 ft base around post
 Land level

Soil sedimentary 18¹/₂ ^{mi} thick
 Dense sage brush & greasewood enter

E. on a random line bet Secs 10 & 15-

va 12° 48' Ee

40.00 Set temporary $\frac{1}{4}$ Sec Cor

79.85 Intersect N to S line at Cor to Secs

10, 11, 14 and 15-

Then I run

N. on a true line bet Secs 10 & 15-

with same va

Over level ground

39.93 Set mag. post 3 ft long 3 ins sq-

with marked stone 12 ins in the

cls

T. S. R. & E.

ground for $\frac{1}{4}$ Sec. Cor. marked
 $\frac{1}{4}$ S on N face. dug pits 18+18+
 12 ins E and W. of post - $5\frac{1}{2}$ ft -
 dist. and raised a mound of
 earth $1\frac{1}{2}$ ft high $3\frac{1}{2}$ ft base
 around post -

79.85 Cor to Secs 9, 10, 15 & 16

Land level

Soil sedimentary 12th rate
 dense brushy tire mile.

At 12 o'clock M. to-day I took
 latitude and found it to be
 $32^{\circ} 39' N$. I also carefully
 examined my compass and
 found it to be in good adjustment.

chs

T₉ S. R₇ E_e

N. bet Secs 9 and 10

ra 12° 48' E_e

Over level ground

- 40.00 Set mesq^t post 3 ft long 3 ins sq^r
with marked stone 12 ins in the
ground for $\frac{1}{4}$ Cor for marked $\frac{1}{4}$
S on N. face dug pits 18+18+12 ins
to S of post $3\frac{1}{2}$ ft dist and
raised a mound of earth $1\frac{1}{2}$ ft
high $3\frac{1}{2}$ ft base around post-
- 80.00 Set mesq^t post 4 ft long 4 ins sq^r
with marked stone 12 ins in the
ground for Cor to Secs 3, 4, 9+10
marked T₉ S. S₃ on N E
R₇ E_e S. 10 on S E_e
S on SW and
S₄ on N. W. faces with 5 notches
on S and 3 notches on E edges
dug pits 18+18+12 ins in each

chs

T. G. S. R. & E

Sec. 54 ft dist. and raised a mound of earth 2 ft high 4 1/2 ft base around post.

Sand level

Soil sedimentary 1st rule
Dense sage brush, greasewood
and guyotte entire rule.

E. at a random line bet Secs 3+10

va $12^{\circ} 49' E$

40.00 Set temporary 1/4 Sec. cor

80.00 Intersect N-S line 21 lbs S

of Cor to Secs 2, 3, 10 + 11

Thence I run

S. $89^{\circ} 54' W$, on a true line bet Secs 3+10

with same va

On a level ground

40.00 Set mesq 1 post 3 ft long 3 ins

2 1/2 ins with marked stone 12 ins

chs

Tg S R 7 E

in the ground for $\frac{1}{4}$ Sec Cor
 marked $\frac{1}{4}$ S on N face. dug
 pits 18 + 18 + 12 ins E of W of post
 $5\frac{1}{2}$ ft dist and raised a mound of
 earth $1\frac{1}{2}$ ft high $3\frac{1}{2}$ ft base across
 post -

80.00 Cor to Secs 3, 4, 9 and 10

Land level

Soil sedimentary 1st with
 heavy brush the entire mile.

Now a random line bet Secs 3 + 4

va 120° $149'$ E

40.00 Set temporary $\frac{1}{4}$ Sec Cor

80.30 Intersect A boundary of the
 township at the Cor to Secs
 3, 4 33 + 34 previously described

by me.

Thence I run

S. on a true line bet Secs 3 + 4

chs

Tg S R 7 E

with some v.c.

40.30 Set mesq post 3 ft long 3 ins
sq. with marked stone 12 ins
in the ground for $\frac{1}{4}$ Sec, cor
marked $\frac{1}{4}$ S. on W. face, dug
pits 18+18+12 ins N & S of post -
5 $\frac{1}{2}$ ft - dia and raised a mound
of earth 1 $\frac{1}{2}$ ft high 3 $\frac{1}{2}$ ft base
around post -

80.30 Cor to Secs 3, 4, 9 and 10
Sand level

Soil sedimentary 18 $\frac{1}{2}$ rods
Cat claws, cactus, Yucca
and greasetta entire mile.

Dec 2nd 1887,

cls

T of S. R. 7 E

From the Cor to Secs 4, 5, 32 & 33
on the S. boundary of the township
previously described by me.

I run

N. bet Secs 32 and 33

by $12^{\circ} 30' E$

Over level ground

40.00 Set mesq. post 3 ft long
3 ins sq. with marked stone
12 ins in the ground for $\frac{1}{4}$ Sec
Cor. marked $\frac{1}{4}$ S on W face
dry pits 10 + 18 + 12 ins N
of post 3 $\frac{1}{2}$ ft dist - and
raised a mound of earth $1\frac{1}{2}$
ft high 3 $\frac{1}{2}$ ft base around
post -

80.00 Set mesq. post 4 ft long 4 ins
sq. with marked stone 12 ins
in the ground for Cor. to Secs

chs T9 S. R7 E

28, 29, 32 and 33 marked

T9 S S. 28 on NE

R7 E S 33 on S. E

S. 32 on SW and

S 29 on NW faces with 1 notch
on S. and 4 notches on E edges

dug pits 18+18+12 ins in each

Sec. $5\frac{1}{2}$ ft. dia. and raised a

mound of earth 2 $\frac{1}{2}$ ft high 4 $\frac{1}{2}$

ft base around post.

Land level

Soil sedimentary and rati-

Sage brush, greasewood and
scrub mesquite.

Now a random line bet Secs 28 & 33

ra 12° 50' E

40.00 Set temporary 1/4 Sec. cor

80.10 Intersect N-S line at the cor

Chs

Tg S. R 7 E

To Secs 27, 28, 33 + 34

Thence I run

N. on a true line bet Secs 28 & 34
with same va

Over level ground

40.05 Set mesq¹ post 3 ft long 3 ins
sq. with marked stone 12 ins
in the ground for $\frac{1}{4}$ Sec. Cor
marked $\frac{1}{4}$ Sec. N face. Aug
pits 78 + 18 + 12 ins E + W of
post $3\frac{1}{2}$ ft - dist and raised a
mound of earth $1\frac{1}{2}$ ft high $3\frac{1}{2}$ ft - base
around post -

80.10 Cor to Secs 28, 29, 32 + 33

Land level

Soil sedimentary 1st rate
dense grass and Sage brush
& scrub mesquite,

Chs T9 S. R7 E

N. bet Secs 28 and 29

wa $12^{\circ} 50' E$

Over level ground

40.00 Set megal post 3 ft long 3 ins sq
with marked stone 12 ins in the
ground for $\frac{1}{4}$ Sec for marked
 $\frac{1}{4}$ S on W. face, dug pits 18+18+
12 ins N & S. of post $3\frac{1}{2}$ ft dist
and raised a mound of earth $1\frac{1}{2}$ ft
high $3\frac{1}{2}$ ft base around post.

80.00 Set megal post 4 ft long 4 ins sq
with marked stone 12 ins in the
ground for Cor to Secs. 20, 21, 28
and 29 marked
T9 S. S 21 on N. E.,
R7 E S 28 on S. E.,
S 29 on SW and
S 20 on NW faces with 2 notches
on S. and 4 notches on 2 edges

Chs

Tg S. R. 7 E

dug pits 18+18+12 ins in Each
Sec. 5½ ft dist. and raised a
mound of earth 2 ft high with
ft base around post.

Land level

Soil sedimentary 2nd rate
dense sage brush & greasewood
entire mile.

✓ E. on a random line bet Secs 21 & 28
va. 12° 49' E

40.00 Set temporary ¼ Sec. Cor.

80.15 Intersect A-S line 16 lks S. of the Cor
to Secs. 21, 22, 27 and 28.

Thence I run

S 89° 33' W. on a true line bet Secs 21 & 28
with same va

Over level ground

40.07 Set mesq. post 3 ft long 3 ins sq

T. G. S. R. 7 E

with marked stone 12 ins in
the ground for $\frac{1}{4}$ Sec Cor marked
 $\frac{1}{4}$ S on N face dug pits 18+18+
12 ins E & W of post $5\frac{1}{2}$ ft dist
and raised a mound of earth
 $1\frac{1}{2}$ ft high $3\frac{1}{2}$ ft base around post

7015 Cor to Secs 20, 21, 28 and 29

Land level

Soil sedimentary 2nd rate -
Dense brush entire mile

N. bet Secs 20 and 21

70 12° 49' E

Over level ground

7000 Set, musy post 3 ft long 3 ins sq r
with marked stone 12 ins in the
ground for $\frac{1}{4}$ Sec Cor marked
 $\frac{1}{4}$ S on W face dug pits 18+18
+12 ins N & S of post $5\frac{1}{2}$ ft dist

chs

T. 9 S. R. 7 E.

and raised a mound of earth 1½ ft
high 3½ ft base around post-
80.00 Set mesq post 4 ft long 4 ins
sq with marked stone 12 ins
in the ground for cor to Secs 16
17, 20 and 21 marked

T 9 S. S 16 on N E

R 7 E. S 21 on S E

S 20 on S W and

S 17 on N W faces with 3 notches
on S. and 4 notches on E edges
dug pits 18+18+12 ins in each
Sec. 5½ ft dist and raised a
mound of earth 2 ft high
4½ ft base around post-
Land level

Soil sedimentary 2nd rate
dense grasswood brush entire with
Dec, 30, 1887

Tq S. R. & E

Even a random line bet Secs 16 and 21

Over level ground ^{wa 120 49' Ee}

40.00 Set temporary $\frac{1}{4}$ Sec cor

40.08 Intersect N + S line 11 lks S
of the cor to Secs 15, 16, 21 and 22

Thence I run

S $89^{\circ} 55'$ N, on a true line bet Secs 16 + 21

with same run

~~Over level ground~~

40.04 Set mesq post 3 ft long 3 ins agr
with marked stone 12 ins in the

ground for $\frac{1}{4}$ Sec cor marked
 $\frac{1}{4}$ S on it face dry pits 78 + 18 + 12 in

E + W of post 3 $\frac{1}{2}$ ft dia and raised a
mound of earth 1 $\frac{1}{2}$ ft high 3 $\frac{1}{2}$ ft base ^{post} around

80.08 Cor to Secs. 16, 17, 20 and 21

Land level

Soil sedimentary 2nd rate
dense sug. brush. Scattering
yuca trees entire mile.

chs

T₉ S. R₇ E₆

N. bet. Secs. 16 and 17

rc 12° 49' E

Over level ground

40.00 Set survey post 3 ft long 3 ins eye
with marked stone 12 ins in the
ground for $\frac{1}{4}$ Sec Cor marked "4"
S. on N. face dug pits 18+18+12 ins
N to S. of post $3\frac{1}{2}$ ft dist. and raised
a mound of earth $\frac{1}{2}$ ft high $3\frac{1}{2}$ ft base
Around post -

80.00 Set survey post 4 ft long 4 ins eye
with marked stone 12 ins in the
ground for Cor to Secs 8, 9, 16+17
marked T₉ S. S₉ on N. E.

R₇ E₆ S₁₆ on S. E.S₁₇ on SW and

S₈ on NW face with 4 notches on
S. and E. edges; dug pits 18
+18+12 ins in each Sec. $5\frac{1}{2}$ ft -

Chs

Tg S.R. 7 Ee.

dit and raised a mound of earth
2 ft high 4 ft base around post.

Land level

Soil sedimentary and rather
dense sage brush entire mile.

E. on a random line bet Secs 9+16

7a 12° 49' Ee

40.00 Set temporary 1/4 Sec. cor

80.00 Intersect N-S line 30 lks S of

cor to Secs 9, 10, 15+16

Thence I run

S 89° 47' W. on a true line bet Secs 9+16

with same va

Over level ground

40.00 Set mesq. post 4 ft long 4 ins

sq. with marked stone 12 ins in

the ground for 1/4 Sec. cor. marked

1/4 S. on N face, dug pits 18+18+12

Chs

T₉ S R₇ E₆

ins. E. & W. of post and raised a mound of earth 1½ ft high 3½ ft base around post.

80.00 cont. to Secs 8, 9, 16 & 17

Land level

Soil sedimentary

Some Grasswood & huge brush

N. bet Secs 8 and 9

Va 12° 49' E.

Over level ground

40.00 Set mag. post 3 ft long 3 ins sq. r with marked stone 12 ins in the ground for ¼ Sec or marked ¼ S on W face dug pits 18 + 18 + 12 ins to S of post 5½ ft dia and raised a mound of earth 1½ ft high 3½ ft base around post.

0.00 *by S R 7 E*

Set survey post 4 ft long 4 ins ago
with marked stone 12 ins in the
ground for cor to Secs 4, 5, 8 & 9
marked *by S S*, 4 on N.E.

R 7 E, S 9 on S.E.

S 8 on SW and

S 5 on N.W. faces with 5 notches
on S and 4 notches on E edge vs. dug
pits 78 + 18 + 12 ins in each sec 5 ft dia
and raised a mound of earth 2 ft
high 2 1/2 ft base around post -
Land level

Soil sedimentary, 2nd rate
some says brush & grassland

E. on a random line bet Secs 4 & 9
va 12° 49' E

40.00 Set temporary 1/4 Sec cor

29.86 Intersect N & S line 16 lbs S.

chs

Tg S. R. 7 E

of Cor. to Secs 3, 4, 9 and 10

Thence I run

S. 89° 05' 3" W. a true line bet. Secs 4 & 9

with same ra.

Over level ground

39.93 Set monument post 3 ft long 3 ins dia,
with marked stone 12 ins in the
ground for $\frac{1}{4}$ Sec. Cor. marked
 $\frac{1}{4}$ S. on N. face, dug pits 18 +
18 + 12 ins E & W. of post $5\frac{1}{2}$ ft dist
and raised a mound of earth $\frac{1}{2}$
ft high $3\frac{1}{2}$ ft base around post

79.86 Cor. to Secs, 4, 5, 8 and 9
Land level

Soil sedimentary 12th rate
sense brush entire mile,

Now a random line bet Secs 4 & 5
ra 12° 49' Ee

60

T. 9 S. R. 7 E

chs

40.00 Set temporary $\frac{1}{4}$ Sec cor
 80.20 Intersect N. boundary of township
 at the cor. to Secs. 4, 31, 32 + 33
 previously described,

Thence I run
 S. on a true line bet Secs 4 and 5
 with same va.

Over level ground

40.20 Set $\frac{1}{4}$ Sec cor post 3 ft long 3 ins
 sq. with marked stone 12 ins
 in the ground for $\frac{1}{4}$ Sec cor
 marked $\frac{1}{4}$ S. on N. face. Aug
 pits 18 + 18 + 12 ins N + S of post
 $5\frac{1}{2}$ ft dist and raised a mound of
 earth $1\frac{1}{2}$ ft high $3\frac{1}{2}$ ft base around,

80.20 Cor to Secs 4, 5, 8 and 9
 Land level

Soil sedimentary 1st rate
 dense brush entire mile.

Chs

Tq S. R. 7 Ee

From the Cor to Secs 5, 6, 31 and 32
on the S. boundary of the township previous
ly described. by me.

Then I run

N. bet Secs 31 and 32

700 120 44' E.

Over level ground

40.00 Set mesq¹ post 3 ft long 3 ins
sq. with marked stone 12 ins in
the ground for $\frac{1}{4}$ Sec Cor marked
 $\frac{1}{4}$ S. on W. face dug pits 18 + 18 + 12
ins N + S of post $3\frac{1}{2}$ ft dist and
raised a mound of earth $1\frac{1}{2}$
ft high $3\frac{1}{2}$ ft base around post.

80.00 Set mesq¹ post 4 ft long 4 ins
sq. with marked stone 12
ins in the ground for $\frac{1}{4}$ Sec.
to Secs 29, 30, 31 and 32 marked
Tq S. 29 on N. Ee.

clus

T₉ S R₇ ER₇ E. S₃₂ on S.E.S₃₁ on SW and

S₃₀ on NW faces with 1 notch on S
and 5 notches on E edges, dug
pits 18+18+12 ins in each Sec
5 1/2 ft diam. and raised a mound
of earth 1 1/2 ft high 4 1/2 ft base
around post.

Land level
Soil sedimentary 1st rate
Some brush entire mile

E. on p. random line bet Secs. 29+32

ba 12° 49' E

40.00 Set temporary 1/4 Sec cor

79.90 Intersect N + S line 15-cks N
of cor to Secs 28, 29, 32 and 33

Thence S rim

N. 89.54 W. on p. line bet Secs 29+32

with same on

Over level ground

39.95 Set misc post 3 ft long 3 ins sq.

cls

T₉ S. R. 7 E.

with marked stone 12 ins in the
ground for $\frac{1}{4}$ Sec Cor marked $\frac{1}{4}$ S
on N face. dug pits 18+18+12 ins E
N of post $5\frac{1}{2}$ ft dia, and raised
a mound of earth 15 ft high $3\frac{1}{2}$ ft
base around post -

79.90 Cor to Secs 29, 30, 31 and 32

Land level

Soil sedimentary 1st rate
dense brush entire mile

W. on a random line bet Secs 30 & 31

on $120^{\circ} 49' E$

40.00 Set temporary $\frac{1}{4}$ Sec Cor79.80 Intersect W. boundary of township
17 lks S. of Cor to Secs 28, 30, 31 & 36

thence I run

S. $89^{\circ} 53' E$, on a true line bet Secs 30 & 31

with same α

T 9 S. R 7 E.

Over level ground

980 Deposit marked stone 12 ins
in the ground for $\frac{1}{4}$ Sec. Cor.
Aug pits 18 + 18 + 12 ins. E & W
 $5\frac{1}{2}$ ft dist and raised a mound
of earth $1\frac{1}{2}$ ft high $3\frac{1}{2}$ ft base over
it. In E pit drove a stake
2 ft long 2 ins sq r 12 ins in
the ground marked $\frac{1}{4}$ S on
N face

980 Cor to Secs 29, 30, 31 and 32

From this cor a mesq & stockade
corral hrs S 35° E. 6 chs dist.
Sand level

Soil yellow loam 1st rate
dense brush & scrub mesq
& yucca entire rule.

Dec. 5th 1887

Chs

Tg S. R. 7 E.

A. bet Secs 29 and 30

va 12° 49' E.

Over level ground

- 40.00 Set mesquite post 3 ft long 3 ins
sq with marked stone 12 ins
in the ground for 14 Red Cor
marked 14 S on N face, dug pits
18+18+12 ins N+S of post 5½
ft dist and raised a mound of
earth 1½ ft high 3½ ft base around post
- 80.00 Set mesquite post 4 ft long 4 ins
sq with marked stone 12 ins
in the ground for Cor to Secs
19, 20, 29 and 30 marked
Tg S. S 20 on N E
R 7 E. S 29 on S E
S. 30 on S W and
S 19 on N W face with 2 notches on
S. and 5 notches on E edges

chs

T. & S. R. & E.

dig pits 18 + 18 + 12 ins in each
 Sec. $5\frac{1}{2}$ ft - dist. and raised a
 mound of earth 2 ft high $4\frac{1}{2}$ ft
 base around feet.

Found level

Soil sedimentary 181 route
 dense brush & mesq 1 entire mile

E. on a random line bet Secs 20 + 29

va 120 49' Ee

40.00 Set temporary $\frac{1}{4}$ Sec. Cor

79.88 Intersect H. L. line at Cor to Secs
 20, 21, 28 and 29

Then I run

Non-a true line bet Secs 20 + 29

with same va

Over level ground

39.94 Set mesq post 3 ft long 3 ins sq
 with marked stone 12 ins in the

cls

T₉ S R₇ E₆

ground for $\frac{1}{4}$ Sec Cor marked
 $\frac{1}{4}$ S. on A face dug pits 18+18+12
 ins Cor W of post - $5\frac{1}{2}$ ft dist - and
 raised a mound of earth $1\frac{1}{2}$ ft
 high $3\frac{1}{2}$ ft base around post.

79.88 Cor. to Secs, 19, 20, 29 and 30

Land level

Soil sedimentary 18' rate
 dense brush entire mile

W. on $\frac{1}{2}$ parallel line bet Secs 19 & 30
 $\text{ra } 120^{\circ} 49' \text{ E}$

40.00 Del temporary $\frac{1}{4}$ Sec Cor

79.84 Intersect W. boundary of township
 25 chs S. of the Cor to Secs 19, 24
 25 and 30 previously described
 Thence I run

S. $89^{\circ} 49' \text{ E}$, on $\frac{1}{2}$ parallel line bet Secs 19 & 30
 with same ra

chs

T₉ S R 7 E

Over level ground

39.84 Set misc. post 3 ft long 3 ins sq
with marked stone 12 ins in the
ground for $\frac{1}{4}$ bed. cor. marked $\frac{1}{4}$
S. or N. face, dug pits 18+18+12
ins E+W of post $5\frac{1}{2}$ ft dist and
raised a mound of earth 1 $\frac{1}{2}$ ft high
 $3\frac{1}{2}$ ft base around post -
79.84 cor to Decs 19, 20, 29 + 30

Land level

Soil Sedimentary 2nd rate
Dense brush entire mile

At 12 o'clock M. today I
took latitude and found it to
be $32^{\circ} 38' N$. I also
carefully examined my compass
and found it in good adjustment.

chs

T₉ S. R₇ E

N. bet Secs 19 and 20

7^a 12° 49' E

Over level ground

40.00 Set mesq¹ post 3 ft long 3 ins sq
with marked stone 12 ins in the
ground for $\frac{1}{4}$ Sec cor marked

$\frac{1}{4}$ S. on N. face. dug pits 15+18
+12 ins N & S. of post 3 $\frac{1}{2}$ ft dist
and raised a mound of earth

1 $\frac{1}{2}$ ft high 3 $\frac{1}{2}$ ft base around

80.00 of post¹ Set mesq¹ post 4 ft long
4 ins sq, with marked stone
12 ins in the ground for cor to
Secs. 17, 18, 19 and 20 marked

T₉ S. S₁₇ on N. E.R₇ E S. 20 on S ES₁₉ on SW and

S₁₈ on N W faces with 3 notches
on S and 5 notches on E edges

chs

T. S. R. 7 E

Dug pits 18+18+12 ins in each sec
 5½ ft dia and raised a mound of
 earth 2 ft high 4½ ft base around post.

Land level

Soil sedimentary and rate
 Dense greasewood brush entire mile

On a random line bet Secs 17 and 20

70° 12' 49" E

40.00 Set temporary ¼ Sec. Cor

79.84 Intersect N-S line 12 chs N
 of the cor to Secs 16, 17, 20 and 21

Thence I run

N. 89° 55' W. on a true line bet Secs 17+20

with same run

Over level ground

39.92 Set mesq post 3 ft long 3 ins
 sq. with marked stone 12 ins in
 the ground for ¼ Sec. cor.

chs

Tg S. R. 7 E

marked $\frac{1}{4}$ S. on N. face; dry pits
 $18+18+12$ ins E + N. of post $3\frac{1}{2}$ ft dist
 and raised a mound of earth $1\frac{1}{2}$ ft
 high $3\frac{1}{2}$ ft base around post.

79.84 Cor. to Secs. 17, 18, 19 and 20

Land level

Soil sedimentary 2nd rate

Scrub brush entire mile

Dec 6, 1887

N. on a random line bet Secs 18 & 19

ra $120^{\circ} 49'$ E40.00 Set temporary $\frac{1}{4}$ Sec. cor79.80 Intersect N. boundary of township
 at the cor to Secs 13, 18, 19 + 24 previously
 described

Thence I run

E. on a true line bet Secs. 18 & 19

with same ra

Over level ground

39.80 Set misc. post 3 ft long 3 ins dia

chs
T. of S. R. 7 E.

with marked stone 12 ins in the ground for $\frac{1}{4}$ Sec. Cor marked $\frac{1}{4}$ S. on N face, dug pits 18+18+12 ins E & W. of post 5 $\frac{1}{2}$ ft - dist and raised a mound of earth 1 $\frac{1}{2}$ ft - high 3 $\frac{1}{2}$ ft base around post

79.80 Cor to Secs. 17, 18, 19 and 20
Sand level

Soil sedimentary 2nd rate
scrub brush entire mile

N. bet Secs. 17 and 18
va 12 $^{\circ}$ 49' E

Over level ground

40.00 Set mesq, post 3 ft - long 3 ins
sq. with marked stone 12 ins in the ground for $\frac{1}{4}$ Sec for marked $\frac{1}{4}$ S. on W. face, dug pits 18+18+12 ins N & S of post 5 $\frac{1}{2}$ ft dist

cls

Tg S R 7 Ee

and raised a mound of earth
 $1\frac{1}{2}$ ft high $3\frac{1}{2}$ ft base around post
 80.00 Set misc post 4 ft long 4 in
 sq with marked stone 12 ins
 in the ground for cor to Secs

7, 8, 17 and 18 marked

Tg S. S 8 on N.E.

R 7 E S. 17 on S.E.

S. 18 on NW and

S. 7 on NW faces with 4 notches
 on Sand 5 notches on E edges
 Any pits 18+18+12 ins in each Sec

$5\frac{1}{2}$ ft dist. and raised a mound
 of earth 2 ft high $4\frac{1}{2}$ ft base ^{post} around
 Sand line

Soil sedimentary 2nd rate
 dense brush entire mile.

chs

T. G. S. R. 7 E

E. end of random line bet Secs 8 + 17

ra $120^{\circ} 49' E$ 40.00 Set temporary $\frac{1}{4}$ Sec cor80.10 Intersect N + S. line 30 lks S
of cor. to Secs. 8, 9, 16 + 17

Thence I run

S. 89° 04' W. on pt true line bet Secs 8 + 17

with same ra

Over level ground

40.05 Set mesq¹ post 3 ft long 3 ins agrwith marked stone 12 ins in the
ground for $\frac{1}{4}$ Sec. cor marked $\frac{1}{4}$ S. on N face dug pits 18 + 18 +
12 ins E + W of post $5\frac{1}{2}$ ft distand raised a mound of earth $1\frac{1}{2}$
ft high $3\frac{1}{2}$ ft base around post.

80.10 Cor. to Secs 7, 8, 17 + 18

Sand line

Soil submersary and rate
burnt brush entire mile.

chs

79 S. R. 7 E

W. as a random line bet Secs 7 & 18

ra $12^{\circ} 49' E$ 40.00 Set temporary $\frac{1}{4}$ Red cor.

79.65 Intersect W. boundary of Twp.

11 elts N of the cor. to Secs. 7, 12

13 and 18 previously described

Thence I run

N $89^{\circ} 55' E$ on a true line bet Secs 7 & 18

with same ra

Over level ground

39.65 Set mag. post 3 ft long 3 ins dia

with marked stone 12 ins in the

ground for $\frac{1}{4}$ Red cor. marked $\frac{1}{4}$ S. on N face. Day pits 78 + 18+ 12 ins E & W of post $5\frac{1}{2}$ ft dist

and raised a mound of earth

 $1\frac{1}{2}$ ft high $3\frac{1}{2}$ ft base around post

79.65 Cor. to Secs 7, 8, 17 and 18

Level

Soil. 2nd rule

beware brush entire mile.

T_g S. R. 7 E

N. bet. Secs 7 and 8

70. 12° 49' E

Over level ground

40.00 Set mesq^t post 3 ft long 3 ins
 sq. with marked stone 12 ins
 in the ground for $\frac{1}{4}$ Sec. Cor. marked
 $\frac{1}{4}$ S. on W face; dug pits 18 + 18
 + 12 ins N & S. of post - 5 $\frac{1}{2}$ ft dist
 and raised a mound of earth
 1 $\frac{1}{2}$ ft high 3 $\frac{1}{2}$ ft base around post

80.00 Set mesq^t post 4 ft long 4 ins
 sq. with marked stone 12 ins in the
 ground for ~~4~~ ^{Cor. to Secs. 5, 6, 7 and 8.} Sec. Cor. marked

T_g S. S 5 on N.E.

R. 7 E S 8 on S.E.

S 7 on SW and

S 6 on NW face with 5 notches on
 Sand E edges; dug pits 18 + 18 + 12 ins
 in each Sec 5 $\frac{1}{2}$ ft dist. and raised

chs

Tg S R 7 E

a mound of earth 2 ft high
 4½ ft base around post
 Land level

Soil sedimentary 2nd rate
 Dense Sage brush within mile
 Guyton grass.

E. on a random line bet Secs 5 & 8
 ra 12° 44' E

40.00 Set temporary ¼ Sec Cor

80.00 Intersect N of line at the corner
 Secs. 4, 5, 8 and 9

Thence I run

N. on a true line bet Secs 5 & 8
 with same ra

Over level ground

40.00 Set monument post 3 ft long 3
 ins sq with marked stone
 12 ins in the ground for ¼

cls

T. 9 S. R. 7 E

Sec. cor marked $\frac{1}{4}$ S. on N. face
 dug pits 18+18+12 ins E + W of
 post 5 $\frac{1}{2}$ ft. dia. - and raised a
 mound of earth 1 $\frac{1}{2}$ ft high 3 $\frac{1}{2}$ ft
 base, around post.

80.00 Cor to Secs 5, 6, 7 and 8

Land level

Soil sedimentary & sandy ¹⁰ feet
 beneath brush entire mile

N. on a random line bet Secs 6 & 7
 va 12° + 9' E

40.00 Set temporary $\frac{1}{4}$ Sec. cor

79.47 Intersect N. boundary of township
 9 cls S of cor to Secs 1, 6, 7 + 12
 previously described

Thence I run

S. 89° 56' E. on a true line bet Secs 6 & 7
 with same va.

chs

Tg. S. R. 7 E.

Over level ground

39.47 Set mesyl post 3 ft long 3 ins apart
with marked stone 12 ins in
the ground for $\frac{1}{4}$ Sec. Cor marked
 $\frac{1}{4}$ S. on N face. They put 18 + 18 + 12
ins E. of N. of post 5 $\frac{1}{2}$ ft - dist and
raised a mound of earth 1 $\frac{1}{2}$ ft high
3 $\frac{1}{2}$ ft - base, around post.

79.47 Cor to Secs 5, 6, 7 and 8

Land level

Soil sedimentary 2nd red
Grews brush entire mile

N. on a random line bet. Secs 5 + 6

70, 12° 49' E

40.00 Set temporary $\frac{1}{4}$ Sec. Cor

80.00 Intersect N. boundary of Tg
at the Cor to Secs 5, 6, 31 and 32
previously described

cls

T. S. R. & Co

Thence I run

S. as a true line bet Secs 5 and 6
with same ra

Over level ground

40.09 Set mes qz post 3 ft long 3 ins dia
with marked stone 12 ins in the
ground for $\frac{1}{4}$ Sec, for marked $\frac{1}{4}$ S
on N. face, dug pits 15 + 18 + 12 ins
N. S. of post $3\frac{1}{2}$ ft - dia & raised
a mound of earth $1\frac{1}{2}$ ft high $3\frac{1}{2}$ ft
base around post.

80.09 Cor to Secs. 5, 6, 7 and 8

Land level

Soil sedimentary 2nd rate
Senses brush entire mile.

Dec. 7th 1887.

T. G. S. P. 7 E

General Description

This township is destitute of water. There are no improvements in it; no person resides in it and there is no road into or through it. The soil is rich yellowish loam or sandy and the ground is covered with sage brush, greasewood, scrub mesquite, cactus yucca, gayetta and other desert-growths.

Herds of burros and cattle range over portions of it during the wet or winter seasons attracted by the browse and gayetta grass.

Widely C. P. Jones

U. S. Deputy Surveyor

BOOK 741

U. S. Surveyor-General's Office,

TUCSON, A. T., Feb. 16 1889

The foregoing Field Notes of the Surveys of
 subdivision lines of
 Township 9 South
 Range 7 East

Gila and Salt River Meridian

in Arizona. executed by

R. C. Powers.

U. S. Deputy Surveyor, under his contract dated

July 20th 1883

having been critically examined, the necessary corrections and explanations made, the said Field Notes and the surveys they describe are hereby approved.

John Wise
 U. S. Surveyor-General
 for the Territory of Arizona.