

841

841

F I E L D N O T E S
OF THE SURVEY OF THE
SUBDIVISION LINES
OF

Township 17 South, Range 9 East.

Gila and Salt River Base and
Meridian,

ARIZONA.

By George J. Roskrugs, S.D., under
Contract dated March 5, 1886.
Survey commenced October 20, 1886.
Survey completed October 25, 1886.

No. 841

Field Notes

of the
Survey of the
Subdivision Lines
of
Township No 17 South, Range 9 East.
of the
Gila and Salt River Meridian
of Arizona

as Surveyed by
Geo. J. Roskinge
U. S. Deputy Surveyor
under his contract No, 1
Dated March 5th 1886.

Survey Commenced: October 20th 1886.

Survey Completed: October 25th 1886.

INDEX

Township 17 South R. 9 East

6	109	5	79	4	60	3	39	2	19	1
107		105		77		58		37		17
7	104	8	75	9	56	10	36	11	16	12
102		100		73		54		34		14
18	98	17	71	16	52	15	32	14	12	13
96		95		70		51		30		11
19	93	20	68	21	48	22	28	23	9	24
91		89		66		47		26		7
30	87	29	64	28	44	27	24	26	5	25
84		83		63		43		23		3
31	81	32	61	33	41	34	21	35	2	36

For preliminary oaths
see Book No. 1,

Township No 17 S. Range No 9. E. G. & S. R. Meridian.

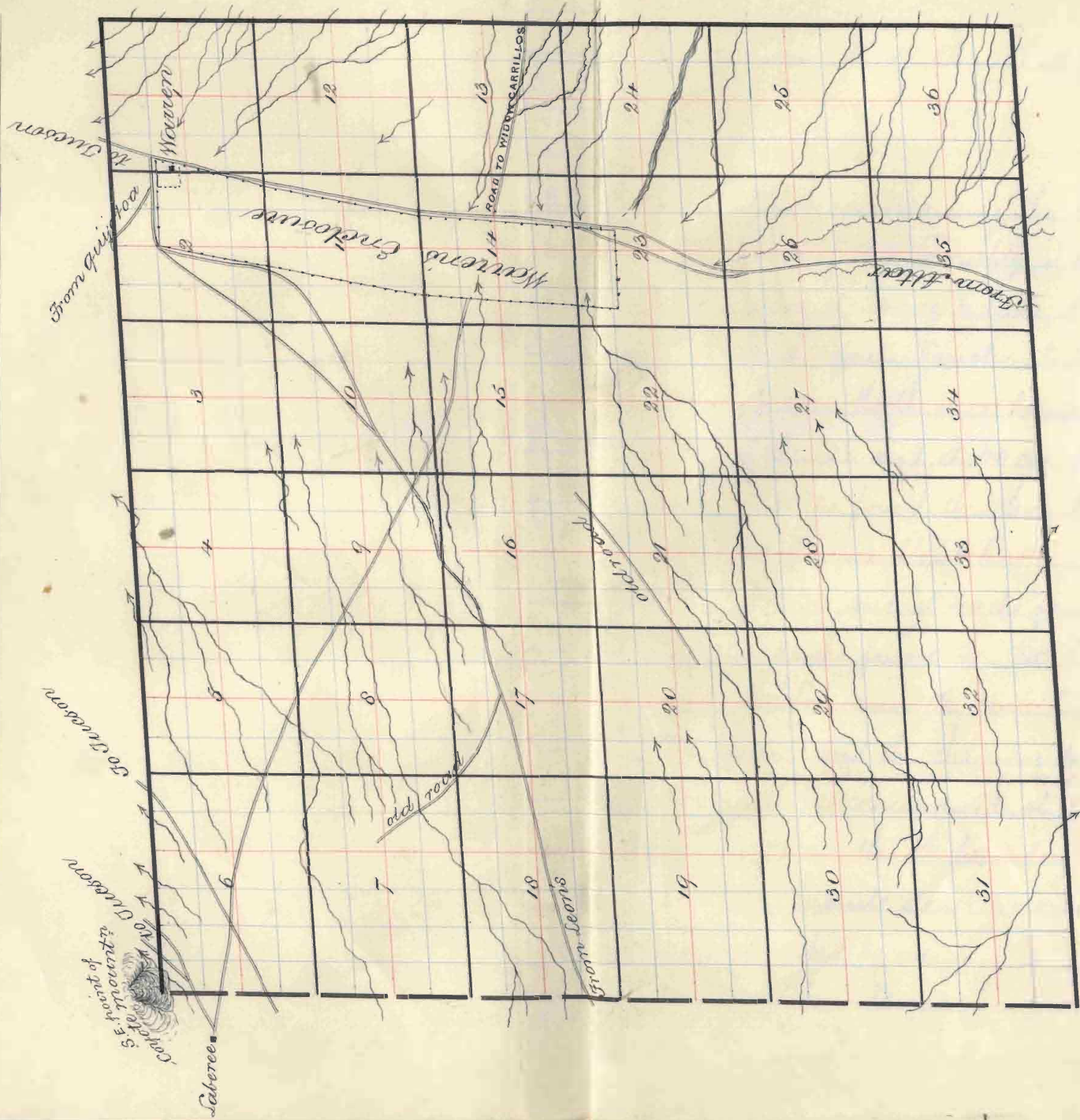

Sp. 17 S. R. 9 E.

Before commencing the Survey of the Subdivision lines of this Township, I take an observation, using a Young & Davis Solar Transit, and find the magnetic Variation to be $12^{\circ}55' E$.

I ran North on a blank line on the E. boundary of Sec. 36. and at 40 chs. found the $\frac{1}{4}$ Sec. Cor. and at 80 chs. found the Sec. Cor. I then ran S. $85^{\circ}40' W$. on a blank line on the S. boundary of Sec. 36, and at 40 chs found the $\frac{1}{4}$ Sec. Cor. and at 80 chs found the Sec. Cor. My compass will therefore run the same line as the exterior boundaries and the chaining practically agrees.

Survey commenced Oct. 20th 1886.
I commenced at the cor to Secs 1. 2. 35 & 36 on the S. boundary of the Township which is a Granite stone previously established and described by me.

Thence I run

Subdivisions, Tp. 17 S. R. 9 E. - Continued

Chains

North, bet Secs 35 & 36.

Var. $12^{\circ}55'$ E.

Over rolling ground.

- 9.00 Arroyo 50 lks wide Course N.W.
- 21.00 Arroyo 20 lks wide Course N.W.
- 27.00 Arroyo 18 lks wide Course N.W.
- 31.00 Arroyo 20 lks wide Course N.W.
- 40.00 Set a Granite stone $16 \times 15 \times 12$ ins 11 ins in the ground, for $\frac{1}{4}$ Sec. Cor., marked $\frac{1}{4}$ on W. face, dug pits $18 \times 18 \times 12$ ins. N. & S. of Stone, $5\frac{1}{2}$ ft dist., and raised a mound of earth $1\frac{1}{2}$ ft high, $3\frac{1}{2}$ ft base, alongside.
- 48.00. Arroyo 30 lks wide, Course W.
- 75.00 Arroyo 50 lks wide, Course W.
- 80.00. Set a Granite stone $18 \times 12 \times 12$ ins 12 ins in the ground for Cor. to Secs. 25-26. 35 & 36, marked with 1 notch on S. and E. edges; dug

Subdivisions, Tp. 17 S. R. 9 E. - Continued

Chains

pits 18x18x12 ins, in each sec., 5½ ft dist, and raised a mound of earth 2 ft high, 4½ ft base, alongside. From which

A mesquite 4 ins. diam. bears S. 76° W. 116 lks dist. marked T. 17 S. R. 9 E. S. 35 B. T.

A mesquite 6 ins. diam bears S. 50° W. 172 lks dist. marked T. 17 S. R. 9 E. S. 35 B. T.

A mesquite 8 ins. diam bears S. 74° E. 203 lks dist. marked T. 17 S. R. 9 E. S. 36 B. T.

No other trees within limits

Land, rolling. Good grass

Soil, 2^d & 3^d rate.

Timber, some Brush and Mesquite.

N 85° 40' E on a random line bet Secs 25 & 36.

Var. 12° 55' E.

Subdivisions, Tp. 17 S. R. 9 E. - Continued

Chains

- Over gently rolling ground
- 8.00. Arroyo 20 lks wide, Course N. 15° W.
- 40.00. Set temporary $\frac{1}{4}$ Sec. Cor.
64.00. Arroyo rocks with course N. W.
79.92. Intersect the E. boundary of Township at 12 lks S. of the cor. to secs. 25, 30, 31 & 36, which is a Granite stone previously established and described by me. Thence I run S. 85° 35' W. on a true line bet secs 25 & 36 with same Var.
- 39.96. Set a Volcanic stone 15 x 15 x 8 ins. 10 ins. in the ground, for $\frac{1}{4}$ Sec. Cor. marked $\frac{1}{4}$ on N. face, dug pits 18 x 18 x 12 ins. E and W. of Stone, 5 $\frac{1}{2}$ ft. dist, and raised a mound of earth 1 $\frac{1}{2}$ ft high, 3 $\frac{1}{2}$ ft base, alongside. From which
A mesquite 6 ins. diam. bears North, 104 lks. dist marked $\frac{1}{4}$ S. B. T.
A mesquite 6 ins. diam. bears N. 53° E, 53 lks. dist

Subdivisions Tp. 17 S. R. 9 E. — Continued

Chains

marked $\frac{1}{4}$ S. B. T.

79.92 The cor. to secs. 25, 26, 35 & 36.

Land, gently rolling. Good grass.

Soil, 2^d and 3^d rate.

Timber, scattering mesquite.

North, bet. Secs 25 & 26

Var. 12° 55' E.

Along broken edge of Mesa.

24.50 Arroyo 30 lks. wide. Course N.W.

40.00 Set a Granite stone 12 x 10 x 8 ins 8 ins in the ground, for $\frac{1}{4}$ Sec. Cor., marked $\frac{1}{4}$ on W. face, dug pits 18 x 18 x 12 ins. N. and S. of stone, 5 $\frac{1}{2}$ ft dist, and raised a mound of earth 1 $\frac{1}{2}$ ft high, 3 $\frac{1}{2}$ ft base, alongside.
From which

Subdivisions, T₁₇ S. R. 9 E. - Continued.

Chains

A mesquite 5 ins. diam. bears N. 5° E. 90 lks.
dist. marked $\frac{1}{4}$ S. B. T.

A mesquite 6 ins. diam. bears S. 13° E. 139 lks.
dist. marked $\frac{1}{4}$ S. B. T.

45.00 Arroyo 18 lks wide. Course N. W.

78.70 Arroyo 10 lks wide. Course N. 80° W.

80.00 Set a Granite stone 14 x 8 x 6 ins. 10 ins in
the ground, for Cor. to Secs. 23, 24, 25 & 26,
marked with 2 notches on S and 1 notch on
E. edges; dug pits 18 x 18 x 12 ins. in each sec.,
5½ ft dist; and raised a mound of earth 2 ft
high, 4½ ft base; alongside. From which
A mesquite 8 ins diam. bears S. 70° W. 308 lks
dist. marked T. 17 S. R. 9 E. S. 26 B. T.

A mesquite 6 ins. diam. bears S. 5° W. 166 lks.
dist. marked T. 17 S. R. 9 E. S. 26. B. T.

Subdivisions, T₁₇S. R. 9E - Continued

Chains

A mesquite 8 ins. diam. bears S. 40° E. 245 lks
dist. marked, T₁₇S. R. 9E. S. 25 B.T.

A palo verde 8 ins. diam. bears N. 68° E 188 lks
dist. marked T₁₇S. R. 9E. S. 24 B.T.

Land, broken.

Soil, 3^d and 4th rate

Timber, scattering mesquite.

N 85° 40' E on a random line bet Secs 24 & 25
Var. 12° 55' E.

Over nearly level ground.

- 9.00 Arroyo 10 lks wide, Course S W.
- 21.00 Same Arroyo 40 lks wide, Course N. 60° W.
- 40.00 Set temporary 1/4 Sec. Cor.
- 80.06 Intersect E. boundary of Township at
16 lks. S. of the cor to secs. 19. 24. 25 & 30, which is

Subdivisions, Tp. 17 S. R. 9 E. - Continued

Chains.

a Granite stone, previously established and described by me. Thence I run

S. $85^{\circ} 33' W.$ on a true line bet Secs 24 & 25 with same Var.

40.03 Set a post, 3 ft long 3 ins. square, with marked stone, 12 ins in the ground, for $\frac{1}{4}$ Sec Cor., marked $\frac{1}{4}$ S. on N. face, dug pits $18 \times 18 \times 12$ ins. E and W. of post $5\frac{1}{2}$ ft dist, and raised a mound of earth $1\frac{1}{2}$ ft high $3\frac{1}{2}$ ft base around post. From which

A mesquite, 10 ins. diam. bears S. $65^{\circ} W.$ 128 lks dist. marked $\frac{1}{4}$ S. B. T.

A mesquite 8 ins. diam. bears S. $84^{\circ} E.$ 42 lks dist. marked $\frac{1}{4}$ S. B. T.

80.06 The cor to secs 23. 24. 25 & 26
Land, nearly level. Good grass.
Soil, 2^d and 3^d rate.

Subdivisions, Tp. 17 S. R. 9 E. - Continued

Chains

Timber, scattering mesquite and brush.

North, bet. Secs 23 & 24.

Var. $12^{\circ}55'E$.

Over rolling ground.

37.00 Enter Arroyo. Course N.W.

39.00 Leave Arroyo. Course N.W.

40.00 Set a Granite Stone $16 \times 12 \times 8$ ins. 11 ins. in the ground, for $\frac{1}{4}$ Sec. Cor. marked $\frac{1}{4}$ on W. face, dug pits $18 \times 18 \times 12$ ins. N. and S. of Stone, $5\frac{1}{2}$ ft dist., and raised a mound of earth $1\frac{1}{2}$ ft high, $3\frac{1}{2}$ ft base, alongside. From which
A pale verde 4 ins. diam. bears N. $83^{\circ}W$. 185 lks
dist. marked $\frac{1}{4}$ S. B. T.

A mesquite 6 ins. diam. bears S. $33^{\circ}W$. 227 lks
dist. marked $\frac{1}{4}$ S. B. T.

Subdivisions, T_p. 17 S. R. 9 E. - Continued

Chains.

75.00 Arroyo 30 lks. wide. Course N 80° W.

80.00 Set a Quartz stone 20 x 12 x 8 ins. 15 ins in the ground, for Cor. to Secs 13. 14. 23 & 24, marked with 3 notches on S. and 1 notch on E. edges, dug pits 18 x 18 x 12 ins. in each sec. 5 ½ ft dist, and raised a mound of earth 2 ft high, 4 ½ ft. base, alongside. From which

A mesquite 8 ins. diam. bears S. 56° W. 300 lks. dist. marked T. 17 S. R. 9 E. S. 23 B. T.

A mesquite, 6 ins. diam. bears S. 55 ½° W. 236 lks. dist. marked T. 17 S. R. 9 E. S. 23 B. T.

No other trees within limits.

Land, rolling, Good grass

Soil, 2^d and 3^d rate.

Timber, scattering mesquite and brush.

Subdivisions, Tp. 17 S. R. 9 E. - Continued

Chains

N $85^{\circ}40'$ E on a random line bet Secs 13 & 24.

Var. $12^{\circ}55'$ E.

Over rolling Mesa land.

23.00. Arroyo 16 lks wide. Course N.W.

40.00. Set temporary $\frac{1}{4}$ Sec. Cor.

40.20 Arroyo 2 chs wide, Course N. 30° W.

70.00 Arroyo 30 lks wide Course N.W.

80.11 Intersect E. boundary of Township at 15 lks N.

of the cor. to secs. 13. 18. 19 & 24 which is a Granite stone previously established and described by me.

Thence I run

S. $85^{\circ}46'$ W. on a true line bet Secs. 13 & 24 with same Var.

40.06 Set a Limestone $12 \times 10 \times 8$ ins. 8 ins. in the ground for $\frac{1}{4}$ Sec. Cor. marked $\frac{1}{4}$ on N. face, dug pits $18 \times 18 \times 12$ ins. E. and W. of stone, $5\frac{1}{2}$ ft dist, and raised a mound of earth $1\frac{1}{2}$ ft high, $3\frac{1}{2}$ ft base, alongside. From which

Subdivisions, T_p 17 S. R. 9 E. - Continued

Chains

A palo verde 6 ins. diam. bears N. 55° E. 98 lks. dist.
marked $\frac{1}{4}$ S. B. T.

A mesquite 8 ins. diam. bears North 78 lks. dist.
marked $\frac{1}{4}$ S. B. T.

80.11 The cor. to secs. 13, 14, 23 & 24.

Land, rolling. Good grass.

Soil, 2^d and 3^d rate.

Timber, scattering mesquite and palo verde.

North, between Secs 13 & 14.

Var. 12° 55' E.

Over rolling Mesa land.

15.00 Thruyo 20 lks. wide. Course N 80° W.

36.50 Road from Canillo's to Alter road Course N 70° W and S. 70° E.

40.00 Set a post, 3 ft long 3 ins. square with marked
stone, 12 ins. in the ground, for $\frac{1}{4}$ sec. cor.

Subdivisions, Twp. 17 S. R. 9 E. - Continued

Chains

marked $\frac{1}{4}$ S. on W. face; dug pits $18 \times 18 \times 12$ ins. N and S. of post, $5\frac{1}{2}$ ft dist. and raised a mound of earth $1\frac{1}{2}$ ft high, $3\frac{1}{2}$ ft base, around post. From which

A mesquite 10 ins. diam. bears N. 32° W. 82 lks. dist. marked $\frac{1}{4}$ S. B. T.

A mesquite 6 ins. diam. bears N. 52° W. 108 lks. dist. marked $\frac{1}{4}$ S. B. T.

40.50. Arroyo 30 lks. wide, Course W.

43.00 Arroyo 18 lks wide, Course W.

80.00. Set a Quartzite stone $20 \times 12 \times 8$ ins. 15 ins. in the ground, for cor. to secs. 11, 12, 13 & 14, marked with 4 notches on S. and 1 notch on E. edges; dug pits $18 \times 18 \times 12$ ins. in each sec. $5\frac{1}{2}$ ft dist, and raised a mound of earth 2 ft high $4\frac{1}{2}$ ft base, alongside. From which A mesquite 6 ins. diam. bears S. 68° E 153 lks.

Subdivisions, T_p. 17 S. R. 9 E. - Continued

Chains

dist. marked T_p. 17 S. R. 9 E. S. 13 B. T.

A mesquite 6 ins. diam. bears N. 20° E. 195 lks dist.

marked T_p. 17 S. R. 9 E. S. 12 B. T.

A mesquite 6 ins. diam. bears N. 21° W. 188 lks.

dist. marked T_p 17 S. R. 9 E. S. 11 B. T.

A mesquite 6 ins. diam. bears S. 78° W. 142 lks.

dist. marked T_p. 17 S. R. 9 E. S. 14 B. T.

Land, rolling. Good grass.

Soil, 2^d and 3^d rate.

Timber, scattering mesquite and brush.

N 85° 40' E on a random line bet Secs. 12 & 13

Var 12° 55' E.

Over rolling Mesa land.

28.00 Arroyo 20 lks wide, Course N.W.

40.00 Set temporary $\frac{1}{4}$ Sec. Cor.

Subdivisions, Tr 17 S. R. 9 E. — Continued

Chains

- 73.00 Arroyo 30 lks wide, Course N.W.
- 79.92 Intersect E. boundary of Township at 6 lks S. of the cor. to secs. 7. 12. 13 & 18 which is a post previously established and described by me.
Thence I run
S. $85^{\circ}37'$ W. on a true line, between Secs. 12 & 13 with same Var.
- 39.96 Set a post 3 ft long 3 ins. square with marked stone, 12 ins. in the ground for $\frac{1}{4}$ Sec. Cor. marked $\frac{1}{4}$ S. on N. face; dug pits 18 x 18 x 12 ins. E. and W. of post, $5\frac{1}{2}$ ft. dist. and raised a mound of earth $1\frac{1}{2}$ ft. high $3\frac{1}{2}$ ft. base, around post.
- 79.92 The cor. to secs 11. 12. 13 & 14.
Land, rolling. Good grass.
Soil, 2^d and 3^d rate
Timber, scattering mesquite and brush.

Subdivisions, T_p. 17 S. R. 9 E. - Continued

Chain

North bet. Secs. 11 & 12.

Var. $12^{\circ}55'E$.

Over level Mesa land.

40.00 Set a Granite stone $16 \times 8 \times 5$ ins. 11 ins. in the ground for $\frac{1}{4}$ Sec. Cor. marked $\frac{1}{4}$ on W. face, dug pits $18 \times 18 \times 12$ ins. N. & S. of stone, $5\frac{1}{2}$ ft dist, and raised a mound of earth $1\frac{1}{2}$ ft high, $3\frac{1}{2}$ ft base, alongside. From which

A mesquite 4 ins. diam. bears S. $29^{\circ}E$. 49 lks. dist. marked $\frac{1}{4}$ S. B. T.

A mesquite 4 ins. diam. - bears S. $50^{\circ}W$. 167 lks. dist. marked $\frac{1}{4}$ S. B. T.

80.00 Set a post 4 ft long 4 ins. square with marked stone 12 ins. in the ground for Cor. to Secs. 1-2-11 & 12 marked

T. 17 S., S 1 on NE.

R. 9 E., S 12 on SE

Subdivisions, Tp. 17 S. R. 9 E. — Continued

Chains

S. 11 on S.W. and
 S. 2 on N.W. faces, with 5 notches on S. and
 1 notch on E. edges, dug pits 18x18x12 ins. in
 each sec. 5½ ft. dia., and raised a mound of
 earth 2 ft. high, 4½ ft. base, around post.
 Land, level. Good grass
 Soil, 1st & 2^d rate
 Timber, scattering mesquite.

N55°40'E on a random line bet Secs 1 & 12.

Var. 12°55'E.

Over level Mesa land.

32.00 Arroyo 18 lks wide. Course N.W.

38.00 Arroyo 25 lks wide. Course N.W.

40.00 Set temporary ¼ Sec. Cor.

69.00 Arroyo 18 lks wide. Course N.W.

Subdivisions, Tp. 17 S. R. 9 E. - Continued

Chains

- 80.10 Intersect E. boundary of Township at 9 lks N. of the cor to Secs 1. 6. 7 & 12, which is a Granite stone previously established and described by me. Thence
 Iron
 S $85^{\circ} 44'$ W. on a true line bet Secs 1 & 12 with same Var.
- 40.05 Set a post 3 ft long 3 ins. square with marked stone 12 ins in the ground for $\frac{1}{4}$ Sec. Cor. marked $\frac{1}{4}$ S. on N. face, dug pits 18 x 18 x 12 ins. E & W. of post, $5\frac{1}{2}$ ft dist. and raised a mound of earth $1\frac{1}{2}$ ft high, $3\frac{1}{2}$ ft base, around post.
- 80.10 The cor to secs 1. 2. 11 & 12.
 Land, level. Good grass
 Soil, 1st & 2^d rate.
 No timber

Subdivisions, Tp 17 S. R. 9 E. — continued

Chain

North on a random line bet Secs. 1 & 2

Var. $12^{\circ}55' E$.

Over level Mesa land.

23.00 Main road from Tucson to Altar. Course $N20^{\circ}E$.
and $S. 20^{\circ}W$.23.50 Fence (Warren's) post and wire Course $N20^{\circ}E$ & $S20^{\circ}W$ 40.00 Set temporary $\frac{1}{4}$ Sec. Cor.46.00 Fence (Warren's) post and wire Course $E \& W$.48.00 Warren's ranch house immediately E . of line.53.20 Fence (Warren's) post & wire; N . boundary of fence
Course $E \& W$. The NE . cor. of fence is 5 chs. E
of line59.00 Road from Robb's to Warren's. Course
 $E \& W$.80.04 Intersect N . boundary of Township at 18 lks W .
of the cor. to secs. 1, 2, 35 & 36 which is a post
previously established and described by me.

Thence I run

Subdivisions, Tp. 17 S. R. 9 E. - Continued

Chains

Stone 12 ins. in the ground, for cor. to secs. 26, 27, 34 & 35, marked

T. 17 S., S. 26 on NE.

R. 9 E., S. 35 on SE.

S. 34 on SW and

S. 27 on NW. faces with 1 notch on S and 2 notches on E. edges, dug pits 18 x 18 x 12 ins in each sec. 5 1/2 ft. dist., and raised a mound of earth 2 ft high 4 1/2 ft base around post.

From which

A mesquite 6 ins. diam. bears S. 30° W. 232 lks. dist. marked T. 17 S. R. 9 E. S. 34 B. T.

A mesquite 6 ins. diam. bears S. 65° W. 263 lks. dist. marked T. 17 S. R. 9 E. S. 34 B. T.

A mesquite 8 ins. diam. bears N. 89° E. 300 lks. dist. marked T. 17 S. R. 9 E. S. 26 B. T.

A mesquite 8 ins. diam. bears S. 87° E. 344 lks.

Subdivisions, T. 17 S. R. 9 E. — Continued

Chains

dist. marked T. 17 S. R. 9 E. S. 35 B. T.

Land, level. Good grass.

Soil, 2^d rate

Timber, scattering mesquite.

 $N 85^{\circ} 40' E$, on a random line bet Secs. 26 & 35Var. $12^{\circ} 55' E$.

Over level ground

37.00 Mainroad from Tucson to Alter, Course N & S
and leave bottom land.40.00 Set temporary $\frac{1}{4}$ Sec. Cor.

57.00 Enter rolling Mesa.

80.01 Intersect N & S line at 16 lks N. of the cor.
to secs 25, 26, 35 & 36. Thence I run
S. $85^{\circ} 47' W$. on a true line bet Secs 26 & 35
with same Var.

Subdivisions, Tp. 17 S. R. 9 E. - Continued.

Chains

40.01 Set a Granite stone 18x10x8 ins. 12 ins. in the ground for $\frac{1}{4}$ Sec. Cor., marked $\frac{1}{4}$ on N. face, dug pits 18x18x12 ins. E & W. of stone $5\frac{1}{2}$ ft dist., and raised a mound of earth $1\frac{1}{2}$ ft high, $3\frac{1}{2}$ ft base, alongside.

80.01 - The cor to Secs. 26, 27, 34 & 35.

Land for 37chs level, then rolling Mesa.

Soil, 1st & 2^d rate.

Timber, very little mesquite or brush.

North bet. Secs 26 & 27

Var. $12^{\circ}55'E$.

Over level ground.

40.00 Set a post 3 ft long 3 ins. square with marked stone, 12 ins in the ground, for $\frac{1}{4}$ sec. cor. marked $\frac{1}{4}$ S. on W. face, dug pits

Subdivisions, Tp. 17 S. R. 9 E. - Continued

Chains

18 x 18 x 12 ins N & S. of post 5 1/2 ft dist, and raised a mound of earth 1 1/2 ft high 3 1/2 ft base, around post. From which

A mesquite 8 ins diam. bears S. 45° W. 142 lks. dist. marked 1/4 S. B. T.

A mesquite 8 ins. diam. bears S. 55° W. 273 lks. dist. marked 1/4 S. B. T.

80.00. Set a post 4 ft long 4 ins. square with marked stone 12 ins in the ground, for cor. to secs 22. 23. 26. & 27 marked

T. 17 S., S. 23 on NE

R. 9 E., S. 26 on SE.

S. 27 on SW and

S. 22 on NW faces, with 2 notches on S. and E. edges, dug pits 18 x 18 x 12 ins. in each sec. 5 1/2 ft dist. and raised a mound of earth 2 ft high, 4 1/2 ft base, around post.

Subdivisions, T. 17 S. R. 9 E. - Continued

Chains

From which

A mesquite 10 ins. diam. bears S. 24° E. 54 lbs.
 dist. marked T. 17 S. R. 9 E. S. 26 B. T.

A mesquite 6 ins. diam. bears N. 68° E. 100 lbs.
 dist. marked T. 17 S. R. 9 E. S. 23 B. T.

A mesquite 4 ins. diam. bears S. 73° W. 114 lbs.
 dist. marked T. 17 S. R. 9 E. S. 27 B. T.

A mesquite 6 ins. diam. bears S. 33° W. 228 lbs.
 dist. marked T. 17 S. R. 9 E. S. 27 B. T.

Land, level. Good grass

Soil, 2^d rate.

Timber, scattering mesquite.

N. $85^{\circ} 40'$ E. on a random line bet. Secs 23 & 26
 Var. $12^{\circ} 55'$ E.

Over level Mesa land.

Subdivisions, Tp. 17 S. R. 9 E. — Continued

chains

- 30.00 Main road from Tucson to Altar Course N 60° E
- 40.00 Set temporary $\frac{1}{4}$ Sec. Cor.
- 43.00 Arroyo 18 lks wide. Course N.W.
- 75.00 Arroyo 25 lks wide. Course N.W.
- 79.84 Intersect N & S line 11 lks W. of the cor. to secs. 23-24, 25 & 26. Thence I run S. $85^{\circ}45'W$. on a true line bet. Secs 23 & 26. with same Var.
- 39.92 Set a Granite stone $14 \times 12 \times 8$ ins. 10 ins in the ground for $\frac{1}{4}$ Sec. Cor. marked $\frac{1}{4}$ on N. face dug pits $18 \times 18 \times 12$ ins. E. & W. of stone, $5\frac{1}{2}$ ft dist, and raised a mound of earth $1\frac{1}{2}$ ft high $3\frac{1}{2}$ ft base, alongside. From which
 A mesquite 6 ins. diam. bears S. $51^{\circ}W$ 212 lks. dist. marked $\frac{1}{4}$ S. B. T.
 A mesquite 8 ins. diam. bears N. $40^{\circ}E$. 68 lks. dist. marked $\frac{1}{4}$ S. B. T.

Subdivisions, Tp 17 S. R. 9 E. - Continued

Chains

79.84. The cor. to secs 22, 23, 26 & 27

Land, level; - broken on E. boundary.

Soil, 2^d rate and 3^d rate.

Timber, scattering mesquite.

North bet Secs 22 & 23.

Var. $12^{\circ}55' E$.

Over level Mesa land.

40.00. Set a post 3 ft long 3 ins. square with marked stone 12 ins. in the ground for $\frac{1}{4}$ sec. cor. marked $\frac{1}{4} S$. on W. face, dug pits $18 \times 18 \times 12$ ins. N & S. of post, $5\frac{1}{2}$ ft dist. and raised a mound of earth $1\frac{1}{2}$ ft high $3\frac{1}{2}$ ft base, around post. From which a mesquite 8 ins. diam. bears $S. 64^{\circ} W. 442$ lbs dist. marked $\frac{1}{4} S. B. T.$

Subdivisions, Tp 17 S. R. 9 E. — Continued

chains

A mesquite 10 ins. diam. bears $N. 63^{\circ} W. 357$ lks
 dist marked $\frac{1}{4}$ S. B. T.

57.00 S. W. cor. of Warren's post & wire fence 10 chs E.

70.00 Arroyo 15 lks wide. Course $N 30^{\circ} E$.

80.00 Set a post 4 ft long 4 ins. square with
 marked stone 12 ins in the ground, for cor
 to secs 14. 15. 22 & 23 marked

T. 17 S. S. 14 on NE

R. 9 E. S. 23 on SE.

S. 22 on SW and

S. 15 on NW faces, with 3 notches
 on S. and 2 notches on E. edges, dug pits
 $18 \times 18 \times 12$ ins. in each sec. $5 \frac{1}{2}$ ft. dist.
 and raised a mound of earth 2 ft high
 $4 \frac{1}{2}$ ft base, around post. From which
 A mesquite 4 ins. diam. bears $N 5^{\circ} W. 132$ lks.
 dist. marked T. 17 S. R. 9 E. S. 15 B. T.

Subdivisions, T. 17 S. R. 9 E. - Continued

Charco

A mesquite 4 ins. diam. bears $N. 50^{\circ} W. 211$ lks
dist. marked T. 17 S. R. 9 E. S. 15 B. T.

A mesquite 6 ins. diam bears $S. 5^{\circ} W 193$
lks. dist. marked T. 17 S. R. 9 E. S. 22 B. T.

A mesquite 8 ins diam. bears $S. 71^{\circ} E 318$
lks dist. marked T. 17 S. R. 9 E. S. 23 B. T.

Land, level. Good grass.

Soil, 2^d and 3^d rate.

Timber, scattering mesquite.

$N 85^{\circ} 40' E$ on a random line bet. Secs 14 & 23.

Var. $12^{\circ} 55' E$.

Over gently rolling ground.

- 10.90 Fence (Warren's) post & wire. Course $N \& S$
22.00 Charco or Waterhole. Course $N \& S$. 50 lks wide
40.00 Set temporary $\frac{1}{4}$ Sec Cor.

Subdivisions, Tp. 17 S. R. 9 E. - Continued

Chains

- 53.50 Fence, (Warren's) post & wire. Course $N10^{\circ}E$ and $S.10^{\circ}W$.
- 53.75 Main road from Tucson to Altar. Course $N \& S$. - Leave bottom land.
- 79.93 Intersect $N \& S$ line at 21 lks S . of the cor to secs 13. 14. 23 & 24. Thence I run $S.85^{\circ}31'W$ on a true line bet. Secs 14 & 23 with same Var.
- 39.97 Set a post 3 ft long by 3 ins. square with marked stone 12 ins. in the ground for $\frac{1}{4}$ sec. cor. marked $\frac{1}{4} S$. on N . face, dug pits $18 \times 18 \times 12$ ins. E and W . of post, $5\frac{1}{2}$ ft dist. and raised a mound of earth $1\frac{1}{2}$ ft high $3\frac{1}{2}$ ft base, around post.
- 79.93 The cor. to secs 14. 15. 22 & 23.
Land gently rolling. Good grass.
Soil, in bottom 1st rate on Mesa 2^d rate.

Subdivisions, Tp. 17 S. R. 9 E. - Continued

Chains

Timber, some mesquite and brush.

By observation taken this day I find the magnetic Variation to be $12^{\circ}55'E$.

North bet. Secs 14 & 15.

Var. $12^{\circ}55'E$.

Over level ground.

40.00. Set a post 3 ft long 3 ins. square with marked stone, 12 ins. in the ground, for $\frac{1}{4}$ Sec. Cor. marked $\frac{1}{4}$ S. on W. face, dug pits $18 \times 18 \times 12$ ins N. & S. of post, $5\frac{1}{2}$ ft. dist., and raised a mound of earth $1\frac{1}{2}$ ft. high, $3\frac{1}{2}$ ft. base, around post. From which a mesquite 8 ins. diam. bears $S 86^{\circ} W$ 150 lbs. dist. marked $\frac{1}{4}$ S. B. T.

Subdivisions, T. 17 S. R. 9 E. — Continued

chains

A mesquite 6 ins. diam. bears S. 84° E 36 lks. dist.
marked $\frac{1}{4}$ S. B. T.

57.20 Arroyo 20 lks wide. Course S E.

61.50 Wood road. Course E & W.

80.00 Set a post, 4 ft. long 4 ins. square, with marked
stone, 12 ins. in the ground, for cor to secs.

10. 11. 14 & 15. marked

T. 17 S. S. 11 on NE

R. 9 E S. 14 on SE.

S. 15 on SW. and

S. 10 on NW. faces, with 4 notches
on S. and 2 notches on E. edges, dug pits
18 x 18 x 12 ins. in each sec., $5\frac{1}{2}$ ft. dist, and
raised a mound of earth 2 ft. high, $4\frac{1}{2}$ ft.
base, around post. From which

A mesquite 6 ins. diam. bears S 74° E. 49 lks.

dist, marked T. 17 S. R. 9 E. S. 14 B. T.

Subdivisions, Tp. 17 S. R. 9 E. - Continued.

Chains

A mesquite 4 ins. diam. bears S 79° E. 130
lks. dist. marked T 17 S. R. 9 E. S. 14 B. T.

A mesquite 12 ins. diam. bears N. 40° W. 300
lks. dist. marked T 17 S. R. 9 E. S. 10 B. T.

No other trees within limits.

Sand, level. Good grass.

Soil, 1st and 2^d rate.

Timber, scattering mesquite.

✓ N 85° 40' E, on a random line bet Secs 11 & 14.

Var. 12° 55' E.

Over gently rolling ground

15.10 Fence (Warren's) post & wire. Course N & S.

40.00. Set temporary $\frac{1}{4}$ Sec. Cor.

58.00 Fence (Warren's) post & wire. Course N. 10° E
and S 10° W.

Subdivisions, Tp. 17 S. R. 9 E - continued

Chain

- 59.00 Main road from Tucson to Altar. Course N. & S.
- 80.08 Intersect N & S line 13 chs N. of the cor to Secs 11, 12, 13 & 14. Thence I run S. $85^{\circ}45'W.$ on a true line bet Secs 11 & 14 with same Var.
- 40.04 Set a post, 3 ft long 3 ins. square with marked stone, 12 ins in the ground, for $\frac{1}{4}$ Sec. Cor. marked $\frac{1}{4}$ S. on N. face; dug pits $18 \times 18 \times 12$ ins. E & W. of post, $5\frac{1}{2}$ ft dist, and raised a mound of earth $1\frac{1}{2}$ ft high, $3\frac{1}{2}$ ft base, around post.
- 80.08 The cor to secs. 10, 11, 14 & 15.
 Land gently rolling. Good grass
 Soil, 1st and 2^d rate
 Timber, scattering mesquite and brush.

Subdivisions, Tp 17 S. R. 9 E. - Continued

Chain

North bet. Secs. 10 & 11

Var. $12^{\circ}55'E$

Over level ground

40.00 Set a post, 3 ft long 3 ins square with marked stone, 12 ins. in the ground, for $\frac{1}{4}$ sec. cor. marked $\frac{1}{4}$ S. on W. face; deep pits $18 \times 18 \times 12$ ins. N. & S. of post, $5\frac{1}{2}$ ft dist, and raised a mound of earth, $1\frac{1}{2}$ ft high, $3\frac{1}{2}$ ft base, around post. From which
 A mesquite 6 ins. diam. bears $S 62^{\circ}E$. 111 lbs dist marked $\frac{1}{4}$ S. B. T.

A mesquite 4 ins. diam. bears N. $67^{\circ}E$ 121 lbs dist. marked $\frac{1}{4}$ S. B. T.

54.50 Road from Tucson to Leon's ranch. Course NE & SW.

80.00 Set a post 4 ft long 4 ins. square with marked stone, 12 ins in the ground for cor

Subdivisions, Tp. 17 S. R. 9 E - Continued

to secs. 2, 3, 10 & 11, marked

T. 17 S. S. 2 on NE.

R. 9 E. S. 11 on SE.

S. 10 on SW and

S. 3 on N.W. face, with 5 notches
on S. and 2 notches on E. edges, dug pits 18
 \times 18 \times 12 ins. in each sec. 5½ ft. dist, and
raised a mound of earth 2 ft high, 4½ ft
base, around post.

Land, level. Good grass.

Soil, 2^d rate

Timber, some mesquite.

N 85° 40' E on a random line bet Secs 2 & 11

Var. 12° 55' E.

Over gently rolling ground

Subdivisions, Tp. 17 S. R. 9 E - Continued

Chains

- 31.00 Road from Tucson to Lem's ranch Course N. 20° E and S. 20° W.
- 31.60 Fence (Warren's) post & wire. Course N. 20° E and S. 20° W.
- 40.00 Set temporary $\frac{1}{4}$ Sec. Cor.
- 75.10 Fence, (Warren's) post & wire. Course N. 20° E and S. 20° W.
- 75.25 Main road from Tucson to Altav. Course N. 20° E and S. 20° W.
- 79.94 Intersect N. & S. line at 8 lks S. of the cor to secs. 1, 2, 11 & 12. Thence I run S. 85° 36' W on a true line bet Secs 2 & 11 with same Var.
- 39.97 Set a post 3 ft long, 3 ins. square with marked stone 12 ins in the ground, for $\frac{1}{4}$ sec. cor. marked $\frac{1}{4}$ S. on N. face; dug pits 18 x 18 x 12 ins; E and W. of post, and raised a mound of earth $1\frac{1}{2}$ ft high $3\frac{1}{2}$ ft base

Subdivisions, Tp 17. R. 9 E - Continued

Chains

around post.

79.94. The cor. to Secs. 2, 3, 10 & 11

Land gently rolling. Good grass.

Soil 1st and 2^d rate

No timber

North on a random line bet Secs. 2 & 3.

Var. $12^{\circ} 55' E$.

Over level ground.

7.30 Road from Tucson to Leon's ranch, Course NE
and SW.40.00 Set temporary $\frac{1}{4}$ Sec. Cor.79.90 Intersect the N. boundary of the Township
at 30 lks W. of the cor. to secs 2, 3, 34 & 35
which is a post previously established and
described by me. Thence I run

Subdivisions, Tp. 17. R. 9 E - Continued

Chains

S. $0^{\circ}13'W$. on a true line bet Secs 2 and 3 with same Var.

39.90. Set a post 3 ft long 3 ins square with marked stone 12 ins in the ground for $\frac{1}{4}$ Sec Cor. marked $\frac{1}{4}$ S. on W. face; dig pits 18 x 18 x 12 ins N & S of post, $5\frac{1}{2}$ ft dist; and raised a mound of earth $1\frac{1}{2}$ ft high, $3\frac{1}{2}$ ft base, around post.

From which

A mesquite 6 ins diam. bears S. $3^{\circ}W$. 189 lks dist. marked $\frac{1}{4}$ S. B. T

A mesquite 4 ins diam bears S. $46^{\circ}W$. 106 lks dist. marked $\frac{1}{4}$ S. B. T

79.90. The cor to secs. 2, 3, 10 & 11.

Land, level. Good grass.

Soil, 2^d rate.

Timber, few mesquite.

October 21st 1886.

Subdivisions, Tp. 17 S. R. 9 E. - Continued

Chains

From the cor to secs 3. 4. 33 & 34 on the S. boundary of Township which is a Granite stone, previously established and described by me, I run

North bet Secs. 33 & 34.

Var. $12^{\circ}55' E$.

Over level Mesa land.

28.00 Arroyo 1 ch. wide. Course $N 30^{\circ} E$

40.00 Set a post 3 ft long 3 ins square with marked stone 12 ins in the ground for $\frac{1}{4}$ Sec. Cor. marked $\frac{1}{4}$ S on W. face, dug pits $18 \times 18 \times 12$ ins. N & S of post $5\frac{1}{2}$ ft dist and raised a mound of earth $1\frac{1}{2}$ ft high $3\frac{1}{2}$ ft base, around post. From which
A mesquite 4 ins. diam bears $S 85^{\circ} W$ 218 lks
dist. marked $\frac{1}{4}$ S. B. S.

A mesquite 4 ins. diam bears $S. 43^{\circ} W$ 173 lks

Subdivisions, T_p. 17. R. 9 E. — Continued

Chains

- 71.00. New road Course
N.W. and S.E.
- 77.00 Arroyo 1 ch. wide. Course N 30° E.
- 80.00 Set a post 4 ft long 4 ins. square with
marked stone 12 ins. in the ground, for
cor to secs 27. 28. 33 & 34. marked
T. 17 S. S. 27 on N.E.
R. 9 E. S. 34 on S.E.
S. 33 on S.W. and
S. 28 on N.W. faces, with 1 notch
on S. and 3 notches on E. edges. From which
A mesquite 4 ins. diam. bears N. 30° W. 130
lks. dist. marked T. 17 S. R. 9 E. S. 28 B. T.
A mesquite 12 ins. diam. bears S. 85° W. 239
lks. dist. marked. T. 17 S. R. 9 E. S. 33 B. T.
A mesquite 8 ins. diam. bears S. 41° W. 107

Subdivisions, Tp. 17. R. 9 E. — Continued

Chain

lks, dist. marked T. 17 S. R. 9 E. S. 33 B. T.

A mesquite 6 ins. diam. bears N. 30° E. 43 lks. dist.

marked T. 17 S. R. 9 E. S. 27 B. T.

Land level. Good grass.

Soil, 2^d rate

Timber, scattering mesquite.

N 85° 40' E on a random line bet Secs 27 & 34.

Var. 12° 55' E.

Over level Mesa land.

7.00 Arroyo 1 ch wide. Course N & E.

40.00 Set temporary $\frac{1}{4}$ Sec. Cor.

80.07 Intersect N & S line at 14 lks. S of the cor
to Secs 26. 27. 34 & 35. Thence I run
S. 85° 34' W. on a true line bet Secs.
27 & 34 with same Var.

40.04 Set a post 3 ft long 3 ins square with

Subdivisions, Tr 17. R. 9 E. - Continued

Chains

marked stone, 12 ins. in the ground for $\frac{1}{4}$ sec. cor., marked $\frac{1}{4}$ S. on N. face, dug pits 18x18x12 ins. E. and W. of post, $5\frac{1}{2}$ ft dist, and raised a mound of earth $1\frac{1}{2}$ ft high $3\frac{1}{2}$ ft base, around post. From which
A mesquite 10 ins. diam. bears N. 44° E.

89 lks. dist. marked $\frac{1}{4}$ S. B.T.

A mesquite 10 ins. diam bears S. 46° W

117 lks. dist. marked $\frac{1}{4}$ S. B.T.

80.07 The cor to Secs 27. 28. 33 & 34.

Land, level. Good grass.

Soil, 2^d rate.

Timber, scattering mesquite.

North bet Secs 27 & 28.

Var. $12^{\circ}55'$ E.

Subdivisions, Tp. 17. R. 9E. - Continued

chains

Over level Mesa land.

25.75 Arroyo 30 lks wide, Course E.

40.00 Set a post 3 ft long 3 ins. square with marked stone 12 ins in the ground for $\frac{1}{4}$ Sec. Cor. marked $\frac{1}{4}$ S. on W. face, dug pits 18 X 18 X 12 ins. N. and S. of post, 5 $\frac{1}{2}$ ft dist, and raised a mound of earth 1 $\frac{1}{2}$ ft high 3 $\frac{1}{2}$ ft base around post. From which
 A mesquite 4 ins. diam. bears N. 28° W. 57 lks dist. marked $\frac{1}{4}$ S. B. T.
 A mesquite 6 ins. diam. bears S. 37° E. 33 lks dist. marked $\frac{1}{4}$ S. B. T.

50.00 Arroyo 20 lks wide, Course NE

74.00 Arroyo 16 lks wide, Course NE

80.00 Set a post 4 ft long 4 ins. square with marked stone 12 ins in the ground for cor to secs. 21. 22. 27 & 28. marked

Subdivisions, T. 17 S. R. 9 E. - Continued

Chains.

T. 17 S. S. 22 on NE.

R 9 E. S. 27 on SE.

S 28 on SW and

S 21 on NW face, with 2 notches on S. and 3 notches on E. edges; dug pits 18 x 18 x 12 ins. in each sec. $5\frac{1}{2}$ ft. dist, and raised a mound of earth 2 ft high $4\frac{1}{2}$ ft base around post. From which

A mesquite 6 ins. diam. bears N. 20° W. 98 lks. dist. marked T. 17 S. R. 9 E. S. 21 B.T.

A mesquite 6 ins. diam. bears N. 18° E. 91 lks. dist. marked T. 17 S. R. 9 E. S. 22 B.T.

✓ A mesquite 4 ins. diam. bears N. 55° E. 53 lks. dist. marked T. 17 S. R. 9 E. S. 22 B.T.

A mesquite 6 ins. diam. bears S. 63° E. 136 lks. dist. marked T. 17 S. R. 9 E. S. 27 B.T.

Land, level. Good grass.

Subdivisions, Tp. 17 S. R. 9 E - Continued

No. 841

Chains

Soil, 2^d rate.

Timber, scattering mesquite.

N 85° 40' E, on a random line bet Secs 22 & 27
Var. 12° 55' E.

Over level Mesa land.

5.00 Arroyo 16 lks wide. Course NE.

40.00 Set temporary $\frac{1}{4}$ Sec. Cor.

80.08 Intersect N. & S. line, 6 lks. N. of the cor to
secs 22, 23, 26 & 27. Thence run
S 85° 43' W. on a true line bet Secs 22 & 27
with same Var.

40.04 Set a post 3 ft long 3 ins. square with
marked stone 12 ins. in the ground, for $\frac{1}{4}$
Sec. Cor. marked $\frac{1}{4}$ S. on N. face, dug pits
18 x 18 x 12 ins. E & W. of post, 5 $\frac{1}{2}$ ft. dist.

Subdivisions, Tp. 17 S. R. 9 E. Continued

Chains.

and raised a mound of earth $1\frac{1}{2}$ ft high 3 ft base around post. From which

A mesquite 10 ins. diam. bears N. 45° E. 180 lks. dist. marked $\frac{1}{4}$ S. B. T.

A mesquite 10 ins. diam. bears N. 83° W. 238 lks. dist. marked $\frac{1}{4}$ S. B. T.

80.08 The cor to secs 21, 22, 27 & 28.

Land, level. Good grass.

Soil, 2^d rate

Timber, scattering mesquite.

North bet Secs. 21 & 22.

Var. $12^{\circ} 55' E$.

Over level Mea land

5.50 Arroyo 45 lks wide, Course N. 70° E

8.00 Arroyo 10 lks wide, Course E.

Subdivisions, Tp. 17 S. R. 9 E. - Continued.

Chains

- 19.00 Arroyo 20 lks wide, Course E.
- 27.00 Arroyo 10 lks wide, Course E.
- 40.00 Set a post 3 ft long 3 ins. square with marked stone 12 ins. in the ground for $\frac{1}{4}$ sec. cor. marked $\frac{1}{4}$ S. on W. face, dug pits 18 x 18 x 12 ins. N & S. of post, 5 $\frac{1}{2}$ ft dist, and raised a mound of earth 1 $\frac{1}{2}$ ft high 3 $\frac{1}{2}$ ft base, around post. From which a mesquite 8 ins. diam. bears N. 24° E. 200 lks. dist. marked $\frac{1}{4}$ S. B. T.
- A mesquite 10 ins. diam. bears S. 18° E 57 lks. dist. marked $\frac{1}{4}$ S. B. T.
- 47.00 Arroyo 2 chs wide. Course N. 60° E
- 57.00 Arroyo 2 chs. wide. Course N. 60° E.
- 80.00 Set a post 4 ft long 4 ins square with marked stone 12 ins. in the ground for cor to secs 15. 16. 21 & 22 marked.

Subdivisions, T. 17 S. R. 9 E - Continued

Chains

T. 17 S. S. 15 on NE

R. 9 E. S. 22 on SE.

S. 21 on SW and

S. 16 on NW face, with 3 notches on S and E edges; dug pits 18x18x12 ins. in each sec. 5 1/2 ft. dist. and raised a mound of earth 2 ft. high 4 1/2 ft. base, around post. From which

A mesquite 12 ins. diam. bears N. 25 1/2° W. 145 lbs. dist. marked T. 17 S. R. 9 E. S. 16 B. T.

A mesquite 8 ins. diam. bears S. 22° W. 153 lbs. dist. marked T. 17 S. R. 9 E. S. 21 B. T.

A mesquite 10 ins. diam. bears N. 45° E. 233 lbs. dist. marked T. 17 S. R. 9 E. S. 15 B. T.

No other trees within limits.

Land, level. Good grass

Soil, 2^d and 3^d rate.

Subdivisions, Tp. 17 S. R. 9 E. Continued

Chains

Timber, scattering mesquite.

N $85^{\circ}40'E$, on a random line bet Secs 15 & 22

Var. $12^{\circ}55'E$.

Over level Mesa land.

40.00 Set temporary $\frac{1}{4}$ Sec. Cor.

79.86 Intersect N. & S. line at 18 lks S of the cor. to
secs. 14, 15, 22 & 23. Thence I run S. $85^{\circ}32'W$ on
a true line bet Secs 15 & 22 with same Var.

39.93 Set a post 3 ft long 3 ins. square, with marked
stone 12 ins in the ground, for $\frac{1}{4}$ sec. cor.,
marked $\frac{1}{4}$ S. on N. face, dug pits 18x18x12 ins
E and W. of post, 5 $\frac{1}{2}$ ft dist, and raised a
mound of earth 1 $\frac{1}{2}$ ft high 3 $\frac{1}{2}$ ft base, around
post. From which

A mesquite 6 ins. diam. bears N. $68^{\circ}W$. 43 lks dist

Subdivisions, T. 17 S. R. 9 E - Continued

Chains

marked $\frac{1}{4}$ S. B. T.A mesquite 6 ins. diam. bears S 36° W. 65 lks
dist. marked $\frac{1}{4}$ S. B. T.

79.86 The cor to secs 15, 16, 21 & 22

Land level. Good grass.

Soil, 2^d rate

Timber, scattering mesquite.

North, bet Secs. 15 & 16

Var $12^{\circ}55'E$.

Over level Mesa land

40.00 Set a post 3 ft long 3 ins. square with marked
stones 12 ins up the ground, for $\frac{1}{4}$ Sec. Cor
marked $\frac{1}{4}$ S. on W. face, dug pits 18 x 18 x 12 ins
N. & S. of post, $5\frac{1}{2}$ ft dist, and raised a
mound of earth 15 ft high, $3\frac{1}{2}$ ft base, around

Subdivisions, T. 17 S. R. 9 E. - Continued

Chains

post. From which

A mesquite 4 ins. diam. bears $N. 84^{\circ} W$ 81 lks dist.
marked $\frac{1}{4}$ S. B. T.A mesquite 4 ins. diam. bears $N. 18^{\circ} W$ 42 lks dist.
marked $\frac{1}{4}$ S. B. T.

49.70 Arroyo 8 lks wide, Course E.

59.50 Arroyo 18 lks wide, Course E.

76.00 Arroyo 20 lks wide, Course E.

80.00 Set a post 4 ft long 4 ins. square, with
marked stone 12 ins. in the ground for cor
to secs. 9, 10, 15 & 16. marked

T. 17 S. S. 10 on N.E.

R. 9 E. S. 15 on S.E.

S. 16 on S.W. and

S. 9 on N.W. face, with 4 notches
on S. and 3 notches on E. edges, dug pits 18
 \times 18 \times 12 ins. in each sec. 5 $\frac{1}{2}$ ft. dia., and

Subdivisions, T17 S. R9E - Continued

Chains.

raised a mound of earth 2 ft high $4\frac{1}{2}$ ft
base around post. From which

A mesquite 12 ins. diam bears S. $0\frac{1}{2}^{\circ}$ W. 218 lbs
dist. marked T. 17 S. R. 9E. S. 16 B. T.

A mesquite 12 ins. diam. bears S 64° W. 163 lbs
dist. marked T. 17 S. R. 9E. S. 16 B. T.

A mesquite 12 ins. diam. bears S. 73° E. 67 lbs
dist. marked T. 17 S. R. 9E. S. 15 B. T.

A mesquite 6 ins. diam. bears N. 85° E. 156 lbs
dist. marked T. 17 S. R. 9E. S. 10 B. T.

Land, level. Good grass

Soil, 2^d rate

Timber, scattering mesquite

N 85° 40' E, on a random line bet Secs 10 & 15

Var 12° 55' E

Subdivisions T_{p.} 17 S. R. 9 E. - Continued

Chains

Over level Mesa land.

24.00 Wood road. Course N W & S E.

40.00 Set temporary $\frac{1}{4}$ Sec. Cor.79.96 Intersect N. & S. line at 23 lks S. of the cor to
secs 10. 11. 14 & 15. Thence I run
S. $85^{\circ}30'$ W. on a true line bet. secs 10 & 15 with
same Var.39.98 Set a post, 3 ft long, 3 ins. square, with
marked stone, 12 ins. in the ground for $\frac{1}{4}$ Sec.
Cor. marked $\frac{1}{4}$ S. on N. face; dug pits 18 x 18
x 12 ins. E & W. of post, 5 $\frac{1}{2}$ ft diam, and raised
a mound of earth 1 $\frac{1}{2}$ ft high 3 $\frac{1}{2}$ ft base,
around post. From which
A mesquite 8 ins. diam bears S. $46^{\circ}\frac{1}{2}'$ E 213 lks
diam. marked $\frac{1}{4}$ S. B. T.

No other trees within limits.

79.96 The cor to Secs 9. 10. 15 & 16.

Subdivisions, T. 17. R. 9 E - Continued

Chains

Land level. Good grass

Soil, 2^a rate

Timber, few mesquite.

North bet. Secs 9 & 10.

Var. $12^{\circ}55' E$.

Over level Mesa land.

- 3.00. Arroyo 15 lks wide. Course E.
- 10.50 Wood road to Lebere's ranch. Course N. $60^{\circ} W$ & S $60^{\circ} E$.
- 12.00 Wash 20 lks wide. Course E.
- 16.00. Road from Tucson to Warren's ^{place} ranch. Course E & W.
- 28.00 Arroyo 50 lks wide. Course E.
- 40.00 Got a Granite stone, $15 \times 8 \times 6$ ins. 10 ins. in the ground, for $\frac{1}{4}$ Sec. Cor., marked $\frac{1}{4}$ on W. face dug pits $18 \times 18 \times 12$ ins. N. & S of stone, $5\frac{1}{2}$ ft. dist, and raised a mound of earth $1\frac{1}{2}$ ft high.

Subdivisions, T. 17 S. R. 9 E. - Continued

Chains

3½ ft base, alongside. From which
 A mesquite 4 ins. diam. bears N. 68° E. 145 lbs
 dist. marked ¼ S. B. T.

A mesquite 6 ins. diam. bears N. 4° E. 193 lbs.
 dist. marked ¼ S. B. T.

68.00 Arroyo 50 lbs wide. Course E.

80.00 Set a Granite stone 12 x 10 x 6 ins 8 ins in
 the ground for Cor. to Secs. 3, 4, 9 & 10, marked
 with 5 notches on S. and 3 notches on E. edges;
 dug pits 18 x 18 x 12 ins. in each sec. 5½ ft
 dist. and raised a mound of earth 2 ft
 high, 4½ ft base, alongside. From which
 A mesquite 12 ins. diam. bears N. 81° W. 277 lbs.
 dist. marked T. 17 S. R. 9 E. S. 4 B. T.

A mesquite 14 ins. diam. bears N. 32° W. 259 lbs
 dist. marked T. 17 S. R. 9 E. S. 4 B. T.

✓ A mesquite 4 ins. diam. bears N. 59° E. 178 lbs

Subdivisions, T. 17 S. R. 9 E. - Continued

Cherino

dist. marked T. 17 S. R. 9 E. S. 3 B. T.

A mesquite 12 ins. diam bears N. 62° E. 206 lks.

dist. marked T. 17 S. R. 9 E. S. 3 B. T.

Land, level. Good grass.

Soil, 2^d rate.

Timber, scattering mesquite.

N 85° 40' E, on a random line bet Secs 3 & 10

Var. 12° 55' E.

Over level Mesa land.

40.00 Set temporary $\frac{1}{4}$ Sec. Cor.

74.00 Road from Tucson to Warren's upper ranch Course
N. E. & S. W.

80.03 Intersect N. & S. line at 11 lks N. of the cor.
to secs. 2, 3, 10 & 11. Thence I run

S 85° 45' W on a true line bet Secs 3 & 10

Subdivisions, T. 17 S. R. 9 E. - Continued

Chains

with same Var.

40.02 Set a post 3 ft long 3 ins. square with marked stone, 12 ins. in the ground, for $\frac{1}{4}$ Sec. Cor., marked $\frac{1}{4}$ S on N. face, dug pits 18 x 18 x 12 in E & W. of post, 5 $\frac{1}{2}$ ft dist, and raised a mound of earth 1 $\frac{1}{2}$ ft high 3 $\frac{1}{2}$ ft base, around post. From which

A mesquite 6 ins. diam. bears West 63 lks. dist. marked $\frac{1}{4}$ S. B. T.

A mesquite 6 ins. diam. bears N. $44\frac{1}{2}^{\circ}$ E. 115 lks. dist. marked $\frac{1}{4}$ S. B. T.

80.03. The cor to secs. 3, 4, 9 & 10.

Land level. Good grass.

Soil 2^d rate

Timber, scattering mesquite.

Subdivisions, T. 17 S. R. 9 E. - Continued

Chains.

North on a random line bet Secs 3 & 4.

Var. $12^{\circ}55'E$.

Over level Mesa land.

5.00 Arroyo 30 lks wide. Course E.

40.00 Set temporary $\frac{1}{4}$ Sec. Cor.

79.85 Intersect the N. boundary of Township at 15 lks. W. of the cor. to secs 3. 4. 33 & 34. which is a post previously established and described by me. Thence run

 $S. 0^{\circ}06' W$ on a true line bet secs 3 & 4 with same Var.39.85 Set a Granite stone $18 \times 8 \times 6$ ins 12 ins in the ground, for $\frac{1}{4}$ Sec. Cor, marked $\frac{1}{4}$ on W. face, dug pits $18 \times 18 \times 12$ ins. N & S of stone $5\frac{1}{2}$ ft diat, and raised a mound of earth $1\frac{1}{2}$ ft high $3\frac{1}{2}$ ft base, alongside. From which A mesquite 8 ins. diam. bears N $37^{\circ}E$. 45 lks dist.

Subdivisions, T. 17 S. R. 9 E. - Continued

Chains

marked $\frac{1}{4}$ S. B. T.A mesquite 4 ins. diam. bears N. 40° E. 96 lks.dist. marked $\frac{1}{4}$ S. B. T.

79.85 The cor. to secs. 3, 4, 9 & 10

Land level. Good grass.

Soil, 2^d rate

Timber, scattering mesquite.

October 22^d 1884.

✓ From the cor to Secs 4, 5, 32 & 33 on the S. boundary of the Township which is a Granite stone previously established and described by me, I run

North bet Secs 32 & 33.

Var. $12^{\circ} 55'$ E.

Over level. Meas. land.

40.00 Set a Granite stone 12 x 8 x 6 ins. 8 ins in the

Subdivision, T. 17 S. R. 9 E. - Continued

Chains

ground, for $\frac{1}{4}$ Sec. Cor. marked $\frac{1}{4}$ on W. face dug pits 18x18x12 ins. N & S of stone and raised a mound of earth $1\frac{1}{2}$ ft high $3\frac{1}{2}$ ft base alongside. From which

A mesquite 12 ins. diam. bears N. 27° E. 200 lks dist. marked $\frac{1}{4}$ S. B. T.

No other trees within limits

43.00 Arroyo 20 lks wide. Course NE.

70.00 Arroyo 30 lks wide. Course NE.

80.00 Set a Granite stone 16x10x8 ins. 11 ins in the ground, for Cor to Secs 28. 29. 32 & 33 marked with 1 notch on S and 4 notches on E. edges, dug pits 18x18x12 ins. in each sec. $5\frac{1}{2}$ ft dist. and raised a mound of earth 2 ft high $4\frac{1}{2}$ ft base, alongside

Land, level. Good grass.

Soil, 2^d rate.

Subdivisions T. 17 S. R. 9 E. - Continued

Chains

Timber, very few mesquite.

N 85° 40' E on a random line bet Secs 28 & 33.

Var. 12° 55' E

Over level Mesa land.

40.00 Set temporary $\frac{1}{4}$ Sec Cor.

46.00 Arroyo 2 chs wide. Course NE.

79.88 Intersect N. & S line at 5 lks N. of the cor-
to secs. 27. 28. 33 & 34. Trench from
S. 85° 42' W. on a true line bet Secs 28 & 33
with same Var.39.94. Set a post 3 ft long 3 ins. square with
marked stone 12 ins. in the ground for $\frac{1}{4}$ Sec
Cor. marked $\frac{1}{4}$ on N. face, dug pits 18 x
18 x 12 ins. E & W. of post, and raised a
mound of earth 1 $\frac{1}{2}$ ft high, 3 $\frac{1}{2}$ ft base, around

Subdivisions, Tp. 17 S. R. 9 E - Continued

Chains

post. From which

A mesquite 6 in. diam. bears East, 105 lks dist.
marked $\frac{1}{4}$ S. B. T.A mesquite 6 in. diam. bears N. 43° W. 63 lks
dist. marked $\frac{1}{4}$ S. B. T.

79.88 The cor to secs. 28. 29. 32 & 33.

Land level. Good grass

Soil, 2^d rate

Timber, some mesquite.

✓ North bet Secs 28 & 29.

Var. $12^{\circ} 55' E$.

Over level Msa land

33.00 Arroyo 30 lks wide. Course NE.

40.00 Set a Granite stone $13 \times 8 \times 4$ ins 9 in in
the ground, for $\frac{1}{4}$ sec. cor. marked $\frac{1}{4}$ on N. face.

Subdivisions, T. 17 S. R. 9 E. - Continued

Chains

dug pits $18 \times 18 \times 12$ ins N.W. S. of stone, $5\frac{1}{2}$ ft
dial, and raised a mound of earth $1\frac{1}{2}$ ft high
 $3\frac{1}{2}$ ft base, alongside. From which

A mesquite 10 ins. diam. bears N. 80° E. 3 chs.
dist. marked $\frac{1}{4}$ S. B. T.

A mesquite 4 ins. diam. bears S. 8° E. 205 lks.
dist. marked $\frac{1}{4}$ S. B. T.

55.50. Arroyo 50 lks. wide. Course NE.

76.00 Arroyo 40 lks wide. Course NE.

80.00. Set a Granite stone $16 \times 8 \times 6$ ins 11 ins in the
ground, for Cor to Secs 20-21-28 & 29, marked
with 2 notches on S. and 4 notches on E. edges;
dug pits $18 \times 18 \times 12$ ins, in each sec., $5\frac{1}{2}$ ft dial,
and raised a mound of earth 2 ft high,
 $4\frac{1}{2}$ ft base, alongside. From which

A palo verde 8 ins. diam. bears N. 23° W 215 lks.
dist. marked T. 17 S. R. 9 E. S. 20 B. T.

Subdivisions, T. 17 S. R. 9 E. - Continued

Chains

A palo verde 10 ins diam bears N. 16° W. 242 lks.
dist. marked T. 17 S. R. 9 E. S. 20 B. T.

A palo verde 5 ins. diam. bears S. 69° W. 94 lks. dist.
marked T. 17 S. R. 9 E. S. 29 B. T.

A palo verde 8 ins. diam. bears S 76° E 204 lks. dist.
marked T. 17 S. R. 9 E. S. 28 B. T.

Land level. Good grass

Soil, 2^d and 3^d rate

Timber, scattering mesquite and palo verde.

N $85^{\circ} 40'$ E. on a random line bet Secs 21 & 28

Var. $12^{\circ} 55'$ E.

Over level Mesa land.

4.50 Arroyo 50 lks wide. Course N. E.

40.00 Set temporary $\frac{1}{4}$ sec. cor.

48.00 Arroyo 60 lks wide. Course S 75° E.

Subdivisions, Tp 17 S. R. 9 E - continued

chains

- 66.00 Same arroyo 1 ch. wide. Course N. 60° E.
- 80.04 Intersect N. & S. line at 21 lks S. of the cor. to secs. 21, 22, 27 & 28. Thence I run S. 85° 31' W. on a true line bet Secs 21 & 28 with same Var.
- 40.02 Set a post 3 ft. long 3 ins. square with marked stone 12 ins. in the ground, for $\frac{1}{4}$ sec. cor. marked $\frac{1}{4}$ S. on N. face, dug pit 18 x 18 x 12 ins. E & W of post, 5 $\frac{1}{2}$ ft. dia., and raised a mound of earth 1 $\frac{1}{2}$ ft. high 3 $\frac{1}{2}$ ft. base, around post. From which
- A mesquite 6 ins. diam. bears N. 50° W 93 lks. dist. marked $\frac{1}{4}$ S. B. T.
- A mesquite 6 ins. diam. bears N. 5° E. 77 lks. dist. marked $\frac{1}{4}$ S. B. T.
- 80.04 The cor. to secs 20, 21, 28 & 29.
Land, level. Good grass.

Subdivisions, T17S. R. 9E. - continued

Chains

Soil, 2^d rate

Timber, scattering mesquite

North bet. Secs. 20 & 21

Var. $12^{\circ}55'E$.

Over level Mesa land

7.00 Arroyo 10 lks wide. Course NE.

22.00 Arroyo 30 lks wide. Course NE.

39.70 Old road.  Course N60°
E and S60°W.40.00 Set a post 3 ft long 3 ins. square with marked
stone, 12 ins. in the ground for $\frac{1}{4}$ sec. cor.
marked $\frac{1}{4}$ S. on W. face, dug pits 18 x 18 x 12
ins. N & S. of post, $5\frac{1}{2}$ ft dist, and raised
a mound of earth $1\frac{1}{2}$ ft high $3\frac{1}{2}$ ft base
around post. From which

Subdivisions, T₁₇ S. R. 9 E - Continued

Chains

A mesquite 8 ins. diam. bears N. 28° W 110 Mo
 dist. marked $\frac{1}{4}$ S. B. T.

A mesquite 4 ins. diam. bears N. 12° E 131 Mo
 dist. marked $\frac{1}{4}$ S. B. T.

80.00 Set a Granite stone 20 x 10 x 8 ins 15 ins in
 the ground, for cor. to secs 16, 17, 20 & 21,
 marked with 3 notches on S. and 4 notches on

E. edges, dug pits 18 x 18 x 12 ins. in each sec.
 5 $\frac{1}{2}$ ft. dist. and raised a mound of earth
 2 ft high 4 $\frac{1}{2}$ ft base, alongside. From which
 A mesquite 8 ins. diam. bears S. 22° E. 39 Mo
 dist. marked T₁₇ S. R. 9 E. S. 21 B. T.

A mesquite 12 ins. diam bears S. 48° E 103 Mo
 dist. marked T₁₇ S. R. 9 E. S. 21 B. T.

A mesquite 4 ins. diam bears S. 88° E. 90 Mo
 dist. marked T₁₇ S. R. 9 E. S. 21 B. T.

A mesquite 6 ins. diam. bears S. 19° W. 233 Mo

Subdivisions, T. 17 S. R. 9 E. - Continued

Chains.

dist. marked T. 17 S. R. 9 E. Sec. 20 B.T.

Land, level. Good grass

Soil, 2^d rate

Timber, scattering mesquite.

N 85° 40' E on a random line bet Secs 16 & 21

Var. 12° 55' E.

Over level Mesa land.

40.00 Set temporary $\frac{1}{4}$ Sec. Cor.

62.25 Old Road. — — — — — Course
N E & S W.

80.06 Intersect N & S line at 19 lks S. of the cor.

to secs. 15. 16. 21 & 22. Thence down

S. 85° 32' W. on a true line bet Secs 16 & 21
with same Var.

40.03. Set a post 3ft long 3 ins. square with marked

Subdivisions, T. 17 S. R. 9 E. - Continued

Chains

stone 12 ins in the ground for $\frac{1}{4}$ sec. cor. marked $\frac{1}{4}$ S. on N. face, dug pits 18 x 18 x 12 ins E and W. of post, 5 $\frac{1}{2}$ ft. dist. and raised a mound of earth 1 $\frac{1}{2}$ ft. high 3 $\frac{1}{2}$ ft. base, around post.

From which

A mesquite 8 ins. diam bears S. 43° W. 139 lks dist. marked $\frac{1}{4}$ S. B. T.

A mesquite 6 ins. diam bears S. 87° W. 228 lks dist. marked $\frac{1}{4}$ S. B. T.

80.06 The cor. to secs 16, 17, 20 & 21

Land level. Good grass

Soil, 2^d rate

Timber, scattering mesquite.

North bet Secs 16 & 17.

Var. 12° 55' E.

Subdivisions, T17 S. R. 9 E - Continued

Chains.

Over level Mesa land.

40.00 Set a Granite stone $14 \times 11 \times 4$ ins. 10 ins. in the ground, for $\frac{1}{4}$ Sec. Cor. marked $\frac{1}{4}$ on W face dug pits $18 \times 18 \times 12$ ins. N & S. of stone, $5\frac{1}{2}$ ft. dist, and raised a mound of earth $1\frac{1}{2}$ ft. high $3\frac{1}{2}$ ft. base, alongside. From which

A mesquite 10 ins. diam. bears S. 61° W. 130 lks. dist. marked $\frac{1}{4}$ S. B. T.

A mesquite 24 ins. diam. bears S 29° E 269 lks. dist. marked $\frac{1}{4}$ S. B. T.

57.80 Road from Warner's upper ranch to Tucson Course W and N 70° E.

59.50 Arroyo 15 lks wide. Course NE.

76.50 Arroyo 30 lks wide. Course NE.

80.00 Set a Granite stone $18 \times 12 \times 10$ ins 12 ins in the ground for Cor. to Secs. 8, 9, 16 & 17 marked with 4 matches on S. and E. edges; dug

Subdivisions, T. 17 S. R. 9 E. - Continued

Chains

pits 18 x 18 x 12 ins. in each sec. 5½ ft. dist. and raised a mound of earth 2 ft high 4½ ft. base alongside. From which

A palo verde 6 ins. diam. bears N. 14° E. 42 lks. dist. marked T. 17 S. R. 9 E. S. 19 B. T.

A mesquite 4 ins. diam. bears N. 24° E. 166 lks. dist. marked T. 17 S. R. 9 E. S. 19 B. T.

No other trees within limits.

Land, level. Good grass.

Soil, 2^d rate.

Timber, scattering mesquite and palo verde.

N 55° 40' E on a random line bet. Secs 9 & 16

Var. 12° 55' E.

Over level Mesa land.

5.00 Arroyo 20 lks wide. Course N. E.

Subdivisions, T17 S. R. 9 E. - Continued

Chains

34.00 Road from Warren's upper ranch to Tucson Courthouse
N. 70° E and S. 70° W.

40.00 Set temporary $\frac{1}{4}$ Sec. Cor.

80.11 Intersect N. & S. line at 14 lks N. of the cor.
to secs. 9, 10, 15 & 16. Thence I run
S. $85^{\circ} 46'$ W. on a true line bet secs. 9 & 16
with same Var.

40.06 Set a post 3 ft long 3 in square with marked
stone 12 in in the ground, for $\frac{1}{4}$ sec. cor.
marked $\frac{1}{4}$ S. on N. face, dug pits 18 x 18 x 12
in. E. & W. of post, $5\frac{1}{2}$ ft dist. and raise
a mound of earth $1\frac{1}{2}$ ft high $3\frac{1}{2}$ ft base
around post. From which

A mesquite 8 in diam bears N. 76° E 43 lks
dist. marked $\frac{1}{4}$ S. B. T.

A mesquite 8 in diam bears S. 8° W. 239 lks
dist. marked $\frac{1}{4}$ S. B. T.

Subdivisions, T. 17 S. R. 9 E. - Continued

Chains

80.11 The cor to secs 8, 9, 16 & 17.

Land level. Good grass.

Soil 2^d rate

Timber, scattering mesquite.

North bet Secs. 8 & 9.

Var. $12^{\circ} 55' E$.

Over level Mesa land.

12.50 Arroyo 20 lks wide. Course NE.

40.00 Set a Granite stone $12 \times 8 \times 6$ ins 8 ins in the ground, for $\frac{1}{4}$ Sec. Cor. marked $\frac{1}{4}$ on W. face dug pits $18 \times 18 \times 12$ ins. N & S of stone, $5\frac{1}{2}$ ft dist, and raised a mound of earth $1\frac{1}{2}$ ft high $3\frac{1}{2}$ ft. base, alongside. From which

A mesquite 8 ins. diam. bears N. 11° W. 86 lks. dist. marked $\frac{1}{4}$ S. B. T.

Subdivisions, T. 17 S. R. 9 E - Continued

Chains.

A mesquite 3 ins. diam. bears S. 7° W. 12.5 lks.
dist. marked $\frac{1}{4}$ S. B. T.

48.00 Arroyo 50 lks wide. Course N. 60° E.

52.00 Arroyo 20 lks wide. Course N. 60° E.

58.50 Wood road to Laberee's ranch. Course N. W. S. E.

80.00 Set a post 4 ft long 4 ins. square with
marked stone 12 ins in the ground, for cor.
to secs. 4, 5, 8 & 9. marked

T. 17 S. S. 4 on N. E.

R. 9 E S. 9 on S. E.

S. 8 on S. W. and

S. 5 on N. W. face, with 5 notches
on S. and 4 notches on E. edge, dug pits 18
 \times 18 \times 12 ins. in each sec. $5\frac{1}{2}$ ft dist. and
raised a mound of earth 2 ft high $4\frac{1}{2}$ ft
base, around post. From which

A mesquite 6 ins. diam. bears N. 33° W. 96 lks

Subdivision, T. 17 S. R. 9 E. - continued

Chains

dist. marked T. 17 S. R. 9 E. S. 5 B. T.

A mesquite 8 ins. diam. bears N. 80° E. 162 lks.

dist. marked T. 17 S. R. 9 E. S. 4 B. T.

A mesquite 4 ins. diam. bears N. 72° E. 194 lks.

dist. marked T. 17 S. R. 9 E. S. 4 B. T.

No other trees within limits.

Land, level. Good grass.

Soil 2^d rate.

Timber, scattering mesquite and palo verde.

N 85° 40' E, on a random line bet Secs 4 & 9.

Var. 12° 55' E.

Over level Mesa land.

40.00 Set temporary $\frac{1}{4}$ Sec. Cor.

60.00 Arroyo 30 lks wide. Course N 60° E.

67.50 Same Arroyo 30 lks wide Course S 80° E.

76.50 Same Arroyo 30 lks wide Course N 10° E.

Subdivisions, T. 17 S. R. 9 E. - Continued

Chains.

- 79.96 Intersect N. & S. line, at 17 lks S of the cor to secs 3, 4, 9 & 10. Thence I run S. $85^{\circ}32'$ W. on a true line bet Secs 4 & 9 with same Var.
- 39.98. Set a post 3 ft long 3 ins square with marked stone 12 ins. in the ground, for $\frac{1}{4}$ Sec. Cor. marked $\frac{1}{4}$ on N. face, dug pits 18 x 18 x 12 ins. E and W. of post 5 $\frac{1}{2}$ ft dist, and raised a mound of earth 1 $\frac{1}{2}$ ft high, 3 $\frac{1}{2}$ ft base around post. From which
 A mesquite 6 ins. diam. bears S. 80° W. 88 lks dist. marked $\frac{1}{4}$ S. B. T.
 A mesquite 8 ins. diam. bears S. 70° W. 136 lks dist. marked $\frac{1}{4}$ S. B. T.
- 79.96. The cor to secs 4, 5, 8 & 9.
 Land level. Good grass
 Soil, 2^d rate

Subdivisions, T. 17 S. R. 9 E - Continued

Chains

Timber, scattering mesquite & palo verde.

North on a random line bet Secs 4 & 5.

Var. $12^{\circ} 55' E$.

Over level Mesa land.

40.00 Set temporary $\frac{1}{4}$ Sec. Cor.

45.50 Arroyo 20 lks wide. Course N. $50^{\circ} E$

52.00 Arroyo 25 lks wide. Course N. $70^{\circ} E$.

75.50 Arroyo 30 lks wide. Course N. $80^{\circ} E$.

80.07 Intersect the North boundary of Township at 10 lks E. of the cor to secs 4.5. 32 & 33 which is a Granite stone previously established and described by me. Thence I run S. $0^{\circ} 04' E$. on a true line bet Secs 4 & 5 with same Var.

40.07 Set a Granite stone $12 \times 8 \times 6$ ins & vis.

Subdivisions T17 S. R. 9 E. - Continued

Chains.

- 67.00 Arroyo 25 lks wide. Course E.
 76.00 Arroyo 20 lks wide. Course N. 20° E.
 79.72 Arroyo 26 lks wide. Course N 70° E.
 80.00 Set a post 4 ft long 4 ins. square with marked
 stone 12 ins in the ground for cor to secs
 29. 30. 31 & 32 marked.

T. 17 S. S. 29 on NE.

R. 9 E. S. 32 on SE.

S. 31 on SW and

S. 30 on NW faces with 1 notch
 on S and 5 notches on E. edges, dug pits
 18x18x12 ins. in each sec. 5½ ft dist, and
 raised a mound of earth 2 ft. high 4½ ft
 base, around post.

Land, level. Good grass.

Soil, 2^d & 3^d rate.

Timber, scattering mesquite.

Subdivisions, Tp. 17 S. R. 9 E. - Continued

Chains

By observation taken this day I find the magnetic Variation to be $12^{\circ}55'E$.

$N85^{\circ}40'E$ on a random line bet Secs 29 & 32.

Var. $12^{\circ}55'E$.

Over level Mesa land.

2.00 Arroyo 30 lks wide. Course $N30^{\circ}E$.

10.00 Arroyo 20 lks wide. Course $N.30^{\circ}E$.

40.00 Set temporary $\frac{1}{4}$ Sec. Cor.

80.09 Intersect N & S line at 11 lks N. of the cor.

to secs. 28, 29, 32 & 33. Thence I run

$S.85^{\circ}45'W$ on a true line bet Secs 29 & 32 with same Var.

40.05 Set a Granite stone $12 \times 10 \times 10$ ins 8 ins. in the ground, for $\frac{1}{4}$ Sec. Cor. marked $\frac{1}{4}$ on N. face, dug pit $18 \times 18 \times 12$ ins. E & W. of stone

Subdivisions, Tp. 17 S. R. 9 E. - Continued

Chains

5½ ft dist, and raised a mound of earth
1½ ft high, 3½ ft base, alongside. From which
A mesquite 4 in. diam. bears S. 44° W 27 lks
dist. marked ¼ S. B. T.

A mesquite 4 in. diam. bears S. 46° W. 76 lks
dist. marked ¼ S. B. T.

80.09 The cov to secs 29. 30. 31 & 32.

Land, level. Good grass

Soil, 2^d & 3^d rate.

Timber, scattering mesquite.

✓ 55° 40' W on a random line bet Secs 30 & 31

Var. 12° 55' E.

Over level Mesa land.

30.00 Arroyo 30 lks wide. Course S. 30° E.

39.70 Arroyo 20 lks wide. Course S 60° E.

Subdivisions, T17 S. R. 9 E. — Continued

Chains

40.00 Set temporary $\frac{1}{4}$ Sec. Cor.

78.00 Arroyo 30 lks wide. Course S W.

120.24 Intersect West boundary of Township at 21 lks.

N. of the cor to secs. 25. 30. 31 & 36 where I found a post 3 ft long 2 ins square, with Bearing Trees, but no pits. I therefore reset the post with marked stone, 12 ins in the ground, for cor to Secs 25. 30. 31 & 36 marked.

T 17 S S. 30 on NE.

R 9 E. S. 31 on SE.

R 8 E. S. 25 on SW and

S. 36 on NW face, with 1 notch on S and 5 notches on N edges; dug pits 18x18x12 ins. in each sec. 5 $\frac{1}{2}$ ft dist. and raised a mound of earth 2 ft high, 4 $\frac{1}{2}$ ft base around post. From which

A mesquite 12 ins. diam. bears N. 88° E. 41 lks.

Subdivisions. T. 17 S. R. 9 E. - Continued

Chairs.

dist. marked T. 17 S. R. 9 E. S. 30 B.T.

A mesquite 4 ins. diam. bears S. 43° E. 56 lks dist.
marked T. 17 S. R. 9 E. S. 31 B.T.

A mesquite 8 ins. diam. bears S. 38° W. 164 lks
dist. marked T. 17 S. R. 8 E. S. 36 B.T.

A mesquite 6 ins. diam. bears N. 78° W. 50 lks
dist. marked T. 17 S. R. 8 E. S. 25 B.T.

Thence I run N. 85° 34' E on a true line
bet Secs 30 & 31 with same Var.

80-24 Set a post 3 ft long 3 ins. square with
marked stone 12 ins in the ground for
¼ Sec. Cor., marked ¼ on N face, dug pits
18 x 18 x 12 ins. E & W. of post, ^{5½ ft dist.} and raised
a mound of earth 1½ ft high 3½ ft base
around post. From which

A mesquite 12 ins. diam. bears N. 6° W. 70 lks
dist. marked ¼ S. B.T.

Subdivisions, T. 17 S. R. 9 E. - Continued

chains

A mesquite 8 ins. diam. bears N. 80° E 93 lks dist
marked $\frac{1}{4}$ S. B. T.

120.24 The cor to Secs 29, 30, 31 & 32.

Land, level. Good grass.

Soil, 2^d & 3^d rate.

Timber, scattering mesquite.

North bet Secs 29 & 30.

Var. 12° 55' E.

Over level Mesa land.

17.50 Arroyo 15 lks wide. Course NE.

39.00 Arroyo 20 lks wide. Course NE.

40.00 Set a post 3 ft long 3 ins. square with
marked stone 12 ins in the ground for $\frac{1}{4}$
Sec. Cor. marked $\frac{1}{4}$ on W. face, dug pits
18 x 18 x 12 ins. N & S. of post, 5 $\frac{1}{2}$ ft dist.

Subdivisions, T. 17 S. R. 9 E. - Continued

Chains.

and raised a mound of earth $1\frac{1}{2}$ ft high
 $3\frac{1}{2}$ ft base, around post. From which
 A mesquite 6 in. diam. bears S. 57° E. 82 lks
 dist. marked $\frac{1}{4}$ S. B. T.

A mesquite 4 in. diam. bears S 56° E 132 lks
 dist. marked $\frac{1}{4}$ S. B. T.

49.00 Arroyo 20 lks wide, Course NE.

70.00 Arroyo 30 lks wide, Course NE.

80.00 Set a post 4 ft long 4 in. square with
 marked stone 12 in. in the ground for
 cor. to sec. 19. 20. 29 & 30. marked

T. 17 S S. 20 on NE.

R. 9 E. S. 29 on SE

S. 30 on SW. and

S. 19 on NW face with 2 notches
 on S and 5 notches on E edge, dug pits
 $18 \times 18 \times 12$ in. in each sec. $5\frac{1}{2}$ ft. dist. and

Subdivisions, T. 17 S. R. 9 E. - Continued

chains

raised a mound of earth 2 ft high, 4 1/2 ft base,
around post. From which

A mesquite 5 ins. diam. bears N. 74° W 164 lks
dist. marked T. 17 S. R. 9 E. S. 19 B. T.

A mesquite 6 ins. diam. bears S. 73° W. 150 lks
dist. marked T. 17 S. R. 9 E. S. 30 B. T.

A mesquite 6 ins. diam. bears S. 37° E 169 lks
dist. marked T. 17 S. R. 9 E. S. 29 B. T.

A mesquite 6 ins. diam. bears N. 55° E 40 lks
dist. marked T. 17 S. R. 9 E. S. 20 B. T.

Land, level. Good grass.

Soil, 2^d and 3^d rate.

Timber, scattering mesquite.

N 85° 40' E on a random line bet Secs 20 & 29.

Var. 12° 55' E.

Subdivisions, T. 17 S. R. 9 E. - Continued

Chains

Over level Mesa land.

35.00 Arroyo 20 lks wide. Course N. 60° E.

40.00 Set temporary $\frac{1}{4}$ Sec. Cor.

79.92 Intersect N & S line at 16 lks S. of the cor to Secs 20. 21. 28 & 29. Thence I run S. 85° 51' W. on a true line bet Sec 20 & 29 with same Var.

39.96. Set a post 3 ft long 3 ins square with marked stone 12 ins. in the ground for $\frac{1}{4}$ Sec Cor. marked $\frac{1}{4}$ on N face, dug pits 18 x 18 x 12 ins. E & W of post, and raised a mound of earth 1 $\frac{1}{2}$ ft high 3 $\frac{1}{2}$ ft base, around post. From which a mesquite 14 ins. diam. bears N. 20° E 112 lks dist. marked $\frac{1}{4}$ S. B. T.A mesquite 6 ins. diam bears North 98 lks dist. marked $\frac{1}{4}$ S. B. T.

79.92 The cor. to secs 19. 20. 29 & 30.

Subdivisions, T. 17 S. R. 9 E. - Continued

Chains

Land, level. Good grass.

Soil, 2^d & 3^d rate.

Timber, scattering mesquite

S. 55° 40' W. on a random line bet Secs 19 & 30

Var. 12° 55' E.

Over level Mesa land.

40.00 Set temporary $\frac{1}{4}$ Sec. Cor.119.70 Intersect W. boundary of Township at 37 lbs
S. of the cor. to secs 19, 24, 25 & 30. where I found
a post 1 $\frac{1}{2}$ ins. square firmly set in the ground
marked

T S. 19 on N.E.

R. 9 E. S. 30 on S.E.

R. 8 E. S. 25 on S.W. and

S. 24 on N.W. face with 2 notches on

Subdivisions, T. 17 S. R. 9 E - Continued

Chains.

S. and 4 notches on N. edge. with pits 18x18
x12 ins. in each sec. $5\frac{1}{2}$ ft dist. and mound
of earth 2 ft high $4\frac{1}{2}$ ft base around post,
but no bearing trees marked although 2
good trees are within limits

Thence from

N $85^{\circ} 51' E$. on a true line bet secs 19 & 30
with same Van.

79. 70. Set a post 3 ft long 3 ins square with
marked stone 12 ins in the ground for
 $\frac{1}{4}$ Sec. Cor. marked $\frac{1}{4}$ S on N. face, dug
pits 18x18x12 ins. E & W. of post, and raised
a mound of earth $1\frac{1}{2}$ ft high $3\frac{1}{2}$ ft base
around post. From which

A palo verde 8 ins diam. bears N. $12^{\circ} W$. 176 Me
dist. marked $\frac{1}{4}$ S. B. T.

A palo verde 8 ins. diam. bears N. $26^{\circ} E$. 175 Me

Subdivisions, T. 17 E. R. 9 E. - Continued

Chains

dist. marked $\frac{1}{4}$ S. B. T.

119.70 The cor to secs 19. 20. 29 & 30.

Land, level. Good grass.

Soil, 2^d and 3^d rate.

Timber, scattering mesquite and palo verde.

North bet. Secs 19 & 20.

Var. 12° 55' E.

Over level ground.

5.00 Arroyo 20 lks wide. Course NE.

27.00 Arroyo 25 lks wide Course NE.

40.00 Set a post 3 ft long 3 ins. square with
 marked stone 12 ins in the ground for $\frac{1}{4}$ Sec
 Cor. marked $\frac{1}{4}$ on W. face, dug pits 18 x 18
 x 12 ins. N & S. of post, 5 $\frac{1}{2}$ ft dist. and
 raised a mound of earth 1 $\frac{1}{2}$ ft high 3 $\frac{1}{2}$ ft

Subdivisions, T. 17 S. R. 9 E. - Continued

chains.

base around post. From which
 A mesquite 8 ins. diam. bears N. 40° W. 127

lks. dist. marked $\frac{1}{4}$ S. B. T.

A mesquite 6 ins. diam. bears N. 68° W. 80

lks. dist. marked $\frac{1}{4}$ S. B. T.

47.00. Arroyo 30 lks wide. Course NE.

80.00. Set a post 4 ft long $\frac{1}{4}$ ins. square with
 marked stone 12 ins in the ground for
 cor to secs 17. 18. 19 & 20. marked

T. 17 S. S. 17 on NE.

R. 9 E. S. 20 on SE

S. 19 on SW and

S. 18 on NW. face, with 3 notches
 on S and 5 notches on E edge, dug pits
 18 x 18 x 12 ins. in each sec. $5\frac{1}{2}$ ft. dist.
 and raised a mound of earth 2 ft high
 $4\frac{1}{2}$ ft base, around post.

Subdivisions. T. 17 S. R. 9 E. - continued

Chains.

Land, level. Good grass.

Soil, 2^d and 3^d rate.Timber, scattering mesquite first 60 chs, last
20 chs. none.October 24th 1886 -

N 86° 40' E, on a random line bet Secs 17 & 20

Var. 12° 50' E.

Over level Mesa land.

40.00 Set temporary $\frac{1}{4}$ Sec. Cor.

80.11 Intersect N. & S. line at 8 lks N. of the cor.

to Secs 16-17. 20 & 21. Thence I run

S. 85° 44' W. on a true line bet Secs 17 & 20
with same Var.40.06 Set a post 3 ft long 3 ins. square with marked
stone, 12 ins. in the ground for $\frac{1}{4}$ Sec. Cor
marked $\frac{1}{4}$ S. on N. face, dug pits 18 x 18 x 12

Subdivisions, T. 17 S. R. 9 E. Continued

Chains

ins. E. & W. of post, $5\frac{1}{2}$ ft. dist. and raised
a mound of earth $1\frac{1}{2}$ ft high $3\frac{1}{2}$ ft base
around post. From which

A mesquite 12 ins. diam. bears N. 45° W 34 lks
dist. marked $\frac{1}{4}$ S. B. T.

A mesquite 4 ins. diam. bears N. 15° W 98 lks
dist. marked $\frac{1}{4}$ S. B. T.

80.11 The cor to secs 17, 18, 19 & 20
Land, level. Good grass.
Soil 2^d & 3^d rate
Timber, scattering mesquites.

$S85^{\circ}40'W$, on a random line bet Secs 18 & 19.

Var. $12^{\circ}55'E$.

Over level Mesa land.

40.00 Set temporary $\frac{1}{4}$ Sec Cor.

Subdivisions, T. 17 S. R. 9 E. - Continued

Chains

109.00 Arroyo 15 lks wide, Course NE.

119.00 Intersect W. boundary of Township 16 lks N. of the cor to secs. 13, 18, 19 & 24. where I found a palo verde stake 2 ins. square 32 ins above ground marked

T. 17 S. 18 on NE.

R. 9 S. 19 on SE.

R. 8. S. 24 on SW and

S. 13 on NW face, with 3 notches on N & S. edges, with pits 18x18x12 ins in each sec. 5½ ft. diam. and mound of earth 2 ft high 3½ ft base around post, but no B. T. marked although plenty of mesquite are within distance. Thence I run N. 85° 35' E. on a true line bet Secs 18 & 19 with same Var.

79.00 Set a post 3 ft long 3 ins square with marked

Subdivisions, T. 17 S. R. 9 E - Continued

Chains

stone 12 ins in the ground for $\frac{1}{4}$ Sec. Cor.
 marked $\frac{1}{4}$ S. on N. face, dug pits 18x
 18x12 ins. E & W. of post, $5\frac{1}{2}$ ft dist.
 and raised a mound of earth $1\frac{1}{2}$ ft high
 $3\frac{1}{2}$ ft base around post. From which
 A mesquite 8 ins diam bears S. 53° E.

151 lks dist. marked $\frac{1}{4}$ S. B. T.

No other trees within limits.

119.00 The cor. to Secs 17, 18, 19, & 20

Land level. Good grass

Soil, 2^d & 3^d rate.

Timber, scattering mesquite.

North bet. Secs 17 & 18

Var. $12^{\circ}55'$ E

Over level Mesa land.

Subdivisions. T. 17 S. R. 9 E. continued

Chains

40.00

Set a post 3 ft long 3 ins diam. with marked stone 12 ins in the ground for $\frac{1}{4}$ Sec Cor. marked $\frac{1}{4}$ S. on W. face, dug pits $18 \times 18 \times 12$ ins. N & S. of post, ^{5 $\frac{1}{2}$ ft diam} and raised a mound of earth $1\frac{1}{2}$ ft high $3\frac{1}{2}$ ft base around post.

43.00

Road from Warren's upper ranch to Tucson Course. N. 60° E & S. 60° W.

79.00

Old dirt road. Course NW & SE.

80.00

Set a Granite stone, $20 \times 12 \times 8$ ins. 15 ins in the ground for Cor to Secs 7-8-17 & 18 marked with 4 notches on S and 5 notches on E. edges; dug pits $18 \times 18 \times 12$ ins. in each sec. $5\frac{1}{2}$ ft diam. and raised a mound of earth 2 ft high $4\frac{1}{2}$ ft base alongside. From which

A mesquite, 8 ins. diam. bears S. 72° W 312 lks dist, marked T. 17 S. R. 9 E. S. 18 B. T.

A mesquite 10 ins. diam. bears S. 38° W 194 lks.

Subdivisions, T. 17 S. R. 9 E. - Continued

Chains

dist. marked T. 17 S. R. 9 E. S. 18 B.T.

A mesquite 8 ins. diam. bears N. 32° E 256 lks

dist. marked T. 17 S. R. 9 E. S. 8 B.T.

No other trees within limits.

Land, level. Good grass.

Soil, 2^d & 3^d rate.

Timber, on N. boundary scattering mesquite.

N $35^{\circ} 40'$ E on a random line bet Secs 8 & 17.

Var. $12^{\circ} 55'$ E.

Over level Mesa land.

37.00 Arroyo 15 lks wide. Course NE.

40.00 Set temporary $\frac{1}{4}$ Sec. cor.

79.93 Intersect N & S. line at 4 lks N. of the cor.
to secs 8-9-16 & 17. Thence run

S. $85^{\circ} 42'$ W. on a true line bet Secs 8 & 17

Subdivisions, T. 17 S. R. 9 E. - Continued

Chains

with same Var.

39.97 Set a post 3 ft long 3 ins. square with marked stone 12 ins in the ground for $\frac{1}{4}$ Sec. Cor. marked $\frac{1}{4}$ S. on N. face. dug pits 18 X 18 X 12 ins E & W of post, and ^{5 $\frac{1}{2}$ ft dirt.} raised a mound of earth 1 $\frac{1}{2}$ ft high, 3 $\frac{1}{2}$ ft base, around post. From which a palo verde 6 ins. diam bears S. 43° W. 93 lks dist. marked $\frac{1}{4}$ S. B. T.

A mesquite 6 ins diam. bears N. 47° W. 94 lks dist. marked $\frac{1}{4}$ S. B. T.

79.93 The cor. to sec. 7. 8. 17 & 18

Land, level. Good grass.

Soil, 2^d and 3^d rate.

Timber, scattering mesquite and palo verde.

Subdivisions, T. 17 S. R. 9 E. - Continued

Chain

S85°40'W on a random line bet Secs 7 & 18

Var 12°55' E.

Over level Mesa land.

- 0.75 Old dirt road. Course NW & SE.
 40.00 Set temporary $\frac{1}{4}$ Sec. Cor.
 49.50 Arroyo 30 lbs wide. Course NE.
 119.43 Intersect W. boundary of Township at 23 lbs
 N. of the cor. to Secs 7, 12, 13 & 18 where I
 found a post firmly set in the ground
 marked

T. 17 S. S. 6 on NE.

R. 9 E. S. 18 on SE.

R. 8 E. S. 13 on SW and

S. 12 on NW face, with 2 notches
 on S and 4 notches on N edges, with pits
 18 x 18 x 12 ins. in each sec. 5½ ft dist. and
 mound of earth 2 ft high 4½ ft base round

Subdivisions, T. 17 S. R. 9 E. - Continued.

Chains

post. Thence from

N. $85^{\circ} 33'$ E. on a true line bet Secs. 7 & 18
with same \overline{VW} .

79.43 Set a Granite stone, $14 \times 8 \times 8$ ins 10 ins. in
the ground for $\frac{1}{4}$ Sec. Cor. marked $\frac{1}{4}$ on N.
face, dug pits $18 \times 18 \times 12$ ins. E & W. of stone
and raised a mound of earth $1\frac{1}{2}$ ft high $3\frac{1}{2}$ ft
base along side. From which

A mesquite 6 ins. diam bears N. 86° W. 230 lbs
dist. marked $\frac{1}{4}$ S. B. T.

A mesquite 8 ins. diam bears S. 45° E. 243 lbs
dist. marked $\frac{1}{4}$ S. B. T.

119.43 The cor to secs. 7-8-17 & 18

Land, level. Good grass.

Soil, 2^d & 3^d rate

Timber, scattering mesquite.

Subdivisions, T. 17 S. R. 9 E. - Continued

Chains

North bet Secs 7 & 8.

Var. $12^{\circ} 55' E$.

Over level Mesa land.

29.00 Arroyo 50 lks wide. Course NE.

38.00 Arroyo 30 lks wide. Course NE.

40.00 Set a Granite stone $15 \times 12 \times 12$ ins 10 ins
in the ground for $\frac{1}{4}$ Sec. Cor. marked $\frac{1}{4}$ on
N. face, and raised a mound of stone, $1\frac{1}{2}$ ft
high $3\frac{1}{2}$ ft base, alongside, pits impracticable.
From which

A mesquite 6 ins. diam. bears N. $47^{\circ} E$ 56 lks
dist. marked $\frac{1}{4}$ S. B. T.

A mesquite 6 ins. diam. bears S. $44^{\circ} W$. 56 lks
dist. marked $\frac{1}{4}$ S. B. T.

47.00 Arroyo 20 lks wide. Course NE.

58.00 Arroyo 18 lks wide. Course NE.

73.00 Arroyo 25 lks wide. Course NE.

Subdivision, T. 17 S. R. 9 E. - Continued

chains

80.00 Set a Granite stone 23 x 12 x 10 in 18 in in the ground for cor to secs 5-6-7 & 8. marked with 5 notches on S and E. edges, dug pits 18 x 18 x 12 in. in each sec. 5 1/2 ft dist, and raised a mound of earth 2 ft high 4 1/2 ft base, alongside. Land, level. Good grass. Soil, 2^d & 3^d rate. Timber, scattering mesquite.

N85.40°E. on a random line bet Secs 5 & 8.

Var. 12°55'E.

Over level Mesa land.

23.00 Arroyo 30 ft wide. Course NE.

40.00 Set temporary 1/4 Sec. Cor.

45.00 Wood-road to Laberee's ranch. Course NW. SE.

80.10 Intersect N & S. line at 9 ft S. of the cor.

Subdivisions, T. 17 S. R. 9 E. - Continued

Chains

to Secs. 4, 5, 8 & 9. Thence I run
S. $85^{\circ}36'$ W. on a true line bet Secs 5 & 8
with same Var.

40.05 Set a post 3 ft. long 3 ins. square with
marked stone 12 ins in the ground for $\frac{1}{4}$ Sec.
Cor. marked $\frac{1}{2}$ on N. face; dug pits 18 x 18
x 12 ins. E & W. of post and raised a
mound of earth $1\frac{1}{2}$ ft high $3\frac{1}{2}$ ft base around
post. From which

A mesquite 12 ins. diam bears N 44° E. 247 lbs.
dist. marked $\frac{1}{4}$ S. B. T.

A mesquite 10 ins. diam bears N. 26° E 85 lbs.
dist. marked $\frac{1}{4}$ S. B. T.

80.10 The cor to secs 5, 6, 7 & 8

Land level. Good grass

Soil 2^d & 3^d rate

Timber, some mesquite and palo verde.

Subdivisions, T. 17 S. R. 9 E. - Continued

Chains

885°40' W on a random line bet Secs 6 & 7.
Var. 12°55' E.

✓ Over level Mesa land.

19.00 Arroyo 20 lks wide. Course S E.

25.00 Same Arroyo 20 lks wide. Course N E.

28.00 Same Arroyo 20 lks wide. Course S E.

32.00 Same Arroyo 20 lks wide. Course N E.

36.00 Same Arroyo 20 lks wide. Course S E.

40.00 Set temporary $\frac{1}{4}$ Sec. Cor.

50.00 Same Arroyo 20 lks wide. Course N 60° E.

118.62. Intersect W. boundary of Township at 19 lks
N. of the cor. to secs. 1, 6, 7 & 12 which is a
post firmly set in the ground, marked
T. 16. R. 9 E. S. 6 on N E.

S. 7 on S E.

T. 17 S. 12 on S W. and

R. 7 S. 1 on N W. face with 1 notch

Subdivisions, T. 17 S. R. 9 E. - Continued

Chains.

on N. and 5 notches on S. edges, with pits
 18x18x12 ins. in each sec. $5\frac{1}{2}$ ft dist. and
 mound of earth 2 ft high $4\frac{1}{2}$ ft base,
 around post. Thence I run
 N. $85^{\circ} 34'$ E. on a true line bet Secs 6 & 7
 with same Var.

78.62. Set a post 3 ft long 3 ins. square with marked
 stone 12 ins. in the ground for $\frac{1}{4}$ Sec. Cor.
 marked $\frac{1}{4}$ on N. face. dug pits 18x18x12
 ins. E & W. of post, ^{$5\frac{1}{2}$ ft dist.} and raised a mound
 of earth $1\frac{1}{2}$ ft high, $3\frac{1}{2}$ ft base around post.
 From which

A mesquite 6 ins. diam. bears S. 87° E $105\frac{1}{2}$
 dist. marked $\frac{1}{4}$ S. B. T.

A mesquite 4 ins. diam. bears N. 23° E $117\frac{1}{2}$
 dist. marked $\frac{1}{4}$ S. B. T.

118.62. The cor to sec. 5-6-7 & 8.

Subdivision, T. 17 S. R. 9 E. — Continued

Chains

Land, level. Good grass
 Soil, 2^d & 3^d rate.
 Timber, a few mesquite.

North on a random line bet Secs 5 & 6.

Var. $12^{\circ}55'E$.

Over level Mesa land.

22.75 Arroyo 18 fms wide. Course N. $60^{\circ}E$.

24.00 Wood road to Laberee's ranch. Course NW & SE

40.00 Set temporary $\frac{1}{4}$ Sec. Cor.

60.00 Arroyo 30 fms wide. Course NE.

79.78 Intersect N. boundary of Township at 19 fms
 W. of the cor to secs 5 & 6. 31 & 32, which is a
 Granite stone previously established and
 described by me. Thence I run

S. $0^{\circ}08'W$ on a true line bet Secs 5 & 6

Subdivisions, T. 17 S. R. 9 E. Continued

Chains

with same Var.

39.78. Set a Granite stone $14 \times 10 \times 10$ ins 10 ins in the ground for $\frac{1}{4}$ Sec. Cor. marked $\frac{1}{4}$ on W. face; dug pits $18 \times 18 \times 12$ ins N. & S. of stone, $5\frac{1}{2}$ ft. dist, and raised a mound of earth, $1\frac{1}{2}$ ft. high, $3\frac{1}{2}$ ft. base, alongside. From which

A mesquite, 4 ins. diam. bears N. 13° E. 60 the dist. marked $\frac{1}{4}$ S. B. T.

A mesquite 6 ins. diam. bears N. 88° W. 266 the dist. marked $\frac{1}{4}$ S. B. T.

79.78 The cor to secs. 5, 6, 7, & 8

Land, level. Good grass

Soil, 2^d & 3^d rate

Timber, scattering mesquite

October 25th 1886.

Subdivisions, T. 17 S. R. 9 E. - Continued.

chains

General Description

Through Secs. 2, 11, 14, 23, 26 & 35 there is a fine belt of first class land.

In Secs. 2, 11, 14 & 23, C. H. Warren, and other parties, have under fence about 1000 acres. Warren's ranch house, outbuildings and corrals are in Secs. 14 & 2.

A well was sunk to a depth of 180 ft and an abundant supply of water obtained which is raised by steam power.

The land in the balance of the Township may be classed as 2^d & 3^d rate, but without irrigation this land is of no use for any purpose. The whole Township is covered by a growth of nutritious grasses. The timber consists of mesquite and palo verde.

George Proskruge
U. S. Deputy Sur^r.

For final oaths see book no. 15.

BOOK 841

OFFICE U. S. Surveyor General,Tucson, Arizona,March 27th. 1888.

The foregoing Field Notes of the surveys of the Subdivision Lines of Township **17** South, Range **9** East, of the Gila and Salt River Base and Meridian Arizona, executed by George J. Roskrutz, U. S. Deputy Surveyor, under his contract of the 5th. day of March 1886, having been critically examined and the necessary corrections and explanations made, the said Field Notes and the surveys they describe are hereby approved.

John Aise
U. S. Surveyor General.