

BOOK 887

No 8

No. 887

BOOK 887

Field Notes

OF THE SURVEY OF THE

BOOK 887

SUBDIVISION LINES

— OF — No. 887

Township 18 S. Range 9 E

Gila and Salt River Base and Meridian

ARIZONA.

By *George J. Roskruged.* S.

under contract dated *Mar. 5, 1886.*

Survey commenced *Sept. 28 1886.*

Survey completed *Oct. 3, 1886.*

887

Field Notes No. 887
 of the
 Survey of Sub-division lines.

of
 Township No. 18 S. Range 9 E.

of the
 Gila and Salt River Meridians
 of Arizona Territory.

As surveyed by

George J. Roskrugs.

U. S. Deputy Surveyor.

under his Contract No. 1

Dated March 5th 1886.

Survey commenced Sept. 28th 1886
 Survey completed October 3rd 1886.

1A

BOOK 887

Township 18 South R. 9 East.

6	98	5	70	4	54	3	36	2	19	1
96	94			69		53		35		18
7	93	8	68	9	51	10	33	11	16	12
91	89			67		50		32		14
18	87	17	65	16	48	15	30	14	12	13
85	84			64		47		29		11
19	83	20	62	21	45	22	27	23	9	24
81	80			61		44		26		7
30	78	29	60	28	42	27	25	26	6	25
76	75			59		41		23		4
31	73	32	57	33	39	34	22	35	2	36

For preliminary oaths
See Book No. 1.

15
Township N. 18. S. Range N. 9, East of S. R. Meridian.

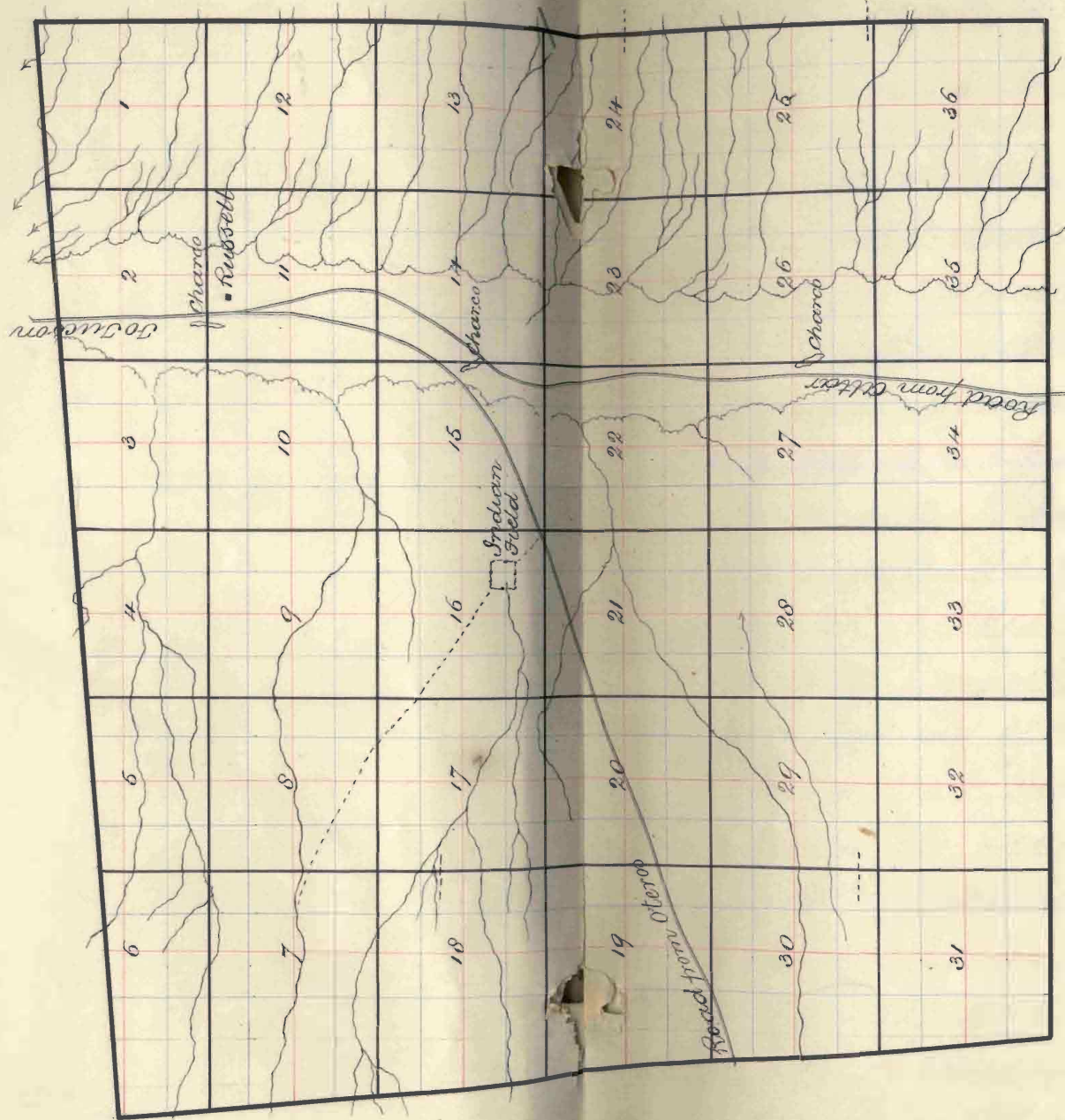

Subdivision No. 18 S R 9 E.

Wiley and Salt River Meridian.

Before commencing the Survey of the Subdivision lines of this Township I take an observation, using a Young & Sons Solar Transit, and find the magnetic variation to be $12^{\circ} 48' E$.

I ran N on a blank line on the E. boundary of Sec. 36, and at 40 chs. I found the $\frac{1}{4}$ Sec. Cor. and at 80 chs. found the Sec. Cor. I then ran $S 89^{\circ} 35' W$ on a blank line on the S. boundary of Sec. 36 and at 40 chs. found the $\frac{1}{4}$ Sec. Cor. and at 80.00 chs. found the Sec. Cor. My compass will therefore run the same lines as the superior boundaries and the chaining practically agrees.

Survey commenced Sept^r 28th 1886.

I commenced at the Cont^r Sec. 1. 2. 35 & 36,

Subdivision Tps. 18 SR & E.

Continued.

Chains

on the South boundary of township
which is a granite stone 15x12x10 ins.
firmly set in the ground with 1 notch
on the E and 5 notches on the W. Wedges
and mound of stone alongside.

Thence I run

North bet. Secs. 35 & 36.

"Var. $12^{\circ} 48' E$

Over rolling land.

13.50 Wash 15 lks. wide course N.W.

26.00 " 18 lks. " " N.W.

40.00 Set a granite stone 18x12x10 ins. 12 ins.
in the ground for $\frac{1}{4}$ Sec. Cor. marked $\frac{1}{4}$
on W. face and raised a mound of
stone $1\frac{1}{2}$ ft. high $3\frac{1}{2}$ ft. base alongside.
"It's impracticable" from which
A meridian 4 mi. diam. brs. N. $87^{\circ} E$. 130 lks. dist.
marked $\frac{1}{4}$ S. 13. T.

Subdivision Sp. 18 SR 9 E.

Continued.

Chains,	No other trees within limits.
48.00	Wash 20 lks. wide, course N 70° W.
63.00	" 18 lks. " " N 80° W.
48.00	" 20 lks. " " N. W.
80.00	Set a granite stone 20 x 12 x 10 ins. 15 ins. in the ground for cor. to Secs 25, 26, 35 x 36, marked with 1 notch on S & E edges, dug pits 18 x 18 x 12 ins. in each Sec. 5 ft. dist. and raised a mound of earth 2 ft. high 4 ft. base alongside, from which A mesquite 10 ins. diam. br. S 2° E. 168 lks. dist. marked S 18 S R 9 E S. 36. B. D. A mesquite 6 ins. diam. br. N 48° E. 134 lks. dist. marked S 18 S R 9 E S 25 B. J. A mesquite 4 ins. diam. br. N 70° W. 115 lks. dist. marked S 18 S R 9 E. S 26 B. J. A mesquite 4 ins. diam. br. N 30° W. 160 lks. dist. marked S 18 S R 9 E S 26 B. J.

Subdivision Op. S. R. G. E.

Continued.

Chains.

Land rolling

Soil 3rd & 4th rate good grass
Timber, scattering Mesquite.

 Part on a random line bet. Secs. 25 & 36
 Yaw. $12^{\circ} 48' E$.

Over rolling land.

40.00 bet temporary 1/4 Sec. Cor.

49.00 Wash 30 lks. wide, course N.W.

 80.24 Intersect E 1/4 of T₄ at 21 lks. S of the
 Cor. to Secs. 25, 30, 31 & 36, which is
 a volcanic stone 20 x 14 x 6 ins. firmly
 set in the ground with 1 notch on the
 S, and 5 notches on the N, edges, with
 pits 18 x 18 x 12 ins. in each Sec. 5 1/2 ft. dia.
 and mound of earth 2 ft. high 4 1/2 ft. base,
 alongside, from which

Subdivision Op., 185 R 9 E.

Continued.

Gains

A mesquite 10 ins. diam. bro. S 10° W. 12 lbs. diet.
 Marked 1/8 S R 19 E. S 36 B. J.

A mesquite 10 ins. diam. bro. S 19° W. 37 lbs. diet.
 Marked 1/8 S R 19 E. S 36 B. J.

Thence Run

S. 89° 57' W. on a true line bet. Secs. 25 & 36
 with same cat.

40. 12 Set a volcanic stone 15 x 12 x 6 ins. 10 ins. in
 the ground for 1/4 Sec. Cor. marked 1/4 on
 N face, dug pits 18 x 18 x 12 ins. E & W of
 stone 5 1/2 ft. diet. and raised a mound
 of earth 1 1/2 ft. high 3 ft. base alongside,
 from which

A mesquite 10 ins. diam. bro. N. 40° W. 1/8 lbs. diet.
 Marked 1/4 S. B. J.

A mesquite 8 ins. diam. bro. S 38° W. 5 1/2 lbs. diet.
 Marked 1/4 S. B. J.

80. 24 The bear, to Secs. 25, 26, 35 & 36.

Subdivision Sp. 18 SR of E.

Continued.

Chains,

Land rolling.

Soil 3^d & 4th rate good grass

Timber Scattering Mesquite.

North lot, Recs. 25 & 26

Var. 12° 48' E.

Over rolling land

2.00 Wash 15 lks. wide course W.

4.00 " 18 " " " W.

34.00 " 20 " " " W.

40.00 Bet a volcanic stone 36 x 24 x 24 ins.
 2 1/2 ins. in the ground for 1/4 Rec. Cor
 marked 74 on W face. dug pits
 18 x 18 x 12 ins. N & S of stone. 5 1/2 ft. dist.
 and raised a mound of earth 1 1/2 ft.
 high 3 1/2 ft. basal on sides

54.50 Wash 20 lks. wide course N.W.

Subdivision Op. 1879 E.

Continued.

Chains. 43.00	Wash 20 lks wide course N.
80.00	Set a volcanic stone 16 x 12 x 8 ins, 11 ins, in the ground for Cor. to Secs. 23, 24, 25 & 26, marked with 2 watches on S. and 1 watch on E edges, dug pits 18 x 18 x 12 ins. in each Cor., 5 1/2 ft. dist, and raised a mound of earth 2 ft. high 4 1/2 ft. base alongside. Land rolling, good grass, Soil 3 ^d & 4 th rate. Timber, some Mesquite in washes.
	East on a random line bet. Secs. 24 & 25, Yaw, 12° 48' E. over rolling lands.
40.00	Set temporary 1/4 Sec. Cor.
53.50	Wash 18 lks. wide, course N.W.

Subdivision Sp. 18 S R 9 E.

Continued.

- Chains
 79.95 Intersect E boundary of Sp. at 13 lks.
 of the cor. to Secs. 19, 24, 25 & 30
 which is a granite stone 16x10x8 ins.
 firmly set in the ground with 2 notches
 on the S. and 4 notches on the edges,
 with pits 18x18x12 ins. in each Sec.
^{5 1/2 ft. dist}
 And mound of earth 2 ft. high 4 1/2 ft.
 base alongside. Thence run
 N 89° 55' W. on a true line bet. Secs. 24 & 25,
 with same var.
- 39.98 Set a volcanic stone 15x10x8 ins.
 10 ins in the ground for 1/4 Sec. Cor.
 marked 1/4 on surface, dug pits
 18x18x12 ins. E & W of stone 5 1/2 ft. dist.
 and raised a mound of earth 1 1/2 ft.
 high 3 1/2 ft. base alongside.
- 49.95 The Cor. to Secs. 23, 24, 25 & 26.
 Land rolling.

Subdivision Sp, 18 SR 9 E

Continued.

Chains	Bail 3 ^d , + 4 th rate good grass Timber - Scattering Mesquite,
--------	--

North Sect. Secs. 23 + 24
"Var. 12° 48' E.

over pulling land.

4.00	Wash 18 lks. wide, course N.W.
13.00	" 20 " " " N.W.
18.50	" 20 " " " N.W.
40.00	Set a volcanic stone 20 x 14 x 8 ins. 15 ins. in the ground for 1/4 Sec. Cor. marked 14 on W face, dug pits 18 x 18 x 12 ins. N. by stone 5 1/2 ft. dist. and raised a mound earth 1 1/2 ft. high 3 1/2 ft. base - alongside.
43.00	Wash 30 lks. wide course N.W.
56.00	" 20 lks. wide " N.W.
69.00	" 15 lks. wide " West.

Subdivision Op. 18 SR 9 E.

Continued.

Chains.

80.00

Set a granite stone $14 \times 12 \times 8$ ins. 10 ins. in the ground for cor. to Secs. 13, 14, 23 & 24 marked with 2 notches on S and 1 notch on E-edges. Aug pits $18 \times 18 \times 12$ ins. in each Sec. $5\frac{1}{2}$ ft. dist. and raised a mound of earth 2 ft. high 4 ft. base alongside, from which

A mesquite 8 ins. diam. bro. S 85° E. $\frac{1}{2}$ lks. dist. marked T 18 S R 9 E. S 24 B. J.

A mesquite 6 ins. diam bro. S 45° W. 100 lks. dist. marked T 18 S R 9 E. S 23 B. J.

A mesquite 4 ins. diam bro. N 43° W. 80 lks. dist. marked T 18 S R 9 E. S 14 B. J.

No other trees within limits.

Land rolling, good grass.

Soil 3rd & 4th rate

Timber Reattaining Mesquite.

Subdivision Sp. 18 S R 9 E

Continued.

- Chavis East on a random line bet. Secs. 13 & 24
 Fav. $12^{\circ} 48' E.$
 over rolling land.
- 39.50 Wash 30 lks, wide, course N. W.
 40.00 Set temporary $\frac{1}{4}$ Sec. Cor.
 62.00 Wash 20 lks, wide, course N.
 80.13 Intersect E boundary of Sp. at 19 lks.
 S. of the cor. to Secs. 13, 18, 19 & 24
 which is a granite stone $18 \times 12 \times 6$ ins.
 firmly set in the ground, with 3 notches
 on A & B edges, from which
 A mesquite 8 ins. diam. brs. $N 52^{\circ} W. 23$ lks. dist.
 marked T 18 S R 9 E. S 13 B. J.
 A mesquite 6 ins. diam. brs. $N 67^{\circ} E. 2/5$ lks. dist.
 marked T 18 S R 10 E. S 13 B. J.
 Thence Run
 S 89 $^{\circ}$ 52' W. on a true line bet. Secs. 13 & 24
 with Rance cor.

Subdivision Sp. 18 SR 9 E

Continued.

chains.

40.07

Set a granite stone $14 \times 10 \times 6$ ins. 10 ins. in the ground for $\frac{1}{4}$ Sec. Cor. marked $\frac{1}{4}$ on N face, dug pits $18 \times 18 \times 12$ ins. E of stone $5\frac{1}{2}$ ft. dist. and raised a mound of earth $1\frac{1}{2}$ ft. high $3\frac{1}{2}$ ft. base alongside, from which
 A mesquite 6 ins. diam. bro. S 60° W. $9\frac{1}{2}$ ft. dist. marked $\frac{1}{4}$ S. B. J.

A mesquite 6 ins. diam. bro. N 45° W. $7\frac{1}{2}$ ft. dist. marked $\frac{1}{4}$ S. B. J.

80.13

The Cor. to Secs. 13, 14, 23 & 24

Land rolling

Soil 3^d & 4th rate good grass

Timber Scattering Mesquite.

Marsh bet. Secs. 13 & 14

Var. 12° $48'$ E.

Subdivision Op. 18 SR 9 E.

Continued.

- | Spains. | |
|---------|--|
| | over rolling land. |
| 12.00 | Wash 18 lks wide course W. |
| 26.00 | " 20 " " " W. |
| 39.00 | " 15 " " " W. |
| 40.00 | Set a granite stone 14 x 12 x 10 ins. 10 ins. in the ground for $\frac{1}{4}$ Sec. cor. marked $\frac{1}{4}$ on W face, dug pits 18 x 18 x 12 ins. N & S of stone $5\frac{1}{2}$ ft. dist. and raised a mound of earth $1\frac{1}{2}$ ft. high $3\frac{1}{2}$ ft. base along side, from which
A mesquite 8 ins. diam. brs. S 65° E. 128 lks. dist. marked $\frac{1}{4}$ S. B. J. |
| | A mesquite 12 ins. diam. brs. S 35° E. 154 lks. dist. marked $\frac{1}{4}$ S. B. J. |
| 66.00 | Wash 30 lks. wide course N. W. |
| 80.00 | Set a granite stone 16 x 10 x 4 ins. 11 ins. in the ground for Cor. Secs. 11, 12, 13 & 14, marked with 4 notches on S and 1 notch |

Subdivision Sp. 18 SR 9 E.

Continued.

Chains

on E edges, dug pits 18 x 18 x 12 ins. in each Sec. 5 1/2 ft. dist. and raised a mound of earth 2 ft. high 4 1/2 ft. base alongside, from which

A mesquite 5 ins. diam. bro. N 7° E 73 Ck. dist.
Marked T 18 S R 9 E. S 12 B. J.

A mesquite 6 ins. diam. bro. S 89° E. 148 Ck. dist.
Marked T 18 S R 9 E. S 13 B. J.

A mesquite 6 ins. diam. bro. S 53° E. 154 Ck. dist.
Marked T 18 S R 9 E. S 13 B. J.

A mesquite 5 ins. diam. bro. S 24° E. 146 Ck. dist.
Marked T 18 S R 9 E. S 13 B. J.

Land rolling, Grad Grass
Soil 2nd & 3^d. rate.

Timber, Scattering Mesquite.

Cast on a random line bet. Secs. 12 & 13
var. 12° 48' E.

Subdivision Op. 18 S R 9 E.

Continued.

Chanis over level land
 40.00 Bet temporary $\frac{1}{4}$ Sec. Cor.
 68.50 Wash 18 lks. wide Course N. W.
 80.14 Intersect E boundary of Township
 at 18 lks N of the Cor. to Recs. 7, 12, 13 & 18,
 which is a granite stone $20 \times 14 \times 8$ ins.
 firmly set in the ground with 4 notches
 on the S and 2 notches on the N edges,
 with pits $18 \times 18 \times 12$ ins, in each Sec.
 $5\frac{1}{2}$ ft diet, and mound of earth 7 ft.
 high $4\frac{1}{2}$ ft. base alongside
 from which
 a mesquite 10 ins. diam. brs. $S 10^{\circ} E 23 \frac{1}{2}$ lks. diet.
 Marked S 18 S R 10 E S 18 13 D.

Thence I run

at $89^{\circ} 52'$ W on a true line bet. Secs. 12 & 13
 with same cor.

40.08 Set a granite stone $16 \times 10 \times 8$ ins, 11 ins.

Subdivision Op. 18 S R 9 E.

Continued.

Chains.

in the ground for $\frac{1}{4}$ Sec. Cor. marked
 $\frac{1}{4}$ on N face, dug pits $18 \times 18 \times 12$ ins
 in each Sec. $5\frac{1}{2}$ ft. dist, and raised
 a mound of earth $1\frac{1}{2}$ ft. high $3\frac{1}{2}$ ft base
 alongside.

80.14 The cor. to Secs. 11, 12, 13 & 14
 Land level, Good Grass.
 Soil 2^a & 3^a rate
 Timber some few Mesquite

North bet. Secs. 11 & 12

Var. $12^{\circ} 48' E.$

over rolling lands.

21.00	Wash	15 lks.	wide,	course	N.W.
16.00	"	20 lks.	"	"	N.W.
32.00	"	30 lks.	"	"	N.W.
39.00	"	15 lks.	"	"	N.W.

Subdivision Sp. 18 SR 9 E.

Continued.

- | | |
|-----------------|--|
| Chairs
40.00 | Set a granite stone 12 x 8 x 6 ins. 8 ins. in the ground for 1/4 Sec. Cor. marked 1/4 on N. face. Aug pits 18 x 18 x 12 ins. N. & S of stone 5 1/2 ft. dist. and raised a mound of earth 1 1/2 ft. high 3 1/2 ft. base alongside, from which
A mesquite 12 ins. diam. bro. S 48° E 61 lks. dist. marked 1/4 S 25.
A mesquite 6 ins. diam. bro. S 3° W. 225 lks. dist. marked 1/4 S, 13, J. |
| 44.00 | Wash 20 lks. wide course N. W. |
| 69.50 | Wash 200 lks wide course West. |
| 80.00 | Set a Granite Stone 14 x 8 x 6 ins. 10 ins. in the ground for Cor. to Secs. 1, 2, 11 & 12, marked with 5 notches on S and 1 notch on E edges, Aug pits 18 x 18 x 12 ins. in each Sec. 5 1/2 ft. dist. and raised a mound of earth 2 ft. high 4 ft. base alongside. |

Subdivision Sp. 18 SR9 E.

Continued.

Chairs

Land rolling, good grass.
Soil 3^d & 4th rate
Timber scattering Mesquite.

Corner a random line bet. Secs. 1 & 12
Var. 12° 48' E.

Own level land

40.00 Set temporary 1/4 Sec. Cor.

49.86 Intersect E. 1/4 of Sp. at 22140. S
of the Cor. to Secs. 1, 6, 7 & 12,
which is a granite stone 16 x 14 x 10 ins.
fairly set in the ground with 5 notches
on the S, and 1 notch on the N, edges,
with pits 18 x 18 x 12 ins. in each Sec.
5 1/2 ft. dia. and mound of earth 2 ft.
high 4 1/2 ft. base alongside. Then I run
S 89° 57' W. on a true line bet. Secs. 1 & 12

Subdivision Sp. 18 SR 9 E

Continued.

Plains.

with sand bar.

29.93 Set a granite stone 16 x 8 x 6 ins. 11 ins.
in the ground for $\frac{1}{4}$ Sec. Cor.
marked $\frac{1}{4}$ on N face dug pits
18 x 18 x 12 ins. E & W of Stone $5\frac{1}{2}$ ft. dist.
and raised a mound of earth $1\frac{1}{2}$ ft.
high $3\frac{1}{2}$ ft. base alongside.

29.86 The Cor. to Secs. 1, 2, 11 & 12

Land level, good grass

Soil 2^d rate

Timber, some few Mesquite & Brush at the
East end of line.

North on a random line to Sec. 1 & 2
Mag. $120^{\circ} 48' E$.

Over rolling land.

18.00 Wash 20 ft. wide course N.W.

Subdivision Sp. 18 S R 9 E.

Continued.

Chains	
25.00	Wash 18 lks. wide, Course N.W.
30.00	" 15 lks. " " N.W.
35.00	" 20 lks. " " N.W.
40.00	Set temporary $\frac{1}{4}$ Sec. Cor.
51.00	Wash 30 lks. wide Course N.W.
74.20	Intersect at boundary of Sp. at 35 lks. W. of the cor. to Secs. 1, 2, 35 & 36. which is a granite stone 20x6x4 ins. firmly set in the ground with 1 notch on the E and 5 notches on the W. edges, with pits 18x18x12 ins. in each Sec. 5 ft. dist. and mound of earth 2 ft. high 4 ft. base alongside, from which A mesquite 10 ins. diam bro S 11° E 54 lks dist. Marked S 18 S R 9 E. S 1 B. J.

Thence Iron

S. 0° 16' W - on a line bet. Secs. 1 & 2
with same var.

Subdivision Op. 18 S. R. 9 E.

Continued.

Changes.
34.20

Set a lim stone $15 \times 8 \times 6$ ins, 10 ins. in the ground for $\frac{1}{4}$ Sec. Cor. marked $\frac{1}{4}$ on W face, dug pits $18 \times 18 \times 12$ ins. Noddy Stone $5\frac{1}{2}$ ft. dist, and raise mound of earth $1\frac{1}{2}$ ft. high $3\frac{1}{2}$ ft base along side, from which

A Mesquite 4 ins. diam, bro. S 12° E. 133 W. dist. marked $\frac{1}{4}$ S. B. T.

No other trees within limits.

74.20

The Cor. to Secs. 1, 2, 11 & 12

Land rolling, good grass
Soil 2nd & 3^d rate

Timber, some few Mesquite.

Sept^r 28th 1886.

From the Cor. to Secs. 2, 3, 34 & 35.
on the South boundary of the township
which is a post 4 ins. square marked

Subdivision Sp. 18 SR 9 E.

Continued.

Chains,

T 18 S. S. 35 on N. E

R. 9 E. S. 2 on S. E

T 19 S. S. 3 on S. W and

S 34 on N. W. faces, with 2 notches on E, and 4 notches on W. edges, with pits 18 x 18 x 12 ins. in each Sec.

5 1/2 ft. dist. and mound of earth 2 ft. high 4 1/2 ft. base around post; Drum

North bet. Secs. 34 & 35

Var. 12° 48' E.

On level bottom land

40.00 Set a post 3 ft. long 3 ins. square with marked stone 12 ins. in the ground for 1/4 Sec. Cor. marked 1/4 S on W face, dug pits 18 x 18 x 12 ins. at S of post, 5 1/2 ft. dist. and raised a mound of earth 1 1/2 ft. high 3 1/2 ft. base around post.

Subdivision Sp. 18 SR 9 E.

Continued.

Chains,

80.00

Set a granite stone 20x12x8 ins. 15 ins. in the ground for Cor. to Secs. 26, 27, 34 & 35, marked with 1 notch on S, and 2 notches on E. edges, Aug pits 18x18x12 ins. in each Sec. 5 1/2 ft. diet and raised a mound of earth 2 ft. high 4 1/2 ft. base alongside.

Land level, good grass
Soil 1st rate
No timber.

Cast on a random line bet. Secs. 26 & 35.
Var. 12° 48' E.

Over level land

36.00

Wash 30 lks. wide Cause S.W.

39.40

Leave Iowa lands and enter Mead.

40.00

Set temporary 1/4 Sec. Cor.

Subdivision 2p, 18 SR 9 E

Continued.

Chains,

- 77.00 Wash bolts, wide, course N.W.
- 80.27 Intuscut et ed line at 18 links North of the Cor. to Secs. 25, 26, 35 & 36, then turn at $89^{\circ}52' N$. on a true line bet. Secs. 26 & 35 with Rammer bar.
- 40.14 Put a granite stone $16 \times 6 \times 4$ ins. 11 ins. in the ground for $\frac{1}{4}$ Sec. Cor. marked $\frac{1}{4}$ on et face, and raised a mound of stone $1\frac{1}{2}$ ft. high $3\frac{1}{2}$ ft. base alongside, pits impracticable, from which a mesquite 6 ins. diam, brs. S. $40^{\circ} W$. 190 ft. dist. marked $\frac{1}{4}$ S.T.B.T.
- A mesquite 8 ins. diam, brs. S $10^{\circ} W$. 213 ft. dist. marked $\frac{1}{4}$ S.T.B.T.
- 80.27 The Cor. to Secs. 26, 27, 34 & 35. Land level, good grass Soil 1st & 3rd rate Timber some few mesquites.

Subdivision Sp. 18529 E.

Continued.

Chains.	
	North, bet. Secs. 26 & 27 Var. $12^{\circ} 48'$ E.
	Over level land
33.00	Chance or water hole 30 rods wide, course N. W. & S. E.
40.00	Set a granite stone $16 \times 8 \times 6$ ins, 11 ins, in the ground for $\frac{1}{4}$ Sec. Cor. marked $\frac{1}{4}$ on W. face, dug pits $18 \times 18 \times 12$ ins. at E of stone $5\frac{1}{2}$ ft. dist. and raised a mound of earth $1\frac{1}{2}$ ft. high $3\frac{1}{2}$ ft. base alongside.
80.00	Set a volcanic stone $24 \times 12 \times 10$ ins, 18 ins, in the ground for C. to Secs. 22, 23, 26 & 27, marked with 2 notches on S & E edges, dug pits $18 \times 18 \times 12$ ins. in each Sec. $5\frac{1}{2}$ ft. dist. and raised a mound of earth 2 ft. high, $4\frac{1}{2}$ ft. base alongside.
	Land level, Good grass. Said $1\frac{1}{2}$ rate

Subdivision Sp. 18 SR 9 E.

Continued.

Chains.

No timber.

Put on a random line bet. Secs. 23 & 26.
 Var. $120^{\circ} 48' E.$

Over level land.

26.50 Same level land and into mesa.

36.00 Wash 15 lks. wide, course N.W.

40.00 Set temporary $\frac{1}{4}$ Sec. Cor.

44.00 Wash 30 lks. wide, course N.W.

50.11 Intersect $\frac{1}{4}$ line at 16 lks. N of the Cor.
 to Secs. 23, 24, 25 & 26, thence I run
 $N 89^{\circ} 53' W$, on a true line bet. Secs. 23 & 26,
 with same var.

40.06 Set a volcanic stone $14 \times 12 \times 8$ ins.
 10 ins in the ground for $\frac{1}{4}$ Sec. Cor.
 marked $\frac{1}{4}$ on N. face, and raised a
 mound of stone $1\frac{1}{2}$ ft. high $3\frac{1}{4}$ ft. base.

Subdivision Sp. 18 SR 9 E.

Continued.

Stations.

80.11

alongside, pits impracticable.
The Cor. to Secs. 22, 23, 26 & 27,
Land level, Good Grass
Soil 1st. & 3d rate.
no timber.

By observation taken this
day I find the magnetic variation
to be $12^{\circ} 48' E.$

North bet. Secs. 22 & 23.

Var. $12^{\circ} 48' E.$

Over level land

40.00 Set a granite stone $14 \times 8 \times 6$ ins., 10 ins.
in the ground for $\frac{1}{4}$ Sec. cor.
marked $\frac{1}{4}$ on W face, dug pits

Subdivision of, 18 SR 9 E.

Continued.

Chains.

18 x 18 x 12 ins. N. S. of stone 5 1/2 ft. dist. and raised a mound of earth 1 1/2 ft. high 3 1/2 ft. base along side, from which

A mesquite 4 in. diam. brs. S. 48° W. 100 lks. dist. Marked 1/4 S, B, J.

A mesquite 3 in. diam. brs. N 36° W. 4 1/2 lks. dist. Marked 1/4 S, B, J.

80.00 Set a granite stone 18 x 10 x 6 ins. 12 ins. in the ground for Cor. to Secs. 14, 15, 22 & 23 marked with 3 notches on S and 2 notches on E. edges. Aug pits 18 x 18 x 12 ins. in each Sec. 5 1/2 ft. dist. and raised a mound of earth 2 ft. high 4 1/2 ft. base along side. from which

A mesquite 4 in. diam. brs. N 5° W. 60 lks. dist. Marked 3/8 SR 9 E S 15 B, J.

No other trees within limits.

Subdivision 3p. 18 SR 9 E.

Continued.

Chains,

Land level, good grass.

Soil 1st Class.Timber some few mesquite last $\frac{1}{2}$ mile.

East on a random line bet. Secs. 14 & 23

Cor. $12^{\circ} 48' E.$

Low level land

25.00 Wash 20 lks. wide course N.W.

40.00 Set temporary $\frac{1}{4}$ Sec. Cor. Enter Mesa80.21 Intersect N-S line at 9 lks. S. of the Cor.,
to Secs. 13, 14, 23 & 24, thence S.W.S. $89^{\circ} 56' N.$ on a true line bet. Secs. 14 & 23,
with same corr.40.11 Set a volcanic stone $16 \times 12 \times 8$ ins. 11 ins. in
the ground for $\frac{1}{4}$ Sec. Cor. marked $\frac{1}{4}$ on
N. face, dug pits $18 \times 18 \times 12$ ins. E & W of
stone $5\frac{1}{2}$ ft. dist. and raised a mound of

Subdivision Sp. 18 S R 9 E.

Continued.

Chains,

earth $1\frac{1}{2}$ ft. high $3\frac{1}{2}$ ft. base alongside,
from which

A Mesquite 12 ins. diam. bro. South $73\frac{1}{2}$ lks. dist.
Marked $\frac{1}{4}$ S. T. S. T.

A Mesquite 8 ins. diam. bro. $S 87^{\circ} E$. 100 lks. dist.
Marked $\frac{1}{4}$ S. T. S. T.

80.21 The Cor. to Secs. 14, 15, 22 & 23,

Land level, good grass

Soil 1st & 2^d. rate.

Timber, ~~Planting~~ Mesquite.

North bet. Secs. 14 & 15,

Yuv. $12^{\circ} 48' E$.

Own level land.

24.00 Main road from Tucson to Altar

course $N 30^{\circ} E$, & $S 30^{\circ} W$.

31.00 Line crosses South end of Charco or water
hole, course $N 30^{\circ} W$.

Subdivision 3p, 18 SR 9 E.

Continued.

Chains.

- 40.00 Set a volcanic stone $12 \times 8 \times 8$ ins, 8 ins. in the ground for $\frac{1}{4}$ Sec. Cor. marked $\frac{1}{4}$ on W face, dug pits $18 \times 18 \times 12$ ins. at $\frac{1}{2}$ W of stone, $5\frac{1}{2}$ ft. dist. and raised a mound of earth $1\frac{1}{2}$ ft. high $3\frac{1}{2}$ ft. base, along side.
- 49.50 Road from Otter's Ranch to Tucson, course S. 60° W. \times $N 20^\circ$ E.
- 80.00 Set a granite stone $20 \times 12 \times 8$ ins. 15 ins. in the ground for Cor. to Secs. 10, 11, 14 & 15, marked with 4 notches on S and 2 notches on E. edges, dug pits $18 \times 18 \times 12$ ins. in each sec, $5\frac{1}{2}$ ft. dist. and raised a mound of earth 2 ft. high $4\frac{1}{2}$ ft. base along side, from which
- A Mesquite 14 ins. diam. bro. S. 12° W. 107 lks. dist. Marked S 18 SR 9 E, R. 15-13. J.
- A Mesquite 6 ins. diam. bro. N 32° E. 146 lks. dist. Marked S 18 SR 9 E, S 11 B. J.

Subdivision Sp. 18 SR 9 E.

Continued.

Chains.

No other trees within limits.

Land level, Good grass.

Soil 1st rate

Timber, some few Mesquite at N end of line.

Castana random line bet. Secs. 11 & 14

var. $12^{\circ} 48' E.$

Over level land.

14.50 Road from Otero's Rancho to Tucson
Course $S 20^{\circ} W.$ & $N 10^{\circ} E.$

33.00 Main road from Tucson to Altar
course $N 4^{\circ} S.$ $30^{\circ} W.$

40.00 Bet temporary $\frac{1}{4}$ Sec. Cor.

41.00 Enter Mesa land.

80.11 Intersect $N \& S$ line at 11 lks north
of the Cor. to Secs. 11, 12, 13 & 14,
Thence down

Subdivision Sp. 18 SR 9 E

Continued.

Pains.

At 89055th on a true line bet. Secs. 11 & 14,
with same var.

40.06 Set a granite stone 12 x 10 x 8 ins. 8 ins. in the
ground for $\frac{1}{4}$ Sec. Cor. marked $\frac{1}{4}$ on N.
face, dug pits 18 x 18 x 12 ins. E & W of
stone 5 $\frac{1}{2}$ ft. diet, and raised a mound
of earth 1 $\frac{1}{2}$ ft. high 3 $\frac{1}{2}$ ft. base along side,
from which

A mosquito 8 ins. diam. bro. S. 43° E. 148 lks. diet,
marked $\frac{1}{4}$ S. T. B. 57.

No other trees within limits.

80.11 The Cor. to Secs. 10, 11, 14 & 15.
hand level, good grass
Dair 1st & 2nd rate
Timber, a few mosquito.

North bet. Secs. 10 & 11

Var. 12° 48' E.

Subdivision Op. 18 SR 9 E.

Continued.

Chains.

One level land.

40.00 Set a granite stone $14 \times 10 \times 8$ ins.
10 ins. in the ground for $\frac{1}{4}$ Sec. Cor. marked
 $\frac{1}{4}$ on W face, dug pits $18 \times 18 \times 12$ ins.
N & S of stone $5\frac{1}{2}$ ft. dist. and raised
a mound of earth $1\frac{1}{2}$ ft. high $3\frac{1}{2}$ ft. base
alongside.

80.00 Set a volcanic stone $15 \times 13 \times \frac{1}{2}$ ins. 10 ins.
in the ground for Cor. to Secs. 2, 3, 10 & 11,
marked with 5 notches on S. and
2 notches on E. edges, dug pits
 $18 \times 18 \times 12$ ins. in each Sec. $5\frac{1}{2}$ ft.
dist. and raised a mound of earth
2 ft. high $4\frac{1}{2}$ ft. base alongside.
Sand level Good grass,
Soil 2^d. rate
No timber.

BOOK 667
 Subdivision 3p, N SR 9 E.

Continued.

Chains,

Put on a random line bet. Secs. 2 & 11.
 Var. 12° 48' E.

Over level land.

- 18.00 Chain over Matahole 50 (Kawido, Area N & S.)
- 20.00 Road from Otero's Ranch to Tucson course N & S,
 and runs into the main road from Tucson
 to Altar, about 20 Chs. North.
- 24.75 Main road from Tucson to Altar, course N & S.
- 27.00 The benches of Russell's well is 11.60 Chs. South.
- 40.00 Set temporary $\frac{1}{4}$ Sec. Cor.
- 49.00 Enter mesa land.
- 80.04 Intersect N & S line at $1\frac{1}{2}$ Km. S. of the Cor. to Secs.
 1, 2, 11 & 12. Thence Run
 $S 89^{\circ} 53' W$ on a true line bet. S. 2 & 11,
 with same var.
- 40.02 Set a granite stone $12 \times 12 \times 10$ ins. This in the
 ground for $\frac{1}{4}$ Sec. Cor. marked $\frac{1}{4}$ on N face.
 dug pits $18 \times 18 \times 12$ ins. E & W of stone.

Subdivision Op. 18 SR 9 E.

Continued

Chains.

5 1/2 ft. dist. and raised a mound of earth 1 1/2 ft. high 3 1/2 ft. base along -
side, from which.

A Mesquite 8 ins. diam. bro. S 7/20° E, 115 lks. dist.
marked 1/4 S, T, D, J.

A Mesquite 4 ins. diam. bro. S 7/30° W, 115 lks. dist.
marked 1/4 S, T, D, J.

80.04 The cor. to Secs. 2, 3, 10 & 11.

Land level, good grass.

Dair 1st & 3^d rate

Timber, scattering mesquite.

Work on a random line bet. Secs. 2 & 3

Var. 12° 48' E.

Over level land.

40.00 Per temporary 1/4 Sec. Cor.

68. 1/2 Interset North boundary of township

Subdivision Sp. 18 SR 9 E.

Continued.

Chains.

at 87 lks. West of the Cor. to Secs. 2, 3, 34 & 35,
which is a granite stone 12x12x6 ins,
firmly set in the ground with 2 notches
on E and 4 notches on W. edges, with
pits 18x18x12 ins, in each Sec, 5 1/2 ft. dist,
and mound of earth 2 ft. high 4 1/2 ft. base
alongside, from which.

A mesquite 6 ins. diam, bro S 65° E, 280 lks dist,
marked S 18 S, R 9 E, S 2 13, J.

A mesquite 8 ins. diam bro, S 80° E, 288 lks, dist,
marked S 18 S R 9 E. S, 2, 13, J.

A mesquite 6 ins. diam., bro N 20° W, 2, 32 lks, dist,
marked S 17 S, R 9 E, S, 34 13, J.

Thence I run

S 0° 44' West. on a true line bet. Secs. 2 & 3,
with same var.

28. 1/2 bet a post 3 ft. long 3 ins. square with
marked stone 10 ins. in the ground for 1/4 Sec. Cor.

Subdivision Sp. 18 SR 9 E.

Continued.

Chains.

marked $\frac{1}{4}$ S on W face, dug pits
 $18 \times 18 \times 12$ ins, N & S of post. $5\frac{1}{2}$ ft. dist.
 and raised a mound of earth $1\frac{1}{2}$ ft. high
 $3\frac{1}{2}$ ft. base around post.

68. $\frac{1}{2}$

The Cor. to Secs. 2, 3, 10 & 11.

Land level, good grass
 Soil 2^d. class.

Timber some few Mesquites on N end of line.
Sept^r 29th 1886.

From the cor. to Secs. 3, 4, 33 & 34, on
 the South boundary of township, which
 is a post 4 ins. square, marked

T 18 S. S 34 on N. E.

R 9 E, S 3 on S. E.

T 19 S. S 4 on S. W. and

S 33 on N. E. faces, with 3 notches
 on E & W faces, with pits $18 \times 18 \times 12$ ins.

Subdivision Op. 18 Steg E.

Continued.

Spains.

in each Sec. $5\frac{1}{2}$ ft. dist. and on round of earth
2 ft. high 4 ft. base around post, from which
a Mosquito 6 ins. diam. bro. 30° W. 238 lks. dist.
marked T 18 S. R. 9 E. S. 33 13. A.

A Mosquito 6 ins. diam. bro. S. 53° W. 214 lks. dist.
marked T. 19 S. R. 9 E. S. 4 13. J.

No other trees within limits.

Hence I run

North bet. Secs. 33 + 34.

Yav. 12° 48' E.

Over level land.

40.00 Set a post 3 ft. long 3 ins. square with
marked stone 12 ins. in the ground, for
 $\frac{1}{4}$ Sec. Cor. marked $\frac{1}{4}$ S on N. face.
dug pits $18 \times 18 \times 12$ ins. N + S. of post, $5\frac{1}{2}$ ft.
dist. and raised a mound of earth
 $1\frac{1}{2}$ ft. high $3\frac{1}{2}$ ft. base around post,
from which

Subdivision Sp. 18 SR9 E.

Continued.

Chains

A Mesquite 6 ins. diam. bro. N 81° W. 38 lks. dist.
marked 1/4 S, B, J.

A Mesquite 8 ins. diam. bro. N 87° W. 64 lks. dist.
Marked 1/4 S, B, J.

80.00 Set a post 4 ft. long 4 ins. square, with
marked stone 12 ins. in the ground
for Cor. to Secs, 27, 28, 33 & 34, marked
S 18 S, S. 27 on N. E.
B 9 E. S. 34 on S. E.
S 33 and S. W and
S 28 on N. W. faces, with 1 notch
on S and 3 notches on E edges
from which

A Mesquite 8 ins. diam. bro. N 27° E. 508 lks. dist.
Marked S 18 S, R 9 E S 27 B, J.

no other trees within limits.

Land level, good grass,
Soil 1st & 2^d. rats

Subdivision Sp. 18 S R 9 E.

Continued.

Chains,

Timber, Scattering Mesquite.

Cast on a random line bet. Secs. 27 & 34
Var. 12° 48' E.

Over level land,

40.00 Set temporary 1/4 Sec. Cor.

73.50 Main road from Tucson to Altam, course N 65°

79.96 Intersect N 65° line at 16 chs. South of the Cor.
to Secs. 26, 27, 34 & 35, thence I run
S 89° 53' W. on a true line bet. Secs. 27 & 34,
with same var.

79.98 Set a granite stone 10 x 10 x 6 ins. 7 ins. in the
ground for 1/4 Sec. Cor. Marked 1/4 on all faces
dig pits 18 x 18 x 12 ins. E & W of stone 5 ft. dist.
and raised a mound of earth 1 1/2 ft. high
3 1/2 ft. base alongside

79.96 The Cor. to Secs. 27, 28, 33 & 34.

Subdivision Sp. 18 S. R 9 E.

Continued.

Chains.

Land level, Good grass.

Soil 1st & 2^d rate.

Timber Scattering Mesquite.

North lot. Secs. 27 & 28

4th 12° 48' E.

One level land.

40.00 Set a post 3 ft. long 3 ins. square, with
marked stone 12 ins. in the ground
for 1/4 Sec. Cor. marked 1/4 on N face.

Aug pits 18 x 18 x 12 ins. N & S of stone
5 1/2 ft. dist. and raised a mound of
earth 1 1/2 ft. high 3 1/2 ft. base alongside.

80.00 Set a post 4 ft. long 4 ins. square, with
marked stone 12 ins. in the ground

for Cor. to Secs. 21, 22, 27 & 28.
Marked

Subdivision Op. 18 S. 18 E.

Continued.

Chairs

T. 18 S. S. 22 on N.E.

R. 9 E. S. 27 on S.E.

S. 28 on S.W. and

S. 21 on N.W. face, with 2 notches on S and 3 notches on E edges. dug pits 18 x 18 x 12 in. in each Sec. 5 1/2 ft. dist. and raised a mound of earth 2 ft. high, 4 1/2 ft. base around post.

Land level good grass.
Soil 2d rate
Dirties scattering mesquite.

Subdivision Op. 18 SR 9 E.

Continued.

Chains.

East on a random line bet. Secs. 22 & 27
7 or 12° 48' E.

Over level land

- 40.00 Set temporary 1/4 Sec. Cor.
- 47.00 Mark 30 lks. wide, course N. E.
- 76.50 Main road from Tucson to Atlas, course N. S.
- 79.91 Intersect at S. line at 20 lks. South of
the Cor. to Secs. 22, 23, 26 & 27.

Thence down

S 89° 57' W. on a true line bet. Secs. 22 & 27
with same bar.

- 39.96 Set a post 3 ft. long, 3 ins. square with
marked stand 12 ins. in the ground for
1/4 Sec. Cor. marked 1/4 S. on N. face,
dug pits 18 x 18 x 12 ins. E & W of post, 5 1/2 ft.
dist. and raised a mound of earth

1 1/2 ft. high 3 1/2 ft. base around post.

- 79.91 The Cor. to Secs. 21, 22, 27 & 28.

No. 887

Subdivision Twp. 18 S R 9 E.

Continued.

Chains

Land level, good grass.
Soil 1st & 2^d. rate
Timber scattering Mesquite.

North bet. Secs. 21 & 22

Var. $12^{\circ} 48' E.$

Even level land.

40.00

Set a post 3 ft. long 3 ins. square with
marked stone 16 ins. in the ground
for $\frac{1}{4}$ Sec. cor. marked $\frac{1}{4}$ S on W. face
dug pits $18 \times 18 \times 12$ ins, N & S of post, $5\frac{1}{2}$ ft.
dist. and raised a mound of earth
 $1\frac{1}{2}$ ft. high $3\frac{1}{2}$ ft. base around post.
from which

A Mesquite 18 ins. diam bro. $N 45^{\circ} W.$ 357 1/2 dist.

Marked $\frac{1}{4} S, B. J.$

A Mesquite 8 ins. diam bro. $N 80^{\circ} W.$ 284 1/2 dist.

Subdivision Op. 18 S R 9 E.

Continued.

Chains marked $\frac{1}{4}$ S. B. T.

80.00 Set a Granite stone $12 \times 10 \times 5$ ins. 8 ins.
 in the ground for Cor. to Sec. 15, 16, 21 & 22,
 marked with 3 notches on S & E edges.
 dug pits $18 \times 18 \times 12$ ins. in each Sec. 5 ft. ft
 dist. and raised a mound of earth
 2 ft. high $4\frac{1}{2}$ ft. base, alongside
 from which

A Mesquite 3 ins. diam. $\text{bore } N 76^\circ E 151$ ft. dist.
 Marked

S 18. S. R. 9. E. S 15 T. 3. J.

No other trees within limits.

Land level, Good grass.

Soil 2^d rate

Timber. Some few Mesquites

Subdivision Tp. 18 S. R. 9 East.

Continued.

Chains.

East on a random line bet. Secs. 15 & 22,
"Var. $12^{\circ} 48' E.$

Over level land.

40.00 Set temporary $\frac{1}{4}$ Sec. Cor.

51.00 Chorro or water hole 30 Ks. wide, corner No. S.

71.50 Main road from Tucson to Altav., course
S. & $20^{\circ} E.$

74.83 Intersect No. S line at 17 Ks. South of the Cor. to
Secs. 14, 15, 22 & 23, thence I run
 $S 89^{\circ} 53' N.$ on a true line bet. Secs. 15 & 22,
with same var.

39.92 Set a granite stone $14 \times 6 \times 6$ ins., 10 ins. in
the ground for $\frac{1}{4}$ Sec. Cor. marked $\frac{1}{4}$
on N face, dug pits $18 \times 18 \times 12$ ins., $5\frac{1}{2}$ ft.
dist. and raised a mound of earth
 $1\frac{1}{2}$ ft. high $3\frac{1}{2}$ ft. base alongside.

79.83 The Cor. to Secs. 15, 16, 21 & 22,
Land level.

Subdivision Sp. 18 SR 9 E.

Continued.

Chains

Sail 1st & 2nd, Class, good grass
Timber, some few Mesquite

By observation taken this day
find the magnetic variation to be
12° 48' East.

North bet. Recs. 15 & 16.

Var. 12° 48' E.

Over level ground.

- .30 Road from Oteros to Tucson, course
N. 55° E and S. 70° W. and a road or trail
bears N. W. and runs towards a field
about 20 Chs. N. W. from this point.
- 40.00 Set a granite stone 12 x 8 x 8 ins, 8 ins.
in the ground for 1/4 Sec. Cor. marked 14
on W face, dug pits 18 x 18 x 12 ins. N & S.

Subdivision 3p. 18 S. R. 9 E

Continued.

Chains
 of stone 5 1/2 ft. dist, and raised a mound
 of earth 1 1/2 ft. high 3 1/2 ft. base alongside,
 from which
 N. E. Cor. of a brush fence inclosing a
 field about 10 Cho. square bro. S 45° W.
 20.50 Cho. dist. - field apparently unoccupied.

72.00 Wash 30 lks. wide, course N. E.

80.00 Set a quartzite stone 16 x 12 x 10 ins. 11 ins. in the
 ground for Cor. to Secs. 9, 10, 15 & 16, marked
 with 4 notches on S, and 3 notches on E, edges,
 dug pits 18 x 18 x 12 ins. in each Sec., 5 1/2 ft.
 dist. and raised a mound of earth 2 ft.
 high 4 1/2 ft. base alongside, from which
 a mesquite 3 ins. diam. bro. S 61° W. 259 lks. dist.
 Marked T. 18 S. R. 9 E. S 16 T. 5.

No other trees within limits.

Land level. Soil 1st & 2^d rate

Timber, some few mesquite

Subdivision Sp. 18 S. R. 9 E

Continued.

- Chains,
 East on a random line bet. Secs. 10 & 15
 $\text{Mag. } 12^{\circ} 48' \text{ E.}$
 over level land,
 10.00 Wash 30 lks. wide, course N. E.
 40.00 Set temporary $\frac{1}{4}$ Sec. Cor.
 79.93 Intersect cross line at 31 lks. South of
 the Cor. to Secs. 10, 11, 14 & 15,
 Thence run
 S $89^{\circ} 41' \text{ W.}$ on a true line bet. Secs. 10 & 15,
 with curve var.
 39.97 Set a post 3 ft. long 3 in. square with
 marked stone 12 ins. in the ground for
 $\frac{1}{4}$ Sec. Cor. marked $\frac{1}{4}$ S on N. face,
 dug pits 18 x 18 x 12 ins. E & W of post
 5 $\frac{1}{2}$ ft. dist and raised a mound of
 earth 1 $\frac{1}{2}$ ft. high, 3 $\frac{1}{2}$ ft. base around post.
 From which
 A Mesquite 8 in. diam. bro. N 46° W, 29 $\frac{1}{2}$ lks. dist.

Subdivision Sp. 18 S. R. 9 E.

Continued.

Charris,

Marked $\frac{1}{4}$ S. B. T.

A mesquite 3 ins diam, bro. N32°W. 215 lks. dist.

Marked $\frac{1}{4}$ S. B. T.

7/9. 93. The Cor. to Secs. 9, 10, 15 & 16,

Land level, good grass,

Soil 1st & 2^d rate.

Timber, some few mesquite.

North pt. Secs. 9 & 10.

Var. 12° 48' E.

Low level land

11.00 Wash 50 lks. wide, course C.

40.00 Set a granite stone 16 x 12 x 4 ins. 11 ins.
in the ground for $\frac{1}{4}$ Sec. Cor. marked $\frac{1}{4}$
on N. face, Aug. pits 18 x 18 x 12 ins N & S. of
stone $5\frac{1}{2}$ ft. dist. and raised a mound
of earth $1\frac{1}{2}$ ft. high, $3\frac{1}{2}$ ft. base, along side

Subdivision Sp. 18 S R 9 E.

Continued.

Chains.

80.00 Set a granite stone $14 \times 12 \times 10$ ins, 10 ins
in the ground for cor. to Sec. 34. 9×10 .
Marked with 5 notches on S and 3 notches
on E edges, dug pits $18 \times 18 \times 12$ ins, in
each cor. $5 \frac{1}{2}$ ft. dist, and raised a
mound of earth 2 ft. high, $4 \frac{1}{2}$ ft. base
along side. From which
A Mesquite 4 ins. diam. bro. $N 75^{\circ} W$. 130 lks. dist.
Marked T 18 S R 9 E. S 4 B. D.

A Mesquite 4 ins. diam. bro. $N 48^{\circ} W$. 146 lks. dist.
Marked T 18 S R 9 E S 4 B. D.

A Mesquite 6 ins. diam. bro. $N 33^{\circ} W$. 159 lks. dist.
Marked T 18 S R 9 E. Sec. 4 B. D.

A Mesquite 4 ins. diam. bro. $N 3^{\circ} E$. 200 lks. dist.
Marked T 18 S R 9 E. S. B. B. D.

Land level good grass
Soil 2 a rate.

Timber, some few Mesquite.

Subdivision Op. 18 S R 9 E
Continued.

Chains,

East on a random line bet. Secs. 3 & 10
Yav. $12^{\circ} 48' E$,

Over level land.

40.00 Set temporary $\frac{1}{4}$ Sec. Cor.

79.81 Intusset et al line at 9 lks. South of the Cor.
to Secs. 2, 3, 10 & 11. Thence I run
S $89^{\circ} 56' W$. on a true line bet. Secs. 3 & 10.
with same vat.

39.91 Set a post 3 ft. long 3 ins. square, with marked
stone 12 ins. in the ground for $\frac{1}{4}$ Sec. Cor.
marked $\frac{1}{4}$ S. on N. face, dug pits 18 x 18 x 12 ins.
E & W. of post, 5 $\frac{1}{2}$ ft. dist. and raised a mound
of earth 1 $\frac{1}{2}$ ft. high 3 $\frac{1}{2}$ ft. base around post.
from which

A Magnite 8 ins. diam. brs. S $15^{\circ} W$. 149 lks. dist.
Marked $\frac{1}{4}$ S. B. J.

A Magnite 6 ins. diam. brs. S $62^{\circ} E$. 190 lks. dist.
Marked $\frac{1}{4}$ S. B. J.

Subdivision Sp. 18 SR 9. E

Continued,

Chains,

79.81

The Cor. to Secs. 3, 4, 9 & 10.

Land level. Good grass

Soil 1st & 2nd rate.

Timber, scattering Mesquite.

North on a random line bet. Secs. 3 & 4

Var. 12° 48' E.

over level land.

26.00 Wash. 15 lks. wide, course E.

40.00 Set temporary 74 Sec. Cor.

63.50 Intersect N. boundary of township
at 54 lks. West of the cor. to Secs. 3, 4, 33 & 34,
which is a granite stone 20 x 10 x 8 ins.
firmly set in the ground, with 3 notches
on E & Wedges, with pits 18 x 18 x 12 ins.
in each Sec. 5 1/2 ft. dist. and mound of
earth 2 ft. high 4 1/2 ft. base along side.

Subdivision Sp. 18 S 1/2 9 E.

Continued

Chain,

from which

A Mesquite 10 ins. diam. brs. N10° E. 8 1/2 lks. dist.
Marked S 17 S. R. 9 E. S 34 B. T.

A Mesquite 6 ins. diam. brs. N39° W. 110 lks. dist.
Marked S. 17 S. R. 9 E. S 33 B. T.

A Mesquite 4 ins. diam. brs. N60° W. 139 lks. dist.
Marked S 17 S. R. 9 E. S 33 B. T.

A Mesquite 6 ins. diam. brs. N86° W. 194 lks. dist.
Marked S 17 S. R. 9 E. S 33 B. T.

Thence Run

S. 29 West on a true line bet. Secs. 3 & 4
with same var.

23.50 Set a post 3 ft. long 3 ins. square, with
marked stone 12 ins. in the ground for 1/4 Sec.
Cor. marked 1/4 S. on W. face, dug pits
18 x 18 x 12 ins. N & S of post 5 1/2 ft. dist. and
raised a mound of earth 1 1/2 ft. high
3 1/4 ft. base around post, from which

Subdivision Sp. 18 SR 9 E.

Continued,

Chains,

A Mesquite 2 in. diam. brs. S 33° W. 105 lks. dist.
marked 74 S. B. 2.

A Mesquite 8 in. diam. brs. S 30° E. 100 lks. dist.
marked 74 S. B. 2.

63.50 The Cor. to Secs. 3, 4, 9 & 10.

Land level good grass
Soil 2^d. rate

Timber, scattering Mesquite.

September 30th 1886

From the Cor. to Secs. 4, 5, 32 & 33, on
the South boundary of Township, which
is a post 4 in. square, marked

P 18, S. S 33 on N. E.

R 9, E. S. 4 on S. E.

S 19, S. S 5 on S. W. and

b 32 on N. E. faces, with 4 notches
on the E, and 2 notches on the W, edges.

Subdivision Sp. 18 SR 9 E.

Continued.

Wains.

from which

A Mesquite 6 ins. diam. bro. S 30° E. 354 lks. dist.

Marked T. 19 S. R 9 E. S. 4 B. J.

A Mesquite 5 ins. diam. bro. S 24° E. 189 lks. dist.

Marked T. 19 S R 9 E. S 4 B. J.

A Mesquite 4 ins. diam. bro. S 1° E. 140 lks. dist.

Marked T 19 S. R 9 E. S. 4 B. J.

A Mesquite 8 ins. diam. bro. S 22° W. 187 lks. dist.

Marked T 19 S. R 9 E. S 5 B. J.

Thence I run

North bet. Secs. 32 & 33.

Var. 12° 48' E.

Over level lands.

40.00 Set a post 3 ft. long 3 ins. square, with
marked stone 12 ins. in the ground, for
1/4 Sec. Cor. marked 1/4 S on W. face.
Dug pits 18 x 18 x 12 ins. N & S of post, 5 1/2 ft.
dist. and raised a mound of each 1 1/2 ft.

Subdivision Sp. N S R 9 E.

Continued.

Chains

North pt. Pers. 28 + 29
 var. 12 + 48. E.

Over level land

40.00 Set a granite stone 12 x 8 x 8 ins. 8 ins. in the
 ground for $\frac{1}{4}$ Sec. Cor. marked $\frac{1}{4}$ on
 N. face, dug pits 18 x 18 x 12 ins. N. & S of
 stone, $5\frac{1}{2}$ ft. dist. and raised a mound
 of earth $1\frac{1}{2}$ ft. high $3\frac{1}{2}$ ft. base alongside,
 from which

Armsquite 6 ins. diam. Cro. N 46° W. 1200 lks. dist.
 marked $\frac{1}{4}$ S. R. J.

Armsquite 6 ins. diam. brs. N 29° E. 136 lks. dist.
 marked $\frac{1}{4}$ S. R. J.

48.00 Wash 50 lks. wide, course N. E.

80.00 Set a granite stone 14 x 10 x 8 ins. 10 ins.
 in the ground for Cor. to Secs. 20. 21. 28 + 29,
 marked with 2 notches on S and 4 notches
 on E edges, dug pits 18 x 18 x 12 ins.

Subdivision Op. 18 SR 9 E.

Continued.

(Chairs)

in each Sec. $5\frac{1}{2}$ ft. dist. and raised a mound of earth 2 ft. high $4\frac{1}{2}$ ft. base alongside.

Land level, good grass

Soil 1st + 2^d. rate

Timber, scattering mesquite & some brush.

East on a random line bet. Secs. 21 & 28
 Fav. $12^{\circ} 48' E.$

One level land.

40.00 Set temporary $\frac{1}{4}$ Sec. cor.

80.14 Intersect N & S line 31 lko. South of the Cor. to Secs. 20, 21, 28 & 29, then on Sec. $89^{\circ} 47'$ W on a true line bet. Secs. 21 & 28, with same cor.

40.07 Set a granite stone $10 \times 8 \times 8$ ins. $\frac{1}{2}$ ins. in the ground for $\frac{1}{4}$ Sec. Cor. marked $\frac{1}{4}$ on N face, dug pits $18 \times 18 \times 12$ ins. E & W of stone, $5\frac{1}{2}$ ft.

Subdivision Sp. 18 SR 9 E.

Continued.

Chains

dist. and raised a mound of earth
 $1\frac{1}{2}$ ft. high, 3 ft. base, alongside, from which
 A mesquite 10 ins. diam. brs. S. 43° W. 98 lks. dist.
 marked $\frac{1}{4}$ S. B. J.

A mesquite 8 ins. diam. brs. S. 70° W. 58 lks. dist.
 marked $\frac{1}{4}$ S. B. J.

80.14 The Cor. to Secs. 20, 21, 28 & 29.

Land level, good grass

Soil 1st & 2^d, sate.

Timber, some few mesquites.

North bet. Secs. 20 & 21

Var. $12^{\circ} 48' E.$

Over level land.

13.00 Wash 20 lks. wide, course N. E.

40.00 Set a Granite Stone $14 \times 6 \times 6$ ins. 10 ins.
 in the ground for $\frac{1}{4}$ Sec. Cor. marked $\frac{1}{4}$

Subdivision Sp. 18 SR 9 E.

Continued,

Chains.

on N. face, dug pits $18 \times 18 \times 12$ ins, $4 \frac{1}{2}$ ft. dist, of stone, $5 \frac{1}{2}$ ft. dist, and raised a mound of earth $1 \frac{1}{2}$ ft. high $3 \frac{1}{2}$ ft. base along side,

53. $\frac{1}{5}$ Road from Otter's Ranch to Tucson, Course N. E. & S. W.

77. 50 Wash 15 lks. wide, Course S, 80° E.

80.00 Set a granite stone $14 \times 10 \times 8$ ins. 10 ins in the ground, for Cor. to Secs 16, 17, 20 & 21, marked with 3 notches on S. and 4 notches on E edges, dug pits $18 \times 18 \times 12$ ins. in each Sec. $5 \frac{1}{2}$ ft. dist, and raised a mound of earth 2 ft. high, $4 \frac{1}{2}$ ft base along side, from which

A Mosquito 12 ins. diam. bro. N 89° W. 20 lks. dist, marked S 18 SR 9 E. S 17 B. J.

A Mosquito 10 ins. diam., bro. S 79° E. 24 lks. dist, Marked S 18 SR 9 E. S 21 B. J.

A Mosquito 4 ins. diam. bro. S 16° E. 152 lks. dist. Marked S 18 SR 9 E. Sec. 21 B. J.

Subdivision Sp. 18 S. R. 9 E.

Continued

Chains.

Amesquite 10 ins. diam bro. S 9° E. 167 1/2 No. dit.

Marked S 18 S. R. 9 E. S 21 13, 5.

Land level, good grass.

Soil 1st & 2^d, rate.

Timber scattering Mesquite & some brush.

By observations taken this day
I find the magnetic variation to be
12° 48' E.

Cast on a random line bet. Secs. 16 & 21

Var. 12° 48' E.

Over level land.

40.00 bet temporary 7/4 Sec. cor.

44.00 Road from Otero's Ranch to Tucson
Course S 80° W. & et. E.

2/9 9/1 Intuscut N. & S. line at 27 1/2 M. South of

Subdivision Sp. 18 S R 9 E.

Continued.

Grass

The Cor. to Secs. 15, 16, 21 & 22, then down
S 89° 48' W. on a town line bet. Secs. 16 & 21, with
same cat.

39.96 Set a granite stone 4 x 8 x 6 ins. 10 ins. in the
ground for 1/4 Sec. Cor. marked 14 on N.
face. Aug pits 18 x 18 x 12 ins. E. & W. of
stone 5 1/2 ft. dist. and raised a mound
of earth 1 1/2 ft. high 3 ft. base alongside.

79.91 The Cor. to Secs. 16, 17, 20 & 21
Land level. Good Grass
Soil 2^d rate
Timber, Beating mesquites

North bet. Secs. 16 & 17.
Far, 12° 48' E.

Over level land.

9.00 Wash 15 lks. wide, Course E.

Subdivision Sp. 18 SR 9 E.

Continued.

Chains,

- 14.00 Wash 15 lks. wide, course S. 80° E.
- 40.00 Set a granite stone $14 \times 10 \times 6$ ins., 10 ins. in the ground for $\frac{1}{4}$ Sec. Cor., marked $\frac{1}{4}$ on N. face, dug pits $18 \times 18 \times 12$ ins. N & S of stone $5\frac{1}{2}$ ft. dist. and raised a mound of earth $1\frac{1}{2}$ ft. high $3\frac{1}{2}$ ft. base alongside.
- 61.50 Road or big trail, course S. E., leading to the field in S. E. Cor. of Sec. 16.
- 80.00 Set a granite stone $16 \times 12 \times 10$ ins., 11 ins. in the ground for Cor. to Secs. 8, 9, 16 & 17, marked with 4 notches on S & E. edges. dug pits $18 \times 18 \times 12$ ins. in each Sec. $5\frac{1}{2}$ ft. dist. and raised a mound of earth 2 ft. high $4\frac{1}{2}$ ft. base alongside.
- Land level, 1 Good grass
Soil 2^d rate.
- Timber, scattering mesquite end of line.

Subdivision Sp. 18 S R 9 E.
Continued.

Chairs

East on a random line bet. Secs. 9 & 16.
Yaw. $12^{\circ} 48' E.$

Over level land.

40.00 Set temporary $\frac{1}{4}$ Sec. Cor.

80.22 Intersect N. & S. line at 13 lks. North of the
Cor. to Secs. 9, 10, 15 & 16, thence I run
 $N. 89^{\circ} 53' W.$ on a true line bet. Secs. 9 & 16.
with same var.

40.11 Set a granite stone $16 \times 12 \times 10$ ins. in the
ground for $\frac{1}{4}$ Sec. Cor. marked $\frac{1}{4}$ on all faces,
dug pits $18 \times 18 \times 12$ ins. E & W of stone, $5\frac{1}{2}$ ft. deep,
and raised a mound of earth $1\frac{1}{2}$ ft. high, $3\frac{1}{2}$ ft.
base alongside.

80.22 The Cor. to Secs. 8, 9, 16 & 17.

Plain level. Good grass.

Soil 2^d. rate.

No timber.

Subdivision Sp. 18 S R 9 E.

Continued.

Chains

North bet. Secs. 8 & 9

"Var. $12^{\circ} 48'$ E.

Own level land.

40.00 Set a granite stone $12 \times 12 \times 11$ ins. 8 ins. in the ground for $\frac{1}{4}$ Sec. Cor. marked $\frac{1}{4}$ on N. face dug pits $18 \times 18 \times 12$ ins. N & S of stone $5\frac{1}{2}$ ft. dist. and raised a mound of earth $1\frac{1}{2}$ ft. high, $3\frac{1}{2}$ ft. base alongside.

47.00 Wash 20 lks. wide, Course S 80° E.

80.00 Set a granite stone $14 \times 12 \times 12$ ins. 10 ins. in the ground for Cor. to Secs. 4, 5, 8 & 9, marked with 5 notches on S, and 4 notches on E. edges, dug pits $18 \times 18 \times 12$ ins. in each Sec. $5\frac{1}{2}$ ft. dist and raised a mound of earth 2 ft. high $4\frac{1}{2}$ ft. base alongside. From which 4 mesquite bins, diam. brs N. 18° W. $3\frac{1}{2}$ lks. dist. marked S. 18 S. R 9 E S. 5 T 3, 5.

Sub-division Sp. 18 S. R. 9 E.

Continued,

Chains.

Armesquite 8 ins. diam. bro. N 25° E. 120 lks. dist.
marked S 18 S. R. 9 E. S. 4 B. J.

Armesquite 8 ins. diam. bro. S 53° E 143 lks. dist.
marked S 18 S. R. 9 E. S. 9 B. J.

Armesquite 8 ins. diam. bro. S 58° W. 208 lks. dist.
marked S 18 S. R. 9 E. S. 8 B. J.

Land level. Good Grass
bail 2^d rate

Timber, scattering mesquite N. end of line.

East on a random line bet. Secs. 4 & 9
Var. 12° 48' E.

Over level land.

40.00 Set temporary 1/4 Sec. Cor.

79.81 Intersect N & S line at 21 lks. N of the
Cor. to Secs. 3, 4, 9 & 10, then go down
N 89° 51' W. on a true line bet. Secs. 4 & 9,

Subdivision Sp. 18 S. R. 9 E.

Continued.

Chains,

with same var.

39.91 Set a granite stone $14 \times 10 \times 10$ ins. 10 ins. in the ground for $\frac{1}{4}$ Sec. cor. marked $\frac{1}{4}$ on N. face, dug pits $18 \times 18 \times 12$ ins. E. & W. of stone, $5\frac{1}{2}$ ft. dist. and raised a mound of earth $1\frac{1}{2}$ ft. high, $3\frac{1}{2}$ ft. base alongside - from which a mesquite 6 ins. diam. brs. $S 44^\circ E. 136$ Ws. dist. marked $\frac{1}{4}$ S. B. 5.

No other trees within limits.

49.81 The Cor. to Secs. 4, 5, 8 & 9.
 Land level, Good grass,
 Soil 2^d. rate
 Timber, scattering mesquite.

North on a random line bet. Secs. 4 & 5,
 var. $12^\circ 48' E.$

Subdivision Twp. 18 S. R. 9 E.

Continued.

Chains,

Low level land.

- 6.50 Wash 10 lks. wide, Course N. E.
 26.00 " 12 lks. " " N 70° E.
 37.50 " 15 lks. " " N 80° E.
 40.00 Set temporary 1/4 Sec. cor.
 57.61 Intersect N boundary of township at
 96 - lks. W. of the cor. to Secs. 4, 5, 32 & 33,
 which is a granite stone 16 x 12 x 8 ins.
 firmly set in the ground, marked with
 4 matches on the E and 2 matches on Wedges,
 with pits 18 x 18 x 12 ins. in each Sec. 57 ft.
 dist. and mound of earth 1 ft. high 4 ft. base
 alongside, from which
 A mesquite 8 ins. diam. brs. S. 69° E. 11 lks. dist.
 marked T 18 S. R 9 E. Sec 4 B. J.
 A mesquite 4 ins. diam. brs. S. 43° E. 55 lks. dist.
 marked T 18 S. R 9 E. Sec. 4 B. J.
 A mesquite 10 ins. diam. brs. S 32° W. 33 lks. dist.
 marked T 18 S. R 9 E. Sec. 5 B. J.

Subdivision Sp, 18 S R 9 E.

Continued.

Chambers,

A Mesquite 12 ins. diam. bro. S 35° W, 16 7/8 lks. dist.
Marked 5 18 S. R 9 E Sec. 5 T 3. S.

Thence I run

S. 0 - 56' W. on a two line bet. Secs. 4 & 5,
with same var.

17.61 Set a granite stone 12 x 8 x 6 ins. 8 ins. in
the ground for 1/4 Sec. Cor. marked 1/4 on
N. face, dug pits 18 x 18 x 12 ins. N. & S. of stone 5 1/2 ft.
dist. and raised a mound of earth 1 1/2 ft. high,
3 1/2 ft. base alongside, from which
A mesquite 6 ins. diam. bro. S 9° W. 49 lks. dist.
Marked 1/4 S. T 3. S.

A mesquite 12 ins. diam. bro. S 44° W. 149 lks. dist.
Marked 1/4 S. T 3. S.

57.61 The Cor. to Secs. 4. 5. 8 & 9.
Land level, good grass
Soil 1st & 2nd rate.
Timber, scattering Mesquite.

October 1st 1886.

Subdivision Twp. 18 S. R. 9 E.

Continued.

Mains.

From the Cor. to Secs. 5, 6, 31 & 32, on
the S. boundary of Twp. which is a post
4 ins square, firmly set in the ground, marked,
T. 18 S. 6, 32 on N. E.

R. 9 E. S. 5 on S. E.

T. 19 S. 6 on S. W. and

S. 31 on N. W. faces, with 5 notches
on E and 1 notch on W. edges, with
pits 18 x 18 x 12 ins, in each Sec. 5 ft. dist.
and mound of earth 2 ft. high 4 ft. base
around post. Thence I run
North bet. Secs. 31 & 32,
Var. $12^{\circ} 48' E.$

Over level land.

40.00 Set a granite stone 12 x 8 x 6 ins. 8 ins, in
the ground for $\frac{1}{4}$ Sec. Cor. marked $\frac{1}{4}$ on
W. face, dug pits 18 x 18 x 12 ins, N & S of
stone 5 ft. dist, and raised a mound of

Subdivision Sp. 18 S. R. 9 E.

Continued

Chains

each 1 1/2 ft. high 3 1/2 ft. base alongside,
 80.00 Set a post 4 ft. long 4 ins. square, with marked
 stone 12 ins. in the ground for Cor. to Secs.

29, 30, 31 & 32, and marked

T 18 S. S 29 on N. E

R 9 E. S. 32 on S. E

S 31 on S. W. and

S 30 on N. W. faces with 1 notch
 on S and 5 notches on E edges from which

A mesquite 8 ins. diam. bro. N 26° W. 150 lks. dist.

Marked T 18 S. R. 9 E. S 30 B. J.

A mesquite 6 ins. diam. bro. N 8° E. 144 lks. dist.

Marked T 18 S. R. 9 E. S 29 B. J.

A mesquite 6 ins. diam. bro. N 59° E. 174 lks. dist.

Marked T 18 S. R. 9 E. S 29 B. J.

No other trees within limits.

Land level, Good grass

Soil 2^d rate.

Subdivision Sp. 18 S R 9 E.
Continued,

Chains, *Pinna*, some few *Mesquite* at N. end of line.

Castanea random line bet. Secs. 29 & 32,
Var 12° 48' E.

- 40.00 Set temporary $\frac{1}{4}$ Sec. Cor.
- 80.04 Intersect N & S line at 21 lks. S of the
Cor. to Secs. 28, 29, 32 & 38, thence down
S 89° 51' W on a true line bet. Secs. 29 & 32,
with same var.
- 40.02 Set a post 3 ft. long 3 ins. square, with marked
stone 12 ins. in the ground for $\frac{1}{4}$ Sec. Cor.
Marked $\frac{1}{4}$ S. on N. face Aug pits 18 x 18 x 12 ins.
E & W of post, 5 $\frac{1}{2}$ ft. dist and raised a mound
of earth 1 $\frac{1}{2}$ ft. high 3 $\frac{1}{2}$ ft. base around post,
from which
A *Mesquite* line, diam. bro. N 60° W 163 lks. dist.
Marked $\frac{1}{4}$ S, 13, D.

Subdivision 3p. 18 SR 9 E.

Continued.

Chains.

A mesquite 4 ins. diam bro. N 45° W, 152 ft. dist.
Marked $\frac{1}{4}$ S. B. S.

80.04 The Cor. to Secs. 29, 30, 31 & 32,
Land level - Good grass
Soil 2nd rate
Timber: Reattening Mesquite.

West on a ran down line bet. Secs. 30 & 31
"Av. 12° 48' E.

Even level land

40.00 Set temporary $\frac{1}{4}$ Sec. Cor.

87.60 Intersect West boundary of township
at 72 ft. N. of the Cor. to Secs. 25, 30, 31 & 36,
which is a volcanic stone 16 x 12 x 10 ins.,
firmly set in the ground, with 1 notch on S,
and 5 notches on N. edges, with sets
18 x 18 x 12 ins. in each Sec. 5 ft. dist. and

Subdivision Twp. 18 S R 9 E.

Continued.

Chains

mound of earth 2 ft. high $4\frac{1}{2}$ ft. base alongside,
from which

A Mesquite 8 ins. diam. bro. S 12° W. 239 lks. dist.
marked T 18 S. R. 8 E. S 36 B. 2.

A Mesquite 6 ins. diam. bro. S 9° W. 187 lks. dist.
marked T 18 S. R. 8 E. S 36 B. 2

A Mesquite 6 ins. diam. bro. S 8° E. 205 lks. dist.
marked T 18 S. R. 9 E. S 31 B. 2.

A Mesquite 5 ins. diam. bro. S 64° E. 237 lks. dist.
marked T 18 S. R. 9 E. Sec. 31 B. 2.

Thence run

N 89° $32'$ E on true line bet. Secs. 30 & 31 with
same error

47.60 Set a Quartzite stone $14 \times 12 \times 8$ ins. 10 ins. in the
ground for $\frac{1}{4}$ Sec. Cor. marked $\frac{1}{4}$ on N face,
dug pits $18 \times 18 \times 12$ ins. E & W of stone 5 ft. dist. and
raised a mound of earth $1\frac{1}{2}$ ft. high $3\frac{1}{2}$ ft. base
alongside, from which

Subdivision Sp. 18 S R 4 E.

Continued.

Chains
 A Mesquite 4 ins. diam. bro. N 48° E 50 lks. dist.
 marked 1/4 S. 13. 27

A Mesquite 6 ins. diam. bro. S 70° W. 131 lks. dist.
 marked 1/4 S. 13. 27

87.60 The cor. to Secs. 29, 30, 31 and 32
 Sand level, Good Grass
 Soil 2^d. rate
 Timber, scattering Mesquite.

North bet. Re co. 29 & 30.

Var. 12° 48' E.

Low level land

15.00 Old trail. course E & W.

24.00 Wash 30 lks. wide course E.

36.50 " 20 lks. " " E.

40.00 Set a granite stone 15 x 8 x 5 ins, 10 ins. in
 the ground for 1/4 Sec. Cor. marked 1/4 on W. face.

Subdivision 3p. 18 S. B. 9. E

Continued

Chains

dug pits $18 \times 18 \times 12$ ins. No S of stone, $5\frac{1}{2}$ ft. dist. and raised a mound of earth $1\frac{1}{2}$ ft. high $3\frac{1}{2}$ ft. base alongside. From which
 A Mesquite 8 ins. diam. brock 59° E. 83 Lks. dist. marked $\frac{1}{4}$ S. B. J.

A Mesquite 3 ins. diam. brock 81° E. 76 Lks. dist. Marked $\frac{1}{4}$ S. B. J.

80.00 Set a granite stone $14 \times 10 \times 8$ ins. 10 ins. in the ground for Co. to Secs. 19, 20, 29 & 30. marked with 2 notches on S and 5 notches on E edges. dug pits $18 \times 18 \times 12$ ins. in each Sec. $5\frac{1}{2}$ ft. dist. and raised a mound of earth $2\frac{1}{2}$ ft. high $4\frac{1}{2}$ ft. base alongside.

Land level, Good grass

Soil 2nd rate.

Timber Scattering Mesquite.

Subdivision Sp. 18 S R 9 E.

Continued.

Chains

East on a random line bet. Secs. 20 & 29
var 12° 48' E.

40.00 Set temporary 1/4 Sec. Cor.

66.00 Wash 30 lks, wide course N, E.

79.89 Intersect at S. line 13 lks. S of the cor. to Secs
20, 21, 28 & 29. Thence I run

S 89° 55' W. on a true line bet. Secs. 20 & 29,
with same var.

39.95 Set a post 3 ft. long 3 ins. square with
marked stone 12 ins. in the ground for 1/4 Sec
cor, marked 1/4 on N face. dug pits 18 x 18

12 ins E & W of post, 5 1/2 ft. dist. and raised
a mound of earth 1 1/2 ft. high 3 1/2 ft. base
around post, from which

A mesquite 4 ins diam, br. W 50 lks dist.
marked 1/4 S. B. J.

A mesquite 8 ins. diam br. S. 86° E. 148 lks. dist.
marked 1/4 S. B. J.

Subdivision Op. 18 SR 9 E.

Continued.

Chains.
79.89

The Cor. to Secs. 19, 20, 29 & 30.

Land level, Good Grass

Soil 2nd rate

Timber, Scattering Mesquite.

West on a random line bet. Secs. 19 & 30.

Var. $12^{\circ} 48' E.$

Over level land.

40.00 Set temporary $\frac{1}{4}$ Sec. Cor.63.00 Road from Otis's Ranch to Tucson, course
 $N 70^{\circ} E$ & $S 40^{\circ} W.$ 94.56 Intersect West boundary of Swornick at
105 lks. N. of the Cor. to Secs. 19, 24, 25 & 30,
which is a granite stone $15 \times 12 \times 8$ ins. firmly
set in the ground, marked with 2 notches
on S and 4 notches on the N. edges, with
pits $18 \times 18 \times 12$ ins. in each Recs. $5\frac{1}{2}$ ft. dist.

Subdivision Sp. 18 SR 9 E.

Continued.

Chains,

and mound of earth 1 1/2 ft. high 3 1/2 ft. base alongside, from which
 a mesquite 6 ins. diam. bro. S 26° W. 275 lks. dist.
 marked T 18 S R 8 E. S 25 T 3, J.

A mesquite 7 ins. diam. bro. S 20° E 200 lks. dist.
 marked T 18 S R 9 E. S. 30 T 3, J.

A mesquite 10 ins. diam. bro. S 41° E. 310 lks. dist.
 marked T 18 S R 9 E S 30 T 3, J.

Thence run

N 89° 22' E on a true line bet. Secs. 19 & 30
 with curve var.

54.56 Set a granite stone 14 x 8 x 6 ins. 10 ins.
 in the ground for 1/4 Sec. Cor. marked 1/4
 on N. face, dug pits 18 x 18 x 12 ins. E & W.
 of stone 5 1/2 ft. dist. and raised a mound
 of earth 1 1/2 ft. high 3 1/2 ft. base alongside.

94.56 The cor. to Secs. 19, 20, 29 & 30.

Land level. Good grass.

Subdivision Sp. 18 SR 9 E.

Continued.

Chairs,

Soil 2nd. rate

Timber, some few Mosquito at West end of line.

North bet. Secs. 19 & 20.

"W. 12° 48' E.

Open level land.

- 22.00 Road from Otter's Ranch to Tucson, Course N 70° E & S 70° W.
- 40.00 Set a granite stone 14 x 9 x 5 ins. 10 ins. in the ground for $\frac{1}{4}$ Sec. Cor. marked $\frac{1}{4}$ on W. face, dug pits 18 x 18 x 12 ins. N & S. of stone, $5\frac{1}{2}$ ft. dist. & raised a mound of earth $1\frac{1}{4}$ ft. high, $3\frac{1}{4}$ ft. base along side. from which
- A Mosquito 4 ins. diam. brs. S 39° E. 33 lks. dist. marked $\frac{1}{4}$ S. T. 3. 5.
- A Mosquito 4 ins. diam. brs. S 16° E. 61 lks. dist. marked $\frac{1}{4}$ S. T. 3. 5.
- 80.00 Set a granite stone 15 x 10 x 6 ins. 10 ins. in the

Subdivision Op. 18 S. R. 9 E.

Continued.

Chains.

ground for Cor. to Sec. 17, 18, 19 & 20,
marked with 3 notches on S and 5 notches
on E, edges, dug pits 18x18x12 ins. in
each Sec. 5 1/2 ft. dist. and raised a
mound of earth 2 ft. high 4 1/2 ft. base
along side; from which
a Mesquite 4 in diam. brod. 7/16 in. 52 lbs. dist.
Marked T 18 S. R. 9 E. S 19 B. 7.
No other trees within limits.

Land level. Good grass
Soil 2nd rate

Timber Scattered Mesquite.
October 2^d 1886.

East on a random line bet. Secs. 17 & 20
4 av. 120 48' E.

One level land.

40.00 Bet temporary 1/4 Sec. Cor.

Subdivision Sp. 18 SR 9 E.

Continued.

- Chain No. 51.50 Wash 20 lks. wide, course at 80° E.
- 71.50 Same wash 20 lks. wide, course $S 80^{\circ}$ E.
- 80.18 Intersect at old line at 2 $\frac{1}{2}$ lks. South of the Cor. to Secs. 16, 17, 20 & 21, thence I run $S 89^{\circ} 49' 11''$ on a true line bet. Secs. 17 & 20 with same var.
- 40.09 Set a granite stone $15 \times 10 \times 6$ ins. 10 ins. in the ground for $\frac{1}{4}$ Sec. Cor. marked $\frac{1}{4}$ on N. face, dug pits $18 \times 18 \times 12$ ins. E & W of stone, $5\frac{1}{2}$ ft. dist. and raised a mound of earth 12 ft. high, $3\frac{1}{2}$ ft. base along side.
- 80.18 The Cor. to Secs. 17, 18, 19 & 20.
Land level, good grass
Soil 2 $^{\text{d}}$. rate.
Timber, scattering mesquite.

West on a random line bet. Secs. 18 & 19.
Var. $12^{\circ} 48' E.$

Subdivision T₁₀, R₁₈ S₁₂ E.

Continued.

Chasms,

Over level land

40.00 Set temporary 1/4 Sec. Cor.

101.54 Intersect West boundary of T₁₀, at
 1350 kts. N. of the Cor. to Secs. 13, 18, 19 & 24,
 which is a granite stone 18 x 10 x 8 in. firmly set
 in the ground, with 3 notches with ledges,
 with pits 18 x 18 x 12 in. in each Sec. in
 5 1/2 ft. dist. and mound of earth 2 ft. high
 4 1/2 ft. base alongside, from which
 a mesquite 7 in. diam. brs. N 11° W. 7 1/4 kts. dist.
 Marked T 18 S. R 8 E S 13 B. J.

A mesquite 6 in. diam. brs. S 6° E. 251 kts. dist.
 Marked T 18 S. R. 9 E. S 19 B. J.

A mesquite 8 in. diam. brs. S 7 1/2° W. 208 kts. dist.
 Marked T. 18 S. R 8 E. S 24 B. J.

Thence I run

N 89° 14' E, on a true line bet. Secs. 18 & 19
 with corner bar.

Subdivision Twp. 18 SR 9 E.

Continued.

Corners.

- 61.52 Set a granite stone $15 \times 8 \times 8$ ins, 10 ins. on the ground for $\frac{1}{4}$ Sec. Cor. marked $\frac{1}{4}$ on N face, dug pits $18 \times 18 \times 12$ ins E & W of stone $5\frac{1}{2}$ ft. dist, and raised a mound of earth $1\frac{1}{2}$ ft. high $3\frac{1}{2}$ ft. low alongside, from which a Mesquite tree, diam. bro. S. 20° W, 64 lks. dist, marked $\frac{1}{4}$ S, B, A.
- A Mesquite tree, diam. bro. N. 10° E. 89 lks. dist marked $\frac{1}{4}$ S, B, J.

- 101.54 The Cor. to Secs. 17, 18, 19 & 20.
 Level land, good grass
 Soil 2^d rate
 Timber, scattering Mesquite.
-

North bet. Secs. 17 & 18
 Fav. 12° $48'$ E.

Over level land

- 11.75 Wash 15 lks wide cause, E.

Subdivision Sp. 18 SR 9 E.

Continued,

Chains.

19.20 Wash 18 lks. wide, Course E.

32.00 Wash 20 lks. " " E.

40.00 Set a granite stone 15 x 6 x 6 ins. 10 ins.
in the ground for $\frac{1}{4}$ Sec. Cor. marked $\frac{1}{4}$
on W. face, dug pits 18 x 18 x 12 ins. at S of
stone 5 $\frac{1}{2}$ ft. dist, and raised a mound of
earth 1 $\frac{1}{2}$ ft. high 3 $\frac{1}{2}$ ft. base alongside
from which

A mesquite 10 ins. diam. brs $S 82^{\circ} W$, 141 lks. dist.

Marked $\frac{1}{4}$ S, 13 J.

A mesquite 4 ins. diam. brs $N 72^{\circ} W$, 180 lks. dist.

Marked $\frac{1}{4}$ S, 13 J.

54.00 Old trail course E-W.

56.00 Wash 8 lks. wide, Course E.

59.50 " 10 lks " " E.

60.00 " 50 lks " " E.

80.00 Set a granite stone 20 x 10 x 8 ins. 15 ins.
in the ground for cor. to Secs. 7, 8, 17 & 18,
marked with 4 notches on S and 5 notches on

Subdivision Sp. 18 S R 9 E.

Continued.

Grains.

E. edges, dug pits 18x18x12 ins. in each Sec. 5 1/2 ft. dist. and raised a mound of earth 2 ft. high 4 1/2 ft. base alongside, from which

A mesquite 6 ins. diam. bro. S 71° W. 270 lks. dist. marked S 18 S. R 9 E. S. 18 B. J.

A mesquite 8 ins. diam. bro. N 6° E. 254 lks. dist. marked S 18 S. R 9 E. S. 5 B. J.

A mesquite 4 ins. diam. N 45° E. 240 lks. dist. marked S 18 S. R 9 E. S. 5 B. J.

A mesquite 5 ins. diam. bro. N. 74° E. 176 lks. dist. marked S 18 S. R 9 E. S. 8 B. J.

Land level, Good grass.
Soil 2^a rate

Timber, Reattung Mesquite.

East on a random line bet. Secs. 8 & 17.
Var 12° 48' E.

Subdivision 3p, 1882 9 E.

Continued.

Chains,	
	Over level land,
40.00	Set temporary $\frac{1}{4}$ Sec. Cor.
58.50	Trail course N.W. & S.E., leading to field in S.E. cor. Sec. 16.
80.11	Intersect N & S line at 14 Chs. North of the Cor. to Secs. 8, 9, 16 & 17, thence I run at $89^{\circ}54'$ W. on a true line bet. Secs. 8 & 17, with narrow cut.
40.06	Set a granite stone 15x10x8 ins., 10 ins. in the ground for $\frac{1}{4}$ Sec. Cor., marked $\frac{1}{4}$ on N. face, dug pits 18x18x12 ins. E & W of stone $5\frac{1}{2}$ ft. dist. and raised a mound of earth $1\frac{1}{2}$ ft. high $3\frac{1}{2}$ ft. base along side.
80.11	The cor. to Secs. 7, 8, 17 & 18. Land level, good grass, Soil 2 ^d rate Timber, scattering Mesquites.

Subdivision Sp, 18 SR 9 E.

Continued.

Chains.

West on a random line bet. Secs. 7 & 18
Tav. $12^{\circ} 48' E$.

Over level land.

30.50 Wash 30 lks, wide, Course S, E.

40.00 Set temporary $\frac{1}{4}$ Sec. Cor.

96.00 Wash 50 lks, wide, Course N. E.

108.90 Intersect West Bdy. of Sp. at 70 lks. N of the Cor.
to Secs. 7, 12, 13 & 18, which is a granite stone $18 \times 10 \times$
8 ins, firmly set in the ground and marked with 4
notches on S, and 2 notches on N, edges, from which
Armesquite 8 ins diam, bro, $N 58^{\circ} W$, 102 lks. dist,
Marked $\frac{1}{4}$ 18 S, R, 9 E, Sec 12 B. T.

Armesquite 10 ins. diam bro $N 8^{\circ} E$ 135 lks. dist,
Marked $\frac{1}{4}$, 18 S, R 9 E, Sec 7 B. T.

Armesquite 12 ins, diam, bro, $S 51^{\circ} E$ 188 lks. dist,
Marked $\frac{1}{4}$ 18 S, R, 9 E Sec. 18 B. T.

Armesquite 10 ins, diam, bro, $S 28^{\circ} E$, 70 lks. dist
Marked $\frac{1}{4}$ 18 S, R 9 E. Sec. 18 B. T.

Subdivision Sp. 18 SR 9 E.

Continued.

Chains,

Thence down

N89° 06' E, on a true line bet. Secs. 7 & 18,
with same var.

68.90 Set a granite stone 14 x 8 x 6 ins, 10 ins, in the ground
for 1/4 Sec. Cor. marked 1/4 on N. face, dug pits
18 x 18 x 12 ins. E & W of stone, 5 1/2 ft. dist. and raised
a mound of earth 1 1/2 ft. high 3 1/2 ft. base along
side. From which

A mesquite 4 in diam, bro. S 78° W. 50 lks, dist.

Marked 1/4 S. T. 3. E.

A mesquite 10 ins. diam bro. S 10° E 1 1/2 lks, dist.

Marked 1/4 S. T. 3. E.

108.90 The Corner Secs. 7, 8, 17 & 18.

Land level, good grass

Soil 2nd Class.

Timber, Scattering Mesquite.

Subdivision 3^d, 18 S R 9 E.

Continued.

Chairs.

North bet. Secs. 7 & 8

over level land, Var. 120 48' E.

32.00 Trail course W. S. E. and runs to field in S. E. Cor. Sec. 16.

35.50 Wash 30 lks. wide course N. E.

40.00 Set a granite stone 13 x 10 x 8 ins. 9 ins. in the ground for $\frac{1}{4}$ Sec. Cor. marked $\frac{1}{4}$ on N. face, dug pits 18 x 18 x 12 ins. N. S. of stone 5 $\frac{1}{2}$ ft. dist. and raised a mound of earth 1 $\frac{1}{2}$ ft. high 3 $\frac{1}{2}$ ft. base alongside, from which a Mesquite 4 ins. diam. bro. S. to E. 16 $\frac{1}{2}$ lks. dist. marked $\frac{1}{4}$ S. T. 3. J.A Mesquite 4 ins. diam. bro. S. 34° W. 157 lks. dist. marked $\frac{1}{4}$ S. T. 3. J.80.00 Set a granite stone 18 x 10 x 8 ins. 12 ins. in the ground for Cor. to Secs. 5, 6, 7 & 8, marked with 5 notches on S & E. edges, dug pits 18 x 18 x 12 ins. in each Sec. 5 $\frac{1}{2}$ ft. dist. and raised a mound grade 5 ft. high 4 $\frac{1}{2}$ ft. base alongside, from which a hackberry 18 ins. diam. bro. N 32° E. 23 lks. dist.

Subdivision Sp. 18 S. R. 9 E.

Continued

Chains,

marked S. 18 S. R. 9 E. S 5 T. 3. J.

A mesquite 6 ins. diam. bro. S 3° E. 42 lks. dist.

marked S. 18 S. R. 9 E. S 8 T. 3. J.

A mesquite 7 ins. diam. bro. N 67° W. 220 lks. dist.

marked S. 18 S. R. 9 E. S 4 T. 3. J.

A mesquite 6 ins. diam. bro. N 26° W. 207 lks. dist.

marked S. 18 S. R. 9 E. S 6 T. 3. J.

Land level, Good grass

Soil 2nd rate.

Pine scattered mesquite.

East on a random line bet Secs. 5 & 8.

Yac. 12° 48' E.

Over level land,

40.00 bet temporary 1/4 Sec. Cor.

80.06 Interset at S. line at 16 lks. South of the
Cor. to Secs. 4, 5, 8 & 9, then run

Subdivision Op. 18 SEC 9 E.

Continued.

Corners.

S. 89° 53' W. on a true line bet. Secs. 5 & 8,
with curve var.

40.03 Set a post 3 ft. long 3 ins. square, white marked
stone 12 ins. in the ground for $\frac{1}{4}$ Sec. Cor. Marked
 $\frac{1}{4}$ S on N face, dug pits 18 x 18 x 12 ins. E & W of
post, 5 $\frac{1}{2}$ ft. dist. and raised a mound of
earth 1 $\frac{1}{2}$ ft. high 3 $\frac{1}{2}$ ft. base around post.

From which

A Mesquite 8 ins. diam. brs. N 84° E. 200 lks. dist.
Marked $\frac{1}{4}$ S. & B. N.

A Mesquite 6 ins. diam. brs. S $\frac{1}{6}$ ° W. 181 lks. dist.
Marked $\frac{1}{4}$ S. & B. N.

80.06 The Cor. to Secs. 5, 6, 7 & 8.

Land level. Good grass

Soil 2nd rate

Timber, scattering Mesquite.

Subdivision Tp. 18 S R 9 E.
Continued.

Chains

Set on a random line bet. Sec. 60 & 7
Var. $12^{\circ} 48' E.$

Crow level land:

11.00 Wash 30 lks. wide course $N 80^{\circ} E.$

14.00 Wash 20 lks. wide course S. E. and runs
into last wash. 1 Ch. South.

40.00 Set temporary $1/4$ Sec. cor.

47.00 Wash 20 lks. wide course S. $80^{\circ} E.$

116.02 Intersect West boundary of township at
206 lks. North of the Cor. to Sec. 1. 6. $7 + 12$ which
is a granite stone $20 \times 10 \times 8$ ins. firmly set in
the ground, marked with 5 notches on the
S. and 1 notch on the N. edge, with pits
 $18 \times 18 \times 12$ ins. in each Sec. 5 ft. dist. and
mound of earth 2 ft. high, 4 ft. base
along side. From which
A mesquite 6 ins. diam. brs. S $18^{\circ} W.$ 36 lks. dist.
Marked T. 18 S. R 8 E. S 12 13 T.

Subdivisions Sp. 18 S. R. 9 E.

Continued

Quins.

A mesquite 6 ins. diam, brs, N 82° E. 36 lbs. diet.
 marked J 18 S. R 9 E S 6 B. T.

A mesquite 8 ins. diam. brs, N 47° W. 1 1/2 lbs. diet
 marked J 18 S. R 8 E. S 1 B. T.

A mesquite 6 ins. diam brs, N 61° W. 250 lbs. diet.
 marked J 18 S. R 8 E S 1 B. T.

Then I run

N 88° 59' E on true line bet. Secs. 6 & 7
 with same out.

76.02 Set a granite stone 15 x 10 x 8 ins. 10 ins. in
 the ground for 1/4 Sec. Cor. marked 1/4 on N. face,
 dug pits 18 x 18 x 12 ins. E & W of stone, 5 1/2 ft. diet,
 and raised a mound of earth 1 1/2 ft. high
 3 1/2 ft. base along side, from which

A mesquite 10 ins. diam, brs, S 24° E. 130 lbs. diet,
 marked 1/4 S. B. T.

A mesquite 8 ins. diam, brs, S 43° W. 203 lbs. diet,
 marked 1/4 S. B. T.

98
Subdivision Op. 18 SR 9 E.

Continued.

Chairs,

116.02

The Cor. to Secs. 5, 6, 7 & 8

Land level. Good grass
Soil 2^d. rate.

Timber, scattering Mesquite.

North on a random line bet. Secs. 5 & 6
Var. $12^{\circ} 48' E.$

On level land,

00.40 Wash 30 lks. wide, Course East.

11.00 " 15 lks. " " S. $70^{\circ} E.$

38.00 " 10 lks. " " S. $80^{\circ} E.$

40.00 Set temporary $\frac{1}{4}$ Sec. Cor.

52.18 Intusset North boundary of Township at
136 lks. West of the Cor. to Secs. 5, 6, 31 & 32

which is a post 4 ins. square, firmly set
in the ground. Marked

P 17, S. S. 32 on N. E.

Subdivision Sp. 18 S R 9 E.

Continued.

Chairs.

R. 9. E. S 5 on S. E.

F 18 S. S. 6 on S. W. and

S. 31 on N. W. faces, with 5 matches on the S and 1 match on the W. eaves, with pits 18x18x12 ins. in each Sec. 5 1/2 ft. dist. and mound of earth 2 ft. high 4 1/2 ft. base around posts. Thence I run

S 1° 30' W on a true line bet. Secs. 5 & 6, with same var.

12. 18 Set a bentonite stone 12x10x8 ins. 8 ins. in the ground for 1/4 Sec. Cor. marked 1/4 on N. faces, dug pits 18x18x12 ins. N & S of stone 5 1/2 ft. dist. and raised a mound of earth 1 1/2 ft. high, 3 1/2 ft. base along side, from which
- A Mesquite 6 ins. diam. brs. S 11° E. 124 lks. dist. marked 1/4 S. B. J.
- A Mesquite 8 ins. diam. brs. S. 27° E. 200 lks. dist. marked 1/4 S. B. J.

Subdivision Sp. 16 S R 9 E.

Continued.

Chains.

57.18

The Cor. to Secs. 5, 6, 7 & 8

Land level, good grass,
Soil 2nd rate.

Timber, scattering Mesquite.

October 3rd 1886.

General Description.

This township contains a large amount of fine farming and grazing land and is covered with a growth of nutritious grasses, — but without irrigation the land is of no use for farming purposes.

Dr. Russell has a well 175 feet deep which furnishes an

General Description, cont.

abundant supply of water for
stock purposes,

At present he has only a small
wooden house, but intends erecting
substantial buildings.

The township is covered with
a scattering growth of mesquite
and Palo Verde timber.

George Roskrige

U. S. Deputy Sec^{ry}

For final oaths, see,
Book No 15.

102
BOOK 887
OFFICE U. S. Surveyors General,

Tucson, Arizona,

March 27th. 1888.

The foregoing Field Notes of the
Surveys of subdivision Lines of
Township 18 South, Range 9 East,
Of the Gila and Salt River Base and
Meridian Arizona, executed by George J.
Roskrige, U. S. Deputy Surveyor. under his con-
tract of the 5th. of March 1886,
having been critically examined and
the necessary corrections and explan-
ations made, the said Field Notes and
the surveys they describe are hereby
approved.

John Wise
U. S. Surveyor General.