

BOOK 962

Book No. 2.

A

No. 962

Field Notes

BOOK 962

OF THE SURVEY OF THE

Subdivision Lines

-OF-

Township *20 S* Range *30 E.*

Gila and Salt River Base and Meridian

ARIZONA. No. 962

By *Walter B. Meib.* D.S.

Under contract dated *May 15th 1884.*

Survey commenced *June 22nd 1884.*

Survey completed *June 28th 1884.*

296

INDEX.

BOOK 962

1A

Township 20 South, Range 30 East,

Gila and Salt River Meridian.

6	101	5	74	4	65	3	38	2	19	1
99	98		72		54		36		18	
7	96	8	70	9	52	10	34	11	16	12
94	92		69		50		33		14	
8	90	17	67	16	49	15	31	14	12	13
8	86		65		47		29		10	
	85	20	64	21	46	22	28	23	8	24
	82		63		45		26		6	
	81	29	60	28	43	27	25	26	5	25
	78		59		42		23		3	
	76	32	57	33	39	34	21	35	1	35

Referring the lines to the pages of the field notes.

1B

BOOK 962

For preliminary oaths &
description of instrument
see Book, No 1

Survey commenced June 22nd 1884
Survey completed June 28th 1884

T. 20 S. R. 30 East

10

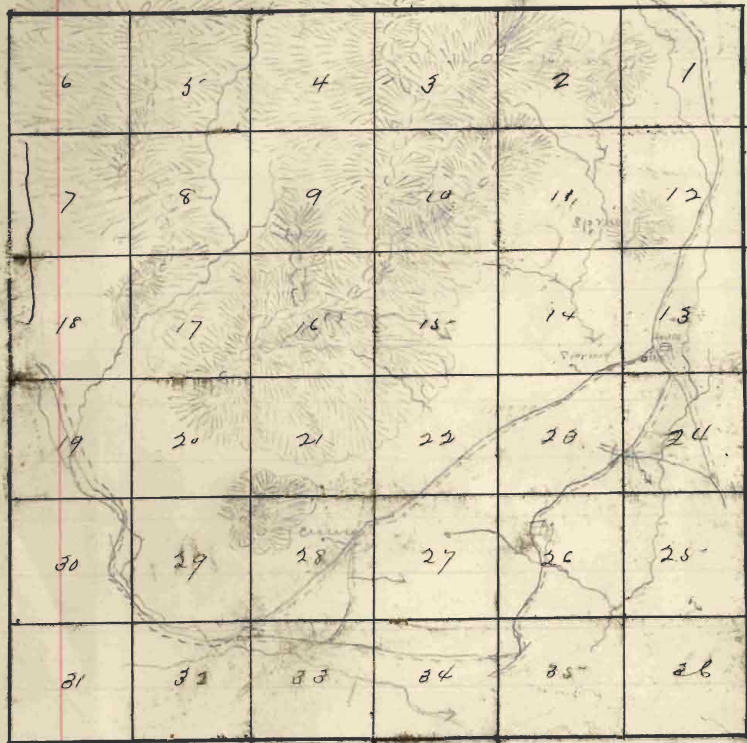

to be used in Book no. 20

Subdivision T. 20 S. R. 30 East

Ch's

From

^{4th stand}
The cor to sees 35^{and} 36
on the 4th stand Parallel
South which is

A Granite Stone 14+8+8 in
firmly set in the ground
marked D.C. with 1 notch on
E & 5 notches on N. edges. a pit
dug N.E. & W. of same & end of each
along side
run

North let-see's 35^{and} 36
Va 12:48⁰

4.00

On Cor/A folks made les S.E

40.00

Set a post 3 ft Long 3 in
square, with marked stone 12
in in the ground for 14
see Cor. marked 14 on
N. fact. dug pits 18+18

Subdivision T 20 S R. 30 East

Ch^o + 12 in N. 45. of post 5 1/2 ft dist and raised a mound of earth 1 1/2 ft high 3 1/2 ft base ~~alongside~~ around post.

80.00 Set a Post 4 ft long 4 in square, with marked stone 12 in. in the ground for Cor & Sec's 25, 26, 35^{and} 36. Marked T. 20 S. S. 25 on N.E. R. 30 E. S. 36 on S.E. S. 35 on S.W. and S. 36 on N.W. faces, with 1 notch on S.E. edge, dug pits 18+18+12 in. in each sec. 5 1/2 ft dist, and raised a mound of earth. 2 ft high 4 1/2 ft base around post

Subdivisions 9. 20 S. P. 30, E.

ch
Land slightly rolling
Soil 3rd rate
Good grass.

East on a random line at sec's 25^{and} 26
Ta 12° 48' E

40.00
43.00
Set temporary 1/4 sec cor
Small beuiga has 7.3 ch
distant

80.16
Intersect E. By of T^p 14
lbs South of cor to sec's
26-30, 31^{and} 36. which is
a Limestone ~~7~~ 10 + 8 ms
family set in the ground
marked, with 1 notch on
S. ^{and} 5 notches on N. edges
with pits dug in each sec

Subdivisions T. 20 S. R. 30 E

his and mound of earth raised
alongside.

Thence down

189° 54' W. on true line lot
see 25^{and} 36. with same rd.

40.05-

Set a Post 3 ft long 3 ins
square, with marked, stone
12 ins in the ground for 14
see cor marked 14 S. on N. face
dug pits 18x18x12 ins. E. & W.
of post, 5 1/2 ft dist; and
raised a mound of earth 1 1/2
ft high 3 1/2 ft base, around
Post.

80.10

The cor to see 25, 26, 35 & 36.
Land Slightly Rolling
Soil. 3rd class.
Good Graz

Subdivisions T. 20 S. R. 30 E

Chain

North let see 25^{and 26}
 Pa 12° 48' E

4.00

Arroyo. 38 lks wide to S.W.

40.00

Set a Post - 3 ft - long 3 in
 square. with - marked stone
 12 in in the ground for 14
 sec cor. marked 14 S on W
 face, dug pits 18 + 18 + 12 in
 N. + S of post - 6 1/2 ft. dist.
 and raised a mound of earth -
 1 1/2 ft high 3 1/2 ft base
 around post.

80.00

Set a Post - 4 ft - long 4 in
 square. with - marked stone
 12 in in the ground for
 the cor see 23. 24. 25^{and 26}
 marked T. 20 S. S. 24 on N. E.
 R 30. E. S. 25 on S. E. S. 26 on S. W.

Subdivisions T-20 S. Q. 30 E.

chains and, sec. 23 on N. W. faces,
 with 2 notches on S^o & 1 notch
 on E. edges, dug pits 18" x 18"
 + 12 ins in each sec 5' 12 ft-
 dist- and raised a mound
 of Earth, 2 ft high 4 1/2 ft-
 base around posts.
 Land. Slightly Rolling
 Soil. 3rd rate -
 Good Grass

East on a random line
 bet sees 24^{and} 25

Var. 12° 48' E

20.00

Quincy pass N. about -
 9 chains dist

28.00

Dry arroyo 60 lbs wide
 bet S. & our rolling valley

Subdivisions T20 S. Q. 30 E

40.00	Set a temporary 14 sec cor
58.00	Road bears N. W. + S. E.
60.00	Point of ridge bears N.
80.16	Intersect E. By T _p 16 th S. of cor to see's 19.24 25 ^{and} 30. which is a granite stone 8+8 ins set firmly in the ground marked with 2 notches on S. + 4 notches on N. edges. with pile-dug in each see. + mound of earth raised alongside. Thence down S 89° 53' W on a true line bet sees 24 ^{and} 25. same va
40.08	Set a Malpais stone 12+10+6 ins. 8 ins in the ground for

Subdivisions T. S. R. S. E.

Chs
 1/4 sec cor. marked 1/4 on
 N. face. dug pits - 18 + 18 + 12
 ins E. & W. of stone 5-1/2 ft-
 dist and raised a mound
 of earth 1 1/2 ft- high 3 1/2 ft-
 base alongside

S. 16

The cor to sec's 23, 24, 25 ^{and} 26
 Land. Rolling ^{and} level
 Soil, 3rd rate
 Good Soil
 Scattering oak

North lot sec's 23 ^{and} 24

Va 13° 10' E

33.50

Road runs N. E. + S. W.

40.00

Set a post - 3 ft long 3 ins
 square with marked stone
 12 ins in the ground for 1/4 sec

Subdivisions T20 S. R. 30 E

Chs

Cor. marked "CSow N. face
dug pits - 18+18+12 ins
N. S. of Post 3 1/2 ft. dist.
and raised a mound of
earth 2 1/2 ft high 3 1/2 ft.
base around post.

80.00

Set a Post - 4 ft long 4 ins square
with marked stone 12 ins on
the ground for the cor & sees
13, 14, 23 ^{and} 24, marked T20
S. R. 30 on N. E. R. 30 E S 24
on S. E., 1, 23 on S. W., & see
14 on N. W. face, with 3 notches
on S. & 1 notch on E edge
dug pits - 18+18+12 ins. m.
Each see 3 1/2 ft. dist and
raised a mound of earth -
2 ft high 4 1/2 ft. base around
posts.

Subdivisions T. 20. S. R. 30 E

Chs	Land Shyftth Rolling Soil. 3 rd rate Good Fragm ^g
	East on a random line Int-secs 13 ^{and} 24 To 12.25' E
24.00	Well has N. about 8 chs dist
29.00	Panche' House has N. about 10 chs dist (Camp Price)
31.00	Enter dense oak timber
36.00	Road has N. W + S. E.
40.00	Set a trap - 1/4 sec cor
42.50	Arroyo 60 lbs wide to S. E.
58.00	Leave dense oak ^{has} N. W + S. E.
60.50	Dry wash from old benigna to S + ascend gradually

Subdivisions T₂₀ S R₃₀ E

Obs

79.98

Subsect - E. By T. 14 lbs
 S of cor to sees 18, 18+19+24
 which is a Lava Stone
 16+12 ins firmly set in the
 ground marked with 3 notches
 on N. S. edge, with pits -
 18+18+12 dig in each see ^{5 1/2 ft. dist}
 mound of earth alongside
 Thence S.W.

S 89° 54' N. on a true line N -
 sees 18+24. with same ca

89.99

Set a Granite Stone 12+10+6
 ins. 8 ins on the ground for
 14 see cor marked 14 on
 N. face. from which
 An Cat's denis drain bears S 88° E.
 42 lbs dist. Marked 14 S. B. T

Subdivisions T20 S R. 80 E

Ch
 An Oak 7 mi drain bears
 S 80° W. 23 lks dist.
 Marked 14 S. B. T.
 79.98 The cor to sec 13, 14, 23 & 24
 Land Rolling & Level
 Soil. ^{good} rate.
 Good grass,
 28 Ch's dense Oak Timber,

North lot-see is 13 ^{and} 14
 Va 12° 28' E
 13.00 Road bears N. E + S. W.
 40.00 Set a post 3 ft long 3 mi
 square, with marked stone
 12 mi in the ground for 14 sec
 cor. marked 14 S. W. face
 dug pits - 18 + 18 + 17 mi.
 N + S of the Post - 5' + 4' + 4'

Subdivisions T20 S R. 30 E

Chs 5 1/2 ft dist- and raised
a mound of earth. 1 1/2 ft
high 5 1/2 ft base ~~around~~
around post.

74.00 Ascend hill bars E & W.

80.00 Set a Laca Stone 20 x 15 x 12 in
15. ins in the ground for
the cor. to see 11. 12. 13 ^{and} 14
marked with 4 notches on
S. ^{and} 1 notch on E. edges.
and raised a mound of
stone alongside. Pits -
impracticable.

Land Rolling ^{and} Level
Soil. 3rd val-

Good Grass

June 22nd 1854

Subdivisions T2. S. R. 30 E

- This East on a random line
 at sec. 12^{and} 13
 on 12° 24' E
 ascend
 20.00 Top of mountainous ridge
 200 ft high bears N. E. 48 W. &
 descend.
 34.00 Foot of same bears N. E. S
 40.00 Set a temporary "used
 cor.
 51.00 Enter dense oak bears N. E. S
 57.00 Road bears N. E. S
 64.00 Dry creek 41 lbs wide east
 80.24 Intersect E Big Sp. 34 lbs
 N. of cor to sec 7, 12, 13, ^{and} 18
 which is a granite stone 15 x 4 in
 set firmly on the ground, marked
 with 4 notches on S & 2 Notches

Subdivisions T20 S R. 30 E

Chs

on N. edge, with pits
 18+18+12 ins. in each sec
 5 1/2 ft. dist. ^{and} mound of
 Earth raised alongside
 the road run

N. 89° 45' W. on line bet-
 sec 12 & 13. same run.

40.12

Set a post - 3 ft long 3 ins
 square, with marked stone
 12 ins in the ground for 1/4
 sec cor. marked 1/4 Sec N. face
 dug pits 18+18+12 ins E & W.
 of post. 5 1/2 ft. dist.; and
 raised a mound of earth -
 1 1/2 ft. high 3 1/2 ft. base
 around post.

80.24

The cor to sec 11, 12, 13 & 14
 Land 34 Chs mountains

Subdivisions T20S, R. 30 E

Ch^s Soil, 3rd sec -
 Druce. Timber. 29 ch^s
 Good Grazing

North - 1st sec 11 ^{and 12}
 Va 12^o. 45' E

Ascend along west-slope

8.00 Highest point on slope
 & descend

18.00 Leave foot of ridge N.E. & S.W.

40.00 Set a Post - 3 ft long & 3 in
 square with marked above
 12 in in the 4 round. for 1/4
 sec cor marked 1/40 on N
 face. dug pit - 18 x 18 x 19 in
 N + S. of post. 3 1/2 ft dist.
 and raised a mound of earth

Subdivisions T. 20 S. Q. 30 E.

Chs

1 1/2 ft high 3 1/2 ft base
around post

80.00

Set a post 4 ft long 4 in
square with marked stone
12 ins in the ground for
the cor. Wees 1. 2. 11. 12
marked. T. 20 S. S. 1 on N. E.
Q. 30 E. S. 12, on S. E. S. 11 on S. W.
& Sec. 2 on N. W. face, with
5 notches on S. & 1 notch on
E edge. dug pits - 18 x 18 x 12
ins in each sec 5 1/2 ft -
dirt & raised a mound of
Earth - 2 ft high 4 1/2 ft -
base around post
Land. Rolling -
Soil - 3rd rate
Good frax

Subdivisions T₂ S. R. 30 E

- Chs East on a random line bet-
secs 1 ^{and} 12.
Ta 12° 42' E
- 40.00 Set a temp 14 sec cor
- 52.00 Enter dense oak timber
trans N. t. S
- 64.00 Dry Creek both sides Co. S.
- 68.00 Road trans N. W. ^{and} A. S. E.
- 79.72 Intersect - E. By Tp 2. Chs
S of cor to sec 1. 6. 7 ^{and} 12
which is, a Granitic Stone
~~#2~~ + 13 + 9 ms set firmly on
the ground marked with
5 notches on S & 1 notch on
N. Edge, & mound of stone
raised along side.
Thence Iron
S. 89° 51' W on a true line bet secs

Subdivisions T20 S R. 31 E

Chs

39.86

1 and 12. with same rd
 Set a frame Stone 17+12+9
 ms 11 ms in the ground for
 14 sec cor. marked 14 on
 N. face. dug pits 18+18+12
 ms, E & W. of $\frac{1}{2}$ stone. 6 1/2
 ft dist & raised a mound
 of earth 1 1/2 ft high 3 1/2
 ft base alongside.

79.72

The cor 2 sets 1, 2, 11 & 12
 Land. Polling ^{and} Leach
 Oil. 3rd sale -
 Timber. Deuse oak \$27.72 Chs

Work on a random line at
 sec 1 and 2.

ca 12: 42'E

Subdivisions T₂₀ S. R. 30 E

Obs

- 18.00 Ascend mountain spur
bears S. & W.
- 40.00 Set a temp. "V sec cor
- 49.00 Top of spur 500 ft high
bears N. E & S. W. and descends
- 72.00 Leave foot of spur bears N. S
- 80.20 Intersect N. B₄ T_p. 19th
East of the cor to sec 1. 2
35 and 36. Just established
by me. Thence down
S. 0.8 E on a true line bet sec
1 and 2. with same val.
- 40.20 Set a Granite Stone 13 + 12 + 9th
8 ins in the ground for "V sec
cor marked "V on N. face.
and raised a mound of stone
alongside. Pits impracticable.

Subdivisions T. 20 S. R. 30 E.

Chs

80.20

The cor to sec 5. 1. 2. 11^{and} 1 of
Land. 62.20 Chs mountainous
soil. 8th row.

Down oak timber east 1/2 mile

June 28th 1884,

From the Standard Cor to
sec 34^{and} 35 on the 4th
Standard Parallel South -
which is

A Granite Stone 8-8 ins
firmly set in the ground
marked S.E. with 2 notches on

E & 4 notches on W edge & red stone
georgic.
I run

North let sec 34^{and} 35 -
to 129.20 E

Subdivisions T. 20 S. R. 30 E

Chis

2800 Dry Creek Co. E.

46.00

Set a Post 3 ft long 3 in sq
~~7/8 in~~ with marked stone
 13 in in the ground for 14
 sec cor marked 14 S on W
 face. Aug pile 18 + 18 + 12 in
 N. + S of post. 5 1/2 ft dist.
 and raised a mound feather
 1 1/2 ft high 3 1/2 ft base
 around post.

49.00

Road ker. N. E. + S. W.

56.00

Road ker. E. + W.

80.00

Set a Post 4 ft long in
 square; with marked stone
 12 in in the ground for the
 Cor to sec 26, 27, 34, + 35;
 marked. T. 20 S. R. 30 E on N. E.
 R. 30, E. S. 35 on S. E. S. 34 on S. W.

Subds T. 20 S R. 30 East
Chs

and Dec 27 on N.W. faces,
with 1 notch on S. & 2 notches
on E. edges, dug pits - 18+18
+12 ins; in each sec. 3 1/2
ft dist. and raised a mound
of earth. 2 ft high 4 1/2 ft
base around post.
Land Slightly Rolling
Soil. 3rd rate.
Good Grazing

East on a random line at
secs 26 ^{and} 35

To 120.48' E

9.00

Road near N. 1/2 S

40.00

Set a trap - 1/4 sec cot

73.30

On crest of hills, 1/2 mile to S.W.

Subdivisions T20 S R 30 E.

Chip

- 7984 Intersect. N. T. S. line 22
 lbs N. of post to sees 25. 26. 35
 and 36. Thence down
 T. 89° 51' N. on a true line
 bet sees 26^{and} 35 same cal
- 39.92 Set a Post 8 ft long 3 ins
 square, with marked stone
 12 ins on the ground for "K" see
 Cor marked "K" on N. face
 dug pits - 18 + 18 + 12 ins. E
 and W. of post 5' 1/2 ft dist
 and raised a mound of
 earth 4' 1/2 ft high 8' 1/2 ft
 dia around post,
- +
 7984 The cor to see 26. 27. 34 +
 35.
 Land. Rolling
 Soil. 2nd + 3rd rate
 Good grass

Subdividing T. 20. S. R. 30 E

Chs

North lot sees 26^{and} 27

Ta 12° 12' E

40.00

Set a Malpais Rock. 18 1/2
+ 7 ins. 12 ins in the ground
for 1/4 sec cor marked
1/4 on W. face. dug pits -
18 + 18 + 12 ins. N + S of stone
5 1/2 ft dist., and raised

49.00

a mound of earth 1/2 ft
high 3 1/2 ft base alongside
Dry Wash. from Ciencija Co
S E

54.00

Ciencija has west about
18 chains distant

80.00

Set a Post - 4 ft - long 4 ins
square. with marked stone
12 ins in the ground for the
Cor to sees 22. 23. 26^{and} 27

Subdivisions, T. 20 S., R. 30 E.

Ch's

marked. T. 20 S., S. 23 on T. & E.
 R. 30 E., S. 26 on S. & E. S. 27 on S. W.
 a sec. 22 on T. W. faces, with
 2 notches on S. & E. edges,
 dug pits 18+18+12 ins. Am.
 each sec 5 1/2 ft. dist., and
 raised a mound of earth
 2 ft high 4 1/2 ft. base
 around post.
 Land slightly rolling
 Soil, 3rd sub:
 Good grazing.

East on a random line bet
 sec 23 ^{and} 26.

To 12° 12' E

23.00

House base South about 22

Subdivision S. 20 S. R. 30 E.

Chⁱ

40.00

41.50

80.24

Chⁱ dist. cienega in
same place flows south-
set temp - 1/4 sec cor.

Road bears N.E. ^{and} S.W.
Intersect N. ^{and} S lines

32 lbs S of cor to sec^s
23. 24. 25 & 26. Thence I run
S. 89° 46' N. on true line bet
sec^s 23 ^{and} 26. same val.

40.12

Set a Granite Stone 14+10+7
ins. 9 ins in the ground for
1/4 sec cor. marked 1/4 cor
N. face. dug pit 18+18+12
ins E & W. of stone 570 ft.
dist. and raised a mound

of earth 11 1/2 ft high
37 1/2 ft base alongside
the ^{the} lines 22-23-24-25
Land. Slight rolling

8024

Subdividing T. 20 S. R. 30 E

Chs

Soil. ~~1st~~ 2nd sale

Good Soil

North lot sec 22 ^{and 23}

To 120. 12"E

40.00

Set a Post 8 ft long 3 in
square with marked stone
12 in. in the ground for 1/4
sec cor. marked 1/4 S on
N. face. dug pits 18+18
+12 in. N. E. S of post
5 1/2 ft dist. and raised
a mound of earth 1 1/2 ft
high 3 1/2 ft base around
post-

41.00

Road runs N 60° E & S 60° W

80.00

Set a Granite Rock. 20+13+12 in

Subdividing T. 20 S R. 30. E

Chp

15' in in the ground for
the cor. to sec's 14, 15, 23
and 23, marked with
3 notches on S. and 2
notches on E. edges, dug
pits 18" x 18" x 12" in each
sec. 542 ft dist. and raised
a mound of earth 2 ft
high 4' x 4' base alongside
land. Nearly level
Soil. ~~3rd~~ -

Good fracq

East on a random line bet.
secs 14 & 23.

Da 12° 28' E

40.00 - Set a temp - 1/4 sec cor

Subdivisions T. 20 S. R. 30 E

Chs

- 44.00 Spring and tank of water 3 chs
St.
- 49.00 Road. bears N. E. + S. W.
- 80.20 Intersect N. T. S. line 60 lbs
South of the cor to secs 13, 14
23^{and} 24. Thence I run
S 89° 34' W, on a true line bet.
secs 14^{and} 23. same val.
- 40.10 Set a Post 3 ft long 3 ins square
with marked stone 12 ins on
the ground for '14 sec cor.
marked '14 S. on N. face.
dug pits - 18 + 18 + 12 ins. E. & W.
of post. 3 1/2 ft dist. and
raised a mound of earth
1 1/2 ft high 3 1/2 ft base
around post.
- 80.20 The cor. to secs 14, 15, 22 & 23

Subdivisions T. 20 S R. 31 E

Chs

Land Slightly Rolling
Soil. 3rd rate
Good Fozing

North Pt. sec 14 ^{and} 15
Va 12° 28' 8"

Ascend Gradually

- 40.00 Set a Granite Stone 12+12+7 ins
8 ins in the ground for 74 sec
cor; marked 74 on N. face.
and raised a mound of
stone alongside. Pits impracticable
- 60.00 Enter Dense Oak and ascend
mountain
- 75.00 Ravine 40 lbs ~~into~~ Sec E.
- 80.00 Set a Granite Rock. 14+12+5 ins
9 ins in the ground for

Subdivisions T. 20 S. R. 30 E.

Chs

The cor to sec's. 10, 11, 14 ^{and} 15
marked with 4 notches on S.
^{and} 2 notches on E. edge.

From which

An Oak 20 mi drain bears $N 30^{\circ} E$
28 lks dist. Marked. T. 20
S. R. 30. E. S. 11. B. J.

An Oak. 14 mi drain bears $S 45^{\circ} E$.
56 lks dist. Marked. T. 20. S.
R. 30. E. S. 24. B. J.

An Oak. 11 mi drain bears $S 6^{\circ} W$.
18 lks dist. Marked T. 20. S.
R. 30 E. S. 15. B. J.

An Oak. 11 mi drain bears $N 34^{\circ} W$.
28 lks dist. Marked. T. 20 S
R. 30, E. S. 10. B. J.

Land. 20 ch's mountainous. 60 rolling
Soil. 4th rate.

Timber. 20 ch - diverse oak.

Subdivisions T. 20 S. R. 31 E

Chs

East on a random line
bet sees 11 ^{and} 14,
ba. 12° 24' E

Descend

36.00

Leaves dense timber
N. + S

40.00

Set temp - 1/4 sec cor
and leaves slope of mountain

75.00

Arroyo 30 lbs wide to S.

76.00

Spring 6 chs N.

79.94

Intersect N. + S line, 20 lbs
S. of cor. to sees 11, 12, 13 + 14
Thence down.

S 89° 51' W. on a true line bet
sees 11 ^{and} 14, same cor

89.97

Set a Granite Rock, 15 + 12 + this
10 ins in the ground for 1/4 sec
cor. marked 1/4 on N face.

Subdivisions T. 20 S R. 30 E

chs

dug pits 18+18+12 m. E. & W.
of stone, 5 1/2 ft. dia., and
raised a mound of earth -
1 1/2 ft high 3 1/2 ft base

7994

along side
M. G. No. 2es 10-11-14-15
Land, 40. chs mountainous
Soil. Rocky 3rd. red

Good forest

Dense oak 50. chs

North Mt. sec 10 ^{and} 11

Va 12° 24' 8"

Ascend gradually

12.00

Ascend mountain spur.

Pass N.E. + S.W.

40.00

Set a Granite Stone 18+12+18 m.

8 m in the ground for 1/4 sec

Subdivisions T20 S. R. 30 E

Chs
 Cor. marked 1/4 on N. face
 and raised a mound of
 stone alongside. Pits
 impracticable. No trees in
 line.

12.00 Top of spur 400 ft high
 bears N. E. & S. W. and descends.

20.00 Set a Gravel Rock, 26 x 13 x 10
 ins. 19 ins in the ground for
 the cor to seeq 2. 3. 10 & 11.

marked with 5 notches on S.

and 2 notches on E. edges.

and raised a mound of
 stone alongside. Pits
 impracticable. From which

An Cat. 12 ins drain bears

N. 64° W. 28 lbs dist. Marked

T20 S. R. 30 E. S. 8. B. T.

Subdivisions T. 20 S. R. 30 E
Chs

No other trees in limits.
Land. Mountainous & very broken
Soil. Stony 4th soil.
Some oak & timber
Good grass

East on a random line Int-
sects 2 and 11.

Val 12° 44' E

Descend

15.00 Dry Creek 20 lbs wide to N.E.

40.00 Set traps - 14 see cov.

57.00 Lean mountainous land.

grass N.E.S

71.00 Dry Creek 24 lbs wide to
S.E.

80.20 Interval N.E.S line 22 lbs

Subdivision N. 20 S. R. 31 E

S. of cor to sees 1. 2. 11 + 12
Therod Iron.

S 89. 51' Now a true line bet-
sees. 2 + 11. with same 20

Set a Granite Stone 20 + 12 + 5
ins. 15 ins in the ground for

1/4 sec cor. marked 74 on
N. face. and raised a mound

of stone alongside. Pile
impracticable. from which

An Oak 13 ins diam has

N. 41° W. 34 lbs diam. marked

1/4 S. B. I. No other trees
within limits

The cor to sees 2. 3. 10 + 11

land 67. Chi Mountainous
Soil. Rocky 8th rate.

Some oak good grass

Subdivisions N. 20 S. R. 30 E.

Pls

Work on a random line
bet sees 2 & 3.

α $12^{\circ} 44' E$

Ascend -

40.00

Set temporary 1/4 sec cor.

53.00

Top of high point of spur
ears N. 1100 ft high & descend

60.46

Intersect N. By of 9p 34
1/4s east of the cor to sees
2.3.34. & 35. just set
by me.

Thence I run

$S. 0^{\circ} 15' E$ on a true line bet
sees 2 & 3. with same α

60.46

Set a Granite Rock, 20 + 13 + 9 in
15 in on the ground for 1/4
sec cor. marked 1/4 on N.
face, and raised a mound

Subdivisions J. 20 S. R. 30 E

Chs

of stone alongside, Pitts
 imperacticable from which
 An Cat 12 mis down here
 S. 82° W. 56 lb dist. marked
 14 S. B. J.

8046

No other here in limits
 the gr 5 lies 2-3-10-11
 Land mountain a broken

Soil - Rocky 4th sale

Druse oak timber

June 24th - 1884.

I carefully examine the adjustments of
 my solar compass today & found
 them correct.

From the ^{stand} ₁ cot to see's 33 + 34 on
 the 4th Stand Parallel South-
 which is, A Granite Stone 10
 + 8 mis, firmly set in the ground
 marked S.B. with 3 notches on

Subdivision I-20 S.R. 30 E

Chs-

E & W edges with pits ^{two} 18+18+12 insN & W of post - 5 1/2 ft dist & mound of earth -
opposite side.
a runNorth lat. sec 33. ^{and 34.}

Ta 12: 20' E

39.24

To S side of creek, Co S. 6., True
Corner being in creek bed. I
set a Granite Stone 18+12+7 ins
10 ins in the ground for witness
cor to 1/4 sec cor, marked N. C.
1/4 on N. side; and dig pits -
18+18+12 ins. N. & S of stone
5 1/2 ft dist and raised a
mound of earth, 1 1/2 ft high, 3 1/2
ft base along side.

41.00

Leave brick Co East

68.00

Road runs E. & W.

80.00

Set a Post 4 ft long 4 ins

Subdivision 920 S.R. 30 E

Chs

square. with marked stone
 12 ins in the ground for the
 cor the cor to sec 27. 28.
 33^{and} 34, marked T20 S
 S. 27 on N.E. R. 30. E. S. 34 on
 S. E. S. 33 on S. W. and S 28
 on N. W. face, with 1 notch
 on S 43 notches on E edge
 dug pits - 18 x 18 x 19 ins. in
 each sec 5 1/2 ft dist. and
 raised a mound of earth -
 2 ft. high 4 1/2 ft. base
 around post.
 Land Slightly Rolling
 Soil. 4th rate.
 Good Grass

Subdivisions T20 S. R. 30 E

Chs

East on a random line bet.
sects 27^{and} 34

To $12^{\circ} 24' E$

40.00

Set a temporary $1/4$ sec cor

79.74

Intersect $N. 15$ line 18 lbs

$N.$ of cor to sec 26-27, 33

834, Thence I run

$N. 89^{\circ} 52' W.$ on a true line

bet sects 27^{and} 34 same cor

39.84

Set a Post. 3 ft long 3 ins
square. with marked stone
12 ins on the ground for $1/4$ sec
cor marked $1/4$ 8 on $N.$ face.
dug pits - 18 x 18 x 12 ins. $E \& W.$
 $N.$ of Post. 5 $1/2$ ft dia and
raised a mound of earth -
1 $1/2$ ft high 3 $1/2$ ft base around
post.

Subdivisions T. 20 S R. 31 E

Chs

7974

The North Secs 27-28-33-34
Land Slightly Rolling
Soil. 3rd rate.
Good grass.

Storkh let sec's 27 ^{and 28}
Va 12; 31' E

37.00

Cross wash. 20 lbs wide to
E.

40.00

Set a Post 8 ft long 8 in
square; with marked stone
12 in in the ground for 1/4
sec cor. marked 1/4 S on N.
face. dug pits 18 x 18 x 12 in
N. ^{and} S. of post. 5 1/2 ft dist.
and raised a mound of
earth. 1 1/2 ft high 3 1/2 ft -
bare around post

Subdivisions S. 20 S. R. 30 E.

Chs

- 48.00 Cicuiga bears west about
12 chains distant
- 52.00 Road bears N.E. & S.W.
- 80.00 Set a Post 4 ft long 4 in
square, with marked stone
12 in on the ground for the
corn holes 21, 22, 27 ^{and} 28.
marked. S. 20 S. S. 22 on
N.E. R 30 E. S 27 on S. E. S. 28
on S.W. ^{and} S. 21 on N.W. faces
with 2 notches on S. ^{and} 3 notches
on E. edge. dug pits - 18 x 18 ft
12 in. in each side. 5 1/2 ft
dial ^{and} raised a mound of
earth, 2 ft high. 4 1/2 ft
base around post,
Land slightly rolling
Soil. ~~good~~ soil
Good fine

Subdivisions J-20 S.R. 308

Chs

East on a random line to
secs 22^{and} 27.
Val 12. 24'E

29.00
40.00
80.20

Road bears N8 + SW.
Set a temporary "4 sec cor
Intersect. N.T.S. line. 14 lds
N. of cor to secs 22. 20. 26 + 27
Thence Iron

N. 89: 64' N. on a true line to
secs 22^{and} 27. same val

40.10

Set a Post 3 ft long 3 ins square
with marked stone. 12 ins in
the ground for "4 sec cor
marked 1/4 SW to face;
dug pits - 18 + 18 + 12 ins. 88 N.
of post. 3 1/2 ft - dist, and
raised a mound of earth -
1 1/2 ft high 3 1/2 ft - base

Subdivisions L 20 S R. 30 E

Chs-

around post.

80.20

The cor lines 21, 22, 27, and 28.

Land Slightly Rolling

Soil. 8th rate.

Good grass

North W-section 21 Aug 22

Ta. 120.21'E

Ascend gradually

22.00

Ascend S. E slope of Chia-
ca-hud. Mountains.

40.00

Set a Granite Rock. 13+12+12
ms. Drive in the ground for 14
sec cot marked 14 on W. face
and raised a mound of stone
alongside; Pils - irrisectioable

80.00

Set a Granite Rock. 15+14+19ms

Subdivisions T20 S.R. 308

Chs

10 ms on the ground for the
 Cor to sees 15, 16, 21 ^{and} 22,
 Marked, with 3 notches on
 S + E. Edges, and raised
 a mound of stones alongside
 Pile impracticable

Land 38 chain's Mountainous
 Soil, Stony ~~at~~ rare

Good grass.

East on a random line bet
 sees 15 ^{and} 22

W 120. 24' E

Ascend

6.00

Arroyo, 20 lbs wide bet S.E.

40.00

Set a temporary 4 sec cor

50.00

Lean slope of mountain

Subdividing T. 20 S. R. 30 E

Chs

Kans N.E. ^{and} S.W.

80.18

Intersect N.E. line 10th N.
of cor to sees 14, 15, 22, ^{and} 23.

Thence I run

N. $89^{\circ} 56'$ W on a true line bet
sees 15 ^{and} 22 same cor.

40.09

Set a Post $3\frac{1}{2}$ ft long 3 in
square, milk-marked about
12 in on the ground for 14
sec cor. marked 14.5 but
N. face, dug pits - 18 x 18
+ 12 in, E. & W. of post - 5' 7 1/2
ft disk and raised a
mound of earth, 17 1/2 ft
high @ 7 1/2 ft base around
post.

80.18

The cor to sees 15, 16, 21 & 23
Land. So. Chs Mountains

Subdivisions T. 20 S. R. 30. E.

Chs

Soil - 3rd soil some rocks
Timber - Scattering oak
Good grass.

North lot sees 15^{and} 16

ascend

Pa 12° 24' E

4.00

Arrowy 24th mile less S. E.

33.00

Racing: 100 lbs mile less 8th ascend mountain

40.00

Set a granite ^{stone} 12 + 10 + 7 ins

8 ins in the ground for '14

see cor. marked '14 on W

face, and raised a mound

of stone also up side. Pits

impracticable from which

A Pinon 9 ins diam bears

S. 13° W. 5-4 lbs dist. marked

'14 S. B. S.

71.00

Top of mountain spur. 900.

Subdivision 9.20 S.R. 308

Chs

It high bears N.E. & S.W. &
 over broken mountain top
 80.00 Set a Granite Stone. 20 x 13 x
 12 ins 16 ins on the ground
 for the cor to see 9, 10, 15 &
 16 marked with 4 notches
 on S & B notches on E.
 edges, and raised a mound
 of stone alongside. Pits
 intractable.
 Land Very Mts & broken
 Soil. Rocky & th-rak-
 Some oak timber.

East on a random line to
 see 10 & 15.

Val 12° 24' E

Subdivisions T₂₀ S₁ R. 30 E

Chs

- 9.00 Descend from mountain
near N. & S.
- 40.00 Set a temporary "C" sec cor^o
- 80.14 Intersect N. & S. line. 40 lbs
South of cor. to sec^s 10-11
14, & 15. Thence, I ran
S. 89° 43' N. on a true line bet-
sec^s 10 ^{and} 15. same cor.
- 40.07 Set a Granite Stone 12+10+7
ins. 8 ins in the ground for
"C" sec cor., marked "C" on
N. face. and raised a mound
of stone alongside. Pits
impracticable, from which
A Pinon 9 ins diam near
S. 13° N. 3-4 lbs dist. Marked
"C" S.B.S. No other trees
within limits

Subdivisions J. 20 S. R. 30 E

Ch's

So. 14 The cor & sec's 9, 10, 15 & 16
 Land Mountainous & broken
 Soil. Rocky & thin
 Some oak & pine

North 1/2 sec's 9 ^{and} 10
 Va 12° 42' E

Along broken summit
 of mountain

38.00 Descend from same bears N. E.
 + S. W.

40.00 Set a Granite Rock. 26 H 3 + 7
 ins., 19 ins on the ground for
 14 sec cor. marked 14 in
 W. fac. from which
 a Pinon 13 ins diam bears N.
 15° 08. 56 lbs dist. Marked 14 S 13.9

Subdivisions J. 20 S. R. 308

Chs

A Pinon 7ms drain base
 Ct. 28° N. 13 lbs dist. Marked
 1/4 S. B. 9

80.00

Set a Granite stone 26" x 3
 + 11" x 9" in the ground
 for the cor to sec 3, 4, 9 & 10
 marked with 5 notches in
 S. & B. notches on E^o edges,
 and raised a mound of
 stone alongside. Pls
 impracticable. No trees
 in limits

Land Mountainous & broken
 Soil. Rocky 4th row.
 Oak & timber

Subdivisions 120 S.R. 30 E

Chs

East on a random line

bet sees 3 + 10

to 12° 36' E

Ascend.

28.00 Top of mountain spur 1100 ft.
high near Mt. S34.00 Descend perpendicular bluff
60 ft high

40.00 Set temp - "1 sec cor.

80.64 Intersect. N + S line. 26 lks
S of cor to sees 2-3-10 and 11
Thence down.S. 89° 49' W. on a true line bet
sees 3 and 10 same cor.40.32 Set a Granite Stone 27+12+4 in
20 in in the ground for "4 sec
cor marked "4 on N. face
from which

Subdivisions T. 20 S. R. 30 E

Ch^o

Am Oak 7 in diam base
Sp. 68° N. 74 lbs dist. Marked
14 S.B.T.

Am Oak 13 in diam base
S. 26° E. 54 lbs dist. Marked
14 S.B.T.

80.64 The cor to sets 3, 4, 9^{and} 10
Land. Mountainous & very broken
Soil. Rocky & thin
Dense Oak timber

North on random line bet. sec 3 & 4,
Ta 12° 20' E

Along N slope of mountain

40.000

Set a temporary 1/4 section

80.20

line - Air Sp
32 lbs N. of cor. to

Subdivisions S. 20 S. R. 50 E

Chs

See 3. 4. 53. and 34, just
set by me.

Then I run

S. 0° 15' W on a true line bet
see 3 & 4. same as

40.26

Set a Granite Stone 24x12x10
ins. 18 ins in the ground for
1/2 see cor. marked 74 on

N. face and raised a
mound of stone alongside
Pts impracticable.

80.26

The cor to see 3. 4. 9 & 10
Land very low & broken
Soil. Rocky & thin soil.
Some oak

June 25th 1884

I carefully examined the adjustments
of my solar compass today & found
them correct.

Subdivision T. 20 S. R. 30 E

Chs

From the Stand - cor 2 -
see's 32 + 33. on the 4th -
stand Parallel South.

which is. A Post 4ft long 4ins square
firmly set in the ground. Marked S. C. T. 20 S. R.
30 E. SW 1/4. See 33 on E. and see.
32. on N. face. with 2 notches on W & 4 notches
on E edges, pits 18 + 18 + 12 ins NE + W of post 3 1/2 - 8 ft
diam - & mound of earth raised around same
drew.

North lat. sec 32 + 33

Ca 12.24'E

40.00

Set a Post - 3ft long 3ins
square. with marked
stone 12 ins in the ground

for 1/4 sec cor. marked
1/4 S on N. face dug pits -

18 + 18 + 12 ins N. E. S of post
5 1/2 ft. diam. & raised

Subdivisions T20 S. R. 30 E
 10

- a mound of earth, $1\frac{1}{2}$ ft. high
 $3\frac{1}{2}$ ft base, around post.
- 48.00 Dry brush 60 lbs wide
 Leo . E.
- 36.00 Road has E. W.
- 64.50 Road .. N.E. + S.W. & ascends
 along South Slope of mtous
 ridges.
- 80.00 Set a Lava Stone 20 x 16 x 2 in
 15 in in the ground for
 the cor to see's 28. 29. 32 + 33
 marked with 1 notch on
 S & 4 notches on E edges.
 and raised a mound of
 stone alongside. Pit -
 impracticable.
- Land. 15.50 this was rough.
 remainder valley

Subdivisions T20 S R. 30 E

Chis

Soil - ~~B²~~ & 4 h. val.
Fair Grass

East on a random line
lat. sec's 28 ^{and 29}
N 12. 24' E

Descent

- 16.00 Leave foot of mountainous
slope near N 8 15' W.
- 18.20 Road near N. E. + S. W.
- 40.00 Set a temporary 1/4 sec cor
Road N 8 15' W.
- 62.00
- 80.20 Intersect - N 15 line 1/4
lbs S of cor to sec's 27. 28
33 + 34. Thence I run
S 89° 04' W on a true line
lat. sec's 28 + 33. same 20

Subdivisions S. 20 S. R. 30 E

Ch's

40.10 Set a Post 3 ft long 3 in
square, with marked stone, 12
in in the ground for, "used
cor. marked "K from W. J. J. J.
dug pit - 18 x 18 x 12 in, E & W
of post - 5 1/2 ft dist. and
raised a mound of earth, 17 1/2
ft high, 3 1/4 ft base, around
post.

80.20 The cor. lines 28, 29, 32 & 33.
Land, 16.00 the mountains
Soil, good soil -
Good fuel,

North - lat. sees 28 and 29
W 12° 28' E
Along mountain slope

Subdivision lines Y 20 S R 30 E

Ch 6

- 40.00 Set a post 3 ft long in square with marked stone 12 ins on the ground for 14 200 cor. marked 1/2 S. on N. face. dug pits 18+18+12 ins. N. & S. of post. 3 1/2 ft dist. and raised a mound of earth 1 1/2 ft. high 3 1/2 ft base around post.
- 46.00 Ascend absolute N 85 W.
- 74.00 Top of mountain spur base N. 85 W. 570 ft high.
- 76.00 Descend. from same
- 80.00 Set a granite stone 17+12+7 ins on the ground for the cor to see 20. 21. 28 & 29. marked. with 2 notches on

Subdivisions T20. S R. 21 East

Chs

S. & 4 notches on \odot edge,
and raised a mound of
stone alongside. Pils
impracticable, from which
An Cast. 13 ms drain bears $N. 10^{\circ} W.$
55 lbs dist. Marked T. 20 S. R. 30 E
S. 20 B. 5.

A Juniper. 24 ms drain bears
S. $78^{\circ} W.$ 26 lbs dist. Marked
T. 20 S. R. 30 E. S 29. B. 5.

No other trees in limits.
Land. Mountainous & broken
Soil. Stony ~~to~~ soil.

Good grass

Subdivisions T. 20 S. R. 30 E

Chs

East on a random line bet
secs 21 ^{and} 28

Pa 12° 24' E

Ascend.

- 4.50 Top of mt spur 600 ft high
cross N.T.S & descend
- 36.00 Enter valley, cross N.E. & S.W.
- 40.00 Set a temp 1/4 sec cor
- 80.23 Intersect - N.T.S line 18 lbs
S. of cor to secs 21, 22, 27 & 28
- Thousand run
S 89° 5' 2" W. on a true line bet
secs 21, ^{and} 22. same cor.
- 40.11 Set a Post 3 ft long 3 in
square with marked stone
12 in in the ground for 1/4
sec cor. marked 748 on N
face. dug pits 18 x 18 x 12 in E

Subdividing T. 20 S. R. 30 E

Chs

& N. of post - 54 ft - dist. &
raised a mound of earth -
1 1/2 ft high 3 1/2 ft - base
around post.

8023

W. 1/4 Secs 20-21-28-29.
Land. 36. Chs mountains

Soil. 3rd sale.

Good grass

North 1/4 Secs 20 and 21
T. 20 S. R. 30 E

Along broken D. N. slope
of mountain spur.

Low divide base E. & N. &
ascend over broken mountains

Set a Granite Stone 26 x 13 x 12
ins. 19 ins in the ground for
1/4 sec cot marked 74 on N. face

18.00

40.00

Subdivisions T. 20 S. R. 30 E

Chs

and raised a mound of stone alongside. Pits intractable,

\$0.00

Set a Granite Stone 17+12+7
ins. 11 ins on the ground for
the cor to sec 16. 17. 20 ^{sub 21}

marked with 3 notches on
S & 4 notches on E edge

and raised a mound of stone alongside. Pits intractable.

Land Mountainous & broken
Soil, Rocky & the soil

Some ^{scall} oak & hickory

East on a random line to sec.
16 and 21.

TA 12:24' E

Subdividing T. 20 S. R. 30. E

chs

Reassembling very broken &
mountainous slope.

41.00

Set a temporary 1/4 sec cor.

80.18

Intersect. At S line. 22 lbs

South of cor. to sec's 15, 16, 21,

and 22. Then I draw

S 89° 57' N on a true line bet.

sec 16 and 21. same 9d

40.09

Set a Granite Stone 18+12+12 in

9 in in the ground for 1/4 sec

cor. marked 1/4 on N face

and raised a mound of stone

alongside. It's impracticable

The cor to sec 16, 17, 20 and 21.

Land Mts & very broken

Soil Rocky & 4th - rate

Scattering oak some grass.

Subdivision G. 20 S. R. 30 E

Chs

Fork let. sec's 16 ^{and} 17
 W 12° 42' E

Over broken & into slope
 ascends.

28.00 Top of mountain 700 ft high
 bears N. W. 58° E. - along same

40.00 Set a Granite Stone 20 + 13 17
 ins 15. ins in the ground for
 14 sec cor. marked 14
 on N. face. from which

An Cut 12 ins diam bears S 30° W.
 42 lbs dist. Marked 14 S. B. J.

An Cut 10 ins diam bears N 22° E
 27 lbs dist. Marked 14 S. B. J.

56.00 Descend slope bears N. W. 58° E.

80.00 Set a Granite Stone 22 + 12 5
 ins. 16 ins in the ground for
 the cor. to sec's S. 9. 16 & 17.

Subdivisions J. 20 S. R. 30 E

Chs

marked with 4 notches on S.
and E. edges, from which
An Oak. 5 in draw bears N.
25° E. 37 lbs dist. Marked J. 20 S.
R. 30 E. S. 9. B. I.

An Oak 5 in draw bears S. 48°
26 lbs dist. Marked J. 20 S. R.
30 E. S. 16. B. I.

An Oak. 12 in draw bears S. 16° W.
44 lbs dist. Marked J. 20 S.
R. 30 E. S. 17. B. I.

An Oak 10 in draw bears N. 16°
W. 32 lbs dist. Marked J. 20 S.
R. 30 E. S. 8. B. I.

Land Mountainous & broken
Soil. Rocky. 4th rate.
Dense Oak

Subdivisions T. 20 S. R. 30 E

Chs

East on a random line bet.
secs 9^{and} 16

Pa 12° 24' E

Ascend.

18.00 Top of mountain spur 800
ft high bears N 15°

40.00 Set benchmarks 1/4 sec cor.

42.00 Descend slope bears N 15° E.

80.26 Intersect N 15° line. 28
lbs N. of cor to secs 9, 10, 15
& 16. Thence I run

N 89° 48' W on true line bet.
secs 9^{and} 16 same as

40.13 Set a Granite Rock 28 + 12 + 7
ins. 21 ins in the ground for
1/4 sec cor. marked 74 on
N. face. from which

Subdivisions T 20 S. R. 30 E

Chs

A Pinon 13 mis drain cross S 40° W
 3' 4 lks dist, marked 74 S. B. J

A Pinon 10 mis drain cross N 17°
 E. 26 lks dist, marked. 74 S. B. J.

80.26

The cor to sec 8. 9. 16 & 17,
 Land. Mts & broken
 Soil. Rocky & sh. pale
 Dense Grass.

North ht sec 8 ^{Aug 9}

70 12° 42' E

Along broken N slope of mountain
 Cañon 5 chs wide to S. W.

19.00

40.00

Set a Granite Rock. 25 + 12 + 12 in
 19 mis in the ground for 74 sec
 cor. marked "4" on N face.
 from which

Subdivisions T. 20 S. R. 30 E

Ch.

An Oak 11 ins diam bears S 12°
N. 31 lbs dist. Marked "4
S. B. T.

An Oak, 9 ins diam bears
S. 18° E. 20 lbs dist. Marked "4 S. B. T.

80.00

Set a Granite Rock 21 + 9 + 7 ins
15 ins in the ground for the
Cov to see if 4, 5, 8 and 9, marked
with 5 notches on S & 4 notches
on E. edge, and raised a
mound stone alongside. Pits
impracticable, from which
A Pin 13 ins diam bears S 12° W.
36 lbs dist. Marked T 20 S. R. 30 E.
S. 9. B. T.

A Pin 8 ins diam bears S 38° W.
48 lbs dist. Marked T 20 S. R. 30 E.
S. 8 B. T.

Subdividing T. 20 S. R. 30. E.

Obs

A Pinon 5 mis drain has N 29° W
 18 lks dist. Marked T. 20 S. R. 30 E
 S. 5. B. S. No. other trees on limits
 Land Mts & very broken
 Soil. Rocky ^{with} rate
 Dense Alt 8 timber

East on a random line 2d
 sec 4 & 9.

N 120.24° E

Ascend

Set temporary 11 x 22 cor.
 intersect N 15. line, 34 lks
 South of cor to sec 3, 4, 9 & 10

Thence I run

S 89.45° W. on a true line 2d
 sec 4 & 9. same 2d

40.00
 80.24

Subdivisions G. 20 S. R. 31 E

Chp

40.17 Set a Granite Stone. 1741314
 ins. 11 ins on the ground
 for 14 sec cor. marked 14
 on N. face, from which
 An Oak 17 ins diam base
 S 13° W. 28 lbs dist. Marked
 14 S. B. J.

An Oak 18.10 ins diam base
 S 41° E. 35 lbs dist. marked
 14 S. B. J.

80.24 The cor to sec 4. 5. 869.
 Land. Mountainous & broken
 Soil. Rocky 4th soil.
 Dense Oak.

Subdivisions T 20 S R. 20 E

Chs

on a random line
North let sees 4 & 5 -
W 12° 45' E

Descend.

40.00 Set a temporary "14 sec
cor.

47.00 Bottom of cañon less S.W.
& ascend.

80.34 Intersect N. Ry Sp. 27 lks
East of cor to see's 4, 5, 32 & 33
just set by me,

Thence draw

S 0° 12' E on a true line let
see 4 & 5. same cor.

40.34 Set a Granite Stone 27 + 12 + 4 in
20 in on the ground for 14
sec cor marked "14 on W
face. From which
An Oak. 13 in diam marks

Subdivision T20 S R. 30 E

Ch-

N. 15° W. 64 lks dist. Marked
"4 S.B. J.

An Oak. 12 ins diam less
N. 64° E. 27 lks dist marked
"4 S.B. J.

8034

The cor to sec's 4, 5, 8 and 9
Land. mts & very broken
Soil. Rocky & thin.
Dense oak.

June 26th 1884.

From the Standard Cor to
sec's 31 & 32. on the 4th -
Standard Parallel South
which is. A Limestone #5
6 to 8 ins firmly set in the
ground. Marked S.B. with 1 notch

Subdivisions T 20 S R. 30 E

Chs

on W. ^{Aug 5} notch on E edge
and mound of stone alongside.

I run

North lot see's 31 ^{Aug 59}

N 12° 24' E.

Over broken land

40.00

Set a post 3 ft long 3 in
square, with marked stone
12 ins in the ground for 74
see cor. marked "14" on W

face, and raised a mound
of small stones, 1 1/2 ft high
3 1/2 ft base around corner
Pit impracticable

50.00

Dry Creek 30 lbs Es. E.

80.00

Set a granite Stone 16 x 12 x 7 in
11 ins on the ground for the
cor to see's 29-30-31 ^{and 32}

Subdivisions T20 S R. 30 E

Obs

marked with 1 notch on S.
 & 5 notches on E. Edge, and
 dug pits - 18+18+12 ins. in
 Each sec 5-12 ft dist; and
 raised a mound of earth - 2 ft
 high 4-12 ft base alongside
 from which

A Pin 9 ins diam bears S 72° E
 70 lbs dist. Marked T20 S. R.
 30. E. S. 32. B. J.

A Pin 14 ins diam bears N. 74° W
 110 lbs dist marked T20 S.
 R. 21. E. S. 30. B. J.

No other trees in limits
 Land Rolling

Soil - 3rd rate -

Good grass

Subdivisions

T. 20 S R. 30 E

Chs

East on a random line to
see 29 ^{and} 32

to 12° 24' E

9.00 Road bears N. 71.5. S.

12.00 Dry Creek, 1.00 ch wide
to S. E. descend over broken
& mts ridges.

40.00 Set a trap 14 sec. cor. is

60.00 Top of ridge bears N. 15

79.84 S. of cor. to see 28, 29, 32, 183

Thence down

S 89° 54' W on a true line to
see 29 & 32. Same to

39.92 Set a lava stone 15 + 14 + 9 ins
10 ins in the ground for 14 sec
cor. marked "4" on N face
dug pits 18 + 18 + 12 ins. P. W.

Subdivisions

T 20 S R. 30 E

Chs

of stone 5' or ft dist; and
 raised a mound of earth -
 1 1/2 ft high 3 1/2 ft base
 along side 29 -

7984

W. to 29 30 31 32
 Land Mountainous & broken
 Soil - Rocky & stony -
 Grass good

Went on a random line to
 sec 30 ^{and} 31

W 12:18'E

Ascend Russell Mountain

40.00

Set a temporary 14 sec cor

76.00

Top of mountain, spur base

A. W. 78.8. & descend

80.42

Intersect W. 24. Sp. 60 lbs

Top cor to sec 25. 30. 31 & 36.

Subdivisions J. 20, S. R. 30. 6.

Chs

Which is
A limestone 15+13+7 ins.
faintly set in the ground, marked
with 1 notch on S. & 5 notches
on N. edge, and mound of
stone raised alongside.

Thence I run

789° 34' East on a true line
to sec. 30 ^{Aug 31} same rd

40.42

Set a Granite Stone, 18+12+7 ins
8 ins in the ground for 14 sec
cor marked 14 on N face, &
raised a mound stone alongside

But impracticable

80.42

The cor to sec 29, 30, 31 ^{Aug 32}
Land. Mts & broken

Soil. Rocky 4th row.
Some scattering oak & pine

Subdivisions of 20 S R 31 E

Chs.

North-ht sees 29 & 30

Td 12: 24' 6"

30.00

Road runs N. W. S. E.

32.20

Along creek to S. E.

40.00

Set a post 3 ft long 3 in
square, with marked stone
12 in in the ground for 14
see cot. marked "14 S on N.

face, dug pits 18 x 18 x 12
in N. W. S. of post. 5 1/2 ft
dick & raised a mound of
earth. 1 1/2 ft high 3 1/2 ft
base, around post.

45.00

Same creek 40 lbs to S. W.

67.00

" " 34 " C. S. E.

88.00

Set a Granite Stone 19 x 12
x 10 in, 12 in in the ground

BOOK 962

Subdivisions T-20 S 430 E

Obs

for the cor trees 19.20
 29 and 30, marked with 2
 notches in. S. & 3 notches
 on E edge, and raised
 a mound of stone alongside
 Pits - impracticable.
 Land Broken & mountainous
 Soil. Stony good soil.
 Good pass

East on a random line
 between 20 & 29

Va 120. 45' E

Over high into mesa

Set a temporary 1/4 sec cor

Ascend mountain spur
 from N 81 S. W.

40.00

60.00

Subdivisions T 20 S. R. 30 E

Chs

- 80.31 Intersect of 15 line & 8 lks
South of cor to sec's 20, 21
28 ^{and} 29. Thence down
S 89° 44' W on a true line
Set sec's 20 & 29 same way
- 40.15 Set a Granite Stone 20 + 16 +
12 in. 15 in on the ground
for 1/4 sec cor. marked "H"
on N. face. dug pits 18
+ 18 + 19 in E. + N. of stone
5-42 ft dist and raised
a mound of earth, 1 1/2 ft
high 3 1/2 ft base along side
- 80.30 The cor to sec's 19, 20, 29
& 30.
Land Mountain up through
Soil 8th & 4th mile.
Some only fair grass

Subdividing T. 20 S. R. 30 E.

Chs

West on a random line bet-
 sees 19 ^{and} 20

to 120.24' E

12.00 Rucker Canyon Road

trans N 71.5. E

18.05 Dry Creek 50 lbs wide Cas
 S. E. & ascend.

40.50 Intersect - offset-line, on
 West. 124. Sp. 52 lbs N of N. to
 to sees 19.24.25 ^{and} 30. which
 is, a Limestone ~~set~~ + 13 + 12 in
 set firmly on the ground
 marked with 2 notches
 on S + 4 notches on N edges.
 a mound of stone alongside.
 Thence. Drive
 N. 89. 15' East - on true line bet-

Subdivisions T 20 S. R 31 E

Ch's

40.50 sees 19 ^{Aug 30.} Same as
 The cor to sees 19-24-25 & 30
 Land. Mountainous & broken
 Soil. Rocky wh. soil.
 Some grass.

40.00 Fork-let sees 19 ^{Aug 20}
 Pa 12° 24' E
 Set a Post-3 ft-long 3 in
 square with marked lines
 12 in on the ground for 1/4
 See cor. marked 1/4 S on
 W face & dug pits 18 x 18
 12 in N of Post-3 1/2
 It dist. raised a mound
 of earth 1 1/2 ft-high 3 1/2
 ft base around post.

Subdivisions T20 S° R. 30 E

Chs

80.00

Set a Granite ^{stone} 16 + 14 + 12 in
 11 in in the ground for the
 Cor to sees 17, 18, 19 & 20
 marked, with 3 notches on
 S° & 3 notches on E edge
 dug pits 18 + 18 + 12 in
 N + S of stone 5' 12 ft dist.
 and raised a mound of earth
 2 ft high 4' 9 ft base
 alongside.
 Land High Rolling prairie
 Soil - 30% sand -
 Good Grass

Back on a random line
 Int-sees 17 ^{and 20.}
 T20 12:24 'E

Subdivision Y 20 S R 30 E

Chs

- 7.00 Enter dense timber tract N. + S
- 16.00 Ascend mountain spur tract N. + S
- 40.00 Set a temp 1/4 sec cor
- 71.00 Top of mountain ridge 900 ft high tract N. + S & descend
- 80.60 Intersect - N & S lines 42 lbs South of the cor to see 16.17. 20 Aug 21. Thence I run. $89^{\circ} 42'$ from a true line set sees 17. Aug 20 same run
- 4030 Set a Granite Stone 16 + 12 + 7 ins. 11 ins on the ground for 1/4 sec cor. marked 1/4 on 76 face. from which An Oaks 16 ins diam tract

Subdivisions T₂ S. R. 30 E

Chs

T₁₇° N. 44° E. dist. Marked
114 S.B. T.

An Oak 10 ins diam bears
S. 12° E. 21 lb dist. marked
114 S.B. T.

80.60

The cor to see 17. 18. 19 & 20
Laud. 64 Chs mountains
Soil. 4 lb soil.

Timber. Dense oak. 73. 60 Chs

Hest on a random line 18
see 18 ^{and} 19.

Va 12° 24' E

Enter dense oak bears 115.

Cavim 100 ft deep. 2.00
Chs side. Co S.W. Spring
of water in same.

3.00

6.00

Subdivisions 'T₂₀ S R 30 E'

Chs

- 40.00 Set temp "4 sec cor.
- 54.00 Road bars N.W. 15.8.
- 61.00 Dry brk 1.00 Chs side
Co S.E.
- 80.24 Intersect. N Big Tp 20 Chs
South - year to sees 13, 18,
19 ^{and} 24, which is
A Limestone + + 4 + 6 in
set. firmly in the ground
marked with 3 notches on
S & N edges. & mound of
stone raised along side
Thence line
S 89° 51' East on a true
line bet. sees 18 ^{and} 19. same cor
- 40.24 Set Post. 3 ft. long 3 in sq
with marked stone 12 in
in the ground for "4 sec cor

Subdivisions T 20. S. R. 31. E

Chs

marked 148 on No face.

from which

An Oak. This claim bears N 44°

E. 26 lbs dist. marked 148 B. J.

An oak. This claim bears N 46° W.

52 lbs dist. Marked 148 B. J.

80.24

The cor to sec's 17, 18, 19 & 20

Land very into broken

Soil. Rocky good soil -

Dense oak timber.

Jan. 27th - 1884

North of sec 17 ^{and} 18

to 12° 45' E

Ascend over into land

2.00

Enter dense oak. bears N 81° 30' W.

28.00

Canton 150 lbs the side less 8 W.

Waters in same

Subdivisions I 20 S R 30 E

Chs

- 40.00 Set a Post 8 ft long 3 mi^s
square with marked steel
12 mi^s in the ground for
1/4 sec cor. marked 1/4^S on
N. face. from which
An Cat. 9 mi^s down bears
N. 72° E. 110 chs dist.
Marked 1/4 S.B. J.
An Cat. 10 mi^s down bears
S 63° E. 120 lds dist. marked
1/4 S.B. J.
- 57.00 Ascend main mountain
bears N. 81° S. W.
- 71.00 Top of spur 600 ft high
bears N. 81° S. W. & ascend
over broken slope.
- 80.00 Set a Granite 28 + 20 + 12 mi^s
21 mi^s in the ground for

Subdivisions T 20 S R. 30 E

Chs

The cor to sees 7. 8. 17 + 18
 marked with 4 notches on
 S + 5 notches on E edges.
 and raised a mound along
 alongside. Pts irrefragably
 sets in deep ravine.
 Land very mountainous & broken
 Soil Rocky & h. soil.
 Dense oak 1/2 - 1/3 mile.

East on a random line
 lat. sees 8 Aug 17.

Ja 12:30' E

Ascend from ravine

24.00

Top of spur 800 ft high

Pass N. 1. S & descend

40.00

Set. temp - 1/4 see cor

Subdivisions T20 S R. 30 E

Chs

- 48.00 Bottom of canon course
South - cascade
- 80.54 Intersect - Pt B line 48 lks
South - Feos to see's S. 9
16, 17. Thence down
S 89° 39' W on a true line
bet sec's 8. and 17 same rd
- 40.27 Set a Granite Stone 20 x 3
+ 7 ins. 15 ins on the ground
for 1/4 sec cor. marked
1/4 on N. face. and raised
a mound stone alongside
Pits impracticable
- 80.54 The cor to sec's 7, 8, 17 + 18
Land. Mts & very broken
soil. Rocky 1/4th way.
Some oak. dense on east
1/2 mile.

Subdivisions T20 S R 30 E

Obs

Hest on a random line

lat. sec 7th 18

Val 12:24'E

Ascend ravine lev S.W.

12.00 Leave ravine cross broken
S.W. slope.

40.00 lat. temp - "4 sec cor.

80.06 Entered W. By 9th 38

Top of cor trees 7.12.13418

which is. A Granite Block
4x10x10 ins, firmly set in

the ground marked with
4 notches on S and 2 notches
on N edge, and mounds
of stone raised alongside.

Thence I run

A. 89° 44' East on a true line

lat. sec 7.1 P. same cor.

Subdivisions T. 20. S. R. 30. E

Chs

- 40.06 Set a granite Stone 19+12+10 in
18 in in the ground for 14 sec
cor. marked 14 on N face
and raised a mound of
stone alongside. Pile
irretrievable. From which
An @ 1/4 mi. 10 in. drain has
S. 34° N. 20 the dist. Marked
14 S. B. T. No structures
in limits.
- 80.06 The col. to sec 7. 12. 13 + 18
Land Mountainous & broken
Soil. Rocky & ch. soil.
Heavy oak

Subdivisions T. 208 R. 30 E

Obs

Storch let-see 7 ^{and} 8

va 12° 62'E

Continue ascent

40.00

Set a Granite Stone 24+131-
12 ins, 18 ins in the ground

for 14 sec cor. marked '14
on W. face. from which

An Oak, 14 ins diam bears

A 26° E. 44 lbs dist. Marked
14 S.B. J.

An Oak, 10 ins diam bears

S. 5-4° N. 62 lbs dist. Marked
14 S.B. J.

69.00

Top of mountain & bears 900
ft high bears N N + S. E.

80.00

Set a Granite Stone 13+1342
ins, 8 ins in the ground for
the cor to see's 5: 6. 7 & 8.

Subdivisions T. 21 S. R. 30 E
Chs

marked with 5 notches on
S ^{and} E. edge and raised
a mound of stone along
side. Pits impracticable
from which

An Oak, 10 ins diam base
S 67° E. 28 lbs dist. Marked
T. 20 S. R. 30. E. S. 8 B. J.

An Oak, 9 ins diam base
S. 42° W. 22 lbs dist. Marked
T. 20 S. R. 30. E. S. 7 B. J.

No other trees in limits,
land. Mts & very broken
Soil. Roctry 4th sub-
dense oak. on parts of
the line

Subdivisions T. 20 S. R. 30 E

Ch

East on a random line bet
secs 5^{and} 8.
Va 12° 42' E

Ascent

- 18.00 Top of spur, 850 ft high
trans N. S. & S. W.
- 22.00 Descend from same
- 40.00 Set temporary 74 sec cor
- 57.00 Bottom of cañon bet S. W &
ascent.
- 80.18 Intersect N. & S line 27 lbs
S. of cor to secs 4, 5, 8 & 9.
Thence I run
S 89° 48' W. on a true line bet
secs 5^{and} 8, same rd
- 46.09 Set a Granite Stone 20x10x6
ins. 15 ins in the ground for 74
sec cor. marked 74 on 76 face

Subdivisions T. 20 S. R. 30 E
Ch^o

and raised a mound of
stone alongside. Pts
impracticable

80.18

The cor to secs 6, 6, 7 & 8
Land. Mountainous & broken
soil. Rocky & thin -
Some heavy oak.

Went on a random line bet -
secs 6 ^{and} 7.

Pa 12°. 42' E

10.00

Descend N.W. slope

40.00

Set a trap - 1/4 sec cor

79.84

Intersect - N. by Sp. 23 N.
of cor to secs 1, 6, 7 & 12
which is
A sandstone 10 + 8 in

Subdivisions T. 20 S. R. 30 E

Chs

firmly set in the ground. marked
with 5 notches on S & 1 notch on N.
Edges & mid stone along side.

Thence I run

N. $89^{\circ} 00' E$. on a true line to

see 6 ~~and~~ 7. same as

39.84

Set a Granite Stone 15 + 15 + 12

ins. 10 ins in the ground for 10

see cor. marked 14 on N.

face from which.

An oak. 6 ins diam bears

N. $38^{\circ} W$. 27 lts dist. Marked

14 S. B. T.

An Oak. 9 ins diam. bears

S. $18^{\circ} E$. 10 lts dist. Marked 14

S. B. T.

79.84

The cor to sees 5-6-7 & 8.

Land, Mt. & broken

Subdivisions T. 20 S. R. 30 E
Chs

Soil. Rocky 4th rate
Dense oak.

North on a random line
Int. sees. 5^{Aug} 6.

To 12° 41' E.

- 16.00 Descend N.W. Slope
- 40.00 Set temp - 1/4 sec cor.
- 80.24 Intersect N. Big Sp. 26
lks east of cor. To sees 5:6.
31. ^{Aug} 32. just established
by me. Thence I run
S 0° 11' E. on a true line
Int-sees 5^{Aug} 6. same cor
- 40.24 Set a Granite Stone 27.412
+ 4 ins. 20 ins on the ground
for 1/4 sec cor. marked

Subdivisions S. 20 S. R. 30 E

Ch

114 on N. face. and
raised a mound of stone
alongside. Pits impracticable

No trap. in limits.
very close 5, 6, 7, 8.

70-24

Land. Mountainous & very

Broken

Soil. Rocky & thin.

Straw oats

June 28th - 1884.

General Description
The South East 1/4 of S. 20 S.
R. 30 E. is nearly level sloping
gradually towards the West,
it is well adapted to grazing
purpose, being plentifully
supplied with water from
numerous small creeks

that rise up in at different points, & afford quite a supply of water.

The S.W. 1/4 is not so well watered but is very good grazing land. The N. 1/2 of the 1/4 is quite Mt. & broken cut up by several very rocky & steep spurs from Mt. It is not so well watered nor does it supply so much grass as S. 1/2. A Road from Queen Cañon crosses the S. 1/2 of 1/4, while several local roads cross it in different directions. There are 2 houses in sec. 13. 26th & 36. The House & Location of applicant: B. W. Merchants in sec 13. Soil about 8th or 9th grade. Grass good.

BOOK 962

U. S. Surveyor General's Office,

Tucson, Arizona, Oct 14 1884

The foregoing Field Notes of the Survey of the

Subdivision Lines of
Tp. 20 South
Range 32 East

Of the Gila and Salt River Base and Meridian, Arizona, execu-

ted by *Walter B. Auld*

Deputy Surveyor, under his contract of the 13th

day of *May*, 1884, having been

critically examined and the necessary corrections and explana-

tions made, the said Field Notes and the surveys they describe
are hereby approved

Rapala Johnson
Surveyor General.