

No. 1031

BOOK 1031

3<sup>rd</sup>

Deputy Surveyor.

T. ----- R. -----

Meridian.

1031

BOOK 1031

# Field Notes

OF

the Subdivision lines of

Township 12 N. Range 5 West

Gila Salt River Meridian, Arizona, California.

BY

S. W. Foreman Deputy Surveyor,

under his Contract of October 14, 1871

Survey commenced January 20, 1872

Survey completed January 22, 1872

Platted,

No. 1031

Copied for Washington,

Transcript sent to Commissioner, March 20, 1872

15 miles

TOWNSHIP 12 N RANGE 5 West MERIDIAN

104031190

BOOK 1031

BOOK 1031

BOOK 1031

This line is supposed  
an account of precipitous  
high rocky peaks

High rocky peaks  
clear part of soil

Rocky mountains

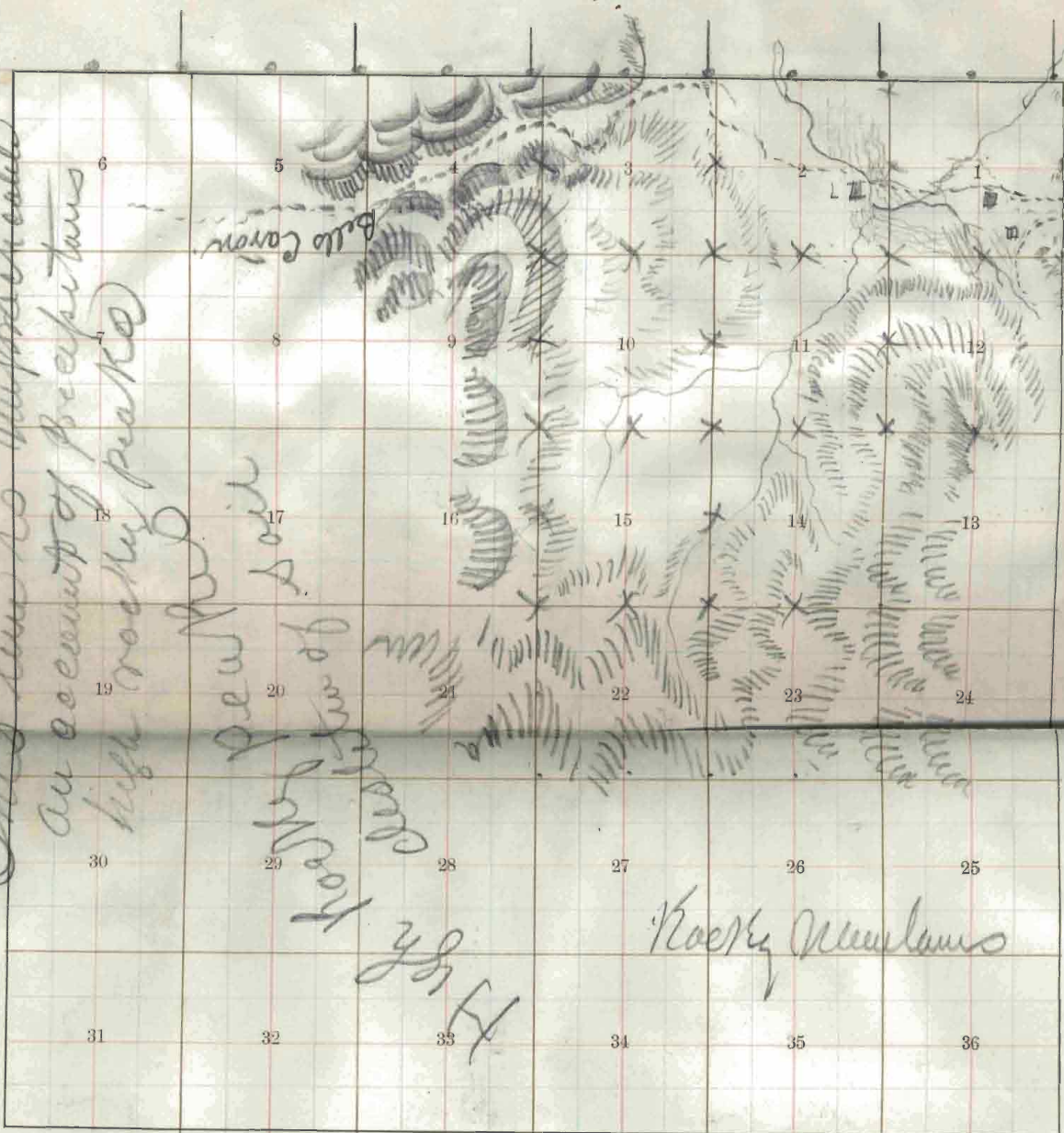

Bancroft's Blank, Township Plot.

A. L. Bancroft & Co., 721 Market St., San Francisco.

- Meridian Line,
- Base Line,
- Standard Line,
- Township Lines,

(over)

1 B

1A

BOOK 1031

4-674.

Township 12 N. R. 5 W., Sec. SR Be M.

6	5	4	17	3	9	2	3	1
				16		8		1
7	8	9	15	10	7	11	4	12
				14		6		5
18	17	16	13	15	10	14		13
				12		11		
19	20	21		22		23		24
30	29	28		27		26		25
31	32	33		34		35		36



Township 12 North. Range 5 West  
 6th Salt River Meridian

Chs The lands in the South  
 and West portion of this  
 Township being worthless  
 and mostly composed of  
 Granite rocks destitute of  
 soil, I therefore began on  
 the East boundary of the  
 Township at the corner to  
 sections 1, 12, 6<sup>th</sup> & 7<sup>th</sup> and run  
 from thence

West on true line bet. secs 1<sup>st</sup> & 12  
 ran.  $13^{\circ}40'$  East  
 (as per standard line)

- 12.50 Point of rocks 10 feet high  
 15.00 Level land bears S. N. <sup>4</sup>/<sub>4</sub> N. E.  
 20.00 Road bears N. E. <sup>4</sup>/<sub>4</sub> S. N.  
 20.40 Enter cornfield bears N. <sup>4</sup>/<sub>4</sub> S. N.  
 31.00 A house 5 chains N. of line  
 25.00 A house 20 chs N. of line.  
 39.00 Dry creek 10 links wide runs N.  
 (over)

Township 13 North. Range 5 West.  
Gila Salt River Meridian

As continued.

40.00 Set a 1/4 sec. cor. stone 14 x  
10 x 6 in. as per instructions  
No trees near.

52.00 Leases Leonard's bears S. E. 1/4 N. 7.

80.00 Set a stone 18 x 10 x 10 in. in a  
stone mound as per in-  
structions for the cor. to secs  
1, 2, 11 & 12.

No trees near.

Land level, except 25 chains  
on E. end of line.

Soil - 1<sup>st</sup> rate.

No timber.

Township 13 North, Range 5 West

Gila Salt River Meridian

Sec North, <sup>outcrop line</sup> between sections 1 & 2  
var.  $13^{\circ} 40'$  East.

5.00 Enter cornfield bears N. N.  $\frac{1}{4}$  S. E.

18.00 Dry creek 20 links wide runs N. N.

23.00 Kelsen's House 10 chains N. of line

30.00 Leave cornfield bears N. N.  $\frac{1}{4}$  S. E.

30.40 Road bears E.  $\frac{1}{4}$  N.

40.00 Set a  $\frac{1}{4}$  sec. cor. stone  $12 \times 10 \times$   
10 in. in ground and set as  
per instructions.

No trees near.

80.00 Intersect the 3<sup>rd</sup> Standard Parallel  
line 8 chains E. from the Standard  
cor. to secs 35 & 36, of Township  
13 N. Range 5 W. and set a  
post in a mound and set  
as per instructions for the  
closing cor. to secs 1 & 2.

No trees near.

Land lev. Soil 1<sup>st</sup> rate. No timber

Township 12 North Range 3 West.  
 Gila & Salt River Meridian

As From the cor. to secs 1, 2, 11.  
 and 12. S run.

South. between secs 11 <sup>and</sup> 12  
 var.  $13^{\circ} 40'$  East

10.00 Begin steep ascent of mountain

40.00 Set a '4 sec. cor. stone  $14 \times 10 \times$   
 $8$  in. as per instructions.

No trees near.

80.00 Set a stone  $18 \times 10 \times 6$  in. as  
 per instructions for the cor.  
 to secs. 11, 12, 13 <sup>and</sup> 14.

No trees near.

Land steep N. N. slope  
 of rock hill.

Coil 2" rate. on N. half of  
 line and post on S. half.

No timber.



Township 12 North. Range 5 West.

Sec. 4 Salt River Mendocino

Co. East. on true line bet. secs. 12 & 13.  
 var. 13' 40" East

40.00 Sec. 4 sec. cor. stone 16 x 10 x  
 8 in. as per instructions  
 No trees near.

Land steep N. W. slope of rock  
 mountain.

Soil poor <sup>and</sup> No timber.

And on account of rocky  
 cliffs this line cannot be  
 run farther East, and the  
 lands S. of line are worthless.



Township 12 North, Range 3 West

Gila Salt River Meridian

From the cor. to secs. 11, 12, 13  
 and 14. I run

West on true line bet. secs 11 and 14  
 var.  $13^{\circ}40'$  East.

40.00 Set a  $\frac{1}{4}$  sec. cor. stone  $12 \times$   
 $10 \times 8$  in. as per instructions  
 No trees near.

50.00 Dry ravine runs North.

80.00 Set a stone  $16 \times 12 \times 6$  in. as  
 per instructions for the corner  
 to sections

10, 11, 14 and 15.

No trees near.

Land broken and stony

Coil 2<sup>nd</sup> and 3<sup>rd</sup> rate.

No timber.

Township 12 North. Range 5 West  
 6th Salt River Meridian  
 Sec. 10 North:

between secs 10 <sup>and</sup> 11  
 var. 13'40" East.

- 6.50 Dog ravine runs N.E.  
 10.00 Set a <sup>1</sup>/<sub>4</sub> sec. cor. stone 10 x  
 10 x 10 in. as per instructions  
 No trees near.  
 20.00 Set a stone 14 x 10 x 8 in. w/  
 a stone mound as per in-  
 structions for the cor. to secs  
 2, 3, 10 <sup>and</sup> 11.

No trees near.

Land rolling.

Oil 2<sup>d</sup> rate.

No timber.

Township 12 North Range 5 N.  
Gda<sup>ms</sup> Salt River Meridian

- As East. on random line bet. secs 2<sup>ms</sup> 11  
var.  $13^{\circ}40'$  East.
- 35.00 Enter level land bears S. E.  $\frac{3}{4}$  N. N.
- 40.00 Set a tem  $\frac{1}{4}$  sec. cor. post.
- 62.25 Symraque runs N. E.
- 80.00 Intersect the N.  $\frac{3}{4}$  S. Line at the  
cor. to secs 1. 2. 11  $\frac{3}{4}$  12 from  
which cor. I run  
West. on true line bet. secs 2<sup>ms</sup> 11.  
var.  $13^{\circ}40'$  East.
- 40.00 Set a  $\frac{1}{4}$  sec. cor. stone  $1\frac{1}{2} \times$   
 $10 \times 8$  in. in a mound and  
pile as per instructions.  
No trees near
- 80.00 The cor. to secs 2. 3. 10  $\frac{3}{4}$  11.  
Land level.  
Coil 1<sup>st</sup> rate.  
No timber.

Township 12 North Range 5 West  
 6th Salt River Meridian

- Sec 3 North on true line bet. secs 2<sup>nd</sup> & 3<sup>rd</sup>.  
 var. 13° 40' East.
- 40.00 Set a 1/4 sec. cor. stone 14 x 12 x  
 6 in. in a stone mound as  
 per instructions  
 No trees near.
- 50.00 Enter level bottom land bears N. W.
- 60.00 Road bears S. E. <sup>1/4</sup> N. W.
- 61.00 Enter cornfield bears E <sup>1/4</sup> N.
- 80.00 Intersect the 3<sup>rd</sup> standard Parallel  
 N. 8. 31 chains E. from the Standard  
 cor. to secs. 34<sup>th</sup> & 35 and set a  
 closing cor. post in mound  
 and pits as per instructions for  
 the cor. to secs 2<sup>nd</sup> & 3<sup>rd</sup>.  
 No trees near
- Land level and rolling  
 Soil 2<sup>nd</sup> <sup>1/4</sup> 1<sup>st</sup> <sup>1/4</sup> rate.  
 No timber



Township 12 North, Range 5 N.  
 6th & Salt River Meridian

No From the cor. to sections 10, 11,  
 12<sup>th</sup> & 13. Iron

South. between secs. 12<sup>th</sup> & 13<sup>th</sup>  
 var.  $13^{\circ} 40'$  East

40.00 Set a  $\frac{1}{4}$  sec. cor. stone  $14 \times 12 \times$   
 5 in. as per instructions.

No trees near.

43.00 Deep rock ravine runs N. E.

80.00 Set a stone  $16 \times 10 \times 7$  in. as  
 per instructions for the cor.  
 to secs.

12. 13. 22<sup>nd</sup> & 23.

No trees near

Land broken<sup>nd</sup> & stony.

Soil poor.

No timber.

Township 12 North. Range 5 West.

Sec 14 Salt River Meridian

Sec East. on true line bet. secs

14 and 23.

var.  $13^{\circ}40'$  East

40.00 Set a  $\frac{1}{4}$  sec. cor. stone  $16 \times 10 \times 8$  in. as per instructions

No trees near.

And on account of precipitous rocky cliffs this line to the East from this point is impracticable and the land worthless.

12

Township 12 North. Range 5 West.

Gila <sup>and</sup> Salt River Meridian

60 West, on true line bet. secs 15<sup>th</sup> & 22.  
var. 13'40" East.

19.20 Dry gulch runs N.

40.00 Set a 74 sec. cor. stow 14  
x 12 x 8 in. as per instructions  
No trees near.

80.00 Set a stow 18 x 10 x 8 in. as  
per instructions for the cor.  
to secs

15, 16, 21<sup>st</sup> & 22.

No trees near.

Land broken and stony  
Soil poor.

No timber.

Township 13 North, Range 5 West  
 6th Salt River Meridian

No. North

between sections 15<sup>3</sup>/<sub>16</sub>  
 var. 13040' East

40.00 Set a 44 sec. cor. stone 14 x 10  
 x 6 in. as per instructions.  
 No trees near.

80.00 Set a stone 16 x 10 x 6 in. as  
 per instructions for the cor.  
 to secs

9, 10, 15<sup>4</sup>/<sub>16</sub>, 16.

No trees near.

Land broken E. base of  
 high rocky mountain  
 Soil on line Northless  
 No timber.

Jan'y 20<sup>th</sup> 1872



Township 12 North, Range 5 West  
 Gila and Salt River Meridian

hd East. on random line bet. secs. 10<sup>and</sup> 15  
 var. 13° 40' East

32.00 Range runs N. E.

40.00 Set a tin. 1/4 sec. cor. post.

80.10 Intersuch the N. and S. Line at  
 the cor. to secs 10, 11, 14<sup>and</sup> 15  
 from which cor. I run

West. on true line bet. secs 10<sup>and</sup> 15  
 var. 13° 40' East

40.05 Set a 1/4 sec. cor. stone 16 x  
 10 x 8 in. as per instructions  
 No trees near.

80.10 The cor. to sections  
 9, 10, 13<sup>and</sup> 16.

Land broken and stony  
 Paid 3<sup>rd</sup> rate.  
 No timber.

Township 12 North Range 5 West  
 Gila <sup>and</sup> Salt River Meridian  
 To North

between secs 9 <sup>and</sup> 10  
 var. 13° 40' East

40.00 Set a <sup>1</sup>/<sub>4</sub> sec. cor. stone 12  
 x 12 x 6 in. as per instructions  
 No trees near.

80.00 Set a stone 16 x 10 x 10 in. as  
 per instructions for the  
 cor. to sections  
 3, 4, 9 <sup>and</sup> 10.

No trees near.  
 Land broken <sup>and</sup> rocky  
 Soil worthless  
 No timber.

Township 12 North, Range 5 West.

Gila Salt River Meridian

to East on random line bet. secs 3<sup>q</sup> 10  
var.  $13^{\circ}40'$  East

40.00 Set a  $\frac{1}{4}$  sec. cor. post.

80.15 Intouch the N. <sup>q</sup> S. Line 10  
links S. from the cor. to secs  
2, 3, 10 <sup>q</sup> 11, from which  
cor. Iron

S.  $89^{\circ}56'$  N. on true line bet. secs  
3<sup>q</sup> 10.

var.  $13^{\circ}40'$  East

40.00 Set a  $\frac{1}{4}$  sec. cor. stone 14  
 $\times 10 \times 10$  in. as per instructions

No trees near.

80.15 The cor. to secs  
4, 5, 9 <sup>q</sup> 10;

Land broken

Coil 3<sup>rd</sup> rate.

No timber.

Township 13 North Range 5 West  
 6th Salt River Meridian

S. North.

on true line bet. secs 3<sup>rd</sup> & 4.

var. 13° 40' East

40.00 Set a  $\frac{1}{4}$  sec. cor. stone 10 x 10 x  
 8 in. as per instructions

No trees near.

47.00 Top of S. side of Bell's Cañon.

60.00 Road bears E.  $\frac{1}{2}$  N. in Bell's Cañon

61.00 Dry creek bed 10 miles wide runs E.

61.50 Base of N. side of Bell's Cañon

75.00 Top of same 200 feet high

80.18 Intersect the 3<sup>rd</sup> Standard Parallel  
 N. 8.40 chains E. from the Standard  
 cor. to secs 3<sup>rd</sup> & 34 and set  
 a stone 18 x 10 x 10 in. as per in-  
 structions for the closing cor.  
 to secs 3<sup>rd</sup> & 4. No trees near.

Land rough <sup>and</sup> broken

Soil worthless

No timber.

(over)



Township 12 North Range 5 West  
Gila Salt River Meridian

Chs continued.

And there is no more  
Surveyable land in this  
Township; the unswayed  
land being composed  
of high rough granite  
mountains and peaks  
destitute of soil.

Date Jan'y 22 1872

## General Description

The surveyed lands in Township 12 N. Range 5 West. are good for grazing and a portion of them are <sup>1<sup>st</sup></sup> rate agricultural lands.

Timber is scarce but water is easily obtained by wells of moderate depth.

The unsurveyed lands are worthless.

O. W. Freeman  
of Dep. Surveyor

## Final Oaths of Assistants.

We hereby certify that we assisted Solomon  
W. Hornum Deputy Surveyor, in surveying  
the Subdivision lines of Townships  
15 N. Range 3 W. and 12 N. Range  
5 W. Gila and Salt River Meridian

and that said Survey has been in all respects, to the  
best of our knowledge and belief, well and faithfully sur-  
veyed, and the boundary monuments planted according to  
the instructions furnished by the Surveyor-General.

George Ellwood  
Fried Smelter  
Joseph France  
James Baker

Subscribed & sworn to before me  
this 21<sup>st</sup> day of February 1872  
Jno. Anderson }  
Probate Judge }  
Pima Co. }

*Final Oath of Deputy Surveyor.*

I, *Salomon N. Forman*  
Deputy Surveyor, do solemnly swear that, in pursuance  
with a contract with *Joshu Nasson*  
United States Surveyor-General for Arizona, bearing date  
the *14<sup>th</sup>* day of *October 1871*, I have well, faithfully  
and truly, in my own proper person, and in strict con-  
formity with the instructions furnished by the Surveyor-  
General, the Surveying Manual, and the laws of the  
United States, surveyed all those parts or portions of  
*the Subdivision lines of Townships*  
*15 N. Range 3 W. and 12 N.*  
*Range 5 W. Gila and Salt*  
*River Mexican*



as are represented in the foregoing *Field Notes* as having



We have been surveyed under my directions; and I do further  
 W. & solemnly swear that all the corners of said surveys have  
 been established and perpetuated in strict accordance with  
 15, the Surveying Manual and printed instructions, and that  
 5 the foregoing are the true and original Field Notes of such  
 Survey.

Solomon W. Farman  
 U. S. Deputy Surveyor.

best o  
 veyed  
 the in

Subscribed and sworn to before me, this 21<sup>st</sup>  
 day of February 1877

Procladius  
 Probate Judge  
 Minn. Co.



So  
 the

Surveyor General's Office

Tucson A.T.

March 20. 1872

The foregoing field notes of the survey of the subdivision lines of Township 12 North, Range 5 West of the Gila and Salt River Base and Meridian lines in the Territory of Arizona executed by S. H. Fireman U. S. Deputy Surveyor, under his contract of October 14. 1871, having been critically examined the necessary corrections and explanations made, the said field notes and the surveys they describe are hereby approved.

Abner Wasson  
Surveyor General