

BOOK 1032

No. 1032

Deputy Surveyor.

T. _____ R. _____

Meridian.

BOOK 1032

Field Notes

OF

the *Subdivision* _____ lines of

Township *13 N* Range *2 West 4*

11 N. Range 3 W.
Salt River Meridian, California, *Arizona*

BY

O. H. Case _____ Deputy Surveyor,

under his Contract of *July 17th* _____ 18*71*

Survey commenced *Sept 26* _____

Survey completed *Oct. 14* _____



Platted,

No. 1032

Copied for Washington,

Transcript sent to Commissioner, *Jan'y 29th 1872*

1032

Preliminary Oaths of Assistants.

I, _____ do solemnly swear that I will well and truly perform the duties of Compassman, according to instructions given me, and to the best of my skill and ability.

Subscribed and sworn to before me, this _____ day of _____ 187

U. S. Deputy Surveyor.

We, A. M. Lindsay and H. W. Schooler

do solemnly swear that we will faithfully execute the duties of Chain Carriers; that we will level the chain upon uneven

ground, and plumb the tally pins, whether by sticking or dropping the same; that we will report the true distance to all notable objects, and the true length of all lines, that we will assist in measuring, to the best of our skill and ability.

N. M. Lindsay
H. W. Scholes

Subscribed and sworn to before me, this 25th day of
Sept 1871

U. S. Deputy Surveyor.

Crowwells
Clerk Dist Court
5th Dist A.S.

I, John Riley
do solemnly swear that I will well and truly perform the
duties of ~~Wounded Soldier~~ Alman
according to instructions given me, and to the best of my
skill and ability.

John Riley

Subscribed and sworn the be before me, this 25th
day of Sept. 1871

U. S. Deputy Surveyor.
E. W. Wells
Clerk Dist Court
2^d Dist Ark.



Index for T. 11 N., R. 3 W. on Page 76

BOOK 1032

4-674.

Township 13 N., R. 2 W., Secs 1, 2, 3, 4, 5, 6, 7, 8, 9, 10, 11, 12, 13, 14, 15, 16, 17, 18, 19, 20, 21, 22, 23, 24, 25, 26, 27, 28, 29, 30, 31, 32, 33, 34, 35, 36

do s
duti
acco
skill

day

6	66	5	49	4	37	3	25	2	13	1
65		64		47		36		24		12
7	63	8	47	9	35	10	23	11	11	12
62		61		45		34		22		10
18	59	17	44	16	33	15	21	14	10	13
58		57		43		31		20		9
19	56	20	42	21	30	22	19	23	8	24
55		54		41		29		18		7
30	53	29	40	28	28	27	17	26	6	25
52		50		39		27		15		5
31	50	32	38	33	26	34	14	35	4	36

Field notes of Subdivision lines of Tp

BOOK 1032

13 North. R. 2 West Gela and Salt River Meridian

Begin at the Standard
 cor between Sec^s 35 and 36
 on the 3^d Standard North
 of the Gela and Salt-river
 Base line from thence run
 North between Sec^s 35 and
 36. Subdivisions commenced Sept 26, 1871

On 13° 47' East

2300 Deep arroyo running E. + W.

Line runs along foot of
 Lynx creek range of mountains

4000 Set a stone 10 x 8 x 8 for the
 cor to 1/4 Sec. from which
 a pine 16 in dia bears N. 87° W. 23
 links No other trees near.

8000 Marked a pine oak, 8 in dia
 for the corner of Sec^s 25 26
 35 + 36 as per instructions
 from which a pine oak, 6 in
 bears S 20° West - 21 links

Township 13 North Range 2 West-
Gila and Salt-River Meridian

a pair oak 18 in North 30 links
Land rolling Soil mineral
Scattering Pine oak and fir

East on random line between
Sec 25 and 36.

Va 13° 47' East-

- 1500 Commenced ascent of hill
250 feet high bears N. & S.
- 4000 Set a post for temporary 1/4
Sec. cor.
- 8000 Intersected East-Boundary
line at a point 15 links
south of cor. from which cor
(25 30 31 + 36) Run S 89° 53' W.
- Va 13° 47' East
on true line between Sec
25 + 36
- 4000 Set a stone 16 x 12 x 12 for

Township 13 North Range 2
West Side and Salt River Meridian

the cor. of 1/4 sec on west-
slope of hill No trees near.
5000 The corner, W Sec- 25, 26, 35,
and 36

Land rolling Soil mineral
Timber pine oak and cedar.

North between Sect 25th
26

to 30° 47' East-

4000 Set a post in mound with
pins as per instructions
No trees near.

6500 Brown Creek runs West 25-
links wide dry bed

8000 Marked a pin oak 24 in
dia for the cor of Sect 23 24
25 + 26 No other trees near
Land broken and hilly; not
much timber. Soil mineral

Township 13 N. Range 9 West-
Sida and Salt-River Meridian

East-between Sec 24 & 25
on railroad line

va. $13^{\circ} 47'$ East-

4000 Set temporary $\frac{1}{4}$ Sec cor.
80,24 Intersected cor of Sect. 24
25 19 & 30. from thence West-
on true line between 24 & 25

va $13^{\circ} 47'$ East-

40,22 Set a post for $\frac{1}{4}$ Sec cor
from which a
pin 16 bears $S 5^{\circ} E$ 50 lks
" 10 " $N 5^{\circ} E$ 37 "

50,24 The corner of Sec 23, 24, 25,
and 26.

Land rolling and hilly
Soil mineral Timber, Pine,
oak, and cedar.

Township 13 N Range 2 W,
Gela and Salt River Meridian

North between 23 and 24

U. 13° 47' East

- 23.00 Trail from Lynxereck to
Prescott, North westerly bearing
- 4.00 Set a Stone 18x12x8 in a mound
of stone 3ft high for $\frac{1}{4}$ Sec cor.
as per instructions No trees near.
- 63.00 East branch of Granite Creek
15 links wide, dry bed.
runs west.
- 8.00 Set a Stone 20x10x6 in a
mound of Stone 3ft high as
per instructions No trees
near.

Land hilly and broken
covered mostly by Short oak
brush. Soil mineral

Sept 26, 1871

Township 13 North Range 2 W.
Gila and Salt-River Mercedem

4000 East-on random line
between Sec 13 and 24
Set post for temporary 1/4
Sec cor

5000 Intersected East-Boundary
of Sp. 18 links North of post-
corner of Sec 13 + 24 from which
Down $N 89^{\circ} 53' W$ on true line
between Sec 13 + 24

Va $13^{\circ} 47'$ East-

4000 Set a Stone 18 x 16 x 14 in
mound of Stone 3ft high as
per instructions No trees near,
quite brushy most of the line

5000 The cor to Sec 13, 14, 23, + 24
Land hilly Soil mineral
No timber of any value.

Township 13 N Range 2 W.
Gila and Salt-River Meridian

North between Sec-
13 & 14

Va. $13^{\circ} 47'$ East

4000 Set a Stone $12 \times 8 \times 6$ in
a mound of Stone 3ft-high
as per instructions for $\frac{1}{4}$ Sec
cor. No trees near.

8000 Set a Stone $24 \times 20 \times 6$
in a mound of Stone 3ft-high
for the cor to Sec- 11, 12, 13 & 14
from which a pine 10 bars
N 22° E 250 links

Land Kelly Soil
Mirral good grazing
Not much timber

East on random line
between Sec- 12 and 13

Va. $13^{\circ} 47'$ East-

4000 Set temporary $\frac{1}{4}$ Sec cor

Township 13 North Range 2 W.
Gila and Salt-River Meridian

- 79.80 Intersected post-corners to
Sec 12 & 13 from thence
Run west-on true line
between Sec 12 & 13
va $13^{\circ} 47'$ East
- 39.90 Set-a Stone 10x10x10 in
mound of stone as per instruction
for $\frac{1}{4}$ Sec cor.
- 49.80 The corner of Sec 11, 12, 13 & 14
Land broken and hilly
Soil mineral No timber Short
oak brush.
- North between Sec 11 & 12
va $13^{\circ} 47'$ East
- 40.00 Set-a Stone 12x8x8 in
mound of Stone 3ft-high as
per instructions for $\frac{1}{4}$ Sec cor
- 80.00 Set-a Stone 10x8x8 on west-

Township 13 N. Range 2 W.

Gila and Salt River Meridian

slope of hill in a mound
of Stone 2 ft high as per
instructions for the corner
to Sect 1, 2, 11, & 12

W. line near
Land hilly Soil mineral
good grazing land.

East on random line
between Sect 1 and 12

at $13^{\circ} 47'$ East-

4000 Set stone for temporary
 $\frac{1}{4}$ Sec cor.

8000 On intersect East-Boundary
of Township at a point
25 links South of Post-cor
to Sect 12 and 1 from which
post-Run S $89^{\circ} 45'$ W on
true line between Sect 1 & 12

13
Township 13 North Range 2 West
Gila and Salt River Meridian

va 13° 47' East -

- 40.00 Set a stone 10 x 14 x 12 for
the corner of 1/4 Sec 2 in a
mound of Stone as per instruction
- 80.00 The corner to Sec 1, 2, 11, + 12
Land broken and hilly
Soil mineral No timber

North on random
line between Sec 1 and 2

va 13° 47' East -

- 40.00 Set a stone for temporary
1/4 Sec cor.
- 84.06 Intersected the North boundary
of Twp. 28 links East of post
corner, to Secs 1 and 2, from
which I run S 0° 12' E, on
true line between Sec 1 + 2
- 40.06 Set a stone 10 x 10 x 6 in

Township 13 North Range 2 W.

Gila and Salt River Indian

mound of earth with pits
as per instructions for 1/4
Sec cor

8006 The corner of Secs 1, 2, 11, + 12
Land rolling and hilly
No timber Soil mineral
Short brush on all the
hills

Sept. 27, 1871

North between Sec
34 + 35

Pa. $13^{\circ} 47'$ East

450 Road from Hoys and
Curtis' Quartz Mill
bars N. W. and S. E.

1900 Wolf creek runs west 20
links wide. A small frame
house west of line about
4 chains on right-bank of
Wolf creek.

Township 13 N, Range 2 W
Gila and Salt River Meridian

- 40.00 Marked a W oak 4 in dia
for 1/4 Sec cor. from which
a W oak 3 in bears South 3 links
- 8.00 Set a stone 16 x 8 x 8 for the
corner of Sec 26 27 34 + 35
from which
- a pine 30 in dia bears N 69° W 56. "
- " W oak 7. " " " S 78° E 53 lks
- " " " 4 " " " S 46° W. 67 "
- Land rolling Soil decomposed
granite and organic mold
Timber Pine Oak + cedar.

East on random line
between Sec. 26 + 35

va 13° 47' East-

- 40.00 Set a stone for temporary
1/4 Sec cor.
- 7.00 Steep slope of West Lynx
creek range of mountains

Township 13 North Range 2W,
Gila and Salt-River Meridian

bears N. & S.

8000 Subtracted N & S line 90
links North of the cor of
Sec 25, 26, 35, & 36 from which
I run N. $89^{\circ}47\frac{1}{2}'$ West on
true line between Sec 26 & 35

4000 Set a Stone 20 x 8 x 6 for 1/4
Sec cor from which a true line
div. bears S $20^{\circ}W$ 22 links

No other true nor

8000 The corner of Sec 26 27 34 & 35
Land rolling soil decomposed
granite Eastern half mile
contains mineral.

Township 13 North Range 2 West
 Gila and Salt River Meridian

North between Sec
 26 & 27
 via 13^d 47' East

4000 Set a stone 12 x 8 x 4 from
 which
 a pine 18 in dia bears N. 75° W. 24.6
 " " oak 16 " " " S 61° E 36 "
 No others near.

6000 Gnomon creek runs S W 25 links
 wide

6050 Field bears East and West

6150 Left field bears E and SW,
 and crossed timber road.

8000 Marked a pine oak 10 in dia
 as per instructions for the
 corner of Secs 22 23 26
 27.

Land gently rolling
 Soil decomposed granite
 and organic mold loam

Township 13 North Range 2N
 Gila and Salt-River Meridians
 pine oak and cedar

East-on random line between
 Sec^s 23 and 26

va. $13^{\circ}47'$ East

4000 Set temporary $\frac{1}{4}$ Sec cor.

8000 Intersected Post-at-cor of Sec
 23, 24, 25, 26 from which I
 run west on true line between
 Sec^s 23+26

va $13^{\circ}47'$ East-

4000 Set a post-for $\frac{1}{4}$ Sec cor
 from which

A pine 12 in. dia bears S. $64^{\circ}W$ 63 lks

" " 12" " " N $83\frac{1}{2}^{\circ}W$, 89"

8000 The cor of Secs 22, 23, 26, and 27
 Land generally level Soil
 de composed granite and mold

Township 13 North Range 2 W,
Gila and Salt-River Meridian

Timber mostly pine oak
and along Groom creek Black
Alder.

- North between Secs 22² & 23
- 44.00 Set a Stone 20x20x8 for 1/4
Sec cor. from which
a pine 24 in dia bears S 5 E, 50 lks
" " 20 " " " N 45 E 42."
- 65.00 East-Branch of Groom-creek
runs N. W. 26-links wide
- 66.00 U. S. Government-Saw mill
4 chains East of line
- 71.50 Road from Saw mill to Camp
Whipple
- 80.00 Marked a pine oak 10 in
dia as per instructions for
the corner of Sec 14
15-22+23

Township 13 North Range 2, W.
Gila and Salt-River Division

East on random line between
Sec^s 14 and 23

Wa. 13° 47' East-

- 40.00 Set temporary $\frac{1}{4}$ Sec cor.
50.00 Left- Timber land, entered
brush bears NE and S
80.00 Intersected N. and S. line
28 links North of corner
to Sec^s 13 14 23 + 24 from
which cor. I run $N 89^{\circ} 48' W.$
on true line between Sec^s
14 and 23

Wa. 13° 47' East-

- 40.05 Set a stone 10 x 10 x 10 in a mound
of stone 3ft high for $\frac{1}{4}$ Sec
cor. as per instructions in this
map.
80.10 The cor of Sec^s 14 15 22 + 23
Land rolling and eastern
end hilly Soil decomposed

Township 13 North Range 2 West
Gila and Salt-River Meridian

Granite and Mold

Timber on west-east of
line. Good Pine oak and
cedar.

North between Sec^s 14 and 15
Va. 13° 47' East-

4000 Set a Stone 16 x 12 x 8 on
west slope of hill 100 feet
high in trees near for 1/4 Sec
cor.

5200 A ravine bears N.E.

5000 Marked a Jack oak 16 in dia
for the corner of Sec. 10, 11, 14, & 15
as per instructions No other
near. Land rolling
Soil decomposed granite
and organic mold. Good

Township 13 North Range, 2 West
Gila and Salt River Meridian

Pine timber East and West
of line.

East on random line between
Seco 11 & 14

Na. $13^{\circ} 47'$ East

12.00 Road from Government
Saw Mill to Camp Whipple

4.00 Set temporary $\frac{1}{4}$ Sec cor.

8.00 Intersected Post-cor of Sec
11, 12, 13, & 14 from which I
run West on true line

Na. $13^{\circ} 47'$ East

4.00 Set a stone in a mound of
stone 3 ft high for $\frac{1}{4}$ Sec
cor as per instructions
from which a cedar bears
S 40 W. 200 links

8.00 The cor to Sec 10, 11, 14, & 15

Township 13 North Range 2W
Gila and Salt River Meridian

Land rolling and hilly
Soil decomposed granite
contains mineral (Gold)

North between Sec 10 & 11
Va 13° 47' East

200 Road from Govt Saw Mill
about 5 chains East bears
North

200 Pine 3ft-dia

4000 Set a stone 18 x 10 x 10 for the
corner of 1/4 Sec from which
a pine 36 in dia bears N 66 1/2° W 43 links
" " Oak 8" " " S 28 1/2° E 34"

5200 Line runs along west-side
of ravine with some good
timber in it

6000 Left timber bears East-
and end broken hilly lower

Township 13 North Range 2 West

Gila and Salt River Indian

8000 Set a stone 20 x 8 x 4 in
a ravine bears E & N.W.
for the cor to Sect 2, 8, 10, 11
No timber

Land broken on
north end of line Southern
rolling timber Pine mostly

East on random line
between Sect 2 and 11

14,000 Strip bluff overlooking ravine
32,000 Road to Fort Whipple bears
North from Saw mill
Some timber in ravine

40,000 Set temporary $\frac{1}{4}$ Sec cor.

49,900 Intersected N and S line
at a point 25 links South
of the cor. to Sect 12 11 & 12

Township 13 North Range 2W
Gila and Salt-River Meridians

from which cor Down S 89°
49' W. between Sec 2 & 11 on
true line

Va 13° 47' East

3995 Set a stone 16 x 10 x 8 in around
of Stone 3ft high for 1/4 Sec
cor. N true, near

7990 The corner of Sec 23: 10⁹/₁₁
11. Land rolling Soil poor
No timber to speak of.
Sept 28th 1871.

North on random line between
Sec 2 & 3.

4 Va 13° 47' East

4000 Set temporary 1/4 Sec cor

8100 Intersected North Boundary
of Township at cor from
which Down South between
Sec 2 & 3. on true line

Township 13 North Range 2 West
 Gile and Salt-River Meridian

ra $13^{\circ} 47' E$.

4000 Set a Stone $18 \times 10 \times 8$ for $\frac{1}{4}$
 Sec cor. N trees near

8000 The corner. W Sec. 23 10×11
 N timber Land rolling
 and covered with brush
 and grape Soil D rate,

North between Sec 33 and 34.

ra. $13^{\circ} 47' East$

1600 Wolf creek runs S W 25 ft wide

4000 Set a stone $18 \times 10 \times 4$ in a mound
 of stone 3 ft high for $\frac{1}{4}$ Sec cor
 N trees near.

8000 Set a stone $16 \times 4 \times 7$ in a mound
 of stone 3 ft high from which
 a pine 20 in dia bears S $29\frac{1}{2}^{\circ} E$ 2
 " pin oak 12 " " S $62\frac{1}{2}^{\circ} W$ 155
 Land rolling Soil mineral

Township 13 North Range 2 West-
Gila and Salt River Meridian

Some timber pine and oak

East on random line between
Sec^s 27, 34 & 34.

Va. 13° 47' East

4000 Set temporary stone for $\frac{1}{4}$
Sec cor.

5800 Road from Noyes and Curtis'
quartz mill

8010 Intersected N and S line at
post corner to Sec^s 26, 27, 34 & 35
from which I run west on
true line between Sec^s 27 & 34

Va. 13° 47' East

4005 Set a stone 16 x 6 x 6, for $\frac{1}{4}$
Sec cor from which

a pine oak 9 in dia bears S 74° W 23 M
a pine 20 " " " N 49° E 37

8010 The corner of Sec^s 27, 28, 33 & 34

Township 13 N. Range 2 W.
Gila and Salt-River Mountains

Land rolling Soil decom-
posed granite and mold
Timber pine and oak pre-
valent.

North between Secs 27 & 28
Va. $13^{\circ} 47'$ East-

- 3300 Groom creek runs S.W. 100
links wide and entered field S.E.
- 3900 Left field entered border land
bears N.E. + S.W.
- 4000 Set a stone $12 \times 10 \times 8$ for $\frac{1}{4}$
Sec cor. from which a
gnomak 12 in. dia bears $N 87^{\circ} W$ 26.6
a Jack oak, 10" " " $N 85^{\circ} E$ 36."
- 5100 Commenced ascent of bald
hills. 3 in number
- 8000 Set a stone $18 \times 10 \times 10$ in a mass
of Stone 8 ft high on East slope

Township 13 N. Range 2 W.
Gila and Salt-River Meridian

of bald hill for the cor
to Sect 21, 22, 27, 28

No trees near

Land rolling and hilly
Soil decomposed granite
and organic mold.

No timber on west of
line; on East - some pines.

East on sundown line
between Sect 22 and 27

Va. 13° 47' East -

4000 Set a temporary 1/4 Sec cor
4200 Little branch, with fine spring
of water runs South
6000 Road to Noyes and Curtis'
Sawmill near NW x SE

7000 Noyes and Curtis' Sawmill
about 20 chains south of
this point on right bank

Township 13 North Range 2 West
 Gila and Salt-River Meridian

of broom creek

8020 Intersected N and S line
 32 links North of post-corner
 from which cor E run $N 89^{\circ} 46' W$
 on true line

Va. $13^{\circ} 47'$ East-

4410 Marked a pin oak 7 in for $\frac{1}{4}$
 Sec cor from which a pin
 oak 8 in dia bears $N. 20^{\circ} E$ 28 links

8020 The corner of Sect 21, 22, 27, & 28
 Land selling not much timber
 Soil decomposed granite
 and organic matter.

North between Sect. 21

and 22

Va. $13^{\circ} 47'$ East-

1400 Deep Cañon running North,
 from two conical hills one East
 and west of line.

Township 13 North Range 2 West
Gila and Salt-River Meridian

- 4400 Set a stone $12 \times 12 \times 8$ for
1/4 Sec cor. from which a
cedar, 16 in dia bears $N 45^\circ W$, 27 links
- 70.00 Road from Arjes and Curtis
mill to Prescott, bears N, W .
- 8000 Set a stone $12 \times 12 \times 8$ in a mound
of stone 3 ft high from which
a cedar 16 in dia bears $S 75^\circ E$ 61 links
Land quite broken Sal Mineral
Timber Pine and oak,

East on random line
between Sec 15 and 22.

2a. 130 4 y East-

- 2700 Arroyo running North empties
into East-Branch of Granite
creek, about three chains North
of line.
- 3200 Granite-Creek 4 chains North
from west-Hammonds house

Township No 13 North Range 2 West
 Eden and Salt River Territorial

- and field along creek, house
 on left bank.
- 4.000 Set temporary 1/4 Sec cor.
- 5.000 Crossed East-branch of Granite
 Creek, runs N.W. 25 links wide
- 6.500 Road from Govt Saw mill
 to Prescott, N.W. bearing
- 8.000 Intersected post corner to
 Sec 14 15 22 & 23 from which
 corner I run West on pine line
 Va 13° 47' East-
- 4.000 Set a Stone 14 x 14 for 1/4
 Sec cor from which a pine
 16 in dia bears. South 12 links
 a pine 18 in dia bears. N 78° W. 32 links
- 8.000 The post corner to Sec
 15, 16, 21 & 22 Land selling
 Soil mineral. Timber pine
 and oak

Township 13 N Range 2 W.
Gila and Salt River Meridian

North between Sec^s 15 & 16

va. 13° 47' East-

- 4000 Set a stone 16 x 8 x 6 in a mound of stone 3 ft high from which a pin oak 10 in dia bears S 72° W 12 links
a pin oak, 10 in N 72° E 40 links
- 5800 Summit of hill overlooking East-branch of Granite Creek bears E. & W.
- 7000 East-branch of Granite creek 30 links wide runs NW and N.
- 7100 Road from Govt Saw mill to Prescott bears NW.
- 8000 Set a stone 36 x 12 x 16 for the corner to Sec^s 9, 10, 15, & 16 from which
a cedar 9 in dia bears N 60½° E 19 links
" pin oak 4" " " S 61° W 18"
" " " 16" " " S 32° E 46"

Township 13 North Range 2 West
Gila and Salt-River Meridian

No others near

Land broken Soil decomposed
granite and organic mold
Timber Pine and Oak.

East on random line between
Sec^s 10 and 15

Va 13° 47' East-

- 4000 Set temporary $\frac{1}{4}$ Sec cor.
- 67.00 Summit of rocky point, a deep
ravine 4 chains south, bears
S.W.
- 7000 Divide bears E and West-
- 79.80 Intersected N and S line 80
links south of post cor to Sec^s
10, 11, 14, and 15 from which cor.
D run S 89° 48' W on true line
between Sec^s 10 and 15
Va. 13° 47' East-
- 39.90 Set a stone 20x10x4 for $\frac{1}{4}$ Sec.

Township 13 N Range 2 West-
Gila and Salt-River Meridian

cor. No trees near.

- 7980 The corner of Sec^s 10, 11, 14, and 15
Land broken Soil mineral
Some timber on west-end of line
barren hills East.

North between Sec^s 9 and 10
on 130° 47' East

- 2000 Bannings house and field
4 chains west-bears N. + S.
- 4000 Set a stone 16 x 14 x 10 for 1/4
Sec cor. from which a Burr oak
one old bears N 87 1/2 W. 10 links
No more trees near.
- 4000 Round conical mountain
with ruins of Aztec Fort
on summit - about - 20 chains
west - 150 feet high
- 8000 Set a stone 12 x 10 x 10 in a mound
of stone 3 ft high for the cor. to Sec^s

Township 13 N. Range 2 W.

Gila and Salt-River Meridian

3, 4, 9, & 10 The cor is in a ravine
bears E. & W. No trees near.

Land rolling good grazing
No timber Soil 2^d rate

East on random line between
Sec- 3 & 10

va. 138° 47' East

Commenced ascent of bushy
hill at corner.

700 Summit bears E. & W.

3700 Ravine bears N. W.

4000 Set a temporary 1/4 Sec cor.

5600 Summit of hill on East of
ravine

8000 Intersected cor of Sec-

2, 3, 10, & 11 at post corner,
from which I ran West-
on true line

Township 13 N. Range 2 West-
Gila and Salt-River Meridian

Va. $13^{\circ} 47'$ East-

4000 Set a stone $14 \times 14 \times 14$ in
a mound of stone 3 ft
high for $\frac{1}{4}$ Sec cor No trees

8000 The corner of Sec 3, 4, 9, + 10
Land rolling short
oak brush along line
No timber

North on random line between
Sec 3, + 4,

Va. $13^{\circ} 47'$ East-

2200 The south boundary of the
Townsite of Prescott, and about
4 chains west of S E cor. of T. S.

3300 Round conical hill 150 feet
high

4000 Set temporary $\frac{1}{4}$ Sec cor

Township 13 N. Range 2, W.

Gila and Salt-River Meridian

79.90 Intersected north boundary
of Township at cor. of Sec
3 and 4 from which run South
on true line

Va $13^{\circ} 47'$ East

39.90 Set a stone $16 \times 10 \times 6$ for $\frac{1}{4}$ Sec.
cor. on north side of conical
hill.

79.90 The cor. of Sect- 3, 4, 9, & 10

Land selling good grazing
No timber along line. Some timber
west Pine, oak, &c

Sept-29, 1871

North between Sec. 33 and
32

Va $13^{\circ} 47'$ East

18.00 Harsayampa creek 100 links
wide runs S.W.

31.00 Dividing ridge between Harsayampa
creek and Iron creek bears S.W.

Township 13 North Range 2, W.

Gila and Salt River Meridian

- 3800 Brown creek Short bend from
NW. to S.W. Line runs along
East bank.
- 4000 Set a stone 12 x 10 x 8 in a mound
of stone 3ft high from which
a pine oak and bears N 37° W 34 lbs
a pine 20 lbs " N 39 1/2 E : 64.
Brown creek runs SW and about
100 links west of corner
- 5600 Crossed Brown creek runs S.W.
30 links wide
- 8000 Marked a pine 12 in dia for the cor.
Secs. 28, 29, 32, & 33
No other near.
Land rolling Soil mineral
Timber pine and oak.

East on random line between
Secs 28 and 33. Va 13° 47' East-

4000 Set temporary 1/2 Sec cor.

Township 13 N. Range 2 W
Gila and Salt River Meridian

- 4800 Groom creek 30 links wide
runs S.W.
- 50.20 Intersected N. and S. line 30 links
South of post-corner. to Sec^s
27, 28, 33, and 34 from which
cor. I run \odot 896 47' W. on true
line between Sec^s 28 and 33
va. $13^{\circ} 47'$ East
- 40.10 Set a stone $12 \times 10 \times 8$ in a mound
of stone 3 ft high on west slope
of hill above bottom of Groom creek
- 50.20 The cor. of Sec^s 28, 29, 32, and 33
Land rolling, soil mineral
Not much timber on west end
of line on east some pine.
- North between Sec^s 28 & 29
va $13^{\circ} 47'$ East
- 4000 Set a stone $20 \times 10 \times 6$ for $\frac{1}{4}$
Sec cor. Land brushy and

Township 13 N Range 2 W,
Gila and Salt River Meridian

broken W timber

5:00 Set a stone 24 x 16 x 12 for
the corner of Sec^s 20, 21, 28, & 29
from which

a pine oak 18 in dia bears S 70 W, 48
" " " 6 " " " S 28 1/2 E 46

No more trees near
Land broken and hilly W timber

East on random line
between Sec^s 21 and 28,

4:00 Set temporary 1/4 Sec cor

6:00 commenced ascent of round
conical hill 200 feet high

7:40 Summit

8:30 Intersected post-corner of
Sec^s 31 32 27 and 28 from which
cor I ran west on true line
between Sec^s 21 and 28

Va 13° 47' East

Township 13 N. Range 2 W.
Gila and Salt River Meridian

- 4015- Set a stone 16 X 16 X 10 in
a mound of stone 3 ft high
for $\frac{1}{4}$ Sec cor
- 8030 The corner of Sec 20, 21
28 & 29
Land broken soil mineral
Scattering pines and plenty
of brush.

North between Secs 20 and
21

Va 130 47' East-

- 4000 Set a stone 24 X 10 X 8 for
 $\frac{1}{4}$ Sec cor. from which
a pine 12 in dia bears N. 19 $\frac{1}{2}$ E 18' dia
a 70 in oak 10. " " N. 58 W. 26 "
- 5800 England Gulch bears west
has placer mines
- 7000 Summit of ridge on north
of gulch. bears E. + W.

Township 13 N. Range 2, W.
 Gila and Salt-River Meridian

50.00 Set a stone 36 x 36 x 36 for
 cor to Sec. 16, 17, 20 & 21
 from which
 a pine 20 in dia bears S 2 1/2° E 64
 " " 20 " " " S 69 1/2° E 80
 No others near

Land rolling Soil mineral
 Timber Pine and oak,

East-on random line between
 Sec. 16, and, 21

9a 130° 47' East-

27.00 Road from Hayes and Curtis
 Saw Mill to Prescott, NW and N.

40.00 Set temporary 1/4 Sec cor.

80.15 Intersected post-corner to Sec-
 16, 16 21 & 22 from which cor
 Run. west-on true line
 between Sec. 16 and, 21.

Township 13 N Range 2 W
 T61a and Salt River Meridian

va 13° 47' East-

4007 Set a stone 12x10x8 on a mound
 of stone 3ft high as per in structure
 for 74 Sec cor.

8015 The corner of Sec^s 16, 17, 20, and 21
 Level rolling Soil mineral
 Timber pine and oak.

North between Sec^s

16 and 17.

va 13° 47' East-

350 West-branch of Granite Creek
 runs N.E.

400 Road from Sterling mine
 to Prescott N.E.

4000 Set a stone 20x8x8 from which
 a pine 18 in N61W 25-links

No other marks.

5300 Dry creek runs East- 10 links
 wide

Township 13 North Range 2 W

Gila and Salt-River Meridian

50.00 Set a stone 18x12x8 in
 a mound of Stone 3ft-high
 For the cor to Secs 8, 9, 16, & 17
 No trees near
 Land rolling Soil
 poor. (mineral) Timber scarce

East on random line between
 Secs 9 and 16

Va 13° 47' East-

10.00 Dry creek runs NE 30 links wide

25.00 Road from Sterling mine to
 Prescott, and from Wyo and
 Curtis Sawmill.

26.00 Granite creek West-branch

20 links wide, N + N.E. running

27.00 Road from Gut-Saw mill to Prescott
 bears NW and West-

40.00 Set temporary 1/4 Sec cor

Township 13 N Range 2 W.

Gila and Salt River Merionis

- 72.00 East branch of Granite creek
40 links wide runs North then
N.E.
- 73.00 Road along bank of creek from
Banning to Gov Sawmill
- 80.20 Intersected cor of Sec^s
9 10 15 and 16 at post corner
from which I run West-
on true line between Sec^s
9 and 16.
Va 13° 47' East-
- 40.10 Set a stone 24 * 8 * 8 from
which a pine 20 in dia bears N 8° E 24 links
a pine 20 in dia bears S 69° E 27"
for 1/4 Sec cor.
- 80.20 The corner of Sec^s 8, 9, 16, 417
Land rolling Soil mineral
Lumber pine and oak.

Township 13 N. Range 2 W.

Gila and Salt River Meridian

North between Secs 8 and 9
va $13^{\circ}47'$ East

4000 Set a stone $12 \times 12 \times 8$ for $\frac{1}{4}$
sec cor as per instructions

No trees near on NW slope
of round conical hill 150
feet high.

8000 Set a stone $18 \times 12 \times 8$ for the
corner to sec^s 4, 5, 8, & 9 in
a mound of stone 3ft high
No trees near.

Land rolling, mineral soil
Timber scattering

East on random line
between Sec^s 4 and 9
va $13^{\circ}47'$ East

3200 George Lanto's house about
3 chains south of line

3400 Road from Hoyes and Curtis

Township 13 N Range 2 W

Gila and Salt-River Meridian

Saw mill bears N.E.

34.50 Euliel Judge Brooks field
bears N.E. House 5 chains East-

36.50 Granite Creek 75-links wide
runs N.E.

4000 Set temporary $\frac{1}{4}$ Sec cor.

8000 Intersected N. and S. line 34
links south of Port-corner to
Sec 34 9+10 from which cor.
I run $S 89^{\circ} 46' W$ on true line
between Sec 4 and 9

va $13^{\circ} 47'$ East-

4000 Set ^{stone} a, 15x8x8 in a mound of
stone for $\frac{1}{4}$ Sec cor. from which
a pine 20 in dia. bears $S 47\frac{1}{2}^{\circ} E$ 43
" Live oak, 8 " " N $60\frac{1}{2}^{\circ} E$ 76,

5000 The corner of Sec 4 5 8 + 9
Land rolling Soil
decomposed granite and mottled

Township 13 N Range 2 west-
Gila and Salt-River Meridian

North on random line
between Sect 4 and 5
Va $13^{\circ} 47'$ East-

- 5.00 Trace from Prescott to
Skull valley, bears E & W.
- 30.00 Mike's Field, fence bears S. E.
- 40.00 Set temporary $\frac{1}{4}$ Sec cor.
- 79.85 Intersected Township line
North, at a point 25 links
west of post-corners between
Sect 4 & 5 - from which point
I run $S 70^{\circ} 11' W$ on true line
between Sect 4 & 5 -
Va $13^{\circ} 47'$ East -

39.85 Set a stone 18 x 16 x 14 in a
mound of Stone 3 ft high for
 $\frac{1}{4}$ sec cor. N lines near

79.85 The corner of Sect 4, 5, 8, & 9
Land rolling Soil decom-
posed granite and mold.

Township 13 N. Range 2 West-
 Gila and Salt-River Meridian

North betw. Sec 31 and 32

Va. $13^{\circ} 47'$ East-

4000 Set a stone $18 \times 16 \times 8$ in a
 mound of stone 3 ft high
 No trees near.

8000 Marked a white-oak as
 per instructions for the corner
 to Sec 29, 30, 31, + 32. No other
 trees near.

Land broken

Soil unimproved No timber
 Short brush. Sept. 30, 1871

East on random

line between Sec 29 + 32

Va $13^{\circ} 47'$ East-

5000 Chain's Road from Sterling
 mill site, (quartz) bears N.W.
 and commenced ascent of hill
 bears N.W.

Township 13 N. Range 2 West-
Chico and Salt River Meridian

- 24.00 Summit of hill 300 feet high
Sterling Quartz mill 8 chains
south of this point
- 40.00 Set temporary 1/4 Sec cor.
- 42.00 Indian creek S.W. runs
- 50.30 Intersected the 1/4 and 8
line 40 links South of post-
corner from which I run
S 89° 43' W. on true line between
Sec 29 + 32.

Wa. 138 47' East-

- 80.15 The corner of 1/4 Sec. set-a
stone 18 x 14 x 12 from which
a W oak 20 in dia bears S 2 W. 20
a pine 14 " " " N 24 E 30

- 80.30 The cor of Sec 29, 30, 31 + 32
- Land broken soil
numerous scattering pines
and oak.

Township 13. N, Range 2 West-
Gile and Salt-River Provision

West on a random line
between Secs 30 & 31

va $13^{\circ} 47' E$.

- 200 Road to Sterling mine S.W.
14.00 " " " " " "
36.00 Shaft to quartz mine about
25 links north of line
40.00 Set temporary $\frac{1}{4}$ Sec cor.
42.00 Cañon 500 feet deep. bears
N. & S.
52.00 opposite side
80.20 Intersected West boundary
of Township 40 links south
of post corner. W Sec. 30 & 31
from which I run $S 89^{\circ} 43' E$
on true line between sec
30 & 31
va $13^{\circ} 49' East$
40.20 Set a post in mound with pits
W true mer for $\frac{1}{4}$ Sec cor.

Township 18 North Range 2 W
Gila and Salt-River Meridian

80.20 The corner to sec^s 29 30 31
and 32

Land broken and hilly
Soil mineral No timber
but plenty of brush.

North between Secs 29 and

30

va 130 47 East-

13.00 Road from Sterling mill to
Prescott, come from S.E.

17.00 Road from Sterling mill to
Prescott bears N, and N.E.

40.00 Marked a $\frac{1}{4}$ in dia for $\frac{1}{4}$ Sec
cor. No others near.

56.00 Walnut-Grove trail bears N.E.

76.00 Duchian creek runs S.E. 30 links
wide

80.00 Set a Stone 18 x 12 x 10 in mound
of Stone for the cor to sec^s

Township 13 N Range 2 W.

Gelev and Salt-River Meridian

19 20 29 + 30 from which
 a pine oak 8 in dia bears S 54° W 67 links
 " pine 36 " " " N 40° W 83 "

No others convenient

Land rolling Soil mineral

Timber on north end of line
 Pine Oak + c.

East-on random line between
 Secs 20 + 29,

va, 13° 47' East-

21.00 Road from Prescott to Sterling
 mine bears S.

40.00 Set temporary 1/4 Sec cor.

80.20 This cor of Secs 20, 21, 28, 29

I intersected the N x S line

18 links South of Post-corner
 from which I run S 89° 32' W,

on true line between Secs 20 and

Township 13 N Range 2 W.
Gila and Salt River Meridian

Va 13° 47' East-

- 40,10 Set-a stone 12x10x5- for $\frac{1}{4}$
Sec cor from which a
pin oak 10 in dia bears S83 $\frac{1}{2}$ E 36 links
" " 16 " " " N79W 45"
8020 The corner of Sec- 19, 20, 29, 30
Land rolling soil
abundant timber pine and oak

West-on new down line
between Sec- 19 and 30

Va 13° 47' East-

- 4,00 Crossed Indian Creek runs
S.E. 25-links wide
25,00 Mammoth quartz ledge, bears
N.E. and S.W.
4000 Set-stone for $\frac{1}{4}$ Sec cor.
4500 Deep ravine bears N.E.,
commenced slope of mountains
7000 Summit of range. N + S.

Township 13 North Range 2 W.

Gila and Salt-River Meridian

79.90 Intersected West boundary
of Township 35 miles W of
corner to Sec^s 19+30 from
which I run N. $89^{\circ} 45' E$
on true line between Sec^s
19 and 30

Va $13^{\circ} 47' East$

39.90 Set a stone $16 \times 10 \times 8$ for
1/4 Sec cor from which a
Pine 20 in dia, bears $S 54 \frac{1}{2}^{\circ} W$ 50 lin's
No others near. The cor stands on
Northern slope of hill

79.90 The cor of Sec^s 19, 20, 29, and 30
Land much broken
Soil mineral Not much
timber

North between Sec^s 19 and

20

Va $13^{\circ} 47' East$

38.00 West branch of Granite creek 14 lks

57
Township 13 N Range, 2 west
Gila and Salt River Meridian

wide runs East-

- 40.00 Set a stone 18x10x10 in
a mound of stone on north
bank of Granite creek for $\frac{1}{4}$ Sec
cor. No tree near.
- 80.00 Set a stone 16x16x8 in a mound
of stone 3ft high for cor to
Sec^s 17, 18, 19, and 20 No trees
near. Land rolling Soil
mineral Scattering timber
of Pine and oak.
-

East on random line between
Sec^s 17 and 20

wa 13° 47' East-

- 40.00 Set temporary $\frac{1}{4}$ Sec cor
- 76.00 West branch of Granite creek
25 links wide runs N.E.

Township 13 N, Range 2 W

Gila and Salt River Territorial

30.10 Intersected post-cor of Sec.
16, 17, 20, and 21, from which
cor. I run West on line
between Sec^s 17 and 20
Va 13° 47' East

40.05 Set a stone 20 x 10 x 10 for 1/4 Sec.
cor from which
a pine 36 in dia. bears S 9° W 29. 1/2 mi
" " 30 " " " S 72 1/2° W 38 "

50.10 The corner to Sec^s 7, 8, 17, and 18
Land rolling Soil mineral
Lumber Pine and oak on
Eastern end of line.

West on run down line between
Sec^s 18 and 19.

Va 13° 47' East

46.00 Set a stone ~~11 x 10 x 3~~ for temporary
1/4 Sec cor.

79.82 Intersected West boundary of

Township 13 N. Range 2 W.
Gila and Salt River Meridians

Township 32 links South
of the cor to sec = 18th and 19
from which cor I run
S 89° 47' E on true line
between Sec = 18 + 19

va 13° 47' East-

39.82 Set a stone 14 x 10 x 3 for 44
Sec cor. No trees near.

79.82 The corner of Sec = 17, 18, 19th and 20
Land broken Soil mineral
No timber

N.

North between Sec = 17th and
18.

va 13° 47' East.

800. Commenced ascent of
Quarby mountain 300 feet high
2000 Summit of Quarby mountain
round peak.

Township 13 N. Range 2 W.

Gila and Salt-River Meadows

- 2300 Quartz Ledge 40 feet-wide
bears NE, and SW. Said to be
barren.
- 3600 First-bench of Quartz mountain
on north side
- 4000 Set-a stone 16x10x4 in a mound
of white quartz rock, 3ft-high
from which a pine oak bears
East 10 links No other near.
- 5000 Second bench and foot of Quartz
mountain
- 6500 Conical hill with Aztec ruins
on summit 300 feet-high and
about 10 chains East of line
- 8000 Set-a stone 18x12x5 for the
cor to Sect 7, 8, 17, and 18,
from which
a pine 24 in dia bears N 19° W 25 1/2
" " 16 " " " N 53° W 19 "
- No others near

Township 13 North Range 2 W
Gila and Salt-River Mundain

Land broken and hilly
Soil mineral
Lumber scarce
Pine and oak,

East on random line between
Sec 8 & 9th, 17.

va. 13° 47' East-

4000 Set a temporary 1/4 Sec cor

8000 Intersected N + S line 40 links
South of post corner from which
Bran S 89° 43' W on true line
between Sec 8, 9th & 17.

va 13° 47' East-

4000 Set a stone 16 x 10 x 6 for
1/4 sec cor. in a mound of
stone 3 ft high

8000 The cor to Sec 7, 8, 17, 9th & 18
Land broken soil mineral

Township 13 N Range 2 W.

Chico and Salt River Mnd'ns

No timber scarcely plenty
of manzanita brush

West on section line between
Secs 7 and 18

ca $13^{\circ} 47'$ East-

2600 Entered manzanita brush bars
N and S.

3500 Dense growth of manzanita brush.

4000 Set temporary $\frac{1}{4}$ Sec cor and left
manzanita brush.

6800 Crossed trail from Skull valley
to Prescott bars N.E.

7000 Commenced ascent of hill bearing
N and S.

7960 Intersected West-boundary
line of Township 35 - links South
of post corner from which Down
 $S 89^{\circ} 45' E$ on true line between
Secs 7 and 18.

Township 13. N Range 2 west
Gila and Salt-River Meridian

Va 13° 47' East-

39.60 Set a Stone 18 x 10 x 8 for 1/4
Sec cor from which
A pin 18 in dia bears S 71° W, 32 1/2 "

" " 10 " " " N 32 1/2 E 30 "

79.60 The corner between Sec 7, 8,
17 and 18.

Land lully Soil mineral
Timber Pine and oak.

Oct-2^d 1871

North between Sec 7 and 8

Va 13° 47' East-

23.00 Trail from Skullvalley to
Prescott bears E and West-

40.00 Set a Stone 14, x 14, x 6, for
1/4 Sec cor from which.

A pin oak 8 in dia bears N 15 1/2° W, 18 1/2 "

" " " 10 " " " S 36 1/2° W, 31 "

57.00 Round conical hill with

Township 13 North Range 24

Yellow and Salt River Meridian

- 6500 Aztec ruins on summit - 150 feet high and about 10 chains East wood road bears N.E.
- 8000 Set a stone 24 x 12 x 12 for the cor to Sec 5, 6, 7, & 8, from which a Cedar 18 in dia bears N 56 1/2 W, 39 1/2; a pine oak 4 in dia bears N 43 1/2 E, 17 1/2. No others near.
- Land rolling soil mineral
Lumber Pine and oak.

East - on random line between Sec 5 and 8. VA 13° 47' East

- 2200 Wood road bears North.
- 4000 Set - temporary 1/4 Sec cor.
- 6100 Trail from Skull Valley to Prescott bears N.E.
- 8000 Intersected corner of Sec 4, 5, 8, 9 at post corner from which I run west on true line between

Township 13 N Range 2 W
Gila and Salt-River Meridian

Sec^s 5 and 8.

Va 13047' East-

4.00 Set-a stone 24 x 24 x 12 in
a mound of earth with pits
as per instructions in this case.

80.00 The corner of Sect 5, 6, 7, and 8
Land rolling soil
minimal timber scattering
along line.

Went on sandbar line
between Sect. 6 and 7.

10.00 Entered Manzanita brush bars
N and S.

26.00 Left Manzanita brush entered
pine timber bars N.E. + S.W.

34.00 Dry creek running N.E. 20 links
wide

40.00 Set temporary 1/4 Sec cor.

66.00 Manzanita brush on East-slope

Township 13 N. Range 2 W.
Chula and Salt River Meridian

of hill bears N and S.

79.60

Intersected West boundary line
to Township 20 miles N of post-
corner to Sec- 6 & 7 from which
cor I run N $89^{\circ} 51' E$ on true
line between Sec- 6 and 7.

Va $13^{\circ} 47' East$

39.60

Set a post- for $\frac{1}{4}$ Sec cor from
which a pine 10 in dia bears S $61^{\circ} E$ 23 lks
Jack oak 6 " " " S $81^{\circ} 1/2 W$ 15 "

79.60

The corner of Sec- 5, 6, 7 & 8
Land showing soil mineral
not but few pines along line

North on random line
between Sec- 5 and 6.

Va $13^{\circ} 47' East$

4000

Set temporary $\frac{1}{4}$ Sec cor

6900

Dry creek running N 6° 25-30 lks
wide

Township 13 N Range 2, W.

Gila and Salt River Meridian

- 79.80 Intersected North boundary
of Township 20 miles West
of Post-cor to Sec 5-²/₄ & 6,
from which cor I run S 89° W.
on true line between Sec 5
& 6. Va 13° 47' East
- 39.80 Set a stone 10 x 10 x 6 for 1/4 Sec
cor. from which a
Juniper 16 in dia bears N 16 1/2° W 21 miles
" 14 " " " N 42 1/2° E 61 "
- 79.80 The cor of Sec 5, 6, 7 and 8,
Land rollin's Soil
mineral Timber Pine and
cedar: scarce

Oct-30-1871.

Township 13 N. Range 2 W,
Gila and Salt River Meridian

General Description

This Township contains a large quantity of valuable timber land which is generally equally distributed throughout the Township, except in the South West portion of Secs 31st and 32nd.

There is not much farming land.

The general feature of the country is rolling, with a splendid growth of mountain grass. Prescott, a town of considerable size is situated in the East half of Sec. 4. There have been considerable quantities of gold taken from several places in the Township, and several lodes located.

W. H. Chase

Deputy Surveyor.

TOWNSHIP 13, N. RANGE 24 Gila and Salt River MERIDIAN

BOOK 1032

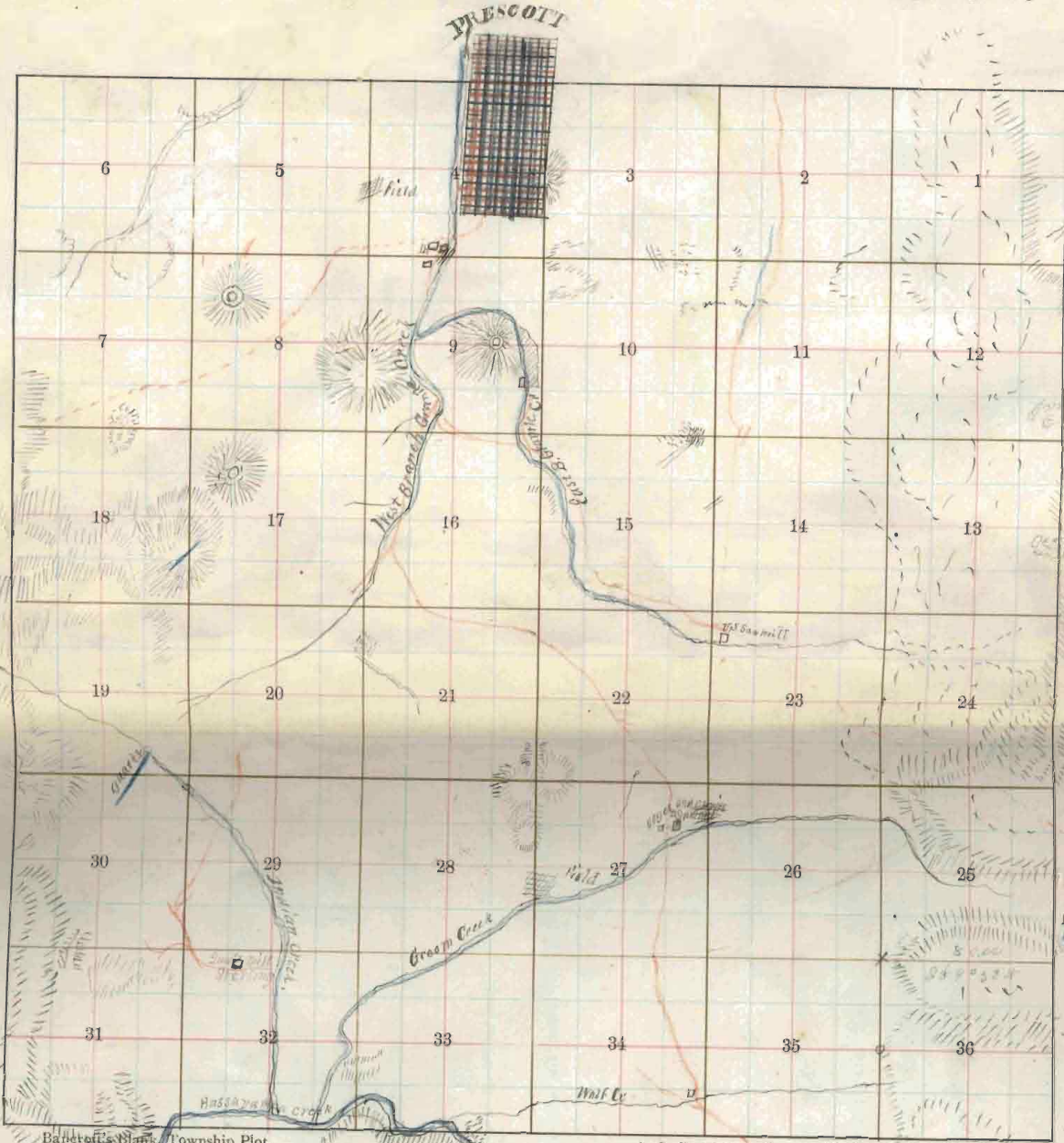

Bancroft's Blank Township Plot. A. L. Bancroft & Co., 721 Market St., San Francisco.

- Meridian Line,*
- Base Line,*
- Standard Line,*
- Township Lines,*
- Section Line,*
- Meander Lines,*
- Office Work,*
- Ranch Lines Re-survey*

BOOK 1032

List of Names.

List of the Names of the individuals employed to assist in running, measuring, or marking the lines and corners described in the foregoing Field Notes of Township No 13, North of Range, 2 West Exterior and Subdivision lines.

showing the respective capacities in which they acted.

A. M. Lindsay
 H. W. Scholer,
 J. T. Brickwood
 John Riley
 James B. Leary

Compassman.

Chainman.

Chainman.

Axeman.

Axeman.

Flagman.



Final Oaths of Assistants.

We hereby certify that we assisted *Oscar*
H. Case Deputy Surveyor, in surveying

The Exterior and Subdivision lines
 of Township No 13 N. Range No 24.
 Gila and Salt. River Meridian
 Arizona Territory.

and that said Survey has been in all respects, to the
 best of our knowledge and belief, well and faithfully sur-
 veyed, and the boundary monuments planted according to
 the instructions furnished by the Surveyor-General.

H. M. Lindsay

H. W. Schooles

F. J. Pickwood

John Riley

James O'Leary

Subscribed and sworn to before

me this 2^d day of Nov. 1891.

E. Cowells

County Clerk

Final Oath of Deputy Surveyor.

I, *Omar H. Case*
Deputy Surveyor, do solemnly swear that, in pursuance
with a contract with *John W. Mason*
United States Surveyor-General for Arizona, bearing date
the 17 day of *July 1871*, I have well, faithfully
and truly, in my own proper person, and in strict con-
formity with the instructions furnished by the Surveyor-
General, the Surveying Manual, and the laws of the
United States, surveyed all those parts or portions of
the exterior and subdivision lines
of Township No 13 North of Range
12 West of the Gila and Salt River
Meridian

as are represented in the foregoing Field Notes as having

been surveyed under my directions; and I do further solemnly swear that all the corners of said surveys have been established and perpetuated in strict accordance with the Surveying Manual and printed instructions, and that the foregoing are the true and original Field Notes of such Survey.

Omar H. Case
U. S. Deputy Surveyor.

Subscribed and sworn to before me, this 20th-
day of Nov. 1871

Crowwells
Ohio Dist Court
3^d Dist Ohio



Surveyor General's Office
Tucson A.T.

January 29th 1872

The foregoing field Notes of the survey of the Subdivision lines of Township 13 N. Range 2 W. of the Gila and Salt River Meridian and Base line in the Territory of Arizona, executed by O. H. Case of. Deputy Surveyor under his contract dated July 17th 1871 having been critically examined, the necessary corrections and explanations made, the said field Notes and the Surveys they describe are hereby approved.

John Masser
of. Surveyor General
for Arizona

Preliminary Oaths of Assistants.

I, _____ do solemnly swear that I will well and truly perform the duties of Compassman, according to instructions given me, and to the best of my skill and ability.

Subscribed and sworn to before me, this _____ day of
187

U. S. Deputy Surveyor.



We, A. M. Lindsay and

H. W. Schooler

do solemnly swear that we will faithfully execute the duties of Chain Carriers; that we will level the chain upon uneven

ground, and plumb the tally pins, whether by sticking or dropping the same; that we will report the true distance to all notable objects, and the true length of all lines, that we will assist in measuring, to the best of our skill and ability.

J. H. Lindsay
H. W. Scholer

Subscribed and sworn to before me, this 25th day of
Sept. 1871

U. S. Deputy Surveyor.
C. W. Wells

Clerk Dist Court
2^d Dist at



I, *John Riley*
do solemnly swear that I will well and truly perform the
duties of *Mound Builder*
according to instructions given me, and to the best of my
skill and ability.

John Riley

Subscribed and sworn the be before me, this 25th
day of *Sept* 1871

E. A. DeWitt

M. S. Deputy Surveyor.

Cowweller

Clario Dick Conn

3rd dist ad.



BOOK 1032

4-674.

Township 11 N. R. 3 W. S. 22 N. 32 W.

6	125	5	114	4	104	3	93	2	92	1
	124		123		113		103		91	91
7	122	8	112	9	102	10	90	11		12
	121		121		111		101			
18	120	17	111	16	100	15	89	14		13
	119		118		110		98		88	81
19	117	20	109	21	97	22	87	23	80	24
			116		108		96		85	79
30		29	107	28	96	27	84	26	78	25
			115		106		94		83	77
31		32	106	33	94	34	82	35	77	36

Field Notes of Subdivision Lines

Twp. 11 North R. 3 W. 6th and Salt River Meridian

Begin at the corner of Sec^s
 1, 2, 35, and 36 on South Boundary
 of Twp Subdivisions commen-
 ced - Oct-10th 1871

North between Sec^s 35 and 36
 Va. 13° 45' East

4,000 Set a stone 14 x 10 x 7 for 14 Sec cor
 in a mound with pits as per instruction

4,200 East Branch of Neesayampa, runs
 S.W.

6,100 Opposite bank, bears South,

8,000 Set a stone 24 x 16 x 8 in a mound
 with pits for cor to Sec^s 25, 26,
 35 and 36.

Land mostly level Soil 1st/₂ mile

East on random line between Sec^s
 25 and 36.

Va. 13° 45' East

Township 11 North Range 3

West-Gila and Salt River Meridians

- 20.00 East Branch of Massayampa,
creek, runs S.W. 400 chains wide
- 40.00 Set a stone for temporary $\frac{1}{4}$
Sec. cor.
- 79.90 Intersected East-Boundary of
Township 10 links South of
post-cor to Sec. 25th and 36th
from which cor I run S $89^{\circ}56'N$
on true line between Sec 25th and 36th
Va $13^{\circ}45'$ East
- 39.95 Set a stone 16x10x8 in a mound
with pits for $\frac{1}{4}$ Sec. cor. No trees
- 79.90 The corner to Sec 25, 26, 35, 36
Land mostly level
Soil 1st salt.

North between Secs 25, and 26,

Va. $13^{\circ}45'$ East

- 20.00 Little Valley of grammar grass
bears S.W. 100 links wide

Township 11 North Range, 3 N.
Gila and Salt River Meridian

- 4000 Set a stone 12x12x4 in a mound
with pits as per instructions
for 1/4 Sec cor.
- 2000 Set a Stone 18x14x8, in a mound
of stone 3ft-high for the cor
to Sec^s 23, 24, 25, 26
on S. West-point of granite hill.
Land mostly gently rolling.
Soil 1st rate.
- 000 East on random line between Sec^s
24 and 25.
Dir. 13° 45' East.
- 400 Summit of granite hill with
ruins of Aztec buildings thereon
bears, NW and SE.
- 400 Set temporary 1/4 Sec cor
- 150 Arroyo runs SE 75 links wide
- 8000 Intersected cor of Sec^s 19, 20, 24, 25

Township 11 North Range 3 N,
Gila and Salt River Meridian

from which cor. I run
West on true line between
Sec^s 24 and 25-

4000 Va. $13^{\circ} 45'$ East -
Set a stone 12 x 10 x 10 in
a mound of Stone 3 ft high
for $\frac{1}{4}$ Sec. cor.

5000 The corner to Sec^s 23 24 25 -
and 26,

Land rolling granite-
hills. Soil poor. No timber

North between Sec^s 23 and
24,

Va. $13^{\circ} 45'$ East

4000 Set a stone 18 x 12 x 10 in
a mound of Stone as per in
structures for $\frac{1}{4}$ Sect. cor.

8000 Set a stone 18 x 18 x 10 for
the cor to Sec^s 13, 14, 23, and 24

Township 11 North Range 31,
Chelan and Silet River Meridian

at the foot of high mountain
of Volcanic scoriae
Land rough and broken
Soil poor. No timber

East on random line between
Sec^s 13, and, 24,

N. 13° 45' East-

4000 Set temporary 1/4 Sec cor.
8020 Intersected East boundary
line 30 links South of post
corner W Sec^s 13, and, 24,
from which corner Osun 1890
49' N on true line between
Sec^s 13 and 24

N. 13° 45' East

4010 Set a stone 10 x 10 x 10 a piece
of Volcanic scoriae in a mound
of same for 1/4 Sec cor.
8020 The corner W Sec^s 13, 14, 23, & 24

Township 11 North Range 3 W.
 Gila and Salt River Meridian

Land rolling and broken.

Soil poor. No timber

On account of Black Mountain
 I did not run this line further
 north. Mountain bears E & W,
 about - 400 feet high of Black
 Volcanic scoriae

North between Secs 34th and 35-

Va. 13° 45' East -

- 20.00 Entered Mesa Land Line
 runs along George Jacksons
 field on west side
- 21.00 George Jackson's house 3 chains
 East
- 40.00 Set a stone 18 x 15 x 6 in a
 mound of stone 3 ft high for the
 cor of 1/4 Sec.
- 42.00 Ditch for farming purposes about

Township 11 N. Range 3 W.

City and Salt River (Puridian)

200 chains East bears N E + South
 8000 Set a stone. Yellow Granite
 12x12x4 in a mound of Stone
 3ft high for the corner of Sec.
 26, 27, 34, and 35 - NW cor.
 Land rolling Soil 1st and 2^d
 rate.

East on random line between
 Sec. 26, and 35

va 13° 45' East

10.00 Left - mesa land Entered bottom
 land bears S W, + N E
 11.00 Trail from Jacksons up the
 Hoassayumpa creek bears N. E.
 16.00 Irrigation ditch runs S W. and
 entered field bears S W and N W.
 20.00 Hoassayumpa creek dry bed 150 links
 wide runs S. E.
 30.00 Irrigation ditch runs S W.

Township 11 N. Range 3, W.

Gila and Salt River Meridian

- 3200 Left bottom corner entered
 Mean bears N^W and S^E,
- 4000 Set temporary $\frac{1}{4}$ Sec cor.
- 8000 Intersected N and S line at
 Post-corner to Sec^s 25, 26, 35, 4, & 36
 Land mostly gently rolling
 Soil 1st and 2^d rate
 From which cor. (25-26 35-4 & 36)
 I run west on true line
 Va 130 45' East-
- 4000 Set Stone 12 x 10 x 8 in a mound
 with pits as per instructions
- 8000 The corner to Sec^s 26, 27, 34, & 35-

North between Sec^s 26th & 27

Va 130 45' East-

- 1200 House 10 chains East of line
- 3800 Strays 100 links wide runs S^E
 House 7 chains East-

Township 11 N. Range 3 W.

Gila and Salt River Meridian

- 4000 Set a Stone 16 x 10 x 8 in a mound of stone for $\frac{1}{4}$ Sec cor No trees
- 7500 Commenced ascent of hill, 200 feet high bears E. + W.
- 8000 Set a Stone 18 x 14 x 18 in a mound of stone 3 ft high on Southern slope of hill for the cor to Sec^s 22, 23, 26, 27
Land mostly rolling
Soil 2^d rate.

East on random line between Sec^s 23rd and 26.

va 13° 45' East

- 2600 Mesa overlooking bottom of Horse-gampe bears N + W and South,
Allen Cullumber's house + chain's North. Quarry mill 100 links west of house.

Township 11 North Range 3 W.
Gila and Salt River Meridian

- 32.00 Cassayumpa creek runs S.E.
40.00 Set temporary $\frac{1}{4}$ Sec cor.
in field
46.00 Left field entered mesa lands
47.00 Road bears N.W. & S.E.
75.00 Rocky ridge bears N.W. and East
80.00 Intersected N & S line at
post corner, from which I
run west on true line between
Sec^s 23 and 26.

On $13^{\circ}45'$ East

- 40.00 Set a stone $12 \times 8 \times 8$ in Callender
field 5 chains east of west line
of field for $\frac{1}{4}$ Sec cor.
90.00 Intersected the corner to Sec^s
22, 23, 26, 27

Land mostly level
Soil 12th rate.

Oct 10th 1871

Township 11 North Range 31W
 Gela and Salt River Meridian

North between Sec^s 22nd & 23

va 13° 45' East

- 000 Summit of hill bearing E & N.
 1000 Foot of range on North side
 1500 Irrigation ditch runs East
 Flume over bed of creek 6 chains
 East-flume bears E
 2000 Kasseyampa creek runs
 S.E. Wry bed, 15-20 links wide
 2500 Set a stone 16 x 12 x 8 in corner
 of stone 3 ft high for 1/4 Sec
 cor. No trees
 3000 Road from Walnut Grove to
 Skullvalley up bed of Kasseyampa
 bears N.W.
 4000 Set a stone 12 x 10 x 8 in corner
 with pits for the corner to
 Sec^s 14, 15, 22, 23 W trees.

Township 11 North Range 3 N.
Gila and Salt River Meridian

East on random line between
Sec 14 23

Var. $13^{\circ}45'$ East

11.00 Arroyo 100 links wide runs
Sib.

4000 Set temporary 14 Sec cor.

8020 Intersected N 2d S line 30
links South of Post corner to
Sec 13 14 23 & 24 from
which corner I run $S 89^{\circ}47' W$
on true line between Sec 14 23

Var. $13^{\circ}45'$ East

4070 Set a stone $18 \times 12 \times 8$ in a
mound of stone 3 ft high
for 14 Sec cor

8020 The corner to Sec 14 15-22
and 13.

Land on Eastern end of
line much broken on weather
rolling Soil Bar

Township 11 N. Range 3 W.
Gila and Salt River Meridian

North between Sec 14th & 15th
2300 ^{at 13°45' East} Arroyo running S. E. 40 feet
wide

4000 Set a stone 14 x 10 x 8 in mound
of stone on west slope of Volcanic
Mountain for 4 Sec cor.

5000 Set a stone 12 x 12 x 12 in mound
of stone 8 ft high on west
slope of Volcanic Mountain
for the cor to Sec 10 11
14th & 15th

Land rolling on west of
line East Mountains

Soil 2^d rate west - Poor East

East on random line between
Sec 11th & 14th.

at 13°45' East

The fine crops high mountain
of Black volcanic stone of 100

Copied

Township 11 North Range 3 N
 Gila and Salt River Meridian

of no value

Therefore I run
 North between Sec 10^{9d} 11

On $13^{\circ} 45'$ East-

- 2200 Crossed West-Spurr of Volcanic
 mountain 150 feet high bears
 E and west
- 4000 Set a post in a mound with
 pits as per instructions
- 4800 Arroyo runs West and SW
 100 links wide
- 8000 Set a post in a mound
 with pits for the cor to
 Sec 2, 3, 10, 9d 11
 Land rolling westerly
 Easterly prominent
 Soil 2 rate good grazing

Township 11 North Range 2 N,
Gila and Salt River Meridian

East on true line between
Sec^s 2 and 11,

Or $13^{\circ} 45'$ East

3700 Arroyo running South 15 links
wide

4000 Set a stone $10 \times 8 \times 8$ in mound
with pits for $\frac{1}{4}$ Sec cor.

5500 Arroyo, running SW. 50 links wide

5000 Set a stone $20 \times 18 \times 16$ in a mound
of stone 3 ft high for the cor.
to Sec^s 1, 2, 11, and 12,

Land selling Soil 2^d rate
No timber

East on random line between
Sec^s 1 and 12

Or, $13^{\circ} 45'$ East

4000 Set temporary $\frac{1}{4}$ Sec cor

5200 Arroyo SW 15 links wide

7982 Intersected N. and S. line 40
links N. of cor. post to Sec^s

Township 11 N. Range 3 W.
Gilev and Salt River Meridian

1st and 12, from which cor
Down start

N. $89^{\circ}43'$ W on true
line between Sect 1 and 12

Va. $13^{\circ}45'$ East

3991 Set a post in mound with
fits for $\frac{1}{4}$ Sec cor. in trees
near

7982 The corner to Sect 1, 2, 11, 12
Land rolling Sect 2nd into

North between Sect 1 and
2 on random line

Va $13^{\circ}45'$ East

4000 Set temporary $\frac{1}{4}$ Sec cor

8010 Set section North Boundary
of Township at cor of ^{1st and 2nd}
which Down South on true
line between Sect 1 and 2 Va $13^{\circ}45'$ E

4010 Set post in mound for $\frac{1}{4}$ Sec

Township 11 N., Range 3 W.
Gulea and Salt River Meridians

cor. No trees

8010 The corner to Sec^s 12, 11, 10th
Land rolling and brushy soil
per. No timber

North between 2nd and 3rd on
random line

Va 13° 45' East

4000 Set temporary 1/4 Sec cor
7984 Intersected North boundary
of Township at post
corner between Sec^s 2nd and
3rd, from which cor I run
South on true line between
Sec^s 2nd and 3rd

Va 13° 45' East

3984 Set a stone 18x10x8 in a
mound of stone 3 ft high for
1/4 Sec cor. No trees

394

Township 11 N Range 3 W.
Gila and Salt River Meridian

79,84 The corner to Sec^s 2, 3, 10, 11
Land rolling Soil poor
No timber. Short-brush
along the line.

North between Sec^s 33rd & 34th
14,50 ^{22, 13th & 14th E} Arroyo runs S E 30 links wide
40,00 Set a Stone 18 x 14 x 10 in
a mound of Stone 3 ft high
for the cor to 1/4 Sec^s.

80,00 Set a stone 30 x 16 x 4 on East-
slope of hill in a mound of
stone 3 ft high for the cor
of sec^s 27, 28, 33, 34

Land rolling Soil
1st & 2^d rate. No timber

East on random line
between Sec^s 27th & 34th

Township 11 N. Range 3 W
 Celeo and Salt River Meridian

VA. 13° 45' East

- 1700 Sleep bank above Grants, Creek
 or Placeritas creek, runs SE
 100 links wide dry bed.
- 2000 Mound on East side of creek
 Gently sloping towards the East
- 4000 Set temporary $\frac{1}{4}$ Sec cor.
- 7100 Arroyo, bears SE 9 chains wide
- 8000 Intersected N and S line at
 post-corner, to Sec 26, 27, 28, and
 33, from which I run
 West on true line between
 Sec 27 and 34.

VA 13° 45' East,

- 4000 Set a stone 12 x 8 x 8 in a
 mound of stone 3 ft high
 for $\frac{1}{4}$ Sec cor NW true
- 8000 The cor to Sec 27, 28, 33, and 34,
 Land gently rolling Soil
 1st and 2^d rate,

Township 11 No Range, 3 W.
 Clear and Salt River Meridian

North between Sec^s 27th & 28th

Pa. 13045' East -

9,000 Cañon of Pleaster creek
 runs East. 50 links wide dry bed
 25 feet deep.

4,000 Set a stone 20 x 16 x 14 in
 a mound of stone 3 ft high for
 1/4 Sec cor. cor stands on point
 of rocky hill

6,000 descent of little hill line
 continues along East slope
 of hills.

8,000 Set a stone 16 x 14 x 12 in a mound
 of stone 3 ft high for the cor.
 to Sec^s 21, 22, 27th and 28

Land rolling to timber
 Soil mineral. (Placer Gold)

Oct - 11 1871

East on random line between
 Sec^s 22nd and 27

Township 11 North Range, 3^d N,
 6th and Salt River Meridian

Va. $13^{\circ} 45'$ East

4000 Set temporary $\frac{1}{4}$ Sec cor,
 88

8050 Intersected N and S line 20'
 links South of post corner to
 Sec^s 22 23 26 and 27 from
 which cor I run $S 89^{\circ} 52' W$,
 on true line between Sec^s 22
 and 27.

Va $13^{\circ} 45'$ East

4025 Set a stone $18 \times 10 \times 8$ in a
 mound of stone 3 ft high
 for $\frac{1}{4}$ Sec cor.

8050 The corner of Sec^s 21, 22, 27, 28
 land much broken and hilly
 Soil mineral (Placer gold,)

North between Sec^s 21 and
 22.

Va, $13^{\circ} 45'$ East

Township 11 N. Range. 3 W.
Gilev and Salt River Meridian

- 500 Line runs along west side
of Gulch. and up mountain
range
- 2500 Summit bears E 9d W.
and commenced descent
North.
- 4000 Set a stone 20x10x4 in a
mound of Stone for 1/4 Sec
cor.
- 8000 Set a stone 16x14x8 in
a mound of stone 3 ft high
on North side of a gulch
for the corner to Sec 21 and 22 159016
Land rolling and hilly
Soil Mineral. Quartz ledges
No timber

East on random line between
Sec 18 and 22.

Va 13° 45 East

Township 11 N. Range 3 N.
Gila and Salt River Meridian

- 4000 Set a temporary $\frac{1}{4}$ Sec. Cor
- 4200 commenced descent of hill overlooking Hassayampa creek,
- 5000 Entered Gilet bars N.S.
- 5200 Hassayampa creek, runs South
- 6000 Little Steve house, 10 chains North, and left side bars N.S.
- 80.30 Intersected N and S line $\frac{3}{4}$ miles South of post cor 15 Sec - 14 15 22 and 23 from which cor I run S 89 $4\frac{1}{2}$ W on true line between Sec - 15 and 22,
- Va. 13° 45 East
- 40.15 Set $\frac{1}{4}$ Sec cor a Stone 16 X 14 X 4 in a mound of Stone 3 ft high for $\frac{1}{4}$ Sec cor.
- 8030 The corner to Sec - 15/16 21 and 22
Land broken and rolling

Township 11 North Range 3 N
Gila and Salt River Meridian

Soil 1st and 3^d rate -
Some timber along creek
bottom Mostly Cottonwoods

- 3000 North between Sec^s 15 and 16
Left mesa land and com-
menced ascent of black
volcanic range.
- 3200 Summit of range near N.W.
and S.E.
- 4000 Set a stone 18 x 16 x 4 on
North-slope of hill for 1st
Sec cor. N.W. cor.
- 5500 Foot of Mountain range near N.W.,
and entered level mesa land
- 7500 Canoa 100 links wide 20 feet-
deep runs S.E.
- 7700 Lambertsons Irrigation ditch
runs, S.E.

Township 11 N. Range, 3 W.
Glebo and Salt River Indian

2000 Set a post on a mound with
 pits ^{the corner to Secs. 9, 10, 15, 16} from which a Cottonwood
 10 in bear S 19° E 16 links
 a cotton wood 10 bear S 52 1/2° W, 52 links
 a " " 9, in bear, N 25 1/2° W, 25 "
 Land mostly - hilly soil poor.

East on random line between
 Sec 10 and 15.

to 13° 45' East.

600 Massayampa creek 150 links wide
 two channels, ^{field} W. end on east-
 bank

1500 Left field entered the ~~land~~ land
 bear NW SE house 4 chains
 south. John White's

1800 Left Mesa and entered field again
 bear NE

2000 Left field entered Mesa land
 bear NE. Grave yard, 5 chains south

Township 11 N. Range 3 W.
 Gela and Salt River Mountains

on little hill.

- 2500 Road from Walnut-Grove
 to Skull Valley bears N.W.
- 4000 Set a stone for temporary
 $\frac{1}{4}$ Sec Cor
- 8020 Intersected Nth line at
 foot-corner between Sec^s 10, 11, 14,
 and 15 from which cor^d I
 run West on true line between
 Sec^s 10 and 15—
 Val. 130° 45' East—
- 4010 Set a stone 14 x 12 x 10 in a
 mound of stone 3 ft high for
 $\frac{1}{4}$ Sec Cor. N.W. cor
- 8020 The corner to Sec^s 9, 10, 15, 16.
 Land rolling mostly
 Soil 2nd and 3rd rate—

North between Sec^s

9 and 16

Township 11 N. Range, 8 W.

Gila and Salt River Meridian

Pa. 13° 45' East

5000 Massayampa Creek, runs
S.E. 2 or 3 miles wide, and
entire bottom of Massayampa
with some timber

1800 Left-bottom entered mesa land
bear N.W.

4000 Set a stone 16 x 10 x 4 in
a mound of stone, for 1/4
See cor.

8000 Set a post in a mound with
posts for the cor to sec^s 3, 4, 9th & 10
W mes near.

Land mostly rolling soil
1st rate - Scattering Cottonwoods
along the - creek.

East on random line between
Sec^s 3rd & 10

Pa. 13° 45' East

Township 11 N. Range 3 West
Gila and Salt River Meridian

- 4000 Set temporary $\frac{1}{4}$ Sec cor.
 2000 Intersected N and S line
 15 links South of post corner
 between Sec^s 2, 3, 10, and 11
 from thence run $S 83^{\circ} 54' W$ on
 true line between Sec^s 3 and 10
 Va $13^{\circ} 45'$ East -
- 4000 Set a stone $14 \times 10 \times 6$ in a
 mound of stone 3 ft high for
 $\frac{1}{4}$ Sec cor.
- 3000 The cor to sect. 3, 4, 9, and 10
 Land gently rolling soil
 Prati-

North on random line between
 Sec^s 3 and 4

Va $13^{\circ} 45'$ East

- 2500 Two houses 200 links west
 of line John Brunger
 and field bears N, and S,

Township 11 N, Range, 3 W.
Gila and Salt River Meridian

- 4000 Set temporary $\frac{1}{4}$ Sec cor.
5800 Left mesa land entered bottom
land bears N, and S,
6000 Hills about 5 chains west
bears N, and S,
400 Abrupt mesa bear NW and SE
30 feet high
7100 Commenced ascent of hill
150 high bear E, N, N,
7990 Intersected North Boundary
of Twp. 33 links East of
post-cor, from which cor
Drun $S 0^{\circ} 15' E$ between Sec
3 and 4.

Dir. $130^{\circ} 45'$ East

- 3990 Set a post in a mound with
pins for the cor to $\frac{1}{4}$ Sec L,
9990 The cor of Sec L 34 9th and 10
Land mostly rolling
Soil 2^d rate

Township 11 N. Range 3 W.
Gila and Salt River Meridian

North between Sec 32nd & 33

VA. 138° 45' East

4000 Set a stone 18x10x8 in on
mound of stone 3ft high
for $\frac{1}{4}$ Sec cor.

8000 Set a stone 24x20x12 in
a mound of stone 3ft high
for the corner to Sec -
28 29 32nd 33

Land broken and hilly
Soil mineral No timber

East on random line between
Sec 28th & 33.

4000 Set temporary $\frac{1}{4}$ Sec cor

4200 Line runs along side of
steep hill bearing E & N.

79.80 Intersected Nor. & S. line
25 links South of post corner
to Sec. 27 28 33 and 34

Township 11 N. Range 3 W.
Gila and Salt River Meridian

from which corner A
run S 89° 49' W on true
line between Sec^s 28nd and 33rd
Va 13° 45' East

3970 Set a stone 12 x 10 x 10 in
a mound of stone 3 ft high
for $\frac{1}{4}$ Sec cor.

3980 The cor to Sec^s 28, 29, 32, 33
Land rolling mesa. Soil
mineral (Gold quartz)
Good grazing No. timber
Oct-12, 1871

North between Sec^s 28
and 29.

Va. 13° 45' East

800 Commenced descent of mesa land
sloping N.

4000 Set a stone 18 x 14 x 14 in
a mound of stone 3 ft high
for this corner to $\frac{1}{4}$ Sec

Township 11 N. Range 3 N.
Gila and Salt River Meridians

- 6200 Gravel or Placer
Creek. 25 links wide runs
SE dry bed
- 8000 Set a stone 18x16x10 in
a mound of stone 3 ft high
for the corner to Sec 2
20 21 28 and 29
Land, hilly Soil mineral
Placer gold.
No timber

- East on random line between
Sec 21 and 28. $\text{Va. } 13^{\circ} 45'$
- 4000 Set a stone for temporary
44 Sec. cor.
- 80,20 Intersected N. and S line
18 links N of corner to
Sec 21 22 27 and 28
from which cor I run N. 89°
 $52'$ E on true line between

Township 11 N. Range, 3W
Gila and Salt River Meridian

Sec - 21 and 28

4010 Set a stone 30 x 20 x 20
in a mound of stone
3ft high for the corner to
1/4 Sec

8020 The corner to Sec 20
21, 28, and 29

Land broken and hilly
Soil mineral (Plains gold)
No timber

North between Sec 20 and 21
on 13° 46' East

900 Left rolling land entered
Mesa land. bears N and E

4000 Set a stone 16 x 8 x 8 in a
mound of stone 3ft high
for 1/4 Sec cor. No trees

8000 Set a stone 20 x 10 x 10 in
a mound of stone 3ft high

Township 11 N. Range 3 W
Giles and Salt River Meridians

for the corner to Secs 16, 17, 20,
and 21, Land mostly level
Soil 2^d rate good grazing
No timber

East on random line
between Secs 16th and 21

44.00 Set temporary $\frac{1}{4}$ Sec cor.
70.00 Ridge of rocks 8 feet high bears
N. and S.

80.10 Intersected N and South line
30 links south of post cor.
to Secs 15, 16, 21 and 22 from
which cor I run S 89° 47' W
on true line

Dir. 13° 45' East -

44.05 Set a stone 12 x 12 x 6 in
a mound of stone 3 ft high for
 $\frac{1}{4}$ Sec cor., No true

80.10 The cor to Secs 16, 17, 20, th and 21

Township 11 N. Range 3 N.
Gila and Salt River Meridian

Land mostly level mesa
sloping S.E. Soil 2^d rate
good grazing No timber

North between Sec^s 16th and 17th
va. 13° 45' East

4000 Set a stone 16x10x10 in
a mound of stone 3ft high
for $\frac{1}{4}$ Sec cor

8000 Set a stone 18x10x8 in
mound of stone 3ft high
for cor to Sec^s 8, 9, 16, and 17
Land on North end of line
rolling Soil 2^d rate No
timber good grazing

East on random line between
Sec^s 9th and 16th,

va 13° 45' East

4000 Set - temporary $\frac{1}{4}$ Sec cor

Townships 11 N Range 3 W,
Gila and Salt River Meridian

- 61.00 Bluff overlooking Massayampa
creek bottom bears N. 4th S.
- 76.00 Lamberton Irrigation ditch
bears S. E.
- 80.00 Intersected N 4th S line
at post corner to Sec 8
9, 10, 15, and, 16 from which
Drun West du true line betw 9 & 16
Va. 13° 45' East - 9
- 40.00 Set a stone 10 x 10 x 8 in mound
of stone 3 ft high for 1/4 Sec cor.
- 80.00 The corner to Sec 8, 9, 16, 9th 17
Land broken Soil 2' salt
No timber.

North between Sec 8 and 9

Va 13° 45' East

- 40.00 Set a stone 18 x 10 x 6 in
a mound of stone 3 ft high
for 1/4 Sec cor. No trees

Township 11 N Range 3 W,
 Celeo and Salt River Meridian

8000 Set a Stone 12 x 10 x 8 in
 a mound of stone 3 ft high
 for the cor to Sec^s 4, 5, 8, 9 and
 9. No trees
 Land rolling Soil 2^d rate
 No timber

East on random line between
 Sec^s 4 and 9.

Va. 13⁺45'E

4000 Set temporary 1/4 Sec cor.
 5000 Bluff overlooking Hassayampa
 creek bottom, bears N.W.
 6000 Hassayampa creek runs
 South 100 links wide, Road along bed
 8000 Intersected N and S line at
 just cor to Sec^s 3 4 9 and
 10 from which I run West
 on true line between Sec^s
 4 and 9.

Township 11 N. Range 3 W.
Chula and Salt River Meridian

Va. $13^{\circ} 45'$ East

4000 Set a stone on summit of
little hill $16 \times 10 \times 10$ per $\frac{1}{4}$
Sec cor

8000 The corner to Sec 4, 5, 8 & 9.
Lance rolling soil 2^d rate
Some timber on banks of
creek. Bearing N.W. S.E.
Cottonwood

North on random line
between Sec. 4 and 5

Va. $13^{\circ} 45'$ East

4000 Set temporary $\frac{1}{4}$ Sec cor

61.00 Little creek runs East-dog
bed.

78.00 Road from Skull valley to
Walnut Grove.

79.30 Intersected N. Boundary of
Township 38 miles East

Townships 11 N, Range 3 W,
Cedar and Salt River Mountains

of post cor to Sec 4
4 and 5 from which cor
I run S-0°17'18"E between Sec 4
4 and 5

Va 13°45' East

3950 Set a stone 20x10x4 in a
mound of stone 3ft high for
the cor to 1/4 Sec.

7950 The corner to Sec 4, 5, 8, and 9
Land rolling soil 2^d rate
No timber.

East on random line between
Sec 29 and 32

Va 13°45' East

1000 Cottonwood creek, runs S. E. 10 links
wide

4000 Set temporary 1/4 Sec cor.

7980 Intersected N and S line 20 links
south of post-cor from which

Townships 11 N. Range, 3 W
Gila and Salt River Meridian

Run S $89^{\circ} 52'$ W. on true
line between Sect 29 and 32
Va $13^{\circ} 45'$ East -

3490 Set a stone $12 \times 12 \times 10$
in a mound of stone 3 ft
high for $\frac{1}{4}$ Sec cor

79.80 The corner to Sect 29 30 31
and 32. Land broken Soil
Mineral (Quartz.)

No timber

Oct 13th 1871

East on random line between
Sect 20 and 29

Va. $13^{\circ} 45'$ East

4000 Set temporary $\frac{1}{4}$ Sec cor
Line runs along bluff overlooking
Placenta creek, trail to Walnut Grove.

5800 Placenta creek running SE 20
fakes aride

8000 Intersected N and S line

Township 11 N. Range, 8 W
Chula and Salt River Meridian

40 links South of post
corner to Secs 20, 21, 28, ²⁹ 29
from which cor & run
S 89° 43' W. on true line
between Secs 20 and 29
Va 13° 45' East

4000 Set a stone 18 x 16 x 4 for 1/4
Sec cor on North slope of bluff.
8000 The cor to Secs 19 20 29
and 30.

Land rolling and hilly
Soil mineral (Gold)

North between Secs 19 and
20

Va. 13° 45' East

2000 Blue river creek runs S.E.
30 links wide dry bed.

4000 Set a stone 16 x 14 x 8 in
a mound of stone 3 ft high

Township 11 N. Range 3, W.
Gila and Salt River Meridian

for $\frac{1}{4}$ Sec cor. W was
and entered. These land
bears N.W.

8000 Set a stone $20 \times 18 \times 18$ in
a mound of stone 3 ft high
for the cor to Sec 17 18 19 and
20

Land rolling and level soil
Mineral and 2^d rate grazing
land. No timber

East on random line between
Sec 17 and 20.

Pa. $13^{\circ} 45'$ East

4000 Set temporary $\frac{1}{4}$ Sec cor
7950 Intersected N and S line
at a point - 24 miles South
of post cor to Sec 16 17 20^{and 21}
from which cor S run
 $S 89^{\circ} 50' W$ on true line between

Township 11 N. Range 3 W
Clyde and Salt River Divisions

Sec 17 and 20.

Va 13° 46' East

3976 Set a stone 10x10x6 in a mound of stone 3 ft high for 1/4 Sec cor. No mis

4950 The corner of Sec 17 18 19 and 20. Land level even Soil 2^o rate 1st rate grazing No timber

West on random line between Sec 18 and 19.

Va. 13° 48' East.

4040 Set - temporary 1/4 Sec cor.
4800 Placented creek runs S E 20 links wide trail along bed.
4868 Intersected West-boundary line 30 links S of cor. from which I run S 89° 47' E on this line between Sec 18 and 19

Township 11 N. Range 3 W
 Gila and Salt River Meridian

va. 13045' East-

3868 Set a stone 10x10x6 in
 a mound of stone 3ft high
 for $\frac{1}{4}$ Sec cor. No trees

7868 The corner to sec^s 17 18 19^q &
 20. Land rolling soil mineral
 No timber, plenty of brush.

North between Sec^s 17^q & 18

4000 Set a stone 12x10x8 in
 a mound of stone 3ft high
 for $\frac{1}{4}$ Sec cor.

5200 Left mesa land entire rolling
 land, of volcanic origin
 bears E. and NE

8000 Set a stone 10x10x10 a piece of
 volcanic rock in a mound with
 pits for the cor to Sec^s - 7 8, 17, & 18
 Land mostly rolling soil
 2^d rate grazing land, No timber

Township 11 N. Range 3 W.

Chico and Salt River Members

East on random line between
between Sect 8th and 17th

Va. 13° 45' East,

4000 Set temporary 1/4 Sec cor

7970 Intersected N and S line

36 links South of post cor to
Sect 8, 9, 16th and 17th from which
I ran S 89° 45' W, on true line
between Sect 8th and 17th

Va. 13° 45' E.

3985- Set a stone 12 x 10 x 8 in a
mound of stone 3 ft high for
1/4 Sec cor.

7970 The cor to Sect 7, 8, 17th and 18th
Lined rolling soil volcanic
origin 1st rate grazing land

West on random line
between Sect 7th and 18th

4000 Set temporary 1/4 Sec cor.

Township 11 N. Range 8 W
Glen and Salt River Minerals

- 6000 Entered State range bears
N.E.
- 78.60 Intersected West boundary
of Tps. at a point 12 miles
North of post cor to Sec 7 & 18
from which I run N. 89° 56' E on
true line between Sec 7 & 18
Va 13° 45 East
- 38.60 Set a stone 12 x 10 x 10 in a
mound of stone 3 ft high for
1/4 Sec, cor
- 78.60 The corner to Sec 7, 8, 17, 2d 18
Land rolling Soil mineral
Walnut Grove mining district
-
- North between Sec 7 & 8
Va 13° 45 East
- 40.00 Set a stone 12 x 10 x 8 in a
mound of stone 3 ft high for

Township 11 N. Range 3 W.
Gila and Salt River Meridian

$\frac{1}{4}$ Sec cor.

8000 Set a stone 10x10x10 in a mound
of stone 3ft-high for the
cor to Sec^s 5, 6, 7, 8
Land broken and hilly
Soil Mineral No timber

East on random line between
Sec^s 5 and 8.

4000 Set a temporary $\frac{1}{4}$ Sec
cor.

8000 Distracted N and S line
at post cor to Sec^s 4, 5, 8, 9 and 9,
from which cor I ran West
on true line between Sec^s 5 and
8.

on $13^{\circ} 45'$ East

4000 Set a stone 12 x 10 x 6 in a
mound of stone 3ft-high
for $\frac{1}{4}$ Sec cor.

Township 11 N. Range 3 W
Gila and Salt River Meridian

8000 The cor to Sec^s 5, 6, 7, and 8
Land hilly soil mostly
poor.

West on random line
between Sec^s 6 and 7,
VA 13° 45' East -

4000 Set temporary 1/4 Sec cor

5200 Entire slate-range bears
N.E.

78.50 Intersected West boundary
of Township 16 miles North
of Post cor to Sec^s 6, and 7,
from which cor $\text{Down N. } 89^{\circ}$
53' E on run line between
Sec^s 6 and 7.

VA 13° 45' East

38.50 Set a stone 10 x 8 x 8 in a
mound of stone 3 ft high for

Township 11 N Range 3 W
 Gileo and Salt River Meridian

1/4 Sec cor.

78.50 The corner to Sec^s 5, 6, 7, 8, 9, 10, 11, 12
 Land rolling out
 Mineral No Timber

North on random line
 between Sec^s 5 and 6

VA 13° 45' East

40.00 Set temporary 1/4 Sec cor

70.00 Stake range. (N6 bearing)

79.50 Intersected or boundary
 of Township 20 links
 East of post-cor from
 which I run S 0° 8' E on true
 line between Sec^s 5 and 6.

VA 13° 45' East

39.50 Set a stone 12 x 8 x 8 in
 a mound of stone 3 ft high
 for 1/4 Sec Cor No trees

79.50 The cor of Sec^s 5, 6, 7, 8, 9, 10, 11, 12

Township 11 N Range, 3 W,
Gila and Salt River Meridian

Land rolling Soil moderate
No timber plenty of brush
Oct-14th-1871

General Description

This Township contains some
fine farming land especially
on the bottom lands of the Casa-
gampa creeks. The uplands are
rolling and well adapted for
grazing. There are several
fine ranches under cultivation.
The products are: Corn and
vegetables. Peaches are grown
by some of the farmers. Timber
is scarce.

The mineral belt
that extends through the NW
portion of Township contains
Gold and Silver in rocks.

Chas. Case Deputy Surveyor

TOWNSHIP 11 N, RANGE 3 West, Gila & Salt River MERIDIAN

BOOK 1032

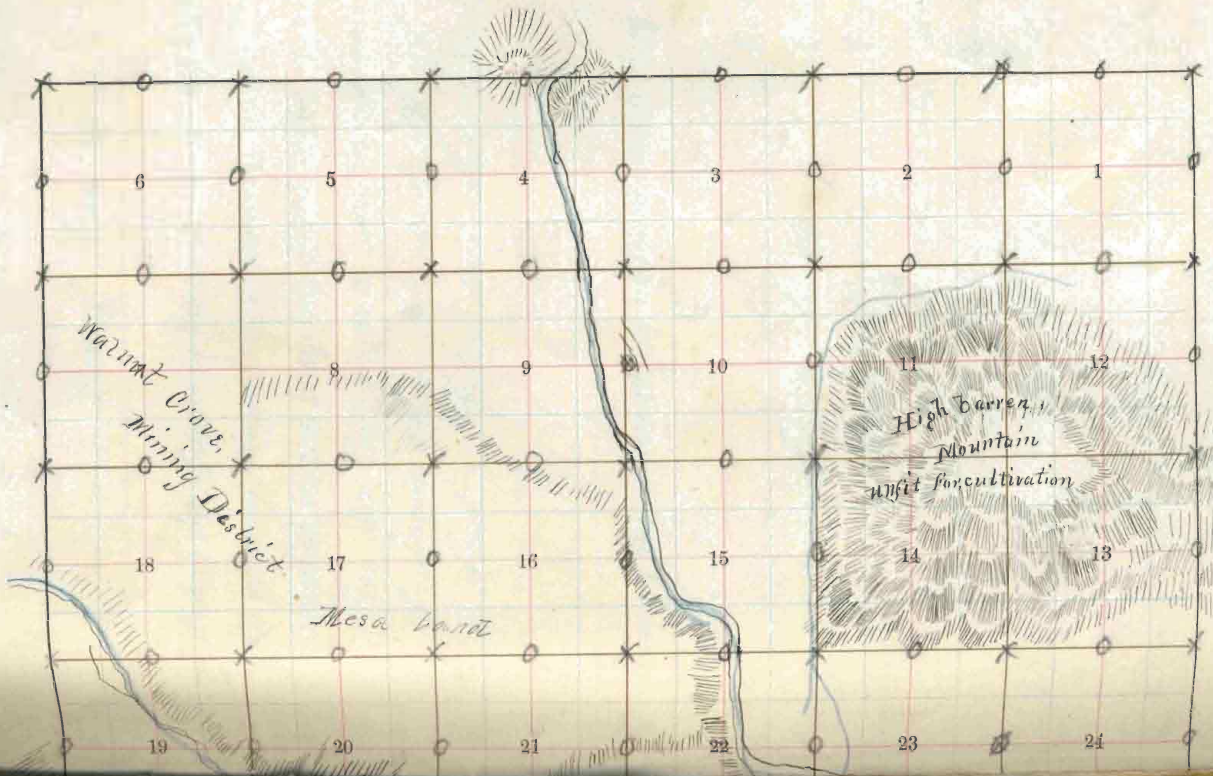

Bancroft's Blank Township Plot.

A. L. Bancroft & Co., 727 Market St., San Francisco.

Meridian Line,

Base Line,

Standard Line,

Township Lines,

Section Line,

Meander Lines,

Office Work,

Ranch Lines Re-survey

BOOK 1032

List of Names.

A List of the Names of the individuals employed to assist in running, measuring, or marking the lines and corners described in the foregoing Field Notes of

The exterior and Subdivision lines of Township No. 11 North of Range 13 West - Clear and Salt River Indian

showing the respective capacities in which they acted.

	Compassman.
O. M. Lindsey	Chainman.
H. W. Scholer	Chainman.
S. T. Brickwood	Axeman.
John Riley	Wood builder
James A. Deery	Flagman

Final Oaths of Assistants.

We hereby certify that we assisted Oscar A. Case
 Deputy Surveyor, in surveying
 the exterior and subdivision lines
 of Township No. 11 North Range No 3
 West. Gila and Salt River Meridian
 Territory of Arizona

and that said Survey has been in all respects, to the
 best of our knowledge and belief, well and faithfully sur-
 veyed, and the boundary monuments planted according to
 the instructions furnished by the Surveyor-General.

A. W. Lindsay
 A. W. Schooley
 P. T. Brickwood
 John Riley
 James O. Leay

Subscribed and sworn to before

this 20th day of Nov. 1871.

E. Crowell

Deputy Dist. Court

3^d Dist. A.T.

Final Oath of Deputy Surveyor

I, Omar H. Case

BOOK 1032

Deputy Surveyor, do solemnly swear that, in pursuance with a contract with John Wasson United States Surveyor-General for Arizona, bearing date the 17 day of July 1871, I have well, faithfully and truly, in my own proper person, and in strict conformity with the instructions furnished by the Surveyor-General, the Surveying Manual, and the laws of the United States, surveyed all those parts or portions of "The exterior and subdivision lines of Township No. 11 North Range 3 West. Gila and Salt. River Meridian

as are represented in the foregoing Field Notes as having

129A

DK 1032

BOOK 1032

been surveyed under my directions; and I do further solemnly swear that all the corners of said surveys have been established and perpetuated in strict accordance with the Surveying Manual and printed instructions, and that the foregoing are the true and original Field Notes of such Survey.

Quar He Lane

BOOK 1032

U. S. Deputy Surveyor.

Subscribed and sworn to before me, this 20th
day of Nov. 1871

Esowells
Clino Dist Court
3^d Dist No.



Surveyor General's Office
Tucson A.T.

January 29th 1872

The foregoing field Notes of
the Survey of the Subdivision
lines of Township 11 North
Range 30. of the Gila and
Salt River Base and Meridian
line in the Territory of Arizona
executed by O. H. Case, U.S. Dep-
uty Surveyor under his con-
tract dated July 17th 1871
having been critically exam-
ined, the necessary corrections
and explanations made,
the said field notes and the
surveys they describe are
hereby approved.

John Massey
U.S. Surveyor General
for Arizona