

RETRACEMENT OF
E. B'dy T. 20 N. R. 4 E.

CONTRACT N^o 102
W. O. SECOR

1411

BOOK 1411

4-671

FIELD NOTES
GENERAL LAND OFFICE.

No. 1411

Field Notes
of the retracement of
the East Boundary of
Township No. 20 North,
Range No. 4 East.
of the
Gila and Salt River
Base and Meridian
in the
Territory of Arizona
as surveyed by
W. Oscar Dixon,
U. S. Deputy Surveyor.
Under his contract No. 102
Dated June 30th, 1902.

Survey commenced Apr. 1st 1904
Survey ended April 3^d, 1904.

2

Names and duties of assistants.

A. K. Ward Chairman
 F. M. Lockwood Chairman
~~Allen Morgan~~ ~~Morgan~~
 C. J. Schwartz Uman
 Norman Cote Flagman

BOOK 1411

Township 20 North Range 4 East
S&W R. B. C. M. County

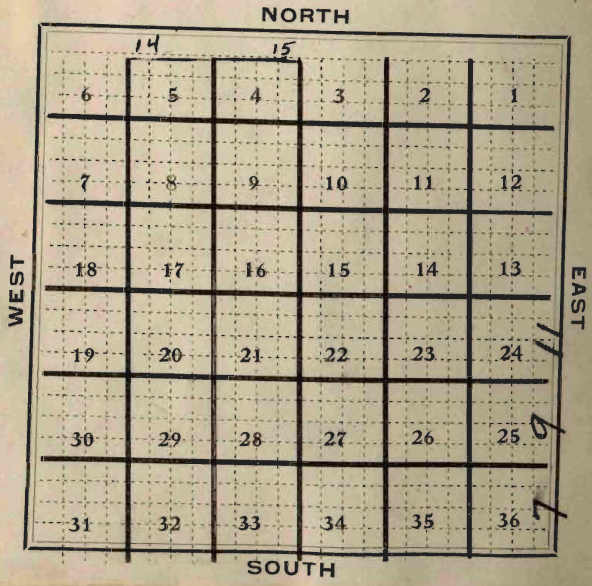

East Boundary of

Survey commenced April 1st, 1904, and executed with a Buff and Berger engineer's transit with Seaguller Solar attachment.

The transit is numbered 672; the horizontal limb having two double verniers placed opposite to each other and reading to 30" of arc.

The instrument was examined, and approved by the Surveyor General of Arizona, at Phoenix, Arizona.

At my camp near the cor. of secs. 25, 26, 35 and 36, T₄ 20 N., R₄ E, in lat. $35^{\circ} 04' N$, long. $111^{\circ} 53' ⁴³ N$, I set off $4^{\circ} 36' N$ on the decl. arc, and at noon

Sp. 20 N. R. 4 E.

observe the sun on the meridian, the resulting lat. is $35^{\circ}04^{\prime}05''$ N. At 3 h. p.m. l.m.t. I set off $4^{\circ}39'30''$ N. on the decl. arc; $35^{\circ}04'$ N. on the lat. arc: and determine a true meridian with the solar, and mark the line thus determined on a stake driven in the ground about 8 chs. N. of my station.

I allow my instrument to remain at this point, and at $6^{\text{h}}40^{\text{m}}$ p.m. l.m.t. I observe Polaris at Western elongation in accordance with instructions in the Manual, and marked the line thus determined by a tack driven in a stake about 8 chs. N. of my station: I lay

off the azimuth of Polaris $1^{\circ}28'$ to the east, and mark the true meridian thus determined on a stake firmly set in the ground. This point falls 0.4 inches west of the point determined by the solar.

Apr. 1st, 1904.

Apr. 2^d; at 9^h a.m. l.m.t. I set off $4^{\circ}57'$ N. on the decl. arc; $35^{\circ}04'$ N. on the lat. arc; and determine a true meridian with the solar, and mark the line thus determined on a stake set in the ground about 8 chs. N. of my station. This line falls 0.2 ins. E. of the meridian determined from the Polaris

observation. I therefore conclude that the adjustments of my instrument are satisfactory.

The magnetic bearing of the true meridian is $N. 14^{\circ} W.$; the angle thus determined gives the magnetic decl. $14^{\circ} E.$
Apr. 2^d 1904.

April 3^d: At 8^h a.m., l.m. t. I set off $5^{\circ} 20'$ N. on the decl. arc; $35^{\circ} 03'$ N. on the lat. arc; and determine a true meridian with the solar at the cor. of Ips. $20^{\circ} N. \text{ } \overset{S.E.}{\nearrow} 4^{\circ} E.$ as established by ~~help~~ Joseph's Compassion. Thence I run.

N. on E. bay. of sec. 36.
Over mountainous lands

Through dense pines
and oak brush.

4.60 The cor. of Tps. 19 and 20
N., R. 5 E., as described
by the Surveyor General.

44.60 The $\frac{1}{4}$ sec. cor. as des-
cribed by the Surveyor
General, bears N. 94 lks.
which makes the bearing
and length of this
half mile N. for 4.60 Chs.
thence N. $1^{\circ} 21'$ N. for 40.01 Chs.
Thence I run.

North

40.00 The cor. of secs. 25, 30, 31
and 36 as described by
the Surveyor General,
bears N. 56 lks. which
makes the bearing and

length of the half mile
N. $0^{\circ}48'N$. 40.00 chs.

Land mountainous ^{80.00} 79.99

Dense pines ^{80.00} 79.99 chs.

Oak brush 79.99 chs.

Soil rocky. 4th rate.

E. Boundary of

N. lot. secs. 25 and 30.
Over mountainous lands.
Through dense pines
and oak brush.

39.99 The $\frac{1}{4}$ sec. cor. as described by the Surveyor General, bears N. 29. lks. which makes the bearing and length of this $\frac{1}{2}$ mile N. $0^{\circ}25'$ N. 39.99 chs
Hence I run.

North

39.98 The cor. of secs. 19, 24, 25 and 30, as described by the Surveyor General, bears N. 29 lks., which makes the bearing and length of this $\frac{1}{2}$ mile N. $0^{\circ}25'$ N. 39.98 chs.

Sp. 20 N. R. 4 E.

Land mountainous 79.97 chs.

Dense pines 79.97 chs.

Oak brush 79.97 chs.

Soil rocky 4th rate.

E. Boundary of
BOOK 1411

N. bet. secs. 19 and 24.

Over mountainous lands

Through dense brush.

29.00 Descend abruptly to Canon.

40.05 The $\frac{1}{4}$ sec. cor. as
described by the Surveyor
General; which makes
the bearing and length
of this $\frac{1}{2}$ mile N. 40.05 chs.
Bottom of Canon, course N. ascend.
Then run

3.00

North.

42.37. The cor. of secs. 13, 18, 19 and
24, a decayed stake
with four witness
trees, bears E. 175 lks.
which makes the bearing
and length of this $\frac{1}{2}$
mile N. $2^{\circ} 22' E.$ 42.38 chs.
I rebuild this cor.

Tp. 20 N., R. 4 E.

at same point as follows
 Set a malpais 20 x 12 x 6 ins.
 in a md. of stone for cor.
 of secs. 13, 18, 19 and 24.
 marked with 3 notches
 on N. and S. edges.

Build a md. of stone
 3 ft. base 2 ft. high N. of
 cor. Old trees marked as described by the ^{Surveyor General} ~~the~~

Pits impracticable
 Land mountains ^{82.43} 82.80 chs.
 Dense brush ^{82.43} 82.80 chs.

Soil rocky. 4th rate.

Apr. 3^d 1904

General Description

The line of this survey passes over a rough and mountainous country, through dense pines, oaks, and oak and other brush.

There are no springs or other living water on this line; neither are there any settlers in the vicinity of the line.

W. S. DeLoach
U. S. Deputy Surveyor.

Retracecuts of T. P. 20 N. R. 4 E.

The following notes along the 5th Standard Parallel were furnished me by the Examiner, Mr. W. O. Owen, who ran the same in order to make a closed survey. From the closing cor. to secs. 5 and 6 East.

6.49 The Standard cor. of secs. 31 and 32⁰ bears N. 25 E. lks.

True course $S 87^{\circ} 48' E$ 6.49

46.50 Standard $\frac{1}{4}$ sec. cor. bears S. 24 E. lks. True course $N 89^{\circ} 59' E$ 46.01

79.88 The closing cor. of secs. 4 and 5 bears N. 108 lks. True course $N 87^{\circ} 44' E$ 33.41 chs. Hence from closing cor. to secs. 4 and 5.

East.

6.53 Standard cor. to secs.

¹⁵
 Retraacements of Tp. 20 N. R. 4 E.

32 and 33 bears N. 8 lks.
 True course $N 89^{\circ} 18' E. 6.53$
 79.54 The closing cor. to secs. 3

and 4 bears S. 34 lks.
 True course $S 89^{\circ} 41' E. 73.01$
 86.51 The Standard cor. to secs.

33 and 34 bears S. 76 lks.

True course $S 86^{\circ} 33' E. 6.98$

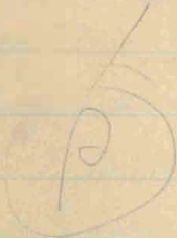

BOOK 1411
No. 1411

16

A P P R O V A L.

Office of the

United States Surveyor-General,

Phoenix, Arizona.

June 15-1904

The foregoing field notes of the ~~sur-~~

vey of *Retracement of the E & N*
Belis of T 210 N. R 4 E

of the Gila and Salt River Base and Me-
ridian, in the Territory of Arizona,

executed by *W. C. Secor*

United States Deputy Surveyor, under his

contract No. 102, dated *June 30 1904*,

having been critically examined, and the
necessary corrections and explanations

made, the said field notes, and the sur-

veys they describe, are hereby approved.

Frank A. Ingalls

U. S. Surveyor-General.