

cred. ~~Wad~~
June 6 1892.

Copies
checked
placed

Sent to U.S.G. 11/19/92

BOOK 1426

Survey approved

No. 1426

Feb 28. 1893

~~See~~

4-671 No. 1426

1426

FIELD NOTES BOOK 1426

GENERAL LAND OFFICE

→ of ←

N. + W By. Tp. 22 N. R. 5 E

N. By. Tp 21 N. R. 1 E

N. W + S By Tp 7 N. R. 1 W

by Francis B. Jacobs, U.S.B.S.

Under Contract 17, dated
May 25. 1891

Survey commenced Sept. 19, 1890
completed May 2, 1892

It is the
 of the Survey of the

North West Boundary of
 Township 27 N R 1 E

General Index

	Page
Exterior Boundaries T 27 N R 6 E -	1
North Boundary T 21 N R 1 E	28
Exterior Boundaries T 7 N R 1 W	45

Field Notes
of the Survey of the
West and North Boundaries
of
Township no 22 North
Range no 5 E
of the
Gila and Salt River
Meridian
in the Territory of
Arizona
as Surveyed by
Francis B Jacobs
U S Deputy Surveyor
Under his Contract ^{no 7} dated
May 23th 1891.

Survey commenced May 2 1892
Survey completed " " "

Names and duties of
Assistants

Clod Thompson Chairman
Lee. Bond Chairman

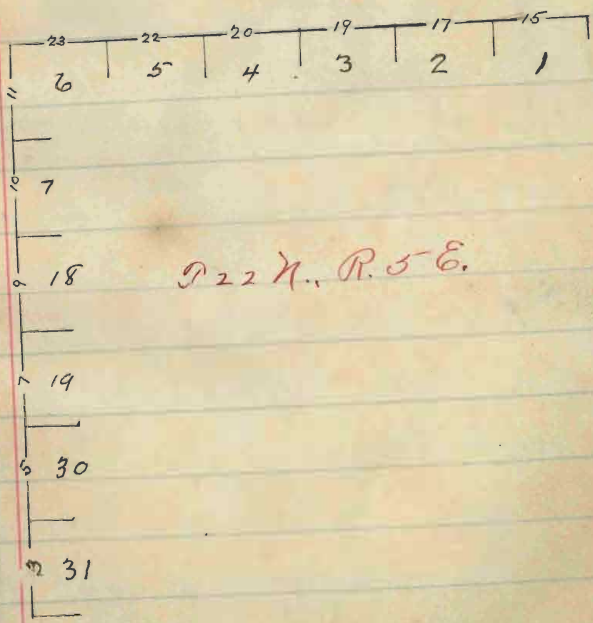

1
 Exterior Boundaries T22N-R5E

chains

Survey Commenced May
 2 1892. With a Gurley
 Mountain Transit. With a Bush
 Solar attachment.

I set my Transit over the
 center of the corner to Townships
 21 and 22. N. Ranges 4 and 5 E.
 and at 7.20 a.m. I turn
 the telescope on a flag 5 chs.
 South of the cor. on a line
 established by me April 28th
 1892 and find its magnetic bearing
 to be S 15° 15' E. Subtract
 for diurnal change. as per
 Table on page 53 of Manual
 0-3'. the difference is the
 Var. 15° 12' E

Exterior Boundaries T22N. R5E

chains

From a line connecting the corners of Townships 21 and 22 north Ranges 4 and 5 E and Townships 22 and 23. north Ranges 4 and 5 E and run by ^{me} in July 1891.

I calculate the true bearing of the West boundary of township 22N Rang 5 E to be $N0^{\circ}46' E$. therefore from the cor. to Township 21 and 22 N. Ranges 4 and 5 E I run

$N0^{\circ}46' E$ on a true line bet sees 31 and 36

Var $15^{\circ}12' E$

Descend

6-50 Ravine course N. W.

40-00 At Post 4 ft long 4 ins square
 74 ins in the ground for $1/4$ sec cor

Exterior Boundaries T22N R5E

Marked $\frac{1}{4}$ S on N side and
raised mound of stone $1\frac{1}{2}$ ft high
3 ft base around Post
From which a Pine 40 ins diam
br S $21^{\circ}30'E$ 179 lks. dist. Marked $\frac{1}{4}$ S B.T.
A Pine 20 ins. diam. br N $12-15^{\circ}$ W
177 lks. dist. Marked $\frac{1}{4}$ S B.T.

80-00 Set Post $4\frac{1}{2}$ ft long $4\frac{1}{2}$ ins
square 12 ins in the ground
for cor to sec 25-30 31 and 36
Marked T22N. S 30. on N. E

R 5 E. S 31. on S. E. R. 4 E. S. 36 on S W
and S 25 on N W faces with 5 notch
on N and 1 notch on S edges
and raised mound of stone
2 ft high high $3\frac{1}{2}$ ft base
around post Pits impracticable
From which - a Pine 24 ins diam
br S $41^{\circ}00'E$ 95 lks. dist

Exterior Boundaries T22N R5E

Marked T22N, R5E S 31-T.B.T.

A Pine 24 ins diam br S $81^{\circ}15'W$

205 lbs disk Marked T22N, R4E S. 36 B.T.

A Pine 10 ins diam. br N $5^{\circ}30'W$

68 lbs disk Marked T22N, R4E. S 25 T.B.T.

Land rolling

Soil 2nd rate

Timber Pine and east

N. 46' E bet secs 25 and 30
var $15^{\circ}12' E$

- 2-00 Ascend
- 3-00 Atlantic and Pacific Railway
br S $61^{\circ}E$ and N $61^{\circ}W$
- 4-00 Western Union Telegraph Line
runs parallel to Railway.
- 40-00 top of ascent on W. slope of hill
set post 4 ft long 5 ins diam
24 ins in the ground for $\frac{1}{4}$ sec. cor

Exterior Boundaries T22N R5E

chain

Marked $\frac{1}{4}$ S on N face and raised mound of stone $1\frac{1}{2}$ ft high 3 ft bar around post from which a pine 10 ins. diam br S $59^{\circ}15' E$ 76 lks. dist marked $\frac{1}{4}$ S B.T.

a pine 20 ins diam br N $35^{\circ}30' W$ 20 lks dist marked $\frac{1}{4}$ S B.T.

Descend

48-00 Bottom of hill

80-00 set Post 4 ft long 5 ins square 24 ins in the ground for corners 19-24-25 and 30 marked

T22N S 19 on N.E. R5E S 30. on S E R4E S 25 - on S W and S 24 on N W faces with 4 notches on N and 2 notches on S sides

From which - a pine 24 ins. diam. br N $74^{\circ}00' E$ 154 lks. dist. marked T22N. R5E S 19 B.T.

Exterior Boundaries T22N. R. 5. E

chain

A Pine 30 ins diam br S 39° 00' E

110 lks. dist. Marked T22N. R. 5E S 30 B-T

A Pine 24 ins. diam. br S 31° 30' W

170. lks. dist. Marked T22N R. 4E S 25 B.T.

A Pine 30 ins diam br N 38° 30' W

115 lks dist. Marked T22NR 4E S 24 B.T.

Land hilly and rolling

Soil 3rd rate

Timber Pine and oak

No. 46' E bet Secs 19 and 24
Var 15° 12' E

4-90 Miller's Sheep Corral Fence

6. 25 Fence opposite side of corral

40-00 set Post 4 ft long 4 ins diam

24 ins in the ground for 1/4 sec cor

Marked 1/4 S on N face and raised

mound of stone 1/2 ft high 3 ft

base around post.

Exterior Boundaries T22N R5E

chains

From which a Pine 36 ins diam
 brs $N 32^{\circ} 30' E$ 69 lks dist
 marked $\frac{1}{4} S T.T.$

a Pine 30 ins diam brs $N 67^{\circ} 15' W$
 52 lks dist marked $\frac{1}{4} S T.T.$

80-00 set Post 4 ft long $4\frac{1}{2}$ ins square
 24 ins in the ground for cor to Secs
 13-18-19 and 24 - marked -

T22N-S 18 on N.E. R5E S 19 on S.E.

R4E S 24 on S.W. and S 13 on N.W.

faces with 3 notches on N and S
 edges. and raised mound of
 stone $1\frac{1}{2}$ ft high $3\frac{1}{2}$ ft base along
 side From which

a Pine 36 ins diam brs $N 70^{\circ} 30' E$
 74 lks dist. Marked T22N R5E S 18 T.T.

a Pine 30 ins diam brs $S 45^{\circ} 30' E$
 23 lks dist Marked T22N R5E S 19 - T.T.

a Pine 36 ins diam brs $S 37^{\circ} 30' W$

Exterior Boundaries T22N R5E

chains

35 chs dist. Marked T22N-R4E S24 B.T.

A Pine 10 ins diam br N51°20'W

72. chs dist Marked T22N-R4E. S 13-B.T.

Land rolling and rocky

Soil 2nd rate

Timber Pine

N 0°46'E brt. sec. 13 and 18

Var 15°12'E

30.00 Leave Timber br E and W

40.00 Set Malpais stone 16x10x6 ins

8 ins in the ground for 1/4 sec cor

Marked 1/4 on W side. dug pits
18x18x12 ins N and S of Stone5 1/2 ft dist and raised mound
of Earth and Stone 2 ft high
3 ft base along side

80.00 Set Malpais stone 20x12x10 ins

14 ins in the ground for cor to sec

Exterior Boundaries T. 22 N., R. 5 E.

chains

7-12-13 and 18. Marked with
 2 notches on N and 4 notches
 on S edges; dug pits
 18x18x12 ins. in each section
 5 1/2 ft disk and raised mound
 of stone, 2 ft high 3 ft base along side.
 Land rolling and rocky
 Soil 3rd rate
 Timber. Pine.

No. 46 E but Secs 7 and 12
 var 15-12 E

40-00 set Malpais stone 16x10x6 ins
 8 ins in the ground for 1/4 sec cor
 Marked 1/4 on N side; dug pits
 18x18x12 ins N and S of stone 5 1/2 ft
 disk and raised mound of Earth
 and stone 2 ft high 3 ft base
 along side

Exterior Boundaries S. 22 N. 12, 3 E.

chains
49.45 Road to Spring Valley to S E and N. W.
80.00 set Malpais Stone 20x12x8 ins
14 ins in the ground for cor to sec.
1-6-7-and-12- Marked with
1 notch on N and 5 notches on
S sides? - dug pits 18x18x12
ins- in each sec. 5 1/2 ft dish
and raised mound of earth
and stone 2 ft high. 3 ft base
along side
Land rolling
Soil 2nd rate
No timber

No. 46'E bet sec. 1 and 6
var 15° 12' E

40.00 set Malpais Stone 16x10x8 ins
8 ins. in the ground for 1/4 sec. cor.
Marked 1/4 on N side?

Exterior. Boundaries T22N R5E

Chains

dry pits 15' x 18' x 12' ins N and S
of stone 5 1/2 ft dist and raised
mound of earth and stone
2 ft high 3 ft base along side

73.08. The cor to Townships 22- and 23

N. Ranges 4 and 5. E

A Malpais stone marked as
described in the field notes
furnished by the Surveyor
General.

Land holding

Sec 3rd rate

No Timber

May 7th 1877

Exterior Boundaries T22N R5E

The North boundary of Township
T22N. R5E was run July
25 and 26. 1891.

the observation was made on Polaris.
July 24th 1891 at the cor. to
Township 22- and 23 N R3.5 and
6 E. in Latitude $35^{\circ}18'N$.
Longitude $111^{\circ}48'W$.

and at 4.33 am. local mean
time. find the magnetic bearing
of the star to be $N15^{\circ}00'W$

Astronomical time

July 23rd 16.33.

Tabular time U.C. Polaris

Aug 1st 16.36.2

Reduction for 7 days $(3-91 \times 7 = 27-4)$ add 27-4

which taken from time 17.03.6

of observation leaves hours

Exterior Boundaries T22 NR 5 E

chains

angle of Polaris	23-29-4
Subtract from	23-56
Argument for Table II	26.6
Azimuth of Polaris	12'
N. End of needle	15° 00'
Sum is the var	15° 12' E

From the con to Ips. 22 and 23
N. Rs. 4 and 5 E.

I run East on a random
line bet Ips 22 and 23 N R 5 E.

Var 15° 12' E

I set temporary 1/2 mile and
mile corners at each 40 and 80
chains. and at 5 miles. 69.
chains and 22 lines I intersect
the Range line 14. chains
S. of the con to Ips 22 and

Exterior Boundaries T22N R35E

chain

23 N. Rs 5 and 6 E.

The correction for the true
line therefor will be 2.38 chs
S. and 10.78 chs N. per mile
and its true course will be
S^{88°17'}W

From the cor to Tps 22 and
23. N. Rs. 5 and 6 E which is
a Post firmly set marked
and witnessed as described
in the field notes furnished
by the Surveyor General.

I run

S^{88°17'}W on a true line
bet sees 1 and 36

Var 15° 17' E

40-00 Set a post 4 ft long 4 in dia. 24
in in the ground for 1/4 sec cor.
Marked 1/4 S. on N. face and raised

Exterior Boundaries D 27 N 25 E

Chains

mound of stone 2 ft high 3 ft
base around fort.

From which -

A Pine 12 in diam on St.
57° 35' E. 35 lbs dirt. Marked
1/4 S. B. T.

A Pine 30 in diam on S 83°
20' W 48 lbs dirt. Marked
1/4 S. B. T.

80-00 Set a post 4 ft long 4 in square
24 in in the ground for cor to
secs 1-2-35 and 36. Marked

T 23 St. S 36. on St. E.

R 5 E. S 1 on S. E.

T 22 N S 2 on S. W. and

S 35 on St. W. faces.

With 1 notch on E and 5 notches
on W. edges. Raised mound of
stone 2 ft high 3 ft base around fort.

Exterior Boundaries T22 N R 5 E

chain

From which - A Pine 30 in diam
 In N. $43^{\circ}45'$ E 30 lbs dist marked
 T23 N. R. 5 E. S 36 B. T.

A Pine 38 in diam In S $52^{\circ}20'$ E
 100 lbs dist marked -
 T22 N. R. 5 E. S 1 B. T.

A Pine 40 in diam In S $33^{\circ}45'$ N.
 74 lbs dist marked
 T22 N. R 5 E. S. 2. B. T.

A Pine 36 in diam In N $83^{\circ}08'$ W
 9 lbs dist marked
 T23 N. R 5 E S 35 - B. T.

Land rolling
 Soil 2nd rate
 Timber - Pine.

July 25th 1891

S $88^{\circ}17'$ N. on true line bet sec
 2 and 35-

Exterior Boundaries 222N R 5E

chain

Var 15° 12' E.

- 34-00 Leave timber on N. E. and S. W. enter East end of "Government Prairie"
- 40-00 Set a foot 4 ft long 4 in diam 12 in in the ground for $\frac{1}{4}$ sec cor marked $\frac{1}{4}$ on N. face dug pit 18x18x12 in East and West of foot 5 $\frac{1}{2}$ ft diam. and raised mound of earth and stone 2 ft high 3 $\frac{1}{2}$ ft base around foot.
to be within limit.
- 23-00 Arcued
- 26-00 Set volcanic stone 20x12x8 in 14 in in the ground for cor to sec 2-3-34 and 35- Marked with 2 notches on E. and 3 notches on W. edge ^{and} raised mound of stone 2 ft high 3 ft base alongside.

Exterior Boundaries 222 N 25 E

chains

Pits infracticable,
Land rolling
Soil 2nd rate
Timber - Pine.

S 88° 17' N. on true line bet sec
3 and 34.

Var 15° 12' E.

2-50 Top of "Bald Hill" 400 ft high
Descend.

0-00 Set post 4 ft long 4 in diam 12 in
in the ground for 1/4 sec cor. marked
1/4 S on N. face raised mound of stone
2 ft high 3 1/2 ft bare around post
Pits - infracticable.

2-00 Bottom of "Bald Hill"

0-00 Set Malpais stone 24 x 14 x 10 in
16 in in the ground for cor to sec
3-4-33 and 34 marked with 3

Exterior Boundaries T22N R5 E
chains

notches on E and W. edges. Dug
pits 18x18x12 in in each sec - 5 $\frac{1}{2}$
ft dirt and raised mound of
earth and stone 2 ft high 3 ft base
alongside.

Land hilly.

Soil 4th rate.

Timber - scattering fine.

S88°17'N on true line bet secs
4 and 33.

Var 15° 12' E.

40-00 Set a post 4 ft long 4 $\frac{1}{2}$ ins diam
12 ins in the ground for $\frac{1}{4}$ sec. cor.
Marked $\frac{1}{4}$ S on N face and
raised mound of stone 2 ft high
3 $\frac{1}{2}$ ft base around post.
Pits impracticable
From which - a Pine 40 ins. diam.

Exterior Boundaries T 22 N. R. 5 E

chains

brs S $9^{\circ}30'$ W 79 lks distMarked $\frac{1}{4}$ S B.T.

no other tree within limit

46-00

Enter Timber brs S 75° Eand N 75° W

0-00

Set a post 4 ft long 4 in square
12 in in the ground for cor to recs

4-5-32 and 33. Marked

T 23 N. S 33 on N. E. R. 5-E. S 4
on S.E.T 22 N. S 5 on S. N. and S 32 on
N. N. faces, with 4 notches on E
and 2 notches on N. edges and
raised mound of stone $2\frac{1}{2}$ ft high
 $3\frac{1}{2}$ ft base around post.

Pits - in practicable.

From which - A Pine 16 in
diam. brs N. $45^{\circ}30'$ E. 22 lks
dist. Marked T 23 N R. 5-E. 34.5

Exterior Boundaries T22N R5E
chains

S 33 B.T.

A Pine 38 in diam. In S. $54^{\circ}00' N$
47 lbs dist. Marked -

T 22 N R 5 E S. 5 B.T.

A Pine 24 in diam In N. $87^{\circ}00' W$
35 lbs dist. Marked -

T 23 N, R. 5 E. S 32 B.T

No other tree within limit.

Land rolling and rocky
Soil 4th rate
Timber - Pine

S $88^{\circ}17' N$ on a true line
bet secs 5 and 32 -

Var $15^{\circ}17' E$

1-00 Leave Timber bro S.W.

40-00 Set Malpais stone $20 \times 16 \times 8$ in 14
in in the ground for $1/4$ sec cor
Marked $1/4$ on N side. dug pit

Exterior Boundaries D22N R5E
chains

18x18x12 in E and N. of stone
5½ ft dist. raised mound of
earth and stone 2 ft high 3
ft base alongside.

50-00 Set Malpais stone 20x12x8 in
14 in in the ground for cor to
secs 5-6-31 and 32 Marked
with 5 notches on E. and 1 notch
on N. edger. dug pits 18x18x12 in
in each sec - 5½ ft dist. and
raised mound of earth and stone
2½ ft high 3½ ft base alongside
Land rolling and rocky.
Soil 3rd rate
No timber.

S 88° 17' N on true line bet secs
6 and 31

Var 15° 12' E.

External Boundaries T227R56

chains

- 4.00 Ascend
- 38.00 Top of hill on st. and S. Descend
- 40.00 Set red volcanic stone 20x14x10
 in 14 in in the ground for $\frac{1}{4}$
 sec cor. marked $\frac{1}{4}$ on st. side
 dug pits 18x18x12 in E. and W. of
 stone $5\frac{1}{2}$ ft dist. raised mound
 of earth and stone 2 ft high 3 ft
 base alongside.
- 50.00 Bottom of hill
- 69.72 Cor to Tps 32- and 23 N Rs. 4
 and 5 E.
 Land hilly
 Soil 4th rate
 No. 11
 July 26th 1871

6 miles and 24 chs of these lines
 run over mountains forest or
 through timber

Exterior Boundaries T27N R5E

chains

Latitudes Departures and Closing Errors

Lines Designated as	True bearing	Distance	Latitudes		Departures	
			N	S	E	W
N. Boundary	N 8° 46' E	473.08	473.03		6.32	
N. Boundary	N 88° 17' E	469.22	14.02		468.98	
E. Boundary	S 0° 03' W	480.61		480.60		.38
S. Boundary	N 89° 50' W	400.48	1.16			400.47
S. Boundary	N 84° 40' W	40.65	3.77			40.47
S. Boundary	S 76° 06' W	36.64		8.80		35.56
Convergency					51	
Totals			491.98	489.40	475.81	476.88
			489.40			475.81
Error in Lat.			2.58	Error in Dep		1.07

General Description
 The northern portion of this Township is rolling and covered with volcanic rock. is very dry. Excepting the N.W. corner is covered with a good growth of Pines.

Francis B. Jacobs
 U.S. Deputy Surveyor

Field Notes
of the Survey of the
North Boundary of
Township No 21 North
Range No 1 East

Gila Co Salt River
Meridian
in the Territory of
Arizona
as Surveyed by
Francis S. Jacobs
U.S. Deputy Surveyor
Under his contract ^{No 17} dated
May 23rd 1891
Survey Commenced August 12th 1891
Survey Completed August 13th 1891

Names and Duties of
Assistants

Charles A Rohr Chapman
G. William Hart Chapman
Milton L. Brown Ayman

41	39	37	35	34	31
6	5	4	3	2	1

D. 21 N. R. 1 E.

North Boundary T21N-R1E

Survey Commenced
 August 12th 1891. with a Gurley
 Mountain Transit with a
 Burt Solar attachment,
 at the corner to Townships
 21 and 22 N. Ranges 1E and 1
 W. in Latitude $35^{\circ}17'N$
 Longitude $112^{\circ}17'W$ at 4^h 35^m
 A.M. of local mean time

I take an observation on Polaris
 and find the Magnetic bearing
 of the star to be $N 15^{\circ}03' W$

Correct Astronomical^{time} of
 observation Aug. 11 16-35

Tabular time U.C. Polaris 1891

Aug. 15 15-41-1

Reduction for 4 days $3.92 \times 4 = 15.7$ add 15-7

Local mean time U.C. of Polaris Aug. 11. 15 56.8

North Boundary T₂₁N R_{1E}

chains

which taken from time of observation

leaves true angle of Polaris 38-2

Azimuth of Polaris for Feb 35. 16'

North end of needle 15-03

the difference is the var. 14° 47' E

I lay off the azimuth to the East
and drive a picket on line
thus found. 3 chs n of cor.

I Begin at the cor. to townships
21 and 22 N Rs. 1 E and 1 W
which is a post firmly set
and marked as described in
the field notes furnished by the
Surveyor General. and run
Thence—

East on a random line bet
Tps. 21 and 22 N R_{1E}
Var 14° 47' E

North Boundary T. 21 N., R. 1 E.

Sitting temporary half mile
and mile corners at each 40.
and 80. chs. and at 5 miles
78. chs. and 80 chs. Intersect
the range line 161 chs S of the
cor. to Townships 21 and 22 N
Rs. 1 and 2 E.

The correction for the true line
will therefore be 27 chs S and
1.20 chs W per mile and its
course will be S 89° 48' W.

From the cor. to Tps. 21 and 22
N Rs 1 and 2 E which is a post
formerly set marked and witnessed
as described in the field notes
furnished by the Surveyor General.
I run —

S 89° 48' W on a true line bet sec
1 and 36

North Boundary T21 N-101 E

chains

Var 14° 47' E

- 1.33 a Pine 18 ins diam on line marked
with 2 notches on E and W sides
- 19.00 Gulch course S. Ascend
- 36.00 Top of S slope of ridge descend
- 40.00 Set Malpais stone 36x18x14 ins
12 ins in the ground (reed prevented
setting deeper) for 1/4 sec cor marked
1/4 on N side and raised mound
of stone 1 1/2 ft high 4 1/2 ft base
around stone From which
a Pine 12 ins diam brs S 71-15 W
- 107 lbs. dish marked 1/4 S T.T.
- a Pine 30 ins diam brs N 71.30 W
- 70 lbs. dish, marked 1/4 S T.T.
- 47.30 Gulch course S.E.
- Ascend ^{300 ft high}
- 78.80 Top of ridge, brs N and S
- 80.00 Set Malpais stone 24x12x10 ins

North Boundary T21N-R1E

chains

18 ins in the ground for cor to
 Secs 1-7-35 and 36 marked
 with 1 notch on E and 5 notches
 on Wedges and raised mound
 of stone $2\frac{1}{2}$ ft high 4 ft base
 alongside. Pits impracticable
 from which - an oak 8 ins diam,

brs N $85^{\circ} 30' E$ 55 lxs dist

marked T22N-R1E S 36-T3T

a Juniper 3 ins diam. brs N $67^{\circ} 30' W$

74 lxs. dist. marked T22N-R1E S 35-T3T,

No other trees within limit

Land lully

Soil 3rd rate

Timber Pine and oak and

Juniper

August 12th 1891

North Boundary T 21 N R 1 E

chains

S 89° 48' W on a true line bet
secs 2 and 35

Var 14° 47' E

Descend through thick
oak brush

30-00 Leave oak brush

40-00 Set post 4 ft long 4 1/2 ins diam
24 ins in the ground for 1/4 sec, Cor.
Marked 1/4 S, on N face and raised
mound of stone 1 1/2 ft high 3 ft base
around post - From which -
a Juniper 24 ins diam br S 36° 45' W
254 lbs dish Marked 1/4 S T, T,
a Juniper 42 ins diam br N 2° 45' W
159 lbs dish Marked 1/4 S T, T,

6615 Western Union Telegraph line

67-15 Atlantic and Pacific Railway
on a 10° curve to left going W

75-00 Ravine Course S.

North Boundary T21N R1 E

chains
80-00

Set Post 4 ft long 4 ins square
12 ins in the ground for cor to
Secs 2-3-34 and 35 marked
T22N. S 35 on N.E. T. ES 2 on S E
T21N. S 3 on SW and S 34 on NW
faces with 2 notches on E and
4 notches on W edges. and raised
mound of stone 1 1/2 ft high 3 1/2 ft
base around post. Pits impracticable
from which a Juniper 30 ins diam
on N42°-E 181 lks dist. marked.

T22 N-R1 E-S 35 T. T. ^{(a Juniper 30 ins}
287 lks dist marked T21N. R1 E S 2 T. ^{diam on S 79.20° E}
No other tree within limit.

S 89° 48' W on a true line beth Secs 3 and 34.

Var 14° 47' E

14-25

Atlantic and Pacific Railway
on a curve 10° to left going West.

15-00

Western Union Telegraph line
runs parallel to Railway

North Boundary 21ⁿ 121^e

chains

- Scarpai Pump and Water
 1 ault brs N 60° E 2 chs. dist
- 40-00 Set Malpais Stone 12x12x6 ins
 6 ins in the ground for $\frac{1}{4}$ sec cor
 marked $\frac{1}{4}$ on N side and raised
 mound of stone 2 ft high 3 ft base
 alongside Pits impracticable
 From which a Juniper 24 ins diam
 brs S. 50° 00' E 266 l's dist marked
 $\frac{1}{4}$ S B.T. No other tree within limit
- 75-00 Descend
- 80-00 Set Malpais Stone 14x10x6 ins 7 ins.
 in the ground for cor. to Secs 3-4
 33 and 34 marked with 3 notches
 on E and W edges and raised
 mound of stone 2 ft high 3 ft base
 along side. Pits impracticable
 From which. a Pine 20 ins diam
 brs N. 7° 30' E 305 l's dist. Marked

North Boundary T22N R1E

chains

T22N-R1E, S34 B.T.

A Pine 20 ins diam br N46-50 W

746 1/4 dish marked T22N-R1E S33-B.T.

No other trees within limit

Land rolling

Soil 3rd rateTimber scattering Juniper
and PineS 89° 48' N on a true line bet
Secs 4 and 33.

Var 14° 47' E

3.55

Ravine course S.W. Ascend

8-50

Top of ascent

40-00

Set Malpais stone 26 x 18 x 12 ins
18 ins in the ground for 1/4 sec
cor marked 1/4 on N side and
raised mound of stone 2 ft
high 3 ft base alongside

North Boundary T21N-171E

chain

From which - a Juniper 24 ins
diam br $N6^{\circ}00' E$ 105 lbs dist
Marked $1/4 S B.T.$

a Juniper 12 ins diam br $S 37^{\circ}45' E$
171 lbs dist Marked $1/4 S B.T.$

80.00 Set Malpais Stone $36 \times 12 \times 8$ ins
15 ins in the ground (rock perforated
sitting deeper) for cor to Secs 4-5
32 and 33. Marked with 4 notches
on E and 2 notches on W Edges
and raised mound of stone $1\frac{1}{2}$ ft
high 4 ft base around stone.

From which -

a Juniper 14 ins diam br $N16^{\circ}10' E$
187 lbs dist Marked T22N-R1E-S33 B.T.

a Pine 14 ins diam br $S 35^{\circ}30' E$
51 lbs dist, Marked T21N-R1E-S4 B.T.

a Juniper 36 ins diam. br $S 22^{\circ}00' W$
200 lbs dist Marked T21N-R1E-S5 B.T.

North boundary T21N-R1E

chains

a Juniper 30 ins diam on N69°30'W

93 lks dist MARKED T21N-R1E-S 32-T.T.

Land rolling and rocky

Soil 3rd rate

Timber Juniper and Pine

S 89°48'W on a true line
bet Secs 5 and 32

Var 14°48' E

40-00

^{malpais}
Set _N stone 12x12x6 ins 6 ins in the
ground for 1/4 sec. cor. Marked

1/4 on N side. and raised

mound of stone 2 ft high. 3 ft base
alongside Pits impracticable

from which. a Pine 30 ins diam

on S64°35'E 218.460 dist

Marked 1/4 S T.T. ~~marked~~

within limit

47-80

Ravine Course S. W. Ascend

North Boundary T21N R1E

chain

- 59-50 Top of ascent. on old
Cemetery containing about
20 graves with 1 head stone
dated 1882.
- 63-00 Descend
- 73-75 Western Union Telegraph line
runs parallel to Railway
- 74-87 Atlantic and Pacific Railway
Brs N 40° W and S 40° E
- 76-00 Ravine course N. W.
- 80-00 set Malpais stone 30 x 10 x 6 ins
22 ins in the ground for cor to secs
5, 6-31 and 32. Marked with 5
notches on E and 1 on W edges
and raised mound of stone 2 ft
high 3 ft base along side
From which —
a Pine 24 ins diam brs N 28-35 E
154 lbs dish Marked T22 N-R 1 E S 32 BT

North Boundary T21N-R1E
chains

- A Pine 30 ins diam br. S46°30'E
127 lks dist marked T21N-R1E S 5 B.T.
A Pine 36 ins diam br. S76°15'W
238 lks dist marked T.21N, R.1E S. 6 B.T.
A Pine 30 ins diam br. N61°00'W
67 lks dist marked T22N-R1E S 31, B.T.

Land rolling

Soil 3rd rate

Timber Pine and Juniper

S89°48'W on a true line

bet nos 6 and 31

Var 14-47 E

Ascend

26-00

Top of ridge brs S.E. and NW

40-00

set volcanic stone 30x12x10 ins

27 ins in the ground for 1/4 sec

cor marked 1/4 on N side and

raised mound of stone 2 ft high

North Boundary 22ⁿ-R1 E

chains

3 ft base along side

Pits, impracticable.

From which - a Juniper 24 ins diam

On N 845' W 207 4/5 dist marked 145 B.T.

No other tree within limit

78-80 Cor to Sp 21 and 22ⁿ R1: E
and 1 W.

Land Rolling

Soil 3rd rateTimber scattering Juniper
and PineAugust 13th 18912 miles of these lines run over
mountainous land or through timber

North Boundary Twp N-R-1 E

Latitudes Departures and Closing Errors.

Lines Designations	True Bearing Distance		Latitudes		Departures	
			N	S	E	W
W. Boundary	North	480.55	480.55			
N. Boundary	N 89° 48' E	478.80	1.67		478.80	
E. Boundary	South	482.67		482.67		
S. Boundary	West	480.00				480.00
Convergence					.51	
Totals			482.22	482.67 482.22	479.31	480.00 479.31
Error in Latitude				.35	Error in Dept	.69

General Description
 The N. E. portion of this Township is hilly, and covered with a good growth of Pine Timber the Western portion is hilly and rolling and very rocky with scattering Juniper Timber and contains very little agricultural land

Francis B. Jacobs

U. S. Deputy Surveyor

Field Notes
of the Survey of the
Exterior Boundaries of
Township No 7 North of
Range No 1 West

Gila and Salt River
Meridian
Territory of
Arizona
as surveyed by
Francis B Jacobs
U S Deputy Surveyor

Under his Contract No 17
Dated May 25th 1891

Survey Commenced September 16th 1891
Survey Completed. 16 18th 1891

Names and Duties of Assistants

Robert J. Shelton Chairman
 James F. Waincott Chairman
 Marion E. Jacobs Playman

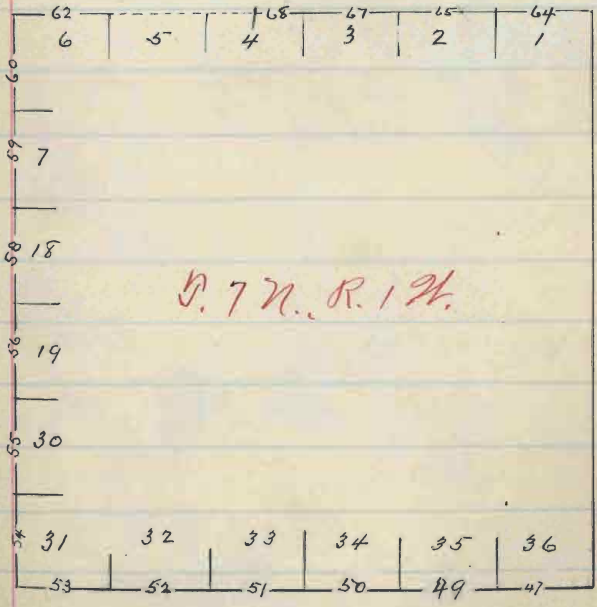

Exterior Boundaries T72 R1 W

Sept. Commenced September
16th 1891. with a Gurley
Mountain Transit with a Burt
Solar attachment.

at the corner to Townships
6 and 7 North Ranges 1 E and 1
W. in latitude $33^{\circ} 54' N$

Long. $112^{\circ} 15' W$. at 4^h 48^m a. m.

I take an observation on Polar
and find the Magnetic bearing of the
star to be

Correct Astronomical time of

observation Sept 15

$\frac{h}{16}$ $\frac{m}{48}$

Local mean time U.C. of Polaris

September 15th 1891

13-39.8

which taken from time of

observation leaves hour angle of Polaris

$3^{\circ} 08.2$

Azimuth of Polaris for Lat 34.

1-08

North end of Needle

14-58

Extreme Boundaries T7 N R1 W

chains

The difference is the var. $13^{\circ}50'$
 I lay off the azimuth to the East and mark the meridian thus found by driving a picket 3 chs. North of the corner

I begin at the cor. to Tps 6 and 7
 N Rs 18 and 19 which is a
 Malpais stone firmly set and marked
 as described in the Field notes
 furnished by the Surveyor General
 and run. Thence
West on a true line bet Secs 1 and 36
 Var $13^{\circ}50' - E$

Observed

- 10-20 Top of bluff 15 ft high
 10-50 Dry wash 80 yds wide Course $S70^{\circ}E$
 12-00 Ascend.

Exterior Boundaries T7 N.-R. 1 W.

chains	
30-00	Top of ridge on N slope descend
34-00	Deep ravine Course N Ascend
37-00	Top of ridge W. of and S.
39-85	Ravine, course N.
40-00	Set Malfair stone 36 x 18 x 4 in 12 in the ground (rock prevented setting deeper) for $\frac{1}{4}$ sec cor marked $\frac{1}{4}$ on N side, and raised mound of stone $1\frac{1}{2}$ ft high 4 ft base around stone. Pits in fractic cable. Thence ascend over broken country
80-00	Set Malfair stone 24 x 6 x 4 in 16 in in the ground for cor to secs 1-2-33- and 36 - Marked with 1 notch on E and 5 notches on W. edges. and raised mound of stone 2 ft high 3 ft base along side. Pits in fractic cable. Land broken and rocky Soil 4 th rate No Timber.

Exterior Boundaries T₇ N R₁ W

Next on true line bet secs 2 and 35-

Var 13° 55' E.

- 1-00 Top of ridge bet st. and S. Descend
- 9-00 Bottom of ridge. Ascend over broken country.
- 40-00 Set Malpais stone 20x18x16 in 14 in in
the ground for 1/4 sec cor. marked 1/4 on st.
side and raised mound of stone 2 ft high
3 ft base alongside. Pits imfracticable
- 80-00 Set granite-stone 24x16x6 in 10 in in
the ground (rocks prevented setting deeper)
for cor to secs 2-3-34 and 35- Marked
with 2 notches on the E. and 4 notches
on the W. edges - and raised mound
of stone 2 1/2 ft high 4 ft base alongside.
Pits imfracticable.
- Land broken and rocky.
- Soil 4th rate.
- No timber.

Exterior Boundaries 37N 181W

chains

- + West on true line bet sec 3 and 34
 Var $13^{\circ} 58' E$
 Ascend steep rocky ridge
 14-00 Top of ridge 600 ft high. In N. and S.
 17-00 Descend
 39-75 Ravine - course S. E.
 40-00 Set Malpais stone $20 \times 12 \times 10$ ins 14 ins
 in the ground for $\frac{1}{4}$ sec cor. Marked $\frac{1}{4}$
 on N. side and raised mound of stone
 2 ft high 3 ft base along side. Pits impracticable
 78-00 Top of ridge. In S. E. and N. W.
 80-00 Set Malpais stone $24 \times 16 \times 6$ ins 16 ins in
 the ground for cor to sec 3+4-33 and 34
 Marked with 3 notches on the E and W. edges
 and raised mound of stone 2 ft high 3 ft
 base along side. Pits impracticable.
 Land hilly and rocky
 Soil 4th rate
 No timber.

Exterior Boundaries 57N R17W

chains

Rest on true line between 4 and 33
Var $13^{\circ} 50'$ E.

Descend

1-50 Prairie - course N.

27-20 Prairie - course N.E. Small spruce and
Cottonwood trees S. 40 lbs dist.

3-20 Recross track - course S. 75° E.

6-00 Ascend

10-06 Set Malfair stone $20 \times 15 \times 10$ in 14 in the
ground for $1/4$ sec cor. Marked $1/4$ on N. side
And raised mound of stone 2 ft high 3 ft
base alongside - Pits in fracturable.

20-00 Set Malfair stone $24 \times 10 \times 8$ in 10 in in the
ground (rock prevented setting deeper) for
cor to sec. 4-5-32 and 33 - Marked
with 4 notches on E and 2 notches on W. edges.
And raised mound of stone 2 ft high 3 ft base
alongside. Pits in fracturable
Land broken and rocky

Exterior Boundaries T7 N R 1 W

chains

Soil 4th rate

Timber - few Cottonwoods along creeks.

Met on true line bet sec 5 and 32
Var $13^{\circ} 50'$ E

Over broken hilly country.

40-00 Set Malpais stone $20 \times 12 \times 6$ ins 14 ins
in the ground for $1/4$ sec cor. marked $1/4$
on N. side and raised mound of stone
2 ft high 3 ft base alongside. Pts. intractable.
Descend.

43.00 Deep gulch - course S.E. Ascend.

58-00 Descend steep bluff

59-00 Gulch course S.E. Ascend.

80-00 Set granite-stone $10 \times 10 \times 4$ ins 12 ins
in the ground for cor to sec 5-6-31 and 32.
Marked with 5 notches on E and 1 notch on
N. edges and raised mound of stone 2
ft high 3 ft base alongside

Exterior Boundaries D⁷ N R17W

chains

Pike impracticable.

Land hilly

Soil 4th rate

No timber.

Next on true line bet secs 6 and 31

Var $13^{\circ} 5' 0''$ E.

12-00 Enter wash course S. 70° E.

23-00 As usual

39-00 Top of steep knoll. 150 ft high Descend.

40-00 Set sandstone 24 x 12 x 4 in 16 in in the ground for 1/4 sec cor. Marked 1/4 on N. side and raised mound of stone 2 ft high 3 ft base alongside. Pike impracticable.

79-03 Set sandstone 36 x 18 x 6 in 12 in in the ground (rock prevented setting deeper) for cor to Lower half 6 and 7 N. R. 1 and 2 W. Marked with 6 notches on N. E. S. and W. edges. And raised mound of stone

Exterior Boundaries 37 N R1W

chains

$1\frac{1}{2}$ ft high 4 ft base around stones.

Pike in practicable.

Land hilly

Soil 4th rate.

No timber.

September 16th 1891

From the cor. to Sp. 6 and 7 St. P. 1 and
2 W. I run N. bet secs 31 and 36.

Var $13^{\circ} 50'$ E.

40-00 Set sandstone $16 \times 8 \times 6$ in & in in the
ground for $\frac{1}{4}$ sec cor Marked $\frac{1}{4}$ on N
side and raised mound of stone 2 ft
high 3 ft base alongside.

Pike in practicable.

41-00 Mark 30 lbs wide course S. 75° E.

Ascend.

59-00 Top of ridge 200 ft high on E and W.

62-00 Head of ravine - course E. Ascend

Exterior Boundaries S 7ⁿ R 1 W

chains
80-00

Set a sandstone 30x8x6 in 12 in
in the ground (rock prevented setting
deeper) for cor to sec 25-30-31 and 36.
Marked with 5 notches on N and 1 notch
on S. edges, and raised mound of
stone 2 ft high 3 ft base alongside.
Pits infracticable.

Land hilly.

Soil 4th rate

No timber.

North bet. sec 25 and 30.

Var 13° 5' 0" E.

- 2-80 Top of bluff 40 ft high - Descend.
4-50 Gulch course E.
7-00 Ascend.
8-00 Top of ridge bet E and W. Descend.
10-00 Gulch - course E. Ascend.
12-00 Top of knoll - Descend.

Exterior Boundaries 17 N 13 W

chains

- 40-00 Set granite-stone 16x8x6 ins 8 ins in the ground for $1/4$ sec cor marked $1/4$ on N. side and raised mound of stone 2 ft high 3 ft base along side. Pits - in practicable.
- 77-00 Top of mountain ridge 1000 ft high on S E and N. W.
- 80-00 Set granite-stone 24x6x6 ins 16 ins in the ground for cor to secs 19-24-25 and 30. Marked with 4 notches on N. and ² E. edges and raised mound of stone 2 ft high 3 ft base along side. Pits - in practicable
Land mountainous.
Soil 4th rate
No timber.

North bet secs 19 and 24

Var $13^{\circ} 58' E$,

Ascend.

Exterior Boundaries S7N R1W

chains
0-00

Summit of Mountain Pass set Malfair
stone 18 x 12 x 4 in 12 in in the ground
for 1/4 sec cor. Marked 1/4 on N. side and
raised mound of stone 2 ft high 3 ft base
alongside. Pits - infracticable.

Descend

5-75

Mountain trail on S. E. and S. W.

8-00

Mark course S. E.

0-00

Set Malfair stone 36 x 18 x 16 in 12 in in
the ground (rock prevented setting deeper)
for cor to secs 13-18-19 and 24. Marked
with 3 notches on N. and S. edges. and
raised mound of stone 1 1/2 ft high 5 ft base
around stone. Pits - infracticable.

Land mountainous.

Soil 4th rate

No Timber

North set secs 13 and 18.

Exterior Boundaries S 7th R 17th

chains

Var 13' 50" E.

10-00 Gulch course E. Ascend

13-00 There being a rock butte 1000 ft high capped with perpendicular rock bluff 75 ft high on line - S offset & chs West thence North -

40-00 The $\frac{1}{4}$ sec cor. would come on the summit of the butte above described, which point is inaccessible.

80-00 S offset & chs East and set Malpais stone 24x16x10 in 10 in in the ground (rock prevented setting deeper) for cor to sec 7-12-13 and 18, marked with 2 notches on N. and 4 notches on S edger - and raised mound of stone 2 ft high 4 ft base alongside.

Pike intractable.

Land mountainous.

Soil 4th gate -

BOOK 1426

Exterior Boundaries S 7 N R 1 W

Chains

No timber.

September 17th 1891

North bet sees 7 and 12

var $13^{\circ} 50' E$

- 1-60 Gueck course E ascend.
- 34-00 Top of mountain 800 ft high
- 35-00 Descend
- 40-00 Set Malpais stone $24 \times 18 \times 14$ ins
18 ins in the ground for $\frac{1}{4}$ sec cor
Marked $\frac{1}{4}$ on N side and raised
mound of stone 2 ft high 3 ft base
along side Pits impracticable
- 80-00 Set Granite stone $30 \times 18 \times 16$ ins
12 ins in the ground (rock prevented
setting deeper) for cor to sees 1-6-7
and 12 Marked with 1 notch on N
and 5 notches on S edges and
raised mound of stone 2 ft high

Exterior Boundaries 377 N 1/4

chain

3 ft base along side Pits impracticable
Land mountainous

Soil 4th rate

No timber

North bet secs 1 and 6

var $13^{\circ} 5' 0''$ E

25-00 North 5-0. Chs wide course $S 60^{\circ} E$.

Ascend

36-00 Top of ridge bet N.E. and S.W. Descend

40-00 Set Malpais stone $18 \times 10 \times 8$ ins 12 ins in
the ground for $1/4$ sec cor marked $1/4$ on

N. side and raised mound of stone
2 ft high 3 ft base alongside
Pits impracticable.

65-00 Gulch course S.E. Ascend

71-00 Low ridge bet E and W

73-00 Descend

80-00 Set granite stone $24 \times 6 \times 12$ ins 18

Exterior Boundaries 27 N 121 W

chains

is in the ground for cor to Tfs. 7
and 8 N. Rgs. 1 and 2 W. Marked
with 6 notches on N. E. and W. edges
and raised mound of stone 3 ft high 5-
ft base along side. Pile infracticable.

Land mountainous

Soil 4th rate -

No timber.

From the cor to Tfs 7 and 8 N

Rgs 1 and 2 W. I run

East on a random line bet

secs 6 and 31.

var $13^{\circ}50'E$

40-00

set temporary 1/4 sec. cor.

80-00

Beyond this point the country is
very rough. There is two or three
canons running into Castle
Crest with perpendicular walls

Exterior Boundaries S7 N R17

Chains

from 400 to 600 ft high and it
is impossible to chain the line
through therefore I allow 1.46
chs for convergence and

Set Granite stone 18x16x12 ins
12 ins in the ground for cor to Secs

5-6-31 and 32 marked with
5 notches on E and 1 on N. edges

and raised mound of stone
2 1/2 ft high 4 ft base along side

Pts impracticable.

Hence West on a true line
bet Secs 6 and 31

Var $13^{\circ} 50' E$

10-00 Top of a yellow Knoll 200 ft high
Descend

40-00 Set Malpais stone 16x8x6 ins
8 ins in the ground for 1/4 sec cor
marked 1/4 on N side

Exterior Boundaries 17ⁿ R 1^w

ains

and raised mound of stone
1 1/2 ft high 2 1/2 ft base along side
Pits impracticable.

46-00 Ascend

52-00 Top of a granite knoll 750 ft high
Descend

58-00 Bottom of knoll

76-00 Descend

78-54 Cor to 3ps 7 and 8ⁿ Rs 1 and 2^w
Land rough and hilly
Soil rocky 4th rate
No timber

September 18th 1891

Exterior Boundaries 77 N R1 W

chains

From the cor. to Dps
7 and 8 N. Rs 1 E. and 1 W.
which is a granite stone firmly set
and marked as described in the
field notes furnished by the Survey
General. A run —
Thence West on a true line bet.
rds 1 and 36

Var $13^{\circ} 58' E$

- 21-00 Wash course $S 75^{\circ} E$. Ascend
40-00 Set Malpais stone $36 \times 18 \times 16$ in
12 in in the ground (rocks pre-
vented setting deeper) for $\frac{1}{4}$ sec cor.
Marked $\frac{1}{4}$ on N. side and raised
mound of stone 2 ft high 3 ft base
along ridge. Pile impracticable.
40-50 Top of ridge in N. and S. Descend
41-80 Prescott and Phoenix Toll road
in $S 15^{\circ} E$. N. $15^{\circ} W$.

Exterior Boundaries 277 N 1 W

chains

61-00 French Creek 100 lbs wide course S
Ascend

20-00

Set granite stone 20x10x8 in 15 in in
the ground for cor to sec 1-2-35 and 36
Marked with 1 notch 1 E. and 5 notches
on N. edge and raised mound of
stone 2 ft high 8 ft base along side
Pike in facticable.

Land rough broken and hilly
Soil rocky - 4th rate -
Timber - Cottonwood along French
Creek.

West on true line bet sec 2 and 35 -
Var. 130 5' 2" E

Descend.

6-00 Bottom of gulch course S 20° E. Ascend

9-00 Top of black Malpais ridge 600 ft high
In stand S. Descend.

Exterior Boundaries T7 N R1 W

chain

- 38-25 Gulch course S25°E. Arcuend.
- 40-00 Set Malpais stone 28x12x8 ins 10 ins
in the ground (rock prevented setting
deeper) for 1/4 sec cor, marked 1/4 on N
side, and raised mound of stone
2 ft high 3 ft base alongside.
Pits infracticable.
- 80-00 Set Malpais stone 16x12x18 ins 8
ins in the ground for cor to sec
2-3-34 and 35. Marked with 2
notches on E. and 4 notches on N
edges, and raised mound of stone
2 ft high 3 ft base alongside.
Pits infracticable.
Land very rough and hilly.
Soil rocky 4th rate.
No timber.

Next on true line bet sec 3- and 34

Exterior Boundaries I 7 N R 1 W

Var 13° 58' E.

Ascend

Top of knoll 600 ft high Descend

Top of rock bluff 100 ft high Descend

Bottom of descent.

Trail on N. 65° E. and S 65° W.

Set granite stake 20 x 8 x 6 in 18 in
in the ground for 1/4 sec cor. Marked

1/4 on N. side and raised mound of
stone 2 ft high 3 ft base along side.

Pits impracticable. Descend

Set Post 4 ft long 4 in square 12 in
in the ground for cor to sec 3-4

33 and 34. Marked.

T. 8 N S 34 on N. E. R 1 W. S 3 on

S. E. T. 7 N S 4 on S. W. and S 33 on

N. W. faces, with 3 notches on E. and W
edges and raised mound of stone

1 1/2 ft high 3 ft base around post

Exterior Boundaries T7th R1th W.

chains

Pits infracticable.

Land rough and hilly
Soil rocky 4th rate -
No timber.

Next on true line bet sec 4 and 33.
Var 13° 5' 0" E.

- 2-00 Bottom of gulch and stream of hot water
flows South. Ascend.
- 5-00 Top of steep bluff
- 19-00 Gulch course S. Ascend.
- 28-00 Top of ridge bet N. and S. Descend
- 38-15- Castle Creek flows S 25° E
- 40-00 Set a granite boulder 36 x 20 x 16 in x 10 in
in the ground (rock prevented setting
deeper) for 1/4 sec cor, marked 1/4 on N
side and raised mound of stone
3 ft high 5 ft base against south side
of stone. Pits infracticable.

Exterior Boundaries T7 N-R1 W

Land very rough and hilly
 Soil rocky 4th rate -
 Some Cottonwood and Willow
 along Castle Creek,

September 19th 1891

30 Chs West of the $\frac{1}{4}$ cor. on N. side
 of sec. 4 The West wall of Castle
 Creek canyon rises very abruptly
 and the country beyond is very
 rough and broken so much
 so that it was impossible to
 chain the line farther,

All of these lines run over rough
 mountainous land.

70 Exterior Boundaries T7N R1-W

General Description.

The Lfs bounded by these lines are very rough and mountainous being most altogether a granite or Malpais formation.

There is very little timber - but only a few Cottonwoods and Willows along the creeks, and scattering Palo Verde trees. Also a luxuriant growth of Cacti throughout the Township.

Francis B. Jacobs
U S Deputy Surveyor

List of Names.

A List of the Names of Individuals employed to assist in running, measuring, or marking the lines and corners described in the foregoing Field Notes of the survey of the N. bound. T. 22 N.

R. 5 E. returning to bound T. 22 N. R. 5 E.

North boundary T. 21 N. R. 4 E. and

range line through Tpo. 21 N. R. 4

H. 5 E.

of the principal town and Mendocino Townships of Arizona

Showing the respective capacities in which they acted.

Clod Thompson Chainman.

Lee Bond Chainman.

..... Axeman.

..... Flagman.

Notary Public

Final Oath of Assistants.

BOOK 1426

M We hereby certify that *we* assisted *Francis*

B Jacobs U. S. Deputy Surveyor, in

surveying *The* *boundary*

and 5 Miles of the West boundary

Township 22 N. R. 5 E. Retracing South

boundary T 22 N. R. 5 E. North boundary

T 21 N. R. 4 E. *Co* Range line through

Tps 21 N. Ranges 4 *and* 5 East

and that said Survey has been in all respects, to the best of our knowledge and belief, well and faithfully executed, and the boundary monuments planted according to the instructions furnished by the Surveyor-General.

Clad Thompson
Chairman.

Lee ^{his} *Bond* Chairman,

Witnessed by *Babbitt* mark Axeman.

Flagman.

Sworn to and subscribed before me, this *7th*

day of *May*, 1892

E Babbitt

Surveyor General

Final Oath of Deputy Surveyor.

BOOK 1426

I,

U. S. Deputy Surveyor, do solemnly swear that in pursuance of a contract with John Wasson, United States Surveyor-General for Arizona, bearing date the day of

187... I have well, faithfully and truly, in my own proper person, and in strict conformity with the instructions furnished by the Surveyor-General, the Surveying Manual, and the laws of the United States, surveyed all those portions of

dated by
1878

dated

corrected

and

..... as are represented in the foregoing Field Notes as having been surveyed under my directions; and I do further solemnly swear that all the corners of said surveys have been established and perpetuated in strict accordance with the Surveying Manual and printed instructions, and also in accordance with the additional requirements con

Arizona

tained in circular instructions from the
Surveyor-General for Arizona, dated S
1, 1873, regarding the establishment of
boundaries of public surveys, and that
going are the true and original Field
such surveys.

Deputy Surveyor

Sworn to and subscribed before me, this
day of -----, 187--

BOOK 1426

BOOK 1426

U. S. Surveyor-General's Office,

TUCSON, A. T., NOV 7 1892

The foregoing Field Notes of the Surveys

Portion of exterior Op 22 N. R. 5 E.
Op 21. N. R. 1. E. T. 7 N. R. 1. W

of the Gila and Salt River Meridian
in Arizona executed by
Francis B Jacobs

U. S. Deputy Surveyor, under his contract dated

May 25th 1891

having been critically examined, the necessary corrections and explanations made, the said Field Notes and the surveys they describe are hereby approved.

Royal Johnson

U. S. Surveyor-General
for the Territory of Arizona