

S. + E. BOUNDARIES
TRIS R 21 E

E + W BOUNDARIES
TRIS R 20 E

BOOK 1579

CONTRACT 787
PL. CON. 3/4
U.S. DEPT.

1579

1579

1579

BOOK 1579

4-671

FIELD NOTES
GENERAL LAND OFFICE.

Of the survey of the
South and East Boundaries
- of
Township No. 21 South, Range No. 21 East
- and
East and West Boundaries
- of
Township No. 21 South, Range No. 20 East
- of the
Gila and Salt River Basins and Meridian
in the
Territory of Arizona
As surveyed by
Philip Cortzen
U. S. Deputy Surveyor
Under his contract No. 87
Dated August 24, 1901.

Survey commenced October 23, 1901.

Survey completed November 10, 1901.

Book No. 1579

” ”
INDEX

BOOK 1579

4TH STANDARD PAR. SOUTH

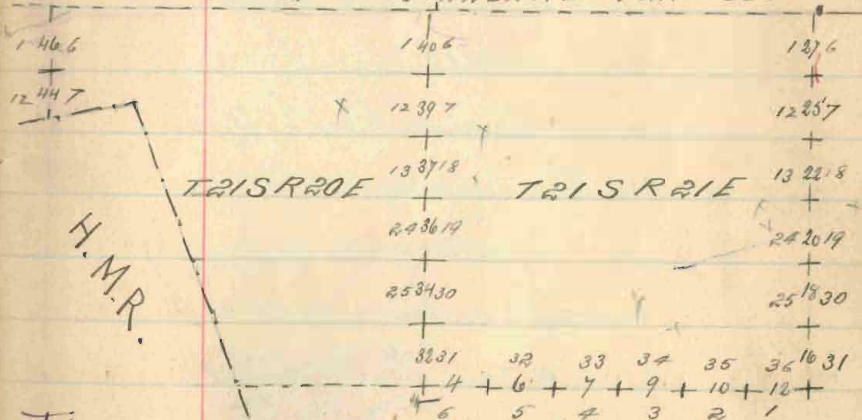

Tp 21 S.

Range 21 E

South Bdry Page 4

East " " 16

West " " 32

T 21 Range 20 E

Free West Bdry Page 44

South boundary of A 21 S, R 21 E.

Chains.

Survey commenced October 23, 1901, and executed with a W. F. L. E. Gurley light mountain transit No. 4607, with Burt's solar attachment, as heretofore described. Examine the adjustments of the instrument and find them correct.

At 8^h 09^m a.m. l.m.t., I set off 31° 33' on the lat arc, 11° 18' S on the decl arc, and determine a true meridian with the solar at the cor of Sps 21 and 22 S, Rs 20 and 21 E, as heretofore described.

Then I run

East on a true line bet secs 6 and 31.

Over gently rolling land.

38.68

Set a redwood post, 3 ft long, 4 ins sq, with marked stone, 24 ins in

South boundary of P 21 S, R 21 E - continued.

Chains

The ground, for $\frac{1}{4}$ sec cor marked
 $\frac{1}{4}$ S 31 on N and $\frac{3}{4}$ S on S faces; dig
 pits 18x18x12 ins, E and W of post,
 3 ft dist, and raise a mound of
 earth 3 $\frac{1}{2}$ ft base, 1 $\frac{1}{2}$ ft high, N of
 cor.

78.68

Set a redwood post, 3 ft long, 4 ins
 sq, with marked stone, 2 $\frac{1}{2}$ ins in
 the ground, for cor of secs 5, 6, 31
 and 32, marked

P 21 S, S 32 on NE,

R 21 E, S 5 on SE.

P 22 S, S 6 on SW, and
 S 31 on NW faces, with 1 notch
 on W and 5 notches on E edges;
 dig pits 18x18x12 ins in each sec,
 5 $\frac{1}{2}$ ft dist, and raise a mound of
 earth 4 ft base, 2 ft high, W
 of cor.

South boundary of P 21 S, R 21 E continued.

Chains

Land, gently rolling.

Soil, granully; 2^d natl.

No timber; undergrowth, scattering mesquite.

East on a true line bet. sec 5 and 32.

Over gently rolling land.

24.30 Wash, 50 lbs wide, course N easterly

40.00 Set a postwood post, 3 ft long, 4 ins sq, with marked stone; 24 ins in the ground, for $\frac{1}{4}$ sec ev, marked $\frac{1}{4}$ S 32 on N, and S 5 on S faces; dig pits 18x18x12 ins, E and W of post, 3 ft dist, and raise a mound of earth 3 $\frac{1}{2}$ ft base, 1 $\frac{1}{2}$ ft high, N of ev.

48.00

Enter scattering mesquite and yucca.

South boundary of Sec 1 S., T. 21 E. - continued
 Chains

60.00 Grass scattering mesquite, and
 yucca.

80.00 Set a sandstone 18x8x8 ins, 12 ins
 in the ground, for cor of secs 4, 5,
 32, and 33, marked with 2 notches
 on W and 4 notches on E edges;
 dig pits 18x18x12 ins, in each sec,
 50 ft dist, and raise a mound of
 earth 4 ft base, 2 ft high, W of
 cor.

Land, gently rolling

Soil, gravelly; 2 sand & rats.

No timber, undergrowth, mesquite
 and yucca.

East on a true line bet secs 4
 and 33.

Over level, gently rolling land.

8.15-

Wash, 20 lbs wick, corner N easterly

South boundary of Sec 1 S, R 2 E - continued

Chains

16.00

Enter drive to set undergrowth, bars N easterly and S westerly.

40.00

Set a redwood post, 3 ft long, 4 ins sq, with marked stone, 24 ins in the ground, for $\frac{1}{4}$ sec cor, marked $\frac{1}{4}$ S 33 on N, and S 4 on S face, dig pits 18x18x12 ins, E and W of post, 3 ft dist, and raise a mound of earth $3\frac{1}{2}$ ft base, $1\frac{1}{2}$ ft high, N of cor.

69.93

Road, bars N easterly and S westerly

80.00

Set a sandstone 18x18x8 ins, 12 ins in the ground, for cor of secs 3, 4, 33 and 34, marked with 3 notches on E, and W edges, and raise a mound of earth 4 ft base, 2 ft high, W of cor.

Land, level, and rolling
Soil, gravelly and rocky; sand

South boundary of S 21 S, R 21 E - continued.

Chains

3 rate.

No timber, undergrowth, mesquite
and mesquite.

Dense undergrowth, 65.00 Chs.

October 23, 1901.

October 24, 1901.

East on a true line bet sses 3
and 34.

Over level and rolling land.

Through dense undergrowth.

22.30 Wash, 100 lbs wide, course N easterly

41.00 Set a 190 mod post, 3 ft long 14
ins sq, with marked stone, 24
ins in the ground, for $\frac{1}{4}$ sec cor,
marked $\frac{1}{4}$ S 34 on N and S 3 on
S faces; dig pits 18 x 18 x 12 ins, E
and W of post, 3 ft dist, and
raise a mound of earth 3 $\frac{1}{2}$ ft.

South boundary of S 21 S, R 21 E - Continued
Chains

base, 1 1/2 ft high, N of cor.
80.00 Set a sandstone 18x8x8 ins, 12 ins
in the ground, for cor of sees 2,
3, 34 and 35, marked with 4 notches
on W and 2 notches on E edges;
dig pits 18x18x12 ins in each sec.
52 ft dist, and raise a mound of
earth 4 ft base, 2 ft high, N
of cor.

Land level and rolling.

Soil, gravelly; 3^d rate.

No timber; undergrowth, tesota,
sage and mesquite.

Dense undergrowth, 80.00 Chs.

East on a true line bet sees 2
and 35.

Through dense undergrowth.

40.00 Set a redwood post, 3 ft long, 4 ins

South boundary of A 21 S, R 21 E - continued
Chains

sq., with marked stone, 24 ins in
the ground, for 4 ssec cor, marked
 $\frac{1}{4}$ S 35 on N and S 2 on S faces;
dig pits 18 x 18 x 12 ins, E and
W of post, 3 ft, dist, and raise
a mound of earth $3\frac{1}{2}$ ft base,
 $1\frac{1}{2}$ ft high, N of cor.

64.10 Telephone line to Pumbstone,
bears N 27° E and S 27° W.

64.20 Road to Pumbstone, bears N
westerly and S westerly.

64.72 Pipe line, bears N E, and S W.

8000 Set a wooden post, 3 ft long, 4
ins sq., with marked stone, 24 ins
in the ground, for cor of ssec 1, 2,
35 and 36, marked

S 21 S, S 36 on N E,

R 21 E, S 1 on S E,

S 22 S, S 2 on S W, and

South boundary of S 21 S, R 21 E - continued
Chains

S 35 on N W faces with 5 notches
on W and 1 notch on E edges;
dig pits 18 x 18 x 12 ins in each sec,
5 1/2 ft dist, and raise a mound
of earth 4 ft base, 2 ft high, W
of sec.

Land, level and rolling
Soil, gravelly; 2^d and 3^d rate.
No timber; undergrowth, brsota,
muscute and Sage.
Dense undergrowth, 8000 lbs.

Cast on a true line bet secs 1
and 36.

Over level and rolling land.
Through dense undergrowth.

4000 Set a sandstone 18 x 8 x ins, 12 ins
in the ground, for 1/4 sec ea, marked
1/4 36 on N and 1 on S faces, and

South boundary of S 21 S, R 21 E - Continued
Chains

- run a mound of stone 2 ft base,
1 1/2 ft high, N of cor. Pits impracti-
cable. A mesquite 6 ins diam, ^{bars} S 21 S,
32 lbs dist, marked 1/4 S 1, B 57.
- 41.00 Draw, 1 ch wide, course N easterly
- 44.20 Intersect W line of the San Rafael
del Valle grant, from which, the
N W cor of grant bears N 13 1/2° W
123.43 chs. dist.
- 48.63 Run fence, bears N 62° E and S 62° W.
- 8000 Set a redwood post, 3 ft long, 4 ins
sq, with marked stone, 24 ins in
the ground, for cor of Sps 21 and
22 S, R 21 and 22 E, marked.
S 21 S, S 31 on N E
R 22 E, S 6 on S E,
S 22 S, S 1 on S W, and
R 21 E, S 36 on N W faces; with
6 notches on each edge; dig pits

South boundary of Sec 1 S, R 21 E - continued.
 Chains

24 x 24 x 12 ins, in each line, N, E
 and W, 4 ft, and S of post, 8 ft
 dist, and raise a mound of earth
 5 ft base, 2 1/2 ft high, S of cor.
 Level, level and rolling.

Soil, gravelly; 2^d and 3^d rates.

No timber, undergrowth, tesota,
 mesquite, and sage.

Dense undergrowth, 8000 chs.

October 24, 1901.

General Description

This line runs over level and
 rolling land and through dense
 tesota, sage and mesquite under-
 growth. Township 22 S, Range
 21 E, is level and rolling. There
 are no settlers or water in the

South boundary of Sec 21 S. R. 21 E. Conchedad.
Chains
Township.

Philip Coetzee
U. S. Deputy Surveyor.

East boundary S 21 S, R 21 E.

Chains

October 25, 1901. At 8^h 11^m a.m. local,
S set off 31° 33' on the lat arc; 12° 00' S
on the decl arc, and determine a
true meridian with the solar at
the cor of Sps 21 and 22 S, R 21
and 22 E, as heretofore described.

Shiner Run

North lat sec 31 and 36.

Over level and rolling land.

Through dense undergrowth.

16.00 Corner wire fence, bears 60 lks W.

18.50 Deep gulch, 100 lks wide, with running
water, course easterly; ruins of old
creek house, bears 8 chs W.

40.00 Set a redwood post, 3 ft long, 4 ins
sq, with marked stone, 24 ins in
the ground, for $\frac{1}{4}$ sec cor, marked
 $\frac{1}{4}$ S 36 on W and S 31 on E faces;
dig pits 18 x 18 x 12 ins, N and S of

East boundary of Sec 1 S, R 21 E - continued.

Chain

post, 3 ft. dist, and raise a mound of earth $3\frac{1}{2}$ ft base, $1\frac{1}{2}$ ft high, W of cor.

76.60 Road, bears N easterly and S westerly.

8.000 Set a redwood post, 3 ft long, 4 ins sq, with marked stones, 24 ins in the ground, for cor of sses 25, 30, 31 and 36, marked
 S 21 S, S 30 on NE,
 R 22 E, S 31 on SE,
 S 36 on SW and

R 21 E, S 36 on NW faces, with 1 notch on S and 5 notches on N edges; dig pits $18 \times 18 \times 12$ ins, in each sse, $5\frac{1}{2}$ ft dist, and raise a mound of earth 4 ft base, 2 ft high, W of cor.
 Ground, level and rolling.

East boundary of Parcel S. R. 21 E. continued.

Chains

Soil, sandy and gravelly; 2^d and 3^d rate.

No timber; undergrowth, tree to, mesquite and sage.

Dense undergrowth, 8,000 chs.

North bit sees 25 and 30.

Over level and rolling land.

Plumch dense undergrowth

40.00

Set a redwood post, 3 ft long, 4 ins sq, with marked stone, 24 ins in the ground, for $\frac{1}{4}$ sec cor, marked $\frac{1}{4}$ S 30 on E and S 25 on W faces; dig pits 18 x 18 x 12 ins, N and S of post, 3 ft dist, and raise a mound of earth 3 $\frac{1}{2}$ ft base, 1 $\frac{1}{2}$ ft high, W of cor.

55.38

Intersect wire fence along N line of San Rafael del Valle

East boundary of Sec 1, R. 2, E. Continued.

Chains

grant, bears $N 76\frac{1}{2}^{\circ} E$; from this point NW cor of grant bears $S 76\frac{1}{2}^{\circ} W$, 66.06 chs dist.

63.00 Lowry drain, 4 chs wide, course N easterly.

8.00 Set a granite stone $18 \times 10 \times 8$ ins, 12 ins in the ground, for cor of secs 19, 24, 25 and 30, marked with 2 notches on S and 4 notches on N edges; dig pits $18 \times 18 \times 12$ ins, in each sec, $5\frac{1}{2}$ ft dist, and raise a mound of earth 4 ft base, 2 ft high, W of cor. From this cor an adobe house bears $N 55^{\circ} E$, 17 chs dist. Land, level and rolling.

Soil, gravelly; 2^d and 3^d rate.
No timber; undergrowth, tesola, mesquite and Sage.

East boundary of Sec 1 S, R 21 E - continued.

Chains

Dense undergrowth, 8000 chs.

North bet sees 19 and 24.

Over level and rolling land.

Through dense undergrowth.

23.00 Draw, 2 chs wide, course, easterly.

26.90 Pipe line to Sumbstone, bears
N 60 and S W

29.10 Road to Fairbank, bears N easterly
and S westerly.

34.12 Telephone line to Sumbstone, bears
N 70° E, and S 25° W.

40.00 Set a redwood post, 3 ft long, 4
ins sq, with marked stum, 24 ins
in the ground, for $\frac{1}{4}$ sec cor.
marked $\frac{1}{4}$ S 24 on W and S 19
on E faces; dig pits 18 x 18 x 12
ins, N and S of post, 3 ft. dist,
and raise a mound of earth

East boundary of Sec 18, 1818 continued.

Chains

3 1/2 ft base, 1 1/2 ft high, W of cor.

67.114 Road, bears easterly and westerly.

67.50 Road, bears N westerly, and S
easterly; junction of roads bears
1 ch E.75.56 Wire fence bears N 57 1/4° E, and
S 57 1/4° W.80.00 Set a redwood post, 3 ft long, 4
ins sq, with marked stones, 24
ins in the ground, for cor of secs

13, 18, 19 and 24, marked

R 21 S, S 18 on NE,

R 22 E, S 19 on SE,

S 24 on SW and

R 21 E, S 13 on NW faces, with
3 mitchers on N and S edges; dig
pits 18 x 18 x 12 ins, in each sec,5 1/2 ft dist, and raise a mound
of earth 4 ft base, 2 ft high,

East boundary of S 21 S, R 21 E - continued

Chains

W of cor.

Land, rolling.

Soil, gravelly; 2nd and 3rd rates.

No timber; undergrowth, tobacco,
mesquite and sage.

Dense undergrowth, 8.00 chs

October 26, 1901.

North bet acres 12 and 18.

Over level and rolling land.

Through dense undergrowth.

11.00 Ascent ridge.

15.00 Supr. bars N W and S E; descent.

22.37 Wire fence, bars N W and S E.

23.00 Foot, under river San Pedro valley.

24.00 Hay stacks on line, bars 1 ch
N W

25.00 Wire fence, bars N W and S E.

26.00 Wolff house, bars 2 chs N W

East boundary of S 21 S, R 21 E - continued.

Chains

- 30.50 Road, bears N easterly and S westerly.
- 31.00 Wire fence, 4 chs E, bears N easterly
and S westerly
- 31.10 Wire fence, bears N easterly and S westerly
- 32.00 Wire gate, bears 1 ch E.
- 32.67 Road, bears N easterly and S easterly;
corn field, bears 5 chs E.
- 38.42 Wire fence, bears N easterly and S
westerly, and enter alfalfa field.
- 40.00 Set a granite stone 18x10x8 ins, 12 ins
in the ground, for $\frac{1}{4}$ sec cor, marked
 $\frac{1}{4}$ 13 on W and 18 on E faces; dig pits
18x18x12 ins, N and S of stone, ^{3 ft dist-} and
raise a mound of earth 3 ft base,
1 1/2 ft high, W of cor.
- 44.00 San Pedro river, 1.30 chs wide, course
N westerly and bears down underground.
- 45.00 Enter section.
- 48.59 Wire fence, bears N 64° W, and S 64° E.

East Boundary of Secs 1, 2, 3, 4 - Continued.

Chains

49.40

Middle of single track of the Arizona
and Southern Railroad, bears
 $N 64^{\circ} W$, and $S 64^{\circ} E$.

49.90

Railroad ditch, bears N westerly and
 S easterly.

50.14

Telegraph line, bears $N 64^{\circ} W$ and
 $S 64^{\circ} E$.

50.22

Wind fence, bears $N 64^{\circ} W$ and $S 64^{\circ} E$.

56.00

Dry wash, 90 lbs wide, course N
westerly.

60.00

Corner, bears 8 chs W .

65.67

Road, bears N westerly and S easterly.

74.00

Corner San Pedro valley and section,
and across mesa and enter dense
timber.

80.00

Set a granite stone, $18 \times 7 \times 7$ ins, 12 ins
in the ground, for cor. of secs 7, 12,
13, and 18, marked with 4 notches
on S and 2 notches on N edges, and

East boundary of Sec 1, R. 21 E - continued.

raise a mound of stone 2 ft base, 1 1/2 ft high; W of cor. pts impracticable.
Land level and rolling.

Soil, sandy, gravelly and rocky;
1st, 2^d and 3^d rate.

No timber; undergrowth, trees and
seston.

Dense undergrowth, 8000 lbs.

North cut sec 7 and 12.

Over mountainous land.

Ascending

3.00 Dry wash, 40 lbs wide, course S
westerly.

4.90 Rocks above wash, 40 lbs wide,
course S westerly.

17.80 Top of rocky knoll; cor. at this
point, 3° 40' E.

22.00 Highest point of Bronkaw Hill

East boundary of P. 21 S, R. 21 E - Continued.

Chains

- bears 6 chs W.
- 37.00 Feet; gulch, 30 lbs wide, course mostly
- 41.00 Set a sandstone $18 \times 8 \times 6$ ins, 12 ins in
the ground, four 4 sec cor. markers $\frac{1}{4}$
 $\frac{1}{4}$ in on W and 7 on E faces, and
raise a mound of stone 2 ft base, 1 1/2
ft high, W of cor. Pits impracticable.
ascend.
- 54.30 Top of ridge, bears E and W, and
descend.
- 58.00 Feet; gulch, 20 lbs wide, course
mostly; ascend.
- 63.17 Top, bears easterly and westerly, and
descend.
- 68.00 Summit, and ascend.
- 72.00 Top, bears N-easterly and S-westerly,
and descend.
- 80.00 Set a slate stone, $18 \times 8 \times 6$ ins, 12 ins
in the ground, four 4 sec. 1, 6, 7

East boundary of S 21 S. R 21 E continued.

Chains

and 12, marked with 5 notches on
 S and 1 notch on N edges, and
 raise a mound of stone 2 ft base,
 1 1/2 ft high, W of cor. Pits impracticable.
 Land, mountainous.

Soil, gravelly and rocky; 3^d and
 4th water.

No timber; undergrowth, scattering
 mesquite, trecha and vegetable.
 Mountainous land, 8.00 chs.

North bat sees 1 and 6.

Over mountainous land.

Overriding.

Through scattering trecha.

1.50 Foot, gulch, 20 lbs wide, course N
 westerly, and ascend.

3.00 Sep, cross E and W; descend.

4.00 Foot, gulch 10 lbs wide, course

East boundary of P 21 S, R 21 E - Continued.
Chains

- westerly; ascend.
- 5.00 Top, brass E and W; descend.
- 8.00 Post; dry wash, 10 lbs wide, course
westerly; ascend.
- 15.00 Old workings of Bunkow mine, brass
2 chs E.
- 17.00 Top, brass E and W, and descend.
- 20.00 Post; dry wash, 10 lbs wide, course
N ~~westerly~~ ^{westerly}; ascend.
- 24.00 Open cut, 10 ft deep.
- 28.00 Post; dry wash, 15 lbs wide, course
N westerly.
- 30.90 Dry wash, 25 lbs wide, course N
westerly.
- 35.20 Dry wash, 10 lbs wide, course S
westerly.
- 35.50 Ascend.
- 40.00 Set a porphyry stone, 18 x 12 x 6 ins,
12 ins in the ground for $\frac{1}{4}$ sec cov,

East boundary of A 21 S, R 21 E - Continued.

Chains

- marked 41 on W and 6 on E
 faces, and raise a mound of stone
 a ft base, 1 1/2 ft high, W of cor. Sets
 impracticable.
- 41.00 Top of W slope of ridge; descend.
- 51.00 Fort; dry wash, 60 lbs wide, course
 N westerly.
- 60.00 Hoist, brow 10 chs W.
- 63.00 Hoist on Banker mine, brow
 10 chs W.
- 68.00 Frame house, brow 5 chs W.
- 70.00 Dry wash, 70 lbs wide, course S
 westerly.
- 74.00 Entrance underground.
- 79.50 Draw draw underground, brow
 E and W.
- 85.30 Road to Bombstone, brow N
 easterly and S westerly.
- 86.50 Road to Bombstone, brow N easterly

East boundary of S 21 S, R 21 E - continued.
Chains

and S westerly.

86.90 Intersect South Standard Parallel
South, at a point 4.67 chs W of
Standard $\frac{1}{4}$ sec cor of S 36, as heretofore described.

Set a limestone 18 x 8 x 6 ins, 12 ins
in the ground, for closing cor of
S 21 S, R 21 E and 22 E, marked
C Cor S, with 6 grooves on S, E and
W faces, and raise a mound of stone
2 ft base, 1 $\frac{1}{2}$ ft high, S of cor. Site
impracticable.

Land, mountainous and mineral
bearing.

Soil, rocky; 4 rats.

No timber, undergrowth, scattering trees.

Mountainous land, 86.90 chs.

October 26, 1901.

East boundary of P. 21 S., R. 21 E. concluded.

General Description.

This line runs over level, rolling and mountainous land, and through dense undergrowth. Township 21 S., Range 21 E., is level, rolling and mountainous, and covered with dense undergrowth. There appears to be some good agricultural land in the western tier.

Philip Conzen

U. S. Deputy Surveyor.

East boundary of P 21 S, R 20 E.
Chairs

Survey commenced October 29, 1901 and executed with a W. and L. E. Gurley light mountain transit No. 4607, with Burt's solar attachment, as heretofore described.

At 4^h 30^m a m. l m t, P sat off $31^{\circ} 33'$ and the lat arc, $13^{\circ} 21'$ on the decl arc, and determine a true meridian with the solar at the cor of P 21 and 22 S, R 20 and 21 E, as heretofore described.

Thence P 21

North bet sec 31 and 36.

Over level land.

41.00 Set a pine post, 3 ft long, 4 ins sq, with marked stone, 2 1/2 ins in the ground, foot sec cor, marked $\frac{1}{4}$ S 36 on W and S 31 on E faces; dig pits $18 \times 18 \times 12$ ins, N and S of post, 3 ft

East boundary of T₂₁S, R₂₀E - continued.

Chains

dist, and raise a mound of earth
3½ ft base, 1½ ft high, W of cor.

46.30 Dig wash, 100 lbs wide, course N
westerly.

48.00 Enter scattering mesquite.

8.00 Set a redwood post, 3 ft long, 4
ins sq, with marked stony, 24 ins
in the ground, for cor of secs
25, 30, 31 and 36, marked

T₂₁S, S₃₀ on N E,

R₂₀E, S₃₁ on SE

S₃₆ on SW and

R₂₀E, S₂₅, on NW faces, with 1
notch on S and 5 notches on N
edges; dig pits 18 x 18 x 12 ins, in
each sec, 5½ ft dist, and raise
a mound of earth, 4 ft base, 2 ft
high, W of cor.

Land, level.

East boundary of P 21 S 16 20 E - Continued.

Chains

Soil, gravelly; 2^d and 3^d rate.

No timber; undergrowth, scattering mesquite.

North bet sres 25 and 30.

Over rolling land.

Plough scattering mesquite

2.000 Clear scattering mesquite.

28.00 Road, bars N easterly and S westerly.

40.00 Set a pine post, 3 ft long, 4 ins sq, with marked stens, 2 1/4 ins in the ground, for 1/4 sec cor, marked 1/4 S 25 on N and S 30 on E faces; dig pits 18 x 18 x 12 ins, N and S of post, 3 ft dist, and raise a mound of earth 3 1/2 ft base, 1 1/2 ft high, W of cor.

58.00 Dry wash, 50 lks wide, course N

East boundary of S 21, R 20 E - Burlington.

Chains

eastwardly.

8000 Set a pine post, 3 ft long, 4 ins
sq., with marked stone, 24 ins in
the ground, for cor of secs 19, 24, 25
and 30, marked

S 21 S, S 19 on N E,

R 21 E, S 30 on S E,

S 25 on S W and

R 20 E, S 24 on N W faces, with

2 notches on S and 4 notches on N

edges; dig pits 18 x 18 x 12 ins, in

each sec, 5 1/2 ft dist, and raise a

mound of earth 4 ft base, 2 ft high,

W of cor.

Land, rolling.

Soil, gravelly; 2^d and 3^d rates.

No timber; undergrowth, scattering
mosquito.

East boundary of Sec 13, R20E-Continued
 Chains

North bet secs 19 and 24.

Over rolling land.

23.00 Enter dense timber, bears easterly
 and westerly

40.00 Set a granite stone, 18x8x6 ins, 12 ins
 in the ground, for $\frac{1}{4}$ sec cor, marked
 $\frac{1}{4}$ 24 in W and 19 in E faces; dig
 pits, 18x18x12 ins, N and S of stone,
 3 ft dist, and raise a mound of
 earth $5\frac{1}{2}$ ft base, $1\frac{1}{2}$ ft high, W of cor.

43.80 Dry wash, 40 lbs wide, course N
 easterly.

85.00 Set a granite stone, 18x6x6 ins, 12
 ins in the ground, for cor of secs
 13, 18, 19 and 24, marked with 3
 notches on S and N edges; dig
 pits 18x18x12 ins, in each sec,
 $5\frac{1}{2}$ ft dist, and raise a mound of
 earth, 4 ft base, 2 ft high, W

East boundary of S 21 S, R 20 E - continued.

Chains

of cor.

Land, rolling.

Soil, generally; 2^d and 3^d rates.

No timber; undergrowth, tsetse.

Dense undergrowth, 5⁰⁰ chs.

North bet secs 13 and 18.

Over rolling land.

Through dense undergrowth.

28.50 Dry wash, 10 chs wide, course, N
westerly.40.00 Set a redwood post, 3 ft long, 4 ins
sq, with marked stone, 2 ft in in
the ground, for $\frac{1}{4}$ sec cor, marked
 $\frac{1}{4}$ S 13 on W, and S 18 on E faces;
dig pits 18x18x12 ins, N and S of
post, 3 ft dist, and raise a mound
of earth, 3 $\frac{1}{2}$ ft base, 1 $\frac{1}{2}$ ft high,
W of cor.

East boundary of A 21 S, R 20 E - Continued.

Chains

63.00 Dry wash, 10 lbs wide, course N
westerly80.00 Set a redwood post, 3 ft long, 4 ins
sq, with marked stone, 24 ins in
the ground, for cor of sec 7, 12, 13
and 18, marked

A 21 S, S 7 on NE,

R 21 E, S 18 on SE,

S 13 on SW and

R 20 E, S 12 on NW corners, with 4
notches on S and 2 notches on N
edges; dig pits 18x18x12 ins, in
each sec, 52 ft dist, and raise a
mound of earth 4 ft base, 2 ft
high, W of cor.

Ground, rolling,

Soil, gravelly; 2^d and 3^d rats.No timber, undergrowth, tobacco
and mesquite.

East boundary of Sec 1 S, R 20 E Continued.

chains

Dense undergrowth, 8.000 chs.

North bet sees 7 and 12.

Over level and rolling land.

Through dense undergrowth.

14.30 Dry wash, 30 chs wide, course N
westerly.

45.00 Set a redwood post, 3 ft long, 4 ins
sq, with marked stone, 24 ins in
the ground, for $\frac{1}{4}$ sec cor, marked
 $\frac{1}{4}$ S 12 on W and S 7 on E faces; dig
pits 18x18x12 ins, N and S of post,
3 ft dist, and raise a mound of
earth 3 $\frac{1}{2}$ ft base, 1 $\frac{1}{2}$ ft high, W of
cor.

68.90 Dry wash, 30 chs wide, course N
westerly.

8.000 Set a redwood post, 3 ft long, 4
ins sq, with marked stone, 24 ins

East boundary of P 21 S, R 20 E - Continued
 Chais

in the ground, for cor of sres 1, 6,
 7, and 12, marked

P 21 S, S 6 on NE,

R 21 E, S 7 on SE,

S 12 on SW and

R 20 E, S 1 on NW faces, with 5
 notches on S and 1 notch on N
 edges; dig pits 18x18x12 ins, in each
 sse, 5 1/2 ft. dist, and raise a mound
 of earth 4 ft base, 2 ft high, W
 of cor.

Land, level, and rolling.

Soil, gravelly; 2^d and 3^d rates.

No timber; undergrowth, twoto, mes-
 quite and sage.

Dense undergrowth, 8,000 chs.

North bet sres 1 and 6.

Over level and rolling land.

East boundary of Sec 1, R 20 E - Continued

Chocoma

Through dense undergrowth.

4000 Set a granite stone, 18 x 6 x 6 ins, 12 ins in the ground, for $\frac{1}{4}$ sec cor marked #1 on W and 6 on E faces, dig pits 18 x 18 x 12 ins, N and S of post, 3 ft dist, and raise a mound of earth 3 $\frac{1}{2}$ ft base, 1 $\frac{1}{2}$ ft high, W of cor.

7000 Road to Parabank, bears N easterly and S westerly.

8670 Intersect Fourth Standard Parallel South at a point 2.50 chs W of Standard $\frac{1}{4}$ sec cor of S 36, T 20 S, R 20 E, as heretofore described.

Set a rounded post, 3 ft long, 4 ins sq, with marked stone, 24 ins in the ground, for closing cor of S 21 S, R 20 and 21 E, marked

East boundary of P 21 S, R 20 E continued
 Chains

C. C. P 21 S on S.

R 21 E, S 6 on E, and

R 20 E, S 1 on W faces; with 6
 grooves on S, E and W faces; dig
 pits 30 x 24 x 12 ins, crosswise on
 each line, E and W 4 ft, and S
 of post, 8 ft dist, and gave a
 mound of earth, 5 ft base, 2 1/2 ft
 high, S of cor.

Level, level and rolling.

Soil, gravelly 2^d and 3^d rate.

No timber. Undergrowth, mesquite,
 teota and sage.

Drain undergrowth, 86.70 chs.

October 29, 1901.

General Description.

This line runs over level and rolling

East boundary of P. S. Row & Co. included,
land, and for the most part through
dense sage, broom and mesquite
undergrowth. There is good grazing
along portions of the line.

Philip Contzer
U. S. Deputy Surveyor.

West boundary of P. 1 S., R. 20 E.

Chama November 10, 1901. At 2^h 00^m p.m.,
 l.m.t., I set off $31^{\circ}37'$ on the lat.
 arc, $17^{\circ}9'$ on the decl. arc; and
 determined a true meridian with
 the solar, at the cor. of secs. 1, 6, 7
 and 12, on the W. leg. of the Sp., as
 heretofore described in subdivisions
 (see line bet secs. 6 and 7, subdivisions).

Phenac S 17 mil

Sunth, on a true line bet secs.
 7 and 12.

Over level and rolling land.

4.00 Day wash, 40 lbs. wide, course N.
 Easterly.

10.00 Level draw, course N. Easterly.

40.00 Set a granite stone, $18 \times 10 \times 6$ ins., 12
 ins. in the ground, for $\frac{1}{4}$ sec. cor.,
 marked $\frac{1}{4}$ 12 on N. and 7 on E.
 faces, and raise a mound of stone,

West boundary of S. 21, T. 16. 20 E. - Continued.

Chains

2 ft. base, 1 1/2 ft. high, W of cor. pits
infracturable.

52.31 Intersect N. by. of the Unachmed
Military Reservation, at a point from
which the N. E. cor. of the reservation
bears N. 82° 20' E. 105.00 chs. dist.

Set a granite stone, 18 x 12 x 12 ins., 12
ins. in the ground for closing cor.
of frac^{tion} 1/4 and 1/2 C. C. on N., 7 on E.,
12 on W., and 16 M. R. on S. faces:
dig pits 18 x 18 x 12 ins., E. and W. of
stone, 3 ft. dist., and raise a mound
of earth, 3 1/2 ft. base, 2 ft. high, N.
of cor.

Land, rolling and level.

Soil, gravelly; 2nd and 3rd rats.

No timber; underground, scattering
mesquite.

West boundary of S. 21 S., R. 20 E. - Continued.

Chains

- From the cor. of secs. 1, 6, 7 and 12,
 From
 Northern a true line bet secs 1
 and 6.
 Over level and rolling land.
- 10.00 Cross draw; bars N. Easterly, and
 ascend.
- 18.00 Top of ridge bars N. Easterly; descend
- 23.00 Foot, and enter Babocomari valley,
 course N. Easterly.
- 23.20 Bend, bars easterly and westerly.
- 30.00 Barb Wire fence. N. W. - S. E.
- 37.00 Babocomari creek, 50 lbs. width,
 course Easterly.
- 41.00 Set a granite stone, 18x8x5 ins., 12
 ins. in the ground, for $\frac{1}{4}$ sec. cor.
 marked $\frac{1}{4}$ 1 on N. and 6 on E. faces;
 dig pits 18x18x12 ins., N. and S. of
 post, 3 ft. dist., and raise a mound
 of earth, $3\frac{1}{2}$ ft. base, $1\frac{1}{2}$ ft. high;

Post boundary of S. 21 S., R. 20 E. - continued.

- Chain
- W. of cor.
- 46.30 Wire fence, bears N. N. Westerly and S. S. Easterly.
- 61.00 Grass Paddy, and ascend.
- 62.10 Wire fence, bears N, $81^{\circ}\frac{3}{4}'$ E., and S $81^{\circ}\frac{3}{4}'$ W.
- 62.83 Middle of single track of the Arizona and New Mexico Railroad, bears N, $81^{\circ}\frac{3}{4}'$ E., and S, $81^{\circ}\frac{3}{4}'$ W.
- 63.56 Wire fence, bears N, $81^{\circ}\frac{3}{4}'$ E., and S, $81^{\circ}\frac{3}{4}'$ W.
- 63.65 Telegraph line, bears N, $81^{\circ}\frac{3}{4}'$ E., and S, $81^{\circ}\frac{3}{4}'$ W.
- 68.00 Enter dense mesquite, undergrowth, bears N. Easterly and S. Westerly.
- 71.50 Intersect South boundary of the San Ignacio
- 86.90 from parcel S. Carter's bearing $70^{\circ}55'55''$ N 200 p. 200.
Intersect Smith's Standard Parallel South, at a point 60 lbs. W. of standard $\frac{1}{4}$ sec. cor. of sec. 36, as heretofore described.
Set a granite stone, $18 \times 8 \times 7$ ins., 12

West boundary of S. 21 S., R. 20 E. - Continued.

Chains

run in the ground, for closing cor.
of S. 21 S., R. 19 and 20 E., marked
C. C., on S., with 6 grooves on S., E.,
and W. faces; dig pits 30 x 24 x 12
ins., crosswise on each line, E. and W.
4 ft., and S. of stone, 8 ft. dist., and
raise a mound of earth, 5 ft. base,
2 1/2 ft. high, S. of cor.

Land, level, rolling and mountainous.
Soil, loam and gravelly; 4th and
6th rates.

No timber, undergrowth, mesquite.
Mountainous land or land covered
with dense undergrowth, 26.90 chs.

November 10, 1901.

 General Description.

This line runs over level and

West boundary of P. 21 S., R. 20 E. - Concluded.

Chain.

broken land. P. 20 S., R. 19 E., is level, rolling and broken. There is good grazing land in this Sp. Part of this Sp is covered by the Homestead Military Reservation and the San Ignacio del Babocomari land grant.

Philip Couzgen
U.S. Deputy Surveyor.

Table Latitudes, Departures & Closing Errors

Course	Dist.	Lat.		Dep.	
		N.	S.	E.	W.
N. Bdy.					
West	478.10				478.10
W. Bdy.					
South	139.21		139.21		
N 82° 20' E.	105.00	14.01		104.06	
S. 21° 24' E.	388.69		361.89	141.83	
S. Bdy.					
East	232.77			232.77	
E. Bdy.					
North	486.70	486.70			
Convergence					.44
		500.71	501.10	478.66	478.54
			500.71	478.54	
Errors of Lat.			.39	.12	Error
					of Departure

T. 21. P., R. 21, E.

BOOK 1579

51

Table Latitudes, Departures & Closing Errors

Course	Dist.	Lat.		Dep.	
		N.	S.	E.	W.
N. Bdy. West	477.83				477.83
S. Bdy. East	478.68			478.68	
E. Bdy. North	486.90	486.90			
W. Bdy. South	486.70		486.70		
Convergence					.44

486.90	486.70	478.68	478.27
486.70		478.27	
.20		.41	

Error of Lat.

Error of Dep.

oaths in Subdivisions of
Sp. 21 S, R. 20 C.

52

BOOK 1579

APPROVAL. BOOK 1579

OFFICE OF THE U.S. SURVEYOR GENERAL.

Phoenix, Arizona.

Feb'y 5-1902.

The foregoing field notes of the π
 survey of *S. E. hdys. of Tp. 21 S. R. 21 E.*
E. & W. hdys. Tp. 21 S. R. 20 E. ---
 executed by *Philip Contzen,* ---
 under his contract No. *87.* --- dated ---
Aug. 24 1901, having critically
 examined and the necessary corrections
 and explanations made, the said field
 notes, and the surveys they describe,
 are hereby approved.

Hugh H. Price

U.S. Sur. Gen. for Arizona.

5/22/03