

W. + N. BDY - T5SR22E  
W BDY - T6SR23E  
~~11.~~

1602

BOOK 1602

1602

4-671

---

FIELD NOTES  
GENERAL LAND OFFICE.

1602

1602

Field Notes  
of the survey of the  
West and North Boundaries  
of  
Township N° 5 South, Range N° 22  
East, and the  
West Boundary  
of  
Township N° 6 South, Range N° 23 East  
of the  
Gila and Salt River Base and Meridian  
in the  
Territory of Arizona,  
as surveyed by  
Philip Coutzen  
U. S. Deputy Surveyor  
under his Contract N° 53.  
Dated June 17, 1899  
Survey commenced March 31, 1900,  
Survey completed April 20, 1900.

BOOK 1602

INDEX

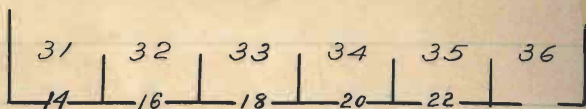

N. Bdy. of T.5.S. R.22.E

BOOK 1602

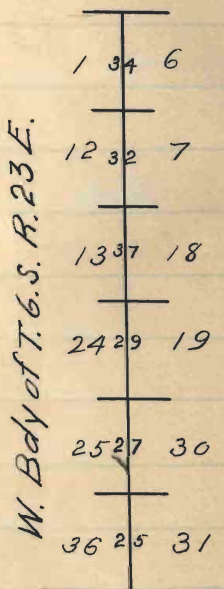
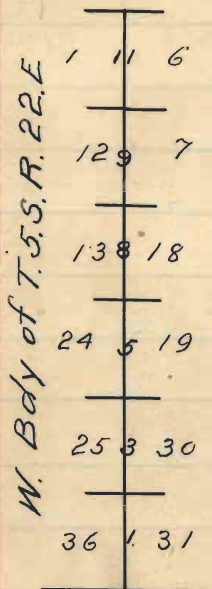

## W. Boundary of

chains

March 31, 1900.

North, bet. secs. 31 and 36

1300 Carry on 40 lks. wide, course Easterly;  
ascend

30.00 Top of high ridge bears NE + SW  
descend along W. slope

40.00 Set a sand stone 18x10x10 ins.  
12 ins. in the ground for  $\frac{1}{4}$  sec.  
cor. marked  $\frac{1}{4}$  S. 31 on W. face  
36. on E. face, and raised a  
mound of stones 2 $\frac{1}{2}$  ft base  
1 $\frac{1}{2}$  ft. high W. of cor. Pits  
impracticable.

73.00 Enter Black Rock Valley bears Easterly

74.00 old corral bears E. 2 chs. dist.

74.75 adobe ruin 1.50 chs E.

75.00 Well 2.80 chs. E.

77.00 Black Rock Creek 40 lks. wide,  
course Easterly

## T 5 S, R 22 E.

chains

- 79.80 Road from Spenazuma to  
St. Thomas, bears Easterly
- 80.00 Set a Granite Stone 18x8x6 ins.  
12 ins. in the ground marked  
with 1 notch on S, and 5 notches  
on N edges, from which  
an ash 10 ins. diam. bears  
N 81° E, 141 lks. dist. marked  
T 5 S, R 22 E, S. 30, B.T.
- an ash 6 ins. diam. bears  
S 75° E, 195½ lks. dist. marked  
T 5 S, R 22 E, S. 31, B.T.
- an ash 12 ins. diam. bears  
S 83° W, 208 lks. dist. marked  
T 5 S, R 21, E, S. 36 B.T.
- A Sycamore 8 ins. diam. bears  
N 45° W, 137 lks. dist. marked  
T 5 S, R 21 E, S. 25, B.T.
- Land mountainous and level

W. Boundary of  
chains

- Soil, gravelly & rocky, 3<sup>rd</sup> rate  
Timber, some sycamore  
ash and mesquite on Black  
Rock Creek  
Mountainous land 73, chs.
- 
- 1.20 North, bet. secs. 25 and 30,  
Black Rock Creek, 40 lks. wide  
course Easterly.
- 1.40 ascend
- 10.00 Top of ascent
- 40.00 Put a granite stone 18x12x6 ins.  
12 ins. in the ground for  $\frac{1}{4}$  sec.  
Cor. marked  $\frac{1}{4}$  S. 25 on W. face  
30 on E. face, and raised a  
mound of stone 2 $\frac{1}{2}$  ft. base  
1 $\frac{1}{2}$  ft. high, W. of cor. Pits  
impracticable.
- 41.50 Top of high ridge, bears E & W.

## T5S. R22E continued

chains

- 45.80 Gulch 10 lks. wide, course N. Easterly  
ascend
- 52.00 Top of spur bears E & W; descend
- 56.50 Gulch 6 lks. wide, course Easterly;  
ascend
- 59.10 Top of spur bears NE & SW; descend
- 68.40 Canyon 100 lks. wide, course N -  
Easterly; ascend
- 76.00 Top of ridge bears E & W; descend
- 80.00 Set a Granite Stone 18 x 12 x 6 ins.  
12 ins. in the ground for cor. of  
secs. 19, 24, 25 and 30, marked  
with 2 notches on S, and  
4 notches on N. edges, from  
which a Cedar 24 ins. diam.  
bears N 25° E, 138 lks. dist.  
marked T5S, R22E, S. 19, 13T.  
a Cedar 14 ins. diam. bears  
S 2 1/4° W, 119 lks. dist. marked

# W. Boundary of

chains

T5S, R21W, S.25, B.T. no  
 other trees within limits.  
 raised a mound of stones  
 2½ ft. base, 1½ ft. high, W. of cor.  
 Pits impracticable.

Land mountainous

Soil, gravelly, 2nd rate  
 Timber, some sycamores  
 and cedars.

Undergrowth yucca & nopal.

Mountainous Land 78.60 chs.

North, bet. secs. 19 and 24  
 over spurs, "N Easterly"

- 4.10 Gulch 100ks. wide, course N Easterly
- 6.00 Top of ridge, bears E & W; descend
- 11.00 Canyon 400ks. wide, course  
N Easterly.
- 33.00 Wash, 300ks. wide, course N, Westerly



## T5S. R22 E. continued

- |        |   |
|--------|---|
| chains |   |
| 3400   | Leave Cañon course $\frac{1}{2}$ Westerly   |
| 39,60  | Enter cañon course $\frac{1}{2}$ Westerly   |
| 40,00  | Set a sandstone $18 \times 12 \times 6$ ins.<br>12 ins. in the ground for $\frac{1}{4}$ sec.<br>cor. marked $\frac{1}{4}$ S. 24, on W. face<br>19 on E. face, dug pits.<br>$18 \times 18 \times 12$ in. N and S. of cor.<br>3 ft. dist. and raised a mound<br>of earth $3\frac{1}{2}$ ft. base, $1\frac{1}{2}$ ft. high<br>W. of cor. |
| 46,70  | Gulch $\frac{1}{2}$ m. wide, course $\frac{1}{2}$ Easterly  |
| 56,00  | Enter Goodwin Valley, bears Easterly  |
| 61,50  | Goodwin wash $100$ m. wide<br>course $\frac{1}{2}$ Easterly   |
| 72,50  | Road to Camp Goodwin bears $\frac{1}{2}$ Easterly   |
| 75,60  | Leave Goodwin Valley, bears Easterly  |
| 80,00  | Set a Granite Stone $18 \times 10 \times 6$ ins.<br>12 ins. in the ground for cor. of<br>secs. 13, 18, 19 and 24, marked  |

7  
 W. Boundary of  
 chains.

with 3 notches on S. and N. edges  
 from which a mesquite  
 7 ins. diam. bears  $S 78\frac{1}{2}^{\circ} E$ .  
 57 lks. dist. marked, T 5 S.  
 R 22 E. S. 19. 13. T.

A mesquite 8 ins. diam. bears  
 $S 18\frac{1}{2}^{\circ} W$ . 41 lks. dist. marked  
 T 5 S. R 21 E. S. 24. 13 T. No  
 other trees within limits  
 dug pits  $24 \times 24 \times 12$  ins. in  
 Secs. 13 and 18. 6 ft. dist. and  
 raised a mound of earth  
 4 ft base, 2 ft high, W. of cor.  
 Land mountainous and level  
 Soil, sandy & gravelly, 1<sup>st</sup> & 3<sup>rd</sup> rate  
 Timber, some cedars, sycamore  
 and mesquites.

Undergrowth, scattering mesquite  
 nopal & cactus

Mountainous Land 54,80 chs.

## T 5 S, R 22 E, continued

chains

North, bet. secs. 13 and 18

- 0.04 Wash 2 lks. wide, course Easterly.
- 3.75 Top of spur, bears E. and W.
- 6.00 Enter wash, course S. Easterly.
- 13.00 Leave wash, course S. Easterly.
- 21.50 Wash 100 lks. wide, course S. Easterly
- 37.00 Enter wash, 40 lks. wide course S Easterly
- 39.00 Leave wash, 40 lks. wide, course S. Easterly
- 40.00 Set a granite stone 18x8x6 ins.  
12 ins. in the ground for  $\frac{1}{4}$  sec. cor.  
marked  $\frac{1}{4}$  S. 13. on W. face.  
18 on E. face, and raised a  
mound of stones 2 $\frac{1}{2}$  ft base, 1 $\frac{1}{2}$   
ft. high N. of cor. Pits impracticable
- 45.00 Gulch 30 lks. wide, course S Easterly
- 64.00 Ridge bears NW and SE.
- 77.00 Wash 20 lks. wide, course, S. Easterly.
- 80.00 Set a granite stone, 18x12x10 ins.  
12 ins. in the ground for cor. of

W. Boundary of  
chains

secs. 7, 12, 13 and 18, marked  
with 4 notches on S. and 2  
notches on N. edges. dug  
pits 18x18x12 ins. in each  
sec.  $5\frac{1}{2}$  ft. dist. and raised  
a mound of earth 4 ft. base  
2 ft high. W. of cor.

Land mountainous.

Soil, gravelly, 3<sup>rd</sup> rate

No Timber.

Undergrowth, Tesota, Palo Verde  
Yucca and greasewood  
mountainous Land 80.00 cks.

March 31, 1900.

April 1st 1900.

North, bet. secs. 7 and 12

- |       |                                      |
|-------|--------------------------------------|
| 7.50  | Wash 100 lks. wide course S Easterly |
| 14.50 | Wash 10 lks. wide course S Easterly  |
| 26.00 | Ridge bears NW and SE                |
| 30.80 | Gulch 4 lks. wide, course, Easterly. |

## T5S. R22E. continued

chains

- 33.90 Ridge bears E and W.
- 37.00 Wash 8 lks. wide, course Easterly
- 40.00 Put a Granite stone 18x10x4 ins.  
12 ins. in the ground for  $\frac{1}{4}$  sec.  
cor. marked  $\frac{1}{4}$  S 12. on W. face  
7 on E face. dug pits 18x18x12  
ins. N and S of cor. 3 ft dist.  
and raised a mound of  
earth  $3\frac{1}{2}$  ft base  $1\frac{1}{2}$  ft. high  
W. of cor.
- 44.40 Wash 10 lks. wide, course S. Easterly
- 51.00 Ridge bears NW and SE
- 60.00 Wash 4 lks. wide, course Easterly
- 69.00 Ridge bears E and W.
- 74.00 Wash 20 lks. wide, course Easterly
- 80.00 Put a Sand Stone 18x10x8 ins.  
12 ins. in the ground for cor. of  
secs. 1, 6, 7 and 12, marked with  
1 notch on N. and 5 notches on S edge.

W Boundary of  
chains

and raised a mound of  
stone 2½ ft. base, 1½ ft high  
W. of cor. Pits impracticable  
Land Mountainous.

Soil, gravelly, 2<sup>nd</sup> & 3<sup>rd</sup> rate  
No timber

Undergrowth, greasewood,  
Yucca, Palo Verde & ocotillo.  
Mountainous Land 80. chs.

North, bet secs. 1 and 6.

- 3.00 Ridge bears E and W.  
20.00 Wash 70 yds. wide, course Easterly  
26.80 Ridge bears NW. and SE  
40.00 Set a granite stone 18x10x3  
ins. 12 ins. in the ground for  
¼ sec. cor. marked ¼ S. 1. on  
W. face. 6 on E face, dug pits  
18x18x12 ins. in N and S. 3 ft  
dist. and raised a mound

## T58. R 22 E. continued

chain

- of earth  $3\frac{1}{2}$  ft base,  $1\frac{1}{2}$  ft high  
W. of cor.
- 47.00 Ridge bears NW & SE
- 52.00 Wash 10 els. wide, course N. Easterly
- 52.40 Road to Turnbull Mines bears  
N. Easterly and S. Westerly
- 62.00 Ridge bears E and W.
- 72.00 Wash 10 els. wide, course Easterly
- 79.00 Ridge bears E and W.
- 80.00 Set a granite stone  $18 \times 8 \times 8$  ins.  
12 ins. in the ground for  
cor. to Tps. 4 and 5 S.  
Rs. 21 and 22 E. marked  
with 6 notches on each edge  
dug pits  $24 \times 24 \times 12$  ins. on each  
line N, E & W, 4 ft dist. and  
S of stone 8 ft. dist. and raised  
a mound of earth 5 ft base  
 $2\frac{1}{2}$  ft high S. of cor.

W. Boundary of T. 55. R. 22 E.  
chains.

Land mountainous

Soil gravelly, 3<sup>rd</sup> rate

No timber

Undergrowth, grease wood  
and Paloverde.

Mountainous Land 80. chs, Apr. 1. 1900.

General Description

The greatest portion of this line  
runs over mountainous land  
covered with scattering undergrowth.

There is some water at times in  
Black Rock creek and Goodwin wash

T. 55. R. 21 E. is principally mountainous  
however there are some good strips  
of land that could be cultivated,  
some settlers.

Philip Conger  
U. S. Dep. Sur.



## N. Boundary of T5S. R22E.

chains.

Owing to the shortage in  
the E. Bdy of this Township  
a random line will not come  
within 3 chs of interior closing  
corner of secs. 2 and 35.

Therefore I run  
East, bet. secs. 6 and 31,  
on a true line

2.40 Ridge bears NE and SW.

39.53 Set a granite stone 18x8x8 ins.  
12 ins. in the ground for  $\frac{1}{4}$  sec.  
cor. marked  $\frac{1}{4}$  S. 31 on N face  
6 on S. face, dug pits 18x18x12 ins  
E & W, 3 ft. dist, and raised a  
mound of earth  $3\frac{1}{2}$  ft. base  
 $1\frac{1}{2}$  ft high N. of cor.

44.40 Wash 10 lks. wide, course N. Easterly

50.00 Wash 20 lks. wide, course N. Easterly

54.00 Road to Mt Turnbull mines bears

## N. Boundary of

chains

NE and SW.

70.60 Road bears E and N.W.

76.00 Wash 70 lks, wide, course SE

79.53 Set a sand stone  $18 \times 8 \times 8$  ins.

12 ins. in the ground for cor. of

secs. 5, 6, 31 and 32 marked

with 5 notches on E and 1 notch

on W. edges, dig pits  $18 \times 18 \times 12$  ins.in each section,  $5\frac{1}{2}$  ft. distant

and raise a mound of earth

4 ft base, 2 ft high W. of cor.

Land mountainous.

Soil, gravelly, 2<sup>nd</sup> & 3<sup>rd</sup> rate

No timber.

Undergrowth, greasewood &amp; Yucca.

Mountainous land 79.53 chs.

East, bet. secs. 5 and 32.

In wash 20 lks, wide, course W

## T5S. R. 22 E continued

chains

- 19.00 Leave wash course N. Easterly
- 20.50 Road to Mt Turnbull mines bears NE and SW.
- 40.00 Set a Lime Stone  $18 \times 8 \times 6$  ins. 12 ins. in the ground for  $\frac{1}{4}$  sec. cor. marked  $\frac{1}{4}$  S. 32. on N face 5 on S. side. dug pits  $18 \times 18 \times 12$  ins. E & W. 3 ft. dist. and raised a mound of earth  $3\frac{1}{2}$  ft. base  $1\frac{1}{2}$  ft. high N of cor.
- 42.20 Wash 10 lbs. wide, course S. Easterly
- 45.00 Road to Mt Turnbull mines bears SE and NW.
- 49.60 Wash 10 lbs. wide course NE & SW.
- 71.50 Enter wash, course Easterly following line
- 79.70 Leave wash, course S. Easterly
- 80.00 Set a Sand Stone  $18 \times 8 \times 6$  ins. 12 ins. in the ground for cor.

N. Boundary of  
chains

of secs. 4, 5, 32 and 33, marked  
with 4 notches on E, and 2 notches  
on W. edges, from which,

a mesquite 6 ins. diam. bears  
 $N 82^{\circ} E$ , 48 lks, dist. marked

T 4 S, R 22 E, S. 33, B. T.

a mesquite 5 ins. diam. bears  
 $S 2\frac{1}{4}^{\circ} E$ , 89 $\frac{1}{2}$  lks, dist. marked

T 5 S, R 22 E, S. 4, B. T.

a mesquite 6 ins. diam. bears  
 $S 14\frac{3}{4}^{\circ} W$ , 232 lks, dist. marked

T 5 S, R 22 E, S. 5, B. T.

a mesquite 6 ins. diam. bears  
 $N 1^{\circ} W$ , 100 lks, dist. marked

T 4 S, R 22 E, S. 32, B. T.

Land rolling.

Soil, gravelly, 2<sup>nd</sup> & 3<sup>rd</sup> rate

Timber, some mesquite

Undergrowth, greasewood, mesquite  
and Tsota.

## T5S. R22E, continued

chains

East, bet. secs. 4 and 33  
over rolling land

40.00 Set a granite stone 18x10x10 ins  
12 ins. in the ground for  $\frac{1}{4}$   
sec. cor. marked 33 on N  
face 4 on S face, from which  
a mesquite 6 ins. diam. bears  
 $N49^{\circ}W$ , 240 lbs. dist. marked  
 $\frac{1}{4}S.33.B.T.$

A mesquite 6 ins. diam. bears  
 $S88\frac{1}{4}^{\circ}W$ , 243 lbs. dist. marked  
 $\frac{1}{4}S.4.B.T.$

48.30 Wash 10 lbs. wide, course S. Easterly

63.50 Wash 10 lbs. wide, course S. Easterly

78.90 Wash 100 lbs. wide, course S. Easterly

80.00 Set a sandstone 18x8x6 ins.  
12 ins. in the ground for cor of  
secs. 3, 4, 33 and 34 marked  
with 3 notches on E and W. edges

chains. N. Boundary of

from which

a mesquite 8 ins. diam. bears  
N 14° E. 58 lks. dist. marked

T 4 S, R 22 E, S. 34, B. T.

a mesquite 14 ins. diam. bears  
S 43 3/4° E. 33 lks. dist. marked

T 5 S, R 22 E, S. 3, B. T.

a mesquite 10 ins. diam. bears  
S 23 1/2° W. 57 lks. dist. marked

T 5 S, R 22 E, S 4, B. T.

a mesquite 8 ins. diam. bears  
N 74 1/2° W. 81 lks. dist. marked

T 4 S, R 22 E, S. 33, B. T.

Land rolling.

Soil, gravelly, 2<sup>nd</sup> & 3<sup>rd</sup> rate

Timber, some mesquite

Undergrowth, greasewood, and  
mesquite

T5S, R22E, continued

chain

East, bet. secs. 3 and 34  
over broken mesa

37.00 Enter dense undergrowth

40.00 Det a sand stone 18x10x5 ins.  
12 ins. in the ground for  $\frac{1}{4}$  sec.  
cor. marked  $\frac{1}{4}$  S 34 on N face  
3 on S face, from which  
a Tesota 7 ins. diam. bears  
N76 $^{\circ}$ 4'W, 40 lks. dist. marked  
 $\frac{1}{4}$  S. 34. B.T.a Tesota 10 ins. diam. bears  
S66 $^{\circ}$ E, 57 lks. dist. marked  
 $\frac{1}{4}$  S. 3. B.T.

43.00 Gulch 10 lks. wide, course SW

48.00 Enter Goodwin Valley, course N Easterly

57.25 Goodwin Wash 100 lks wide course N Easterly

62.00 Wash 100 lks. wide course N Easterly

65.50 Wash 100 lks. wide, course N Easterly

80.00 Det a Granite stone 18x8x8 ins.

chains N. Boundary of

12 ins. in the ground for  
cor. of secs. 2, 3, 34 and 35,  
marked with 4 notches on  
W. and 2 notches on E. edges  
from which,

A Tescota 7 ins. diam. bears  
 $N 75\frac{1}{4}^{\circ} E$ , 174 lks. dist. marked  
T 4 S, R 22 E S. 35, 13, T.

A Tescota 6 ins. diam. bears  
 $S 51\frac{3}{4}^{\circ} E$ , 72 lks. dist. marked  
T 5 S, R 22 E, S. 2, 13, T.

A mesquite 8 ins. diam. bears  
 $S 51\frac{1}{2}^{\circ} W$ , 200 lks. dist. marked  
T 5 S, R 22 E, S. 3, 13, T.

A mesquite 12 ins. diam. bears  
 $N 30\frac{1}{2}^{\circ} W$ , 73 lks. dist. marked  
T 4 S, R 22 E, S. 34, 13, T.

Land level and broken

Soil, sandy and gravelly 1<sup>st</sup> & 3<sup>rd</sup> rate



T5S, R 22E, continued

chains

Timber, some mesquite  
undergrowth, Tesota and  
mesquite

Dense undergrowth 43, chs.

April 2, 1900.

East, bet. secs. 2 and 35  
over level land, through  
dense undergrowth

10.00 Leave dense undergrowth  
and ascend

12.00 Top of ridge bears N 4 S; descend

16.00 Enter level land

32.80 Road to Camp Goodwin bears  
NE and SW.

40.00 Set a granite stone 18x12x8 ins,  
12 ins. in the ground for  $\frac{1}{4}$  sec. cor.  
marked  $\frac{1}{4}$  S, 35, on N face  
2. on S. face, dug pits

N. Boundary of  
chains

18x18x12 ins. E and W. 3 ft  
dist. and raised a mound  
of earth 3½ ft. base, 1½ ft  
high. N of cor.

5280 Wash 40 chs. wide, course N. Easterly

5991 Intersect W. line of Camp  
Goodwin military Reservation

(abandoned) 3, 20 chs. S. of old

4. M. cor. of E. 3 dy. S.C. 1, R. and  
79.08 chs. N of 5. M. cor. of E. Bay, S.C. 1, R.  
and 4, 02 chs. N of interior

closing cor. to secs. 2, and 35.

said corners are properly  
marked and witnessed as  
described by the Surveyor General.

Set a Granite Stone 18x12x6 ins.

12 ins. in the ground for closing  
cor. of secs. 2 and 35. marked

C. G. M. R. on E face, 2, on S. face

C. C. on W. face and 35 on N face.

T. 5. S. R. 22. E.

chains

dug pits N and S, 3 ft.  
dist. and W. of cor. 7 ft. dist.  
and raised a mound of earth  
4 ft. base, 2 ft. high, W. of cor.  
Land level

Soil, sandy, 1<sup>st</sup> & 2<sup>nd</sup> rate  
Timber, some mesquite  
Undergrowth, mesquite & *Lesota*  
Dense undergrowth, 10. chs.

April 3, 1900.

### General Description

This line runs over level, broken  
and some mountainous land  
covered with undergrowth and  
some good mesquite timber, on  
the easterly end.

T. 4 S. R. 22 E. is mostly rolling. There  
is some good land in the SE. portion  
no settlers

Philip Conner  
U. S. Deputy Surveyor

W. Boundary of  
chains.

april 20, 1900. at 7.30 am. l.m.  
I set off  $32^{\circ} 50'$  on the lat. arc;  
 $11^{\circ} 29' N$  on the decl. arc; and  
determine a true meridian at  
the cor. of T<sub>4</sub>. 5 S. R<sub>s</sub>. 22 and  
23 E.

Thence I run  
North, bet. sec. 31 and 36  
over level land

40.00 Set a granite stone  $18 \times 10 \times 4$  ins  
12 ins. in the ground for "4  
sec. cor. marked "4 S. 31 on W  
face, 36 on E. face.

from which

A mesquite 8 ins. diam. bears  
 $N 73^{\circ} 4' E$ ,  $163^{\frac{1}{2}}$  lks. dist. marked  
"4 S. 31. 13. T.

A mesquite 10 ins. diam. bears  
 $S. 55^{\circ} 4' W$ ,  $219$  lks. dist. marked

## T. 6 S. R. 23 E.

chains

 $\frac{1}{4}$ S. 36. B.T.

8000 Set a Quartzite stone  $18 \times 8 \times 8$  ins.  
12 ins. in the ground for cor.  
of secs. 25, 30, 31 and 36.

marked with 1 notch on S.  
and 5 notches on N edges  
from which

a mesquite 4 ins. diam.  
bears  $N 20^\circ E$ , 91 lks. dist.  
marked T 6 S. R 23 E. S. 30 B.T.

a mesquite 6 ins. diam. bears  
 $S 61\frac{1}{4}^\circ E$  229 lks. dist. marked  
T 6 S. R 23 E. S. 31. B.T.

a mesquite 8 ins. diam. bears  
 $S 5\frac{1}{2}^\circ W$ , 156 $\frac{1}{2}$  lks. dist. marked  
T 6 S. R 22 E. S. 36 B.T.

a mesquite 6 ins. diam. bears  
 $N 42\frac{3}{4}^\circ W$ , 307 lks. dist. marked  
T 6 S. R 22 E. S. 25. B.T.

## W. Boundary of

chains

Land level

Soil, gravelly, 2<sup>nd</sup> rate

Timber, scrub mesquite

Undergrowth, scrub mesquite

North, bet. secs. 25 and 30

40.00

Set a Granite stone 18x8x6 ins  
12 ins. in the ground for 1/4sec. cor. marked 1/4 S, 25, on W  
face, 30 on E face

from which

a mesquite 8 ins. diam. bears

N 81 3/4° E, 53 lks. dist. marked  
1/4 S, 30, B.T.

a mesquite 8 ins. diam. bears

S 49 3/4° W, 106 lks. dist. marked  
1/4 S, 25, B.T.

80.00

Set a Granite stone 18x8x6 ins  
12 ins. in the ground for cor.

## T6S, R23E, continued

chains

of secs. 19, 24, 25 and 30  
marked with 2 notches on  
S and 4 notches on N edges  
from which

a mesquite 8 ins. diam. bears  
N78 $\frac{1}{4}$ ° E, 116 lks. dist. marked  
T6S, R23E, S19, 13T.

a mesquite 8 ins. diam. bears  
S37 $\frac{3}{4}$ ° E, 60 lks. dist. marked  
T6S, R23E, S30, 13T.

a mesquite 5 ins. diam. bears  
S10° W, 10 $\frac{1}{2}$  lks. dist. marked  
T6S, R22E, S25, 13T.

a mesquite 8 ins. diam. bears  
N12 $\frac{1}{2}$ ° W, 82 lks. dist. marked  
T6S, R22E, S24, 13T.

Land level

Soil, gravelly, 2nd rate

Timbr. scrub mesquite

undergrowth, scrub mesquite

## W. Boundary of

chains

- North, bet. secs. 19 and 24
- 0.50 Wash 10 lks, wide course Easterly
- 18.90 Wash 10 lks, wide course Easterly
- 24.00 Road to St Thomas bears NE
- 29.40 Wash 10 lks, wide course Easterly
- 40.00 Put a granite stone 18x10x5 ins,  
12 ins. in the ground for  $\frac{1}{4}$  sec. cor.  
marked  $\frac{1}{4}$  S, 24 on W. face, 19 on E face  
from which  
a mesquite 6 ins. diam. bears  
N  $57\frac{1}{4}^{\circ}$  E, 32 lks, dist. marked  
 $\frac{1}{4}$  S, 19, B.T.  
a mesquite 6 ins. diam. bears  
N  $26^{\circ}$  W, 32 lks dist. marked  
 $\frac{1}{4}$  S, 24, B.T.
- 41.50 Wash 10 lks, wide, course N, Easterly
- 50.00 Wash 10 lks, wide, course Easterly
- 77.00 Wash 10 lks, wide, course Easterly
- 80.00 Put a granite stone 18x10x3 ins.



## T 6S, R 23 E. continued

Chains

12 ins. in the ground for cor.  
of secs. 13, 18, 19 and 24.

marked with 3 notches on  
N and S. edges, from which  
a mesquite 6 ins diam. bears  
N  $12\frac{3}{4}^{\circ}$  E. 163 lks. dist.

marked T 6S, R 23 E S. 18, 13 T.

a mesquite 6 ins diam. bears  
S.  $60^{\circ}$  E. 130 lks. dist. marked

T 6S, R. 23 E. S. 19 13 T.

a mesquite 12 ins. diam.  
bears S  $72\frac{1}{2}^{\circ}$  W. 147  $\frac{1}{2}$  lks. dist.

marked T 6S, R 22 E. S. 24 13 T.

a mesquite diam. bears  
N  $3\frac{1}{4}^{\circ}$  W. 129 lks. dist. marked

T 6S, R 22 E. S. 13, 13 T.

Sand level

Soil, gravelly, 2<sup>nd</sup> rate

Timber, scrub mesquite

Undergrowth, grasswood & sc. mesquite

## W. Boundary of

chains

North, bet. secs. 13 and 18.  
over level land

40.00 Set a granite stone  $18 \times 8 \times 8$  ins.  
12 ins. in the ground for  $\frac{1}{4}$   
sec. cor. marked  $\frac{1}{4}$  S, 13, on  
W face, 18 on E face  
from which

a mesquite 6 ins. diam. bears  
 $N 25\frac{1}{2}^{\circ} W$ , 60 lks. dist. marked  
 $\frac{1}{4}$  S, 13, B.T.

A mesquite 6 ins. diam. bears  
 $N 89^{\circ} E$ , 106 lks. dist. marked  
 $\frac{1}{4}$  S, 18, B.T.

80.00 Set a granite stone  $18 \times 12 \times 4$  ins.  
12 ins. in the ground for cor.  
of secs. 7, 12, 13 and 18, marked  
with 4 notches on S and 2 notches  
on N edges. from which  
a mesquite 6 ins. diam. bears

## T6S, R23E, continued

chains

N 23 1/2° E, 219 lks, dist, marked

T6S, R23E, S, 7, B.T.

a mesquite 10 ins. diam, bears

S 85 1/4° E, 123 lks dist, marked

T6S, R23E, S, 18, B.T.

a mesquite 10 ins. diam,

bears, S 26° W, 93 lks, dist,

marked T6S, R22E, S, 13, B.T.

a mesquite 6 ins. diam, bears

N 30 1/2° W, 33 lks, dist, marked

T6S, R22E, S, 12, B.T.

Land, Level

Soil, gravelly and rati

Timber, scrub mesquite

Undergrowth,

North, bet. secs. 7 and 12

over level land

40.00 Bet a granite stone 18x8x6 ins.

chains

## W. Boundary of

12 ins. in the ground for  $\frac{1}{4}$  sec. cor. marked  $\frac{1}{4}$  S. 12 on W. face, 7 on E face from which

a mesquite 5 ins. diam bears N  $22\frac{3}{4}^{\circ}$  W. 79 lks. dist. marked  $\frac{1}{4}$  S. 12, 13, T.

a mesquite 8 ins. diam. bears S  $86\frac{1}{4}^{\circ}$  E. 79 lks. dist. marked  $\frac{1}{4}$  S. 7, 13, T.

80.00

Set a Granite stone  $18 \times 8 \times 5$  ins 12 ins. in the ground for cor. of secs. 1, 6, 7 and 12, marked with 5 notches on S, and 1 notch on N edges. from which a mesquite 6 ins. diam. bears S  $52^{\circ}$  W. 46 lks. dist. marked. T 6 S. R 22 E. S. 12, 13, T.

## T6S, R22E, continued

chains

a mesquite 3 ins. diam.  
 bears, N  $72\frac{1}{4}^{\circ}$  W, 80 $\frac{1}{2}$  lbs. dist.  
 marked T6S, R22E, S. 1.  
 B. T. no other trees within  
 limits. dug pits 24x24x12 ins  
 in secs. 6 and 7. 5 $\frac{1}{2}$  ft dist.  
 and raised a mound of  
 earth 4 ft base 2 ft high  
 N. of cor.

Sand level

Soil, gravelly, 2<sup>nd</sup> rate

Timber, scrub mesquite

Undergrowth, scrub mesquite

North bet. secs. 1 and 6

- 8.50 Wash, 10 lbs. wide, course N Easterly  
 32.50 Wash, 8 lbs. wide course N Easterly  
 40.00 Put a granite stone 18x8x5 ins.  
 12 ins. in the ground for  $\frac{1}{4}$  sec.

## W. Boundary of

chains

cor. marked  $\frac{1}{4}$  S. 1. on W. face  
6 on E. face, from which  
a mesquite 10 ins. diam. bears  
S  $27\frac{1}{2}^{\circ}$  E. 198 lks. dist. marked  
 $\frac{1}{4}$  S. 6. B.T.

a mesquite 10 ins. diam.  
bears S  $5^{\circ}$  W. 254 lks. dist.  
marked  $\frac{1}{4}$  S. 1. B.T.

44.40 Wash 20 lks. wide, course N. Easterly

54.50 Wash, 20 lks. wide, course N. Easterly

59.00 Wash 20 lks. wide, course N. Easterly

75.50 Intersect 1<sup>st</sup> Standard Parallel

South 25.85 chs. W. of S.C. to  
Tps. 5 S. Rs. 22 and 23 E.

Set a Granite stone 24 x 12 x 6  
ins. 18 ins. in the ground for  
closing cor. to Tps. 6 S. Rs. 22  
and 23 E. marked C.C. on  
S. with 6 grooves on S. E. and W.

T6S, R. 23E. concluded

chains

faces, from which  
 A mesquite 6 ins. diam. bears  
 S 50 $\frac{1}{2}$ ° E, 99 lks. dist. marked  
 T6S, R 23E, S. 6, B.T.

A mesquite 6 ins. diam. bears  
 S 24 $\frac{3}{4}$ ° W, 39 lks. dist. marked  
 T6S, R 22, E, S. 1, B.T.

Land use

Soil, ~~sandy~~, 2<sup>nd</sup> rate  
 Timber, scrub mesquite,  
 Undergrowth grasswood and  
 mesquite.

April 20, 1900.

General Description

This line runs over level  
 land covered with scrub  
 mesquite timber and  
 undergrowth. The soil

is mostly sandy and  
gravelly loam of 2<sup>nd</sup> and  
3<sup>rd</sup> rate capable of produc-  
ing crops with irrigation  
The East half of T.6S. R.22E.  
is mostly level land with  
good soil.

Philip Cortzen  
U. S. Deputy Surveyor.



# BOUNDARIES OF T.S.S. R. 22 E.

*Latitudes, Departures and Closing errors*

Line designated	True Bearing	Distance <i>chs</i>	Latitudes		Departures	
			N	S	E	W
187 Standard Parallel South	West	480.00	480.00	---	---	480.00
West Boundary	North	480.00	---	---	---	---
North	East	379.91	---	206.82	379.91	---
East	South	206.82	98.41	---	98.41	---
	N 45° E	139.18	---	50.50	.15	---
	S 0° 10' E	50.50	---	80.00	.48	---
	S 0° 21' E	80.00	---	80.00	.43	---
	S 0° 17' E	80.00	---	2.35	.11	---
	S 0° 17' E	2.35	---	77.65	---	---
	S 0° 05' E	77.65	---	40.76	.74	---
	South	40.76	---	39.24	---	---
	S 1° 05' E	39.24	---	---	.47	---
Convergency	---	---	578.41	577.32	480.70	480.00
Totals	---	---	577.32	---	480.00	---
Error in Lat.	---	---	1.09	Error in Dep 0.70	---	---

Latitudes Departures

Line designated	True Bearing
West Boundary -----	North
1 <sup>st</sup> Standard Parallel South -----	East
	589° 56' E
	589° 46' E
	589° 50' E
	589° 53' E
	589° 48' E
	589° 50' E
East Boundary -----	50° 05' W
South " -----	589° 54' W
	589° 57' W
	589° 40' W
	589° 57' W
	West
	589° 00' W
	N 86° 30' W
	N 86° 30' W
	N 89° 05' W
Convergency -----	
TOTALS -----	
Error in Lat. -----	

and closing errors

Distance	Latitudes		Departures	
	N	S	E	W
chs.				
475.50	475.50		25.85	
25.85			79.31	
79.31		.09		
79.08		.32		
79.35		.07		
79.35		.16		
79.18		.27		
53.87		.15		
476.44		476.44		0.67
80.00		.13		80.
80.00		.06		80.
80.00		.46		80.
80.00		.06		80
37.50				37.50
40.03		.69		40.03
2.47	0.15			2.46
37.79	2.30			37.72
38.62	.51			38.61
			0.47	
-----	478.46	478.90	476.46	476.99
		478.46		476.46

0.44 Error in Dep. 0.53

U. S. Surveyor-General's Office,  
Tucson, Arizona, Oct. 27, 1900.

The foregoing field notes of the sur-  
vey of *Ward H. Boundary* ..  
*T. 5 S. R. 22 E. and 20* ..  
*Boundary 6 S. T. 23 E.* ..  
of the G. & S. R. B. & M., Arizona, ex-  
ecuted by

PHILIP CONTZEN, D.S.,  
under his contract No. 53, dated June 1  
17, 1899, having been critically exam-  
ined, and the necessary corrections  
and explanations made, the said field  
notes and the surveys they describe  
are hereby approved.

*George Christ*  
U. S. Surveyor-General.