

1709

West and South Boundaries

T. 28 N. R 3 W

27 N R 3 W

GIRARD, D.S.

→ and ←

Fractional West bdy of T. 27 N R 3 W.

4-671

BOOK 1709

1709

FIELD NOTES
GENERAL LAND OFFICE.

1709

- Field Notes. -

Of the Survey of the West and South Boundaries of Township No 28 North Range No 3 W. and the West Boundary of fractional Township No 27 N. R. 3 West of the Gila and Salt River Base and Meridian. In the Territory of Arizona, as surveyed by James B. Girard U.S. Deputy Surveyor, Under his contract No 74 Dated June 13th 1900.

Survey commenced Sept 26, 1900

Survey completed Sept 28th 1900.

Names and duties of assistants.

John A. Randall	Chairman
W ^m N Lockridge	Chairman
Amos Adams	Moundman
E. D. Stafford	Moundman
Chas Wolf	Axman
Russell Stone	Axman
P. W. Lattimer	Flagman.

BOOK 1709

Index

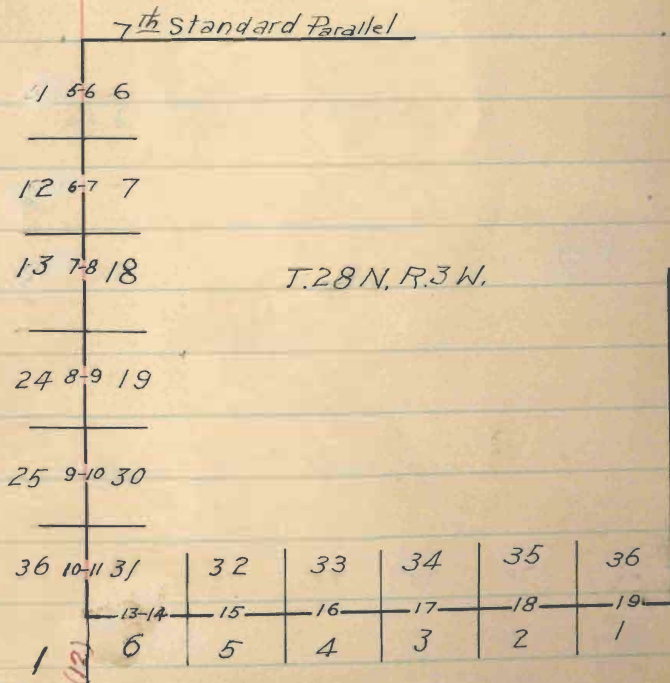

Trac. T27N R3W Page 12

West Boundary of Tp 28 N R 3 W.

BOOK 1709

At 6.24 chains East of Standard Corner of Tp 29 N Rd 3 + 4 West, which is a limestone 10 x 5 ins 8 ins above ground marked and witnessed as described by the Surveyor General. I establish the closing corner of Tp 28 N R 3 + 4. W. which is a limestone 24 x 12 x 6 ins 15 ins in the ground marked C.C. 28 N on S 3 W on E, 4 W. on W face, with 6 notches on S. E. + W edges, Dig pits 30 x 24 x 12 ins crosswise on each line E. + W, 4 ft and South of stone 8 ft dist and raised a mound of earth 5 ft base 2 1/2 ft high South of corner.

Sept 25th at 7^h —^m P.M. 1 m.t.

West Boundary of $\frac{1}{2}$ 28 N R 3 W

Chains.

BOOK 1709

I observe Polaris when at its greatest Eastern elongation. In accordance with Manual of Instructions, and mark a point in line thus determined on a rock 5.00 chains N. of Instrument

Sept 25th 1900

Sept 26th 1900 at 8^h 30^m A.M. P.M.T. I set off $1^{\circ} 15'$ on my decl arc, and $54^{\circ} 11'$ for my co latitude and determine a true meridian with the solar. and mark a point in line thus determined, by driving a tack in plug set 5.00 chains North of my instrument. I lay off the azimuth of Polaris $1^{\circ} 31'$ to W and find that the line coincides with my meridian.

Chairs.

Variation of the Needle when
induced by table on page
of Manual
109, at the closing corner of
Sp. 28 N. R. 3 + 4 W. is
 $14^{\circ} 39' E.$

Hence I run

South, between Sine 1 + 6
through dense undergrowth

40.00 Set a limestone $18 \times 8 \times 5$ ins

12 ins in the ground for $\frac{1}{4}$ cor.

cor. marked $\frac{1}{4}$ on W face. Dig

pits $18 \times 18 \times 12$ ins N & S. of cor 3 ft

dial and raise a mound of earth

$3\frac{1}{2}$ ft base $1\frac{1}{2}$ ft high W of cor.

80.00 Set a limestone $18 \times 10 \times 3$ ins

12 ins in the ground for cor of sec

1.6.7 + 12 marked with 5 notches

on S, and 1 notch on N edge.

Dig pits $18 \times 18 \times 12$ ins in rock

sec $5\frac{1}{2}$ ft dial and raise a

mound of earth 4 ft base 2 ft

6 West Boundary of Twp. 28 N. R. 3 W.

chains.

BOOK 1709

High W of corner.

Land rolling

Soil gravelly 3rd rate.

No Timber.

Dense Undergrowth Chis brush

80.00 chains.

South. between secs 7 & 12
through dense undergrowth.

40.00 Set a limestone 18 x 5 x 4 ins

12 ins in the ground for $\frac{1}{4}$ sec

corner. marked $\frac{1}{4}$ on W face

dig pits 18 x 18 x 12 ins N & S

of cor 3 ft dist and raise a

mound of earth 3 $\frac{1}{2}$ ft base

1 $\frac{1}{2}$ high W of corner.

80.00 Set a limestone 18 x 6 x 3 ins

12 ins in the ground for cor

of secs 7, 12, 13 & 18. marked

with 4 notches on S and 2

notches on N edge

West Boundary of $\frac{1}{2}$ 28 N. R. 3 W.

7

Chains.

BOOK 1709

Dig pits 18 X 18 X 12 ins in each sec. 5½ ft dist, and raise a mound of earth 4 ft base 2 ft high N of corner.

Land rolling.

Soil gravelly 3rd rate.

No Timber.

Dense undergrowth this tract 80 chains.

South, between secs 13 & 18
through dense undergrowth.

40.00 Set a limestone 22 X 5 X 4 ins

12 ins in the ground for $\frac{1}{4}$ sec cor marked $\frac{1}{4}$ on N face.

dig pits 18 X 18 X 12 ins N & S.

and 3 ft dist and raised a mound of earth 3½ ft base

1½ ft high N. of corner.

80 00 Set a limestone 20 X 7 X 4 ins

12 ins in the ground for cor

of secs. 13, 18, 19 & 24. marked

with 3 notches on N. & S. edges

Chains.

Dig pits 18 x 18 x 12 ins in each
sec 5 1/2 ft dist and raised
a mound of earth 4 ft base
2 ft high N of corner.

Land rolling

Soil gravelly 3rd rate.

No Timber.

Dense undergrowth Chico brush

80.00 Chains.

South between sec 19 + 24
through dense undergrowth.
40.00 Set a limestone 20 x 7 x 4 ins

12 ins in the ground for 1/4 sec
corner. marked 1/4 on N face

Dig pits 18 x 18 x 12 ins N. & S.
of cor and 3 ft dist. raised a
mound of earth 3 1/2 ft base
1 1/2 ft high N of cor.

80.00 Set a limestone 20 x 10 x 3 ins
12 ins in the ground for cor.

West Boundary of P. 28 N, R. 3 W.

BOOK 1709

Chains

of sec 19, 25, 24 + 30,
 marked with 2 notches on
 S and 4 notches on N edge.
 Dig pits 18 x 18 x 12 ins in each
 sec 5 1/2 ft dist and raised
 a mound of earth 4 ft base
 2 ft high N of corner.
 Land rolling.
 Soil gravelly 3rd rate
 No Timber.
 Dense undergrowth chics brush
 80.00 chains

South, between sec 25 + 30
~~through dense undergrowth~~
 40.00 ft a limestone 20 x 8 x 3 ins
 10 ins in the ground for 1/4 sec
 corner marked 1/4 on N face
 Dig pits 18 x 18 x 12 ins N.E. of
 cor 3 ft dist. and raise a mound
 of earth 3 1/2 ft base 1 1/2 ft high

West Boundary of P 28 N. R. 34 W.

BOOK 1709

Chains.

N of corner.

80.00 Set a limestone $20 \times 14 \times 3$ ins
12 ins in the ground for cor of
secs 25, 30, 31 & 36. marked
with 1 notch on S, and 5
notches on N edges. Dig
pits $18 \times 18 \times 12$ ins in each
sec., $5\frac{1}{2}$ ft. dist and raised
a mound of earth 4 ft base
2 ft high N of corner.

Land rolling.

Soil, gravelly 3rd rate

No Timber.

Dense undergrowth chico brush
80.00 chains

South between secs. 31 & 36
through dense undergrowth
40.00 Set a limestone $20 \times 8 \times 6$ ins
12 ins in ground for $\frac{1}{4}$ sec cor
marked $\frac{1}{4}$ on N face

West Boundary of Sp. 28 N. R. 3 W.

BOOK 1709

11

Dig pits 18x18x12 ins N. & S. of cor
3 ft dist and raise a mound of
earth 3 1/2 ft base 1 1/2 ft high
N of corner.

80.00

Set a limestone 30x8x4 ins,
20 ins in the ground for Cor of
Spa. 27 & 28 N. Rs 3 & 4. W.
marked, 28 N on N.E. 37 W on
S.E. 27 N on S.W. & 4 W on N.W.
facia with 6 notches on S.N.
E. & W. edges, dig pits 24x24
x12 ins on each line N.E. & W
4 ft, and south of stone 8 ft
dist, and raised a mound of
earth 5 ft base 2 1/2 ft high
S of corner.

Land rolling.

Soil gravelly 3rd rate

No Timber.

Dense undergrowth chis brush 80 chas.

¹² West Boundary of tract Tp. 27 N., R. 3 W.

BOOK 1709

Chains.

South, between secs 1 + 6.
through dense undergrowth
40.00 Set a limestone 20 x 8 x 3 ins
12 ins in the ground for $\frac{1}{4}$ sec
corner, marked $\frac{1}{4}$ on N face
dig pits 18 x 18 x 12 ins N. + S. of
cor 3 ft dist and raise a
mound of earth $3\frac{1}{2}$ ft base $1\frac{1}{2}$
ft high N of corner.

80.00 Set a limestone 20 x 8 x 4 ins, 12 ins
in the ground for cor of secs 1, 6, 7 + 12 marked
with 5 notches on S and 1 notch on N
edges. Dig pits 18 x 18 x 12 ins in each sec
 $5\frac{1}{2}$ ft dist. and raise a mound of earth
4 ft base 2 ft high N of corner.

Land rolling,

Soil gravelly 3rd rate.

No Timber.

Dense undergrowth chief brush

80.00 Chains.

Sept 27th 1900

South Boundary of Tps 28 N, R. 3 W.

BOOK 1709

Chains.

From the corner of Tps 27 + 28 North R's 2 + 3 West heretofore described Iron West on a random line along the South boundary of Tps 28 N R. 3 W. setting temporary quarter and section corners at intervals of 40 chains and at 478, 43 chains - intersect line between R's 3 + 4 W. 33 lines N of the corner of Tps 27 + 28 N R's 3 + 4 W. heretofore described, the falling answer to a correction of two minutes or 5 1/2 lines S. per mile. Counting from S.E. Cor of Tp. Therefor Iron N 89° 58' E between sec 2 + 31 through dense undergrowth.

38, 43

Set a limestone 18 X 8 X 4 ins.
10 ins in ground for 1/4 sec Cor.

South Boundary of T₂₈ N_R 3₄ W.

Chains,

BOOK 1709

marked 4 on N face, dig pits 18x18x12 ins E + N of cor 3ft dist and raised a mound of earth 3 1/2 ft base 1 1/2 ft high N. of corner.

78.43

Set a limestone 18x8x4 ins 10 ins in the ground for cor of sec 5, 6, 31 + 32 marked with 5 notches on E and one notch on N edge. Dig pits 18x18x12 ins in each sec 5 1/2 ft dist and raise a mound of earth 4 ft base 2 ft high N. of corner.

Land rolling.

Soil gravelly 3rd rate.

No Timber.

Dense undergrowth ches brush

78.43 chains,

15

South Boundary of Sp. 28 N. R. 3 W.

Chains

BOOK 1709

N 89° 58' E between secs 5 + 32
through dense undergrowth

40.00 Set a limestone 18x10x4 ins
12 ins in the ground for 1/4 sec. cor.
marked 1/4 on N face. Dig pits
18x18x12 ins E + W of cor 3 ft
dist and raise a mound of earth
3 1/2 ft base 1 1/2 ft high N. of cor.

80.00 Set a limestone 16x8x8 ins, 10 ins
in the ground for cor of secs 4, 5,
32 + 33, marked with 4 notches
on E + 2 notches on W edge,
raised a mound of stone 2 ft base
1 1/2 ft high W. of corner Pits
impracticable -

Land rolling

Soil gravelly 3rd note.

No Timber

Dense undergrowth chis brush
80.00 chains.

South Boundary of Sp. 28 N. R 3 W,
Chains.

- N. $89^{\circ}58'E$. Between Secs 4 + 33
through dense undergrowth
36.57 Cross road Course $S 20^{\circ} E$.
- 40.00 Set a limestone $20 \times 9 \times 7$ ins.
12 ins in the ground for $\frac{1}{4}$ sec cor
marked $\frac{1}{4}$ in N face. Dig pits
 $18 \times 18 \times 12$ ins E. & W. of cor 3 ft dist
and raise a mound of earth $3\frac{1}{2}$
ft base $1\frac{1}{2}$ ft high N of corner.
- 80.00 Set a limestone $26 \times 12 \times 8$ ins.
14 ins in the ground for cor of
secs, 3, 4, 33 + 34 marked with
3 notches on E. & W. edge.
Dig pits $18 \times 18 \times 12$ ins in each
sec $5\frac{1}{2}$ ft dist and raise a
mound of earth 4 ft base 2 ft
high W of cor.

Land rolling.

Soil gravelly 3rd rate.

No Timber.

Dense undergrowth chio brush 80.00 chains

South Boundary of Sp. 28 N. R. 3 W.

Chains.

N 89° 58' E between Secs 3 + 34
through dense undergrowth.

40.00 Set a limestone 16 x 4 x 7, 10 ins
in the ground for $\frac{1}{4}$ sec cor.
marked $\frac{1}{4}$ on N face. Dig pits
18 x 18 x 12 ins E + W of cor 3 ft dist
and raise a mound of earth $3\frac{1}{2}$
ft base $1\frac{1}{2}$ ft high N of corner.

80.00 Set a limestone 26 x 12 x 8 ins 16 ins
in the ground for cor of sec
2, 3, 34 + 35 marked with 2
notches on E + 4 notches on W
edges. Dig pits 18 x 18 x 12 ins
in each sec $5\frac{1}{2}$ ft dist and
raise a mound of earth 4 ft base
2 ft high N of corner.

Road rolling.

Soil gravelly 3rd rate.

No Timbers.

Dense undergrowth chief brush 80 chns.

South Boundary of Tp 28 N. R. 3 W

Chains.

- N. 89° 58' E. between sec 2 + 35
through dense undergrowth
40.00 Set a limestone 16 x 8 x 4 ins
10 ins in the ground for $\frac{1}{4}$ sec
corner. marked $\frac{1}{4}$ on N face
Dig pits 18 x 18 x 12 ins E + W.
of cor and 3 ft dist and raised
a mound of earth $3\frac{1}{2}$ ft base
 $1\frac{1}{2}$ ft high N of corner.
- 80.00 Set a limestone 2.2 x 12 x 3 ins
12 ins in the ground for cor of
secs 1. 2. 35 + 36. marked with
1 notch on E + 5 notches on
W edge. Dig pits 18 x 18 x 12 ins
in each sec $5\frac{1}{2}$ ft dist and
raised a mound of earth 4 ft
base 2 ft high W of corner.
Land rolling
Soil gravelly 3rd rate.
No timber.
Dense undergrowth chis bush 80 chains.

South Boundary of Tps. 28 N. R. 3 W.

Chains.

N. 89° 58' E between Secs 1 + 36
through dense undergrowth.

40.00 Set a limestone 16 x 7 x 4 in.
10 ins in the ground for $\frac{1}{4}$ sec. cor.
marked $\frac{1}{4}$ on N face. Dig pits
18 x 18 x 12 ins E. + W. of cor 3 ft dist
and raised a mound of earth
 $3\frac{1}{2}$ ft base $1\frac{1}{2}$ ft high N of cor.

80.00 The cor of Tps 27 + 28 N R 2 +
3 W.

Land rolling

Soil gravelly + rocky 3rd + 4th notes.

No Timber

Dense undergrowth chico brush

80.00 chains.

Sept 28th 1900

Line designated	True bearing
7 th Standard Parallel	West
E. b'dy T. 28 N. R. 3 W.	North
S. " " " " " " "	N 89° 58' E
W. " " " " " " "	South
Convergency	

This Township is rolling
land, No Timber. No water.
No grass, the soil is
gravelly and rocky and
unfit for agricultural
purposes. The whole Town-
ship is covered with a
dense undergrowth of Ohio
brush. There are no settlers

J. B. Girard.
C.S. Deputy Surveyor.

and closing error.

Distance	Latitudes		Departures	
	N	S	E	W
477.92				477.92
480.00	480.00			
478.45	.33		478.45	
480.00		480.00		
				.527
	480.33	480.00	478.45	478.447
	480.00		478.447	
Error in Lat.	.33		Error in Dep.	.003

A P P R O V A L.

OFFICE OF THE UNITED STATES SURVEYOR GENERAL

Tucson, Arizona.

Dec 10, 1900.

The foregoing field notes of the survey of The West^{2d} of South

Boundaries of Tracts 27th and 28th

N. R. 3 - W. 4 and S. R. 1 -
executed by James D. Girard

under his contract No. 72, dated June
13th, 1900, having been critically

examined, and the necessary corrections

and explanations made, the said field

notes, and the surveys they describe,

are hereby approved.

George Lehist

U. S. Surveyor General for Arizona