

1741

BOOK 1741

~~1728~~

1741

1741

*Retracing*

# FIELD NOTES

OF

BOOK 1741

1741

The *Boundary* Line between  
*Arizona* *New Mexico.*  
*S. and S. R. Meridian, Arizona*

BY

*Milton Santee* Deputy Surveyor,

under his contract of *April 29<sup>th</sup>* 1882

Survey commenced *June 9<sup>th</sup>* 1882.

Survey completed *June 13<sup>th</sup>* 1882.

Platted by ~~1728~~ 188

Copied for Washington by 188

Copied for Register by 188

*[Faint signature]*

1741

1741

4-674.

Township 12 N. R. 31 E.

			4		
6	5	4	3	2	1
7	8	9	10	11	12
18	17	16	15	14	13
19	20	21	22	23	24
30	29	28	27	26	25
31	32	33	34	35	36

7919b5m4-08

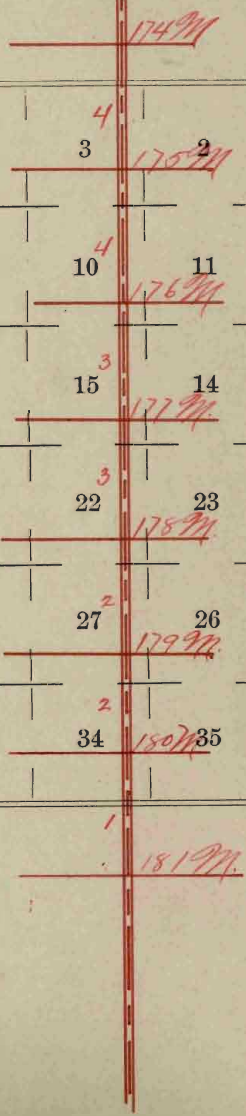

4-674.

Township 13 N., R. 31 E.

6	5	4	3	2	1
			9		
7	8	9	10	11	12
			8		
18	17	16	15	14	13
			8		
19	20	21	22	23	24
			7		
30	29	28	27	26	25
			7		
31	32	33	34	35	36
			6		

7919b5m4-08

168 M.  
169 M.  
170 M.  
171 M.  
172 M.  
173 M.  
174 M.

4-674.

Township 14 N., R. 31 E.

6	5	4	3	2	1
7	8	9	10	11	12
18	17	16	15	14	13
19	20	21	22	23	24
30	29	28	27	26	25
31	32	33	34	35	36

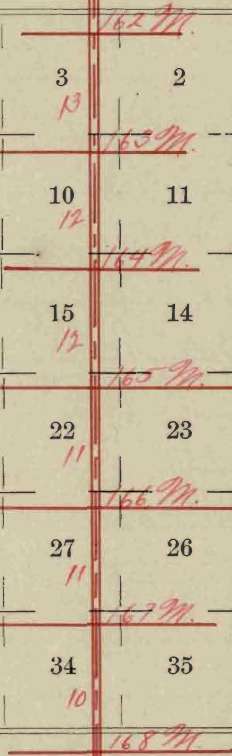

4-674.

Township 15 N., R. 31 W.

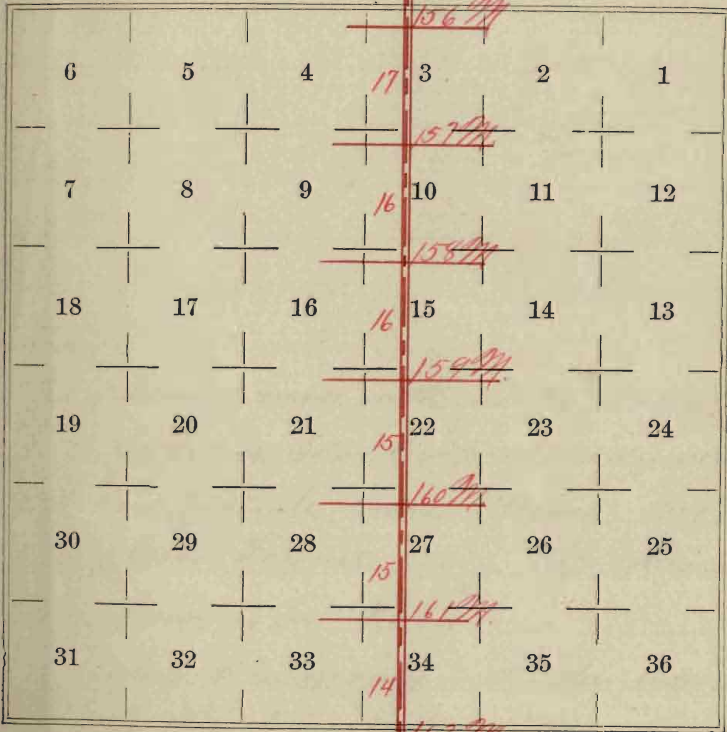

7919b5m4-03

15 N. 31 W. 21 North.

Survey made with Burt's Patent  
Improved Solar Compass, nearly new <sup>one</sup>  
in perfect order. Made by  
Otto Feunel of Cassel,  
Germany in 1881.

Before proceeding with the exterior  
of this Sp., I made a change of 5  
minutes in the latitude arc of my  
Solar Compass, by subtracting same  
from the reading previously given <sup>and</sup>  
at noon verified and corrected same  
by observation on the sun. I also tested instrument  
by reversing. I took the latitude <sup>and</sup> found  
it to be  $34^{\circ} 21'$  North.

# Retracing Boundary bet. U. M. and Arizona.

Chains.

From the 181<sup>st</sup> Mile post, which is a Basaltic stone 17 x 12 x 12 ins., marked Arizona on W. side, U. M. on E. side, 181 on N. side and 32 W. L. on S. side, around which I redig pits and rebuild mound of earth, I run

North on a random line.

Var.  $13^{\circ} 45' E.$

78.67

To a point 19 lks. E. of 180<sup>th</sup> Mile post, which is a Basalt stone, marked Arizona on W. side, U. M. on E. side, 180 on N. side and 32 W. L. on S. side, around which I redig pits and rebuild mound of earth.

The return course is therefore S. 8' E.

Retracing Boundary, bet. N. M. and Arizona.

Chariis

From the 180<sup>th</sup> Mile Post, I run North on a random line.

Wa. 13° 45' East.

79.27 To a point 3 lks. West of the 179<sup>th</sup> Mile post, which is a Basalt stone marked Arizona on W. side, N. M. on E. side, 179 on N. side and 32° W. L. on S. side, in a mound of earth, with pits. I redig pits and rebuild mound to be of proper size.

The return course is therefore S. 1° W.

From the 179<sup>th</sup> Mile Post, I continue North on a random line.

Wa. 13° 45' East.

79.80 To a point 2 lks. West of the 178<sup>th</sup> Mile post, which is a Basalt stone, marked Arizona on W. side, N. M. on E. side, 178 on N. side and 32° W. L. on S. side, with a



Retracing Boundary line bet. N. M. <sup>and</sup> Arizona.

Chains.

mound of stone, which I rebuilt.  
The return course is therefore S. 1' W.

---

From the 178<sup>th</sup> Mile Post, I continue  
North on a random line.

Wa. 13° 45' East.

79.37 To a point 58 lks. West of the  
177<sup>th</sup> Mile Post, which is a  
Sandstone, marked Arizona on W.,  
N. M. on E., 177 on N. <sup>and</sup> 32 W. L.  
on S. sides, with a mound of stone  
which I rebuilt.

x W.

The return course is therefore S. 20' <sup>W.</sup> E.

---

From the 177<sup>th</sup> Mile Post, I continue  
North on a random line.

Wa. 13° 45' East.

79.66 To a point 72 lks. E. of the 176<sup>th</sup>  
Mile post, which is a Sandstone  
marked Arizona on W., N. M. on E.,  
176 on N. <sup>and</sup> 32 W. L. on S. sides, with

Retracing Boundary, bet. N. M. and Arizona.

Chains.

earth mound and pits. I redig pits and rebuild mound to be of proper size.

The return course is therefore S. 31° E.

---

From the 176<sup>th</sup> Mile post, I continue North on a random line,

Var. 13° 45' East.

79.75 To a point which is the 175<sup>th</sup> Mile post, which is a post, marked Arizona on W., N. M. on E., 175 on N. and 32° W. L. on S. sides, with earth mound and pits. I redig pits and rebuild mound to be of proper size.

June 9<sup>th</sup> 1882.

---

From the 175<sup>th</sup> Mile post, I continue North on a random line,

Var. 13° 45' East.

79.46 To a point 3 lks. East of the 174<sup>th</sup> Mile post, which is a Boulder

## Retracing Boundary bet. N.M. and Arizona.

Chains.

marked Arizona on W., N. M. on  
 E., 174 on N. and  $32^{\circ}$  W. L. on  
 S. sides, with earth mound and  
 pits. I redig pits and rebuild  
 mound to be of proper size.  
 The return course is therefore S. 1'E.

Retracing Boundary bet. N. M. and Arizona.

Chairs.

Before proceeding with these retracings, I made a change of 5 minutes in the latitude arc of my Solar Compass, by adding same to the reading previously given and at noon verified and corrected same by observation on the sun. I also further tested instrument by reversing. I took the latitude and found it to be  $34^{\circ}26'N$ . From the 174<sup>th</sup> Mile post, I continue North on a sandow line.

Var.  $13^{\circ}45'$  East.

77.38 To a point 12 lks. East of the 173<sup>rd</sup> Mile post which is a post in Earth mound. I reset and remark post, Arizona on W, N. M. on E., 173 on N. and  $32^{\circ}N$ . L. on S. sides. I dig pits and rebuild mound. The return course is therefore S. & E.

## Retracing Boundary bet. N. M. and Arizona.

## Chains.

From the 173<sup>rd</sup> Mile Post, I continue North on a random line.

Wa.  $13^{\circ}45'$  East.

- 79.60 To a point 5 lks. West of the 172<sup>nd</sup> Mile post, which is a post in earth mound and pits. I reset and remark post, Arizona on W., N. M. on E. 172 on N. and  $32^{\circ}$  W. L. on S. sides, and dig pits and rebuild mound to be of proper size. The return course is therefore S. 2' W.

From the 172<sup>nd</sup> Mile Post, I continue North on a random line.

Wa.  $13^{\circ}45'$  East.

- 80.83 To a point 97 lks. East of 171<sup>st</sup> Mile post, which is a Sandstone, marked Arizona on W., N. M. on E., 171 on N. and  $32^{\circ}$  W. L. on S. sides, with a mound of stone. The return course is therefore S. 42' E.

8

# Retracing Boundary bet. N. M. and Arizona.

Chains

From the 171<sup>st</sup> Mile Post, I continue North on a random line.

Wa.  $13^{\circ} 40'$  East.

79.70

To a point 80 lks. West of the 170<sup>th</sup> Mile Post, which is a post, lying on the ground. I reset and remark post, Arizona on W., N. M. on E., 170 on N. Wa  $32^{\circ}$  W. L. on S. sides, and rebuild mound of earth.

The return course is therefore S.  $34'$  W.

From the 170<sup>th</sup> Mile Post, I continue North on a random line.

Wa.  $13^{\circ} 40'$  East.

79.80

To a point 30 lks. W. of the 169<sup>th</sup> Mile Post, which is a sandstone, marked Arizona on W., N. M. on E., 169 on N. Wa  $32^{\circ}$  W. L. on S. sides, with a mound of stone, which I rebuilt,

The return course is therefore S.  $13'$  W.

## Retracing Boundary bet. N. M. and Arizona.

Achaic.

From the 169<sup>th</sup> Mile Post, I continue  
North on a random line.

W.  $13^{\circ} 45'$  East.

80.70 To a point 17 lks. East of the 168<sup>th</sup>  
Mile post, which is a sandstone,  
marked Arizona on W., N. M. on E.,  
168 on N. and  $32^{\circ}$  W. L. on S. sides,  
with a mound of earth and pits.  
I rebuild mound and redig pits.  
The return course is therefore S.  $7^{\circ}$  E.

June 10<sup>th</sup> 1882.

Retracing Boundary bet. N. M. and Arizona.

Chairs.

Before proceeding with these retracings, I made a change of 5 minutes in the latitude arc of my Solar Compass, by adding same to the reading previously given and at noon verified ~~and~~ corrected same by observation of the sun. I also further tested instrument by reversing. I took the latitude and found it to be  $34^{\circ}31'41''$ .

From the 168<sup>th</sup> Mile post, I continue North on a random line.

Var.  $13^{\circ}45'$  East.

78.97 To a point 28 lks. East of the 167<sup>th</sup> Mile post, which is a sandstone marked Arizona on W, N. M. on E., 167 on N. and  $32^{\circ}$  W. S. on S. sides, with a mound of stone, which I rebuild.

The return course is therefore S.  $12^{\circ}$  E.



## Retracing Boundary bet. N. M. and Arizona.

## Chains.

From the 167<sup>th</sup> Mile post, I continue  
North on a random line,

Wa.  $13^{\circ}58'$  East.

- 79.86 To a point 2 lks. East of the 166<sup>th</sup>  
Mile post, which is a Sandstone  
marked Arizona on W, N. M. on E,  
166 on N. and  $32^{\circ}$  W. L. on S. sides,  
with a mound of stone which I  
rebuild.

The return course is therefore S.  $1^{\circ}$  E.

From the 166<sup>th</sup> Mile Post, I continue  
North on a random line.

Wa.  $13^{\circ}58'$  East.

- 77.63 To a point 55 lks. W. of the 165<sup>th</sup> Mile  
post, which is a Sandstone marked  
Arizona on W, N. M. on E, 165 on N.  
and  $32^{\circ}$  W. L. on S. sides, with a mound  
of earth which I rebuild and pits  
which I redig.

The return course is therefore S.  $24'$  W.

12

Retracing Boundary, bet. N. M. and Arizona.

Chains.

From the 165<sup>th</sup> Mile post, I continue  
North on a random line.

Wa.  $30^{\circ}54'$  East.

79.67 To a point 89 lks. East of the  
164<sup>th</sup> Mile post, which is a  
Sandstone, marked Arizona on W.,  
N. M. on E., 164 on N. and  
 $32^{\circ}$  W. S. on S. side, with a mound  
of stone, which I rebuild.

The return course is therefore S.  $38'$  E.

---

From the 164<sup>th</sup> Mile post, I continue  
North on a random line.

Wa.  $13^{\circ}54'$  East.

78.92 To the 163<sup>rd</sup> Mile post, which is a  
post, marked Arizona on W., N. M. on  
E., 163 on N. and  $32^{\circ}$  W. S. on S. Sides,  
with mound of earth and pits. I  
redig pits and rebuild mound to  
be of proper size.

## Retracing Boundary bet. Arizona and New Mexico.

Chains.

From the 163<sup>rd</sup> Mile post, I continue North on a random line.

W.  $13^{\circ} 54'$  East.

79. 29 To a point 35 lks. West of the 162<sup>nd</sup> Mile post, which is a post marked Arizona on W, N. M. on E, 162 on N. and  $32^{\circ} W. S.$  on S. sides, with a mound of earth and pits. I redig pits and rebuild mound to be of proper size.

The return course is therefore S.  $16' W.$

## Retracing Boundary bet. Arizona and N. M.

## Chains.

Before proceeding with these retracings, I made a change of 6 minutes in the latitude on of my Solar Compass, by adding same to the reading previously given. I also further tested instrument by reversing. I took the latitude and found it to be  $34^{\circ} 37'$  N.

From the 162<sup>nd</sup> Mile post, I continue North on a random line.

Wa.  $13^{\circ} 54'$  East.

- 79.51 To a point 45 lks. East of the 161<sup>st</sup> Mile post, which is a Cedar, 4 ins. dia, marked Arizona on W., N. M. on E., 161 on N. and  $32^{\circ}$  W. L. on S. sides, with mound of earth and pits. I rebuilt mound and redig pits. The return course is therefore S.  $19^{\circ}$  E.

## Retracing Boundary bet. Arizona and N. M.

Lohans.

From the 161<sup>st</sup> Mile post, I continue North on a random line.

Wa.  $13^{\circ}58'$  East.

79.89 To a point 12 lks. West of 160<sup>th</sup> Mile post, which is a post, marked Arizona on W., N. M. on E., 160 on N. and  $32^{\circ}W. L.$  on S. sides, with mound of earth and pits. I rebuild mound and redig pits.

The return course is therefore S.  $5^{\circ}W.$

From the 160<sup>th</sup> Mile post, I continue North on a random line.

Wa.  $13^{\circ}58'$  East.

80.29 To a point 3 lks. East of the 159<sup>th</sup> Mile post which is a post, marked Arizona on W., N. M. on E., 159 on N. and  $32^{\circ}W. L.$  on S. sides, with a mound of earth, which I rebuild and pits which I redig.

The return course is therefore S.  $1^{\circ}E.$

## Retracing Boundary bet. N. M. and Arizona.

Lk. 36.

From the 157<sup>th</sup> Mile post, I continue  
North on a random line.

Var.  $13^{\circ} 58'$  East.

- 80.36 To a point 2 lks. West of the 158<sup>th</sup>  
Mile post, which is a post, marked  
Arizona on W., N. M. on E., 158 on  
N. and 32<sup>o</sup> W. L. on S. sides, with  
a mound of earth and pits. I redig  
pits and rebuild mound of earth.  
The return course is therefore S. 1' W.

From the 158<sup>th</sup> Mile Post, I continue  
North on a random line.

Var.  $13^{\circ} 58'$  East.

- 79.74 To a point 25 lks. East of the  
157<sup>th</sup> Mile post, which is a post  
marked Arizona on W., N. M. on E.,  
157 on N. and 32<sup>o</sup> W. L. on S. sides, with  
a mound of earth and pits. I redig pits  
and rebuild mound of earth.  
The return course is therefore S. 11' E.

Retracing Boundary bet. Arizona and N. M.

Chavis.

From the 157<sup>th</sup> Mile post, I continue North on a random line.

Wa.  $130^{\circ} 58'$  East.

78.21 To a point 55 lks. West of the 156<sup>th</sup> Mile post, which is a post marked Arizona on W., N. M. on E., 156 on N. Wa.  $52^{\circ} 40'$  W. S. on S. sides with a mound of earth and pits. I dig pits and rebuild mound of earth.

The return course is therefore  $S 24^{\circ} W$

June 12<sup>th</sup> 1882.

U. S. Surveyor General's Office,  
Tucson, Arizona, Dec. 20, 1872.

The foregoing Field Notes of the survey of

Retracing  
the Boundary Line between  
Arizona and New Mexico

of the Gila and Salt River Base and Meridian, Arizona,  
executed by Milton Dante,  
D. S., under his contract of the 29<sup>th</sup> day of  
April, 1872, having been critically ex-  
amined and the necessary corrections and explanations  
made, the said Field Notes and the surveys they de-  
scribe, are hereby approved.

J. W. Robinson

Surveyor General.