

San Bernardino
Land Grant

1749

BOOK 1749

1749

1749

4-671

1749

FIELD NOTES
GENERAL LAND OFFICE.

1749

Index

BOOK 1749

BOOK 1749

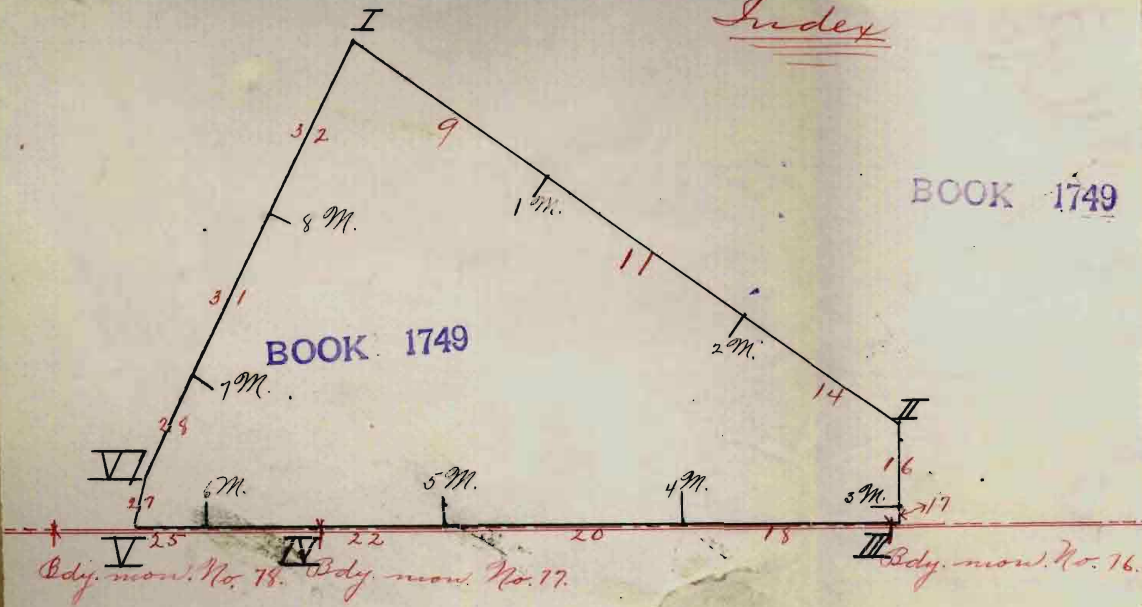

Mexico.

Field Notes
 the sur
 the
 undare
 of the
 u Bernard
 Land Ge
 at survey
 un A Roc
 l. S. Deput
 in Contrae
 dated March

Field Notes
of the survey of
the
Boundaries
of the
San Bernardino private
Land Grant

as surveyed by
John A. Rockwell
U. S. Deputy Surveyor

Under Contract No 79
dated March 19 1901

Survey commenced
July 15 1901
Survey completed
July 20 1901

Names & duties
of Assistants 27

W. J. Slaughter Chairman
Joe A. Hurry "
Clarence Minus Flagman

Preliminary Oaths of Assistants.

We, *A. L. Fisher*
and *W. J. Slaughter & Jos. A. Henry*
do solemnly swear that we will well and faithfully
execute the duties of Chain Carriers; that we will
level the chain upon even and uneven ground, and
plumb the tally pins, either by sticking or dropping
the same; that we will report the true distance to
all notable objects, and the true lengths of all lines
that we assist in measuring, to the best of our skill
and ability, and in accordance with instructions
given us, in the survey of the

San Bernardino
Land Grant

of the Gila and Salt River Base and Meridian in
the Territory of Arizona.

<i>A. L. Fisher</i>	Did not serve
		Chainman.
<i>W. J. Slaughter</i>	Chainman.
<i>Jos. A. Henry</i>	Chainman.
		Chainman.

Subscribed and sworn before me, this *15th*

day of *July* 189*1*

John A. Rockefeller
Notary Public.

[SEAL.]

MY COMMISSION EXPIRES APR. 10, 1903

MY COMMISSION EXPIRES APR. 10, 1903

We, Clarence Minus 3

do solemnly swear that ~~we~~ ^I will well and truly perform the duties of Flagman

in the establishment of corners and other duties, according to instructions given us, and to the best of our skill and ability, in the survey of the

San Bernardino
Land Grant

of the Gila and Salt River Base and Meridian, in the Territory of Arizona.

Clarence Minus

Subscribed and sworn to before me this 15

day of July 1901 189

John A. Rockswold
Notary Public.

Survey commenced
July 15 1901, and
executed with a
Young & Sons Mountain
Transit No 6855 with
Smith Solar attachment.
The horizontal limb
is provided with
two verniers oppo-
site to each other
reading to single
minutes of arc,
which is also the
least count of the
verniers of the
latitude and decli-
nation arcs.
The instrument
was examined & tested
on the true meridian.

at Tucson, found correct and was approved by the Surveyor General for Arizona May 10 1901. During the whole of this week the nights were cloudy and I was unable to observe the star Polaris.

On July 14th I found both forenoon and afternoon solar observations agreed perfectly. The instrument standing over the same point all day. A noon observation for latitude, also, agreed with the recorded latitude.

of the International
Boundary viz:

$31^{\circ} 20' N.$

July 15 1901

I proceed to the head
of Aston Springs but
after diligent search
am unable to find
the initial Monu-
ment referred to in
Special Instructions.

I then proceed
to a large stone monu-
ment about 600 ft
westward from the
ranch house of Mr.
J. H. Slaughter at
San Bernardino de-
scribed in plat fur-
nished me by the

Feet

Surveyor General, as
"Old Monument"

Thence I run
S $10^{\circ} 45' 21''$

10164 Intersect the Inter-
national Boundary Line
& 1654 ft from
M'n't No 78. At this
pt of intersection, I
drive a temporary
stake

I return to the above
mentioned "Old Mon-
ument" and
run thence N $26^{\circ} 07' 8''$
10705.3 feet

This point falls upon
the top of the west bank
of Aston Spring Gulch
a short distance from

Said Springs,
a slope covered with
loose volcanic
boulders.

I establish here the
N.W. Cor. of the Grant
Set a volcanic rock
24 x 14 x 8 ins., 18 ins in
ground, chiseled
Δ No 1

S.B.G. on the S.E. and
P.L. " " N.W. :

dig pits 24 x 24 x 12 ins
S. $26^{\circ} 07' W$ 8 ft. and
S. $53^{\circ} 16' 26'' E$ 4 ft.; and
raise a wall of stone
and earth 5 ft. base
3 ft. high. S. of cor.
Whence

College Peak brs. N. $53^{\circ} 26' W$

Fret

Bunk Robinson PK. brs. S. 78° 31' E
 A knob on S. side of Cerro
 Gallardo or "Niggerhead"
 brs S. 73° 19' W

An old rock monument
 6 ft. base 3 ft. high with
 tree limb in center
 brs. S 67° 40' W 1102.7 ft.
 va 120° 25' E

July 16 1901

July 17 1901

From Δ No 1 above
 described I run
 S. 55° 16' 26" E

2086 Nagor road San
 Simon to San Bernardino
 brs N. N. E. & S. S. W

2101 Center San Simon Wash
 20 ft wide course S.

2640 Set a volcanic

Feb.

Rock 20x14x8 ins
(an old metal) 15
ins in the ground
for $\frac{1}{2}$ mile corner
Chiseled $\frac{1}{2}$ M on the W.

S. B. G. on the S
and P. L. on the N. :
dig pits 18x18x12 ins
on line $5\frac{1}{2}$ ft each
way from cor. :
and raise a ridge
of earth $3\frac{1}{2}$ ft base
 $1\frac{1}{2}$ ft high W. of cor.
Whence :

A small adobe and
rock house occupied
by Mexican tenant
brz S 52° 55' W about
1500 ft
A large rock at st.

Feet

end of a masonry
dam brs. S. $72^{\circ}15'W$
about 1000 ft
ra $12^{\circ}E$.

4711

Upper edge of brushy
musa brs NE S.W.

5280

Set a granite rock
 $24 \times 24 \times 8$ in. (an old
metate) 18 in in
ground for one
mile corner,

Chisled 1 M on W.

S B Cx " S.

PL " N.

dig pits $18 \times 18 \times 12$ in
on line $5\frac{1}{2}$ ft each
way from cor.: and
raise a mid of earth
 $8\frac{1}{2}$ ft base $1\frac{1}{2}$ ft high
W. of Cor. ~~the~~

Fet

Whence: the peak
of roof of Halver
house near Bdy Mt.

No. 77 brs S $39^{\circ} 30' W$

The square above
rock house men-
tioned above brs
N. $82^{\circ} 20' W$.

Bunk Robinson Peak
brs N $67-07^{\circ} E$.

Ya $11^{\circ} 50' E$.

7920 Set a volcanic
rock $27 \times 18 \times 6$ ins.
16 ins in ground
for $1\frac{1}{2}$ mile cor.

Chiseled $1\frac{1}{2}$ in on W,

S.B. G on S,

P.L. on N.

dig pits: $18 \times 18 \times 12$ ins
on line $5\frac{1}{2}$ ft each

Fuel

way from Cor: and
raise a mid of earth
3 1/2 ft base 1 1/2 ft high
W. of Corner

Whiner:

Kio on Cerro Gallardo

br. S. 79° 40' N

Squaw Mountain

br. S. 70° 35' E

A prominent peak in
Mexico br. S 11° 50' E

Va 11° 40' E

10200 Road San Bernardino
to Sycamore br. S. 85° S.W.

10560 Set a volcanic rock
24 x 16 x 6 in 18 in
inground for 2 mile
corner chiseled

2 m on the W.

S B G " " S

P. L. " " N

Feet

dig pits 18 X 18 X 12 ins
 on line 5 1/2 ft dist
 each way from cor.:
 raise a mound
 of earth 3 1/2 ft base
 1 1/2 ft high N. of cor.

Thence

Collyer Crk brs N 53° 38' W

Prominent peak in

Mexico brs S 16° 15' E

Chiricahua Dome brs N 8° 15' E

Ya 11° 40' E

11565 Wash of Hay Hollow 30
 ft wide course S.W.
 Thence over rolling
 granite ridges & knolls.

13200 Set a volcanic rock
 24 X 14 X 12 ins 18 ins
 in the ground for
 2 1/2 mile course

Feet

Chiseled: $2\frac{1}{2}$ M on the W

S B G " " S

P.L. " " N

dig pits $18 \times 18 \times 12$ ins
 on line $5\frac{1}{2}$ ft each
 way from cor.;

raise a ridge of
 earth $3\frac{1}{2}$ ft base

$1\frac{1}{2}$ ft high W of cor.

3728 N.E. cor of Grant
 on a gravel hillock

Set a volcanic rock

$24 \times 12 \times 6$ ins 18 ins

in the ground for cor. ^{no 2}

Chiseled: $\Delta 2$

S. B. G. on the S.W.

P.L. " " N.E.

dig pits $24 \times 24 \times 12$ ins

N. $55^{\circ} 16' 26''$ W. 4 ft. and

$50^{\circ} 11' 2''$ W 8 ft. :

Feet

raise a mid of
stone 4 ft base
1 1/2 ft high S. of cor
Thence:

Knob on Cerro Gallardo
brz S 83° 30' W.

Collyer Peak brz N. 53° 40' W.

A tree on the center
of three peaks (3 heads)
brz S. 76° 15' W.
Va. 12° E

Thence 50° 11' W
over rolling gravel
ridges

2112

Set a volcanic
rock 20 X 10 X 10 ins
15 ins. in ground
for true true cor
chiseled 3 M on N
S B C " W

Foot

and P.I. on East;
 Dig pits 18x18x12 in
 on line $5\frac{1}{2}$ ft
 each way from cor;
 raise a mid of east
 $3\frac{1}{2}$ ft base, $1\frac{1}{2}$ ft
 high. N of cor.
 No bearings avail-
 able. Va 120° E

2840 Wagon road along
 International Bdy
 to E of

2902 Barbed wire fence
 to E of

2905 Intersect Inter-
 national Bdy
 N $87^{\circ} 25\frac{1}{2}$ W 52 ft
 from Bdy Mark No 76
 Set a limestone
 24x12x10 in 18 in

Fut

in ground for
S.E. Cor. Chiswell
 $\Delta 3$

S.B.G. on the N.W.

P.L. on the E.

M.E.X. on the S.:

big pits 24 x 24 x 12

like N. $0^{\circ} 11' E$ 4 ft. and

N $89^{\circ} 25\frac{1}{2}' W$ 4 ft.:

rain a mid of stone
and earth 4 ft base

3 ft high S. of Cor.

Val $120^{\circ} E$

July 17

July 18

From $\Delta 3$ heretofore
described run

N $89^{\circ} 25\frac{1}{2}' W$. Along interior
international boundary line

On when rough

Feet

ground

155 Barbed wire fence
brs E & W.

1847 Set a limestone

24 x 20 x 12 ins

18 ins in the ground

for 3 1/2 mile corner
Chisled 3 1/2 M on E

S B G on the N.

MEX " " S.

dig pits 18 x 18 x 12 ins

on line 5 1/2 ft. each

way from corner.

raise a rid of earth

3 1/2 ft base 1 1/2 ft

high W. of cor.

Va. 12^o E.

4487 Set a limestone

20 x 16 x 10 ins 16 ins

in the ground for

7ft

4 mile corner
 Chiseled 4M on the E
 S B G on " N
 MEX " " S.
 dig pits 18 x 18 x 12
 lines on line
 5 1/2 ft each way
 from cor:
 raise a mid of
 earth 3 1/2 ft base
 1 1/2 ft high W. of cor
 val 12° E.

6765 Beane rough broken
 ground for grassy
 flat course E. S. W.
 Mountainous land 1765 ft

7029 Barbed wire fence
 to S. N. W. & S. E.

7127 Set a limestone
 20 x 12 x 10 in 15
 in in the ground

Feet.

for 4 1/2 mile cor.
 Chiselled 4 1/2 M on E
 S B G on the N
 MEX " " S
 dip pits 18 X 18 X 12 ins
 on line 5 1/2 ft
 each way from
 cor.: raise a
 ridge of earth 3 1/2 ft.
 base 1 1/2 ft high
 N. of cor.
 Wa 12° E.

9240 Center of San Bern-
 nardino Creek
 Wash 30 ft wide
 course S.

9767 Set a limestone
 22 X 12 X 12 ins, 16
 ins in the ground
 for S mile corner

Chiseled 5M on the E.
 S B G " " SY
 MEX " " S.

Dig pits 18 X 18 X 12 ins
 on line 5 1/2 ft
 each way from cor;
 raise a mid of earth
 3 1/2 ft base 1 1/2 ft
 high at of cor
 Va 120 E

10757 Old unit 5 ft sq.

11017 Leave flat ascend.
 enter dense mesquite brush.

11368. Witness cor. to A cor. No. 4. Det. red calcareous rock 24 X
 12 X 8 ins. 15 ins. in the ground chiseled S No
 4. S. B. G. on N face. Mex. on W. face and U. C. on E. face.

11378. Intersect International Bdy. Monument
 No. 77, which is a large affair of masonry
 covered with a coating of lime cement, exposing
 the original rocks chiseled by the Army survey
 in 1854. This mon. is identical with A cor.
 No. 4. Therefore I set U. C. as above described.
 Note: Owing to proximity

of iron in monument
 it was not practicable
 to determine mag-

note variation
 dense undergrowth 36/ft
 Thence:

West on true line
 along International
 Bdy, through
 dense mesquit
 brush

1029 Set a volcanic
 rock 26 x 16 x 6 ins
 20 ins in ground
 for $5\frac{1}{2}$ mile cor.

Chisled $5\frac{1}{2}$ M on E
 S.B.G. on the N
 MEX " " S

dig pits 18 x 18 x 12 ins
 on line $5\frac{1}{2}$ ft each
 way from cor. ;
 raise a m'd of earth
 $3\frac{1}{2}$ ft base $1\frac{1}{2}$ ft high W
 of cor. Va $120^{\circ} 45' E$

Feet

Heavy rains inter-
fere with further
work. July 18

July 19th

- 1366 E. side picket corral
 1443 N. " " "
 1551 ^{inter garden} E. entrance to old
 Mormon house
 of 3 rooms, 40 x 17 1/2 ft.
 for N & S.
 1566.5 W. entrance to same
 1656 Barbed wire fence
 to N & S.
 Leave garden
 1661 Spring house 18 ft left
 1675 Leave dense brush
 1804 Barbed wire fence to
 N & S
 2254 Creek 5 ft wide course

Feet

S.E.

3309

Barbed wire fence
brs No 8

Even dense brush

3669

Set a limestone

24 X 10 X 10 ins

18 ins in ground
for 6 mile cor

Chisel 6 M on the E

S.B.G. " " N

MEX " " S

dig pits 18 X 18 X 12

ins on line

5 1/2 ft each way
from cor. :

raise a mound

of earth 3 1/2 ft base

1 1/2 ft high W of cor

Va 12° E

4533

Wagon road

Feet

San Bernardino
 to La Morita on
 NE R.S.H.

4798.4 Intersection point
 on International ^{bdy}
 before determined
 Lava volcanic rock
 20 x 12 x 12 in, 15
 ins in ground
 sketched:

Δ No. 5. on top
 S B G on the N.E.
 MEX " " S.
 P.L. on the W.
 dig pits 24 x 24 x
 12 ins E. 4 ft and
 N 10° 45' E 4 ft: raise
 @ mid of earth 4 ft
 base 2 ft high S of
 Cor. Humer

Feb

Inter. Bdy Mit No 78
 brs W 1638 ft

va. 1140' E
 dense undergrowth total 3525.4 ft
 Thence N. 10° 45' E

Leave dense brush
 for scattering brush

1016.4

"Old Monument"
 heretofore described
 Set a volcanic
 rock 24 x 15 x 10 ins
 18 ins in the ground
 at the center of base
 of old Monument
 Chiseled \triangle

S.B.G. on the E

PL " " W

dig pits 24 x 24 x 12

hrs. N. 26° 07' E 4 ft

and S. 10° 45' W 8 ft "

raise a mid of stone

Feet

4½ ft base, 3 ft high
S of Cor.

Thence

Knob on Cerro Gallardo

brz. S. 83° 25' N.

Bank Robinson Peak

brz. N 65° 15' E

College Peak brz

N. 44° 05' N.

Peak of Mrs. Howells

house brz S 78° 08' E

San Bernardino

Ranch house, res-
idence of J. H. Slaughter
brz. S 87° 46' E

5.88 ft to main en-
trance

va 11° E

Thence N 26° 07' E

130

Road to Douglas & Bisbee

feet

brs N & E

143 Telephone line
to same points
brs N & E

222 Road San Bernardino
to Mud Springs
brs N. & E

494.7 Set a volcanic
rock 21 X 13 X 8 in
15 1/2 ins in ground
for 6 1/2 mile cor.
Chiselled 6 1/2 M on the S
S.B.G. " " E
P.L. " " W

Raise a mid of stone
4 ft. base 3 ft high
W. of cor pits in-
practicable

740 Gulch 20 ft wide
course S. & E.

Feet.

Thence ascend
and over volcanic
mesa,

3134.2 Set a volcanic
rock 22 X 16 X 12 in
16 in in the ground
for 7 in cor.

Chiseled 7 Mouths

S.B.G. " " E

P.L. " " W

Raise a n'd of stone
4 ft. base, 3 ft. high
N. of cor.: pits in-
practicable

Thence:

College Peak brs N 46° 42' W

Knob of Cerro Gallardo

brs S 80° 08' W

Bank Robinson Peak

brs N. 66° 42' E

Feet.

Ya $11^{\circ}20' E$

5774.2 Set a volcanic
 rock $22 \times 14 \times 8$ ins
 16 ins. in ground
 for $7\frac{1}{2}$ mil cor.
 Chiseled $7\frac{1}{2}$ Mouths
 S.B.G. " " E
 P.L. " " W

dig pits $18 \times 18 \times 12$ ins
 on line $5\frac{1}{2}$ ft
 each way from
 cor.: raise a
 mid of earth $3\frac{1}{2}$ ft
 base $1\frac{1}{2}$ ft high
 W. of cor.

Thence:

Sierra Prieta brs
 $S 19^{\circ}20' W$

Chiricahua Dome
 brs $N 11^{\circ}37' E$

Feet.

College PK. br N $48^{\circ} 55' W$
 Va $12^{\circ} 15' E$

8414.7 Set a volcanic rock

26 x 12 x 10 in, 10 in
 in ground to bed rock
 for 8 mile cor.

chiseled 8 M on the S

S. B. G. " " E

P. L. " " W

I surround corner
 with a mound of
 stone $3\frac{1}{2}$ ft base
 $1\frac{1}{2}$ ft high, pits in-
 practicable

Whence: Va $14^{\circ} 15' E$

Bunk Robinson Peak

br N. $69^{\circ} 25' E$.

Knob of Cerro Galleardo

br S $75^{\circ} 15' W$

- Feet
 9996 Old road to NW 1/4 Sec.
 10150 Rock mid in spring
 35 ft. rt of line
 10230 Center Aston Creek
 15 ft wide course
 S 30° E
 10600 Point in old rock
 wall enclosure or
 corral, 60 ft diam.
 10705.3 Cor. No. 1, the
 place of begin-
 ning
July 19th

General Description

This land grant is found in the southeastern portion of Cochise County, Arizona, lying along the International Boundary Line.

It includes a narrow valley containing several springs of water forming San Bernardino Creek which flows south into Mexico.

The water is utilized to irrigate several areas of valley land.

The surrounding

region is of volcanic
origin. The mesas
over which the
boundaries extend
are quite ~~low~~ rocky
covered with a sparse
growth of native grasses.

The only settlements
are the residences
of Mr J H Slaughter
and Mrs Howell
and the buildings
occupied by the
employees of the ranch.

There is no timber.
Considerable mesquite
brush is found in
portions of the grant.
There are no mines
of valuable minerals.

discovered,
The magnetic needle
is considerably affected
along the western
boundary, the variation
ranging from
 11° to $14^{\circ}45'$ E.

The area of the
grant as surveyed
is 2382.86 acres.

This differs somewhat
from the calculated area in letters
of instructions owing
to the fact that the
International Bdy. Line
between monuments
76 and 77 is assumed
to be due west, while
in reality the course

is $S. 89^{\circ} 25\frac{1}{2}' W.$

The course of
The Boundary Line
between Marsden

77 and 78 is due West

Fontstone Ariz

Aug. 2. 1901

John A. Rockfellow
U.S. Dep. Surveyor.

see next page

Calculation

	Course	Dist.	Lat.		Dep.	
			N.	S.	E.	W.
1	N. 10° 45' E	1016.4	998.6		189.6	
2	N. 26° 07' E	10705.3	9612.3		4712.5	
3	S. 55° 16' 26" E	13728.0		7820.0	11283.0	
4	S. 0° 11' W	2905.0		2905.0		9
5	N. 89° 25½' W	11378.0	114.1			11377
6	West	4798.4				4798
			10725.0	10725.0	16195.1	16185

of Area.

Mer. Distance	Double Meridist.	Areas	
		N	S
189.6	189.6	189334.56	
4902.1	5091.7	48942947.91	
16185.1	21087.2		164901904.00
16175.8	32360.9		94008414.50
4798.4	20974.2	2,393,156.22 547497.44	

~~49679779.91~~ 258910318.50
 51525438.69 49679779.91
 2) 209230538.59
 43560) 104615269.29
 2401.63
 acres.

258910318.50
 51525438.69
 2) 207354879.81
 43560) 103697439.905

Correct Area. 2382.86 acres.

Note - Office corrections in red ink.

Interlineations authorized by deputy's letter of Dec. 16, 1901. also correction of area.

Preliminary Oaths of Assistants.

We, **BOOK 1749**

and
do solemnly swear that we will well and faithfully
execute the duties of Chain Carriers; that we will
level the chain upon even and uneven ground, and
plumb the tally pins, either by sticking or dropping
the same; that we will report the true distance to
all notable objects, and the true lengths of all lines
that we assist in measuring, to the best of our skill
and ability, and in accordance with instructions
given us, in the survey of the.....

.....

.....

.....

*of the Gila and Salt River Base and Meridian in
the Territory of Arizona.*

..... Chainman.

..... Chainman.

..... Chainman.

..... Chainman.

Subscribed and sworn before me, this

day of 189

.....
Notary Public.

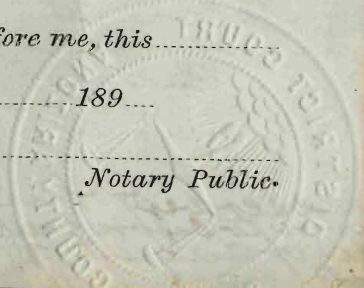

[SEAL.]

41
Pg 40 Blank
BOOK 1749

I John H. Rockfellow, U. S. W. S.
Surveyor do solemnly swear
that in pursuance of a con-
tract rec'd from Geo. Christ U. S.
Surveyor General for Arizona
dated March 19, 1901 I have
well faithfully and truly
in my own proper person
and in strict conformity with
the instructions furnished
by the Surveyor General for
Arizona, the manual of Sur-
veying Instructions and
the laws of the U. S. Surveyor
the exterior boundaries
of the San Bernardino
Private Land Grant
which are represented
in the foregoing field notes
and having been surveyed
by me and under my di-
rection; and I do further
solemnly swear that all the
corners of the said survey
have been established and per-
petrated in strict accordance
with the manual of Surveying
Instructions, and the specific
instructions of the U. S. Surveyor
General for Arizona and in the
specific manner described
in the field notes of said
survey, and should any error
be detected I will suffer the
penalty of perjury under the
provisions of an act of Congress
approved Aug. 8 1876

Subscribed at Phoenix, Arizona
this 20th day of August 1901
John H. Rockfellow
Deputy Surveyor

We hereby certify that we
 assisted John A Rockfellow
 U.S. Dep. Surveyor in surveying
 all those parts or por-
 tions of the San Bernardino
 Land Grant which are
 represented in the foregoing
 field notes as having been
 surveyed by him and
 under his direction;
 and that said survey
 has been in all respects
 to the best of our knowledge
 and belief, well and faith-
 fully surveyed, and the
 corner monuments estab-
 lished according to the
 instructions furnished
 by the U.S. Surveyor General
 for Arizona.

W. H. Haughton, Chairman
 J. A. Perry, Chairman
 Clarence Menard, Flagman

Clarence Menard

BOOK 1749

Subscribed and sworn to
 before me this 20th day
 of June 1901

John A Rockfellow
 Notary Public

Notary Public

MY COMMISSION EXPIRES APR. 15, 1903

and by this 20th day

We,.....

do solemnly swear that we will well and truly perform the duties of.....

in the establishment of corners and other duties, according to instructions given us, and to the best of our skill and ability, in the survey of the.....

of the Gila and Salt River Base and Meridian, in the Territory of Arizona.

Subscribed and sworn to before me this.....

day of..... 189.....

Notary Public.

no un blank 11

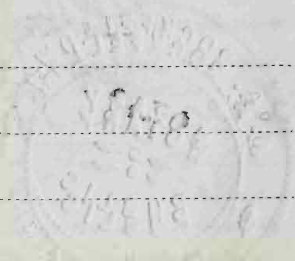

Thomas M. Clark

43

BOOK 1749
A P P R O V A L .

Office of the

United States Surveyor General.

Phoenix, Arizona, March 14/02

The foregoing field notes of the survey of the boundaries of the San Bernardino Private Land Grant:

~~of the Gila and Salt River Base and Meridian, in the Territory of Arizona,~~

Executed by John A. Rockefeller,

United States Deputy Surveyor, under his contract No. 79, dated March 19 1901,

having been critically examined, and the

necessary corrections and explanations

made, the said field notes, and the sur-

veys they describe, are hereby approved.

August H. Rice

U. S. Surveyor General.