

1762

BOOK 1762

1762

Field Notes

of the

Preliminary Survey
of the
Exterior Boundaries

of the

BOOK 1762

Rancho of San Ignacio
del Sabaeonahi.

Gila and Salt River Base and Meridian

ARIZONA.

By Solomon M. Allis D. S.

Under contract dated Sept. 14, 1879.

Survey commenced Dec. 14, 1879.

Survey completed Dec. 26, 1879.

1762

1762

1762

Index.

BOOK 1762

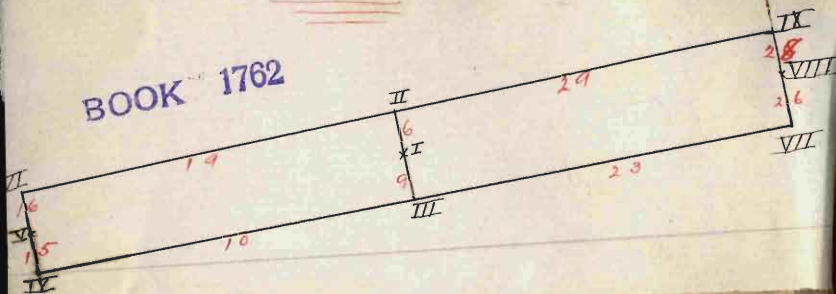

Field Notes

- of -

Preliminary Survey
 of the
 Rancho of San Ignacio
 del Babacomori
 Private
 Land Grant

Pima Co
 A. T.

Survey commenced Dec 17, 1879
 under orders from Surveyor
 General of Arizona dated
 Dec 2nd 1879

and

Contract of Sept 17th 1879
 No -

Survey Completed Dec 26, 1879.
 Solomon M. Allen
 U. S. Dep. Surveyor.

We, E. J. Partridge
 and Thomas Miller
 do solemnly swear that we will well and truly per-
 form the duties of Flagbearers
and axeman
 according to instructions given us, and to the best
 of our skill and ability.

E. J. Partridge
T. Miller

Sworn to and subscribed before me this 17th
 day of December, 1879

Solon W. Allen

Notary Public Fins Co. A. T.



Preliminary Survey of the
Rancho of San Ignacio del
Batacomori. Situated in Pima
County Arizona Territory -

According to the extract from
the original grant papers
furnished by the Surveyor
General of Arizona, with
the instructions authorizing
me to execute this survey,
the Grant of San Ignacio del
Batacomori is for eight
square Mexican Leagues
of land along the course
of the Batacomori Creek
Pima County A.T. being
eight leagues in length
along the general course
of said creek and one
league in width. From

Rancho of San Ignacio del Babacomeri

Pima Co. A.T.

the said Grant papers it also appears that the central or initial point of said Grant was the Ciuega of San Ignacio del Babacomeri.

I therefore go to said Ciuega which is a prominent and well known place in the said Valley of the Babacomeri and the only Ciuega in the vicinity. Being unable after diligent search to find any traces of the original central monument I established my initial Point as follows.

Dec 17. 1879

I set a post of Walnut 4x4

Rancho of San Ignacio del Babocomon
Pinar del Rio

inches square and 4 1/2 feet long, marked S.T.B. N° 1 - one foot deep in a hole in a rock - made probably by the Indians and used as a mortar, and built a monument of stones around it according to instructions from the Surveger General.

This hole was found and post set on the summit of a small rocky knoll or ledge, the second of four which were found standing in line in line and quite near together, extending like a small broken ridge from the foot of a high Mesa which here ends in an abrupt steep bank facing

Rancho of San Ignacio del Babacomon,

Pima Co. A.T.

the Cinega, which is found just south of and near the Mustang Mountains and about three miles west of old Fort Wallen.

From the post thus set the S.E. Cor of Liberty House bears $N 77^{\circ} 24' W$ dist ~~about~~ 18 chains.

S.E. Dome of Mustang Mountains bears $N 34^{\circ} 33' E$.
Var at this point by Obs on Polaris $8^{\circ} 18' E$.

This variation increases $3^{\circ} 58'$ and becomes $12^{\circ} 16' E$ on leaving the immediate vicinity of rock upon which post is placed.

I therefore conclude that the the local attraction

Rancho of San Ignacio del Babacomori.

Pinar del Rio, N.J.

at this point deflects
the middle $3^{\circ}58' W$.

Again referring to the
Grant papers it appears
that the course run
lengthways of the Grant
was $W. S. W. \frac{1}{4} W$ and
 $E. N. E. \frac{1}{4} E$. Magnetic which
would correspond with
 $S 70^{\circ}19' W$ and $N 70^{\circ}19' E$
Magnetic or $S 82^{\circ}35' W$
and $N 82^{\circ}35' E$ True Mer.

It is better to find any
Monuments described in
the Grant papers as "ordered"
to be placed at the middle
of each side of the Grant
and to decide the proper

Rancho of San Ignacio del Babacomor

Pima Co. A.T.

chains - places for such middle points if monuments could not be found, I turned a right angle with the course above mentioned and ran

Var $12^{\circ}16'$ E by Obs on Polaris
N $7^{\circ}25'$ W

17.94 To further side of Ciénega
As we could not chain on line, I caused a flag to be set up on line at further side of bog and turning a right angle to course and measured on base of 7.57 lks. Found angle of intersection at flag to be $22^{\circ}53'$ Nat les Tow of which equal 2.369254.
Multiplying this by 7.57

Rancho of San Ignacio del Babacomori
Pima los A.S.

Chains or bars = 17.94 lhs
distances to flag on line.

As 40 Cordells are
mentioned in the Grant papers
as the distance measured
in this direction from
the center of Grant to
middle of Side line and
as one Cordell equals 50
Varas, I calculated the
distance to equal 5500
feet or 83.333 lchains
as the Vara equals 33 inches
by authority of the Commissioner
of the General Land Office
in letter to the Surveyor General
of California dated March 5, 1852

$$33 \times 50 = 1650 = 1 \text{ Cordell}$$

on varas inches

$$1650 \times 40 = 66000 \div 12 = 5500 \text{ feet}$$

Cordells inches

* and referred to in a decision of the Supreme Court of the U.S. in the case of U.S. Appealant vs. Elizabeth Peab et al. No. 143. October Term, 1888. and the common usage in California.

Rancho of San Ignacio del Batacon

Pinalco A.T.

Chains

$5500 \div 66 = 83 \text{ chains and } 22 \text{ ft}$
 or 83.333 chains .

83.333

I therefore ran on the
 course above described
 to middle of North side
 of Grant where after diligent
 search without success for
 existing monuments, I
 set a post of Walnut 4×4
 inches square 5 feet long
 marked S.I.B. N^o. 2. two feet
 in the ground and built
 a monument of stones
 around it $2\frac{1}{2}$ feet high
 as per instructions from the
 Surveyor General

From which a steep bluff
 of rocks on summit of a
 hill about 46 chains

Ranchos of San Ignacio del Babecumari
Pinalco A.T.

Chain dist bears S 49° 44' E

Returning to the center post
No 1. Iron

Var 12° 16' E by Obs on Polaris
S 7° 25' E

125.00

.60² Cordell

this being the course and
distance given in the Grant
papers to the place where a
Monument was ordered
to be placed, at middle of
south side of Grant.

Searched for Old Monuments
unsuccessfully

Dec 18th 1879

Search was resumed for a
monument not finding any
traces of one. I set a Walnut
post 4x4 inches squared

Rancho of San Ignacio del Batacomon

Pima Co. A.T.

Chains.

5 ft long marked S.I.B N° 3.
two feet in the ground
and built a monument
of stones 2 1/2 ft high as
per instructions from the
Surveyr General.



This post is on the north
slope of a spur of the Mesa
which is here cut up by steep
banked ravines.

Thence Iran

Var $12^{\circ}16'$ E by Olson Polaris
 $S 82^{\circ}35'$ W Along Southern
boundary of Grant, this
course corresponding to
the direction of the Grant

74.98 to top of steep bluff or
Mesa 40 ft high and
bounding the valley just
crossed which is here 70.00 chs

Rancho of San Ignacio del Babacomori.

Pinar Co A.T.

Chain wide.

190.81 to middle of small valley
about 5 chains wide with
steep banks to the Right
direction of
Valley bearing N.E.

227.26 Found two fine springs
15.00 chains North of this
point at foot of abrupt
bluff of sandstone beds of
which lie nearly horizontal.

Dec 19th 1879

409.27 Came to scattering trees of
Oak and Country becomes
more broken

454. Country to left became cut
up by steep ravines and
oak trees become quite
numerous on line.

560.59. Crossed large Arroyo.

Rancho of San Ignacio del Babacom

Pima Co. A.T.

Steep banks on south side

563.00 Commence to ascend hills

575.00 Top of large flat hill sloping
South. Free from trees.605.00 bottom of hill, the country
becomes smooth and
rolling no trees.

757.54 came to limestone ledges

772.69 Trees cover the country

Referring to the extract from
the original Grant papers
furnished me by the Surveyor
General of Arizona, I found
that the Grant being for
eight square leagues, and
one league wide one half
would be four leagues in
length and as one
league equals 100 Cordells

Rancho of San Ignacio del Batocomeri
Pima Co. A.T.

or 208.333 Chains four leagues
equal 833.33 Chains.

833.33 Reaching this point and
after diligent search
finding no existing mon-
-uments I set up a Cedar
post for the S.W. Corner of
Grant. Marked S, 1, B, 4
Post 4x4 inches squared
4 1/2 ft long Set one foot
in ground on edge of
Rocks with monument
of stones 2 1/2 feet high built
around it as per instruction
From which

A large oak tree 20 inches
in diameter bears S 7° 18' E
Distant 24 links. Tree
blazed on three sides - On

Rancho of San Ignacio del Babaco

Pima Co. A. T.

Chs.

side facing south the
Blaze marked "W."
North point of a high
double topped or saddle
shaped hill bears $S 82^{\circ} 35' W$
and about 15 Chains
distant.

Dec 20. 1879

To square the end of the
Grant as per instructions
from the Surveyor General
and extracts from the
Grant papers furnished by
him I here turned a
right angle to the course
run on southern boundary
and run

Var $12^{\circ} 42' E$ by Obs on Polaris
 $N 7^{\circ} 25' W$ along western

Rancho of San Ignacio de Babacomori.

Pima Co. A.T.

- chs end boundary of Grant
 60.00 To a wide ravine or ^{dry} Arroyo
 at foot of high hill covered
 with oak trees
 62.00 To North bank of same
 and foot of hill -
 83.32 Top of Hill -

December 21.

Resumed running line of
 West boundary of end of
 Grant

- 105.00 bottom of hill.
 Referring to the extract from
 original Grant papers.
 I found that at 60. cordells
 which equal 125.00 chain
 a monument was ordered
 to be placed.

After diligent search

Rancho of San Ignacio del Babacorn
Pima Co. A.T.

Chain

125.00

and finding none

At this point set a cedar post, 4x4 inches squared 5 feet long marked SIB N^o 5. Set post two feet in the ground and built a monument of stones around it 3 feet high according to instructions

The same Arroyo that we crossed at 60.00 chain approaches this point from the East and bends northward at a point about 15.00 chain distant and runs parallel with line towards the North, ~~improving on line~~
Having reached a point one Mexican League equal to 100 Cordells or

Rancho of San Ignacio del Babacomori
Pima Co. A.T.

chs

208.333 to chains from the
S.W. corner of Grant, and
after diligent search finding
no existing monuments
said to have been ordered
placed there in extracts
from Grant papers furnished
by the Surveyor General

208.333

I here set a cedar post
4x4 inches squared 4 $\frac{1}{2}$
feet high marked S 1. B. N $^{\circ}$ 6
set in ground one foot on
ledge and built a
Monument of stones around
it 3 feet high as per
instructions from the
Surveyor General
From which An Oak tree
8 inches in diameter bears
N 65 $^{\circ}$ 13' W dist 30 links

Rancho of San Ignacio del Babacom
Pima Co. A.T.

chs - An oak 16 inches in dia
blazed on three sides and
marked W on blaze facing
the post bears N $12^{\circ}42'$ W
dist 12 links.

An oak 24 inches in
diameter bears S $32^{\circ}18'$ E
dist 1.29 chains.

This post is on the
summit of a small,
detached rocky knoll
between two high ridges
of limestone and at the
head of a long narrow
valley, looking out
towards the Whetstone
and Mustang mountains.
From the corner of the
Grant thus established to
top of the S. E. Ridge

Rancho of San Ignacio del Babocomari
Pinar del Rio A.T.

0.00 - is about 16.00 chains
to top of N.W. Ridge 6.00 chs.
Bearing to N.W. Corner of
the Mustang 16 to
 $N 52^{\circ} 47' E$

Turning a right angle
at this corner I ran

Var $12^{\circ} 42' E$ by Obs on Polaris
along northern boundary
of Grant
 $N 82^{\circ} 35' E$

7.55 To ^{dry} Arroyo running N.E.
1 chain wide -

8.55 bottom of hill -

30.00 Top of hill rough on
West side, smooth on East
with some Oak trees -

45.00 bottom of hill. commencement of
Rough country cut up by Ravines
and many Oak trees.

Rancho of San Ignacio del Babacomori

Pima Co. A. T.

chains

90.90

To edge of timber and
commencement of smooth
Rolling land free from
trees.December 22nd 1879

409.00

From this point N.W. Dome
of Mustang Mountains
bears $N 27^{\circ} 46' E$.Middle Dome bears
 $N 60^{\circ} 46' E$.Two very large cedar trees
in Arroyo about 11.00 chs
to right. High bank of Mesa
on south side of Arroyo.

446.00

Country smooth to here

447.50

BANKS of ^{dry} Arroyos
crossing line from the
S.W. 2.00 to chain grid -
Babacomori Creek heads in this Arroyo.

Rancho of San Ignacio del Babacomori

Pima Co. A.T.

Chain

- 475.00 Edge of bluff of Mesa
Steep
- 606.00 Crossed Road from Camp
Crittenden to Fort Waller
and Chaleston.
From this point a
Mexican Ranch house
bears
Var $12^{\circ}16' E$ by Obs
on Polaris
- N. $25^{\circ}29' W$ distant about
30.0 chains.
- ~~636.50~~ Crossed ~~dry bed of~~
~~Babacomori Creek~~ 50 links
~~wide creek runs S.E.~~
- 606.00 From this point N.W. Dome
of Mustang Mountain
bears N $30^{\circ}16' E$.
Middle dome of same
Mountain bears N $46^{\circ}16' E$

Rancho of San Ignacio del Babacomari

Pima Co. A.T.

chs

- 606.00 Water holes at right of Road going East.
- 630.50 Crossed dry bed of Babacomari Creek 50 links wide & runs S.E.
- 636.09 Country begins to be cut up by ravines from the Mustang Mountains
- 713.11 Mc Gary House bears S 15° 11' E dist ~~about~~ 53. chains -
- 757.56 Line crosses a steep rocky spur of a high hill back of Mc Gary. Hill high to left sloping South -
- 831.97 Reached Post marked SIB No 2 already described as set for the middle point of North side of Grant. line falling 23

Rancho of San Ignacio del Batacomori.

Pisina les A.T.

links south of post.
As the north line run to
this point crossed some
steep banked ravines at West
End I assumed the distance
correct altho measured
1.36 chains short.

December 23rd 1879
Proceeded to the post
already described as set up
at middle of south side
boundary of Grant marked
S.I.B. No 3. and from
that point ran

Var $12^{\circ}16'$ by Obs on Polaris
 $N 82^{\circ}35' E$ along southern
boundary of Grant over a
country cut up by ravines
222.71 crossed a large ^{dry} Arroyo ^{mid} 75 links

Rancho of San Ignacio del Zabacocon

Pima Co. A.T.

<u>Chains</u>	
231.04	crossed road from Old Camp Wallen to Camp Huachuca
	From this point Old Fort Wallen (Middle of West Building) bears N ^o 14 E. and dist about 1 1/2 Miles
363.63	West side of steep banked Arroyo (dry) -
371.20	East bank of same.
475.75	West side of steep banked Arroyo
480.75	East side of same.
530.29	crossed a second road to Camp Huachuca
634.88	crossed a third road to Camp Huachuca -
671.29	crossed a fourth road to Camp Huachuca

Rancho of San Ignacio del Babocomori
Pinar del Rio A. J.

Chains

833.33

December 24, 1879

At this point which ^{measures} ~~is~~ ^{distance of} equal to four Mexican Leagues - I looked for a monument spoken of in the Original Grant papers as ordered to be placed there, and after diligent search finding none I set a post of Mesquite 4 x 4 inches square 5 feet long and marked S. I. B. N. 7. Two feet in the ground with mound and pits as per instructions from the Surveyor General
From which the S. E. Dome of Montang Mountain bears N 59° 28' W - Var by Obs on

Rancho of San Ignacio del Babacomá

Pima Co. A. T.

Chainon Polaris $11^{\circ}27' E$ -

Having established this S. E. Corner of Grant I turned a right Angle to course of side line to square the end of the grant according to instructions of the Surveyor General and the extracts from the Grant paper furnished and ran

Var $11^{\circ}27' E$ by Obs
on Polaris

$N 7^{\circ}25' W$ along East end
boundary of Grant.

68.00

To same road to Camp
Huachuca which we
crossed at 671.29 of side line
said road being from
San Pedro Valley

Rancho of San Ignacio del Babucumri.

Pima Co., A. T.

Chains

125.00

At 125.00 chains which equal 60 cordsells, the distance mentioned in the original Grant papers as measured from Initial line of Grant to S. E. Corner and where it is also mentioned that a monument was ordered to be placed. I searched

125.00

diligently but could find none - I therefore set a Mesquit Post 4x4 inches squared 5 feet long marked S. I. B. No 8 - set two feet in the ground with mound and pits as per instructions, from which an iron rod true 6 inches in diameter bears N 71° 32' W dist 5.68 chains.

Rancho of San Ignacio del Babacomori

Pima Co AZ.

Lohain

Continuing along East
end boundary of Grant
which equal 100 Cordells
or one league - the width of
the Grant as stated in the
original Grant papers and
when a monument was
said to have been placed
I searched diligently for
one but finding none

208.33

I have set a post of
Mesquit 6x6 inches squared
5 feet long marked S.I.B.N. 9
set two feet in the ground
with mound and pits
as per instructions - from
which a large Mesquit tree
12 inches in diameter ~~was~~
with one fork cut off
Blazed and marked W

Rancho of San Ignacio del Babacomori
Pima Co A.T.

Chain
run

bears - S 53° 54' W - dist - 4.06
Chains - This post is in a
hollow - at foot of two ridges
each about two chains dist
and bounding a hollow
that has cut the mesa
southwards from the
Babacomori Valley.

SW Cor of Merrill's House
bears N 53° 54' W dist about
60 chains -

Babacomori Creek is
dist ~~about~~ 12.12 Chains between
Post and Merrill's house.

December 25, 1879.

Turning a right angle
from the corner of East end
of Grant
Iran

Rancho of San Ignacio del Babacomori

Pima Co. A.T.

Chas

Var 11° 27' E by Obs on Polaris
 S 82° 35' W Along North
 boundary of Grant

30.30

To edge of steep bluff S.E.
 of Babacomori Creek which
 here runs N.E. and is about
 40 links wide and dry
 for a long distance West.

60.89

To Road to Chualar
 from Fort Waller running
 N.E. & S.W.

Steep bank of Mesa 30.00
 chains to left.

424.23

From this point Middle
 Dome of Mustang Mts
 bears N 72° 44' W -
 S.E. Dome bears N 36° 29' W

512.50

crossed arroyo from
 Mustang Mts running
 S.E.

Rancho of San Ignacio del Babacomori

Pima Co. A. T.

- chs
 529.16 ^{upper crossing} crossed road to San Pedro River from Fort Wallen running N. E.
 585.28 Crossed road from Old Fort Wallen to Empire Ranch by way of Gap between Mounting Mts - on the left and Whetstone Mts on the Right
 Road Run $S 5^{\circ} 14' E$ towards Fort Wallen which lies a little less than a mile away.
-

Dec 26. 1879.

continued North side
 boundary line

Var now $12^{\circ} 16' E$ by Obs
 on Polaris -

Rancho of San Ignacio del Babacomori

Pima Co. A.T.

Chain

833.33 Ended the Survey of
 Exterior Lines at post
 already described at Center
 of North Side line marked
 S.I.B. No 2

General Description

This Grant is found
 in the Valley of the
 Babacomori Creek
 its Eastern end being
 about seven miles below
 and East of old Fort
 Waller.

The N. E. Corner is
 easily found by going
 from Aberrill House
 to the last water found
 in Babacomori Creek

Rancho of San Ignacio del Babacomri.

Pinar Co A.T.

For about four miles
going up the valley
and, ^{found} in the vicinity of
4 cotton wood trees.

The post is in the first
little hollow that cuts
the steep bank of Mesa
to the South being South
of creek about 12 chains
and East of last water
about 20.00 chains.

The Grant is mostly
fine grazing land, the
Eastern half somewhat
broken by ravines coming
down from Huachuca
Mts.

The Western half very
smooth and rolling
except a small strip at

Rancho of

San Ignacio del Babacomori

Pima Co. AZ.

extreme west end which is quite broken by limstone ledges and deep ravines - The Grant ending in this direction at a range of high hills - running N and S -

On the West line water was found issuing from Sandstone ledges underlying the limstone in the large Arroyo mentioned in notes also at foot of Sandstone bluffs near middle of South side -

On the line running north from the center post No 1 to middle of North line of Grant we crossed an extensive

Rancho of San Ignacio del Babacomori
Pinar del Rio, A.T.

outcrop of limestone which
seem to dip under the
Moutang Mountains
Reappearing between
the Moutang and
Whittons -

This deposit contains
Many fossils and casts
difficult to determine
Among them were
found Spirifer's prob
of Carboniferous age
A Nodose Nautilus
resembling the Nautilus
Decoratus of Cox first
discovered in the coal
Measures of Kentucky
and what appears to be
a Productus Punctatus
of the coal Measures.

Rancho of San Ignacio del Babacomun

Pinar Co., A.T.

and the Spirifer
Bisulcatus of same
horizon were found -

At the west end the
limestone beds are very
prominent containing
Pentaculites and Emericites
age and Species undeter-
-mined -

The local Var of $3^{\circ}58'W$.
at center was limited to
a short distance

This Grant contains
34722.027 Acres

Solon M. Allis
U.S. Dep Surveyor

List of Names.

A List of the Names of Individuals employed
to assist in running, measuring, or marking the
lines and corners described in the foregoing Field
Notes of the survey of the ^{Public Boundaries of the} San Ignacia del

Sabocomori Las Grant

Pimolco Arizona Terr

Showing the respective capacities in which they
acted.

Samuel A. Mantel Chainman.

Samuel H. Van Pelt Chainman,

Thos Miller Axeman.

E. J. Partridge Flagman.

Final Oath of Assistants.

We hereby certify that we assisted Solon
M. Allis U. S. Deputy Surveyor, in
 surveying The San Ignacia del
Babocomori Land Grant

and that said Survey has been in all respects, to
 the best of our knowledge and belief, well and
 faithfully executed, and the boundary monuments
 planted according to the instructions furnished by
 the Surveyor-General.

E. Miller Assessor
Samuel A. Macdonald Chairman
E. J. Partidge Flagman

Sworn to and subscribed before me, this 29th
 day of December, 1879

Solon M. Allis
 Notary Public Pima Co AZ



Final Oath of Deputy Surveyor.

I, Solon M. Ellis

U. S. Deputy Surveyor, do solemnly swear that
in pursuance of a contract with John Wasson,
United States Surveyor-General for Arizona, bear-
ing date the 17th day of September

1879. I have well, faithfully and truly, in my
own proper person, and in strict conformity with
the instructions furnished by the Surveyor-Gener-
al, the Surveying Manual, and the laws of the
United States, surveyed all those portions of

the San Ignacio del Babacomori
Land Grant -

..... as are repre-
sented in the foregoing Field Notes as having
been surveyed under my directions; and I do
further solemnly swear that all the corners of
said surveys have been established and perpet-
uated in strict accordance with the Surveying
Manual and printed instructions, and also in ac-
cordance with the additional requirements con-

tained in circular instructions from the U. S. Surveyor-General for Arizona, dated September 1, 1873, regarding the establishment of corn boundaries of public surveys, and that the foregoing are the true and original Field Notes of such surveys.

Solon M. Ellis

Deputy Surveyor

BOOK 1762

Sworn to and subscribed before me, this 5th day of

January, 1880

John H. Faull

Notary Public

U.S. Simeyer General's Office.
Tucson, Arizona Jan. 16, 1880.

The foregoing field notes
of the preliminary survey
of the Exterior Boundaries
of the Private Land Claim
known as the Rancho of
San Ignacio del Sabasco-
mai executed by Solon
M. Ellis, D.S., under
his contract of the 17th
of September, 1879, having
been critically examined
and the necessary corre-
ctions and explanations
made, the said field notes
and the survey they describe
are hereby approved.

John Mason.
Simeyer General.