

SAN-RAFAEL DEL VALLE

PRIVATE LAND CLAIM

CONTRACT NO 95

1776

PHILIP CONTZEN
U. S. DEP. SUR

1.

1776

BOOK NO 1776

1776

4-871

1776

FIELD NOTES
GENERAL LAND OFFICE.

1776

8/8/02

Transcribed

Compared

Field Notes
of the survey of the
Extremes of the
San Rafael del Valle Private
Land Grant
Situated in Cochise County
In the
Territory of Arizona

As surveyed by
Philip Cortzen
U. S. Deputy Surveyor

Under his contract No. 95-
Dated June 20, 1902

Survey commenced July 1, 1902.
Survey completed July 10, 1902

2

Preliminary Oaths of Assistants.

We, *John M. Trayer*
and *Andrew G. Akin*

do solemnly swear that we will well and faithfully execute the duties of Chain Carriers; that we will level the chain upon even and uneven ground, and plumb the tally pins, either by sticking or dropping the same; that we will report the true distance to all notable objects, and the true lengths of all lines that we assist in measuring, to the best of our skill and ability, and in accordance with instructions given us, in the survey of the *Exteriors of*

the San Rafael Mts.
Valle Private Land Grant
situated

of the Gila and Salt River Base and Meridian, in the Territory of Arizona.

John M. Trayer Chainman.
Andrew G. Akin Chainman.

Chainman.

Chainman.

Sworn and subscribed before me, this

1st

day of

July

190 *2*

Philip Contzen

Notary Public.

U. S. Deputy Surveyor

No notary available

[SEAL.]

We, Paul Redd ^{Ind} 2A
F. C. Howard

do solemnly swear that we will well and truly perform the
duties of flagman ^{Ind} axeman

in the establishment of corners and other duties, according
to instructions given us, and to the best of our skill and
ability, in the survey of the Ex. tensions
of the San Rafael del
Valle Private Land
Grant situated partly in
Tps 21-22-23 S. Rs 21-22 E
of the Gila and Salt River Base and Meridian, in the Ter-
ritory of Arizona.

Paul Redd Flagman.

F. C. Howard Axeman.

Axeman.

Axeman.

Subscribed and sworn to before me this 1st
day of July 1902

Philip Center

Notary Public.

U. S. Deputy Surveyor
no notary available

Index for

BOOK 1777

BOOK 1776

3

”
INDEX
”

Books 1776 and
1777

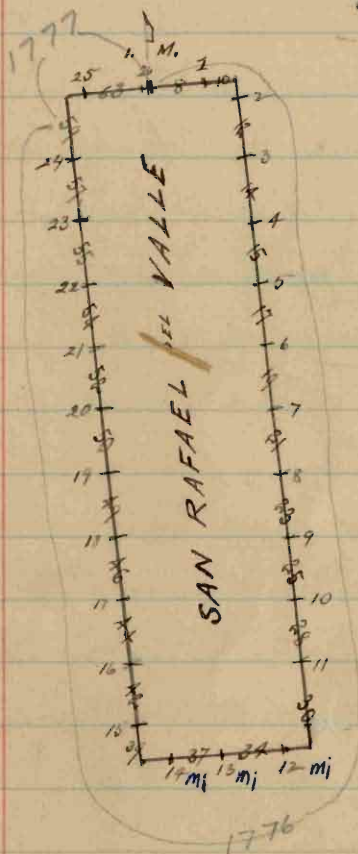

*Extrinsic of the San Rafael del
Chiriqui*

Survey commenced July 1, 1902, and
executed with a Young & Sons' light
mountain transit No. 5609, with a
Sigsbee solar attachment. The
horizontal limb being provided with
two opposite verniers reading to within
30" of an arc.

This instrument was examined on
the true meridian at Tucson,
found correct, and was approved by
the surveyor general for Arizona.
Commenced at foot on King Hill,
as described in my special instruction
dated June 20, 1902.

In order to test the solar apparatus
by comparing the results of observations
on the sun made during a.m. and
p.m. hours, with a true meridian
determined by observations on Polaris,

Puller Point Land Grant.
Chains

I proceed as follows:
At 3^h 35^m p.m., local mean time,
I set off 31' 36" on the lat arc;
23° 12' N on the decl arc, and
mark the true meridian thus de-
termined with the solar by a cross
on a stone, firmly set in the ground,
5 chains North of the instrument.
June 30, 1902.

July 1, 1902.
At 12.50 a.m. local mean time.
I observe Polaris at eastern elonga-
tion, in accordance with instructions
in the manual, and mark the
line thus determined by a tack
driven in a wooden plug set in
the ground, 5 chains North of my
station.
At 4^h 10^m a.m., I lay off the

Exterior of the San Rafael del
Chains

azimuth of Polaris 1026 to the
West and mark the true meridian.
This determined, by cutting a small
groove in the stone set last evening
on which the true meridian falls
.3 ins ^{East} of the mark determined by
the solar.

At $7^h 55^m$ a.m. I set off $81^{\circ} 30'$
on the lat arc, $23^{\circ} 9'$ N. on the
decl arc, and mark the true meri-
dian determined with the solar
by a cross on the stone already set
5 chains North of my station, this
mark falls .28 ins West of the
true meridian established by the
Polaris observation.

The solar apparatus by p.m.,
and a.m. observations defines
positions of true meridians with

Vallée Private Land Grant - Confirmed
Chains

BOOK 1776

sufficient accuracy, therefore I conclude that the adjustments of the instrument are satisfactory.

The magnetic bearing of the true meridian at 7.55 a.m. is $76^{\circ}22' W$, the angle thus determined, reduced by the table, page 100, gives the mean mag. decl. $12^{\circ}23'$ East.

From the above point I run, in compliance with my instructions, $S 13^{\circ}31'30'' E$, 91.10 chs, (6013 ft) where I establish the beginning cor of the San Rafael del Vallée Grant by setting a quartz stone $26 \times 14 \times 10$ ins, 20 ins in the ground, marked S R D V, BEG C D R on S and P L on N. faces; and pits $36 \times 36 \times 12$ ins, $S 76^{\circ}28' W$ and $N 76^{\circ}28' E$ of stone, 4 ft dist, and raise

Extension of the San Rafael del
Chinas

a mound of earth 5 ft base, 22 ft
high S. of cor.

Shiner Run

N 6° 28' 30" E on 1st Mile

Over land bottom land

Through dense mesquite undergrowth

7.30

Right bank San Pedro river, bears
Northwly and Southwly

12.60

Left bank San Pedro river, bears Northwly
and Southwly

20.74

Bank bears Northwly and Southwly

20.80

River finer, bears Northwly and Southwly

21.50

Middle of single track of the El Paso
and Southern railroad, bears Northwly
and Southwly

22.23

Telegraph wire bears Northwly and Southwly

22.26

River finer, bears Northwly and Southwly

27.10

Hazelgrain's house, corral and stable
bear S. & E. dist.

Tells Private Land Grant - Continued
Chains

BOOK 1776

9

2800 Set a granite stone, $20 \times 10 \times 10$ ins., 14 ins.
in the ground, for witness cor to
the $\frac{1}{2}$ mile cor, marked N. C., S. E. D. P.
and S. P. L. on N and $\frac{1}{2}$ M on E face,
dig pits $36 \times 36 \times 12$ ins, S $76^{\circ} 28'$ W and
N $76^{\circ} 28'$ E of stone, 4 ft dist, and raise
a mound of earth 5 ft base, 2 $\frac{1}{2}$ ft
high S of cor.

3700 Right bank of big arroyo, corner
S. W. Easterly

4200 The point for the $\frac{1}{2}$ mile cor falls in
small running stream in arroyo

4450 Left bank of arroyo, corner N. Easterly
and S. Westerly and ascend

8000 Top, corner N. Westerly and S. Easterly
Set a granite stone $22 \times 10 \times 10$ ins., 15 ins.
in the ground, for the $\frac{1}{2}$ mile cor,
marked S. R. D. V. on S. P. L. on N
and $\frac{1}{2}$ M on E face, dig pits $36 \times 36 \times 12$

Exteriors of the San Rafael del
Chains

ins, $S 76^{\circ} 28' P$ and $N 76^{\circ} 28' E$ of stone,
4 ft dist and raise a mound of earth
5 ft base, 2 1/2 ft high, S. of cor.
Land level and rolling
Soil, gravelly, and mud 3rd rate.
No timber, underground, mesquite.
Under underground, 8000 lbs.

$N 76^{\circ} 28' 30'' E$ on 2nd Mile
Corrupt Land

Through dense underground

24.50 Angle cor No. 1.

Set a spindle stone $28 \times 10 \times 10$ ins, 21 ins
in the ground, for angle cor No. 1 marked
COR A No. 1 on top, B B B on S. W.
and P L on N. E. faces, dig pits
 $36 \times 36 \times 12$ ins, $S 76^{\circ} 28' P$ and $S 33^{\circ} 31' E$
of stone ^{8 ft dist} and raise a mound of earth
5 ft base, 2 1/2 ft high, S. W. of cor

Public Private Land Grant - Continued
Chains

From this cor. Baldy peak Santa Rita
mountains, bears N $79^{\circ} 35'$ W.

Quachua peak, bears S $36^{\circ} 40'$ W

San Jose peak, Sonora, Mexico, bears
S. $19^{\circ} 40'$ E.

Turner S $13^{\circ} 31' 30''$ E

15.50 Set a granite stone $24 \times 12 \times 10$ ins, 18 ins
in the ground for the $1\frac{1}{2}$ mile cor.
marked S R D on W, P. E. on E

since $1\frac{1}{2}$ M on S. face, dig pits $36 \times 36 \times 12$
ins, W $13^{\circ} 31'$ W and S $13^{\circ} 31'$ E of stone.

4 ft chit, and raise a mound of earth
5 ft base $2\frac{1}{2}$ ft high W of cor.

31.60 Road, runs N. Easterly and S. Westerly

55.50 Completion of 2nd mile.

Set a sandstone $24 \times 10 \times 8$ ins, 18 ins in
the ground for the 2 mile cor, marked
S R D on W, P. E. on E and 2 M on

Extremes of the San Rafael del Chains

S. 13° 31' 30" E. dig pits 36 x 36 x 12 ins N. 13° 31' 40"
and S. 13° 31' E. of stone, 4 ft dist. and
raise a mound of earth 5 ft base, 2 1/2 ft
high W. of cr.

Land, gently rolling

Soil, gravelly, 2nd rate

No timber, undergrowth, mesquite, sage,
grassweed and tsetse

Dense undergrowth, 8.000 chs.

S. 13° 31' 30" E. on 3rd. Mile.

Gently rolling land.

Sparse dense undergrowth.

6.90 Dry wash, 15 lbs wide, course
Westerly.

4.00 Set a granite stone 24 x 10 x 8 ins
18 ins in the ground, for the 2 1/2
mile cr. marked S. R. D. ~~P~~ore
N. P. E. on E and 2 1/2 W. on S. 1/2 W.

Park Private Land Grant - Continued

BOOK 1776

13

Chains

dig pits $36 \times 36 \times 12$ ins, $N 13^{\circ} 31' W$
and $S 13^{\circ} 31' E$ of stone, 4 ft dist
and raise a mound of earth 5 ft
base, $2\frac{1}{2}$ ft high, P of cor.

49.50 Enter valley, leave W. side

59.50 Dry wash, 5 lbs wide, corner W. side

66.50 Leave valley.

8.00 Set a granite stone $20 \times 16 \times 12$ in
18 in in the ground, for the 3 mile
cor. marked S B D on W, P on
E and 3 M in S. General dig pits $36 \times 36 \times 12$
ins, $N 13^{\circ} 31' W$ and $S 13^{\circ} 31' E$ of stone

4 ft dist, and raise a mound of earth
5 ft base, $2\frac{1}{2}$ ft high, P of cor.

Good soil

Soil, gravelly; 2nd and 3rd rate
timber, undergrowth mesquite
and sage

Dense undergrowth, 8.00 chs.

Extrioris of the San Rafael del
Charras

- S. $3^{\circ} 31' 30''$ E on 4th Mile.
Overrolling land
Through dense undergrowth
- 13.50 Enter valley, cross M.P.
- 15.90 Road, cross N. R. R. and S. R. R.
- 36.90 Benchmark line cross N 43° W and
S 43° E
- 38.27 Middle of single track of the
El Paso and Southern railroad
cross N 43° W and S 43° E
- 4 000 Set a granite stone $20 \times 10 \times 10$ ins, 18
in the ground for the 3rd mile cor.
marked S R. R. on W, P. L. on E and
S. W. on S. face, dig pits $36 \times 36 \times 12$ ins
N $13^{\circ} 31'$ W and S $13^{\circ} 31'$ E of stone, 4 ft
dist and raise a mound of earth
5 ft, 22 ft high W of cor.
- 8 000 Set a granite stone $20 \times 10 \times 10$ ins, 14
ins in the ground for the 4 mile

Palk Private Land Grant - Continued Chinus

cor. marked S R D r on W, P L on
E and 4 M on S. faces, dig pits
36 x 36 x 12 ins, N 13° 31' W and S 13° 31' E
of stone, 4 ft dist, and raise a mound
of earth 5 ft base, 2 1/2 ft high, W of cor.
Land rolling up and level.

Soil, sandy, loam, 1st and 2nd rate
Timber, scattering mesquite, under-
growth mesquite, grasswood and
Tupelo.

Undergrowth, 8000 lbs
July 1, 1902.

S 13° 31' 30" E on 5th Mile
Very rolling land
Through dense undergrowth.

15.50 Descend

16.00 Port

16.80 Dry wash, 40 lbs wick, course for thirty

Extriors of the San Rafael del
Chains

18.00 Ascend

21.50 Top of ridge, cross Easterly and
Westerly, and descend

29.50 Post, and enter draw, corner W. Westerly

34.50 Cross draw, and ascend

4.00 Set a granite stone, $24 \times 10 \times 10$ ins, 18
in the ground, for the $4\frac{1}{2}$ mile cor,
marked S.R.R.C. on W, P.C. on E
and $4\frac{1}{2}$ M on S. face. dig pits
 $36 \times 36 \times 12$ ins. W $130^{\circ} 31'$ W and $S. 3^{\circ} 51' E$
of stone, 4 ft dist, and raise a mound
of earth 4 ft base 2 ft high W of cor.
44.50 Top cross Easterly and Westerly, and
descend.

61.30 Post, and enter draw corner Westerly

65.00 Dry wash, 10 lbs wide, corner Westerly

66.50 Leave draw

8.00 Set a granite stone, $20 \times 18 \times 10$ ins, 14
ins in the ground, for the 5 mile cor

Palle Private Land Grant-Continued

Chains

marked S R & P on W P L on E and
5 W on S. faced dig pits 36 x 36 x 12
ins. N 13° 31' W and S 133' E of stone
4 ft dist and raise a mound
of dirt 5 ft base, 2 ft high. W
of cor.

Land rolling.

Soil, gravelly, 3rd rate

No timber underground, grasswood,
sage and mesquite

Dense underground, 5000 lbs

S 13° 31' 30" E on 6th Mile.

Very rolling land

Through dense underground.

2.50 Enter draw

8.00 Snake Ranch, bare S 75° W. about
1 1/2 miles dist

17.20 Dry wash, 5 lbs wide, corner Property

Extremes of the San Rafael del Chain

37.50 Enter draw, course Westerly.

40.00 Set a granite stone $24 \times 12 \times 10$ ins, 18
ins in the ground, for the $5\frac{1}{2}$ mile
cor. marked S R D P on N, P. D. on E, and
 $5\frac{1}{2}$ on S face, dig pits $36 \times 36 \times 12$
ins, N $13^{\circ} 31'$ W and S $13^{\circ} 31'$ E of stone,
4 ft dist and raise a mound of earth
5 ft base, $2\frac{1}{2}$ ft high, W of cor.

40.50 Leave draw, and ascend

55.70 Top of ridge, leave Easterly and Westerly.

72.80 Descend to the river, course, Westerly
and around.

80.00 Set a granite stone $24 \times 12 \times 10$ ins, 18
ins in the ground for the 6 mile cor.
marked S R D P on N, P. D. on
E, and 6 M on S face, dig pits $36 \times 36 \times 12$
ins, N $13^{\circ} 31'$ W and S $13^{\circ} 31'$ E of stone, 4 ft
dist, and raise a mound of earth
5 ft base, $2\frac{1}{2}$ ft high, W of cor.

Pale Pointe Land Grant-Continued

Cond. rolling.

Soil, gravelly; 3rd rate

No timber; undergrowth, mesquite, sage,
grasswood and tobacco.

Dense undergrowth, 5000 cu.

S $13^{\circ} 31' 30''$ E on 7th Mile.

Poor land

Through dense grasswood and sage

8.70 Pop, bears N. Westerly and S. Easterly
and descend

10.00 Post, gulch 10 lbs wide, course
N. Westerly, and ascend

14.50 Pop of ridge, bears N. Westerly
and S. Easterly and descend

15.00 Road to Ramming's station, bears
N. Westerly and S. Easterly

21.50 Begin steep descent,

23.00 Post, and enter draw, course

Extremes of the San Rafael del Chains

Westerly

26.30 Cry wash, 10 lbs wide, course Westerly

28.30 Enter draw and ascend

40.00 Set a granite stone $24 \times 12 \times 8$ ins, 18
ins in the ground for the $6\frac{1}{2}$ mile
cor, marked S E S T on W, P L
on E and $6\frac{1}{2}$ M on S. from chg
posts $36 \times 36 \times 12$ ins N $130^{\circ} 31'$ W and
S $130^{\circ} 31'$ E of stone, 4 ft dist, and
raise a mound of earth 5 ft base
 $2\frac{1}{2}$ ft high W of cor.

65.50 Road, leave Easterly and Westerly

71.10 Enter wash, course Westerly

72.90 Leave wash

76.00 Begin steep ascent

77.00 Top of ridge, leave Easterly and
Westerly, and descend

80.00 Set a granite stone, $22 \times 16 \times 10$ ins, 16
ins in the ground, for the 7 mile

Talk Private Land Grant-Continued
Chains

cr. marked S. E. D. P. on N. P. L.
on E and 7 W on S. faces. dig pits
36 x 36 x 12 ins, N $13^{\circ}31'$ W and S $13^{\circ}31'$ E
of stone, 4 ft dist and raise a
mound of earth 5 ft base, $2\frac{1}{2}$ ft
high N. of cr.

Land rolling.

Soil gravelly, 3rd rate

No timber. Undergrowth, grasswood,
sage and mesquite

Lower undergrowth 8,000 lbs.

S $13^{\circ}31'30''$ E on 8th Mile

Very rolling land

Descending through dense sage
and mesquite undergrowth

2.30 Foot and enter draw, course
Westerly

3.30 Leave draw

Extrins of the San Rafael salt Chains

- 14.40 Dry wash 40 lbs wide, course
Westerly
- 28.00 Draw, 2 chs wide, course, Westerly
- 40.00 Set a granite stone $26 \times 14 \times 10$ ins, 18
ins in the ground, for the $7\frac{1}{2}$ mile
cor, marked S B D V on W P L
on E and $7\frac{1}{2}$ M on S. Pass. dig
pits $36 \times 36 \times 12$ ins, N $130^{\circ} 31'$ W
and S $130^{\circ} 31'$ E of stone, 4 ft dist
and raise a mound of earth
5 ft base, $2\frac{1}{2}$ ft high W of cor.
and enter draw, course Westerly
- 54.00 Draw draw
- 57.50 Draw, 1 ch wide, course Westerly
- 72.00 Enter draw, course Westerly
- 74.00 2 of wire fence, bars 9 lbs W
- 76.00 Draw draw
- 80.00 Set a limestone $20 \times 10 \times 10$, 14 ins
in the ground, for the 8 mile

Public Private Land Grant-Continued
Chains

cor. marked S B D on W. & L
on E and S M on S. face and
raise a mound of stone 3 ft base
3 ft high, top of cor. Its impractical
Land rolling

Soil, gravelly. 3rd and 4th rate
No timber. Undergrowth, grassweed,
brook sage and mesquite
Dense undergrowth. Saw one

July 2, 1902.

July 5, At 7^h 50^m a.m. from
Port off 31° 30' on the lat
are, 22° 50' N. on the decl are
and determining a true meridian
with the solar at the 8 mile cor.
Thence Down

S 13° 31' 30" E. on 9th Mile.
Over rolling land

Extriors of the San Rafael del
Chains

- Through dense forest, grasswood
and mesquite undergrowth
- 5.00 Dry wash, 5 lbs wide corner Westly
- 16.10 Dry wash, 40 lbs wide, corner Westly
- 18.00 Draw, 1 ch wide corner Westly
- 4.000 Set a limestone $24 \times 10 \times 10$ ins, 18 ins
in the ground, for the $8\frac{1}{2}$ mile, cor,
marked S R W on N, P K on E
and $8\frac{1}{2}$ M on S. faced dig pits
 $36 \times 36 \times 12$ ins, N $13^\circ 31'$ W and S $13^\circ 31'$ E
of stone, 4 ft dist, and raise a
mound of earth 5 ft base, $2\frac{1}{2}$ ft
high W of cor.
- 42.12 Draw, 1 ch wide corner Westly
- 52.00 Enter dry wash, corner Westly
- 57.00 Draw wash
- 68.00 Enter draw corner Westly
- 80.00 Draw drain
- Set a limestone $20 \times 10 \times 10$ ins, 15 ins

Public Private Land Hunt - Continued
Chains

in the ground for the 9 mile cor.
marked S. C. D. P. on W. S. E.
on E, and 9 W on S. face, dig pits
36 x 36 x 12 ins N 13° 31' W, and S. 13° 31' E
of stone, 4 ft dist, and raise a mound
of earth 5 ft base, 2½ ft high W
of cor.

Land, level and rolling
Soil, gravelly; 2nd and 3rd rate
No timber. Undergrowth, huckle, mus-
squito and sage.
Dense undergrowth, 8000 lbs.

S. 13° 31' 30" E, on 10th Mile.

Very rolling land

Through dense musquitos, huckle and
sage undergrowth.

- 15.50 Dry wash, 5 lbs wide, corner Westerly
18.50 Run, 1 lb wide, corner Westerly

Extriors of the San Rafael del

Chains

17 000

Set a pinestone $20 \times 10 \times 8$ ins, 14 ins
in the ground for the $9\frac{1}{2}$ mile cor
marked, S. C. & P. on N. P. & S. on E
and $9\frac{1}{2}$ M on S. face. dig pits
 $36 \times 36 \times 12$ ins, N $13^\circ 31'$ W and S $13^\circ 31'$ E
of stone, 4 ft dist, and raise a
mound of earth 5 ft base, $2\frac{1}{2}$ ft
high, N. of cor.

41.00 Draw, 2 chs under corner Westerly,
and ground

50.40 Intersect N. Edg of Sp 23, S. 1622 E,
at a point from which the cor of
lines 2, 3, 34 and 35,
which is a stone, marked and wit-
nessed as described by the surveyor
general, bears N $89^\circ 55'$ E, 23.10 chs
dist.

Set a pinestone $18 \times 8 \times 8$ ins, 12 ins
in the ground for closing cor of

Walk Private Land Hunt - Continued

Chains

fract. 540 3 and 34 marked
C on E and S R Road faces and raise
a mound of stone, 2 ft base, 12 ft
high N of cor. Site impracticable!

51.00 Pop. brass Easterly and Westerly

8.00 Set a limstone $24 \times 12 \times 10$ ins, 18
ins in the ground, for the 10 inch
cor. marked S. R. D. on W, P. L.
on E and 10 M. on S. faces. dig
pits $36 \times 36 \times 12$ ins, N $13^{\circ} 31'$ W and
S $13^{\circ} 31'$ E of stone, 4 ft dist. and
raise a mound of earth 5 ft base
22 ft high N of cor.

Land rolling

Soil gravelly. 2nd and 3rd rate.
No timber. Undergrowth, mosquito
trout and sage

Undergrowth 8000 cu

Exposures of the San Rafael del Chains

S $13^{\circ} 31' 30''$ E. on 11th Mile.

Overrolling land, ascending
through dense forest, sage and mus-
quitos undergrowth.

17.20 Road to Richards station, bears
N.E. and S.W.

4000 Set a firestone $22 \times 10 \times 8$ ins, 18 ins
in the ground, for the $10\frac{1}{2}$ mile
cor, marked S.R.D.R on W, & E
on E and $10\frac{1}{2}$ M on S. face. dig
pit, $36 \times 36 \times 12$ ins N $13^{\circ} 31' W$, and
S $13^{\circ} 31' E$ of stone, 4 ft dist, and
raise a mound of earth 5 ft base
 $2\frac{1}{2}$ ft high, N.E. cor.

5307 Buterret see line bet sres 3 and
10. Sp 23 S R 22 E, at a point
from which the cor of sres 2, 3, 10
und 11 ^{which is a strong inclined and well exposed}
^{discontinuity for the younger group} bears S $89^{\circ} 35' E$, 3.89 chs dist.
Set a firestone $18 \times 8 \times 6$ ins, 12 ins in

Path Private Land Grant - Continued
Chamie

the ground, for closing in of parcel
secs 3 and 10, marked C C on
E, S. R. D. T on W, 3 on N and
10 on S faces, and raise a mound
of stone 2 ft base, 12 ft high E of
w. This is impracticable.

68.70 Dry wash, 1 ch wide, course westerly.

69.90 Put a set of line bet secs 10 and
11, Pp 23 S, R 22 E at a point
from which the cor of secs 2, 8
10 and 11, which is a stone,
marked and witnessed as described
by the surveyor general, bears
N 00° 1' W 16.36 chs dist

Set a limestone 18 x 8 x 6 ins, 12 ins
in the ground, for closing in of
parcel secs 10 and 11, marked C C
on N and S. R. D. T on S, faces,
and raise a mound of stone 2 ft

Extrins of the San Rafael del Chimins

base, $12\frac{1}{2}$ ft high, N of cor. Pits
impracticable.

8.000 Set a limestone $24 \times 16 \times 12$ ins, 18 ins
in the ground for the 11 mile cor,
marked S $16^{\circ} 31'$ on N, R $13^{\circ} 31'$ on E,
and 11 M on S. fwers. dig pits
 $36 \times 36 \times 12$ ins, N $13^{\circ} 31'$ W and S $13^{\circ} 31'$ E
of stone, 4 ft dist and raise a
mound of earth 5 ft base, $2\frac{1}{2}$ ft
high, W of cor.

Land, rolling and level.

Soil, sandy and gravelly; 2nd and
3rd rate.

No timber, undergrowth, sage and
greasewood.

Dense undergrowth, 8.000 chs.

S $13^{\circ} 31' 30''$ E on 12th Mch.
Over gently rolling land

Roll Tracts Land Grant Continued
Chain

BOOK 1776

31

through dense mesquite, greasewood
and sage

4 cor. Set a limestone $28 \times 8 \times 8$ ins, 20 ins
in the ground, for the $11\frac{1}{2}$ mile
cor, marked S R S on W, R L
on E. and $11\frac{1}{2}$ M on S. facs. dig
pits $36 \times 36 \times 12$ ins, N. $13^{\circ}31'$ W. and
S. $13^{\circ}31'$ E. of stone, 4 ft dist, and
raise a mound of earth 5 ft base,
 $2\frac{1}{2}$ ft high, W of cor.

56.13. Intersect sec line, bet secs 11 and
14, S. $23^{\circ}3'$ E. 22 E. at a point from
which the 4 cor of secs 11 and 14,
which is a monument marked and
witnessed, as described by the surveyor
general, bears N $89^{\circ}58'E$ 24.82 chs dist.
Set a limestone $18 \times 8 \times 6$ ins, 12 ins
in the ground, for closing cor of
tract secs 11 and 14, marked

Extriors of the San Rafael del
Chains

CC on E, and S.R.D.P. on N face,
dig pits $24 \times 18 \times 12$ ins, E 7 ft, and
N $13^{\circ} 31'$ W of stone, $80 \times 24 \times 12$ ins, 3
ft dist, and raise a mound of earth
4 ft base, 2 ft high E of cor.

60.56

Angle cor No 2.

Set a limestone $24 \times 16 \times 12$ ins, 18 ins
in the ground, for angle cor No. 2,
marked CORA No 2 on top, S.R.D.P.
on N.W. and P.L. on S.E. face.
dig pits $36 \times 36 \times 12$ ins N $13^{\circ} 31'$ W
and $S 76^{\circ} 28'$ W of stone, 8 ft dist,
and raise a mound of earth 5 ft
base, $2\frac{1}{2}$ ft high, N.W. of cor.

From this cor. San Goor sprak,
Sonora, Mexico, bears $S 29^{\circ} 25' E$
Mustung sprak bears $N 53\frac{1}{2}^{\circ} W$

Turner $S 76^{\circ} 28' 30" W$

Public Private Land Grant - Continued

Chains
16.94 Intersect sec line bet secs 14 and 15, $\text{Ch } 23 \text{ S. } 16 \text{ x } 6$, at a point from which the $\frac{1}{2}$ cor of secs 14 and 15 bear $\text{S } 0^\circ 1' \text{ E. } 30.68 \text{ chs}$ dist. Set a granite stone $18 \times 6 \times 4 \text{ ins}$, 12 ins in the ground, for closing cor of parcel secs 14 and 15, marked C.C. on S and S.B. & P. on N. facs. dig pits $24 \times 18 \times 12 \text{ ins}$ S 7 ft and $\text{N } 76^\circ 28' \text{ E}$ of stone 3 ft dist, and raise a mound of earth 4 ft base 2 ft high S of cor.

19.49 Completion of 12th Mile.

Set a granite stone $20 \times 16 \times 12 \text{ ins}$ 18 ins in the ground, for the 12 mile cor, marked $\text{S } 16 \text{ D } 16 \text{ on N.}$ $\text{P } 16 \text{ on S.}$ and 12 M on W facs. dig pits $36 \times 36 \times 12 \text{ ins}$ $\text{N } 76^\circ 28' \text{ E}$ and $\text{S } 76^\circ 28' \text{ W}$ of stone

Extremes of the San Rafael del
Chocoma

4 ft dist
and raise a mound of earth 5 ft
base, 2 1/2 ft high, N. of cor.

land, level and rolling

Soil gravelly; 3rd rate

No timber, undergrowth mesquite,
trotas and sage.

Undergrowth 8,000 lbs

July 5, 1902

S 76° 28' 30" W on 13th Mile

Very rolling land

Through dense mesquite and trotas
undergrowth

30.40 Dried

34.00 Port, and into San Pedro Valley,
cross Northward and Southward

36.40 Road cross Northward
and Southward and cross undergrowth

39.67 River from San N. N. Northward

Upper Spruett Land Grant - Continued

and S. S. Easterly

(40.00 Set a granite stone $20 \times 12 \times 10$ ins
14 ins in the ground, for the $12\frac{1}{2}$
mile cor, marked S. R. D. on N
T. Cor S and $12\frac{1}{2}$ M on N. Pass.
dig pits $36 \times 36 \times 12$ ins, $N 76^{\circ} 28' E$
and $S 76^{\circ} 28' W$ of stone, 4 ft
dist, and raise a mound of
earth 5 ft base, $2\frac{1}{2}$ ft high, N
of cor.

40.40 Pin fence, cross N. N. W. Easterly
and S. S. Easterly

40.80 Litch, 8 lbs wide corner N. Easterly

45.95 Litch 15 lbs wide corner N. Easterly
and enter plowed land

50.38 Pin fence, cross N. N. W. and S. S. E.
and enter alfalfa field

66.66 Pin fence, cross N. N. W. and S. S. E.
and leave field.

Public Private Land Grant - Continued
 Chain

mound of earth 4 ft base, 2 ft high,
 S of cor.

8.00 Set a granite stone 20 x 10 x 8 ins, 14
 ins in the ground, for the 13 mile
 cor marked S R L on N. P L
 on S and 13 M on N face. dig
 pits 36 x 36 x 12 ins, N $76^{\circ}25'E$, and
 $S 76^{\circ}25'N$ of stone 4 ft dist, and
 raise a mound of earth 5 ft
 base, 2 ft high, N of cor.

Land, level and rolling
 Soil, gravelly, 1st and 3rd rate
 Timber, cottonwood along ditches,
 undergrowth, grasswood and
 brush

Drain undergrowth 36.40 chs
 $S 76^{\circ}28'30'N$ on 14th Mile
 Cor level land

7.80 San Pedro river (branch) 30 chs

Extremes of the San Rafael del
Chinus

- with course Northerly
- 19.42 River runs Northerly and
Southerly
- 22.00 Cross Valley and ascend and enter
dense grassland and mesquite un-
dergrowth, runs Northerly and Southerly
- 28.00 Fox runs Northerly and Southerly
- 40.00 Set a sandstone $24 \times 10 \times 8$ ins, 15 ins
in the ground for the 13 $\frac{1}{2}$ mile cor,
marked S.E. & on N, P.E. on S,
and 13 $\frac{1}{2}$ M on N face. dig pits
 $36 \times 36 \times 12$ ins, N $76^{\circ}28'E$ and S $76^{\circ}23'W$
of stone, 4 ft dist and raise a
mound of earth 5 ft base, 2 $\frac{1}{2}$ ft
high N of cor
- 42.00 Run down undergrowth, runs N
and S
- 50.00 Set a sandstone $20 \times 12 \times 10$ ins 14
ins in the ground, for the 14 mile

Public Private Land Grant - Continued

Chains

cor marked S. R. S. Pon N. P. L.
 on D. and 14' W on D. facing dig
 pits $36 \times 36 \times 12$ ins, N $76^{\circ} 28'$ E and
 S $76^{\circ} 28'$ W of stone, 4 ft dist, and
 raise a mound of earth 5 ft base,
 2 1/2 ft high N of cor.
 Land, level and rolling
 Soil gravelly; 2nd and 3rd rate.
 No timber. undergrowth grasswood,
 mesquite and shrubs.
 Minor undergrowth. 2000 lbs.

S $76^{\circ} 28' 30''$ W on 15th Mile
 Over level land

2, 16 Intersect sec line bet secs 16 and
 17 S. R. S. Pon E, at a point
 from which the cor of secs 16, 17,
 20 and 21, which is a reduced post
 marked and introduced as described

Chains

Extremity of the San Rafael del

by the survey general, bears $50^{\circ} 2' E$,
32.36 chs dist,

Set a sandstone $18 \times 10 \times 6$ ins, 12 ins
in the ground, for closing cor of
fracl sec 16 and 17, marked C C on
S. and S. B. D. V on N. face. dig
pits $24 \times 18 \times 12$ ins S 7° ft and
 ~~$30 \times 24 \times 12$ ins~~
S $76^{\circ} 28' W$ of stone, 3 ft dist, and
raise a mound of earth 4 ft base
2 ft high, S of cor

29.56 Angler cor No. 3.

Set a sandstone $24 \times 16 \times 12$ ins, 20 ins
in the ground, for angle cor No. 3,
marked C O R A No 3 on top S B D V
on N E and P. L. on S. W. face.
dig pits $36 \times 36 \times 12$ ins N $76^{\circ} 28' E$
and N $13^{\circ} 31' W$ of stone, 8 ft dist
and raise a mound of earth
5 ft base, $2\frac{1}{2}$ ft high N E of cor.

Walla Walla Land Grant - Continued
Chains

from which San Poor peak, Souwa
Mexino, bears $S 84^{\circ} 45' E$. high peak
bears $S 76^{\circ} N$. Carri peak, Cona-
clinea mountain, bears $S 84^{\circ} 15' W$.

Plumer $N 13^{\circ} 31' 30'' N$.

10.44 Set a granite stone $20 \times 12 \times 8$ ins, 14
ins in the ground, for the $14\frac{1}{2}$
mile, or, marked S B D on E,
P L on W and $14\frac{1}{2}$ M on N face, dig
pits $36 \times 36 \times 12$ ins, $S 13^{\circ} 31' E$
and $N 13^{\circ} 31' W$ of stone, 4 ft dist
and raise a mound of earth 5 ft
high, 2 ft high E of cor.

Completion of 15 mile
30.44 Set a granite stone, $20 \times 12 \times 8$ ins, 14
ins in the ground for the 15 mile
or, marked S B D on E, P L
on W and 15 M on N face. dig
pits $36 \times 36 \times 12$ ins $S 13^{\circ} 31' E$ and

Extremis of the San Rafael del
Chamie

N $13^{\circ} 31'$ W of stone, 4 ft dist,
and raise a mound of earth
5 ft base, 22 ft high E of cor.
Land, gently rolling
Soil, gravelly, 2nd and 3rd rate.
No timber, undergrowth, scattering
muscquitos.

N $13^{\circ} 31' 30''$ W on 16th Mile
Over land

4.53 Pin finer, bears W $82^{\circ} 2'$ W and
S $82^{\circ} 2'$ E.

5.09 Intersect see line bet sees 8 and
17, Sp 23, S. Rec E, at a point
from which the $\frac{1}{4}$ cor of sees 8
and 17, which is a rounded post,
marked and witnessed as described
by the surveyor general, bears
N $89^{\circ} 58'$ W, 40 fms dist.

Public Private Land Grant - Continued
 Charms

Set a sandstone $18 \times 8 \times 6$ ins, 12 ins in
 the ground, for showing cor of parcel
 8 and 17 marked W on W and
 S. R. D. V on E face, dig pits
 $24 \times 18 \times 12$ W, 2 ft, and $30 \times 24 \times 12$ ins
 S $13^{\circ} 31' E$
 of stone, 8 ft dist, and raise a
 mound of earth 4 ft base, 2 ft
 high W of cor.

17.10 Road, from Easterly and Westerly

23.30 Road, from Easterly and Westerly

4.00 Set a granite stone $20 \times 14 \times 8$ ins, 14
 ins in the ground, for the 15 $\frac{1}{2}$
 with cor marked S. R. D. V on
 E, P. C. on W and 15 $\frac{1}{2}$ W on
 N face, dig pits $36 \times 36 \times 12$ ins
 S $13^{\circ} 31' E$ and N $13^{\circ} 31'$ W of stone
 4 ft dist, and raise a mound of
 earth, 5 ft base, 2 $\frac{1}{2}$ ft high
 E of cor.

Extremes of the San Rafael del

Chains

1. 8000

Set a sandstone $20 \times 14 \times 10$ ins,
14 ins in the ground, for the 16
mile cor, marked S R D Pon C
P on W and 16 M on N. faces;
dig pits $36 \times 36 \times 12$ ins, S $13^{\circ} 31' \frac{8}{1}$ and
N $13^{\circ} 31'$ W of stone, 4 ft dist, and
raise a mound of earth 5 ft base
 $2\frac{1}{2}$ ft high, E of cor.

Land level and gently rolling
Soil, sandy; and and 3rd rate
No timber. Undergrowth, scattering
mesquite

July 6, 1902.

N $13^{\circ} 31' 30''$ W on 17^{th} Mile
Very gently rolling land

4.45 Old road runs N. Easterly and
S. Westerly

7.32 Intersect sec five bet sec 5 and

Public Private Land Grant - Continued
Chains

8, Apr 23 S. 162 E. at a point from which the cor of sec 5, 6, 7 and 8, which is a rounded post marked and witnessed as described by the surveyor general, bears West 21, 31 the dist.

Set a granite stone $15 \times 8 \times 8$ ins, 12 ins in the ground, for closing cor of frac l sec 5 and 8, marked C C on W and S. B. D P on E faces, dig pits $24 \times 18 \times 12$ ins, W 7 ft and $30 \times 24 \times 12$ ins, S $13^{\circ} 31'$ E, of stone, and ^{3 ft dist} raise a mound of earth 5 ft base, $2\frac{1}{2}$ ft high W of cor.

40.00

Set a granite stone $24 \times 14 \times 10$ ins, 18 ins in the ground, for the $16\frac{1}{2}$ mile cor, marked S. B. D P on E, P. L. on W and $16\frac{1}{2}$ M on N faces, dig pits $36 \times 36 \times 12$ ins, S $13^{\circ} 31'$ E. and

Exterior of the San Rafael del

Chains

N $13^{\circ}31'$ W, of stone, 4 ft dist, and
raise a mound of earth 5 ft base,
 $2\frac{1}{2}$ ft high, E of cor.

8.000 Set a granite stone $20 \times 10 \times 8$ ins,
14 ins in the ground, for Sta 17 mile
cor, marked S. R. D. Pen E. P.D.
on N and 17 W on N face, dig
pits $36 \times 36 \times 12$ ins S $13^{\circ}31'$ E. and
N $13^{\circ}31'$ W of stone, 4 ft dist, and
raise a mound of earth 5 ft base,
 $2\frac{1}{2}$ ft high, E of cor.

Land gently rolling.

Soil, gravelly; 2nd and 3rd rate.

No timber. Undergrowth scattering
mossy mts.

N $13^{\circ}31'30''$ W on 18th Mile.

Over gently rolling land.

9.55 Intersect N. by of Sp 23 S

Pall's Private Land Grant - returned
Chamie

BOOK 1776

412

R 22 E, at a point from which
the cor of sec 5, 6, 31 and 32, which
is a railroad post, marked and
returned as described by the surveyor
general, bears $S 89^{\circ} 55' W$ ^{2.03} ~~1.44~~ the
dist.

Set a granite stone $15 \times 8 \times 6$ ins, 12
ins in the ground, for closing cor of
fracl sec 5 and 6 marked C C
on W, and S. E. D P on E faces.
Dig pits, crosswise on each line,
 $24 \times 18 \times 12$ ins W, 7 ft and $30 \times 24 \times 12$ ins
 $S 13^{\circ} 31' E$ of stone 3 ft dist and give a
mound of earth 4 ft base, 2 ft high W of cor

20.50

Run fence, bears N. Easterly and
S. Westerly, and enter dense mesquite
undergrowth

23.70

Dry wash, 80 lbs wide, course N.
Easterly

Extremes of the San Rafael del

Chains

4000

Set a granite stone $20 \times 10 \times 8$ ins, 14 ins in the ground for the 17½ mile cor, marked S R D P on E, P. L. on W and 17½ M on N face. dig pits $36 \times 36 \times 12$ ins S $13^{\circ} 31'$ E and N $13^{\circ} 31'$ W of stone, 4 ft dist, and raise a mound of earth 5 ft base, 2½ ft high, E of cor.

54.17 Run finer, base N $16\frac{1}{2}^{\circ}$ E and S $76\frac{1}{2}^{\circ}$ W

8000 Set a granite stone $24 \times 12 \times 12$ ins, 18 ins in the ground for the 18 mile cor, marked S R D P on E, P. L. on W and 18 M on N face. dig pits $36 \times 36 \times 12$ ins S $13^{\circ} 31'$ E and N $13^{\circ} 31'$ W of stone, 4 ft dist and raise a mound of earth 5 ft base, 2½ ft high, E of cor.

Land polling

Public Private Land Grant - Continued.

Chama

Soil, sandy and gravelly, 2nd and 3rd rate

No timber, undergrowth grass, oak, sage, mesquite and Arctostaphylos.

Cross undergrowth, 59.50 ch.

N. 3° 31' 30" W on 19th Mile.

Very gently rolling land

Plough dense mesquite undergrowth

21.60 Road runs N. Easterly and S. Westerly

4.000 Set a granite stone, 24 x 12 x 12 ins, 18 ins in the ground, for the 18th mile cor, marked S. B. D. on E. S. E. on W and 18th M on N. face, dig pits 36 x 36 x 12 ins, S 13° 31' E and N 13° 31' W of stone, 4 ft dist and raise a mound of earth 6 ft base, 2¹/₂ ft high, E of cor.

Entrance of the San Rafael del
Chunio

57.45 Dry wash, 170 yds wide, course E.

8.00 Set a granite stone $20 \times 14 \times 12$ ins
14 ins in the ground for the 19
mih cor, marked S E D P on E,
P. E. on W, and 19 W on N. face,
dig pits $36 \times 36 \times 12$ ins, $E 13^{\circ} 31' E$
and $W 13^{\circ} 31' W$ of stone, 4 ft dist,
and raise a mound of earth
5 ft base, 2 1/2 ft high, E of cor.
Land rolling
Soil, rich loam, 1st, 2nd and 3rd
rate.

No timber, underground, mosquito.
Dense underground, 8000 chi.

$N 13^{\circ} 31' 30'' W$, on 20th Mih.
Very rolling land

Through dense mosquito underground
16.20 Road, runs Easterly and Westerly

Roll Private Land Grant - Continued

Chain

4.000

Set a granite stone $22 \times 14 \times 12$ ins,
16 ins in the ground, for the $19\frac{1}{2}$
mile cor. marked S R D P on E, P L
on W and $19\frac{1}{2}$ W on N face. dig
pits $36 \times 36 \times 12$ ins, S $13^{\circ} 31'$ E and
N $13^{\circ} 31'$ W of stone, 4 ft dist, and
a mound of earth 5 ft base, $2\frac{1}{2}$ ft
high, E of cor.

raise

43.50 Draw a line wide, course Easterly
50.50 Enter valley, bears Easterly and
Westerly

64.50 Leave valley

68.00 Ranch house, bear 18 chs E.

73.70 Road, bears N. Easterly and S. Westerly

8.000 Set a sandstone $26 \times 16 \times 12$ ins, 20
ins in the ground, for the 20
mile cor. marked S R D P on E
P L on W and 20 W on N face.
dig pits $36 \times 36 \times 12$ ins, S $13^{\circ} 31'$ E

Chunio

Exterior of the San Rafael del
and $N 13^{\circ} 31' W$ of stone, 4 ft dist
and raise a mound of earth 5 ft
base, 22 ft high, 6 of cor.

Land rolling

Soil, sandy and gravelly, 1st and
3rd rate.

No timber undergrowth, mesquite
Dense undergrowth, 8000 cbs

July 8, 1902.

July 9, 1902. At 7^h 40^m a.m. l.m.t.
Set off $31^{\circ} 31'$ on the lat arc,
 $22^{\circ} 26' N$ on the decl arc, and
determine a true meridian with
the solar at the 20 miles cor
Plumer P.m.
 $N 13^{\circ} 31' 30'' W$ on 21st mile
Very rolling land
Plumage dense mesquite undergrowth

Public State Land Grant - Continued

Chasie

4 000

Set a granite stone $20 \times 10 \times 8$ ins, 14 ins in the ground for the $20\frac{1}{2}$ mile cor. marked S. E. & V on E, P. L. on W and $20\frac{1}{2}$ W on N. faces, dig pits $36 \times 36 \times 12$ ins, S. $13^{\circ} 31'$ E and N $13^{\circ} 31'$ W of stone, 4 ft dist, and raise a mound of earth 5 ft base $2\frac{1}{2}$ ft high, E of cor.

8 000

Set a granite stone $20 \times 10 \times 10$ ins, 14 ins in the ground for the 21 mile cor, marked S. E. & V on E, P. L. on W and 21 W on N. faces, dig pits $36 \times 36 \times 12$ ins, S. $13^{\circ} 31'$ E and N $13^{\circ} 31'$ W of stone, 4 ft dist, and raise a mound of earth 5 ft base, $2\frac{1}{2}$ ft high E of cor.

Gravel, rolling

Soil, sandy and gravelly, 2nd and 3rd rates.

Chains

Exposure of the San Rafael del
No timber, undergrowth, mesquite
and tosta.
Dense undergrowth, 8000 chs.

N $13^{\circ} 31' 30''$ W on 22nd Mile
Very rolling land

Through dense undergrowth

4000 Set a granite stone $26 \times 10 \times 8$ ins,
20 ins in the ground, for the $21\frac{1}{2}$
mile cor, marked S R D W on E
P. L. on W and $21\frac{1}{2}$ M on N side,
dig pits $36 \times 36 \times 12$ ins, S $13^{\circ} 31'$ E
and N $13^{\circ} 31'$ W of stone, 4 ft dist
and raise a mound of earth 5 ft
base, $2\frac{1}{2}$ ft high E of cor.

57.40 Discovered

64.60 Port, and enter R. V. brand, course
Easterly

65.90 Enter dry creek, banks 10 ft high,

North Point Land Grant - Continued

Chains

corner N. Easterly

69.60 Grace Creek

74.60 Run Road

8.00 Set a granite stone $20 \times 10 \times 6$ ins, 14
ins in the ground, for the 22 mile
cor. marked S B D P on E P L on
N and 22 M on N. face. dig
into $36 \times 36 \times 12$ ins, S $13^{\circ} 31'$ E, and
N $13^{\circ} 31'$ W of stone, 4 ft dist. and
raise a mound of earth 5 ft base
22 ft high E of cor.
Land rolling

Soil, gravelly. 3rd rate.

Pinch, Cottonwoods, walnuts and ash
in grass, undergrowth, magnolia and
Sycamore

Dense undergrowth, 8.00 chs

N $13^{\circ} 31'$ W on 23rd Mile

Chambers

Exterior of the San Rafael isl
 Original land

Through snow underground

4000 Set a granite stone $24 \times 14 \times 10$ ins,
 18 ins in the ground, for the 22 $\frac{1}{2}$
 mile cor, marked S R D P on E
 P L on W and 22 $\frac{1}{2}$ M on N face. dig
 pits $36 \times 36 \times 12$ ins, S $13^{\circ} 31'$ E
 and N $13^{\circ} 31'$ W of stone, 4 ft dist,
 and raise a mound of earth 5 ft
 base, 2 $\frac{1}{2}$ ft high, E of cor.

8000 Set a granite stone $20 \times 8 \times 6$ ins, 14
 ins in the ground for the 23 mile
 cor, marked S R D P on E, P L
 on W and 23 M on N face. dig
 pits $36 \times 36 \times 12$ ins, S $13^{\circ} 31'$ E and
 N $13^{\circ} 31'$ W of stone, 4 ft dist, and
 raise a mound of earth 5 ft base
 2 $\frac{1}{2}$ ft high, East of cor
 Hand rolling.

Public Private Land Grant - Continued
 Chains

Soil, gravelly, 2nd and 3rd rate.
 No timber, undergrowth, mesquite
 and sage
 Lower undergrowth, 8000 lbs.

N $13^{\circ} 31' 30''$ R on 24th Mile

Overgrowing (and
 Blunt) dense mesquite and sage.

20.42 In dirt fence

22.45 Put a stake S. E. of Pt 2, S. R. E.
 at a point from which the $\frac{1}{4}$ cor of
 sec 1 and 36, which is a stone.

marked and witnessed as prescribed
 by the surveyor general, Trans. Dist.
 4.40 chs. East

Set a sandstone $18 \times 8 \times 6$ ins, 12 ins
 in the ground, for closing cor of
 parcels 1 and 36, marked C
 on W and S R D P on E faces.

Chains

Stations of the San Rafael del

Dig pits crosswise on each line
 30 x 24 x 12 ins, S $13^{\circ}31'$ E 3 ft and
 W of stone 7 ft dist, and raise a
 mound of earth 4 ft base, 2 ft
 high, N of cor.

23.80 Dig wash, 100 lbs. weight, corner A.
 Easterly.

38.25 Cor of wire fence.

40.00 Set a granite stone 24 x 16 x 12 ins
 18 ins in the ground for the 23 $\frac{1}{2}$
 mile cor, marked S E D P on E
 S on N, and 23 $\frac{1}{2}$ W on N. face,
 dig pits 36 x 36 x 12 ins, S $13^{\circ}31'$ E
 and N. $13^{\circ}31'$ W of stone, 4 ft dist
 and raise a mound of earth 5 ft
 base, 2 $\frac{1}{2}$ ft high, E of cor.

80.00 Set a granite stone 22 x 14 x 10 ins
 16 ins in the ground for the ²⁴~~25~~
 mile cor, marked S E D P on E

Public Private Land Grant - Continued

Chains

P. E. on N. and 24 W. on N. face,
dig pits $36 \times 36 \times 12$. ins, S $13^{\circ} 31' E$ and
N $13^{\circ} 31' W$ of stone, 4 ft dist, and
raise a mound of earth 3 ft base
2 1/2 ft high, E of cor.

Land rolling.

Soil, sandy and gravelly, and
and 3rd rate.

No timber, undergrowth, twigs,
mosses and sage.

Shrub undergrowth 8 or 9 ft.

July 9, 1902.

N $13^{\circ} 31' 50'' W$ on 25th Mile.

Our gently rolling land

through dense undergrowth

24.46 Intersect sec timber bet secs 25 and
36, Sp 21 S, R 21 E, at a point
from which the cor of secs 25, 26

Extriors of the San Rafael del
Quinto

35 and 36, which is a railroad
post, marked and witnessed
as described by the surveyor
general, trans N. 25.12 E. dist-
Set a granite stone $18 \times 8 \times 6$ ins, 12
ins in the ground, for closing cor
of gravel sec 25 and 36, marked
C C on N, S R D on E face.
dig pits crosswise on rock line,
 $30 \times 24 \times 12$ ins, S $13^{\circ} 31' E$, 3 ft and
 $24 \times 18 \times 12$ ins N of stone, 7 ft dist
and raise a mound of earth 5 ft
base, 2 1/2 ft high, W of cor

27.25

~~27.25~~

Drillstone line from water works
to Timberline, trans N. Easterly and
S. Westerly

4000

Set a granite stone $22 \times 10 \times 8$ ins,
16 ins in the ground, for the 24th
mile cor, marked S R D on E