

No 1

1985

1985

15-13

BOOK 1985

1985

4-671

1985

FIELD NOTES

GENERAL LAND OFFICE.

SUBDIVISIONS

PAPAGO INDIAN RESERVATION.

T. 15 S. - R. 13 E.

1985

BOOK 1985
 BOOK 1986
 BOOK 1987

Index for

INDEX.

Township 15 South, Range 13 East.

GILA AND SALT RIVER MERIDIAN.

6	5	4	3	2	1
		143.			
		142.			
		140			
		139			
		137			
		135			
		134			
		132			
		130			
		126			
		127			
		123			
		121			
		118			
		116			
		112			
		108			
		105			
		101			
		97			
		93			
		89			
		86			
		85			
		81			
		78			
		75			
		71			
		67			
		64			
		60			
		56			
		52			
		49			
		45			
		44			
		41			
		38			
		35			
		30			
		27			
		23			
		20			
		16			
		12			
		8			
		4			
		3			

Referring the lines to the pages of the field notes.

Meridian Line,
 Base Line,

Township No. 15 S Range No. 13 E Meridian.

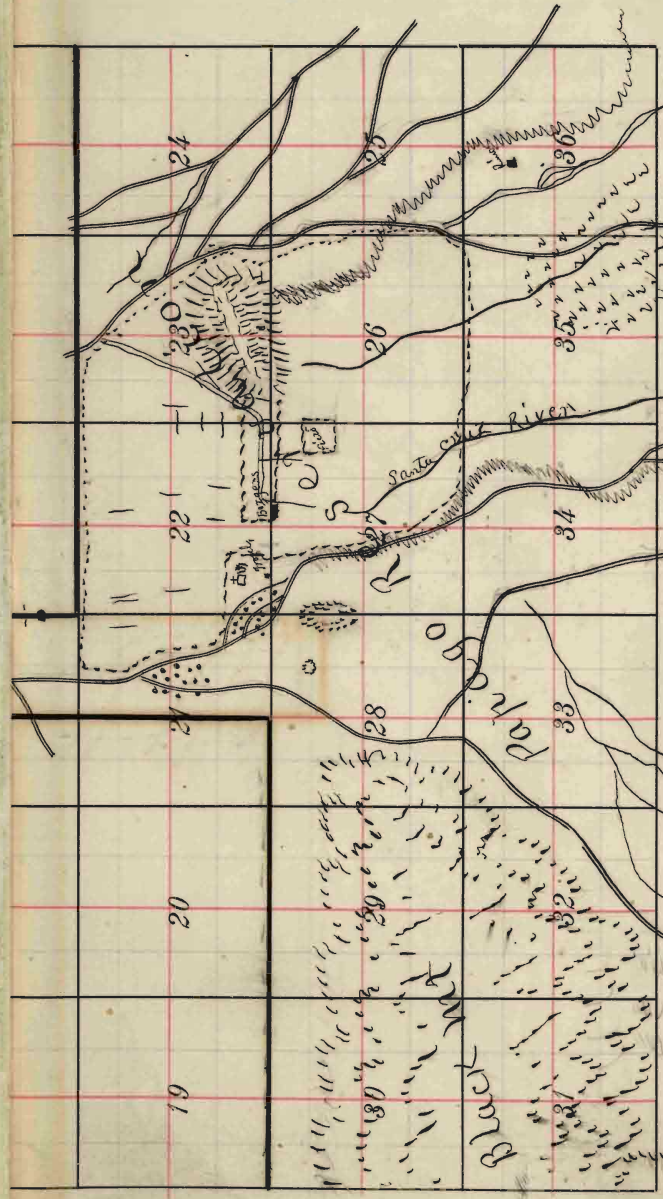

Crocker's Blank No. 1903-TOWNSHIP PLAT. 80 CHAINS TO 1 INCH. H. S. Crocker & Co., San Francisco and Sacramento, Cal.

Meridian Line,
Base Line,

Field Notes
of the Survey of the
Subdivisions Lines
of
Township No 15 South
Range 13 East
in the
Papago Indian Reservation
of the
Gila and Salt River
Meridian
of Arizona
as Surveyed by
L. D. Phillips
U. S. Deputy Surveyor
Under his contract - No 8 -
Dated Nov 30th 1888
Survey commenced Feby 15th 1888
Survey completed Feby 21st 1888.

Subdivisions T15S R13E in

Preliminary to commencing this survey I run a line on a Blank line on the south Boundary of Sec. 36 and at 20.01 chs found the $\frac{1}{16}$ Sec Cor at 39.97 chs found the $\frac{1}{4}$ Sec. Cor. at 60.04 chs found the $\frac{1}{16}$ Sec Cor at 80.04 chs found the Sec Cor

Thence from the Cor to Secs 31 & 36 I run north on a Blank line between Secs 31 & 36. and at 19.96 chs found the $\frac{1}{16}$ Sec Cor at 40.03 chs found the $\frac{1}{4}$ Sec Cor at 60.04 chs found the $\frac{1}{16}$ Sec Cor at 80.00 chs found the Sec Cor My compass will therefore run the same line as the exterior boundaries and the chaining practically agrees

Survey commenced Feb 15th 1888. with a Survey Solar Transit

BOOK 1985
Papago Indian Reservation. 3

Beginning at the Standard
Corner to Secs 35 + 36 in T
15 S, R 13 E, which is a post
4 ft long 4 ins of. set firmly
in the ground marked S.C.
T 15 S, R 13 E on N
S 36 on E and
S 35 on W faces, with
1 notch on E and 5 notches
on W faces, with pits 18 x
18 x 12 ins N, E + W of
post 5 1/2 ft dist, I ran
North bet secs 35 + 36
Var 13° 10' E.

14.42 Gulch 15 ft deep, 50 lbs wide
course N.W.

20. Set a post 3 ft long 3 ins of
with charred stake 12 ins in
ground for 1/6 Sec cor marked
1/16. Pow W face dug pits 18

#

BOOK 1985
Subdivisions

x 18 x 12 mis N + S of post
5 1/2 ft dist and raised mound
of earth 1 1/2 ft high 3 1/2 ft base
around post. This corner
is in mesquite thicket.

Thence E on a random
line thro' S 1/2 of sec 36
Var 13° 10' E

- .80 Old Road. Bears N + S
- 2. Heavy timber.
- 20. Set tempy 1/16 Sec cor
- 39. Old Road. Bears NW + SE
- 40. Set tempy 1/16 Sec cor.
- 60. Set tempy 1/16 Sec cor.
- 62.50 Lease heavy timber and
enter sandy mesa.
- 80.09 Intersect East Boundary
Township 11 R. South of 1/16
Sec cor
Thence S 89° 55' W on a

T 15 S. R 13 E

true line thro $S \frac{1}{2}$ of sec
36 with same var.

- 20.02 Set a post 3 ft long 3 ins off
with charred stake 12 ins in
ground for $\frac{1}{16}$ Sec cor marked
 $\frac{1}{16}$ S on W face dug pits
 $18 \times 18 \times 12$ ins E + W of post
 $5 \frac{1}{2}$ ft dist and raised a
mound of earth $1 \frac{1}{2}$ ft high
 $3 \frac{1}{2}$ ft base around post.
from which a mesquite
6 ins diam bears $N 87^\circ$
W 14 lbrs dist marked
 $\frac{1}{16}$ S.B.T.

A mesquite 5 ins diam
bears $S 42^\circ E 37$ lbrs dist
marked $\frac{1}{16}$ S.B.T.

- 40.04 Set a post 3 ft long 3 ins off
with charred stake 12 ins
in ground for $\frac{1}{16}$ Sec cor

Subdivisions

marked $\frac{1}{16}$ Low N face,
 dug pits $18 \times 18 \times 12$ ins E
 + W of post $5\frac{1}{2}$ ft dist and
 raised mound of earth $1\frac{1}{2}$
 ft high $3\frac{1}{2}$ ft base around
 post from which a mesquite
 8 ins diam bears $N 15^\circ E$
 2.5 lbs dist marked $\frac{1}{16}$ S
 B. T.

A mesquite 3 ins diam
 bears $N 4^\circ W$ 92 lbs dist
 marked $\frac{1}{16}$ S. B. T.

60.06 Set a post 3 ft long 3 ins of
 with charred stake 12 ins
 in ground for $\frac{1}{16}$ Sec cor
 marked $\frac{1}{16}$ Low N face
 dug pits $18 \times 18 \times 12$ ins E
 + W of post $5\frac{1}{2}$ ft dist and
 raised mound of earth $1\frac{1}{2}$
 ft high $3\frac{1}{2}$ ft base around

T 15 S. R 13 E

post from which a mesquite
8 mi's drain bears $S 14^{\circ} W$
52 lks dist marked $\frac{1}{16}$
S.B. T.

72.07 A Mesquite 14 mi's drain.

80.09 The $\frac{1}{16}$ Sec cor.

Land for 62.50 chs level
bottom, with Soil 1st rate,
for 17.50 chs level mesa
with Soil 2nd rate

Mesquite timber and
Brush 80 chs.

Thence North bet secs
35 and 36

Var $13^{\circ} 10', E$

1.60 Old Road bears N + S.

14. Enter heavy timber.

18. Leave heavy timber

20. The old $\frac{1}{4}$ Sec cor. Set a

Subdivisions

post 3 ft long 3 in dia with
 charred stake 12 in in ground
 for $\frac{1}{4}$ Sec cor, marked $\frac{1}{4}$ S
 on W face, dug pits 18 x 18
 x 12 in E + W of post $5\frac{1}{2}$
 ft dist and raised mound
 of earth $1\frac{1}{2}$ ft high $3\frac{1}{2}$ ft
 base around post from
 which a mesquite 14 in dia
 bears S 8° W 148 lbs
 dist marked $\frac{1}{4}$ S.B.T.
 A mesquite 12 in dia
 bears N $10^{\circ} 20'$ W 132 lbs
 dist marked $\frac{1}{4}$ S.B.T.

Thence East on road down
 line thro centre of sec 36
 Var $13^{\circ} 10' E$

20. Set tempy $\frac{1}{16}$ Sec cor
 25.50 old Road bears N + S.
 31. Enter prairie

- 32.80 Old Road bears N & S
- 40.00 Set temporary $\frac{1}{4}$ Sec cor
43. Leave Bottom ^{and frame} and ascend mesa.
- 56.50 Dry wash 60 lks wide
course N.W.
60. Set temporary $\frac{1}{16}$ Sec cor
- 80.10 Intersect East Boundary
Township 14 lks S of $\frac{1}{4}$
Sec cor
Thence ^{run} S $89^{\circ} 54'$ W on
a true line thro centre of
Sec 36 with same var.
- 20.02 Set a post 3 ft high 3 ins of
with charred stake 12 ins in
ground for $\frac{1}{16}$ Sec cor
marked $\frac{1}{16}$ S on N face
dug pits $18 \times 18 \times 12$ ins E
& W of post $5\frac{1}{2}$ ft dist and
raised mound of earth $\frac{1}{2}$

Subdivisions

ft high $3\frac{1}{2}$ ft base around post
 from which a mesquite 12
 mis down bears $N 85^\circ E$
 34 lvs dist marked $\frac{1}{16}$
 S.B.T.

A mesquite 8 mis down
 bears $S 14^\circ W$ 63 lvs dist
 marked $\frac{1}{16}$ S.B.T.

40.05 Set a post 3 ft long 3 mis of
 with charred stake 12 mis
 in ground for $\frac{1}{4}$ Sec or
 marked $\frac{1}{4}$ Sec on N face,
 dug pits $18 \times 18 \times 12$ mis E
 + W of post $5\frac{1}{2}$ ft dist ^{and}
 raised a mound of earth
 $1\frac{1}{2}$ ft high $3\frac{1}{2}$ ft base a-
 round post, which is set
 in the frame.

60.07 Set a post 3 ft long 3 mis of
 with charred stake 12 mis

T 15 S, R 13 E.

BOOK 1985

11

in ground for $\frac{1}{16}$ Sec cor,
marked $\frac{1}{16}$ Tow N face, dug
pits $18 \times 18 \times 12$ ins E + W
of post $5\frac{1}{2}$ ft dist and
raised mound of earth
 $1\frac{1}{2}$ ft high $3\frac{1}{2}$ ft base a -
round post from which a
mesquite 5 ins diam bears
 $S 45^\circ E$ 30 lks dist marked
 $\frac{1}{16}$ S. B. T.

A mesquite 7 ins diam bears
 $S 84^\circ E$ 57 lks dist marked
 $\frac{1}{16}$ S. B. T.

80.10 The $\frac{1}{4}$ Sec. cor.

Land for 43 chs level
bottom and soil 1st rate,
for 37 chs level mesa and
soil 2nd rate

Mesquite Timber and Pinal
for 80 chs.

Subdivisions

Thence North bet secs

35 + 36

Var $13^{\circ} 10' E$.

20. Set a post 3 ft long 3 in of
with charred stake 12 in
in ground for $\frac{1}{16}$ Sec cor
marked $\frac{1}{16}$ S on W face
dug pits $18 \times 18 \times 12$ in N
& S of post $5\frac{1}{2}$ ft dist ^{and}
raised a mound of earth
 $1\frac{1}{2}$ ft high $3\frac{1}{2}$ ft base
around post, which is
in mesquite thicket.

Thence East on random
line thro N $\frac{1}{2}$ of sec 36

Var $13^{\circ} 10' E$.

20. Set tempy $\frac{1}{16}$ Sec cor
21. old Road bears N + S
21.50 Enter Prairie
30. Leave Prairie and enter

mesquite timber.

- 31.50 Old corral 15 lRs S.
 40. Lettempy $\frac{1}{16}$ Sec cor.
 42. Leave bottom and ascend
 mesa.
 60. Lettempy $\frac{1}{16}$ Sec cor
 65.68 Old Road bears N.W. + S.E.
 80.11 Intersect East Boundary
 Township 4 lRs N of $\frac{1}{16}$
 Sec cor

Thence Run N $89^{\circ} 58'$
 W on a true line thro N $\frac{1}{2}$
 of sec 36 with same var

- 20.02 Set a post 3 ft long 3 in ϕ
 with charred stake 12 ins
 in ground for $\frac{1}{16}$ Sec cor
 marked $\frac{1}{16}$ S on N face
 dug pits 18 x 18 x 12 ins E
 + W of post 5 $\frac{1}{2}$ ft dist and
 raised a mound of earth

17

BOOK 1985

Subdivisions

1 1/2 ft high 3 1/2 ft base a -
round post, from which a
mesquite 6 ins diam bears
N 87° W 10 lks dist marked
1/16 S.B.T.

A mesquite 8 ins diam,
bears S 13° E 33 lks dist
marked 1/16 S.B.T.

40.05 Set a post 3 ft long 3 in dia
with charred stake 12 ins
in ground for 1/16 Sec cor
marked 1/16 S on N face
dug pits 18 x 18 x 12 ins E
& W of post 5 1/2 ft dist,
and raised mound of
earth 1 1/2 ft high 3 1/2 ft
base around post from
which a mesquite 8 ins in
diam bears N 85° E 6
lks dist marked 1/16 S.B.T.

T 13 S. R 13 E

A mesquite 4 in diam,
bearing $S 52^{\circ} W$ 16 lbs
dist marked $\frac{1}{16}$ L.B.T.

60.08 Set a post 3 ft long 3 in dia
with charred stake 12 in
in ground for $\frac{1}{16}$ Sec cor
marked $\frac{1}{16}$ S on N face
dig pits 18 x 18 x 12 in E
& W of post $5\frac{1}{2}$ ft dist and
raised mound of earth $\frac{1}{2}$
ft high $3\frac{1}{2}$ ft base around
post. The corner is in a
mesquite thicket.

80.11 The $\frac{1}{16}$ Sec cor.

Land for 42 chs, level
bottom and soil 1st rate, for
38 chs level mesa and soil
2nd rate

Mesquite timber and brush
80 chs

Subdivisions

These North lot sees
35 + 36

Var $13^{\circ} 10' E$

20. The old sec cor. I set a post 4 ft long 4 ins dia with charred stake 12 ins in ground for cor to sees 25, 26, 35 + 36 marked T 15 S, S 25 on N.E. R 13 E. S 36 on S.E. S 35 on SW and S 26 on NW faces. with 1 notch on S and 1 notch on E edges, dug pits $18 \times 18 \times 12$ ins in each section $5\frac{1}{2}$ ft dist and raised mound of earth 2 ft high $4\frac{1}{2}$ ft base around post. This corner is in an open space near

The corner of wire fence
and on E side of old road

Land for 80chs bet
secs 35 + 36 level bottom
and soil 1st rate

Mesquite timber and
Brush for 80chs.

Thence East on random
line bet secs 25 + 36

Var $13^{\circ} 10' E$

11.80 Old Road bears NW + SE

20. Set tempy $1/16$ Sec cor

33. Ascend mesa,

40. Set tempy $1/4$ Sec cor

56.40 Old Road bears NW + SE

60. Set tempy $1/16$ Sec cor

80.14 Intersect East Boundary
Township 11 lth. S cor to
secs 25, 30, 31 + 36

Subdivisions

Thence Iron $S 89^{\circ} 55' W$
on a true line bet sees 25
+ 36 with same bar.

20.03 Set a post 3 ft long 3 in of
with charred stake 12 in in
ground for $\frac{1}{16}$ Sec cor ^{marked}
 $\frac{1}{16}$ on N face dug pits 18
 \times 18 \times 12 in E + W of post
5 $\frac{1}{2}$ ft dist and raised a
mound of earth 1 $\frac{1}{2}$ ft
high 3 $\frac{1}{2}$ ft base around
post

40.07 Set a post 3 ft long 3 in of
with charred stake 12 in in
ground for $\frac{1}{4}$ Sec cor,
marked $\frac{1}{4}$ on N face,
dug pits 18 \times 18 \times 12 in
E + W of post 5 $\frac{1}{2}$ ft dist
and raised mound of
earth 1 $\frac{1}{2}$ ft high 3 $\frac{1}{2}$ ft

T 15 S. R 13 E.

base around post. The
old corner obliterated.

- 60.10 Set a post 3 ft long 3 in of
with charred stake 12
ins in ground for $\frac{1}{16}$
See cor marked $\frac{1}{16}$ Low
N face dug pits 18 x 18 x 12
ins E + W of post $5\frac{1}{2}$ ft
dist and raised mound
length $1\frac{1}{2}$ ft high $3\frac{1}{2}$ ft
base around post from
which a mesquite 6 ins
diam bears N 23° E 14
lks dist marked $\frac{1}{16}$ S.P.T.
A mesquite 5 ins diam
bears S 13° E 34 lks dist
marked $\frac{1}{16}$ S.P.T.

- 80.14 The cor to secs 25, 26, 35, 36.
Laud for 33 chs level
bottom soil 1st rate, for

Subdivisions

47 chs level mesa and
 soil 2nd - rate
 mesquite timber and Brush
 for 80 chs

Thence North betsees
 25 + 26

Var $13^{\circ} 10' E$,

- .55 old Road bears N + S.
2. The wire fence of Papago enclosure bears N + S
20. Set a post 3 ft long 3 in dia with charred stake 12 in in ground for $\frac{1}{16}$ Sec cor marked $\frac{1}{16}$ S on W face dug pits $18 \times 18 \times 12$ in N. + S of post $5\frac{1}{2}$ ft dist and raised a mound of earth $1\frac{1}{2}$ ft high $3\frac{1}{2}$ ft base around post, which

T 15 S. R 13 E

is in Papago pasture.

Thence East on random
line thro $5\frac{1}{2}$ of sec 25

Var $13^{\circ} 10'$ E.

- .47 Cross wire fence ^{bears} "N + S".
- 1.20 Old Road bears "N + S"
- 18.70 Leave Valley ^{and ascend mesa}
20. Set tempy $\frac{1}{16}$ Sec cor
40. Set tempy $\frac{1}{16}$ Sec cor
53. Old Road bears NW + SE
60. Set tempy $\frac{1}{16}$ Sec cor
- 80.07 Intersect East Boundary
Township of LR S of $\frac{1}{16}$
Sec cor. ^{Shun}
- Thence $S 89^{\circ} 57' W$ on a
true line thro $5\frac{1}{2}$ of Sec
25 with same var
- 20.01 Set a post 3ft long 3 in dia of
with charred stake 12 in
in ground for $\frac{1}{16}$ Sec cor.

22
BOOK 1985

Subdivisions

marked $\frac{1}{16}$ S on N face,
dug pits $18 \times 18 \times 12$ ins E
+ W of post $5\frac{1}{2}$ ft dist
and raised a mound of
earth $1\frac{1}{2}$ ft high $3\frac{1}{2}$ ft
base around post.

40.03 Set a post 3 ft long 3 ins off
with charred stake 12 ins
in ground for $\frac{1}{16}$ Sec cor
marked $\frac{1}{16}$ S on N face
dug pits $18 \times 18 \times 12$ ins E
+ W of post $5\frac{1}{2}$ ft dist
and raised mound of
earth $1\frac{1}{2}$ ft high $3\frac{1}{2}$ ft
base around post.

60.04 Set a post 3 ft long 3 ins off
with charred stake 12 ins in
ground for $\frac{1}{16}$ Sec cor, marked
 $\frac{1}{16}$ S on N face dug pits 18
 $\times 18 \times 12$ ins E + W of post

T 15 S. R 13 E

5 1/2 ft dirt and raised a
mound of earth 1 1/2 ft high
3 1/2 ft base around post

80.07 The 1/6 Sec cor.

Land for 18 chs level
bottom and soil 1st rate,
for 52 chs level mesa and
soil 2nd rate.

Scattering trees

mesquite Brush 80 chs

Feb 15th 1888

Thence North bet secs

25-426

Var 13° 10' E

12. Ascend mesa course N + S

13.50 Enter mesquite thickets.

20. Set a post 3 ft long 3 in dia
with charred stake 12 in
in ground for 1/4 Sec cor.
marked 1/4 S on W face

Subdivisions

dug pits $18 \times 18 \times 12$ ins N
 + S of post $5\frac{1}{2}$ ft dist,
 and raised a mound of
 earth $1\frac{1}{2}$ ft high $3\frac{1}{2}$ ft
 base around post. The
 old corner is obliterated,
 and trees cut down but
 the stumps remain.

Hence East on railroad
 line thro center of sec 25
 Var $13^{\circ} 10' E$,

- .51 Papago wire fence bears NW
 + S.E.
- 7.25 Old Road bears N + S.
20. Let tempy $\frac{1}{16}$ Sec cor
- 36.50 Old Road bears NW + S.E.
- 39.90 Road bears E + W
40. Let tempy $\frac{1}{4}$ Sec cor
60. Let tempy $\frac{1}{16}$ Sec cor
- 80.11 Intersect East Boundary

T 15 S. R 13 E

Township 4 lbs S of 1/4

Sec cor Iron

Thence $S 89^{\circ} 58' W$ on
a true line thro center of
Sec 25 with same var

20.02 Set a post 3 ft long 3 in ϕ
with charred stake 12 in
in ground for 1/6 Sec cor
marked 1/6 S on N face
dug pits 18 x 18 x 12 in
E & W of post 5 1/2 ft dist
and raised mounds of earth
1 1/2 ft high 3 1/2 ft base
around post from which
a mesquite 12 in diam
bears $S 89^{\circ} E$ 60 lbs
dist marked 1/6 S.B.T.

40.024 Set a post 3 ft long 3 in ϕ
with charred stake 12 in
in ground for 1/4 Sec cor

Subdivisions

marked $\frac{1}{4}$ Low N face
dug pits $18 \times 18 \times 12$ mis E
+ W of post $5\frac{1}{2}$ ft dist
and raised mound of
earth $1\frac{1}{2}$ ft high $3\frac{1}{2}$ ft
base around post.

60.07 Set a post 3 ft long 3 mis off
with charred stake 12 mis
in ground for $\frac{1}{16}$ Sec cor
marked $\frac{1}{16}$ Low N face
dug pits $18 \times 18 \times 12$ mis
E + W of post $5\frac{1}{2}$ ft dist
and raised mound of
earth $1\frac{1}{2}$ ft high $3\frac{1}{2}$ ft
base around post, from
which a mesquite 7 mis
in drain bears $N 70^\circ E$
85 lbs dist marked $\frac{1}{16}$
S.B.T.

80.11 The $\frac{1}{4}$ Sec cor

T 15 S. R 13 E

Land level mesa

Soil 2nd rate

Scattering trees

mesquite Bush rocks

Thence North bet secs

25 + 26

Var $13^{\circ} 10'$ E.

4. 80 Cross Papago fence: it
bears NW + SE.

20. Set a post 3 ft long 3 in
Ø with charred stake 12
in in ground for $\frac{1}{16}$ Sec cor
marked $\frac{1}{16}$ S on W face
dug pits 18 x 18 x 12 in N +
S of post $5\frac{1}{2}$ ft dist and
raised a mound of earth
 $1\frac{1}{2}$ ft high $3\frac{1}{2}$ ft base a-
round post, which is in
a mesquite thicket.

Subdivisions

Thence East on random
line thro $N\frac{1}{2}$ of sec 25
Var $13^{\circ} 10' E$.

- 6.30 old Road bears $N + S$.
 17.50 old Road bears $NW + SE$.
 20. Set tempy $\frac{1}{16}$ Sec cor
 40. Set tempy $\frac{1}{16}$ Sec cor
 60. Set tempy $\frac{1}{16}$ Sec cor
 73.60 Road, bears $NW + SE$.
 80.03 Intersect East Boundary
 Township 3 R₂ N of $\frac{1}{16}$ Sec
 cor.

Thence Run $N 89^{\circ} 59' W$
 on a true line thro $N\frac{1}{2}$ of
 Sec 25 with same var

- 20.01 Set a post 3ft long 3ins ϕ
 with charred stake 12 ins
 in ground for $\frac{1}{16}$ Sec cor
 marked $\frac{1}{16}$ S on N face,
 dug pits $18 \times 18 \times 12$ ins E

T I S S . R I B E .

4 w of post 5 1/2 ft dist
 and raised around of
 earth 1 1/2 ft high 3 1/2 ft
 base around post, from
 which a mesquite 9 mis
 drain bears S 45° E
 14 lrs marked 1/16 S.B.T.

40.01

Set a post 3 ft long 3 mis of
 with charred stake 12 mis
 in ground for 1/16 Sec cor
 marked 1/16 Low N face
 dug pits 18 x 18 x 12 mis E
 4 w of post 5 1/2 ft dist
 and raised around of
 earth 1 1/2 ft high 3 1/2 ft
 base around post from
 which a mesquite tree 8 mis
 drain bears N 57° E 35
 lrs dist marked 1/16 S
 B.T.

Subdivisions

60.02 Set a post 3 ft long 3 ins dia
with charred stake 12 ins
in ground for $\frac{1}{16}$ Sec cor
marked $\frac{1}{16}$ S on N face
dug pits 18 x 18 x 12 ins E
& W of post $5\frac{1}{2}$ ft dist and
raised a mound of earth
 $1\frac{1}{2}$ ft high $3\frac{1}{2}$ ft base a
round post, from which
a mesquite tree 5 ins diam
bears $S 5^{\circ} 15' E$ 25 lks
dist marked $\frac{1}{16}$ S.B.T.

80.03 The $\frac{1}{16}$ Sec cor
Land level mesa
Soil 2nd rate
Scattering trees
mesquite Bush 80 chs

Thence N bet secs 25

Var $13^{\circ} 10' E$

5. Old road bears NW + SE

20. The old sec cor. I set a post 4 ft long 4 ins off with charred stake 12 ins in ground for cor to sec 23. 24. 25. 26. marked

T 15 S, S 24 on NE

R 13 E, S 25 on SE

S 26 on SW and

S 23 on NW faces with 2 notches on S and 1 notch on E edges, dug pits $18 \times 18 \times 12$ ins in each sec $5\frac{1}{2}$ ft dist and

raised a mound of earth 2 ft high $3\frac{1}{2}$ ft base around post from which a mesquite 9 ins diam bears N of $5^{\circ} 30' W 27$

Subdivisions

lks dist marked T15S,
R13E S23 BT.

Land for 32 chs bet
secs 25 + 26 level bottom
and soil 1st rate, for 48
chs level mesa and soil 2nd-
rate.

Scattering trees and trees
quite brush for 80 chs

These East on Raudown
line bet secs 24 + 25

Var $13^{\circ} 10'$ E,

- 4.30 Road bears NW + SE
20. Set tempy $1/16$ Sec cor
37. Road bears NW + SE
40. Set tempy $1/4$ Sec cor
54.70 old Road bears N + S
60. Set tempy $1/16$ Sec cor
80.01 Intersect East Boundary

T 15 S. R 13 E.

Township 4 lrs S of cor
to secs 19, 24, 25, + 30

Thence Iron $S 89^{\circ} 58'$
W on a true line bet secs
24 + 25 with same var
20. Set a post 3 ft long 3 ins of
with charred stake 12 ins
in ground for $\frac{1}{16}$ Sec cor
marked $\frac{1}{16}$ S on N face
dug pits 18 x 18 x 12 ins E
+ W of post $5\frac{1}{2}$ ft dist
and raised mound of
earth $1\frac{1}{2}$ ft high $3\frac{1}{2}$ ft
base around post from
which a mesquite 5 ins
diam bears $S 4^{\circ} E 28$
lrs dist marked $\frac{1}{16}$ S
B T

40. Set a post 3 ft long 3 ins of
with charred stake 12 ins

Subdivisions

in ground for $\frac{1}{4}$ Sec cor
 marked $\frac{1}{4}$ S on N face
 dug pits $18 \times 18 \times 12$ ins E
 + W of post. $5\frac{1}{2}$ ft diet
 and raised mound of
 earth $1\frac{1}{2}$ ft high $3\frac{1}{2}$ ft
 base around post. The old
 cor obliterated.

60. Set a post 3 ft long 3 ins sq
 with charred stake 12 ins
 in ground for $\frac{1}{16}$ Sec cor
 marked $\frac{1}{16}$ S on N face dug
 pits $18 \times 18 \times 12$ ins E + W
 of post $5\frac{1}{2}$ ft diet and
 raised mound of earth $1\frac{1}{2}$
 ft high $3\frac{1}{2}$ ft base around
 post from which a meepute
 5 ins drain bears $S 17^\circ W$
 14 lks dist marked $\frac{1}{16}$
 S.B.T

T 15 S, R 13 E.

80.01 The cor to secs 23.24.25
+26.

Land level mesa

Soil 2nd rate

Scattering trees

mesquite Brush rocks

Thence North bet secs
23 + 24

Var $13^{\circ} 10'$ E

5.30 Old Road bears NW + SE.

20. A mesquite tree 5 ins in
diameter which I mark R $\frac{1}{16}$
S on W face for $\frac{1}{16}$ Sec cor
dug pits $18 \times 18 \times 12$ ins N
+ S of tree $5\frac{1}{2}$ ft dist
and raised mound of
earth around tree.

Thence East on random
line thro $S\frac{1}{2}$ of sec 24

Subdivisions

Var $13^{\circ} 10' E$,

3.10 Road bears NW & SE

20. Set tempy $\frac{1}{16}$ Sec cor

35.40 Road bears E & W

40. Set tempy $\frac{1}{16}$ Sec cor60. Set tempy $\frac{1}{16}$ Sec cor80.04 Intersect East Boundary
Township 5 lks N of $\frac{1}{16}$ Sec cor.Thence I run N $89^{\circ} 58' W$
on a true line thro $5\frac{1}{2}$ of sec
24 with same var20.01 Set a post 3 ft long 3 ins of
with charred stake 12 ins
in ground for $\frac{1}{16}$ Sec cor
marked $\frac{1}{16}$ S on N face dug
pits $18 \times 18 \times 12$ ins E & W
of post $5\frac{1}{2}$ ft dist and
raised mound of earth
 $1\frac{1}{2}$ ft high $3\frac{1}{2}$ ft base a
round post from which a

T 15 S, R 13 E

mesquite 4 mis down bears
 $N 80^{\circ} W 15$ lrs dist marked
 $\frac{1}{16}$ S.B.T.

40.02 Let a post 3 ft long 3 mis of
 with charred stake 12 mis
 in ground for $\frac{1}{16}$. See cor.
 marked $\frac{1}{16}$ Pow N face
 dug pits $18 \times 18 \times 12$ mis E
 + W of post $5\frac{1}{2}$ ft dist
 and raised around of
 earth $1\frac{1}{2}$ ft high $3\frac{1}{2}$ ft
 base around post

60.03 Let a post 3 ft long 3 mis of
 with charred stake 12 mis in
 ground for $\frac{1}{16}$. See cor
 marked $\frac{1}{16}$ Pow N face
 dug pits $18 \times 18 \times 12$ mis E
 + W of post $5\frac{1}{2}$ ft dist and
 raised mound of earth $1\frac{1}{2}$ ft
 high $3\frac{1}{2}$ ft base around post.

Subdivisions

80.04 The $\frac{1}{16}$ Sec cor
 Landlocked mesa.
 Soil 2nd rate
 Scattering trees
 Mesquite Bush rocks

Thence North bet sees

23 + 24

Var $13^{\circ} 10' E$

2. Road bears NW + SE
- 14.60 Road bears NW + SE
20. Set a post 3 ft long 3 ins of
 with charred stake 12 ins in
 ground for $\frac{1}{4}$ Sec cor marker
 $\frac{1}{4}$ S on W face dug pits 18
 \times 18 \times 12 ins N + S of post $5\frac{1}{2}$
 ft dist and raised mound
 of earth $1\frac{1}{2}$ ft high $3\frac{1}{2}$ feet
 base around post, from
 which a mesquite 8 ins diam

T 15 S, R 13 E

bears $N 5^{\circ} E$ 12 lrs dist
marked $\frac{1}{4}$ S.B.T. The
old corner obliterated.

Thence East on random
line thro center of sec 24
Var $13^{\circ} 10' E$.

4.85 Dry wash 3 lrs wide course
N.W.

5.15 Road bears N + S

20. Let tempy $\frac{1}{16}$ Sec cor

30.30 Road bears N + S.

40. Let tempy $\frac{1}{4}$ Sec cor

60. Let tempy $\frac{1}{16}$ Sec cor

80. Intersect East Boundary
Township 9 lrs S of $\frac{1}{4}$
Sec cor

Thence Run $S 89^{\circ} 56' W$
on a true line thro cen of
Sec 24 with same var.

20. Set a post 3 ft long 2 ins of

Subdivisions

with charred stake 12 ins in
ground for $\frac{1}{16}$ Sec cor^{marked}
 $\frac{1}{16}$ P on N face dug pits
18x18x12 ins E & W of post
5 $\frac{1}{2}$ ft dist and raised a
mound of earth 1 $\frac{1}{2}$ ft high
3 $\frac{1}{2}$ ft base around post.

40.

Set a post 3 ft long 3 ins of
with charred stake 12 ins in
ground for $\frac{1}{4}$ Sec cor^{marked}
 $\frac{1}{4}$ P on N face dug pits
18x18x12 ins E & W of
post 5 $\frac{1}{2}$ ft dist and raised
mound of earth 1 $\frac{1}{2}$ ft high
3 $\frac{1}{2}$ ft base around post

60.

Set a post 3 ft long 3 ins of
with charred stake 12 ins in
ground for $\frac{1}{16}$ Sec cor,
marked $\frac{1}{16}$ P on N face
dug pits 18x18x12 ins E &

T 15 S, R 13 E.

W of post 5 1/2 ft dist and
raised a mound of earth
1 1/2 ft high 3 1/2 ft base a
round post.

80.

The 1/4 Sec cor.

Land mostly level mesa

Soil 2nd rate

No trees

Greasewood Bush 80chs

Thence North bet secs 23

+24

Var 13° 10' E

6.

Drywash 3000s wide
course N.W.

20.

Set a post 3 ft long 3 ins off
with charred stake 12 ins
in ground for 1/16 Sec cor
marked 1/16 Pow W face dug
pits 18 x 18 x 12 ins N + S of

Subdivisions

post $5\frac{1}{2}$ ft dict and raised
a mound of earth $1\frac{1}{2}$ ft high
 $3\frac{1}{2}$ ft base around post.

Thence East on random
line thro $N\frac{1}{2}$ of sec 24

Var $13^{\circ} 10' E$

5.60 Road bears $N + S$

20. Settempy $\frac{1}{16}$ Sec cor

20.75 Road bears $N + S$

40. Settempy $\frac{1}{16}$ Sec cor

60. Settempy $\frac{1}{16}$ Sec cor

80.05 Intersect East Boundary
Township 6 lks N of $\frac{1}{16}$ Sec
cor

Thence I run $N 89^{\circ} 58'$
 W on a true line thro $N\frac{1}{2}$ of
Sec 24 with same var

T 15 S. R 13 E

- 20.01 Set a post 3 ft long 3 ins of
with charred stake 12 ins
in ground for $\frac{1}{16}$ Sec cor
marked $\frac{1}{16}$ S on N face
dug pits 18 x 18 x 12 ins E
& W of post 5 $\frac{1}{2}$ ft dist and
raised a mound of earth
1 $\frac{1}{2}$ ft high 3 $\frac{1}{2}$ ft base a
round post.
- 40.02 Set a post 3 ft long 3 ins of
with charred stake 12 ins in
ground for $\frac{1}{16}$ Sec cor
marked $\frac{1}{16}$ S on N face
dug pits 18 x 18 x 12 ins E
& W of post 5 $\frac{1}{2}$ ft dist and
raised a mound of earth
1 $\frac{1}{2}$ ft high 3 $\frac{1}{2}$ ft base a
round post.
- 60.03 Set a post 3 ft long 3 ins of
with charred stake 12 ins in

Subdivisions

ground for $\frac{1}{16}$ Sec cor marked
 $\frac{1}{16}$ Low N face dug pits 18
 $\times 18 \times 12$ ins E + W of post
 $5\frac{1}{2}$ ft dist and raised a
mound of earth $1\frac{1}{2}$ ft high
 $3\frac{1}{2}$ ft base around post.

80.05 The $\frac{1}{16}$ Sec cor

Land level mesa

Soil 2nd rate

No trees

Greenswood Bush rocks

Thence North on random
line bet secs 23 + 24

Var $13^{\circ} 10' E$

19.10 Intersect North Boundary
of Reservation 45 lrs E of
cor to secs 13.14, 23 + 24

Thence from $S 1^{\circ} 21' E$
on a true line bet secs 23 +

T 15 S, R 13 E

24 with same var

19.10 The $\frac{1}{16}$ Sec cor

Land for 80 chs bet secs

23 + 24 mostly level mesa.

Soil 2nd rate

Scattering trees for 40

chs: No trees for 40 chs.

Greasewood Bush 80 chs

Thence from cor to secs
34 + 35 on South Boundary
Township I run North bet
secs 34 + 35

20. Set a post 3 ft long 3 ins of
with charred stake 12 ins
in ground for $\frac{1}{16}$ Sec cor
marked $\frac{1}{16}$ S on W face dig
pits 18 x 18 x 12 ins N + S of
post $5\frac{1}{2}$ ft dist and raised
a mound of earth $1\frac{1}{2}$ ft high

Subdivisions

3 1/2 ft base around post from
which a mesquite 12 ins in
diam bears S 85° W 22 lks
dist marked 1/16 P.B.T.

A mesquite 10 ins diam
bears N 31° E 44 lks dist
marked 1/16 P.B.T.

Thence East on random
line thro' S 1/2 of sec 35
Var 13° 10' E,

4.35 Santa Cruz River 87 lks
wide course North.

20. Set tempy 1/16 Sec cor

40. Set tempy 1/16 Sec cor

60. Set tempy 1/16 Sec cor

76.40 Spring Branch, marshy
bed 1 ch wide.

80.04 Intersect N + S line of lks
S of 1/16 Sec cor

Thence Draw S 89° 56'

T 15 S, R 13 E.

W on a true line thro S $\frac{1}{2}$ of
Sec 35 with same var

20.01 A mesquite 14 mis drain
which I marked $\frac{1}{16}$ P on N
face for $\frac{1}{16}$ Sec cor, dug
pits 18 \times 18 \times 12 mis E + W
of tree $5\frac{1}{2}$ ft dist and
raised a mound of earth
around tree, from which
a mesquite 18 mis drain
bears S 40° W 11 lbs marked
 $\frac{1}{16}$ P. B. T.

A mesquite 20 mis drain
bears N 31° E 22 lbs dist
marked $\frac{1}{16}$ L. B. T.

33.10 A mesquite 10 mis drain.

40.02 Set a post 3 ft long 3 mis of
with charred stake 12 mis
in ground for $\frac{1}{16}$ Sec cor
marked $\frac{1}{16}$ P on N face

BOOK 1985

Subdivisions

dug pits $18 \times 18 \times 12$ ins E
 + W of post $5\frac{1}{2}$ ft dist,
 and raised mound of
 earth $1\frac{1}{2}$ ft high $3\frac{1}{2}$ ft
 base around post, which
 is in a mesquite thicket.

51.90 A mesquite 14 ins diam.

60.03 Set a post 3 ft long 3 ins sq.
 with charred stake 12 ins
 in ground for $\frac{1}{16}$ Sec cor
 marked $\frac{1}{16}$ S on N face

dug pits $18 \times 18 \times 12$ ins E
 + W of post $5\frac{1}{2}$ ft dist
 and raised mound of
 earth $1\frac{1}{2}$ ft high $3\frac{1}{2}$ ft
 base around post from
 which a mesquite 10 ins
 diam bears $N 45^\circ E 45'$
 lts dist marked $\frac{1}{16}$ S
 B.T.

T 15 S, R 13 E.

80.04

The $\frac{1}{16}$ Sec cor
 Level level bottom
 Soil 1st rate
 Mesquite Timber & Brush
 for 80 cks.
 Feb 16th 1888

Thence North bet secs

34 + 35

Var $13^{\circ} 10'$ E.

20.

Set a post 3 ft long 3 in ϕ
 with charred stake 12
 in in ground for $\frac{1}{4}$ Sec
 cor marked $\frac{1}{4}$ S on W face
 dug pits $18 \times 18 \times 12$ in N
 + S of post $5\frac{1}{2}$ ft dist
 and raised mound of
 earth $1\frac{1}{2}$ ft high $3\frac{1}{2}$ ft
 base around post. This
 cor is in mesquite thickets
 The old cor obliterated.

Subdivisions

Thence East on random
line thro' center of sec 35
Var $13^{\circ} 10' E$

2.15 Santa Cruz River 80 lks wide
bank 15 high course North

5.50 Drywash 25 lks wide
course N.W.

20. Set tempy $\frac{1}{16}$ Sec cor

21. Heavy timber

40. Set tempy $\frac{1}{4}$ Sec cor

50. Leave heavy timber

60. Set tempy $\frac{1}{16}$ Sec cor

60.25 Spring Branch 1 ch wide

75.60 old Road bears N + S.

80.07 Intersect N + S line 14
lks S of $\frac{1}{4}$ Sec cor

Thence Run S $89^{\circ} 54'$
W on a true line thro' cent.
of sec 35 with same var

20.01 Set a post 3 ft long 3 ins of

T 15 S, R 13 E

with charred stake 12 ins
in ground for $\frac{1}{16}$ Sec cor
marked $\frac{1}{16}$ S on N face
dug pits $18 \times 18 \times 12$ ins E + W
of post $5\frac{1}{2}$ ft dist and
raised mound of earth $1\frac{1}{2}$
ft high $3\frac{1}{2}$ ft base around
post. This cor is in mes-
quite thicket.

40.03

A mesquite tree 18 ins
diam which I mark $\frac{1}{4}$
S on N face for $\frac{1}{4}$ Sec cor
dug pits $18 \times 18 \times 12$ ins E
+ W of tree $5\frac{1}{2}$ ft dist and
raised a mound of earth
around tree, from which
a mesquite 9 ins diam
bears $N 46^\circ E$ 40 lks
dist marked $\frac{1}{4}$ S.B.T.

60.04

Set a post 3 ft long 3 ins dia

Subterraneous

with charred stake 12 ins
in ground for $\frac{1}{16}$ Lec cor,
marked $\frac{1}{16}$ South face dug
pit 18 x 18 x 12 ins E + W of
post $5\frac{1}{2}$ ft dist and
raised a mound of earth
 $1\frac{1}{2}$ ft high $3\frac{1}{2}$ ft base a
round post. The cor in
a mesquite thicket.

80.07 The $\frac{1}{16}$ Lec cor.

Land level bottom

Post 1st Rate

mesquite Timber + Bush
for 80 cts

Thence North bet sees

34 + 35

Var $13^{\circ} 10'$ E.

10.42 Santa Cruz River 1 ch wide
banks 10 ft high. Course N

T. 15 S. R. 13 E

20. Set a post 3 ft long 3 in of
with charred stake 12 in
in ground for $\frac{1}{16}$ Sec cor
marked $\frac{1}{16}$ Pow. N face
dug pits 18 x 18 x 12 in E
tr of post 5 $\frac{1}{2}$ ft dia
and raised a mound of earth
1 $\frac{1}{2}$ ft high 3 $\frac{1}{2}$ ft base a
round post.

Thence East on random
line thro N $\frac{1}{2}$ of Sec 35
Var $13^{\circ} 10'$ E

20. Set tempy $\frac{1}{16}$ Sec cor

40. Set tempy $\frac{1}{16}$ Sec cor

53.30 Spring Branch 90 lks wide
course North.

60. Set tempy $\frac{1}{16}$ Sec cor

76.75
80.05 Intersect N & S line of lks
N of $\frac{1}{16}$ Sec cor

Thence Run $N 89^{\circ} 56' W$

Subdivisions

on a true line thro N $\frac{1}{2}$ of
Sec 35 with same as

- 20.01 Set a post 3 ft long 3 in of
with charred stake 12 in
in ground for $\frac{1}{16}$ Sec cor
marked $\frac{1}{16}$ Sow N face
dug pits $18 \times 18 \times 12$ in E
& W of post $5\frac{1}{2}$ ft dist
and raised mound of
earth $1\frac{1}{2}$ ft high $3\frac{1}{2}$ ft
base around post. The
cor in a mesquite thickets.
- 40.02 Set a post 3 ft long 3 in of
with charred stake 12 in in
ground for $\frac{1}{16}$ Sec cor
marked $\frac{1}{16}$ Sow N face
dug pits $18 \times 18 \times 12$ in E
& W of post $5\frac{1}{2}$ ft dist and
raised a mound of earth
 $1\frac{1}{2}$ ft high $3\frac{1}{2}$ ft base a-

T 15 S, R 13 E

round post from which a
mesquite 11 mis drain bears
N $89^{\circ} 30'$ W 78 lbs dist
marked $\frac{1}{16}$ S.B.T.

60.03 Set a post 3 ft long 3 mis off
with charred stake 12 mis
in ground for $\frac{1}{16}$ Sec cor
marked $\frac{1}{16}$ Pon N face
dug pits 18 x 18 x 12 mis E
& W of post 5 $\frac{1}{2}$ ft dist and
raised mound of earth
1 $\frac{1}{2}$ ft high 3 $\frac{1}{2}$ ft base a -
round post from which
a mesquite 10 mis drain
bears S 89° W 14 lbs dist
marked $\frac{1}{16}$ S.B.T.

80.05 The $\frac{1}{16}$ Sec cor
Land level bottom
Soil 1st rate
Mesquite Timber & Brush Rocks

56.

BOOK 1985

Subdivisions

These North betsees

34 + 35

Var $13^{\circ} 10' E$

20.

The old Sec cor. I set a post 4 ft long 4 in. dia. with charred stake 12 in. in ground for cor to secs 26, 27, 34 + 35 marked

T 15 S S 26 on NE
 R 13 E S 35 on SE
 S 34 on SW and
 S 27 on NW faces, with 1 notch on S and 2 notches on E edges, dug pits $18 \times 18 \times 12$ in. in each sec $5\frac{1}{2}$ ft dist and raised mound of earth 2 ft high $4\frac{1}{2}$ ft base around post, from which a mesquite 10 in. diam bears $N 61^{\circ} E 55'$

T 15 S, R 13 E.

lks dist marked T 15 S,
R 13 E S 26 B T.

A mesquite tree 18 mi in
drain bears $S 50^{\circ} W 122$

lks dist marked T 15 S
R 13 E. S 34 B T.

A mesquite tree 10 mi in
drain bears $N 57^{\circ} 30' W$

125 lks dist marked T
15 S R 13 E S 27 B T.

This corner is on P side
of Papago wire fence.

Land for rocks bet secs
34 + 35 level bottom

Soil 1st rate

Mesquite timber & Brush
for rocks

My observation taken this day I find the
magnetic var to be $13^{\circ} 10'$

These East on Random
line bet secs 26 + 35

Subdivisions

- Var $13^{\circ} 10' \text{ E}$
13. Along wire fence bears E & W
Cross wire fence bears E & W
and enter Papago Pasture.
20. Set temporary $\frac{1}{16}$ Sec cor
40. Set temporary $\frac{1}{4}$ Sec cor
- 47.50 Spring Branch holds wide,
running water course N.
60. Set temporary $\frac{1}{16}$ Sec cor.
- 79.74 Cross wire fence bears N.E
& S.W. Corner to same is 128
lks South.
- 79.94 old Road N & S.
- 80.08 Intersect N & S line 11 lks
S of cor to secs 25, 26, 35 &
36.
- These Iron $S 89^{\circ} 55' \text{ W}$
on a true line bet secs 26 &
35 with same var.
- 20.02 Set a post 3 ft long 3 in of

with charred stake 12 ins
in ground for $\frac{1}{16}$ Sec cor
marked $\frac{1}{16}$ S on N face
dug pits $18 \times 18 \times 12$ ins E
& W of post $5\frac{1}{2}$ ft dist and
raised a mound of earth
 $1\frac{1}{2}$ ft high $3\frac{1}{2}$ ft base a-
round post, which is in
Papago pasture.

40.024

Set a post 3 ft long 3 ins ϕ
with charred stake 12 ins in
ground for $\frac{1}{4}$ Sec cor
marked $\frac{1}{4}$ S on N face,
dug pits $18 \times 18 \times 12$ ins E
& W of post $5\frac{1}{2}$ ft dist
and raised mound of
earth $1\frac{1}{2}$ ft high $3\frac{1}{2}$ ft
base around post, which
is in Papago pasture. The
old cor obliterated.

Subdivisions

60.06 Set a post 3 ft long 3 in of
with charred stake 12 in in
ground for $\frac{1}{16}$ Sec cor
marked $\frac{1}{16}$ S on N face
dug pits 18 x 18 x 12 in E
& W of post $5\frac{1}{2}$ ft dist and
raised mound of earth $1\frac{1}{2}$
ft high $3\frac{1}{2}$ ft base around
post, which is in Papago
pasture.

80.08 The cor to secs 26, 27, 34 & 35

Level Bottom

Soil 1st rate

Good Grass.

mesquite Timber and
Brush 80 ch

Thence North bet secs
26 & 27

Var $13^{\circ} 10' E$

T 15 S, R 13 E

- 0.9 Cross wire fence bears E +
W and enter Papago pasture.
20. Set a post 3 ft long 3 in of
with charred stake 12 in
in ground for $\frac{1}{16}$ Sec cor
marked $\frac{1}{16}$ Sec W face
dug pits 18 x 18 x 12 in N.
+ S of post 5 $\frac{1}{2}$ ft dist and
raised mound of earth
1 $\frac{1}{2}$ ft high 3 $\frac{1}{2}$ ft base a-
round post

Thence East on random
line, thro $\frac{1}{2}$ of sec 26
Var $130^{\circ} 10' E.$

In scattering timber

20. Set tempy $\frac{1}{16}$ Sec cor
38. Lease timber + enter open prairie
40. Set tempy $\frac{1}{16}$ Sec cor
- +2.85 Spruce Branch 30 lbs wide
running water course North

60. Set tempy $\frac{1}{16}$ Sec cor
- 80.04 Intersect N + S line 7 lks
N of $\frac{1}{16}$ Sec cor
Thence Run N $89^{\circ} 57'$
W on a true line thro $5\frac{1}{2}$ of
Sec 26 with same cor
- 20.01 Set a post 3 ft long 3 ins dia
with charred stake 12 ins
in ground for $\frac{1}{16}$ Sec cor
marked $\frac{1}{16}$ S on N face
dug pits $18 \times 18 \times 12$ ins E +
W of post $5\frac{1}{2}$ ft dist and
raised mound of earth
 $1\frac{1}{2}$ ft high $3\frac{1}{2}$ ft base
around post.
- 40.02 Set a post 3 ft long 3 ins dia
with charred stake 12 ins
in ground for $\frac{1}{16}$ Sec cor
marked $\frac{1}{16}$ S on N face
dug pits $18 \times 18 \times 12$ ins E

4" w of post $5\frac{1}{2}$ ft dist
and raised mound of
earth $1\frac{1}{2}$ ft high $3\frac{1}{2}$ ft
base around post

56.65 A mesquite tree 9 ins diam
60.03 Set a post 3 ft long 3 ins dia
with charred stake 12 ins
in ground for $\frac{1}{16}$ Sec cor
marked $\frac{1}{16}$ S. W. N face
dig pits $18 \times 18 \times 12$ ins E
4" w of post $5\frac{1}{2}$ ft dist
and raised a mound of
earth $1\frac{1}{2}$ ft high $3\frac{1}{2}$ ft base
around post, from which
a mesquite 5 ins in diam
bears $N 15^\circ E 25$ l. R. dist
marked $\frac{1}{16}$ S. B. T.

80.04 The $\frac{1}{16}$ Sec cor
Level level bottom
Soil 1st rate

Subdivisions. T15 S. R13 E

Good Grass

Scattering timber & Brush
for 40 chs, & open prairie for 40 chs

Thence North bet sees

26 + 27

Var $13^{\circ} 10' E$

20.

x

The old $\frac{1}{4}$ Sec cor. I set a
post 3 ft long ^{with orange slash} 3 ins of for the $\frac{1}{4}$
Sec cor marked $\frac{1}{4}$ S on W face
dug pits $18 \times 18 \times 12$ ins N + S
of post $5\frac{1}{2}$ ft dist and raised
a mound of earth $1\frac{1}{2}$ ft high
 $3\frac{1}{2}$ ft base around post, from
which a mesquite 15 ins diam
bears $S 45^{\circ} W$ 2.82 chs dist
marked $\frac{1}{4}$ S.B.T

A mesquite 12 ins diam bears
 $N 42^{\circ} 30' E$ 65 lks dist marked
 $\frac{1}{4}$ S.B.T.

Continued, Book 1986.

Concluded, Book 1987.