



321

BOOK 2025

2025

# Field Notes

OF THE SURVEY OF

*The Townsite of Middleton  
on Kingman, Mohave Co  
Arizona.*

2025

2025

*Gila and Salt River Base and Meridian*

**ARIZONA.**

By *C. D. Foster*, D. S.

Under contract dated *Sept 8, 1882*

Survey commenced *October 23, 1882*

Survey completed *October 23, 1882*

2025

BOOK 2025

Index

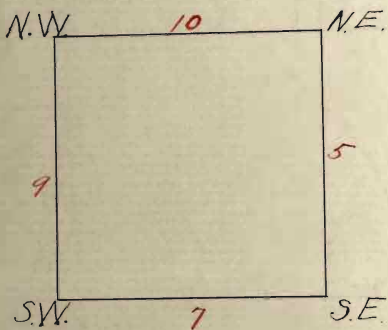

BOOK 2025

BOOK 2025

Post KTSNE Cor

Post KTSNS

Post KTSNW Cor

Mesa Land

S 45° 40' E Hualapai Peak

Post KTSSE

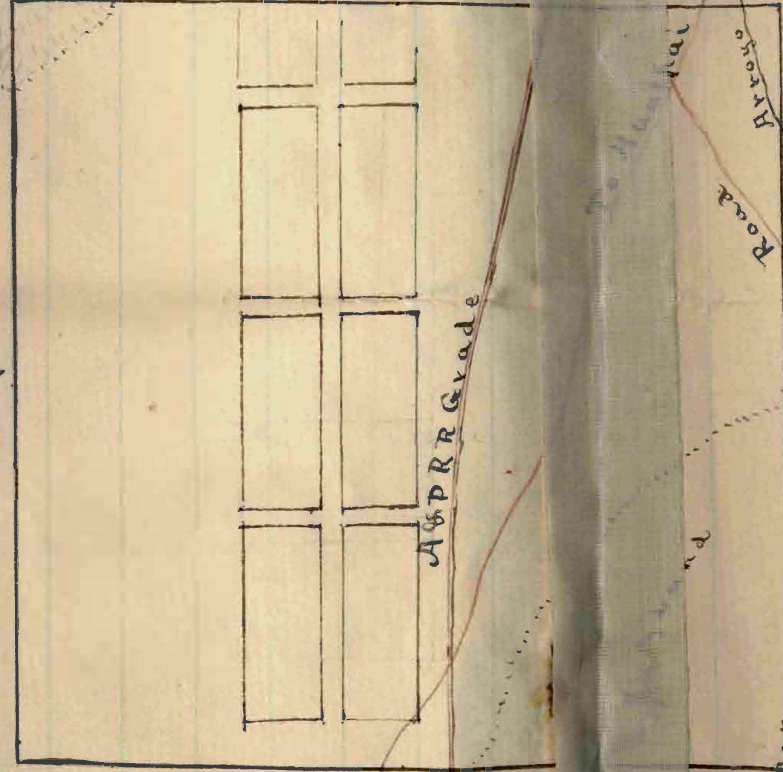

To Beale Spgs

Post KTSWS

APRR Grade

Post KTS SW Cor

Road

Post KTS SS

Hualapai Valley

Post KTSSE Cor

S 47° 30' E Hualapai Peak

Plat  
of

Kingman Townsite  
Mohave County Arizona

Surveyed by

C B Foster D S

October 23 1882

On a 15° 8' East Scale 10 chs to in

BOOK 2025

636  
67  
82

1A A

BOOK 2028

Preliminary Oaths of Assistants.

We Jim Sullivan  
and C. A. Highy

do solemnly swear that we will well and faithfully execute the duties of Chain Carriers; that we will level the chain over even and uneven ground, and plumb the tally pins, either by sticking or dropping the same; that we will report the true distance to all notable objects, and the true length of all lines that we assist in measuring, to the best of our skill and ability and in accordance with instructions given us in the survey of the

Exterior Boundaries of the  
Territory of Middleton or  
Kingman in Mohave County  
Arizona

of the principal base and meridian in the Territory of Arizona.

Jim Sullivan Chainman.

C. A. Highy Chainman.

Subscribed and sworn before me, this 23<sup>rd</sup>

day of October 1887

C. B. Foster  
Deputy Clerk District Court  
3<sup>rd</sup> Judicial Dist  
Arizona  
Notary Public

~~We~~ I H J Chamberlain

do solemnly swear that ~~we~~<sup>I</sup> will well and truly perform the  
the duties of Surveyor

in the establishment of corners and other duties according to  
instructions given ~~us~~<sup>me</sup>, and to the best of ~~our~~<sup>my</sup> skill and ability,  
in the survey of the Exterior boundaries  
of the Townsite of Middleton  
or Kingman in Mohave  
County Arizona

of the principal base and meridian in the Territory of Arizona.

I H J Chamberlain

Subscribed and sworn to before me this 23<sup>rd</sup>  
day of October 1882

C. Foster

Notary Public  
Deputy Clerk District Court  
3<sup>rd</sup> Judicial Dist.  
Arizona

## Field Notes

of the Survey of the  
Exterior boundaries  
of the Townsite of  
Middleton or Kingman  
Mohave County  
Arizona

By  
L. D. Foster  
U.S. Deputy Surveyor  
under his contract of  
Sept 8<sup>th</sup> 1882 and letter  
of instructions of  
Sept 23<sup>rd</sup> 1882

Survey commenced Oct 23<sup>rd</sup> 1882  
" Completed " 23<sup>rd</sup> 1882

Field Notes of the Survey of the  
Exterior boundaries of Middleton or  
Kingman Townsite claim

Mohave County, Arizona

The townsite association  
having changed the name  
of the town from Middleton  
to Kingman

I begin at the NE Cor  
of claim which is  
situated on the west  
slope of a rocky hill  
or projection from  
the mesa on the NE  
into the level plain on  
the south; The surface  
in this vicinity being  
solid bed rock, at point  
of Cor I mark + 4x4 ins  
and over + set a post  
5 ft long 4 ins square  
(the post being the

Field Notes of the Survey of the  
Exterior boundaries of Middleton or  
Kingman Townsite Claim

Mohave County Arizona

Largest to be procured  
in this section of Country)  
plainly cut on S W face  
K T S N E Cor, firmly  
in a mound of Stone  
5 ft square at the base  
and 3 ft high around  
post, from this Cor  
a rocky butte 50 ft high  
25 ft in diameter at  
Summit with a + 4x4 ins  
cut on S E side near  
Summit bears N 40° W 62° 5' to dit  
to +

The highest peak of Kaalpai  
Mountains bears S 45° 40'  
E from Cor  
Deal Springs is N. W.



Field Notes of the Survey of the  
 Exterior boundaries of Middleton or  
 Kingman Townsite Claim

Chain Mohave County, Arizona

from this Cor about 2  
 Miles dist

The entrance of the A & P  
 RR grade from  
 Hualpai Valley into  
 Railroad Cañon is  
 E S E from this Cor  
 about 2 Miles dist.

From the N E Cor I run  
 South

Along the E boundary of Claim  
 Va  $15^{\circ} 8'$  East

as per observation of Polaris  
 with a Gurley Transit  
 5.00 leave slope of hill and  
 enter level plain bears  
 N N W and S E.

20.00 Set a post  $4\frac{1}{2}$  ft long, faced

Field Notes of the Survey of the  
 Exterior Boundaries of Middleton or  
 Krugman Torrensite Claim

Moore County Arizona  
 Claim

- 4 ins wide on W side and  
 marked K T S E. S. 1 ft  
 in the ground and on E and  
 W of post  $5\frac{1}{2}$  ft dist dig  
 pits  $18 \times 18 \times 12$  ins and raised  
 mound of earth  $1\frac{1}{2}$  ft high  
 $3\frac{1}{2}$  ft base around post
- 28.00 Center of A and P P P grade  
 bears E S E and N N W
- 36.00 Wagon road bears S. E. and N W
- 38.00 Arroyo 40 lks wide flows E  
 and enter north point of  
 low hill bears S
- 40.00 To S E Cor of Claim, set a  
 post 5 ft long 4 ins square  
 1 ft in the ground marked  
 on N W face K T S S E  
 Cor and raised around

Field Notes of the Survey of the  
 Exterior boundaries of Middleton or  
 Kingman Townsite Claim

Mo-have County Arizona

post Mound of Stone 4 ft  
 square at the base and  
 2 ft high, sits impracticable  
 from this Cor the highest  
 peak of Huilpai Mountains  
 bears  $S 47^{\circ} 30' E$

Land on W of line Mostly  
 level. Soil 3<sup>rd</sup> rate  
 No Timber or underground

Hence West on true line  
 along S boundary of Claim  
 $Ta 15^{\circ} 8' East$

- 6.00 Arroyo 40 ft wide flows E N E  
 12.40 Road bears N E and N S W  
 20.00 Set a post  $4\frac{1}{2}$  ft long  
 faced 4 ins wide on N side  
 Marked K T S. S. S. 1 ft

Field Notes of the Survey of the  
 Exterior boundaries of Middleton or  
 Kingman Torrensite Claim

Chains Mohave County Arizona

in the ground and N and S  
 of post 5 1/2 ft dist dig pits  
 18x18x12 ins and raised Mound  
 of earth 1 1/2 ft high 3 1/2 ft  
 base around post

X 20.25 leave plain and enter low  
 rolling hills bear NW and S  
 40.00 to SW Cor of claim where I  
 set 1 ft in the ground a post  
 5 ft long, 4 ins square marked  
 on NE face N T S SW Cor  
 and raised around post  
 Mound of earth and stone  
 2 ft high 4 ft square at the  
 base pits impracticable  
 Sand level E; rolling W  
 Soil 3rd rate

No Timber or undergrowth

Field Notes of the Survey of the  
 Exterior boundaries of Middleton or  
 Kingman Townsite Claim

McKone County Arizona  
 Claim

Thence North along W  
 boundary of Claim  
 Va 15° 8' East

16.85 Extra level plain bears W and SE

17.85 Center of Standard RR grade  
 bears E and W

20.00 Set a post  $4\frac{1}{2}$  ft long faced  
 4 ins wide on E side marked  
 K.T.S.W.S. 1 ft in the  
 ground and E and W of  
 post  $5\frac{1}{2}$  ft dia dig pits  
 18x18x12 ins and raised <sup>around post</sup> mound  
 of earth  $1\frac{1}{2}$  ft high  $3\frac{1}{2}$  ft base

21.00 Road bears N W and S E

40.00 to N W Cor of Claim set 1  
 ft in the ground a post 5 ft  
 long 4 ins square marked  
 on E face K.T.S.W.S. Cor.

Field Notes of the Survey of the  
 Exterior boundaries of Middleton or  
 Kingman Townsite claim

Chains Mohave County Arizona

and E and W of post 6 ft dist  
 dig pits 18x18x12 ins and raised  
 around post mound of earth  
 and stone 2 1/2 ft high and 4  
 ft square at the base  
 Sand S of RR grade rolling  
 N of grade level  
 Soil 3<sup>rd</sup> rate

No Timber or undergrowth

Three Coconino tree line  
 along N boundary of claim  
 Ta 15° 8' East  
 Instrument Sighting N. E.  
 Cor of claim

20.00 Set a post 4 1/2 ft long 4 ins  
 square faced on S side 4 ins wide  
 Marked K T S N S 1 ft in

Field Notes of the Survey of the  
 Exterior boundaries of Middleton on  
 Kingman Torrance claim

Mohave County Arizona

Claims

the ground and on N and S  
 side of post  $5\frac{1}{2}$  ft dist  
 dig pits  $18 \times 18 \times 12$  ins and  
 raised around post mound  
 of earth  $1\frac{1}{2}$  ft high  $3\frac{1}{2}$  ft  
 base

35.00 begin ascent of W slope of  
 Mesa bears NNE and SE

40.00 Thru NE Cor post of  
 Claim and place of beginning

Land mostly level

Soil 3rd rate

No Timber or undergrowth

General Description

The land embraced in  
 this claim is mostly a level  
 plain, strictly non-mineral

Field Notes of the Survey of the  
Exterior boundaries of Middleton or  
Kingman Townsite Claim

Mohave County Arizona

The Soil is 3<sup>rd</sup> rate being a  
sandy plain of an alkali  
character

The Claim and Country  
adjacent Contains No Timber  
or underground

Considerable building and  
other improvements are  
being prosecuted near  
the central portion of the  
Claim

October 23<sup>rd</sup> 1882

C. B. Foster  
U. S. Deputy Surveyor



Final Oaths for Surveys.

LIST OF NAMES.

BOOK 2025

A List of the Names of Individuals employed by  
*C. B. Foster* U. S. Deputy Surveyor to  
 assist in running, measuring and marking the lines and  
 corners described in the foregoing Field Notes of the survey of  
 the Exterior boundaries of  
 the Townsite of Middleton  
 in Kingman Mohave  
 County, Arizona

of the principal base and meridian in the Territory of Arizona,  
 showing the respective capacities in which they acted.

*Tim Sullivan* Chairman  
*C. A. Higby* do  
*W. J. Chamberlain* do

BOOK 2025

Final Oaths of Assistants.

We hereby certify that we assisted *C B*  
*Foster* U. S. Deputy Surveyor, in surveying  
 The Exterior boundaries of the  
 Townsite of *Middleton* or  
*Kingman Mohave*  
*County Arizona*

of the principal base and meridian in the Territory of Arizona,  
 as are represented in the foregoing field notes as having been  
 surveyed by him and under his direction; and that said Survey  
 has been in all respects, to the best of our knowledge and belief,  
 well and faithfully surveyed, and the corner monuments es-  
 tablished according to the instructions furnished by the U. S.  
 Surveyor-General for Arizona.

*Jim Sullivan*  
*C. A. Wigby*  
*W. J. Chamberlain*

Subscribed and sworn to before me this *24<sup>th</sup>*  
 day of *October* 188*7*

*C B Foster*  
 Deputy Clerk <sup>Notary Public</sup> District Court  
 3<sup>d</sup> Judicial Dist Arizona

Final Oath of U. S. Deputy Surveyor.

BOOK 2025

I Chas. Foster

United States Deputy Surveyor, do solemnly swear that in  
pursuance of instructions received from J. W.

Rabbinis U. S. Surveyor General for Ari-  
zona bearing date of the 23<sup>rd</sup> day of September

1887 I have well, faithfully, and truly, in my own proper  
person and in strict conformity, with the instructions furnish-  
ed by the U. S. Surveyor General for Arizona, the surveying  
manual and the laws of the United States surveyed the

The Exterior boundaries  
of the Townsite of Middleton  
or Kingman Mohave  
County Arizona

of the principal base and meridian in the Territory of Ari-  
zona, as are represented in the foregoing fields notes as having  
been surveyed by me and under my direction; and I do further  
solemnly swear that all the corners of the said survey have been  
established and perpetuated in strict accordance with the survey-  
ing manual, printed instructions, the special written instruc-  
tions of the U. S. Surveyor General for Arizona, and in the

18  
specific manner described in the field notes, and that the foregoing are the true field notes of such survey, and should any fraud be detected I will suffer the penalty of perjury under the provisions of an Act of Congress approved August 8, 1846.

*C. B. Foster*

U. S. Deputy Surveyor.

BOOK 2025

Subscribed and sworn to before me, this 28<sup>th</sup>  
day of October 1882

*M. C. Foster*

*M. C. Foster*

Notary Public.



BOOK 2025

U. S. Surveyor General's Office,

Tucson, Arizona, January 29, 1883.

The foregoing Field Notes of the Survey of the

Exterior Boundaries of the  
Townsites of Middleton or  
Kingman, Mohave County,  
Arizona

Of the Gila and Salt River Base and Meridian, Arizona, execu-  
ted by C. B. Foster

Deputy Surveyor, under his contract of the 8th  
day of September, 1882, having been

critically examined and the necessary corrections and explana-  
tions made, the said Field Notes and the surveys they describe  
are hereby approved

J. W. Robinson  
Surveyor General.