

Accepted Title 2-17-1908  
OCT. 9-1908  
OCT. 14-1908

Book G

2152

BOOK 2152

# FIELD NOTES

2152

OF THE SURVEY OF THE fragmentary Subdivisional lines

2152

T. 21 S. R 9 E - ~~Trs. 20 21 22 23 24~~  
R 10 E, embracing subdivisional  
lines, bet sees ~~24-25; 13-24;~~  
~~11-12 and 13-14;~~  
~~12-13;~~ and bet sees 1-12; and bet  
sees 4-5; 3-4 respectively.

2152

Of the 6th of Salt River Base 4th Meridian,  
Arizona

AS SURVEYED BY

Philip Couzner

United States Deputy Surveyor,

Under his ~~Contract No.~~ Contract No. 147, dated April 11, 1907

Survey commenced December 27<sup>th</sup>, 1907

Survey completed December 28<sup>th</sup>, 1907

2152

631A

BOOK 2152

NAMES AND DUTIES OF ASSISTANTS.

Walter Percival - chairman  
Chris Olsen - chairman  
Arthur M. Pogue - stewardman  
Henry G. Willets - axeman  
L. W. Whitacre - flagman

64  
10

BOOK 2152

INDEX DIAGRAM.

Township 21 D, Range 9 E

6	5	4	3	2	1
7	8	9	10	11	12
13	14	15	16	17	18
19	20	21	22	23	24
25	26	27	28	29	30
31	32	33	34	35	36

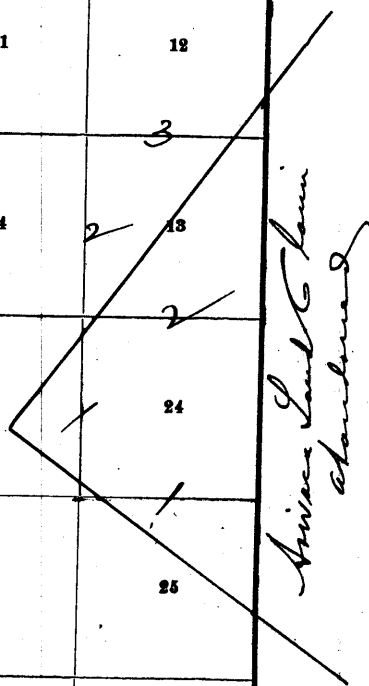

Meanders Page.....

1065  
 WE, Walter Percival and Chris Olsen  
 do solemnly swear that we will well and faithfully execute the duties of chainmen; that we will level the chain upon even and uneven ground, and plumb the tally pins, either by sticking or dropping the same; that we will report the true distances to all notable objects, and the true lengths of all lines that we assist in measuring, to the best of our skill and ability, and in accordance with instructions given us, in the survey of Tps. 20 & 21 S. R. 9 E and Tps. 20 & 22 S. R. 10 E embracing sec. lines bet. sec. 24-25, 23-24, 12-13 and sec. 1+12 and sec. 4-5 + 3-4 respectively.

Walter Percival, Chainman.  
Chris Olsen, Chainman.

Subscribed and sworn to before me this 26<sup>th</sup>  
 day of December, 1907



Philip Coutzen  
 U. S. Deputy Surveyor  
 no notary available

WE, Arthur M. Pogue and  
 do solemnly swear that we will well and truly perform the duties of moundmen in the establishment of corners, according to the instructions given us, to the best of our skill and ability, in the survey of T. 21 S. R. 9 E and Tps. 20 + 22 S. R. 10 E embracing sec. lines bet. sec's 24-25, 23-24, 12-13 and sec. 1+12 and sec. 4-5 + 3-4 respectively.

Arthur M. Pogue, Moundman.  
 Moundman.

Subscribed and sworn to before me this 26<sup>th</sup>  
 day of December, 1907



Philip Coutzen  
 U. S. Deputy Surveyor  
 no notary available

WE, Henry G. Willets and  
 do solemnly swear that we will well and truly perform the duties of axmen in the establishment of corners and other duties, according to instructions given us, to the best of our skill and ability, in the survey of Tp. 21 S. R. 9 E and Tps. 20 + 22 S. R. 10 E embracing sec. lines bet. sec. 24-25, 23-24, 12-13 and sec. 1+12 and sec. 4-5 + 3-4 respectively.

Henry G. Willets, Axman.  
 Axman.

Subscribed and sworn to before me this 26<sup>th</sup>  
 day of December, 1907



Philip Coutzen  
 U. S. Deputy Surveyor  
 no notary available

I, L. W. Whitacre, do solemnly swear that I will well and truly perform the duties of flagman according to instructions given me, to the best of my skill and ability, in the survey of Tp. 21 S. R. 9 E and Tps. 20 + 22 S. R. 10 E embracing sec. lines bet. sec. 24-25, 23-24, 12-13 and sec. 1+12 and sec. 4-5; + 3-4 respectively.

L. W. Whitacre, Flagman.  
 Flagman.

Subscribed and sworn to before me this 26<sup>th</sup>  
 day of December, 1907



Philip Coutzen  
 U. S. Deputy Surveyor  
 no notary available

66  
1D

Subdivision of Tp. 21-South, Range 9 East

chains	
	December 27, 1907. At 8:00 a.m., l.m.t., I lay off $33^{\circ} 19'$ on the decl. arc, and $31^{\circ} 35'$ on the lat. arc, and determine a true meridian with the solar at the cor. of secs. 23, 24, 25 and 26, which I find to be a porphyry stone, 24 X 10 X 8 ins., lying on the ground. I reset same, 18 ins. in the ground and rebuild mound 2 ft. base, $1\frac{1}{2}$ ft. high, W. of cor and mark
	A mesquite, 10 ins. diam., brs. S. $36^{\circ}$ E., 76 lks. dist., T 21 S R 9 E S 25 B T.
	No other trees available.
	Thence I run,
	East on a random line bet. secs. 24 and 25.
40.00	Set temp. $\frac{1}{4}$ sec. cor.
80.00	Intersect the E. Bdy. of Tp. at a point 9 lks. S. of cor. of secs. 19, 24, 25 and 30.
	Thence I run,
	S. $89^{\circ} 56'$ W. on a true line bet. secs. 24 and 25.
	Descending over mountainous land.
7.20	Gulch, 10 lks. wide, course N., ascend.
13.00	Top of N. slope; descend.
19.60	Gulch, 20 lks. wide, course N.
23.50	Gulch, 20 lks. wide, course NE.
27.00	Gulch, 20 lks. wide, course N.
32.50	Ridge, extends NE. and SW.
40.00	Set a porphyry stone, 18 X 8 X 6 ins., 12 ins. in the ground, for $\frac{1}{4}$ sec. cor., marked $\frac{1}{4}$ on N. face, and raise a mound of stone, 2 ft. base, $1\frac{1}{2}$ ft. high, N. of cor.
	An oak, 12 ins. diam., brs. S. $46^{\circ}$ W., 63 lks. dist. marked $\frac{1}{4}$ S 25 B T.
	A mesquite, 12 ins. diam., brs. N. $5\frac{1}{2}^{\circ}$ W., 163 lks. dist., marked $\frac{1}{4}$ S 24 B T.
40.30	Gulch, 20 lks. wide, course NE., ascend steep ridge.
57.50	Top of ascent, extends N. and S., descend.
69.02	I find a porphyry stone, 18 X 10 X 6 ins. above ground, marked A P L on N., C C on S., set in mound of stone.
74.80	Wash, 20 lks. wide, course NW.
78.30	Same wash, 20 lks. wide, course SW.
80.00	The cor. of secs. 23, 24, 25 and 26.
	Land, mountainous.
	Soil, gravelly and rocky; 3rd and 4th rate.
	Timber, a few mesquite.
	Mountainous land, exceptionally difficult to survey, 80/00 chs.
	-----
	N. $0^{\circ} 1'$ W., bet secs. 23 and 24.
	Ascending over mountainous land.
9.25	I find a porphyry stone, 18 X 10 X 8 ins. set in a mound of stone, marked A L G on E. and C C on W. face;
25.00	Top of high ridge, extends NW. and SE.; descend abruptly.
40.00	Point for $\frac{1}{4}$ sec. cor. falls on porphyry rock in place <del>30 X 24 X 24 ins.</del> above ground, which I mark with a cross for exact $\frac{1}{4}$ sec. cor., with $\frac{1}{4}$ W. of cross and raise a mound of stone, 2 ft. base, $1\frac{1}{2}$ ft. high, W. of stone. Pits impracticable.
60.00	Foot of abrupt descent and top of spur, extends NE.
60.30	Wire fence, extends NE. and SW.
76.40	I find a porphyry stone, 18 X 10 X 6 ins, set in mound of stone, marked A L C on E. and C C on W. face.
80.00	<del>After this stone I find no traces of any corner,</del> Therefore I set a porphyry stone, 18 X 6 X 5 ins., 12 ins. in the ground, and raise a mound of stone, 2 ft. base, $1\frac{1}{2}$ ft. high, N. of cor., as a bank as on the W.
	A mesquite, 5 ins. diam., brs. N. $76\frac{1}{2}^{\circ}$ E., 90 lks. dist., marked T 21 S R 9 E S 13 B T.
	A mesquite, 15 ins. diam., brs. S. $6^{\circ}$ W., 67 lks. dist., marked T 21 S R 9 E S 23 B T.
	No other trees available.
	I mark this stone with 3 notches on the S., and 1 notch on the E. edge.

Fractional Subdivision of Tp. 21 South, Range 9 East.

chains	Land, mountainous. Soil, rocky; 3rd and 4th rate. Timber, a few oak and scrub mesquite. Mountainous land, exceptionally difficult to survey, 80.00 chs. Dec. 27; At noon, I set off 23° 20' on the decl. arc, and observe the sun on the meridian; the resulting lat. is 31° 36' N.
40.00	N. 89° 56' E. on a random line bet. secs. 13 and 24. Set temp. sec. cor.
80.00	Intersect the E. Bdy. of Tp. at a point 9 lks. N. of cor. of secs. 13, 18, 19 and 24. Thence I run, West, on a true line bet. secs. 13 and 24. Over mountainous land, through dense mesquite undergrowth.
7.00	Road to Arivaca, brs. NW. and SE.
11.30	Arivaca Creek, 2.50 chs. wide, course NW.
23.60	Wash, 40 lks. wide, course NNE., ascend.
40.00	Set a malachite stone, 18 X 14 X 6 ins., 12 ins. in the ground, for $\frac{1}{4}$ sec. cor., marked $\frac{1}{4}$ on N. face and raise a mound of stone, 2 ft. base, 1 $\frac{1}{2}$ ft. high, N. of cor. A mesquite, 8 ins. diam., brs. S. 46 $\frac{1}{2}$ ° E., 126 lks. dist., marked $\frac{1}{4}$ S 24 B T. A mesquite, 4 ins. diam., brs. N. 55° E., 157 lks. dist., marked $\frac{1}{4}$ S 13 B T.
46.18	Wire fence, brs. NE. and SW.
68.00	Top of ridge, extends NE. and SW.
76.70	I find a porphyry stone, 18 X 8 X 6 ins. above mound of stone, marked A L C on E. and C C on W. face.
80.00	The cor. of secs. 13, 14, 23 and 24. Land, mountainous. Soil, gravelly. 3rd and 4th rate. Timber, a few cottonwoods on the Creek and a few mesquite. Dec. 27, 1907.
	December 28, 1907. At 8 $\frac{1}{2}$ a.m., l.m.t., I set off 23-16 $\frac{1}{2}$ on the decl. arc, and 31° 36' N on the lat. arc, and determine a true meridian with the solar at the cor. of secs. 13, 14, 23 and 24. Thence I run, N. 0° 1' W., bet. secs. 13 and 14. Descending over mountainous land.
2.00	Gulch, course N.
6.00	Leave gulch, course NE.
39.70	Wash, 15 lks. wide, course NNE.
40.00	Find old malachite stone lying on the W. side of wash. Reset this stone, 18 X 12 X 8 ins., 12 ins. in the ground marked $\frac{1}{4}$ on W. face, and raise a mound of stone, 2 ft. base, 1 $\frac{1}{2}$ ft. high, W. of cor. Pits impracticable. A mesquite, 30 ins. diam., brs. N. 60° W., 119 lks. dist., marked $\frac{1}{4}$ S 14 B T. A mesquite, 8 ins. diam., brs. S. 50 $\frac{1}{4}$ ° E., 39 lks. dist., marked $\frac{1}{4}$ S 13 B T.
40.60	Wash, 15 lks. wide, course NW.
47.90	Ridge, extends NW. and SE., descend. R. Pauls' house brs. N. 87° 45' E. Ruins of Wright's house, brs. N. 61 $\frac{1}{2}$ ° E.
55.00	Foot of descent.
63.00	Corral brs. east, 2.00 chs. dist.
65.50	Wash, 30 lks. wide, course NE.
66.25	Road to Arivaca, brs. NW. and SE.
76.00	Arivaca Creek, 2.50 chs. wide, course NW.
80.00	<del>After diligent search I fail to find any trace of old cor.</del>

*Find first traces of old cor.*

Fractional Subdivision of Township 21 South, Range 9 East.

chains Set a sandstone, 24 X 5 X 5 ins., 18 ins. in the ground for cor. of secs. 11, 12, 13 and 14, marked with 4 notches on the S. and 1 notches on the E. edge, and raise a mound of stone, 2 ft. base, 1½ ft. high, W. of cor. Pits impracticable.

A mesquite, 6 ins. diam., brs. S. 75½° E., 22 lks. dist., marked T 21 S R 9 E S 13 B T.

A mesquite, 10 ins. diam., brs. S. 43° W., 37 lks. dist., marked T 21 S R 9 E S 14 B T.

No other trees available.

Land, mountainous.

Soil, gravelly; 2nd and 3rd rate.

Timber, a few mesquite and sycamores.

December 28, 1907. At noon, I set off 23° 18' S on the decl. arc, and observe the sun on the meridian; the resulting lat. is 31° 36½' N. ✓

-----

East, on a random bet. secs. 12 and 13.

40.00 Set temp/ ¼ sec. cor.

80.20 Intersect the E. Bdy. of tp. at a point 9 lks. S. of cor. of secs. 7, 12, 13 and 18.

Thence I run,

S. 89° 56' W., on a true line bet. secs. 12 and 13.

Descending over mountainous land.

.90 Wash, 20 lks. wide, course S., ascend.

6.00 Ridge, extends NE. and SW.

10.50 Wash, 20 lks. wide, course SW.

13.60 I find a porphyry stone, 24 X 12 X 8 ins. above small mound of stone, marked A L C on E. and CC on W. face.

15.00 Wash, 20 lks. wide, course SSW, ascend.

29.00 Top of ridge, extends N. and S., descend.

32.10 Wash, 30 lks. wide, course S.

40.10 Find a malachite stone, 18 X 12 X 8 ins. above ground marked 1 on N., and I raise a mound of stone, 2 ft. base, 1½ ft. high, N. of stone. Pits impracticable.

Paul's house brs. S. 14½° W.

Wright's house brs. S. 51½° W.

42.00 Top of ridge, extends NE. and SW.

56.00 Gulch, course SW; ascend.

65.00 Ridge, extends NE. and SW.

71.00 Wash, 2.00 chs. wide, course S. ascend.

80.20 The cor. of secs. 11, 12, 13 and 14.

Land, mountainous.

Soil, gravelly, 3rd and 4th rate.

Timber, a few scrub mesquite.

December 28, 1907.

Note; For resurvey of the boundaries of the Arivaca Private Land Claim see Book J.

*Philip Coulter*  
U. S. Deputy Surveyor.

*For authority of red ink corrections see  
deputy's letter 11/23/08*

FINAL OATHS OF DEPUTY SURVEYOR AND HIS ASSISTANTS.

69

BOOK 2152

LIST OF NAMES.

A list of the names of the individuals employed by Philip Contzen, United States Deputy Surveyor, to assist in running, measuring, and

marking the lines and corners described in the foregoing field notes of the survey of T. 21 S. R. 9 E and Tps. 20 + 22 S. R. 10 E embracing sec. lines bet. secs 24-25; 18-24; 12-13 and secs 1-12 and secs 4-5; + 3-4 respectively showing the respective capacities in which they acted:

- Walter Percival, Chairman.
- Chris Olsen, Chairman.
- Arthur M. Pogue, Moundman.
- Henry G. Willets, Axman.
- P. W. Whitacre, Flagman.

FINAL OATH OF ASSISTANTS:

We hereby certify that we assisted Philip Contzen, United States Deputy Surveyor, in surveying all

those parts or portions of the T. 21 S. R. 9 E and Tps. 20 + 22 S. R. 10 E embracing sec. lines bet. secs 24-25; 18-24; 12-13 and secs 1-12 and secs 4-5; + 3-4 respectively

of the Gila Salt River Base meridian, Territory of Arizona, which are represented in the foregoing field notes as having been surveyed by him and under his direction; and that said survey has been in all respects, to the best of our knowledge and belief, well and faithfully surveyed, and the corner monuments established, according to the instructions furnished by the United States Surveyor General for Arizona

- Chris Olsen, Chairman.
- Walter Percival, Chairman.
- Arthur M. Pogue, Moundman.
- Henry G. Willets, Axman.
- P. W. Whitacre, Flagman.

Subscribed and sworn to before me this 21<sup>st</sup> day of December, 1907



Philip Contzen  
U.S. Deputy Surveyor  
no notary available



705

FINAL OATH OF UNITED STATES DEPUTY SURVEYOR.

BOOK 2152

I, Philip Coutzen, United States Deputy Surveyor, do solemnly swear that, in pursuance of a contract <sup>Sup. Special Insts.</sup> received from Frank H. Ingalls, United States Surveyor General for Arizona, bearing date of the 11 day of April, 1907, I have well, faithfully, and truly, in my own proper person, and in strict conformity with the instructions furnished by the United States Surveyor General for Arizona, the Manual of Surveying Instructions, and the laws of the United States, surveyed all those parts or portions of Tps 2, S. R 9 E and Tps 22 S. R 10 E embracing subdividing lines between sec's 24-25; 13-24; 12-13; and bet. sec's 1-12 and sec's 4-5 and 3-4 respectively of the Gila Salt

River Base meridian, in the Territory of Arizona, which are represented in the foregoing field notes as having been surveyed by me, and under my direction; and I do further solemnly swear that all the corners of said survey have been established and perpetuated in strict accordance with the Manual of Surveying Instructions, and the special written instructions of the United States Surveyor General for Arizona and in the specific manner described in the field notes, and that the foregoing are the original field notes of such survey.

Philip Coutzen  
United States Deputy Surveyor.

Subscribed by said Philip Coutzen, and sworn to before me }  
this 31<sup>st</sup> day of December, 1907

James R. Sweeney  
U. S. Commissioner 1st Jud. Dist,  
Territory of Arizona.



APPROVAL.

OFFICE OF THE UNITED STATES SURVEYOR GENERAL,

The foregoing field notes of the survey of Fragmentary Subdivisional lines in T 21 P R 9 E, Gila Salt River Base and Meridian, Arizona, Shoring Ariz. Aug. 16, 1907

executed by Philip Coutzen U.S. Deputy Surveyor under his contract No. 144, dated April 11, 1907, having been critically examined, and the necessary corrections and explanations made, the said field notes, and the surveys they describe, are hereby approved.

Frank H. Ingalls  
United States Surveyor General.

I certify that the foregoing transcript of the field notes of the above-described surveys in \_\_\_\_\_, has been correctly copied from the original notes on file in this office.

United States Surveyor General.