

2161

4-679.

Book G.

BOOK 2161

Accepted, letter E. May 4-1910

July 5 1909

74

# FIELD NOTES

OF THE SURVEY OF THE

2161

East Boundary of T. 20 S. R. 20 E.

2161

North

"

"

"

"

West

"

"

"

"

2161

Of the Gila & Salt River Base & Meridian,  
Arizona.

AS SURVEYED BY

Jesse B. Wright, United States Deputy Surveyor,

Under his Contract No. 154, dated February 9th, 1909

Survey commenced May 2, 1909

Survey completed May 5, 1909

6-151

2161

2161

2161

1A

BOOK 2161

NAMES AND DUTIES OF ASSISTANTS.

Walter Percival Chainman

Rollin Brown "

Jas L. Finley Moundman

"

Ramon Escuders Axeman

"

Arbrey W. Anderson Flagman

46  
13

BOOK 2161

INDEX DIAGRAM.

Township 20 South, Range 20 East

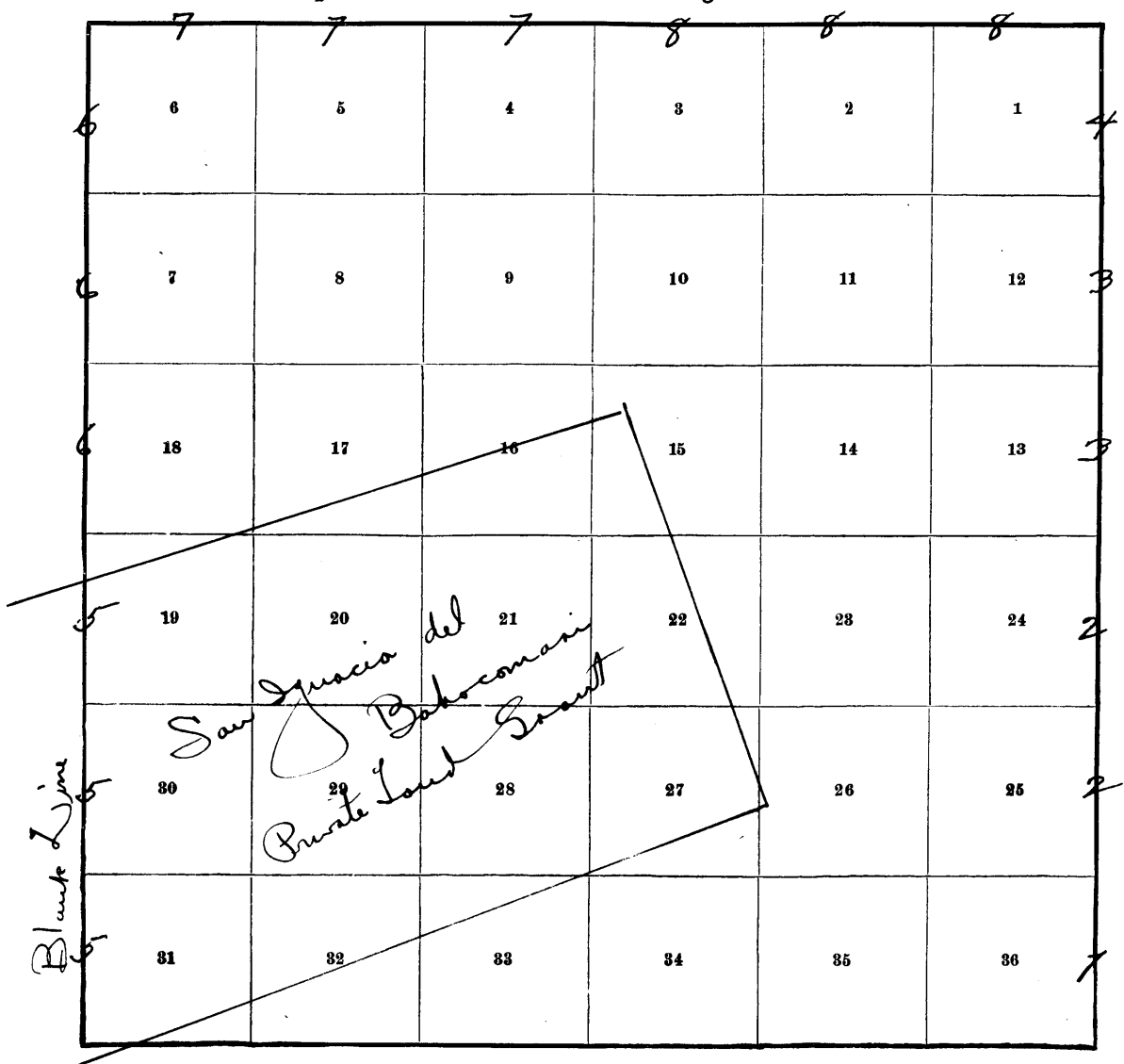

Meanders Page

PRELIMINARY OATHS OF ASSISTANTS.

17 10  
We, Walter Percival and Rollin Brown

do solemnly swear that we will well and faithfully execute the duties of chainmen; that we will level the chain upon even and uneven ground, and plumb the tally pins, either by sticking or dropping the same; that we will report the true distances to all notable objects, and the true lengths of all lines that we assist in measuring, to the best of our skill and ability, and in accordance with instructions given us, in the survey of

Boundaries of T. 20 S. R. 20 E.

Walter Percival, Chainman.

Rollin Brown, Chainman.

Subscribed and sworn to before me this 2nd  
day of May, 1909



Jesse B. Wright  
U. S. Dep. Surveyor.

We, Jas. L. Triley and

do solemnly swear that we will well and truly perform the duties of moundmen in the establishment of corners, according to the instructions given us, to the best of our skill and ability, in the survey of

Boundaries of T. 20 S. R. 20 E.

Jas. L. Triley, Moundman.  
Jas. L. Triley, Moundman.

Subscribed and sworn to before me this 2nd  
day of May, 1909



Jesse B. Wright  
U. S. Dep. Surveyor.

We, Ramon Escudero and

do solemnly swear that we will well and truly perform the duties of axmen in the establishment of corners and other duties, according to instructions given us, to the best of our skill and ability, in the survey of

Boundaries of T. 20 S. R. 20 E.

Ramon Escudero, Axman.

Ramon Escudero, Axman.

Subscribed and sworn to before me this 2nd  
day of May, 1909



Jesse B. Wright  
U. S. Deputy Surveyor

I, Aubrey W. Anderson, do solemnly swear that I will well and truly perform the duties of flagman according to instructions given me, to the best of my skill and ability, in the survey of

Boundaries of T. 20 S. R. 20 E.

Aubrey W. Anderson, Flagman.

Subscribed and sworn to before me this 2nd  
day of May, 1909



Jesse B. Wright  
U. S. Dep. Surveyor.

## East Boundary of T. 20 S. R. 20 E.

A  
10

## Chains

Survey begun, May 2, 1909 and executed with a Young & Sen's light mountain transit No. 6492, with Smith patent solar attachment on side. The horizontal limb of the instrument is provided with two double verniers each reading to 1' of arc, which is also the least reading of the latitude and vertical arcs and declination arc. I begin at the Standard Cor. of Tps. 20 S. Rs. 20 & 21 E.

At this cor. I examine, test and adjust the levels, the line of collimation and standards of the instrument. I also examine and test the latitude and declination arcs and hour circle of the solar and find same correct. Then to test the solar apparatus by comparing the results of observations for meridian made during p.m., & a.m. hours with a true meridian established by Polaris observations, I proceed as follows.

at the above described cor. lat.  $31^{\circ} 38' 03''$  N. long.  $110^{\circ} 16' 24''$  W. at 4h p.m., l.m.t., I set off  $15^{\circ} 25' N.$  on the decl. arc and  $31^{\circ} 38' N.$  on the lat. arc and determine a meridian with the solar and mark a point in the meridian thus determined by a tack in a stake 10 chs. N. of my sta.

May 3, 1909, at 4h 47m a.m. l.m.t. I observe Polaris at E. Elong. in accordance with instructions in the "Manual" and mark the line thus determined by a cross on a fixed stone 10 chs. N. of my station.

at 8h a.m., l.m.t., I set off the azimuth of Polaris  $1^{\circ} 23'$  to the W. and mark the true meridian thus determined by a tack in the stake 10 chs. N. of my station., which point is 0.35 ins. E. of the line as given by the solar on preceding evening. Then I set off  $15^{\circ} 37' N.$  on the decl. arc and  $31^{\circ} 38' N.$  on the lat. arc and determine a meridian with the solar and mark a point in the meridian thus determined by a tack in the stake 10 chs. N. of my station, which point is 0.25 ins. E. of the meridian determined by Polaris observations.

The solar apparatus, by a.m. & p.m. observations defines positions for meridians respectively, about  $6''$  E. and  $9''$  W. of the meridians determined by polaris observation; these errors being not more than the ordinary errors of observation, I conclude that the adjustments of the instrument are satisfactory.

The mag. Var. on this true meridian is  $13^{\circ} 45' E.$  From this Standard Cor. of Tps. 20 S. Rs. 20 & 21 E. which is a sandstone  $10 \times 6 \times 8$  ins. above ground marked and witnessed as described by the Surveyor General,

I run, as per instructions, North, on range line bet. secs. 36 & 31, Var.  $14^{\circ} 45' E.$

Over rolling mesa, through dense greasewood & scattering mesquite brush.

- 12.00 Old road, brs. E. & W. desc. grad.  
 35.75 Road, Charleston to Fort Huachuca, brs. ENE. & WSW.  
 38.00 Enter draw, brs. NE. & SW. and very dense mesquite through which I chain with great difficulty.  
 40.00 Set a quartzite stone  $24 \times 12 \times 8$  ins. 18 ins. in the ground for  $\frac{1}{4}$  sec. cor. marked  $\frac{1}{4}$  on W. face and raise a mound of stone 2 ft. base  $1\frac{1}{2}$  ft. high W. of cor. from which, A mesquite tree 8 ins. diam. brs. S.  $26\frac{3}{4}^{\circ}$  W. 153 lks. dist. marked  $\frac{1}{4}$  S. 36 B.T.  
 41.50 No other bearings available. Pits impracticable.  
 48.00 Dry wash 20 lks. wide, course NE.  
 48.00 Leave draw, brs. NE. & SW. asc. grad.  
 70.00 Leave dense heavy mesquite, brs. E. & W. desc. grad. through dense greasewood.  
 78.30 Dry wash 80 lks. wide, course E. asc.

East Boundary of T. 20 S. R. 20 E.

Chains

80.00 Set a granite stone 30x12x10 ins. 12 ins. in ground to bedrock in mound of stone for cor. of secs. 25,30,31 & 36 marked with 1 notch on S. & 5 notches on N. edges and raise a mound of stone 3 ft. base 2 ft. high W. of cor. from which,  
 A mesquite tree 10 ins.diam.brs.N.82½°E.174 lks.dist. marked T. 20 S. R. 21 E. S. 30 B.T.  
 A mesquite tree 8 ins.diam.brs.S.26¼°E. 104 lks.dist. marked T. 20 S. R. 21 E. S. 31 B.T.  
 A mesquite tree 8 ins.diam.brs.S.27½°W. 100 lks.dist. marked T. 20 S. R. 20 E. S. 36 B.T.  
 A mesquite tree 6 ins.diam.brs.N. 8½°W. 36 lks.dist. marked T. 20 S. R. 20 E. S. 25 B.T.  
 Land, rolling.  
 Soil, 2nd & 3rd rate, sandy, gravelly.  
 Timber, some mesquite.  
 Undergrowth, dense mesquite, greasewood.  
 Rolling land covered with dense undergrowth,----- 48.00 chs.  
 Rolling land covered with dense undergrowth and exceptionally difficult to survey,----- 32.00 chs.

North, bet. secs. 25 & 30.

Over broken land desc through dense mesquite & greasewood.  
 2.00 Gulch 80 lks. wide, course E. asc.  
 10.00 Leave dense mesquite, thence asc. over mts. land.  
 22.00 Top of rocky knoll, brs. NE. & SW. High butte NE. 15 chs. Desc.  
 30.00 Draw 5 chs. wide, course SE. asc.  
 39.00 Rocky knoll, brs. E. & W. desc.  
 40.00 Set a quartzite stone 36x18x6 ins. 20 ins. in ground to bed rock in mound of stone for ¼ sec.cor. & raise a md.of stone 2 ft. base 1½ ft. high W. of cor. which I mark ¼ on W,face. No bearings available. Pits impracticable.  
 6000 Desc. grad. through dense greasewood and scattering tesseta.  
 80.00 Leave dense undergrowth, brs. E. & W.  
 Set a granite stone 24x8x6 ins. 18 ins. in the ground for cor. of secs. 24,25, 19 & 30, marked with 2 notches on S. & 4 notches on N. edges and dig pits 18x18x12 ins. in each sec. 5½ ft. dist. and raise a mound of earth 4 ft. base 2 ft. high W. of cor. No bearings available.  
 Land broken, mts. rolling.  
 Soil, 2nd & 3rd rate, sandy, gravelly, stony.  
 No timber.  
 Undergrowth, tesseta, greasewood, mesquite.  
 Mts. land or land covered with dense undergrowth 80.00 chs.

North, bet. secs. 24 & 19.

Over rolling land desc. grad.  
 10.00 Enter dense dense tesseta, greasewood & mesquite, brs.E.& W.  
 40.00 Set a granite stone 24x10x9 ins. 18 ins. in the ground for ¼ sec.cor. marked ¼ on W. face, dig pits 18x18x12 ins.N. & S. 3 ft. dist. and raise a mound of earth 3½ ft. base 1½ ft. high W. of cor. No bearings available.  
 80.00 Set a granite stone 30x18x6 ins. 24 ins. in the ground for cor. of secs.13,18,24 & 19 marked with 3 notches on N. & S. edges, from which,  
 A mesquite tree 10 ins.diam.brs.N.83¾°E.60 lks.dist. marked T. 20 S. R. 21 E. S. 18 B.T.  
 A mesquite tree 8 ins.diam.brs.S.38½°E.155 lks.dist. marked T. 20 S. R. 21 E. S. 19 B.T.  
 A mesquite tree 8 ins.diam. brs. S.58½°W.58 lks.dist. marked T. 20 S. R. 20 E. S. 24 B.T.  
 A mesquite tree 12 ins.diam.brs.N. 7½°W. 74 lks.dist. marked T. 20 S. R. 20 E. S. 13 B.T.  
 Land, rolling.  
 Soil, 2nd rate, sandy.  
 Timber, none.

## East Boundary of T. 20 S. R. 20 E.

Chains	
	Undergrowth, mesquite, tésseta, greasewood, black brush. Smooth & open land ---- 10.00 chs. Rolling land covered with dense undergrowth, 70.00 chs. At this cor. at 11h 56m 50s a.m., l.m.t. I set off 15°40' N on the decl. arc and observe the sun on the meridian, The resulting lat. is 31° 41' N., which is correct.
	North bet. secs. 13 & 18. Over rolling land, desc. grad. through dense mesquite.
7.15	Road, brs. NE. & SW.
8.15	Wire fence, brs. N.30°E & S. 30° W. Enter field of Ramon Escudero.
12.00	Leave dense mesquite, enter bottom.
17.77	Irrigation ditch, brs. NE. & SW.
26.50	S. bank of Babocomori creek, brs. NE. & SW. desc. abrupt 10 ft.
28.00	Middle of Babocomori Creek, flows NE. stream 50 lks. wide 3 ins. deep.
31.00	Irrigation ditch NE. & SW. asc. abrupt 12 ft.
31.80	Top N. bank of Babocomori creek, brs. NE. & SW.
33.06	Wire fence parallel to RR. NE. & SW.
33.93	Centre of single track of Arizona and New Mexico Railroad. brs. N.60° 15' E. & S. 60° 15' W.
34.78	Wire fence par. to R.R.
36.24	Road, brs. NE. & SW.
37.45	Yard fence of Ramon Escudero, brs. NE. & SW.
38.00	House of Ramon Escudero on line, brs. NE. & SW. Thence On offset line West 1 ch. North 1 ch. East, 1 ch. to
39.00	On true line. leave bottom and asc.
40.00	Set a sandstone 20x12x10 ins. 15' ins. in the ground for $\frac{1}{4}$ sec.cor. marked $\frac{1}{4}$ on W. face and from which, A mesquite tree 6 ins.diam.brs.S.12° E. 28 lks.dist. marked $\frac{1}{4}$ S. 18 B.T. A mesquite tree 6 ins.diam.brs.S.15°W. 31 lks.dist. marked $\frac{1}{4}$ S. 13 B.T.
41.90	Asc. through dense mesquite, with great difficulty. SE. cor. of corral 3 chs. sq. NW. & SE.
46.65	Top of mesa, brs. NE. & SW. Thence over broken ground slopes slightly to E.
80.00	Set a quartzite stone 30 x 10x8 ins. 24 ins. in the ground for cor. of secs. 12, 13, 7 & 18, marked with 4 notches on S. & 2 notches on N. Edges and dig pits 18x18x12 ins. in each sec. 5 $\frac{1}{2}$ ft. dist. and raise a mound of earth 4 ft. base 2 ft. high W. of cor. No bearings available. Land, rolling, broken. Soil, 1st, 2nd, & 3rd rate, loamy, sandy, gravelly. Timber, mesquite, few cottonwood & willow in creek. Rolling land covered with dense undergrowth, 12.00 chs. Smooth and open land, -----28.00 " Rolling land covered with dense undergrowth and exceptionally difficult to survey, -----40.00 "
	North, bet. secs. 12 & 7. Over rolling land, through dense greasewood & mesquite.
19.80	Old road, brs. NE. & SW.
32.00	Top of rise, desc.
40.00	Set a pine post 4 ins. sq. 3 ft. long 2 ft. in ground with marked stone for $\frac{1}{4}$ sec.cor. marked $\frac{1}{4}$ S. 12 on W. face and S.7 on E. face, dig pits 18x18x12 ins. N. & S. 3 ft. dist. and raise a mound of earth 3 $\frac{1}{2}$ ft. base 1 $\frac{1}{2}$ ft. high W. of cor. No bearings available.
61.00	Draw 4 chs. wide, course SE. asc. grad.
78.00	Top of rise, desc.

## East Boundary of T. 20 S. R. 20 E.

Chains 80.00	<p>Set a granite stone 15x6x6 ins. 10 ins. in ground for Cor. of secs. 1,6,7 &amp; 12, marked with 5 notches on S. &amp; 1 notch on N. edges, dig pits 18x18x12 ins. in each sec. 5½ ft. dist. and raise a mound of earth 4 ft. base 2 ft. high W. of cor.          No bearings available.          Land, rolling.          Soil, 2nd &amp; 3rd rate, gravelly.          Timber, none.          Undergrowth, dense mesquite, greasewood, &amp; tesseta.          Rolling land covered with dense undergrowth, 80.00 chs.</p> <hr/> <p>North, bet. secs. 1 &amp; 6.          Over gently rolling land, through dense tesseta &amp; greasewood.</p>
31.05	Road, brs. E. & W.
40.00	<p>Set a pine post 3 ft. long 4 ins. sq. with marked stone. 24 ins. in the ground for ¼ sec. cor. marked ¼ S. 1 on W. face and 6 on E. face and dig pits 18x18x12 ins. N. &amp; S. 3 ft. dist. and raise a mound of earth 3½ ft. base 1½ ft. high W. of cor.          No bearings available.</p>
46.00	Enter draw, brs. ENE.
52.00	Leave draw, asc. grad.
80.00	<p>Set a granite stone 30x10x6 ins. 24 ins. in the ground for cor. of Tps. 19 &amp; 20 S. Rs. 20 &amp; 21 E. marked with 6 notches on N., S., E., &amp; W. edges, dig pits 18x18x12 ins. in each sec. 5½ ft. dist. and raise a mound of earth 5 ft. base 2½ ft. high W. of cor. from which,          A mesquite tree 6 ins. diam. brs. N. 67° E. 323 lks. dist. marked T. 19 S. R. 21 E. S. 31 B.T.          A mesquite tree 6 ins. diam. brs. N. 8° W. 295 lks. dist. marked T. 19 S. R. 20 E. S. 36 B.T.          No other bearings available.          Land, rolling.          Soil, 2nd rate, sandy, gravelly.          No timber.          Undergrowth, greasewood, mesquite, tesseta, black brush.          Rolling land covered with dense undergrowth, -----80.00 chs.</p>

May 3, 1909



West Boundary of T. 20 S. R. 20 E.

Chains

May 4, 1909.  
 At 7h a.m. I set off 15° 54' 30" N. on the decl. arc and 31° 38' N. on the lat. arc and determine a true meridian at the Standard cor. of Tps. 20 S. Rs. 19 & 20 E., which is a granite stone 10x8x8 ins. above ground marked and witnessed as described by the Surveyor General. Thence I run,  
 North, on range line, on blank line as per instructions. bet. secs. 31 & 36.  
 Over rolling land through dense mesquite.  
 30.00 Asc. steep.  
 36.10 Top of mesa, brs. NW. & SE. in road, NW. & SE. Thence over rolling land.  
 40.00 Cor. point for 1/4 sec. cor.  
 80.00 Cor. point for cor. of secs. 25, 30, 31 & 36.  
 Land covered with dense undergrowth 80.00 chs.

North bet. secs. 25 & 30, on blank line.  
 Over rolling mesa.  
 .40 Gulch 50 lks. wide, course ESE.  
 40.00 Cor. point for 1/4 sec. cor.  
 80.00 Cor. point for cor. of secs. 24, 25, 19 & 30.  
 Rolling land ----- 80.00 chs.

North bet. secs. 19 & 24, on blank line.  
 Over rolling mesa, through dense greasewood. & mesquite.  
 22.35 Road, brs. NE. & SW.  
 38.00 Enter open grassy draw, brs. ESE.  
 40.00 Cor. point for 1/4 sec. cor.  
 45.00 Leave draw, asc. grad. through dense greasewood & scattering mesquite.  
 59.35 Intersect N. bdy. of San Ignacio del Babocomori Grant Set a pine post 6 ft. long 6x8 ins. 3 ft. in ground for closing cor. of secs. 19 & 24, marked C.C.T. 20 S. on N., S.I.D.B. on S.T. 20 S. R. 20 E. S. 19 on E., and T. 20 S. R. 19 E. S. 24 on W. faces, with 6 grooves on E. & W. faces, from which,  
 A mesquite tree 4 ins. diam. brs. N. 1° E. 56 lks. dist. marked T. 20 S. R. 20 E. S. 19 C.C.B.T.  
 A mesquite tree 6 ins. diam. brs. N. 59° W. 44 lks. dist. marked T. 20 S. R. 19 E. S. 24 C.C.B.T.  
 The 42 mile cor. on N. bdy. of S.I.D.B. Grant brs. S. 70° 55' 55" W. 7.30 chs.  
 The 42 1/2 mile cor. on N. bdy. of S.I.D.B. Grant brs. N. 70° 55' 55" E. 32.70 chs. (Grant cor. mkd. & wit. as desc. by the S.G.)  
 60.00 Leave dense undergrowth, enter open grassy flat.  
 80.00 Set a sandstone 24x10x10 ins. 18' ins. in the ground for Cor. of secs. 18, 19, 13 & 24, marked with 3 notches on N. & S. edges and dig pits 18x18x12 ins. in each sec. 5 1/2 ft. dist. and raise a mound of earth 4 ft. base 2 ft. high W. of cor. No bearing trees available.  
 Dry ranch of Frank Hand brs. S. 80° W. about 30 chs.  
 Land, rolling. Soil, 2nd & 3rd rate.  
 No timber. Undergrowth, dense greasewood, mesquite.  
 Rolling land covered with dense undergrowth, 60.00 chs.  
 Level land, smooth & open, -, 20.00 chs.  
 At this cor. at noon, I set off 15° 57' N. on the decl. arc and observe the sun on the meridian.  
 The resulting lat. is 31° 41' N.

## West Boundary of T. 20 S. R. 20 E.

## Chains

- North bet. secs. 18 & 13.  
Over level grassy flat., hay field of Frank hand.
- 40.00 Set a sandstone 20x10x8 ins. 15 ins. in the ground for  $\frac{1}{4}$  sec. cor. marked  $\frac{1}{4}$  on W. face, dig pits 18x18x12 ins. N. & S. of cor. 3 ft. dist. and raise a mound of earth  $3\frac{1}{2}$  ft. base  $1\frac{1}{2}$  ft. high W. of cor.  
No bearings available.
- 60.00 Leave flat, enter dense mesquite brush, brs E. & W.
- 62.00 Wash 20 lks. wide, course ENE.
- 80.00 Set a sandstone 20x10x6 ins. 15 ins. in the ground for cor. of secs. 7, 12, 13 & 18, marked with 2 notches on N. & 4 notches on S. edges, dig pits 18x18x12 ins. in each sec.  $5\frac{1}{2}$  ft. dist. and raise a mound of earth 4 ft. base 2 ft. high W. of cor.  
No bearings available.
- Land rolling.  
Soil 2nd & 3rd rate. clayey, sandy.  
No timber. Undergrowth, mesquite, tesseta, greasewood.  
Level land, 60.00 chs.  
Land covered with dense undergrowth, 20.00 chs.
- 
- North bet. secs. 7 & 12.  
Over level land through dense mesquite.
- 40.00 Set a sandstone 20x6x6 ins. 15 ins. in the ground for  $\frac{1}{4}$  sec. cor. marked  $\frac{1}{4}$  on W. face, dig pits 18x18x12 ins. N. & S. of cor. 3 ft. dist. and raise a mound of earth  $3\frac{1}{2}$  ft. base  $1\frac{1}{2}$  ft. high W. of cor.  
No bearings available.
- 80.00 Set a sandstone 20x10x10 ins. 15 ins. in the ground for cor. of secs. 6, 7, 1, & 12, marked with 5 notches on S. & 1 notch on N. edges, and dig pits 18x18x12 ins. in each sec.  $5\frac{1}{2}$  ft. dist. and raise a mound of earth 4 ft. base 2 ft. high W. of cor.  
No bearings available.
- Land, level.  
Soil, 2nd & 3rd rate, sandy, clayey.  
No timber. Undergrowth, mesquite, tesseta.  
Land covered with dense undergrowth, 80.00 chs.
- 
- North bet. secs. 1 & 6.  
Over gently rolling land, through dense mesquite tesseta, & blackbrush.
- 40.00 Set a sandstone 24x10x8 ins. 18 ins. in the ground for  $\frac{1}{4}$  sec. cor. marked  $\frac{1}{4}$  on W. face and dig pits 18x18x12 ins. N. & S. of stone 3 ft. dist.; and raise a mound of earth  $3\frac{1}{2}$  ft. base  $1\frac{1}{2}$  ft. high W. of cor.  
No bearings available.
- 76.60 Road, brs. E. & W.
- 80.00 Set a redwood post 3 ft. long 4x6 ins. with marked stone 24 ins. in the ground for cor. of Tps. 19 & 20 S. Rs. 19 & 20 E. marked
- T. 20 S. S. 31 $\frac{1}{2}$  on NE.,  
R. 20 E. S. 6 on SE.,  
T. 20 S. S. 1 on SW.  
R. 19 E. S. 36 on NW: faces, with 6 notches on each edge from which,
- A mesquite tree 6 ins. diam. brs. N. 61 $\frac{1}{2}$  $^{\circ}$  E. 195 lks. dist., marked T. 19 S. R. 20 E. S. 31 $\frac{1}{2}$  B.T.  
A mesquite tree 4 ins. diam. brs. S. 62 $^{\circ}$  E. 282 lks. dist., marked T. 20 S. R. 20 E. S. 6 $\frac{1}{2}$  B.T.  
A mesquite tree 6 ins. diam. brs. S. 25 $^{\circ}$  W. 230 lks. dist., marked T. 20 S. R. 19 E. S. 1 $\frac{1}{2}$  B.T.  
A mesquite tree 4 ins. diam. brs. N. 24 $^{\circ}$  W. 138 lks. dist., marked T. 19 S. R. 19 E. S. 36 $\frac{1}{2}$  B.T.
- Land, rolling. Soil, 2nd & 3rd rate, sandy.  
No timber. Undergrowth, dense mesquite, tesseta, blackbrush.  
Land covered with dense undergrowth, ---80.00 chs.  
May 4, 1909.

North Boundary of T. 20 S. R. 20 E.

Chains May 5, 1909, at 7h a.m., l.m.t., I set off 31° 43' N. on the lat. arc and 16° 12' N. on the decl. arc and determine a true mer. with the solar at cor. of Tps. 20 & 21 S. Rs. 20 & 21 E. Thence I run, West, on a random line on N. bdy. of T. 20 S. R. 20 E. At 5 miles 79.50 chs. I intersect the W. bdy. of Tp. 28 lks. S. of cor. of Tps. 19 & 20 S. Rs. 19 & 20 E. Whence I run, S. 89° 58' E. on a true line on N. bdy. of Tp. bet. secs. 6 & 31.

37.85 Over rolling mesa, through dense mesquite & tesseta. Old road, brs. N. & S. desc. grad.

39.50 Set a sandstone 24x12x10 ins. 18 ins. in the ground for 1/4 sec. cor. marked 1/4 on N. face and raise a mound of stone 2 ft. base 1 1/2 ft. high N. of cor. No bearings available.

79.50 set a sandstone 24x10x6 ins. 18 ins. in the ground for cor. of secs. 5, 6, 31 & 32., marked with 1 notch on W. & 5 notches on E. edges and raise a mound of stone 2 ft. base 1 1/2 ft. high W. of cor. No bearings available. Land, rolling. Soil, 2nd rate, gravelly. No timber. Undergrowth, dense tesseta, mesquite, Land covered with dense undergrowth, 79.50 chs.

---

S. 89° 58' E. bet. secs. 5 & 32. Over rolling land desc. grad. through dense tesseta and scattering mesquite.

12.00 Road, brs. NW. & SE.

40.00 Set a sandstone 24x12x8 ins. 18 ins. in the ground for 1/4 sec. cor. marked 1/4 on N. face, dig pits 18x18x12 ins. N. & W. of stone 3 ft. dist.; and raise a mound of Earth 3 1/2 ft. base 1 1/2 ft. high N. of cor. No bearings available.

80.00 Set a pine post 3 ft. long 4 ins. sq. with marked stone 24 ins. in ground for cor. of secs. 4, 5, 32 & 33, marked T. 19 S. S. 33 on NE., R. 20 E. S. 4 on SE., T. 20 S. S. 5 on SW., and R. 20 E. S. 32 on NW. face, with 2 notches on W. & 4 notches on E. edges; dig pits 18x18x12 ins. in each sec. 5 1/2 ft. dist. and raise a mound of earth 4 ft. base 2 ft. high W. of cor. No bearings available. Land, rolling. Soil, 2nd rate, sandy. No timber. Undergrowth, mesquite, tesseta, palmeo. Land covered with dense undergrowth, ---80.00 chs.

---

S. 89° 58' E. bet. secs. 4 & 33. Over gently rolling land desc. grad. through dense mesquite, & tesseta.

40.00 Set a pine post 3 ft. long 4x6 ins. 2 ft. in ground for 1/4 sec. cor. marked 1/4 S. 33 on N., and 4 on S. faces, dig pits 18x18x12 ins. E. & W. of post 3 ft. dist. and raise a mound of earth 3 1/2 ft. base 1 1/2 ft. high N. of cor. No bearings available.

80.00 Set a pine post 3 ft. long 4 ins. sq., with marked stone 24 ins. in the ground for cor. of secs. 3, 4, 33, & 34, marked, T. 19 S. S. 34 on NE., R. 20 E. S. 3 on SE., T. 20 S. S. 4 on SW., R. 20 E. S. 33 on NW., face, with 3 notches on E. & W. edges, dig pits 18x18x12 ins. in each sec. 5 1/2 ft. dist. and raise a mound of earth 4 ft. base 2 ft. high W. of cor. No bearings available. Land, rolling. Soil, 2nd rate, sandy. No timber. Undergrowth, dense tesseta, mesquite. Land covered with dense undergrowth, ---80.00 chs.

North Boundary of T. 20 S. R. 20 E.

Chains

S. 89° 58' E. bet. secs. 3 & 34,  
 Over gently rolling land through dense mesquite & tesseta.  
 40.00 Set a pine post 3 ft. long 4 ins. sq. with marked stone  
 2 ft. in ground for 1/4 sec. cor. marked 1/4 S. 34 on N. &  
 3 on S. faces, dig pits 18x18x12 ins. E. & W. of cor.  
 3 ft. dist. and raise a mound of earth 3 1/2 ft. base 1 1/2  
 ft. high N. of cor. No bearings available.  
 At this cor. at noon, I set off 16° 14' 30" N. on the  
 decl. arc and observe the sun on the meridian.  
 The resulting lat. is 31° 43' N. ✓  
 80.00 Set a sandstone 20x10x6 ins. 15 ins. in the ground for  
 cor. of secs. 2, 3, 34 & 35, marked with 4 notches on  
 W. & 2 notches on E. edges from which,  
 A mesquite tree 6 ins. diam. brs. N. 76 1/2° E. 94 lks. dist.  
 marked T. 19 S. R. 20 E. S. 35 B.T.  
 A mesquite tree 6 ins. diam. brs. S. 73 1/2° E. 123 lks. dist.,  
 marked T. 20 S. R. 20 E. S. 2 B.T.  
 A mesquite tree 6 ins. diam. brs. S. 81 1/2° W. 124 lks. dist.,  
 marked T. 20 S. R. 20 E. S. 3 B.T.  
 A mesquite tree 6 ins. diam. brs. N. 31° W. 173 lks. dist.,  
 marked T. 19 S. R. 20 E. S. 34 B.T.  
 Land, rolling. Soil, 2nd rate, sandy.  
 No timber. Undergrowth, dense mesquite, tesseta.  
 Land covered with dense undergrowth, 80.00 chs.

S. 89° 58' E. bet. secs. 2 & 35.  
 Over gently rolling land, through very dense mesquite,  
 tesseta, and black brush.  
 40.00 Set a pine post 3 ft. long 4 ins. sq. with marked stone  
 2 ft. in ground for 1/4 sec. cor. marked 1/4 S. 35 on N. & 2  
 on S. faces, from which,  
 A mesquite tree 6 ins. diam. brs. N. 11 1/2° E. 47 lks. dist.  
 marked 1/4 S. 35 B.T.  
 A mesquite tree 4 ins. diam. brs. S. 13° W. 55 lks. dist.  
 marked 1/4 S. 2 B.T.  
 Leave heavy mesquite & tesseta.  
 80.00 Set a quartzite stone 24x10x10 ins. 18 ins. in the ground  
 for cor. of secs. 2, 1, 35 & 36, marked with 5 notches on  
 W. & 1 notch on E. edges, dig pits 18x18x12 ins. in each  
 sec. 5 1/2 ft. dist. and raise a mound of earth 4 ft. base  
 2 ft. high W. of cor. No bearings available.  
 Land, rolling. Soil, 2nd & 3rd rate, sandy, gravelly.  
 Timber, some mesquite. 1st 1/2 mile.  
 Undergrowth, mesquite, tesseta, black brush.  
 Land covered with dense undergrowth & exceptionally  
 difficult to survey, -----40.00 chs.  
 Land covered with dense undergrowth, 40.00 chs.

S. 89° 58' E. bet. secs. 1 & 36.  
 Over gently rolling land, through dense mesquite, tesseta.  
 40.00 Set a pine post 3 ft. long 4 ins. sq. with marked stone  
 2 ft. in ground for 1/4 sec. cor. marked 1/4 S. 36 on N. &  
 1 on S. faces, dig pits 18x18x12 ins. in each sec. 5 1/2  
 ft. dist. and raise a mound of earth 3 1/2 ft. base 1 1/2 ft.  
 high N. of cor.  
 No bearings available.  
 80.00 To cor. of Tps. 19 & 20 S. Rs. 20 & 21 E. as heretofore  
 described.  
 Land, rolling. Soil, 2nd rate, sandy, gravelly.  
 No timber. Undergrowth, dense mesquite, tesseta, black brush.  
 Land covered with dense undergrowth, 80.00 chs.  
 May 5, 1909.

Boundaries of T. 20 S. R. 20 E.

Latitudes, departures, and closing errors.

Line designated	True bearing.	Dist. Chs.	Latitudes		Departures	
			North. Chs.	South. Chs.	East. Chs.	West. Chs.
S. Bdy.,						
Std. Par. S.	West.	480.00 ✓				480.00 ✓
West Bdy.	North.	480.00 ✓	480.00 ✓			
North Bdy.	S. 89° 58' E.	479.50 ✓		.28 ✓	479.50 ✓	
East Bdy.	South.	480.00 ✓		480.00 ✓		
Convergancy					.45	
			480.00	480.28 ✓	479.95	480.00
				480.00		479.95
			Error in lat. .28 ✓		Error in dep. 05	

General Description.

The East boundary of this Tp. is over a rolling mesa, somewhat broken, and covered mostly with dense mesquite brush which is very heavy in the valley of Babocomori Creek. The West and North boundaries run in general over a rolling mesa, covered mostly with dense mesquite brush, and tesseta or catclaw. There is no water on the lines of the Boundaries except that in Babocomori creek.

\* Inasmuch as I employed my assistants in the immediate vicinity of the work and great delay and expense would have been incurred to appear before a Notary or other officer duly qualified to administer oaths, I was compelled to administer the preliminary and final oaths to my assistants.

May 5, 1909.

*James B. Wright*  
 J.S. Deputy Surveyor.

FINAL OATHS OF DEPUTY SURVEYOR AND HIS ASSISTANTS.

LIST OF NAMES.

A list of the names of the individuals employed by Jesse B. Wright

a, United States Deputy Surveyor, to assist in running, measuring, and marking the lines and corners described in the foregoing field notes of the survey of

Boundaries of T. 20 S. R. 20 E.

showing the respective capacities in which they acted:

Walter Percival, Chainman.

Rollin Brown, Chainman.

Gas. L. Finley, Moundman.

Ramon Escudero, Axman.

Aubrey W Anderson, Flagman.

FINAL OATH OF ASSISTANTS.

We hereby certify that we assisted Jesse B. Wright

, United States Deputy Surveyor, in surveying all those parts or portions of the

Boundaries of T. 20 S. R. 20 E.

of the Gila &

Salt River Base & meridian, Terr. of Arizona, which are represented

in the foregoing field notes as having been surveyed by him and under his direction; and that said survey has been in all respects, to the best of our knowledge and belief, well and faithfully surveyed, and the corner monuments established, according to the instructions furnished by the United States Surveyor

General for Arizona

Walter Percival, Chainman.

Rollin Brown, Chainman.

Gas. L. Finley, Moundman.

Ramon Escudero, Axman.

Aubrey W Anderson, Flagman.

Subscribed and sworn to before me this 17<sup>th</sup>

day of May, 1909



Jesse B. Wright  
U. S. Deputy Surveyor

FINAL OATH OF UNITED STATES DEPUTY SURVEYOR.

I, Jesse B. Wright, United States Deputy Surveyor, do solemnly swear that, in pursuance of a contract received from Frank S. Ingalls United States Surveyor General for Arizona, bearing date of the 9th day of February, 1909, I have well, faithfully, and truly, in my own proper person, and in strict conformity with the instructions furnished by the United States Surveyor General for Arizona, the Manual of Surveying Instructions, and the laws of the United States, surveyed all those parts or portions of

Boundaries of T. 20 S. R. 20 E.

of the Gila & Salt River Base & meridian, in the Terr of Arizona, which are represented in the foregoing field notes as having been surveyed by me, and under my direction; and I do further solemnly swear that all the corners of said survey have been established and perpetuated in strict accordance with the Manual of Surveying Instructions, and the special written instructions of the United States Surveyor General for Arizona and in the specific manner described in the field notes, and that the foregoing are the original field notes of such survey.

Jesse B. Wright  
United States Deputy Surveyor.

Subscribed by said Jesse B. Wright, and sworn to before me) this 10th day of June, 1909

[Signature]  
U.S. Commissioner



APPROVAL.

OFFICE OF THE UNITED STATES SURVEYOR GENERAL,

Phoenix Ariz. July 20, 1910

The foregoing field notes of the survey of North East and fractional West Boundary of T. 20 S. R. 20 E. Gila and Salt River Base and Meridian, Arizona

executed by Jesse B. Wright U.S. Dep. Sur. under his contract No. 154, dated July 9, 1909, having been critically examined, and the necessary corrections and explanations made, the said field notes, and the surveys they describe, are hereby approved.

Frank S. Ingalls  
United States Surveyor General.

I certify that the foregoing transcript of the field notes of the above-described surveys in \_\_\_\_\_, has been correctly copied from the original notes on file in this office.

United States Surveyor General.