

original Oct 21/00  
2162

29

2162  
4-679.

5-5 1900

*B*ook *H.*

*accepted, letter E. May 4-1910.*

BOOK 2162

# FIELD NOTES

OF THE SURVEY OF THE

2162 Subdivision of T. 20 S. R. 20 E.

2162

2162

Of the Gila & Salt River Base & Meridian,  
Arizona.

AS SURVEYED BY

Jesse B. Wright, United States Deputy Surveyor,

Under his Contract No. 154, dated February 9th, 1909

Survey commenced May 5, 1909

Survey completed May 12, 1909

6-151

2162

2162

2162

1A30

BOOK 2162

NAMES AND DUTIES OF ASSISTANTS.

Walter Percival Chainman

Rollin Brown Chainman

Jos. L. Trilly Moundman

Ramon Esenders Axeman

Aubrey W. Anderson Flagman

BOOK 2162

INDEX DIAGRAM.

Township 20 South, Range 20 East

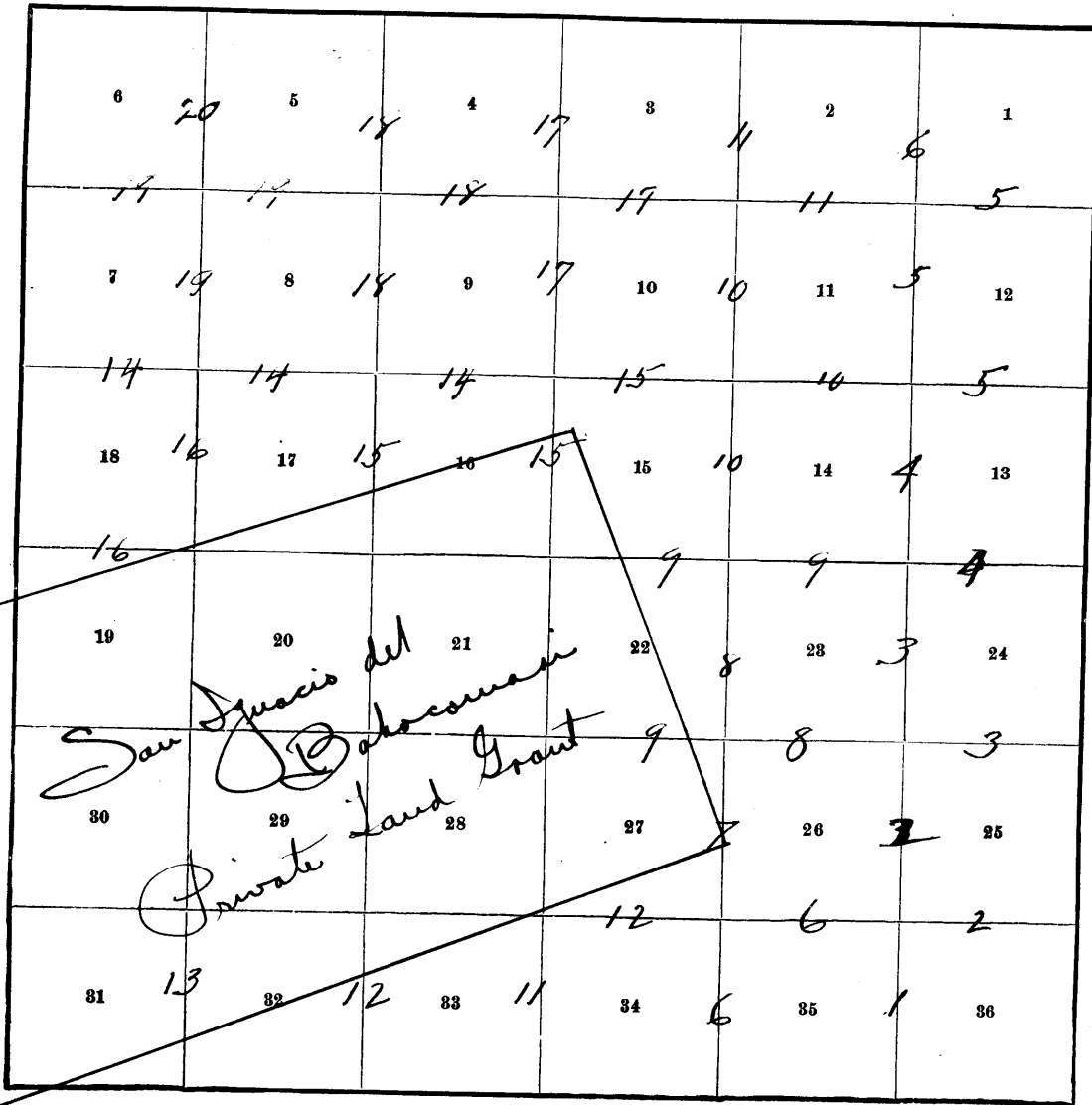

Meanders Page.....

PRELIMINARY OATHS OF ASSISTANTS.

WE, Walter Percival and Rollin Brown  
do solemnly swear that we will well and faithfully execute the duties of chainmen; that we will level the chain upon even and uneven ground, and plumb the tally pins, either by sticking or dropping the same; that we will report the true distances to all notable objects, and the true lengths of all lines that we assist in measuring, to the best of our skill and ability, and in accordance with instructions given us, in the survey of

Subdivision of T. 20 S. R. 20 E.

Walter Percival, Chainman.

Rollin Brown, Chainman.

Subscribed and sworn to before me this 2<sup>nd</sup>

day of May, 1909



Jesse B. Wright  
U. S. Dep. Surveyor.

WE, Joe L. Triley and \_\_\_\_\_  
do solemnly swear that we will well and truly perform the duties of moundmen in the establishment of corners, according to the instructions given us, to the best of our skill and ability, in the survey of

Subdivision of T. 20 S. R. 20 E.

Joe L. Triley, Moundman.

\_\_\_\_\_, Moundman.

Subscribed and sworn to before me this 2<sup>nd</sup>

day of May, 1909



Jesse B. Wright  
U. S. Dep. Surveyor.

WE, Ramon Escudero and \_\_\_\_\_  
do solemnly swear that we will well and truly perform the duties of axmen in the establishment of corners and other duties, according to instructions given us, to the best of our skill and ability, in the survey of

Subdivision of T. 20 S. R. 20 E.

Ramon Escudero, Axman.

\_\_\_\_\_, Axman.

Subscribed and sworn to before me this 2<sup>nd</sup>

day of May, 1909



Jesse B. Wright  
U. S. Deputy Surveyor.

I, Aubrey W. Anderson, do solemnly swear that I will well and truly perform the duties of flagman according to instructions given me, to the best of my skill and ability, in the survey of

Subdivision of T. 20 S. R. 20 E.

Aubrey W. Anderson, Flagman.

Subscribed and sworn to before me this 2<sup>nd</sup>

day of May, 1909



Jesse B. Wright  
U. S. Dep. Surveyor.

Subdivision of Township 20 South, Range 20 East.

Chains

Survey begun May 5, 1909, and executed with a Young & Son's light mountain transit No. 6492, with Smith patent solar attachment on side.

The horizontal limb of the instrument is provided with two double verniers, each reading to 1' of arc, which is also the least reading of the latitude and declination arcs.

I begin as per instructions at the Standard cor. of secs. 35 & 36 on S. bdy. of T. 20 S. R. 20 E., which is a redwood post 4x4x12 ins. above ground, marked and witnessed as described by the Surveyor General.

I examine, and test the levels and line of collimation and standards of the instrument, and also test the latitude arc by means of the strident level, and find same correct.

Then to test the solar apparatus by comparing the results of observations for meridian made during a.m., & p.m. hours, I proceed as follows.

At 5h P.m., l.m.t., I set off 16° 19' N. on the decl. arc and 31° 38' N. on the lat. arc and determine a meridian with the solar, and mark a point in the meridian thus determined by a tack in a stake driven in the ground 6 chs. N. of my station.

May 6, 1909, at 4h 30m a.m., l.m.t., I observe polaris at E. Elongation in accordance with instructions in the Manual, and mark a point in the line thus determined by a tack in a stake driven firmly in the ground 7 chs. N. of my station.

At 7h a.m., l.m.t., I set off the azimuth of polaris 1° 23' to the W. and mark a point in the true meridian thus determined by a tack in the stake 6 chs. N. of my station. which point falls .3 ins. E. of the meridian determined by the solar on preceding evening.

Then I set off 16° 29' N. on the decl. arc and 31° 38' N. on the lat. arc and determine a meridian with the solar, which meridian coincides with the meridian as determined by polaris observations.

From these observations I conclude that the adjustments of the instrument are satisfactory.

The magnetic bearing of the true meridian at 7h a.m. is N. 13° 45' W. The angle thus determined gives the magnetic declination as 13° 45' E.

From the standard cor. above described, I run, N. 0° 1' W. bet. secs. 35 & 36.

Over rolling mesa, through dense greasewood, and scattering mesquite.

16.00 Old road, brs. E. & W.

40.00 Set a mesquite post 3 ft. long 3 ins. sq. 2 ft. in ground for 1/4 sec. cor. marked 1/4 S 35 on W. and 36 on E. faces dig pits 18x18x12 ins. N. & S. of cor. 3 ft. dist. and raise a mound of earth 3 1/2 ft. base 1 1/2 ft. high W. of cor. from which,

A mesquite tree 4 ins. diam. brs. S. 23° E. 61 lks. dist., marked 1/4 S. 36 B.T.

No other bearings available.

59.00 Dry wash 15 lks. wide, course NE.

80.00 Set a granite stone 30x18x10 ins. 24 ins. in ground for cor. of secs. 25, 26, 35 & 36 marked with 1 notch on S. & E. edges, dig pits 18x18x12 ins. in each sec. 5 1/2 ft. dist. and raise a mound of earth 4 ft. base 2 ft. high W. of cor.

No bearings available.

Land, gently rolling mesa.

Soil, 2nd & 3rd rate, sandy, loamy.

No timber. Undergrowth, dense greasewood, mesquite.

Land covered with dense undergrowth, 80.00 chs.

## Subdivision of T. 20 S. R. 20 E.

Chains  
 East on a random line bet. secs. 25 & 36.  
 40.00 Set temp.  $\frac{1}{4}$  sec. cor.  
 79.80 Intersect E. bdy. of Tp. 7 lks. S. of cor. of secs. 25, 30,  
 31 & 36, whence I run,  
 S.  $89^{\circ} 57'$  W. on a true line bet. secs. 25 & 36.  
 Over rolling land asc. grad. through dense greasewood  
 and scattering mesquite.  
 10.00 Top of rise, desc. grad.  
 18.50 Wash 20 lks. wide, course NE. asc. grad.  
 20.00 Enter dense mesquite, brs. NE. & SW.  
 32.00 Leave dense mesquite, brs. NE. & SW.  
 39.90 Set a granite stone 20x10x10 ins. 15 ins. in the ground  
 for  $\frac{1}{4}$  sec. cor. marked  $\frac{1}{4}$  on N. face, dig pits 18x18x12  
 ins. E. & W. of cor. 3 ft. dist. and raise a mound  
 of earth  $3\frac{1}{2}$  ft. base  $1\frac{1}{2}$  ft. high N. of cor.  
 No bearings available.  
 79.80 To cor. of secs. 25, 26, 35 & 36.  
 Land, rolling.  
 Soil, 2nd & 3rd rate, sandy gravelly.  
 Timber, some mesquite.  
 Undergrowth, dense greasewood, mesquite, tesseta.  
 Land covered with dense undergrowth 79.80 chs.

N.  $0^{\circ} 1'$  W. bet. secs. 25 & 26.  
 Over gently rolling mesa desc. rad. through dense  
 greasewood & scattering mesquite.  
 39.50 Desc. steep from mesa. brs. E. & W.  
 40.00 Set a talcite stone 24x15x8 ins. 18 ins. in the ground  
 for  $\frac{1}{4}$  sec. cor. marked  $\frac{1}{4}$  on W. face and raise a mound of  
 stone 2 ft. base  $1\frac{1}{2}$  ft. high W. of cor.  
 No bearings available.  
 41.10 Foot of upper mesa, desc. grad. through paloverde, &  
 mesquite.  
 80.00 Set a mesquite post 3 ft. long 4 ins. sq. 2 ft. in ground  
 for cor. of secs. 24, 23, 25 & 26, marked  
 T. 20 S. S. 24 on NE.,  
 R. 20 E. S. 25 on SE.,  
 S. 26 on SW.,  
 S. 23 on NW., face, with 2 notches on S. and  
 1 notch on E. edges; from which,  
 A mesquite tree 6 ind. diam. brs. N.  $41\frac{1}{2}^{\circ}$  E. 60 lks. dist.,  
 marked T. 20 S. R. 20 E. S. 24 B.T.  
 A mesquite tree 4 ins. diam. brs. S.  $8\frac{1}{2}^{\circ}$  E. 50 lks. dist.,  
 marked T. 20 S. R. 20 E. S. 25 B.T.  
 A mesquite tree 4 ins. diam. brs. S.  $13\frac{1}{2}^{\circ}$  W. 133 lks. dist.,  
 marked T. 20 S. R. 20 E. S. 26 B.T.  
 A mesquite tree, 4 ins. diam. brs. N.  $75^{\circ}$  W. 32 lks. dist.,  
 marked T. 20 S. R. 20 E. S. 23 B.T.  
 Land, rolling, broken.  
 Soil 2nd & 3rd rate, sandy, gravelly, stony.  
 No timber. Undergrowth, greasewood, mesquite, paloverde.  
 Land covered with dense undergrowth, 80.00 chs.

At this cor. at noon, I set off  $16^{\circ} 31'$  N. on the decl.  
 arc and observe the sun on the meridian.  
 The resulting lat. is  $31^{\circ} 40'$  N. ✓

## Subdivision of T. 20 S. R. 20 E.

Chains	
	N. 89° 57' E. on a random line bet. secs. 24 & 25.
40.00	Set temp. $\frac{1}{4}$ sec. cor.
79.90	Intersect E. bdy. of Tp. 7 lks. N. of cor. of secs. 24, 25, 19, & 30, whence I run, West, on a true line bet. secs. 24 & 25. Over level land.
5.00	Enter dense mesquite & greasewood, brs. N. & S.
36.56	Old road, brs. N. & S.
39.95	Set a white limestone 24x12x10 ins. 18 ins. in the ground for $\frac{1}{4}$ sec. cor. marked $\frac{1}{4}$ on N. face, dig pits 18x18x12 ins. E. & W. of cor. 3 ft. dist. and raise a mound of earth $3\frac{1}{2}$ ft. base $1\frac{1}{2}$ ft. high N. of cor. No bearings available. Over broken land, slopes to N.
73.00	Enter draw, course NW.
78.00	Leave draw & asc.
79.90	To cor. of secs. 23, 24, 25, & 26. Land, rolling, broken. Soil, 2nd & 3rd rate, sandy, gravelly. No timber. Undergrowth, mesquite, tesseta, greasewood. Land covered with dense undergrowth, --- 74.90 chs. Level land, ----- 5.00 chs.
	N. 0° 1' W. bet. secs. 23 & 24. Over broken land desc. through dense mesquite brush and greasewood.
8.50	N. edge of mesa, descend.
17.50	Old road, brs. E. & W.
20.00	Enter flat of Babocomori Creek.
29.00	Enter heavy mesquite, brs. E. & W.
33.00	S. bank of Babocomori Creek, course NNE. desc. abrupt 10 ft.
35.00	Centre of " " stream of water 4 ins. deep 20 lks. wide, course NNE.
37.50	N. bank of " " NNE. asc. abrupt 12 ft.
40.00	Set a granite stone 18x10x10 ins. 15 ins. in the ground for $\frac{1}{4}$ sec. cor. marked $\frac{1}{4}$ on W. face, from which, A mesquite tree 10 ins. diam. brs. S. 10 $\frac{1}{2}$ ° E. 59 lks. dist., marked $\frac{1}{4}$ S. 24 B.T. A mesquite tree 8 ins. diam. brs. N. 79° W. 25 lks. dist., marked $\frac{1}{4}$ S. 23 B.T.
41.00	Mouth of deep wash 80 lks. wide from W. Along W. bank of Creek.
49.00	Leave Creek, runs NE. and heavy mesquite, brs. E. & W. Enter open flat.
57.93	Wire fence, NE. & SW.
58.94	Centre of Southern Pacific Railroad, single track, brs. N. 49° 10' E. & S. 49° 10' W.
59.95	Wire fence, Par. to R.R.
60.00	I drove Iron bolt 3 ft. long 1 in. diam. on line. Whence SW. Cor. of Brookline station house brs. N. 45° E. 2 chs. dist. House of T.M. Larrieu brs. S. 55° W. 10 chs. dist. Leave bottom land. asc. through very dense mesquite with great difficulty
63.89	Main road, brs. NE. & SW.
73.50	Top of mesa, brs. NE. & SW.
80.00	Set a sandstone 20x10x10 ins. 15 ins. in the ground for Cor. of secs. 13, 14, 23 & 24, marked with 3 notches on S. & 1 notch on E. edges, and raise a mound of stone 3 ft. base $1\frac{1}{2}$ ft. high W. of cor. from which, A mesquite tree 8 ins. diam. brs. N. 80° E. 82 lks. dist. marked T. 20 S. R. 20 E. S. 13 B.T. A mesquite tree 4 ins. diam. brs. S. 60° E. 35 lks. dist., marked T. 20 S. R. 20 E. S. 24 B.T., A mesquite tree 10 ins. diam. brs. S. 42 $\frac{1}{2}$ ° W. 121 lks. dist., marked T. 20 S. R. 20 E. S. 25 B.T. No other bearings available. Land, rolling, broken. Soil, 2nd & 3rd rate, sandy, gravelly. Timber, mesquite, some cottonwood in creek Undergrowth, mesquite, tesseta, greasewood, paloverde. Open land 11.00 chs. Land covered with dense und'g'th 29.00 chs. Land covered with dense und'g'th, exc. diff. to survey, 40.00 chs.





Subdivision of T. 20 S. R. 20 E.

Chains

May 7, 1909, at 7h a.m., 1.m.t., at the cor. of secs. 11, 12, 13 & 14, I set off  $16^{\circ} 45' 30''$  N. on the decl. arc and  $31^{\circ} 42'$  N. on the lat. arc and determine a true meridian with the solar.  
 Thence I run,  
 N.  $89^{\circ} 53'$  E. on a random line bet. secs. 12 & 13.  
 40.00 Set temp.  $\frac{1}{4}$  sec. cor.  
 79.84 Intersect E. Bdy. of Tp. 12 lks. N. of cor. of secs. 12, 13, 7, & 18, Whence I run,  
 S.  $89^{\circ} 58'$  W. on a true line bet. secs. 12 & 13.  
 Over rolling land asc. grad. through dense tesselata and greasewood.  
 39.92 Set a pine post 3 ft. long 4 ins. sq. with marked stone 2 ft. in ground for  $\frac{1}{4}$  sec. cor. marked  $\frac{1}{4}$  S. 12 on N. face and 13 on S. face, dig pits 18x18x12 ins. E. & W. 3 ft. dist. and raise a mound of earth  $3\frac{1}{2}$  ft. base  $1\frac{1}{2}$  ft. high N. of cor. No bearings available.  
 79.84 To cor. of secs. 11, 12, 13, & 14.  
 Land, rolling.  
 Soil, 2nd & 3rd rate, sandy.  
 No timber.  
 Undergrowth, mesquite, tesselata, greasewood.  
 Land covered with dense undergrowth, 79.84 chs.

N.  $0^{\circ} 1'$  W. bet. secs. 11 & 12.  
 Over gently rolling mesa, through dense tesselata and mesquite.  
 40.00 Set a pine post 3 ft. long 4 ins. sq. 2 ft. in ground for  $\frac{1}{4}$  sec. cor. marked  $\frac{1}{4}$  S. 11 on W. and 12 on E. faces, dig pits 18x18x12 ins. N. & S. of cor. 3 ft. dist. and raise a mound of earth  $3\frac{1}{2}$  ft. base  $1\frac{1}{2}$  ft. high W. of cor. from which,  
 A mesquite tree 4 ins. diam. brs. S.  $1^{\circ}$  E. 148 lks. dist., marked  $\frac{1}{4}$  S. 12 B.T.  
 A mesquite tree 4 ins. diam. brs. S.  $51^{\circ}$  W. 126 lks. dist., marked  $\frac{1}{4}$  S. 11 B.T.  
 80.00 Set a quartzite stone 24x8x6 ins. 18 ins. in the ground for cor. of secs. 1, 2, 11 & 12, marked with 5 notches on S. & 1 notch on E. edges and from which,  
 A mesquite tree 8 ins. diam. brs. N.  $6\frac{1}{4}^{\circ}$  E. 214 lks. dist. marked 2. 20 S. R. 20 E. S. 1 B.T.  
 A mesquite tree 6 ins. diam. brs. S.  $35\frac{1}{2}^{\circ}$  E. 268 lks. dist., marked T. 20 S. R. 20 E. S. 12 B.T.  
 A mesquite tree 5 ins. diam. brs. S.  $6\frac{1}{2}^{\circ}$  W. 202 lks. dist., marked T. 20 S. R. 20 E. S. 11 B.T.  
 A mesquite tree 6 ins. diam. brs. N.  $48^{\circ}$  W. 153 lks. dist., marked T. 20 S. R. 20 E. S. 2 B.T.  
 Land, rolling. Soil, 2nd & 3rd rate, gravelly, sandy.  
 No timber. Undergrowth, mesquite, tesselata, greasewood.  
 Land covered with dense undergrowth, --- 80.00 chs.

N.  $89^{\circ} 58'$  E. on a random line bet. secs. 1 & 12.  
 40.00 Set temp.  $\frac{1}{4}$  sec. cor.  
 79.70 Intersect E. Bdy. of Tp. 12 lks. N. of cor. of secs. 1, 12, 6, & 7, whence I run,  
 N.  $89^{\circ} 57'$  W. on a true line bet. secs. 1 & 12.  
 Over Rolling land through dense mesquite and tesselata.  
 39.85 Set a pine post 3 ft. long, 4 ins. sq. 2 ft. in ground for  $\frac{1}{4}$  sec. cor. marked  $\frac{1}{4}$  S. 1 on N. and 12 on S. faces, from which,  
 A mesquite tree 4 ins. diam. brs. S.  $20^{\circ}$  E. 10 lks. dist., marked  $\frac{1}{4}$  S. 12 B.T.  
 A mesquite tree 6 ins. diam. brs. N.  $32^{\circ}$  W. 186 lks. dist., marked  $\frac{1}{4}$  S. 1 B.T.  
 79.70 To cor. of secs. 1, 2, 11 & 12.  
 Land, gently rolling. Soil 2nd rate, sandy.  
 No timber. Undergrowth, mesquite, tesselata, greasewood.  
 Land covered with dense undergrowth, 79.70 chs.

Subdivision of T. 20 S. R. 20 E.

Chains

N. 0° 1' W. on a random line bet. secs. 1 & 2.  
 40.00 set temp. 1/4 sec. cor.  
 79.75 Intersect N. Bdy. of Tp. 26 lks. E. of cor. of secs. 1, 2, 35 & 36, whence I run,  
 S. 0° 12' E. on a true line bet. secs. 1 & 2.  
 Over gently rolling land, through dense mesquite and tesselata.  
 39.75 Set a pine post 3 ft. long 4 ins. sq. 2 ft. in ground for 1/4 sec. cor. marked 1/4 S. 2 on W. and 1 on E. faces, from which,  
 A mesquite tree 6 ins. diam. brs. N. 81 1/2° E. 66 lks. dist., marked 1/4 S. 1 B.T.  
 A mesquite tree 4 ins. diam. brs. S. 14° W. 40 lks. dist., marked 1/4 S. 2 B.T.  
 65.40 Old road, brs. E. & W.  
 79.85 To cor. of secs. 1, 2, 11 & 12.  
 Land, rolling. Soil, 2nd rate, sandy, .  
 No timber. Undergrowth, mesquite, tesselata, greasewood.  
 Land covered with dense undergrowth, 79.75 chs.  
 At this cor. at noon, I set off 16° 48' N. on the decl. arc and observe the sun on the meridian.  
 The resulting lat. is 31° 42', 30" N. ✓

---

From the Standard Cor. of secs. 34 & 35 on S. Bdy. of Tp. which is a redwood post 4x4x12 ins. above ground marked and witnessed as described by the Surveyor General, I run,

N. 0° 1' W. bet. secs. 34 & 35,  
 Over broken mesa, through scattering mesquite and dense greasewood.  
 40.00 Set a sandstone 15x6x6 ins. 10 ins. in the ground for 1/4 sec. cor. marked 1/4 on W. face, from which,  
 A mesquite tree 4 ins. diam. brs. N. 16° E. 71 lks. dist., marked 1/4 S. 35 B.T.  
 A mesquite tree 4 ins. diam. brs. N. 48° W. 67 lks. dist., marked 1/4 S. 34 B.T.  
 63.00 Knoll, brs. E. & W. desc. grad. through dense mesquite.  
 80.00 Set a sandstone 30x10x10 ins. 24 ins. in the ground for cor. of secs. 26, 27, 34 & 35, marked with 1 notch on S. and 2 notches on E. edges and raise a mound of stone 2 ft. base 1 1/2 ft. high W. of cor. from which,  
 A mesquite tree 6 ins. diam. brs. N. 24 1/2° W. 87 lks. dist., marked T. 20 S. R. 20 E. S. 27 B.T.  
 No other bearings available.  
 Land, rollin, broken. Soil, 2nd rate, sandy, gravelly.  
 No timber. Undergrowth, mesquite, tesselata, greasewood.  
 Land covered with dense undergrowth, 80.00 chs.

---

East on a random line bet. secs. 26 & 35.  
 40.00 set temp. 1/4 sec. cor.  
 79.80 Intersect N. & S. line 14 lks. N. of cor. of secs. 25, 26 35 & 36, whence I run,  
 N. 89° 54' W. on a true line bet. secs. 26 & 35.  
 Over rolling mesa, through dense greasewood & mesquite.  
 39.90 Set a granite stone 18x8x6 ins. 12 ins. in the ground for 1/4 sec. cor. marked 1/4 on N. face, from which,  
 A mesquite tree 6 ins. diam. brs. N. 19° E. 131 lks. dist., marked 1/4 S. 26 B.T.  
 A mesquite tree 4 ins. diam. brs. S. 36 3/4° E. 100 lks. dist., marked 1/4 S. 35 B.T.  
 Desc. over broken mesa.  
 57.00 Wash 50 lks. wide, course N. asc.  
 79.80 To cor. of secs. 26, 27, 34 & 35.  
 Land, rolling, broken. Soil, 3rd rate, gravelly.  
 No timber. Undergrowth, mesquite, tesselata, greasewood.  
 Land covered with dense undergrowth, 79.80 chs.

May 7, 1909.

Subdivision of T. 20 S. R. 20 E.

Chains

May 8, 1909, At 7h a.m., l.m.t., at the cor. of secs. 26, 27, 34 & 35, I set off 17° 02' N. on the decl. arc and 31° 39' N. on the lat. arc and determine a true meridian with the solar. Thence I run, N. 0° 1' W. bet. secs. 26 & 27. with great difficulty. Over broken mesa, desc. grad. through dense mesquite brush.

25.00 Gulch 80 lks. wide, course NW. asc. steep gravelly slope.

28.00 Intersect S. Bdy. of San Ignacio del Babocomori Grant; Set a sandstone 20x10x8 ins. 15 ins. in the ground for closing cor. of secs. 26 & 27, marked C.C. on S., S.I.D.B. on N., with 2 grooves on E. faces, and raise a mound of stone 2 ft. base 1½ ft. high S. of cor. from which, Cor. No. 1 of San Ignacio del Babocomori grant brs. N. 70° 55' 55" E. 3.06 chs. *said cor. is not situated as described by the S. G.* No bearing trees available.

34.00 Thence on blank line through Grant, continuing measurement. Top of high knoll, brs. E. & W. desc. steep gravelly slope.

37.39 Intersect E. end line of San Ignacio del Babocomori Grant. Set a quartzite stone 20x10x8 ins. 15 ins. in the ground for North closing cor. of secs. 26 & 27, marked C.C. on N., S.I.D.B. on S., with 2 grooves on E. faces and raise a mound of stone 3 ft. base 2 ft. high N. of cor. from which, A mesquite tree 6 ins. diam. brs. N. 54½° E. 28 lks. dist., marked T. 20 S. R. 20 E. S. 26 C.C.B.T. A mesquite tree 6 ins. diam. brs. N. 13½° W. 19 lks. dist., marked T. 20 S. R. 20 E. S. 27 C.C.B.T. The 1 mile cor. of San Ignacio del Babocomori Grant, brs. S. 19° 04' 05" E. 5.27 chs. *said cor. is not situated as desc. by the S. G.* Foot of slope enter very dense, heavy mesquite.

40.00 Set a quartzite stone 24x12x12 ins. 18 ins. in the ground for ¼ sec. cor. marked ¼ on W. face, from which, A mesquite tree 8 ins. diam. brs. S. 88° E. 107 lks. dist. marked ¼ S. 26 B.T. A mesquite tree 6 ins. diam. brs. N. 58½° W. 87 lks. dist., marked ¼ S. 27 B.T.

42.00 Head of wash 50 lks. wide, 10 ft. deep, course NNE. With great difficulty along W. edge of same.

48.00 Desc. abrupt 10 ft. into Babocomori Creek, course NE.

50.00 Centre Babocomori Creek, Course NE. dry at this point.

52.00 Asc. abrupt 10 ft. N. bank of Creek. NE. Small house of Jane Lowry brs. W. 3 chs. unoccupied.

52.90 Road, brs. E. & W. from house.

65.43 Wire fence, brs. N. 37° W. & S. 37° E. Enter field of L.S. Hawkins.

77.00 Wire fence, NE. & SW. Par. to R.R.

78.80 Centre of single track of Southern Pacific R.R. brs. N. 54° E. & S. 54° W.

79.75 Wire fence, Par. to R.R.

80.00 Set a granite stone 30x12x10 ins. 24 ins. in the ground for cor. of secs. 22, 23, 26 & 27, marked with 2 notches on S. & E. edges from which, A mesquite tree 6 ins. diam. brs. N. 62½° E. 60 lks. dist. marked T. 20 S. R. 20 E. S. 23 B.T. A mesquite tree 8 ins. diam. brs. S. 54½° E. 292 lks. dist., marked T. 20 S. R. 20 E. S. 26 B.T. A mesquite tree 6 ins. diam. brs. S. 44½° W. 68 lks. dist., marked T. 20 S. R. 20 E. S. 27 B.T. A mesquite tree 4 ins. diam. brs. N. 80° W. 86 lks. dist., marked T. 20 S. R. 20 E. S. 22 B.T. Land, broken, rolling, level. Soil, 1st, 2nd rate, sandy, loamy, gravelly. Timber, mesquite, cottonwood, willow. Undergrowth, mesquite, tesselata, greasewood, paloverde. Land covered with dense undergrowth and exceptionally difficult to survey, --80.00 chs.

Subdivision of T. 20 S. R. 20 E.

Chains	S. 89° 54' E. on a random line bet. secs. 23 & 26.
40.00	Set temp. 1/4 sec. cor.
79.90	Intersect N. & S. line 14 lks. S. of cor. of secs. 23, 24, 25 & 26, whence I run, West on a true line bet. secs. 23 & 26. Over broken N. edge of mesa, with great difficulty, through dense mesquite and black brush.
2.00	Descend.
5.00	Wash 80 lks. wide, course N. asc. over very broken ground.
13.50	Top of pint, brs. N. & S.
27.88	Wire fence, brs. N. & S.
36.00	Knoll, brs. NE. & SW. very stony ground. desc. steep.
39.95	Set a quartzite stone 24x12x8 ins. 18 ins. in the ground for 1/4 sec. cor. marked 1/4 on N. face, from which. A mesquite tree 4 ins. diam. brs. S. 43° E. 29 lks. dist. marked 1/4 S. 26 B.T. A mesquite tree 4 ins. diam. brs. N. 8 1/2° W. 34 lks. dist., marked 1/4 S. 23 B.T. Cor. at foot of slope. House of J.H. Shipp brs. S. 10° W. 3 chs. dist. House of L.S. Hawkins brs. N. 5° W. 24 chs. dist.
49.00	S. bank of Babocomori Creek NE. & SW. desc. abrupt 12 ft.
51.00	Middle of Babocomori Creek, running stream, 20 lks. wide 4 ins. deep, course NE.
52.00	N. bank of Babocomori Creek, NE. & SW. asc. abrupt 15 ft. Thence over level bottom.
64.75	Wash 20 lks. wide, course SE.
74.77	Road, brs. NE. & SW.
77.04	Wire fence, brs. NE. & SW. par. to R.R.
78.30	Centre of single track of Southern Pacific R.R. brs. N. 54° E. & S. 54° W.
79.60	Wire fence, par. to R.R.
79.90	To cor. of secs. 22, 23, 26 & 27. Land, broken, rolling, level. Soil, 2nd & 3rd rate, sandy, stony, gravelly. Timber, mesquite, cottonwood, willow. Undergrowth, mesquite, very dense. Land covered with dense undergrowth and exceptionally difficult to survey, 79.90 chs. At this cor. at noon, I set off 17° 04' 30" N. on the decl. arc and observe the sun on the meridian. The resulting latitude is 31° 40' N.
<hr/>	
	N. 0° 1' W. bet. secs. 22 & 23. Over rolling land, asc. grad. with great difficulty through very dense mesquite.
1.60	Main road, brs. NE. & SW.
7.70	Wash 30 lks. wide, course SE. Leave bottom land of valley and asc.
20.00	Wash 150 lks. wide, course SE.
40.00	Set a granite stone 30x15x10 ins. 24 ins. in the ground for 1/4 sec. cor. marked 1/4 on W. face, from which, A mesquite tree 8 ins. diam. brs. N. 60° E. 34 lks. dist., marked 1/4 S. 23 B.T. A mesquite tree 6 ins. diam. brs. S. 5 1/2° W. 26 lks. dist., marked 1/4 S. 22 B.T.
41.00	Top of flat ridge, brs. SE. & NW. desc.
50.00	Wash 80 lks. wide, course SE. asc. gradually.
80.00	Set a quartzite stone 24x15x10 ins. 18 ins. in the ground for cor. of secs. 14, 15, 22 & 23, marked with 3 notches on S. & 2 notches on E. edges, from which, A mesquite tree 6 ins. diam. brs. S. 68° E. 112 lks. dist. marked T. 20 S. R. 20 E. S. 23 B.T. A mesquite tree 6 ins. diam. brs. N. 56 1/4° E. 69 lks. dist., marked T. 20 S. R. 20 E. S. 24 B.T. A mesquite tree 4 ins. diam. brs. S. 54 1/2° W. 53 lks. dist., marked T. 20 S. R. 20 E. S. 22 B.T. A mesquite tree 6 ins. diam. brs. N. 1° W. 112 lks. dist., marked T. 20 S. R. 20 E. S. 15 B.T. Land, rollin. Soil, 2nd rate, gravelly. No timber. dense mesquite. Land covered with dense undg' th exc. diff. to surv. 80.00 chs.

## Subdivision of T. 20 S. R. 20E.

## Chains

- west, bet. secs. 22 & 27.  
Over rolling land, through very dense mesquite  
with great difficulty.
- 2.2.15 Main road, brs. NE. & SW.
- 14.65 Intersect E. end line of San Ignacio del Babocomori Grant.  
Set a granite stone 30x10x10 ins. 24 ins. in the ground  
for closing cor. of secs. 22 & 27 marked C.C. on E.  
S.I.D.B. on W. with 2 grooves on S. faces from which,  
A mesquite tree 6 ins.diam. brs S.75° E.90 lks.dist.,  
marked T. 20 S. R. 20 E. S. 27 C.C.B.T.  
A mesquite tree 6 ins.diam. brs. N.8½° W. 201 lks.dist.,  
marked T. 20 S. R. 20 E. S. 22 B.T.  
The ½ mile cor. of Grant brs. S. 19° 04' 5" E. 10.17 chs.  
Land, rolling, Undergrowth, dense, heavy mesquite.  
Land covered with dense undergrowth, 14.65 chs.
- 
- West bet. secs. 15 & 22.  
Over rolling land, through dense mesquite and tesseta.
- 20.37 Road, brs. ENE. & WSW.
- 40.00 Set a pine post 3 ft. long 4 ins. sq. 2 ft. in ground for  
¼ sec. cor. marked ¼ S. 15 on N. & 22 on S. faces from which,  
A mesquite tree 4 ins.diam. brs. N.70½° W. 59 lks.dist.,  
marked ¼ S. 15 B.T.  
A mesquite tree 6 ins.diam. brs. S.10° E. 147 lks.dist.,  
marked ¼ S. 22 B.T.
- 42.15 Intersect E. end line of San Ignacio del Babocomori Grant.  
Set a pine post 3 ft. long 4 ins. sq. 2 ft. in ground for  
closing cor. of secs. 15 & 22, marked,  
CC. T. 20 S. R. 20 E. on E.,  
S. 15 on N.,  
S. 22 on S., and  
S.I.D.B. on W. faces with 3 grooves on S. face,  
from which,  
A mesquite tree 4 ins.diam. brs. N.3° E.65 lks.dist.,  
marked T. 20 S. R. 20 E. S. 15 C.C.B.T.  
A mesquite tree 4 ins.diam. brs. S.67½° E. 120 lks.dist.,  
marked T. 20 S. R. 20 E. S. 22 C.C.B.T.  
The 46½ mile cor. of S.I.D.B. Grant brs. S.19° 04' 05" E.  
12.37 chs. *marked and set as desc. by the D.S.*  
Land, rolling. Soil, 2nd rate, sandy, gravelly.  
No timber. Undergrowth, mesquite, tesseta.  
Land covered with dense undergrowth, 42.15 chs.
- 
- East on a random line bet. secs. 14 & 23.
- 40.00 Set temp. ¼ sec. cor.
- 79.80 Intersect N. & S. line 5 lks. N. of cor. of secs. 13, 14,  
23 & 24, whence I run,  
N. 89° 58' W. on a true line bet. secs. 14 & 23.  
Over broken mesa land, through very dense mesquite.
- 14.00 Wash, 20 lks. wide, course SE. asc.
- 30.00 Top of mesa, brs. NE. & SW.
- 39.90 Set a quartzite stone 24x10x8 ins. 18 ins. in the ground  
for ¼ sec. cor. marked ¼ on N. face from which,  
A mesquitre tree 6 ins.diam. brs. N.29° E.46 lks.dist.  
marked ¼ S. 14 B.T.  
A mesquite tree 6 ins.diam. brs. S. 2° W.59 lks.dist.,  
marked ¼ S. 23 B.T.
- 79.80 To Cor. of secs. 14, 15, 22 & 23.  
Land, rolling, broken.  
Soil, 2nd & 3rd rate, sandy, gravelly.  
No timber.  
Undergrowth, mesquite tesseta. very dense 1st ½ mile.  
Land covered with dense undergrowth and exceptionally  
difficult to survey, 39.90 chs.  
Land covered with dense undergrowth, 39.90 chs.  
May 8, 1909.

## Subdivision of T. 20 S. R. 20 E.

- Chains May 9, 1909.
- At 7h a.m., 1.m.t. at the cor. of secs. 14, 15, 22 & 23,  
I set off  $17^{\circ} 18'$  N. on the decl. arc and  $31^{\circ} 41'$  N. on the lat. arc and determine a true meridian with the solar, thence I run,  
N.  $0^{\circ} 1'$  W. bet. secs. 14 & 15.
- 7.92 Over rolling mesa, through dense mesquite and tesseta.  
Old road, brs. E. & W.
- 30.00 Leave mesquite brs. E. & W. enter dense greasewood, and black brush.
- 40.00 Set a pine post 3 ft. long 4 ins. sq. 12 ins. in the ground to bed-rock in mound of small stones. for  $\frac{1}{4}$  sec. cor. marked  $\frac{1}{4}$  S. 15 on W. & 14 on E. faces, dig pits 18x18x12 ins. N. & S. of cor. 3 ft. dist. and raise a mound of earth  $3\frac{1}{2}$  ft. base  $1\frac{1}{2}$  ft. high W. of cor.  
No bearings available.
- 50.00 Enter very dense tesseta, brs. E. & W.
- 80.00 Set a granite stone 24x12x10 ins. 18 ins. in the ground for cor. of secs. 10, 11, 14 & 15, marked with 4 notches on S. & 2 notches on E. edges, from which,  
A mesquite tree 4 ins. diam. brs. N.  $53\frac{1}{2}^{\circ}$  E. 62 lks. dist., marked T. 20 S. R. 20 E. S. 11 B.T.  
No other bearings available.  
Dig pits 18x18x12 ins. in each sec.  $5\frac{1}{2}$  ft. dist. and raise a mound of earth 4 ft. base 2 ft. high W. of cor.  
Land, rolling.  
Soil, 2nd rate, sandy, loamy.  
No timber.  
Undergrowth, mesquite, tesseta, black brush, greasewood.  
Land covered with dense undergrowth, 50.00 chs.  
Land covered with dense undergrowth, & exceptionally difficult to survey, --- 30.00 chs.
- 
- 40.00 S.  $89^{\circ} 58'$  E. on a random line bet. secs. 11 & 14.  
Set temp.  $\frac{1}{4}$  sec. cor.
- 80.04 Intersect N. & S. line 2 lks. S. of cor. of secs. 11, 12, 13, & 14, whence I run,  
N.  $89^{\circ} 59'$  W. on a true line bet. secs. 11 & 14.  
Over level land, through very dense tesseta & black brush.
- 40.02 Set a redwood post 3 ft. long 4 ins. sq. 2 ft. in ground for  $\frac{1}{4}$  sec. cor. marked  $\frac{1}{4}$  S. 11 on N. & 14 on S. faces, dig pits 18x18x12 ins. E. & W. of cor. 3 ft. dist. and raise a mound of earth  $3\frac{1}{2}$  ft. base  $1\frac{1}{2}$  ft. high N. of cor.  
No bearings available.
- 80.04 To cor. of secs. 10, 11, 14 & 15.  
Land, rolling. level.  
Soil, 2nd rate, sandy, loamy.  
No timber. Undergrowth, mesquite, tesseta, black brush.  
Land covered with dense undergrowth, 80.04 chs.
- 
- 40.00 N.  $0^{\circ} 1'$  W. bet. secs. 10 & 11.  
Over rolling land through dense mesquite and tesseta.  
Set a pine post 3 ft. long 4 ins. sq. 2 ft. in ground for  $\frac{1}{4}$  sec. cor. marked  $\frac{1}{4}$  S. 10 on W. & 11 on E. faces, dig pits 18x18x12 ins. N. & S. 3 ft. dist. & raise a mound of earth  $3\frac{1}{2}$  ft. base  $1\frac{1}{2}$  ft. high W. of cor. No bearings available.
- 80.00 Set a pine post 3 ft. long 4 ins. sq. 2 ft. in ground for cor. of secs. 2, 3, 10, & 11, marked  
T. 20 S. S. 2. on NE. R. 20 E. S. 11 on SE., S. 10 on SW., and S. 3 on NW. faces with 5 notches on S. & 2 notches on E. edges, from which,  
A mesquite tree 6 ins. diam. brs. N.  $1^{\circ}$  W. 85 lks. dist., marked T. 20 S. R. 20 E. S. 3 B.T. No other trees available.  
Dig pits 18x18x12 ins. in each sec.  $5\frac{1}{2}$  ft. dist. & raise a mound of earth 4 ft. base 2 ft. high W. of cor.  
Land, rollin. Soil, 2nd rate, sandy. No timber.  
Undergrowth, mesquite, tesseta, greasewood, black brush.  
Land covered with dense undergrowth, 80.00 chs.

Subdivision of T. 20 S. R. 20 E.

Chains	
	S. 89° 59' W. on a random line bet. secs. 2 & 11.
40.00	Set temp. ¼ sec. cor.
80.00	Intersect N. & S. line 2 lks. S. of cor. of secs. 1, 2, 11 & 12, whence I run,
	West, on a true line bet. secs. 2 & 11.
40.00	Over gently rolling land, through dense tesseta & mesquite.
	Set a sandstone 15x10x10 ins. 10 ins. in ground for ¼ sec. cor. marked ¼ on N. face, dig pits 18x18x12 ins. E. & W. of cor. 3 ft. dist. and raise a mound of earth 3½ ft. base 1½ ft. high N. of cor.
80.00	To cor. of secs. 2, 3, 10 & 11.
	Land, rolling.
	Soil, 2nd rate, sandy, loamy.
	No timber.
	Undergrowth, mesquite, tesseta, greasewood, black brush.
	Land covered with dense undergrowth, 80.00 chs.
	At the above cor. at noon I set off 17° 21' N. on the decl. arc and observe the sun on the meridian.
	The resulting lat. is 31° 42' N.
40.00	N. 0° 12' W. on a random line bet. secs. 2 & 3.
79.80	Set temp. ¼ sec. cor.
	Intersect N. Bdy. of Tp. 9 lks. W. of cor. of secs. 2, 3, 34 & 35, whence I run,
	S. 0° 08' E. on a true line bet. secs. 2 & 3.
	Over gently rolling land, through dense tesseta.
39.80	Set a pine post 3 ft. long 4 ins. sq. 2 ft. in ground for ¼ sec. cor. marked ¼ S. 3 on W. & 2 on E. faces, from which,
	A mesquite tree 6 ins. diam. brs. N. 65° E. 24 lks. dist., marked ¼ S. 2 B.T.
	A mesquite tree 6 ins. diam. brs. N. 76° W. 106 lks. dist., marked ¼ S. 3 B.T.
73.45	Road, brs. ESE. & WNW.
79.80	To cor. of secs. 2, 3, 10 & 11.
	Land, rolling.
	Soil, 2nd rate, sandy.
	No timber.
	Undergrowth, mesquite, tesseta, black brush, greasewood.
	Land covered with dense undergrowth, -----79.80 chs.
	From the standard cor. of secs. 33 & 34 on S. Bdy. of Tp., which is a redwood post 4x4x12 ins. above ground, marked and witnessed as described by the Surveyor General, I run,
	N. 0° 02' W. bet. secs. 33 & 34.
	Over broken land along E. edge of mesa, through dense tesseta
20.00	Head of gulch, course NE.
24.00	Top of mesa, brs NE. & SW. desc. grad. over broken W. edge of mesa.
38.00	Head of gulch, course NW.
40.00	Set a quartzite stone 24x12x10 ins. 18 ins. in the ground for ¼ sec. cor. marked ¼ on W. face, and raise a mound of stone 2 ft. base 1½ ft. high W. of cor.
	No bearings available.
49.00	Head of gulch, course NNE.
72.00	Desc. steep from mesa.
79.75	Foot of mesa E. & W. old road, brs. E. & W.
80.00	Set a sandstone 20x10x8 ins. 15 ins. in the ground for cor. of secs. 27, 28, 33 & 34, marked with 3 notches on E. & 1 notch on S. edges, from which,
	A mesquite tree 6 ins. diam. brs. N. 55½° E. 102 lks. dist., marked 2. 20 S. R. 20 E. S. 27 B.T.
	A mesquite tree 6 ins. diam. brs. S. 66¾° E. 80 lks. dist., marked T. 20 S. R. 20 E. S. 34 B.T.
	A mesquite tree 6 ins. diam. brs. S. 10¾° W. 100 lks. dist., marked T. 20 S. R. 20 E. S. 33 B.T.

Subdivision of T. 20 S. R. 20 E.

Chains

80.55 A mesquite tree 4 ins. diam. brs. N. 58° W. 26 lks. dist., marked T. 20 S. R. 20 E. S. 28 B.T.  
Intersect S. Bdy. of San Ignacio del Babocomori Grant.  
Set a quartzite stone 24x15x10 ins. 18 ins. in the ground for Closing cor.,  
marked C.C. on S. S.I.D.B. on N. with 3 grooves on E. faces from which,  
A mesquite tree 6 ins. diam. brs. N. 70½° E. 68 lks. dist., marked T. 20 S. R. 20 E. S. 27 C.C.B.T.  
A mesquite tree 6 ins. diam. brs. S. 51½° W. 110 lks. dist., marked T. 20 S. R. 20 E. S. 33 CC.B.T.  
The 2 mile cor. of S.I.D.B. Grant brs. N. 70° 55' 55" E. 11.25 chs. dist. *marked and wit. as desc. by the D. S.*  
Land, broken, rollin.  
Soil, 2nd & 3rd rate, sandy, gravelly.  
No timber.  
Undergrowth, mesquite, tesseta, greasewood.  
Land covered with dense undergrowth 80.55 chs.

40.00 East on a random line bet. secs. 27 & 34.  
Set temp. ¼ sec. cor.  
80.04 Intersect N. & S. line 19 lks. S. of cor. of secs. 26, 27, 34 & 35, whence I run, S. 89° 52' W. on a true line bet. secs. 27 & 34.  
Over broken mesa, through dense mesquite.  
11.00 Edge of Mesa. brs. N. & S. desc.  
25.00 Wash 80 lks. wide, course NE. asc.  
28.00 Knoll, brs. N. & S.  
30.00 Wash 50 lks. wide, near head, course NE. asc.  
40.02 Set a quartzite stone 24x12x8 ins. 18 ins. in the ground for ¼ sec. cor. marked ¼ on N. face and raise a mound of stone 2 ft. base 1½ ft. high N. of cor.  
No bearings available. Pits impracticable.  
Top of ridge, brs. N. & S. desc.  
51.50 Road, brs. N. & S.  
53.00 Main wash 2 chs. wide, course NNE.  
57.00 Wash 50 lks. wide, course NE.  
60.00 Knoll, brs. NE. & SW. desc.  
62.00 Foot, brs. NE. & SW. Old road, N. & S. Very dense mesquite.  
Thence along N. edge of mesa. with great difficulty.  
69.50 Wash 80 lks. wide, course NE.  
79.45 Road, brs. ENE. & WSW.  
80.04 To cor. of Secs. 27, 28, 33 & 34.  
Land, broken. Soil 2nd & 3rd rate, sandy gravelly.  
No timber. Undergrowth, mesquite, greasewood.  
Land covered with dense undergrowth, -----62.00 chs.  
Land covered with dense undergrowth & exceptionally difficult to survey, ----- 18.04 chs.

From the Std. Cor. of secs. 32 & 33 on S. Bdy. of Tp.  
Which is a granite stone 8x6x10 ins. above ground, marked and witnessed as described by the Surveyor General, the pits and mound being almost obliterated, I raise a mound of stone 3 ft. base 2 ft. high N. of this cor. and run thence,  
N. 0° 2' W. bet. secs. 32 & 33  
Over broken land, through dense mesquite.  
4.20 Gulch 50 lks. wide, 50 ft. deep near head, course ENE.  
21.10 Desc. very steep from mesa, brs. NE. & SW.  
House of J.D. Lowry brs. S. 80° 25' W. 32 chs.  
House of Albert Turner brs. N. 57° 05' E. 24 chs.  
24.20 Road brs E. & W. foot of slope, enter flat.  
26.00 Water hole, brs. E. & W.  
26.60 Wire fence, brs. E. & W. enter field of J.D. Lowry.  
40.00 Set a sandstone 20x10x6 ins. 15 ins. in the ground for ¼ sec. cor. marked ¼ on W. face from which,



Subdivision of T. 20 S. R. 20 E.

Chains

A mesquite tree 6 ins.diam.brs.S.18° E. 107 lks.dist.  
 marked  $\frac{1}{4}$  S. 33 B.T.  
 A mesquite tree 6 ins.diam.brs.N.6 $\frac{1}{2}$ °W. 179 lks.dist.  
 marked  $\frac{1}{4}$  S. 32 B.T.  
 52.20 Babocomori creek 50 lks. wide, 10 ft. deep course NE.  
 Dry at this point.  
 53.28 Intersect S. Bdy. of San Ignacio del Babocomori Grant.  
 Set a sandstone 20x10x10 ins. 15 ins. in the ground for  
 closing cor. of secs. 32 & 33 marked with 4 grooves on  
 E., CC. on S., & S.I.D.B. on N. faces, and raise a  
 mound of stone 3 ft. base 2 ft. high S. of cor.  
 from which,  
 A mesquite tree 6 ins.diam.brs.S.45°40'E. 107 lks.dist.  
 marked T. 20 S. R. 20 E. S. 33 C.C.B.T.  
 A willow tree 8 ins.diam.brs.S. 17° W. 163 lks.dist.,  
 marked T. 20 S. R. 20 E. S. 32 CC.B.T.  
 3 $\frac{1}{2}$  mile cor. of S.I.D.B. Grant, brs. S.70°55'55"W. 24.20 chs.  
 3 mile cor. of S.I.D.B. Grant, brs. N.70°55'55"E. 15.80 chs.  
 Land rolling, broken. Soil, 2nd & 3rd rate, sandy.  
 Timber, mesquite, willow in valley.  
 Undergrowth, mesquite, greasewood, sacaton.  
 Land covered with dense undergrowth, 53.28 chs.

From the cor. of secs. 31 & 32. on S. Bdy. of Tp.  
 Which is a redwood post 4x4x12 ins. above ground marked  
 and witnessed as described by the Surveyor General,  
 I run,  
 N.0° 3' W. bet. secs. 31 & 32.  
 18.80 Over level land, through dense sacaton & scattering mesquite.  
 Babocomori Creek, 30 lks. wide 10 ft. deep course N.75°E.  
 Dry at this point.  
 25.92 Intersect S. Bdy. of San Ignacio del Babocomori Grant.  
 Set a sandstone 24x12x10 ins. 18 ins. in the ground for  
 closing cor. of secs. 31 & 32 marked with 5 grooves on E.  
 CC.T.20.S.on.S. and S.I.D.B. on N. faces, and raise a  
 mound of stone 2 ft. base 1 $\frac{1}{2}$  ft. high S. of cor.  
 from which,  
 A mesquite tree 6 ins.diam.brs.S.56°E. 32 lks.dist.  
 marked T. 20 S. R. 20 E. S. 32 C.C.B.T.  
 A mesquite tree 6 ins.diam.brs.S.57°W. 46 lks.dist.,  
 marked T. 20 S. R. 20 E. S. 31 C.C.B.T.  
 House of A. Landers, brs. S.57 $\frac{1}{2}$ °E. about 30 chs.  
 4 $\frac{1}{2}$  mile cor. on S.Bdy.S.I.D.B. Grant, brs. S.70°55'55"W.  
 29.58 chs. *marked and witnessed as desc. by the S.S.*  
 4 mile cor. of S.I.D.B. Grant brs. N.70°55'55"E. 29.50 chs.  
 Land, level.  
 Soil, 1st & 2nd rate, sandy, loamy.  
 Timber, some willow & cottonwood, mesquite.  
 Undergrowth, mesquite, willow, sacaton.  
 Land covered with dense undergrowth, 25.92 chs.  
 May 9, 1909.

Subdivision of T. 20 S. R. 20 E.

Chains

May 10, 1909.

At 7h a.m., l.m.t., at the cor. of secs. 10, 11, 14 & 15, as heretofore described, I set off 17° 34' N. on the decl. arc and 31° 42' N. on the lat. arc and determine a true meridian with the solar,

Thence I run, for Auxiliary base line,

West on a random line, setting temp. cors. at 40 & 80 chs.

At 3 miles, 79.60 chs., I intersect the W. bdy. of Tp. at point 19 lks. N. of cor. of secs. 7, 18, 12 & 13,

Whence I run,

N. 89° 58' E. on a true line bet. secs. 7 & 18.

Over level land, through scattering mesquite & palmeo.

10.35 Old road, brs. N. & S.

39.60 Set a sandstone 24x12x10 ins. 18 ins. in the ground for 1/4 sec. cor. marked 1/4 on N. face, dig pits 18x18x12 ins. E. & W. of stone 3 ft. dist. and raise a mound of earth 3 1/2 ft. base 1 1/2 ft. high N. of cor. No bearings available.

Enter dense mesquite & tesseta, brs. N. & S.

79.60 Set a sandstone 20x12x6 ins. 15 ins. in the ground for cor. of secs. 7, 8, 17 & 18, marked with 4 notches on S. & 5 notches on E. edges and from which,

A mesquite tree 6 ins. diam. brs. N. 32 1/2° E. 148 lks. dist., marked T. 20 S. R. 20 E. S. 8 B.T.

A mesquite tree 6 ins. diam. brs. S. 42 1/4° E. 224 lks. dist., marked T. 20 S. R. 20 E. S. 17 B.T.

A mesquite tree 6 ins. diam. brs. S. 10° W. 185 lks. dist., marked T. 20 S. R. 20 E. S. 18 B.T.

A mesquite tree 6 ins. diam. brs. N. 58 1/4° W. 236 lks. dist., marked T. 20 S. R. 20 E. S. 7 B.T.

Land, level, rolling.

Soil, 2nd rate, sandy.

No timber.

Undergrowth, mesquite, tesseta, palmeo, good native grass.

Level land, -----39.60 chs.

Land covered with dense undergrowth; -----40.00 chs.

N. 89° 58' E.

bet. secs. 8 & 17.

Over gently rolling land through dense tesseta & black brush.

40.00 Set a sandstone 18x12x6 ins. 12 ins. in the ground for 1/4 sec. cor. marked 1/4 on N. face, dig pits 18x18x12 ins. E. & W. of stone 3 ft. dist. and raise a mound of earth 3 1/2 ft. base 1 1/2 ft. high N. of cor. No bearings available.

80.00 Set a pine post 3 ft. long 4 ins. sq. 2 ft. in ground for cor. of secs. 8, 9, 16 & 17, marked,

T. 20 S. S. 9 on NE.,

R. 20 E. S. 16 on SE.,

S. 17 on SW., and

S. 8 on NW. faces,

dig pits 18x18x12 ins. in each sec. 5 1/2 ft. dist. and raise a mound of earth 4 ft. base 2 ft. high W. of cor.

No bearings available.

Land, level. Soil, 2nd rate, sandy.

No timber. Undergrowth, tesseta, black brush, mesquite.

Land covered with dense undergrowth, 80.00 chs.

N. 89° 58' E. bet. secs. 9 & 16.

Over level land through very dense tesseta & mesquite.

39.90 Old road, brs. NW. & SE.

40.00 Set a redwood post 3 ft. long 4 ins. sq. 2 ft. in ground for 1/4 sec. cor. marked 1/4 S. 9 on N. & 16 on S. faces, from which,

A mesquite tree 4 ins. diam. brs. N. 82° E. 225 lks. dist., marked 1/4 S. 9 B.T.

A mesquitree 6 ins. diam. brs. S. 39° W. 145 lks. dist., marked 1/4 S. 16 B.T.

## Subdivision of T. 20 S. R. 20 E.

## Chains

80.00 Set a redwood post 3 ft. long 4 ins. sq. 2 ft. in ground for cor. of secs. 9, 10, 15 & 16, marked,  
 T. 20 S. S. 10 on NE.,  
 R. 20 E. S. 15 on SE.  
     S. 16 on SW., and  
     S. 9 on NW. faces with 4 notches on S. & E. edges,  
 dig pits 18x18x12 ins. in each sec. 5½ ft. dist. and  
 raise a mound of earth 4 ft. base 2 ft. high W. of cor.  
 No bearings available.  
 Land, roll in, level.  
 Soil, 2nd rate, sandy.  
 No timber.  
 Undergrowth, tesseta, mesquite, black brush, greasewood.  
 Land covered with dense undergrowth, -----80.00 chs.

N. 89° 58' E. bet. secs. 10 & 15.

Over level land, through dense tesseta & scattering mesquite.

40.00 Set a redwood post 3 ft. long 4 ins. sq. 2 ft. in ground for ¼ sec. cor. marked ¼ S. 10 on N. & 15 on S. faces,  
 Dig pits 18x18x12 ins. E. & W. of cor. 3 ft. dist. and  
 raise a mound of earth 3½ ft. base 1½ ft. high N. of cor.

80.00 To cor. of secs. 10, 11, 14 & 15, as heretofore described.

Land, level, gently rolling.

Soil, 2nd & 3rd rate, sandy, gravelly.

No timber.

Undergrowth, tesseta mesquite, greasewood.

Land covered with dense undergrowth, -----80.00 chs.

At this cor. at noon, I set off 17° 36' 30" N. on the dec. arc and observe the sun on the meridian.

The resulting lat. is 31° 42' N.

S. 0° 2' E. bet. secs. 15 & 16.

Over level land, through dense tesseta, & black brush.

18.25 Intersect. N. Bdy. of San Ignacio del Babocomori Grant.

Set a redwood post 3 ft. long 4 ins. sq. 2 ft. in ground for closing cor. of secs. 15 & 16, marked,

C.C.T. 20 S. R. 20, E. on N.,

    S. 15 on E.,

    S. 16 on W., and

    S.I.D.B. on S. faces with 3 grooves on E. face.

Dig pits 24x18x12 ins. crosswise on each line,

N. 70° 56' E. & S. 70° 56' W. 3 ft. dist. and N. of cor. 7 ft.

dist. and raise a mound of earth 4 ft. base 2 ft. high

N. of cor. from which,

The 45 mile cor. of S.I.D.B. Grant brs. S. 70° 55' 55" W.

21.08 chs.

*and with as desc. by the D.G.*

Cor. No. 6 of S.I.D.B. Grant brs. N. 70° 55' 55" E. 15.76 chs.

from which 45½ mile cor. on E. end line of

S.I.D.B. Grant brs. S. 19° 04' 05" E. 3.16 chs.

Plat and field notes as furnished by the Surveyor General being in error as to dist. bet. 45M & 45½ M. corners,

Land, rolling. Soil, 2nd rate, sandy.

No timber. Undergrowth, mesquite, tesseta, black brush.

Land covered with dense undergrowth, 18.25 chs.

S. 0° 2' E. bet. secs. 16 & 17.

Over level land, through dense tesseta.

40.00 Set a redwood post 3 ft. long 4 ins. sq. 2 ft. in ground for ¼ sec. cor. marked ¼ S. 17 on W. & 16 on E. faces,  
 dig pits 18x18x12 ins. N. & S. of cor. 3 ft. dist. and  
 raise a mound of earth 3½ ft. base 1½ ft. high W. of cor.  
 No bearings available.

Subdivision of T. 20 S. R. 20 E.

Chains

45.85 Intersect N. Bdy. of San Ignacio del Babocomori Grant.  
 Set a pine post 3 ft. long 4 ins. sq. 2 ft. in ground for  
 closing cor. of secs. 16 & 17, marked,  
 C.C.T. 20 S. R. 20 E. on N.,  
 S. 16 on E.,  
 S. 17 on W., and  
 S.I.D.B. on S. faces and 4 grooves on E.  
 face, and raise a mound of stone 2 ft. base 1½ ft. high  
 N. of cor. from which,  
 44 mile cor. of S.I.D.B. Grant brs. S. 70° 55' 55" W. 16.20 chs.  
 44½ mile cor. of S.I.D.B. Grant brs. N. 70° 55' 55" E. 23.80 chs.  
 45 mile cor. of S.I.D.B. Grant brs. N. 70° 55' 55" E. 63.80 chs.  
*All corners are marked and witnessed as dec. by the Sur. Genl.*

Land, rolling, level.  
 Soil, 2nd & 3rd rate, sandy, gravelly.  
 No timber. Undergrowth, tesseta, mesquite, black brush.  
 Land covered with dense undergrowth, 45.85 chs.

S. 0° 3' E. bet. secs. 17 & 18.  
 Over level, land, through dense tesseta & scattering mesquite.  
 40.00 Set a quartzite stone 24x10x10 ins. 18 ins. in the ground  
 for ¼ sec. cor. marked ¼ on W. face,  
 dig pits 18x18x12 ins. N. & S. of stone 3 ft. dist. and  
 raise a mound of earth 3½ ft. base 1½ ft. high W. of cor.  
 No bearings available.

50.00 Leave undergrowth, enter grassy hay flat, brs. E. ¾ mile &  
 W. 2 miles

70.00 Leave flat, enter dense tesseta.

73.25 Intersect N. Bdy. of San Ignacio del Babocomori Grant.  
 Set a quartzite stone 20x12x10 ins. 15 ins. in the ground  
 for closing cor. of secs. 17 & 18, marked  
 C.C. on N., S.I.D.B. on S., with 5 grooves on E. face,  
 from which,

A mesquite tree 4 ins. diam. brs. N. 62½° E. 44 lks. dist.,  
 marked T. 20 S. R. 20 E. S. 17 C.C.B.T.

A mesquite tree 4 ins. diam. brs. S. 78° W. 85 lks. dist.,  
 marked T. 20 S. R. 20 E. S. 18 C.C.B.T.

43 mile cor. of S.I.D.B. Grant brs. S. 70° 55' 55" W. 11.67 chs.  
 Thence on blank line, *marked & witnessed as dec. by the S. G.*

80.00 Cor. point for cor. of secs. 17, 18, 19 & 20.  
 Land rollin, level. Soil, 2nd rate, sandy.  
 No timber. Undergrowth, tesseta, mesquite, greasewood.  
 Land covered with dense undergrowth, -----60.00 chs.  
 Level land, ----- 20.00 chs.

From cor. point of secs. 17, 18, 19 & 20, I run,  
 S. 89° 58' W. on a random line bet. secs. 18 & 19.

40.00 Set temp. ¼ sec. cor.

79.64 Intersect W. Bdy. of Tp. 3 lks. N. of cor. of secs. 18, 19, 13,  
 & 24, whence I run,  
 N. 89° 57' E. on a true line bet. secs. 18 & 19.

Over gently rolling land, through dense mesquite.

39.64 Set a quartzite stone 20x10x10 ins. 15 ins. in ground for  
 ¼ sec. cor. marked ¼ on N. face from which,

A mesquite tree 6 ins. diam. brs. N. 70° E. 100 lks. dist.,  
 marked ¼ S. 18 B.T.

A mesquite tree 4 ins. diam. brs. S. 46° E. 163 lks. dist.,  
 marked ¼ S. 19 B.T.

60.10 Intersect N. Bdy. San Ignacio del Babocomori Grant.  
 Set a quartzite stone 20x10x8 ins. 15 ins. in ground for  
 closing cor. of secs. 18 & 19 marked C.C. on W., S.I.D.B. on  
 E., with 3 grooves on S. faces. Dig pits 18x24x12 ins. W. 7 ft.  
 and 24x30x12 ins. N. 70° 56' E. 3 ft. dist. and raise a mound of  
 earth 4 ft. base 2 ft. high W. of cor. from which,  
 43 mile cor. of S.I.D.B. Grant brs. N. 70° 55' 55" E. 9 chs.

79.64 To cor. point for cor. of secs. 17, 18, 19 & 20.  
 Land, rolling. Soil, 2nd rate, sandy. No timber. Dense mesquite.  
 Land covered with dense undergrowth, 79.64 chs.

May 10, 1909.

## Subdivision of T. 20 S. R. 20 E.

## Chains

May 11, 1909.

At 7h a.m., l.m.t. at the cor. of secs. 9, 10, 15 & 16 as heretofore described, I set off  $17^{\circ}49'30''$  N. on the decl. arc and  $31^{\circ}42'$  N. on the lat. arc and determine a true meridian with the solar.

Thence I run,

N.  $0^{\circ}2'$  W. bet. secs. 9 & 10.

Over gently rolling land, through very dense tesseta blackbrush, and greasewood, with great difficulty.

40.00 Set a quartzite stone  $18 \times 8 \times 6$  ins. 12 ins. in the ground for  $\frac{1}{4}$  sec. cor. marked  $\frac{1}{4}$  on N. face from which,

A mesquite tree 6 ins. diam. brs. N.  $19^{\circ}$  E. 121 lks. dist., marked  $\frac{1}{4}$  S. 10 B.T.

A mesquite tree 4 ins. diam. brs. S.  $79^{\circ}$  W. 55 lks. dist., marked  $\frac{1}{4}$  S. 9 B.T.

80.00 Set a quartzite stone  $12 \times 10 \times 6$  ins. 9 ins. in ground for cor. of secs. 3, 4, 9 & 10, marked with 5 notches on S. & 3 notches on E. edges.

Dig pits  $18 \times 18 \times 12$  ins. in each sec.  $5\frac{1}{2}$  ft. dist. and raise a mound of small stones covered with earth 4 ft. base 2 ft. high W. of cor.

No bearings available.

Land, rolling, level. Soil 2nd rate, sandy.

No timber.

Undergrowth, tesseta, mesquite, greasewood, blackbrush.

Land covered with dense undergrowth, and

exceptionally difficult to survey, ----80.00 chs.

N.  $89^{\circ}58'$  E. on a random line bet. secs. 3 & 10.

40.00 Set temp.  $\frac{1}{4}$  sec. cor.

80.04 Intersect N. & S. line 5 lks. N. of cor. of secs. 2, 3, 10 & 11, whence I run,

West on a true line bet. secs. 3 & 10.

Over gently rolling land, through dense mesquite & tesseta.

40.02 Set a quartzite stone  $15 \times 12 \times 8$  ins. 10 ins. in the ground for  $\frac{1}{4}$  sec. cor. marked  $\frac{1}{4}$  on N. face,

dig pits  $18 \times 18 \times 12$  ins. E. & W. of stone 3 ft. dist. and raise a mound of earth  $3\frac{1}{2}$  ft. base  $1\frac{1}{2}$  ft. high N. of cor.

No bearings available.

80.04 To cor. of secs. 3, 4, 9 & 10.

Land, rolling. Soil 2nd & 3rd rate, sandy, gravelly.

No timber.

Undergrowth, tesseta, mesquite, greasewood, blackbrush.

Land covered with dense undergrowth, 80.04 chs.

N.  $0^{\circ}8'$  W. on a random line bet. secs. 3 & 4.

40.00 Set temp.  $\frac{1}{4}$  sec. cor.

79.96 Intersect N. bdy. of Tp. 18 lks. W. of cor. of secs. 3, 4, 33 & 34, whence I run,

South, on a true line bet. secs. 3 & 4.

Over gently rolling mesa,

Through dense tesseta, blackbrush & scattering mesquite.

39.96 Set a redwood post 3 ft. long 4 ins. sq. 2 ft. in ground for  $\frac{1}{4}$  sec. cor. marked  $\frac{1}{4}$  S. 4 on W. & 3 on E. faces,

dig pits  $18 \times 18 \times 12$  ins. N. & S. of cor. 3 ft. dist. and raise a mound of earth  $3\frac{1}{2}$  ft. base  $1\frac{1}{2}$  ft. high W. of cor.

No bearings available.

54.45 Road, brs. ESE. & WNW.

79.96 To cor. of secs. 3, 4, 9 & 10.

Land, rolling. Soil, 2nd & 3rd rate, sandy, gravelly.

No timber. Undergrowth, tesseta, mesquite, blackbrush.

Land covered with dense undergrowth, 79.96 chs.

At this cor. at noon, I set off  $17^{\circ}52'$  N. on the decl. arc and observe the sun on the meridian.

The resulting latitude is  $31^{\circ}42'30''$  N.

Subdivision of T. 20 S. R. 20 E.

Chains

N. 0° 2' W. bet. secs. 8 & 9.  
 Over rolling land, through dense tesseta & scattering mesquite, and black brush.  
 40.00 Set quartzite stone 15x8x6 ins. 12 ins. in the ground for  $\frac{1}{4}$  sec.cor. marked  $\frac{1}{4}$  on W. face,  
 dig pits 18x18x12 ins.N. & S. of stone 3 ft.dist. and raise a mound of earth  $3\frac{1}{2}$ ft.base  $1\frac{1}{2}$  ft.high W. of cor.  
 55.00 Old road, brs. NW. & SE.  
 80.00 Set a quartzite stone 24x12x10 ins. 18 ins. in the ground for cor. of secs. 4, 5, 8 & 9., marked with 5 notches on S. & 4 notches on E. edges,  
 dig pits 18x18x12 ins.in each sec. $5\frac{1}{2}$  ft.dist. and raise a mound of earth 4 ft.base 2 ft. high W. of cor.  
 No bearings available.  
 Land, rolling.  
 Soil, 2nd rate, sandy.  
 No timber.  
 Undergrowth, mesquite, tesseta, black brush, greasewood.  
 Land covered with dense undergrowth, ----- 80.00 chs.

N. 89° 58' E. on a random line bet. secs. 4 & 9.  
 40.00 Set temp.  $\frac{1}{4}$  sec.cor.  
 79.90 Intersect N. & S. line 12 lks.S.of cor.of secs,4,5,8 & 9, whence I run,  
 S. 89° 57' W. on a true line bet. secs. 4 & 9.  
 Over rolling land, through dense tesseta & black brush.  
 39.95 Set a pine post 3 ft. long 4 ins. sq. 2 ft. in ground for  $\frac{1}{4}$  sec.cor. marked  $\frac{1}{4}$  S 4. on N. & 9 on S. faces,  
 dig pits 18x18x12 ins. E. & W. of cor.3 ft.dist.and raise a mound of earth  $3\frac{1}{2}$  ft.base  $1\frac{1}{2}$  ft.high N.of cor.  
 No bearings available.  
 79.90 To cor. of secs. 4,5,8 & 9.  
 Land,rolling.  
 Soil,2nd & 3rd rate, sandy,loamy.  
 No timber.  
 Undergrowth,tesseta,mesquite,greasewood,black brush,palmeo.  
 Land covered with dense undergrowth, ----- 79.90 chs.

North, on a random line bet. secs. 4 & 5.  
 40.00 Set temp.  $\frac{1}{4}$  sec.cor.  
 80.12 Intersect N. bdy.16 lks.E.of cor.of secs.4,5,32 & 33, whence I run,  
 S.0° 7' E. on a true line bet. secs. 4 & 5.  
 Over level land,  
 Through dense black brush & scattering mesquite.  
 40.12 Set a quartzite stone 20x10x10 ins. 15 ins. in the ground for  $\frac{1}{4}$  sec.cor.marked  $\frac{1}{4}$  on W. face,  
 dig pits 18x18x12 ins. N. & S. of stone 3 ft.dist.and raise a mound of earth  $3\frac{1}{2}$  ft.base  $1\frac{1}{2}$  ft.high W.of cor.  
 No bearings available.  
 47.35 Road, brs. WNW. & ESE.  
 80.12 To cor. of secs. 4,5, 8 & 9.  
 Land, rolling,level.  
 Soil, 2nd & 3rd rate, sandy, gravelly.  
 No timber.  
 Undergrowth, tesseta,black brush,mesquite,greasewood,palmeo.  
 Land covered with dense undergrowth, 80.12 chs.

May 11,1909

Subdivision of T. 20 S. R. 20 E.

Chains

May 12, 1909.  
 At 7h a.m., l.m.t., at the cor. of secs. 7, 8, 17 & 18, as heretofore described,  
 I set off 18° 05' 30" N. on the decl. arc and 31° 42' N. on the lat. arc and determine a true meridian with the solar, thence I run,  
 N. 0° 3' W. bet. secs. 7 & 8.  
 Over gently rolling land, through dense tesseta.  
 30.00 Leave undergrowth, brs. E. & W. enter grassy flat.  
 38.35 Old road, brs. NE. & SW.  
 40.00 Set a quartzite stone 20x10x6 ins. 15 ins. in the ground for ¼ sec. cor. marked ¼ on W. face, dig pits 18x18x12 ins. N. & S. of stone 3 ft. dist., and raise a mound of earth 3½ ft. base 1½ ft. high W. of cor. Leave flat, enter dense tesseta, brs. NE. & SW.  
 50.00 Leave undergrowth, brs. NE. & SW. enter grassy flat & scattering mesquite & palmeo.  
 80.00 Set a quartzite stone 20x12x12 ins. 15 ins. in the ground for cor. of secs. 5, 6, 7 & 8, marked with 5 notches on S. & E. edges, dig pits 18x18x12 ins. in each sec. 5½ ft. dist. & raise a mound of earth 4 ft. base 2 ft. high W. of cor. No bearings available.  
 Land, rolling, level. Soil, 2nd rate, sandy, loamy.  
 No timber.  
 Undergrowth, mesquite, tesseta, palmeo.  
 Land covered with dense undergrowth, ----- 40.00 chs.  
 Level land, ----- 40.00 chs.

N. 89° 58' E. on a random line bet. secs. 5 & 8.  
 40.00 Set temp. ¼ sec. cor.  
 80.08 Intersect N. & S. line 9 lks. N. of cor. of secs. 4, 5, 8 & 9, whence I run,  
 N. 89° 58' W. on a true line bet. secs. 5 & 8.  
 Over gently rolling land, through dense tesseta.  
 19.40 Road, brs. NW. & SE.  
 40.04 Set a quartzite stone 20x8x6 ins. 15 ins. in the ground for ¼ sec. cor. marked ¼ on N. face, dig pits 18x18x12 ins. E. & W. of stone 3 ft. dist., and raise a mound of earth 3½ ft. base 1½ ft. high N. of cor. No bearings available.  
 80.08 To cor. of secs. 5, 6, 7, & 8.  
 Land, rolling. Soil, 2nd & 3rd rate, sandy, loamy.  
 No timber.  
 Undergrowth, tesseta, mesquite, greasewood, palmeo.  
 Land covered with dense undergrowth, 80.08 chs.

S. 89° 58' W. on a random line bet. secs. 6 & 7.  
 40.00 Set temp. ¼ sec. cor.  
 79.55 Intersect W. Bdy. of Tp. 9 lks. S. of cor. of secs. 6, 7, 1 & 12, whence I run,  
 S. 89° 58' E. on a true line bet. secs. 6 & 7.  
 Over level land, through scattering mesquite & palmeo.  
 39.55 Set a quartzite stone 15x8x6 ins. 10 ins. in ground for ¼ sec. cor. marked ¼ on N. face, dig pits 18x18x12 ins. E. & W. of stone 3 ft. dist., and raise a mound of earth 3½ ft. base 1½ ft. high N. of cor. No bearings available.  
 79.55 To cor. of secs. 5, 6, 7 & 8.  
 Land, level.  
 Soil, 2nd rate, sandy, gravelly.  
 No timber.  
 Undergrowth, mesquite, tesseta, palmeo, fine native hay grass.  
 Level land, ----- 79.55 chs.  
 At this cor. at noon I set off 18° 7' 30" N. on the decl. arc and observe the sun on the meridian.  
 The resulting lat. is 31° 42' 30" N.

Subdivision of T. 20 S. R. 20 E.

Chains N.0° 7' W. on a random line bet. secs. 5 & 6.  
 40.00 Set temp. 1/4 sec.cor.  
 80.05 Intersect N. Bdy. of Tp. 5 lks. W. of cor.of secs.5,6,  
 31 & 32, whence I run,  
 S.0° 5' E. on a true line bet. secs. 5 & 6.  
 Over gently rolling grassy mesa.  
 40.05 Set a mesquite post 3.ft. long 3 ins. sq. with marked stone  
 2 ft.in ground for 1/4 sec.cor. marked 1/4 S. 6 on W. & 5 on  
 E. faces, Dig pits 18x18x12 ins. N. & S.of cor. on line  
 3 ft. dist. and raise a mound of earth 3 1/2 ft.base 1 1/2 ft  
 high W. of cor.  
 No bearings available.  
 80.05 To cor. of secs. 5,6,7 & 8.  
 Land,level,rolling.  
 Soil, 2nd rate,sandy,gravelly.  
 No timber.  
 Undergrowth, scattering mesquite,palmeo,  
 fine native hay grass.  
 Level land, 80.05 chs. May 12,1909.

General Description.

This Township is somewhat hilly and broken in the SE.,  
 rolling in the NE. and nearly level in the NW. portions.  
 The land in the valley of Babocomori creek is very  
 fertile and a great part of it could be reclaimed and  
 irrigated. The valley is covered with a very dense growth  
 of mesquite. Very little of the land is cleared or  
 cultivated at present.  
 The following settlers have small cleared tracts, which  
 they have fenced and improved, and also have built  
 more or less substantial buildings and irrigation ditches.

- J.H.Shipp, in sec.26.
- C.E.Miller,in sec.23.
- L.S.Hawkins in sec.23.
- T.M.Larrieu in sec.23.
- A. Turner, in sec.33.
- A. Landers in sec. 32.
- J.D.Lowry in sec. 32.
- G. Larrieu in sec. 31.
- Ramon,Escudero, in sec. 13.

The latter settler ,Ramon Escudero has highly improved  
 the land he occupies has good buildings and irrigatio  
 ditches. He also has improved land in sec. 18, of  
 T. 20 S. R. 21 E.

There is but little water in the Township except in  
 Babocomori Creek, which runs permanently about 50 miness  
 inches.

The soil is a rich sandy loam, in the valley and  
 ranges to gravelly, and stony in the broken mesas.  
 There is some cottonwood ,willow,and mesquite timber  
 along Babocomori Creek.

The NW. portion of the Tp. is a level grassy flat  
 where quantities of native hay is grown and cut.  
 The soil is very fertile and this portion could also  
 be farmed to advantage during the rainy season.

Inasmuch as I employed my assistants in the immediate  
 vicinity of the work and great delay and expense would  
 have been incurred to appear before a Notary Public or  
 other officer duly qualified to administer oaths,I was  
 compelled to administer the preliminary and final oaths  
 to my assistants.

May 12, 1909.

*Joseph B. Wright*  
 U.S. Deputy Surveyor.

*No authority found with corrections see Deputy's letter of Sept. 7-09*



FINAL OATHS OF DEPUTY SURVEYOR AND HIS ASSISTANTS.

LIST OF NAMES.

A list of the names of the individuals employed by Jesse B. Wright

....., United States Deputy Surveyor, to assist in running, measuring, and marking the lines and corners described in the foregoing field notes of the survey of .....

Subdivision of T. 20 S. R. 20 E.

showing the respective capacities in which they acted:

Walter Percival ..... Chainman.

Rollie Brown ..... Chainman.

Joe L. Finley ..... Moundman.

Ramon Escudero ..... Moundman.

Aubrey W. Anderson ..... Axman.

FINAL OATH OF ASSISTANTS.

We hereby certify that we assisted Jesse B. Wright

....., United States Deputy Surveyor, in surveying all those parts or portions of the .....

Subdivision of T. 20 S. R. 20 E.

..... of the Gila & Salt River Base & meridian, Terr. of Arizona .....

....., which are represented in the foregoing field notes as having been surveyed by him and under his direction; and that said survey has been in all respects, to the best of our knowledge and belief, well and faithfully surveyed, and the corner monuments established, according to the instructions furnished by the United States Surveyor

General for ARIZONA

Walter Percival ..... Chainman.

Rollie Brown ..... Chainman.

Joe L. Finley ..... Moundman.

Ramon Escudero ..... Moundman.

Aubrey W. Anderson ..... Axman.

Subscribed and sworn to before me this 17<sup>th</sup>

day of May, 1909



Jesse B. Wright  
U. S. Dep. Surveyor

FINAL OATH OF UNITED STATES DEPUTY SURVEYOR.

I, Jesse B. Wright, United States Deputy Surveyor, do solemnly swear that, in pursuance of a contract received from Frank S. Ingalls United States Surveyor General for Arizona, bearing date of the 9th day of February, 1909, I have well, faithfully, and truly, in my own proper person, and in strict conformity with the instructions furnished by the United States Surveyor General for Arizona, the Manual of Surveying Instructions, and the laws of the United States, surveyed all those parts or portions of

Subdivision of T. 20 S. R. 20 E.

of the Gila & Salt River Base & meridian, in the Terr. of Arizona, which are represented in the foregoing field notes as having been surveyed by me, and under my direction; and I do further solemnly swear that all the corners of said survey have been established and perpetuated in strict accordance with the Manual of Surveying Instructions, and the special written instructions of the United States Surveyor General for Arizona and in the specific manner described in the field notes, and that the foregoing are the original field notes of such survey.

Jesse B. Wright  
United States Deputy Surveyor.

Subscribed by said Jesse B. Wright, and sworn to before me }  
this 12th day of June, 1909



[Signature]  
United States Surveyor General.

APPROVAL.

OFFICE OF THE UNITED STATES SURVEYOR GENERAL,

The foregoing field notes of the survey of Subdivisions of fractional T. 20 S. R. 20 East, Gila and Salt River Base and Meridian, Arizona Phoenix, Ariz. July 20, 1909

executed by Jesse B. Wright, U.S. Dep. Sur. under his contract No. 154, dated July 9, 1909, having been critically examined, and the necessary corrections and explanations made, the said field notes, and the surveys they describe, are hereby approved.

Frank S. Ingalls  
United States Surveyor General.

I certify that the foregoing transcript of the field notes of the above-described surveys in \_\_\_\_\_, has been correctly copied from the original notes on file in this office.

\_\_\_\_\_  
United States Surveyor General.