

2223

Book C

BOOK 2223

FIELD NOTES

Accepted by G. O. letter
E. dated Sep. 26-1911
2223

OF THE SURVEY OF THE

South and West Boundaries and Subdivisional Lines
of Township Twenty-four North, Range 9 West of the
Gila and Salt River Base and Meridian.

2223

2223

2223

Of the Meridian,

Arizona

AS SURVEYED BY

W. O. Seer

Transitman
United States Deputy Surveyor,

Under his Contract No. 8, dated August 25, 1910

Survey commenced November 25 18, 1910

Survey completed December 24 November 23, 1910

2223

2223

NAMES AND DUTIES OF ASSISTANTS.

Theodor Alden	Chairman
C. J. Schwartz	Chairman
George Eitz	Flagman
J. H. McCall	Moundman
Carl Barandon	Axman
Paul Dial	Axman
Geo. J. Schwadron (See Bk. A subs T24NR9W)	Moundman
John Aubrey (" ")	Axman.

BOOK 2223

INDEX DIAGRAM.

Township 24 N., Range 9 W.

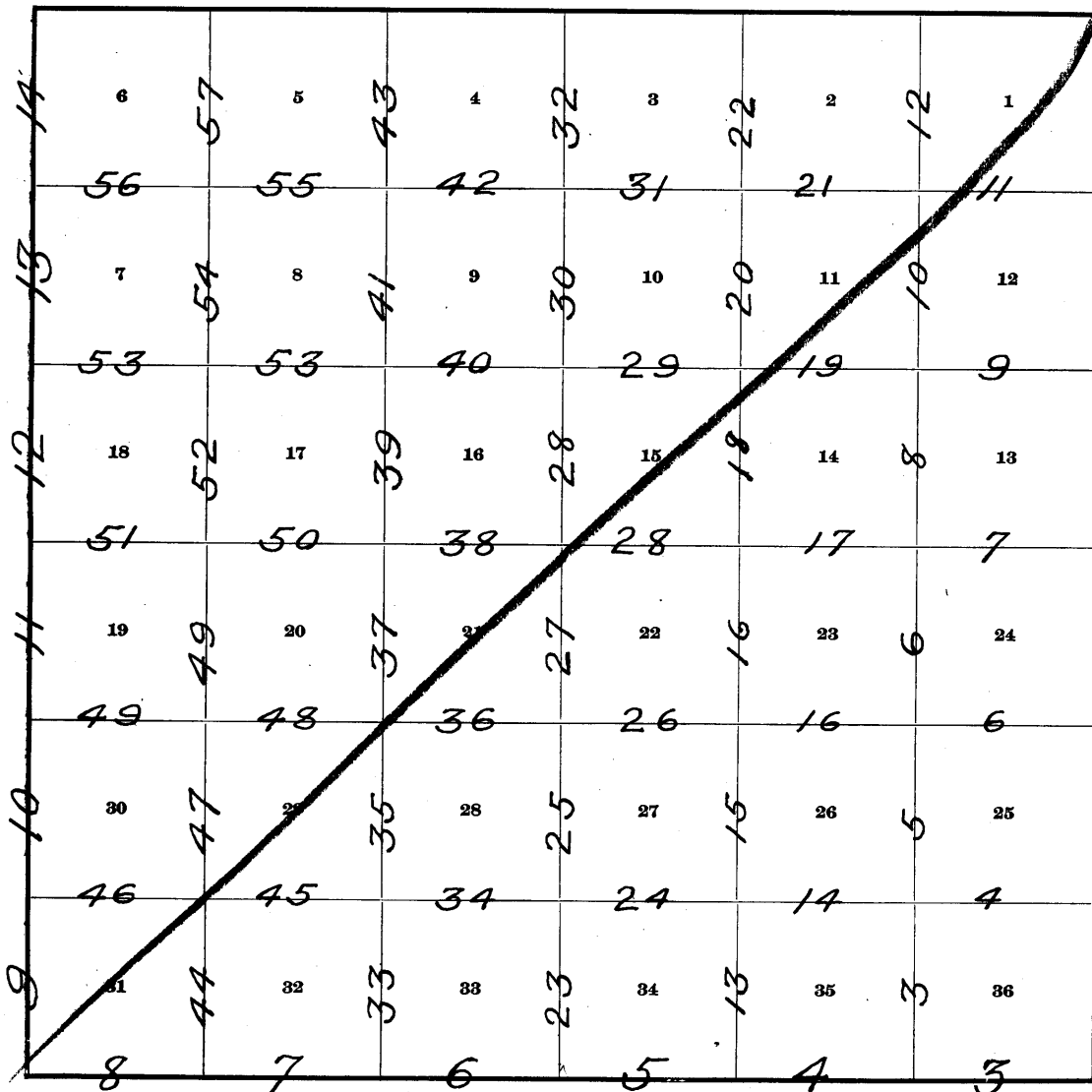

Meanders Page

BB 71

PRELIMINARY OATHS OF ASSISTANTS.

BOOK 2223

WE, Theodore Alden and C. J. Schwartz do solemnly swear that we will well and faithfully execute the duties of chainmen; that we will level the chain upon even and uneven ground, and plumb the tally pins, either by sticking or dropping the same; that we will report the true distances to all notable objects, and the true lengths of all lines that we assist in measuring, to the best of our skill and ability, and in accordance with instructions given us, in the survey of South & west lds. & subs. of T. & N. R. 9 W.

Theodore Alden, Chainman. C. J. Schwartz, Chainman.

Subscribed and sworn to before me this 18th day of November, 1910



W. O. Jacob, Transitman

WE, J. H. McCall and Geo. J. Schwadron do solemnly swear that we will well and truly perform the duties of moundmen in the establishment of corners, according to the instructions given us, to the best of our skill and ability, in the survey of S. & W. lds. & subs. T. & N. R. 9 W.

J. H. McCall, Moundman. Geo. J. Schwadron, Moundman.

Subscribed and sworn to before me this 18th day of November, 1910



W. O. Jacob, Transitman

WE, Paul Dial and Carl Barandon John Aubrey do solemnly swear that we will well and truly perform the duties of axmen in the establishment of corners and other duties, according to instructions given us, to the best of our skill and ability, in the survey of S. & W. lds. & subs. T. & N. R. 9 W.

Paul Dial, Axman. Carl Barandon John Aubrey, Axman.

Subscribed and sworn to before me this 18th day of November, 1910



W. O. Jacob, Transitman

I, George Ely, do solemnly swear that I will well and truly perform the duties of flagman according to instructions given me, to the best of my skill and ability, in the survey of S. & W. lds. & subs. T. & N. R. 9 W.

George Ely, Flagman.

Subscribed and sworn to before me this 18th day of November, 1910



W. O. Jacob, Transitman

South boundary of Tps. 24 N., R. 9 West.

Survey commenced Nov^r 18, 1910, ^{and} executed with a Buff^{er} & Berger engineer's transit N^o 672, with a Sargmüller Solar Attachment, approved by the U.S. Surveyor-General ^{and} Asst. Supervising Surveyor; the horizontal limb having two double verniers placed opposite to each other ^{and} reading to 30" of arc.

I begin at the cor. of Tps. 23 ^{and} 24 N. R. 8 ^{and} 9 W. which I recently established. Latitude $35^{\circ}25'N$, longitude $113^{\circ}11'01''W$.

At this cor., at 3^h 39^m a.m. l.m.t. I observe Polaris at western elongation in accordance with instructions in the Manual, ^{and} mark a point in the line thus determined on a rock about 5.00 Chs. N. of my station.

At 7^h 30^m a.m. I lay off the azimuth of Polaris, $1^{\circ}26'$ to the east ^{and} mark the meridian thus determined by a point on a stake driven in the ground, east of the point established this morning.

The magnetic bearing of the meridian is $N. 15^{\circ}17' W.$, which gives the magnetic decl. $15^{\circ}17' E$:

At 8^h 00^m a.m. l.m.t. I set off $19^{\circ}04' S$ on the decl. arc; $35^{\circ}25' N$ on the lat. arc; ^{and} determine a meridian with the solar which is identical with the meridian obtained from my observation on Polaris; I therefore conclude the adjustments of my instrument are satisfactory ^{and} I proceed to run

West on S. Bdy. of sec. 36.
Over rolling hills, through scattering cedars.
40.00 Set an iron post, 3 ft. long, 1 in. in diam., 26 ins. in ground, for $\frac{1}{4}$ sec. cor., marked on brass cap: $S. 36^{\circ}14'$ on N.; ^{and} $S. 1'$ on S. half; from which
A pinon 12 ins. diam. bears $N. 16^{\circ}36' E. 265$ lks. dist. marked $\frac{1}{4} S. 36 B.S.$
A cedar 7 ins. diam. bears $S. 9^{\circ}08' W. 241$ lks. dist.

South boundary Tp. 24 N. Range 9 West.

marked $\frac{1}{4}$ S. 1 B.T.

65.00 Leave cedars, proceed over rolling land,
80.00 Set an iron post 3 ft. long, 3 ins. diam. 24 ins. in ground for cor. of secs. 1, 2, 35 and 36, marked on brass cap:
T. 24 N., R. 9 W., on N.;
S. 35 in N.W.;
S. 36 in N.E.;
S. 1 in S.E.; and
S. 2 in S.W. quadrant, ^{T. 23 N. on S.} from which
A cedar 6 ins. diam. bears N. 55° 18' E. 271 lbs. dist. marked T. 24 N. R. 9 W., S. 36 B.T.
A cedar 6 ins. diam. bears S. 36° 50' E. 472 lbs. dist. marked T. 23 N. R. 9 W. S. 1 B.T. No other trees available.
Raise a mound of stone 2 ft. base, 1 1/2 ft. high N. of cor.
Land: Rolling hills 65.00 Chs.; 25.00 rolling grass land. Scattering cedars 65.00 Chs.
Good grama grass 80.00 Chs.
Soil for E. 65.00 Chs. rocky and shallow; 25.00 Chs. a dark red loam mixed with lime gravel.
Drainage to south.

West between secs. 2 and 35.

20.00 Over rolling land, descending
Bottom of draw, course S., 5.00 Chs. S. turns S. E.
Begin to asc. gentle slope
35.00 Enter scattering cedars.
40.00 Set an iron post 3 ft. long, 1 in. in diam. 26 ins. in ground for $\frac{1}{4}$ sec. cor., marked on brass cap:
 $\frac{1}{4}$ S. 35 on N.; and
S. 2 on S. half, from which
A cedar 14 ins. diam. bears N. 5° 26' W. 250 lbs. dist. marked $\frac{1}{4}$ S. 35 B.T.
A cedar 12 ins. diam. bears S. 31° 01' W. 151 lbs. dist. marked $\frac{1}{4}$ S. 2 B.T.
60.00 Enter dense cedars, ascend more abruptly over rough hilly land.

South boundary Tp. 24 N. Range 9 West

72.00 Top of rise.
 74.00 Descend
 76.00 Draw, course S.E.
 80.00 Set an iron post 3 ft. long, 3 ins. diam. 24 ins
 in ground for cor. of secs. 2, 3, 34 and 35, marked
 on brass cap:
 T. 24 N., R. 9 W. on N.;
 S. 34 on N.W.;
 S. 35 in N.E.; and
 S. 2 in S.E.;
 S. 3 in S.W. quadrant, ^{T. 23 N. on S.} from which
 A cedar 6 ins. diam. bears N. 18° 50' W. 95 lks.
 dist. marked T. 24 N., R. 9 W. S. 34 B. J.
 A cedar 8 ins. diam. bears N. 67° 00' E. 15 lks.
 dist. marked T. 24 N., R. 9 W. S. 35 B. J.
 A piñon 6 ins. diam. bears S. 43° 55' W. 6 lks. dist.
 marked T. 23 N., R. 9 W. S. 3 B. J.
 A cedar 14 ins. diam. bears S. 45° 14' E. 100 lks.
 dist. marked T. 23 N., R. 9 W., S. 2 B. J.
 Land: E. 40.00 Chs. rolling; W. 40.00 Chs. rough
 & hilly. Dense cedars and brush 20.00 Chs.
 Scattering cedars 60.00 Chs.
 Soil, rocky and of no value other than grazing.

Nest between secs. 3 and 34.
 Descending through dense cedars.
 40.00 Set an iron post 3 ft. long, 1 in. in diam. 26 ins.
 in ground for 1/4 sec. cor., marked on brass cap:
 1/4 S. 34 on N.; and
 S. 3 on S. half, from which
 A cedar 12 ins. diam. bears S. 26° 38' W. 33 lks.
 dist., marked 1/4 S. 3 B. J.
 A cedar 7 ins. diam. bears N. 38° 06' W. 44 lks. dist.
 marked 1/4 S. 34 B. J.

Nov. 18, 1910.

South boundary of Tp. 24 N. R. 9 West

60.00
80.00

Nov 19: At 8^h 00^m a.m. l.m.t. I set off $19^{\circ} 18\frac{1}{2}' S.$ on the decl. arc; $35^{\circ} 25' N.$ on the lat. arc; and determine a meridian with the solar at the $\frac{1}{4}$ sec. cor. on the S. bdy. sec. 34; thence I run West on S. Bdy. sec. 34.

Cedars become scattering
Set an iron post 3 ft. long, 3 ins. diam. 24 ins. in ground for cor. of secs. 3, 4, 33^{and} 34, marked on brass cap:
T. 24 N., R. 9 W. on N.;
S. 33 in N.W.;
S. 34 in N.E.;
S. 3 in S.E.;
S. 4 in S.W. quadrant,^{and}
T. 23 N. on S., from which a cedar branch 8 ins. diam. bears $S. 10^{\circ} 25' E.$ 127 lks. dist. marked T. 23 N. R. 9 W. S. 3 B.T.
A cedar 6 ins. diam. bears $S. 15^{\circ} 15' W.$ 346 lks. dist. marked T. 23 N. R. 9 W. S. 4 B.T. - No other trees.
Dig pits 18x18x12 ins. in secs. 33^{and} 34, $5\frac{1}{2}$ ft. dist. ^{and} raise a mound of earth 4 ft. base, 2 ft. high N. of cor.
Land rolling: Soil dark red or brown loam mixed with lime gravel.
Dense cedars 60.00 Chs.; Scattering cedars 20.00 Chs.; Good growth of grama grass covers the mile.

15.00
20.00
40.00

West between secs. 4^{and} 33.
Over rolling land.
Enter dense cedars
Cedars become scattering.
Set an iron post 3 ft. long, 1 in. in diam. 26 ins. in ground for $\frac{1}{4}$ sec. cor., marked on brass cap:
 $\frac{1}{4}$ S. 33 on N.; ^{and}
S. 4 on S. half; dig pits 18x18x12 ins. E^{and} W of post 3 ft. dist. ^{and} raise a mound of earth

South boundary of Tp. 24 N. Range 9 West.

80.00 3 1/2 ft. base, 1 1/2 ft. high N. of cor.
 Proceed along N. edge of open park
 Set an iron post 3 ft. long, 3 ins. diam. 24 ins. in ground for cor. of secs. 4, 5, 32 and 33, marked on brass cap:
 T. 24 N. R. 9 W. on N.;
 S. 32 on N. W.;
 S. 33 on N. E.;
 S. 4 on S. E.; and
 S. 5 in S. W. quadrant, and
 T. 23 N. on S.; dig pits 18x18x12 ins. in each sec. 5 1/2 ft. dist. and raise a mound of earth 4 ft. base, 2 ft. high N. of cor.
 Land rolling. Soil, a sandy loam mixed with lime gravel with a hard lime sub-soil.
 Dense cedars 5.00 Chs.
 An abundant growth of grama grass covers the mile.

West between secs. 5 and 32.
 Over rolling, open park.
 20.00 Begin to asc. gradually - Enter grove of cedars and pinons.
 30.00 Leave grove.
 40.00 Set an iron post 3 ft. long, 1 in. in diam, 26 ins. in ground for 1/4 sec. cor. marked on brass cap:
 1/4 S. 32 on N.; and
 S. 5 on S. half; dig pits 18x18x12 ins. E. and W. of post 3 ft. dist.; and raise a mound of earth 3 1/2 ft. base, 1 1/2 ft. high N. of cor.
 60.00 Top of low ridge covered with burnt cedars, brass N.E. and S.W. Descend gradually.
 71.70 Road Yampai to Ft. Rock, brass N.E. and S.W. asc.
 75.00 Enter scattering cedars
 80.00 Set an iron post 3 ft. long, 3 ins. diam. 24 ins. in ground for cor. of secs. 5, 6, 31 and 32, marked on brass cap:
 T. 24 N. R. 9 W. on N.;

South boundary of Tp. 24 N. Range 9 West.

S. 31 in N.W.;
 S. 32 in N.E.;
 S. 5 in S.E.; ^{and}
 S. 6 in S.W. quadrant, ^{and}
 T. 23 N. on S., from which
 A cedar 12 ins. diam. bears S. 41° 08' E. 14 lks. dist., marked T. 23 N. R. 9 W. S. 5 B.T.
 A cedar 8 ins. diam. bears N. 54° 25' E. 161 lks. dist., marked T. 24 N. R. 9 W. S. 32 B.T.
 A cedar 6 ins. diam. bears S. 4° 41' W. 107 lks. dist. marked T. 23 N. R. 9 W. S. 6 B.T.
 A cedar 6 ins. diam. bears N. 25° 26' W. 275 lks. dist. marked T. 24 N. R. 9 W. S. 31 B.T.
 Land rolling: Dense cedars 10.00 chs.
 Scattering cedars ^{and} dense brush 20.00 chs.
 Soil: E. 20.00 chs. loose sandy loam mixed with small gravel. W. 60.00 chs. rocky ^{and} unfit for any purpose other than grazing.
 A good growth of grama grass covers the mile.

West between secs. 6 ^{and} 31
 Ascending over rolling land through scattering cedars, dense brush ^{and} burnt cedars.
 12.00 Top of ascent - Descend.
 15.37 Road - Nelson to Ft. Rock, bears N.W. ^{and} S.E.
 40.00 Set an iron post 3 ft. long, 1 in. in diam. 26 ins. in ground for $\frac{1}{4}$ sec. cor, marked on brass cap:
 $\frac{1}{4}$ S. 31 on N.; ^{and}
 S. 6 on S. half, from which
 A cedar 18 ins. diam. bears S. 51° 48' E. 168 lks. dist. marked $\frac{1}{4}$ S. 6 B.T.
 A cedar branch 12 ins. diam. bears N. 86° 25' W. 120 lks. dist. marked $\frac{1}{4}$ S. 31 B.T.
 50.00 Foot of descent, Ascend through dense cedars.
 78.46 Set an iron post, 3 ft. long, 3 ins. diam. 24 ins. in ground for cor. of Tps. 23 ^{and} 24 N. Rs. 9 ^{and} 10 W. marked on brass cap.

South boundary of township 24 N. R. 9 West

T. 24 Non N.;
 R. 10 W. - S. 36 on N.W.;
 R. 9 W - S. 31 in N.E.;
 S. 6 in S.E.;^{and}
 S. 1 in S.W. quadrant,^{and}
 T. 23 Non S.; from which
 A cedar 14 ins. diam. bears N. 70° 10' W. 36 lks. dist. marked T. 24 N. R. 10 W. S. 36 B.T.
 A cedar 7 ins. diam. bears S. 5° 41' W. 268 lks. dist. marked T. 23 N. R. 10 W. S. 1 B.T.
 A cedar 24 ins. diam. bears S. 73° 52' E. 121 lks. dist. marked T. 23 N. R. 9 W. S. 6 B.T.
 A cedar 8 ins. diam. bears N. 45° 00' E. 210 lks. dist. marked T. 24 N. R. 9 W. S. 31 B.T.
 Land rolling: Dense cedars 30.00 Chs.
 Scattering cedars 50.00 Chs.; Dense brush 80.00 Chs.
 Soil: a sandy loam mixed with small gravel on a sub-soil of hard clay.
 A good growth of grama grass covers the mile.
 Nov 19, 1910.

West boundary of Tp. 24 N. R. 9 West.

Nov 21: At 8^h 00^m a.m. l.m.t. I set off 19° 46' S on the decl. arc; 35° 25' N. on the lat. arc; ^{and} determine a meridian with the solar at the cor. of Tps. 23 ^{and} 24 N. R. 9 ^{and} 10 W. thence I run North between secs. 31 ^{and} 36

9.00
23.00
40.00

Over rolling land, through dense cedars ^{and} brush. Leave cedars ^{and} brush. Enter E. edge of open park. Enter dense cedars ^{and} brush. Set an iron post 36 ins. long, 1 in. in diam. 26 ins. in ground for 1/4 sec. cor. marked on brass cap: S. 36 1/4 on W.; ^{and}
 S. 31 on E. half; from which
 A cedar branch 17 ins diam. bears S. 81° 55' W. 29 lks. dist. marked S. 1/4 36 B.T.
 A cedar 24 ins diam. bears N. 55° 23' E. 148 lks. dist. marked 1/4 S. 31 B.T.
 Cedars become scattering, Desc. gradually.

43.00

West boundary of Township 24 N. Range 9 West.

80.00 Set an iron post 3 ft. long, 3 ins. in diam. 24 ins. in the ground for cor. of secs. 25, 30, 31^{and} 36, marked on brass cap:
T. 24 N., on N.;
R. 10 W. - S. 25, in N.W.;
R. 9 W. - S. 30, in N.E.;
S. 31 in S.E.;^{and}
S. 36 in S.W. quadrant; from which
A cedar 9 ins diam. bears S. 23° 23' W. 370 lks. dist.
marked T. 24 N. R. 10 W. S. 36 B.S.
No other trees available; dig pits 18x18x12 ins. in secs 25, 30^{and} 31, 5 1/2 ft. dist. ^{and} raise a mound of earth 4 ft. base, 2 ft. high W. of cor.
Land rolling with drainage to N.
Soil of good quality, though rather heavy; of a yellowish color with lime gravel.
Dense cedar 29.00 chs. Good grass covers the hills.

North between secs. 25^{and} 30.
Descending gentle slope through open park.
0.60 Road bears N. 60° E. ^{and} S. 60° W.
11.24 Old road bears N.E. ^{and} S.W.
38.36 Road bears E. ^{and} W. - Foot of descent, drainage to W.; ascend
40.00 Set an iron post 3 ft. long, 1 in. in diam. 26 ins. in ground for 1/4 sec. cor. marked on brass cap:
S. 25 1/4 on W.;^{and}
S. 30 on E. half;
dig pits 18x18x12 ins. N. ^{and} S. of post 3 ft. dist.
^{and} raise a mound of earth 3 1/2 ft. base, 1 1/2 ft. high W. of cor.
Begin to ascend more abruptly.
52.00 Top of low ridge, bears N.E. ^{and} S.W. - Descend.
60.00 Foot of descent - Draw course W.; Ascend.
80.00 Set an iron post 3 ft. long, 3 ins. in diam. 24 ins. in ground for cor. of secs. 19, 24, 25^{and} 30, marked on brass cap:
T. 24 N., on N.;

West boundary of Township 24 N. Range 9 West.

R. 10 W-S. 24 on N. W.;
 R. 9 W.-S. 19 in N. E.;
 S. 30 in S. E.; ^{and}
 S. 25 in S. W. quadrants;
 dig pits 18x18x12 ins. in each sec. 5 1/2 ft. dist. ^{and}
 raise a mound of earth 4 ft. base, 2 ft. high
 W. of cor.

Land rolling,
 Soil: a rather heavy, yellowish loam mixed
 with lime gravel, supporting an excellent
 growth of grama grass ^{and} low brush.
 Nov 21, 1910

Nov 22: At 7^h 55^m a.m. l.m.t. I set of 19° 59'
 S. on the decl. arc; 35° 26' 30" N. on the lat. arc;
^{and} determine a meridian with the solar at the
 cor. of secs. 19, 24, 25 ^{and} 30; thence I run
 North bet. secs. 19 ^{and} 24.

Ascending.

5.00 Enter dense cedar ^{and} brush; ascend more ab-
 ruptly over boulders ^{and} frequent cropping of lime
 bed-rock.

40.00 Set an iron post 3 ft. long, 1 in. in diam. 26
 ins. in ground for 1/4 sec. cor. marked on brass cap:
 S. 24 1/4 on N.; ^{and}
 S. 19 on E. half; from which
 A piñon 8 ins. diam. bears S. 50° 30' W. 49 lks.
 dist. marked 1/4 S. 24 B.T.
 A cedar 12 ins. diam. bears N. 41° 38' E. 61 lks.
 dist. marked 1/4 S. 19 B.T.

72.00 Top of rise - apparently the highest point in the
 township. Proceed over rolling land through
 dense brush ^{and} scattering cedar ^{and} piñons.

80.00 Set an iron post 3 ft. long, 3 ins. in diam. 24
 ins. in ground for cor. of secs. 13, 18, 19 ^{and} 24, mkd.
 on brass cap:
 T. 24 N. on N.;
 R. 10 W.-S. 13, in N. W.;

West boundary Township 24 N. Range 9 West.

R. 9 W. - S. 18, in N. E.;
 S. 19 in S. E.; ^{and}
 S. 24 in S. W. quadrant, from which
 A cedar 8 ins. diam. bears S. 46° 56' W. 183 lks. dist.
 marked T. 24 N. R. 10 W. S. 24 B. T.
 A cedar 18 ins. diam. bears N. 80° 18' E. 139 lks. dist.
 marked T. 24 N. R. 9 W. S. 18 B. T.
 A cedar 10 ins. diam. bears S. 6° 47' E. 285 lks. dist.
 marked T. 24 N. R. 9 W. S. 19 B. T.
 A cedar 8 ins. diam. bears N. 9° 20' W. 250 lks. dist.
 marked T. 24 N. R. 10 W. S. 13 B. T.
 Land rough ^{and} very rocky.
 Soil thin - lime bed-rock close to surface.
 Dense cedar ^{and} pines by 67.00 Chs.
 Fair growth of grama grass covers the mile.

North between secs. 13 ^{and} 18.
 Over rolling land, through dense brush and
 scattering cedars.
 20.00 Enter dense cedars.
 40.00 Set an iron post 3 ft. long, 1 in. in diam. 26 ins.
 in ground for $\frac{1}{4}$ sec. cor. marked on brass cap:
 S. 13 $\frac{1}{4}$ on W.; ^{and}
 S. 18 on E. half, from which
 A cedar 8 ins. diam. bears N. 14° 35' E. 68 lks. dist.
 marked $\frac{1}{4}$ S. 18 B. T.
 A cedar 8 ins. diam. bears S. 46° 00' W. 97 lks. dist.
 marked $\frac{1}{4}$ S. 13 B. T.
 80.00 Set an iron post 3 ft. long, 3 ins. diam. 24 ins.
 in ground for cor. of secs. 7, 12, 13 ^{and} 18, marked
 on brass cap.
 T. 24 N. on N.;
 R. 10 W. - S. 12 in N. W.;
 R. 9 W. - S. 7 in N. E.;
 S. 18 in S. E.; ^{and}
 S. 13 in S. W. quadrant, from which
 A cedar 20 ins. diam. bears N. 40° 50' W. 120 lks.
 dist. marked T. 24 N. R. 10 W. S. 12 B. T.

West boundary of Township 24 N. Range 9 West.

A cedar 15 ins. diam bears S. 57° 00' W. 180 lks. dist. marked T. 24 N. R. 10 W. S 13 B. T.

A cedar 16 ins. diam. bears N. 46° 15' E. 132 lks. dist. marked T. 24 N. R. 9 W. S. 7 B. T.

A piñon 20 ins. diam. bears S. 47° 56' E. 212 lks. dist. marked T. 24 N. R. 9 W. S 18 B. T.

Land rolling: Dense cedars ^{and} piñons 60.00 Chs
Soil thin ^{and} rocky. Good grama grass
Dense brush 80.00 Chs.

Nov 22. 1910.

Nov 23: At 8^h 10^m a.m. l.m.t. I set off 20° 12' S on the decl. arc; 35° 29' N. on the lat. arc; ^{and}, at the cor. of secs. 7, 12, 13 ^{and} 18, determine a meridian with the solar; thence I run

North between secs. 7 ^{and} 12

Over rolling, rocky land, through dense cedars ^{and} buck brush.

7.00

Cedars become thinner; descend to draw.

15.00

Center of draw, course E., at 10 Chs. turns N. E.

Ascend

22.00

Top of ascent. Proceed over rolling land thro. dense cedars.

40.00

Set an iron post 3 ft. long, 1 in. diam. 26 ins. in ground for 1/4 sec. cor. marked on brass cap:

S. 12 1/4 on W.; ^{and}

S. 7 on E. half, from which

A cedar 20 ins. diam bears N. 24° 50' E. 50 lks. dist. marked 1/4 S. 7 B. T.

A cedar 20 ins. diam. bears N. 48° 50' W. 137 lks. dist. marked 1/4 S. 12 B. T.

80.00

Set an iron post 3 ft. long, 3 ins. diam. 24 ins. in ground for cor. of secs. 1, 6, 7 ^{and} 12, marked on brass cap:

T. 24 N. on N.;

R. 10 W. - S. 1 in N. W.;

R. 9 W. - S. 6 in N. E.;

S. 7 in S. E.; ^{and}

West boundary of Township 24 N. Range 9 West.

5.12 in S.W. quadrant, from which
 A cedar 8 ins. diam. bears N. 30° 01' W. 41 lks. dist.
 marked T. 24 N. R. 10 W. S. 1 B. T.
 A cedar 12 ins. diam. bears N. 82° 39' E. 41 lks. dist.
 marked T. 24 N. R. 9 E. S. 6 B. T.
 A cedar 6 ins. diam. bears S. 46° 17' E. 130 lks. dist.
 marked T. 24 N. R. 9 W. S. 7 B. T.
 A cedar 12 ins. diam. bears S. 56° 32' W. 36 lks. dist.
 marked T. 24 N. R. 10 W. S. 12 B. T.
 Land rough, rolling ^{and} very rocky; many large
 lime boulders with frequent croppings of limestone
 ledges: Bed-rock close to surface.
 Soil very thin, but bears a good crop of grama
 grass. Dense cedars 65.00 Chs.

North between secs. 1 ^{and} 6.

Over rough, rocky land, through dense cedars.
 Descending.

- 2.00 Bottom of draw, course E.; ascend.
- 15.50 Top of ascent, descend.
- 28.50 Bottom of draw, course N. 75° E., Ascend.
- 39.50 Top of high ridge bearing E. ^{and} W.
- 40.00 Point for cor. coming where lime bed-rock is
 near the surface, ^{and} a careful search revealing
 no spot within a reasonable distance that will
 admit an iron post, I set a hard lime stone
 30 x 12 x 8 ins., 10 ins. in ground on top of lime bed-
 rock, for 1/4 sec. cor. marked 1/4 S. 1 on W.; ^{and} 1/4 S. 6 on
 E, face ^{and} built a mound of stone around cor.
 from which
 A cedar 10 ins. diam. bears N. 78° 49' E. 108 lks.
 dist. marked 1/4 S. 6 B. T.
 A cedar 9 ins. diam. bears S. 84° 55' W. 21 lks.
 dist. marked 1/4 S. 1 B. T.
- 41.00 Descend over rough, rocky land.
- 73.68 Intersect 6th Standard Parallel North 16.80 Chs.
 west of standard cor. of secs. 31 ^{and} 32, Tp. 25 N.
 R. 9 W. recently set by me,

West boundary of Township 24 N. Range 9 West.

Set an iron post 3 ft. long, 3 ins. diam. 24 ins. in the ground for closing cor. of Tps. 24 N. Rs. 9 ^{and} 10 W. marked on brass cap:
 C.C., S. of centre;
 T. 25 N. R. 9 W., S. 31 in N.;
 T. 24 N. in S. half;
 S. 6, R. 9 W. in S.E. ^{and}
 S. 1, R. 10 W. in S.W. quadrant; from which
 A piñon 12 ins. diam. bears S. 12° 18' E. 91 lks. dist. marked T. 24 N. R. 9 W. S. 6 C.C. B.T.
 A piñon 10 ins. diam. bears S. 31° 34' W. 104 lks. dist. marked T. 24 N. R. 10 W. S. 1 C.C. B.T.
 Land rough ^{and} exceedingly rocky; the lime bed-rock being close to the surface ^{and} frequently exposed. Dense cedars 73.68 chs.
 Soil very thin though bearing a good crop of grama grass.
 Nov 23, 1910.

Boundaries of Tps. 24 N. Range 9 West.
 Latitudes, departures ^{and} closing errors.

Lines designated	Bearing	Dist.	Latitudes		Departures	
			N.	S.	E.	W.
6 th Standard Parallel N.	West	477.62				477.62
2 nd G. Meridian W.	North	473.49	473.49			
N. Bdy. T. 24 N. R. 9 W.	South	473.68		473.68		
S. Bdy. T. 24 N. R. 9 W.	East	478.46			478.46	
Convergence						0.51
Totals			473.49	473.68	478.46	478.13
Closing errors			Lat.	0.19	0.33	Depts



West boundary of Township 24 N. Range 9 West.

General Description.

The south ^{and} west boundaries of this township are generally hilly ^{and} rough, though not sufficiently rough to be called mountainous.

In the hilly portions lime ledges ^{and} bed-rock frequently crop ^{and}, in some localities are exposed over a considerable area.

There are several narrow draws or graded valleys that are without timber or brush, but in which grama grass grows abundantly.

The timber in this township is principally cedar with some piñon, ^{and} is only fit for fence posts ^{and} fire-wood.

There are no settlers along the south or west boundaries, neither is there any water.

LIST OF NAMES.

A list of the names of the individuals employed by W. O. Secor

Transitman
Deputy Surveyor

United States Deputy Surveyor, to assist in running, measuring, and marking the lines and corners described in the foregoing field notes of the survey of The south and west boundaries and subdivisional lines of T. 24 N. R. 9 West showing the respective capacities in which they acted:

- Theodore Alden Chainman.
- C. J. Schwartz Chainman. ✓
- J. H. McCall Moundman. ✓
- Geo. J. Schwadron (For oath see Bk. A - Subs. T. 24 N. R. 9 W.) Moundman.
- Paul Dial Axman. ✓
- Carl Barandon Axman.
- George Etz Flagman. ✓
- John Aubrey (For oath see Bk. A Subs. T. 24 N. R. 9 W.) Axman. ✓

FINAL OATH OF ASSISTANTS.

We hereby certify that we assisted W. O. Secor

Transitman

United States Deputy Surveyor, in surveying all those parts or portions of the South and West Boundaries and Subdivisional Lines of Township Twenty-four North of Range Nine West of the Gila and Salt River Meridian

of the _____ meridian, Territory of Arizona, which are represented in the foregoing field notes as having been surveyed by him and under his direction; and that said survey has been in all respects, to the best of our knowledge and belief, well and faithfully surveyed, and the corner monuments established, according to the instructions furnished by the United States Surveyor General for Arizona.

- Theodore Alden Chainman.
- C. J. Schwartz Chainman.
- J. H. McCall Moundman.
- Moundman.
- Paul Dial Axman.
- Axman.
- George Etz Flagman.

Subscribed and sworn to before me this 24th day of December, 1910

W. O. Secor
Transitman



107
BOOK 2223

FINAL OATH OF UNITED STATES DEPUTY SURVEYOR.

I, W. O. Secor, ^{Transitman} United States Deputy Surveyor, do solemnly swear that, ~~in pursuance of a contract received from~~ United States Surveyor General for _____, bearing date of the _____ day of _____, 19____, I have well, faithfully, and truly, in my own proper person, and in strict conformity with the instructions furnished by the United States Surveyor General for _____, the Manual of Surveying Instructions, and the laws of the United States, surveyed all those parts or portions of the south and west boundaries and subdivided lines of Twp. 24 N. R. 9 West of the Gila and Salt River Base and Meridian

_____ of the _____ meridian, in the Territory of Arizona, which are represented in the foregoing field notes as having been surveyed by me, and under my direction; and I do further solemnly swear that all the corners of said survey have been established and perpetuated in strict accordance with the Manual of Surveying Instructions, and the special written instructions of the United States Surveyor General for Arizona and in the specific manner described in the field notes, and that the foregoing are the original field notes of such survey.

W. O. Secor
United States Deputy Surveyor.

Subscribed by said W. O. Secor, and sworn to before me }
this 17th day of January, 1911

my com
expires Jan 16th 1915 William Grant
Notary Public



APPROVAL.

OFFICE OF THE UNITED STATES SURVEYOR GENERAL,
Phoenix, Ariz. March 15, 1911.

The foregoing field notes of the survey of the South and West

Boundaries of Twp. 24 N. R. 9 W.
Gila and Salt River Base and Meridian, Arizona

executed by W. O. Secor
under his ~~contract~~ ^{group} No. 8, dated August 25, 1910, having been critically examined, and the necessary corrections and explanations made, the said field notes, and the surveys they describe, are hereby approved.

Frank S. Lyall
United States Surveyor General.

I certify that the foregoing transcript of the field notes of the above-described surveys in _____, has been correctly copied from the original notes on file in this office.

United States Surveyor General.