

2406

64
1

Ordered filed G.L.D. letter "C" Sept. 6, 1913

Original and Supplemental

Book L.

BOOK 2406

FIELD NOTES

OF THE SURVEY OF THE

Subdivision of Tract Tp. 1 N. R. 16 E

and

Retracement of Portion of West Boundary of
White Mountain or San Carlos Indian Reservation

Of the Gila and Salt River Basins and Meridian,

Arizona

AS SURVEYED BY

Roscoe C. Ham, United States Deputy Surveyor,

Under his Contract No. 162, dated January 5, 1910

Survey commenced November 22, 1910

Survey completed November 26, 1910

1A

BOOK 2406

20 NAMES AND DUTIES OF ASSISTANTS.

See Book 6. Subs. of T.N. R 15/2/6

Handwriting practice lines consisting of multiple horizontal dashed lines.

BOOK 2406

INDEX DIAGRAM.

Township 1 N., Range 16 E.

Notes of this line
in Supplemental Book "D"
hereto attached

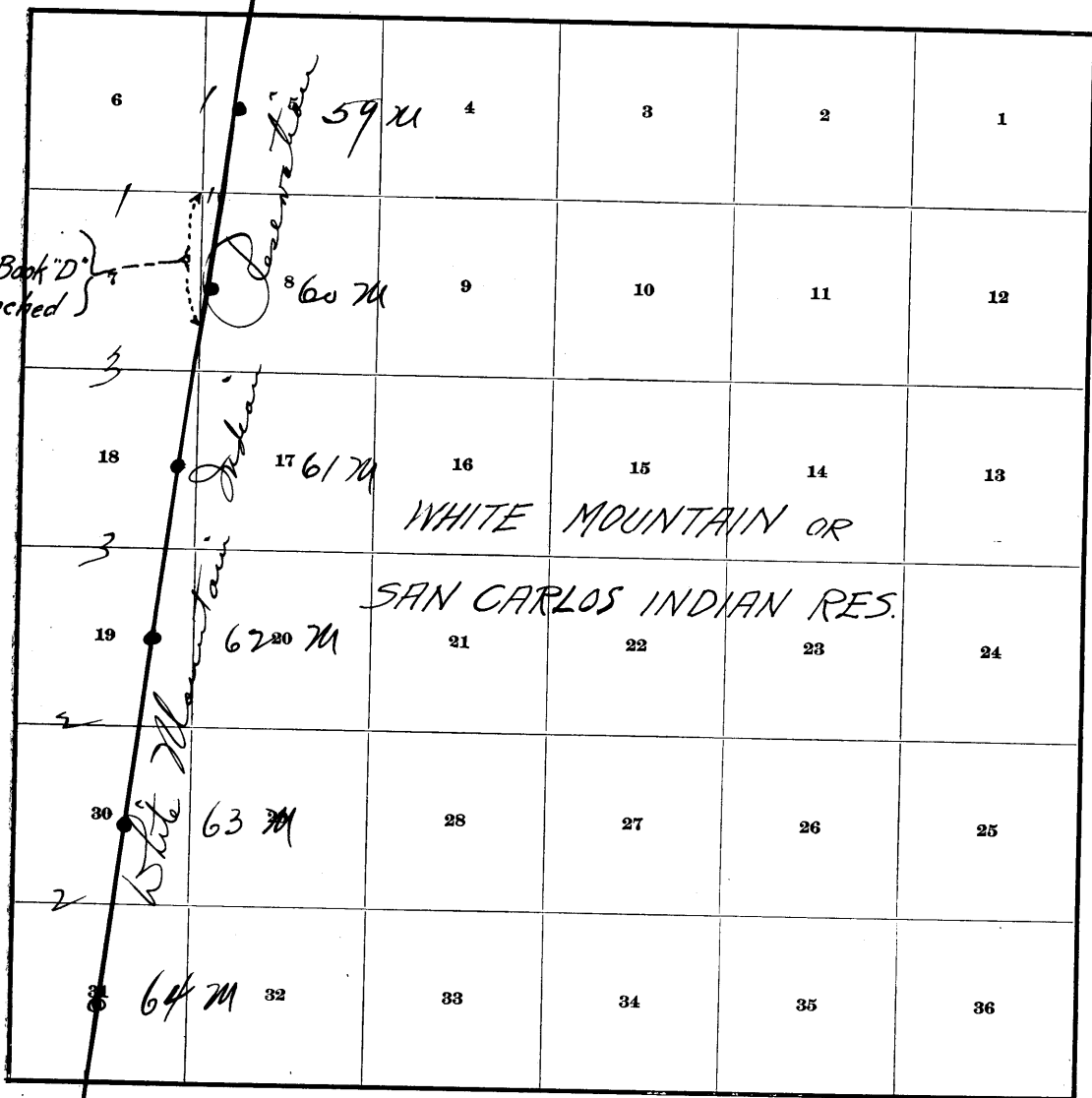

Meanders Page

For

PRELIMINARY OATHS OF ASSISTANTS.

On Book G. Subs. T.M.R. 15 1/2 E.

WE, _____ and _____

do solemnly swear that we will well and faithfully execute the duties of chainmen; that we will level the chain upon even and uneven ground, and plumb the tally pins, either by sticking or dropping the same; that we will report the true distances to all notable objects, and the true lengths of all lines that we assist in measuring, to the best of our skill and ability, and in accordance with instructions given us, in the survey of

_____, *Chainman.*

_____, *Chainman.*

Subscribed and sworn to before me this _____ }
day of _____, 19 _____ }



WE, _____ and _____

do solemnly swear that we will well and truly perform the duties of moundmen in the establishment of corners, according to the instructions given us, to the best of our skill and ability, in the survey of

_____, *Moundman.*

_____, *Moundman.*

Subscribed and sworn to before me this _____ }
day of _____, 19 _____ }



WE, _____ and _____

do solemnly swear that we will well and truly perform the duties of axmen in the establishment of corners and other duties, according to instructions given us, to the best of our skill and ability, in the survey of

_____, *Axman.*

_____, *Axman.*

Subscribed and sworn to before me this _____ }
day of _____, 19 _____ }



I, _____, do solemnly swear that I will well and truly perform the duties of flagman according to instructions given me, to the best of my skill and ability, in the survey of _____

_____, *Flagman.*

Subscribed and sworn to before me this _____ }
day of _____, 19 _____ }



Subdivision of Township 1 North, Range 16 East.

10

Chains.

Survey commenced November 22, 1910, and executed with a Young & Sons light mountain transit No. 5609, equipped with a Smith solar attachment, the horizontal limb being provided with two opposite verniers reading to 1' of arc, which is also the least count of the verniers of the latitude and declination arcs.

I examine the adjustments of the transit, and correct the level and collimation errors.

Thence I run
S. 61° W. on a true line bet. secs. 5 and 6.

Ascending over mountainous land.

4.00 Top ridge, brs. E and W, 100 ft. above cor. Descend

17.70 Small gulch, brs. E and W, 10 lks. wide, course SW, ascend.

38.00 Top ridge, brs. NE and SW. Descend

40.00 Falls on SE. slope. Set a limestone, 17x9x7 ins., 13 ins. in the ground for $\frac{1}{4}$ sec. cor., marked $\frac{1}{4}$ on W. face; and raise a mound of stone, 2 ft. base, $1\frac{1}{2}$ ft. high W. of cor.

Magnetic declination, N. 14° 15' E., 800 ft. below top of ridge

40.70 Gulch, course SW. Ascend

42.50 Top of ascent on W. slope.

48.00 Shaft, 6x6x10 ft., 75 lks. E. of line.

52.00 Descend.

54.50 Gulch, 30 lks. wide, course SW. Ascend along W. slope.

63.00 Top W. slope ridge. Descend.

74.00 Gulch, 40 lks. wide, course SW. Ascend along W. slope.

76.50 Top W. slope. Descend.

80.00 On S. slope. Set a limestone, 15x10x10 ins., 10 ins. in the ground for cor. secs. 5, 6, 7 and 8, marked, 5 notches on E. edge; 5 notches on S. edge; and raise a mound of stone, 2 ft. base, $1\frac{1}{2}$ ft. high, W. of cor.

Magnetic declination, N. 14° E.

Land, mountainous.
Soil, rocky; 4th and 5th rate.
No timber.
Undergrowth, few scrub oak, palo Cristo and ocatillo.
Mountainous land, exceptional difficulties, 80 chs.

E. bet. secs. 5 and 8, on a true line
Ascending over mountainous land.

6.83 Intersect the W. bdy. of White Mountain Indian Reservation, N. 8° 21' E., 40 lks. from cor. of 59 $\frac{1}{2}$ mile, which is a limestone, 14x10x6 ins. above ground, marked and witnessed as described by the Surveyor General.

Set a limestone, 18x8x6 ins., 14 ins. in the ground for closing corner of secs. 5 and 8, marked, C C on W. face; S 5 on N. face; S 8 on S. face; W M I R W B on E. face; and raise a mound of stone 2 ft. base $1\frac{1}{2}$ ft. high W. of cor.

Magnetic declination, N. 14° 15' E.

Land, mountainous.
Soil, rocky; 4th and 5th rate
No timber.
Mountainous land, exceptional difficulties 6.83 chs.

November 22, 1910: At 3h p.m., l.m.t., I set off 20° 05' S. on the decl. arc; 33° 27' N. on the lat. arc; and determine a true meridian with the solar at the cor. of secs. 5, 6, 7 and 8.

Thence I run
W. on a random line, bet. secs. 6 and 7
Descending over mountainous land

40.00 Set temp. $\frac{1}{4}$ sec. cor. (Point for)

80.00 Intersect W. bdy. of Tp., 4 lks. S. of cor. of secs. 1, 6, 7, and 12

Thence I run
S. 89° 58' E., on a true line, bet. secs. 6 and 7
E. bank wash. Ascend

4.60 Top ridge, brs. NW and SE, 100 ft. above wash. Descend.

17.00

Chains.
 30.00 Bottom gulch, 30 lks. wide, course S., 75 ft. below ridge. Ascend
 36.00 Top ridge, brs. N and S. Descend
 40.00 Set a limestone, 15x12x8 ins., 10 ins. in the ground, for
 ¼ sec. cor., marked ¼ on N. face; and raise a mound of
 stone, 2 ft. base, 1½ ft. high, N. of cor.
 Magnetic variation, N. 14° 15' E.
 40.20 Gulch, course S. Ascend
 46.00 Top ridge, brs. N and S, 90 ft. above gulch. Descend
 52.00 Gulch, 40 lks. wide, course SW. Ascend
 73.20 Top ridge, brs. NE and SW, 100 ft. above gulch.
 74.20 Gulch, 20 lks. wide, course SW. Ascend.
 80.00 The cor. of secs., 5, 6, 7 and 8.
 Land, mountainous;
 Soil, rocky and gravelly; 3rd, 4th and 5th rate.
 No timber.
 Underbrush, scattered scrub oak and mesquite in gulches.
 Mountainous land, exceptional difficulties, 80.00 chs.
 November 22, 1910.

Note. For notes of line between Secs. 7 & 8 see Supplemental Book "D" hereto attached.

From cor. of secs. 25, 30, 31 and 36, I run E. on a true line
 bet. secs. 30 and 31.
 Descending over mountainous land
 6.80 Bottom, wash, 25 lks. wide, course NE, 100 ft. below cor.
 9.92 Road, Cutter to Globe, brs. NE and SW. Ascend
 12.50 Top, 60 ft. above wash. Descend
 13.50 Bottom, wash, 20 lks. wide, course NE.
 16.00 Ascend
 20.00 Top of ascent. Descend
 23.50 Bottom. Descend across flat.
 24.05 Road, brs. NW and SE. Enter dense mesquite and catclaw.
 31.57 Wash, 1 ch. wide, course SE.
 39.00 Wash, course SE. Leave dense mesquite and catclaw.
 40.00 Intersect the W. bdy. of White Mountain Indian Reservation,
 S. 8° 21' W., 1.48 chs. from 63½ mile cor., which is a quartz-
 ite rock, 15x12x6 ins. above ground, marked and witnessed
 as described by the Surveyor General.
 Point for closing corner falls in wash.
 38.00 Set a quartzite rock, 20x8x6 ins., 15 ins. in the ground as
 a witness cor. for closing cor. of secs. 30 and 31, marked
 W C C C on W. face; W M I R W B on E. face; 30 on N. face;
 31 on S. face; and raise a mound of stone 2 ft. base, 1½
 ft. high W. of cor.
 Magnetic declination, N. 14° 15' E.
 Land, mountainous and rolling.
 Soil, sandy and gravelly; 2nd and 3rd rate.
 No timber.
 Underbrush, catclaw and mesquite.
 Mountainous land, exceptional difficulties, 24 chs.
 November 23, 1910.

From cor. of secs. 19, 24, 25 and 30, I run E.
 I run E. on a true line bet. secs. 19 and 30
 Descending over mountainous land.
 1.75 Wash, course S., 20 lks. wide. Ascend
 3.70 Road, brs. NW and SE.
 13.55 S. 8 chs. to pond, 4 chs. in diameter.
 26.50 Top ridge, brs. N and S, 125 ft. above wash. Descend
 29.30 Bottom wash, 30 lks. wide, course S., 90 ft. below ridge. Ascend
 31.05 Top ridge, brs. N and S. Descend
 34.65 Bottom wash, course S. Ascend
 40.00 Set a quartzite stone, 18x10x8 ins., 14 ins. in the ground
 for ¼ sec. cor., marked ¼ on N. face; and raise a mound
 of stone 2 ft. base 1½ ft. high N. of cor.
 Magnetic declination, N. 14° 15' E.
 44.50 Top of ascent. Descend
 50.50 Bottom draw, course S.

Subdivision of Township 1 North, Range 16 East

3

Chains.	
51.46	Intersect W.bdy. White Mountain Indian Reservation, S. 8° 21' W. 1.00 ch. from 62½ mile cor., which is a quartzite rock, 16x10x6 ins. above ground, marked and witnessed as described by the Surveyor General. Set a quartz stone 20x8x8 ins., 15 ins. in the ground for closing cor. of secs. 19 and 30, marked C C on W. face; W M I R W B on E. face; 30 on S. face; 19 on N. face; and raise a mound of stone 2 ft. base 1½ ft. high W. of cor. Magnetic declination, N. 14° 15' E. Land, mountainous. Soil, gravelly and rocky; 3rd and 4th rate. No timber. Undergrowth, catclaw and Spanish bayonet. Mountainous land, exceptional difficulties, 51.46 chs. November 24, 1910.

	From cor. of secs. 13, 18, 19 and 24 I run E. on a true line bet. secs. 18 and 19 Descending over mountainous land.
6.00	Gulch, 30 lks. wide, course SW, 75 ft. below cor. Ascend
7.20	Top of ascent. Descend
9.00	Gulch, 15 lks. wide, course SW. Ascend
14.00	Top W. rim rolling mesa. Descend along mesa
40.00	Set a quartz stone, 18x6x6 ins., 14 ins. in the ground for ¼ sec. cor., marked ¼ on N. face; and raise a mound of stone, 2 ft. base 1½ ft. high, N. of cor. Magnetic declination, N. 14° 15' E.
48.50	Gulch, 30 lks. wide, course SE. Ascend
50.00	Top ridge, brs. NW and SE. Descend
53.00	E. rim mesa. Descend
54.50	Bottom, draw, 75 ft. below rim. Enter dense mesquite.
59.00	Wash, 1 ch. wide, course S.
60.00	Leave mesquite. Ascend
63.07	Intersect W.bdy. White Mountain Indian Reservation, S. 8° 21' W. 68 lks. from 61½ mile cor., which is a quartzite rock, 15x12x5 ins. above ground, marked and witnessed as des- cribed by the Surveyor General. Set a quartz stone, 18x7x7 ins., 14 ins. in the ground for closing cor. of secs. 18 and 19, marked C C on W. face; W M I R W B on E. face; and raise a mound of stone 2 ft. base 1½ ft. high, W. of cor. Magnetic declination, N. 14° 15' E. Land, mountainous. Soil, gravelly and rocky; 3rd and 4th rate. No timber. Undergrowth, mesquite and catclaw Mountainous land, exceptional difficulties, 16 chs. November 25, 1910.

	From cor. of secs. 7, 12, 13 and 18 I run E. on a true line, bet. secs. 7 and 18 Descending over mountainous land.
1.20	Bottom, wash, course S. Enter dense catclaw.
6.00	Main channel wash, 2 chs. wide, course S.
9.00	E. bank wash. Ascend
10.20	Top E. bank wash. Leave dense catclaw.
11.50	Gulch, course SW. Ascend
27.00	Top rim mesa. Descend over rolling mesa
40.00	Set a quartz stone, 18x10x8 ins., 14 ins. in the ground for ¼ sec. cor., marked ¼ on N. face; and raise a mound of stone, 2 ft. base 1½ ft. high, N. of cor. Magnetic declination, N. 14° 15' E.
44.00	E. rim mesa. Descend
55.30	Bottom, gulch, course SE. Ascend
63.00	Top ridge, brs. NW and SE. Descend
65.00	Gulch, course SE. Ascend
67.00	Top ridge, brs. NW and SE. Descend.

Chains
75.09

Intersect W.bdy. of White Mountain Indian Reservation,
S. 8° 21' W., 34 lks. from 60½ mile cor., which is a quartz-
ite rock, 15x12x5 ins. above ground, marked and witnessed
as described by the Surveyor General.

Set a quartzite stone, 20x8x6 ins., .15 ins. in the ground,
for closing cor. of secs. 7 and 18; marked C C on W. face;
WM I R W B on E. face; 7 on N. face; 18 on S. face; and
raise a mound of stone, 2 ft. base, 1½ ft. high W. of cor.
Magnetic declination, N. 14° 15' E.

Land, mountainous.

Soil, gravelly and rocky; 3rd and 4th rate.

No timber.

Undergrowth, catclaw and mesquite.

Mountainous land, exceptional difficulties, 49.00 chs.

Nov. 26, 1910

November 26, 1910.

Paul Horn
US Deputy Surveyor

Retracement of Portion of W.Bdy.
White Mountain Indian Reservation.

5

Chains.

NOTE: For the purpose of testing only the measurements of that portion of the west boundary of the White Mountain Indian Reservation, and which forms the East Boundary of fractional Tp.1 N., R.16 E., and to prove closings of fractional secs.5,7,8,18,19,30 and 31,I proceed to the 58th mile cor.,which is a stone,properly marked and witnessed as described by the surveyor general

Nov.26,1910,at 1h 30m p.m.,l.m.t.,I set off 20°54' S.on the decl.arc; 33°29'N on the lat.arc; and determine a meridian with the solar at the above corner. I deflect 8°21' from the meridian to the W. and run

S. 8° 21' W. on the 59th mile

Over mountainous land.

39.98 58½ mile cor.,which is a stone marked and witnessed as described by the surveyor general.

79.98 59th mile cor.,which is a stone marked and witnessed as described by the surveyor general.

Land, mountainous.

Soil, gravelly and rocky; 3rd and 4th rate.

S. 8° 21' W., on the 60th mile. Over mountainous land

39.52 59½ mile cor.,which is a stone,marked and witnessed as described by the surveyor general.

79.54 60th mile cor.,which is a stone,marked and witnessed as described by the surveyor general.

Land, mountainous.

Soil, gravelly and rocky ; 3rd and 4th rate.

S. 8° 21' W., on the 61st mile. Over mountainous land

39.97 60½ mile cor.,which is a stone,marked and witnessed as described by the surveyor general.

80.09 61st mile cor.,which is a stone,marked and witnessed as described by the surveyor general.

Land, mountainous.

Soil, gravelly and rocky; 3rd and 4th rate.

S. 8° 21' W., on the 62nd mile. Over mountainous land.

39.99 61½ mile cor.,which is a stone,marked and witnessed as described by the surveyor general.

80.07 62nd mile cor.,which is a stone,marked and witnessed as described by the surveyor general.

Land, mountainous.

Soil, gravelly and rocky; 3rd and 4th rate.

S. 8° 21' W., on the 63rd mile. Over mountainous land.

40.10 62½ mile cor.,which is a stone,marked and witnessed as described by the surveyor general.

80.26 63rd mile cor.,which is a stone,marked and witnessed as described by the surveyor general.

Land, mountainous.

Soil, rocky and gravelly; 3rd and 4th rate.

S.8° 21' W., on the 64th mile. Over mountainous land.

40.08 63½ mile cor.,which is a stone,marked and witnessed as described by the surveyor general.

80.08 64th mile cor.,which is a stone,marked and witnessed as described by the surveyor general.

Land, mountainous.

Soil, rocky and gravelly; 3rd and 4th rate.

S. 8° 21' W., on the 65th mile. Over mountainous land.

39.96 64½ mile cor.,which is a stone,marked and witnessed as described by the surveyor general.

79.98 65th mile cor.,which is a stone,marked and witnessed as described by the surveyor general.

X

6

Retracement of Portion of
West Bdy. of White Mountain Indian Reservation

Chains.

Land, mountainous.
Soil, gravelly and rocky; 3rd and 4th rate.

Roscoe C. Ham
U. S. Deputy Surveyor.

November 26, 1910.

J FINAL OATHS OF DEPUTY SURVEYOR AND HIS ASSISTANTS.

See Book C. Qu. T. N. R. 15 1/2 E.

LIST OF NAMES.

A list of the names of the individuals employed by _____

_____, United States Deputy Surveyor, to assist in running, measuring, and marking the lines and corners described in the foregoing field notes of the survey of _____

showing the respective capacities in which they acted:

- _____, *Chainman.*
- _____, *Chainman.*
- _____, *Moundman.*
- _____, *Moundman.*
- _____, *Axman.*
- _____, *Axman.*
- _____, *Flagman.*

FINAL OATH OF ASSISTANTS.

We hereby certify that we assisted _____

_____, United States Deputy Surveyor, in surveying all those parts or portions of the _____

_____ of the _____ meridian, _____ of _____, which are represented

in the foregoing field notes as having been surveyed by him and under his direction; and that said survey has been in all respects, to the best of our knowledge and belief, well and faithfully surveyed, and the corner monuments established, according to the instructions furnished by the United States Surveyor General for _____

- _____, *Chainman.*
- _____, *Chainman.*
- _____, *Moundman.*
- _____, *Moundman.*
- _____, *Axman.*
- _____, *Axman.*
- _____, *Flagman.*

Subscribed and sworn to before me this _____ }
day of _____, 19 _____ }



73
7

BOOK 2406

In FINAL OATH OF UNITED STATES DEPUTY SURVEYOR.

See Book C, Part of T.M. Q. 15 1/2 E.

I, _____, United States Deputy Surveyor, do solemnly swear that, in pursuance of a contract received from _____ United States Surveyor General for _____, bearing date of the _____ day of _____, 19 _____, I have well, faithfully, and truly, in my own proper person, and in strict conformity with the instructions furnished by the United States Surveyor General for _____, the Manual of Surveying Instructions, and the laws of the United States, surveyed all those parts or portions of _____

_____ of the _____ meridian, in the _____ of _____, which are represented in the foregoing field notes as having been surveyed by me, and under my direction; and I do further solemnly swear that all the corners of said survey have been established and perpetuated in strict accordance with the Manual of Surveying Instructions, and the special written instructions of the United States Surveyor General for _____ and in the specific manner described in the field notes, and that the foregoing are the original field notes of such survey.

United States Deputy Surveyor.

Subscribed by said _____, and sworn to before me }
this _____ day of _____, 19 _____ }



APPROVAL.

OFFICE OF THE UNITED STATES SURVEYOR GENERAL.

Henry C. ... MAY 14 1913

The foregoing field notes of the survey of *the subdivisional lines of* *Trac. of 17. Q. 16 E. of the Gila and Salt River* *Basin and Meridian, Arizona*

executed by *Roscoe C. ...* *W.D. Dep. Sur.*
under his contract No. *162*, dated *January 5*, 19*10*, having been critically examined, and the necessary corrections and explanations made, the said field notes, and the surveys they describe, are hereby approved.

Frank ...
United States Surveyor General.

I certify that the foregoing transcript of the field notes of the above-described surveys in _____, has been correctly copied from the original notes on file in this office.

United States Surveyor General.

1000. May 13-1912

74
8

4-679.

BOOK 2406

MAY 24 1912

Book D

Supplemental
FIELD NOTES

OF THE SURVEY OF THE

Subdivision of Township 1 North
Range 16 East

Of the Gila & Salt River Base Meridian,

AS SURVEYED BY

Roscoe C. Ham, United States Deputy Surveyor,

Under his Contract No. 167, dated January 5th, 1910

Survey commenced December 19th, 1911

Survey completed December 19th, 1911

NAMES AND DUTIES OF ASSISTANTS.

Arthur M. Pogue Chairman

Budd Dozier "

Manuel Salazar Woundeman

Manuel Salazar Apron

Manuel Salazar Flagman

70

BOOK 2406

INDEX DIAGRAM.

Township 1 N., Range 16 E.

6	5	4	3	2	1
7	8	9	10	11	12
18	17	16	15	14	13
19	20	21	22	23	24
30	29	28	27	26	25
31	32	33	34	35	36

Meanders Page

PRELIMINARY OATHS OF ASSISTANTS.

WE, Arthur M. Ponce and Budd Dozier
do solemnly swear that we will well and faithfully execute the duties of chainmen; that we will level the chain upon even and uneven ground, and plumb the tally pins, either by sticking or dropping the same; that we will report the true distances to all notable objects, and the true lengths of all lines that we assist in measuring, to the best of our skill and ability, and in accordance with instructions given us, in the survey of

Sec. Line Bet. Secs 7 & 8 Tpk 1 N. R. 16 E.

Arthur M. Ponce, Chainman.
Budd Dozier, Chainman.

Subscribed and sworn to before me this 19
day of Dec, 1911



Roscoe C. Ham
As Deputy
no notary available

I, Manuel Salazar

do solemnly swear that we will well and truly perform the duties of moundmen in the establishment of corners, according to the instructions given us, to the best of our skill and ability, in the survey of

Sec. Line Bet. Secs 7 & 8 Tpk 1 N. R. 16 E.

Manuel Salazar, Moundman.
Manuel Salazar, Moundman.

Subscribed and sworn to before me this 19
day of Dec, 1911



Roscoe C. Ham
As Deputy
no notary available

I, Manuel Salazar

do solemnly swear that we will well and truly perform the duties of axmen in the establishment of corners and other duties, according to instructions given us, to the best of our skill and ability, in the survey of

Sec. Line Bet. Secs 7 & 8 Tpk 1 N. R. 16 E.

Manuel Salazar, Axman.
Manuel Salazar, Axman.

Subscribed and sworn to before me this 19
day of Dec, 1911



Roscoe C. Ham
As Deputy
no notary available

I, Manuel Salazar, do solemnly swear that I will well and truly perform the duties of flagman according to instructions given me, to the best of my skill and ability, in the survey of

Sec. Line Bet. Secs 7 & 8 Tpk 1 N. R. 16 E.

Manuel Salazar, Flagman.

Subscribed and sworn to before me this 19
day of Dec, 1911



Roscoe C. Ham
As Deputy
no notary available

Chains. Survey of Section Line Between Secs. 7 and 8.

Dec. 19, 1911, at 9 A.M. I set off 23° - 21' S on Decl. arc. 33° - 27' N on Lat. arc. and run

From the cor. of secs. 5, 6, 7 and 8,

S. bet. Secs. 7 and 8, on a true line.

Over mountainous land, descending.

33.50 Wash. 10 lks. wide, course SW.

40.00 Set a limestone, 18x10x6 ins., 12 ins. in the ground for 1/4 sec. cor., marked 1/4 on W. face; and raise a mound of stone, 2 ft. base, 1 1/2 ft. high, W. of cor.

46.54 Intersect the W. bdy. of White Mountain Indian Reservation, S. 8° 21' W., 6.60 chs. from 60 mile cor. which is a limestone, 6x15x9 ins. above ground, marked and witnessed as described by the Surveyor General.

Set a limestone, 18x8x8 ins., 12 ins. in the ground for closing cor. of secs. 7 and 8, marked C C on N. face,

W M I R W B on E. face, 8 on E. face, 7 on W. face; and

raise a mound of stone, 2 ft. base, 1 1/2 ft. high, N. of cor.

Magnetic declination, N. 14° 15' E.

Land mountainous.

Soil, gravelly and rocky; 3rd and 4th rate.

No timber.

Undergrowth, catclaw and mesquite.

Mountainous land, exceptionally difficult to survey,

46.54 chs.

Roscoe A. ...

U. S. Deputy Surveyor.

.....

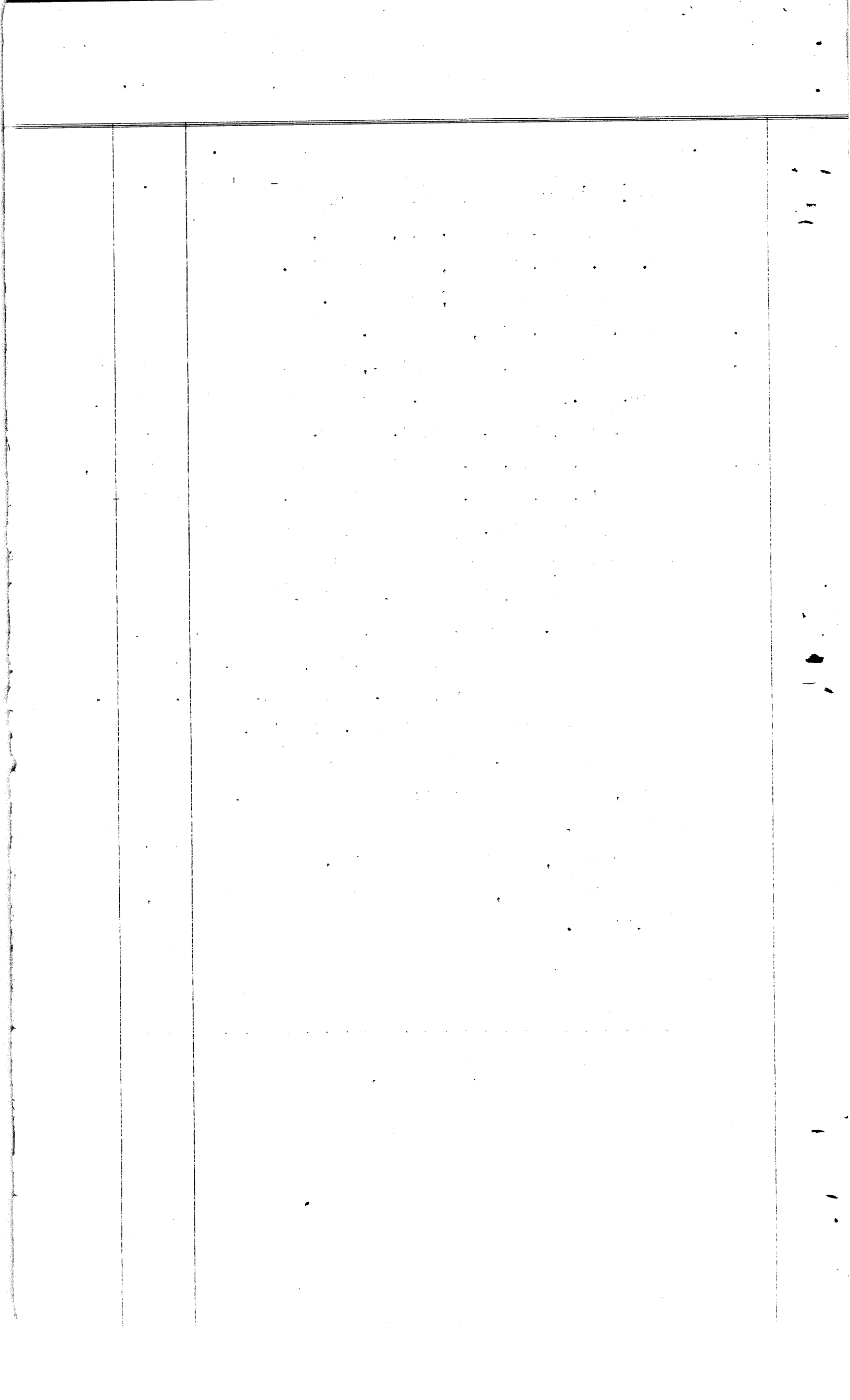

FINAL OATHS OF DEPUTY SURVEYOR AND HIS ASSISTANTS.

LIST OF NAMES.

A list of the names of the individuals employed by Rocco C. Ham

....., United States Deputy Surveyor, to assist in running, measuring, and marking the lines and corners described in the foregoing field notes of the survey of Sec Line Bit Sec 7 & 8 Twp 1 N. R. 16 E

showing the respective capacities in which they acted:

Arthur M. Pogue....., Chainman.

Budd Dozier....., Chainman.

Manuel Salazar....., Moundman.

....., Moundman.

Manuel Salazar....., Axman.

....., Axman.

Manuel Salazar....., Flagman.

FINAL OATH OF ASSISTANTS.

We hereby certify that we assisted Rocco C. Ham

....., United States Deputy Surveyor, in surveying all those parts or portions of the Sec. Line Between Sections 7 and 8, Township 1 North Range 16 East

..... of the Gila and Salt River Basins meridian, Territory of Arizona, which are represented in the foregoing field notes as having been surveyed by him and under his direction; and that said survey has been in all respects, to the best of our knowledge and belief, well and faithfully surveyed, and the corner monuments established, according to the instructions furnished by the United States Surveyor General for Arizona

Arthur M. Pogue....., Chainman.

Budd Dozier....., Chainman.

Manuel Salazar....., Moundman.

....., Moundman.

Manuel Salazar....., Axman.

....., Axman.

Manuel Salazar....., Flagman.

Subscribed and sworn to before me this 29th day of Dec, 1911

H. G. Power
Notary Public

My commission expires May 16th 1912



FINAL OATH OF UNITED STATES DEPUTY SURVEYOR.

I, Roscoe C. Ham, United States Deputy Surveyor, do solemnly swear that, in pursuance of a contract received from Frank Sigall United States Surveyor General for Arizona, bearing date of the 5th day of Jan, 1910, I have well, faithfully, and truly, in my own proper person, and in strict conformity with the instructions furnished by the United States Surveyor General for Arizona, the Manual of Surveying Instructions, and the laws of the United States, surveyed all those parts or portions of T. 1 N. R. 16 E.

of the G. & S. P. B. T. meridian, in the T. 1 N. of Arizona, which are represented in the foregoing field notes as having been surveyed by me, and under my direction; and I do further solemnly swear that all the corners of said survey have been established and perpetuated in strict accordance with the Manual of Surveying Instructions, and the special written instructions of the United States Surveyor General for Arizona and in the specific manner described in the field notes, and that the foregoing are the original field notes of such survey.

Roscoe C. Ham
United States Deputy Surveyor.

Subscribed by said Roscoe C. Ham, and sworn to before me }
this 10th day of May, 1912

Ray B. Johnson
United States Commissioner
in charge Western Division of the
Western District of Missouri



APPROVAL.

OFFICE OF THE UNITED STATES SURVEYOR GENERAL,

Phoenix Arizona MAY 14, 1913

^{Supplemental}
The foregoing field notes of the survey of Section line between
Sections 7 & 8, of T. 1 North - Range 16 East of the
Gila and Salt River Base & Meridian Arizona

executed by Roscoe C. Ham U.S. Deputy Surveyor
under his contract No. 162, dated Jan. 5, 1910, having been critically examined, and the necessary corrections and explanations made, the said field notes, and the surveys they describe, are hereby approved.

Frank Sigall
United States Surveyor General.

I certify that the foregoing transcript of the field notes of the above-described surveys in _____, has been correctly copied from the original notes on file in this office.

United States Surveyor General.