

112-1

2409

BOOK 2409

Ordered filed G.L. Letter "C" Sept. 6, 1913.
4-679.

MAY 27 1911

Book J

FIELD NOTES

OF THE SURVEY OF THE

Subdivision T21N R11W

Of the T21N R11W Meridian,

Arizona

AS SURVEYED BY

Charles A. Smith, United States Deputy Surveyor,

Under his Contract No. 142, dated Jan 5, 1911

Survey commenced March 3, 1911

Survey completed March 12, 1911

BOOK 2409 NAMES AND DUTIES OF ASSISTANTS.

<u>Arthur W. Rogers</u>	<u>Chairman</u>
<u>Edwin Young</u>	<u>Chairman</u>
<u>Albert Murphy</u>	<u>Secretary</u>
<u>W. B. Joyce</u>	<u>Secretary</u>
<u>W. B. Joyce</u>	<u>Secretary</u>
<u>W. S. Jackson</u>	<u>F. Layman</u>

BOOK 2409

INDEX DIAGRAM.

Township 21N, Range 11W

6	5	4	3	2	1
			11		
7	8	9	10	6	11
		15	10	6	4
18	17	15	9	15	5
	14	14	9	4	3
19	18	20	14	21	8
	17	13			22
					23
					2
					1
30	27	29	13	28	7
	16	12			
31	32	12	33	7	34
					35
					36

Meanders Page

12/5

BOOK 2409

PRELIMINARY OATHS OF ASSISTANTS.

WE, Arthur Young and Elmer Young do solemnly swear that we will well and faithfully execute the duties of chainmen; that we will level the chain upon even and uneven ground, and plumb the tally pins, either by sticking or dropping the same; that we will report the true distances to all notable objects, and the true lengths of all lines that we assist in measuring, to the best of our skill and ability, and in accordance with instructions given us, in the survey of

Trinity

Arthur Young, Chainman.
Elmer Young, Chainman.

Subscribed and sworn to before me this 4 day of February, 1911



Racelleston
US Deputy Surveyor

WE, Albert Murphy and R. J. Martin do solemnly swear that we will well and truly perform the duties of moundmen in the establishment of corners, according to the instructions given us, to the best of our skill and ability, in the survey of

Albert Murphy, Moundman.
R. J. Martin, Moundman.

Subscribed and sworn to before me this 19 day of February, 1911



Racelleston
US Deputy Surveyor

WE, N. B. Joyce and do solemnly swear that we will well and truly perform the duties of axmen in the establishment of corners and other duties, according to instructions given us, to the best of our skill and ability, in the survey of

N. B. Joyce, Axman.

Subscribed and sworn to before me this 17 day of February, 1911



Racelleston
US Deputy Surveyor

I, W. E. Anderson, do solemnly swear that I will well and truly perform the duties of flagman according to instructions given me, to the best of my skill and ability, in the survey of

Trinity

W. E. Anderson, Flagman.

Subscribed and sworn to before me this 19 day of February, 1911



Racelleston
US Deputy Surveyor

Subdivision of Township 21 North, Range 11 West 1 D

Chains.

Survey commenced March 2, 1911, and executed with a Young & Sons light mountain transit, No. 5609, equipped with a Smith solar attachment, the horizontal limb being provided with two opposite verniers reading to 1' of arc, which is also the least count of the verniers of the latitude and declination arcs.

I examine the adjustments of the transit, and correct the level and collimation errors; then, to test the solar apparatus, by comparing its indications, resulting from solar observations made during a.m. and p.m. hours, with a meridian determined by observations on Polaris, I proceed as follows:

March 2: At my camp at Old Camp Willow Grove, I set off 7° 18' S on the decl. arc; 35° 11' N on the lat. arc; and at 4 p.m., l.m.t., determine a true meridian with solar, and mark the meridian thus determined by a groove on a stone 5 chs. N. of my station.

March 2: At 8h 45m p.m., l.m.t., I observe Polaris at western elongation, according to instructions in the Manual, and mark a point in the line thus determined by a tack in a wooden stake set firmly in the ground, 5 chs. N. of my station.

March 3: At 7 a.m., l.m.t., at my station, I turn off the azimuth of Polaris, 1° 25' to the east, and mark the meridian thus determined by a cross (X) on the stone set March 2, 1911, on which the meridian falls 0.4 ins. east of the groove determined by the solar.

March 3: At 8 a.m., l.m.t., I set off 7° 03' S on the decl. arc; 35° 11' N on the lat. arc; and mark the meridian thus determined by a groove on the stone already set 5 chs. N. of my station; this mark falls 0.3 ins. E. of the meridian established by Polaris.

I therefore conclude that the adjustments of the instrument are satisfactory.

March 3, 1911: At 9h 12m a.m., l.m.t., I set off 7° 03' S on the decl. arc; 35° 11' N on the lat. arc; and determine a meridian with the solar at the cor. of secs. 19, 30, 24 and 25.

Thence I run

West on a true line, bet. secs. 24 and 25
Ascending from flat, over boulders

- 4.00 Granite boulder knob.
- 6.30 Top of knob, brs. SE and NW; descend
- 9.50 Leave boulders, ascend over flat through dense cedar timber and scrub oak.
- 30.00 Leave dense timber and undergrowth; ascending steeply on NE slope over boulders, with great difficulty
- 34.50 Top of N. slope, granite knob 150 ft. above bottom, brs. NW and SE; descend
- 40.00 Set a granite stone, 18x12x10 ins., 12 ins. in the ground for $\frac{1}{4}$ sec. cor., marked $\frac{1}{4}$ on N. face; from which
 - A pinon, 12 ins. diam., brs. N. 14° 30' W., 90 lks. dist., marked $\frac{1}{4}$ S 24 B T
 - A pinon, 4 ins. diam., brs. S. 22° 35' W., 78 lks. dist., marked $\frac{1}{4}$ S 25 B T
- Variation, N. 15° E.
- 46.00 Descend among granite boulders on top of ridge.
- 49.50 Ravine, 30 lks. wide, course SE; ascend
- 55.50 Top of granite hill, brs. NW and SE.
- 56.70 Wash, 30 lks. wide, course SE; ascend
- 67.00 Top of S. slope, brs. NW and SE; descend
- 75.00 Wash, 25 lks. wide, course NW; ascend
- 80.00 Top of ridge, brs. NW and SE, 500 ft. above wash; descend
- Set a malapai stone, 20x12x8 ins., 15 ins. in the ground for cor. of secs. 23, 24, 25 and 26, marked with 1 notch on E. and 2 notches on S. edge; from which

Subdivison of Township 21 North, Range 11 West

Chains

- A cedar, 15 ins. diam., brs. S. 39° 16' W., 39 lks. dist., marked T 21 N R 11 W S 26 B T
- A cedar, 12 ins. diam., brs. S. 20° 43' E., 71 lks. dist., marked T 21 N R 11 W S 25 B T
- A cedar, 9 ins. diam., brs. N. 49° 04' W., 58 lks. dist., marked T 21 N R 11 W S 23 B T
- A cedar, 10 ins. diam., brs. N. 79° 00' E., 95 lks. dist., marked T 21 N R 11 W S 24 B T

Land, mountainous.
 Soil, gravelly and rocky; 2nd, 3rd and 4th rate.
 Timber, cedar.
 Undergrowth, scrub oak.
 Mountainous land, steep ascents and descents, steep slopes covered with loose rocks and boulders or land covered with dense timber or dense undergrowth and exceptionally difficult to survey, 80.00 chs.

 From the cor. of secs. 23, 24, 25 and 26, I run N. 0° 1' W., bet. secs. 23 and 24

- Descending on W. slope through dense cedar timber and scrub oak undergrowth.
- 14.00 Ravine, 20 lks. wide, course NE; ascend
- 17.00 Top of E. slope, brs. NE and SW; descend on E. slope over big granite boulders.
- 21.67 Top of big granite boulder; descend
- 25.00 Ravine, 30 lks. wide, course NE; ascend
- 27.00 Top of granite boulder; descend.
- 34.00 Ravine, 25 lks. wide, course NE; ascend over granite boulders.
- 40.00 A cross on a granite boulder in place, 8x8x4 ft. above ground for $\frac{1}{4}$ sec. cor., marked $\frac{1}{4}$ on W. face; from which
 A cross (X) on a granite boulder in place, 4x8x6 ft. above ground, brs. S. 50° 34' E., 19.5 lks. dist., marked $\frac{1}{4}$ S 24 B O
 A cedar, 9 ins. diam., brs. S. 87° 11' W., 365 lks. dist., marked $\frac{1}{4}$ S 23 B T
 Variation, N. 15° E.
- 43.00 Descend
- 48.00 Ravine 30 lks. wide, course NE; ascend
 Top of granite hill 200 ft. above ravine, brs. NE and SW; descend
- 54.00 Ravine, 10 lks. wide, course NE; ascend
- 63.50 Ravine, 15 lks. wide, course NE; ascend
- 80.00 On E. slope.

Set a porphyry stone, 24x10x6 ins., 18 ins. in the ground for cor. of secs. 13, 14, 23 and 24, marked with 3 notches on S. and 1 notch on E. edge; from which
 An oak, 6 ins. diam., brs. N. 14° 17' W., 128 lks. dist., marked T 21 N R 11 W S 14 B T
 A cedar, 8 ins. diam., brs. S. 68° 19' E., 186 lks. dist., marked T 21 N R 11 W S 24 B T
 No other trees available.
 Raise a mound of stone, 2 ft. base, 1 $\frac{1}{2}$ ft. high, W. of cor. Pits impracticable.
 Variation, N. 16° E.

On rocky slope, 30 lks. S. of Lookout wash.
 Land, mountainous.
 Timber, cedar.
 Soil, rocky; 3rd and 4th rate.
 Undergrowth, scrub oak.
 Mountainous land, steep ascents and descents, steep slopes covered with loose rocks and boulders or land covered with dense timber or dense undergrowth and exceptionally difficult to survey, 80.00 chs.

March 3: At this corner I set off 7° 00' S on the decl. arc; and at 12h 12m p.m., l.m.t., observe the sun on the meridian; the resulting lat. is 33° 12' N

Subdivision of Township 21 North, Range 11 West

Chains.	East on a random line, bet. secs. 13 and 24
40.00	Set temp. $\frac{1}{4}$ sec. cor.
79.95	Intersect E.bdy. of Tp., 5 lks. N. of cor. of secs. 13 and 24.
	Thence I run
	N. $89^{\circ}58'$ W., on a true line, bet. secs. 13 and 24.
	Descending over granite boulders 300 ft.
28.00	Bottom of gulch, 20 lks. wide, course SW; ascend 300 ft.
34.00	Top of granite ridge, brs. NE and SW; descend 350 ft.
36.00	7 chs. S. to 1 story frame house of George W. Miller, stone outhouse; garden vineyard, orchard and spring
39.97 $\frac{1}{2}$	Set a granite stone, 20x10x8 ins., 15 ins. in the ground for $\frac{1}{4}$ sec. cor., marked $\frac{1}{4}$ on N. face; and raise a mound of stone, 2 ft. base, 1 $\frac{1}{2}$ ft. high, N. of cor. Pits impracticable.
	Variation, N. 15° E.
43.50	Bottom of descent; descend down to bottoms
44.50	Miller corral; wood corral fence brs. NW and SE.
45.30	Wagon road, Kingman to Prescott, brs. NW and SE.
49.50	Lookout wash, 75 lks. wide, course NW; ascend 200 ft.
56.00	Top of N. slope of ridge, brs. NW and SE; descend parallel to Lookout wash.
66.00	Bottom of descent 75 ft; wash, course N.; ascend.
70.00	Top of N. slope of ridge 150 ft. above bottom, brs. NW and SE; descend
74.00	Bottom of descent; ascend
79.50	Ascend steeply over loose rock.
79.95	The cor. of secs. 13, 14, 23 and 24.
	Land, mountainous.
	Soil, gravelly and rocky; 1st, 2nd, 3rd and 4th rate.
	Timber, cedar.
	Undergrowth, scrub oak.
	Mountainous land, steep ascents and descents, steep slopes covered with loose rocks and boulders and exceptionally difficult to survey, 79.97 chs.

	From the cor. of secs. 13, 14, 23 and 24, I run
	N. $0^{\circ}1'$ W., on a true line, bet. secs. 13 and 14.
	Over mountainous land.
0.30	Bottom of steep slope, enter bottom of Lookout wash.
2.70	Main channel of Lookout wash, 15 lks. wide, course NW.
4.45	N. channel of Lookout wash, 40 lks. wide, course W; ascend
5.00	Wagon road, Kingman to Prescott, brs. E and W; ascend over loose, rocky land.
5.70	Barbed wire fence Miller's pasture, brs. NW and SE; ascend
11.00	Top of E. slope, 200 ft. above wash; descend
16.00	Top of saddle; ascend on W. slope
40.00	On W. slope of hill 500 ft. above wash.
	Set a porphyry stone, 16x12x6 ins., 10 ins. in the ground for $\frac{1}{4}$ sec. cor., marked $\frac{1}{4}$ on W. face; from which
	A cedar, 12 ins. diam., brs. S. $55^{\circ}40'$ W., 70 lks. dist., marked $\frac{1}{4}$ S 14 B T
	A cedar, 20 ins. diam., brs. S. $64^{\circ}18'$ E., 105 lks. dist., marked $\frac{1}{4}$ S 13 B T
	Variation, N. $15^{\circ}50'$ E.
	Thence ascending on steep SW slope over loose rocks, with great difficulty.
45.74	Barbed wire fence Miller's pasture, brs. NE and SW.
52.00	Top of ridge, brs. NW and SE, 800 ft. above flat; descend along E. slope of ridge through dense cedar timber.
80.00	Set a malapai stone, 18x8x8 ins., 12 ins. in the ground for cor. of secs. 11, 12, 13 and 14, marked with 1 notch on E. and 4 notches on S. edge; from which
	A cedar, 9 ins. diam., brs. S. $21^{\circ}57'$ E., 190 lks. dist., marked T 21 N R 11 W S 13 B T
	A cedar, 12 ins. diam., brs. N. $6^{\circ}08'$ E., 98 lks. dist., marked T 21 N R 11 W S 12 B T
	A cedar, 15 ins. diam., brs. S. $52^{\circ}16'$ W., 11 lks. dist., marked T 21 N R 11 W S 14 B T

Subdivision of Township 21 North, Range 11 West	
Chains	<p>A cedar, 10 ins. diam., brs. N. 13° 51' W., 188 lks. dist., marked T 21 N R 11 W S 11 B T Variation, N. 15½° E.</p> <p>Land, mountainous. Soil, rocky and gravelly; 2nd, 3rd and 4th rate. Timber, cedar. Undergrowth, scrub oak.</p> <p>Mountainous land, steep ascents and descents, steep slopes covered with loose rocks and boulders or land covered with dense timber or undergrowth and exceptionally difficult to survey, 80.00 chs. March 3, 1911.</p> <hr/> <p>March 4: At 8h 12m a.m., l.m.t., I set off 6° 40' S. on the decl. arc; 35° 13' N on the lat. arc; and determine a meridian with the solar at the cor. of secs. 11, 12, 13 and 14. Thence I run S 89° 58' E on a random line, bet. secs. 12 and 13</p> <p>40.00 Set temp. ¼ sec. cor.</p> <p>80.02 Intersect E. bdy. of Tp., 10 lks. S. of cor. of secs. 7, 12, 13 and 18. Thence I run S. 89° 58' W., on a true line, bet. secs. 12 and 13 Over mountainous land, through dense cedar and scrub oak and land covered with loose malapai rocks and boulders, ascending</p> <p>26.00 Top of granite ridge, 200 ft. above sec. cor., brs. NE and SW; descend</p> <p>32.20 Wash, 25 lks. wide, course SW, 150 ft. below ridge; ascend</p> <p>40.01 Set a granite stone, 18x10x6 ins., 12 ins. in the ground for ¼ sec. cor., marked ¼ on N. face; from which A cedar, 30 ins. diam., brs. S. 49° 08' W., 244 lks. dist., marked ¼ S 13 B T A cedar, 6 ins. diam., brs. N. 46° 40' W., 204 lks. dist., marked ¼ S 12 B T Variation, N. 15° E.</p> <p>Thence ascending over steep slope covered with loose rocks and dense cedar, with great difficulty.</p> <p>43.85 Barbed wire fence, Miller's pasture, brs. NW and SE.</p> <p>80.02 The cor. of secs. 11, 12, 13 and 14. 400 ft. above ¼ sec. cor. Land, mountainous. Soil, rocky and gravelly; 2nd, 3rd and 4th rate. Timber, cedar. Undergrowth, scrub oak. Mountainous land, steep ascents and descents and slopes covered with loose rocks and boulders or land covered with dense timber and undergrowth and exceptionally difficult to survey, 80.02 chs.</p> <hr/> <p>From the cor. of secs. 13, 14, 23 and 24, I run West, on a true line, bet. secs. 14 and 23 Over steep, mountainous land, covered with rocks and boulders, ascending</p> <p>3.55 Top of spur 100 ft. above wash, brs. NE and SW; descend on W. slope over loose malapai rocks with difficulty.</p> <p>8.20 Wash, 18 lks. wide, course NE, 90 ft. below top; ascend</p> <p>19.00 Top of N. slope of ridge 400 ft. above wash, brs. NE and SW; descend along N. slope.</p> <p>26.65 Wash, 30 lks. wide, course NE; ascend on N. slope of ridge</p> <p>32.00 Top of N. slope of ridge, brs. NE and SW; descend along N. slope.</p> <p>35.00 Ravine, 20 lks. wide, course NE; ascend</p> <p>40.00 On E. slope of malapai ridge. Set a malapai stone, 18x10x6 ins., 12 ins. in the ground for ¼ sec. cor., marked ¼ on N. face; and raise a mound of stone, 2 ft. base, 1½ ft. high, N. of cor. Pits impracticable. Variation, N. 15° E.</p>

Subdivision of Township 21 North, Range 11 West

Chains.	
47.00	Top of ridge, brs. NW and SE, 800 ft. above Lookout wash; descend
73.00	Ravine, 30 lks. wide, course SW, 300 ft. below top; ascend
80.00	On E. slope, Set a porphyry stone, 18x8x6 ins., 12 ins. in the ground for cor. of secs. 14, 15, 22 and 23, marked with 2 notches on E. and 3 notches on S. edge; from which
	A cedar, 6 ins. diam., brs. N. 19° 30' E., 28 lks. dist., marked T 21 N R 11 W S 14 B T
	A cedar, 15 ins. diam., brs. S. 74° 07' E., 77 lks. dist., marked T 21 N R 11 W S 23 B T
	A cedar, 4 ins. diam., brs. S. 11° 11' W., 41 lks. dist., marked T 21 N R 11 W S 22 B T
	A cedar, 12 ins. diam., brs. N. 84° 42' W., 86 lks. dist., marked T 21 N R 11 W S 15 B T
	Land, mountainous.
	Soil, rocky; 3rd and 4th rate.
	Timber, scattered cedar.
	Undergrowth, scattered scrub oak
	Mountainous land, very steep, rocky slopes ascents and descents covered with loose rocks and boulders and exceptionally difficult to survey, 80.00 chs.
	March 4: At this corner I set off 6° 37' S on the decl. arc; and at 12h 12m p.m., l.m.t., observe the sun on the meridian; the resulting lat. is 35° 12' N.

	N. 0° 1' W., on a true line, bet. secs. 14 and 15.
	Over mountainous land, ascending over loose rocks and through dense cedar timber, with great difficulty.
8.00	Top of east slope, brs. NE and SW; descend on NE slope, with great difficulty, over loose rock, 800 ft.
40.00	Set a porphyry stone, 18x8x6 ins., in mound of stone, for 1/4 sec. cor., marked 1/4 on W. face; from which
	A cedar, 12 ins. diam., brs. S. 42° 45' E., 116 lks. dist., marked 1/4 S 14 B T
	A cedar, 24 ins. diam., brs. S. 63° 25' W., 83 lks. dist., marked 1/4 S 15 B T
	Variation, N. 15 1/2° E.
	Thence descending to wash.
42.50	Bottom of Lookout wash, 60 lks. wide, course W; ascend
58.00	Wagon road, Kingman to Prescott, brs. NW and SE; leave dense cedar.
70.75	Rail fence of corral, Buckley ranch, brs. NE and SW.
71.00	Frame house of George Buckley 2 chs. E. of line.
72.50	Same rail fence corral corner, 60 lks. E.
74.20	Corral fence, brs. E and W
79.00	Corral fence, brs. NE and SW
80.00	Set a porphyry stone, 18x10x6 ins., 12 ins. in the ground for cor. of secs. 10, 11, 14 and 15, marked with 2 notches on E. and 4 notches on S. edge; from which
	A cedar, 9 ins. diam., brs. S. 18° 50' W., 299 lks. dist., marked T 21 N R 11 W S 15 B T
	A cedar, 24 ins. diam., brs. N. 14° 15' W., 166 lks. dist., marked T 21 N R 11 W S 10 B T
	A cedar, 18 ins. diam., brs. N. 22° 09' E., 176 lks. dist., marked T 21 N R 11 W S 11 B T
	No other trees available.
	Raise a mound of stone, 2 ft. base, 1 1/2 ft. high W. of cor. Pits impracticable.
	Land, mountainous.
	Soil, gravelly and rocky; 2nd, 3rd and 4th rate.
	Timber, cedar.
	Mountainous land, steep ascents and descents and steep slopes covered with loose rocks or covered with dense timber and exceptionally difficult to survey, 80.00 chs.

Chains	From the cor. of secs. 10, 11, 14 and 15, I run
40.00	East on a random line, bet. secs. 11 and 14
79.80	Set temp. $\frac{1}{4}$ sec. cor.
	Intersect N. and S. line, 14 lks. S. of cor. of secs. 11, 12, 13 and 14.
	Thence I run
	S. $89^{\circ}54'W.$, on a true line, bet. secs. 11 and 14
	Over mountainous land, ascending over loose malapai boulders through dense cedar timber.
13.00	Top of ridge, brs. NW and SE; leave dense cedar; descend
34.00	Ravine, 20 lks. wide, course SW; ascend on S. slope.
39.90	On S. slope, 450 lks. N. of wash, 300 ft. below top of ridge.
	Set a porphyry stone, 16x10x8 ins., 10 ins. in the ground for $\frac{1}{4}$ sec. cor., marked $\frac{1}{4}$ on N. face; from which
	A cedar, 20 ins. diam., brs. S. $67^{\circ}42'E.$, 22 lks. dist., marked $\frac{1}{4}$ S 14 B T
	A cedar, 9 ins. diam., brs. N. $31^{\circ}38'E.$, 116 lks. dist., marked $\frac{1}{4}$ S 11 B T
	Variation, N. $15^{\circ} E.$
41.90	Wash, 40 lks. wide, course NW; ascend on N. slope.
50.00	Top of spur 300 ft. above wash, brs. NW and SE; descend on N. slope.
56.00	Saddle, brs. NW and SE; ascend on S. slope of hill.
62.00	Top of ridge, brs. NW and SE; descend
76.12	Barbed wire fence, brs. NE and SW
77.00	2 chs. S. to cement water tank, 30x15 lks., on George Buckley's ranch.
79.50	Picket fence corral.
79.80	The cor. of secs. 10, 11, 14 and 15.
	Land, mountainous.
	Soil, rocky; 3rd and 4th rate.
	Timber, cedar.
	Undergrowth, scrub oak.
	Mountainous land, steep ascents and descents, slopes covered with loose rocks and boulders or land covered with dense timber and exceptionally difficult to survey, 79.80 chs.

	From the cor. of secs. 10, 11, 14 and 15, I run
	N. $0^{\circ}1'W.$, on a true line, bet. secs. 10 and 11
	Over mountainous land, ascending through dense cedar timber from bottom
4.00	Wash, 50 lks. wide, course SW.
6.80	Wash, 40 lks. wide, course SW.
10.95	Fence posts, br. NW and SE.
20.00	Cattle trail, brs. SE and NW; enter dense cedar.
31.00	Top of W. slope of ridge, 300 ft. above wash, brs. NE and SW; descend.
38.00	Trail, brs. SW and NE.
40.00	Set a porphyry stone, 18x10x8 ins., 12 ins. in the ground for $\frac{1}{4}$ sec. cor., marked $\frac{1}{4}$ on W. face; from which
	A cedar, 12 ins. diam., brs. S. $48^{\circ}05'E.$, 234 lks. dist., marked $\frac{1}{4}$ S 11 B T
	A cedar, 15 ins. diam., brs. N. $11^{\circ}47'W.$, 375 lks. dist., marked $\frac{1}{4}$ S 10 B T
	Variation, $15\frac{3}{4}^{\circ} E.$
	Ascend.
49.00	Top of knob, brs. NE and SW; descend through dense cedar timber.
59.00	Wash, 40 lks. wide, brs. SW; ascend 300 ft. through dense cedar timber.
80.00	Set a malapai stone, 18x8x6 ins., 12 ins. in the ground for cor. of secs. 2, 3, 10 and 11, marked with 2 notches on E. and 5 notches on W. edge; from which
	A cedar, 12 ins. diam., brs. S. $51^{\circ}11'W.$, 46 lks. dist., marked T 21 N R 11 W S 10 B T
	A cedar, 8 ins. diam., brs. S. $35^{\circ}19'E.$, 103 lks. dist., marked T 21 N R 11 W S 11 B T

Subdivision of Township 21 North, Range 11 West

Chains	<p>A cedar, 8 ins.diam.,brs.N.31°15'W.,223 lks.dist., marked T 21 N R 11 W S 3 B T</p> <p>A cedar,10 ins.diam.,brs.N.29°20'E.,129 lks.dist., marked T, 21 N, R 11 W S 2 B T</p> <p>Land, mountainous. Soil, gravelly, loamy and rocky;1st,2nd,3rd and 4th rate. Timber, dense cedar. Undergrowth, scattered scrub oak. Mountainous land, steep ascents and descents, slopes covered with loose rocks and boulders; or land covered with dense timber and exceptionally difficult to survey, 80.00 chs.</p> <p style="text-align: right;">March 4, 1911.</p> <hr/> <p>March 5: At 8 a.m.,l.m.t., I set off 6°17'S on the decl. arc; 35° 10'Non the lat.arc; and determine a true meridian with the solar at the standard corner of secs. 33 and 34.</p> <p>Thence I run N. 0° 2' W., bet. secs. 33 and 34. Over mountainous land covered with loose rock and through dense cedar timber, with great difficulty.</p> <p>10.00 Top of mesa, brs. E and W; descend 12.74 10 in. cedar on line. 24.35 Ravine, 30 lks. wide, course NW; ascend along W.slope. 31.00 Top of W. slope, brs. E and W; descend 38.10 Ravine, 10 lks. wide, course W; ascend 40.00 Set a malapai stone,18x10x4 ins.,12 ins.in the ground for 1/4 sec.cor.,marked 1/4 on W.face; from which A cedar,10 ins.diam.,brs.N.15°00'W., 18 lks.dist., marked 1/4 S 33 B T A cedar,20 ins.diam.,brs.N.45°00'E.,160 lks.dist., marked 1/4 S 34 B T</p> <p style="text-align: center;">Variation, N. 15° E.</p> <p>50.00 Top of ridge, brs.NW and SE, 200 ft.above 1/4 sec.cor;desc 53.50 Gulch, 20 lks. wide, course NW; ascend 58.00 Top of ridge, brs. NW and SE; descend 74.85 Gulch, 20 lks. wide, course NW. 77.90 Gulch, 30 lks. wide, course NW; leave dense cedar. 80.00 Set a malapai stone,18x8x8 ins.,12 ins.in the ground for cor.of secs.27,28,33 and 34,marked with 1 notch on S. and 3 notches on E.edge; from which A cedar,20 ins.diam.,brs.N.73°43'W.,114 lks.dist., marked T 21 N R 11 W S 28 B T A cedar,12 ins.diam.,brs.N.50°19'E.,105 lks.dist., marked T 21 N R 11 W S 27 B T A cedar,12 ins.diam.,brs.S.25°25'E.,137 lks.dist., marked T 21 N R 11 W S 34 B T A cedar,15 ins.diam.,brs.S.29°00'W.,271 lks.dist., marked T 21 N R 11 W S 33 B T</p> <p>Land, mountainous. Land, gravelly and rocky; 2nd, 3rd and 4th rate. Timber, dense cedar. Undergrowth, scattered scrub oak. Mountainous land, steep ascents and descents, slopes covered with loose rocks and boulders or land covered with dense cedar timber and exceptionally difficult to survey, 80.00 chs.</p> <hr/> <p>N.0°1'W., bet. secs. 27 and 28 Over mountainous land, descending through dense cedar</p> <p>1.00 Gulch, 15 lks. wide, course NW. 9.50 Gulch, 20 lks. wide, course NW; ascend 15.55 Gulch, 40 lks. wide, course NW; ascend 22.00 Top of ridge, brs.E and W.,200 ft.above sec.cor.; descend leave dense cedar 30.00 Enter tufa boulders. 37.20 Wash,30 lks.wide,course NW;leave tufa boulders;ascend</p>
--------	---

Chains	
40.00	ON S. slope. Set a tufa stone, 18x8x6 ins., 12 ins. in the ground for $\frac{1}{4}$ sec. cor., marked $\frac{1}{4}$ on W. face; from which A cedar 12 ins. diam., brs. N. 48° 47' E., 47 lks. dist., marked $\frac{1}{4}$ S 27 B T A cedar, 12 ins. diam., brs. S. 86° 15' W., 108 lks. dist., marked $\frac{1}{4}$ S 28 B T Variation, N. 15° E.
	March 5: at this $\frac{1}{4}$ sec. cor., I set off 6° 14' S on the decl. arc; and at 12h 12m p.m., l.m.t., observe the sun on the meridian; the resulting lat. is 35° 11' N.
42.00	Enter large tufa boulders
49.50	Top of knob of tufa ridge 100 ft. above $\frac{1}{4}$ sec. cor., brs. SE and NW; descend
52.00	Leave tufa boulders.
56.60	Bottom of wash, 40 lks. wide, course NW
60.35	Wash, 30 lks. wide, brs. NW; ascend
64.00	Top of ridge, 100 ft. above wash, brs. E and W; descend
65.50	Gulch, 30 lks. wide, course SW; ascend
80.00	On S. slope 400 ft. above wash. Set a porphyry stone, 18x8x8 ins., 12 ins. in the ground for cor. of secs. 21, 22, 27 and 28, marked with 2 notches on S. and 3 notches on E. edge; from which A cedar, 12 ins. diam., brs. S. 69° 10' W., 137 lks. dist., marked T 21 N R 11 W S 28 B T A cedar, 12 ins. diam., brs. N. 70° 08' W., 211 lks. dist., marked T 21 N R 11 W S 21 B T A cedar, 10 ins. diam., brs. S. 31° 03' E., 165 lks. dist., marked T 21 N R 11 W S 27 B T A cedar, 10 ins. diam., brs. N. 64° 26' E., 150 lks. dist., marked T 21 N R 11 W S 22 B T Variation, N. 15° 55' E.
	Land, mountainous. Soil, gravelly and rocky; 3rd and 4th rate. Timber, cedar. Undergrowth, scrub oak. Mountainous land, covered with loose rocks and boulders, 40.00 chs. Mountainous land, steep ascents and descents, loose rocks on steep slopes or land covered with dense timber and boulders and exceptionally difficult to survey, 40.00 chs.

	N. 0° 2' W., bet. secs. 21 and 22
	Over mountainous land, ascending over steep slope covered with loose rocks with great difficulty.
6.50	Top of ridge, 700 ft. above cor., brs. E and W; descend
32.00	Wash, 45 lks. wide, course NW, 500 ft. below ridge; ascend
40.00	Set a porphyry stone, 20x8x6 ins., 15 ins. in the ground for $\frac{1}{4}$ sec. cor., marked $\frac{1}{4}$ on W. face; from which A cedar, 15 ins. diam., brs. S. 33° 17' W., 82 lks. dist., marked $\frac{1}{4}$ S 21 B T A cedar, 12 ins. diam., brs. S. 62° 23' E., 53 lks. dist., marked $\frac{1}{4}$ S 22 B T
45.55	Wash, 20 lks. wide, course SW; ascend
46.25	Trail, brs. E and W.
58.00	Top of W. slope of ridge, brs. NE and SW; descend on W. slope
64.00	Top of N. slope of ridge, brs. E and W; descend
69.80	Wash, 20 lks. wide, course W; ascend
75.00	Top of W. slope, 200 ft. above Lookout wash, brs. NE and SW.
77.00	Top of bluff above Lookout wash, brs. NE and SW.
79.30	Lookout wash, 45 lks. wide, course SW.
79.80	Prescott and Kingman road, brs. NE and SW.
80.00	On N. bank of Lookout wash. Set a tufa stone, 30x12x10 ins., 22 ins. in the ground for cor. of secs. 15, 16, 21 and 22, marked with 3 notches on E.

Chains 80.00	<p>S. slope in dense cedar. Set a porphyry stone, 18x15x8 ins., 12 ins. in the ground for cor. of secs. 9, 10, 15 and 16, marked with 3 notches on E. and 4 notches on S. face; from which</p> <p>A cedar, 12 ins. diam., brs. S. 57°15'E., 185 lks. dist., marked T 21 N R 11 W S 15 B T</p> <p>A cedar, 12 ins. diam., brs. N. 52°47'E., 211 lks. dist., marked T 21 N R 11 W S 10 B T</p> <p>A cedar, 24 ins. diam., brs. S. 47°35'W., 262 lks. dist., marked T 21 N R 11 W S 16 B T</p> <p>A cedar, 12 ins. diam., brs. N. 74°00'W., 208 lks. dist., marked T 21 N R 11 W S 9 B T</p> <p>Variation, N. 15°10'E.</p> <p>Land, mountainous. Soil, rocky; 2nd, 3rd and 4th rate. Timber, dense cedar. Undergrowth, scrub oak. Mountainous land, steep ascents and descents, steep slopes covered with loose rocks or boulders or land covered with dense timber and exceptionally difficult to survey, 80.00 chs.</p> <p>March 6: At this corner, I set off 5°51'S. On the decl. arc; and at 12h 12m p.m., l.m.t., observe the sun on the meridian; the resulting lat. is 35° 13'N</p>
40.00 80.25 0.85 14.00 24.00 40.12 1/2	<p>N. 89° 58' E., on a random line, bet. secs. 10 and 15. Set temp. 1/4 sec. cor.</p> <p>Intersect N. and S. line, 21 lks. S. of cor. of secs. 10, 11, 14 and 15. Thence I run</p> <p>S. 89° 49' W., on a true line, bet. secs. 10 and 15 Over mountainous land, ascending</p> <p>Wash, 40 lks. wide, course SW; ascend</p> <p>Top of S. slope of ridge, brs. SE and NW.; descend through dense cedar timber.</p> <p>N. bank of box canyon, 75 ft. deep, course SE; ascend</p> <p>Set a tufa stone, 12x12x8 ins., 10 ins. in the ground for 1/4 sec. cor., marked 1/4 on N. face; from which</p> <p>A cedar, 20 ins. diam., brs. S. 17°20'E., 40 lks. dist., marked 1/4 S 15 B T</p> <p>A cedar, 20 ins. diam., brs. N. 80°40'W., 65 lks. dist., marked 1/4 S 10 B T</p> <p>Variation, N. 15 1/2° E.</p>
56.00 62.20 80.25	<p>Top of ridge, brs. N and S.; descend</p> <p>Gulch, 25 lks. wide, course SE; ascend</p> <p>The cor. of secs. 9, 10, 15 and 16 Land, mountainous. Soil, rocky; 2nd, 3rd and 4th rate. Timber, dense cedar Undergrowth, scrub oak. Mountainous land, steep ascents and descents, steep slopes covered with loose rocks and boulders or land covered with dense timber and exceptionally difficult to survey, 80.25 chs.</p> <p style="text-align: right;">March 6, 1911.</p>
4.00 23.00 28.00 29.80	<p>March 7: At 8 a.m., l.m.t., I set off 5°31'S on the decl. arc; 35°13'N on the lat. arc; and determine a true meridian with the solar at the cor. of secs. 9, 10, 15 and 16. Thence I run</p> <p>N. 0° 2' W., bet. secs. 9 and 10. Over mountainous land, ascending through dense cedar.</p> <p>Top of ridge, brs. NE and SW; descend</p> <p>S. bank of box canyon, 130 lks. wide, course NW; ascend</p> <p>Top of spur; descend</p> <p>Top of S. bank of Tuckayou wash. Set a flag for triangulation in center of Tuckayou wash. At this point I</p>

Subdivision of Township 21 North, Range 11 West. 11

Chains	turn at right angles from my line and run 4 chs.W. and read angle to my flag on top of bluff 63°04' which gives flag in wash 7.87 chs dif.from flag on top of bluff
37.67	Wash, 30 lks. wide, course SW; ascend
40.00	Set a malapai stone, 18x10x8 ins., 12 ins. in the ground for 1/4 sec. cor., marked 1/4 on W. face; from which A cedar, 20 ins. diam., brs. N. 79°46' W., 156 lks. dist., marked 1/4 S 9 B T A cedar, 4 ins. diam., brs. N. 16°00' E., 259 lks. dist., marked 1/4 S 10 B T
50.00	Ravine, 15 lks. wide, brs. SE; ascend
71.00	Top of ridge, brs. NW and SE; descend
78.00	Ravine, 20 lks. wide, course SE; ascend.
80.00	400 ft. above wash. Set a limestone, 18x10x6 ins., 12 ins. in the ground for cor. of secs. 3, 4, 9 and 10, marked with 5 notches on S. and 3 notches on E. edge; from which A cedar, 24 ins. diam., brs. N. 39°35' W., 71 lks. dist., marked T 21 N R 11 W S 4 B T A cedar, 15 ins. diam., brs. N. 15°11' E., 94 lks. dist., marked T 21 N R 11 W S 3 B T A cedar, 15 ins. diam., brs. S. 42°58' W., 308 lks. dist., marked T 21 N R 11 W S 9 B T A cedar, 12 ins. diam., brs. S. 36°03' E., 245 lks. dist., marked T 21 N R 11 W S 10 B T
	Land, mountainous Soil, rocky; 2nd, 3rd and 4th rate. Timber, dense cedar. Undergrowth, scrub oak. Mountainous land, steep ascents and descents, slopes steep and covered with loose rocks and boulders or land covered with dense timber and exceptionally difficult to survey, 80.00 chs.

40.00	N. 89° 49' E., on a random line, bet. secs. 3 and 10 Set temp. 1/4 sec. cor.
80.10	Intersect N. and S. line, 10 lks. N. of cor. of secs. 2, 3, 10 and 11. Thence I run S. 89° 53' W., on a true line, bet. secs. 3 and 10. Over mountainous land, ascending through dense cedar timber.
3.50	Top of ridge, brs. NE and SW 200 ft. above corner; descend steep, rocky slope through dense cedar timber.
11.00	Gulch, 20 lks. wide, course SW, 300 ft. below ridge; ascend on S. slope of ridge.
23.40	Wash, 25 lks. wide; course NW; descend
29.40	Ravine, 40 lks. wide, course NW; ascend
31.00	Top of knob; descend
39.10	Wash, 30 lks. wide, course SW; ascend
40.05	Set a granite stone, 18x8x6 ins., 12 ins. in the ground for 1/4 sec. cor., marked 1/4 on N. face; from which A cedar, 8 ins. diam., brs. N. 37°00' E., 23 lks. dist., marked 1/4 S 3 B T A cedar, 8 ins. diam., brs. S. 44°00' W., 55 lks. dist., marked 1/4 S 10 B T
	March 7: At this 1/4 sec. cor., I set off 5°28'S on the decl. arc; and at 12h 11m p.m., l.m.t., observe the sun on the meridian; the resulting lat. is 35°14'N
47.00	Top of steep E. bank wash; leave dense cedar timber; descend 150 ft.
55.00	Enter wash, course SW.
57.00	Leave wash, ascend steep 200 ft. cliff.
60.00	Top of W. bank; descend through dense cedar timber.
80.10	The cor. of secs. 3, 4, 9 and 10. Land, mountainous. Soil, rocky; 3rd and 4th rate. Timber, dense cedar. Undergrowth, scrub oak.

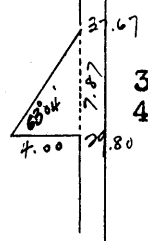

Chains	Mountainous land, steep ascents and descents, slopes steep and covered with loose rocks or boulders or land covered with dense timber and exceptionally difficult to survey, 80.10 chs.

	From the standard corner of secs. 32 and 33, I run N. 0° 2' W., on a true line, bet. secs. 32 and 33 Over mountainous land, descending over loose rocks and through dense cedar timber.
3.00	Ravine, 15 lks. wide, course NE; ascend
9.00	Top of ridge, brs. NE and SW; descend
13.00	Ravine, 20 lks. wide, course NE; ascend
17.00	Top of steep ridge, brs. NE and SW; descend
21.50	Ravine, 30 lks. wide, course NE; ascend
23.50	Top of E. slope of ridge; descend
40.00	Set a malapai stone, 18x6x6 ins., 12 ins. in the ground for $\frac{1}{4}$ sec. cor., marked $\frac{1}{4}$ on W. face; from which A cedar, 5 ins. diam., brs. S. 73° 30' W., 62 lks. dist., marked $\frac{1}{4}$ S 32 B T A cedar, 15 ins. diam., brs. S. 75° 53' E., 343 lks. dist., marked $\frac{1}{4}$ S 33 B T Variation, N. 15 $\frac{1}{4}$ ° E.
56.50	Ravine, 30 lks. wide, course NE; ascend
67.00	Top of E. slope, Brs. NE and SW; descend.
80.00	Leave dense cedar timber. On E. end of tufa ridge. Set a tufa stone, 20x8x6 ins., 15 ins. in the ground for cor. of secs. 28, 29, 32 and 33, marked with 1 notch on S. and 4 notches on E. edge; from which A cedar, 10 ins. diam., brs. S. 67° 15' E., 292 lks. dist., marked T 21 N R 11 W S 33 B T A cedar, 15 ins. diam., brs. S. 12° 30' W., 15 lks. dist., marked T 21 N R 11 W S 32 B T A cedar, 8 ins. diam., brs. N. 83° 30' E., 129 lks. dist., marked T 21 N R 11 W S 28 B T No other tree. Raise a md. of stone, 2 ft. base, 1 $\frac{1}{2}$ ft. high, W. of cor. Soil, rocky; 2nd, 3rd and 4th rate. Land mountainous. Timber, dense cedar. Undergrowth, scrub oak. Mountainous land, steep ascents and descents, steep slopes covered with loose rocks and boulders or land covered with dense timber and exceptionally difficult to survey, 80.00 chs.
March 7, 1911.	

	March 8: At 8 a.m., 1.m.t., I set off 5° 07' S on the decl. arc; 35° 10' N on the lat arc; and determine a true meridian with the solar at the cor. of secs. 28, 29, 32 & 33; thence I run East on a random line, bet. secs. 28 and 33
40.00	Set temp. $\frac{1}{4}$ sec. cor.
79.90	Intersect N. and S. line, 4 lks. S. of cor. of secs. 27, 28, 33 and 34. Thence I run S. 89° 58' W., on a true line, bet. secs. 28 and 33 Over mountainous land, descending over loose, rough rocks and through dense cedar timber with great difficulty.
37.00	Bottom of descent, gulch, 20 lks. wide, course NW; leave dense cedar; ascend
39.00	Top of ledge of tufa, brs. N and S.
39.95	On tufa ledge. Set a tufa stone, 20x12x10 ins., 15 ins. in the ground for $\frac{1}{4}$ sec. cor., marked $\frac{1}{4}$ on N. face; and raise a mound of stone, 2 ft. base, 1 $\frac{1}{2}$ ft. high, N. of cor.
42.50	Leave lava ledge; descend across flats
55.00	Bottom of descent; road NW. and SE. Wash, course NE.; asc.
79.90	The cor. of secs. 28, 29, 32 and 33.

Chains	Land, mountainous. Soil, rocky; 2nd, 3rd and 4th rate. Timber, dense cedar. Undergrowth, scrub oak. Mountainous land, covered with loose rocks, 37.40.chs. Mountainous land, steep ascents and descents, steep slopes covered with loose rocks and boulders or land covered with dense timber and exceptionally difficult to survey 42.50. chs.

1.00	N. 0° 2' W., bet. secs. 28 and 29
14.00	Over mountainous land, ascending Tufa boulder, 20x10x10 ins., on line; descend Wash, 30 lks. wide, course NE; ascend through dense cedar timber.
20.00	Top of E. slope of ridge; descend
30.00	Leave dense cedar. Enter bottom land, brs. NW and SE.
36.00	Wagon road to Miller's ranch, brs NW and SE.
39.40	Wash, 50 lks. wide, course NW and SE.
40.00	Set a porphyry stone, 18x8x8 ins., 12 ins. in the ground for $\frac{1}{4}$ sec. cor., marked $\frac{1}{4}$ on on W. face; from which A cedar, 15 ins. diam., brs. N. 60° 25' E., 198 lks. dist., marked $\frac{1}{4}$ S 28 B T No other trees available. Raise a mound of stone, 2 ft. base, 1 $\frac{1}{2}$ ft. high, W. of cor. Pits impracticable. Variation, N. 14 $\frac{1}{2}$ ° E.
43.00	March 8: At this $\frac{1}{4}$ sec. cor., I set off 5° 04' S. on the decl. arc; and at 12h 11m p.m., l.m.t., observe the sun on the meridian; the resulting lat. is 35° 11' N. Leave bottom; ascend over rough, rocky slope through dense cedar timber,
54.00	Top of spur; descend
62.00	Enter bottom; leave dense cedar.
69.70	Leave bottom; ascend
73.00	Top of knob; descend
74.00	14 in. cedar on line.
75.00	Enter bottom
77.00	Corral, 5 chs. E.
80.00	Set a malapai stone, 20x8x6 ins., 15 ins. in the ground for cor. of secs. 20, 21, 28 and 29, marked with 2 notches on S. and 4 notches on E. edge; from which A cedar, 12 ins. diam., brs. S. 16° 46' E., 375 lks. dist., marked T 21 N R 11 W S 28 B T No other trees available. Dig pits 18x18x12 ins., in each sec. 5 $\frac{1}{2}$ ft. dist.; and raise a mound of earth, 4 ft. base, 2 ft. high, W. of cor.
	Land, mountainous. Soil, gravelly and rocky; 2nd, 3rd and 4th rate. Timber, dense cedar. Undergrowth, scrub oak. Mountainous land, covered with loose rocks and dense timber, 41.00 chs. Mountainous land, steep slopes covered with loose rocks and dense timber and exceptionally difficult to survey, 39.00 chs.

40.00	From the cor. of secs. 20, 21, 28 and 29, I run N. 89° 58' E., on a random line, bet. secs. 21 and 28
79.75	Set temp. $\frac{1}{4}$ sec. cor. Intersect N. and S. line, 16 lks. N. of cor. of secs. 21, 22, 27 and 28. Thence I run N. 89° 55' W., on a true line, bet. secs. 21 and 28 Over mountainous, over steep slope covered with loose porphyry rocks and through dense cedar.

Chains	
30.00	Wash, 30 lks. wide, course NW, 400 ft. below cor.; ascend over boulders.
37.00	Top of slope, brs. NW and SE; leave dense cedar; descend
39.87½	Set a porphyry, 20x10x6 ins., 15 ins. in the ground for ¼ sec. cor., marked ¼ on N. face; from which A cedar 13 ins. diam., brs. N. 74°39'E., 145 lks. dist., marked ¼ S 21 B T A cedar, 12 ins. diam., brs. S. 12°44'E., 45 lks. dist., marked ¼ S 28 B T
46.00	Gully, 20 lks. wide, course NW.
49.00	Wash, 40 lks. wide, course NW; ascend
56.00	Top of knob, brs. NW and SE; descend
79.75	The cor. of secs. 20, 21, 28 and 29. Land, mountainous. Soil, rocky; 2nd, 3rd and 4th rate. Timber, cedar. Mountainous land, covered with loose rocks, 39.75 chs. Mountainous land, steep slopes covered with loose rocks or land covered with dense timber and exceptionally difficult to survey, 40.00 chs.
	March 8, 1911.

	March 9: At 8 a.m., l.m.t., I set off 4°44'S. On the decl. arc; 35°11'N on the lat. arc; and determine a meridian at the cor. of secs. 20, 21, 28 and 29. Thence I run N. 0° 2' W., bet. secs. 20 and 21 Over rolling land, descending along flat.
8.80	Wagon road, brs. E and W.
9.25	Barbed wire fence, brs. E and W.
40.00	Set a limestone, 18x10x6 ins., 12 ins. in the ground for ¼ sec. cor., marked ¼ on W. face; and raise a mound of stone, 2 ft. base, 1½ ft. high, W. of cor. Pits impracticable. Variation, N. 15° E.
44.94	Barbed wire fence, brs. E and W; ascend along W. slope of ridge.
47.00	Wagon road, Tuckayou Ranch to Old Camp Willow Grove, brs. E and W.
49.00	Top of spur, brs. E and W.
51.00	Top of bank of Willow creek. Same wagon road brs. NE and SW.
52.50	Willow creek, 100 lks. wide, course SW; ascend from creek along E. slope.
66.06	Top of E. slope 150 ft. from creek, brs. NE and SW; descend
70.00	Bluff 50 ft. high.
70.00	Enter bottom land of Willow creek.
80.00	In bottom Set a porphyry stone, 18x12x10 ins., 12 ins. in the ground for cor. of secs. 16, 17, 20 and 21, marked with 3 notches on S. and 4 notches on E. edge; dig pits, 18x18x12 ins., in each sec. 5½ ft. dist.; and raise a mound of earth, 4 ft. base, 2 ft. high W. of cor. Variation, N. 15½° E. Land, mountainous and rolling. Soil, gravelly, clayey and rocky; 2nd and 3rd rate. Timber, scattered cedar. Rolling land, 62x50 chs. Mountainous and rolling land, 62.50 chs. Mountainous land, exceptionally difficult to survey, 17.50 chs.

	From the cor. of secs. 16, 17, 20 and 21, I run S. 89°55'E., on a random line, bet. secs. 16 and 21
40.00	Set temp. ¼ sec. cor.
79.80	Intersect N. and S. line, 2 lks. N. of cor. of secs. 15, 16, 21, 22 Thence I run N. 89°54'W., on a true line, bet. secs. 16 and 21

Chains	Over mountainous and rolling land, ascending from Look-out wash.
1.15	Barbed wire fence, brs. NE and SW.
5.00	Top of ascent, brs. NE and SW.; descend
10.00	Bottom of descent.
20.00	Leave bottom; ascend
23.00	Top of knob on S. slope, brs. NE and SW; descend
33.00	Gully, 10 lks. wide, course SW; ascend
34.60	Trail, brs. NE and SW.
39.90	Set a tufa stone, 20x6x6 ins., in mound of stone, for $\frac{1}{4}$ sec. cor., marked $\frac{1}{4}$ on N. face; from which A cedar, 20 ins. diam., brs. N. 14° 35' W., 267 lks. dist., marked $\frac{1}{4}$ S 16 B T A cedar, 18 ins. diam., brs. S. 40° 31' E., 170 lks. dist., marked $\frac{1}{4}$ S 21 B T Variation, N. 13 $\frac{1}{4}$ ° E.
	Ascend
46.00	Top of S. slope; descend
59.00	Enter bottom of Willow Creek.
61.82	Barbed wire fence, brs. NW and SE.
67.70	Willow Creek wash, 100 lks. wide, course SW; ascend
68.65	Wagon road, Tuckayou Ranch to Willow Grove, brs. NW and SE ascend over Willow flat.
79.80	The cor. of secs. 16, 17, 20 and 21 Land, mountainous and rolling. Soil, sandy, clay, loam; 2nd, 3rd and 4th rate. Timber, scattered cedar. Undergrowth, scattered scrub oak. Mountainous and rolling land, 80.00 chs. March 9: At this corner, I set off 4° 41' S on the decl. arc; and at 12h 11m p.m., l.m.t., observe the sun on the meridian; the resulting lat. is 35° 12' N.

	N. 0° 2' W., bet. secs. 16 and 17
	Over mountainous land, ascending over Willow creek flat.
6.25	Wagon road, Tuckayou Ranch to Willow Grove, brs. NW and SE
9.00	Wash, 40 lks. wide, course E; ascend
37.00	Leave flat, ascend on S. slope of ridge.
40.00	Set a malapai stone, 24x10x8 ins., in mound of stone, for $\frac{1}{4}$ sec. cor., marked $\frac{1}{4}$ on W. face; from which A cedar, 40 ins. diam., brs. S. 23° 02' W., 67 lks. dist., marked $\frac{1}{4}$ S 17 B T A cedar, 24 ins. diam., brs. S. 67° 51' E., 36 lks. dist., marked $\frac{1}{4}$ S 16 B T Variation, N. 15 $\frac{3}{4}$ ° E.
59.00	Top of ridge, brs. NE and SW, 500 ft. above Willow Creek flat.
66.00	Saddle, brs. NE and SW; ascend
74.50	Top of butte, 800 ft. above flat; descend
80.00	On N. slope. Set a porphyry stone, 18x6x6 ins., 12 ins. in the ground for cor. of secs. 8, 9, 16 and 16, marked with 4 notches on S. and 4 notches on E. edge; and raise a mound of stone, 2 ft. base, 1 $\frac{1}{2}$ ft. high W. of cor. Pits impracticable. Variation, N. 15 $\frac{1}{4}$ ° E.
	Land, mountainous. Soil, clay, loam and rocky; 2nd, 3rd and 4th rate. Timber, cedar. Undergrowth, scrub oak. Mountainous land, 40.00 chs. Mountainous land, exceptionally difficult to survey, 40.00 chs.

	From the cor. of secs. 8, 9, 16 and 17, I run
40.00	S. 89° 54' E., on a random line, bet. secs. 9 and 16
79.90	Set temp $\frac{1}{4}$ sec. cor. Intersect N. and S. line, 9 lks. S. of cor. of secs. 9, 10, 15, 16

Chains	Thence I run N. 89° 58' W., on a true line, bet. secs. 9 and 16 Over mountainous land, ascending through dense cedar timber.
8.00	Top of ascent, brs. NE and SW; descend to Turkeyou wash, 500 ft. below.
19.00	Ravine, 20 lks. wide, course SW; ascend
23.00	Top of ridge, course NE and SW; descend
28.00	Bottom of east side of Turkeyou wash, 50 lks. wide, course SW.
32.00	West bank of wash; ascend steep slope covered with loose rocks, through dense cedar timber.
39.95	On steep E. slope Turkeyou wash. Set a porphyry stone, 18x14x8 ins., 12 ins. in the ground for $\frac{1}{4}$ sec. cor., marked $\frac{1}{4}$ ON N. face; from which A cedar, 12 ins. diam., brs. N. 13° 35' W., 56 lks. dist., marked $\frac{1}{4}$ S 9 B T A cedar, 16 ins. diam., brs. S. 40° 26' E., 22 lks. dist., marked $\frac{1}{4}$ S 16 B T
73.00	Top of ridge, brs. NE and SW, 500 ft. above wash; descend
79.90	The cor. of secs. 8, 9, 16 and 17. Land, mountainous. Soil, rocky; 3rd and 4th rate. Timber, dense cedar. Undergrowth, scrub oak. Mountainous land, steep ascents and descents, steep slopes covered with loose rocks and boulders and land covered with dense cedar timber and exceptionally difficult to survey, 79.90 chs.
	March 9, 1911.

	March 10: At 8 a.m., l.m.t., I set off 4° 21' S on the decl. arc; 35° 10' N on the lat. arc; and determine a meridian with the solar at the cor. of secs. 28, 29, 32 and 33 Thence I run W., on a true line, bet. secs. 29 and 32. Over very mountainous land, ascending
2.00	Top of slope tufa ridge, brs. NE and SW.
3.00	Top of tufa ridge, 40 ft. high, brs. NE and SW; descend through dense scrub oak
8.00	Bottom of descent; ascend
14.35	Gulch, 25 lks. wide, course NE.
20.00	Top of NE slope of ridge, brs. NE and SW; descend
26.40	Leave dense scrub oak; gulch, 30 lks. wide, course NE; ascend steep rocky slope, covered with loose rocks.
40.00	Set a tufa stone, 18x6x6 ins., 12 ins. in the ground for $\frac{1}{4}$ sec. cor., marked $\frac{1}{4}$ on N. face; from which A cedar, 8 ins. diam., brs. S. 7° 00' E., 22 lks. dist., marked $\frac{1}{4}$ S 32 B T A cedar, 6 ins. diam., brs. N. 64° 40' W., 151 lks. dist., marked $\frac{1}{4}$ S 29 B T Variation, N. 13 $\frac{1}{2}$ ° E.
43.50	Top of ridge, brs. NE and SW 600 ft. above sec. cor. on steep rocky slope.
57.50	Gulch, 35 lks. wide, course NE; ascend
75.00	Top of ridge, 700 ft. above gulch, brs. NE and SW; descend
80.00	Set a porphyry stone, 20x10x8 ins., 15 ins. in the ground for cor. of secs. 29, 30, 31 and 32, marked 1 notch on S. and 5 notches on E. edge; from which A cedar, 12 ins. diam., brs. S. 16° 33' E., 58 lks. dist., marked T 21 N R 11 W S 32 B T a cedar, 12 ins. diam., brs. N. 68° 50' W., 39 lks. dist., marked T 21 N R 11 W S 30 B T No other trees available. Raise a mound of stone, 2 ft. base, 1 $\frac{1}{2}$ ft. high, W. of cor. Pits impracticable. Variation, N. 16° E. Land, mountainous. Soil, rocky; 3rd and 4th rate. Timber, cedar. Undergrowth, scrub oak.

Chains

Mountainous land, steep ascents and descents, steep slopes covered with loose rocks and land covered with dense timber and undergrowth and exceptionally difficult to survey, 80.00 chs.

From the cor. of secs. 29, 30, 31 and 32, I run N. 0° 3' W., on a true line, bet. secs. 29 and 30. Over mountainous land, descending very steep rocky slope through dense cedar, with great difficulty.

20.00
39.00
40.00

Top of ridge on W. slope, brs. NW and SE; ascend
Top of ridge, brs. NW and SE; descend; leave dense cedar on N. slope.
Set a quartzite stone, 20x8x6 ins., 15 ins. in the ground for $\frac{1}{4}$ sec. cor., marked $\frac{1}{4}$ on W. face; and raise a mound of stone, 2 ft. base, $1\frac{1}{2}$ ft. high, W. of cor. Pits impracticable.

Variation, N. 16° E.

43.65
47.00
51.00
55.00
57.00
73.00
75.40
80.00

Gulch, 35 lks. wide, course NW; ascend
Top of ridge, brs. NW and SE
Gulch, 20 lks. wide, course NW
Enter S bank of Willow creek, 30 lks. wide, course SW, 800 ft. below sec. cor.
Leave N. bank, ascend over large granite boulders on E. slope of hill over large boulders.
Top of NE slope of ridge, brs. SW and NE.
Gulch, 20 lks. wide, course NE.
Set a granite stone, 18x10x8 ins., 12 ins. in the ground for cor. of secs. 19, 20, 29 and 30, marked with 2 notches on S. and 5 notches on E. edge; from which
A cedar, 14 ins. diam., brs. S. 69° 20' E., 65 lks. dist., marked T 21 N R 11 W S 29 B T
A cedar, 8 ins. diam., brs. S. 81° 13' W., 135 lks. dist., marked T 21 N R 11 W S 30 B T
A cedar, 8 ins. diam., brs. N. 75° 24' E., 170 lks. dist., marked T 21 N R 11 W S 20 B T
A cedar, 12 ins. diam., brs. N. 3° 15' W., 85 lks. dist., marked T 21 N R 11 W S 19 B T
Variation, N. 15° E.

Land, mountainous.
Soil, rocky; 3rd and 4th rate.
Timber, cedar.
Undergrowth, scrub oak.

Mountainous land, steep ascents and descents, steep slopes covered with loose rocks and land covered with dense timber and exceptionally difficult to survey, 80.00 chs.

March 10: At this corner I set off 4° 18' S on the decl. arc; and at 12h 11m p.m., l.m.t., observe the sun on the meridian; the resulting lat. is 35° 11' N.

East on a random line, bet. secs. 20 and 29

40.00
79.90

7.00
13.50
20.00
22.00
23.40
26.00
29.00
30.60
38.00

Set temp. $\frac{1}{4}$ sec. cor.
Intersect N. and S. line, 4 lks. N. of cor. of secs. 20, 21, 28, 29
Thence I run
N. 89° 58' W., on a true line, bet. secs. 20 and 29
Ascending from rolling land
Top of knob, brs. N and S; descend
Enter rolling bottom.
Wash, 50 lks. wide, course SW.
Same wash, course NW.
Wagon road, Kingman to Prescott, brs. SW and NE.
Wash, 40 lks. wide, course NW.
250 lks. S. to Willow Creek Ranch owned by Hi hyman, consisting of, ranch, frame house and corral.
Wagon road, Kingman to Prescott, brs. NW and SE.
Ascend over granite ridge, brs. NW and SE.

Chains	
39.95	Set a granite stone, 18x8x6 ins., 12 ins. in the ground for $\frac{1}{4}$ sec. cor., marked $\frac{1}{4}$ on N. face; and raise a mound of stone, 2 ft. base, $1\frac{1}{2}$ ft. high, N. of cor. Pits impracticable.
45.00	Top of granite ridge, brs. NE and SW; descend over rough granite slope.
65.00	Willow creek, 2 chs. wide, running water, course SW; asc.
79.90	The cor. of secs. 19, 20, 29 and 30. Land, mountainous. Soil, sandy loam and rocky; 2nd, 3rd and 4th rate. Timber, cedar. Undergrowth, scrub oak. Mountainous land, covered with loose rock, 39.90 chs. Mountainous land, steep slopes covered with loose rocks and exceptionally difficult to survey, 40.00 chs. March 10, 1911.

	March 11: Owing to heavy rain all day of March 11, 1911, no work was done.

	March 12: At 8 a.m., l.m.t., I set off $3^{\circ}34'5$ on the decl arc; $35^{\circ}11'N$ on the lat. arc; and determine a meridian with the solar at the cor. or secs. 19, 20, 29 and 30. Thence I run N. $0^{\circ} 3' W.$, on a true line, bet. secs. 19 and 20 Over mountainous land, descending through dense timber.
7.60	Gulch, 40 lks. wide, course SE; ascend
12.05	Road, Kingman to Prescott, brs. NW and SE; ascend
25.75	Gulch, 20 lks. wide, brs. SE; ascend
26.65	Same gulch, course W; ascend
28.10	Same gulch, course SE; ascend
34.50	Same gulch, 20 lks. wide, course SW.
40.00	Mark a cedar, 4 ins. diam., for $\frac{1}{4}$ sec. cor., marked $\frac{1}{4}$ S 19 on W. face and $\frac{1}{4}$ S 20 on E. face; from which A cedar, 5 ins. diam., brs. S. $59^{\circ}42'W.$, 76 lks. dist., marked $\frac{1}{4}$ S 19 B T A cedar, 12 ins. diam., brs. S. $79^{\circ}03'E.$, 164 lks. dist., marked $\frac{1}{4}$ S 20 B T
42.40	Top of ridge 700 ft. above wash, brs. NE and SW; descend through dense cedar timber.
55.00	Ridge, brs. NE and SW; descend
80.00	Set a porphyry stone, 20x10x6 ins., 15 ins. in the ground for cor. of secs. 17, 18, 19 and 20, marked with 3 notches on S. and 5 notches on E. edge; from which A cedar, 6 ins. diam., brs. S. $30^{\circ}31'E.$, 44 lks. dist., marked T 21 N R 11 W S 20 B T A cedar, 15 ins. diam., brs. S. $50^{\circ}22'W.$, 18 lks. dist., marked T 21 N R 11 W S 19 B T A cedar, 8 ins. diam., brs. N. $61^{\circ}55'E.$, 87 lks. dist., marked T 21 N R 11 W S 17 B T A cedar, 20 ins. diam., brs. N. $71^{\circ}00'W.$, 177 lks. dist., marked T 21 N R 11 W S 18 B T Variation, N. $15^{\circ} E.$ Land, mountainous. Soil, rocky; 3rd and 4th rate. Timber, dense cedar. Undergrowth, scrub oak. Mountainous land, steep ascents and descents, steep slopes covered with loose rocks and boulders and land covered with dense timber and exceptionally difficult to survey, 80.00 chs. March 12: At this corner, I set off $3^{\circ}31'5$ on the decl. arc; and at 12h 10m p.m., l.m.t., observe the sun on the meridian; the resulting lat. is $35^{\circ}12'N$.

Subdivision of Township 21 North, Range 11 West. 19

Chains	S. 89° 58' E., on a random line, bet. secs. 17 and 20.
40.00	Set temp. $\frac{1}{4}$ sec. cor.
79.60	Intersect N. and S. line, 23 lks. S. of cor. of secs. 16, 17, 20 and 21.
	Thence I run
	S. 89° 52' W., on a true line, bet. secs. 17 and 20
	Over mountainous land, ascending from Willow creek flat.
15.00	Ascend through dense cedar timber; leave flat.
23.00	Top of S. slope, brs. NE and SW; descend
30.00	Ravine, 15 lks. wide, course SW; ascend
31.50	Top of ascent, brs. NE and SW; descend
32.10	Gulch, 10 lks. wide, course SE; ascend
39.80	Set a porphyry stone, 20x12x6 ins., 15 ins. in the ground for $\frac{1}{4}$ sec. cor., marked $\frac{1}{4}$ on N. face; from which
	A cedar, 8 ins. diam., brs. N. 25° 19' W., 75 lks. dist., marked $\frac{1}{4}$ S 17 B T
	A cedar, 18 ins. diam., brs. S. 24° 06' E., 259 lks. dist., marked $\frac{1}{4}$ S 20 B T
	Variation, N. 14° 10' E.
42.00	Top of ridge, brs. N and S; descend
54.20	Wash, 35 lks. wide, course SE, 300 ft. below ridge; asc.
62.65	Gulch, 25 lks. wide, course SE; ascend
71.80	Gulch, 10 lks. wide, course NE; ascend
78.50	Top of knoll, brs. NE and SW; descend
79.60	The cor. of secs. 17, 18, 19 and 20.

March 12, 1911.

GENERAL DESCRIPTION.

Township 21 North, Range 11 West is rough, mountainous and rocky, suitable for grazing with appearances of good growth of summer grasses. Small area of land, suitable for farming, in flats and bottoms of washes.

Three ranchers are located in Township 21 North, Range 11 West: George W. Miller, in the NW $\frac{1}{4}$ of NE $\frac{1}{4}$, Sec. 24. He has a frame house, garden, vineyard, spring, spring-house and orchard; he has also a permanent spring called Lookout.

On old government road, Prescott to Colorado river, barns, corrals for cattle, house, spring corrals, garden and tank in NW $\frac{1}{4}$ of NW $\frac{1}{4}$ Sec. 14 occupied by Ralph Buckley.

Hi Hyman at Ranch House corral in NW $\frac{1}{4}$ of NE $\frac{1}{4}$ Sec. 29. The Willows or Old Camp Willow Grove cattle ranch, spring and running water in NW $\frac{1}{4}$ of NE $\frac{1}{4}$ Sec. 29.

The entire township, with the exception of small flats, is covered with a dense growth of white cedar timber.

U.S. Deputy Surveyor.

March 12, 1911.

FINAL OATHS OF DEPUTY SURVEYOR AND HIS ASSISTANTS.

LIST OF NAMES.

A list of the names of the individuals employed by W. C. Anderson

....., United States Deputy Surveyor, to assist in running, measuring, and marking the lines and corners described in the foregoing field notes of the survey of

showing the respective capacities in which they acted:

- Arthur M. Payne Chainman.
- Ernest Young Chainman.
- Albert Murphy Moundman.
- Moundman.
- H. Martin Moundman.
- S. B. Tyree Axman.
- W. E. Anderson Flagman.

FINAL OATH OF ASSISTANTS.

We hereby certify that we assisted W. C. Anderson

....., United States Deputy Surveyor, in surveying all those parts or portions of the T21 N R 11 W

..... of the G. H. S. T.

B. S. meridian, Arizone of Arizone, which are represented in the foregoing field notes as having been surveyed by him and under his direction; and that said survey has been in all respects, to the best of our knowledge and belief, well and faithfully surveyed, and the corner monuments established, according to the instructions furnished by the United States Surveyor

General for Arizone

- Arthur M. Payne Chainman.
- Ernest Young Chainman.
- R. F. Martin Moundman.
- Albert Murphy Moundman.
- N. B. Tyree Axman.
- Axman.
- W. E. Anderson Flagman.

Subscribed and sworn to before me this 13th day of March, 1911

W. C. Anderson
U.S. Deputy Surveyor



FINAL OATH OF UNITED STATES DEPUTY SURVEYOR.

I, Roscoe O'Hann, United States Deputy Surveyor, do solemnly swear that, in pursuance of a contract received from Frank S. Ingalls United States Surveyor General for Arizona, bearing date of the 5th day of Jan, 1910, I have well, faithfully, and truly, in my own proper person, and in strict conformity with the instructions furnished by the United States Surveyor General for Arizona, the Manual of Surveying Instructions, and the laws of the United States, surveyed all those parts or portions of Elbow Spring T21N R11W

64 of the G & S R meridian, in the territory of Arizona, which are represented in the foregoing field notes as having been surveyed by me, and under my direction; and I do further solemnly swear that all the corners of said survey have been established and perpetuated in strict accordance with the Manual of Surveying Instructions, and the special written instructions of the United States Surveyor General for Arizona and in the specific manner described in the field notes, and that the foregoing are the original field notes of such survey.

Roscoe O'Hann
United States Deputy Surveyor.

Subscribed by said Roscoe O'Hann, and sworn to before me)
this 17 day of March, 1911

W. H. ...



APPROVAL.

OFFICE OF THE UNITED STATES SURVEYOR GENERAL,

Phoenix, Ariz MAY 14, 1913

The foregoing field notes of the survey of a portion of the subdivided lines of T21N R11W Bilsa and Salt River Base & Meridian, Arizona

executed by Roscoe O'Hann under his contract No. 162, dated July 5, 1910, having been critically examined, and the necessary corrections and explanations made, the said field notes, and the surveys they describe, are hereby approved.

Frank S. Ingalls
United States Surveyor General.

I certify that the foregoing transcript of the field notes of the above-described surveys in _____, has been correctly copied from the original notes on file in this office.

United States Surveyor General.