

2415

Book "5"

4-679

filed Mar. 9-1914

BOOK 2415

45
①

FIELD NOTES

OF THE SURVEY OF THE

South, West, & North Bdrs., T. 23 N., R. 10 W.

West Boundary, T. 24 N., R. 10 W.

East Boundary, T. 24 N., R. 6 W.

East, West, & North Bdrs., T. 25 N., R. 6 W.

North Boundary, T. 25 N., R. 7 W.

East, West, & North Bdrs., T. 26 N., R. 6 W.

North Boundary, T. 26 N., R. 7 W.

East, West, & North Bdrs., T. 27 N., R. 6 W.

Fractional West Boundary, T. 27 N., R. 7 W.

Of the Gila and Salt River Base & Meridian,

In the State of ARIZONA

EXECUTED BY

Jesse B. Wright

In the capacity of U. S. Surveyor August 28 1911 & February 5, 1912,
issued by the United States Surveyor General to govern surveys included in
Groups No. 15 & 16, which were approved by the Commissioner of the General Land
Office, Sept. 28, 1911, & March 1, 1912, pursuant to authority contained in the Act of
Congress dated June 25, 1910.

Survey commenced March 14, 1912

Survey completed June 2, 1912

INDEX DIAGRAM.

Township _____, Range _____

6	5	4	3	2	1
7	8	9	10	11	12
18	17	16	15	14	13
19	20	21	22	23	24
30	29	28	27	26	25
31	32	33	34	35	36

INDEX.

46
1A

HUALPAI IND. RES.

Contract 60 August & September, 1900.

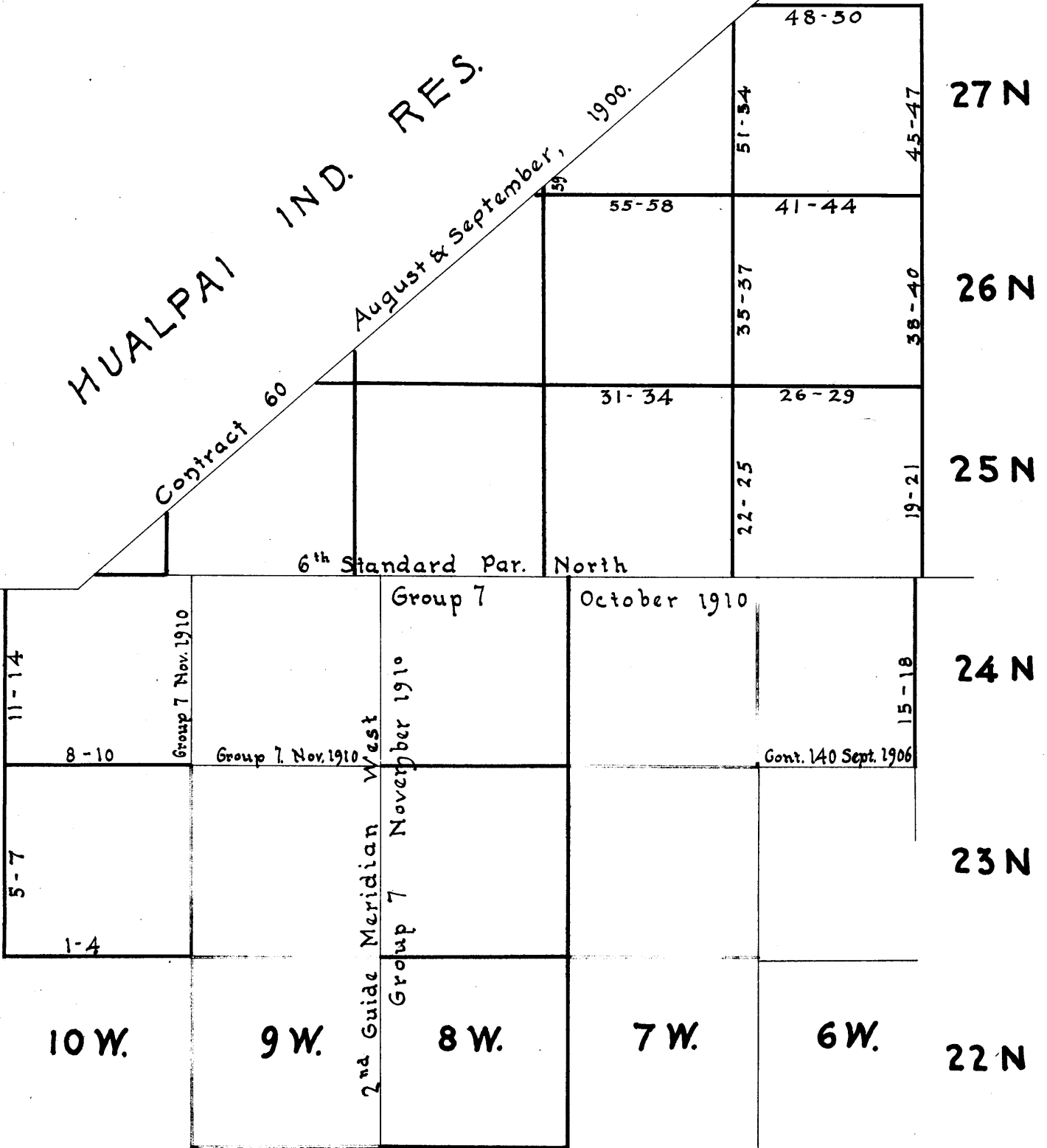

Explanation

- See Book 4
- " " 3
- " " 2
- " " 1
- This Book
- Former Surveys.

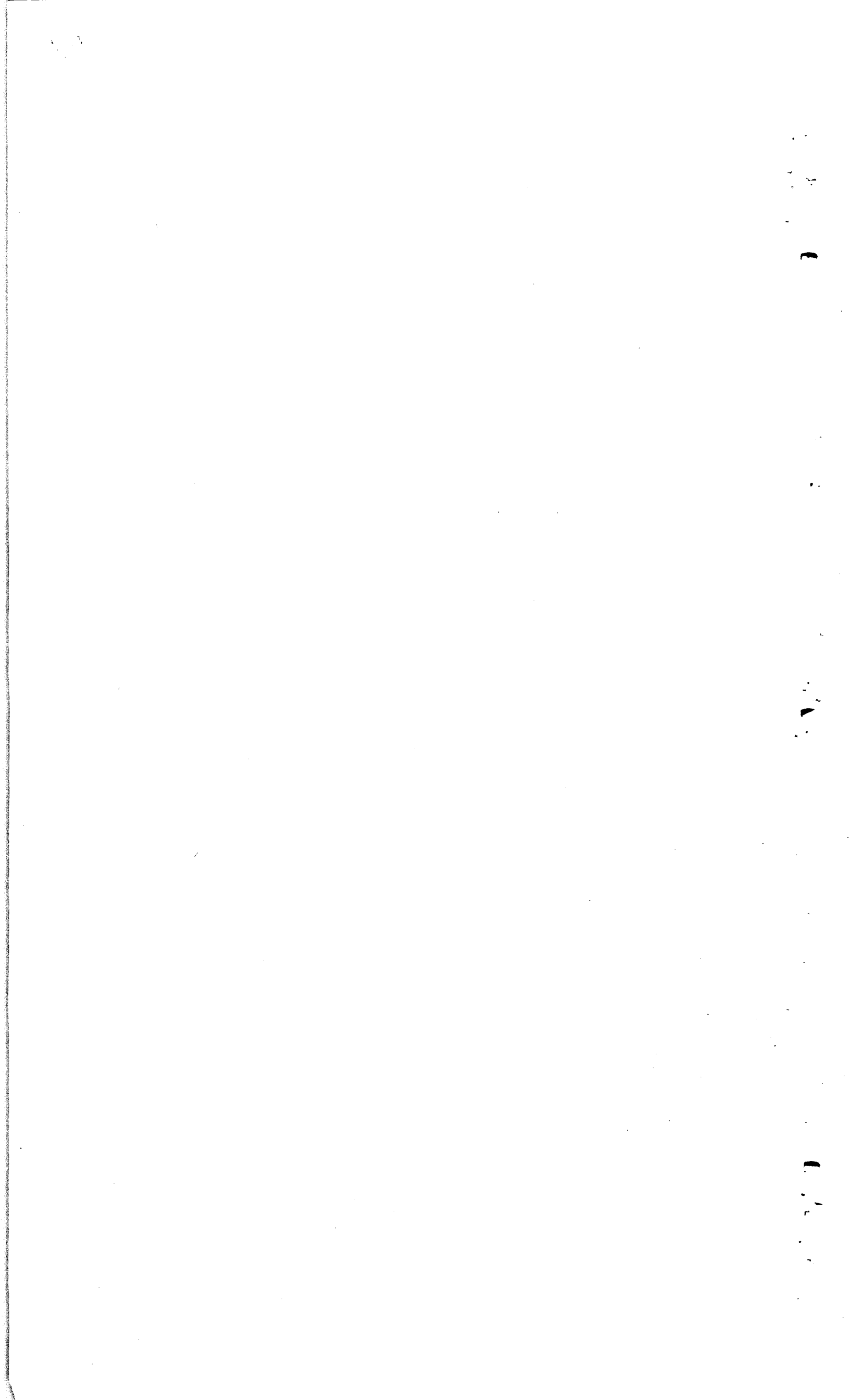

47
13

Chains.

Survey commenced March 14, 1912, and executed with a Young & Son's light mountain transit No. 6492, with Smith's patent solar attachment on side. The horizontal limb of the instrument is provided with two double verniers placed opposite to each other, and each reading to 1' of arc, which is also the least reading of the verniers of the latitude and declination arcs of the solar.

I examine and test all the adjustments of the transit and solar attachment, and finding same correct; then in order to test the solar apparatus, by comparing the results of observations on the sun, for meridians, made during p.m. & a.m. hours, with a true meridian as determined by Observation of Polaris, I proceed as follows :-

At 12h 9 $\frac{1}{2}$ m p.m., l.m.t., at my camp, which is situated at Munds ranch, near the cor. point of secs. 14, 15, 22 & 23, on this date, I set off 2°25' S. on the decl. arc, and observe the sun on the meridian.

The resulting lat. is 35°22 $\frac{1}{2}$ ' N.

At 3h p.m., l.m.t., I set off 35°22 $\frac{1}{2}$ ' N. on the lat. arc, and 2°22' S. on the decl. arc, and determine a meridian with the solar, and mark the meridian thus determined by a tack in a stake driven firmly in the ground 5 chs. N. of my station.

At 7h 55m p.m., l.m.t., I observe Polaris at Western elongation, in accordance with instructions in the "Manual", and mark the line thus determined by a cross on a fixed stone about 7 chs. N. of my station.

March 14, 1912.

March 15, 1912.

At 8h a.m., l.m.t., I set off the azimuth of Polaris, 1°25 $\frac{1}{2}$ ' to the East, and mark the true meridian thus determined by a tack in the stake 5 chs. N. of my station, which point falls .35 ins. E. of the point in the meridian as determined by the solar on preceding afternoon.

Then I set off 2°05' S. on the decl. arc, and 35°22 $\frac{1}{2}$ ' N. on the lat. arc, and determine a meridian with the solar, and mark a point in the meridian thus determined by a tack in the stake 5 chs. N. of my station, which point falls .20 ins. E. of the point in the true meridian as determined by observation of Polaris.

The solar apparatus, by p.m. & a.m. hours observations, defines positions for meridians about 20" W., and 10" E. respectively, of the true meridian as determined by observation of Polaris: therefore, I conclude that my instrument is in satisfactory adjustment.

The magnetic bearing of the true meridian at 8h a.m. is N. 15°55' W.; the angle thus determined gives the magnetic declination as 15°55' E.

I proceed to the Cor. of Tps. 22 & 23 N., Rs. 9 & 10 W., as established by me under Group No. 15, Ariz., and heretofore described by me, lat. 35°20' N., long. 113°16' 19" W.,

At this cor., at 8h 30m a.m., l.m.t.,

I set off 2°04 $\frac{1}{2}$ ' S. on the decl. arc, and 35°20' N. on the lat. arc, and determine a meridian with the solar. Thence I run, as per instructions,

Chains.

West, on S. bdy. of Tp., bet. secs. 1 & 36.
 Var. 15°50' E.
 Over gently rolling, grassy valley.

40.00 Set an iron post 3 ft. long, 1 in. in diam. 26 ins. in the ground for $\frac{1}{4}$ sec. cor., marked on brass cap, $\frac{1}{4}$ S 36 in N., and S 1 in S. half; dig pits 18x18x12 ins. E. & W. of cor. 3 ft. dist., and raise a mound of stone 2 ft. base, 1 $\frac{1}{2}$ ft. high N. of cor.

70.00 Enter scattering cedar, brs. N. & S., asc. gently.

80.00 Set an iron post 3 ft. long, 3 ins. in diam. 24 ins. in the ground for cor. of secs. 1, 2, 35 & 36, marked on brass cap, T 23 N in N., T 22 N, in S., and R 10 W, in W. half; S 35 in NW., S 36 in NE., S 1 in SE., and S 2 in SW. quad.; from which,
 A cedar tree 12 ins. diam. brs. N. 15° E. 315 lks. dist., marked T 23 N R 10 W S 36 B T.
 A cedar tree 10 ins. diam. brs. S. 30° E. 179 lks. dist., marked T 22 N R 10 W S 1 B T.
 A cedar tree 18 ins. diam. brs. S. 69° W. 337 lks. dist., marked T 22 N R 10 W S 2 B T.
 A cedar tree 15 ins. diam. brs. N. 36° W. 189 lks. dist., marked T 23 N R 10 W S 35 B T.

Land, level, rolling.
 Soil, 3rd rate, gravelly, sandy, loose.
 Sparse cedar, sage brush, fine grass.

West, bet. secs. 2 & 35.
 Over rolling land, asc. grad., through scattering cedar.

32.00 Foot of limestone hill, brs. N. & S., leave valley, asc. through dense cedar.

40.00 Set an iron post 3 ft. long, 1 in. in diam. 26 ins. in the ground for $\frac{1}{4}$ sec. cor., marked on brass cap, $\frac{1}{4}$ S 35 in N., and S 2 in S. half; from which,
 A cedar tree 6 ins. diam. brs. N. 89 $\frac{1}{2}$ ° E. 37 lks. dist., marked $\frac{1}{4}$ S 35 B T.
 A cedar tree 8 ins. diam. brs. S. 70° W. 24 lks. dist., marked $\frac{1}{4}$ S 2 B T.

59.00 Top of broken mesa, brs. N. & S., enter heavy cedar.

80.00 Set an iron post 3 ft. long, 3 ins. in diam. 12 ins. in the ground, on bed-rock, in mound of stone for cor. of secs. 2, 3, 34 & 35, marked on brass cap, T 23 N in N., T 22 N in S., and R 10 W in W. half, S 34 in NW., S 35 in NE., S 2 in SE., and S 3 in SW. quad.; from which,
 A cedar tree 14 ins. diam. brs. N. 66° E. 90 lks. dist., marked T 23 N R 10 W S 35 B T.
 A cedar tree 10 ins. diam. brs. S. 20° E. 43 lks. dist., marked T 22 N R 10 W S 2 B T.
 A cedar tree 6 ins. diam. brs. S. 57° W. 50 lks. dist., marked T 22 N R 10 W S 3 B T.
 A cedar tree 10 ins. diam. brs. N. 73 $\frac{1}{2}$ ° W. 44 lks. dist., marked T 23 N R 10 W S 34 B T.

Land, rolling, mts.
 Soil, 3rd rate, gravelly, stony.
 Cedar, some pinons, scrub oak, fair grass.
 At this cor., at noon, I set off 2° 01 $\frac{1}{2}$ ' S. on the decl. arc, and observe the sun on the meridian.
 The resulting lat. is 35° 20' N.

Chains.

West, bet. secs. 3 & 34.
 Over heavily rolling, broken mesa, through dense, heavy cedar.

40.00 Set an iron post 3 ft. long, 1 in. in diam. 26 ins. in the ground for $\frac{1}{4}$ sec. cor., marked on brass cap, $\frac{1}{4}$ S 34 in N., and S 3 in S. half; from which,
 A cedar tree 6 ins.diam.brs. N.5°W. 63 lks. dist., marked $\frac{1}{4}$ S 34 B T.
 A cedar tree 6 ins.diam.brs. S.29°W. 57 lks. dist., marked $\frac{1}{4}$ S 3 B T.

62.00 Limestone Knoll, brs. N. & S. desc.
 72.00 Grassy draw, 6 chs. wide, course NNE., asc. grad.
 80.00 Set an iron post 3 ft. long, 3 ins. in diam. 24 ins. in the ground for cor. of secs. 3, 4, 33 & 34, marked on brass cap, T 23 N in N., T 22 N in S., and R 10 W in W. half; from which,
 A cedar tree 12 ins.diam.brs. N.45 $\frac{1}{4}$ °E. 905 lks. dist., marked T 23 N R 10 W S 34 B T.
 A cedar tree 20 ins.diam.brs. S.83 $\frac{1}{4}$ °E. 340 lks. dist., marked T 22 N R 10 W S 3 B T.
 A cedar tree 10 ins.diam.brs. S.42°W. 230 lks. dist., marked T 22 N R 10 W S 4 B T.
 A cedar tree 20 ins.diam.brs. N.13 $\frac{1}{2}$ °W. 295 lks. dist., marked T 23 N R 10 W S 33 B T.

Land, heavily rolling.
 Soil, 3rd rate, gravelly, stony, dry.
 Cedar, pinon, scrub oak, fair grass in draws.
 Cloudy and raining after 2 30 p.m. this day.
 March 15, 1912.

March 16, 1912.
 At 8h a.m., l.m.t., at the above corner,
 I set off 1°41'S. on the decl. arc, and 35°20'N. on the lat. arc, and determine a meridian with the solar. Thence I run,
 West, bet. secs. 4 & 33.
 Over heavily rolling mesa, asc. from cor. through cedar.

14.00 Top of hill, brs. WNW. & S., desc. along gentle SSW. slope, through dense cedar.

38.00 Leave dense cedar, becomes scattering, brs. N. & S.

40.00 Set an iron post 3 ft. long, 1 in. in diam. 26 ins. in the ground for $\frac{1}{4}$ sec. cor., marked on brass cap, $\frac{1}{4}$ S 33 in N., and S 4 in S. half; from which,
 A cedar tree 30 ins.diam.brs. N.2 $\frac{1}{2}$ °E. 236 lks. dist., marked $\frac{1}{4}$ S 33 B T.
 A cedar tree 30 ins.diam.brs. S.79 $\frac{3}{4}$ °E. 204 lks. dist., marked $\frac{1}{4}$ S 4 B T.

A ranch house brs. S.51°41' W., about 2 miles.
 Open grassy valley extends S. & SW. from this cor. about 1 $\frac{1}{2}$ miles.

50.00 Enter N. end of valley, brs. E. & W., leave cedar.

80.00 Set an iron post 3 ft. long, 3 ins. in diam. 24 ins. in the ground for cor. of secs. 4, 5, 32 & 33, marked on brass cap, T 23 N in N., T 22 N in S., and R 10 W in W. half,
 S 32 in NW.,
 S 33 in NE.,
 S 4 in SE., and
 S 5 in SW. quad.;

dig pits 18x10x12 ins. in each sec. 5 $\frac{1}{2}$ ft. dist., and raise a mound of earth 4 ft. base, 2 ft. high W. of cor.
 No bearings available.
 Land, rolling, hilly.
 Soil, 3rd rate, gravelly, dry, loose.
 Cedar, pinon, scrub oak, good grass.

Chains.

- West, bet. secs. 5 & 32.
Over gently rolling land, good sandy loam.
- 16.00 W. side of valley, brs. ENE. & SSW., enter scattering cedar, asc. grad.
- 40.00 Set an iron post 3 ft. long, 1 in. in diam. 26 ins. in the ground for $\frac{1}{4}$ sec. cor., marked on brass cap,
 $\frac{1}{4}$ S 32 in N., and
S 5 in S. half; from which,
A cedar tree 12 ins. diam. brs. N. $33\frac{1}{2}^{\circ}$ E. 22 lks. dist., marked $\frac{1}{4}$ S 32 B T.
A cedar tree 14 ins. diam. brs. S. 54° E. 175 lks. dist., marked $\frac{1}{4}$ S 5 B T.
- 59.50 Road, brs. ENE. & WSW., enter dense cedar.
- 67.00 Top of low spur, brs. NE. & SW. desc. grad.
- 80.00 Set an iron post 3 ft. long, 3 ins. in diam. 24 ins. in the ground for cor. of secs. 5, 6, 31 & 32, marked on brass cap, T 23 N in N.,
T 22 N in S., and
R 10 W in W. half;
S 31 in NW.,
S 32 in NE.,
S 5 in SE., and
S 6 in SW. quad.; from which,
A cedar tree 15 ins. diam. brs. N. 36° E. 178 lks. dist., marked T 23 N R 10 W S 32 B T.
A cedar tree 20 ins. diam. brs. S. $71\frac{1}{2}^{\circ}$ E. 47 lks. dist., marked T 22 N R 10 W S 5 B T.
A cedar tree 8 ins. diam. brs. S. $0^{\circ}15'$ W. 119 lks. dist., marked T 22 N R 10 W S 6 B T.
A cedar tree 24 ins. diam. brs. N. 24° W. 51 lks. dist., marked T 23 N R 10 W S 31 B T.
- Land, rolling, hilly.
Soil, 3rd rate, gravelly, loose, dry.
Cedar, some pinon, scrub oak, few cacti, good grass.
At this cor., at noon, I set off $1^{\circ}38'$ S. on the decl. arc, and observe the sun on the meridian.
The resulting lat. is $35^{\circ}20'$ N.
-
- West, bet. secs. 6 & 31.
Over hilly land, desc. grad.
- 10.76 Wash, 30 lks. wide, course SSE., asc.
- 25.00 Top of low spur, brs. S. & N., desc. through cedar.
- 40.00 Set an iron post 3 ft. long, 1 in. in diam. 26 ins. in the ground for $\frac{1}{4}$ sec. cor., marked on brass cap,
 $\frac{1}{4}$ S 31 in N., and
S 6 in S. half; from which,
A cedar tree 6 ins. diam. brs. N. 28° E. 256 lks. dist., marked $\frac{1}{4}$ S 31 B T.
A cedar tree 14 ins. diam. brs. S. 72° E. 191 lks. dist., marked $\frac{1}{4}$ S 6 B T.
- 46.00 Centre of open grassy draw, 8 chs. wide, course S.,
- 56.20 Old road, brs. NE. & SW., asc. grad., drainage to SSE. Allowing 102 lks. for convergency, as per instructions, at
- 78.98 Set an iron post 3 ft. long, 3 ins. in diam. 24 ins. in the ground, for cor. of Tps. 22 & 23 N., Rs. 10 & 11 W., marked on brass cap,
T 23 N in N., R. 10 W in E., T 22 N in S., & R 11 W in W. half,
S 36 in NW., S 31 in NE., S 6 in SE., and S 1 in SW. quad.; from which,
A cedar tree 20 ins. diam. brs. N. $47\frac{1}{2}^{\circ}$ E. 99 lks. dist., marked T 23 N R 10 W S 31 B T.
A cedar tree 10 ins. diam. brs. S. $84\frac{1}{2}^{\circ}$ E. 84 lks. dist., marked T 22 N R 10 W S 6 B T.
A cedar tree 5 ins. diam. brs. S. $52\frac{1}{2}^{\circ}$ W. 162 lks. dist., marked T 22 N R 11 W S 1 B T.
A cedar tree 18 ins. diam. brs. N. $72\frac{1}{2}^{\circ}$ W. 110 lks. dist., marked T 23 N R 11 W S 36 B T.
- Land, rolling, hilly. Soil, 3rd rate, gravelly, loose.
Cedar, pinon, good grass. March 16, 1912.

Chains

March 16, 1912.
 At 1h p.m., l.m.t., at the cor. of Tps. 22 & 23 N.,
 Rs. 10 & 11W, just established by me, & hereinbefore described.
 I set off 1°37' S. on the decl. arc, and 35°20' N. on
 the lat. arc, and determine a meridian with the solar.
 Thence I run, as per instructions,
 North, on W. bdy. of Tp., bet. secs. 31 & 36.
 Var. 16°E.

- 12.00 Over mts. broken land, asc. through dense cedar, & pinon.
- 23.00 To top of low ridge, brs. NW. & SE., desc. grad.
- 30.00 Draw, 1 chs. wide, course ESE., asc. grad.
- 40.00 Low ridge, brs. ESE. & WNW., desc. grad.
- 50.00 Set an iron post 3 ft. long, 1 in. in diam. 26 ins. in
 the ground for 1/4 sec. cor., marked on brass cap,
 1/4 S 36 in W., and
 S 31 in E. half; from which,
 A pinon tree 12 ins. diam. brs. S.83°E. 73 lks. dist.,
 marked 1/4 S 31 B T.
 A cedar tree 24 ins. diam. brs. N.15°W. 38 lks. dist.,
 marked 1/4 S 36 B T.
- 65.00 Open draw, 8 chs. wide, course ESE., asc. stony low ridge.
- 76.00 Top of ridge, brs. ESE. & WNW., desc.
- 80.00 Wash, 5 ft. deep, 30 lks. wide, course ESE., asc. grad.
- 80.00 Set an iron post 3 ft. long, 3 ins. in diam. 24 ins. in
 the ground for cor. of secs. 25, 30, 31 & 36, marked on
 brass cap, T 23 N in N. half,
 R 11 W S 25 in NW.,
 R 10 W S 30 in NE.,
 S 31 in SE., and
 S 36 in SW. quad.; from which,
 A cedar tree 24 ins. diam. brs. N.51°E. 192 lks. dist.,
 marked T 23 N R 10 W S 30 B T.
 A cedar tree 8 ins. diam. brs. S.23°E. 47 lks. dist.,
 marked T 23 N R 10 W S 31 B T.
 A cedar tree 6 ins. diam. brs. S.88°W. 53 lks. dist.,
 marked T 23 N R 11 W S 36 B T.
 A cedar tree 6 ins. diam. brs. N.11°W. 478 lks. dist.,
 marked T 23 N R 11 W S 25 B T.

Land, mts., broken. Soil, 3rd rate, gravelly, stony, dry.
 Cedar, pinon, scrub oak, fair grazing.

- 40.00 North, bet. secs. 25 & 30.
 Over mts. land, asc. grad. along W. slope of low ridge,
 through dense cedar, foot of slope 6 chs. to W.
 Set an iron post 3 ft. long, 1 in. in diam. 26 ins. in
 the ground for 1/4 sec. cor., marked on brass cap,
 1/4 S 25 in W., and
 S 30 in E. half; from which,
 A cedar tree 24 ins. diam. brs. S.60°E. 65 lks. dist.,
 marked 1/4 S 30 B T.
 A cedar tree 14 ins. diam. brs. S.01°W. 75 lks. dist.,
 marked 1/4 S 25 B T.
- 59.97 Wash, 25 lks. wide, course SSW., asc. steeper.
- 76.00 Gulch, 15 lks. wide, course SSE., same wash as above.
- 80.00 Set an iron post 3 ft. long, 3 ins. in diam. 24 ins. in
 the ground for cor. of secs. 19, 24, 25 & 30, marked on
 brass cap, T 23 N in N. half, R. 11 W S 24 in NW.
 R 10 W S 19 in NE., S 30 in SE., and S 25 in SW. quad.,
 from which,
 A pinon tree 6 ins. diam. brs. N.66°E. 115 lks. dist.,
 marked T 23 N R 10 W S 19 B T.
 A pinon tree 12 ins. diam. brs. S.42°E. 129 lks. dist.,
 marked T 23 N R 10 W S 30 B T.
 A pinon tree 12 ins. diam. brs. S.30°W. 33 lks. dist.,
 marked T 23 N R 11 W S 25 B T.
 A pinon tree 15 ins. diam. brs. N.15°W. 38 lks. dist.,
 marked T 23 N R 11 W S 24 B T.

Land, mts., broken. Soil, 3rd rate, gravelly, stony.
 Cedar, pinon, scrub oak, fair grass.
 March 16, 1912.

Chains March 17, 1912.
 At 8h a.m., l.m.t., at the ^{above} cor. of ~~secs. 19, 24, 25 & 30,~~
 I set off $1^{\circ}17\frac{1}{2}'$ S. on the decl. arc, and $35^{\circ}22'$ N. on
 the lat. arc, and determine a meridian with the solar.
 Thence I run,
 North, bet. secs. 19 & 24.
 Over mts. land, asc. through dense cedar and pinon.
 22.00 Top of ridge, brs. E. & W., enter scattering cedar, desc.
 31.00 Gulch, 30 lks. wide, course E., heads 15 chs. to W., asc.
 40.00 Set an iron post 3 ft. long, 1 in. in diam. 26 ins. in
 the ground for $\frac{1}{4}$ sec. cor., marked on brass cap,
 $\frac{1}{4}$ S 24 in W., and
 S 19 in E. half; from which,
 A cedar tree 12 ins. diam. brs. S. 67° E. 195 lks. dist.,
 marked $\frac{1}{4}$ S 19 B T.
 A cedar tree 6 ins. diam. brs. N. $66\frac{1}{2}^{\circ}$ W. 50 lks. dist.,
 marked $\frac{1}{4}$ S 24 B T.
 53.00 Top of ridge, brs. NE., and SSW., desc.
 65.00 Foot of main slope, brs. NE. & SW., desc. grad.
 80.00 Set an iron post 3 ft. long, 3 ins. in diam. 24 ins. in
 the ground for cor. of secs. 13, 18, 19 & 24, marked on
 brass cap, T 23 N in N. half,
 R 11 W S 13 in NW.,
 R 10 W S 18 in NE.,
 S 19 in SE., and
 S 24 in SW. quad.; from which,
 A cedar tree 24 ins. diam. brs. N. 81° E. 186 lks. dist.,
 marked T 23 N R 10 W S 18 B T.
 A cedar tree 6 ins. diam. brs. S. 81° E. 203 lks. dist.,
 marked T 23 N R 10 W S 19 B T.
 A cedar tree 24 ins. diam. brs. S. 41° W. 196 lks. dist.,
 marked T 23 N R 11 W S 24 B T.
 A cedar tree 24 ins. diam. brs. N. 55° W. 543 lks. dist.,
 marked T 23 N R 11 W S 13 B T.
 Land, mts. Soil, 3rd rate, gravelly, stony, dry.
 Cedar, pinon, scrub oak, good grass.

North, bet. secs. 13 & 18.
 Over heavily rolling, stony land, through cedar.
 6.25 Road, brs. SE., from WNW.
 7.95 Wire fence, brs. WNW. & ESE., asc., in McIntire's pasture.
 24.00 Top of hill, brs. E. & W.,
 30.00 Desc. grad. WNW. slope.
 40.00 Set an iron post 3 ft. long, 1 in. in diam. 26 ins. in
 the ground for $\frac{1}{4}$ sec. cor., marked on brass cap,
 $\frac{1}{4}$ S 13 in W., and
 S 18 in E. half; from which,
 A cedar tree 20 ins. diam. brs. N. 8° E. 130 lks. dist.,
 marked $\frac{1}{4}$ S 18 B T.
 A scrub oak tree 6 ins. diam. brs. N. 2° W. 55 lks. dist.,
 marked $\frac{1}{4}$ S 13 B T.
 41.45 Wire fence, brs. NE. & SW., corners 3 chs. to NE., thence
 runs ENE., leave pasture.
 53.50 Draw, 1 ch. wide, course W., asc. along W. slope of ridge.
 70.00 Enter dense cedar and pinon.
 80.00 Set an iron post 3 ft. long, 3 ins. in diam. 24 ins. in
 the ground for cor. of secs. 7, 12, 13 & 18, marked on
 brass cap, T 23 N in N. half, R 11 W S 12 in NW.
 R 10 W S 7 in NE., S 18 in SE., and S 13 in SW. quad.,
 from which,
 A pinon tree 12 ins. diam. brs. N. 54° E. 63 lks. dist.,
 marked T 23 N R 10 W S 7 B T.
 A cedar tree 24 ins. diam. brs. S. 45° E. 26 lks. dist.,
 marked T 23 N R 10 W S 18 B T.
 A pinon tree 8 ins. diam. brs. S. 36° W. 58 lks. dist.,
 marked T 23 N R 11 W S 13 B T.
 A pinon tree 10 ins. diam. brs. N. 36° W. 27 lks. dist.,
 marked T 23 N R 11 W S 12 B T.
 Land, mts., broken. Soil, 3rd rate, gravelly, stony, dry.
 Cedar, pinon, scrub oak, fair grazing.
 At this cor., at noon, I set off $1^{\circ}14'$ S. on the decl. arc,
 and observe sun on meridian. Resulting lat. is $35^{\circ}23\frac{1}{2}'$ N.

Chains.

North, bet. secs. 7 & 12.
Over heavily rolling, stony land, through dense cedar and pinon.

- 16.00 Enter open draw.
 - 19.00 Wash, 30 lks. wide, course NE., asc. S. slope.
 - 24.85 Old road, brs. NE. & SW.
 - 39.00 Leave draw, brs. NW. & SE., enter dense cedar.
 - 40.00 Set an iron post 3 ft. long, 1 in. in diam. 26 ins. in the ground for $\frac{1}{4}$ sec. cor., marked on brass cap, $\frac{1}{4}$ S 12 in W., and S 7 in E. half; from which,
 - A cedar tree 10 ins.diam.brs. N.83°E. 26 lks. dist., marked $\frac{1}{4}$ S 7 B T.
 - A cedar tree 10 ins.diam.brs. S.49°W. 55 lks. dist., marked $\frac{1}{4}$ S 12 B T.
 - 50.00 Asc. prec. S. slope.
 - 64.00 Top of high ridge, brs. E. & W., thence over rough mts. land, desc. steep.
 - 79.85 Wash, 10 lks. wide, course E.
 - 80.00 Set an iron post 3 ft. long, 3 ins. in diam. 24 ins. in the ground for Cor. of secs. 1,6,7 & 12, marked on brass cap, T 23 N in N. half, R 11 W S 1 in NW., R 10 W S 6 in NE., S 7 in SE., and S 12 in SW. quad.; from which,
 - A pinon tree 4 ins.diam.brs. N.88°E. 67 lks. dist., marked T 23 N R 10 W S 6 B T.
 - A cedar tree 10 ins.diam.brs. S.64°E. 29 lks. dist., marked T 23 N R 10 W S 7 B T.
 - A cedar tree 14 ins.diam.brs. S.40°W. 50 lks. dist., marked T 23 N R 11 W S 12 B T.
 - A cedar tree 8 ins.diam.brs. N.89°W. 13 lks. dist., marked T 23 N R 11 W S 1 B T.
- Land, broken, mts. Soil, 3rd rate, stony, gravelly, dry.
Cedar, pinon, scrub oak, fair grass.

North, bet. secs. 1 & 6.
Over mts. stony land, asc. steep S. slope, through dense cedar and pinon.

- 11.00 Top of high spur, brs. ENE., desc. grad. N. slope.
 - 40.00 Set an iron post 3 ft. long, 1 in. in diam. 26 ins. in the ground for $\frac{1}{4}$ sec. cor., marked on brass cap, $\frac{1}{4}$ S 1 in W., and S 6 in E. half; from which,
 - A cedar tree 8 ins.diam.brs. N.87°E. 127 lks. dist., marked $\frac{1}{4}$ S 6 B T.
 - A pinon tree 4 ins.diam.brs. S.49 $\frac{1}{2}$ °W. 85 lks. dist., marked $\frac{1}{4}$ S 1 B T.
 - 41.00 Desc. steep N. slope.
 - 51.00 Gulch, 50 lks. wide, course NE., asc. ESE. slope.
 - 65.00 Top of rise, top of hill 10 chs. to W., desc. NNE.slope.
 - 80.00 Set an iron post 3 ft. long, 3 ins. in diam. 24 ins. in the ground for cor. of Tps.23 & 24 N.,Rs.10 & 11 W., marked on brass cap, T 24 N in N.,R 10 W in E.,T 23 N in S.,& R 11 W in W. half; S 36 in NW.,S 31 in NE.,S 6 in SE.,and S 1 in SW. quad.; from which,
 - A pinon tree 6 ins.diam.brs. N.23°E. 110 lks. dist., marked T 24 N R 10 W S 31 B T.
 - A cedar tree 4 ins.diam.brs. S.21°E. 85 lks. dist., marked T 23 N R 10 W S 6 B T.
 - A cedar tree 6 ins.diam.brs. S.19°W. 47 lks. dist., marked T 23 N R 11 W S 1 B T.
 - A cedar tree 20 ins.diam.brs. N.58°W. 80 lks. dist., marked T 24 N R 11 W S 36 B T.
- Land, mts., broken.
Soil, 3rd rate, gravelly, stony, dry.
Cedar, pinon, scrub oak, fair grazing.

March 17, 1912.

Chains.

March 18, 1912.

At 8h a.m., l.m.t., at the cor. of Tps. 23 & 24 N., Rs. 9 & 10 W., which is an iron post 3 ins. in diam. 1 ft. above above ground, with brass cap, marked and witnessed as described by the Surveyor-General,

I set off 35°25' N. on the lat. arc, and 0°54' S. on the decl. arc, and determine a meridian with the solar.

Thence I run, as per instructions, West, on a random line, on N. bdy. of Tp.

At 5 miles 78.55 chs., on this line, the cor. of Tps. 23 & 24 N., Rs. 10 & 11 W., brs. S. 30 lks. dist., Therefore I run, from this cor.

N. 89°58' E., on a true line, on N. bdy. of Tp. bet. secs. 6 & 31.

20.75 Over mts. land, desc. grad. through dense cedar & pinon. Wash, 10 lks. wide, in draw, 5 chs. wide, course NE., asc.

28.00 Top of small ridge, brs. NE. & SW., desc.

38.55 Set an iron post 3 ft. long, 1 in. in diam. 26 ins. in the ground for 1/4 sec. cor., marked on brass cap, 1/4 S 31 in N., and S 6 in S. half; from which,

A cedar tree 22 ins. diam. brs. N. 3° E. 150 lks. dist., marked 1/4 S 31 B T.

A cedar tree 26 ins. diam. brs. S. 35° E. 330 lks. dist., marked 1/4 S 6 B T.

40.75 Wash, 20 lks. wide in draw 4 chs. wide, course NW., asc.

42.00 Road, brs. NW. & SE.

57.00 Draw 2 chs. wide, course NW., asc. steeper.

78.55 Set an iron post 3 ft. long, 3 ins. in diam. 24 ins. in the ground for cor. of secs. 5, 6, 31 & 32, marked on brass cap, T 24 N in N.,

T 23 N in S., and

R 10 W in W. half,

S 31 in NW., S 32 in NE., S 5 in SE., and S 6 in SW. quad., from which,

A cedar tree 9 ins. diam. brs. N. 17 1/2° E. 125 lks. dist., marked T 24 N R 10 W S 32 B T.

A cedar tree 8 ins. diam. brs. S. 18° E. 63 lks. dist., marked T 23 N R 10 W S 5 B T.

A cedar tree 20 ins. diam. brs. S. 82° W. 190 lks. dist., marked T 23 N R 10 W S 6 B T.

A cedar tree 9 ins. diam. brs. N. 43° W. 20 lks. dist., marked T 24 N R 10 W S 31 B T.

Land, mts., broken. Soil, 3rd rate, gravelly, stony. Cedar, pinon, scrub oak, good grass in draws.

N. 89°58' E., bet. secs. 5 & 32.

Over mts. land, asc. through dense cedar and pinon.

8.00 Top of steep ascent, thence along top of ridge, brs. E. & W.

40.00 Set an iron post 3 ft. long, 1 in. in diam. 26 ins. in the ground for 1/4 sec. cor., marked on brass cap, 1/4 S 32 in N., and

S 5 in S. half; from which,

A pinon tree 8 ins. diam. brs. N. 55 1/2° E. 40 lks. dist., marked 1/4 S 32 B T.

A pinon tree 10 ins. diam. brs. S. 56 1/2° E. 35 lks. dist., marked 1/4 S 5 B T.

55.00 Desc.

69.35 Wash, 10 lks. wide, in draw 3 chs. wide, course NE., asc.

80.00 Set an iron post 3 ft. long, 3 ins. in diam. 24 ins. in the ground for cor. of secs. 4, 5, 32 & 33, marked on brass cap, T 24 N in N., T 23 N in S., & R 10 W in W. half, S 32 in NW., S 33 in NE., S 4 in SE., & S 5 in SW. quad.; From which,

A cedar tree 7 ins. diam. brs. N. 20° E. 40 lks. dist., marked T 24 N R 10 W S 33 B T.

A cedar tree 8 ins. diam. brs. S. 50 1/2° E. 60 lks. dist., marked T 23 N R 10 W S 4 B T.

A cedar tree 10 ins. diam. brs. S. 40 1/2° W. 104 lks. dist., marked T 23 N R 10 W S 5 B T.

A cedar tree 15 ins. diam. brs. N. 67 1/2° W. 119 lks. dist., marked T 24 N R 10 W S 32 B T.

Land, mts. Soil, 3rd rate, gravelly. Cedar, pinon, fair grass.

North Boundary T. 23 N., R. 10 W.

9

Chains. N. 89°58' E., bet. secs. 4 & 33.
 Over mts. land, asc. through cedar and pinon.
 12.00 Top of ridge, brs. NE. & SW., desc.
 26.00 Draw, 2 chs. wide, course NE., asc.
 39.00 Top of ridge, brs. NW. & SE., desc.
 40.00 Set an iron post 3 ft. long, 1 in. in diam. 26 ins. in
 the ground for $\frac{1}{4}$ sec. cor., marked on brass cap,
 $\frac{1}{4}$ S 33 in N., and
 S 4 in S. half; from which,
 A cedar tree 18 ins. diam. brs. N. 31° W. 139 lks. dist.,
 marked $\frac{1}{4}$ S 33 B T.
 A cedar tree 20 ins. diam. brs. S. 45° E. 110 lks. dist.,
 marked $\frac{1}{4}$ S 4 B T.
 56.00 Draw 2 chs. wide, course NW., asc.
 80.00 Set an iron post 3 ft. long, 3 ins. in diam. 24 ins. in
 the ground for cor. of secs. 3, 4, 33 & 34, marked on
 brass cap, T 24 N in N.,
 T 23 N in S., and
 R 10 W in W. half,
 S 33 in NW.,
 S 34 in NE.,
 S 3 in SE., and
 S 4 in SW. quad.; from which,
 A cedar tree 5 ins. diam. brs. N. 42 $\frac{1}{2}$ ° E. 162 lks. dist.,
 marked T 24 N R 10 W S 34 B T.
 A pinon tree 8 ins. diam. brs. S. 7° E. 29 lks. dist.,
 marked T 23 N R 10 W S 3 B T.
 A cedar tree 5 ins. diam. brs. S. 33 $\frac{1}{2}$ ° W. 35 lks. dist.,
 marked T 23 N R 10 W S 4 B T.
 A cedar tree 12 ins. diam. brs. N. 71° W. 170 lks. dist.,
 marked T 24 N R 10 W S 33 B T.
 Land, mts., broken. Soil, 3rd rate, gravelly, loose, dry.
 Cedar, pinon, good grass. March 18, 1912.

March 19, 1912.
 At 8h a.m., l.m.t., at the above corner, I set off 0°30' S. on the decl. arc, and 35°25' N. on the
 lat. arc, and determine a meridian with the solar.
 Thence I run,
 N. 89°58' E., bet. secs. 3 & 34.
 Over heavily rolling land, through dense cedar & pinon.
 8.00 Draw, 3 chs. wide, course NE., asc.
 16.00 Low spur, brs. NNE. & SSW. desc.
 24.00 Wash, 30 lks. wide, course NNE., asc. W. slope.
 40.00 Set an iron post 3 ft. long, 1 in. in diam. 26 ins. in
 the ground for $\frac{1}{4}$ sec. cor., marked on brass cap,
 $\frac{1}{4}$ S 34 in N., and
 S 3 in S. half; from which,
 A pinon tree 6 ins. diam. brs. N. 49° W. 15 lks. dist.,
 marked $\frac{1}{4}$ S 34 B T.
 A cedar tree 14 ins. diam. brs. S. 62° W. 10 lks. dist.,
 marked $\frac{1}{4}$ S 3 B T.
 Cor. on N. end of hill, near top, brs. NW. & SE.
 54.00 Top of ridge is 6 chs. to S., from hill, desc.
 80.00 Set an iron post 3 ft. long, 3 ins. in diam. 24 ins. in
 the ground for cor. of secs. 2, 3, 34 & 35, marked on
 brass cap, T 24 N in N.,
 T 23 N in S., and
 R 10 W in W. half,
 S 34 in NW., S 35 in NE., S 2 in SE., and S 3 in SW. quad.,
 from which,
 A cedar tree 8 ins. diam. brs. N. 77° E. 44 lks. dist.,
 marked T 24 N R 10 W S 35 B T.
 A cedar tree 10 ins. diam. brs. S. 34° E. 36 lks. dist.,
 marked T 23 N R 10 W S 2 B T.
 A cedar tree 10 ins. diam. brs. S. 59° W. 5 lks. dist.,
 marked T 23 N R 10 W S 3 B T.
 A cedar tree 12 ins. diam. brs. N. 18° W. 18 lks. dist.,
 marked T 24 N R 10 W S 34 B T.
 Land, heavily rolling, Soil, 3rd rate, gravelly, stony.
 Cedar, pinon, fair grass in draws.

Chains. N. 89°58' E., bet. secs. 2 & 35.
 Over mts. land, desc. through dense cedar and pinon.
 7.12 Road, brs. NE. & SW.
 7.61 Centre of draw, 4 chs. wide, course NE.
 15.50 Draw 4 chs. wide, course NW., reservoir in same about
 20 chs. to NNW., asc. grad.
 40.00 Set an iron post 3 ft. long, 1 in. in diam. 26 ins. in
 the ground for $\frac{1}{4}$ sec. cor., marked on brass cap,
 $\frac{1}{4}$ S 35 in N., and
 S 2 in S. half; from which,
 A cedar tree 6 ins. diam. brs. N. 19° W. 99 lks. dist.,
 marked $\frac{1}{4}$ S 35 B T.
 A cedar tree 10 ins. diam. brs. S. 8° W. 128 lks. dist.,
 marked $\frac{1}{4}$ S 2 B T.
 45.00 Small reservoir about 20 chs. to N., both of above noted
 tank enclosed in wire fence, located by John Munds.
 68.00 Ridge, brs. NNW. & SE., desc. grad.
 80.00 Set an iron post 3 ft. long, 3 ins. in diam. 24 ins. in
 the ground for cor. of secs. 1, 2, 35 & 36, marked on
 brass cap, T 24 N in N. half,
 T 23 N in S. half, and
 R 10 W in W. half;
 S 35 in NW., S 36 in NE., S 1 in SE., and S 2 in SW. quad.,
 from which,
 A cedar tree 8 ins. diam. brs. N. 80° E. 214 lks. dist.,
 marked T. 24 N R 10 W S 36 B T.
 A cedar tree 12 ins. diam. brs. S. 40° E. 145 lks. dist.,
 marked T. 23 N R 10 W S 1 B T.
 A cedar tree 12 ins. diam. brs. S. 20° W. 213 lks. dist.,
 marked T. 23 N R 10 W S 2 B T.
 A cedar tree 4 ins. diam. brs. N. 12° W. 206 lks. dist.,
 marked T 24 N R 10 W S 35 B T.
 Land, heavily rolling. Soil, 3rd rate, gravelly, stony.
 Cedar, pinon, scrub oak, good grass.
 At this cor., at noon, clouds obscure the sun.
 Impracticable to observe the latitude.

N. 89°58' E., bet. secs. 1 & 36.
 Over heavily rolling land, through dense cedar & pinon.
 12.00 Open draw, 10 chs. wide, course N.
 40.00 Set an iron post 3 ft. long, 1 in. in diam. 26 ins. in
 the ground for $\frac{1}{4}$ sec. cor., marked on brass cap,
 $\frac{1}{4}$ S 36 in N., and
 S 1 in S. half; from which,
 A pinon tree 12 ins. diam. brs. N. 16° E. 64 lks. dist.,
 marked $\frac{1}{4}$ S 36 B T.
 A pinon tree 10 ins. diam. brs. S. 17° W. 48 lks. dist.,
 marked $\frac{1}{4}$ S 1 B T.
 48.00 Open draw, 6 chs. wide, course NE., asc. grad.
 60.00 Top of low ridge, brs. ENE. & WSW., desc.
 70.00 Open draw 6 chs. wide, course ENE.
 80.00 To cor. of Tps. 23 & 24 N., Rs. 9 & 10 W., heretofore described.

General Description.

The S., W., and N. bdrs. of Tp. 23 N., R. 10 W. runs
 over land heavily rolling or mts., mostly well
 covered with cedar and pinon. To the S. and W. of the
 Tp. the land is rolling, good grazing land, and should
 be surveyed. There is no water on or near the lines.

Latitudes, departures and closing errors.

Line Designated.	True bearing.	Dist. Chs.	Latitudes.		Departures.	
			N.	S.	E.	W.
South Boundary	West,.....	478.98	-----	-----	-----	478.98
West Boundary	North,....	480.00	480.00	-----	-----	-----
North Boundary	N. 89°58' E.	478.55	--0.28	-----	478.55	-----
East Boundary	S. 01°02' E...	479.81	-----	479.81	--0.28	-----
Convergency,-----			-----	-----	--0.51	-----
		Totals,	480.28	479.81	479.34	478.98
			479.81	-----	478.98	-----
		Error lat.,	0.47	Error dep.	0.36	-----

March 19, 1912.

John A. Wright
 U. S. Surveyor.

West Boundary T. 24 N., R. 10 W.

Chains.

March 20, 1912.
 At 8h a.m., l.m.t., at the cor. of Tps. 23 & 24 N., Rs. 10 & 11 W., as herebefore established and described by me, I set off $0^{\circ}6\frac{1}{2}'$ S. on the decl. arc, and $35^{\circ}25'$ N. on the lat. arc, and determine a meridian with the solar. Thence I run, as per instructions.
 North, bet. secs. 31 & 36, on W. bdy. of Tp.,
 Var. 16° E.
 Over heavily rolling land, through dense cedar & pinon.
 23.50 Wash, 20 lks. wide, course E.
 34.80 Gulch, 30 lks. wide, course ESE.
 40.00 Set an iron post 3 ft. long, 1 in. in diam. 26 ins. in the ground for $\frac{1}{4}$ sec. cor., marked on brass cap,
 $\frac{1}{4}$ S 36 in W., and
 S 31 in E. half; from which,
 A pinon tree 10 ins. diam. brs. N. 40° E. 24 lks. dist., marked $\frac{1}{4}$ S 31 B T.
 A cedar tree 14 ins. diam. brs. S. 79° W. 22 lks. dist., marked $\frac{1}{4}$ S 36 B T.
 60.00 Spur, brs. ENE. & WSW., desc. along low spur from ridge to W. to the cor.
 80.00 Set an iron post 3 ft. long, 3 ins. in diam. 24 ins. in the ground for cor. of secs. 25, 30, 31 & 36, marked on brass cap, T 24 N in N. half,
 R 11 W S 25 in NW.,
 R 10 W S 30 in NE.,
 S 31 in SE., and
 S 36 in SW. quad.; from which,
 A cedar tree 10 ins. diam. brs. N. 80° E. 42 lks. dist., marked T 24 N R 10 W S 30 B T.
 A cedar tree 10 ins. diam. brs. S. 30° E. 24 lks. dist., marked T 24 N R 10 W S 31 B T.
 A pinon tree 14 ins. diam. brs. S. $39\frac{1}{4}^{\circ}$ W. 155 lks. dist., marked T 24 N R 11 W S 36 B T.
 A cedar tree 10 ins. diam. brs. N. 63° W. 11 lks. dist., marked T 24 N R 11 W S 25 B T.
 Land, heavily rolling, broken. Soil, 3rd rate, gravelly. Cedar, pinon, scrub oak, few cacti, good grass.

North, bet. secs. 25 & 30.
 Over heavily rolling land, desc. through cedar & pinon.
 6.25 Ravine 50 lks. wide, course E. asc.
 11.00 Top of low spur, brs. E. & W., desc.
 20.00 Wash, 10 lks. wide, course E., asc.
 26.00 Spur, brs. E. & W., desc.
 29.00 Draw, 1 ch. wide, course E., asc.
 38.00 Spur, brs. E. & W., desc.
 40.00 Set an iron post 3 ft. long, 1 in. in diam. 26 ins. in the ground for $\frac{1}{4}$ sec. cor., marked on brass cap,
 $\frac{1}{4}$ S 25 in W., and
 S 30 in E. half; from which,
 A cedar tree 6 ins. diam. brs. S. 2° E. 18 lks. dist., marked $\frac{1}{4}$ S 30 B T.
 A cedar tree 30 ins. diam. brs. S. 59° W. 46 lks. dist., marked $\frac{1}{4}$ S 25 B T.
 41.50 Ravine, 50 lks. wide, course E.
 45.00 Spur, brs. E. & W., thence desc. NE. slope.
 63.00 Wash, 30 lks. wide, course NNW., leave cedar, brs. NW. & SE, enter grassy valley.
 80.00 Set an iron post 3 ft. long, 3 ins. in diam. 24 ins. in the ground for cor. of secs. 19, 24, 25 & 30, marked on brass cap, T 24 N in N. half,
 R 11 W S 24 in NW.,
 R 10 W S 19 in NE.,
 S 30 in SE., and
 S 25 in SW. quad.; No trees available.
 dig pits 18x18x12 ins. in each sec. $5\frac{1}{2}$ ft. dist., and raise a mound of earth $\frac{1}{4}$ ft. base, 2 ft. high W. of cor.
 Land, heavily rolling, broken.
 Soil, 3rd rate, gravelly, loose, dry.
 Cedar, pinon, scrub oak, cacti, good grass.

Chains.

North, bet. secs. 19 & 24.
 Over rolling land.

5.00 Leave valley, brs. NW. & SE., asc.
 12.00 Top of flat mesa, brs. NW. & SE.
 20.00 Enter dense cedar, brs. E. & W.
 30.00 Cedar becomes scattering.
 40.00 Set an iron post 3 ft. long, 1 in. in diam. 26 ins. in the ground for $\frac{1}{4}$ sec. cor., marked on brass cap, $\frac{1}{4}$ S 24 in W., and S 19 in E. half; from which,
 A cedar tree 12 ins.diam.brs. S. 1°E. 215 lks. dist., marked $\frac{1}{4}$ S 19 B T.
 A cedar tree 15 ins.diam.brs. N.20°W. 134 lks. dist., marked $\frac{1}{4}$ S 24 B T.

Asc. from cor.
 57.00 Spur, brs. NE. & SW., desc. on same, along W. side of edge.
 80.00 Set an iron post 3 ft. long, 3 ins. in diam. 14 ins. in the ground, on bed-rock, in mound of stone for cor. of secs. 13,18,19 & 24, marked on brass cap, T 24 N in N. half, R 11 W S 13 in NW., R 10 W S 18 in NE., S 19 in SE., and S 24 in SW. quad.; from which,
 A cedar tree 12 ins.diam.brs. N.19 $\frac{3}{4}$ °E. 192 lks. dist., marked T 24 N R 10 W S 18 B T.
 A cedar tree 8 ins.diam.brs. S.1 $\frac{1}{4}$ °E. 126 lks. dist., marked T 24 N R 10 W S 19 B T.
 A cedar tree 10 ins.diam.brs. S.31 $\frac{3}{4}$ °W. 219 lks. dist., marked T 24 N R 11 W S 24 B T.
 A cedar tree 12 ins.diam.brs. N.38 $\frac{3}{4}$ °W. 89 lks. dist., marked T 24 N R 11 W S 13 B T.

Land, mts., broken, rolling. Soil, 3rd rate, gravelly. Cedar, pinon, scrub oak, cacti, good grass.
 At this cor., at noon, I set off 0°03' S. on the decl. arc, and observe the sun on the meridian.
 The resulting lat. is 35°28' N.

North, bet. secs. 13 & 18.
 Over heavily rolling land, through scattering cedar.

11.00 Draw, 2 chs. wide, course ENE. asc.
 28.00 Spur, brs. NNE., from SW., desc. along W. side of same.
 40.00 Set an iron post 3 ft. long, 1 in. in diam. 26 ins. in the ground for $\frac{1}{4}$ sec. cor., marked on brass cap, $\frac{1}{4}$ S 13 in W., and S 13 in E. half; from which,
 A cedar tree 12 ins.diam.brs. N.12°E. 166 lks. dist., marked $\frac{1}{4}$ S 13 B T.
 A cedar tree 10 ins.diam.brs. S.65°W. 80 lks. dist., marked $\frac{1}{4}$ S 13 B T.

80.00 Centre of draw 10 chs. wide, course NNE.
 Set an iron post 3 ft. long, 3 ins. in diam. 24 ins. in the ground for cor. of secs. 7,12,13 & 18, marked on brass cap, T 24 N in N. half, R 11 W S 12 in NW., R 10 W S 7 in NE., S 18 in SE., and S 13 in SW. quad.; No trees available.
 Dig pits 18x18x12 ins. in each sec. 5 $\frac{1}{2}$ ft. dist., and raise a mound of earth 4 ft. base, 2 ft. high W. of cor.

Land, rolling, broken.
 Soil, 3rd rate, gravelly, stony, loose, dry.
 Cedar, few pinons, scrub oak, cacti, good grass.

West Boundary T. 24 N., R. 10 W.

Chains.

North, bet. secs. 7 & 12.
 Over heavily rolling land.

15.00 Draw, 20 chs. wide, course ENE.
 17.90 Old road, brs. NE. & SW.
 25.00 Enter scattering cedar, brs. NE. & SW. asc.
 40.00 Set an iron post 3 ft. long, 1 in. in diam. 26 ins. in the ground for $\frac{1}{4}$ sec. cor., marked on brass cap,
 $\frac{1}{4}$ S 12 in W., and
 S 7 in E. half; from which,
 A cedar tree 16 ins. diam. brs. N. 50° E. 69 lks. dist., marked $\frac{1}{4}$ S 7 B T.
 A cedar tree 4 ins. diam. brs. S. 72° W. 32 lks. dist., marked $\frac{1}{4}$ S 12 B T.

48.00 Ridge, brs. NE. & SW., desc.
 62.75 Gulch, 50 lks. wide, course ENE., asc.
 80.00 Set an iron post 3 ft. long, 3 ins. in diam. 24 ins. in the ground for cor. of secs. 1, 6, 7 & 12, marked on brass cap, T 24 N in N. half,
 R 11 W S 1 in NW.,
 R 10 W S 6 in NE.,
 S 7 in SE., and
 S 12 in SW. quad.; from which,
 A cedar tree 20 ins. diam. brs. N. 75° E. 48 lks. dist., marked T 24 N R 10 W S 6 B T.
 A pinon tree 10 ins. diam. brs. S. 20° E. 119 lks. dist., marked T 24 N R 10 W S 7 B T.
 A cedar tree 30 ins. diam. brs. S. 39 $\frac{1}{2}$ ° W. 46 lks. dist., marked T 24 N R 11 W S 12 B T.
 A cedar tree 8 ins. diam. brs. N. 32° W. 303 lks. dist., marked T 24 N R 11 W S 1 B T.

Land, heavily rolling, mts. Soil, 3rd rate, stony, dry.
 Cedar, few pinons, scrub oak, cacti, good grass.

North, bet. secs. 1 & 6.
 Over mts. land, asc. through cedar and pinon.

13.00 Top of high spur, brs. NE. & SW., desc.
 22.00 Wash, 10 lks. wide, course NE., asc.
 28.00 Spur, brs. E. & W., desc.
 34.00 Gulch, 50 lks. wide, course E., asc.
 36.77 Intersect South line of Hualpai Indian Reservation, whence 58 $\frac{1}{2}$ mile cor. on said line, brs. East, 122 lks. dist., which is a limestone in place, showing 24x17x10 ins. above ground, marked and witnessed as described by the Surveyor-General.

Set an iron post 3 ft. long, 3 ins. in diam. 24 ins. in the ground for closing cor. of Tps. 24 N., Rs. 10 & 11 W., marked on brass cap,
 C C, S. of centre,
 H I R in N., and
 T 24 N in S. half,
 S 6, R 10 W, in SE. and
 S 1, R 11 W, in SW. quadrants; from which,
 A pinon tree 8 ins. diam. brs. S. 19 $\frac{3}{4}$ ° E. 76 lks. dist., marked T 24 N R 10 W S 6 C C B T.
 A cedar tree 6 ins. diam. brs. S. 51° W. 64 lks. dist., marked T 24 N R 11 W S 1 C C B T.

Land, mts., broken.
 Soil, 3rd rate, gravelly, stony.
 Cedar, pinon, scrub oak, cacti, good grass.

General Description.

The West boundary of T. 24 N., R. 10 W. runs over a broken, or heavily rolling country, sparsely covered with cedar and pinon, with good native grass, in the open draws. There is no water along or near the line. To the west the land lies broken, dropping off at about 4 miles into a valley. The Tp. to the west is nearly all good grazing land, and should be surveyed.

Latitudes, Departures, and closing errors.

Line Designated.	True bearing.	Dist. Chs.	Latitudes.		Departures.	
			N.	S.	E.	W.
South Boundary	S. 89° 58' W.	478.55	-----	0.28	-----	478.55
West Boundary	North, ...	436.77	436.77	-----	-----	-----
S. Line Hualpai Indian Reserv'n	East,	121.22	-----	-----	121.22	-----
"	N. 50° E.	56.18	36.11	-----	43.04	-----
6th Std. Par'l N. East Boundary,	East,	313.58	-----	-----	313.58	-----
Convergency, ---	South,	473.68	-----	473.68	-----	-----
					-----	-----
		Totals, 472.88	472.88	473.96	478.35	478.55
				472.88		478.35
		Error in lat.,		1.08	Error dep.	0.20

March 20, 1912.

Jose Burdick
 U. S. Surveyor.

Chains.

April 21, 1912.
 At 9h a.m., 1.m.t., at the cor. of Tps. 23 & 24 N., Rs. 5 & 6 W., Lat. 35°25'15"N., long. 112°52'19" W., which is a malpais stone 10x8x6 ins. above ground, marked and witnessed as described by the Surveyor-General,
 I set off 11°54½' N. on the decl. arc, and 35°25' N. on the lat. arc, and determine a meridian with the solar. (For instrument test and Polaris observation, see field notes of subdivision of T. 24 N., R. 6 W.)
 Thence I run, as per instructions,
 North, on East bdy. of Tp., bet. secs. 31 & 36.
 Var. 15°40' E.
 Over rolling, broken land, desc., through scattering cedar.
 8.00 Wash, 10 lks. wide, course E., enter valley.
 33.00 Leave valley, asc. steep, stony SSE. slope.
 40.00 Set an iron post 3 ft. long, 1 in. in diam. 26 ins. in the ground for ¼ sec. cor., marked on brass cap, ¼ S 36 in W., and S 31 in E. half; from which, A cedar tree 7 ins. diam. brs. N. 73° W. 90 lks. dist., marked ¼ S 36 B T. No other tree available.
 Raise a mound of stone 2 ft. base, 1½ ft. high W. of cor.
 60.00 Top of ridge, brs. SSW. & N., thence along top of same.
 78.00 Desc., ridge brs. NE. & S.
 80.00 Set an iron post 3 ft. long, 3 ins. in diam. 24 ins. in the ground for cor. of secs. 25, 30, 31 & 36, marked on brass cap, T 24 N in N. half, R 6 W S 25 in NW., R 5 W S 30 in NE., S 31 in SE., and S 36 in SW. quad.
 No trees available. Pits impracticable.
 Raise a mound of stone 2 ft. base, 1½ ft. high W. of cor.
 Land, mts. Soil, 3rd rate, gravelly, stony.
 Sparse cedar, cacti, fair grass.

North, bet. secs. 25 & 30.
 Over mts. land, desc.
 1.00 Gulch, 50 lks. wide, course NE. asc.
 4.00 Spur, brs. SSE. & NNW.
 6.00 Desc. NNE. slope.
 32.00 Draw 6 chs. wide, course SE., asc.
 40.00 Set an iron post 3 ft. long, 1 in. in diam. 26 ins. in the ground for ¼ sec. cor., marked on brass cap, ¼ S 25 in W., and S 30 in E. half; No trees available.
 Raise a mound of stone 2 ft. base, 1½ ft. high W. of cor.
 60.00 Spur, brs. SE. & NW., desc.
 73.50 Enter flat on W. side of Chino wash
 80.00 Set an iron post 3 ft. long, 3 ins. in diam. 24 ins. in the ground for cor. of secs. 19, 24, 25 & 30, marked on brass cap, T 24 N in N. half, R 6 W S 24 in NW., R 5 W S 19 in NE., S 30 in SE., and S 25 in SW. quad.;
 dig pits 18x18x12 ins. in each sec. 5½ ft. dist., and raise a mound of earth 4 ft. base, 2 ft. high W. of cor.
 Land, mts. Soil, 3rd rate, gravelly, stony, sandy, loose.
 Few cedars, cacti, good grass.
 At this cor., at noon, I set off 11°52' N. on the decl. arc, and observe the sun on the meridian.
 The resulting lat. is 35°27' N.

Chains.

North, bet. secs. 19 & 24.

Over rolling land.

- 2.50 Leave flat, asc. E.S. slope.
 10.00 Spur, brs. E. & W., desc.
 13.70 Chino wash, 150 lks. wide, course ESE.
 17.62 Road, brs. ESE. & WNW.
 19.00 Leave valley of wash, brs. SE. & NW., asc. SW. slope.
 39.50 Spur, brs. W. & E., desc.
 40.00 Set an iron post 3 ft. long, 1 in. in diam. 26 ins. in the ground for $\frac{1}{4}$ sec. cor., marked on brass cap, $\frac{1}{4}$ S 24 in W., and S 19 in E. half; from which,
 A cedar tree 6 ins. diam. brs. S. $82\frac{1}{2}^{\circ}$ W. 22 lks. dist., marked $\frac{1}{4}$ S 24 B T.
 A cedar tree 6 ins. diam. brs. S. $65\frac{1}{2}^{\circ}$ E. 48 lks. dist., marked $\frac{1}{4}$ S 19 B T.
 44.30 Drain 5 lks. wide, course W., asc.
 52.00 Spur, brs. W. & E., desc.
 64.00 Drain 5 lks. wide, course WNW., asc.
 79.00 Spur, brs. NW. & SE., desc.
 80.00 Set an iron post 3 ft. long, 3 ins. in diam. 24 ins. in the ground for cor. of secs. 13, 18, 19 & 24, marked on brass cap, T 24 N in N. half, R 6 W S 13 in NW., R 5 W S 18 in NE., S 19 in SE., and S 24 in SW. quad.; from which,
 A cedar tree 10 ins. diam. brs. N. $36\frac{1}{2}^{\circ}$ E. 41 lks. dist., marked T 24 N R 5 W S 18 B T.
 A cedar tree 6 ins. diam. brs. S. $71\frac{1}{2}^{\circ}$ E. 75 lks. dist., marked T 24 N R 5 W S 19 B T.
 A cedar tree 6 ins. diam. brs. S. $23\frac{1}{2}^{\circ}$ W. 92 lks. dist., marked T 24 N R 6 W S 24 B T.
 A cedar tree 8 ins. diam. brs. N. 69° W. 22 lks. dist., marked T 24 N R 6 W S 13 B T.

Land, rolling, mts., broken.

Soil, 3rd rate, gravelly, stony.

Cedar, cacti, good grass.

North bet. secs. 13. & 18.

Over mts. land, desc. limestone cliff 50 ft. high.

- 1.50 Wash, 50 lks. wide, course W.
 8.00 Branch of same wash, 50 lks. wide, course E.
 22.00 Road, in Chino Wash, course WSW., wash 50 lks. wide. Asc. SE. slope of peak.
 32.00 Top of slope, apex of peak brs. W. about 35 chs. desc. NE. slope.
 40.00 Set an iron post 3 ft. long, 1 in. in diam. 26 ins. in the ground for $\frac{1}{4}$ sec. cor., marked on brass cap, $\frac{1}{4}$ S 13 in W., and S 18 in E. half; No trees available. raise a mound of stone 2 ft. base, $1\frac{1}{2}$ ft. high W. of cor.
 44.00 A concrete tank brs. East, about 12 chs. dist.
 46.30 Wire fence, brs. NE. & SW., extends NE. 40 lks. to bluff 100 ft. high, brs. N. & S.
 74.50 Chino Wash, 100 lks. wide in canyon 10 chs. wide, course SE. Asc. grad.
 80.00 Set an iron post 3 ft. long, 3 ins. in diam. 24 ins. in the ground for cor. of secs. 7, 12, 13 & 18, marked on brass cap, T 24 N in N. half, R 6 W S 12 in NW., R 5 W S 7 in NE., S 18 in SE., and S 13 in SW. quad.; No trees available. Raise a mound of stone 2 ft. base, $1\frac{1}{2}$ ft. high W. of cor.
 Land, mts., broken.
 Soil, 3rd rate, gravelly, stony, loose, dry.
 Few cedars, cacti, good grass in places.

April 21, 1912.

Chains.

April 22, 1912.

At 8h a.m., l.m.t., at the above corner, I set off 12°14' N. on the decl. arc, and 35°29' N. on the lat. arc, and determine a meridian with the solar. Thence I run,

North, bet. secs. 7 & 12.

Over flat mesa, slopes gently to E.

40.00 Set an iron post 3 ft. long, 1 in. in diam. 26 ins. in the ground for ¼ sec. cor., marked on brass cap, ¼ S 12 in W., and S 7 in E. half; No trees available.

80.00 Raise a mound of stone 2 ft. base, 1½ ft. high W. of cor. Set an iron post 3 ft. long, 3 ins. in diam. 24 ins. in the ground for cor. of secs. 1, 6, 7 & 12, marked on brass cap, T 24 N in N. half, R 6 W S 1 in NW., R 5 W S 6 in NE., S 7 in SE., and S 12 in SW. quad.; No bearings available, raise a mound of stone 2 ft. base, 1½ ft. high W. of cor. Land, rolling. Soil, 3rd rate, gravelly, stony, dry, loose, clayey. Few cedars, cacti, good grass.

North, bet. secs. 1 & 6.

Over rolling mesa.

36.00 Desc. grad. to draw, course WSW.

40.00 Set an iron post 3 ft. long, 1 in. in diam. 26 ins. in the ground for ¼ sec. cor., marked on brass cap, ¼ S 1 in W., and S 6 in E. half; No bearings available, raise a mound of stone 2 ft. base, 1½ ft. high W. of cor.

Cor. in middle of draw, course W., fine grass.

44.00 Leave draw, asc. grad.

88.08 Intersect 6th Standard Parallel North at a point whence Std. cor. of Tps. 25 N., Rs. 5 & 6 W., brs. East, 20.27 chs. dist., which is an iron post 3 ins. in diam. 1 ft. above ground, with brass cap, marked and witnessed as described by the Surveyor-General. Set an iron post 3 ft. long, 3 ins. in diam. 24 ins. in the ground for closing cor. of Tps. 24 N., Rs. 5 & 6 W., marked on brass cap,

C C, S. of centre;
T 25 N, R 6 W S 36, R 5 W S 31 in N., and
T 24 N, in S. half,
S 6 R 5 W, in SE., and
S 1 R 6 W, in SW. quad.;

No bearings available, pits impracticable.

Raise a mound of stone 2 ft. base, 1½ ft. high S. of cor.

Land, rolling.

Soil, 3rd rate, gravelly, stony, dry, clayey, heavy.

Few cedars, cacti, good grass.

At this cor., at noon, I set off 12°17' N. on the decl. arc, and observe the sun on the meridian.

The resulting lat. is 35°30½' N.

General Description.
 The East boundary of T. 24 N., R. 6 W. runs over a broken, hilly or mts. country for four miles, trending into a high rolling mesa to the north. The soil is in general gravelly, covered in places with showered volcanic tufa, with underlying limestone. There is no timber or water on or near the line. To the East, the land is more broken and hilly, but well covered with native grass, being good grazing land for five or six miles to the East. T. 24 N., R. 5 W. should be surveyed.

T. 24 N. R. 6 W.

Latitudes, departures, and closing errors.

Line designated.	True bearing.	Dist.	Latitudes.		Departures.	
			N.	S.	E.	W.
South Boundary	S. 89° 58' W.	Chs. 391.80	Chs. -----	Chs. --0.23	Chs. -----	Chs. 391.80
West Boundary,	North, ----	487.50	487.50	-----	-----	-----
6th Std. Par. N.	East, ----	391.30	-----	-----	391.30	-----
East Boundary,	South, ----	488.08	-----	488.08	-----	-----
Convergency,	-----	-----	-----	-----	--0.42	-----
Totals, -----			487.50	488.31	391.72	391.80
				<u>487.50</u>		<u>391.72</u>
Error in lat. -----				0.81	-----	
Error in dep. -----						0.08

April 22, 1912.

Jose B. Wright

 U. S. Surveyor.

Chains.

April 30, 1912.
 At 8h a.m., l.m.t., at the Standard cor. of Tps. 25 N.,
 Rs. 5 & 6 W., which is an iron post 3 ins. in diam. 1 ft.
 above ground, with brass cap, marked and witnessed
 as described by the Surveyor-General,
 I set off $14^{\circ}48'$ N. on the decl. arc, and $35^{\circ}30\frac{1}{2}'$ N. on
 the lat. arc, and determine a meridian with the solar.
 Thence I run, as per instructions,
 North, on range line, bet. secs. 31 & 36.
 Var. $15^{\circ}30'$ E.
 Over rolling mesa, gravelly, loose soil, few cedars.

25.65 Road, brs. WNW. & ESE.
 40.00 Set an iron post 3 ft. long, 1 in. in diam. 26 ins. in
 the ground for $\frac{1}{4}$ sec. cor., marked on brass cap,
 $\frac{1}{4}$ S 36 in W., and
 S 31 in E. half; no bearings available.
 Raise a mound of stone 2 ft. base, $1\frac{1}{2}$ ft. high W. of cor.

56.50 Road, brs. WSW. & ENE. to ranch of Morrow and Adamson.
 60.50 Wash, 30 lks. wide, course SW.
 80.00 Set an iron post 3 ft. long, 3 ins. in diam. 24 ins. in
 the ground for cor. of secs. 25, 30, 31 & 36, marked on
 brass cap, T 25 N, in N. half,
 R 6 W S 25 in NW.,
 R 5 W S 30 in NE.,
 S 31 in SE., and
 S 36 in SW. quad.; no trees available,
 dig pits $18 \times 18 \times 12$ ins. in each sec. $5\frac{1}{2}$ ft. dist., and
 raise a mound of earth 4 ft. base, 2 ft. high W. of cor.
 Land, rolling.
 Soil, 3rd rate, gravelly, loose, dry, some clay in places.
 Few cedars, cacti, good grass.

North, bet. secs. 25 & 30.
 Over rolling mesa.

17.65 Road, brs. NW. & SSE.
 40.00 Set an iron post 3 ft. long, 1 in. in diam. 26 ins. in
 the ground for $\frac{1}{4}$ sec. cor., marked on brass cap,
 $\frac{1}{4}$ S 25 in W., and
 S 30 in E. half; no trees available.
 raise a mound of stone 2 ft. base, $1\frac{1}{2}$ ft. high W. of cor.

77.00 Wash, 15 lks. wide, course SW.,
 80.00 Set an iron post 3 ft. long, 3 ins. in diam. 24 ins. in
 the ground for cor. of secs. 19, 24, 25 & 30, marked on
 brass cap, T 25 N, in N. half,
 R 6 W S 24 in NW.,
 R 5 W S 19 in NE.,
 S 30 in SE., and
 S 25 in SW. quad.; no trees available.
 dig pits $18 \times 18 \times 12$ ins. in each sec. $5\frac{1}{2}$ ft. dist., and
 raise a mound of earth 4 ft. base, 2 ft. high W. of cor.
 Land, rolling.
 Soil, 3rd rate, gravelly.
 Few cedars, cacti, good grass.

North, bet. secs. 19 & 24.
 Over rolling land., asc. grad. through scattering cedar.

20.00 Top of rise, brs. SW. & NE., desc. grad.
 40.00 Set an iron post 3 ft. long, 1 in. in diam. 26 ins. in
 the ground for $\frac{1}{4}$ sec. cor., marked on brass cap,
 $\frac{1}{4}$ S 24 in W., and
 S 19 in E. half; no trees available,
 raise a mound of stone 2 ft. base, $1\frac{1}{2}$ ft. high W. of cor.

80.00 Set an iron post 3 ft. long, 3 ins. in diam. 24 ins. in
 the ground for cor. of secs. 13, 18, 19 & 24, marked on
 brass cap, T 25 N, in N. half,
 R 6 W S 13 in NW.,
 R 5 W S 18 in NE.,
 S 19 in SE., and
 S 24 in SW. quad.; from which,

Chains.

A cedar tree 8 ins. diam. brs. N.86°E. 152 lks. dist.,
 marked T 25 N R 5 W S 18 B T.
 A cedar tree 12 ins. diam. brs. S.76°E. 136 lks. dist.,
 marked T 25 N R 5 W S 19 B T.
 A cedar tree 20 ins. diam. brs. S. 3° W. 172 lks. dist.,
 marked T 25 N R 6 W S 24 B T.
 A cedar tree 24 ins. diam. brs. N.10° W. 149 lks. dist.,
 marked T 25 N R 6 W S 13 B T.
 Land, rolling. Soil, 3rd rate, gravelly.
 Sparse cedar, cacti, good grass.

North, bet. secs. 13 & 18.

Over rolling land, asc. grad., through scattering cedar.
 40.00 Set an iron post 3 ft. long, 1 in. in diam. 26 ins. in
 the ground for $\frac{1}{4}$ sec. cor., marked on brass cap,
 $\frac{1}{4}$ S 13 in W., and
 S 13 in E. half; from which,
 A cedar tree 8 ins. diam. brs. S.7° E., 73 lks. dist.,
 marked $\frac{1}{4}$ S 18 B T.
 A cedar tree 30 ins. diam. brs. S.13° W. 101 lks. dist.,
 marked $\frac{1}{4}$ S 13 B T.
 At this cor., at noon, I set off 14'51" N. on the decl.
 arc, and observe the sun on the meridian.

The resulting lat. is 35°33 $\frac{1}{2}$ ' N.

56.00 Enter dense cedar, brs. E. & W.
 80.00 Set an iron post 3 ft. long, 3 ins. in diam. 24 ins. in
 the ground for cor. of secs. 7, 12, 13 & 18, marked on
 brass cap, T 25 N, in N. half,
 R 6 W S 12 in NW.,
 R 5 W S 7 in NE.,
 S 18 in SE., and
 S 13 in SW. quad.; from which,
 A cedar tree 20 ins. diam. brs. N.46°E. 82 lks. dist.,
 marked T 25 N R 5 W S 7 B T.
 A cedar tree 10 ins. diam. brs. S.50 $\frac{1}{2}$ °E. 98 lks. dist.,
 marked T 25 N R 5 W S 18 B T.
 A cedar tree 15 ins. diam. brs. S.38°W. 156 lks. dist.,
 marked T 25 N R 6 W S 13 B T.
 A cedar tree 12 ins. diam. brs. N.4°W. 185 lks. dist.,
 marked T 25 N R 6 W S 12 B T.
 Land, rolling. Soil, 3rd rate, gravelly, stony.
 Cedar, some pinon, good grass.

North, bet. secs. 7 & 12.

Over heavily rolling, land, through dense cedar.
 30.00 Cedar becomes scattering, brs. E. & W.
 40.00 Set an iron post 3 ft. long, 1 in. in diam. 26 ins. in
 the ground for $\frac{1}{4}$ sec. cor., marked on brass cap,
 $\frac{1}{4}$ S 12 in W., and
 S 7 in E. half; from which,
 A cedar tree 15 ins. diam. brs. N.57°E. 235 lks. dist.,
 marked $\frac{1}{4}$ S 7 B T.
 A cedar tree 18 ins. diam. brs. S.23°W. 83 lks. dist.,
 marked $\frac{1}{4}$ S 12 B T.
 56.00 Enter dense cedar, brs. E. & W.
 74.15 Wash, 10 lks. wide, course W.
 80.00 Set an iron post 3 ft. long, 3 ins. in diam. 24 ins. in
 the ground for cor. of secs. 1, 6, 7 & 12, marked on
 brass cap, T 25 N, in N. half,
 R 6 W S 1 in NW.,
 R 5 W S 6 in NE.,
 S 7 in SE., and
 S 12 in SW. quad.; from which,

Chains.

- A cedar tree 12 ins.diam.brs. N.70°E. 26 lks. dist.,
marked T 25 N R 5 W S 6 B T.
A cedar tree 10 ins.diam.brs. S.15°E. 133 lks. dist.,
marked T 25 N R 5 W S 7 B T.
A cedar tree 10 ins.diam.brs. S.21°W. 149 lks. dist.,
marked T 25 N R 6 W S 12 B T.
A cedar tree 12 ins.diam.brs. N.12°W. 32 lks. dist.,
marked T 25 N R 6 W S 1 B T.

Land, rolling.

Soil, 3rd rate, gravelly, stony, dry.

Cedar, pinons, good grass in places.

North, bet. secs. 1 & 6.

Over rolling land, asc. grad. through dense cedar,
drainage to W.

10.00 Land becomes stony, covered with volcanic tufa.

40.00 Set an iron post 3 ft. long, 1 in. in diam. 26 ins. in
the ground for $\frac{1}{4}$ sec. cor., marked on brass cap,
 $\frac{1}{4}$ S 1 in W., and

S 6 in E. half; from which,

A cedar tree 15 ins.diam.brs. S.16°E. 87 lks. dist.,
marked $\frac{1}{4}$ S 6 B T.A cedar tree 10 ins.diam.brs. S.7°W. 168 lks. dist.,
marked $\frac{1}{4}$ S 1 B T.Cedar becomes scattering, brs. E. & W.
desc. grad. from cor.

56.00 Grassy draw, 8 chs. wide, course W., asc. grad.

62.00 Enter dense cedar, brs. E. & W., desc. grad.

72.00 Leave cedar, brs. E. & W., enter open land.

80.00 Set an iron post 3 ft. long, 3 ins. in diam. 24 ins. in
the ground for cor. of Tps. 25 & 26 N., Rs. 5 & 6 W.,
marked on brass cap,

T.26 N, in N.,

R 5 W, in E.,

T 25 N, in S., and

R 6 W, in W. half,

S 36 in NW.,

S 31 in NE.,

S 6 in SE., and

S 1 in SW. quad.; from which,

A cedar tree 6 ins.diam.brs. S.0 $\frac{3}{4}$ °E. 490 lks. dist.,
marked T 25 N R 5 W S 6 B T.A cedar tree 10 ins.diam.brs. S.0 $\frac{3}{4}$ °W. 489 lks. dist.,
marked T 25 N R 6 W S 1 B T.

No other trees available, pits impracticable.

Raise a mound of stone 2 ft. base, 1 $\frac{1}{2}$ ft. high S. of cor.

Land, rolling, drainage to W.

Soil, 3rd rate, gravelly, stony, dry.

Cedar, some pinon, few cacti, good grass in open places.

April 30, 1912..

- Chains May 1, 1912.
- At 8h a.m., l.m.t., at the Standard cor. of Tps. 25 N., Rs. 6 & 7 W., which is an iron post 3 ins. in diam., 1 ft. above ground, with brass cap, marked and witnessed as described by the Surveyor-General,
- I set off $15^{\circ}06\frac{1}{2}'$ N. on the decl. arc, and $35^{\circ}30\frac{1}{2}'$ N. on the lat. arc, and determine a meridian with the solar. Thence I run, as per instructions,
- North, on range line, bet. secs. 31 & 36.
Var. $15^{\circ}30'$ E.
- Over heavily rolling land, desc. grad., through cedar, pinon, and juniper.
- 15.00 Draw, 5 chs. wide, course NE., asc. grad.
- 40.00 Set an iron post 3 ft. long, 1 in. in diam. 26 ins. in the ground for $\frac{1}{4}$ sec. cor., marked on brass cap,
 $\frac{1}{4}$ S 36 in W., and
S 31 in E. half; from which,
A cedar tree 5 ins. diam. brs. N. 15° E. 109 lks. dist., marked $\frac{1}{4}$ S 31 B T.
A juniper tree 24 ins. diam. brs. S. 15° W. 205 lks. dist., marked $\frac{1}{4}$ S 36 B T.
- 58.00 Top of ridge, brs. ENE. & WSW., desc. steep, over mts. land.
- 67.00 Deep gulch, , 150 lks. wide, canyons to NE., thence along E. slope of sharp spurs.
- 75.00 Asc. steep SSE., slope.
- 80.00 Set an iron post 3 ft. long, 3 ins. in diam. 24 ins. in the ground for cor. of secs. 25, 30, 31 & 36, marked on brass cap, T 25 N, in N. half,
R 7 W S 25 in NW.,
R 6 W S 30 in NE.,
S 31 in SE., and
S 36 in SW. quad.; from which,
A pinon tree 5 ins. diam. brs. N. 22° E. 49 lks. dist., marked T 25 N R 6 W S 30 B T.
A pinon tree 6 ins. diam. brs. S. 50° E. 24 lks. dist., marked T 25 N R 6 W S 31 B T.
A cedar tree 10 ins. diam. brs. S. 23° W. 60 lks. dist., marked T 25 N R 7 W S 36 B T.
A cedar tree 7 ins. diam. brs. N. 81° W. 126 lks. dist., marked T 25 N R 7 W S 25 B T.
- Land, rolling, mts.
Soil, 3rd rate, gravelly, stony.
Cedar, pinon, some junipers, good grass.
-
- North, bet. secs. 25 & 30.
Asc. from cor., through cedar, and pinon.
- 7.00 Ridge, brs. NE. & SW., desc.
- 24.00 Canyon, 50 lks. wide, course NNE. asc.
- 30.00 Spur, brs. ENE., near point, desc.
- 34.00 Gulch, 30 lks. wide, course E., asc.
- 40.00 Set an iron post 3 ft. long, 1 in. in diam. 26 ins. in the ground for $\frac{1}{4}$ sec. cor., marked on brass cap,
 $\frac{1}{4}$ S 25 in W., and
S 30 in E. half; from which,
A pinon tree 10 ins. diam. brs. N. 27° E. 9 lks. dist., marked $\frac{1}{4}$ S 30 B T.
A pinon tree 8 ins. diam. brs. N. 16° W. 29 lks. dist., marked $\frac{1}{4}$ S 25 B T.
- At this cor., at noon, I set off $15^{\circ}09'$ N. on the decl. arc, and observe the sun on the meridian.
The resulting lat. is $35^{\circ}32'$ N.
- 41.00 Spur, brs. E. & W.,
- 50.50 Long ridge, brs. N. 64° E. & S. 64° W., desc.
- 55.00 Ravine, 150 ft. deep, near head, course ENE., asc.
- 64.00 Spur, brs. NNE., desc. prec.
- 73.50 Wash, 10 lks. wide, course NE., asc. grad.

Chains.

80.00 Set an iron post 3 ft. long, 3 ins. in diam. 24 ins. in the ground for cor. of secs. 19, 24, 25 & 30, marked on brass cap, T 25 N, in N. half,
 R 7 W S 24, in NW.,
 R 6 W S 19, in NE.,
 S 30 in SE., and
 S 25 in SW. quad.; from which,
 A pinon tree 8 ins. diam. brs. N. 22° E. 28 lks. dist., marked T 25 N R 6 W S 19 B T.
 A cedar tree 8 ins. diam. brs. S. 67° E. 59 lks. dist., marked T 25 N R 6 W S 30 B T.
 A pinon tree 10 ins. diam. brs. S. 51° W. 41 lks. dist., marked T 25 N R 7 W S 25 B T.
 A pinon tree 7 ins. diam. brs. N. 4° W. 55 lks. dist., marked T 25 N R 7 W S 24 B T.
 Land, mts., broken.
 Soil, 3rd rate, gravelly, stony, loose, dry, calcareous.
 Cedar, pinon, few junipers, good grass.

North, bet. secs. 19 & 24.
 Over mts. land, asc. grad. SE. slope, through dense cedar, limestone formation.
 12.00 Timber becomes scattering, brs. NE. & W., desc. steep.
 25.60 Ravine, 150 lks. wide, 50 ft. deep, course NNE., asc. along ESE. slope.
 35.00 Spur, brs. E. & W., desc. ENE. slope.
 40.00 Set an iron post 3 ft. long, 1 in. in diam. 26 ins. in the ground for 1/4 sec. cor., marked on brass cap,
 1/4 S 24 in W., and
 S 19 in E. half; from which,
 A juniper tree 15 ins. diam. brs. S. 3° E. 64 lks. dist., marked 1/4 S 19 B T.
 A juniper tree 12 ins. diam. brs. N. 54° W. 148 lks. dist., marked 1/4 S 24 B T.
 50.00 Foot of spur, enter valley, brs. ESE. & W. leave timber.
 55.50 Road, brs. W., from ESE. (56.50 Dry wash, course West.)
 68.00 Leave valley, brs. E. & W., thence along E. slope of spur, over sandstone outcropping.
 80.00 Set an iron post 3 ft. long 3 ins. in diam. 24 ins. in the ground for cor. of secs. 13, 18, 19 & 24, marked on brass cap, T 25 N, in N. half,
 R 7 W S 13 in NW.,
 R 6 W S 18 in NE.,
 S 19 in SE., and
 S 24 in SW. quad.;
 No trees available, pits impracticable.
 Raise a mound of stone 2 ft. base, 1 1/2 ft. high W. of cor.
 Land, mts., broken, rolling.
 Soil, 3rd rate, gravelly, stony, sandy, calcareous.
 Cedar, pinon, junipers, good grass.
 May 1, 1912.

May 2, 1912.
 At 8h a.m., l.m.t., at the above corner, I set off 15° 24 1/2' N. on the decl. arc, and 35° 33' N. on the lat. arc, and determine a meridian with the solar.
 Thence I run,
 North, bet. secs. 13 & 18.
 Over mts. land, along E. slope of sandstone spur.
 31.50 Wash, 10 lks. wide, course SE., asc. steep S. slope of spur.
 40.00 Set an iron post 3 ft. long, 1 in. in diam. 26 ins. in the ground for 1/4 sec. cor., marked on brass cap,
 1/4 S 13 in W., and
 S 18 in E. half; from which,
 A juniper tree 15 ins. diam. brs. N. 35 1/4° W. 19 lks. dist., marked 1/4 S 13 B T.
 raise a mound of stone 2 ft. base, 1 1/2 ft. high W. of cor.
 41.00 Spur, brs. ESE. & WNW., ends 18 chs. to ESE., desc.
 49.90 Gulch, 50 lks. wide, course ESE., thence along foot of E. slope of spur.

Chains.

58.00 Branch of main canyon, 150 lks. wide, course SE., asc.
 70.00 Spur, brs. ESE., desc.
 76.00 Gulch, 50 lks. wide, course ESE., near head, asc.
 80.00 Set an iron post 3 ft. long, 3 ins. in diam. 24 ins. in the ground for cor. of secs. 7, 12, 13 & 18, marked on brass cap, T 25 N, in N. half,
 R 7 W S. 12 in NW.,
 R 6 W S 7 in NE.,
 S 13 in SE., and
 S 13 in SW. quad.; from which,
 A cedar tree 10 ins. diam. brs. N. 37° E. 144 lks. dist., marked T 25 N R 6 W S 7 B T.
 A cedar tree 6 ins. diam. brs. S. 34° E. 80 lks. dist., marked T 25 N R 6 W S 13 B T.
 A juniper tree 15 ins. diam. brs. S. 44° W. 105 lks. dist., marked T 25 N R 7 W S 13 B T.
 A cedar tree 8 ins. diam. brs. N. 48° W. 65 lks. dist., marked T 25 N R 7 W S 12 B T.
 Land, broken, mts. Soil, 3rd rate, gravelly, stony, dry. Sparse cedar, juniper, cacti, fair grass.

North, bet. secs. 7 & 12.

Over mts. land, asc. grad., through sparse cedar, and scrub oak.
 8.00 Spur, brs. ENE., desc.
 32.10 Wash, 15 lks. wide, course ESE., asc. through dense pinon cedar and scrub oak.
 40.00 Set an iron post 3 ft. long, 1 in. in diam. 26 ins. in the ground for $\frac{1}{4}$ sec. cor., marked on brass cap,
 $\frac{1}{4}$ S 12 in W., and
 S 7 in E. half; from which,
 A cedar tree 10 ins. diam. brs. N. 40° E. 48 lks. dist., marked $\frac{1}{4}$ S 7 B T.
 A pinon tree 6 ins. diam. brs. N. 10° W. 26 lks. dist., marked $\frac{1}{4}$ S 12 B T.
 Cor. on top of spur, brs. E. & W., desc.
 At this cor., at noon, I set off 15° 27' N. on the decl. arc, and observe the sun on the meridian.
 The resulting lat. is 35° 34 $\frac{1}{2}$ ' N.
 55.00 Few pine trees E. & W. of line, timber becomes scattering.
 58.00 Draw 2 chs. wide, course E., asc. over rolling land.
 80.00 Set an iron post 3 ft. long, 3 ins. in diam. 24 ins. in the ground for cor. of secs. 1, 6, 7 & 12, marked on brass cap, T 25 N, in N. half,
 R 7 W S. 1 in NW.,
 R 6 W S 6 in NE.,
 S 7 in SE., and S 12 in SW. quad.; from which,
 A cedar tree 8 ins. diam. brs. S. 84 $\frac{1}{2}$ ° W. 145 lks. dist., marked T 25 N R 7 W S 12 B T.
 raise a mound of stone 2 ft. base, 1 $\frac{1}{2}$ ft. high W. of cor.
 Land, mts., broken. Soil, 3rd rate, gravelly, stony.
 Cedar, pinon, few junipers and pines, good grass.

North, bet. secs. 1 & 6.

Over heavily rolling land, desc. grad.
 32.00 Gulch, 50 lks. wide, 100 ft. deep, course ESE., asc. grad.
 40.00 Set an iron post 3 ft. long, 1 in. in diam. 26 ins. in the ground for $\frac{1}{4}$ sec. cor., marked on brass cap,
 $\frac{1}{4}$ S 1 in W., and S 16' in E. half; from which,
 A juniper tree 10 ins. diam. brs. N. 65° E. 153 lks. dist., marked $\frac{1}{4}$ S 6 B T.
 A juniper tree 25 ins. diam. brs. S. 57° W. 116 lks. dist., marked $\frac{1}{4}$ S 1 B T.
 45.00 Spur, brs. E. & W., desc.
 50.00 Gulch, 50 lks. wide, course ENE., asc.
 55.00 Spur, brs. E. & W., desc.
 64.00 Gulch, 30 lks. wide, course E., asc.
 80.00 Set an iron post 3 ft. long, 3 ins. in diam. 24 ins. in the ground for cor. of Tps. 25 & 26 N., Rs. 6 & 7 W., marked on brass cap,

Chains.

T 26 N in N.,
 R 6 W in E.,
 T 25 N in S., and
 R 7 W in W. half,
 S 36 in NW.,
 S 31 in NE.,
 S 6 in SE., and
 S 1 in SW. quad.; from which,

A cedar tree 8 ins. diam. brs. S. $67\frac{1}{4}^{\circ}$ W. 198 lks. dist.,
 marked T 25 N R 7 W S 1 B T.

No other trees available.

Dig pits 24x18x12 ins. on each line, N., E. & W., 4 ft.
 and S. of cor. 8 ft. dist., and

raise a mound of earth 5 ft. base $2\frac{1}{2}$ ft. high S. of cor.

This cor. is on top of low flat divide, brs. ESE. & WNW.

A Geological or triangulation survey monument on Mt. Floyd
 brs. S. $45^{\circ}51'$ E.

A sharp round butte brs. S. $27^{\circ}40'$ E.

The South peak of San Francisco Mts. brs. S. $71^{\circ}25'$ E.

Land, mts., broken.

Soil, 3rd rate, gravelly, dry.

Cedar, pinon, few junipers, fair grass.

May 2, 1912.

Chains.

May 3, 1912.

At 7h a.m., l.m.t., at the cor. of Tps. 25 & 26 N., Rs. 5 & 6 W., recently established by me, & hereinbefore described, I set off $35^{\circ}36'$ N. on the lat. arc, and $15^{\circ}42'$ N. on the decl. arc, and determine a meridian with the solar. thence I run, as per instructions.

West, on a random line, bet. Tps. 25 & 26 N.

At 6 miles, 0.20 chs., I fall 42 lks. N. of the cor. of Tps. 25 & 26 N., Rs. 6 & 7 W., recently established by me, whence I run, as per instructions.

N. $89^{\circ}57'$ E., on a true line, on N. bdy. of Tp., bet. secs. 6 & 31.

Over rolling land, desc. grad.

40.20 Set an iron post 3 ft. long, 1 in. in diam. 26 ins. in the ground for $\frac{1}{4}$ sec. cor., marked on brass cap, $\frac{1}{4}$ S 31 in N., and

S 6 in S. half; from which,

A pinon tree 7 ins. diam. brs. N. $37\frac{1}{2}^{\circ}$ E. 104 lks. dist., marked $\frac{1}{4}$ S 31 B T.

A cedar tree 7 ins. diam. brs. S. $33\frac{1}{4}^{\circ}$ E. 28 lks. dist., marked $\frac{1}{4}$ S 6 B T.

74.00 Draw, 4 chs. wide, course SE.

80.20 Set an iron post 3 ft. long, 3 ins. in diam. 24 ins. in the ground for cor. of secs. 5, 6, 31 & 32, marked on brass cap, T 26 N in N.,

T 25 N in S., and

R 6 W in W half,

S 31 in NW.,

S 32 in NE.,

S 5 in SE., and

S 6 in SW. quad.; no trees available,

Pits impracticable.

Raise a mound of stone 2 ft. base, $1\frac{1}{2}$ ft. high W. of cor.

Land, rolling. Soil, 3rd rate, gravelly, dry.

Sparse cedar, pinon, good grass.

N. $89^{\circ}57'$ E., bet. secs. 5 & 32.

Over rolling land.

40.00 Set an iron post 3 ft. long, 1 in. in diam. 26 ins. in the ground for $\frac{1}{4}$ sec. cor., marked on brass cap, $\frac{1}{4}$ S 32 in N., and

S 5 in S. half; No trees available.

raise a mound of stone 2 ft. base, $1\frac{1}{2}$ ft. high N. of cor.

80.00 Set an iron post 3 ft. long, 3 ins. in diam. 24 ins. in the ground for cor. of secs. 4, 5, 32 & 33, marked on brass cap, T 26 N in N.,

T 25 N in S., and

R 6 W in W. half,

S 32 in NW.,

S 33 in NE.,

S 4 in SE., and

S 5 in SW. quad.;

No bearings available. Pits impracticable.

Raise a mound of stone 2 ft. base, $1\frac{1}{2}$ ft. high W. of cor.

Land, rolling.

Soil, 3rd rate, gravelly, dry.

Few cedars, pinons, good grass.

At this cor. at noon, I set off $15^{\circ}45'$ N. on the decl. arc, and observe the sun on the meridian.

The resulting lat. is $35^{\circ}36'$ N.

Chains.

N. 89°57' E., bet. secs. 4 & 33.
 Over rolling land, desc. grad. through scattering cedar, juniper and pinon.

6.00 Enter draw, course ESE.
 20.00 Leave draw, asc. grad.

40.00 Set an iron post 3 ft. long, 1 in. in diam. 26 ins. in the ground for $\frac{1}{4}$ sec. cor., marked on brass cap,
 $\frac{1}{4}$ S 33 in N., and
 S 4 in S. half; from which,
 A cedar tree 12 ins. diam. brs. N. 28° W. 183 lks. dist., marked $\frac{1}{4}$ S 33 B T.
 A cedar tree 9 ins. diam. brs. S. 69° E. 310 lks. dist., marked $\frac{1}{4}$ S 4 B T.

42.00 Top of flat ridge, brs. N. & S., desc. grad.
 68.00 Enter draw, course S.
 75.00 Wash, 20 lks. wide, course S., leave draw, asc.
 80.00 Set an iron post 3 ft. long, 3 ins. in diam. 24 ins. in the ground for cor. of secs. 3, 4, 33 & 34, marked on brass cap, T 26 N in N.,
 T 25 N in S., and
 R 6 W in W. half,
 S 33 in NW.,
 S 34 in NE.,
 S 3 in SE., and
 S 4 in SW. quad.; from which,
 A cedar tree 12 ins. diam. brs. N. 38° W. 75 lks. dist., marked T 26 N R 6 W S 33 B T.
 No other trees available.
 Dig pits 18x18x12 ins. in each 5 $\frac{1}{2}$ ft. dist., and raise a mound of earth 4 ft. base, 2 ft. high W. of cor.
 Land, rolling.
 Soil, 3rd rate, sandy, gravelly, dry.
 Sparse cedar, pinon, juniper, good grass.

N. 89°57' E., bet. secs. 3 & 34.
 Over rolling land, asc.

10.00 Top of rise, brs. N. & S.
 40.00 Set an iron post 3 ft. long, 1 in. in diam. 26 ins. in the ground for $\frac{1}{4}$ sec. cor., marked on brass cap,
 $\frac{1}{4}$ S 34 in N., and
 S 3 in S. half; from which,
 A cedar tree 15 ins. diam. brs. S. 38 $\frac{1}{2}$ ° W. 355 lks. dist., marked $\frac{1}{4}$ S 3 B T.
 A cedar tree 8 ins. diam. brs. N. 30° W. 196 lks. dist., marked $\frac{1}{4}$ S 34 B T.

56.00 A hill is 25 chs. to N. of line, desc. through dense cedar.
 68.00 Leave cedar, brs. N. & S.
 75.00 Draw, 2 chs. wide, near head, asc.
 80.00 Set an iron post 3 ft. long, 3 ins. in diam. 24 ins. in the ground for cor. of secs. 2, 3, 34 & 35, marked on brass cap, T 26 N in N.,
 T 25 N in S., and
 R 6 W in W. half,
 S 34 in NW.,
 S 35 in NE.,
 S 2 in SE., and
 S 3 in SW. quad.; from which,
 A cedar tree 6 ins. diam. brs. N. 30 $\frac{1}{2}$ ° E. 264 lks. dist., marked T 26 N R 6 W S 35 B T.
 No other bearings available, pits impracticable.
 Raise a mound of stone 2 ft. base, 1 $\frac{1}{2}$ ft. high W. of cor.
 Land, rolling.
 Soil, 3rd rate, gravelly, dry.
 Sparse cedar, pinon, fair grass.

Chains.

N. 89°57' E., bet. secs. 2 & 35.
 Over rolling land, asc. grad.
 6.00 Top of low spur, brs. S. & N., desc. through open draw.
 40.00 Set an iron post 3 ft. long, 1 in. in diam. 26 ins. in
 the ground for $\frac{1}{4}$ sec. cor., marked on brass cap,
 $\frac{1}{4}$ S 35 in N., and
 S 2 in S. half; from which,
 A cedar tree 12 ins. diam. brs. N. 4°W. 214 lks. dist.,
 marked $\frac{1}{4}$ S 35 B T.
 A cedar tree 50 ins. diam. brs. S. 88°W. 230 lks. dist.,
 marked $\frac{1}{4}$ S 2 B T.
 Enter open valley, brs. N. & S.
 67.00 Wash, 40 lks. wide, course S.
 69.46 Road, brs. N. & S.
 76.15 Wire fence, brs. NW. & SE.
 80.00 Set an iron post 3 ft. long, 3 ins. in diam. 24 ins. in
 the ground for cor. of secs. 1, 2, 35 & 36, marked on
 brass cap, T 26 N in N.,
 T 25 N in S., and
 R 6 W in W. half,
 S 35 in NW.,
 S 36 in NE.,
 S 1 in SE., and
 S 2 in SW. quad.; from which,
 A cedar tree 15 ins. diam. brs. S. 6°E. 62 lks. dist.,
 marked T 25 N R 6 W S 1 B T.
 A cedar tree 8 ins. diam. brs. S. 62°W. 20 lks. dist.,
 marked T 25 N R 6 W S 2 B T.
 A cedar tree 12 ins. diam. brs. N. 78°W. 97 lks. dist.,
 marked T 26 N R 6 W S 35 B T.
 No other bearings available, pits impracticable.
 Raise a mound of stone 2 ft. base, $1\frac{1}{2}$ ft. high W. of cor.
 Land, rolling. Soil, 3rd rate, sandy, gravelly, dry.
 Sparse cedar, pinon, good grass.

N. 89°57' E., bet. secs. 1 & 36.
 Over heavily rolling land, desc. NE. slope from cor.
 5.00 Small reservoir 4 chs. to N. of line.
 13.00 Wash, 20 lks. wide, course N., asc.
 22.44 Wire fence, brs. NE. & SW., around reservoir, enter dense
 cedar, brs. NNW. & SSE.
 40.00 Set an iron post 3 ft. long, 1 in. in diam. 26 ins. in
 the ground for $\frac{1}{4}$ sec. cor., marked on brass cap,
 $\frac{1}{4}$ S 36 in N., and
 S 1 in S. half; from which,
 A cedar tree 8 ins. diam. brs. S. 49°W. 22 lks. dist.,
 marked $\frac{1}{4}$ S 36 B T.
 A cedar tree 6 ins. diam. brs. N. 84°W. 20 lks. dist.,
 marked $\frac{1}{4}$ S 36 B T.
 45.00 Cedar becomes scattering, brs. N. & S.
 49.00 Stony gulch, 250 lks. wide, course SSW., asc. grad.
 59.00 Leave cedar, brs. SE. & N.
 80.00 To cor. of Tps. 25 & 26 N., Rs. 5 & 6 W., hereinbefore described.
 Land, rolling.
 Soil, 3rd rate, gravelly, stony.
 Cedar, pinon, fair grass.

Boundaries of T. 25 N., R. 6 W.

GENERAL DESCRIPTION

The East Boundary of T. 25 N., R. 6 W. runs over a rolling country draining to the SW. East of the line the land rises gradually through dense cedar and pinon for several miles. There is no water on or near the line.

The West Boundary of T. 25 N., R. 6 W. runs over a rough broken country, sparsely covered with cedar and pinon, with rough limestone and sandstone outcroppings on the ridges. There is no water or timber on the line, nor any indications of a mineral character noted.

The North Boundary of T. 25 N., R. 6 W., runs over a smooth or rolling country, sparsely covered with cedar and pinon, but has a good growth of native grass. The soil is in general loose, sandy or gravelly.

Boundaries of T. 25 N., R. 6 W.
Latitudes, departures, and closing errors.

Line designated.	True bearing.	Dist.	Latitudes.		Departures.	
			N.	S.	E.	W.
		Chs.	Chs.	Chs.	Chs.	Chs.
6th Std. Par. N. West, ----	West, ----	480.00	-----	-----	-----	480.00
West Boundary, --	North, ----	480.00	480.00	-----	-----	-----
North Boundary, -	N.89°57'E.	480.20	0.42	-----	480.20	-----
East Boundary, --	South, ----	480.00	-----	480.00	-----	-----
Convergency, ----	-----	-----	-----	-----	0.52	-----
Totals, -----		-----	480.42	480.00	480.72	480.00
Error in Lat. -----		-----	480.00	-----	480.00	-----
Error in Dep. -----		-----	0.42	-----	-0.72	-----

May 3, 1912.

Joseph B. Wright
U. S. Surveyor.

		<p>[Faint, illegible text, possibly bleed-through from the reverse side of the page]</p>	
--	--	--	--

Chains.

May 4, 1912.

At 7h a.m., l.m.t., at the cor. of Tps. 25 & 26 N., Rs. 6 & 7 W., recently established by me, & hereinbefore described,

I set off 15°59½' N. on the decl. arc, and 35°36' N., on the lat. arc, and determine a meridian with the solar., Thence I run, as per instructions, West, on a random line, on N. bdy. of Tp.

At 6 miles, .25 chs., I intersect the cor. of Tps. 25 & 26 N., Rs. 7 & 8 W., whence I run, East, on a true line, on N. bdy. of Tp., bet. secs. 6 & 31; (Correcting the line bet. secs. 6 & 31, previously run by me from theoretic closures)

Over rolling plain, asc. gently, though sage brush and cacti, good grass.

.81 Road, brs. NW. & SE.

35.82 Road, brs. NNW. & SSE.

40.25 Set an iron post 3 ft. long, 1 in. in diam. 26 ins. in the ground for ¼ sec. cor., marked on brass cap, ¼ S 31 in N., and S 6 in S. half;

dig pits 10x18x12 ins. E. & W. of cor. 3 ft. dist., and raise a mound of earth 3½ ft. base, 1½ ft. high N. of cor.

80.25 Set an iron post 3 ft. long, 3 ins. in diam. 24 ins. in the ground for cor. of secs. 5, 6, 31 & 32, marked on brass cap, T 26 N in N.,

T 25 N in S., and R 7 W in W. half, S 31 in NW., S 32 in NE., S 5 in SE., and S 6 in SW. quad.;

dig pits 18x18x12 ins. in each sec. 5½ ft. dist., and raise a mound of earth 4 ft. base, 2 ft. high W. of cor. Land, rolling. Soil, 3rd rate, sandy, gravelly, dry. Sage brush, cacti, fine grass.

East, bet. secs. 5 & 32.

Over rolling land, asc. grad.

30.00 Asc. through dense cedar and pinon.

40.00 Set an iron post 3 ft. long, 1 in. in diam. 26 ins. in the ground for ¼ sec. cor., marked on brass cap, ¼ S 32 in N., and S 5 in S. half; from which,

A cedar tree 15 ins. diam. brs. S. 75° E. 55 lks. dist., marked ¼ S 5 B T.

A pinon tree 5 ins. diam. brs. N. 33° E. 24 lks. dist., marked ¼ S 32 B T.

50.00 Leave valley, asc. prec. W. slope of bluff, brs. NE. & S.

71.76 Top of rim, brs. NE. & SSW., thence along top of bluff, near N. rim of point.

80.00 Set an iron post 3 ft. long, 3 ins. in diam., on bed-rock, in mound of stone for cor. of secs. 4, 5, 32 & 33, marked on brass cap, T 26 N in N.,

T 25 N in S., and R 7 W in W. half; from which,

A cedar tree 6 ins. diam. brs. N. 39° E. 65 lks. dist., marked T 26 N R 7 W S 33 B T.

A cedar tree 8 ins. diam. brs. S. 2° E. 118 lks. dist., marked T 25 N R 7 W S 4 B T.

A pinon tree 10 ins. diam. brs. S. 68° W. 90 lks. dist., marked T 25 N R 7 W S 5 B T.

A cedar tree 12 ins. diam. brs. N. 69° W. 60 lks. dist., marked T 26 N R 7 W S 32 B T.

Land, rolling, mts. Soil, 3rd & 4th rate, stony. Cedar, pinon, cacti, fair grass.

At this cor., at noon, I set off 16°02' N. on the decl. arc, and observe the sun on the meridian.

The resulting lat. is 35°36' N.

532 in NW.
533 in NE.
54 in SE. and
55 in SW. quadrant,

Chains.

East, bet. secs. 4 & 33.
 Over mts. land, asc., on high broken mesa, through
 cedar and pinon.

15.00 Top of rise, brs. N. & S., desc.
 40.00 Set an iron post 3 ft. long, 1 in. in diam. 26 ins. in
 the ground for $\frac{1}{4}$ sec. cor., marked on brass cap,
 $\frac{1}{4}$ S 33 in N., and
 S 4 in S. half; from which,
 A pinon tree 30 ins. diam. brs. N. 75° E. 138 lks. dist.,
 marked $\frac{1}{4}$ S 33 B T.
 A pinon tree 10 ins. diam. brs. S. 85° W. 93 lks. dist.,
 marked $\frac{1}{4}$ S 4 B T.

41.00 Centre of draw, 2 chs. wide, course NE., pine trees to NE.
 43.00 Asc.
 79.00 Ridge, brs. NE. & SW., desc.
 80.00 Set an iron post 3 ft. long, 3 ins. in diam. 24 ins. in
 the ground for cor. of secs. 3, 4, 33 & 34, marked on
 brass cap, T 26 N in N.,
 T 25 N in S., and
 R 7 W in W. half; from which,
 A juniper tree 30 ins. diam. brs. N. 59° E. 161 lks. dist.,
 marked T 26 N R 7 W S 34 B T.
 A juniper tree 12 ins. diam. brs. S. 73° E. 142 lks. dist.,
 marked T 25 N R 7 W S 3 B T.
 A scrub oak 6 ins. diam. brs. S. 41° W. 64 lks. dist.,
 marked T 25 N R 7 W S 4 B T.
 A scrub oak 6 ins. diam. brs. N. 34° W. 148 lks. dist.,
 marked T 26 N R 7 W S 33 B T.

Land, mts.
 Soil, 3rd rate, stony.
 Cedar, pinon, scrub oak, juniper, sparse grass.

East, bet. secs. 3 & 34.
 Over mts. land, desc.

23.00 Draw, 2 chs. wide, course NE., asc.
 29.00 Spur, brs. NE. & SW., desc.
 40.00 Set an iron post 3 ft. long, 1 in. in diam. 26 ins. in
 the ground for $\frac{1}{4}$ sec. cor., marked on brass cap,
 $\frac{1}{4}$ S 34 in N., and
 S 3 in S. half; from which,
 A Juniper tree 35 ins. diam. brs. S. 15° W. 185 lks. dist.,
 marked $\frac{1}{4}$ S 3 B T.
 A scrub oak tree 6 ins. diam. brs. N. 83° W. 170 lks. dist.,
 marked $\frac{1}{4}$ S 34 B T.

62.00 Asc. steep SW. slope of wooded ridge.
 71.00 Ridge, brs. SE. & NW., at 8 chs. to SE., turns to E. & NE.
 80.00 Set an iron post 3 ft. long, 3 ins. in diam. 24 ins. in
 the ground for cor. of secs. 2, 3, 34 & 35, marked on
 brass cap, T 26 N in N.,
 T 25 N in S., and
 R 7 W in W. half,
 S 35 in NE.,
 S 2 in SE., and
 S 3 in SW., and
 S 34 in NW. quad.; from which,
 A Juniper tree 20 ins. diam. brs. S. 12° W. 252 lks. dist.,
 marked T 25 N R 7 W S 3 B T.

No other trees available,
 dig pits 18x18x12 ins. in each sec. 5 $\frac{1}{2}$ ft. dist., and
 raise a mound of earth 4 ft. base, 2 ft. high W. of cor.

Land, mts., rolling.
 Soil, 3rd rate, dry, gravelly.
 Cedar, pinon, juniper scrub oak, good grass.

Chains.

East, bet. secs. 2 & 35.
 Over mts. land, asc.
 1.50 Spur, brs. ENE. & WSW., desc.
 24.50 Canyon 150 lks. wide, course SE., asc. steep.
 40.00 Set an iron post 3 ft. long, 1 in. in diam. 26 ins. in
 the ground for $\frac{1}{4}$ sec. cor., marked on brass cap,
 $\frac{1}{4}$ S 35 in N., and
 S 2 in S. half; from which,
 A cedar tree 6 ins.diam.brs. S.2°E. 234 lks. dist.,
 marked $\frac{1}{4}$ S 2 B T.
 A cedar tree 6 ins.diam.brs. N.61°W. 132 lks.dist.,
 marked $\frac{1}{4}$ S 35 B T.
 44.60 Long spur, brs. ESE., turns to E.
 60.00 Same spur, brs. NE. & SW., desc.
 65.00 Along S. slope of spur.
 80.00 Set an iron post 3 ft. long, 3 ins. in diam. 24 ins. in
 the ground for cor. of secs. 1,2,35 & 36, marked on
 brass cap, T 26 N in N.,
 T 25 N in S., and
 R 7 W in W. half,
 S 35 in NW.,
 S 36 in NE.,
 S 1 in SE., and
 S 2 in SW. quad.; from which,
 A cedar tree 10 ins.diam.brs. N.29°E. 34 lks. dist.,
 marked T 26 N R 7 W S 36 B T.
 A cedar tree 18 ins.diam.brs. S.25°W. 13 lks. dist.,
 marked T 25 N R 7 W S. 2 B T.
 A cedar tree 12 ins.diam.brs. N.21°W. 89 lks. dist.,
 marked T 26 N R 7 W S 35 B T.
 No other bearings available.
 Dig pits 18x18x12 ins. in each sec. 5 $\frac{1}{2}$ ft.dist., and
 raise a mound of earth 4 ft.base, 2 ft.high W.of cor.
 Land, mts., broken.
 Soil, 3rd rate, stony, dry, loose.
 Cedar, pinon, juniper, good grass.

East, bet. secs. 1 & 36.
 Over mts. land, desc.
 17.00 Ravine 150 lks. wide, course ENE., asc.
 40.00 Set an iron post 3 ft. long, 1 in. in diam. 26 ins. in
 the ground for $\frac{1}{4}$ sec. cor., marked on brass cap,
 $\frac{1}{4}$ S 36 in N., and
 S 1 in S. half;
 No bearings available, pits impracticable.
 Raise a mound of stone 2 ft.base, 1 $\frac{1}{2}$ ft.high N.of cor.
 44.00 Spur, brs. NE. & SW., desc.
 59.00 Ravine, 100 lks. wide, course NE., asc.
 80.00 To cor. of Tps. 25 & 26 N., Rs. 6 & 7 W., hereinbefore described.
 Land, mts., heavily rolling.
 Soil, 3rd rate, gravelly, dry, loose.
 Sparse cedar, pinon, good grass.

May 4, 1912.

Latitudes, departures, and closing errors.

Line Designated.	True bearing.	Distance Chs.	Latitudes.		Departures.	
			N. Chs.	S. Chs.	E. Chs.	W. Chs.
6th Std. Par. N. ---	West, ----	480.46	-----	-----	-----	480.46
West Boundary, ----	North, ---	480.00	480.00	-----	-----	-----
North Boundary, ---	East, ----	480.25	-----	-----	480.25	-----
East Boundary, ----	South, ---	480.00	-----	480.00	-----	-----
Convergency, ----		-----	-----	-----	-0.52	-----
	Totals,		480.00	480.00	480.77	480.46
			480.00	-----	480.46	-----
	Error in lat. ----		0.00	-----	-----	-----
	Error in dep. ----		-----	-----	-0.31	-----

General Description.

The E.&N. bdrs. of T. 25 N., R. 7 W., as surveyed by me runs over a very broken mts. country, sparsely covered with cedar and pinon, and juniper, with good growth of native grass.

There is no water on or near the line.

The formation or rock structure is mostly limestone overlying several strata of red sandstone. No indications of mineral noted.

(Note)

It is evident from my closures on the 6th Std. Par. N. that this line is in excess in measurement, an error of 46 lks. being found in the S. bdy. of sec. 35, T. 25 N., R. 7 W., when closing from the South during survey of T. 25 N., R. 7 W.

May 4, 1912.

James B. Wright
U. S. Surveyor.

Chains.

May 15, 1912.
 At 7h a.m., l.m.t., at the cor. of Tps. 25 & 26 N., Rs. 6 & 7 W., recently established by me, & hereinbefore described, I set off 18°53' N. on the decl. arc, and 35°36' N. on the lat. arc, and determine a meridian with the solar. Thence I run, as per instructions, North, on range line, bet. secs. 31 & 36. Over heavily rolling, or mts. land, desc. NW. slope of ridge, through scattering timber.

12.00 Draw, 150 lks. wide, course NE., ascend. grad.
 28.00 Top of ridge, brs. E. & W., desc.
 40.00 Set an iron post 3 ft. long, 1 in. in diam. 26 ins. in the ground for 1/4 sec. cor., marked on brass cap, 1/4 S 36 in W., and S 31 in E. half;
 No trees available, dig pits 18x18x12 ins. N. & S. of cor. 3 ft. dist., and raise a mound of stone covered with earth 3 1/2 ft. base, 1 1/2 ft. high W. of cor.

42.00 Draw, 5 chs. wide, course ESE., asc.
 60.50 Ridge, brs. ESE. & WNW., desc.
 78.50 Draw, 50 lks. wide, course ESE., asc.
 80.00 Set an iron post 3 ft. long, 3 ins. in diam. 24 ins. in the ground for cor. of secs. 25, 30, 31 & 36, marked on brass cap, T 26 N in N., half, R 7 W S 25 in NW., R 6 W S 30 in NE., S 31 in SE., and S 36 in SW. quad.; from which,
 A cedar tree 10 ins. diam. brs. N. 61 1/4° E. 52 lks. dist., marked T 26 N R 6 W S 30 B T.
 A cedar tree 7 ins. diam. brs. S. 84° E. 72 lks. dist., marked T 26 N R 6 W S 31 B T.
 A cedar tree 10 ins. diam. brs. S. 58 1/2° W. 7 lks. dist., marked T 26 N R 7 W S 36 B T.
 A cedar tree 8 ins. diam. brs. N. 65 1/4° W. 111 lks. dist., marked T 26 N R 7 W S 25 B T.

Land, heavily rolling, broken.
 Soil, 3rd rate, sandy, gravelly, dry.
 Pinon, cedar, scrub oak, good grass.

North, bet. secs. 25 & 30.
 Over mts. land, asc. through dense timber.

7.00 Ridge, brs. NE. & SW., desc.
 18.10 Wash, 10 lks. wide, in draw, 2 chs. wide, course ENE., asc.
 34.00 Top of ridge, brs. ENE. & WSW., desc., leave timber.
 40.00 Set an iron post 3 ft. long, 1 in. in diam. 26 ins. in the ground for 1/4 sec. cor., marked on brass cap, 1/4 S 25 in W., and S 30 in E. half; no trees available.
 Raise a mound of stone 2 ft. base, 1 1/2 ft. high W. of cor.

42.00 Draw, 50 lks. wide, course E., asc.
 61.00 Top of ridge, brs. ENE. & WSW., desc. grad. on spur.
 80.00 Set an iron post 3 ft. long, 3 ins. in diam. 24 ins. in the ground for cor. of secs. 19, 24, 25, & 30, marked on brass cap, T 26 N in N. half, R 7 W S 24 in NW., R 6 W S 19 in NE., S 30 in SE., and S 25 in SW. quad.; no trees available,
 Raise a mound of stone 2 ft. base, 1 1/2 ft. high W. of cor.

Land, mts., rolling.
 Soil, 3rd rate, gravelly, dry.
 Cedar, pinon, good grass.

Chains.

North, bet. secs. 19 & 24.
 Over mts. land, desc. on spur.
 8.30 Wash, 10 lks. wide, course NE., asc.
 10.50 Wash, 10 lks. wide, course E.; asc.
 20.15 Ridge, brs. ENE. & WSW., desc.
 36.00 Draw, 50 lks. wide, course NE., asc.
 40.00 Set an iron post 3 ft. long, 1 in. in diam. 26 ins. in the ground for $\frac{1}{4}$ sec. cor., marked on brass cap,
 $\frac{1}{4}$ S 24 in W., and
 S 19 in E. half; from which,
 A cedar tree 15 ins. diam. brs. S. $20\frac{1}{2}^{\circ}$ W. 90 lks. dist.,
 marked $\frac{1}{4}$ S 24 B T.
 No other bearings available, pits impracticable.
 Raise a mound of stone 2 ft. base, $1\frac{1}{2}$ ft. high W. of cor.
 43.00 Top of ridge, brs. NE. & SW., desc.
 56.50 Wash, 10 lks. wide, in draw, 3 chs. wide, course SE., asc.
 72.00 Ridge, brs. SE. & NW., desc.
 80.00 Set an iron post 3 ft. long, 3 ins. in diam. 24 ins. in the ground for cor. of secs. 13, 18, 19 & 24, marked on brass cap, T 26 N in N. half,
 R 7 W S 13 in NW.,
 R 6 W S 18 in NE.,
 S 19 in SE., and
 S 24 in SW. quad.; from which,
 A cedar tree 9 ins. diam. brs. S. $35\frac{1}{2}^{\circ}$ W. 234 lks. dist.,
 marked T 26 N R 7 W S 24 B T.
 No other bearings available;
 Dig pits 18x18x12 ins. in each sec. $5\frac{1}{2}$ ft. dist., and
 raise a mound of earth 4 ft. base, 2 ft. high W. of cor.
 Land, mts. Soil; 3rd rate, stony, gravelly, dry.
 Sparse cedar, pinon, scrub oak, good grass.
 At this cor. at noon, I set off $18^{\circ}55\frac{1}{2}'$ on the decl.
 arc, and observe the sun on the meridian.
 The resulting lat. is $35^{\circ}38\frac{1}{2}'$ N.

North, bet. secs. 13 & 18.
 Over rolling land, through scattering cedar and pinon.
 19.00 Draw, 2 chs. wide, course ESE., asc. grad.
 37.00 Draw, 3 chs. wide, course SE.
 40.00 Set an iron post 3 ft. long, 1 in. in diam. 26 ins. in the ground for $\frac{1}{4}$ sec. cor., marked on brass cap,
 $\frac{1}{4}$ S 13 in W., and
 S 18 in E. half; from which,
 A cedar tree 7 ins. diam. brs. S. $71\frac{1}{2}^{\circ}$ E. 73 lks. dist.,
 marked $\frac{1}{4}$ S 18 B T.
 A cedar tree 7 ins. diam. brs. S. 74° W. 125 lks. dist.,
 marked $\frac{1}{4}$ S 13 B T.
 80.00 Set an iron post 3 ft. long, 3 ins. in diam. 24 ins. in the ground for cor. of secs. 7, 12, 13 & 18, marked on brass cap, T 26 N in N. half,
 R 7 W S 12 in NW.,
 R 6 W S 7 in NE.,
 S 18 in SE., and
 S 13 in SW. quad.; from which,
 A cedar tree 6 ins. diam. brs. N. $46\frac{3}{4}^{\circ}$ E. 249 lks. dist.,
 marked T 26 N R 6 W S 12 B T.
 A cedar tree 12 ins. diam. brs. S. $87\frac{1}{4}^{\circ}$ E. 309 lks. dist.,
 marked T 26 N R 6 W S 18 B T.
 A cedar tree 10 ins. diam. brs. S. 58° W. 254 lks. dist.,
 marked T 26 N R 7 W S 13 B T.
 A cedar tree 14 ins. diam. brs. N. $73\frac{1}{2}^{\circ}$ W. 291 lks. dist.,
 marked T 26 N R 7 W S 12 B T.
 Land, mts., rolling.
 Soil, 3rd rate, gravelly, dry.
 Cedar, pinon, scrub oak, cacti, good grass.

Chains.

North, bet. secs. 7 & 12.
 Over rolling land, through scattering brush and cedar.
 18.00 Draw, 3 chs. wide, course ENE.
 40.00 Set an iron post 3 ft. long, 1 in. in diam. 26 ins. in the ground for $\frac{1}{4}$ sec. cor., marked on brass cap, $\frac{1}{4}$ S 12 in W., and S 7 in E. half; from which,
 A cedar tree 7 ins. diam. brs. S. 16° E. 303 lks. dist., marked $\frac{1}{4}$ S 7 B T.
 A cedar tree 7 ins. diam. brs. S. 70° W. 124 lks. dist., marked $\frac{1}{4}$ S 12 B T.
 43.00 Draw 2 chs. wide, course ENE.,
 49.00 Draw 3 chs. wide, course SE., near junction.
 80.00 Set an iron post 3 ft. long, 3 ins. in diam. 24 ins. in the ground for cor. of secs. 1, 6, 7 & 12, marked on brass cap, T 26 N in N. half, R 7 W S 1 in NW., R 6 W S 6 in NE., S 7 in SE., and S 12 in SW. quad.; No trees available.
 Raise a mound of stone 2 ft. base, 1 $\frac{1}{2}$ ft. high W. of cor. Land, rolling.
 Soil, 3rd rate, gravelly, dry.
 Sparse cedar, pinon, scrub oak, cacti, good grass.

North, bet. secs. 1 & 6.
 Over heavily rolling land, through scattering brush and cedar and pinon.
 9.00 Draw, 1 ch. wide, near head, course NE.
 16.75 Draw, 1 ch. wide, near head, course NE, asc.
 34.00 Desc. steep NW. slope.
 40.00 Set an iron post 3 ft. long, 1 in. in diam. 26 ins. in the ground for $\frac{1}{4}$ sec. cor., marked on brass cap, $\frac{1}{4}$ S 1 in W., and S 6 in E. half; from which,
 A pinon tree 7 ins. diam. brs. N. 45° E. 10 lks. dist., marked $\frac{1}{4}$ S 6 B T.
 A pinon tree 10 ins. diam. brs. S. 30° W. 41 lks. dist., marked $\frac{1}{4}$ S 1 B T.
 42.00 Draw, 4 chs. wide, course NE., asc. grad.
 74.00 Ridge, brs. NE. & SW., desc.
 79.25 Draw, 1 ch. wide, course NE.
 80.00 Set an iron post 3 ft. long, 3 ins. in diam. 24 ins. in the ground for cor. of Tps. 26 & 27 N., Rs. 6 & 7 W., marked on brass cap,
 T 27 N in N.,
 R 6 W in E.,
 T 26 N in S., and
 R 7 W in W. half;
 S 36 in NW.,
 S 31 in NE.,
 S 6 in SE., and
 S 1 in SW. quad; from which,
 A cedar tree 9 ins. diam. brs. N. 18 $\frac{1}{2}$ ° E. 194 lks. dist., marked T 27 N R 6 W S 31 B T.
 A cedar tree 9 ins. diam. brs. S. 27 $\frac{1}{2}$ ° E. 237 lks. dist., marked T 26 N R 6 W S 6 B T.
 A cedar tree 9 ins. diam. brs. S. 32 $\frac{1}{2}$ ° W. 172 lks. dist., marked T 26 N R 7 W S 1 B T.
 A cedar tree 10 ins. diam. brs. N. 32 $\frac{1}{2}$ ° W. 118 lks. dist., marked T 27 N R 7 W S 36 B T.
 Land, heavily rolling, broken.
 Soil, 3rd rate, gravelly, dry.
 Cedar, pinon, scrub oak, cacti, good grass.

May 15, 1912.

Chains.

May 16, 1912.

At 7h a.m., l.m.t., at the cor. of Tps. 25. & 26 N., Rs. 5 & 6 W., recently established by me, & hereinbefore described.

I set off $19^{\circ}07\frac{1}{2}'$ N. on the decl. arc, and $35^{\circ}36'$ N. on the lat. arc, and determine a meridian with the solar. Thence I run, as per instructions,

North, on range line, bet. secs. 31 & 36.

Over rolling land. Van. $14\frac{1}{2}^{\circ}$ E.

30.00 Enter scattering cedar, hrs. E. & W.

40.00 Set an iron post 3 ft. long, 1 in. in diam. 26 ins. in the ground for $\frac{1}{4}$ sec. cor., marked on brass cap,

$\frac{1}{4}$ S 36 in W., and

S 31 in E. half; from which,

A cedar tree 24 ins. diam. hrs. S. 3° W. 290 lks. dist., marked $\frac{1}{4}$ S 36 B T.

No other trees available, pits impracticable.

Raise a mound of stone 2 ft. base, $1\frac{1}{2}$ ft. high W. of cor.

52.00 Cedar becomes dense, hrs. NE. & SW.

74.00 Cedar becomes scattering, hrs. NNE. & SW.

80.00 Set an iron post 3 ft. long, 3 ins. in diam. 24 ins. in the ground for cor. of secs. 25, 30, 31 & 36, marked on brass cap, T 26 N in N. half,

R 6 W S 25 in NW.,

R 5 W S 30 in NE.,

S 31 in SE., and

S 36 in SW. quad.; from which,

A cedar tree 10 ins. diam. br. S. 32° W. 113 lks. dist., marked T 26 N R 6 W S 36 B T.

No other trees available.

Dig pits $18 \times 18 \times 12$ ins. in each sec. $5\frac{1}{2}$ ft. dist., and raise a mound of stone 2 ft. base, $1\frac{1}{2}$ ft. high W. of cor.

Land, rolling. Soil, 3rd rate, gravelly, sandy, dry. Cedar, pinon, good grass.

North, bet. secs. 25 & 30.

Over rolling land, asc. grad. SW. slope, dense cedar 10 chs. to W.

20.00 Top of rise, hrs. SW. & NE., enter scattering cedar.

40.00 Set an iron post 3 ft. long, 1 in. in diam. 26 ins. in the ground for $\frac{1}{4}$ sec. cor., marked on brass cap,

$\frac{1}{4}$ S 25 in W., and

S 30 in E. half; no trees available.

Raise a mound of stone 2 ft. base, $1\frac{1}{2}$ ft. high W. of cor.

63.50 Top of ascent, hrs. NW. & SE., desc.

80.00 Set an iron post 3 ft. long, 3 ins. in diam. 24 ins. in the ground for cor. of secs. 19, 24, 25 & 30, marked on brass cap, T 26 N in N. half,

R 6 W S 24 in NW.,

R 5 W S 19 in NE.,

S 30 in SE., and

S 25 in SW. quad.; from which,

A cedar tree 15 ins. diam. hrs. S. 76° E. 355 lks. dist., marked T 26 N R 5 W S 30 B T.

A cedar tree 10 ins. diam. hrs. N. $27\frac{1}{2}^{\circ}$ W. 337 lks. dist., marked T 26 N R 6 W S 24 B T.

No other trees available.

Dig pits $18 \times 18 \times 12$ ins. in each sec. $5\frac{1}{2}$ ft. dist., and raise a mound of earth 4 ft. base, 2 ft. high W. of cor.

Land, rolling.

Soil, 3rd rate, gravelly, dry.

Cedar, pinon, scrub oak, cacti, fair grass.

Chains.

- North, bet. secs. 19 & 24.
Over mts. land, desc. grad. through scattering cedar.
- 12.00 Draw 20 chs. wide, course NNW., low divide brs. ESE. about 20 chs.
- 25.00 Hill 20 chs. to E., asc. through scattering cedar.
- 30.00 Enter dense timber, brs. E. & W.
- 40.00 Set an iron post 3 ft. long, 1 in. in dia. 26 ins. in the ground for $\frac{1}{4}$ sec. cor., marked on brass cap, $\frac{1}{4}$ S 24 in W., and S 19 in E. half; from which,
A pinon tree 10 ins. diam. brs. S. 80° E. 13 lks. dist., marked $\frac{1}{4}$ S 19 B T.
A cedar tree 10 ins. diam. brs. S. 60° W. 17 lks. dist., marked $\frac{1}{4}$ S 24 B T.
- 55.00 Top of rise, brs. WSW, & ENE., desc.
- 79.90 Old road, brs. ENE. & WNW.
- 80.00 Set an iron post 3 ft. long, 3 ins. in diam. 24 ins. in the ground for cor. of secs. 13, 18, 19 & 24, marked on brass cap, T 26 N in N. half,
R 6 W S 13 in NW.,
R 5 W S 18 in NE.,
S 19 in SE., and
S 24 in SW. quad.; from which,
A cedar tree 8 ins. diam. brs. N. 2 $\frac{1}{2}$ ° E. 702 lks. dist., marked T 26 N R 5 W S 18 B T.
A cedartree 12 ins. diam. brs. S. 32 $\frac{1}{2}$ ° E. 289 lks. dist., marked T 26 N R 5 W S 19 B T.
A cedar tree 12 ins. diam. brs. S. 4° W. 212 lks. dist., marked T 26 N R 6 W S 24 B T.
A cedartree 12 ins. diam. brs. N. 82° W. 208 lks. dist., marked T 26 N R 6 W S 13 B T.
- Land, rolling.
Soil, 3rd rate, gravelly, dry.
Cedar, pinon, scrub oak, fair grass.

- North, bet. secs. 13 & 18.
Over rolling land.
- 10.00 Enter open grassy valley, brs. E. & W.
- 20.00 S. end of a barren playa brs. 20 chs. to W.
- 40.00 Set an iron post 3 ft. long, 1 in. in diam. 26 ins. in the ground for $\frac{1}{4}$ sec. cor., marked on brass cap, $\frac{1}{4}$ S 13 in W., and S 18 in E. half;
dig pits 18x18x12 ins. N. & S. of cor. 3 ft. dist., and raise a mound of earth 3 $\frac{1}{2}$ ft. base, 1 $\frac{1}{2}$ ft. high W. of cor. E. edge of barren playa is 5 chs. to W.
- 54.47 Road, brs. NNE. & SSW.
- 80.00 Set an iron post 3 ft. long, 3 ins. in diam. 24 ins. in the ground for cor. of secs. 7, 12, 13 & 18, marked on brass cap, T 26 N in N. half,
R 6 W S 12 in NW.,
R 5 W S 7 in NE.,
S 18 in SE., and
S 13 in SW. quad.;
dig pits 18x18x12 ins. in each sec. 5 $\frac{1}{2}$ ft. dist., and raise a mound of earth 4 ft. base, 2 ft. high W. of cor.
- Land, rolling.
Soil, 3rd rate, gravelly, dry.
Cedar, some pinon, good grass.
At this cor. at noon, I set off 19° 09 $\frac{1}{2}$ ' N. on the decl. arc, and observe the sun on the meridian.
The resulting lat. is 35° 39' N.

Chains.

- North, bet. secs. 7 & 12.
 Asc. grad. in open draw, dense cedar E. & W. about 15 chs.
- 40.00 Set an iron post 3 ft. long, 1 in. in diam. 26 ins. in the ground for $\frac{1}{4}$ sec. cor., marked on brass cap,
 $\frac{1}{4}$ S 12 in W., and
 S 7 in E. half; from which,
 A cedar tree 8 ins. diam. brs. N. 03° E. 2 $\frac{1}{2}$ lks. dist.,
 marked $\frac{1}{4}$ S 7 B T.
 A cedar tree 8 ins. diam. brs. S. $9\frac{1}{2}^{\circ}$ W. 1.03 lks. dist.,
 marked $\frac{1}{4}$ S 12 B T.
- 43.00 Enter dense timber, brs. E. & W.
- 80.00 Set an iron post 3 ft. long, 3 ins. in diam. 24 ins. in the ground for cor. of secs. 1, 6, 7 & 12, marked on brass cap, T 26 N. in N. half,
 R 6 W S 1. in NW.,
 R. 5 W S 6 in NE.,
 S 7 in SE., and
 S 12 in SW. quad.; from which,
 A pinon tree 10 ins. diam. brs. N. 68° E. 49 lks. dist.,
 marked T 26 N R 5 W S 6 B T.
 A cedar tree 10 ins. diam. brs. S. 16° E. 45 lks. dist.,
 marked T 26 N R 5 W S 7 B T.
 A pinon tree 14 ins. diam. brs. S. 36° W. 32 lks. dist.,
 marked T 26 N R 6 W S 12 B T.
 A pinon tree 12 ins. diam. brs. N. 30° W. 21 lks. dist.,
 marked T 26 N R 6 W S 1 B T.
- Land, rolling.
 Soil, 3rd rate, gravelly, dry, stony.
 Cedar, pinon, scrub oak, fair grass.

- North, bet. secs. 1 & 6.
 Over rolling land.
- 28.00 Asc. SW. slope of malapais hill.
- 32.00 Malapais hill, apex brs. about 60 chs. to W.
- 40.00 Top of ascent, apex of another malapais hill is 2 chs. E.
 Set an iron post 3 ft. long, 1 in. in diam. 26 ins. in the ground for $\frac{1}{4}$ sec. cor., marked on brass cap,
 $\frac{1}{4}$ S 1 in W., and
 S 6 in E. half; from which,
 A pinon tree 24 ins. diam. brs. N. 65° E. 11 lks. dist.,
 marked $\frac{1}{4}$ S 6 B T.
 A pinon tree 10 ins. diam. brs. S. 65° W. 29 lks. dist.,
 marked $\frac{1}{4}$ S 1 B T.
- Desc. from cor.
- 57.00 Wash, 10 lks. wide, course NE., in open draw 6 chs. wide.
 Mag. var. at this point is 15° E. asc.
- 78.00 Top of rise, brs. NE. & SW., desc.
- 80.00 Set an iron post 3 ft. long, 3 ins. in diam. 24 ins. in the ground for cor. of Tps. 26 & 27 N., Rs. 5 & 6 W., marked on brass cap,
 T 27 N in N.,
 R 5 W in E.,
 T 26 N in S., and
 R 6 W in W. half,
 S 36 in NW.,
 S 31 in NE.,
 S 6 in SE., and
 S 1 in SW. quad.; from which,
 A cedar tree 10 ins. diam. brs. N. 42° E. 11 lks. dist.,
 marked T 27 N R 5 W S 31 B T.
 A pinon tree 8 ins. diam. brs. S. 31° E. 57 lks. dist.,
 marked T 26 N R 5 W S 6 B T.
 A cedar tree 8 ins. diam. brs. S. 44° W. 18 lks. dist.,
 marked T 26 N R 6 W S 1 B T.
 A pinon tree 10 ins. diam. brs. N. 47° W. 22 lks. dist.,
 marked T 27 N R 6 W S 36 B T.
- Land, rolling, mts. Soil, 3rd rate, stony, gravelly, dry.
 Cedar, pinon, scrub oak, fair grass.

May 16, 1912.

Chains.

May 17, 1912.
 At 7h a.m., l.m.t., at the cor. of Tps. 26 & 27 N., Rs. 5 & 6 W., recently established by me, & hereinbefore described, I set off 19°21' N. on the decl. arc, and 35°41' N. on the lat. arc, and determine a meridian with the solar. Thence I run, as per instructions, West, on a random line, on N. bdy. of Tp. At 5 miles, 79.75 chs., I fall 28 lks. N. of the cor. of Tps. 26 & 27 N., Rs. 6 & 7 W., recently established by me, whence I run, N. 89°58' E., on a true line, on N. bdy. of Tp., bet. secs. 6 & 31, Var. 14°30' E. Over heavily rolling land, through scattering cedar and pinon.

0.80 Draw 80 lks. wide, course NE., near head, turns to E., Asc.

4.00 Small spur, brs. NE. & SW., desc.

29.00 Draw 4 chs. wide, course ESE., thence along N. side of same through dense cedar extending to N.

39.75 Set an iron post 3 ft. long, 1 in. in diam. 26 ins. in the ground for ¼ sec. cor., marked on brass cap, ¼ S 31 in N., and S 6 in S. half; from which, A cedar tree 10 ins. diam. brs. N. 7° E. 90 lks. dist., marked ¼ S 31 B T. No other trees available, pits impracticable. Raise a mound of stone 2 ft. base, 1½ ft. high N. of cor.

44.00 Enter draw, course N.

47.70 Main wash, or gulch on E. side of draw, wash, 50 lks. wide course N., asc. steep SW. slope.

70.00 Spur, brs. SSW. & NNE., desc. along E. side of same.

79.75 Set an iron post 3 ft. long, 3 ins. in diam. 24 ins. in the ground for cor. of secs. 5, 6, 31 & 32, marked on brass cap, T 27 N in N., T 26 N in S., and R 6 W in W. half, S 31 in NW., S 32 in NE., S 5 in SE., and S 6 in SW. quad.; from which, A pinon tree 12 ins. diam. brs. N. 14° E. 191 lks. dist., marked T 27 N R 6 W S 32 B T. A scrub oak 6 ins. diam. brs. S. 5° E. 23 lks. dist., marked T 26 N R 6 W S 5 B T. No other trees available, pits impracticable. Raise a mound of stone 2 ft. base, 1½ ft. high W. of cor. Land, rolling, broken. Soil, 3rd rate, stony, gravelly, dry. Cedar, pinon, scrub oak, good grass.

N. 89°58' E., bet. secs. 5 & 32. Over heavily rolling ridges, through scattering cedar and pinon, desc. on ridge.

4.00 Draw, 80 lks. wide, course ENE.

12.00 Spur, brs. NNE. & SSW.

16.00 Draw, 150 lks. wide, course ENE.

28.00 Draw, 150 lks. wide, course NE., dry well about 10 chs. to N., in draw.

40.00 Set an iron post 3 ft. long, 1 in. in diam. 26 ins. in the ground for ¼ sec. cor., marked on brass cap, ¼ S 32 in N., and S 5 in S. half; from which, A cedar tree 10 ins. diam. brs. N. 59° W. 148 lks. dist., marked ¼ S 32 B T. A cedar tree 10 ins. diam. brs. S. 42° E. 175 lks. dist., marked ¼ S 5 B T. Asc. grad. from cor.

42.00 Enter dense cedar, brs. NW. & SE.

50.00 Wooded spur, brs. SE. & NW., desc.

68.00 Gulch, 50 lks. wide, course SE., asc. SW. slope.

76.00 Leave dense cedar, brs. NE. & SW.

Chains.

80.00 Set an iron post 3 ft. long, 3 ins. in diam. 24 ins. in the ground for cor. of secs. 4, 5, 32 & 33, marked on brass cap, T 27 N in N.,
 T 26 N in S., and
 R 6 W in W. half,
 S 32 in NW.,
 S 33 in NE.,
 S 4 in SE., and
 S 5 in SW. quad.; from which,
 A cedar tree 8 ins. diam. brs. N. 35° W. 170 lks. dist.,
 marked T 27 N R 6 W S 32 B T.
 No other bearings available.
 Dig pits 18x18x12 ins. in each sec. 5½ ft. dist., and
 raise a mound of earth 4 ft. base, 2 ft. high W. of cor.
 Land, rolling, broken. Soil, 3rd rate, gravelly, dry.
 Cedar, pinon, good grass.
 At this cor., at noon, I set off 19° 23' N. on the decl.
 arc, and observe the sun on the meridian.
 The resulting lat. is 35° 41' N.

N. 89° 58' E., bet. secs. 4 & 33.

Over heavily rolling, grassy ridges, trend and drain to ENE., desc. along ESE. slope., sparse cedar.

33.00 Draw, 4 chs. wide, course NE., asc.

40.00 Spur, brs. NE. & SW.

Set an iron post 3 ft. long, 1 in. in diam. 26 ins. in the ground for ¼ sec. cor., marked on brass cap,
 ¼ S 33 in N., and
 S 4 in S. half; from which,

A cedar tree 10 ins. diam. brs. S. 15° W. 268 lks. dist.,
 marked ¼ S 4 B T.

A scrub oak 6 ins. diam. brs. N. 23° W. 160 lks. dist.,
 marked ¼ S 33 B T.

74.00 Draw, 80 lks. wide, course NNE., runs into draw 4 chs. wide, running ENE., about 14 chs. to N. of line.

80.00 Set an iron post 3 ft. long, 3 ins. in diam. 24 ins. in the ground for cor. of secs. 3, 4, 33 & 34, marked on brass cap, T 27 N in N.,

T 26 N in S., and
 R 6 W in W. half,
 S 33 in NW.,
 S 34 in NE.,
 S 3 in SE., and
 S 4 in SW. quad.; from which,

A pinon tree 10 ins. diam. brs. N. 61½° E. 70 lks. dist.,
 marked T 27 N R 6 W S 34 B T.

A cedar tree 10 ins. diam. brs. S. 42° E. 47 lks. dist.,
 marked T 26 N R 6 W S 3 B T.

A cedar tree 20 ins. diam. brs. S. 34½° W. 10 lks. dist.,
 marked T 26 N R 6 W S 4 B T.

A cedar tree 10 ins. diam. brs. N. 56½° W. 102 lks. dist.,
 marked T 27 N R 6 W S 33 B T.

Land, rolling heavily, broken.

Soil, 3rd rate, dry, gravelly.

Sparse cedar, pinon, scrub oak, good grass.

Chains.

N. 89°58' E., bet. secs. 3 & 34.

Over heavily rolling land, desc. grad.

40.00 Set an iron post 3 ft. long, 1 in. in diam. 26 ins. in the ground for 1/4 sec. cor., marked on brass cap, 1/4 S 34 in N., and

S 3 in S. half; from which,

An oak tree 5 ins. diam. brs. N. 22 1/4° W. 123 lks. dist., marked 1/4 S 34 B T.

An oak tree 5 ins. diam. brs. S. 41° E. 59 lks. dist., marked 1/4 S 3 B T.

60.00 Long ridge, brs. N. & S., thence on flat top of same.

68.00 Along spur, runs E. & N., from SW.

80.00 Set an iron post 3 ft. long, 3 ins. in diam. 24 ins. in the ground for cor. of secs. 2, 3, 34 & 35, marked on brass cap, T 27 N in N.,

T 26 N in S., and

R 6 W in W. half; from which,

S 34 in NW.,

S 35 in NE.,

S 2 in SE., and

S 3 in SW. quad.; from which,

A cedar tree 30 ins. diam. brs. S. 23° W. 73 lks. dist., marked T 26 N R 6 W S 3 B T.

A cedar tree 24 ins. diam. brs. N. 89° W. 71 lks. dist., marked T 27 N R 6 W S 34 B T.

No other bearings available.

Dig pits 18x18x12 ins. in each sec. 5 1/2 ft. dist., and raise a mound of earth 4 ft. base, 2 ft. high W. of cor.

Land, rolling, hilly.

Soil, 3rd rate, gravelly, dry.

Cedar, pinon, scrub oak, good grass.

N. 89°58' E., bet. secs. 2 & 35.

Over rolling land, desc. through scattering cedar, along top of spur.

24.15 Road, centre of draw, 8 chs. wide, course NNE.

40.00 Set an iron post 3 ft. long, 1 in. in diam. 26 ins. in the ground for 1/4 sec. cor., marked on brass cap, 1/4 S 35 in N., and

S 2 in S. half; from which,

A cedar tree 8 ins. diam. brs. S. 75° W. 88 lks. dist., marked 1/4 S 2 B T.

A cedar tree 10 ins. diam. brs. N. 66° W. 82 lks. dist., marked 1/4 S 35 B T.

68.00 Enter draw, 12 chs. wide, course NW., near head.

80.00 Set an iron post 3 ft. long, 3 ins. in diam. 24 ins. in the ground for cor. of secs. 1, 2, 35 & 36, marked on brass cap, T 27 N in N.,

T 26 N in S., and

R 6 W in W. half,

S 35 in NW.,

S 36 in NE.,

S 1 in SE., and

S 2 in SW. quad.; from which,

A cedar tree 6 ins. diam. brs. N. 4° W. 132 lks. dist., marked T 27 N R 6 W S 35 B T.

A cedar tree 15 ins. diam. brs. N. 16 1/2° E. 83 lks. dist., marked T 27 N R 6 W S 36 B T.

No other trees available.

dig pits 18x18x12 ins. in each sec. 5 1/2 ft. dist., and raise a mound of earth 4 ft. base, 2 ft. high W. of cor.

Land, rolling.

Soil, 3rd rate, gravelly, dry.

Cedar, pinon, good grass.

Chains.

N. 89°58' E., bet. secs. 1 & 36.
 Over heavily rolling land, asc. grad. along SW. slope.
 30.00 Foot of malapais hill, brs. NW. & SE., asc. prec. SW. slope.
 40.00 Top of steep slope, brs. NW. & SE.
 Set an iron post 3 ft. long, 1 in. in diam. 26 ins. in
 the ground for $\frac{1}{4}$ sec. cor., marked on brass cap,
 $\frac{1}{4}$ S 36. in N., and
 S 1 in S. half; from which,
 A cedar tree 12 ins. diam. brs. N. 2 $\frac{1}{4}$ ° W. 12 lks. dist.,
 marked $\frac{1}{4}$ S 36 B T.
 A cedar tree 10 ins. diam. brs. S. 12 $\frac{1}{2}$ ° E. 33 lks. dist.,
 marked $\frac{1}{4}$ S 1 B T.
 Thence along S. side of wooded hill, near top, through
 dense cedar and pinon.
 56.00 Cross hill, brs. WNW. & ESE., desc. steep E. slope.
 70.00 Foot of main slope, brs. N. & S., desc. grad.
 80.00 To cor. of Tps. 26 & 27 N., Rs. 5 & 6 W., hereinbefore described.
 Land, mts.
 Soil, 3rd rate, gravelly, stony.
 Cedar, pinon, scrub oak, fair grass.

General Description.

The North, East, and West Boundaries of T. 26 N., R. 6 W.
 runs over heavily rolling, or broken land, lying on a
 high, broken mesa, covered in places with a dense growth
 of cedar and pinon.

Boundaries of T. 26 N., R. 6 W.
 Latitudes, departures, and closing errors.

Line designated.	True bearing.	Dist. Chs.	Latitudes.		Departures.	
			N. Chs.	S. Chs.	E. Chs.	W. Chs.
South Boundary, ---	S. 89°57' W.	480.20	-----	--0.42	-----	480.20
West Boundary, ---	North, ---	480.00	480.00	-----	-----	-----
North Boundary, ---	N. 89°58' E.	479.75	--0.28	-----	479.75	-----
East Boundary, ---	South, ---	480.00	-----	480.00	-----	-----
Convergency, ---	-----	-----	-----	-----	00.52	-----
Totals, ---	-----	-----	480.28	480.42	480.27	480.20
			-----	480.28	480.20	-----
Error in Lat. ---	-----	-----	-----	0.14	-----	-----
Error in Dep. ---	-----	-----	-----	-----	0.07	-----

May 17, 1912.

Jose B. Wright
 U. S. Surveyor.

Chains.

May 31, 1912.

At 7h a.m., l.m.t., at the cor. of Tps. 26 & 27 N., Rs. 5 & 6 W., recently established by me, & hereinbefore described I set off $21^{\circ}56\frac{1}{2}'$ N. on the decl. arc, and $35^{\circ}41'$ N. on the lat. arc, and determine a meridian with the solar.

Thence I run, as per instructions,

North, on range line, bet. secs. 31 & 36.

Over mts. land, along E. slope, through dense cedar and pinon.

30.00 Cedar becomes scattering, brs. SE. & NW., foot of slope.

40.00 Set an iron post 3 ft. long, 1 in. in diam. 26 ins. in the ground for $\frac{1}{4}$ sec. cor., marked on brass cap,

$\frac{1}{4}$ S 36 in W., and

S 31 in E. half; from which,

A cedar tree 15 ins. diam. brs. S. 31° E. 395 lks. dist., marked $\frac{1}{4}$ S 31 B T.

A cedar tree 12 ins. diam. brs. S. 73° W. 210 lks. dist., marked $\frac{1}{4}$ S 36 B T.

80.00 Set an iron post 3 ft. long, 3 ins. in diam. 24 ins. in the ground for cor. of secs. 25, 30, 31 & 36, marked on brass cap, T 27 N in N. half,

R 6 W S 25 in NW.,

R 5 W S 30 in NE.,

S 31 in SE., and

S 36 in SW. quad.; from which,

A cedar tree 4 ins. diam. brs. S. 42° E. 130 lks. dist., marked T 27 N R 5 W S 31 B T.

A cedar tree 5 ins. diam. brs. S. 82° W. 128 lks. dist., marked T 27 N R 6 W S 36 B T.

A cedar tree 10 ins. diam. brs. N. 86° W. 150 lks. dist., marked T 27 N R 6 W S 25 B T.

No other bearings available, pits impracticable.

Raise a mound of stone 2 ft. base, $1\frac{1}{2}$ ft. high W. of cor.

Land, mts., rolling.

Soil, 3rd rate, gravelly, dry.

Cedar, pinon, good grass.

North, bet. secs. 25 & 30.

Over rolling land, desc. grad.

15.00 Draw, 4 chs. wide, course SSE.

A lone butte brs. E. about 10 chs. dist., asc.

30.00 Malapais ridge, brs. NW. & SE., with fence along edge.

40.00 Set an iron post 3 ft. long, 1 in. in diam. 26 ins. in the ground for $\frac{1}{4}$ sec. cor., marked on brass cap,

$\frac{1}{4}$ S 25 in W., and

S 30 in E. half; from which,

A cedar tree 15 ins. diam. brs. N. 52° E. 135 lks. dist., marked $\frac{1}{4}$ S 30 B T.

A cedar tree 4 ins. diam. brs. S. $41\frac{1}{4}^{\circ}$ W. 142 lks. dist., marked $\frac{1}{4}$ S 25 B T.

80.00 Set an iron post 3 ft. long, 3 ins. in diam. 24 ins. in the ground for cor. of secs. 19, 24, 25 & 30, marked on brass cap, T 27 N in N. half,

R 6 W S 24 in NW.,

R 5 W S 19 in NE.,

S 30 in SE., and

S 25 in SW. quad.; from which,

A cedar tree 5 ins. diam. brs. N. $12\frac{1}{2}^{\circ}$ E. 142 lks. dist., marked T 27 N R 5 W S 19 B T.

A cedar tree 15 ins. diam. brs. S. $29\frac{1}{2}^{\circ}$ E. 212 lks. dist., marked T 27 N R 5 W S 30 B T.

A cedar tree 7 ins. diam. brs. S. $41\frac{1}{2}^{\circ}$ W. 51 lks. dist., marked T 27 N R 6 W S 25 B T.

A cedar tree 10 ins. diam. brs. N. $89\frac{3}{4}^{\circ}$ W. 314 lks. dist., marked T 27 N R 6 W S 24 B T.

Land, rolling.

Soil, 3rd rate, gravelly, sandy, dry.

Cedar, pinon, good grass.

Chains.

North, bet. secs. 19 & 24.
 Over rolling land, asc.

12.00 Top of malapias ridge, brs. ESE. & WNW.,
 19.85 Rim of canyon, brs. NNW. & ESE.
 25.00 Mag. Var. at this point, $15^{\circ}10'$ E.
 32.00 Desc. steep NNE. slope, a tank of water is 12 chs. to E.
 36.00 Desc. grad. ruins of house and fence 2 chs. to E.
 40.00 Set an iron post 3 ft. long, 1 in. in diam. 26 ins. in
 the ground for $\frac{1}{4}$ sec. cor., marked on brass cap,
 $\frac{1}{4}$ S 24 in W., and
 S 19 in E. half;
 No trees available, pits impracticable.
 Raise a mound of stone 2 ft. base, $1\frac{1}{2}$ ft. high W. of cor.

40.60 Wash, 15 lks. wide, course W., from canyon.
 80.00 Set an iron post 3 ft. long, 3 ins. in diam. 24 ins. in
 the ground for cor. of secs. 13, 18, 19 & 24, marked on
 brass cap, T 27 N in N. half,
 R 6 W S 13 in NW.,
 R 5 W S 18 in NE.,
 S 19 in SE., and
 S 24 in SW. quad.; no bearings available.
 dig pits 18x18x12 ins. in each sec. $5\frac{1}{2}$ ft. dist., and
 raise a mound of earth 4 ft. base, 2 ft. high W. of cor.
 Land, rolling.
 Soil, 3rd rate, gravelly, dry, sandy.
 Sparse cedar, pinon, fair grass.
 At this cor. at noon, I set off $21^{\circ}57\frac{1}{2}'$ N. on the decl.
 arc, and observe the sun on the meridian.
 The resulting lat. is $35^{\circ}43\frac{1}{2}'$ N.

North, bet. secs. 13 & 18.
 Over rolling land.

19.35 Wire fence, brs. S. 85° W. & N. 35° E.
 35.00 Enter point of scattering cedar from E.
 40.00 Set an iron post 3 ft. long, 1 in. in diam. 26 ins. in
 the ground for $\frac{1}{4}$ sec. cor., marked on brass cap,
 $\frac{1}{4}$ S 13 in W., and
 S 18 in E. half; from which,
 A cedar tree 18 ins. diam. brs. S. 31° E. 231 lks. dist.,
 marked $\frac{1}{4}$ S 18 B T.
 A cedar tree 12 ins. diam. brs. N. 72° W. 148 lks. dist.,
 marked $\frac{1}{4}$ S 13 B T.

70.00 Top of low ridge, brs. NW. & SE.
 80.00 Set an iron post 3 ft. long, 3 ins. in diam. 24 ins. in
 the ground for cor. of secs. 7, 12, 13 & 18, marked on
 brass cap, T 27 N in N. half,
 R 6 W S 12 in NW.,
 R 5 W S 7 in NE.,
 S 18 in SE., and
 S 13 in SW. quad.; from which,
 A cedar tree 14 ins. diam. brs. N. 47° E. 115 lks. dist.,
 marked T 27 N R 5 W S 7 B T.
 A cedar tree 10 ins. diam. brs. S. $15\frac{1}{2}^{\circ}$ E. 42 lks. dist.,
 marked T 27 N R 5 W S 18 B T.
 A cedar tree 20 ins. diam. brs. S. 57° W. 18 lks. dist.,
 marked T 27 N R 6 W S 13 B T.
 A cedar tree 8 ins. diam. brs. N. $56\frac{1}{2}^{\circ}$ W. 54 lks. dist.,
 marked T 27 N R 6 W S 12 B T.

Land, rolling.
 Soil, 3rd rate, sandy, gravelly, loose, dry.
 Scattering cedar, pinon, good grass.

Chains.

North, bet. secs. 7 & 12.

Over rolling land, desc., through scattering cedar.
40.00 Set an iron post 3 ft. long, 1 in. in diam. 26 ins. in the ground for 1/4 sec. cor., marked on brass cap, 1/4 S 12 in W., and 1/4 S 7 in E. half; No trees available. dig pits 18x18x12 ins. N. & S. of cor. 3 ft. dist., and raise a mound of earth 3 1/2 ft. base, 1 1/2 ft. high W. of cor.

41.00 Draw 4 chs. wide, course E.

61.54 Wire fence, brs. S. 34 1/2° W. & N. 34 1/2° E.

73.50 Wire fence, brs. N. 40° W. & S. 40° E., cors. to NW.

75.00 Top of ridge, brs. NW. & SE., desc.

30.00 Set an iron post 3 ft. long, 3 ins. in diam. 24 ins. in the ground for cor. of secs. 1, 6, 7 & 12, marked on brass cap, T 27 N in N. half,

R 6 W S 1 in NW.,

R 5 W S 6 in NE.,

S 7 in SE., and

S 12 in SW. quad.; from which,

A cedar tree 16 ins. diam. brs. N. 69° E. 96 lks. dist., marked T 27 N R 5 W S 6 B T.

A cedar tree 6 ins. diam. brs. S. 63° E. 17 lks. dist., marked T 27 N R 5 W S 7 B T.

A cedar tree 12 ins. diam. brs. S. 13° W. 105 lks. dist., marked T 27 N R 6 W S 12 B T.

A pinon tree 14 ins. diam. brs. N. 56° W. 48 lks. dist., marked T 27 N R 6 W S 1 B T.

Land, rolling.

Soil, 3rd rate, sandy, gravelly, dry, loose.

Cedar, pinon, good grass.

From the above cor., a windmill at ranch house brs.

N. 33° 32' E..

A wire fence is 5.53 chs. to W. of this cor., runs NNE.

North, bet. secs. 1 & 6.

Over rolling land.

11.85 Wire fence, brs. N. 89° W. & S. 89° E., cross fence joins same 4 chs. to W.

16.30 Wash, 45 lks. wide, course ENE.

35.80 Wire fence, brs. S. 85° W. & N. 85° E., asc.

40.00 Set an iron post 3 ft. long, 1 in. in diam. 26 ins. in the ground for 1/4 sec. cor., marked on brass cap, 1/4 S 1 in W., and 1/4 S 6 in E. half; no bearings available.

dig pits 18x18x12 ins. N. & S. of cor. 3 ft. dist., and raise a mound of stone covered with earth 4 ft. base 2 ft. high W. of cor.

Windmill brs. S. 63° 40' E.

52.00 Top of rise, brs. E. & W.

80.00 Set an iron post 3 ft. long, 3 ins. in diam. 24 ins. in the ground for cor. of Tps. 27 & 28 N., Rs. 5 & 6 W., marked on brass cap,

T 28 N in N.,

T 27 N in S.,

R 5 W in E., and

R 6 W in W. half;

S 36 in NW.,

S 31 in NE.,

S 6 in SE., and

S 1 in SW. quad.; from which,

A cedar tree 10 ins. diam. brs. N. 89 1/2° E. 565 lks. dist., marked T 28 N R 5 W S 31 B T.

A cedar tree 15 ins. diam. brs. S. 72 3/4° E. 203 lks. dist., marked T 27 N R 5 W S 6 B T.

A cedar tree 12 ins. diam. brs. S. 20° W. 76 lks. dist., marked T 27 N R 6 W S 1 B T.

A cedar tree 8 ins. diam. brs. N. 77 1/2° W. 82 lks. dist., marked T 28 N R 6 W S 36 B T.

Land, rolling, hilly. Soil, 3rd rate, sandy, gravelly, dry. Cedar, pinon, good grass.

May 31, 1912.

Chains

- June 1, 1912.
At 7h a.m., 1.m.t., at the cor. of Tps. 27 & 28 N., Rs. 5 & 6 W., recently established by me, & hereinbefore described.
I set off $22^{\circ}05'$ N. on the decl. arc, and $35^{\circ}46'$ N. on the lat. arc, and determine a meridian with the solar. Thence I run, as per instructions,
West, on Tp. line, bet. secs. 1 & 36.
Over rolling land, sparse cedar and pinon.
Var. $14^{\circ}30'$ E.
- 27.35 Road, brs. N. & S.
40.00 Set an iron post 3 ft. long, 1 in. in diam. 26 ins. in the ground for $\frac{1}{4}$ sec. cor., marked on brass cap,
 $\frac{1}{4}$ S 36 in N., and
S 1 in S. half; from which
A cedar tree 5 ins. diam. brs. S. $78\frac{1}{2}^{\circ}$ E. 68 lks. dist., marked $\frac{1}{4}$ S 1 B.T.
A cedar tree 12 ins. diam. brs. N. $68\frac{1}{4}^{\circ}$ W. 120 lks. dist., marked $\frac{1}{4}$ S 36 B.T.
- 47.00 Desc. prec. WNW. slope.
53.00 Enter broad draw.
63.00 Wash, 30 lks. wide, course ESE.
74.00 Road, Pine Springs to Ranches to SE., brs. NW. & SE.
79.45 Wash, 50 lks. wide, course SE.
80.00 Set an iron post 3 ft. long, 3 ins. in diam. 24 ins. in the ground for cor. of secs. 1, 2, 35 & 36, marked on brass cap, T 28 N in N.,
T 27 N in S., and
R 6 W in W. half,
S 35 in NW.,
S 36 in NE.,
S 1 in SE., and
S 2 in SW. quad.; No trees available.
dig pits 18x18x12 ins. in each sec. $5\frac{1}{2}$ ft. dist., and raise a mound of earth 4 ft. base, 2 ft. high W. of cor.
Land, rolling, hilly.
Soil, 3rd rate, sandy, loose, gravelly, dry.
Sparse cedar, pinon, good grass.
- West, bet. secs. 2 & 35.
Over rolling land, desc. grad.
- 1.12 Wash, 30 lks. wide, course ESE.
4.20 Wash, 30 lks. wide, course NE.
40.00 Set an iron post 3 ft. long, 1 in. in diam. 26 ins. in the ground for $\frac{1}{4}$ sec. cor., marked on brass cap,
 $\frac{1}{4}$ S 35 in N., and
S 2 in S. half; from which,
A cedar tree 15 ins. diam. brs. N. 55° E. 325 lks. dist., marked $\frac{1}{4}$ S 35 B.T.
No other trees available.
Dig pits 18x18x12 ins. E. & W. of cor. 3 ft. dist., and raise a mound of earth $3\frac{1}{2}$ ft. base, $1\frac{1}{2}$ ft. high N. of cor.
80.00 Set an iron post 3 ft. long, 3 ins. in diam. 24 ins. in the ground for cor. of secs. 2, 3, 34 & 35, marked on brass cap, T 28 N in N.,
T 27 N in S., and
R 6 W in W. half;
S 34 in NW.,
S 35 in NE.,
S 2 in SE., and
S 3 in SW. quad.; from which,
A cedar tree 20 ins. diam. brs. N. $58\frac{1}{2}^{\circ}$ E. 145 lks. dist., marked T 28 N R 6 W S 35 B.T.
A cedar tree 24 ins. diam. brs. N. $3\frac{1}{2}^{\circ}$ W. 113 lks. dist., marked T 28 N R 6 W S 34 B.T.
No other trees available.
dig pits 18x18x12 ins. in each sec. $5\frac{1}{2}$ ft. dist., and raise a mound of earth 4 ft. base, 2 ft. high W. of cor.
Land, rolling. Soil, 3rd rate, sandy, loose, gravelly, dry.
Cedar, pinon, good grass.

Chains.

West, bet, secs. 3 & 34.

Over rolling land, through scattering cedar.

32.00 Draw, 4 chs. wide, course SE., from W.

Asc. grad. along S. side of same.

40.00 Set an iron post 3 ft. long, 1 in. in diam. 26 ins. in the ground for 1/4 sec. cor., marked on brass cap,

1/4 S 34 in N., and
S 3 in S. half; from which,

A cedar tree 12 ins.diam.brs. N.87°E. 226 lks. dist., marked 1/4 S 34 B T.

A cedar tree 6 ins.diam.brs. S.33 1/4°E.418 lks. dist., marked 1/4 S 3 B T.

80.00 Set an iron post 3 ft. long, 3 ins. in diam. 24 ins. in the ground for cor. of secs. 3,4,33 & 34, marked on brass cap, T 28 N in N.,

T 27 N in S., and
R 6 W in W. half,

S 33 in NW.,
S 34 in NE.,
S 3 in SE., and

S 4 in SW. quad.; from which,

A cedar tree 10 ins.diam.brs. S.18 3/4°E. 140 lks. dist., marked T 27 N R 6 W S 3 B T.

A cedar tree 10 ins.diam.brs. S.7 1/2°W. 38 lks. dist., marked T 27 N R 6 W S 4 B T.

No other trees available,
dig pits 18x18x12 ins. in each sec. 5 1/2 ft.dist., and
raise a mound of earth 4 ft.base, 2 ft.high W.of cor.

Land, rolling.

Soil, 3rd rate, gravelly, dry.

Cedar, pinon, good grass.

At this cor., at noon, I set off 22°05 1/2' N. on the decl. arc, and observe the sun on the meridian.

The resulting lat. is 35°46' N.

West, bet. secs. 33 & 4.

Over rolling land, along S. side of draw to E., through large scattering cedars.

40.00 Set an iron post 3 ft. long, 1 in. in diam. 26 ins. in the ground for 1/4 sec. cor., marked on brass cap,

1/4 S 33 in N., and
S 4 in S. half; from which,

A cedar tree 12 ins.diam.brs. N.77°W. 220 lks. dist., marked 1/4 S 33 B T.

A cedar tree 4 ins.diam.brs. S.69°E. 189 lks. dist., marked 1/4 S 4 B T.

60.00 Enter dense cedar, brs. NW. & SE.

80.00 Set an iron post 3 ft. long, 3 ins. in diam. 24 ins. in the ground for cor. of secs. 4,5,32 & 33, marked on brass cap, T 28 N in N.,

T 27 N in S., and
R 6 W in W. half,

S 32 in NW.,
S 33 in NE.,
S 4 in SE., and

S 5 in SW. quad.; from which,

A cedar tree 20 ins.diam.brs. N.30°E. 155 lks. dist., marked T 28 N R 6 W S 33 B T.

A cedar tree 18 ins.diam.brs. S.24 1/4°E.125 lks. dist., marked T 27 N R 6 W S 4 B T.

A cedar tree 18 ins.diam.brs. S.57°W. 133 lks. dist., marked T 27 N R 6 W S 5 B T.

A cedar tree 18 ins.diam.brs. N.85 1/2°W.440 lks. dist., marked T 28 N R 6 W S 32 B T.

Land, rolling.

Soil, 3rd rate, gravelly, dry.

Cedar, pinon, fine grass.

Chains.

West, bet. secs. 5 & 32.
 Over rolling land, through dense cedar.

10.00 Draw 50 lks. wide, course S., heads 6 chs. N.
 28.00 Leave dense cedar, brs. NW. & SE., desc. grad.
 34.55 Wash, 20 lks. wide, course ESE., in draw, 10 chs. wide,
 40.00 Set an iron post 3 ft. long, 1 in. in diam. 26 ins. in
 the ground for $\frac{1}{4}$ sec. cor., marked on brass cap,
 $\frac{1}{4}$ S 32 in N., and
 S 5 in S. half; from which,
 A cedar tree 20 ins. diam. brs. S. 59° W. 212 lks. dist.,
 marked $\frac{1}{4}$ S 5 B T.
 No other trees available.
 dig pits 18x18x12 ins. E. & W. of cor. 3 ft. dist., and
 raise a mound of earth $3\frac{1}{2}$ ft. base, $1\frac{1}{2}$ ft. high N. of cor.

50.60 Road, brs. brs. ESE. & WNW., in middle of draw, 8 chs.
 wide, course ESE.

60.00 Enter dense cedar, brs. NW. & SE.
 80.00 Set an iron post 3 ft. long, 3 ins. in diam. 24 ins. in
 the ground for cor. of secs. 5, 6, 31 & 32, marked on
 brass cap, T 28 N in N.,
 T 27 N in S., and
 R 6 W in W. half,
 S 31 in NW.,
 S 32 in NE.,
 S .5 in SE., and
 S 6 in SW. quad.; from which,
 A cedar tree 20 ins. diam. brs. N. 42° E. 59 lks. dist.,
 marked T 28 N R 6 W S 32 B T.
 A cedar tree 20 ins. diam. brs. S. 39 $\frac{1}{4}$ ° E. 54 lks. dist.,
 marked T 27 N R 6 W S 5 B T.
 A cedar tree 6 ins. diam. brs. S. 54° W. 56 lks. dist.,
 marked T 27 N R 6 W S 6 B T.
 A pinon tree 8 ins. diam. brs. N. 78° W. 49 lks. dist.,
 marked T 28 N R 6 W S 31 B T.

Land, rolling. Soil, 3rd rate, gravelly, dry.
 Cedar, pinon, good grass.

West, bet. secs. 6 & 31.
 Over rolling land, through dense heavy cedar and pinon.

40.00 Set an iron post 3 ft. long, 1 in. in diam. 26 ins. in
 the ground for $\frac{1}{4}$ sec. cor., marked on brass cap,
 $\frac{1}{4}$ S 31 in N., and
 S 6 in S. half; from which,
 A pinon tree 6 ins. diam. brs. N. 71° E. 11 lks. dist.,
 marked $\frac{1}{4}$ S 31 B T.
 A pinon tree 6 ins. diam. brs. S. 65° E. 17 lks. dist.,
 marked $\frac{1}{4}$ S 6 B T.

44.95 Intersect SE. Boundary Line of Hualpai Indian Reservation,
 at a point whence,
 89 mile cor. on said line brs. N. 50° E. 21.17 chs. dist.,
 which is a sandstone 10x6x8 ins. above ground, marked and
 and witnessed as described by the Surveyor-General.
 Set an iron post 3 ft. long, 3 ins. in diam. 24 ins. in
 the ground for closing cor. of Tps. 27 & 28 N., R. 6 W.,
 marked on brass cap,
 C C W. of centre,
 H I R in NW., and
 R 6 W in SE. half,
 T 28 N S 31 in NE., and
 T 27 N S 6 in SE. sectors; from which,
 A cedar tree 20 ins. diam. brs. N. 78° E. 511 lks. dist.,
 marked T 28 N R 6 W S 31 C C B T.
 A cedar tree 20 ins. diam. brs. S. 89° E. 137 lks. dist.,
 marked T 27 N R 6 W S 6 C C B T.

Land, rolling. Soil, 3rd rate, gravelly, loose, dry.
 Cedar, pinon, scrub oak, good grass.

June 1, 1912.

Chains

June 2, 1912.

At 7h a.m., l.m.t., at the cor. of Tps. 26 & 27 N., Rs. 6 & 7 W., recently established by me, & hereinbefore described I set off 22°12' N. on the decl. arc, and 35°41' N. on the lat. arc, and determine a meridian with the solar. Thence I run, as per instructions,

North, bet. secs. 31 & 36.

Var. 15° E.

Over mts. land, asc.

- 4.00 Spur, brs. NE. & SW., desc.
- 16.00 Draw, 4 chs. wide, course E., asc. through dense cedar, brs. E. & W.
- 30.00 Asc. steep.
- 38.00 Ridge, brs. E. & W., desc.
- 40.00 Set an iron post 3 ft. long, 1 in. in diam. 26 ins. in the ground for 1/4 sec. cor., marked on brass cap, 1/4 S 36 in W., and S 31 in E. half; from which,
 - A cedar tree 10 ins. diam. brs. N. 69° E. 281 lks. dist., marked 1/4 S 31 B T.
 - A cedar tree 6 ins. diam. brs. S. 19° W. 76 lks. dist., marked 1/4 S 36 B T.
 Thence along N. side of spur to N.
- 54.00 Desc. N. end of spur.
- 80.00 Set an iron post 3 ft. long, 3 ins. in diam. 24 ins. in the ground for cor. of secs. 25, 30, 31 & 36, marked on brass cap, T 27 N in N., R 6 W in E., and R 7 W in W. half, S 25 in NW., S 30 in NE., S 31 in SE., and S 36 in SW. quad.; from which,
 - A cedar tree 12 ins. diam. brs. N. 29° W. 147 lks. dist., marked T 27 N R 7 W S 25 B T.
 No other trees available, pits impracticable. Raise a mound of stone 2 ft. base, 1 1/2 ft. high W. of cor. Land, mts. Soil, 3rd rate, gravelly, dry. Cedar, pinon, scrub oak, few junipers, good grass.

North, bet. secs. 25 & 30.

Over mts. land, desc.

- 17.00 Draw, 2 chs. wide, course ENE.
- 35.00 Draw, 1 ch. wide, course ENE.
- 40.00 Set an iron post 3 ft. long, 1 in. in diam. 26 ins. in the ground for 1/4 sec. cor., marked on brass cap, 1/4 S 25 in W., and S 30 in E. half; from which,
 - A cedar tree 8 ins. diam. brs. S. 38° E. 19 lks. dist., marked 1/4 S 30 B T.
 - A cedar tree 6 ins. diam. brs. S. 75° W. 28 lks. dist.; marked 1/4 S 25 B T.
- 80.00 Set an iron post 3 ft. long, 3 ins. in diam. 24 ins. in the ground for cor. of secs. 19, 24, 25 & 30, marked on brass cap, T 27 N in N., R 6 W in E., and R 7 W in W. half, S 24 in NW., S 19 in NE., S 30 in SE., and S 25 in SW. quad; from which,
 - A cedar tree 10 ins. diam. brs. N. 54° E. 262 lks. dist., marked T 27 N R 6 W S 19 B T.
 - A cedar tree 10 ins. diam. brs. S. 39 1/2° E. 265 lks. dist., marked T 27 N R 6 W S 30 B T.
 - A cedar tree 14 ins. diam. brs. S. 20 1/2° W. 412 lks. dist., marked T 27 N R 7 W S 25 B T.
 - A cedar tree 12 ins. diam. brs. N. 80° W. 187 lks. dist., marked T 27 N R 7 W S 24 B T.
 Land, mts., rolling. Soil, 3rd rate, gravelly, dry. Cedar, pinon, good grass.

Chains.

North, bet. secs. 19 & 24.
 Over rolling land, enter draw.
 2.00 Leave draw, asc. through dense cedar.
 14.00 Ridge, brs. NE. & SW., desc. through scattering cedar.
 36.00 Enter draw, course ENE.
 40.00 Set an iron post 3 ft. long, 1 in. in diam. 26 ins. in
 the ground for $\frac{1}{4}$ sec. cor., marked on brass cap,
 $\frac{1}{4}$ S 24 in W., and
 S 19 in E. half; No trees available.
 dig pits 18x18x12 ins. N. & S. of cor. 3 ft. dist., and
 raise a mound of earth $3\frac{1}{2}$ ft. base, $1\frac{1}{2}$ ft. high W. of cor.
 44.00 Leave draw, asc. grad.
 54.00 Flat draw, 4 chs. wide, course ENE., asc.
 74.00 Ridge, brs. NE. & SW., desc.
 80.00 Set an iron post 3 ft. long, 3 ins. in diam. 24 ins. in
 the ground for cor. of secs. 13, 18, 19 & 24, marked on
 brass cap, T 27 N in N.,
 R 6 W in E., and
 R 7 W in W. half;
 S 13 in NW.,
 S 18 in NE.,
 S 19 in SE., and
 S 24 in SW. quad.; from which,
 A cedar tree 6 ins. diam. brs. N. 7° E. 275 lks. dist.,
 marked T 27 N R 6 W S 18 B T.
 A cedar tree 15 ins. diam. brs. S. 83° E. 182 lks. dist.,
 marked T 27 N R 6 W S 19 B T.
 An oak tree 4 ins. diam. brs. S. 37° W. 353 lks. dist.,
 marked T 27 N R 7 W S 24 B T.
 A pinon tree 10 ins. diam. brs. N. $39\frac{1}{2}^{\circ}$ W. 282 lks. dist.,
 marked T 27 N R 7 W S 13 B T.
 Land, mts., broken, rolling.
 Soil, 3rd rate, sandy, gravelly, dry.
 Cedar, pinon, good grass.
 At this cor., at noon, I set off $22^{\circ}13\frac{1}{2}'$ N. on the decl.
 arc, and observe the sun on the meridian.
 The resulting lat. is $35^{\circ}43\frac{1}{2}'$ N.

North, bet. secs. 13 & 18.
 Over heavily rolling land, desc. grad.
 14.18 Draw 4 chs. wide, course ENE., turns to NE., asc. grad.
 40.00 Set an iron post 3 ft. long, 1 in. in diam. 26 ins. in
 the ground for $\frac{1}{4}$ sec. cor., marked on brass cap,
 $\frac{1}{4}$ S 18 in W., and
 S 18 in E. half; from which,
 A pinon tree 14 ins. diam. brs. S. 17° E. 129 lks. dist.,
 marked $\frac{1}{4}$ S 18 B T.
 A pinon tree 12 ins. diam. brs. S. 31° W. 207 lks. dist.,
 marked $\frac{1}{4}$ S 13 B T.
 48.00 Ridge, brs. SW. & NE. desc. grad., leave timber.
 80.00 Set an iron post 3 ft. long, 3 ins. in diam. 24 ins. in
 the ground for cor. of secs. 7, 12, 13 & 18, marked on
 brass cap, T 27 N in N.,
 R 6 W in E., and
 R 7 W in W. half;
 S 12 in NW.,
 S 7 in NE.,
 S 18 in SE., and
 S 13 in SW. quad.;
 No trees available, pits impracticable.
 Raise a mound of stone 2 ft. base, $1\frac{1}{2}$ ft. high W. of cor.
 Land, mts., rolling.
 Soil, 3rd rate, gravelly, dry, stony.
 Cedar, pinon, good grass.

West Boundary T. 27 N., R. 6 W.

Chains.

North, bet. secs. 7 & 12.

Over rolling land, desc. grad.

26.30 Wash, 10 lks. wide, course ENE., in draw 10 chs. wide.

40.00 Set an iron post 3 ft. long, 1 in. in diam. 26 ins. in the ground for 1/4 sec. cor., marked on brass cap, 1/4 S 12 in W., and S 7 in E. half;

No trees available, pits impracticable.

Raise a mound of stone 2 ft. base, 1 1/2 ft. high W. of cor.

Top of spur, brs. SE. & NW., desc. grad.

50.00 Enter draw, course ENE.

80.00 Set an iron post 3 ft. long, 3 ins. in diam. 24 ins. in the ground for cor. of secs. 1, 6, 7 & 12, marked on brass cap, T 27 N in N., R 6 W in E., and R 7 W in W. half, S 1 in NW., S 6 in NE., S 7 in SE., and S 12 in SW. quad.; from which,

A cedar tree 24 ins. diam. brs. N. 15° E. 58 lks. dist., marked T 27 N R 6 W S 6 B T.

A cedar tree 14 ins. diam. brs. S. 60° E. 27 lks. dist., marked T 27 N R 6 W S 7 B T.

A pinon tree 12 ins. diam. brs. S. 39° W. 38 lks. dist., marked T 27 N R 7 W S 12 B T.

A cedar tree 15 ins. diam. brs. N. 7° W. 36 lks. dist., marked T 27 N R 7 W S 1 B T.

Land, rolling. Soil, 3 rd rate, gravelly, dry, loose. Cedar, pinon, good native grass.

North, bet. secs. 1 & 6.

Over rolling land.

12.00 Draw, 8 chs. wide, course ENE.

40.00 Set an iron post 3 ft. long, 1 in. in diam. 26 ins. in the ground for 1/4 sec. cor., marked on brass cap, 1/4 S 1 in W., and S 6 in E. half; from which,

A cedar tree 15 ins. diam. brs. N. 68° W. 217 lks. dist., marked 1/4 S 1 B T.

A scrub oak tree 4 ins. diam. brs. N. 44° E. 59 lks. dist., marked 1/4 S 6 B T.

51.20 Intersect SE. Boundary Line of Hualpai Indian Reservation, at a point whence,

The 88 mile cor. on said line brs. S. 50° W. 13.96 chs. dist., which is a sandstone 10x6x6 ins. above ground, marked and witnessed as described by the Surveyor-General

Set an iron post 3 ft. long, 3 ins. in diam. 24 ins. in the ground for closing cor. of Tps. 27 N., Rs. 6 & 7 W., marked on brass cap,

C C E. of centre,

H I R in NW., and

T 27 N in SE. half,

S 6, R 6 W, in SE., and

S 1, R 7 W, in SW. sectors; from which,

A cedar tree 12 ins. diam. brs. S. 33° E. 42 lks. dist., marked T 27 N R 6 W S 6 C C B T.

A pinon tree 10 ins. diam. brs. S. 40° W. 37 lks. dist., marked T 27 N R 7 W S 1 C C B T.

Land, rolling. Soil, 3rd rate, gravelly, dry. Cedar, pinon, scrub oak, good grass.

T. 27 N., R. 6 W.
 General Description.
 The East, West, and North Boundaries of T. 27 N., R.6 W. run over a high rolling, broken mesa, well covered in places with dense cedar and pinon, and some pine trees, but none of any timber value.

T. 27 N., R. 6 W.
 Latitudes, departures and closing errors.

Line designated.	True bearing.	Dist.	Latitudes.		Departures.	
			N. Chs.	S. Chs.	E. Chs.	W. Chs.
South Boundary,--	S.89°58'W.	479.75	-----	--0.28	-----	479.75
West Boundary,---	North,---	451.20	451.20	-----	-----	-----
SE.Bdy.Hual.InRes.	N.50°E.---	44.87	28.84	-----	34.37	-----
North Boundary,--	East,---	444.95	-----	-----	444.95	-----
East Boundary,---	South,---	480.00	-----	480.00	-----	-----
Convergency,---	-----	-----	-----	-----	--0.52	-----
Totals,-----	-----	-----	480.04	480.28	479.84	479.75
			-----	480.04	479.75	-----
			-----	-----	-----	-----
	Error in Lat.	-----	-----	-0.24	-----	-----
	Error in Dep.	-----	-----	-----	-0.09	-----

June 2, 1912.

James B. Wright

 U. S. Surveyor.

Chains

May 23, 1912.

At 7h a.m., l.m.t., at the cor. of Tps. 26 & 27 N., Rs. 6 & 7 W., recently established by me, & hereinbefore described.

I set off 20°36' N. on the decl. arc, and 35°41' N. on the lat. arc, and determine a meridian with the solar. Thence I run, as per instructions,

West, on a random line, on N. bdy. of Tp.,

At 6 miles, 0.49 chs., I intersect the W. bdy. of The tp. 3 lks. S. of cor. of Tpd. 26 & 27 N., Rs. 7 & 8 W., heretofore established and described by W.H.Elliott, whence I run,

East, on a true line, on Tp. line, bet. secs. 6 & 31. Var. 15° E.

Over undulating valley.

32.00 Road, brs. SSE. & NNW.

40.49 Set an iron post 3 ft. long, 1 in. in diam. 26 ins. in the ground for 1/4 sec. cor., marked on brass cap, 1/4 S 31 in N., and S 6 in S. half;

No trees available.

Dig pits 18x18x12 ins. E. & W. of cor. 3 ft. dist., and raise a mound of earth 3 1/2 ft. base, 1 1/2 ft. high N. of cor.

42.35 Pipe line, brs. NNW. & SSE., from Pine Spring to tanks to S.

74.00 Foot of ridge, brs. N. & S., asc.

~~80.49~~ 80.23 Set an iron post 3 ft. long, 3 ins. in diam. 24 ins. in the ground for cor. of secs. 5, 6, 31 & 32, marked on brass cap, T 27 N in N.,

T 26 N in S., and
R 7 W in W. half,
S 31 in NW.,
S 32 in NE.,
S 5 in SE., and
S 6 in SW. quad.;

No bearings available, pits impracticable.

Raise a mound of stone 2 ft. base, 1 1/2 ft. high W. of cor.

Land, rolling.

Soil, 3rd rate, gravelly, sandy, loose.

Sparse sage brush, cacti, good native grass.

East, bet. secs. 5 & 32.

Over mts. land, asc. SW. slope of limestone ridge.

6.00 Top of ridge, brs. NNW. & SSE., desc.

31.00 Foot of slope, brs. NW. & SE., ridge ends 20 chs. to SSE.

40.00 Set an iron post 3 ft. long, 1 in. in diam. 26 ins. in the ground for 1/4 sec. cor., marked on brass cap, 1/4 S 32 in N., and S 5 in S. half;

No bearings available,

dig pits 18x18x12 ins. E. & W. of cor. 3 ft. dist., and raise a mound of earth 3 1/2 ft. base, 1 1/2 ft. high N. of cor.

47.00 Enter smooth valley, fine sandy loam.

30.00 Set an iron post 3 ft. long, 3 ins. in diam. 24 ins. in the ground for cor. of secs. 4, 5, 32 & 33, marked on brass cap; T 27 N in N.,

T 26 N in S., and
R 7 W in W. half,
S 32 in NW.,
S 33 in NE.,
S 4 in SE., and
S 5 in SW. quad.;

No bearings available,

dig pits 18x18x12 ins. in each sec. 5 1/2 ft. dist., and raise a mound of earth 4 ft. base, 2 ft. high W. of cor.

Land, rolling, hilly.

Soil, 2nd & 3rd rate, sandy, stony, gravelly, dry, loose.

Sage brush, greasewood, cacti, good grass.

At this cor., at noon, I set off 20°38' N. on the decl. arc, and observe the sun on the meridian.

The resulting lat. is 35°41' N.

Chains.

East, bet. secs. 33 & 4.
 Over level plain.
 28.40 Wash, 25 lks. wide, course S., centre of drainage.
 40.00 Set an iron post 3 ft. long, 1 in. in diam. 26 ins. in
 the ground for $\frac{1}{4}$ sec. cor., marked on brass cap,
 $\frac{1}{4}$ S 33 in N., and
 S 4 in S. half;
 dig pits 18x18x12 ins. E. & W. of cor. 3 ft. dist., and
 raise a mound of earth $3\frac{1}{2}$ ft. base, $1\frac{1}{2}$ ft. high N. of cor.
 60.00 Asc. grad. W. slope.
 80.00 Set an iron post 3 ft. long, 3 ins. in diam. 24 ins. in
 the ground for cor. of secs. 3, 4, 33 & 34, marked on
 brass cap, T 27 N in N.,
 T 26 N in S., and
 R 7 W in W. half,
 S 33 in NW.,
 S 34 in NE.,
 S 3 in SE., and
 S 4 in SW. quad.;
 dig pits 18x18x12 ins. in each sec. $5\frac{1}{2}$ ft. dist., and
 raise a mound of earth 4 ft. base, 2 ft. high W. of cor.
 Land, rolling, level.
 Soil, 2nd & 3rd rate, sandy, gravelly, dry, loose.
 Sage brush, cacti, greasewood, good grass.

East, bet. secs. 3 & 34.
 Over rolling land, asc. grad. W. slope.
 6.00 Enter dense cedar, pinon, and brush, brs. N. & S.
 20.00 Leave timber, brs. N. & S.
 24.00 Asc. prec., leave valley, brs. NNW. & SSE.
 36.00 Top of sharp spur, brs. NNW. & SSE., desc.
 39.25 Gulch, 10 lks. wide, course NNW., asc.
 40.00 Set an iron post 3 ft. long, 1 in. in diam. 26 ins. in
 the ground for $\frac{1}{4}$ sec. cor., marked on brass cap,
 $\frac{1}{4}$ S 34 in N., and
 S 3 in S. half;
 Raise a mound of stone 2 ft. base, $1\frac{1}{2}$ ft. high N. of cor.
 44.00 Top of slope, brs. NNW. & SSE., desc. through dense timber
 and brush.
 55.00 Gulch, 150 lks. wide, course WNW.,
 57.50 Same gulch, course WSW.
 67.00 Same, gulch, course WNW., asc. pred. WSW. slope.
 80.00 Set an iron post 3 ft. long, 3 ins. in diam. 6 ins. in
 the ground, on prec. W. slope, on bed-rock, in mound
 of stone for cor. of secs. 2, 3, 34 & 35, marked on
 brass cap, T 27 N in N.,
 T 26 N in S., and
 R 7 W in W. half,
 S 34 in NW.,
 S 35 in NE.,
 S 2 in SE., and
 S 3 in SW. quad.; from which;
 A cedar tree 8 ins. diam. brs. N. 17° E. 56 lks. dist.,
 marked T 27 N R 7 W S 35 B T.
 A pinon tree 14 ins. diam. brs. S. 40° E. 44 lks. dist.,
 marked T 26 N R 7 W S 2 B T.
 A cedar tree 12 ins. diam. brs. S. 12° W. 21 lks. dist.,
 marked T 26 N R 7 W S 3 B T.
 A cedar tree 8 ins. diam. brs. N. 83° W. 17 lks. dist.,
 marked T 27 N R 7 W S 34 B T.
 Land, mts., rough.
 Soil, 3rd rate, stony.
 Cedar, pinon, scrub oak, good grass in valley.

Chains.

- East, bet. secs. 2 & 35.
- Over mts. land, asc. prec. WSW. slope, dense timber.
- 12.20 Head of steep canyon, course WSW., asc. prec. W. slope.
- 24.00 Top of divide, brs. NE. & SW., desc.
- 40.00 Set an iron post 3 ft. long, 1 in. in diam. 26 ins. in the ground for $\frac{1}{4}$ sec. cor., marked on brass cap,
 - $\frac{1}{4}$ S 35 in N., and
 - S 2 in S. half; from which,
 - A cedar tree 10 ins. diam. brs. S. 18° E. 28 lks. dist., marked $\frac{1}{4}$ S 2 B T.
 - A cedar tree 8 ins. diam. brs. N. 49° W. 17 lks. dist., marked $\frac{1}{4}$ S 35 B T.
- 50.00 Draw, 1 ch. wide, course ENE, asc.
- 65.00 Spur, brs. ENE., desc. along same., scattering cedar.
- 80.00 Set an iron post 3 ft. long, 3 ins. in diam. 24 ins. in the ground for cor. of secs. 1, 2, 35 & 36, marked on brass cap,
 - T 27 N in N.,
 - T 26 N in S., and
 - R 7 W in W. half,
 - S 35 in NW.,
 - S 36 in NE.,
 - S 1 in SE., and
 - S 2 in SW. quad.; from which,
 - A scrub oak 4 ins. diam. brs. N. 11° E. 65 lks. dist., marked T 27 N R 7 W S 36 B T.
 - A cedar tree 12 ins. diam. brs. S. 24 $\frac{1}{2}$ ° E. 93 lks. dist., marked T 26 N R 7 W S 1 B T.
 - A scrub oak 3 ins. diam. brs. S. 52° W. 64 lks. dist., marked T 26 N R 7 W S 2 B T.
 - A scrub oak 3 ins. diam. brs. N. 8° W. 79 lks. dist., marked T 27 N R 7 W S 35 B T.

Land, mts.
 Soil, 3rd rate, gravelly, stony, dry.
 Cedar, pinon, scrub oak, fair grass.

- East, bet. secs. 10 & 36.
 - Over mts. land, desc. ESE. slope, through scattering cedar, and clumps of dense scrub oak.
 - 10.00 Long draw, 2 chs. wide, course ENE.
 - 40.00 Set an iron post 3 ft. long, 1 in. in diam. 26 ins. in the ground for $\frac{1}{4}$ sec. cor., marked on brass cap,
 - $\frac{1}{4}$ S 36 in N., and
 - S 1 in S. half; from which,
 - A scrub oak 4 ins. diam. brs. N. 35° E. 33 lks. dist., marked $\frac{1}{4}$ S 36 B T.
 - A pinon tree 6 ins. diam. brs. S. 22° W. 191 lks. dist., marked $\frac{1}{4}$ S 1 B T.
 - 42.00 Long spur, brs. ENE. & WSW., near point., desc.
 - 50.00 Draw, 2 chs. wide, course NE., asc. over spurs.
 - 70.00 Ridge, brs. NE. & SW., desc. through dense timber.
 - 80.00 To cor. of Tps. 26 & 27 N., Rs. 6 & 7 W., hereinbefore described.
- Land, mts.
 Soil, 3rd rate, gravelly, dry.
 Cedar, scrub oak, pinon, good grass.

General Description.

The North Boundary of T. 26 N., R. 7 W., runs over a smooth rolling valley for two miles to the west, then ascends to the high, broken mesa in the Eastern part of the Tp. There is no water along or near the line. There are some stretches of heavy cedar and pinon and a few pine trees but none of any timber value. The formation is in general a broken limestone, overlying red sandstone, which outcrops in the deep gulches on the W. rim of the broken mesa. No indications of a mineral character. There are no settlers near the line.

T. 26 N. R. 7 W.

Latitudes, departures, and closing errors.

Line designated:	True bearing.	Dist. Chs.	Latitudes.		Departures.	
			N. Chs.	S. Chs.	E. Chs.	W. Chs.
South Boundary, - West, -	270°	480.25	-----	-----	-----	480.25
West Boundary, - North, -	0°	480.00	480.00	-----	-----	-----
North Boundary, - East, -	90°	480.00	-----	-----	480.49	-----
East Boundary, - South, -	180°	480.00	-----	480.00	-----	-----
Convergency, -	-----	-----	-----	-----	-----	-----
					0.52	
					480.75	
Totals, -			480.00	480.00	481.01	480.25
			480.00	-----	480.25	-----
			-----	-----	-----	-----
Error in lat. -			0.00	-----	-----	-----
Error in dep. -			-----	-----	0.50	-----
			-----	-----	0.76	-----

May 23, 1912.

Jesse B. Wright
 U. S. Surveyor.

Frac. West Boundary T. 27 N., R. 7 W.

Chains

May 23, 1912.
 From the cor. of Tps. 26 & 27 N., Rs. 7 & 8 W., as established and described by W.H.Elliott, in Book 1, I run, as per instructions, North, bet. secs. 31 & 36, on range line, Var. 15° E.
 Over gently rolling valley.
 13.00 Wash, 10 lks. wide, course E.
 40.00 Set an iron post 3 ft. long, 1 in. in diam. 26 ins. in the ground for $\frac{1}{4}$ sec. cor., marked on brass cap, $\frac{1}{4}$ S 36 in W., and S 36 in E. half;
 No bearings available, dig pits 18x18x12 ins. N. & S. of cor. 3 ft. dist., and raise a mound of earth $3\frac{1}{2}$ ft. base, $1\frac{1}{2}$ ft. high W. of cor.
 49.74 Intersect SE. boundary line of Hualpai Indian Reservation at a point whence,
 50.07 The $80\frac{1}{2}$ mile cor. on said line bears ~~N. 50° E. 10.30~~ ^{N. 50° 10' E. 10.32} chs. dist., which is a sandstone 20x6x4 ins. above ground, marked and witnessed as described by Surveyor-General.
 Set an iron post 3 ft. long, 3 ins. in diam. 24 ins. in the ground for closing cor. of Tps. 27 N., Rs. 7 & 8 W., marked on brass cap,
 C C E. of centre,
 H I R in NW., and
 T 27 N in SE. half,
 S 31, R 7 W, in SE., and
 S 36, R 8 W, in SW. sectors;
 No bearings available.
 dig pits 30x24x12 ins., crosswise on each line, N. 50° E. & S. 50° W. 4 ft., and S. of cor. 8 ft., dist., and raise a mound of earth 5 ft. base, $2\frac{1}{2}$ ft. high S. of cor.
 Land, rolling.
 Soil, 2nd & 3rd rate, sandy, loose, dry.
 Sage brush, few cacti, good grass.

May 23, 1912.

Joseph B. Wright

 U. S. Surveyor.

BOOK 2415

105
60

CERTIFICATE OF ASSISTANTS.

We, the undersigned, hereby certify upon honor that we assisted, to the best of our skill and ability,

Jesse B. Wright, U. S. Surveyor, during the periods and in the capacities
under Groups 15 & 16
 stated opposite our several signatures, in surveying all those parts or portions of *the South, West & North Bdrs. of Tp. 23 N.-R. 10 W., West Boundary of Tp. 24 N.-R. 10 W., East Bdy of Tp. 24 N.-R. 6 W., East, West & North Bdrs of Tp. 25 N.-R. 6 W., North Bdy of Tp. 25 N.-R. 7 W., East, West & North Bdrs of Tp. 26 N.-R. 6 W., North Bdy of Tp. 26 N.-R. 7 W., East, West & North Bdrs of Tp. 27 N.-R. 6 W., and the Fractional West Boundary of Tp. 27 N., R. 7 W.*

of the Gila & Salt River Base & Meridian, in the State of Arizona,
 which are represented in the foregoing field notes as having been executed by him, and under his direction; and that said survey has been, in all respects, to the best of our knowledge and belief, well and faithfully executed.

NAME.	PERIOD OF SERVICE.		CAPACITY.
	BEGUN.	ENDED.	
<i>Hubert W. Worcester</i>	Mch. 6, 1912	June 17, 1912.	Chainman.
<i>Samuel J. Kennedy</i>	Mch. 6, 1912	June 17, 1912.	Chainman.
<i>Alfred N. Glass</i>	Mch. 7, 1912	June 17, 1912.	Flagman.
<i>Frank J. McSherry</i>	Mch. 6, 1912	June 17, 1912.	Axeman.
<i>Richard W. Ham</i>	Mch. 6, 1912	June 10, 1912.	Moundman.
	Mch. 6, 1912		

Subscribed and certified to before me on the dates of the final service as shown above.

Jesse B. Wright
 U. S. Surveyor.

FINAL OATH OF UNITED STATES SURVEYOR.

I, Jesse B. Wright, U. S. Surveyor, do solemnly swear that, in pursuance of special instructions received from the U. S. Surveyor General for Arizona, Groups 15 & 16 bearing dates of the 28th of August, 1911, & 5th of Feb., 1912, I have well, faithfully, and truly, in my own proper person, and in strict conformity with said instructions, the Manual of Surveying Instructions, and the laws of the United States, surveyed all those parts or portions of the S, W, & N. bdrs. of T. 23 N. - R. 10 W., the W. bdy. of T. 24 N. - R. 10 W., the E. bdy. of T. 24 N. - R. 6 W., the E., W, & N. bdrs. of T. 25 N. - R. 6 W., the N. bdy. of T. 25 N. - R. 7 W., the E., W, & N. bdrs. of T. 26 N. - R. 6 W., the N. bdy. of T. 26 N. - R. 7 W., the E., W, & N. bdrs. of T. 27 N. - R. 6 W., and the Frac'l W. bdy. of T. 27 N. - R. 7 W. of the Gila and Salt River Base and Meridian, in the State of Arizona, which are represented in the foregoing field notes as having been executed by me, and under my direction; and I do further solemnly swear that all the corners of said survey have been established and perpetuated in strict accordance with the Manual of Surveying Instructions, and the special written instructions of the U. S. Surveyor General for _____ and in the specific manner described in the field notes, and that the foregoing are the original field notes of such survey.

Jesse B. Wright
U. S. Surveyor.

Subscribed by said Jesse B. Wright and sworn to before me }
this 15th day of October, 1912

Frank S. Ingalls
SURVEYOR GENERAL OF ARIZONA



APPROVAL.

OFFICE OF THE UNITED STATES SURVEYOR GENERAL,
Phoenix Arizona, April 21, 1913

The foregoing field notes of the survey of the S, W, & N. bdrs. of T. 23 N. - R. 10 W., the W. bdy. of T. 24 N. - R. 10 W., the E. bdy. of T. 24 N. - R. 6 W., the E., W, & N. bdrs. of T. 25 N. - R. 6 W., the N. bdy. of T. 25 N. - R. 7 W., the E., W, & N. bdrs. of T. 26 N. - R. 6 W., the N. bdy. of T. 26 N. - R. 7 W., the E., W, & N. bdrs. of T. 27 N. - R. 6 W., and the Frac'l W. bdy. of T. 27 N. - R. 7 W., of the Gila and Salt River Base and Meridian, Arizona

executed by Jesse B. Wright, U. S. Surveyor under his special instructions, ^{for Groups 15 & 16} dated August 28, 1911 and February 5, 1912, having been critically examined, and the necessary corrections and explanations made, the said field notes, and the surveys they describe, are hereby approved.

Frank S. Ingalls
U. S. Surveyor General.

I certify that the foregoing transcript of the field notes of the above-described surveys in _____, has been correctly copied from the original notes on file in this office.

Phoenix, Arizona,
June 3, 1915.

This is to certify that on August 12, 1914, in compliance with Supplemental Special Instructions dated February 11, 1914 and approved by the Commissioner of the General Land Office February 19, 1914, I proceeded to the $\frac{1}{4}$ sec. cor. bet. secs. 31 and 36, Ts. 27 N., Rs. 7 and 8 W., G. & S.R. B. & M., and remeasured the distance north to the township closing cor. on the SE. bdy. of the Hualpai Indian Reservation and found the same to be 9.74 chs. I then proceeded to the $\frac{1}{4}$ sec. cor. bet. secs. 6 and 31, Ts. 26 and 27 N., R. 7 W., and remeasured the distance west to the cor. of Ts. 26 and 27 N., Rs. 7 and 8 W., and found the same to be 40.23 chs.

A. C. Horton Jr.

U. S. Surveyor.

Subscribed by said A. C. Horton Jr., and sworn to before me this 3rd day of June, 1915.

Frank S. Ingalls

Surveyor General of Arizona.