

# FIELD NOTES

OF THE SURVEY OF THE

Subdivision of Fraction T. 21 S., R. 32 E.

Of the Gila and Salt River Base and Meridian,

In the State of ARIZONA

EXECUTED BY

Jesse B. Wright,

and

William H. Elliott,

In the capacity of U. S. Surveyor<sup>s</sup>, under instructions dated Oct. 6, 1911,

issued by the United States Surveyor General to govern surveys included in Group No. 17,

which were approved by the Commissioner of the General Land Office, October 14, 1911, pursuant to authority contained in the Act of

Congress dated Aug. 24, 1912

Survey commenced Oct. 27, 1912, 191

Survey completed Nov. 9, 1912, 191

1A/22

BOOK 2477

# INDEX DIAGRAM.

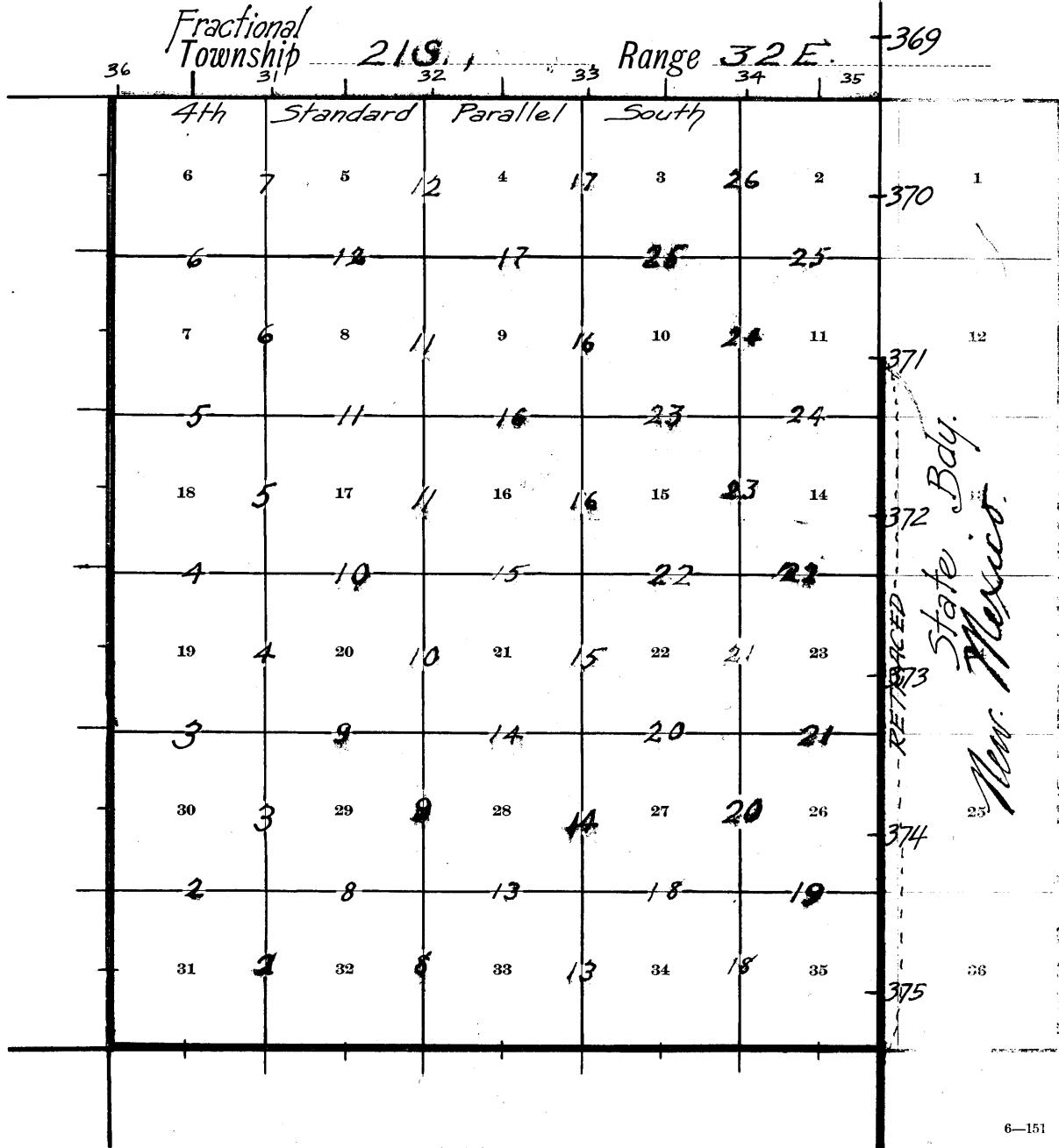

——— Book "A"  
 - - - - Book "B"  
 ——— Book "D"

Chains

Survey commenced Oct. 27, 1912, and executed jointly by Jesse B. Wright, and William H. Elliott, U. S. Surveyors, Wright using transit No. 8145, and Elliott using transit No. 8492, bot made by Young & Son's, with Smith solar attachments on side.

At our camp which is located near the centre of T. 21 S., R. 32 E., we examine and test all the adjustments of the transits and solar apparatus, and finding same correct as to tests; then, in order to test the solars by comparison of results made from observations on the sun for meridians, with a true meridian established by observation of Polaris, we proceed as follows :-

At 4h p.m., l.m.t., we set off  $12^{\circ}53'S.$  on the decl. arcs, and  $31^{\circ}35\frac{1}{2}' N.$  on the lat. arcs, and determine meridians with the solars, and mark points in the meridians thus determined by tacks driven in stakes driven firmly in the ground 5 chs. N. of our stations.  
Oct. 27, 1912.

Oct. 28, 1912.

At 5h 01m a.m., l.m.t., we observe Polaris at W. elong. in accordance with instructions in the "Manual", and marked the true meridian thus determined by a tack on a stake driven firmly in the ground 8 chs. N. of our station.

At 7h a.m., l.m.t, we set off the azimuth of Polaris,  $1^{\circ}21\frac{1}{2}'$  to the East, and mark the true meridian thus determined by a tack in a stake driven firmly in the ground 5 chs. N. of our station, which point falls .20 and .30 ins. E. of the meridians as determined by the solars of transits 8145 and 8492 on preceding afternoon, respectively.

Then we set off  $13^{\circ}07\frac{1}{2}' S.$  on the decl. arcs, and  $31^{\circ}35\frac{1}{2}' N.$  on the lat. arcs, and determine meridians with the solars, and mark the meridians thus determined by pencil marks on the stake on true meridian 5 chs. N. of our station, numbered points W and E, for transits 8145 and 8492, respectively, which points falls .25 and .20 ins. respectively E. of the point in the true meridian as determined by Polaris observation.

By p.m. & a.m. observations on the sun, for meridians, the solars give following results :  
that of instrument No. 8145 falls about 11" W., and 13" E., respectively of the true meridian as determined from observation of Polaris;  
that of instrument No. 8492 falls about 15" W., and 11" E., respectively of the true meridian as determined from observation of Polaris.

From these observations, we conclude that the adjustments of the instruments are satisfactory.

The magnetic bearing of the true meridian at 7h a.m. is N.  $13^{\circ} W.$ ; the angle thus determined gives the magnetic declination as  $13^{\circ} E.$

#

In the following notes the initials J.B.W., and W.H.E. show the lines run by Jesse B. Wright, and William H. Elliott, respectively.

Oct. 29, 1912.

J.B.W.

At 8h a.m., l.m.t., at the cor. of secs. 5, 6, 31 & 32, on the S. bdy. of the Tp., as recently established by me, and hereafter described in Book D

I set off  $13^{\circ}26\frac{1}{2}' S.$  on the decl. arc, and  $31^{\circ}33' N.$  on the lat. arc, and determine a meridian with the solar. Thence I run, as per instructions,  
Var.  $13^{\circ}05' E.,$

| Chains. |   |
|---------|---|
|         | N. 0°10' E. bet. secs. 31 & 32, parallel to E. bdy. of T. 21 S. R. 32 E.  |
|         | Over mts. land. asc. prec. SW. slope.   |
| 18.00   | Top of ridge, brs. W. & E., desc. prec.   |
| 31.00   | Desc. gentle N. slope.  |
| 40.00   | Set an iron post 3 ft. long, 1 in. in diam. 10 ins. in the ground to bed-rock, in mound of stone for $\frac{1}{4}$ sec. cor., marked on brass cap,<br>$\frac{1}{4}$ S 31 in W., and<br>S 32 in E. half;<br>raise a mound of stone 2 ft. base $1\frac{1}{2}$ ft. high W. of cor.   |
| 42.35   | Drain 15 lks. wide, course WNW., asc.   |
| 52.00   | Top of ridge, brs. W. & E., desc.   |
| 65.00   | Grassy flat, foot of slope, brs. E. & W.  |
| 77.65   | Wash 25 lks. wide, course W., asc.  |
| 80.00   | Set an iron post 3 ft. long, 2 ins. in diam. 24 ins. in the ground for cor. of secs. 29, 30, 31 & 32, marked on brass cap,<br>T 21 S R 32 E, in N. half,<br>S 30 in NW.,<br>S 29 in NE.,<br>S 32 in SE., and<br>S 31 in SW. quad.<br>No bearings available, pits impracticable.<br>Raise a mound of stone 2 ft. base, $1\frac{1}{2}$ ft. high W. of cor.<br>Land, mts., rolling.<br>Soil, 3rd rate, gravelly, stony, dry.<br>No timber.<br>Undergrowth, cacti, scrub oak, fair grass. |
|         | West, on a random line, bet. secs. 30 & 31.   |
| 40.00   | Set temp $\frac{1}{4}$ sec. cor.  |
| 79.98   | Intersect E. bdy. of T. 21 S. R. 32 E., 47 lks. S. of cor. of secs. 25, 30, 31 & 36, as here recently re-established by W.H.E. and described, in Book "A", whence I run,<br>S. 89°40' E. on a true line, bet. secs. 30 & 31.<br>Over rolling land, asc. gradually on grassy W. slope.   |
| 38.00   | Ridge, brs. N. & S., desc. grad.  |
| 39.98   | Set an iron post 3 ft. long. 1 in. in diam. 26 ins. in the ground for $\frac{1}{4}$ sec. cor., marked on brass cap,<br>$\frac{1}{4}$ S 30 in N., and<br>S 31 in S. half, and<br>raise a mound of stone 2 ft. base, $1\frac{1}{2}$ ft. high N. of cor.   |
| 52.00   | Along N. slope of hill, covered with lava stone.  |
| 62.00   | Desc.   |
| 70.58   | Draw, 2 chs. wide, course WNW., asc. grad. along N. side of same.   |
| 79.98   | To cor. of secs. 29, 30, 31 & 32, hereinbefore described,<br>Land, rolling, hilly.<br>Soil, 2nd & 3rd rate, gravelly, stony.<br>No timber.<br>Undergrowth, sparse cacti, scrub oak, good grass.<br>At this cor., at noon, I set off 13°31' S. on the decl. arc, and observe the sun on the meridian.<br>The resulting lat. is 31°34' N., which is within 1' of the calculated latitude.   |

Frac.  
Subdivision of T. 21 S., R. 32 E.

Chains

N. 0° 10' E., bet. secs. 29 & 30.  
 Over mts. land. along broken W. slope, asc.  
 18.00 Ridge, brs. W. & E., desc.  
 25.56 Drain, 10 lks. wide, course W., thence along W. slope of hill, over loose lava stone.  
 40.00 Set an iron post 3 ft. long, 1 in. in diam. 26 ins. in the ground for  $\frac{1}{4}$  sec. cor., marked on brass cap,  $\frac{1}{4}$  S 30 in W., and S 29 in E. half; raise a mound of stone 2 ft. base,  $1\frac{1}{2}$  ft. high W. of cor.  
 48.00 Desc. along W. NW. slope.  
 63.10 Drain, 10 lks. wide, course W.  
 72.00 Asc. steep SW. slope.  
 80.00 Set an iron post 3 ft. long. 2 ins. in diam' 24 ins. in the ground for cor. of secs. 19, 20, 29 & 30, marked on brass cap, T 21 S R 32 E, in N. half, S 19 in NW., S 20 in NE., S 29 in SE., and S 30 in SW. quad.; no bearings available. raise a mound of stone 2 ft. base,  $1\frac{1}{2}$  ft. high W. of cor.  
 Land, mts., broken.  
 Soil, 3rd rate, gravelly, stony, dry.  
 Cacti, scrub oak, good grass.

Since the retracement of E. bdy. of T. 21 S., R. 31 E. shows an excess in measurement, necessitating a closing cor. on said line for secs. 19 & 30 of T. 21 S., R. 32 E., therefore from the cor. of secs. 19, 20, 29 & 30, as above described, I run, West, bet. secs. 19 & 30.

Over mts. land. desc. stony W. slope.  
 17.50 Wash, 10 lks. wide, course SW., asc.  
 20.00 Low ridge, brs. S. & N., desc.  
 32.00 Foot of slope, brs. NE. & SW., desc. grad.  
 40.00 Set an iron post 3 ft. long, 1 in. in diam. 26 ins. in the ground for  $\frac{1}{4}$  sec. cor., marked on brass cap,  $\frac{1}{4}$  S 19 in N., and S 30 in S. half; raise a mound of stone 2 ft. base  $1\frac{1}{2}$  ft. high N. of cor.  
 44.00 Wash, 50 lks. wide, course NNW., road in same, asc. grad.  
 60.00 Asc. E. slope of ridge.  
 77.00 Ridge, brs. N. & S., desc.  
 79.96 Intersect E. bdy. of T. 21 S., R. 31 E. at a point 98 lks. S. of W. of the cor. of secs. 19 & 30 on said bdy., as heretofore re-established by W.H.E. & described in Book "A".  
 Set an iron post 3 ft. long, 2 ins. in diam. 24 ins. in the ground for closing cor. of secs. 19 & 30, marked on brass cap, CC, W. of centre, T 21 S, in N., & S 24, S 25, R 31 E, in W. half, S 19 in NE., and S 30 in SE. quad.; No bearings available, pits impracticable. Raise a mound of stone 2 ft. base,  $1\frac{1}{2}$  ft. high E. of cor.  
 Land, mts., rolling.  
 Soil, 3rd rate, gravelly, stony, dry, loose.  
 Sparse cacti, sage brush, good grass.

Oct. 29, 1912.

| Chains | hereinbefore described  |
|--------|---|
|        | <p>Oct. 30, 1912.</p> <p>At 8h a.m., l.m.t., at the cor. of secs. 19, 20, 29 &amp; 30,<br/>         I set off <math>13^{\circ}46\frac{1}{2}'</math> S. on the decl. arc, and <math>31^{\circ}35'</math> N. on<br/>         the lat. arc, and determine a meridian with the solar.<br/>         thence I run,<br/>         N. <math>0^{\circ}10'</math> E., bet. secs. 19 &amp; 20.<br/>         Over mts. land, asc.</p>  |
| 10.00  | Ridge, brs. W. & E., desc.  |
| 20.00  | Head of draw, course W., asc.   |
| 23.00  | Spur, brs. W. & E., desc.   |
| 36.00  | Foot of slope, brs. E. & W., enter draw.  |
| 40.00  | Set an iron post 3 ft. long, 1 in. in diam. 26 ins. in<br>the ground for $\frac{1}{4}$ sec. cor., marked on brass cap,<br>$\frac{1}{4}$ S 19 in W., and<br>S 20 in E. half;<br>raise a mound of stone 2 ft. base, $1\frac{1}{2}$ ft. high W. of cor.  |
| 43.00  | Wash, 80 lks. wide, course NW., asc.  |
| 52.00  | Asc. steep stony ridge.   |
| 77.00  | Ridge, slopes steeply to W. from E., desc.  |
| 80.00  | Set an iron post 3 ft. long, 2 ins. in diam. 24 ins. in<br>the ground for cor. of secs. 17, 18, 19 & 20, marked on<br>brass cap,<br>T 21 S R 32 E, in N. half,<br>S 18 in NW.,<br>S 17 in NE.,<br>S 20 in SE., and<br>S 19 in SW. quad.;<br>raise a mound of stone 2 ft. base $1\frac{1}{2}$ ft. high W. of cor.<br>Land, hilly.<br>Soil, 3rd rate, stony, gravelly, dry.<br>Cacti, scrub oak, good grass.  |
|        | <hr/> <p>West, bet. secs. 18 &amp; 19<br/>         Over mts. land, desc. NW. slope of stony ridge.</p>  |
| 22.00  | Foot of ridge, brs. NE. & SW., desc. grad. over rolling<br>land.  |
| 40.00  | Set an iron post 3 ft. long, 1 in. in diam. 26 ins. in<br>the ground for $\frac{1}{4}$ sec. cor., marked on brass cap,<br>$\frac{1}{4}$ S 18 in N., and<br>S 19 in S. half;<br>raise a mound of stone 2 ft. base, $1\frac{1}{2}$ ft. high N. of cor.  |
| 44.80  | Road, brs. N. & S.  |
| 45.90  | Wash, 40 lks. wide, course N., asc. grad.   |
| 79.94  | Intersect E. bdy. of T. 21 S., R. 31 E. 195 lks. S. & W. of<br>cor. of secs. 13, 24, 29 & 30, recently re-established and<br>by W.H.E. and described in Book "A"<br>Set an iron post 3 ft. long, 2 ins. in diam. 24 ins. in<br>the ground for closing cor. of secs. 18 & 19, marked on<br>brass cap,<br>C C, W. of centre,<br>T 21 S in N., and<br>S 13, S 24, R 31 E., in W. half,<br>S 18 in NE., and<br>R 32 E S 19 in SE. quad.;<br>Raise a mound of stone 2 ft. base, $1\frac{1}{2}$ ft. high E. of cor.<br>Land, mts., rolling.<br>Soil, 3rd rate, gravelly, dry, stony, loose.<br>Scrub oak, cacti, fair grass.<br>At this cor., at noon, I set off $13^{\circ}50\frac{1}{2}'$ S. on the decl.<br>arc, and observe the sun on the meridian.<br>The resulting lat. is $31^{\circ}35\frac{1}{2}'$ N. |

Frac.  
 Subdivision of T. 21 S., R. 31 E.

5

Chains.

- N. 0° 10' E. bet. secs. 17 & 18.  
 Over mts. land, desc.
- 10.00 Head of draw, course W., asc.  
 25.00 Top of W. slope of high ridge, desc.  
 40.00 Set an iron post 3 ft. long, 1 in. in diam., 26 ins. in  
 the ground for  $\frac{1}{4}$  sec. cor., marked on brass cap,  
 $\frac{1}{4}$  S 18 in W., and  
 S 17 in E. half;  
 raise a mound of stone 2 ft. base,  $1\frac{1}{2}$  ft. high W. of cor.
- 48.00 Desc. grad., foot of slope, brs. NE. & SW., over grassy  
 plain.
- 80.00 Set an iron post 3 ft. long, 2 ins. in diam. 24 ins. in  
 the ground for cor. of secs. 7, 8, 17 & 18, marked on  
 brass cap,  
 T 21 S R 32 E, in N. half,  
 S 7 in NW.,  
 S 8 in NE.,  
 S 17 in SE., and  
 S 18 in SW. quad.;  
 raise a mound of stone 2 ft. base,  $1\frac{1}{2}$  ft. high W. of cor.  
 Land, rolling, mts.  
 Soil, 2nd & 3rd rate, stony, gravelly, dry.  
 Scrub oak, cacti, good grass in valley.
- 
- West, bet. secs. 7 & 18.  
 Over rolling land.
- 40.00 Set an iron post 3 ft. long, 1 in. in diam. 26 ins. in  
 the ground for  $\frac{1}{4}$  sec. cor., marked on brass cap,  
 $\frac{1}{4}$  S 7 in N., and  
 S 18 in S. half;  
 raise a mound of stone 2 ft. base  $1\frac{1}{2}$  ft. high N. of cor.
- 69.70 Wire fence, brs. N.  $7\frac{1}{2}$ ° W., and S.  $7\frac{1}{2}$ ° E.  
 79.20 Dry wash 25 lks. wide, course NW.  
 79.92 Intersect E. bdy. of T. 21 S., R. 31 E. 270 lks. S. 0° 9' W. of  
 cor. of secs. 12 & 13 recently re-established by W.H.E. & described in Book A.  
 Set an iron post 3 ft. long, 2 ins. in diam. 24 ins. in  
 the ground for closing cor. of secs. 7 & 18, marked on  
 brass cap,  
 C C, W. of centre,  
 T 21 S, in N., and  
 S 12, S 13, R 31 E, in W. half,  
 S 7 in NE., and R 32 E  
 S 18 in SE. quad.;  
 raise a mound of stone 2 ft. base,  $1\frac{1}{2}$  ft. high E. of cor.  
 Land, rolling.  
 Soil, 3rd rate, gravelly, sandy, loose, dry.  
 Sage brush, cacti, good grass.

Oct. 30, 1912.

Frac.  
Subdivision of T. 21 S., R. 32 E.

Chains.

Oct. 31, 1912. (hereinbefore described)  
 At 8h a.m., l.m.t., at the cor. of secs. 7, 8, 17 & 18,  
 I set off  $14^{\circ}05\frac{1}{2}'$  E. on the decl. arc, and  $31^{\circ}36\frac{1}{2}'$  N. on  
 the lat. arc, and determine a meridian with the solar.  
 Thence I run,  
 N.  $0^{\circ}10'$  E., bet. secs. 7 & 8.  
 Over stony, grassy flat.  
 1.40 Road, brs. E. & W.  
 40.00 Set an iron post 3 ft. long, 1 in. in diam. 26 ins. in  
 the ground for  $\frac{1}{4}$  sec. cor., marked on brass cap,  
 $\frac{1}{4}$  S 7 in W., and  
 S 8 in E. half,  
 raise a mound of stone 2 ft. base,  $1\frac{1}{2}$  ft. high W. of cor.  
 62.00 Enter bed of wash from SSE., thence down same.  
 66.00 Leave wash, 2 chs. wide, runs NNW.  
 80.00 Set an iron post 3 ft. long, 2 ins. in diam. 24 ins. in  
 the ground for cor. of secs. 5, 6, 7 & 8, marked on  
 brass cap,  
 T 21 S R 32 E, in N. half,  
 S 6 in NW.,  
 S 5 in NE.,  
 S 8 in SE., and  
 S 7 in SW. quad.;  
 raise a mound of stone 2 ft. base,  $1\frac{1}{2}$  ft. high W. of cor.  
 Land, rolling.  
 Soil, 3rd rate, gravelly, stony, dry.  
 Sparse sage brush, cacti, good grass.

West, bet. secs. 6 & 7.  
 Over rolling land.  
 0.60 Wash, 2 chs. wide, course N.  
 40.00 Set an iron post 3 ft. long, 1 in. in diam. 26 ins. in  
 the ground for  $\frac{1}{4}$  sec. cor., marked on brass cap,  
 $\frac{1}{4}$  S 6 in N., and  
 S 7 in S. half;  
 raise a mound of stone 2 ft. base,  $1\frac{1}{2}$  ft. high N. of cor.  
 79.90 Intersect E. bdy. of T. 21 S., R. 31 E. 322 lks. S. of cor.  
 of secs. 1 & 12, as ~~recently~~ re-established by  
 W.H.E. & described in Book A,  
 Set an iron post 3 ft. long, 2 ins. in diam. 24 ins. in  
 the ground for closing cor. of secs. 6 & 7, marked on  
 brass cap,  
 C C, W. of centre,  
 T 21 S in N., and  
 S 1, S 12, R 31 E, in W. half,  
 S 6 in NE., and R 32 E  
 S 7 in SE. quad.;  
 raise a mound of stone 2 ft. base,  $1\frac{1}{2}$  ft. high E. of cor.  
 Land, rolling.  
 Soil, 3rd rate, gravelly, dry, loose.  
 Sparse sage brush, cacti, good grass.



Frac.  
subdivision of T. 21 S., R. 32 E.

7

Chains N. 0° 10' E., bet. secs. 5 & 6.  
 Over rolling land, drains to N.  
 5.60 Road, brs. E. & W.  
 40.00 Set an iron post 3 ft. long, 1 in. in diam. 26 ins. in  
 the ground for  $\frac{1}{4}$  sec. cor., marked on brass cap,  
 $\frac{1}{4}$  S 6 in W., and  
 S 5 in E. half;  
 raise a mound of stone 2 ft. base,  $1\frac{1}{2}$  ft. high W. of cor.  
 At this cor., at noon, the sky is overcast, impracticable  
 to observe the latitude.  
 60.00 Road, brs' NW: & SE.  
 As point for closing cor. of secs. 5 & 6 will fall in wash,  
 at  
 83.11 Set an iron post 3 ft. long, 2 ins. in diam. 24 ins. in  
 the ground for witness cor. to closing cor. of  
 secs. 5 & 6, marked on brass cap,  
 CC, S. of center,  
 T 20 S, R 31 E, S 36, R 32 E, S 31, in N. half,  
 S 5 in SE., and  
 S 6 in SW. quad.;  
 raise a mound of stone 2 ft. base,  $1\frac{1}{2}$  ft. high S. of cor.  
 84.61 Intersect 4th Standard Parallel South at a point whence,  
 Standard  $\frac{1}{4}$  sec. cor. on S. bdy. Sec. 31, T. 20 S., R. 32 E.  
 brs. N. 89°52' E. 5.39 chs. dist., as recently  
 re-established by W.H. Elliott, and described in Book B. 1881.  
 Land, rolling.  
 Soil, 3rd rate, sandy, loose, gravelly, dry.  
 Sparse sage brush, cacti, fine native grass.  
 Stormy in afternoon, this date. Oct. 31, 1912.

J.B.W.

-----

Chains.

Oct. 30, 1912. W.H.E.  
 At 8h a.m., l.m.t., at the cor. of secs. 4, 5, 32 & 33,  
 on the S. bdy. of the Tp., recently established by  
 J.B. Wright, and ~~herebefore~~ described, in Book "D"  
 I set off  $13^{\circ}46'$  S. on the decl. arc, and  $31^{\circ}33'$  N. on  
 the lat. arc, and determine a meridian with the solar.  
 thence I run,  
 N.  $0^{\circ}10'$  E., bet. secs. 32 & 33.  
 Over mts. land, asc. along W. slope.  
 3.00 Desc. prec. NW. slope.  
 13.00 Gulch, 30 lks. wide, course W., near head, asc. prec.  
 20.00 Spur, brs. W. & E., desc. prec.  
 36.00 Gulch, 50 lks. wide, course W., asc.  
 40.00 Top of rise, on W. slope,  
 Set an iron post 3 ft. long, 1 in. in diam. 26 ins. in  
 the ground for  $\frac{1}{4}$  sec. cor., marked on brass cap,  
 $\frac{1}{4}$  S 32 in W., and  
 $\frac{1}{4}$  S 33 in E. half;  
 raise a mound of stone 2 ft. base,  $1\frac{1}{2}$  ft. high W. of cor.  
 Desc. NW. slope, from cor.  
 52.00 Gulch, 50 lks. wide, course W.  
 55.00 Asc. prec.  
 65.00 Spur, brs. W. & E., desc. prec.  
 70.00 Along W. slope.  
 80.00 Set an iron post 3 ft. long, 2 ins. in diam. 24 ins. in  
 the ground for cor. of secs. 28, 29, 32 & 33, marked on  
 brass cap,  
 T 21 S R 32 E, in N. half,  
 S 29 in NW.,  
 S 28 in NE.,  
 S 33 in SE., and  
 S 32 in SW. quad.;  
 raise a mound of stone 2 ft. base,  $1\frac{1}{2}$  ft. high W. of cor.  
 Land, mts., rough.  
 Soil, 3rd & 4th rate, stony.  
 Scrub oak, cacti, sparse grass.  
 -----  
 West, on a random line, bet. secs. 29 & 32.  
 40.00 Set temp!  $\frac{1}{4}$  sec. cor. herebefore described  
 79.96 Intersect N. & S. line at cor. of secs. 29, 30, 31 & 32,  
 whence I run,  
 East, on a true line, bet. secs. 29 & 32.  
 Over heavily rolling, broken land, asc. grad.  
 32.78 Wash, 30 lks. wide, course SSW., asc. NW. slope.  
 39.98 Set an iron post 3 ft. long, 1 in. in diam. 26 ins. in  
 the ground for  $\frac{1}{4}$  sec. cor., marked on brass cap,  
 $\frac{1}{4}$  S 29 in N., and  
 S 32 in S. half;  
 raise a mound of stone 2 ft. base.  $1\frac{1}{2}$  ft. high N. of cor.  
 58.00 Spur, brs. S. & N., desc.  
 71.00 Drain, 20 lks. wide, course S., asc. prec.  
 79.96 To cor. of secs. 28, 29, 32 & 33, herebefore described.  
 Land, mts., broken, covered with lava stone.  
 Soil, 3rd rate, stony, dry.  
 Scrub oak, cacti, fair grass.  
 At this cor., at noon, I set off  $13^{\circ}50'$  S. on the decl.  
 arc, and observe the sun on the meridian.  
 The resulting lat. is  $31^{\circ}34'$  N.

Subdivision of <sup>Frac.</sup> T. 21 S., R. 32 E.

Chains

N. 0° 10' E., bet. secs. 28 & 29  
 Over mts. land, along W. slope of stony hill, asc. grad.  
 6.00 Ridge, brs. NW. & SE., desc. grad.  
 15.00 Drain, 30 lks. wide, course E., asc.  
 30.00 Stony ledge on line, 20 ft. high.  
 30.90 Top of spur, brs. E. & W., desc. grad.  
 40.00 Set an iron post 3 ft. long, 1 in. in diam. 26 ins. in the ground for  $\frac{1}{4}$  sec. cor., marked on brass cap,  $\frac{1}{4}$  S 29 in W., and S 28 in E. half;  
 raise a mound of stone 2 ft. base,  $1\frac{1}{2}$  ft. high W. of cor.  
 48.00 Stony spur, brs. E. & W., desc. NE. slope.  
 72.00 Desc. steep NE. slope.  
 80.00 Set an iron post 3 ft. long, 2 ins. in diam. 24 ins. in the ground for cor. of secs. 20, 21, 28 & 29, marked on brass cap,  
 T 21 S R 32 E, in N. half,  
 S 20 in NW.,  
 S 21 in NE.,  
 S 28 in SE., and  
 S 29 in SW. quad.;  
 raise a mound of stone 2 ft. base,  $1\frac{1}{2}$  ft. high W. of cor.  
 Land, mts., broken.  
 Soil, 3rd rate, stony.  
 Scrub oak, cacti, fair grass.

Oct. 30, 1912.

Oct. 31, 1912.

At 8h a.m., l.m.t., at the cor. of secs. 20, 21, 28 & 29, <sup>hereinafter described</sup>  
 I set off  $14^{\circ}05\frac{1}{2}'$  S. on the decl. arc, and  $31^{\circ}35'$  N. on the lat. arc, and determine a meridian with the solar.  
 Thence I run,  
 West, on a random line, bet. secs. 20 & 29.  
 40.00 Set temp.  $\frac{1}{4}$  sec. cor.  
 79.94 Intersect N. & S. line 7 lks. N. of cor. of secs. 19, 20, 29 & 30, <sup>hereinafter described</sup>, whence I run, N.  $89^{\circ}57'$  E., on a true line, bet. secs. 20 & 29 .  
 Over mts. land, asc.  
 22.80 Ridge, brs. N. & S., desc.  
 34.00 Wash, in draw, 25 lks. wide, course N., asc.  
 39.97 Set an iron post 3 ft. long, 1 in. in diam. 26 ins. in the ground for  $\frac{1}{4}$  sec. cor., marked on brass cap,  $\frac{1}{4}$  S 20 in N., and S 29 in S. half;  
 raise a mound of stone 2 ft. base,  $1\frac{1}{2}$  ft. high N. of cor.  
 51.00 Ridge, brs. N. & S., desc. grad.  
 60.00 Desc. prec.  
 71.00 Deep, stony gulch, 25 lks. wide, course NE., asc. steep.  
 79.94 To cor. of secs. 20, 21, 28 & 29, <sup>hereinafter described</sup>.  
 Land, mts., broken.  
 Soil. 3rd rate, stony.  
 Scrub oak, cacti, fair grass.

Chains.

N. 0° 10' E., bet. secs. 20 & 21.  
 Over mts. land, desc. steep.  
 6.00 Gulch, 10 lks. wide, course ENE., asc. steep.  
 21.00 Asc. grad. along steep E. slope.  
 40.00 Set an iron post 3 ft. long, 1 in. in diam. 26 ins. in  
 the ground for  $\frac{1}{4}$  sec. cor. marked on brass cap,  
 $\frac{1}{4}$  S 20 in W., and  
 S 21 in E. half;  
 raise a mound of stone 2 ft. base,  $1\frac{1}{2}$  ft. high W. of cor.  
 52.00 Desc. steep NW. slope.  
 77.00 Gulch, 20 lks. wide, course E., asc. prec.  
 80.00 Set an iron post 3 ft. long, 2 ins. in diam. 24 ins. in  
 the ground for cor. of secs. 16, 17, 20 & 21, marked on  
 brass cap,  
 T 21 S R 32 E, in N. half,  
 S 17 in NW.,  
 S 16 in NE.,  
 S 21 in SE., and  
 S 20 in SW. quad.;  
 raise a mound of stone 2 ft. base,  $1\frac{1}{2}$  ft. high W. of cor.  
 Land, mts., broken.  
 Soil, 3rd rate, stony, dry.  
 Scrub oak, cacti, fair grass.

---

S. 89° 57' W., on a random line, bet. secs. 17 & 20.  
 40.00 Set temp.  $\frac{1}{4}$  sec. cor.  
 79.92 Intersect N. & S. line 5 lks. S. of cor. of  
 secs. 17, 18, 19 & 20, ~~hereinbefore described~~, whence I run,  
 N. 89° 59' E., on a true line, bet. secs. 17 & 20.  
 Over mts. land, asc. prec.  
 7.00 Ridge. brs. N. & S.  
 24.00 Desc. prec.  
 32.00 Desc. more gradually.  
 39.96 Set an iron post 3 ft. long, 1 in. in diam. 26 ins. in  
 the ground for  $\frac{1}{4}$  sec. cor., marked on brass cap,  
 $\frac{1}{4}$  S 17 in N., and  
 S 20 in S. half;  
 raise a mound of stone 2 ft. base,  $1\frac{1}{2}$  ft. high N. of cor.  
 55.00 N. edge of wash, 20 lks. wide, from SSW., runs ESE.  
 Asc. SW. slope.  
 63.00 Top of rise, brs. N. & S., descends steep to S. of line.  
 76.00 Wash, 10 lks. wide, course SE., asc.  
 79.92 To cor. of secs. 16, 17, 20 & 21, ~~hereinbefore described~~,  
 Land, mts., broken.  
 Soil, 3rd rate, stony, gravelly, dry.  
 Sparse scrub oak, cacti, good grass.  
 At this cor., at noon, the sky is overcast,  
 impracticable to observe the latitude.

Subdivision of <sup>Frac.</sup> T. 21 S., R. 32 E.

Chains  
 N. 0° 10' E., bet. secs. 16 & 17.  
 Over mts. land, asc. steep.  
 22.00 Ridge, brs. E. & W., desc. steep.  
 31.00 Gulch, 30 lks. wide, course E., asc. steep.  
 40.00 Set an iron post 3 ft. long, 1 in. in diam. 26 ins. in the ground for  $\frac{1}{4}$  sec. cor., marked on brass cap,  $\frac{1}{4}$  S 17 in W., and S 16 in E. half; raise a mound of stone 2 ft. base,  $1\frac{1}{2}$  ft. high W. of cor.  
 41.00 Desc. steep.  
 55.00 Gulch. 15 lks. wide, course E., asc. steep.  
 63.00 Ridge, brs. E. & W., desc. steep.  
 72.00 Gulch, 20 lks. wide, course ENE., asc. steep.  
 80.00 Set an iron post 3 ft. long, 2 ins. in diam. 24 ins. in the ground for cor. of secs. 8, 9, 16 & 17, marked on brass cap, 3  
 T 21 S R 32 E, in N. half,  
 S 8 in NW.,  
 S 9 in NE.,  
 S 16 in SE., and  
 S 17 in SW. quad. ;  
 raise a mound of stone 2 ft. base,  $1\frac{1}{2}$  ft. high W. of cor.  
 Land, mts., broken.  
 Soil, 3rd rate, gravelly, dry.  
 Sparse scrub oak, cacti, good grass.  
 Oct. 31, 1912. W.H.E.

N ov. 2, 1912. J.B.W.  
 At 8h a.m., l.m.t., at the cor. of secs. 8, 9, 16 & 17, as above described, by W.H.E.  
 I set off  $14^{\circ}44'$  S. on the decl. arc, and  $31^{\circ}36\frac{1}{2}'$  N. on the lat. arc, and determine a meridian with the solar. Thence I run,  
 S.  $89^{\circ}59'$  W. on a random line, bet. secs. 8 & 17.  
 40.00 Set temp.  $\frac{1}{4}$  sec. cor.  
 79.94 Intersect N. & S. line 3 lks. S. of cor. of secs. 7, 8, 17 & 18, whence I run, East, on a true line, bet. secs. 8 & 17! Over rolling land, asc. grad.  
 26.00 Asc. steep SW. slope.  
 36.00 Spur, brs. NW. & SE., extends about 5 chs. to NW. desc. NE. slope.  
 39.97 Set an iron post 3 ft. long, 1 in. in diam. 26 ins. in the ground for  $\frac{1}{4}$  sec. cor., marked on brass cap.  $\frac{1}{4}$  S 8 in N., and S 17 in S. half; raise a mound of stone 2 ft. base,  $1\frac{1}{2}$  ft. high N. of cor.  
 61.00 Draw, 10 chs. wide, course NW., asc.  
 71.00 Ridge, brs. NNE. & SSW., desc.  
 79.94 To cor. of secs. 8, 9, 16 & 17, hereinbefore described.  
 Land, rolling, mts.  
 Soil, 3rd rate, gravelly, dry.  
 Few cacti, good grass.

N. 0° 10' E., bet. secs. 8 & 9.  
 Over mts. land, along E. slope.  
 10.00 Desc.  
 22.00 Enter draw, course ESE.  
 33.00 Asc.  
 40.00 Top of low flat ridge, brs. E. & W.  
 Set an iron post 3 ft. long, 1 in. in diam. 26 ins. in the ground for  $\frac{1}{4}$  sec. cor., marked on brass cap.  $\frac{1}{4}$  S 8 in W., and S 9 in E. half; raise a mound of stone 2 ft. base,  $1\frac{1}{2}$  ft. high W. of cor.  
 41.00 Desc.  
 55.00 Enter grassy flat, brs. E. & W.  
 55.20 Road, brs. E. & W.  
 75.70 Road, brs. E. & W.

Chains.  
80.00 Set an iron post 3 ft. long, 2 ins. in diam. 24 ins. in the ground for cor. of secs. 4,5,8 & 9, marked on brass cap,  
T 21 S R 32 E, in N. half,  
S 5 in NW.,  
S 4 in NE.,  
S 9 in SE., and  
S 8 in SW. quad.;  
raise a mound of stone 2 ft. base, 1½ ft. high W. of cor.  
Land, mts., broken, rolling.  
Soil, 3rd rate, gravelly, loose, dry.  
Cacti, greasewood, good grass.

---

40.00 West, on a random line, bet. secs. 5 & 8.  
Set temp. ¼ sec. cor.  
79.90 Intersect N. & S. line 5 lks. S. of cor. of secs. 5,6,7 & 8, ~~hereinbefore described~~, whence I run, S. 89°58' E., on a true line, bet. secs. 5 & 8.  
Over stony, grassy flat.  
39.95 Set an iron post 3 ft. long, 1 in. in diam. 26 ins. in the ground for ¼ sec. cor., marked on brass cap,  
¼ S 5 in N., and  
S 8 in S. half;  
raise a mound of stone 2 ft. base, 1½ ft. high N. of cor.  
56.00 Road, brs. WNW. & ESE.  
79.50 Wash, 15 lks. wide, course N.  
79.90 To cor. of secs. 4,5,8 & 9, ~~hereinbefore described~~.  
Land, rolling.  
Soil, 3rd rate, stony.  
Sparse cacti, greasewood, good grass.  
At this cor., at noon, I set off, 14°48' S. on the decl. arc arc, and observe the sun on the meridian.  
The resulting lat. is 31°37' N., which is within 1' of the the calculated latitude.

---

N. 0° 10' E., bet. secs. 4 & 5.  
Over open, grassy flat, desc. gently.  
1.20 Road, brs. ENE. & WSW.  
38.00 Enter bottom land, of wide grassy draw.  
40.00 Set an iron post 3 ft. long, 1 in. in diam. 26 ins. in the ground for ¼ sec. cor., marked on brass cap,  
¼ S 5 in W., and  
S 4 in E. half;  
raise a mound of stone 2 ft. base, 1½ ft. high W. of cor.  
84.80 Intersect 4th Standard Parallel South, at a point whence Std. ¼ sec. cor. on S. bdy. secs. 32, T. 20 S., R. 32 E. brs. N. 89°52' E. 6.63 chs. ~~dist.~~, recently re-established by W.H. Elliott, and ~~herebefore described in Book B~~  
Set an iron post 3 ft. long, 2 ins. in diam. 24 ins. in the ground for closing cor. of secs. 4 & 5, marked on brass cap,  
C C, S. of centre,  
T 20 S R 32 E, S 31, S 32, in N. half,  
S 4 in SE., and  
S 5 in SW. quad.;  
raise a mound of stone 2 ft. base. 1½ ft. high S. of cor.  
Land, rolling.  
Soil, 3rd rate, sandy, gravelly, loose, dry.  
Few cacti, good grass.

Nov. 2, 1912.

Subdivision of <sup>Frac.</sup> T. 21 S., R. 32 E.

13

## Chains.

- Nov. 1, 1912.  
At 8h a.m., l.m.t., at the cor. of secs. 3, 4, 33 & 34,  
on the S. bdy. of the Tp, recently established by  
me, and ~~herebefore~~ described, in Book "D".  
I set off  $14^{\circ}26'$  S. on the decl. arc, and  $31^{\circ}33'$  N. on  
the lat. arc, and determine a meridian with the solar,  
thence I run.  
N.  $0^{\circ}11'$  E., bet. secs. 33 & 34.  
Over mts. land, asc. prec.  
8.50 Asc. grad. on top of ridge, brs. W. & E.  
28.00 Desc. prec.  
40.00 Set an iron post 3 ft. long, 1 in. in diam. 26 ins. in  
the ground for  $\frac{1}{4}$  sec. cor., marked on brass cap,  
 $\frac{1}{4}$  S 33 in W., and  
S 34 in E. half; from which,  
An oak tree 14 ins. diam. brs. N.  $89^{\circ}W$ . 81 lks. dist.,  
marked  $\frac{1}{4}$  S 33 B T.  
An oak tree 12 ins. diam. brs. S.  $25^{\circ}E$ . 32 lks. dist.,  
marked  $\frac{1}{4}$  S 34 B T.  
41.00 Drain, 50 lks. wide, course NE.  
Asc. prec.  
48.00 Ridge, brs. E. & W., desc. prec.  
65.00 Gulch, 60 lks. wide, course NW., asc. prec.  
80.90 Set an iron post 3 ft. long, 2 ins. in diam. 24 ins. in  
the ground for cor. of secs. 27, 28, 33 & 34, marked on  
brass cap, T 21 S, R 32 E, in N. half,  
S 28 in NW.,  
S 27 in NE.,  
S 34 in SE., and  
S 33 in SW. quad., no trees available.  
raise a mound of stone 2 ft. base  $1\frac{1}{2}$  ft. high W. of cor.  
Land, mts., rough.  
Soil, 3rd rate, stony, gravelly, dry.  
Sparse oak, cedar, scrub oak, cacti, fair grass.
- 
- West on a random line, bet. secs. 28 & 33.  
40.00 Set temp.  $\frac{1}{4}$  sec. cor.  
80.02 Intersect N. & S. line 5 lks. S. of cor. of  
secs. 28, 29, 32 & 33, ~~herebefore described~~, whence I run,  
S.  $89^{\circ}58'$  E., on a true line, bet. secs. 28 & 33.  
Over mts. land, asc.  
4.00 Spur, brs. N. & S., desc. grad.  
22.00 Desc. prec.  
35.00 Gulch, 60 lks. wide, course N., asc. steep.  
40.01 Set an iron post 3 ft. long, 1 in. in diam. 26 ins. in  
the ground for  $\frac{1}{4}$  sec. cor., marked on brass cap,  
 $\frac{1}{4}$  S 28 in N., and  
S 33 in S. half; from which,  
An oak tree 14 ins. diam. brs. N.  $61^{\circ}E$ . 24 lks. dist.,  
marked  $\frac{1}{4}$  S 28 B T.  
No other bearings available, pits impracticable.  
raise a mound of stone 2 ft. base,  $1\frac{1}{2}$  ft. high N. of cor.  
Asc. from cor.  
47.70 Ridge, brs. NE. & SW., desc. steep.  
65.00 Gulch, 60 lks. wide, course N., asc. steep SW. slope.  
80.02 To cor. of secs. 27, 28, 33 & 34, ~~herebefore described~~.  
Land, mts., broken.  
Soil, 3rd rate, stony, gravelly.  
Sparse oak, cedar, juniper, dense clumps of scrub oak.  
At this cor., at noon, I set off  $14^{\circ}29''$  S. on the decl.  
arc, and observe the sun on the meridian.  
The resulting lat. is  $31^{\circ}34'$  N.

|        |   |
|--------|---|
| Chains | N. 0° 11' E., bet. secs. 27 & 28.<br>Over mts. land, asc. grad. along W. side of ridge.   |
| 5.00   | Top of ridge, brs. NNW. & SSE., desc. grad.   |
| 15.00  | Desc. prec. NW. slope, ridge turns to NE.   |
| 40.00  | Set an iron post 3 ft. long, 1 in. in diam. 26 ins. in the ground for $\frac{1}{4}$ sec. cor., marked on brass cap, $\frac{1}{4}$ S 28 in W., and S 27 in E. half; from which,<br>An oak tree 20 ins. diam. brs. S. 19 $\frac{3}{4}$ ° E. 154 lks. dist., marked $\frac{1}{4}$ S 27 B T.<br>An oak tree 14 ins. diam. brs. S. 58 $\frac{1}{2}$ ° W. 225 lks. dist., marked $\frac{1}{4}$ S 28 B T.                                      |
| 45.00  | Gulch, 80 lks. wide, course NE., asc. steep, stony SE. slope.   |
| 59.00  | Stony ledge, brs. NE. & SW., 10 ft. high, asc. grad.  |
| 70.00  | Top of ridge, brs. NE. & SW. desc. grad. along W. slope.  |
| 80.00  | Set an iron post 3 ft. long, 2 ins. in diam. 24 ins. in the ground for cor. of secs. 21, 22, 27 & 28, marked on brass cap, T 21 S R 32 E, in N. half,<br>S 21 in NW.,<br>S 22 in NE.,<br>S 27 in SE., and<br>S 28 in SW. quad.;<br>raise a mound of stone 2 ft. base, 1 $\frac{1}{2}$ ft. high W. of cor.<br>Land, mts., broken.<br>Soil, 3rd rate, stony, dry.<br>Few oak trees, scrub oak, cacti, fair grass.<br>Nov. 1, 1912. J.B.W. |

|       |  |
|-------|--|
|       | Nov. 2, 1912. <span style="float: right;">W.H.E.</span><br>At 8h a.m., l.m.t., at the cor. of secs. 21, 22, 27 & 28, recently established and <sup>hereinbefore</sup> described by J.B. Wright, I set off 14° 44' S. on the decl. arc, and 31° 35' N. on the lat. arc, and determine a meridian with the solar. Thence I run,<br>N. 89° 58' W. on a random line, bet. secs. 21 & 28. |
| 40.00 | Set temp. $\frac{1}{4}$ sec. cor.  |
| 80.06 | Intersect N. & S. line 7 lks. S. of cor. of secs. 20, 21, 28 & 29, whence I run,<br>S. 89° 55' E., on a true line, bet. secs. 21 & 28.<br>Over mts. land, desc. steep NE. slope.   |
| 10.48 | Gulch, 50 lks. wide, course N., asc. steep.  |
| 21.00 | Ridge, brs. N. & S., desc.   |
| 35.00 | Gulch, 50 lks. wide, course NNE., asc.   |
| 40.03 | Set an iron post 3 ft. long, 1 in. in diam. 26 ins. in the ground for $\frac{1}{4}$ sec. cor., marked on brass cap, $\frac{1}{4}$ S 21 in N., and S 28 in S. half;<br>raise a mound of stone 2 ft. base, 1 $\frac{1}{2}$ ft. high N. of cor.<br>Desc. grad. from cor.  |
| 73.00 | Wash, 20 lks. wide, course NNW., asc. grad.  |
| 80.06 | To cor. of secs. 21, 22, 27 & 28, <sup>hereinbefore</sup> described.<br>Land, mts., broken.<br>Soil, 3rd rate, stony, dry.<br>No timber or trees, scrub oak, cacti, fair grass.  |



Subdivision of <sup>Frac.</sup> T. 21 S., R. 32 E.

|         |  |
|---------|--|
| Chains. | N. 0° 11" E., bet. secs. 21 & 22.<br>Over mts. land, asc. grad. SW. grassy slope.  |
| 20.00   | Knoll, brs. NW. & SE.  |
| 25.00   | Desc. prec. through scattering oak.  |
| 31.50   | Gulch, 30 lks. wide, course ESE., asc. prec.   |
| 40.00   | Set an iron post 3 ft. long, 1 in. in diam. 26 ins. in<br>the ground for $\frac{1}{4}$ sec. cor., marked on brass cap,<br>$\frac{1}{4}$ S 21 in W., and<br>S 22 in E. half,<br><br>No trees in limits.<br>raise a mound of stone 2 ft. base, $1\frac{1}{2}$ ft. high W. of cor.                                  |
| 43.00   | Ridge, brs. NW. & SE., desc. grad.   |
| 53.00   | Desc. prec.  |
| 63.00   | Enter grassy flat, foot of main slope, brs. NW. & SE.  |
| 68.50   | Wash, 60 lks. wide, course NW., asc. grad.   |
| 80.00   | Set an iron post 3 ft. long, 2 ins. in diam. 24 ins. in<br>the ground for cor. of secs. 15.16.21 & 22, marked on<br>brass cap, T 21 S R 32 E, in N. half,<br>S 16 in NW.,<br>S 15 in NE.,<br>S 22 in SE., and<br>S 21 in SW. quad.;<br><br>raise a mound of stone 2 ft. base, $1\frac{1}{2}$ ft. high W. of cor. |
|         | Land, mts., rolling.<br>Soil, 3rd rate, stony, gravelly.<br>Scrub oak, cacti, good grass.<br>At this cor., at noon, I set off '14°48' S. on the decl.<br>arc, and observe the sun on the meridian.<br>The resulting lat. is $31^{\circ}35\frac{1}{2}'$ N.  |
| <hr/>   |  |
|         | N. 89°55' W. on a random line, bet. secs. 16 & 21.   |
| 40.00   | Set temp. $\frac{1}{4}$ sec. cor.  |
| 80.02   | Intersect N. & S. line 9 lks. N. of cor. of<br>16,17,20 & 21, <del>hereinbefore described</del> , whence I run,<br>S. 89°59' E. on a true line, bet. secs. 16 & 21.<br>Over mts. land, asc.  |
| 1.70    | Top of S. point of spur, brs. S. & N., desc.   |
| 5.00    | Wash, 15 lks. wide, course NE., asc. gently.   |
| 23.00   | Flat ridge, brs. N. & S., desc.  |
| 35.00   | Wash, 10 lks. wide, course NW., asc.   |
| 40.01   | Set an iron post 3 ft. long, 1 in. in diam. 26 ins. in<br>the ground for $\frac{1}{4}$ sec. cor., marked on brass cap,<br>$\frac{1}{4}$ S 16 in N., and<br>S 21 in S. half;<br><br>raise a mound of stone 2 ft. base, $1\frac{1}{2}$ ft. high N. of cor.   |
| 46.00   | Low ridge, brs. N. & S., desc.   |
| 54.00   | Asc.   |
| 63.00   | Spur, brs. N. & S., desc.  |
| 70.00   | Wash, 20 lks. wide, course N., asc.  |
| 80.02   | To cor. of secs. 15,16.21 & 22, <del>hereinbefore described</del> ,<br>Land, mts., broken, rolling.<br>Soil, 3rd rate, gravelly, stony, dry.<br>Scrub oak, cacti, fair grass.  |

| Chains. |   |
|---------|---|
|         | N. 0° 11' E., bet. secs. 15 & 16.<br>Over mts. land, along W. slope of ridge.   |
| 40.00   | Set an iron post 3 ft. long, 1 in. in diam. 26 ins. in the ground for $\frac{1}{4}$ sec. cor., marked on brass cap, $\frac{1}{4}$ S 16 in W., and S 15 in E. half;<br>raise a mound of stone 2 ft. base, $1\frac{1}{2}$ ft. high W. of cor.   |
| 45.00   | Desc. grad.   |
| 55.00   | Enter flat, foot of main slope, brs. NW. & SE.  |
| 80.00   | Set an iron post 3 ft. long, 2 ins. in diam. 24 ins. in the ground for cor. of secs. 9, 10, 15 & 16, marked on brass cap, T 21 S R 32 E, in N. half, S 9 in NW., S 10 in NE., S 15 in SE., and S 16 in SW. quad.;<br>raise a mound of stone 2 ft. base, $1\frac{1}{2}$ ft. high W. of cor.  |
|         | Land, broken, rolling.<br>Soil, 3rd rate, gravelly, stony, dry.<br>Scrub oak, cacti, mesquite, fair grass.<br>Nov. 2, 1912.   |
| <hr/>   |   |
|         | Nov. 4, 1912. <del>hereinbefore</del> described   |
|         | At 8h a.m., l.m.t., at the cor. of secs. 9, 10, 15 & 16.<br>I set off $15^{\circ}21\frac{1}{2}'$ S. on the decl. arc, and $31^{\circ}36\frac{1}{2}'$ N. on the lat. arc, and determine a meridian with the solar. Thence I run,   |
|         | N: $89^{\circ}59'$ W., on a random line, bet. secs. 9 & 16.   |
| 40.00   | Set temp. $\frac{1}{4}$ sec. cor.   |
| 80.04   | Intersect N. & S. line 7 lks. N. of cor. of secs. 8, 9, 16 & 17. <del>hereinbefore</del> described, whence I run,<br>N. $89^{\circ}58'$ E., on a true line, bet. secs. 9 & 16.<br>Over mts. land, desc. E. slope.   |
| 5.00    | Drain, 10 lks. wide, course NNW.<br>foot of main slope, in valley, brs. NW. & SE., thence desc. grad.   |
| 40.02   | Set an iron post 3 ft. long, 1 in. in diam. 26 ins. in the ground for $\frac{1}{4}$ sec. cor., marked on brass cap, $\frac{1}{4}$ S 9 in N., and S 16 in S. half,<br>raise a mound of stone 2 ft. base, $1\frac{1}{2}$ ft. high N. of cor.  |
| 63.50   | Wash, 60 lks. wide, course N.<br>Enter mesquite, brs. N. & S.   |
| 76.00   | Leave mesquite, brs. N. & S.  |
| 80.04   | To cor. of secs. 9, 10, 15 & 16, <del>hereinbefore</del> described.<br>Land, rolling.<br>Soil, 3rd rate, gravelly sandy, loose, dry.<br>Mesquite, tesseta, sage brush, fine native grass.   |
| <hr/>   |   |
|         | N. 0° 11' E., bet. secs. 9 & 10.<br>Over level flat.  |
| 23.50   | Road at forks, brs. SE., and NW., fork to NNW.<br>Wind mill of San Simon Cattle Co, brs. East, 8 chs. dist.   |
| 25.00   | Desc.   |
| 35.00   | Road, brs. SE. & NW., in creek bottom.  |
| 40.00   | Set an iron post 3 ft. long, 1 in. in diam. 26 ins. in the ground for $\frac{1}{4}$ sec. cor., marked on brass cap, $\frac{1}{4}$ S 9 in W., and S 10 in E. half;<br>raise a mound of stone 2 ft. base, $1\frac{1}{2}$ ft. high W. of cor, from which,<br>An oak tree 10 ins. diam. brs. S. $88^{\circ}$ E. 96 lks. dist., marked $\frac{1}{4}$ S 10 B T. |
| 40.37   | Dry creek from Skeleton Canyon, 60 lks. wide, course NW.  |

Frac.  
Subdivision of T. 21 S., R. 32 E.

17

## Chains.

- 42.00 House of J.E. Summers brs. East, 8 chs. dist.  
 47.10 Wire fence, brs. E. & W.  
 51.50 Wire fence, brs. E. & W.  
 61.20 Wire fence, brs. NE. & SW., asc. grad.  
 70.00 Top of rise, on mesa brs. NW. & SE.  
 80.00 Set an iron post 3 ft. long, 2 ins. in diam. 24 ins. in the ground for cor. of secs. 3, 4, 9 & 10, marked on brass cap, T 21 S R 32 E, in N. half  
     S 4 in NW.,  
     S 3 in NE.,  
     S 10 in SE., and  
     S 9 in SW. quad.;  
 raise a mound of stone 2 ft. base,  $1\frac{1}{2}$  ft. high W. of cor. Land, rolling.  
 Soil, 3rd rate, sandy, gravelly, loose.  
 Mesquite, tesseta, sycamore, in creek bottom, fine grass.  
 At this cor., at noon, I set off  $45^{\circ}26''$  S. on the decl. arc, and observe the sun on the meridian.  
 The resulting lat. is  $31^{\circ}37'$  N.
- 
- 40.00 S.  $89^{\circ}58''$  W., on a random line, bet. secs. 4 & 9.  
 Set temp.  $\frac{1}{4}$  sec. cor.  
 80.06 Intersect N. & S. line 5 lks. S. of cor. of secs. 4, 5, 8 & 9, ~~hereinbefore described~~, whence I run, East, on a true line, bet. secs. 4 & 9.  
 Over gently rolling valley.  
 2.20 Road, brs. NW. & SE.  
 34.40 Wash, 20 lks. wide, course N.  
 40.03 Set an iron post 3 ft. long, 1 in. in diam. 26 ins. in the ground for  $\frac{1}{4}$  sec. cor., marked on brass cap,  
      $\frac{1}{4}$  S 4 in N., and  
     S 9 in S. half;  
 dig pits  $18 \times 18 \times 12$  ins. E. & W. of cor. 3 ft. dist., and raise a mound of earth  $3\frac{1}{2}$  ft. base,  $1\frac{1}{2}$  ft. high N. of cor.  
 41.80 Road, brs. NW. & SE.  
 49.60 Wash, 30 lks. wide, course NW.  
 75.80 Road, brs. N. & S.  
 80.06 To cor. of secs. 3, 4, 9 & 10, ~~hereinbefore described~~.  
 Land, rolling. Soil, 2nd & 3rd rate, sandy, gravelly.  
 Mesquite, tesseta, sage brush, few cacti, fine grass.
- 
- 40.00 N.  $0^{\circ} 11'$  E., bet. secs. 3 & 4.  
 Over rolling land, through mesquite & tesseta.  
 Set an iron post 3 ft. long, 1 in. in diam. 26 ins. in the ground for  $\frac{1}{4}$  sec. cor., marked on brass cap,  
      $\frac{1}{4}$  S 4 in W., and  
     S 3 in E. half;  
 dig pits  $18 \times 18 \times 12$  ins. N. & S. of cor. 3 ft. dist., and raise a mound of earth  $3\frac{1}{2}$  ft. base,  $1\frac{1}{2}$  ft. high W. of cor.  
 59.00 House of J.J. Wheeler brs. West, 7 chs. dist.  
 64.00 Cross E. end of reservoir covering 2 acres full of flood water, dam 12 chs. to W., in wash, course W.  
 68.00 Wash, 50 lks. wide, course WSW.  
 71.00 NE. end of reservoir 1 ch. to W.  
 82.30 Road, brs. WNW. & SE.  
 85.08 Intersect 4th Std. Par. N. at a point whence,  
 Std.  $\frac{1}{4}$  sec. cor. on S. bdy. sec. 33, T. 20 S., R. 32 E., brs. N.  $89^{\circ}52'$  E. 7.74 chs. dist., recently re-established by me, and ~~hereinbefore described~~ in Book B.  
 Set an iron post 3 ft. long, 2 ins. in diam. 24 ins. in the ground for closing cor. of secs. 3 & 4, marked on brass cap, C C, S. of centre,  
     T 20 S R 32 E, S 32, S 33, in N. half,  
     S 3 in SE., and  
     S 4 in SW. quad., and

Chains.

Raise a mound of stone 2 ft. base,  $1\frac{1}{2}$  ft. high S. of cor.  
 Land, rolling.  
 Soil, 3rd rate, gravelly, dry.  
 Mesquite, tesseta, sage brush, cacti, fair grass.  
 Nov. 4, 1912.

Nov. 5, 1912.

At 8h a.m. l.m.t., at the cor. of secs. 2, 3, 34 & 35,  
 on the S. bdy. of the Tp., recently established and  
 described by J.B. Wright, in Book D

I set off  $15^{\circ}40'$  S. on the decl. arc, and  $31^{\circ}33'$  N. on  
 the lat. arc, and determine a meridian with the solar.  
 Thence I run,

N.  $0^{\circ}11'$  E., bet. secs. 34 & 35.

Over mts. land, asc. prec., very rough.

.50

Granite ledge 30 ft. high, brs. E. & W.

10.00

Top of spur, brs. W. & E., desc. along broken WNW. slope.

40.00

Set an iron post 3 ft. long, 1 in. in diam. 26 ins. in  
 the ground for  $\frac{1}{4}$  sec. cor., marked on brass cap,  
 $\frac{1}{4}$  S 34 in W., and  
 S 35 in E. half;

raise a mound of stone 2 ft. base,  $1\frac{1}{2}$  ft. high W. of cor.

Asc. from cor.

44.00

Top of spur, brs. W. & E., desc. prec.

62.00

Gulch, 50 lks. wide, course W., scattering oaks in same.

Asc. prec.

80.00

Set an iron post 3 ft. long, 2 ins. in diam., on bed-rock,  
 in mound of stone for cor. of secs. 26, 27, 34 & 35, marked  
 on brass cap,

T 21 S R 32 E, in N. half;

S 27 in NW.,

S 26 in NE.,

S 35 in SE., and

S 34 in SW. quad.;

raise a mound of stone 2 ft. base,  $1\frac{1}{2}$  ft. high W. of cor.

Land, mts., very rough.

Soil, 3rd & 4th rate, stony.

Few oaks, scrub oak, cacti, sparse grass.

West, on a random line, bet. secs. 27 & 34.

40.00

Set temp.  $\frac{1}{4}$  sec. cor.

80.04

Intersect N. & S. line 9 lks. N. of cor. of  
 secs. 27, 28, 33 & 34, ~~hereinbefore~~ described, whence I run,  
 N.  $89^{\circ}56'$  E., on a true line, bet. secs. 27 & 34.

Over mts. land, desc. steep.

20.00

S. fork of Skeleton Canyon, 160 lks. wide, course NNE.

26.00

Asc.

40.02

Set an iron post 3 ft. long, 1 in. in diam. 26 ins. in  
 the ground for  $\frac{1}{4}$  sec. cor., marked on brass cap,

$\frac{1}{4}$  S 27 in N., and

S 34 in S. half; from which,

An oak tree 6 ins. diam. brs. N.  $38\frac{1}{2}^{\circ}$  E. 67 lks. dist.,  
 marked  $\frac{1}{4}$  S 27 B T.

An oak tree 12 ins. diam. brs. S.  $48\frac{1}{2}^{\circ}$  E. 96 lks. dist.,  
 marked  $\frac{1}{4}$  S 34 B T.

Asc. steep from cor.

48.00

Top of main slope from canyon, brs. NNW. & SSE., desc. grad.

80.04

To cor. of secs. 26, 27, 34 & 35, ~~hereinbefore~~ described.

Land, mts., very rough.

Soil, 3rd rate, stony.

Oak, scrub oak, mesquite, cacti.

At this cor., at noon, I set off  $15^{\circ}44'$  S. on the decl.  
 arc, and observe the sun on the meridian.

The resulting lat. is  $31^{\circ}34'$  N.

Subdivision of <sup>Frac.</sup> T. 21 S., R. 32 E.

19

## Chains.

East, bet. secs. 26 & 35.  
 Over mts. land, desc. grad.  
 2.00 Desc. steep.  
 7.00 Gulch, 60 lks. wide, course SSW., asc. SW. slope.  
 30.00 Spur, brs. NW. & SE., desc. steep.  
 34.00 Gulch, 50 lks. wide, course NW., asc. steep.  
 40.00 Set an iron post 3 ft. long, 1 in. in diam. 2 $\frac{1}{2}$  ins. in  
 the ground for  $\frac{1}{4}$  sec. cor., marked on brass cap,  
 $\frac{1}{4}$  S 26 in N., and  
 S 35 in S. half;  
 raise a mound of stone 2 ft. base, 1 $\frac{1}{2}$  ft. high N. of cor.  
 50.00 Asc. prec. W. slope, through dense scrub oak.  
 69.60 Intersect East Boundary of Ariz. 30.35 chs. S. of the  
 374 mile cor. as re-established by J. B. W. & described in Book "A"  
 Set an iron post 3 ft. long, 2 ins. in diam. 24 ins. in  
 the ground for closing cor. of secs. 26 & 35, marked on  
 brass cap, C C, E. of centre,  
 ARIZ, T 21 S R 32 E in W., and  
 N M, in E. half,  
 S 26 in NW., and  
 S 35 in SW. quad.;  
 raise a mound of stone 2 ft. base, 1 $\frac{1}{2}$  ft. high W. of cor.

Nov. 5, 1912.

20  
142

Chains.

Nov. 6, 1912. (hereinafter described)  
 At 8h a.m., l.m.t., at the cor. of secs. 26, 27, 34 & 35,  
 I set off 15°58' S. on the decl. arc, and 31°34' N. on  
 the lat. arc, and determine a meridian with the solar.  
 Thence I run,  
 N. 0° 11' E., bet. secs. 26 & 27.  
 Over mts. land, asc. grad.  
 7.00 Asc. steep.  
 20.40 Ridge, brs. W. & E., desc. steep.  
 30.00 Wash, 10 lks. wide, course W., heads 8 chs. E., asc. steep.  
 40.00 Set an iron post 3 ft. long, 1 in. in diam. 26 ons. in  
 the ground for  $\frac{1}{4}$  sec. cor., marked on brass cap,  
 $\frac{1}{4}$  S 27 in W., and  
 S 26 in E. half;  
 raise a mound of stone 2 ft. base, 1 $\frac{1}{2}$  ft. high W. of cor.  
 40.80 Ridge, brs. E. & W., desc. steep.  
 50.00 Along steep E. side of spur.  
 80.00 Set an iron post 3 ft. long, 2 ins. in diam. 2 $\frac{1}{2}$  ins. in  
 the ground for cor. of secs. 22, 23, 26 & 27, marked on  
 brass cap, T 21 S R 32 E, in N, half,  
 S 22 in NW.,  
 S 23 in NE.,  
 S 26 in SE., and  
 S 27 in SW. quad. ;  
 raise a mound of stone 2 ft. base, 1 $\frac{1}{2}$  ft. high W. of cor.  
 Land, rough, mts.  
 Soil, 3rd rate, stony.  
 Scrub oak, cacti, fair grass.

---

S. 89°56' W., on a random line, bet. secs. 22 & 27.  
 40.00 Set temp.  $\frac{1}{4}$  sec. cor.  
 80.02 Intersect N. & S. line 5 lks. S. of cor. of secs.  
 21, 22, 27 & 28, ~~hereinafter described~~, whence I run,  
 N. 89°58' E., on a true line, bet. secs. 22 & 27.  
 Over mts. land, asc.  
 9.00 Ridge, brs. N. & S., desc. steep.  
 21.00 Gulch, 30 lks. wide, course SE., asc.  
 24.00 Ridge, brs. N. & S., desc.  
 31.50 Enter draw, course N.  
 31.75 Road, hrs. NE. & SW.  
 33.50 Wash, 25 lks. wide, course NE.  
 35.00 Asc.  
 40.01 Set an iron post 3 ft. long, 1 in. in diam. 2 $\frac{1}{2}$  ins. in  
 the ground for  $\frac{1}{4}$  sec. cor., marked on brass cap,  
 $\frac{1}{4}$  S 22 in N., and  
 S 27 in E. half;  
 raise a mound of stone 2 ft. base, 1 $\frac{1}{2}$  ft. high N. of cor.  
 At this cor., at noon, I set off 16°02' S. on the decl.  
 arc, and observe the sun on the meridian.  
 The resulting lat. is 31°35' N., which is within 1' of  
 the calculated lat.  
 48.00 Ridge, brs. N. & S., desc.  
 59.00 Gulch, 40 lks. wide, course NNW., asc.  
 75.00 Ridge, brs. N. & S., desc.  
 80.02 To cor. of secs. 22, 23, 26 & 27, ~~hereinafter described~~.  
 Land, mts., very rough.  
 Soil, 3rd rate, stony, dry, granite formation.  
 Scrub oak, cacti, fair grass.

Chains.

- East, bet. secs. 23 & 26.  
Over rough, broken, mts. land, desc.
- 12.00 Wash, 30 lks. wide, course NNW., asc. grad.
- 26.00 Asc. steep.
- 38.00 Ridge, brs. N. & S., desc. prec.
- 40.00 Set an iron post 3 ft. long, 1 in. in diam. 26 ins. in the ground for  $\frac{1}{4}$  sec. cor., marked on brass cap,  
 $\frac{1}{4}$  S 23 in N., and  
S 26 in S. half;  
raise a mound of stone 2 ft. base,  $1\frac{1}{2}$  ft. high N. of cor.  
Cor. on E. slope of prec. ridge, brs. N. & S., desc.
- 55.00 Wash, 30 lks. wide, course NNW., asc. prec.  
over huge granite ledges.
- 66.90 Top of spur from high granite ridge to SE., brs. NW. & SE.  
Desc.
- 69.34 Intersect East Boundary of Arizona 30.40 chs. S. of the 373 mile cor., re-established and described by J.B. Wright, in Book "A"  
Set an iron post 3 ft. long, 2 ins. in diam. 24 ins. in the ground for closing cor. of secs. 23 & 26, marked on brass cap, C C, E. of centre.  
ARIZ, T 21 S R 32 E, in W. half, and  
N M, in E. half,  
S 23 in NW., and  
S 26 in SW. quad.;  
raise a mound of stone 2 ft. base,  $1\frac{1}{2}$  ft. high W. of cor.  
Land, very rough, mts.  
Soil, 3rd rate, stony, dry.  
Few oaks and pinons, scrub oak, cacti, fair grass.  
Nov. 6, 1912.
- 
- Nov. 7, 1912. ~~heretofore~~ described  
At 8h a.m., l.m.t., at the cor. of secs. 22, 23, 26 & 27,  
I set off  $16^{\circ}16'$  S. on the decl. arc, and  $31^{\circ}35'$  N. on the lat. arc, and determine a meridian with the solar.  
Thence I run,  
N.  $0^{\circ}11'$  E., bet. secs. 22 & 23.  
Over mts. land, desc. ENE. slope.
- 40.00 Set an iron post 3 ft. long, 1 in. in diam. 10 ins. in the the ground, on bed-rock, in mound of stone for  $\frac{1}{4}$  sec. cor. marked on brass cap,  
 $\frac{1}{4}$  S 22 in W., and  
S 23 in E. half;  
raise a mound of stone 2 ft. base,  $1\frac{1}{2}$  ft. high W. of cor.
- 57.50 Wash, 30 lks. wide, course NNW.
- 61.75 Skeleton Canyon, 150 lks. wide, course WNW., road in bed of same.
- 62.50 Asc.
- 80.00 Set an iron post 3 ft. long, 2 ins. in diam. 24 ins. in the ground for cor. of secs. 14, 15, 22 & 23, marked on brass cap, T 21 S R 32 E, in N. half,  
S 15 in NW.,  
S 14 in NE.,  
S 23 in SE., and  
S 22 in SW. quad.;  
raise a mound of stone 2 ft. base,  $1\frac{1}{2}$  ft. high W. of cor.  
Land, rough, mts.  
Soil, 3rd rate, stony, gravelly granite formation.  
Scrub oak, cacti, few trees, sycamore, mesquite, oak, in Canyon, fair grass.

Chains.  
 40.00 S. 89°58' W., on a random line, bet. secs. 15 & 22.  
 Set temp. 1/4 sec. cor.  
 80.06 Intersect N. & S. line 5 lks. S. of cor. of  
 Secs. 15, 16, 21 & 22, ~~hereinbefore described~~, whence I run,  
 East, on a true line, bet. secs. 15 & 22.  
 Over heavily rolling land, asc.  
 4.00 Top of low ridge, brs. N. & S.  
 5.00 Desc. grad.  
 15.00 Wash, 20 lks. wide, in draw 10 chs. wide, course N.,  
 asc. grad.  
 25.00 Low ridge, brs. N. & S., desc.  
 36.50 Wash, 25 lks. wide, course N.  
 40.03 Set an iron post 3 ft. long, 1 in. in diam. 26 ins. in  
 the ground for 1/4 sec. cor., marked on brass cap,  
 1/4 S 15 in N., and  
 S 22 in S. half;  
 44.00 <sup>Road N. & S.</sup> raise a mound of stone 2 ft. base. 1 1/2 ft. high N. of cor.  
 53.00 Desc. steep to creek bottom.  
 58.60 West bank of dry creek from Skeleton Canyon,  
 60.25 East bank of Skeleton creek, course NNW., asc. steep.  
 61.25 Asc. grad.  
 80.06 To cor. of secs. 14, 15, 22 & 23, ~~hereinbefore described~~.  
 Land, broken, rolling.  
 Soil, 3rd rate, stony, gravelly, dry.  
 Scrub oak, cacti, few oaks in canyon, good grass.  
 At this cor. at noon, I set off 16°20' S. on the decl.  
 arc, and observe the sun on the meridian.  
 The resulting lat. is 31°35 1/2' N.

---

East, bet. secs. 14 & 23.  
 Over mts., broken land, asc.  
 10.00 Spur, brs. N. & S., desc. steep.  
 30.00 Ravine 50 lks. wide, course S., asc.  
 33.00 Spur, brs. N. & S., desc. prec.  
 40.00 Set an iron post 3 ft. long, 1 in. in diam. 26 ins. in  
 the ground for 1/4 sec. cor., marked on brass cap,  
 1/4 S 14 in N., and  
 S 23 in S. half;  
 raise a mound of stone 2 ft. base, 1 1/2 ft. high N. of cor.  
 46.00 Gulch, 20 lks. wide, course S., asc.  
 60.00 Ridge, brs. N. & S., desc. grad.  
 68.94 Intersect East Boundary of Arizona 30.38 chs. S. of  
 372 mile cor., re-established and described by J. B. W. in Book 4.  
 Set an iron post 3 ft. long, 2 ins. in diam. 24 ins. in  
 the ground for closing cor. of secs. 14 & 23, marked on  
 brass cap, C C, E. of centre.  
 ARIZ, T 21 S R 32 E, in W., and  
 N M, in E. half;  
 S 14 in NW., and  
 S 23 in SW. quad.;  
 raise a mound of stone 2 ft. base, 1 1/2 ft. high W. of cor.  
 Land, mts., broken.  
 Soil, 3rd rate, stony, dry.  
 Few oaks, scrub oak, cacti, sparse grass.  
 Nov. 7, 1912.



Chains.

Nov. 8, 1912. (hereinbefore described)  
 At 8h a.m., l.m.t., at the cor. of secs. 14, 15, 22 & 23,  
 I set off  $16^{\circ}33\frac{1}{2}'$  S. on the decl. arc, and  $31^{\circ}35\frac{1}{2}'$  N. on  
 the decl. arc, and determine a meridian with the solar.  
 Thence I run,  
 N.  $0^{\circ}11''$  E., bet. secs. 14 & 15.  
 Over broken, rolling land, desc.  
 4.90 Wash, 10 lks. wide, course W.  
 14.00 Wash, 10 lks. wide, course SSW., leave flat, asc. grad.  
 21.10 Wire fence, brs. E. & W., enter Pasture of Toney's ranch.  
 Thence along W. slope of steep stony granite hill,  
 brs. N. & S.  
 31.50 House of S.T. Toney brs.  $S.55^{\circ}45'$  W., about 30 chs. dist.  
 40.00 Set an iron post 3 ft. long, 1 in. in diam. 26 ins. in  
 the ground for  $\frac{1}{4}$  sec. cor., marked on brass cap,  
 $\frac{1}{4}$  S 15 in W., and  
 S 14 in E. half;  
 raise a mound of stone 2 ft. base,  $1\frac{1}{2}$  ft. high W. of cor.  
 Desc. from cor., WNW. slope.  
 41.00 Gulch, 20 lks. wide, course WNW., asc.  
 42.00 Asc. grad. along W. slope, of hill.  
 44.00 Desc. grad.  
 67.05 Wire fence, brs. WNW. & ESE., leave pasture.  
 80.00 Set an iron post 3 ft. long, 2 ins. in diam. 24 ins. in  
 the ground for cor. of secs. 10, 11, 14 & 15, marked on  
 brass cap, T 21 S R 32 E, in N. half,  
 S 10 in NW.,  
 S 11 in NE.,  
 S 14 in SE., and  
 S 15 in SW. quad.;  
 raise a mound of stone 2 ft. base,  $1\frac{1}{2}$  ft. high W. of cor.  
 Land, broken, rolling.  
 Soil, stony, gravelly.  
 Scrub oak, few cacti, fair grass.

---

West, on a random line, bet. secs. 10 & 15.  
 40.00 Set temp.  $\frac{1}{4}$  sec. cor.  
 80.00 Intersect N. & S. line 5 lks. S. of cor. of  
 secs. 9, 10, 15 & 16, ~~hereinbefore described~~, whence I run,  
 S.  $89^{\circ}58''$  E., on a true line, bet. secs. 10 & 15.  
 Over slightly rolling land.  
 11.00 Road, brs. N. & S.  
 15.00 Enter draw, course N.  
 21.75 Wash, 50 lks. wide, from Skeleton Canyon, course N.  
 23.00 Wash, 40 lks. wide, course N., joins above wash, 2 chs. N.  
 Asc. through mesquite, leave draw.  
 40.00 Set an iron post 3 ft. long, 1 in. in diam. 26 ins. in the  
 the ground for  $\frac{1}{4}$  sec. cor., marked on brass cap,  
 $\frac{1}{4}$  S 10 in N., and  
 S 15 in S. half;  
 raise a mound of stone 2 ft. base,  $1\frac{1}{2}$  ft. high N. of cor.  
 65.00 Desc.  
 79.00 Wash, 10 lks. wide, course N., asc.  
 80.00 To cor. of secs. 10, 11, 14 & 15, ~~hereinbefore described~~.  
 Land, rolling, broken.  
 Soil, 3rd rate, gravelly, stony.  
 Scrub oak, mesquite, good grass.  
 At this cor., at noon. I set off  $16^{\circ}37\frac{1}{2}'$  S. on the decl.  
 arc, and observe the sun on the meridian.  
 The resulting lat. is  $31^{\circ}36\frac{1}{2}'$  N.

|        |  |
|--------|--|
| Chains | <p>East, bet. secs. 11 &amp; 14.<br/> Over mts. land, asc. over North side of hill.<br/> 14.60 Wire fence, brs. N. &amp; S., enter pasture of J.F.Barker.<br/> 29.00 Ridge, brs. N. &amp; S., desc.<br/> 32.00 Wash, 15 lks. wide, course N., asc.<br/> 40.00 Set an iron post 3 ft. long, 1 in. in diam. 26 ins. in the ground for <math>\frac{1}{4}</math> sec. cor., marked on brass cap,<br/> <math>\frac{1}{4}</math> S 11 in N., and<br/> S 14 in S. half; from which,<br/> An oak tree 6 ins. diam. brs. N. <math>64\frac{1}{2}^{\circ}</math> E. 40 lks. dist., marked <math>\frac{1}{4}</math> S 11 B T.<br/> An oak tree 10 ins. diam. brs. S. <math>7^{\circ}</math> E. 56 lks. dist., marked <math>\frac{1}{4}</math> S 14 B T.<br/> Thence along N. slope of hill.<br/> 57.00 Wire fence, brs. N. &amp; S., leave pasture.<br/> 61.00 Wash, 20 lks. wide, course NNW.<br/> 68.60 Intersect East Boundary of Arizona 30.34 chs. S. of 371 mile cor., which is a granite stone 18x10x4 ins. above ground, set in mound of stone, marked and witnessed as described by the Surveyor-General.<br/> Set an iron post 3 ft. long, 2 ins. in diam. 24 ins. in the ground for closing cor. of secs. 11 &amp; 14, marked on brass cap, C C, E. of centre,<br/> ARIZ, T 21 S R 32 E, in W., and<br/> N M, in E. half,<br/> S 11 in NW., and<br/> S 14 in SW. quad.;<br/> raise a mound of stone 2 ft. base, <math>1\frac{1}{2}</math> ft. high W. of cor.<br/> Land, rolling, broken.<br/> Soil, 3rd rate, stony, gravelly, dry.<br/> Few oaks, scrub oak, cacti, sparse grass.</p> |
|        | Nov. 8. 1912.  |
|        | <p>Nov. 9. 1912. <span style="float: right;"><u>hereinbefore</u> described</span><br/> At 8h a.m., l.m.t., at the cor. of secs. 10, 11, 14 &amp; 15,<br/> I set off <math>26^{\circ}50\frac{1}{2}'</math> S. on the decl. arc, and <math>31^{\circ}36\frac{1}{2}'</math> N. on the lat. arc, and determine a meridian with the solar.<br/> Thence I run,<br/> N. <math>0^{\circ}11'</math> E., bet. secs. 10 &amp; 11.<br/> Over rolling land, desc. grad.<br/> 7.40 Gulch 20 lks. wide, course NW.<br/> Thence over level, or gently rolling, grassy plain.<br/> 40.00 Set an iron post 3 ft. long, 1 in. in diam. 26 ins. in the ground for <math>\frac{1}{4}</math> sec. cor., marked on brass cap,<br/> <math>\frac{1}{4}</math> S 10 in W., and<br/> S 11 in E. half;<br/> raise a mound of stone 2 ft. base, <math>1\frac{1}{2}</math> ft. high W. of cor.<br/> 61.70 Wash, 60 lks. wide, course W., asc. gently.<br/> 80.00 Set an iron post 3 ft. long, 2 ins. in diam. 24 ins. in the ground for cor. of secs. 2, 10 &amp; 11, marked on brass cap, T 21 S R 32 E, in N. half,<br/> S 3 in NW.,<br/> S 2 in NE.,<br/> S 11 in SE., and<br/> S 10 in SW. quad.;<br/> raise a mound of stone 2 ft. base, <math>1\frac{1}{2}</math> ft. high W. of cor.<br/> Land, rolling.<br/> Soil, 3rd rate, gravelly, dry.<br/> Scrub oak, cacti, low mesquite, tesseta good grass.</p>   |

Chains.

N. 89°58' W., on a random line, bet. secs. 3 & 10.  
 40.00 Set temp.  $\frac{1}{4}$  sec. cor. (hereinbefore described)  
 80.02 Intersect N. & S. line at cor. of secs. 3, 4, 9 & 10,  
 whence I run,  
 S. 89°58' E., on a true line, bet. secs. 3 & 10.  
 Over gently rolling land, asc. grad.  
 38.00 Desc .  
 40.01 Set an iron post 3 ft. long, 1 in. in diam. 26 ins. in  
 the ground for  $\frac{1}{4}$  sec. cor., marked on brass cap,  
 $\frac{1}{4}$  S 3 in N., and  
 S 10 in S. half;  
 raise a mound of stone 2 ft. base,  $1\frac{1}{2}$  ft. high N. of cor.  
 40.50 Wash, 14 lks. wide, course NW., asc. grad.  
 80.02 To cor. of secs. 2, 3, 10 & 11, hereinbefore described.  
 Land, rolling.  
 Soil, 3rd rate, sandy, gravelly, covered in places with  
 showered volcanic tufa.  
 Scrub oak, mesquite, cacti, good grass.  
 At this cor., at noon, I set off 16°55' S. on the decl.  
 arc, and observe the sun on the meridian.  
 The resulting lat. is 31°37' N.

---

East, bet. secs. 2 & 11.  
 Over gently rolling land, through low mesquite.  
 24.00 Road, brs. NW. & SE.  
 38.50 House of J.F. Barker brs. S. 6 chs. dist.  
 39.00 Asc. low stony ridge, leave mesquite, brs. NW. & SE.  
 40.00 Set an iron post 3 ft. long, 1 in. in diam. 26 ins. in  
 the ground for  $\frac{1}{4}$  sec. cor., marked on brass cap,  
 $\frac{1}{4}$  S 2 in N., and  
 S 11 in S. half;  
 raise a mound of stone 2 ft. base,  $1\frac{1}{2}$  ft. high N. of cor.  
 44.00 Top of hill, brs. N. & S., near S. end, desc.  
 68.40 Intersect East Boundary of Arizona 30.30 chs. S. of  
 the 370 mile cor. on said line, which is a granite  
 stone 16x12x5 ins. set in mound of stone, marked as  
 described by the Surveyor-General.  
 Set an iron post 3 ft. long, 2 ins. in diam. 24 ins. in  
 the ground for closing cor. of secs. 2 & 11. marked on  
 brass cap, C C, E. of centre,  
 ARIZ, T 21 S R 32 E, in W., and  
 N M, in E. half,  
 S 2 in NW., and  
 S 11 in SW. quad.;  
 raise a mound of stone 2 ft. base,  $1\frac{1}{2}$  ft. high W. of cor.  
 Land, rolling, hilly.  
 Soil, 3rd rate, gravelly, sandy, stony.  
 mesquite, cacti, good grass.

Chains.

N. 0° 11' E., bet. secs. 2 & 3.  
 Overrolling land.  
 16.82 Road, brs. NW. & SE.  
 40.00 Set an iron post 3 ft. long, 1 in. in diam. 26 ins. in the ground for  $\frac{1}{4}$  sec. cor., marked on brass cap,  $\frac{1}{4}$  S 3 in W., and S 2 in E. half;  
 dig pits 18x18x12 ins. N. & S. of cor. 3 ft. dist., and raise a mound of earth  $3\frac{1}{2}$  ft. base,  $1\frac{1}{2}$  ft. high W. of cor.  
 49.00 Wash, 15 lks. wide, course NW.  
 85.30 Intersect 4th Std. Par. S. at a point whence, Std.  $\frac{1}{4}$  sec. cor. on S. bdy. sec. 34, T. 20 S., R. 32 E., brs. N. 89° 52' E., 8.91 chs. dist., as recently re-established by me, and heretofore described in Book "B"  
 Set an iron post 3 ft. long, 2 ins. in diam. 24 ins. in the ground for closing cor. of secs. 2 & 3, marked on brass cap, C C, S. of centre.  
 T 20 S R 32 E, S 33, S 34 in N. half,  
 S 2 in SE., and  
 S 3 in SW. quad.;  
 dig pits 24x18x12 ins., crosswise on each line, E. & W. 3 ft., and S. of cor. 7 ft. dist., and raise a mound of earth 4 ft. base, 2 ft. high S. of cor.  
 Land, rolling.  
 Soil, 3rd rate, sandy, gravelly, dry.  
 Sparse mesquite, cacti, good grass.

Nov. 9, 1912. W.H.E.  
 Note :- lines bet. secs. 26 & 35, 23 & 26, 14 & 23, 11 & 14, and 2 & 11 were run East, and flags left at known theoretic points by W.H. Elliott during the subdivision of this Tp., being unable to find the corners thereon. The closing corners proper were set by J.B. Wright on Nov. 14 & 15 at the intersection of these East lines with said E. bdy. of Ariz., when making the retracement of E. bdy. of Ariz. from Mile. cors. 371-378.  
 J.B.W. & W.H.E.

Fractional

General Description.

T. 21 S., R. 32 E. is rough and mts. in the southern and rolling or smooth in the northern portion. The greater portion is good grazing land, with some good tracts of agricultural land in the broad draws or flats in the northern portion. There is no water available for irrigation in the Tp. or from any other source or location. There are several good wells for watering cattle in the gulches near the various ranches noted below, also several good storage reservoirs that hold water the greater part of the year. The following parties have located on lands in the Tp., and have good houses and other substantial improvements such as wells, windmills, corrals, and tanks :-  
 J.E. Summers, in sec. 10,  
 J.J. Wheeler, " " 4,  
 San Simon Cattle Co., in sec. 10,  
 J.F. Barker, in sec. 11, and  
 S.T. Toney, in sec. 15.  
 The soil is in general a loose, sandy loam, from the granite decomposition of adjacent mountains, with some clay underlying in places, and covered in places with showered volcanic tufa.  
 There is some oak, pinon, cedar, and juniper timber in the southern portion in the higher or mountain-part, but none suitable for building or commercial purposes.  
 The mountainous parts are mineralized, several locations being noted, but no developed mines.  
 Jesse B. Wright.  
 William B. Smith. U.S. Surveyors.

CERTIFICATE OF ASSISTANTS.

(Same applies to surveys of Subdivision lines in Books E,H,J,L, O,P,Q,R,S,U,V,W, and X.)

We, the undersigned, hereby certify upon honor that we assisted, to the best of our skill and ability,

William H. Elliott

, U. S. Surveyor, during the periods and in the capacities

stated opposite our several signatures, in surveying all those parts or portions of Subdivision

lines of townships under Group 17, Arizona, as follows:

T.18 S., R.15 E., T.19 S., R.18 E., T.19 S., R.19 E., T.19 S., R.24 E.,  
T.20 S., R.23 E., T.20 S., R.24 E., ~~frac.~~ T.21 S., R.32 E., T.22 S., R.30  
E., frac. T.22 S., R.32 E., T.23 S., R.15 E., T.23 S., R.29 E.,  
T.23 S., R.30 E., frac. T.24 S., R.30 E., and frac. T.24 S., R.32 E.

of the Gila & Salt River Base & Meridian, in the State of Arizona,

*and notes in Books E H J L O P Q R S U V W and X*

which are represented in the foregoing field notes, as having been executed by him, and under his direction; and that said surveys have been, in all respects, to the best of our knowledge and belief, well and faithfully executed.

| NAME.               | PERIOD OF SERVICE. |                              | CAPACITY.           |
|---------------------|--------------------|------------------------------|---------------------|
|                     | BEGUN.             | ENDED.                       |                     |
| Eric F. Lanagan     | Oct 10, 1912       | Apr 11, 1913                 | Chorman             |
| Robert M. Bonnell   | Oct 24, 1912       | Dec 24, 1912                 | Chorman             |
| Frank E. Shurtliff  | Oct 16, 1912       | Nov 8, 1912                  | Assessor            |
| Thomas H. Shimpfard | Oct 16, 1912       | Dec 25, 1912<br>Feb 10, 1913 | Flagman<br>Chorman  |
| Charles Croych      | Oct 16, 1912       | Feb 10, 1913<br>Apr 11, 1913 | Assessor<br>Chorman |
| Rolla Richhart      | Nov 8, 1912        | Jan 31, 1913                 | Assessor            |
| John B. Estes       | Dec 26, 1912       | Dec 31, 1912                 | Flagman             |
| Patrick Wells       | Jan 1, 1913        | Jan 28, 1913                 | Assessor            |
| George Thompson     | Feb 1, 1913        | Mar 22, 1913                 | Maurdneon           |
| Wm Malloch          | Feb 1, 1913        | Mar 22, 1913                 | Assessor            |
| Ward Young          | Feb 1, 1913        | Apr 11, 1913                 | Flagman             |
| Ricardo Valenzuela  | Mar 22, 1913       | Apr 11, 1913                 | Maurdneon           |

Subscribed and certified to before me on the dates of the final service as shown above.

William H. Elliott

U. S. Surveyor.

28-50  
BOOK 2471

**FINAL OATH OF UNITED STATES SURVEYOR.**  
(Same applies to surveys of Subdivision lines in Books E, H, J, L, O, P, Q, R, S, U, V, W, and X.)

I, William H. Elliott, U. S. Surveyor, do solemnly swear that, in pursuance of special <sup>and supplemental</sup> instructions received from the U. S. Surveyor General for Arizona bearing date of the ~~6th day of Oct. 1911, the 27th day of Nov. 1912~~ the 13th day of Jan. 1913 and the 10th day of March 1913, I have well, faithfully, and truly, in my own proper person, and in strict conformity with said instructions, the Manual of Surveying Instructions, and the laws of the United States, surveyed all those parts or portions of Subdivision lines of townships surveyed under Group 17 as follows:

T.18 S., R.15 E.; T.19 S., R.18 E., T.19 S., R.19 E., T.19 S., R.24 E., T.20 S., R.23 E., T.20 S., R.24 E., frac. T.21 S., R.32 E., T.22 S., R.30 E., frac. T.22 S., R.32 E., T.23 S., R.15 E., T.23 S., R.29 E., T.23 S., R.30 E., frac. T.24 S., R.30 E., & frac. T.24 S., R.32 E.

of the Gila and Salt River Base Meridian, in the State of Arizona, which are represented in the foregoing field notes <sup>and notes in Books E, H, J, L, O, P, Q, R, S, U, V, W and X</sup>, as having been executed by me, and under my direction; and I do further solemnly swear that all the corners of said surveys have been established and perpetuated in strict accordance with the Manual of Surveying Instructions, and the special written instructions of the U. S. Surveyor General for Arizona and in the specific manner described in the field notes, and that the foregoing <sup>and notes in Books E, H, J, L, O, P, Q, R, S, U, V, W and X</sup> are the original field notes of such surveys

William H. Elliott  
U. S. Surveyor.

Subscribed by said William H. Elliott, and sworn to before me }  
this 20th day of June, 1913



Frank S. Ingalls  
SURVEYOR-GENERAL OF ARIZONA

**APPROVAL.**

OFFICE OF THE UNITED STATES SURVEYOR GENERAL,  
Phoenix, Arizona, 1914

The foregoing field notes of the survey of Subdivision lines, frac. T.21 S., R.32 E., of the Gila and Salt River Base and Meridian, Arizona,

executed by Jesse B. Wright and William H. Elliott, U. S. Surveyors, under <sup>their</sup> special instructions <sup>for Group 17</sup>, dated October 6, 1911, having been critically examined, and the necessary corrections and explanations made, the said field notes, and the surveys they describe, are hereby approved.

U. S. Surveyor General.

I certify that the foregoing transcript of the field notes of the above described surveys in \_\_\_\_\_, has been correctly copied from the original notes on file in this office.

U. S. Surveyor General.

**CERTIFICATE OF ASSISTANTS.**

Same applies to surveys of ~~Subdivision~~ lines in Books E, F, I, K, M, N, P, Q, R, S, T, V, W, and X.

We, the undersigned, hereby certify upon honor that we assisted, to the best of our skill and ability, **Jesse B. Wright**, U. S. Surveyor, during the periods and in the capacities

stated opposite our several signatures, in surveying all those parts or portions of ~~subdivision lines~~ of Tps. surveyed under Group 17, as follows:

T. 18 S., R. 15 E., T. 19 S., R. 18 E., T. 19 S., R. 24 E., frac. Tp. 20 S., R. 19 E., T. 20 S., R. 23 E., T. 20 S., R. 24 E., frac. T. 21 S., R. 32 E., T. 22 S., R. 31 E., frac. T. 22 S., R. 32 E., T. 23 S., R. 15 E., T. 23 S., R. 29 E., T. 23 S., R. 31 E., frac. T. 23 S., R. 32 E., frac. T. 24 S., R. 29 E., and frac. T. 24 S., R. 31 E.

of the **Gila & Salt River Base & Meridian**, in the State of **Arizona**, and notes in Books *EFIKMNPQRSTVW and X* which are represented in the foregoing field notes, as having been executed by him, and under his direction; and that said surveys have been, in all respects, to the best of our knowledge and belief, well and faithfully executed.

| NAME.                      | PERIOD OF SERVICE. |                                  | CAPACITY.            |
|----------------------------|--------------------|----------------------------------|----------------------|
|                            | BEGUN.             | ENDED.                           |                      |
| <i>Frank J. McHenry</i>    | Oct. 10, 1912.     | April 11, 1913                   | Chainman.            |
| <i>Samuel Kennedy</i>      | Oct. 13, 1912.     | Jan. 27, 1913.                   | Chainman.            |
| <i>Edward Simpson</i>      | Oct. 15, 1912.     | Jan. 25, 1913.                   | Moundman.            |
| <i>William Bird</i>        | Oct. 16, 1912.     | Jan. 4, 1913.                    | Axeman.              |
| <i>Charles Fast</i>        | Oct. 24, 1912.     | Nov. 30, 1912.                   | Flagman.             |
| <i>Jesse W. Richardson</i> | Nov. 2, 1912.      | Jan. 27, 1913<br>Mch. 22, 1913.  | Axeman.<br>Chainman. |
| <i>John F. Turner</i>      | Jan. 5 1913.       | Jan. 24, 1913.                   | Axeman.              |
| <i>Allen Thompson</i>      | Feb. 1, 1913.      | Mch. 22, 1913.                   | Moundman.            |
| <i>Jesse Greenlee</i>      | Feb. 1, 1913.      | Mch. 22, 1913.<br>Apr. 10, 1913. | Axeman.<br>Chainman. |
| <i>John H. Bygones</i>     | Mch. 12, 1913.     | Apr. 10, 1913.                   | Flagman.             |
| <i>William Leek</i>        | Mch. 23, 1913.     | Mch. 27, 1913.                   | Moundman.            |
| <i>Sydney Morales</i>      | Apr. 4, 1913.      | Apr. 10, 1913.                   | Axeman.              |
| <i>James H. Walker</i>     | Apr. 4, 1913.      | Apr. 10, 1913.                   | Moundman.            |
|                            |                    |                                  |                      |
|                            |                    |                                  |                      |

Subscribed and certified to before me on the dates of the final service as shown above.

*Jesse B. Wright*  
U. S. Surveyor.

3852  
BOOK 2477

FINAL OATH OF UNITED STATES SURVEYOR.

Same applies to surveys of Subdivision lines in Books E, F, I, K, M, N, P, Q, R, S, T, V, W, and X.

Jesse B. Wright

I, \_\_\_\_\_, U. S. Surveyor, do solemnly swear that, in pursuance of special <sup>and supplemental</sup> instructions received from the U. S. Surveyor General for Arizona

bearing date of the ~~6th day of Oct. 1911, the 27th day of Nov. 1912~~ <sup>the 13th day of Jan. 1913 and the 10th day of Mar. 1913</sup>, I have well, faithfully, and truly, in my own proper person, and in strict conformity with said instructions, the Manual of Surveying Instructions, and the laws of the United States, surveyed all those parts or portions of Subdivision lines of Township surveyed under Group 17, as follows:

T. 18 S., R. 15 E., T. 19 S., R. 18 E., T. 19 S., R. 24 E., frac. T. 20 S. R. 19 E., T. 20 S., R. 23 E., T. 20 S., R. 24 E., frac. T. 21 S., R. 32 E., T. 22 S., R. 31 E., frac. T. 22 S. R. 32 E., T. 23 S., R. 15 E., T. 23 S., R. 29 E., T. 23 S., R. 31 E., frac. T. 23 S. R. 32 E., frac. T. 24 S. R. 29 E. and Gila & Salt

River Base & Meridian, in the State of Arizona, which are represented in the foregoing field notes <sup>and notes in Books E F I K M N P Q R S T V W and X</sup>, as having been executed by me, and under my direction; and I do further solemnly swear that all the corners of said surveys have been established and perpetuated in strict accordance with the Manual of Surveying Instructions, and the special written instructions of the U. S. Surveyor General for Arizona and in the specific manner described in the field notes, and that the foregoing <sup>and notes in Books E F I K M N P Q R S T V W and X</sup> are the original field notes of such surveys

*Jesse B. Wright*  
U. S. Surveyor.

Subscribed by said *Jesse B. Wright* and sworn to before me }  
this *20th* day of *June*, 1913



*Frank S. Ingalls*  
SURVEYOR-GENERAL OF ARIZONA

APPROVAL.

OFFICE OF THE UNITED STATES SURVEYOR GENERAL,

*Phoenix, Arizona Jan. 26*, 1914

The foregoing field notes of the survey of Subdivision lines of *the Subdivision lines of* Fractional Township 21 South, Range 32 East, and of the Gila and Salt River Base and Meridian, Arizona

executed by *Jesse B. Wright, and William H. Elliott, U.S. Surveyors* under ~~the~~ <sup>their</sup> special instructions, dated *October 6*, 1911, having been critically examined, and the necessary corrections and explanations made, the said field notes, and the surveys they describe, are hereby approved.

*Frank S. Ingalls*  
U. S. Surveyor General.

I certify that the foregoing transcript of the field notes of the above described surveys in \_\_\_\_\_, has been correctly copied from the original notes on file in this office.